

City of Las Vegas
Office Of The City Clerk
495 South Main Street, 2nd Floor
Las Vegas, Nevada 89101

PRSR
FIRST CLASS MAIL
U.S. Postage
PAID
Las Vegas, NV
Permit No. 1630

Return Service Requested Official Notice of Public Hearing

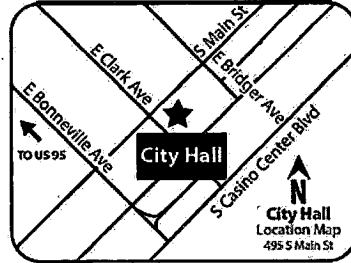

If you wish to file your protest or support on this request, check the appropriate box below and return this card in an envelope with postage to the Office Of The City Clerk at the address listed above or fax this side of this card to (702) 382-4803. If you would like to contact your Council Representative, please call (702) 229-6405.

I SUPPORT
this Request

I OPPOSE
this Request

Please use available blank space on card for your comments.

VAR-66457 & WVR-66636

City Council Meeting of 11/16/2016

Application Information

VAR-66457 - VARIANCE RELATED TO GPA-66455 AND ZON-66456 - PUBLIC HEARING - APPLICANT: SUMMIT HOMES OF NEVADA, LLC - OWNER: ROARING FORK MANAGEMENT, LLC - For possible action on a request for a Variance TO ALLOW A CONNECTIVITY RATIO OF 1.0 WHERE 1.3 IS REQUIRED on 4.78 acres at the northwest corner of Centennial Parkway and Alpine Ridge Way (APN 126-24-401-016), U (Undeveloped) Zone [R (Rural Density Residential) General Plan Designation] [PROPOSED: R-SL (Residential Small Lot)], Ward 6 (Ross) [PRJ-66281].

WVR-66636 - WAIVER RELATED TO GPA-66455, ZON-66456 AND VAR-66457 - PUBLIC HEARING - APPLICANT: SUMMIT HOMES OF NEVADA, LLC - OWNER: ROARING FORK MANAGEMENT, LLC - For possible action on a request for a Waiver TO ALLOW A 182-FOOT EXTERNAL INTERSECTION OFFSET WHERE 220 FEET IS THE MINIMUM SEPARATION REQUIRED FOR A PROPOSED SINGLE FAMILY RESIDENTIAL SUBDIVISION on 4.78 acres at the northwest corner of Centennial Parkway and Alpine Ridge Way (APN 126-24-401-016), U (Undeveloped) Zone [R (Rural Density Residential) General Plan Designation] [PROPOSED: R-SL (Residential Small Lot)], Ward 6 (Ross) [PRJ-66281].

Application Location

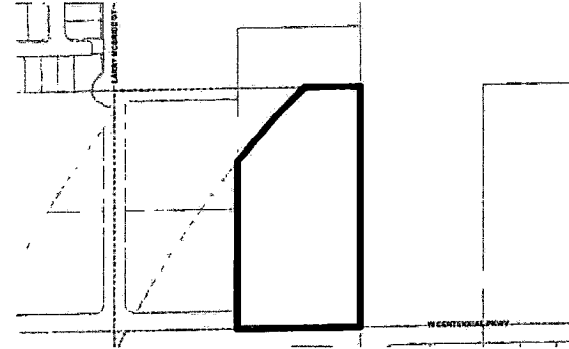

The proposed project may not pertain to the entire highlighted project site.

Public Hearing Information

Meeting: City Council
Date: *November 16, 2016*
Time: 1:00 P.M.
Location: City Council Chambers
495 South Main Street, 2nd Floor
Las Vegas, Nevada

Any and all interested persons may appear and be heard at said meeting, or may, prior thereto, file written objections thereto or approvals thereof with the City Clerk, 2nd Floor, City Hall, 495 South Main Street, Las Vegas, Nevada, 89101. For further information, please call (702) 229-6311 (TTY 7-1-1). **Note that postcards and comments received after an agenda posts will not be reflected online until after the meeting; however, the comments are made available to the members of the governing body for their consideration prior to the meeting.**

Report of All Selected Parcels**Case Number:**

VAR-66457, WVR-66636

Printed On: Tue: October 18, 2016

<u>Owner</u>	<u>Address</u>	<u>Parcel Number</u>
ANGELI RONALD & KATHRYN FAM TR	ANGELI RONALD & KATHRYN TRS 6196 SERENITY BLUFFS ST LAS VEGAS NV 89149	12625501004
ANTON GREGORY JR & LINDSAY	10581 LEROUX CT LAS VEGAS NV 89166	12624414016
AUSTIN JEFFERY R & HOLLY P	6279 CAPE CANAVERAL CT LAS VEGAS NV 89149-1383	12625110017
BANNISTER RONALD S & BARBARA A	10589 LEROUX CT LAS VEGAS NV 89166	12624414018
BERRIOS GLENDA	6390 BUZZ ALDRIN DR LAS VEGAS NV 89149-1389	12625510014
BILL TOWER INVESTMENT TRUST	PARKER ROBERT JEFFREY TRS 380 RANCHO ROSARIO CT LAS VEGAS NV 89138	12624401019
BILL TOWER INVESTMENT TRUST	PARKER ROBERT JEFFREY TRS 380 RANCHO ROSARIO CT LAS VEGAS NV 89138	12624401017
BLACK FAMILY TRUST	BLACK JAMES C & JEAN M CO-TRS 6104 KINGS BROOK CT LAS VEGAS NV 89149-3205	12625511008
BLASER SCOTT & MELODY REV FAM TR	BLASER SCOTT P & MELODY R TRS 10345 W REGENA AVE LAS VEGAS NV 89149-1242	12625501016
BOWLES DALE & LAURA	6293 GALILEO DR LAS VEGAS NV 89149-1385	12625110006
CLARK JEFFREY M & DEBORAH L TRUS	CLARK JEFFREY M & DEBORAH L CO-T 6263 CAPE CANAVERAL CT LAS VEGAS NV 89149	12625110016
CLAYMORE TRUST	CLAYMORE GAY M & VICKY A TRS 6282 BUZZ ALDRIN DR LAS VEGAS NV 89149-1388	12625510006
COURNOYER KRISTINA ANNE	10337 WHITE BISON CT LAS VEGAS NV 89149-1265	12625511002
CRAIG ADAM & CIA'RRRA	6311 BUZZ ALDRIN DR LAS VEGAS NV 89149	12625510009
DAVIS GEOFFREY V	BETTERSON-DAVIS BENITA L 10328 WHITE BISON CT LAS VEGAS NV 89149-1265	12625511004
DAVIS KAYLA	6330 MICHELLI CREST WAY LAS VEGAS NV 89149	12625501027
DAVIS MICHAEL M & LORIE A	6278 GALILEO DR LAS VEGAS NV 89149-1385	12625110008
ELLSWORTH FAMILY TRUST 2007 TR	ELLSWORTH JENNIE L & JOHN C TRS 6296 CAPE CANAVERAL CT LAS VEGAS NV 89149-1383	12625110019
EXZABE JAIME K	6422 DUNNS RIVER ST LAS VEGAS NV 89166	12624414009
FRABBIELE TIMOTHY	6371 BUZZ ALDRIN DR LAS VEGAS NV 89149	12625510012
GAMBLIN KENNETH	6350 MICHELLI CREST WAY LAS VEGAS NV 89113	12625501026
GONSALVES FAMILY TRUST	GONSALVES JOHN M & CYNTHIA E TRS 10312 WHITE BISON CT LAS VEGAS NV 89149-1265	12625511005
GRAY JASON S	6291 BUZZ ALDRIN DR LAS VEGAS NV 89149-1388	12625510005
GRAY RUSSELL A & VIRGINIA D	10447 MOUNT MITCHELL CT LAS VEGAS NV 89149	12625112020
GREGORY SCOTT L	6350 BUZZ ALDRIN DR LAS VEGAS NV 89149-1389	12625510016
GREYSTONE NEVADA L L C	2490 PASEO VERDE PKWY #120 HENDERSON NV 89074	12625112022
GREYSTONE NEVADA L L C	2490 PASEO VERDE PKWY #120 HENDERSON NV 89074	12625112003
GREYSTONE NEVADA L L C	2490 PASEO VERDE PKWY #120 HENDERSON NV 89074	12625112015
GREYSTONE NEVADA L L C	2490 PASEO VERDE PKWY #120 HENDERSON NV 89074	12625112033
GREYSTONE NEVADA L L C	2490 PASEO VERDE PKWY #120 HENDERSON NV 89074	12625112025
GREYSTONE NEVADA L L C	2490 PASEO VERDE PKWY #120 HENDERSON NV 89074	12625112005
GREYSTONE NEVADA L L C	2490 PASEO VERDE PKWY #120 HENDERSON NV 89074	12625112018

Report of All Selected Parcels**Case Number:**

VAR-66457, WVR-66636

Printed On: Tue: October 18, 2016

<u>Owner</u>	<u>Address</u>	<u>Parcel Number</u>
GREYSTONE NEVADA L L C	2490 PASEO VERDE PKWY #120 HENDERSON NV 89074	12625112031
GREYSTONE NEVADA L L C	2490 PASEO VERDE PKWY #120 HENDERSON NV 89074	12625112023
GREYSTONE NEVADA L L C	2490 PASEO VERDE PKWY #120 HENDERSON NV 89074	12625112004
GREYSTONE NEVADA L L C	2490 PASEO VERDE PKWY #120 HENDERSON NV 89074	12625112002
GREYSTONE NEVADA L L C	2490 PASEO VERDE PKWY #120 HENDERSON NV 89074	12625112028
GREYSTONE NEVADA L L C	2490 PASEO VERDE PKWY #120 HENDERSON NV 89074	12625112024
GREYSTONE NEVADA L L C	2490 PASEO VERDE PKWY #120 HENDERSON NV 89074	12625112019
GREYSTONE NEVADA L L C	2490 PASEO VERDE PKWY #120 HENDERSON NV 89074	12625112021
GREYSTONE NEVADA L L C	2490 PASEO VERDE PKWY #120 HENDERSON NV 89074	12625112013
GREYSTONE NEVADA L L C	2490 PASEO VERDE PKWY #120 HENDERSON NV 89074	12625112011
GREYSTONE NEVADA L L C	2490 PASEO VERDE PKWY #120 HENDERSON NV 89074	12625112029
GREYSTONE NEVADA L L C	2490 PASEO VERDE PKWY #120 HENDERSON NV 89074	12625112014
GREYSTONE NEVADA L L C	2490 PASEO VERDE PKWY #120 HENDERSON NV 89074	12625112010
GREYSTONE NEVADA L L C	2490 PASEO VERDE PKWY #120 HENDERSON NV 89074	12625112017
GREYSTONE NEVADA L L C	2490 PASEO VERDE PKWY #120 HENDERSON NV 89074	12625112001
GREYSTONE NEVADA L L C	2490 PASEO VERDE PKWY #120 HENDERSON NV 89074	12625112009
GREYSTONE NEVADA L L C	2490 PASEO VERDE PKWY #120 HENDERSON NV 89074	12625112030
GREYSTONE NEVADA L L C	2490 PASEO VERDE PKWY #120 HENDERSON NV 89074	12625112016
GREYSTONE NEVADA L L C	2490 PASEO VERDE PKWY #120 HENDERSON NV 89074	12625112032
GREYSTONE NEVADA L L C	2490 PASEO VERDE PKWY #120 HENDERSON NV 89074	12625112026
GREYSTONE NEVADA L L C	2490 PASEO VERDE PKWY #120 HENDERSON NV 89074	12625112006
GREYSTONE NEVADA L L C	2490 PASEO VERDE PKWY #120 HENDERSON NV 89074	12625112012
GREYSTONE NEVADA L L C	2490 PASEO VERDE PKWY #120 HENDERSON NV 89074	12625112007
GREYSTONE NEVADA L L C	2490 PASEO VERDE PKWY #120 HENDERSON NV 89074	12625112008
GREYSTONE NEVADA L L C	2490 PASEO VERDE PKWY #120 HENDERSON NV 89074	12625112027
HART GLEN A & DEBORAH P	6330 BUZZ ALDRIN DR LAS VEGAS NV 89149-1389	12625510017
JACOBS ETHEL H TRUST	JACOBS ALAN & ETHEL J TRS 6245 MICHELLI CREST WY LAS VEGAS NV 89149-1238	12625510007
JOBSKI GLENN DUANE & SELENA MARI	6351 BUZZ ALDRIN DR LAS VEGAS NV 89149-1389	12625510011
JOHNSON CHARLES E	6294 GALILEO DR LAS VEGAS NV 89149-1385	12625110007
KIM GENA C	209 CHALMETTE DR #4 NORMAN OK 73071	12625511009
KNIGHT THOMAS S	6430 DUNNS RIVER DR LAS VEGAS NV 89166	12624414007
KOEHLMOOS ASHLEY & TRAVIS	6417 DUNNS RIVER ST LAS VEGAS NV 89166	12624414015

Report of All Selected Parcels**Case Number:**

VAR-66457, WVR-66636

Printed On: Tue: October 18, 2016

<u>Owner</u>	<u>Address</u>	<u>Parcel Numbe</u>
LANGER ROBERT	6271 BUZZ ALDRIN DR LAS VEGAS NV 89149-1388	12625510004
LAWRENCE ALI	YUHAS CHRISTINE 6434 DUNNS RIVER ST LAS VEGAS NV 89166	12624414006
LONGA DAVID W & LYDIA B	6380 MICHELLI CREST WAY LAS VEGAS NV 89149	12625501024
LYNDS TROY P & DEBORAH L	6264 CAPE CANAVERAL CT LAS VEGAS NV 89149-1383	12625110021
MADSEN JAMES R	6310 MICHELLI CREST WY LAS VEGAS NV 89149-1221	12625501005
MALIN R & L TRUST	MALIN ROBERT & LISA ANNE TRS 6261 GALILEO DR LAS VEGAS NV 89149-1385	12625110004
MAURER FAMILY TRUST	MAURER MARK F & KATHLEEN M CO-TR 10309 HAVKIN CT LAS VEGAS NV 89149-1266	12625511006
MCCABE FAMILY TRUST	MCCABE GREG A & BETSY R TRS 6262 GALILEO DR LAS VEGAS NV 89149-1385	12625110009
MCKEEVER DEKKER N V R E L L C	YORK BREANNA 10255 REGENA AVE LAS VEGAS NV 89149	12625501020
NEWMAN BARBARA LIVING TRUST	3425 CLIFF SHADOWS PKWY #130 LAS VEGAS NV 89129	12624401024
O'BRIEN 2002 FAMILY REVOCABLE TR	NEWMAN BARBARA D TRS 6280 CAPE CANAVERAL CT LAS VEGAS NV 89149-1383	12625110020
O'DELL LISA L & JOHNNY R	O'BRIEN TIMOTHY P & PHYLLIS R TR 6277 GALILEO DR LAS VEGAS NV 89149-1385	12625110005
OETTINGER KARL & ERICA	6331 BUZZ ALDRIN DR LAS VEGAS NV 89149-1389	12625510010
OFIANA MARLO F & YVEN M	10325 HAVKIN CT LAS VEGAS NV 89149-1266	12625511007
PALECZNY STEPHANY & MICHAEL	10576 COPPERAS COVE AVE LAS VEGAS NV 89166	12624416021
PARKER PLACE FAMILY TRUST	6426 DUNNS RIVER ST LAS VEGAS NV 89166	12624414008
RAMOS ROBERTO JR & LUISA M	PARKER LEVI D & ISABELLE D TRS 10311 WHITE BISON CT LAS VEGAS NV 89149	12625511001
RICHMOND AMERICAN HOMES NEVADA I	P O BOX 621544 LAS VEGAS NV 89162	12624414017
RICHMOND AMERICAN HOMES NEVADA I	4350 S MONACO ST DENVER CO 80237	12624417016
RICHMOND AMERICAN HOMES NEVADA I	4350 S MONACO ST DENVER CO 80237	12624417031
RICHMOND AMERICAN HOMES NEVADA I	4350 S MONACO ST DENVER CO 80237	12624417015
RICHMOND AMERICAN HOMES NEVADA I	4350 S MONACO ST DENVER CO 80237	12624417006
RICHMOND AMERICAN HOMES NEVADA I	4350 S MONACO ST DENVER CO 80237	12624417017
RICHMOND AMERICAN HOMES NEVADA I	4350 S MONACO ST DENVER CO 80237	12624414022
RICHMOND AMERICAN HOMES NEVADA I	4350 S MONACO ST DENVER CO 80237	12624417008
RICHMOND AMERICAN HOMES NEVADA I	4350 S MONACO ST DENVER CO 80237	12624417027
RICHMOND AMERICAN HOMES NEVADA I	4350 S MONACO ST DENVER CO 80237	12624417012
RICHMOND AMERICAN HOMES NEVADA I	4350 S MONACO ST DENVER CO 80237	12624416002
RICHMOND AMERICAN HOMES NEVADA I	4350 S MONACO ST DENVER CO 80237	12624417025
RICHMOND AMERICAN HOMES NEVADA I	4350 S MONACO ST DENVER CO 80237	12624417007
RICHMOND AMERICAN HOMES NEVADA I	4350 S MONACO ST DENVER CO 80237	12624417003
RICHMOND AMERICAN HOMES NEVADA I	4350 S MONACO ST DENVER CO 80237	12624416020

Report of All Selected Parcels

Case Number:

VAR-66457, WVR-66636

Printed On: Tue: October 18, 2016

<u>Owner</u>	<u>Address</u>	<u>Parcel Number</u>
RICHMOND AMERICAN HOMES NEVADA I	4350 S MONACO ST DENVER CO 80237	12624417001
RICHMOND AMERICAN HOMES NEVADA I	4350 S MONACO ST DENVER CO 80237	12624417026
RICHMOND AMERICAN HOMES NEVADA I	4350 S MONACO ST DENVER CO 80237	12624417011
RICHMOND AMERICAN HOMES NEVADA I	4350 S MONACO ST DENVER CO 80237	12624415001
RICHMOND AMERICAN HOMES NEVADA I	4350 S MONACO ST DENVER CO 80237	12624417020
RICHMOND AMERICAN HOMES NEVADA I	4350 S MONACO ST DENVER CO 80237	12624416015
RICHMOND AMERICAN HOMES NEVADA I	4350 S MONACO ST DENVER CO 80237	12624416027
RICHMOND AMERICAN HOMES NEVADA I	4350 S MONACO ST DENVER CO 80237	12624414027
RICHMOND AMERICAN HOMES NEVADA I	4350 S MONACO ST DENVER CO 80237	12624414001
RICHMOND AMERICAN HOMES NEVADA I	4350 S MONACO ST DENVER CO 80237	12624414004
RICHMOND AMERICAN HOMES NEVADA I	4350 S MONACO ST DENVER CO 80237	12624417022
RICHMOND AMERICAN HOMES NEVADA I	4350 S MONACO ST DENVER CO 80237	12624417033
RICHMOND AMERICAN HOMES NEVADA I	4350 S MONACO ST DENVER CO 80237	12624417029
RICHMOND AMERICAN HOMES NEVADA I	4350 S MONACO ST DENVER CO 80237	12624414003
RICHMOND AMERICAN HOMES NEVADA I	4350 S MONACO ST DENVER CO 80237	12624417018
RICHMOND AMERICAN HOMES NEVADA I	4350 S MONACO ST DENVER CO 80237	12624416019
RICHMOND AMERICAN HOMES NEVADA I	4350 S MONACO ST DENVER CO 80237	12624416017
RICHMOND AMERICAN HOMES NEVADA I	4350 S MONACO ST DENVER CO 80237	12624416018
RICHMOND AMERICAN HOMES NEVADA I	4350 S MONACO ST DENVER CO 80237	12624417019
RICHMOND AMERICAN HOMES NEVADA I	4350 S MONACO ST DENVER CO 80237	12624417023
RICHMOND AMERICAN HOMES NEVADA I	4350 S MONACO ST DENVER CO 80237	12624417010
RICHMOND AMERICAN HOMES NEVADA I	4350 S MONACO ST DENVER CO 80237	12624414002
RICHMOND AMERICAN HOMES NEVADA I	4350 S MONACO ST DENVER CO 80237	12624417034
RICHMOND AMERICAN HOMES NEVADA I	4350 S MONACO ST DENVER CO 80237	12624414030
RICHMOND AMERICAN HOMES NEVADA I	4350 S MONACO ST DENVER CO 80237	12624417005
RICHMOND AMERICAN HOMES NEVADA I	4350 S MONACO ST DENVER CO 80237	12624416004
RICHMOND AMERICAN HOMES NEVADA I	4350 S MONACO ST DENVER CO 80237	12624416016
RICHMOND AMERICAN HOMES NEVADA I	4350 S MONACO ST DENVER CO 80237	12624414033
RICHMOND AMERICAN HOMES NEVADA I	4350 S MONACO ST DENVER CO 80237	12624416026
RICHMOND AMERICAN HOMES NEVADA I	4350 S MONACO ST DENVER CO 80237	12624417004
RICHMOND AMERICAN HOMES NEVADA I	4350 S MONACO ST DENVER CO 80237	12624414026
RICHMOND AMERICAN HOMES NEVADA I	4350 S MONACO ST DENVER CO 80237	12624414024

Report of All Selected Parcels**Case Number:**

VAR-66457, WVR-66636

Printed On: Tue: October 18, 2016

<u>Owner</u>	<u>Address</u>	<u>Parcel Numbe</u>
RICHMOND AMERICAN HOMES NEVADA I	4350 S MONACO ST DENVER CO 80237	12624417009
RICHMOND AMERICAN HOMES NEVADA I	4350 S MONACO ST DENVER CO 80237	12624417032
RICHMOND AMERICAN HOMES NEVADA I	4350 S MONACO ST DENVER CO 80237	12624417021
RICHMOND AMERICAN HOMES NEVADA I	4350 S MONACO ST DENVER CO 80237	12624414019
RICHMOND AMERICAN HOMES NEVADA I	4350 S MONACO ST DENVER CO 80237	12624414023
RICHMOND AMERICAN HOMES NEVADA I	4350 S MONACO ST DENVER CO 80237	12624414025
RICHMOND AMERICAN HOMES NEVADA I	4350 S MONACO ST DENVER CO 80237	12624416003
RICHMOND AMERICAN HOMES NEVADA I	4350 S MONACO ST DENVER CO 80237	12624416001
RICHMOND AMERICAN HOMES NEVADA I	4350 S MONACO ST DENVER CO 80237	12624417013
RICHMOND AMERICAN HOMES NEVADA I	4350 S MONACO ST DENVER CO 80237	12624417024
RICHMOND AMERICAN HOMES NEVADA I	4350 S MONACO ST DENVER CO 80237	12624415002
RICHMOND AMERICAN HOMES NEVADA I	4350 S MONACO ST DENVER CO 80237	12624417002
RICHMOND AMERICAN HOMES NEVADA I	4350 S MONACO ST DENVER CO 80237	12624414032
RICHMOND AMERICAN HOMES NEVADA I	4350 S MONACO ST DENVER CO 80237	12624414020
RICHMOND AMERICAN HOMES NEVADA I	4350 S MONACO ST DENVER CO 80237	12624417014
RICHMOND AMERICAN HOMES NEVADA I	4350 S MONACO ST DENVER CO 80237	12624414031
RICHMOND AMERICAN HOMES NEVADA I	4350 S MONACO ST DENVER CO 80237	12624417030
RICHMOND AMERICAN HOMES NEVADA I	4350 S MONACO ST DENVER CO 80237	12624416028
RICHMOND AMERICAN HOMES NEVADA I	4350 S MONACO ST DENVER CO 80237	12624414034
RICHMOND AMERICAN HOMES NEVADA I	4350 S MONACO ST DENVER CO 80237	12624414021
RICHMOND AMERICAN HOMES NEVADA I	4350 S MONACO ST DENVER CO 80237	12624417028
RIVERA DAWN & BOBBY	10575 PELICAN ISLAND AVE LAS VEGAS NV 89166	12624416022
RIVNEY FAMILY TRUST	RIVNEY MICHAEL R & HOLLY TRS 10325 W REGENA AVE LAS VEGAS NV 89149-1242	12625501017
ROARING FORK MANAGEMENT L L C	11603 GLOWING SUNSET LN LAS VEGAS NV 89135-1659	12624401016
SALEEM MUNERRAH	6408 DUNNS RIVER ST LAS VEGAS NV 89166	12624414012
SAN PAN FAMILY TRUST	10310 HAVKIN CT LAS VEGAS NV 89149-1266	12625511011
SCALZO CARL & SABRINA	P O BOX 428 FLORHAM PARK NJ 07932	12624414014
SCHOOL BOARD OF TRUSTEES	4190 MCLEOD DR 2ND FLR LAS VEGAS NV 89121	12624801003
SCHOOL BOARD OF TRUSTEES	4190 MCLEOD DR 2ND FLR LAS VEGAS NV 89121	12624801002
SCHOOL BOARD OF TRUSTEES	4190 MCLEOD DR 2ND FLR LAS VEGAS NV 89121	12624801007
SCOTT BRANDON W	10344 WHITE BISON CT LAS VEGAS NV 89149	12625511003
SHALLENBERGER JAKOB	10571 PELICAN ISLAND AVE LAS VEGAS NV 89166	12624416023

Report of All Selected Parcels**Case Number:**

VAR-66457, WVR-66636

Printed On: Tue: October 18, 2016

<u>Owner</u>	<u>Address</u>	<u>Parcel Number</u>
SOTO MELINDA MANGUBAT	6370 MICHELLI CREST WAY LAS VEGAS NV 89149	12625501025
STEELE FANNYE M	6391 BUZZ ALDRIN DR LAS VEGAS NV 89149-1389	12625510013
STEINER LIVING TRUST	STEINER ALVIN LEO JR & ROSANNE M 6414 DUNNS RIVER ST LAS VEGAS NV 89166	12624414011
SUDBERRY CHARLES A	HALLENBERG JENNIFER A 6370 BUZZ ALDRIN DR LAS VEGAS NV 89149-1389	12625510015
SUFFOLETTA JEFFREY N	10326 HAVKIN CT LAS VEGAS NV 89149-1266	12625511010
THOMPSON SHAUN M & JESSICA A	10567 PELICAN ISLAND AVE LAS VEGAS NV 89166	12624416024
TYLER CHARLES L & KATHERINE L	6295 CAPE CANAVERAL LAS VEGAS NV 89149-1383	12625110018
WASHINGTON MARC P & GEORGIA E	6407 DUNNS RIVER ST LAS VEGAS NV 89166	12624414013
WONGTAREO PICHET & MONSALAI	6418 DUNNS RIVER ST LAS VEGAS NV 89166	12624414010
WOOLFORD ROBERT E & LESLIE L	6251 BUZZ ALDRIN DR LAS VEGAS NV 89149-1388	12625510003
WYSZOMIRSKI BRIGID E	6310 BUZZ ALDRIN DR LAS VEGAS NV 89149	12625510018
ZIROS PETRA	6438 DUNNS RIVER ST LAS VEGAS NV 89166	12624414005