

City of Las Vegas
Office Of The City Clerk
495 South Main Street, 2nd Floor
Las Vegas, Nevada 89101

PPSRT STD
U.S. Postage
PAID
Las Vegas, NV
Permit No. 1630

Return Service Requested Official Notice of Public Hearing

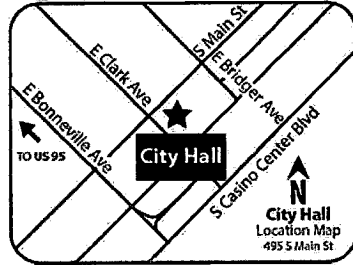

If you wish to file your protest or support on this request, check the appropriate box below and return this card in an envelope with postage to the Office Of The City Clerk at the address listed above or fax this side of this card to (702) 382-4803. If you would like to contact your Council Representative, please call (702) 229-6405.

I SUPPORT
this Request

I OPPOSE
this Request

Please use available blank space on card for your comments.

VAR-65909 & VAR-66310

City Council Meeting of 10/5/2016

Application Information

VAR-65909 - VARIANCE - PUBLIC HEARING - APPLICANT: FOUNDERS ACADEMY OF LAS VEGAS - OWNER: PRE RANCHO JONES, LLC - For possible action on a request for a Variance TO ALLOW AN EIGHT-FOOT TALL WALL IN THE FRONT YARD WHERE A MAXIMUM WALL HEIGHT OF FIVE FEET IS ALLOWED on a 6.11 acre portion of a 17.08 acre parcel on the northwest corner of Leon Avenue and Alexander Road (APN 138-01-401-003), U (Undeveloped) Zone, [ML (Medium Low Density Residential) General Plan Designation], Ward 5 (Barlow) [PRJ-65274]. The Planning Commission (6-0 vote) and Staff recommend APPROVAL.

VAR-66310 - VARIANCE RELATED TO VAR-65909 - PUBLIC HEARING - APPLICANT: FOUNDERS ACADEMY OF LAS VEGAS - OWNER: PRE RANCHO JONES, LLC - For possible action on a request for a Variance TO ALLOW A DEVIATION FROM COMPLETE STREETS STANDARDS TO PROVIDE A HORSE TRAIL IN PLACE OF A SIDEWALK ADJACENT TO LEON AVENUE on a 6.11 acre portion of a 17.08 acre parcel on the northwest corner of Leon Avenue and Alexander Road (APN 138-01-401-003), U (Undeveloped) Zone, [ML (Medium Low Density Residential) General Plan Designation], Ward 5 (Barlow) [PRJ-65274]. Staff recommends DENIAL. The Planning Commission recommends APPROVAL.

Application Location

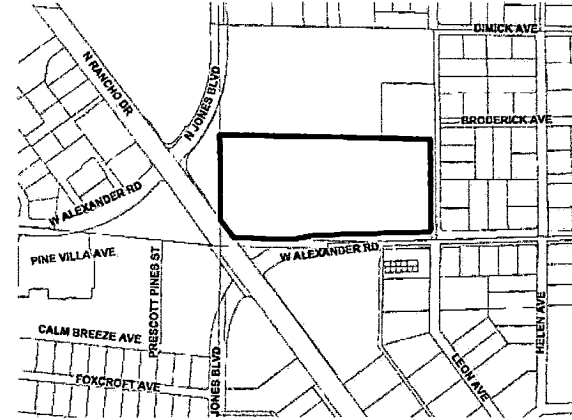

The proposed project may not pertain to the entire highlighted project site.

Public Hearing Information

Meeting: City Council
Date: *October 05, 2016*
Time: 9:00 A.M.
Location: City Council Chambers
495 South Main Street, 2nd Floor
Las Vegas, Nevada

Any and all interested persons may appear and be heard at said meeting, or may, prior thereto, file written objections thereto or approvals thereof with the City Clerk, 2nd Floor, City Hall, 495 South Main Street, Las Vegas, Nevada, 89101. For further information, please call (702) 229-6311 (TTY 7-1-1). **Note that postcards and comments received after an agenda posts will not be reflected online until after the meeting; however, the comments are made available to the members of the governing body for their consideration prior to the meeting.**

Report of All Selected Parcels**Case Number:** VAR-65909 & VAR-66310**Printed On:** Wed: August 3, 2016

<u>Owner</u>	<u>Address</u>	<u>Parcel Number</u>
3920 SWEET PINE L L C	12855 S W 57TH AVE CORAL GABLES FL 33156	13811517054
4631 W S M L L C	%F SHAKIB 16461 SHERMAN WY #140 VAN NUYS CA 91406-3856	13812110012
4631 W S M L L C	16461 SHERMAN WY #140 VAN NUYS CA 91406-3856	13812110012
6164 ALEXANDER L L C	10033 TRAPPER MOUNTAIN ST LAS VEGAS NV 89178	13802801003
A D K FAMILY TRUST 2000	DIAZ ANGEL SANDOVAL TRS 7920 W LONE MOUNTAIN RD LAS VEGAS NV 89129-5302	13811511012
ABAIR ALAN & SANDRA	3A RED MAPLE LN CLIFTON PARK NY 12065	13811517050
ABEL STEVEN F & LEANNE E FAM TR	ABEL STEVEN F & LEANNE E TRS 1819 BELCASTRO ST LAS VEGAS NV 89117-2103	13811517086
ABEL STEVEN F & LEANNE E FAM TR	%S ABEL 1819 BELCASTRO ST LAS VEGAS NV 89117-2103	13811517088
ABEL STEVEN F & LEANNE E FAM TR	%S ABEL 1819 BELCASTRO ST LAS VEGAS NV 89117-2103	13811517155
ACEVEDO ISELA	6140 PINE VILLA AVE #102 LAS VEGAS NV 89108	13811517005
ACHIARDI MICHELLE	3066 CADBURY DR LAS VEGAS NV 89121-5608	13802803001
ADAMS CALVIN & ITASKA	5413 DIMICK AVE LAS VEGAS NV 89130-2551	13801403002
AGUILAR MELINDA P	907 CRESCENT AVE SAN FRANCISCO CA 94110-6153	13811517074
ALLRED JOY KAY	4209 HELEN AVE LAS VEGAS NV 89130-2530	13801305005
AMIRI HEIDI	DOWLATSHAHI PATRICK NIMA 4777 CRAKOW CT LAS VEGAS NV 89147-8123	13811517020
AMIRI HEIDI	DOWLATSHAHI PATRICK N 4777 CRAKOW CT LAS VEGAS NV 89147	13811517110
ANAYA ELSA YADIRA	2800 E TONOPAH AVE NORTH LAS VEGAS NV 89030	13801402004
ANNILLO JOHN J	8-6TH ST PARK RIDGE NJ 07656-1938	13811515035
ARIYOSHI DYAN & REED	618 ANELA PL WAILUKU HI 96793	13811517171
ARIYOSHI DYAN & REED	618 ANELA PL WAILUKU HI 96793	13811517040
AVILA DENISE	3905 SWEET PINE ST #101 LAS VEGAS NV 89108-5195	13811517158
AVILA DENISE	3905 SWEET PINE ST #101 LAS VEGAS NV 89108-5195	13811517079
BAHAM CHIN-JUNG	3904 LAZY PINE ST #102 LAS VEGAS NV 89108	13811517083
BARCLEY MYRA L	6170 CALM BREEZE AVE #102 LAS VEGAS NV 89108-8112	13811517119
BARLING HAROLD R REV TR AGMT	BARLING HAROLD R TRS 6164 PINE VILLA AVE LAS VEGAS NV 89108-5194	13811515018
BARTHELEMY JANE	8000 W BADURA #2126 LAS VEGAS NV 89113-2117	13811517100
BARTHELEMY JANE	8000 W BADURA #2126 LAS VEGAS NV 89113-2117	13811517151
BARTSAS MARY 13 L L C	601 S RANCHO DR #C23 LAS VEGAS NV 89106-4825	13811502003
BARTSAS MARY 13 L L C	601 S RANCHO DR #C23 LAS VEGAS NV 89106-4825	13812110049
BARTSAS MARY 13 L L C	601 S RANCHO DR #C23 LAS VEGAS NV 89106-4825	13812110049
BASA DALE	6153 PINE DESERT AVE #102 LAS VEGAS NV 89108-8155	13811517137
BAUTISTA-AGUILAR SIMON	581 OLD WEST CT LAS VEGAS NV 89110-3283	13812110041

Report of All Selected ParcelsCase Number:

VAR-65909

Printed On: Wed: August 3, 2016

<u>Owner</u>	<u>Address</u>	<u>Parcel Number</u>
BEDARD ANTHONY	5601 BRODERICK AVE LAS VEGAS NV 89130	13801404004
BEDARD ANTHONY J	5601 BRODERICK AVE LAS VEGAS NV 89130	13801404003
BERRY LIVING TRUST	BERRY PATRICIA S TRS 6164 PINE VILLA AVE #104 LAS VEGAS NV 89108	13811515149
BERRY LIVING TRUST	BERRY PATRICIA S TRS 6164 PINE VILLA AVE #104 LAS VEGAS NV 89108	13811515020
BERTOCCHINI FAMILY TRUST	BERTOCCHINI LENO OR KAY J CO-TRS 3922 HELEN AVE LAS VEGAS NV 89130-2819	13812110046
BERTOCCHINI FAMILY TRUST	BERTOCCHINI LENO OR KAY J CO-TRS 3922 HELEN AVE LAS VEGAS NV 89130-2819	13812110046
BOTT LEAH RENEE LIVING TRUST	BOTT LEAH RENEE TRS 2018 KARSEN LN HEARTLAND TX 75126	13811517062
BOWGREN DALE H & MARGARET C	P O BOX 28112 LAS VEGAS NV 89126-2112	13812110014
BOWGREN FAMILY L P	5320 BRAEMAR DR LAS VEGAS NV 89130-2021	13812110013
BOWGREN FAMILY L P	5320 BRAEMAR DR LAS VEGAS NV 89130-2021	13812110013
BRASSARD ROBERT	6124 FOXCROFT AVE LAS VEGAS NV 89108	13811511008
BROOKS PAULA	9526 CAPISTRANO AVE CHATSWORTH CA 91311-2631	13811517032
BROOKS STEWART	9526 CAPISTRANO AVE CHATSWORTH CA 91311-2631	13811517089
BROOKS STEWART & PAULA	9526 CAPISTRANO AVE CHATSWORTH CA 91311-2631	13811517018
BROOKS STEWART & PAULA	9526 CAPISTRANO AVE CHATSWORTH CA 91311	13811517063
BULMER JOHN E & MELINDA M	5691 DIMICK AVE LAS VEGAS NV 89130-2524	13801402001
C A I INVESTMENTS SERIES 43 L L	3753 HOWARD HUGES PKWY #200 LAS VEGAS NV 89169	13811515160
C P I-RAINIER L V I L L C ETAL	F E M RANCHO DRIVE L L C 235 MOORE ST #300 HACKENSACK NJ 07601	13812102003
C S C TRUST	CASE CHARLEEN TRS 66090 MESSANGER CT LAS VEGAS NV 89108	13811517002
C S D C P C FOUNDERS ACADEMY	6731 COLUMBIA GATEWAY DR #220 COLUMBIA MD 21046	13802814029
CACCAVALE ROBERT REV LIV TR	CACCAVALE ROBERT TRS 5755 SUNSET DOWNS ST NORTH LAS VEGAS NV 89081-5243	13811517049
CAI INVESTMENTS SERIES 43 L L C	3753 HOWARD HUGHES PKWY #200 LAS VEGAS NV 89169	13811515148
CARDENAS MARIA R	3796 EDWARD AVE LAS VEGAS NV 89108	13812110008
CARTER CLEMON E & SANDRA R	3922 CROOKED OAK ST NORTH LAS VEGAS NV 89032-7652	13801405002
CASTRO GERARDO M	3912 SWEET PINE ST #101 LAS VEGAS NV 89108-8183	13811517169
CASTRO GERARDO M & NEMIA J	3912 SWEET PINE ST #101 LAS VEGAS NV 89108-8183	13811517046
CHEN KUAN-CHENG & LE C H FAM TR	CHEN KUAN-CHENG & LE CHAU H TRS 28371 VISTA DEL VALLE HEMET CA 92544-8361	13811517056
CHEN LILY	6164 PINE VILLA AVE #202 LAS VEGAS NV 89108	13811515022
CHERNYUK TETYANA	420 LAKE WINDEMERE ST LAS VEGAS NV 89138-3004	13811517184
CHERNYUK TETYANA	420 LAKE WINDEMERE ST LAS VEGAS NV 89138-3004	13811517001
CHILESE FAMILY REVOCABLE LIV TR	CHILESE JOHN F & BAMBI L TRS 5711 HICKAM AVE LAS VEGAS NV 89130-2554	13801304007
CLARK JASON	5421 ROYAL YACHT WY NORTH LAS VEGAS NV 89031-0731	13811517047

Report of All Selected Parcels**Case Number:**

VAR-65909

Printed On: Wed: August 3, 2016

<u>Owner</u>	<u>Address</u>	<u>Parcel Number</u>
CLARK NORMAN W & MARIA L	3917 PRESCOTT PINES ST #103 LAS VEGAS NV 89108-8173	13811517030
CLOUSE ANN M	6122 PINE VILLA AVE #101 LAS VEGAS NV 89108-8122	13811517180
CLOUSE ANN M	6122 PINE VILLA AVE #101 LAS VEGAS NV 89108-8122	13811517013
COHEN ISRAEL & SHOSHANA REVOCABL	%S COHEN 23673 GERRAD WAY WEST HILLS CA 91307-1319	13811515055
COHEN ISRAEL & SHOSHANA REVOCABL	%S COHEN 23673 GERRARD WAY WEST HILLS CA 91307	13811517114
COHEN ISRAEL & SHOSHANA REVOCABL	%SHAY COHEN 23673 GERRAD WAY WEST HILLS CA 91307-1319	13811517027
COHEN SARA IRA #11559	COHEN SHAI IRA #11560 23673 GERRAD WY WEST HILLS CA 91307-1319	13811515031
COLEMAN LORETTA	438 W 1045 N CEDAR CITY UT 84721-4164	13811517126
CONNOR MARTHA J	881 GLENBARD RD GLEN ELLYN IL 60137-6472	13801404001
CORD DONNA G	6158 CALM BREEZE AVE #101 LAS VEGAS NV 89108-8110	13811517147
CORD DONNA G	6158 CALM BREEZE AVE #101 LAS VEGAS NV 89108-8110	13811517112
CORRAL CARMEN LUNA	1115 FAIRCHILD ST LAS VEGAS NV 89110	13801304003
CORRAL MARCO A	6153 PINE DESERT AVE #103 LAS VEGAS NV 89108-8155	13811517138
COTTERILL ANDREW	%SMART REALTY 6955 N DURANGO DR #1115-107 LAS VEGAS NV 89149-4411	13811517178
DAS RACHEL	3736 ALPINE BYPASS AVE NORTH LAS VEGAS NV 89081	13811517022
DAS RACHEL	3736 ALPINE BYPASS AVE NORTH LAS VEGAS NV 89081	13811517177
DAVIS TONY	6 RUE DU PALAIS CT HENDERSON NV 89011	13811517127
DAVIS TONY	6 RUE DU PALAIS CT HENDERSON NV 89011	13811517142
DELGADO DENISE RENE	213 MACADAMIA NUT AVE NORTH LAS VEGAS NV 89084	13811517108
DEMETRIOU DEMETRIOS	11159 HOLLAND CIR EDEN PRAIRIE MN 55347	13811517068
DENNISON RONALD L	3904 SWEET PINE ST #102 LAS VEGAS NV 89108	13811517041
DESERT PINE VILLAS HOMEOWNERS AS	%DESERT COMMUNITY MANAGEMENT L L 5550 PAINTED MIRAGE RD #120 LAS VEGAS NV 89149	13811515015
DESERT PINE VILLAS HOMEOWNERS AS	%DESERT COMM MGMT LLC 5550 PAINTED MIRAGE RD #120 LAS VEGAS NV 89149	13811517085
DESERT PINE VILLAS HOMEOWNERS AS	%DESERT COMMUNITY MANAGEMENT L L 5550 PAINTED MIRAGE RD #120 LAS VEGAS NV 89149	13811517009
DESERT PINE VILLAS HOMEOWNERS AS	%DESERT COMMUNITY MANAGEMENT L L 5550 PAINTED MIRAGE RD #120 LAS VEGAS NV 89149	13811517028
DESROCHES PAUL	5656 W ALEXANDER RD LAS VEGAS NV 89130-2802	13801404009
DEVERA ALFONSO R & N D REV TR	DEVERA ALFONSO R & NORMA D TRS 2277 PHEASANT DR HERCULES CA 94547-1640	13811517015
DIMOULAS STEVE	P O BOX 572007 LAS VEGAS NV 89157-2007	13801406005
DONOVAN FAMILY TRUST	DONOVAN MICHAEL P & TINA M TRS 7401 APPLE SPRINGS AVE LAS VEGAS NV 89131	13811515019
DORRELL DEIRICK	1494 COUNTY RD 607 PONTIAC MO 65729	13811517167

Report of All Selected ParcelsCase Number:

VAR-65909

Printed On: Wed: August 3, 2016

<u>Owner</u>	<u>Address</u>	<u>Parcel Number</u>
DORRELL DEIRICK	1494 COUNTY RD 607 PONTIAC MO 65729	13811517052
DOWLATSHAHI BEHZAD	3925 LAZY PINE ST #204 LAS VEGAS NV 89108	13811515056
DOWLATSHAHI BEHZAD	3925 LAZY PINE ST #204 LAS VEGAS NV 89108	13811515161
E M J J FAMILY TRUST	PATTON EARNEST JR & MICHELLE H T 1320 SHARON RD LAS VEGAS NV 89106	13812110073
E M J J FAMILY TRUST	PATTON EARNEST JR & MICHELLE H T 1320 SHARON RD LAS VEGAS NV 89106	13812110073
EDGEL MARK J & PATRICE	5645 W ALEXANDER RD LAS VEGAS NV 89130-2801	13812110026
EDGEL MARK J & PATRICE	5645 W ALEXANDER RD LAS VEGAS NV 89130-2801	13812110026
ELLUL LEGACY SPENDTHRIFT TRUST	ELLUL PAUL A TRS 3915 HELEN AVE LAS VEGAS NV 89130-2813	13812110031
ELLUL LEGACY SPENDTHRIFT TRUST	ELLUL PAUL A TRS 3915 HELEN AVE LAS VEGAS NV 89130-2813	13812110031
EMMANUEL LIVING TRUST	CORDON DAVID JR & YAZMIN TRS 5655 W ALEXANDER RD LAS VEGAS NV 89130-2801	13812110025
EMMANUEL LIVING TRUST	CORDON DAVID JR & YAZMIN TRS 5655 W ALEXANDER RD LAS VEGAS NV 89130-2801	13812110025
EQUITY TRUST COMPANY	156 ST CHARLES AVE SAN FRANCISCO CA 94132	13811517024
ETHIER CHRIS	POIROT TATYANA A 8250 N GRAND CANYON AVE #2031 LAS VEGAS NV 89166	13811517124
FAILLOS CARLOS A	4201 HELEN AVE LAS VEGAS NV 89130-2530	13801305006
FAUNI LUCILLE	3925 SWEET PINE ST #102 LAS VEGAS NV 89108	13811517065
FEWKES TRENTON & JANICE	4001 LEON AVE LAS VEGAS NV 89130-2511	13801404012
FISCHER D'OR ANTHONY NI'HEEM	12118 LA CARTA CT LAS VEGAS NV 89138	13811515023
FLYNN EDWARD J III	103 GLENDALE AVE MANCHESTER NH 03103-2900	13811517094
FLYNN EDWARD J III	103 GLENDALE AVE MANCHESTER NH 03103-2900	13811517153
FOSTER CORY	301 N 45TH ST #3 FREEMONT WA 98103-6364	13811517031
FOSTER CORY	301 N 45TH ST #3 FREEMONT WA 98103-6364	13811517174
FOURTEEN S A C SELF-STORAGE CORP	1250 E MISSOURI AVE PHOENIX AZ 85014-2912	13812101005
FOURTEEN S A C SELF-STORAGE CORP	1250 E MISSOURI AVE PHOENIX AZ 85014-2912	13812101004
FOX MARK & SUZANA	8137 VILLA DE LA PLAYA ST LAS VEGAS NV 89131	13812110058
FOX MARK & SUZANA	8137 VILLA DE LA PLAYA ST LAS VEGAS NV 89131	13812110058
FREE DENNIS	4116 HELEN AVE LAS VEGAS NV 89130-2508	13801403008
GALLAGHER MICHAEL & APRIL	3916 LAZY PINE ST #103 LAS VEGAS NV 89108-5188	13811517091
GALLAGHER MICHAEL & APRIL	3916 LAZY PINE ST #103 LAS VEGAS NV 89108-5188	13811517011
GALLAGHER MICHAEL & APRIL	3916 LAZY PINE ST #103 LAS VEGAS NV 89108-5188	13811517016
GALLAGHER MICHAEL & APRIL	3916 LAZY PINE ST #101 LAS VEGAS NV 89108-5188	13811517154
GALLAGHER MICHAEL J & APRIL L	3916 LAZY PINE ST #103 LAS VEGAS NV 89108-5188	13811517093
GAMBOA PASCUAL	4011 HELEN AVE LAS VEGAS NV 89130-2509	13801404011

Report of All Selected Parcels**Case Number:**

VAR-65909

Printed On: Wed: August 3, 2016

<u>Owner</u>	<u>Address</u>	<u>Parcel Number</u>
GANDECHA ANOOP	23441 GOLDEN SPRINGS DR #170 DIAMOND BAR CA 91765-2030	13811517044
GARCIA ERIC G	6140 PINE VILLA AVE #103 LAS VEGAS NV 89108-8100	13811517006
GARCIA GERONIMO	3929 SWEET PINE ST #101 LAS VEGAS NV 89108	13811517061
GARCIA GERONIMO	3829 SWEET PINE ST #101 LAS VEGAS NV 89108	13811517164
GARCIA JAIME G & ROSALINDA C	3921 SWEET PINE ST #103 LAS VEGAS NV 89108-8189	13811517069
GARRICK KATHIE E	3926 HELEN AVE LAS VEGAS NV 89130-2819	13812110047
GARRICK KATHIE E	3926 HELEN AVE LAS VEGAS NV 89130-2819	13812110047
GATTUSO CARMELO VINCENT MICHAEL	3940 QUIET PINE ST #202 LAS VEGAS NV 89108-8103	13811515014
GEMINI TRUST	P O BOX 570460 LAS VEGAS NV 89157	13812110035
GEMINI TRUST	%L THOMPSON P O BOX 570460 LAS VEGAS NV 89157	13812110035
GIBSON BEVERLY A	5601 W ALEXANDER RD LAS VEGAS NV 89130	13812110027
GIBSON BEVERLY A	5601 W ALEXANDER RD LAS VEGAS NV 89130	13812110027
GOLDEN BIT L L C	%C & V SROMALLA 6618 GOLDEN BIT AVE LAS VEGAS NV 89131-0220	13812110051
GOLDEN BIT L L C	%C & V SROMALLA 6618 GOLDEN BIT AVE LAS VEGAS NV 89131-0220	13812110052
GRAY KELLY S	8780 LA SUNDORA CIR LAS VEGAS NV 89129	13812110003
GRAY KELLY S	8780 LA SUNDORA CIR LAS VEGAS NV 89129	13812110003
GREEN NANCY	3917 LAZY PINE ST #202 LAS VEGAS NV 89108-8105	13811515038
GREENE MARY T SEPERATE PPTY TR	GREENE MARY T TRS 3931 LEON AVE LAS VEGAS NV 89130-2816	13812110023
GREENE MARY T SEPERATE PPTY TR	GREENE MARY T TRS 3931 LEON AVE LAS VEGAS NV 89130-2816	13812110023
GREGG KRISTEN E	6164 CALM BREEZE AVE LAS VEGAS NV 89108-8107	13811517117
GRIMES VICKY J	4135 HELEN LAS VEGAS NV 89130-2507	13801402006
GUR TOMER & EDITH	14534 NEWPORT AVE #2 TUSTIN CA 92780-1017	13811517106
GUR TOMER & EDITH	14534 NEWPORT AVE #2 TUSTIN CA 92780-1017	13811517149
GUTIERREZ QUENTIN G JR	P O BOX 1251 MONTEBELLO CA 90640-1251	13801405001
H L N ENTERPRISES L L C	9337 CANYON SHADOW LN LAS VEGAS NV 89117	13802814011
HABERMAN RACHEL	P O BOX 48528 LOS ANGELES CA 90048-0528	13811515040
HADI HERMAWAN	405 BUCHANAN ROCK ST HENDERSON NV 89074	13811517105
HALL SHERRY D	3904 LAZY PINE ST #101 LAS VEGAS NV 89108-5182	13811517157
HALL SHERRY D	3904 LAZY PINE ST #101 LAS VEGAS NV 89108-5182	13811517082
HAMILTON SIVASOTHI & MICHAEL K	5721 HICKAM AVE LAS VEGAS NV 89130-2554	13801304006
HAMMONTREE ALBERT L & DANA J	6109 FOXCROFT AVE LAS VEGAS NV 89108-5117	13811511013
HAND SHAKE INVESTMENTS L L C	9905 FOX SPRINGS DR LAS VEGAS NV 89117-0942	13812110021

Report of All Selected Parcels**Case Number:**

VAR-65909

Printed On: Wed: August 3, 2016

<u>Owner</u>	<u>Address</u>	<u>Parcel Number</u>
HAND SHAKE INVESTMENTS L L C	9905 FOX SPRINGS DR LAS VEGAS NV 89117-0942	13812110021
HANSEN MARIANNE	3805 W RED COACH AVE NORTH LAS VEGAS NV 89031-0142	13801402002
HARDEMAN RAMONA L	6134 PINE VILLA AVE #102 LAS VEGAS NV 89108-8124	13811517008
HARPER DON A TRUST	HARPER DON A TRS 5411 W ALEXANDER RD LAS VEGAS NV 89130-2805	13812110039
HARRINGTON WILLIAM C	3107 BRIGHTON AVE LOS ANGELES CA 90018	13811515016
HARTER MATTHEW P ETAL	CASALE PATRICK A & ASSOC LTD 376 E WARM SPRINGS RD LAS VEGAS NV 89119-4262	13812110068
HARTER MATTHEW P ETAL	CASALE PATRICK A & ASSOC LTD 376 E WARM SPRINGS RD LAS VEGAS NV 89119-4262	13812110068
HARWELL KIM E	3920 SWEET PINE ST #102 LAS VEGAS NV 89108-8187	13811517053
HARWOOD JOHN	5636 BRODERICK AVE LAS VEGAS NV 89130-2516	13801402012
HASSELFELD ERNEST C & L FAM TR	BROWN WENDY V TRS 1835 BANABA LN LAS VEGAS NV 89156-6892	13812110017
HASSELFELD ERNEST C & L FAM TR	BROWN WENDY V TRS 1835 BANABA LN LAS VEGAS NV 89156-6892	13812110017
HAYGOOD WILLIAM L & SHAENA R	4225 LEON AVE LAS VEGAS NV 89130-2535	13801304009
HERNANDEZ MARIA L	3909 SWEET PINE ST #103 LAS VEGAS NV 89108-8131	13811517078
HICKSTEIN FRANK B SR & JULIA L	3924 QUIET PINE ST #101 LAS VEGAS NV 89108-8102	13811515147
HICKSTEIN FRANK B SR & JULIA L	3924 QUIET PINE ST #101 LAS VEGAS NV 89108-8102	13811515041
HODSON ADAM	6116 PINE VILLA AVE #102 LAS VEGAS NV 89108-8121	13811517017
HOLLIS TYSON	4200 N HELEN AVE LAS VEGAS NV 89130-2532	13801306005
HONTUCAN MARY NANCY	3921 PRESCOTT PINES ST #101 LAS VEGAS NV 89108-8175	13811517025
HONTUCAN MARY NANCY	3921 PRESCOTT PINES ST #101 LAS VEGAS NV 89108-8175	13811517176
HUEBNER TREVOR M	6341 MALACHITE BAY AVE LAS VEGAS NV 89130	13801405009
HUERTA NOEL P	1751 ASHBURN DR NORTH LAS VEGAS NV 89032-3162	13801404006
HUGHES KAREN	3920 LAZY PINE ST #103 LAS VEGAS NV 89108-5190	13811517096
HUNT MARLENE	5656 BRODERICK AVE LAS VEGAS NV 89130	13801402010
INTEREST INCOME PARTNERS L P	10D YELLOW FERRY HARBOR SAUSALITO CA 94965	13802814033
INTEREST INCOME PARTNERS L P	10D YELLOW FERRY HARBOR SAUSALITO CA 94965	13802814034
J A M PROPERTIES INTL L L C	17555 VENTURA BLVD #202 ENCINO CA 91316-3890	13811517118
J A M PROPERTIES INTL L L C	17555 VENTURA BLVD #202 ENCINO CA 91316-3890	13811517145
J P 3 PROPERTIES L L C	5715 W ALEXANDER RD #155 LAS VEGAS NV 89130-2807	13812110060
J P 3 PROPERTIES L L C	5715 W ALEXANDER RD #155 LAS VEGAS NV 89130-2807	13812110060
JACK BARBARA K	5665 W ALEXANDER RD LAS VEGAS NV 89130-2801	13812110024
JACK BARBARA K	5665 W ALEXANDER RD LAS VEGAS NV 89130-2801	13812110024
JACKSON LULA M	6156 PINE VILLA AVE #204 LAS VEGAS NV 89108-8127	13811515032

Report of All Selected Parcels**Case Number:**

VAR-65909

Printed On: Wed: August 3, 2016

<u>Owner</u>	<u>Address</u>	<u>Parcel Number</u>
JAEHN FRANK & JULIE R	5647 HICKAM AVE LAS VEGAS NV 89130-2521	13801305004
JAGGERS DANIEL	MOLTZEN TAMMY 4080 HELEN AVE LAS VEGAS NV 89130-2531	13801405008
JAMES FAMILY TRUST	JAMES ERIC TRS 3929 HELEN AVE LAS VEGAS NV 89130-2813	13812110028
JAMES FAMILY TRUST	JAMES ERIC TRS 3929 HELEN AVE LAS VEGAS NV 89130-2813	13812110028
JIMENEZ JONATHAN RAFAEL	2232 MELINDA LAS VEGAS NV 89101	13801304010
JOHNSON FAMILY TRUST	JOHNSON MICHAEL C & BETH ANN TRS 5401 W ALEXANDER RD LAS VEGAS NV 89130-2805	13812110040
JOHNSON PAULETTE L	6122 PINE VILLA AVE #102 LAS VEGAS NV 89108-8122	13811517014
K & M RENTALS INC	13426 TRACY ST #4 BALDWIN PARK CA 91706	13811515029
KECK FRED G & IRENE H LIVING TR	KECK FRED G & IRENE H TRS 3940 QUIET PINE ST #201 LAS VEGAS NV 89108-8103	13811515013
KECK FRED G & IRENE H LIVING TR	KECK FRED G & IRENE H TRS 3940 QUIET PINE ST #201 LAS VEGAS NV 89108-8103	13811515139
KIRKWOOD JOEL D	10658 MOUNT BLACKBURN AVE LAS VEGAS NV 89166	13811517173
KIRKWOOD JOEL D	10658 MOUNT BLACKBURN AVE LAS VEGAS NV 89166	13811517034
KOLCH RODNEY R & BETH	4000 HELEN AVE LAS VEGAS NV 89130-2510	13801406009
KOYSHMAN YACOV & OLGA LIVING TR	KOYSHMAN YACOV & OLGA TRS 10330 ETON AVE CHATSWORTH CA 91311-2322	13811517121
KOYSHMAN YACOV & OLGA LIVING TR	KOYSHMAN YACOV & OLGA TRS 10330 ETON AVE CHATSWORTH CA 91311-2322	13811515047
KOYSHMAN YACOV & OLGA LIVING TR	KOYSHMAN YACOV & OLGA TRS 10330 ETON AVE CHATSWORTH CA 91311	13811515152
KOYSHMAN YACOV & OLGA LIVING TR	KOYSHMAN YACOV & OLGA TRS 10330 ETON AVE CHATSWORTH CA 91311-2322	13811517144
KRAFT KEVIN	200 S JONES LAS VEGAS NV 89107	13801402009
KRAUSHAAR MARK C	3940 QUIET PINE ST #104 LAS VEGAS NV 89108-8103	13811515012
KURLAND MICHELE	3905 PRESCOTT PINES ST #103 LAS VEGAS NV 89108-8167	13811517039
LAATZ RICHARD	34 N MAY FLOWER AVE NORTH LAS VEGAS NV 89030	13802814006
LAI PAK SUNG & ANGIE WONG	P O BOX 3686 COVINA CA 91722	13811517067
LAI PAK SUNG & ANGIE WONG	P O BOX 3686 COVINA CA 91722	13811517162
LAI PAK SUNG & ANNGIE WONG	P O BOX 3686 COVINA CA 91722	13811515051
LAI PAK SUNG & ANNGIE WONG	P O BOX 3686 COVINA CA 91722	13811515157
LAKIS MARK & KITTY TRUST	LAKIS MARK G & CATHERINE M TRS 6320 DARBY AVE LAS VEGAS NV 89146-6608	13811517036
LAM ROGER PUN-TAK	REIMER LAI MING 11402 SITKA ROSE CIR EAGLE RIVER AK 99577	13811517185
LAS VEGAS DEV GROUP L L C	397 3RD AVE #A CHULA VISTA CA 91910-3982	13811517057
LAS VEGAS RENTAL HOMES I L L L P	1950 S RAINBOW BLVD #103-210 LAS VEGAS NV 89146	13811517133
LAS VEGAS RENTAL HOMES I L L L P	1950 S RAINBOW BLVD #103-210 LAS VEGAS NV 89146	13811517140
LASKOVA RADKA	LASKOV JEKO 543 HOLTHOUSE TERR SUNNYVALE CA 94087	13811517033
LAUER HARRY S & BARBARA A	3930 HELEN AVE LAS VEGAS NV 89130-2819	13812110038

Report of All Selected Parcels**Case Number:**

VAR-65909

Printed On: Wed: August 3, 2016

<u>Owner</u>	<u>Address</u>	<u>Parcel Number</u>
LAUER HARRY S & BARBARA A	3930 HELEN AVE LAS VEGAS NV 89130-2819	13812110038
LE MICHAEL	NGO THUY HANG & TONY 9364 DE ADALENA ST ROSEMEAD CA 91770	13811517051
LEDDY JAMES	6177 PINE DESERT AVE #101 LAS VEGAS NV 89108-8163	13811517143
LEWIS MICHAEL R & CAROLYN K	6165 PINE DESERT AVE #102 LAS VEGAS NV 89108-8159	13811517131
LEXI HOLDINGS L L C	5715 W ALEXANDER #160 LAS VEGAS NV 89130-2807	13812110074
LEXI HOLDINGS L L C	5715 W ALEXANDER #160 LAS VEGAS NV 89130-2807	13812110074
LI JUN	YAO LI 4280 SALT LAKE BLVD #H52 HONOLULU HI 96818-1154	13811517107
LONG-BLESSUM NANCY	3925 HELEN AVE LAS VEGAS NV 89130-2813	13812110029
LONG-BLESSUM NANCY	3925 HELEN AVE LAS VEGAS NV 89130-2813	13812110029
LONG-DURAND FAMILY TRUST	24 LYLEWOOD CT SACRAMENTO CA 95834-3827	13811517081
LOPEZ JOHN R & RUTH M	139 KENTUCKY WAY FREEHOLD NJ 07728	13811515049
LU CHYI-CHING & YUH-YUN	3908 LAZY PINE ST #103 LAS VEGAS NV 89108-5184	13811517087
LUJAN GREGORY	3924 QUIET PINE ST #204 LAS VEGAS NV 89108-8102	13811515048
LUTZ MARILYN J	3917 LAZY PINE ST #101 LAS VEGAS NV 89108-5189	13811515033
LYTLE JEFFREY KENT & KRISTIE D	5423 DIMICK AVE LAS VEGAS NV 89130-2551	13801403001
M K C O L L L C	6320 DARBY AVE LAS VEGAS NV 89146-6608	13811517132
MACON JANISSA	2128 SADDLEBILL CT NORTH LAS VEGAS NV 89084	13811517048
MADDOX RICHARD A & BETH L	6812 WAR EAGLE CIR LAS VEGAS NV 89108-5017	13811517130
MADDOX RICHARD A & BETH L	6812 WAR EAGLE CIR LAS VEGAS NV 89108-5017	13811517141
MADSEN CHRISTOPHER E	6158 CALM BREEZE AVE #102 LAS VEGAS NV 89108-8110	13811517113
MANN STEPHEN T & CONNIE L	4123 HELEN AVE LAS VEGAS NV 89130-2507	13801402008
MANUMALEUNA BRANDON	6159 PINE DESERT AVE #102 LAS VEGAS NV 89108-8157	13811517134
MARTINEZ JAOQUIN M & AMELIA	5434 W ALEXANDER RD LAS VEGAS NV 89130-2806	13801406006
MARTINEZ JOAQUIN	MARTINEZ JOSE MANUEL 5434 W ALEXANDER RD LAS VEGAS NV 89130-2806	13812110019
MARTINEZ JOAQUIN	MARTINEZ JOSE MANUEL 5434 W ALEXANDER RD LAS VEGAS NV 89130-2806	13812110019
MARTINEZ JOAQUIN & JOSE	MARTINEZ FULGENCIO 5434 W ALEXANDER RD LAS VEGAS NV 89130-2806	13812110018
MARTINEZ JOAQUIN & JOSE	MARTINEZ FULGENCIO 5434 W ALEXANDER RD LAS VEGAS NV 89130-2806	13812110018
MARTINEZ JOSE M & MARIA D	3851 LEON AVE LAS VEGAS NV 89130-2816	13812110032
MARTINEZ JOSE M & MARIA D	3851 LEON AVE LAS VEGAS NV 89130-2816	13812110032
MARTINEZ RAYMUNDO GARCIA	GARCIA LAUREANO 1000 BAKER AVE LAS VEGAS NV 89108	13812110033
MASOOD AHMED & MALKA M	6171 PINE DESERT AVE #102 LAS VEGAS NV 89108-8161	13811517128
MCGUIRE LIVING TRUST	MCGUIRE JACK & SUSAN TRS 4011 LEON AVE LAS VEGAS NV 89130-2511	13801404008

Report of All Selected Parcels**Case Number:**

VAR-65909

Printed On: Wed: August 3, 2016

<u>Owner</u>	<u>Address</u>	<u>Parcel Number</u>
MILLS NED L	3925 LEON AVE LAS VEGAS NV 89130	13812110037
MILLS NED L	3925 LEON AVE LAS VEGAS NV 89130	13812110037
MINER'S GOLD FAMILY L P	5783 HICKAM AVE LAS VEGAS NV 89130-2512	13801304005
MINER'S GOLD FAMILY L P	5783 HICKAM AVE LAS VEGAS NV 89130-2512	13801304004
MIRABELLI FRANK & KAREN TRUST	MIRABELLI FRANK R & KAREN L TRS 4009 JORY TRL LAS VEGAS NV 89108-5202	13802811015
MIRANDA MANLEO	6940 SENTON AVE LAS VEGAS NV 89108	13801402005
MOE ALTA M	856 MORRISON ST SAN DIEGO CA 92012	13811517037
MOE ALTA M	856 MORRISON ST SAN DIEGO CA 92102	13811517172
MONTESANO LUCILLE	6116 FOXCROFT AVE LAS VEGAS NV 89108-5116	13811511009
MOORE FAMILY TRUST	MOORE LOREN T & MICHELLE M TRS 5932 LADY CAROLINA ST NORTH LAS VEGAS NV 89081	13811517077
MOUSENYOK INC	%C BRAUNAGEL P O BOX 4230 PORT JERVIS NY 12771-4230	13811515011
MOUSENYOK INC	%C BRAUNAGEL P O BOX 4230 PORT JERVIS NY 12771-4230	13811515142
MULKERN TIMOTHY & M SIDNEY	6164 PINE VILLA AVE #201 LAS VEGAS NV 89108-8120	13811515021
MYNARCIK NEVADA TRUST	MYNARCIK BRANDON TRS 6350 W CHEYENNE LAS VEGAS NV 89108-4309	13802814035
NATION PATRICIA	3919 HELEN AVE LAS VEGAS NV 89130-2813	13812110030
NATION PATRICIA	3919 HELEN AVE LAS VEGAS NV 89130-2813	13812110030
O'BRIEN ANGELITA	6128 PINE VILLA AVE #101 LAS VEGAS NV 89108	13811517181
OLEARY BRYAN B & JILL A	4031 LEON AVE LAS VEGAS NV 89130-2511	13801404005
ORLANDO SUZANNE E	3904 SWEET PINE ST #103 LAS VEGAS NV 89108-8181	13811517042
OSHIRO KEVIN T	156 ST CHARLES AVE SAN FRANCISCO CA 94132	13811517075
OUTHOUMMOUNTRY LALI & PATRICK S	5657 HICKAM AVE LAS VEGAS NV 89130-2521	13801305003
P R E RANCHO JONES L L C	120 PRESIDENTIAL WAY #300 WOBURN MA 01801	13802804001
P R E RANCHO JONES L L C	120 PRESIDENTIAL WAY #300 WOBURN MA 01801	13801401002
P R E RANCHO JONES L L C	120 PRESIDENTIAL WAY #300 WOBURN MA 01801	13801401001
P R E RANCHO JONES L L C	120 PRESIDENTIAL WAY #300 WOBURN MA 01801	13801401003
PARRA MANUEL & MARIA	4081 HELEN AVE LAS VEGAS NV 89130-2509	13801404007
PARRISH BISHOP P & HELEN N	P O BOX 370968 LAS VEGAS NV 89137-0968	13811515146
PARRISH BISHOP P III & HELEN N	P O BOX 370968 LAS VEGAS NV 89137-0968	13811515046
PARRISH BISHOP P III & HELEN N	P O BOX 370968 LAS VEGAS NV 89137-0968	13811515025
PARRISH BISHOP P III & HELEN N	P O BOX 370968 LAS VEGAS NV 89137-0968	13811515137
PAULO JOSEPH O	87-1449 AKOWAI RD WAIANAE HI 96792	13811517098
PAZ FAMILY TRUST	PAZ CAESAR JR & ESMERALDA TRS 2059 NEWCASTLE DR OXNARD CA 93036	13811517115

Report of All Selected Parcels**Case Number:**

VAR-65909

Printed On: Wed: August 3, 2016

<u>Owner</u>	<u>Address</u>	<u>Parcel Number</u>
PAZ FAMILY TRUST	PAZ CAESAR JR & ESMERALDA CO-TRS 2059 NEWCASTLE DR OXNARD CA 93036	13811517146
PEDROLA JILL & STEVE	6132 FOXCROFT AVE LAS VEGAS NV 89108-5116	13811511007
PERONA LOURDES R LIVING TRUST	PERONA LOURDES R TRS %P PERONA JR 3933 LAZY PINE ST #204 LAS VEGAS NV 89108-8165	13811515008
PETERS CALVIN & STELLA	19002 N LAKE FOREST DR SUN CITY AZ 85373-1410	13812110034
PETERS CALVIN & STELLA	19002 N LAKE FOREST DR SUN CITY AZ 85373-1410	13812110034
PHOENIX L V REALTY PARTNERS NO 2	3753 HOWARD HUGHES PKWY #200 LAS VEGAS NV 89169	13811515052
PHOENIX LV REALTY PARTNERS LLC	3753 HOWARD HUGHES PKWY #200 LAS VEGAS NV 89169	13811515024
PHOENIX LV REALTY PARTNERS LLC	3753 HOWARD HUGHES PKWY #200 LAS VEGAS NV 89169	13811515150
PHOENIX LV REALTY PARTNERS NO 2	3753 HOWARD HUGHES PKWY #200 LAS VEGAS NV 89169	13811515002
PHOENIX LV REALTY PTNRS #2 L L P	3753 HOWARD HUGHES PKWY #200 LAS VEGAS NV 89169	13811515039
PHOENIX LV REALTY PTNRS #2 L L P	3753 HOWARD HUGHES PKWY #200 LAS VEGAS NV 89169-0952	13811515026
PHOENIX LV REALTY PTNRS #2 L L P	3753 HOWARD HUGHES PKWY #200 LAS VEGAS NV 89169	13811517019
PHOENIX LV REALTY PTNRS #2 LLP	3753 HOWARD HUGHES PKWY LAS VEGAS NV 89169	13811515036
PHOENIX LV REALTY PTNRS NO2 LLP	3753 HOWARD HUGHES PKWY #200 LAS VEGAS NV 89169	13811515006
PIKE RANDALL & CYNTHIA	6164 CALM BREEZE AVE #102 LAS VEGAS NV 89108-8111	13811517116
PLOTKIN FERN & ROBERT	6164 PINE VILLA AVE #101 LAS VEGAS NV 89108-8120	13811515017
POOLE-SANFORD L L C	3901 N RANCHO DR LAS VEGAS NV 89130-3415	13812110004
POOLE-SANFORD L L C	3901 N RANCHO DR LAS VEGAS NV 89130-3415	13812110005
POOLE-SANFORD L L C	3901 N RANCHO DR LAS VEGAS NV 89130-3415	13812110004
PRE RANCHO CRAIG L L C	120 PRESIDENTIAL WAY #300 WOBURN MA 01801	13802713001
PRESCIA ANTHONY & NANCY FAM TR	PRESCIA NADINE LIVING TRUST 10538 MEADOW MIST AVE LAS VEGAS NV 89135	13802814013
PRESCIA ANTHONY & NANCY FAM TR	PRESCIA NADINE LIVING TRUST 10538 MEADOW MIST AVE LAS VEGAS NV 89135	13802814014
PRODROMIDES JOHN & BRENDA	1916 SMITH ST LAS VEGAS NV 89108-2433	13811517092
PRUETTE ROGER	4001 JORY TRL LAS VEGAS NV 89108-5202	13802811016
R & L HOLDING L L C	5646 W ALEXANDER RD LAS VEGAS NV 89130	13801404010
R C P PROPERTY HOLDINGS I L L C	3905 DIAMOND RIDGE ST LAS VEGAS NV 89129	13812110067
R C P PROPERTY HOLDINGS I L L C	3905 DIAMOND RIDGE ST LAS VEGAS NV 89129	13812110067
R C P PROPERTY HOLDINGS II L L C	3905 DIAMOND RIDGE ST LAS VEGAS NV 89129-7058	13812110071
R C P PROPERTY HOLDINGS II L L C	3905 DIAMOND RIDGE ST LAS VEGAS NV 89129-7058	13812110071
R C P PROPERTY HOLDINGS III L L	3905 DIAMOND RIDGE ST LAS VEGAS NV 89129-7058	13812110072
R C P PROPERTY HOLDINGS III L L	3905 DIAMOND RIDGE ST LAS VEGAS NV 89129-7058	13812110072
RAFFER HELEN P	RUDICK LILY 5317 FRIESAN WY ELK GROVE CA 95757-3222	13811515138

Report of All Selected Parcels**Case Number:**

VAR-65909

Printed On: Wed: August 3, 2016

<u>Owner</u>	<u>Address</u>	<u>Parcel Number</u>
RAFFER HELEN P	RUDICK LILY 5317 FRIESAN WY ELK GROVE CA 95757-3222	13811515009
RAMZI JAMEL A	3905 ASPENCREST DR LAS VEGAS NV 89108	13811517111
RANDAZZO VICTOR	3924 QUIET PINE ST #201 LAS VEGAS NV 89108-8102	13811515045
REED DARRYL W	4124 HELEN AVE LAS VEGAS NV 89130-2508	13801403004
REED SHAWNA L	9509 COUNTRY WINE CT LAS VEGAS NV 89129-7879	13811515007
REINHARDT KATHERINE A	6177 PINE DESERT AVE #102 LAS VEGAS NV 89108-8163	13811517125
RIDGE VIEW L L C	P O BOX 1099DUCK CREEK VILLAGE U T 84762-1099	13802814005
ROBERTS CLAY	6108 FOXCROFT AVE LAS VEGAS NV 89108	13811511010
RODRIGUEZ STEVE & MARIA	7235 RIDGELINE DR RIVERSIDE CA 92509-5514	13812110036
RODRIGUEZ STEVE & MARIA	7235 RIDGELINE DR RIVERSIDE CA 92509-5514	13812110036
ROGERS WILLIAM O & LOREEN L	5647 DIMICK AVE LAS VEGAS NV 89130-2524	13801402003
ROSAS DAVID J III	1025 CALHOUN AVE BRONX NY 10465-1910	13811517038
ROSE MICHAEL S & CAROL D	5424 IRELAND ST LAS VEGAS NV 89149-2019	13811517064
ROSE MICHAEL S & CAROL D	5424 IRELAND ST LAS VEGAS NV 89149-2019	13811517163
ROSS CO CONSTRUCTION INC	3920 LEON AVE #1 LAS VEGAS NV 89130	13812110020
ROSS CO CONSTRUCTION INC	3920 LEON AVE #1 LAS VEGAS NV 89130	13812110020
ROSS IRIS M	6159 PINE DESERT AVE #103 LAS VEGAS NV 89108-8157	13811517135
ROVERE GREG	RETCHLESS VICTORIA ANN 1068 VIA CANALE DR HENDERSON NV 89011	13811517095
ROVERE GREG A	RETCHLESS VICTORIA ANN 1068 VIA CANALE DR HENDERSON NV 89011	13811517003
RUTLEDGE KYLE REED	5697 HICKAM AVE LAS VEGAS NV 89130-2521	13801305007
S F R INVESTMENT POOL 1 L L C	5030 PARADISE RD #B-214 LAS VEGAS NV 89119	13811517090
S F R INVESTMENTS POOL 1 L L C	5030 PARADISE RD #B-214 LAS VEGAS NV 89119	13811517102
SAFIR ROBERT	SULLIVAN KATHY LYNNE 3917 SWEET PINE ST #103 LAS VEGAS NV 89108	13811517072
SANCHEZ EFREN R & LEIGHA JANEL	12716 GREAT COUNTRY DR BAKERSFIELD CA 93312-6902	13811517104
SANTOS AMANDA RIBERTO	3929 PRESCOTT PINES ST #103 LAS VEGAS NV 89108-8179	13811517021
SATARAY PROPERTIES GROUP CORP	216 N LAMB BLVD LAS VEGAS NV 89110	13812110070
SATARAY PROPERTIES GROUP CORP	216 N LAMB BLVD LAS VEGAS NV 89110	13812110069
SATARAY PROPERTIES GROUP CORP	216 N LAMB BLVD LAS VEGAS NV 89110	13812110069
SATARAY PROPERTIES GROUP CORP	216 N LAMB BLVD LAS VEGAS NV 89110	13812110070
SAUCEDO ARTURO	SAUCEDO-CHAIDEZ ARTURO 5941 HICKAM AVE LAS VEGAS NV 89130-2556	13801304002
SCHINNERER FAMILY TRUST	SCHINNERER DAVID E & DEBRA TRS 30936 CARTIER DR RANCHO PALOS VERDES CA 90275	13802814032
SCUDDER MICHAEL Y & CAROL J	3925 LAZY PINE ST #201 LAS VEGAS NV 89108-8164	13811515053

Report of All Selected Parcels**Case Number:**

VAR-65909

Printed On: Wed: August 3, 2016

<u>Owner</u>	<u>Address</u>	<u>Parcel Number</u>
SELVA GRACIELA A REVOCABLE TRUST	SELVA GRACIELA A TRS 6156 PINE VILLA AVE #204 LAS VEGAS NV 89108-8127	13811515030
SHERPA INVESTMENTS L L C	3528 BROOKS RANGE ST LAS VEGAS NV 89129-7339	13811511006
SHIVAN INVESTMENTS L L C	8440 W LAKE MEAD BLVD #101 LAS VEGAS NV 89128	13811517045
SKAARUP MARY	5646 BRODERICK AVE LAS VEGAS NV 89130-2516	13801402011
SLAVIN HELEN	517 FALCON LN LAS VEGAS NV 89107-3838	13812101002
SLEEK FAMILY TRUST	SLEEK THEODORE R TRS 1214 VISTA CANTORA SAN CLEMENTE CA 92672-2362	13811515154
SLEEK FAMILY TRUST	SLEEK THEODORE R TRS 1214 VISTA CANTORA SAN CLEMENTE CA 92672-2362	13811515043
SLEEK FAMILY TRUST	MENDEZ BLANCA E TRS 1214 VISTA CANTORA SAN CLEMENTE CA 92672-2362	13811515155
SLEEK FAMILY TRUST	SLEEK THEODORE R TRS 1214 VISTA CANTORA SAN CLEMENTE CA 92672-2362	13811515050
SLEEK FAMILY TRUST	MENDEZ BLANCA E TRS 1214 VISTA CANTORA SAN CLEMENTE CA 92672-2362	13811515054
SLEEK FAMILY TRUST	SLEEK THEODORE R TRS 1214 VISTA CANTORA SAN CLEMENTE CA 92672-2362	13811515153
SMITH CHRISTOPHER A	1116 PORTER ST RIDGECREST CA 93555-8805	13811517071
SOTO JOE	5655 BRODERICK AVE LAS VEGAS NV 89130-2517	13801404002
SOUTHERN HILLS PEDIATRICS L L C	5775 S FORT APACHE RD #110 LAS VEGAS NV 89148	13812110065
SOUTHERN HILLS PEDIATRICS L L C	P O BOC 400923 LAS VEGAS NV 89140	13812110062
SOUTHERN HILLS PEDIATRICS L L C	5775 S FORT APACHE RD #110 LAS VEGAS NV 89148	13812110065
SOUTHERN HILLS PEDIATRICS L L C	P O BOC 400923 LAS VEGAS NV 89140	13812110062
STERLING ASSETS L L C	402 E OCEANFRONT #A NEWPORT BEACH CA 92661	13811515140
STERLING ASSETS L L C	402 E OCEANFRONT #A NEWPORT BEACH CA 92661	13811515010
STETS MARK	3925 LOST MINER CT LAS VEGAS NV 89129-7658	13811517099
STEWART THOMAS J	3904 LAZY PINES ST #103 LAS VEGAS NV 89108-5182	13811517084
SU JINGMEI	4662 SAUK AVE SAN DIEGO CA 92117	13811517182
SU JINGMEI	4662 SAUK AVE SAN DIEGO CA 92117	13811517007
SUMMERS MELVIN G & JULIA B	3933 LAZY PINE ST #101 LAS VEGAS NV 89108-8151	13811515001
T & T PROPERTIES L L C	4804 LAUREL CANYON BLVD #135 VALLEY VILLAGE CA 91607	13811515005
T T R PROPERTIES L L C	P O BOX 370997 LAS VEGAS NV 89137	13802814009
TATE SUSAN R	3933 LAZY PINE ST #103 LAS VEGAS NV 89108-8151	13811515003
TATE SUSAN R	3933 LAZY PINE ST #103 LAS VEGAS NV 89108-8151	13811515144
TAYLOR LLOYD	10850 KNICKERBOCKER AVE LAS VEGAS NV 89166	13811517103
TAYLOR LLOYD	10850 KNICKERBOCKER AVE LAS VEGAS NV 89166	13811517150
THEOBALD SCOTT A	5701 HICKAM AVE LAS VEGAS NV 89130-2554	13801304008
THODUPUNOORI SRIKANTH	630 PARK VIEW DR #108 SANTA CLARA CA 95054-3579	13811517059

Report of All Selected Parcels**Case Number:**

VAR-65909

Printed On: Wed: August 3, 2016

<u>Owner</u>	<u>Address</u>	<u>Parcel Number</u>
THOMAS LARRY D & NERISSA L	6500 W EL CAMPO GRANDE AVE LAS VEGAS NV 89130-1218	13812110015
TICE JOSHUA	3933 LAZY PINE ST #104 LAS VEGAS NV 89108	13811515004
TICE JOSHUA	3933 LAZY PINE ST #104 LAS VEGAS NV 89108	13811515145
TICE JOSHUA	3944 LAZY PINE ST #104 LAS VEGAS NV 89108	13811515143
TOOMEY REAL ESTATE L L C	%EL JEN MEDICAL HOSPITAL INC 5538 DUNCAN DR LAS VEGAS NV 89130-2812	13812110053
TOOMEY REAL ESTATE L L C	5538 DUNCAN DR LAS VEGAS NV 89130-2812	13812110053
TOUCHE TRUST	OZERETSKAYA ANNA TRS 172 DUNBLANE ST HENDERSON NV 89012	13811517043
TOUCHE TRUST	OZERETSKAYA ANNA TRS 172 DUNBLANE ST HENDERSON NV 89012	13811515037
TOUCHE TRUST	OZERETSKAYA ANNA TRS 172 DUNBLANE ST HENDERSON NV 89012	13811517170
TRUSTEE CLARK COUNTY TREASURER	%O'BRIEN ANGELITA 6128 PINE VILLA AVE #101 LAS VEGAS NV 89108	13811517010
TRUSTEE CLARK COUNTY TREASURER	%TOWNER PHELEANCE 3928 SWEET PINE ST #101 LAS VEGAS NV 89108-8191	13811517165
TRUSTEE CLARK COUNTY TREASURER	%ELIAS YOLANDA 316 AUTUMN PALACE CT LAS VEGAS NV 89144-4108	13811517152
TRUSTEE CLARK COUNTY TREASURER	%AGHA RAZA ALI 7865 TIDAL POOL CT LAS VEGAS NV 89139-6121	13811517175
TRUSTEE CLARK COUNTY TREASURER	%G M A C MORTGAGE L L C 1100 VIRGINIA DR FT WASHINGTON PA 19034-3204	13811517179
TRUSTEE CLARK COUNTY TREASURER	%MORRELL BEVERLY A 6164 PINE VILLA AVE #203 LAS VEGAS NV 89108-8120	13811515158
TRUSTEE CLARK COUNTY TREASURER	%DESERT PINES ASSOCIATES 333 N RANCHO #100 LAS VEGAS NV 89106-3797	13811515141
TRUSTEE CLARK COUNTY TREASURER	%JOHNSON SEAN 3908 LAZY PINE ST #101 LAS VEGAS NV 89108-5184	13811517156
TRUSTEE CLARK COUNTY TREASURER	%FEDERAL HOME LOAN MORTGAGE CORP 5000 PLANO PKWY CARROLLTON TX 75010-4900	13811517168
TRUSTEE CLARK COUNTY TREASURER	%DESERT PINES ASSOCIATES 333 N RANCHO #100 LAS VEGAS NV 89106-3797	13811515156
TRUSTEE CLARK COUNTY TREASURER	%SHARPE JUNE R LIVING TRUST 3925 LAZY PINE ST #101 LAS VEGAS NV 89108-8147	13811515159
UGOCHUKWU VITALIS N & GLORIA N	4430 CELESTE CT VALLEJO CA 94591-6385	13811517035
ULANSKI MICHAEL	3921 PRESCOTT PINES ST #102 LAS VEGAS NV 89108-8175	13811517026
VEGAS VALLEY AUCTIONS L L C	3900 S HUALAPAI WAY #125 LAS VEGAS NV 89147-5738	13811517122
VIOLA ENTERTAINMENT INC	25835 TABLE MEADOW RD AUBURN CA 95602-8958	13802814004
W & H ASSOCIATES L L C	16468 BELL RIDGE DR CHINO HILLS CA 91709-4911	13811517066
WEINBERGER DAVID ALAN	3924 LAZY PINE #101 LAS VEGAS NV 89108-8145	13811517097
WEN FABIENNE	%FOSTER REALTY LLC 3900 PARADISE RD #121 LAS VEGAS NV 89169	13811517160
WEN FABIENNE	%FOSTER REALTY LLC 3900 PARADISE RD #121 LAS VEGAS NV 89169	13811517073
WESTCARE FOUNDATION INC	P O BOX 94738 LAS VEGAS NV 89193	13812110056
WHITE CHARLES S LIVING TRUST	WHITE CHARLES S TRS 4001 HELEN AVE LAS VEGAS NV 89130-2509	13801404013
WHITEMAN DENNIS F	MUILENBURG JULIE JANE 3917 LAZY PINE ST #102 LAS VEGAS NV 89108	13811515034
WILCOX GEOFF	3917 SWEET PINE ST #101 LAS VEGAS NV 89108-8136	13811517070

Report of All Selected Parcels**Case Number:**

VAR-65909

Printed On: Wed: August 3, 2016

<u>Owner</u>	<u>Address</u>	<u>Parcel Numbe</u>
WILCOX GEOFF	3917 SWEET PINE ST #101 LAS VEGAS NV 89108-8136	13811517161
WILLIAMS FAMILY TRUST	10061 RIVERSIDE DR #732 TOLUCA LAKE CA 91602	13801402007
WISEINVEST L L C	1782 SOUTH RD #87 WAPPINGERS FALLS NY 12590	13811515044
WITT DAVID	MUNOZ KRISTA 6100 FOXCROFT AVE LAS VEGAS NV 89108	13811511011
WOOD ROBIN L	3928 SWEET PINE ST #103 LAS VEGAS NV 89108-8191	13811517060
YAHAV SHMUEL & NAOMI	1685 H ST #311 BLAINE wa 98230	13811515027
YAO YE	6336 BLUE TWILIGHT CT LAS VEGAS NV 89108	13811517123
YUAN JERRY	301 OSPREY RIDGE DR EMERALD ISLE NC 28594	13811517120
YUEN LANCE LEE	4471 DEAN MARTIN DR #1504 LAS VEGAS NV 89103	13811515028
Z & G MANAGEMENT INC	12117 VISTA LINDA AVE LAS VEGAS NV 89138	13811517129