

City of Las Vegas
Office Of The City Clerk
495 South Main Street, 2nd Floor
Las Vegas, Nevada 89101

S.V. ✓

PRSRT STD U.S. Postage PAID Las Vegas, NV Permit No. 1630
--

Return Service Requested
Official Notice of Public Hearing

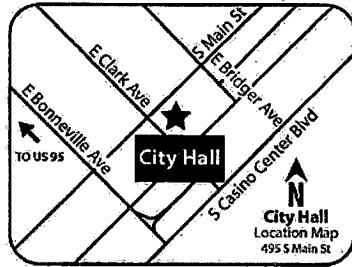

If you wish to file your protest or support on this request, check the appropriate box below and return this card in an envelope with postage to the Office Of The City Clerk at the address listed above or fax this side of this card to (702) 382-4803. If you would like to contact your Council Representative, please call (702) 229-6405.

I SUPPORT
this Request

I OPPOSE
this Request

Please use available blank space on card for your comments.

VAR-65374 & SUP-65375

City Council Meeting of 10/19/2016

11 ✓

Application Information

VAR-65374 - VARIANCE RELATED TO ZON-65372 AND VAR-65373 - PUBLIC HEARING - APPLICANT: NEVADA SAFES - OWNER: MCC INVESTMENT COMPANY LTD - For possible action on a request for a Variance TO ALLOW ZERO ADDITIONAL PARKING SPACES ON A PARKING IMPAIRED DEVELOPMENT WHERE EIGHT ADDITIONAL SPACES ARE REQUIRED on 0.53 acres at 5250 West Charleston Boulevard (APN 138-36-803-004), R-1 (Single Family Residential) and C-1 (Limited Commercial) Zones [PROPOSED: C-1 (Limited Commercial)], Ward 1 (Tarkanian) [PRJ-65195]. Staff recommends DENIAL. The Planning Commission (6-0 vote) recommends APPROVAL.

SUP-65375 - SPECIAL USE PERMIT RELATED TO ZON-65372, VAR-65373 AND VAR-65374 - PUBLIC HEARING - APPLICANT: NEVADA SAFES - OWNER: MCC INVESTMENT COMPANY LTD - For possible action on a request for a Special Use Permit FOR A PROPOSED BOAT AND TRAILER DEALERSHIP (NEW AND USED) WITH A WAIVER TO ALLOW A MINIMUM SITE AREA OF 23,087 SQUARE FEET WHERE 25,000 SQUARE FEET IS REQUIRED at 5250 West Charleston Boulevard (APN 138-36-803-004), R-1 (Single Family Residential) and C-1 (Limited Commercial) Zones [PROPOSED: C-1 (Limited Commercial)], Ward 1 (Tarkanian) [PRJ-65195]. Staff recommends DENIAL. The Planning Commission (6-0 vote) recommends APPROVAL.

Any and all interested persons may appear and be heard at said meeting, or may, prior thereto, file written objections thereto or approvals thereof with the City Clerk, 2nd Floor, City Hall, 495 South Main Street, Las Vegas, Nevada, 89101. For further information, please call (702) 229-6311 (TTY 7-1-1). Note that postcards and comments received after an agenda posts will not be reflected online until after the meeting; however, the comments are made available to the members of the governing body for their consideration prior to the meeting.

Application Location

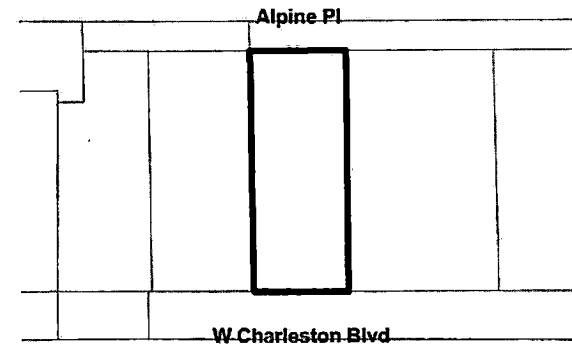

The proposed project may not pertain to the entire highlighted project site.

Public Hearing Information

Meeting: City Council
Date: *October 19, 2016*
Time: 1:00 P.M.
Location: City Council Chambers
495 South Main Street, 2nd Floor
Las Vegas, Nevada

S.V

Report of All Selected Parcels

Case Number:

VAR-65374, SUP-65375

Printed On: Mon: September 26, 2016

<u>Owner</u>	<u>Address</u>	<u>Parcel Number</u>
901 ALPINE VENTURE	3990 RUFFIN RD #100 SAN DIEGO CA 92123-4805	13836802001
A & W INVESTMENT L L C	9716 CLAYBOURNE CT LAS VEGAS NV 89148-4654	13836801012
AGUIRRE MARTIN	RAMIREZ CARMEN J 5220 LYTTON AVE LAS VEGAS NV 89146	16301512004
AINSWORTH KEITH B & DENISE M	7060 DARBY AVE LAS VEGAS NV 89117	13836803005
ALCARDE VIRGILIO C & YOLANDA J	5320 LONGRIDGE AVE LAS VEGAS NV 89146	16301511046
ALFARO VICTOR ROMEO	DIAZ SULMA NOEMY 5062 BLATON DR LAS VEGAS NV 89122	13836810024
ALLARD VIVIAN LEE & DARLA	5412 HOLMBY AVE LAS VEGAS NV 89146-1328	16301510007
ALVAREZ MARIA E	5212 CORY PL LAS VEGAS NV 89107-3773	13836814008
AMARA FAMILY TRUST	AMARA MAXIE P & SUSAN C TRS 7628 TOWNSVILLE LAS VEGAS NV 89113-3278	13836812018
ANDERSON JUAN J	1000 MOHAWK ST LAS VEGAS NV 89107-3714	13836407016
ANGEL CESAR	5429 LIVERPOOL RD LAS VEGAS NV 89107-3751	13836412033
ANGEL-HERNANDEZ KEILA DEL	1209 WILSHIRE ST LAS VEGAS NV 89146-1429	16301512105
ANTONIO LETICIA	BERNALES LOUSALIE 801 BREANNA ST LAS VEGAS NV 89107-3799	13836812021
ANTONIO LETICIA B	904 BREANNA ST LAS VEGAS NV 89107-3748	13836814015
ARK CONSTRUCTION INC	9500 HILLWOOD DR #110 LAS VEGAS NV 89134	13836801015
ATEN FAMILY TRUST	ATEN MATTHEW G & JOAN E TRS 6255 N PARK ST LAS VEGAS NV 89149-2376	13836408005
ATEN FAMILY TRUST	ATEN MATTHEW G & JOAN E TRS 6255 N PARK ST LAS VEGAS NV 89149-2376	13836408008
AYALA ALVARO & LETICIA	5424 CORY PL LAS VEGAS NV 89107-3789	13836412039
BAILEY JERRY E & ANNA C	5224 PADUA WAY LAS VEGAS NV 89107	13836812002
BAKER 1993 TRUST	BAKER AVALON R TRS 900 MOHAWK ST LAS VEGAS NV 89107-3712	13836404008
BALLEZA LICHEL C NAVAL	4034 W ARGYLE ST CHICAGO IL 60630-2702	13836813004
BALLNER JOHN L & TAMMI	5416 ALPINE PL LAS VEGAS NV 89107-3754	13836407030
BANK WELLS FARGO NATIONAL ASSN	P O BOX 2609 CARLSBAD CA 92018-2609	13836408009
BARAJAS FRANCISCO J & MARIA E	5308 HOLMBY AVE LAS VEGAS NV 89146-1344	16301511023
BARNES LAWRENCE B & ANNIE FAM TR	BARNES ANNIE M TRS 5146 CORAL BEACH ST NORTH LAS VEGAS NV 89031-6275	16301512003
BARNETT JAMES C & EDEN B FAM TR	BARNETT JAMES C & EDEN B TRS 5208 PADUA WY LAS VEGAS NV 89107-0402	13836812006
BAROL MIGNON P	900 NOOROZIAN CT LAS VEGAS NV 89107-3747	13836814001
BASS WILLIAM H & DENNIS JAMES LI	BASS WILLIAM H TRS 1004 BREANNA ST LAS VEGAS NV 89107-3779	13836810011
BEDOLLA MIGUEL CHAVEZ	5404 CORY PL LAS VEGAS NV 89107-3706	13836413008
BELANGER JOAN M	5232 LYTTON AVE LAS VEGAS NV 89146-1425	16301512001
BEROYA CARLOS B JR & ZENaida R	8501 CREST HILL AVE LAS VEGAS NV 89145-4843	13836813003
BISHOP JEFF	5408 CORY PL LAS VEGAS NV 89107-3706	13836413007

11 ✓

Report of All Selected Parcels**Case Number:**

VAR-65374, SUP-65375

Printed On: Mon: September 26, 2016

Owner	Address	Parcel Number
BISTREK ROBERT & CAROL R	5316 LYTTON AVE LAS VEGAS NV 89146-1348	16301511005
BITTNER CARL	AHEDO OFELIA 904 MOHAWK ST LAS VEGAS NV 89107-3712	13836413012
BRAEUNER R P FAMILY TRUST	BRAEUNER ROSALIA P TRS 809 MOHAWK ST LAS VEGAS NV 89107-3794	13836813013
BRAEUNER R P FAMILY TRUST	BRAEUNER ROSALIA P TRS 809 MOHAWK ST LAS VEGAS NV 89107-3794	13836813001
BRITEZ ADOLFO D	5304 LONGRIDGE AVE LAS VEGAS NV 89146-1313	16301511042
CABALLERO PATRICIA Y & ALEJANDRO	809 BREANNA ST LAS VEGAS NV 89107-3799	13836812023
CACHO ROGELIO CARINO & AME CANTA	2747 E VAN BUREN ST CARSON CA 90810	13836812004
CALMA IMELDA	5850 W DEWEY DR LAS VEGAS NV 89118-6076	16301512100
CARLOS JOSE I & MARIA A	5324 PADUA WY LAS VEGAS NV 89107-0404	13836813002
CARRASCO EDUARDO & LILIANA	5225 LYTTON AVE LAS VEGAS NV 89146-1451	16301512101
CASTANEDA JUAN	5225 PADUA WY LAS VEGAS NV 89107-0403	13836812029
CHAN VIKKI SIU HA	300 E HAVEN AVE ARCADIA CA 91006	13836404007
CHARDAN HOLDINGS L L C	913 EUGENE CERNAN ST LAS VEGAS NV 89145-6128	13836810002
CHARLIE RAH RAH	3075 ROSANNA LAS VEGAS NV 89117-3141	16301501001
CHARLIE RAH RAH	3075 ROSANNA LAS VEGAS NV 89117-3141	16301501002
CHARMP KILDRUMMIE L L C	P O BOX 778222 HENDERSON NV 89077	13836812025
CHENG TAO LIEN & KO HUILING	5310 N WALNUT GROVE AVE SAN GABRIEL CA 91776	16301510013
CHEONG ALTON	888 IWILEI RD #703 HONOLULU HI 96817	16301512005
CHIANG TINA CHEN	1000 NATIONAL AVE #254 SAN BRUNO CA 94066	16301511034
CHION-LEN ANGIELLO	5420 LIVERPOOL RD LAS VEGAS NV 89107-3750	13836412014
CHU FAMILY TRUST	805 BREANNA ST LAS VEGAS NV 89107	13836812022
CHUN LESLIE & MARISOL M	5400 CORY PL LAS VEGAS NV 89107-3706	13836413009
CITY OF LAS VEGAS	333 N RANCHO DR 8TH FL LAS VEGAS NV 89106-3703	13836801002
CONNOLLY SHAWN A & CHASE M	903 BARTONA ST LAS VEGAS NV 89107-3743	13836413001
CORONADO FRANCISCO	MEREDITH CARMEN 5425 LIVERPOOL RD LAS VEGAS NV 89107-3751	13836412034
CRESS JEAN A	1013 MOHAWK ST LAS VEGAS NV 89107-3713	13836810023
CRUZ MIGUEL A	5412 CORY PLACE LAS VEGAS NV 89107-3706	13836413006
DARCY ANDREW W	848 N RAINBOW BLVD #2781 LAS VEGAS NV 89107	16301511001
DEFREZE CHARLENE L	805 BARTONA ST LAS VEGAS NV 89107-3781	13836404003
DELACRUZ EMERSON N	SO-DELACRUZ LORETTA 84-15 CORONA AVE ELMHURST NY 11373-5838	13836812010
DELAROSA MARTHA O	905 BARTONA ST LAS VEGAS NV 89107-3743	13836413002
DELEON ADOLFO	5332 LONGRIDGE AVE LAS VEGAS NV 89146-1313	16301511049

Report of All Selected Parcels**Case Number:**

VAR-65374, SUP-65375

Printed On: Mon: September 26, 2016

Owner	Address	Parcel Number
DIAZ MARGARITA P	5216 ALPINE PL LAS VEGAS NV 89107-3709	13836812005
DICKINSON C RICHARD & CO 401K	5509 AVANT GARDE CT LAS VEGAS NV 89146-1303	13836407011
DOLORES JOEL M	63 IRON HORSE LN WALNUT CREEK CA 94597	13836814005
DOMINGO ARNOLD & ROSELA RUIZ	11070 FORT BOWIE ST LAS VEGAS NV 89179	13836813012
DUGGAN CHARLES & LINDA FAMILY TR	DUGGAN CHARLES C & LINDA M TRS 8480 OHARE RD LAS VEGAS NV 89143-1235	13836812008
DUNK ROY EARL & LEANNE K	5420 ALPINE PL LAS VEGAS NV 89107-3754	13836407029
ESHAGHYAN IMAN	166 N CANNON DR BEVERLY HILLS CA 90210	16301510012
ESSLINGER FAMILY TRUST SURV TR	12932 N 136TH ST SCOTTSDALE AZ 85259-2313	16301103025
ESTRADA ANTONIO & MARIA	908 MOHAWK ST LAS VEGAS NV 89107-3712	13836413011
FALKOR PROPERTIES L L C	1929 VAN NESS AVE SAN FRANCISCO CA 94109	16301515001
FALKOR PROPERTIES L L C	1929 VAN NESS AVE SAN FRANCISCO CA 94109	16301502017
FAMILY DOLLAR INC	P O BOX 1017 CHARLOTTE NC 28201-1017	13836408010
FANTOM 1 L L C	9670 W TROPICANA AVE #115 LAS VEGAS NV 89147	13836814013
FEDERAL NATIONAL MORTGAGE ASSOCI	7105 CORPORATE DR PLANO TX 75024	16301511026
FERNANDEZ RAMON ANGEL	5309 HOLMBY AVE LAS VEGAS NV 89146	16301511038
FERNANDEZ SATURNINO	CEPERO ESTHER 907 BARTONA ST LAS VEGAS NV 89107-3743	13836413003
FICEK JOANNE C REVOCABLE LIV TR	FICEK JOANNE C TRS 1008 BREANNA ST LAS VEGAS NV 89107-3779	13836810012
FOLEY JAMES & ANNEMARIE REV TR	FOLEY JAMES J & ANNEMARIE E TRS 40263 COLONY DR MURRIETA CA 92562-5519	13836810017
FRANKLIN GREGORY L & JULIA	5328 LYTTON AVE LAS VEGAS NV 89146-1348	16301511008
G M B INVESTMENTS L L C	5113 ALPINE PLACE LAS VEGAS NV 89107-3767	13836803012
GALSTIAN VARDAN	1328 HIGHLAND AVE GLENDALE CA 91202-2047	13836801010
GARCIA ALONDRA FLORES & VICTORIA	5412 ALPINE PL LAS VEGAS NV 89107-3754	13836407031
GENDALL LILY TRUST	GENDALL LILY TRS 8955 POMONA CT LAS VEGAS NV 89147-6551	13836801013
GEORGE MICHAEL & IMELDA C	5204 CORY PL LAS VEGAS NV 89107-3773	13836814010
GLENCOE PROPERTIES INC	7548 W SAHARA AVE #102 LAS VEGAS NV 89117	13836803014
GONZALEZ JOSE	900 BREANNA ST LAS VEGAS NV 89107-3748	13836814016
GOVEA PATRICIA	9514 CHERRYDALE CT LAS VEGAS NV 89147	16301511033
GRANT IVAN	5309 PADUA WAY LAS VEGAS NV 89107	13836813011
GUEVARRA MAGDALENA B	BARNETT EDEN B 5220 CORY PL LAS VEGAS NV 89107-3773	13836814006
GUO JUN	9164 LEROY ST SAN GABRIEL CA 91775-2025	16301511041
GUTIERREZ ARIANA	804 MOHAWK ST LAS VEGAS NV 89107-3793	13836404004
HAASE KURT W & JANET	1012 BREANNA LAS VEGAS NV 89107-3779	13836810015

Report of All Selected Parcels**Case Number:**

VAR-65374, SUP-65375

Printed On: Mon: September 26, 2016

<u>Owner</u>	<u>Address</u>	<u>Parcel Number</u>
HAASE KURT W LIVING TRUST	HAASE KURT W TRS 1012 BREANNA ST LAS VEGAS NV 89107-3779	13836810013
HAN JONG WOO	5424 ALPINE PL LAS VEGAS NV 89107-3754	13836407028
HASSELBACK GERALDINE	905 MOHAWK ST LAS VEGAS NV 89107	13836801006
HAYES JOINT FAMILY LIVING TRUST	HAYES CONNIE Z TRS 5208 LYTTON AVE LAS VEGAS NV 89146-1425	16301512007
HE YUE & WEIXIONG	36 LIVING EDENS CT LAS VEGAS NV 89148-2812	13836810003
HERNANDEZ ANGEL A & MARIA O	5116 PADUA WY LAS VEGAS NV 89107-0400	13836812012
HERNANDEZ BENJAMIN R II	1217 WILSHIRE ST LAS VEGAS NV 89146-1429	16301510010
HERRERA-LARA LAURA	5308 LYTTON AVE LAS VEGAS NV 89146	16301511003
HOLLY HELEN A	5204 LYTTON AVE LAS VEGAS NV 89146-1425	16301512008
HU RICHARD H & CECELIA Y	3015 KASHIWA ST TORRANCE CA 90505	16301511037
IBARRA FRANCISCO	5391 IVAN HOE AVE RIVERSIDE CA 92503-2435	16301510006
IGAYAC IMELDA & DIODIE	1000 BREANNA ST LAS VEGAS NV 89107-3779	13836810010
IRWIN JAMES M & DIANE J	5308 LONGRIDGE AVE LAS VEGAS NV 89146-1313	16301511043
JAUREGUI MIGUEL Y	5417 CORY PL LAS VEGAS NV 89107-3785	13836407012
JAUREGUI MIGUEL Y & OLGA M	5417 CORY PL LAS VEGAS NV 89107-3785	13836407013
JAVIER GLORIA	5408 ALPINE PL LAS VEGAS NV 89107-3754	13836407032
JIANG CHENGMOU	5304 PADUA WY LAS VEGAS NV 89107-0404	13836813007
JOHNSON DEBBIE A	1012 MOHAWK ST LAS VEGAS NV 89107-3714	13836407035
JOHNSON DONALD	800 BREANNA ST LAS VEGAS NV 89107-3798	13836812026
JURANI ROMEO S & NADIA C LIVING	1408 CASTLE WALL ST LAS VEGAS NV 89117-1379	16301512006
K & K ASSET MANAGEMENT L L C	5070 E VEGAS VALLEY DR #621804 LAS VEGAS NV 89162	16301511050
KENDRICK NORMAN & LAN	5208 ALPINE PL LAS VEGAS NV 89107-3709	13836810016
KHAMSAENG KANITA	1016 BREANNA ST LAS VEGAS NV 89107-3779	13836810014
KHOZANI NASSER & NASRIN	5228 PADUA WY LAS VEGAS NV 89107-0402	13836812001
KITCHEN JOSEPH H & ALLENE	P O BOX 8181 SPRING CREEK NV 89815	13836412013
KLEE LIVING TRUST	LEE KATY L TRS P O BOX 2309 SARATOGA CA 95070-0309	16301511044
KUEWA RAMIE N	5413 CORY PL LAS VEGAS NV 89107-3785	13836407014
KURTH ERIC	5424 HOLMBY AVE LAS VEGAS NV 89146-1328	16301510004
L & L CAPITAL L L C	410 W WINNIE WAY ARCADIA CA 91007-7957	13836812014
L R L RIBAUDO L L C	1855 DUNEVILLE ST LAS VEGAS NV 89146	13836803010
LANDA CORNELIO & AMELIA	5216 ALPINE PL LAS VEGAS NV 89107	13836810018
LANZILLI BABETTA TRUST	LANZILLI BABETTA TRS 913 MOHAWK ST LAS VEGAS NV 89107-3711	13836801008

Report of All Selected Parcels**Case Number:**

VAR-65374, SUP-65375

Printed On: Mon: September 26, 2016

Owner	Address	Parcel Number
LAO ZENaida J FAMILY TRUST	LAO ZENaida J TRS 5112 PADUA WY LAS VEGAS NV 89107-0400	13836812013
LAPP MICHAEL S OR ARLENE D	5301 CORY PL LAS VEGAS NV 89107-3761	13836810005
LE BINH	LEDANG MYTINH LINDA 908 NOOROZIAN CT LAS VEGAS NV 89107-3747	13836814003
LEE TAI SUK LIVING TRUST	5300 ALPINE PL LAS VEGAS NV 89107-3797	13836810019
LEINBACH JEREMY E & SARAH L	1990 MILL POND LN LAS VEGAS NV 89119	16301511028
LEONARDO JOSEPH	5428 HOLMBY AVE LAS VEGAS NV 89146-1328	16301510003
LESLIES POOLMART	3925 E BROADWAY RD #100 PHOENIX AZ 85040-2976	16301502004
LI HOU-YING TRUST	LI HOU-YING TRS 5301 PADUA WAY LAS VEGAS NV 89107-0404	13836813009
LI QIU PING	18395 CAMINO BELLO #C ROWLAND HEIGHTS CA 91748	16301511027
LI SUI & XIANG	5304 ALPINE PL LAS VEGAS NV 89107-3797	13836810020
LIAO YI XIAN	4261 SANDERLING CIR #324 LAS VEGAS NV 89103-6365	16301511010
LICEA LIVING TRUST	LICEA TEODORO G & ANA P CO-TRS 17644 SCOTTSDALE RD RIVERSIDE CA 92504-9408	16301512078
LIN KUNG-SHENG & CHIN LIANG	4300 MEADOW #502 LAS VEGAS NV 89107-3008	13836813008
LINARES JOSE A & CARLA H	916 BREANNA ST LAS VEGAS NV 89107-3748	13836814012
LONG PATRICIA	908 BREANNA ST LAS VEGAS NV 89107-3748	13836814014
LUONG HA D & MELANIE B	5109 PADUA WY LAS VEGAS NV 89107-0401	13836812019
LUOTO KENNETH D	KEEHN NANCY C 5337 LYTTON AVE LAS VEGAS NV 89146-1347	16301511011
LUX MAURICIO	5205 CORY PL LAS VEGAS NV 89107-3774	13836810009
LY BRIAN	5216 CORY PL LAS VEGAS NV 89107-3773	13836814007
LY DANNY & JENNIFER	904 NOOROZIAN CT LAS VEGAS NV 89107-3747	13836814002
M C C INVESTMENT COMPANY LTD	3416 E 8350 S SALT LAKE CITY UT 84121-5875	13836803004
MAGANA JOSE M	5428 ALPINE PL LAS VEGAS NV 89107-3754	13836407027
MARIGOLD PATRICK & SUSAN	5428 CORY PL LAS VEGAS NV 89107-3789	13836412040
MARQUEZ-BERMUDEZ ANA M	BERMUDEZ ANDRE 4613 HAYES PL LAS VEGAS NV 89107	16301512009
MARROQUIN MARIANO	5328 LONGRIDGE AVE LAS VEGAS NV 89146-1313	16301511048
MARTIN DONALD DEAN & DORINDA S	5304 HOLMBY AVE LAS VEGAS NV 89146-1344	16301511022
MCCONNELL RUSSELL LEE & TRACEY S	5209 LYTTON AVE LAS VEGAS NV 89146-1441	16301512075
MEDINA VICTORIA	5305 CORY PL LAS VEGAS NV 89107-3761	13836810004
MEJIA JOSE & VILIAN Y	5329 LYTTON AVE LAS VEGAS NV 89146-1347	16301511013
MEJIA ROSA N	5336 HOLMBY AVE LAS VEGAS NV 89146-1344	16301511030
MOHAWK CHARLESTON L L C	P O BOX 80743 LAS VEGAS NV 89180	13836803002
MOHAWK CHARLESTON L L C	P O BOX 80743 LAS VEGAS NV 89180	13836803001

Report of All Selected Parcels**Case Number:**

VAR-65374, SUP-65375

Printed On: Mon: September 26, 2016

Owner	Address	Parcel Number
MOHAWK CHARLESTON L L C	P O BOX 80743 LAS VEGAS NV 89180	13836803015
MOHAWK CHARLESTON L L C	P O BOX 80743 LAS VEGAS NV 89180	13836803016
MONTENEGRO HECTOR	5221 HOLMBY AVE LAS VEGAS NV 89146-1419	16301512098
MOON VALLEY NURSERY VEGAS L L C	19820 N 7TH ST #260 PHOENIX AZ 85024	16301501011
MORALES CLAUDIA LILY	5333 HOLMBY AVE LAS VEGAS NV 89146-1343	16301511032
MY CHARLESTON PLAZA L L C	5112 W CHARLESTON BLVD #C LAS VEGAS NV 89146-1447	13836803008
MY CHARLESTON PLAZA L L C	5112 W CHARLESTON BLVD #C LAS VEGAS NV 89146-1447	13836803011
NANAYAKKARA PRABASH S	17319 17TH DRIVE SE BOTHELL WA 98012-6477	13836412038
NELSON ERIC	2641 VIA VALDEZ PALOS VERDES ESTATES CA 90274-2 811	13836407033
NEW VISTA RANCH INC	5220 W CHARLESTON BLVD LAS VEGAS NV 89146	13836803013
NICOSIA MICHAEL W	4417 MCLEOD DR LAS VEGAS NV 89121-5320	16301511012
NOTTINGHAM RAMONA	FEDERICI ESTHER 5316 LONGRIDGE AVE LAS VEGAS NV 89146	16301511045
NUNEZ CAROLINA	5324 LYTTON AVE LAS VEGAS NV 89146-1348	16301511007
NUNEZ-DIAZ ANDRES	5308 PADUA WY LAS VEGAS NV 89107-0404	13836813006
OLDENBURG ADONIS & PATRICIA	5229 LYTTON AVE LAS VEGAS NV 89146-1451	16301512103
OLDENBURG ADONIS T & PATRICIA A	5229 LYTTON AVE LAS VEGAS NV 89146-1451	16301512102
ORDANZA GAY O	808 BREANNA ST LAS VEGAS NV 89107-3798	13836812024
OSAKA PENSION PLAN	7046 EL PURGUE LAS VEGAS NV 89117	16301512104
OTHA CHULALAK & AWINAN	5312 HOLMBY AVE LAS VEGAS NV 89146	16301511024
P W PLAZA L L C	5421 N GRAND CANYON BLVD LAS VEGAS NV 89145	16301501012
PACIFIC HOLDING LLC HUNT SERIES	601 S RANCHO DR #A-6 LAS VEGAS NV 89106	16301512099
PADILLA-DELIS EDILBERTO	909 BARTONA ST LAS VEGAS NV 89107-3743	13836413004
PAIZ RONY O	SOSA SANDRA 5313 LYTTON AVE LAS VEGAS NV 89146-1347	16301511017
PALMA NELSON V & CELIA A	2955 FINCH ST LOS ANGELES CA 90039-2105	13836812020
PANTOJA BERTA L	5421 LIVERPOOL RD LAS VEGAS NV 89107-3751	13836412035
PAYAN AMBROSIO TRUST	PAYAN AMBROSIO TRS 5305 LYTTON AVE LAS VEGAS NV 89146-1347	16301511019
PEREZ FELIPE HIDALGO	5332 LYTTON AVE LAS VEGAS NV 89146-1348	16301511009
PITTAN DONALD E	5309 LYTTON AVE LAS VEGAS NV 89146	16301511018
PLOMENBOIM ORSHY	P O BOX 17184 BEVERLY HILLS CA 90209	13836810006
POWERS ROBERT T	1001 MOHAWK ST LAS VEGAS NV 89107-3713	13836810001
PUBLIC STORAGE INC	P O BOX 25025 GLENDALE CA 91221-5025	13836804001
QUICK DANIEL L & FAITH TRUST	QUICK FAITH TRS P O BOX 571321 LAS VEGAS NV 89157-1321	16301511014

Report of All Selected Parcels**Case Number:**

VAR-65374, SUP-65375

Printed On: Mon: September 26, 2016

Owner	Address	Parcel Number
QUICK N CLEAN 51 L L C	7291 E ADOBE DR #115 SCOTTSDALE AZ 85253	13836408006
R O R & B M R PROPERTIES L L C	4525 N FORT APACHE LAS VEGAS NV 89129	16301511015
RAMIREZ ALBERTO & ANA	4524 BAXTER PL LAS VEGAS NV 89107-4243	13836812009
RAMIREZ FRANCISCO & MARTA	5317 HOLMBY AVE LAS VEGAS NV 89146-1343	16301511036
RAMIREZ VERONICA	1008 MOHAWK ST LAS VEGAS NV 89107-3714	13836407034
RAMOS FAMILY TRUST	RAMOS FELIX S & SYLVIA O TRS 9126 DELPHIA AVE DES PLAINES IL 60016	13836814011
RAMPTON CONNIE B	5429 CORY PL LAS VEGAS NV 89107-3785	13836407010
RATHBUN RICHARD JOE JR	5300 HOLMBY AVE LAS VEGAS NV 89146-1344	16301511021
RETH SAMBATH & TOUCH	5021 BEVVIE DR LAS VEGAS NV 89108	13836814009
REYES MARIA E	917 MOHAWK ST LAS VEGAS NV 89107-3711	13836801009
RIVIECCIO JOSEPH & FRANCES E	909 MOHAWK ST LAS VEGAS NV 89107-3711	13836801007
RODARTE FRANCISCO MUNOZ	807 BARTONA ST LAS VEGAS NV 89107	13836404005
RODRIGUEZ ADALBERTO	907 NOOROZIAN CT LAS VEGAS NV 89107-3747	13836801014
RODRIGUEZ IRENE L	CARBAJAL NADINE 5420 HOLMBY AVE LAS VEGAS NV 89146-1328	16301510005
ROGERS FRED & YUNG S	5312 ALPINE PL LAS VEGAS NV 89107-3797	13836810022
ROMERO FAMILY TRUST	ROMERO DAVID J & ALMA M TRS 5400 LONGRIDGE AVE LAS VEGAS NV 89146	16301510030
ROSEN IAN D	901 MOHAWK ST LAS VEGAS NV 89107-3711	13836813014
SANDOVAL ANTHONY & JOY	5416 CORY PL LAS VEGAS NV 89107	13836412037
SANESI GRAZIANO & MICHIKO	5229 PADUA WY LAS VEGAS NV 89107-0403	13836812030
SANGIL SANTIAGO T & AURORA M	1663 9TH AVE SAN FRANCISCO CA 94122-3620	13836813010
SANTOS EDNA L & MARIE L	912 MOHAWK ST LAS VEGAS NV 89107-3712	13836413010
SCHULTZ DENNIS L & MARIA D	5320 LYTTON AVE LAS VEGAS NV 89146-1348	16301511006
SCULL MARJORIE M LIFETIME TRUST	SCULL MARJORIE M TRS 10721 WINDLEDGE AVE LAS VEGAS NV 89134-5254	13836810025
SEELEY NEIL JAMES & MARIA GEA BE	808 MOHAWK ST LAS VEGAS NV 89107-3793	13836404006
SHIPPY L L C	1165 S HUALAPAI WY LAS VEGAS NV 89117-7535	16301502014
SIERRA MAX	MARTINEZ-QUINTANILLA MARIA P 5228 LYTTON AVE LAS VEGAS NV 89146	16301512002
SONE WAYNE F & LINDA J	5312 LYTTON AVE LAS VEGAS NV 89146-1348	16301511004
SOUTHERN NV HOUSING AUTHORITY	340 N 11 ST #170 LAS VEGAS NV 89101-3125	13836801003
SOUTHERN NV HOUSING AUTHORITY	340 N 11 ST #170 LAS VEGAS NV 89101-3125	13836801004
SPIESS CARLOS A & MARY ANN	901 BARTONA ST LAS VEGAS NV 89107-3743	13836404009
SPRING MOUNTAIN VEGAS L L C	5760 SPRING MOUNTAIN RD LAS VEGAS NV 89146	16301501007
STANIFORTH ANDREA F	3705 ARCTIC BLVD #1699 ANCHORAGE AK 99503	16301511029

Report of All Selected Parcels**Case Number:**

VAR-65374, SUP-65375

Printed On: Mon: September 26, 2016

Owner	Address	Parcel Number
STARKS RUDOLPH JR	6592 ABALONE SHELL CT LAS VEGAS NV 89139-6136	16301511047
SUBLETT CINDER A	5217 LYTTON AVE LAS VEGAS NV 89146-1441	16301512077
SUCCESS DEVELOPMENT INC	5220 INDIAN RIVER DR #295 LAS VEGAS NV 89103-7446	13836813005
SYLVIA REMEDIOS H	5232 DOE AVE LAS VEGAS NV 89146-0302	16301512107
T F L PLAZA L L C	5421 N GRAND CANYON DR LAS VEGAS NV 89149	16301501010
TABERA CIRO & MINERVA CARIDAD	5432 ALPINE PL LAS VEGAS NV 89107-3754	13836407026
TENG ZHONG JIAN	ZHAO YIWEN 17008 BRACEWOOD DR HACIENDA HEIGHTS CA 91745-5705	16301511025
TENG ZHONG JIAN	ZHAO YIWEN 17008 BRACEWOOD DR HACIENDA HEIGHTS CA 91745-5705	16301511020
TERAN LAURO	5317 LYTTON AVE LAS VEGAS NV 89146-1347	16301511016
THOMPSON ROBERT & KIM	5413 HOLMBY AVE LAS VEGAS NV 89146-1331	16301510014
TONG SHUN ON & WAI FONG	5120 PADUA WY LAS VEGAS NV 89107-0400	13836812011
TROCIO JOEY C & FLORENCIA G	5409 CORY PL LAS VEGAS NV 89107-3785	13836407015
VELASQUEZ MIRNA M	5304 LYTTON AVE LAS VEGAS NV 89146-1348	16301511002
VENDIOLA FAMILY TRUST	VENDIOLA ARSENIO & TERESITA TRS 5220 PADUA WY LAS VEGAS NV 89107-0402	13836812003
VICTOR DENNIS M	5235 W CHARLESTON BLVD LAS VEGAS NV 89146-1438	16301502001
VIENTE SONIALITA R	5101 PADUA WY LAS VEGAS NV 89107-0401	13836812017
VILLASENOR FAMILY TRUST	VILLASENOR ABRAHAM TRS 5408 HOLMBY AVE LAS VEGAS NV 89146-1328	16301510008
VILLATORO HYRUM E & ABBIGAIL G	5300 CORY PL LAS VEGAS NV 89107-3758	13836801011
VISHENINA ELEONORA	5209 CORY PL LAS VEGAS NV 89107	13836810008
VIVONA FRANCIS	5217 PADUA WY LAS VEGAS NV 89107-0403	13836812027
VU MICHAEL & HILLARY	16435 SIERRA ST FOUNTAIN VALLEY CA 92708-2105	16301511040
WALTERS RAYMOND	1213 WILSHIRE ST LAS VEGAS NV 89146	16301512106
WANG BING	2989 FORMIA DR HENDERSON NV 89052	13836812028
WANG HSIU MEI LIVING TRUST	WANG HSIU MEI TRS 22809 BROADWELL AVE TORRANCE CA 90502-2943	13836814004
WEBER JOHN R & SANDRA J FAM TR	WEBER JOHN R & SANDRA J TRS P O BOX 27356 LAS VEGAS NV 89126-1356	13836404002
WEST COAST PRIVATE INVESTS L L C	32035 ISLE VIS LAGUNA NIGUEL CA 92677	13836803007
WESTWOOD JACKIE MARIE REV TR	5305 HOLMBY AVE LAS VEGAS NV 89146-1343	16301511039
WHITNEY JAMES & LORRAINE FAM TR	WHITNEY JAMES E & LORRAINE B TRS 5404 HOLMBY AVE LAS VEGAS NV 89146-1328	16301510009
WIJNAENDTS ROBERT PAUL & TAMMY L	5213 LYTTON AVE LAS VEGAS NV 89146-1441	16301512076
WINCHELLS DONUT HOUSE L P	5220 PACIFIC CONCOURSE DR #130 LOS ANGELES CA 90045-6269	13836803009
WONG & TEE FAMILY TRUST ETAL	TEE NORA KHIN WIN TRS 209 W CAMINO REAL AVE ARCADIA CA 91007	13836810007
WONG RICKY	1515 N MILPITAS BLVD #29 MILPITAS CA 95035	16301511035

Report of All Selected Parcels**Case Number:**

VAR-65374, SUP-65375

Printed On: Mon: September 26, 2016**Owner**

WU RAYMOND
YI XIANG CHUN ZHU INC
YOUNG SUSANNA & FRANCO
YUAN ZHI JUN
ZHANG XIAO MEI

Address

LIN TING TING 1515 S 2ND ST #B ALHAMBRA CA 91801-5011
6292 W SPRING MOUNTAIN RD #105 LAS VEGAS NV 89146
1707 7TH AVE SAN FRANCISCO CA 94122-4705
JIANG BO WEN 1328 RAINY SKY AVE NORTH LAS VEGAS NV 89030
P O BOX 186 ALHAMBRA CA 91802-0186

Parcel Numbe

13836810021
16301511031
16301510011
13836812007
16301512079