

S.V

City of Las Vegas  
Office Of The City Clerk  
495 South Main Street, 2<sup>nd</sup> Floor  
Las Vegas, Nevada 89101

PRSR STD  
U.S. Postage  
**PAID**  
Las Vegas, NV  
Permit No. 1630

**Return Service Requested**  
**Official Notice of Public Hearing**

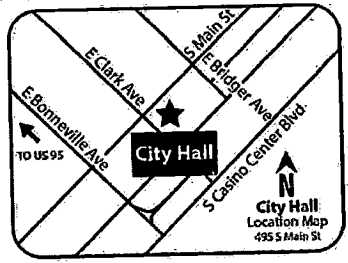

If you wish to file your protest or support on this request, check the appropriate box below and return this card in an envelope with postage to the Office Of The City Clerk at the address listed above or fax this side of this card to (702) 382-4803. If you would like to contact your Council Representative, please call (702) 229-6405.

I SUPPORT  
this Request

I OPPOSE  
this Request

Please use available blank space on card for your comments.

**VAR-65234**

City Council Meeting of 9/21/2016

15v

## Application Information

VAR-65234 - VARIANCE - PUBLIC HEARING -  
APPLICANT/OWNER: DAN CLONINGER AND JAENE GRAYE  
- For possible action on a request for a Variance TO ALLOW A ZERO-FOOT SIDE YARD SETBACK WHERE FIVE FEET IS REQUIRED, A ZERO-FOOT DISTANCE SEPARATION FROM THE PRIMARY RESIDENCE WHERE SIX FEET IS REQUIRED, AND TO NOT BE AESTHETICALLY COMPATIBLE WITH THE PRINCIPAL DWELLING WHERE SUCH IS REQUIRED FOR A PROPOSED ACCESSORY STRUCTURE (CLASS II) [CARPORT] on 0.16 acres at 9045 Gray Bluff Drive (APN 138-08-214-009), R-CL (Single Family Compact-Lot) Zone, Ward 4 (Anthony) [PRJ-65178]. The Planning Commission (5-2 vote) and Staff recommend DENIAL.

## Application Location

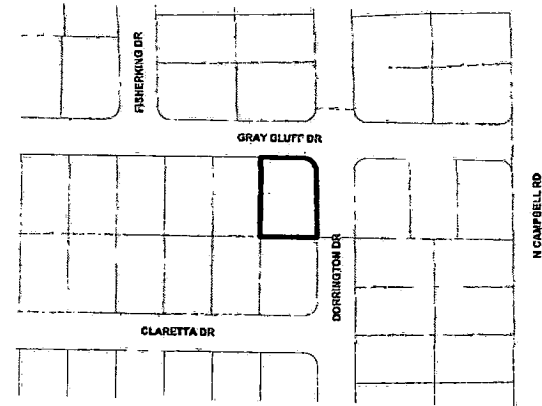

The proposed project may not pertain to the entire highlighted project site.

## Public Hearing Information

**Meeting:** City Council  
**Date:** *September 21, 2016*  
**Time:** 1:00 P.M.  
**Location:** City Council Chambers  
495 South Main Street, 2<sup>nd</sup> Floor  
Las Vegas, Nevada

Any and all interested persons may appear and be heard at said meeting, or may, prior thereto, file written objections thereto or approvals thereof with the City Clerk, 2<sup>nd</sup> Floor, City Hall, 495 South Main Street, Las Vegas, Nevada, 89101. For further information, please call (702) 229-6311 (TTY 7-1-1). Note that postcards and comments received after an agenda posts will not be reflected online until after the meeting; however, the comments are made available to the members of the governing body for their consideration prior to the meeting.

S.v

**Report of All Selected Parcels**

Case Number:

VAR-65234 (PRJ-65178)

Printed On: Wed: September 7, 2016

<u>Owner</u>	<u>Address</u>	<u>Parcel Number</u>
2008 HANSBOURGH LIVING TRUST	FLIPPIN VALERIE A BROWN TRS 3572 TOBEL SPRING DR LAS VEGAS NV 89129-6373	13808317026
A R S TRUST	3705 TREASURE BLUFF CT LAS VEGAS NV 89129	13808217019
ADAME THOMAS K & MARIAN L	3721 N CAMPBELL RD LAS VEGAS NV 89129-7028	13808218007
ADAMS BRUCE A & THAO	3576 MOUNTAIN VALLEY DR LAS VEGAS NV 89129-6385	13808317036
AGAH SASAN	8973 HILLSBORO CREEK CT LAS VEGAS NV 89129-3645	13808211005
ALBRIGHT D CHRIS & ELAINE FAM TR	ALBRIGHT D CHRIS & ELAINE B TRS 3720 FISHERKING DR LAS VEGAS NV 89129-7049	13808221021
ALDRIDGE JED & DEBRA	3620 DEER FLATS ST LAS VEGAS NV 89129-7036	13808220004
ALLEN MARK & NICKI ARLENE	3804 DIAMOND RIDGE ST LAS VEGAS NV 89129-7060	13808113079
ALLEY JAMES R & AVIS L	3737 N CAMPBELL RD LAS VEGAS NV 89129-7028	13808218003
ALVARES ANTHONY L	14258 S WEST AVE CARUTHERS CA 93609	13808218013
ALVARES ANTHONY L	14258 S WEST AVE CARUTHERS CA 93609	13808222032
ALVAREZ MANUEL J & MARY J	8924 SAILPLANE AVE LAS VEGAS NV 89129-7030	13808217007
AQUINO NORMA M	8941 FORT CRESTWOOD DR LAS VEGAS NV 89129-3639	13808211010
ARNESS EMIL & CATHERINE J	3563 N CAMPBELL RD LAS VEGAS NV 89129-6194	13808316005
AVALLONE JAMES	44007 VILLAGE 44 CAMARILLO CA 93012	13808220016
BALZANO TOBIA R & AGNES S	8928 SAILPLANE AVE LAS VEGAS NV 89129	13808217008
BANK WELLS FARGO N A TRS	780 DELTA DR LA4-1040 MONROE LA 71203	13808210010
BAPTISTE LAVERNE E & WALLACE II	3573 MOUNTAIN VALLEY DR LAS VEGAS NV 89129-6386	13808317004
BARNETT HARVEY R & LINDA M	8911 FORT CRESTWOOD DR LAS VEGAS NV 89129	13808211013
BENDER-GEMMELL CYNTHIA M	GEMMELL THOMAS DR 3621 FOX HEATHER DR LAS VEGAS NV 89129-7034	13808220005
BENITO JOHN	3713 DEER FLATS ST LAS VEGAS NV 89129	13808223014
BENNET ELIZABETH A	3609 DEER FLATS ST LAS VEGAS NV 89129-7037	13808220022
BENSON STANLEY B & HEATHER D	9105 DIAMOND LAKE AVE LAS VEGAS NV 89129-7064	13808113025
BERARDI DANNY & LUCIA	13124 W CHOCTAW TRL HOMER GLEN IL 60491	13808222005
BIDNER MARYANN R	JOHONNOT CHERYL 8983 SIDEBROOK CT LAS VEGAS NV 89129-7035	13808218022
BITON RIVI H	57-90 228TH ST BAYSIDE NY 11364	13808211009
BLACK THOMAS L & CAN TU	8908 SAILPLANE AVE LAS VEGAS NV 89129	13808217003
BLUE LAND L P	4157 ELM VIEW DR ENCINO CA 91316	13808316001
BOLTON DOUGLAS M	3412 FEATHER REED AVE LONGMONT CO 80503	13808220015
BONNELL RICHARD J & CATHERINE J	8936 FORT CRESTWOOD DR LAS VEGAS NV 89129-3637	13808211021
BORCHERS DANIEL	3725 DORRINGTON DR LAS VEGAS NV 89129-7053	13808222028
BOWMAN KLEITZ FAMILY TRUST	KLEITZ JEFFREY B TRS 9109 LAWTON PINE AVE LAS VEGAS NV 89129-7047	13808222020

15✓

**Report of All Selected Parcels****Case Number:**

VAR-65234 (PRJ-65178)

**Printed On:** Wed: September 7, 2016

<u>Owner</u>	<u>Address</u>	<u>Parcel Number</u>
BOYD F C TRUST	BOYD F C TRS 9091 BAYSINGER DR LAS VEGAS NV 89129-7001	13808216019
BOYLE RHONDA A	8972 BRACKEN CLIFF CT LAS VEGAS NV 89129-3648	13808212011
BRADLEY DEBRA	9160 BUCKSPRINGS DR LAS VEGAS NV 89129-6399	13808321001
BRASIER KAREN E	8932 SAILPLANE AVE LAS VEGAS NV 89129-7031	13808217009
BRASS KENNETH G & LENA M	8978 SIDEBROOK CT LAS VEGAS NV 89129-7035	13808218024
BRAUN CHARLES M & CINDY A	9101 DIAMOND LAKE AVE LAS VEGAS NV 89129-7064	13808113024
BROWN FAMILY TRUST	BROWN HONGYING & WILLIAM J TRS 19212 SLEEPING OAK DR TRABUCO CANYON CA 92679	13808210020
BROWN JIMMY DALE JR	9128 JEWEL CRYSTAL CT LAS VEGAS NV 89129-6100	13808320031
BRUCKNER SUSAN M	9093 CLARETTA DR LAS VEGAS NV 89129-7007	13808215020
BUCKNER 2008 TRUST	BUCKNER KENNETH L & SANDRA L TRS 3625 FOX HEATHER DR LAS VEGAS NV 89129-7034	13808221001
BULICA DARIUS S	3704 N CAMPBELL RD LAS VEGAS NV 89129-7026	13808218012
BURK DANIEL I & MARTHA J FAM TR	BURK DANIEL I & MARTHA J TRS 9104 SONGWOOD CT LAS VEGAS NV 89129-7050	13808221019
BURKE PATRICK M & JANE M	3713 DORRINGTON DR LAS VEGAS NV 89129	13808222031
BURNS DAVID & DAWN TRUST	BURNS DAVID E & R DAWN TRS 9108 SONGWOOD CT LAS VEGAS NV 89129-7050	13808221029
BURRUS FAMILY TRUST	4261 MCKINNON DR SAN JOSE ca 95130	13808220006
BUSTAMANTE FAMILY TRUST	BUSTAMANTE DAVID A & C L TRS 3732 DORRINGTON DR LAS VEGAS NV 89129-7052	13808222009
BUXTON BOYD LIVING TRUST	BUXTON BOYD R & SUZANNE B TRS 8953 HILLSBORO CREEK CT LAS VEGAS NV 89129-3645	13808211007
C A H 2014-2 BORROWER L L C	8665 E HARTFORD DR #200 SCOTTSDALE AZ 85255	13808317002
C A H 2015-1 BORROWER L L C	8665 E HARTFORD DR #200 SCOTTSDALE AZ 85255	13808222034
C A H 2015-1 BORROWER L L C	8665 E HARTFORD DR #200 SCOTTSDALE AZ 85255	13808211006
C A H 2015-1 BORROWER L L C	8665 E HARTFORD DR #200 SCOTTSDALE AZ 85255	13808211019
CABAJ ZBIGNIEW & MARIA FAMILY TR	12997 PIPLO CT SAN DIEGO CA 92129-3561	13808218020
CABALLERO REMEDIOS R LIVING TR	CABALLERO REMEDIOS R TRS 26 PRINCEVILLE LN LAS VEGAS NV 89113-1345	13808211020
CALIMA MAIRA MAE & ERIC	9039 LEISURE SPRINGS DR LAS VEGAS NV 89129-6371	13808317055
CAMMY INVESTMENTS INC	3525 DEL MAR HEIGHTS RD #758 SAN DIEGO CA 92130	13808316007
CAMPOS MARIA CELAYA	3728 N CAMPBELL RD LAS VEGAS NV 89129-7029	13808218018
CANZONA RICHARD A & SUSAN L	9044 LEISURE SPRINGS DR LAS VEGAS NV 89129-6370	13808317031
CARDONA JAVIER & MARISELA	1565 W BROOKS AVE NORTH LAS VEGAS NV 89032-3830	13808316008
CARPENTER DARBY & JOVITA M	3700 FISHERKING DR LAS VEGAS NV 89129-7049	13808221026
CARR BARBARA J	3717 N CAMPBELL RD LAS VEGAS NV 89129-7028	13808218008
CARTER THOMAS B JR & ALICE C	9144 BAYSINGER DR LAS VEGAS NV 89129-7003	13808220009
CASADEI ROBERT & PEARL	9101 LAWTON PINE AVE LAS VEGAS NV 89129-7047	13808222036

**Report of All Selected Parcels****Case Number:**

VAR-65234 (PRJ-65178)

**Printed On:** Wed: September 7, 2016

<u>Owner</u>	<u>Address</u>	<u>Parcel Number</u>
CASH COLTON	385 N CAMPBELL RD LAS VEGAS NV 89129	13808316002
CASIMIRO ARTURO C & ESTHER B	3716 RIVER CANYON RD LAS VEGAS NV 89129-3642	13808217015
CASINO ROBERT A III & BARBARA L	3713 TREASURE BLUFF CT LAS VEGAS NV 89129-7033	13808217017
CASTELLANI PAUL S & KAREN E	3645 N CAMPBELL RD LAS VEGAS NV 89129-7019	13808210005
CASTELLINO REVOCABLE LIVING TR	CASTELLINO MIKE & DONNA MTRS 3675 N CAMPBELL RD LAS VEGAS NV 89129-7019	13808210008
CATO EARL F & YU C	9112 BAYSINGER DR LAS VEGAS NV 89129-7003	13808216002
CAUTHREN NANCY L	PANGELINAN JULIE A 8936 SAILPLANE AVE LAS VEGAS NV 89129-7031	13808217010
CHAVEZ BRANDON L & YARELI A	8912 SAILPLANE AVE LAS VEGAS NV 89129	13808217004
CHAVEZ DEBORAH	3717 RIVER CANYON RD LAS VEGAS NV 89129-3643	13808217014
CIBOROWSKI GEORGE D & RITA A	3581 MOUNTAIN VALLEY DR LAS VEGAS NV 89129-6386	13808317003
CITY OF LAS VEGAS	333 N RANCHO DR 8TH FLR LAS VEGAS NV 89106	13808222012
CITY OF LAS VEGAS	495 S MAIN ST 6TH FL LAS VEGAS NV 89101-6318	13808317041
CLABEAUX MURLE D	3682 RIVER CANYON RD LAS VEGAS NV 89129-3641	13808211022
CLARK NANCY	3700 N CAMPBELL RD LAS VEGAS NV 89129-7026	13808218011
CLONINGER DANIEL	GRAYE JAENE 9045 GRAY BLUFF DR LAS VEGAS NV 89129-7022	13808214009
COBLE JAMES RONALD II & KELLE S	1100 SUPERIOR AVE #200 CLEVELAND OH 44114	13808210013
COLE CAROLYN MARY REV FAM TR	COLE CAROLYN MARY TRS 9075 GRAY BLUFF DR LAS VEGAS NV 89129-7022	13808214006
COLLINS GARY DON	9074 CLARETTA DR LAS VEGAS NV 89129-7006	13808215007
COMBS APRIL M	KRAMER FREDERICK J 3708 DEER FLATS ST LAS VEGAS NV 89129-7042	13808223020
CORONNA JOSEPH	29 E MAIN ST #2 BAY SHORE NY 11706-8304	13808317006
CORWIN TRUST	CORWIN CLUAYNNE M TRS 3708 PLUM BLOSSOM CT LAS VEGAS NV 89129-7051	13808223039
COX MATHIAS	9094 GRAY BLUFF DR LAS VEGAS NV 89129	13808221009
CRAWFORD RANDOLPH D & JOAN G	9073 CLARETTA DR LAS VEGAS NV 89129-7007	13808215018
CRISAN LUCIAN AMORE & CRISTINA	9132 LAWTON PINE AVE LAS VEGAS NV 89129-7048	13808223003
CROSS KAREN L & RICHARD T	9109 SONGWOOD CT LAS VEGAS NV 89129-7050	13808221013
CUGINI ROBERT W & JO ANN M	3625 N CAMPBELL RD LAS VEGAS NV 89129-7019	13808210003
CUNG DAVID V	8962 BRACKEN CLIFF CT LAS VEGAS NV 89129-3648	13808212010
DAULAT SARITA SEPARATE PPTY TR	DAULAT SARITA TRS 39 DRIFTING SHADOW WAY LAS VEGAS NV 89135-7879	13808223017
DAVIDSON STEVEN E & ELIZABETH K	9084 CLARETTA DR LAS VEGAS NV 89129-7006	13808215006
DAWSON VANDERBILT JR & GAIL M	3733 N CAMPBELL RD LAS VEGAS NV 89129-7028	13808218004
DEAL LIVING TRUST	DEAL CHRISTOPHER MICHAEL TRS 3629 FOX HEATHER DR LAS VEGAS NV 89129-7034	13808221002
DEAN CHRISTOPHER H & CAROL HELEN	4205 H ST RD BLAINE WA 98230-9228	13808210015

**Report of All Selected Parcels****Case Number:**

VAR-65234 (PRJ-65178)

**Printed On:** Wed: September 7, 2016

<u>Owner</u>	<u>Address</u>	<u>Parcel Number</u>
DEISS DONNA R	DEISS WILLIS A & DOROTHY R 8939 DOVE COVE DR LAS VEGAS NV 89129-6342	13808311016
DELROSARIO FRANCISCO & JEANNETTE	3708 FISHERKING DR LAS VEGAS NV 89129-7049	13808221024
DENIRO CARRI ELIZABETH	3656 DORRINGTON DR LAS VEGAS NV 89129	13808215013
DINULOS FAMILY REVOCABLE LIVING	DINULOS ERIC & ROSARIE TRS 9060 LEISURE SPRINGS DR LAS VEGAS NV 89129-6370	13808317033
DISTASO MARK W	4403 PELONA CANYON RD ACTON CA 93510	13808220007
DOUCET BRITTANY	3548 SUMMERSPRINGS DR LAS VEGAS NV 89129-6396	13808320012
DUNWAY LORI M	3621 DEER FLATS ST LAS VEGAS NV 89129-7037	13808220025
EFFINGER MICHAEL R & KATHRYN A	9028 LEISURE SPRINGS DR LAS VEGAS NV 89129-6370	13808317029
EGENSE PATRICK JOHN TRUST	EGENSE PATRICK JOHN TRS 9044 CLARETTA DR LAS VEGAS NV 89129-7006	13808215010
EICHBERGER STEVEN M	3724 PLUM BLOSSOM CT LAS VEGAS NV 89129-7051	13808223044
EL CAPITAN PROPERTIES L L C	4180 S PECOS RD #175 LAS VEGAS NV 89121-5076	13808202002
ERICKSON FAMILY REVOCABLE TRUST	ERICKSON CLARENCE JR & S TRS 9109 DIAMOND LAKE AVE LAS VEGAS NV 89129-7064	13808113026
ESCOBEDO JOSE N	9017 GRAY BLUFF DR LAS VEGAS NV 89129-7022	13808214011
ESTENOZ JORGE ROVIROSA	9137 BUCKSPRINGS DR LAS VEGAS NV 89129-6398	13808320033
ESTRADA JOEL	3583 WHITE DIAMOND DR LAS VEGAS NV 89129	13808310035
EVANS MARCIA JOHNSON FAMILY TR	EVANS MARCIA J TRS 8971 FORT CRESTWOOD DR LAS VEGAS NV 89129-3639	13808210014
FAGIANO RICHARD C & DARLENE G	9084 GRAY BLUFF DR LAS VEGAS NV 89129-7021	13808221010
FAJARDO LUIS	8933 BRACKEN CLIFF CT LAS VEGAS NV 89129	13808212018
FAUERBACH GEORGE & KATHLEEN	9122 BAYSINGER DR LAS VEGAS NV 89129-7003	13808216001
FEBRE TIFFANY	9104 GRAY BLUFF DR LAS VEGAS NV 89129	13808221008
FELICIANO EVELYN	9080 LAWTON PINE AVE LAS VEGAS NV 89129-7044	13808222016
FERNANDEZ CAROLINE	254 W ASH AVE #104 BURBANK CA 91502-2470	13808310008
FERO IAN J & DOROTHY	3724 N CAMPBELL RD LAS VEGAS NV 89129-7029	13808218017
FISHER-STARK TAUNIA	8940 SAILPLANE AVE LAS VEGAS NV 89129-7031	13808217011
FITZLAFF TERRY M LIVING TRUST	FITZLAFF TERRY M TRS 716 BLORKA ST #B SITKA AK 99835-7632	13808310027
FITZPATRICK KENNETH A & DARLENE	3654 N CAMPBELL RD LAS VEGAS NV 89129-7018	13808210016
FITZPATRICK MICHELLE L	FITZPATRICK MICHELLE T 9132 GRAY BLUFF DR LAS VEGAS NV 89129-7024	13808221005
FLAXA REVOCABLE FAMILY TRUST	FLAXA WILLIAM LEE & HAZEL M TRS P O BOX 35576 LAS VEGAS NV 89133-5576	13808214008
FORNEY LIVING TRUST	FORNEY SCOTT D & KENDRA TRS 8922 BRACKEN CLIFF CT LAS VEGAS NV 89129-3647	13808212006
FOWLER PATRICIA C	3721 PLUM BLOSSOM CT LAS VEGAS NV 89129-7051	13808223027
FOX WILLIAM	DREYFUSS TERESA P O BOX 1628 SIERRA MADRE CA 91025-4628	13808223021
FRANKLIN SIDNEY J SR & DEBORAH E	8981 HILLSBORO CREEK CT LAS VEGAS NV 89129-3645	13808211004

**Report of All Selected Parcels**Case Number:

VAR-65234 (PRJ-65178)

Printed On: Wed: September 7, 2016

<u>Owner</u>	<u>Address</u>	<u>Parcel Number</u>
FREDERICKS ELIZABETH S	9042 BAYSINGER DR LAS VEGAS NV 89129-7000	13808216009
GABEL REX E	3634 N CAMPBELL LAS VEGAS NV 89129-7018	13808210018
GAINES MARY J IRREVOCABLE TRUST	GAINES JACQUELINE M TRS 609 COLUMBUS AVE NEW YORK NY 10024	13808220023
GARCIA BERNARD	9143 BUCKSPRINGS LAS VEGAS NV 89129-6398	13808320034
GARCIA EFRAIN ROBLES	ROBLES ANGELICA URIBE 3729 DORRINGTON DR LAS VEGAS NV 89129	13808222027
GARCIA GABRIELA	3709 PLUM BLOSSOM CT LAS VEGAS NV 89129-7051	13808223047
GARCIA ROGUE & SUSANA I	3712 TREASURE BLUFF CT LAS VEGAS NV 89129-7033	13808217024
GEORGES LORI JEAN SEP PPTY TR	GEORGES LORI JEAN TRS 9052 BAYSINGER DR LAS VEGAS NV 89129-7000	13808216008
GIFFORD MICHAEL	9068 LEISURE SPRINGS DR LAS VEGAS NV 89129	13808317034
GIL SANDRA	9055 SUNPINE CT LAS VEGAS NV 89129-6388	13808317049
GILLESPIE WAVY C JR & ELAINE E	3572 SUMMERSPRINGS DR LAS VEGAS NV 89129-6396	13808320008
GILLSON KIMBERLY D	9129 BAYSINGER DR LAS VEGAS NV 89129	13808220014
GIPSON ROBERT L	9064 SUNPINE CT LAS VEGAS NV 89129-6387	13808317051
GLASPER FRANDA CAROL	8953 BRACKEN CLIFF CT LAS VEGAS NV 89129-3649	13808212016
GONZALES ROBERT B & YSABLE J	8982 BRACKEN CLIFF CT LAS VEGAS NV 89129	13808212012
GOODHART PHILIP	4940 HAYRIDE ST LAS VEGAS NV 89149-4758	13808211014
GORUM GEORGE W & LISA L	9155 BUCKSPRINGS DR LAS VEGAS NV 89129-6398	13808320036
GRAYSON JOSEPH L	COLEMAN-GRAYSON PATRICE M 9056 LAWTON PINE AVE LAS VEGAS NV 89129-7044	13808222013
GRBAV DOMINIC & MARIA	8994 FORT CRESTWOOD DR LAS VEGAS NV 89129-3640	13808210009
GULEWICH CHERYL	9116 LAWTON PINE AVE LAS VEGAS NV 89129-7048	13808223001
GUSTAFSON FAMILY TRUST	8941 SAILPLANE AVE LAS VEGAS NV 89129-7032	13808217012
HAMILTON JAMES C & CAROL A	9124 GRAY BLUFF DR LAS VEGAS NV 89129-7024	13808221006
HANEY JOHN	8944 DOVE COVE DR LAS VEGAS NV 89129-6340	13808311014
HANSEN STEPHEN F & DELORES A	8728 CASTLE VIEW AVE LAS VEGAS NV 89129	13808210017
HASKETT ROBIN N & KAREEM W A	3576 INDIAN ROCK RD SW ATLANTA GA 30331	13808223013
HASSE FAMILY TRUST	HASSE GEORGE W & ELISA M TRS 3728 DEER FLATS ST LAS VEGAS NV 89129	13808223025
HEATON ROY & BARBARA TRUST	HEATON ROY A & BARBARA J TRS 3700 DEER FLATS ST LAS VEGAS NV 89129-7054	13808223018
HERMANSON NOEL C & KELLY	3704 DEER FLATS ST LAS VEGAS NV 89129-7042	13808223019
HERNANDEZ JESUS S	HERNANDEZ MIGUEL & CARMEN 9100 SONGWOOD CT LAS VEGAS NV 89129	13808221020
HERNANDEZ JULIO CESAR & MARIA J	3555 WHITE DIAMOND DR LAS VEGAS NV 89129	13808310026
HERNANDEZ MARIA	3547 WHITE DIAMOND DR LAS VEGAS NV 89129-6303	13808310025
HINCAPIE HERMAN & CLAUDIA E	3716 FISHERKING DR LAS VEGAS NV 89129-7049	13808221022

**Report of All Selected Parcels****Case Number:**

VAR-65234 (PRJ-65178)

**Printed On:** Wed: September 7, 2016

<u>Owner</u>	<u>Address</u>	<u>Parcel Number</u>
HINKLE JR LIVING TRUST	HINKLE JAMES O JR & JEAN A TRS 3716 N CAMPBELL RD LAS VEGAS NV 89129-7026	13808218015
HOFFMAN JOHN D SR & CORENA S	8963 DOVE COVE DR LAS VEGAS NV 89129-6343	13808310011
HOLLENBECK PAUL L	SANCHEZ-HOLLENBECK CONNIE M P O BOX 570366 LAS VEGAS NV 89157-0366	13808222004
HOLMES JIM & LINDA TRUST	HOLMES JAMES H & LINDA M TRS 9111 CLARETTA DR LAS VEGAS NV 89129-7011	13808215022
HOOSHIDAR MEHRZAD	3575 WHITE DIAMOND DR LAS VEGAS NV 89129-6303	13808310037
HOYT MERLYN HAROLD & CAROL L	8995 SIDEBROOK CT LAS VEGAS NV 89129-7035	13808218019
HUNTLY MATTHEW D & ELIZABETH L	3716 PLUM BLOSSOM CT LAS VEGAS NV 89129-7051	13808223050
J M A LIVING TRUST	ALSUP JEANE MAE TRS 9047 LEISURE SPRINGS DR LAS VEGAS NV 89129-6371	13808317056
JAMESON JOHANNES JR	9073 LAWTON PINE AVE LAS VEGAS NV 89129-7045	13808222024
JOHNSON NAOMI F REVOCABLE LIV TR	JOHNSON NAOMI F TRS 9094 CLARETTA DR LAS VEGAS NV 89129-7006	13808215005
JOHNSTON JOSHUA J	8885 PERFECT DIAMOND CT LAS VEGAS NV 89124	13808215014
JOHONNOT GERALD & CHERYL	8982 SIDEBROOK CT LAS VEGAS NV 89129-7035	13808218025
JORDAN CESAR	MORALES PAOLO CESAR JORDAN 3579 N CAMPBELL RD LAS VEGAS NV 89129-6196	13808316003
JORGENSEN GREG S & DESIREE D	3713 PLUM BLOSSOM CT LAS VEGAS NV 89129-7051	13808223046
K M MANAGEMENT GROUP L L C	3535 INLAND EMPIRE BLVD ONTARIO CA 91764	13808216021
KAAL-QUALLS JANET N	QUALLS GREG 8970 HILLSBORO CREEK CT LAS VEGAS NV 89129-3644	13808211002
KABILING NYLMA M & HIX S	9053 CLARETTA DR LAS VEGAS NV 89129-7007	13808215016
KANSKY RICHARD G	3548 N CAMPBELL RD LAS VEGAS NV 89129-6193	13808310028
KAPLAN TERRY S & KAREN EFRON	P O BOX 8119 NORTHRIDGE CA 91327-8119	13808214010
KARI MATTHEW & SHERRIE	4811 VIA FRONDOSO YORBA LINDA CA 92886-3026	13808215015
KELLY TERRANCE M & SULLY TRUST	KELLY TERRANCE M & SULLY TRS 9082 BAYSINGER DR LAS VEGAS NV 89129-7000	13808216005
KIDO GLENN	9158 BUCKSPRINGS DR LAS VEGAS NV 89129-6399	13808320001
KINGSTON RONALD R SR	8936 DOVE COVE DR LAS VEGAS NV 89129-6340	13808311013
KNOX NELSON O	3705 PLUM BLOSSOM CT LAS VEGAS NV 89129-7051	13808223048
KOCEJA VICKI A REVOCABLE TRUST	KOCEJA VICKI A TRS 8937 SAILPLANE AVE LAS VEGAS NV 89129	13808217013
KODWEIS GREGORY P & COLLEEN C	9124 LAWTON PINE AVE LAS VEGAS NV 89129-7048	13808223002
KOHISTANI SINA	9149 BAYSINGER DR LAS VEGAS NV 89129-7005	13808220019
KOLANOWSKI JAMES S & ANN M	9051 BAYSINGER DR LAS VEGAS NV 89129-7001	13808216015
KOPACZ ROBERT	3800 DIAMOND RIDGE ST LAS VEGAS NV 89129-7060	13808113080
KOST JUDITH E	3560 SUMMERSPRINGS DR LAS VEGAS NV 89129-6396	13808320010
KOSTIV VERONICA M REVOCABLE TR	KOSTIV VERONICA M TRS 9076 LEISURE SPRINGS DR LAS VEGAS NV 89129-6370	13808317035
KOZAL GARY A	MAXWELL TONI L 3724 FISHERKING DR LAS VEGAS NV 89129-7049	13808222025

**Report of All Selected Parcels****Case Number:**

VAR-65234 (PRJ-65178)

**Printed On:** Wed: September 7, 2016

<u>Owner</u>	<u>Address</u>	<u>Parcel Numbe</u>
KUSAR JERRY S LIVING TRUST	KUSAR JERRY S TRS 3708 TREASURE BLUFF CT LAS VEGAS NV 89129-7033	13808217023
LALLY FAMILY TRUST	LALLY MICHAEL J & BONNIE T TRS 9112 SONGWOOD CT LAS VEGAS NV 89129-7050	13808221028
LANDAZ ELPIDIO S & TESSIE S	8987 SIDEBROOK CT LAS VEGAS NV 89129-7035	13808218021
LARA JOSEPH R & SUZANNE M	3712 RIVER CANYON RD LAS VEGAS NV 89129-3642	13808211025
LARKINS THEODORE S & AVELINA	3808 DIAMOND RIDGE ST LAS VEGAS NV 89129-7060	13808113078
LATHAM FAMILY TRUST	LATHAM R KEITH & EVELYN TRS 3540 TOBEL SPRINGS DR LAS VEGAS NV 89129-6373	13808317022
LAUER CHARLES W & MONICA L	9124 CLARETTA DR LAS VEGAS NV 89129-7010	13808215002
LAWRENCE CAROLYN M & CHARLES C	5512 IVY SIDE AVE LAS VEGAS NV 89131-3689	13808317025
LAZAREVICH SASHA & ALMA D	8979 SIDEBROOK CT LAS VEGAS NV 89129-7035	13808218023
LAZZAROTTO JACK & S REV TR AGMT	LAZZAROTTO JACK V & S CO-TRS 8942 BRACKEN CLIFF CT LAS VEGAS NV 89129-3647	13808212008
LEE ANH	LAM DAVID 20400 HIAWATHA ST CHATSWORTH CA 91311-2565	13808317024
LEE ROSELANI C REVOCABLE LIV TR	LEE ROSELANI C TRS 9136 BAYSINGER DR LAS VEGAS NV 89129-7003	13808220011
LENSING KATHARINE E	3635 N CAMPBELL RD LAS VEGAS NV 89129-7019	13808210004
LETUS JOHN A & STEVEN J	3712 FISHERKING DR LAS VEGAS NV 89129-7049	13808221023
LEVEILLE FAMILY JOINT LIVING TR	8896 FORT CRESTWOOD DR LAS VEGAS NV 89129-3636	13808211017
LEVOYER WITHER A & HOLLY J	9149 BUCKSPRINGS DR LAS VEGAS NV 89129-6398	13808320035
LEWIS TYLER E	9063 CLARETTA DR LAS VEGAS NV 89129	13808215017
LEYVA BENJAMIN JR & VERONICA	3725 DEER FLATS ST LAS VEGAS NV 89129	13808223011
LIMONGI ALEJANDRO	3720 DEER FLATS ST LAS VEGAS NV 89129-7042	13808223023
LINDQUIST FAMILY TRUST	LINDQUIST ROBERT E & KAREN A TRS 3605 DEER FLATS ST LAS VEGAS NV 89129-7037	13808220021
LIPKOWITZ PAUL J & JULIA H	9048 SUNPINE CT LAS VEGAS NV 89129-6387	13808317053
LIVINGSTON DAVID J & YVETTE M	9114 BUCKSPRINGS DR LAS VEGAS NV 89129-6397	13808320006
LOERA-RENTERIA FRANCISCO J	LOERA MARIA 17596 MORGAN COUNTY RD Q 8 FORTH MORGAN CO 80701	13808310001
LONG MONIQUE M LIVING TRUST	LONG MONIQUE M TRS 9123 CLARETTA DR LAS VEGAS NV 89129-7011	13808215023
LONG WILLIAM & CATHRINE A	9072 LAWTON PINE AVE LAS VEGAS NV 89129	13808222015
LOOSE ALFRED	3712 N CAMPBELL RD LAS VEGAS NV 89129-7026	13808218014
LOPEZ BENJAMIN S & MARIA A	3700 DORRINGTON DR LAS VEGAS NV 89129-7038	13808222001
LUCAS STEPHEN D	3709 RIVER CANYON RD LAS VEGAS NV 89129-3643	13808211001
LUCKY RENTAL'S L L C	145 E HARMON AVE #86 LAS VEGAS NV 89109-4511	13808223015
LUIS AURELIANO	9131 BUCKSPRINGS DR LAS VEGAS NV 89129-6398	13808320032
MADDEN WILLIAM C & JUDY	9031 BAYSINGER DR LAS VEGAS NV 89129-7001	13808216013
MAI YEN T	3588 TOBEL SPRINGS DR LAS VEGAS NV 89129-6373	13808317028

**Report of All Selected Parcels****Case Number:**

VAR-65234 (PRJ-65178)

**Printed On:** Wed: September 7, 2016

<u>Owner</u>	<u>Address</u>	<u>Parcel Number</u>
MARINI CHRISTOPHER & JENNIFER	7575 W WASHINGTON AVE #127-177 LAS VEGAS NV 89128-4333	13808310009
MARQUEZ JUAN I & ESTELA	9052 LEISURE SPRINGS DR LAS VEGAS NV 89129-6370	13808317032
MARTIN JACK & TONDA	3717 PLUM BLOSSOM CT LAS VEGAS NV 89129-7051	13808223045
MARTIN TAMARA L	3724 DEER FLATS ST LAS VEGAS NV 89129-7042	13808223024
MARTINEZ FRANSICO JR	8962 NORCO DR LAS VEGAS NV 89129-6307	13808310012
MARTINEZ JESUS	8968 DOVE COVE DR LAS VEGAS NV 89129-6341	13808310007
MAST FREDERICK J & AMY L	9072 BAYSINGER DR LAS VEGAS NV 89129-7000	13808216006
MASULA MICHAEL & CAROLE A	9116 GRAY BLUFF DR LAS VEGAS NV 89129-7024	13808221007
MATHEWS DASIL & KATHLEEN FAM TR	MATHEWS DASIL G TRS 3626 DORRINGTON DR LAS VEGAS NV 89129-7020	13808216011
MATHEWS MICHAEL S & DANA M	9114 CLARETTA DR LAS VEGAS NV 89129-7010	13808215003
MCCLAIN GREGORY & CHERYL	9131 GRAY BLUFF DR LAS VEGAS NV 89129-7025	13808214001
MCDOWELL TAMARA LYNN	9105 SONGWOOD CT LAS VEGAS NV 89129-7050	13808221012
MCK HEALTHY ENVIRONMENT INTL INC	450 W NORMAN AVE ARCADIA CA 91007-7915	13808317039
MCMANUS PARKER R & CONCETTA	8976 DOVE COVE DR LAS VEGAS NV 89129-6341	13808310006
MEDINA ADRIANA	9092 BAYSINGER DR LAS VEGAS NV 89129	13808216004
MESSINGER JUDITH A LIVING TRUST	SMITH PATRICIA KAY TRS 8954 NORCO DR LAS VEGAS NV 89129	13808310013
MICALLEF ANTHONY & PATRICIA	16639 FIVE POINTS ST REDFORD MI 48240	13808321002
MILADINOV MILADIN	1925 VILLAGE CENTER CIR #150 LAS VEGAS NV 89134	13808317023
MILLER DAVID V & DIANA W	3616 DORRINGTON DR LAS VEGAS NV 89129-7020	13808216012
MONTERO ALFREDO XAVIER	9168 BUCKSPRINGS DR LAS VEGAS NV 89129-6104	13808321003
MOORE TRACY S	9055 LEISURE SPRINGS DR LAS VEGAS NV 89129	13808317057
MOSER URSULA S	9105 GRAY BLUFF DR LAS VEGAS NV 89129-7025	13808214003
MOYA LEO & JESSICA L	9103 CLARETTA DR LAS VEGAS NV 89129	13808215021
MUELLER MARLIN M & KAREN S	3601 DEER FLATS ST LAS VEGAS NV 89129-7037	13808220020
MUELLER RANDALL HOWARD & SUSAN	9145 BAYSINGER DR LAS VEGAS NV 89129-7005	13808220018
MURATA CURTIS S	FIGUEROA-MURATA MAGALI 9141 BAYSINGER DR LAS VEGAS NV 89129-7005	13808220017
MURRAY THOMAS J & ANNE	9100 LAWTON PINE AVE LAS VEGAS NV 89129-7046	13808222035
MURZINSKI FRANK & AMY	8963 BRACKEN CLIFF CT LAS VEGAS NV 89129	13808212015
NARO MARK	CARSON TANIA P O BOX 3544 ALBUQUERQUE NM 87190-3544	13808214005
NARTKER KAROLYN	9132 BUCKSPRINGS DR LAS VEGAS NV 89129-6397	13808320004
NAVA SERGIO & RUTH	9081 BAYSINGER DR LAS VEGAS NV 89129-7001	13808216018
NEGRIN FAMILY TRUST	NEGRIN ESTHER C TRS 3729 DEER FLATS ST LAS VEGAS NV 89129-7043	13808223010

**Report of All Selected Parcels****Case Number:**

VAR-65234 (PRJ-65178)

**Printed On:** Wed: September 7, 2016

<u>Owner</u>	<u>Address</u>	<u>Parcel Number</u>
NEOH KINGSTON & ERIKA	8983 BRACKEN CLIFF CT LAS VEGAS NV 89129-3650	13808212013
NGUYEN JUSTIN V	VO KIMUYEN 3624 DEER FLATS ST LAS VEGAS NV 89129-7036	13808220003
NHIM YUNNEAT FAMILY TRUST	NHIM YUNNEAT TRS 12338 CROWN CT CERRITOS CA 90703-7145	13808223038
NICKLES MARILYN JOAN	3676 DORRINGTON DR LAS VEGAS NV 89129-7020	13808215011
NICKUM CATHRYN ANN	3680 TOBEL SPRINGS DR LAS VEGAS NV 89129-6373	13808317027
NUNES ZITA LIVING TRUST	NUNES ZITA TRS 8916 SAILPLANE AVE LAS VEGAS NV 89129-7030	13808217005
OCHOA TRUST	OCHOA NICOLAS A & CARRIE TRS 3652 FLORADALE CT THOUSAND OAKS CA 91360-7038	13808317040
O'DONNELL FAMILY TRUST	O'DONNELL R J QUALIFIED RES TR 3664 DORRINGTON DR LAS VEGAS NV 89129-7020	13808215012
OGUREK ALFRED G & ROBIN L	3717 TREASURE BLUFF CT LAS VEGAS NV 89129-7033	13808217016
O'LEARY BRIAN & CLAUDIA	3584 N CAMPBELL RD LAS VEGAS NV 89129-6195	13808310002
ORF JOSEPH	3704 FISHERKING DR LAS VEGAS NV 89129-7049	13808221025
ORTH PEGGY LEE & ROBERT EARL	9156 LAWTON PINE AVE LAS VEGAS NV 89129-7048	13808223006
OSHITA NELSON K & SHARON K	3708 DORRINGTON DR LAS VEGAS NV 89129-7038	13808222003
OWENS WAYLON & ARIANE	9063 SUNPINE CT LAS VEGAS NV 89129	13808317050
PAGAN OSCAR & BASILISA	6317 COUCELLES PKWY COEUR D ALENE ID 83815-8327	13808214004
PARKER KEITH E & MELONY A	P O BOX 482233 KAUNAKAI HI 96748-2233	13808220028
PARTAIN RICKEY W & KIMBERLY J	8980 HILLSBORO CREEK CT LAS VEGAS NV 89129-3644	13808211003
PAULSON DAVID LEE REVOCABLE TR	PAULSON DAVID LEE TRS 9083 CLARETTA DR LAS VEGAS NV 89129-7007	13808215019
PAYNE PAULI A	9101 BAYSINGER DR LAS VEGAS NV 89129	13808216020
PENA MARIA C LIVING TRUST	PENA MARIA C TRS 1250 E TROPICANA AVE LAS VEGAS NV 89119	13808220010
PERCH THOMAS	3628 DEER FLATS ST LAS VEGAS NV 89129	13808218001
PERCH THOMAS M	3628 DEER FLATS ST LAS VEGAS NV 89129	13808220001
PERCH THOMAS M	3628 DEER FLATS ST LAS VEGAS NV 89129	13808210002
PERCH THOMAS M	3628 DEER FLATS ST LAS VEGAS NV 89129	13808220027
PERCH THOMAS M	3628 DEER FLATS ST LAS VEGAS NV 89129	13808218006
PERCH THOMAS M	3628 DEER FLATS ST LAS VEGAS NV 89129	13808210021
PERCH THOMAS M	3628 DEER FLATS ST LAS VEGAS NV 89129	13808220002
PEREZ BALLEEN F & PAULA R	3705 DEER FLATS ST LAS VEGAS NV 89129-7043	13808223016
PERNELL AARON L	9132 BAYSINGER DR LAS VEGAS NV 89129-7003	13808220012
PETRILLO PAUL R & NICOLE N	3560 MOUNTIAN VALLEY DR LAS VEGAS NV 89129	13808317038
PIONTEK PATRICK D & CLAUDIA	3716 TREASURE BLUFF CT LAS VEGAS NV 89129-7033	13808217025
PLASCH GREGGORY D	3728 DORRINGTON DR LAS VEGAS NV 89129-7052	13808222008

**Report of All Selected Parcels****Case Number:**

VAR-65234 (PRJ-65178)

**Printed On:** Wed: September 7, 2016

<u>Owner</u>	<u>Address</u>	<u>Parcel Number</u>
POLK MANFRED F	SHACKLEFORD-POLK CHERYL 9041 BAYSINGER DR LAS VEGAS NV 89129-7001	13808216014
PONZIO VINCENT A & BRENDA L	9062 BAYSINGER DR LAS VEGAS NV 89129-7000	13808216007
POOLE ROBERT J & LINDA A	8923 BRACKEN CLIFF CT LAS VEGAS NV 89129-3649	13808212019
PORTER 1995 TRUST	PORTER FRANK A & DORENE M TRS 3597 MOUNTAIN VALLEY DR LAS VEGAS NV 89129-6386	13808317001
PRICE KEVIN W & THERESA	5321 GREAT HORIZON DR LAS VEGAS NV 89149	13808215009
PROPERTY MANAGEMENT GROUP INC	17555 VENTURA BLVD #202 ENCINO CA 91316	13808310003
PULIDO ELSSY I	2524 ROSEWORTHY ST LAS VEGAS NV 89134-7330	13808311012
R C R PROPERTIES L L C	2837 TURTLE HEAD PEAK DR LAS VEGAS NV 89135-1643	13808218009
RANDALL KIM D	8955 DOVE COVE DR LAS VEGAS NV 89129-6343	13808310010
RANKIN FAMILY TRUST	RANKIN JAMES C & LISA D TRS 8921 FORT CRESTWOOD DR LAS VEGAS NV 89129-3638	13808211012
RANSOM & CARPI REV LIV TR	RANSOM LAWRENCE C III TRS 8954 FORT CRESTWOOD DR LAS VEGAS NV 89129-3640	13808211008
REID NYCOLE & ALEX	8943 BRACKEN CLIFF CT LAS VEGAS NV 89129-3649	13808212017
RICE PHYLLIS B	3624 N CAMPBELL RD LAS VEGAS NV 89129-7018	13808210019
RICHARDSON JUDITH LIVING TRUST	3720 PLUM BLOSSOM CT LAS VEGAS NV 89129-7051	13808223043
RILEY ANGELA	9164 LAWTON PINE AVE LAS VEGAS NV 89129-7048	13808223007
RILEY JOHN F	9102 BAYSINGER DR LAS VEGAS NV 89129-7002	13808216003
RIOS ALFONSO	8947 DOVE COVE DR LAS VEGAS NV 89129-6343	13808311015
RIOS KENNETH JR & CRYSTAL A	3053 W CRAIG RD #E-204 NORTH LAS VEGAS NV 89032-5124	13808215008
ROBERTS VINCENT DE PAUL	9115 GRAY BLUFF DR LAS VEGAS NV 89129	13808214002
RODRIGUES PATRICIA ACERBI	19200 NORDHOFF ST #1202 NORTHRIDGE CA 91324-5192	13808222019
RODRIGUEZ ANSELMO	VILLAGRAN MARIA 9134 JEWEL CRYSTAL CT LAS VEGAS NV 89129-6100	13808320030
ROMANS ROBERT J & JANICE FAM TR	ROMANS ROBERT J & JANICE S TRS 3636 DORRINGTON DR LAS VEGAS NV 89129-7020	13808216010
ROSA JAMES A & PATRICIA E	8920 SAILPLANE AVE LAS VEGAS NV 89129-7030	13808217006
RUSSA MOHAMMAD M & NAZIR M	9064 LAWTHON PINE DR LAS VEGAS NV 89129-7044	13808222014
S A S PROPERTY TRUST	ALI SHAHZAD TRS 8058 ELK MOUNTAIN ST LAS VEGAS NV 89113-4018	13808215024
S A W L L C	3801 N CAMPBELL RD LAS VEGAS NV 89129	13808101021
S A W L L C	3801 N CAMPBELL RD LAS VEGAS NV 89129	13808101030
SAGER ELAINE	11222 BIG DIPPER DR MIRA LOMA CA 91752-2112	13808317047
SAMMONS DONALD L	9040 LAWTON PINE AVE LAS VEGAS NV 89129-7044	13808222011
SANCHEZ IDALINA	9101 SONGWOOD CT LAS VEGAS NV 89129	13808221011
SANDERS MICHAEL H & TESSA M	3712 PLUM BLOSSOM CT LAS VEGAS NV 89129-7051	13808223040
SARATHCHANDRA D M G & JANAKI	2157 COAST AVE SAN MARCOS CA 92078-8402	13808320002

**Report of All Selected Parcels****Case Number:**

VAR-65234 (PRJ-65178)

**Printed On:** Wed: September 7, 2016

<u>Owner</u>	<u>Address</u>	<u>Parcel Number</u>
SAVINO ANNA	8973 BRACKEN CLIFF CT LAS VEGAS NV 89129-3650	13808212014
SCARBOROUGH FAMILY TRUST	3702 RIVER CANYON RD LAS VEGAS NV 89129	13808211024
SCHMIDT DARCY	9153 CLARETTA DR LAS VEGAS NV 89129	13808220008
SCHMIDT TROY ERICH	3580 SUMMERSPRINGS DR LAS VEGAS NV 89129-6396	13808320007
SCHUERMAN TRUST	SCHUERMAN HOWARD H & LYNETTE TRS 8906 FORT CRESTWOOD DR LAS VEGAS NV 89129-3637	13808211018
SCOVIL BRETT	9148 LAWTON PINE DR LAS VEGAS NV 89129-7048	13808223005
SEIFMAN FAMILY TRUST	SEIFMAN THOMAS M & COLLEEN M TRS 8986 SIDEBROOK CT LAS VEGAS NV 89129-7035	13808218026
SELMA ALEXANDER R	9047 SUNPINE CT LAS VEGAS NV 89129-6388	13808317048
SKRABANEK PATRICK	3729 N CAMPBELL RD LAS VEGAS NV 89129-7028	13808218005
SLAVIN FAMILY LIVING TRUST	SLAVIN STEVEN H & TERRI A TRS 3617 DEER FLATS ST LAS VEGAS NV 89129-7037	13808220024
SMITH ABRAHAM J IV	9063 LEISURE SPRINGS DR LAS VEGAS NV 89129	13808317058
SODERSTROM KEVIN	9040 SUNPINE CT LAS VEGAS NV 89129-6387	13808317054
SOLORZANO ADRIAN & CAROL T	3541 MOUNTAIN VALLEY DR LAS VEGAS NV 89129-6384	13808317008
SOUTHERN NV HOUSING AUTHORITY	340 N 11 ST #170 LAS VEGAS NV 89101-3125	13808320005
SPAFFORD-HUFFMAN FAM REV LIV TR	SPAFFORD VIRGINIA C TRS 3721 DEER FLATS ST LAS VEGAS NV 89129-7043	13808223012
SPECA PAUL R	9140 LAWTON PINE AVE LAS VEGAS NV 89129-7048	13808223004
SPIVEY ROSEMARY	SPIVEY CYNTHIA L & KENNETH A 9136 BUCKSPRINGS DR LAS VEGAS NV 89129-6397	13808320003
STAN MARZENA	3701 TREASURE BLUFF CT LAS VEGAS NV 89129-7033	13808217020
STANCIU PANTA & ANNA	3625 DEER FLATS ST LAS VEGAS NV 89129-7037	13808220026
STEPHENSON JEFFREY & DEBRA A	3658 MALLARDWOOD DR LAS VEGAS NV 89129-3646	13808211015
STEWART LIVING TRUST	STEWART JEAN TRS 8915 BRACKEN CLIFF CT LAS VEGAS NV 89129-3649	13808212020
STJOHN-BARRETT FAMILY REV LIV TR	STJOHN DAVID ADAMS TRS 3704 DORRINGTON DR LAS VEGAS NV 89129-7038	13808222002
STONE CHANDRA O	3540 N CAMPBELL RD LAS VEGAS NV 89129-6193	13808310029
STRATE ROY R & CHRISTINE E	8932 BRACKEN CLIFF CT LAS VEGAS NV 89129-3647	13808212007
SUTILA MARGARET I	3555 N CAMPBELL LAS VEGAS NV 89129-6194	13808316006
SWARTZ JANICE E LIVING TRUST	SWARTZ JANICE E TRS 3720 N CAMPBELL RD LAS VEGAS NV 89129-7029	13808218016
TAH 2015-1 BORROWER L L C	P O BOX 6660 FOLSOM CA 95763	13808317052
TAH 2015-1 BORROWER L L C	P O BOX 6660 FOLSOM CA 95763	13808317030
TAIBI KERRY R	3571 N CAMPBELL RD LAS VEGAS NV 89129-6196	13808316004
TARKHANYAN ARMEN	VARDANYAN ANGELA 7803 ALLOTT AVE PANAMA CITY CA 91402	13808222007
TELLER STEPHEN	HUDSON JOANN G 3725 PLUM BLOSSOM CT LAS VEGAS NV 89129	13808223026

**Report of All Selected Parcels****Case Number:**

VAR-65234 (PRJ-65178)

**Printed On:** Wed: September 7, 2016

<u>Owner</u>	<u>Address</u>	<u>Parcel Number</u>
TENORIO JOHN CHARLES	11811 156TH STREET CT E PUYALLUP WA 98374-9789	13808317007
TERRY LOUIS N & PATRICIA A	3716 DEER FLATS ST LAS VEGAS NV 89129-7042	13808223022
THELIN SHIRLEY J TRUST	THELIN SHIRLEY J TRS 9071 BAYSINGER DR LAS VEGAS NV 89129-7001	13808216017
THOMPSON R C & NORELIUS-T IRR TR	THOMPSON ROGER C TRS 3701 PLUM BLOSSOM CT LAS VEGAS NV 89129-7051	13808223049
THORPE KERRI ANNE	3700 TREASURE BLUFF CT LAS VEGAS NV 89129-7033	13808217021
TORRES ZORAIDA ESCALONA	3554 SUMMERSPRINGS DR LAS VEGAS NV 89129-6396	13808320011
UMBACH RICHARD J	3741 N CAMPBELL RD LAS VEGAS NV 89129-7028	13808218002
VALENZUELA CARLOS E & TRACEY Y	8974 FORT CRESTWOOD DR LAS VEGAS NV 89129-3640	13808210011
VATEV GEORGI V	ZUEVA-VATEV TATYANA T 3709 TREASURE BLUFF CT LAS VEGAS NV 89129-7033	13808217018
VELEZ ANGEL L JR	3565 MOUNTAIN VALLEY DR LAS VEGAS NV 89129-6386	13808317005
VERDEL FAMILY TRUST	VERDEL MICHIEL L M & LOUISE TRS 3804 TERRACE GROVE ST LAS VEGAS NV 89129-7828	13808222030
VEYNA ANNA E	3665 N CAMPBELL RD LAS VEGAS NV 89129-7019	13808210007
WALKER FAMILY REVOCABLE TRUST	8964 FORT CRESTWOOD DR LAS VEGAS NV 89129	13808210012
WALKER FRANCES M	3728 FISHERKING DR LAS VEGAS NV 89129-7049	13808222026
WALTER DAVID J TRUST	6789 CHIPMUNK DR NINEVEH IN 46164	13808222006
WARSO DAVID M & MILAGROS O	9128 BAYSINGER DR LAS VEGAS NV 89129-7003	13808220013
WASIAK JOSE L & WENDY ANN	3633 FOX HEATHER DR LAS VEGAS NV 89129-7034	13808221027
WAYBLE WILLIAM V & NANCY A	9113 SONGWOOD CT LAS VEGAS NV 89129	13808221014
WEAVER JOAN TRUST	WEAVER JOAN M TRS 9104 CLARETTA DR LAS VEGAS NV 89129-7008	13808215004
WEBER BRUCE & SUSAN	3704 TREASURE BLUFF CT LAS VEGAS NV 89129-7033	13808217022
WEBER BRUCE L & SUSAN M	WEBER PATRICIA S 3705 DORRINGTON DR LAS VEGAS NV 89129-7040	13808222033
WIGGS ALFRED & SUSAN	9007 GRAY BLUFF DR LAS VEGAS NV 89129-7022	13808214012
WIGGS ALFRED & SUSAN M	9007 GRAY BLUFF DR LAS VEGAS NV 89129-7022	13808218010
WILDRAIN JAKOB	JOHNSON DORAN JOHN REV LIV TR 3338 MISSION CREEK CT LAS VEGAS NV 89135-1837	13808212009
WILSON FAMILY TRUST	WILSON STEVEN DUANE & JAYME TRS 3692 RIVER CANYON RD LAS VEGAS NV 89129-3641	13808211023
WILSON RAYMOND E & MARZETTE M	9143 CLARETTA DR LAS VEGAS NV 89129-7011	13808215025
WISE CHRISTOPHER T	8994 SIDEBROOK CT LAS VEGAS NV 89129-7035	13808218027
WOMELDORFF DANIEL W	KIMMEL KELLY Y 3655 N CAMPBELL RD LAS VEGAS NV 89129-7019	13808210006
WRIGHT STANLEY	3498 FALCON RIDGE RD DIAMOND BAR CA 91765-3741	13808320013
WUERTZ JAMIE TRUST	WUERTZ JAMIE M TRS 9065 GRAY BLUFF DR LAS VEGAS NV 89129-7022	13808214007
XIE GUANJIN	604 N NEW AVE #K MONTEREY PARK CA 91755	13808216016
YAEGER CHARLES WILLIAM TRUST ETA	MARINO TRACY ANN TRS 3605 N CAMPBELL RD LAS VEGAS NV 89129-7019	13808210001

**Report of All Selected Parcels****Case Number:**

VAR-65234 (PRJ-65178)

**Printed On:** Wed: September 7, 2016**Owner**

YOCUM JAMES R & NANCY  
YOO BYUNG HO & MYONG SOON  
YUEN FAMILY REVOCABLE LIVING TR  
ZAITSEV ALEXANDER  
ZEMLYAK VALENTINA  
ZTREH PROPERTIES L L C  
ZUBEL ERIC & CATHERINE L

**Address**

8912 BRACKEN CLIFF CT LAS VEGAS NV 89129-3647  
1921 WASHINGTON AVE ANCHORAGE AK 99515  
YUEN STEPHEN K & ELLE M TRS 9247 W VIKING RD LAS VEGAS NV 89147-6852  
3721 DORRINGTON DR LAS VEGAS NV 89129  
17407 RAINBOW RIDGE CIR GRANADA HILLS CA 91344  
9212 GOLDEN EAGLE DR LAS VEGAS NV 89134-6162  
9134 CLARETTA DR LAS VEGAS NV 89129-7010

**Parcel Numbe**

13808212005  
13808211011  
13808317037  
13808222029  
13808222023  
13808311011  
13808215001