

S.r

City of Las Vegas
Office Of The City Clerk
495 South Main Street, 2nd Floor
Las Vegas, Nevada 89101

PRSRT STD
U.S. Postage
PAID
Las Vegas, NV
Permit No. 1630

Return Service Requested
Official Notice of Public Hearing

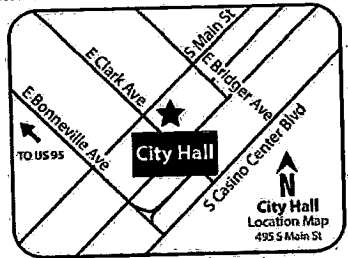

If you wish to file your protest or support on this request, check the appropriate box below and return this card in an envelope with postage to the Office Of The City Clerk at the address listed above or fax this side of this card to (702) 382-4803. If you would like to contact your Council Representative, please call (702) 229-6405.

I SUPPORT
this Request

I OPPOSE
this Request

Please use available blank space on card for your comments.

VAR-64887

City Council Meeting of 9/21/2016

Application Information

VAR-64887 - VARIANCE RELATED TO GPA-64884 AND ZON-64885 - PUBLIC HEARING - APPLICANT/OWNER: 7470, LLC - For possible action on a request for a Variance TO ALLOW A 40-FOOT RESIDENTIAL ADJACENCY SETBACK ALONG THE EAST PROPERTY LINE WHERE 72 FEET IS REQUIRED AND TO ALLOW A 56-FOOT RESIDENTIAL ADJACENCY SETBACK ALONG THE NORTH PROPERTY LINE WHERE 72 FEET IS REQUIRED on 5.19 acres at the northeast corner of Deer Springs Way and Hualapai Way (APN 125-19-202-006), Ward 6 (Ross) [PRJ-64757]. Staff recommends DENIAL. The Planning Commission (6-1 vote) recommends APPROVAL.

Application Location

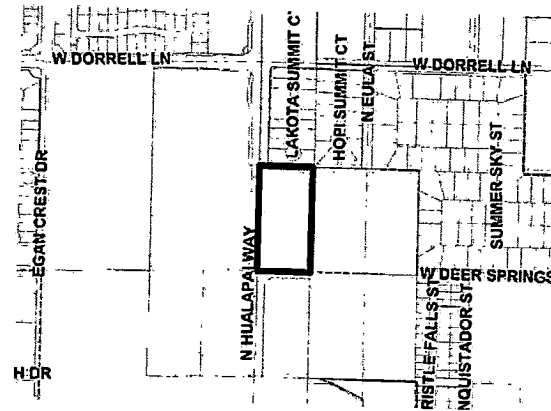

The proposed project may not pertain to the entire highlighted project site.

Public Hearing Information

Meeting: City Council
Date: *September 21, 2016*
Time: 1:00 P.M.
Location: City Council Chambers
495 South Main Street, 2nd Floor
Las Vegas, Nevada

Any and all interested persons may appear and be heard at said meeting, or may, prior thereto, file written objections thereto or approvals thereof with the City Clerk, 2nd Floor, City Hall, 495 South Main Street, Las Vegas, Nevada, 89101. For further information, please call (702) 229-6311 (TTY 7-1-1). Note that postcards and comments received after an agenda posts will not be reflected online until after the meeting; however, the comments are made available to the members of the governing body for their consideration prior to the meeting.

Report of All Selected Parcels**Case Number:**

VAR-64887

Printed On: Thu: August 25, 2016

<u>Owner</u>	<u>Address</u>	<u>Parcel Number</u>
1941 SEDONA PASEO TRUST	4933 W CRAIG RD #311 LAS VEGAS NV 89130-2730	13820615008
2015-1 I H 2 BORROWER L P	901 MAIN ST #4700 DALLAS TX 75202	13821212021
2132 FOUNTAIN VIEW L L C	2132 FOUNTAIN VIEW DR LAS VEGAS NV 89134-0317	13820610021
613 INVESTMENTS L L C	8350 W SAHARA AVE #210 LAS VEGAS NV 89117-8941	13820613083
8805 LUSSO L L C	1833 CORTA BELLA DR LAS VEGAS NV 89134	13820218007
8812 BONTA L L C	1833 CORTA BELLA DR LAS VEGAS NV 89134	13820313010
8821 BONTA COURT L L C	8821 BONTA CT LAS VEGAS NV 89134	13820313017
A B H FAMILY TRUST	8801 LUSSO CT LAS VEGAS NV 89134-6190	13820218006
A K C LIVING TRUST	CROTEAU ALBERT J III & KAREN TRS 8325 HOLLOW WHARF DR LAS VEGAS NV 89128-7428	13821212040
A M H ROMAN TWO N V L L C	30601 AGOURA RD #200 AGOURA HILLS CA 91301	13820518001
ABEAR PAUL & ANN	8332 HOLLOW WHARF DR LAS VEGAS NV 89128-7427	13821121007
ABULIEL SALEEM S & DIMITRA P	2021 PARADISE PEAK DR LAS VEGAS NV 89134-0309	13820612012
ADAMS ELBERT L CHAR RMNDR TR	ADAMS ELBERT L TRS 1508 THE STRAND MANHATTON BEACH CA 90266	13820614006
ADAMS ELBERT L CHAR RMNDR TR	ADAMS ELBERT L TRS 1508 THE STRAND MANHATTON BEACH CA 90266	13820614004
ADAMS LINDA KAREN	8313 SWAN LAKE AVE LAS VEGAS NV 89128-7415	13821118056
ADAMS MELISSA R	8717 WINTRY GARDEN AVE LAS VEGAS NV 89134-0350	13820610037
ADAMS STACY Y & ALICE F	8733 WINTRY GARDEN AVE LAS VEGAS NV 89134-0352	13820520053
ADAMSEN PATRICIA FAMILY TRUST	ADAMSEN ARNOLD A & PATRICIA TRS 8901 WINDSOR LOCKS AVE LAS VEGAS NV 89134-0379	13820217004
ADAMS-KEEFER FAMILY REVOCABLE LI	KEEFER KAREN NAYLOR TRS 8332 EMERALD ISLE AVE LAS VEGAS NV 89128-7500	13821215005
AFRAVI JAY J	2136 DRIFITNG CLOUD CIR LAS VEGAS NV 89134	13820520032
AG-ICC DEST TWO PUEBLO OWNER	245 PARK AVE 26TH FLR NEW YORK NY 10167	13820614014
AGNEW MICHELLE R & DANIEL S	8524 ESTRELITA DR LAS VEGAS NV 89128	13820714009
AHMAD AZIZ & LAURA	8813 VALLEY CREEK DR LAS VEGAS NV 89134-0372	13820710001
AHMED MAMUN	SHUMI MOUSHUMI R 2124 HILLSGATE ST LAS VEGAS NV 89134-0367	13820217020
AIMONE FAMILY TRUST	AIMONE ALAN C & BARBARA A TRS 2412 SUNUP DR LAS VEGAS NV 89134	13820517018
ALBERTO CYNTHIA M TRUST	SCHORGL CYNTHIA M TRS 2036 SEDONA CREEK CIR LAS VEGAS NV 89128-8215	13821210071
ALLEN CLEO D & AUDREY K LIV TR	ALLEN CLEO D & AUDREY K TRS 2101 BACHELOR CT LAS VEGAS NV 89128-7620	13821117028
ALLEN GEORGIA A	8209 EMERALD ISLE AVE LAS VEGAS NV 89128-7476	13821216027
ALLEN SUSAN	8340 CRETAN BLUE LN LAS VEGAS NV 89128-7469	13821212032
ALLEN TRUST 2000	ALLEN LARRY D & SALLY M CO-TRS 2012 SEDONA CREEK CIR LAS VEGAS NV 89128-8213	13821310001
ALLGOOD JODY & KATHERINE TRUST	ALLGOOD JODY W & KATHERINE TRS 8813 CORTILE DR LAS VEGAS NV 89134-6153	13820314014
ALLYSON'S SERIES III L L C	270 PLEASANT ST #324 WATERTOWN MA 02472	13820516001

Report of All Selected Parcels**Case Number:**

VAR-64887

Printed On: Thu: August 25, 2016

<u>Owner</u>	<u>Address</u>	<u>Parcel Number</u>
ALMEYDA-PEREZ JULIAN A	ALMEYDA YAMARYS 8612 ESTRELITA DR LAS VEGAS NV 89128-8232	13820714003
AMERIAN RONALD V & PRISCILLA J	8777 TULARE DR #410B HUNTINGTON BEACH CA 92646	13820516015
AMUNDSON PAUL G & ELIZABETH C	2136 FOUNTAIN VIEW DR LAS VEGAS NV 89134-0317	13820610022
ANAYA GABRIEL S & VIRGINIA P	8308 EMERALD ISLE AVE LAS VEGAS NV 89128-7478	13821215011
ANDERSON DOUGLAS EDWARD	2129 FOUNTAIN VIEW DR LAS VEGAS NV 89134-0319	13820610024
ANTONACCIO VICTOR	RODRIGUEZ MARIA 2020 WATERBURY LN LAS VEGAS NV 89134-0384	13820616015
AOKI CAROLEE M	TANAKA FUSAE TRS 3204 OLU ST HONOLULU HI 96816-1253	13820612009
APPLEBAUM PHYLLIS & HAROLD	APPLEBAUM JAY NORMAN 2408 DESERT GLEN DR LAS VEGAS NV 89134-8871	13820511002
ARADO SUSAN	8604 PALE MOON CT LAS VEGAS NV 89134-0356	13820610018
ARAKAWA SEISHIN & EDITH CHIDORI	ARAKAWA DENNIS SHIGERU TRS 8705 SUMMER RIDGE DR LAS VEGAS NV 89134-0324	13820613023
ARANTE OSCAR N & NELINA P	8349 HOLLOW WHARF DR LAS VEGAS NV 89128-7428	13821212034
ARANTE OSCAR N & NELINA P	2013 SEDONA CREEK CIR LAS VEGAS NV 89128-8214	13820615014
ARAUJO MARGARITA	8300 SEDONA SUNSET DR LAS VEGAS NV 89128-8474	13821210009
ARBABI-TEHRAN RUDY S	8348 BRITTANY HARBOR DR LAS VEGAS NV 89128-7492	13821215030
ARBUSTO JASON B & VIRGINE	8360 SHELTERED VALLEY DR LAS VEGAS NV 89128	13821117019
ARIES HOLDINGS L L C	413 CANYON GREENS DR LAS VEGAS NV 89144-0829	13820611006
ARSEN RONALD F & DEBORAH A	8808 CRESCENT RIDGE LN LAS VEGAS NV 89134-0304	13820613053
ARSHADNIA ELIYAHU	8321 BRITTANY HARBOR DR LAS VEGAS NV 89128	13821215048
ASATO SANDRA S LIVING TRUST	ASATO SANDRA S TRS 1236 8TH AVE HONOLULU HI 96816-2603	13820612001
ASHFORD CONSTANZA TRUST	ASHFORD CONSTANZA TRS 8805 BONTA CT LAS VEGAS NV 89134-6131	13820313013
AUGUSTA INVESTMENT MANAGEMENT L	2320 S POTOSI ST #130 LAS VEGAS NV 89146	13820713003
AUGUSTA INVESTMENT MGT LLC	2320 S POTOSI #130 LAS VEGAS NV 89146	13820713004
AUSTIN MARIA E	8704 SILVER MOUNTAIN CT LAS VEGAS NV 89134-0353	13820613027
AVERMAN LINDA	8608 ESTRELITA DR LAS VEGAS NV 89128-8232	13820714004
AVRANCHES L L C	41 CORPORATE PARK #250 IRVINE CA 92606-5179	13820522004
AVXHI BUJAR	8333 CRETAN BLUE LN LAS VEGAS NV 89128-7468	13821212011
BAILEY RICHARD & MARY TRUST	BAILEY RICHARD C & MARY F TRS 2112 WATERBURY LN LAS VEGAS NV 89134-0387	13820616010
BAILEY RICHARD C	2112 WATERBURY LN LAS VEGAS NV 89134-0387	13820613042
BAKER AYSHIA S	GIBB RICHARD 1980 CANYON BREEZE DR LAS VEGAS NV 89134-0327	13820613056
BAKER EDWARD H & KYUNG JA	8708 PRAIRIE HILL DR LAS VEGAS NV 89134-8414	13820510021
BALGIL YAKOV	8916 WINDSOR LOCKS AVE LAS VEGAS NV 89134-0381	13820217009
BANK BUILDING INC	101 N TRYON ST CHARLOTTE NC 28255	13820614001

Report of All Selected Parcels**Case Number:**

VAR-64887

Printed On: Thu: August 25, 2016

Owner	Address	Parcel Number
BARBEE R W & V M LIVING TRUST	BARBEE ROBERT W & VIRGINIA M TRS 2112 BACHELOR CT LAS VEGAS NV 89128-7620	13821117024
BARBER MARCUS A & HARGROW D JR	FRAZIER JANICE 2142-66TH AVE OAKLAND CA 94621-3616	13820513018
BARNES CAROL M	8800 STAFFORD SPRINGS DR LAS VEGAS NV 89134-0373	13820616005
BARNES SYLVIA FLETCHER	8717 SMOKEY DR LAS VEGAS NV 89134	13820515004
BARNHART ROBERT M & ROBERT	8516 CHIQUITA DR LAS VEGAS NV 89128-7913	13820813001
BARONE JAMES & KAY	1900 VERO DR LAS VEGAS NV 89134	13820715005
BARTOLOMUCCI RAYMOND V JR & MERI	7950 DUBLIN BLVD #109 DUBLIN CA 94568-2966	13820520050
BARTON CHANCE	2013 SEDONA MORNING DR LAS VEGAS NV 89128-8484	13820615004
BASILIO GRACEMAY	8229 CRETAN BLUE LN LAS VEGAS NV 89128-7466	13821212020
BASSETT THOMAS J & MIYOKO	2136 RAINBOW FALLS DR LAS VEGAS NV 89134-0331	13820520040
BATEMAN FAMILY TRUST	BATEMAN CHARLES B & BARBARA J TR 2124 HENNIKER WAY LAS VEGAS NV 89134	13820211015
BATONGBACAL FAMILY TRUST	BATONGBACAL MANUEL & AURORA TRS 8301 CRETAN BLUE LN LAS VEGAS NV 89128-7466	13821212019
BAUR ROSE M	2037 HARBOR CLIFF DR LAS VEGAS NV 89128-7461	13821212004
BAVARO JOHNNY W	8700 CRESCENT RIDGE LN LAS VEGAS NV 89134-0302	13820613007
BEARER WALTER H & LYNETTE E	8725 PRAIRIE HILL DR LAS VEGAS NV 89134-8416	13820517002
BEATTY ALEXANDER	DULAMSUREN NARANGUA 8209 SEDONA SUNSET DR LAS VEGAS NV 89128-8293	13821210056
BECK LILI C TRUST	BECK LILI C TRS 8225 SEDONA SUNRISE DR LAS VEGAS NV 89128-7912	13821310036
BECKLEY DOUGLAS SCOTT	7500 W LAKE MEAD #9-490 LAS VEGAS NV 89128-0297	13820712018
BEIERSCHMITT MICHAEL	8345 EMERALD ISLE AVE LAS VEGAS NV 89128-7501	13821215026
BELLER NEIL TRS	7408 W SAHARA LAS VEGAS NV 89117-2740	13820615010
BELLSEY EILEEN R	2200 BEAR VALLEY ST LAS VEGAS NV 89128-7602	13821112030
BENEDICT WALTRAUD	P O BOX 370068 LAS VEGAS NV 89137	13821118036
BENSIMON ERIC & SANDRINE	8517 ESTRELITA DR LAS VEGAS NV 89128-7959	13820712017
BERNARD RANDY J	H AidAL MARTHA 8408 PASEO VISTA DR LAS VEGAS NV 89128	13821318003
BERNICK CHARLES B & JULIE	8808 CORTILE DR LAS VEGAS NV 89134-6152	13820314017
BERNSTEIN J S FAMILY TRUST	2132 HENNIKER WAY LAS VEGAS NV 89134-0343	13820114009
BERRY LORENE R TRUST	HUTCHERSON LORENE BERRY TRS 2133 FOUNTAIN VIEW DR LAS VEGAS NV 89134-0319	13820610023
BET-SHLIMON JOULIET & ANDREW	3 HIGH RIDGE DR LINCOLN RI 02865-3816	13820513016
BISCHOFF JAMES QUALIFIED RES TR	BISCHOFF M L QUALIFED RES TR 8320 PASEO VISTA DR LAS VEGAS NV 89128-8244	13821317026
BLAMIRE JAMES J	8245 SEDONA SUNRISE DR LAS VEGAS NV 89128	13821310041
BLANCKAERT JERRY A JR	8416 PASEO VISTA DR LAS VEGAS NV 89128-8274	13820716002
BLENKUSH JONATHAN E & ALICIA M	8833 VALLEY CREEK DR LAS VEGAS NV 89134-0372	13820215002

Report of All Selected Parcels**Case Number:**

VAR-64887

Printed On: Thu: August 25, 2016

<u>Owner</u>	<u>Address</u>	<u>Parcel Number</u>
BLOMBERG CHUCK SEPARATE PPTY TR	BLOMBERG JUDITH ANN TRS 8304 SEDONA SUNRISE DR LAS VEGAS NV 89128-8257	13821310006
BLOOD JENNIER HOLMES	2024 WATERBURY LN LAS VEGAS NV 89134	13820616014
BODROG JOSEPH A & BETHANNE M	8361 SUGAR BOWL CT LAS VEGAS NV 89128-7607	13821112026
BOEHME FAMILY TRUST	BOEHME JOHN LOUIS & CAROL A TRS 8800 ROZETTA CT LAS VEGAS NV 89134-6179	13820317015
BONGIOVI GINA	8628 ESTRELITA DR LAS VEGAS NV 89128	13820818018
BONIELLA SUSAN L	8333 HOLLOW WHARF DR LAS VEGAS NV 89128-7428	13821212038
BONYADI BAHAREH	2200 SAPPHIRE VALLEY ST LAS VEGAS NV 89128-7615	13821117008
BOOTH RONALD BRUCE & MAREN L	1904 VERO DR LAS VEGAS NV 89134-6154	13820715004
BOSWORTH ROSEMARY	KASCH LYNN 8241 SEDONA SUNSET DR LAS VEGAS NV 89128	13821210064
BOTA ELENA CORNELIA	8312 ARROYO JUSTIN AVE LAS VEGAS NV 89128	13821317010
BOVERO BRETT	8352 BRITTANY HARBOR DR LAS VEGAS NV 89128-7492	13821215029
BOWEN CHRISTINE & GLYN	8500 ESTRELITA DR LAS VEGAS NV 89128-7958	13820712005
BOWERS GERALDINE ANN	8309 CRETAN BLUE LN LAS VEGAS NV 89128-7466	13821212017
BOXHILL INVESTMENTS L L C	8916 RAINBOW RIDGE DR LAS VEGAS NV 89117-5816	13820613061
BOYER ALBERT B	110 E 100 S ST GEORGE UT 84770	13820613086
BOYER JOHN	5345 GOLDEN GOSSAMER ST LAS VEGAS NV 89149	13821216036
BOZ MIKE	3 CLIFFSIDE CT BELMONT CA 94002-3313	13820612006
BRADSHAW GERALD S & TIFFANY A	2113 WATERBURY LN LAS VEGAS NV 89134-0389	13820616020
BRANDT MILTON P & LYNDA P	2425 PALMRIDGE DR LAS VEGAS NV 89134	13820517054
BRAY DAVID R & MARY MAGGIE	8345 HOLLOW WHARF DR LAS VEGAS NV 89128-7428	13821212035
BRITTANY HARBOR L L C	10620 SO HIGHLANDS PKWY #110-109 LAS VEGAS NV 89141-4371	13821216044
BRITTON RONALD L & BEVERLY A	8213 CRETAN BLUE LANE LAS VEGAS NV 89128-7474	13821216011
BROADHURST MARK W & MICHELLE K	8308 SEDONA SUNRISE DR LAS VEGAS NV 89128-8257	13821310005
BROOKS MICHAEL R & KATHLEEN M	8433 PASEO VISTA DR LAS VEGAS NV 89128-8274	13820716007
BROWN RICHARD P & PATRICIA A	408 E LIBERTY ST MEDINA OH 44256	13820613029
BROWN ROXIE B	2005 EVENING GLOW DR LAS VEGAS NV 89134-0307	13820613074
BROWN TERI E	8220 EMERALD ISLE LAS VEGAS NV 89128-7475	13821216020
BROWNSON-GILBERT LIVING TRUST	8712 MAGNOLIA RIDGE AVE LAS VEGAS NV 89134-0334	13820520010
BUHLER BROWN FAMILY TRUST	BUHLER ROBERT CO-TRS 235 CARVER RD #8 PLYMOUTH MA 02360	13820613075
BULLARD WILLIAM J & VIVIAN	8820 BONTA CT LAS VEGAS NV 89134-6133	13820313009
BUONANTONY EUGENE	8304 CRETAN BLUE LN LAS VEGAS NV 89128-7465	13821212023
BURCHILL CASEY CARL	OLSON-KEY MAGGIE MAE 2009 SEDONA PATH WAY LAS VEGAS NV 89128	13821210068

Report of All Selected Parcels**Case Number:**

VAR-64887

Printed On: Thu: August 25, 2016

Owner	Address	Parcel Number
BURDEN JACK P & KARIN	8317 PASEO VISTA DR LAS VEGAS NV 89128-8246	13821317017
BURNS WILLIAM R & JENNIFER L	8724 CRESCENT RIDGE LN LAS VEGAS NV 89134	13820613001
BURT VELMA & KEVIN	8701 DIAMOND CREEK CT LAS VEGAS NV 89134-0323	13820613015
BURTON ANA & BRIAN FAMILY TRUST	BURTON BRIAN A & ANA R TRS 8313 EMERALD ISLE AVE LAS VEGAS NV 89128-7480	13821215018
BURTON LOVELL	DAUGHERTY-BURTON TASHA 2225 ORCHID BLOSSOM DR LAS VEGAS NV 89134	13820520002
BUTCHER LISA J & JIMMY D JR	10617 ABILENE ST COMMERCE CITY CO 80022	13820615001
BYINGTON FAMILY TRUST	BYINGTON RICHARD J & ALICE M TRS 2000 SEDONA MORNING DR LAS VEGAS NV 89128	13820615009
C A H 2014-1 BORROWER L L C	8665 E HARTFORD DR #200 SCOTTSDALE AZ 85255	13821216042
C A H 2015-1 BORROWER L L C	8665 E HARTFORD DR #200 SCOTTSDALE AZ 85255	13821121003
C A H 2015-1 BORROWER L L C	8665 E HARTFORD DR #200 SCOTTSDALE AZ 85255	13821121006
C L K TRUST	LUNG VINCENT & KAREN TRS 1021 S GLADYS AVE SAN GABRIEL CA 91776	13820612020
C P FUND 1 L L C	3079 MONTE ROSA AVE LAS VEGAS NV 89120	13821215044
CABRAL REVOCABLE TRUST	CABRAL MICHAEL L & SANDRA TRS 3022 MONTEREY ST OXNARD CA 93033-4937	13820520044
CALDWELL KENNETH S	8804 VALLEY CREEK DR LAS VEGAS NV 89134	13820613034
CAMPOS SAMSON D & IRMA T	8720 MAGNOLIA RIDGE AVE LAS VEGAS NV 89134-0365	13820520008
CAPORICCI BORIANA	8816 CORTILE DR LAS VEGAS NV 89134	13820314019
CAPURRO ANTHONY RANDALL & J A J	8817 VALLEY CREEK LAS VEGAS NV 89134-0372	13820613036
CAPURRO STEPHEN G & CHERYL	8613 ESTRELITA DR LAS VEGAS NV 89128-8234	13820714014
CAR SPA T H HOLDING L L C	5195 LAS VEGAS BLVD S LAS VEGAS NV 89119	13820521002
CARBONE FRANK ANTHONY JR	STAR CARLENE ROBERTA 8812 MONTAGNA DR LAS VEGAS NV 89134-6146	13820315013
CARLSEN RENE & EMILY	8813 STAFFORD SPRINGS DR LAS VEGAS NV 89134-0375	13820616025
CARLSON ERIC	3240 118TH AVE S E #100 BELLEVUE WA 98005-4136	13820711008
CARON DAVID R & CATHERINE O	2121 RAINBOW FALLS DR LAS VEGAS NV 89134-0332	13820520057
CARRARA LISA M	8228 SEDONA SUNRISE DR LAS VEGAS NV 89128-7911	13821310012
CARRAWAY FAMILY TRUST	CARRAWAY JAMES D & NINA F TRS 8108 GRACEVILLE AVE LAS VEGAS NV 89128-6778	13820520030
CARRILLO BARBARA A & CREVENNE C	2024 EVENING GLOW DR LAS VEGAS NV 89134-0322	13820613010
CARROLL EDWARD S & SHERRI	8309 HOLLOW WHARF DR LAS VEGAS NV 89128-7426	13821212044
CARROLL JAMES P	WALSH SHANNON L 8808 LUSSO CT LAS VEGAS NV 89134-6190	13820218003
CASH LISA A	1976 CANYON BREEZE DR LAS VEGAS NV 89134-0327	13820613057
CASTANAGA EVELYN T	2204 ORCHID BLOSSOM DR LAS VEGAS NV 89134-0320	13820610027
CASTANAGA EVELYN T & NAPOLEON	2204 ORCHID BLOSSOM DR LAS VEGAS NV 89134-0320	13820520068
CASTANAGA EVELYN T & NAPOLEON	2204 ORCHID BLOSSOM DR LAS VEGAS NV 89134-0320	13820610034

Report of All Selected Parcels**Case Number:**

VAR-64887

Printed On: Thu: August 25, 2016

Owner	Address	Parcel Number
CASTILLO WILLIAM J & MARIA C	1832 DOLCE DR LAS VEGAS NV 89134-6150	13820715007
CASWELL LINDA & JOHN	8929 WINDSOR LOCKS AVE LAS VEGAS NV 89134-0380	13820211003
CATLETT DEAN & GIANNA	8826 VALLEY CREEK DR LAS VEGAS NV 89134	13820613062
CHAI LV L L C	P O BOX 80652 LAS VEGAS NV 89180-0652	13821212002
CHAN CINDY & WAI LAM	2008 SEDONA CREEK CIR LAS VEGAS NV 89128-8213	13821310002
CHANDLER HELEN	8317 HOLLOW WHARF DR LAS VEGAS NV 89128-7426	13821212042
CHANG LE	11816 DEANA ST #B EL MONTE CA 91732	13821216033
CHAPPELLE DERICK R & SHARETA CLA	8300 EMERALD ISLE AVE LAS VEGAS NV 89128	13821215013
CHEATER JULIAN C & CAMILA R	4730 ARNOLD LOOP LAS VEGAS NV 89115	13820712019
CHEN PHIL YUAN-CHUNG	P O BOX 531346 HENDERSON NV 89053-1346	13820612021
CHEN SAM XU	PAN HUAILIAN 8636 ESTRELITA DR LAS VEGAS NV 89128-8233	13820818016
CHEN YUN CHIEH	LIN HUNG SHENG 1497 FIELDS DR SAN JOSE CA 95129	13821215017
CHESS BARBARA KAY	8717 PRAIRIE HILL LAS VEGAS NV 89134-8416	13820517004
CHIN ELAINE K REVOCABLE TRUST	8825 VALLEY CREEK DR LAS VEGAS NV 89134-0372	13820613038
CHIN JEFFREY G	P O BOX 17185 SEATTLE WA 98127-0885	13820612003
CHISM D K & J K TRUST	CHISM DONALD K & JANICE K TRS 8301 SEDONA SUNRISE DR LAS VEGAS NV 89128-8258	13821310042
CHOO MARINA L FAMILY TRUST	CHOO MARINA L TRS 8237 HOLLOW WHARF DR LAS VEGAS NV 89128-7424	13821212047
CHOW GILBERT & TINA ETAL	2075 VILLAGE CENTER CIR LAS VEGAS NV 89134	13821216005
CIARLO CRAIG A & P A REV LIV TR	CIARLO CRAIG A & PATRICIA A TRS 1340 OCTOBER OAK AVE LAS VEGAS NV 89134-8877	13817812025
CINTRA REVOCABLE FAMILY TRUST	CINTRA ANTONIO C & BEATRIZ TRS 11371 BAIRD AVE NORTHRIDGE CA 91326-1958	13820520048
CLARK CAROL J TRUST	CLARK CAROL J TRS 8709 PRAIRIE HILL DR LAS VEGAS NV 89134-8416	13820517006
CLARK FAMILY REVOCABLE LIV TR	CLARK ARLO Z & RENEE TRS 2409 DESERT GLEN DR LAS VEGAS NV 89134-8406	13820517043
CLARK JOHN E III & SALLY SUE	8440 SHELTERED VALLEY DR LAS VEGAS NV 89128-7632	13820513012
CLARK MARCELLA	8721 PRAIRIE HILL DR LAS VEGAS NV 89134-8416	13820517003
CLARK TROY A	8308 BRITTANY HARBOR DR LAS VEGAS NV 89128-7489	13821215040
COFIELD TYRONE & KATISHA	1809 PASEO OVERLOOK CT LAS VEGAS NV 89128-8275	13820716011
COHEN RON SIMHAYOFF	8836 CORTILE DR LAS VEGAS NV 89134-6141	13820314023
COHEN STANLEY J & MELANIE S	1825 DOLCE DR LAS VEGAS NV 89134-6151	13820713010
COLEMANSMITH GARY L	3021 NE 72ND DR #9-152 VANCOUVER WA 98661-7300	13821210058
COLLINS MICHAEL F & LOUISA M	1829 FRANCISCO PEAK PL LAS VEGAS NV 89128	13821318008
COLMAN JOHN R	8344 BRITTANY HARBOR DR LAS VEGAS NV 89128-7492	13821215031
COLONY STARWOOD HOMES PARTNERSHI	8665 E HARTFORD DR #200 SCOTTSDALE AZ 85255	13821117012

Report of All Selected Parcels**Case Number:**

VAR-64887

Printed On: Thu: August 25, 2016

<u>Owner</u>	<u>Address</u>	<u>Parcel Number</u>
COLUMBIA GROUP LTD	1014 VINE ST CINCINNATI OH 45202-1141	13820521003
CONSTELF HOLDINGS L L C	7616 PAINTED DUNES DR LAS VEGAS NV 89149	13821215010
COOK RAYMOND	8601 ESTRELITA DR LAS VEGAS NV 89128-8234	13820714012
COOK SCOTT R	2016 SEDONA CREEK CIR LAS VEGAS NV 89128	13821210076
COOPER STANLEY A &/OR JEANNE C	COOPER TOD 2417 DESERT GLEN DR LAS VEGAS NV 89134-8406	13820517045
CORDON GEORGE & JOYCE	8820 CORTILE DR LAS VEGAS NV 89134-6152	13820314020
CORDOVA RAZEL A	8913 WINDSOR LOCKS AVE LAS VEGAS NV 89134-0379	13820217007
CORTA BELLA COMMUNITY ASSN	3360 W SAHARA AVE #200 LAS VEGAS NV 89102-6069	13820218011
CORZO NEPTALI	FIGUEREDO-ALVAREZ JUANA 8240 SEDONA SUNSET DR LAS VEGAS NV 89128	13821210011
COVER FAMILY TRUST	COVER FRED W & MARI-ANNE TRS 6633 VILLA BONITA RD LAS VEGAS NV 89146-6570	13821212031
COVEY FAMILY TRUST	COVEY BRIAN W & SUSAN M TRS 2208 SAPPHIRE VALLEY ST LAS VEGAS NV 89128-7615	13821117006
COVEY JOHN & BETTY FAMILY TR	COVEY JOHN H JR & BETTY J TRS 2212 BEAR VALLEY ST LAS VEGAS NV 89128-7602	13821112033
CRAIG WILLIAM W	2113 BACHELOR CT LAS VEGAS NV 89128-7620	13821117031
CRAMBES JAMES L & EVELYN E	8717 CYPRESSWOOD AVE LAS VEGAS NV 89134-0313	13820610008
CRANDALL MAXINE TRUST	CRANDALL MAXINE R TRS 2400 SPRINGRIDGE DR LAS VEGAS NV 89134-8843	13820512001
CRAW CAROLE C LIVING TRUST	CRAW CAROLE C TRS 8625 PRAIRIE HILL DR LAS VEGAS NV 89134-8415	13820516005
CRAWFORD MARK R TRUST	CRAWFORD MARK R TRS 8429 DUTCH HILL CT LAS VEGAS NV 89128-7624	13821110008
CRUZ RICARDO C & MARIA B	2967 CROWN BLUFFS CT LAS VEGAS NV 89117-2577	13820520037
CUDDY DANIEL C & FLORENCE	2116 RICO PEAK CT LAS VEGAS NV 89128-7634	13821117040
CURRY DARYN	HARTVIGSEN NICOLE 8316 ARROYO JUSTIN AVE LAS VEGAS NV 89128	13821317009
CURTIS JOHN T & PATRICIA J TRUST	CURTIS JOHN T & PATRICIA J TRS 2145 HILLSGATE ST LAS VEGAS NV 89134-0370	13820114014
CUTHBERTSON THOMAS A	8325 BRITTANY HARBOR DR LAS VEGAS NV 89128-7490	13821215049
D L B FAMILY TRUST	8232 SEDONA SUNSET DR LAS VEGAS NV 89128-7964	13821210013
D S F R NV HOLDINGS L L C	909 N SEPULVEDA BLVD #840 EL SEGUNDO CA 90245	13820712016
DAGGER PROPERTIES 4 L L C	419 MAIN ST #433 HUNTINGTON BEACH CA 92648-5199	13821210001
DAGGER PROPERTIES 6 L L C	419 MAIN ST #433 HUNTINGTON BEACH CA 92648-5199	13821121009
DARLING STEPHEN T	8604 MAGNOLIA RIDGE AVE LAS VEGAS NV 89134-0333	13820520021
DAS SRUTI	500 TUSCANY VIEW ST LAS VEGAS NV 89145	13820616012
DAVIS MARIA E SEPARATE PPTY TR	8213 SEDONA SUNRISE DR LAS VEGAS NV 89128-7910	13821310033
DAY ROBERT BRUSH	8424 PASEO VISTA DR LAS VEGAS NV 89128-8274	13820716004
DEATON BERLE W & GLORIA A	8325 SWAN LAKE AVE LAS VEGAS NV 89128-7415	13821118059
DECRISTOFORO DEAN A REV LIV TR	DECRISTOFORO DEAN A TRS 2224 FIERO DR LAS VEGAS NV 89134-6038	13820514010

Report of All Selected Parcels**Case Number:**

VAR-64887

Printed On: Thu: August 25, 2016

<u>Owner</u>	<u>Address</u>	<u>Parcel Number</u>
DEGUZMN ROY C & LINLEY C	2017 SEDONA PATH WY LAS VEGAS NV 89128-7968	13821210070
DEJESUS JOSE ROEL & MARIA C	8809 SUMMER RIDGE DR LAS VEGAS NV 89134-0346	13820612018
DELEO MICHAEL A	2017 CANYON BREEZE DR LAS VEGAS NV 89134-0301	13820613050
DEMARCO ANTHONY & ANGELA	8200 SEDONA SUNSET DR LAS VEGAS NV 89128	13821210020
DENIKER ROBERT J & GLORIA E	413 W CRESTVIEW CORONA CA 92882-4823	13820610041
DENNIS ANDREW C & MARILYN	8309 PASEO VISTA DR LAS VEGAS NV 89128-8245	13821317015
DETENTE TRUST	DOBEY JAMES A & LARISSA A TRS 8813 BONTA CT LAS VEGAS NV 89134	13820313015
DIEBOLD ROBERT & MEREDITH	8205 SEDONA SUNRISE DR LAS VEGAS NV 89128	13821310031
DIGUGLIELMO DOMINIC A & ARLENE	P O BOX 16 MIMBRES NM 88049-0016	13820520076
DILGER IVETA A	2129 RAINBOW FALLS DR LAS VEGAS NV 89134-0332	13820520059
DIMINICH BRUNO & LUCIANA REV TR	DIMINICH BRUNO & LUCIANA TRS 8809 LUSSO CT LAS VEGAS NV 89134-6190	13820218008
DINGMAN 2009 TRUST	DINGMAN KENNETH O & CHRISTEN TRS 8348 SUGAR BOWL CT LAS VEGAS NV 89128-7606	13821112022
DIODATO JAMES J JR	ZELENSKA M MADELEINE 14 JOYCE AVENUE MASSAPEQUA NY 11758-3726	13820520067
DIPHASTA FAMILY TRUST	HERTZ DIANE TRS 2709 CRYSTAL BEACH DR LAS VEGAS NV 89128	13820520012
DOBAK PAUL & CINDY	1850 LAXALT WY ELKO NV 89801-4691	13821310038
DOBSON JONATHAN	8224 CRETAN BLUE LN LAS VEGAS NV 89128-7465	13821216007
DOERING KEITH P & LINDA	2209 ORCHID BLOSSOM DR LAS VEGAS NV 89134-0321	13820520083
DOMBROWSKI MARY GWEN 1986 LIV TR	DOMBROWSKI MARY GWEN TRS 1824 DOLCE DR LAS VEGAS NV 89134-6150	13820713002
DONOVAN FAMILY TRUST	DONOVAN RUPERT & MELVINA TRS 2100 HENNIKER WY LAS VEGAS NV 89134-0336	13820211021
DORZI SKENDER & RAZIJE	DORZI KLODIAN 2117 HARBOR CLIFF DR LAS VEGAS NV 89128-7460	13821121002
DOVE IAN J & KELLY H	8328 PASEO VISTA DR LAS VEGAS NV 89128	13821317024
DRISCOLL NEAL A & PAMELA P	1972 CANYON BREEZE DR LAS VEGAS NV 89134-0327	13820613058
DUBOIS FAMILY 2006 REVOCABLE TRU	DUBOIS JOHN TRS 2549 DAYSPRING ST LAS VEGAS NV 89128	13821121001
DUFFY MICHAEL	8229 HOLLOW WHARF DR LAS VEGAS NV 89128-7424	13821212049
DUGGER CRAIG W & MONICA M	8348 EMERALD ISLE AVE LAS VEGAS NV 89128-7500	13821215001
DUKE MICHAEL	11911 MAGNOLIA BLVD #3 VALLEY VILLAGE CA 91607-4406	13820520051
DUNCAN LARRY S & CONSTANCE L	8349 CRETAN BLUE LN LAS VEGAS NV 89128	13821212007
DUNKINS CHARLES SR	1988 CANYON BREEZE LAS VEGAS NV 89134-0327	13820612002
DUZAN KELLI L & CHARLES D	8921 STAFFORD SPRINGS DR LAS VEGAS NV 89134	13820114012
DYAKOVA YULIYA & YANA	1964 CANYON BREEZE DR LAS VEGAS NV 89134-0327	13820613060
E & C FAMILY TRUST	1820 MADERA CANYON PL LAS VEGAS NV 89128	13820712008
E J I ENTERPRISE L L C	P O BOX 371764 LAS VEGAS NV 89137	13821212009

Report of All Selected Parcels**Case Number:**

VAR-64887

Printed On: Thu: August 25, 2016

Owner	Address	Parcel Number
E L O CAPITAL L L C	E L O CAPITAL L L C 9501 BALATTA CANYON CT LAS VEGAS NV 89144-0837	13820520005
E Z & D N L L C	11901 SANTA MONICA BLVD #313 LOS ANGELES CA 90025	13821216040
EALEY JAMES R & CARRIE L	8725 CYPRESSWOOD AVE LAS VEGAS NV 89134-0314	13820610007
ELLING CAROLYN & MEYER	8352 SUGAR BOWL CT LAS VEGAS NV 89128-7606	13821112023
ELLIOTT ARTHUR R & MARY H	1832 MADERA CANYON PL LAS VEGAS NV 89128-7949	13820712006
EMANUELE PETER	TONWUT CHIRAWAN 6352 VICUNA DR LAS VEGAS NV 89146-3006	13821216024
EMERALD A B 100 L L C	P O BOX 370261 LAS VEGAS NV 89137	13820520054
ENAYAT SEPEHR B	8329 EMERALD ISLE AVE LAS VEGAS NV 89128-7480	13821215022
ERBLAND RICHARD & LESLIE TRUST	ERBLAND RICHARD D & LESLIE G TRS 8332 PASEO VISTA DR LAS VEGAS NV 89128-8244	13821317023
ERMENIO EUGENE & ALICE	2021 SEDONA CREEK LAS VEGAS NV 89128-8216	13821210078
ERWIN-SUNDAY RITA	2404 SPRINGRIDGE DR LAS VEGAS NV 89134-8843	13820512002
ESPIRITU OMAR M & ROWENA S	8349 BRITTANY HARBOR DR LAS VEGAS NV 89128-7493	13821215053
ESTACIO MARIA CELINA	8805 VALLEY CREEK DR LAS VEGAS NV 89134-0372	13820710003
ESTRADA FAMILY TRUST	ESTRADA GARY A & JUDY L TRS 2000 SEDONA CREEK CIR LAS VEGAS NV 89128-8213	13820711019
ETTER TIMOTHY M	2017 WATERBURY LN LAS VEGAS NV 89134-0385	13820217013
EUCLID 3P L L C	2124 MISTY MEADOW DR LAS VEGAS NV 89134-0347	13820610044
EUCLID 3P L L C	2124 MISTY MEADOW DR LAS VEGAS NV 89134-0347	13820520035
EXBER INVESTMENTS L L C	4021 MEADOWS LN LAS VEGAS NV 89107	13821310015
F B RIVIERA L L C	11684 CALLE ALBARA EL CAJON CA 92019	13821211004
FAFARD RAYMOND J & THERESA L	8701 SUMMER RIDGE DR LAS VEGAS NV 89134-0324	13820613022
FAIRCHILD JULIA A	8344 CRETAN BLUE LN LAS VEGAS NV 89128-7469	13821212033
FAKKEMA BARBARA L	346 OCONNER ST MENLO PARK CA 94025-2663	13820314016
FARRAR GRANT R & DANIELLE H	1921 SEDONA PASEO LN LAS VEGAS NV 89128-8287	13820711005
FASCE THOMAS J & NINA	2025 PARADISE PEAK DR LAS VEGAS NV 89134-0309	13820612011
FASSLER DAVID A & JUDY L	2837 KINNEY DR WALNUT CREEK CA 94595-1032	13820520036
FELLOUS FRANCINE N	5649 W RIM CIR RIVERSIDE CA 92509-4968	13820520009
FENG DU	ZHENG GUANGHUI 2392 BROCKTON WAY HENDERSON NV 89074	13820613045
FERGUSON JACOB R	8813 SILVER MOUNTAIN CT LAS VEGAS NV 89134-0361	13820613070
FERRE A VICTOR & J LOUISE	8617 PRAIRIE HILL DR LAS VEGAS NV 89134-8415	13820516007
FFZ FAMILY INVESTMENT TRUST	KAPLAN ZEV E TRS 1701 GLENVIEW DR LAS VEGAS NV 89134-6121	13821317032
FIEMAN HOWARD S & ANDREA LIV TR	FIEMAN HOWARD S & ANDREA R TRS 2121 HILLSGATE ST LAS VEGAS NV 89134-0369	13820211028
FINDLEY JERRY L & SHANDRA M	P O BOX 35739 LAS VEGAS NV 89133-5739	13821216032

Report of All Selected Parcels**Case Number:**

VAR-64887

Printed On: Thu: August 25, 2016

Owner	Address	Parcel Number
FINN BARRY R LIVING TRUST	FINN BARRY R TRS 2116 WATERBURY LN LAS VEGAS NV 89134-0387	13820616009
FISCHER PAMELA A LIVING TR 2007	FISCHER PAMELA A TRS 2208 BEAR VALLEY ST LAS VEGAS NV 89128-7602	13821112032
FISHEL MIKE & IVY	2141 HILLSGATE ST LAS VEGAS NV 89134-0370	13820211033
FLIPPIN THOMAS O & VENETA G LIVI	FLIPPIN THOMAS O & VENETA G TRS 8212 SEDONA SUNRISE DR LAS VEGAS NV 89128-7909	13821310016
FLUELLYN HERMAN D & LILLIAN	FLUELLYN TRACEY 2405 DESERT BUTTE DR LAS VEGAS NV 89134	13820517023
FODOR IMRE	2109 RICO PEAK CT LAS VEGAS NV 89128-7634	13820518002
FOLEY MARK J & KATHERINE TR AGMT	FOLEY MARK J & KATHERINE L TRS 8920 STAFFORD SPRINGS DR LAS VEGAS NV 89134-0340	13820114002
FOLEY ROBERT E SR REVOCABLE LIVI	FOLEY ROBERT E SR TRS 8809 BAYSIDE CIR LAS VEGAS NV 89117	13820315014
FONG & ASSOCIATES-MEADOWS LTD II	FONG KENNETH WAYNE TRS 6305 MEADOWSWEET WAY LAS VEGAS NV 89108	13820521001
FONG & ASSOCIATES-MEADOWS LTD II	FONG KENNETH WAYNE TRS 6305 MEADOWSWEET WAY LAS VEGAS NV 89108	13820611004
FONG & ASSOCIATES-MEADOWS LTD II	FONG KENNETH WAYNE TRS 6305 MEADOWSWEET WAY LAS VEGAS NV 89108	13820521008
FORNOF NV ASSET PROTECTION TRUST	8824 MONTAGNA DR LAS VEGAS NV 89134-6149	13820315016
FORT JOHN D SR & ESTHER P	2108 LOOKOUT POINT CIR LAS VEGAS NV 89117-5805	13820211027
FOWLER ROBERT & JOYCE	8337 BRITTANY HARBOR DR LAS VEGAS NV 89128-7493	13821215050
FRANCIS B CHRISTIAN & LISA A	2120 HENNIKER WY LAS VEGAS NV 89134-0343	13820211016
FRANKLIN DAVID T & LINDA S	2208 ANGELFIRE ST LAS VEGAS NV 89128-7610	13821117016
FRANKLIN THOMAS & MAMIE	2024 SEDONA MORNING DR LAS VEGAS NV 89128	13821210083
FRAZIER IRENE	9821 GLENROCK DR LAS VEGAS NV 89134	13820711018
FRETTY DAVID & TAMARA	2201 ANGELFIRE ST LAS VEGAS NV 89128-7611	13821117009
FREUDENBERGER FAMILY TRUST	FREUDENBERGER STEPHAN & KIM TRS 8805 CORTILE DR LAS VEGAS NV 89134-6153	13820715008
FREUND BRADLEY S & LORI J	8805 STAFFORD SPRINGS DR LAS VEGAS NV 89134	13820616023
FREUND GREGORY T & LISA MARIE	8304 ARROYO JUSTIN AVE LAS VEGAS NV 89128	13821317012
FRISBEY SHAWN W	WILSON WILLIAM L 2025 SEDONA CREEK CIR LAS VEGAS NV 89128	13821210079
G A C C LIVING TRUST	RHODES JOHN C & SHELLEY L TRS 2113 HILLSGATE ST LAS VEGAS NV 89134-0369	13820211026
GAJARDO PATRICIO ALDO	8341 BRITTANY HARBOR DR LAS VEGAS NV 89128-7493	13821215051
GALLAGHER DEBORAH	8316 SEDONA SUNSET DR LAS VEGAS NV 89128-8474	13821210005
GALLI RALPH JR	8229 SEDONA SUNSET DR LAS VEGAS NV 89128-7965	13821210061
GAPUTAN NECTOR & NEVA	2112 MISTY MEADOW DR LAS VEGAS NV 89134-0347	13820610042
GARCIA DAVID & PHYLLIS M	8228 BRITTANY HARBOR DR LAS VEGAS NV 89128-7495	13821216037
GARCIA JESUS	YOUNG TRICIA T 8317 CRETAN BLUE LN LAS VEGAS NV 89128-7468	13821212015
GARCIA RICARDO	2105 BACHELOR CT LAS VEGAS NV 89128	13821117029
GARDECKI GARY S & JULIE M	2140 FOUNTAIN VIEW DR LAS VEGAS NV 89134-0317	13820520023

Report of All Selected Parcels**Case Number:**

VAR-64887

Printed On: Thu: August 25, 2016

Owner	Address	Parcel Number
GARNIER DEXTER A & JUDITH L	51 A CHULA LN SAN FRANCISCO CA 94114-1725	13820520075
GAUVIN NATHALIE	8729 WINTRY GARDEN AVE LAS VEGAS NV 89134-0352	13820520052
GEIGER KENNETH & KATHRYN	GEIGER KATHRYN 1968 EVENING GLOW DR LAS VEGAS NV 89134-0358	13820613025
GEMUS IRREVOCABLE TRUST	4465 S JONES BLVD LAS VEGAS NV 89103-3307	13820716005
GHANOONI RAHIM	8301 BRITTANY HARBOR DR LAS VEGAS NV 89128-7494	13821215043
GIBBONS DENNIS E LIVING TRUST	GIBBONS DENNIS EDWARD TRS 2117 WATERBURY LN LAS VEGAS NV 89134-0389	13820616021
GILGE KURT & JENNIFER L	2216 BEAR VALLEY ST LAS VEGAS NV 89128-7602	13821112034
GILMAN MATTHEW EVAN	8357 SUGAR BOWL CT LAS VEGAS NV 89128-7607	13821112027
GISMONDI VICTOR ALAN & SHANA COH	2017 EVENING GLOW DR LAS VEGAS NV 89134	13820613077
GITLIN ASSET PROTECTION TRUST	GITLIN JEFFREY B & LAURA G TRS 8308 ARROYO JUSTIN AVE LAS VEGAS NV 89128-8278	13821317011
GJIKA VASIL & MIMOZA	GJIKA GERTI 8316 BRITTANY HARBOR DR LAS VEGAS NV 89128-7489	13821215038
LENCOE PROPERTIES INC	7548 W SAHARA AVE #102 LAS VEGAS NV 89117	13820611003
GO BLUE TRUST	2129 HILLSGATE ST LAS VEGAS NV 89134-0370	13820211030
GOLDBERG SAMELA E TRUST	GOLDBERG SAMELA E TRS 8613 PRAIRIE HILL DR LAS VEGAS NV 89134-8415	13820516008
GOLDFARB SIMCHA & BENTE	8829 BONTA CT LAS VEGAS NV 89134-6132	13820313019
GOLDMAN LORI A & MARK A	9820 DESMOND DR OAK HILLS CA 92344-0775	13821310007
GOLDSTEIN EVA M & MARC M	2105 SNOWBIRD CT LAS VEGAS NV 89128-7622	13821117037
GOLDSTEIN FAMILY TRUST	GOLDSTEIN CAROLE H TRS 3330 FRUITVILLE RD #1 SARASOTA FL 34237	13820517024
GONZALEZ-MARTINEZ CARLOS A	BIZOSO-SOLA VIRGINIA E 8728 MAGNOLIA RIDGE AVE LAS VEGAS NV 89134-0365	13820520006
GORDON JOHN REAVES & KATHERINE J	8825 CORTILE DR LAS VEGAS NV 89134-6142	13820314011
GORMAN CARL & KELLIE TRUST	GORMAN CARL & KELLIE TRS 7389 STRUTTING SILVER CT LAS VEGAS NV 89131-2348	13821117013
GOTA JAMES M	NG YOKE LIAN 2032 SEDONA CREEK CIR LAS VEGAS NV 89128-8215	13821210072
GOTA JOHN Y & STEVEN Y	1146 N CENTRAL AVE #116 GLENDALE CA 91202-2506	13820613026
GOTTESMAN LOUIS TRUST	GOTTESMAN LOUIS TRS 8740 SMOKEY DR LAS VEGAS NV 89134-8419	13820510017
GRADE JASON	8804 CYPRESSWOOD AVE LAS VEGAS NV 89134-0363	13820520073
GRAEBER JENNY	8821 VALLEY CREEK DR LAS VEGAS NV 89134-0372	13820613037
GRAHAM MARGARET	8673 PRAIRIE HILL DR LAS VEGAS NV 89134-8415	13820517009
GRASSICK FREDERICK G & ARDEN FAM	GRASSICK DORIS J 11597 CALDICOT DT LAS VEGAS NV 89138	13820517031
GRAVES ROCHELLE A	2128 MISTY MEADOW DR LAS VEGAS NV 89134-0347	13820520027
GREEN APPLE PROPERTIES IV L L C	2320 S POTOSI ST #130 LAS VEGAS NV 89146	13820713011
GREENE GERALD A & ELYNNE P	8244 PASEO VISTA DR LAS VEGAS NV 89129	13821317033
GREENSPAN FAMILY TRUST	GREENSPAN ELLEN M TRS 2419 DESERT GLEN DR LAS VEGAS NV 89134-8406	13820517046

Report of All Selected Parcels**Case Number:**

VAR-64887

Printed On: Thu: August 25, 2016

<u>Owner</u>	<u>Address</u>	<u>Parcel Number</u>
GREENSTEIN FRANCINE L TRUST	GREENSTEIN FRANCINE L TRS 8824 VALLEY CREEK DR LAS VEGAS NV 89134-0371	13820613063
GRILLO JOHN & DEBRA	8349 EMERALD ISLE AVE LAS VEGAS NV 89128-7501	13821215027
GRONQUIST FAMILY TRUST	GRONQUIST KEITH R & BARBARA TRS 8508 ESTRELITA DR LAS VEGAS NV 89128-7958	13820712003
GUADAGNI LUIGI & GRACE TRUST	GUADAGNI LUIGI & GRACE TRS 8324 ARROYO JUSTIN AVE LAS VEGAS NV 89128-8278	13821317007
GUARNERA SALVATORE M & SHELLEY	8804 ROZETTA CT LAS VEGAS NV 89134-6179	13820317016
GUERRERO ROBERT W	2005 PARADISE PEAK DR LAS VEGAS NV 89134-0309	13820612016
GUEVARRA DANIEL P JR & GRACE S	2137 MISTY MEADOW DR LAS VEGAS NV 89134	13820520031
GUIA VICTOR	BEI YIRU 8240 PASEO VISTA DR LAS VEGAS NV 89128-8242	13821316018
GUILLOTTE LEO & CATHERINE	2100 BACHELOR CT LAS VEGAS NV 89128-7620	13821117027
GUTH LEONARD E & CAROLE FAM TR	GUTH LEONARD E & CAROLE E CO-TRS 2025 SEDONA MORNING DR LAS VEGAS NV 89128-8484	13820615002
GUZMAN YURAC G & MITZY D	2116 HENNIKER WAY LAS VEGAS NV 89134-0336	13820211017
GYURE ROSEMARY	2001 CANYON BREEZE DR LAS VEGAS NV 89134-0301	13820613046
H L O LIVING TRUST	OSTERHOUDT HENRY J & LESLEY TRS 2205 ANGELFIRE ST LAS VEGAS NV 89128-7611	13821117010
HAINSWORTH CHARLES N & CAROL ANN	2121 WATERBURY LN LAS VEGAS NV 89134-0389	13820616022
HAJARIAN AREZU	10440 DEERWOOD RD #824 HOUSTON TX 77042	13820612015
HAKES STACY B	2025 EVENING GLOW DR LAS VEGAS NV 89134-0307	13820613079
HAKOPIAN LIANA	2005 CANYON BREEZE DR LAS VEGAS NV 89134	13820613047
HALASTICK JANET M & MICHAEL J	2004 EVENING GLOW DR LAS VEGAS NV 89134-0306	13820613018
HALEY ANNE TRUST	HALEY ANNE TRS 8705 PRAIRIE HILL DR LAS VEGAS NV 89134-8416	13820517007
HALL MARGARET O & ALBERT G JR	8233 BRITTANY HARBOR DR LAS VEGAS NV 89128-7494	13821216039
HALL MELINDA S	PETTITT MAUREEN A 2408 SUNUP DR LAS VEGAS NV 89134-8426	13820517019
HALL ROSEMARY C & NATHANIEL JR	8204 SEDONA SUNRISE DR LAS VEGAS NV 89128	13821310018
HAMILTON LUMAS	1428 E 70TH ST LOS ANGELES CA 90001-1921	13820813016
HAMOU SHARONIT BEN	8345 CRETAN BLUE LN LAS VEGAS NV 89128-7470	13821212008
HAN YOUNGHEE	2037 SEDONA CREEK CIR LAS VEGAS NV 89128-8216	13821210081
HANAGAMI BURT Y LIVING TRUST	HANAGAMI BURT Y TRS 1927 E LA DENEY CT ONTARIO CA 91764-2316	13820520025
HANKEL FAMILY TRUST	HANKEL DOUGLAS M & ALMA L TRS 1920 SEDONA PASEO LN LAS VEGAS NV 89128-8286	13820711015
HANLEY MARY ANN REVOCABLE TRUST	HANLEY MARY ANN TRS 2404 DESERT BUTTE DR LAS VEGAS NV 89134	13820517029
HARDING JUDITH & SHARYN	8425 DUTCH HILL CT LAS VEGAS NV 89128-7624	13821110009
HARDMAN GLEN G & JENNIFER L	8329 PASEO VISTA DR LAS VEGAS NV 89128-8246	13821317020
HAROONIAN OMID	17531 JACARANDA LN IRVINE CA 92612	13821215061

Report of All Selected Parcels**Case Number:**

VAR-64887

Printed On: Thu: August 25, 2016

<u>Owner</u>	<u>Address</u>	<u>Parcel Number</u>
HARRINGTON PAUL G & MARGARET R	8321 SEDONA SUNRISE DR LAS VEGAS NV 89128-8258	13821310046
HART JAMES T & JANET L	2228 FIERO DR LAS VEGAS NV 89134-6039	13820514009
HATHAWAY MARCUS & NAOMI	8201 SEDONA SUNRISE DR LAS VEGAS NV 89128-7910	13821310030
HATTORI RIE	8700 SILVER MOUNTAIN CT LAS VEGAS NV 89134-0353	13820613028
HAUCK RANDAL & ESTHER	8309 SWAN LAKE AVE LAS VEGAS NV 89128-7415	13821118055
HAVILAND ROBERT & ANA G	8233 HOLLOW WHARF DR LAS VEGAS NV 89128-7424	13821212048
HAWKINS D C & K J REV LIV TR	HAWKINS DOUGLAS C & KAREN J TRS 8312 HOLLOW WHARF DR LAS VEGAS NV 89128-7425	13821212068
HAYES HERBERT H	8712 WINTRY GARDEN AVE LAS VEGAS NV 89134-0349	13820520049
HAYWARD HARRIET A	8621 PRAIRIE HILL DR LAS VEGAS NV 89134-8415	13820516006
HEANEY BRIAN	8621 CLIFFTOP DR LAS VEGAS NV 89134-8425	13820517052
HELBLING RONALD F LIVING TRUST	HELBLING RONALD F TRS 8329 SEDONA SUNRISE DR LAS VEGAS NV 89128-8258	13821310048
HELMICK DAVID P	HELMICK RICHARD E & CATHERINE G 2109 SNOWBIRD CT LAS VEGAS NV 89128-7622	13821117038
HENDERSON STEPHEN E & DANETTE R	58 DEERWOOD DR LITTLETON CO 80127-2616	13820613081
HENDRY CHERYL	8745 SMOKEY DR LAS VEGAS NV 89134-8421	13820510008
HERNANDEZ PETER	THOMPSON STEPHANIE D 8700 SUMMER RIDGE DR LAS VEGAS NV 89134	13820613021
HERNANDEZ VICENTE V III & ALEAN	8352 SHELTERED VALLEY DR LAS VEGAS NV 89128-7621	13821117021
HERNDON TYLER W	2009 HARBOR CLIFF DR LAS VEGAS NV 89128-7461	13821215059
HERRERA JESSE & MICHELE	8705 SILVER MOUNTAIN CT LAS VEGAS NV 89134-0354	13820613030
HIDVEGHY SHARON L	8328 CRETAN BLUE LN LAS VEGAS NV 89128-7467	13821212029
HIGGINS BRIGID	2112 HILLSGATE ST LAS VEGAS NV 89134	13820217023
HIGUERA ALBERTO & VERONICA	8436 SHELTERED VALLEY DR LAS VEGAS NV 89128-7632	13820513011
HILL CONNIE M TRUST	8721 DOUBLE EAGLE DR LAS VEGAS NV 89117	13820816006
HILL GARY & AMY	8700 DIAMOND CREEK CT LAS VEGAS NV 89134-0323	13820613014
HILTON ROBERT J P & MARGARET H	2001 SEDONA PATH WY LAS VEGAS NV 89128-7968	13821310008
HIRATA TRUST BYPASS TRUST	HIRATA JANE M TRS 1724 BALDWIN PL MONTEBELLO CA 90640	13820513003
HITT JENNIFER BUCKLEY	2144 HILLSGATE ST LAS VEGAS NV 89134-0368	13820616027
HLAING MI MI	8213 EMERALD ISLE AVE LAS VEGAS NV 89128-7476	13821216026
HOEN FAMILY TRUST	HOEN LISA F RISCO TRS 2108 WATERBURY LN LAS VEGAS NV 89134-0387	13820616011
HOLTZMAN FAMILY TRUST	HOLTZMAN PHILIP A & SANDRA B TRS 8933 WINDSOR LOCKS AVE LAS VEGAS NV 89134-0380	13820211004
HONG BERKMAN & REBECCA FAMILY TR	HONG BERKMAN & REBECCA A TRS 11582 HARRISBURG RD LOS ALAMITOS CA 90720-3822	13821318002
HORN LARRY L & KAREN L	1615 PAM LN SAN JOSE CA 95120-5705	13820610031
HOWARD COBIE JR & ROMONA L	P O BOX 371596 LAS VEGAS NV 89137-1596	13820613080

Report of All Selected Parcels**Case Number:**

VAR-64887

Printed On: Thu: August 25, 2016

<u>Owner</u>	<u>Address</u>	<u>Parcel Number</u>
HSIEH ALAN	CHEN WEI-JU 923 E VALLEY BLVD #106 SAN GABRIEL CA 91776	13820610029
HSU JASON D & JACQUELINE K	22888 CANYON VIEW RD DIAMOND BAR CA 91765-3218	13820520074
HUANG HAIBO	YANG YING 4145 PORTILLA PL SAN DIEGO CA 92130-2216	13821215006
HUANG TIANYUAN	GUO YIFEI 1631 DAHILL RD #2R BROOKLYN NY 11223	13820520046
HUBERMAN ROMA TRUST AGREEMENT	HUBERMAN ROMA R TRS 8312 SEDONA SUNRISE DR LAS VEGAS NV 89128-8257	13821310004
HUDDLESTON BOB	8821 MONTAGNA DR LAS VEGAS NV 89134-6148	13820315011
HUGELMEYER FAMILY TRUST	HUGELMEYER CHARLES D & LAURA TRS 8505 CHIQUITA DR LAS VEGAS NV 89128-7914	13820813012
HUGHEY DWIGHT	DENNIS KAREN 2108 HENNIKER WY LAS VEGAS NV 89134-0336	13820211019
HUIZENGA LYLE R & B A REV LIV TR	HUIZENGA BONNIE ANN TRS 8713 SHORT PUTT DR LAS VEGAS NV 89134-8417	13820510023
HUNT THOMAS K	7890 E SPRING ST #16D LONG BEACH CA 90815-1600	13820520041
IBE LYNN M	SHAFFER DAVID 2209 ANGELFIRE ST LAS VEGAS NV 89128-7611	13821117011
IBE RAMON & TERESITA	8737 CYPRESSWOOD AVE LAS VEGAS NV 89134-0314	13820610004
ICHAKI ORI	8022 S RAINBOW #119 LAS VEGAS NV 89139	13820613067
INGENDOH DEBRA	2100 SNOWBIRD CT LAS VEGAS NV 89128-7622	13821117035
J A S INVESTMENT PROPERTIES INC	OMNI INVESTMENT PROPERTIES L L C 2451 S BUFFALO DR #132 LAS VEGAS NV 89117	13820612014
J C R GROUP L L C	1705 CORTA BELLA DR LAS VEGAS NV 89134-6176	13820520004
J G F LIVING TRUST	FABRIZIO JOSEPH G TRS 1413 CASTLE CREST DR LAS VEGAS NV 89117-7005	13820511004
J M H ASSOCIATES L L C	3782 CAMINO CODORNIZ CALABASAS CA 91302-3043	13820613084
JACKSON THOMAS TODD	HOOD-JACKSON SUSAN 2004 CANYON BREEZE DR LAS VEGAS NV 89134-0300	13820612004
JAGMIN MARIANNE	2404 SUNUP DR LAS VEGAS NV 89134-8426	13820517020
JANAKIRAM SRIDHAR	2021 CANYON BREEZE DR LAS VEGAS NV 89134	13820613051
JANUSZ KRISTINA	2028 SEDONA MORNING DR LAS VEGAS NV 89128-8484	13821210082
JARCZOK SABRINA	8225 CRETAN BLUE AVE LAS VEGAS NV 89128-7466	13821216008
JASPER PROPERTY GROUP L L C	6475 MOSS AGATE DR LAS VEGAS NV 89131	13821212022
JASPER PROPERTY GROUP L L C	6475 MOSS AGATE DR LAS VEGAS NV 89131	13821216009
JAUREGUI MARIA	8812 CYPRESSWOOD AVE LAS VEGAS NV 89134-0312	13820520071
JECKEWICZ FAMILY REVOCABLE TRUST	7821 SUMMER HARVEST AVE LAS VEGAS NV 89129	13820520029
JENKYNs CHARLES W & JANE	8525 ESTRELITO DR LAS VEGAS NV 89128-7959	13820714010
JENSEN HERBERT TRUST	JENSON HERBERT J TRS 8601 PRAIRIE HILL DR LAS VEGAS NV 89134-8415	13820516011
JENSON JAMES L	2240 FIERO DR LAS VEGAS NV 89134-6040	13820514006
JOB LISA M	2220 FIERO DR LAS VEGAS NV 89134	13820514011
JOHNS DONALD W	MARTIN PAMELA R 2109 WATERBURY LN LAS VEGAS NV 89134-0389	13820616019

Report of All Selected Parcels**Case Number:**

VAR-64887

Printed On: Thu: August 25, 2016

<u>Owner</u>	<u>Address</u>	<u>Parcel Number</u>
JOHNSON DAVID M & KELLY JO	2116 HILLSGATE ST LAS VEGAS NV 89134-0367	13820217022
JOHNSON FAMILY TRUST	JOHNSON ROBERT D & GLORIA A TRS 2013 HARBOR CLIFF DR LAS VEGAS NV 89128-7461	13821215060
JOHNSON JOEL L & MAUREEN E	8713 PRAIRIE HILL DR LAS VEGAS NV 89134	13820517005
JONES SANDRA & CHARLES	9721 ECHO HILLS DR LAS VEGAS NV 89134	13820610010
JORDAN FAMILY TRUST	JORDAN WESS M & ANDREA C RADTKE 8500 CHIQUITA DR LAS VEGAS NV 89128-7913	13820712012
JUDKIEWICZ ARON	9030 W SAHARA AVE #668 LAS VEGAS NV 89117	13821210006
JUST BE CLAUS ENTERPRISE L L C	8420 W LAKE MEAD BLVD LAS VEGAS NV 89128	13820611007
JUST IN CASE TRUST	1833 DOLCE DR LAS VEGAS NV 89134-6151	13820713012
JUSTIN JEFFREY THOMAS & LISA PAI	8529 ESTRELITA DR LAS VEGAS NV 89128	13820714011
K D S HOLDINGS L L C	10650 ALPINE FROST CT LAS VEGAS NV 89129-3224	13821218001
K J B INVESTMENTS L L C	8381 LAS LUNAS WY LAS VEGAS NV 89129-1820	13821215004
KANG IN J & HYE R	2204 ANGELFIRE ST LAS VEGAS NV 89128-7610	13821117017
KARMO-CLARK NADIA	CLARK RUSSELL 1825 FRANCISCO PEAK PL LAS VEGAS NV 89128-8276	13821318009
KATZ RANDIE S	2228 ORCHID BLOSSOM DR LAS VEGAS NV 89134-0329	13820520063
KAUFFMAN ROGER & ARLENE	8205 SEDONA SUNSET DR LAS VEGAS NV 89128-8293	13821210055
KAUFMAN KEN & KAREN FAMILY TRUST	KAUFMAN KEN W & KAREN L TRS 8809 BONTA CT LAS VEGAS NV 89134-6131	13820313014
KAUFMANN KAREN LIVING TRUST	KAUFMANN SHANE & KAREN TRS 8324 SEDONA SUNRISE DR LAS VEGAS NV 89128-8257	13820711012
KAY FAMILY TRUST	KAY LAWRENCE P & ANGELA M TRS 8312 CRETAN BLUE LN LAS VEGAS NV 89128-7465	13821212025
KAYLOR FAMILY REVOCABLE LIVING T	GREGORY-KAYLOR MARGARET TRS 4706 HALTERMAN RD ENOCH UT 84721	13820510010
KAZEMZADEH FAMILY TRUST	KAZEMZADEH MAHMOOD & SHAHLA TRS 7925 MAESTRO AVE WEST HILLS CA 91304	13821310044
KAZMIERSKI MARVIN T TRUST	KAZMIERSKI MARVIN T TRS 8657 PRAIRIE HILL DR LAS VEGAS NV 89134	13820517013
KELLEY'S HEROES L L C	8809 CORTILE DR LAS VEGAS NV 89134-6153	13820314015
KELLY DON I & MURIEL PARKER	8229 SEDONA SUNRISE DR LAS VEGAS NV 89128-7912	13821310037
KELLY KEVIN M	ROSEHILL PAIGE K 6029 S FORT APACHE RD #100 LAS VEGAS NV 89148-5563	13820517048
KENNEDY STEPHEN M & P L FAM TR	KENNEDY STEPHEN & PATRICIA TRS 8233 SEDONA SUNSET DR LAS VEGAS NV 89128-7965	13821210062
KERN ROBERT	8337 CRETAN BLUE LN LAS VEGAS NV 89128-7470	13821212010
KETCHUM FAMILY TRUST	KETCHUM GEORGE E & BONNIE J TRS 8620 PRAIRIE HILL DR LAS VEGAS NV 89134	13820517037
KIM BOK S	8921 WINDSOR LOCKS AVE LAS VEGAS NV 89134-0380	13820219001
KIM JAE & BYUNG	8805 SUMMER RIDGE DR LAS VEGAS NV 89134-0346	13820612019
KIM SAMUEL I & EUN JOO	8621 ESTRELITA DR LAS VEGAS NV 89128-8234	13820816002
KIRSKY EMMETT A TRUST	KIRSKY EMMETT A TRS 4850 GERANIUM PL OAKLAND CA 94619-3037	13820516014
KISSEL FAMILY REVOCABLE LIVING T	KISSEL ROBERT SCOTT & KRISTEN JU 8176 SEDONA SUNSET DR LAS VEGAS NV 89128	13821210022

Report of All Selected Parcels**Case Number:**

VAR-64887

Printed On: Thu: August 25, 2016

<u>Owner</u>	<u>Address</u>	<u>Parcel Number</u>
KITTILSEN RONALD J & SHARON LEE	2021 HARBOR CLIFF DR LAS VEGAS NV 89128	13821215062
KITTIPONGDAJA LIVING TRUST	KITTIPONGDAJA SRIRATANA TRS 8609 ESTRELITA DR LAS VEGAS NV 89128-8234	13820714013
KLEUTGENS JOERG	LIFSHITZ NIVI 8321 SWAN LAKE AVE LAS VEGAS NV 89128-7415	13821118058
KLIJANOWICZ BRIAN	8320 HOLLOW WHARF DR LAS VEGAS NV 89128-7425	13821212070
KLONER LOUISE Z	8433 APPLE HILL CT LAS VEGAS NV 89128-7635	13820513008
KNIPPEL JUSTIN L	2020 SEDONA CREEK CIR LAS VEGAS NV 89128-8215	13821210075
KNOEPEL RICHARD M & DANIELLE E	8425 PASEO VISTA DR LAS VEGAS NV 89128-8274	13820716009
KO EDWARD KING-HANG	GUAN MINDY XIAOMIN 1575 PLYMOUTH AVE SAN FRANCISCO CA 94112	13820520017
KODRA ALFRED & FATMIRA	2209 HARBOR CLIFF DR LAS VEGAS NV 89128-7419	13821118063
KOHISTANI FAMILY LIVING TRUST	KOHISTANI HAIDER & MASOOMA TRS 8344 EMERALD ISLE AVE LAS VEGAS NV 89128-7500	13821215002
KONOPKA CLEMENTINE M	2412 SPRINGRIDGE DR LAS VEGAS NV 89134	13820512004
KONRAD INVESTMENTS L L C	2020 EMERY ST LAS VEGAS NV 89134-5200	13820510016
KOONCE JAMES B & SHANNON E	2205 HARBOR CLIFF DR LAS VEGAS NV 89128-7419	13821118062
KOONS ALEX W & STEPHANIE L	1961 CANYON BREEZE DR LAS VEGAS NV 89134	13820114013
KOTWICA JEROME J & ELZBIETA M	8336 BRITTANY HARBOR DR LAS VEGAS NV 89128-7492	13821215033
KRACK C V FAMILY TRUST	KRACK VINCENT J & CAROLYN M TRS 1968 CANYON BREEZE DR LAS VEGAS NV 89134-0327	13820613059
KRAMER HAROLD & ESTELLE	8633 PRAIRIE HILL DR LAS VEGAS NV 89134-8415	13820516003
KRAWCZYK ROBERT A & REGINA E	2430 STERLING CREEK PKWY OVIEDO fl 32766	13820818017
KRELLENSTEIN STANLEY & EILEEN	KRELLENSTEIN SCOTT 8336 SEDONA SUNRISE DR LAS VEGAS NV 89128-8257	13820711013
KRUEGER LANCE A & DORI L	2013 SEDONA PATH WY LAS VEGAS NV 89128-7968	13821210069
KUCHAR ROGER & ELAINE FAM LIV TR	KUCHAR ROGER T & ELAINE J TRS 1816 MADERA CANYON PL LAS VEGAS NV 89128-7949	13820712009
KURTZE LORRAINE & JERRY	KURTZE JERRY J 10294 SOFFERTO AVE LAS VEGAS NV 89135-3247	13821210057
KWASNESKI STEVEN R & SUSAN M	8624 MAGNOLIA RIDGE AVE LAS VEGAS NV 89134-0333	13820520016
L C MILLER FAMILY TRUST	MILLER LARRY I & CANDACE L TRS 2120 BACHELOR CT LAS VEGAS NV 89128-7620	13821117022
L J G LIVING TRUST	GIUSTI LUIGI & JOYCE TRS 10631 ANGELO TENERO AVE LAS VEGAS NV 89135	13820510024
LACAMBRA BRENDA	8220 BRITTANY HARBOR DR LAS VEGAS NV 89128-7498	13821216035
LAIN GABRIELA C	8353 BRITTANY HARBOR DR LAS VEGAS NV 89128-7493	13821215054
LANDRUS RONALD K & MARIEANNE	8200 SEDONA SUNRISE DR LAS VEGAS NV 89128-7909	13821310019
LANDSEM LARRY A JR & KRISTY K	2017 SEDONA CREEK CIR LAS VEGAS NV 89128	13821210077
LARRABEE ALAN W	1 KELLOGG CT LEEDS NY 12451	13820517010
LASCALA EMILIO & MARIA D	8213 BRITTANY HARBOR DR LAS VEGAS NV 89128-7499	13821216043
LEACH FAMILY TRUST	LEACH SHANNON P & JOANN Z TRS 8400 PASEO VISTA DR LAS VEGAS NV 89128	13821318001

Report of All Selected ParcelsCase Number:

VAR-64887

Printed On: Thu: August 25, 2016

<u>Owner</u>	<u>Address</u>	<u>Parcel Number</u>
LEAVITT WILLIAM P & SUSAN LINDA	8320 ARROYO JUSTIN AVE LAS VEGAS NV 89128-8278	13821317008
LEBOEUF CAROL	2412 DESERT BUTTE DR LAS VEGAS NV 89134-8865	13820517027
LECHTRECK ROBERT T & MARTHA E	2028 SEDONA CREEK CIR LAS VEGAS NV 89128-8215	13821210073
LEDBETTER JOHN S TRUST	LEDBETTER JOHN S TRS 2016 EVENING GLOW DR LAS VEGAS NV 89134-0322	13820613012
LEE LARRY & JACQUEITA M	8428 APPLE HILL CT LAS VEGAS NV 89128-7635	13820513004
LEFFNER GARY L & TERI L	8353 EMERALD ISLE AVE LAS VEGAS NV 89128-7501	13821215028
LEGER WILLIAM & EVANGELINE	2633 LOTUS HILL DR LAS VEGAS NV 89134-7858	13820516013
LEIBOWITZ STEVEN	653 TOWN CENTER DR #102 LAS VEGAS NV 89144-0515	13821310040
LENORE PROPERTIES L L C	8700 MAGNOLIA RIDGE LAS VEGAS NV 89134-0334	13820520014
LEON-GUERRERO RAYMOND	JAVIER NANETTE 8220 SEDONA SUNSET DR LAS VEGAS NV 89128-7966	13821210016
LERNER MARK & LYNNE TRUST R-501	LERNER MARK D & LYNNE T TRS 8316 PASEO VISTA DR LAS VEGAS NV 89128-8244	13821317027
LESLIE BRUCE A	2416 RANCHO BEL AIR LAS VEGAS NV 89107-2344	13821117007
LEV OVADIA & AMILIA	16911 VALLE VERDE RD POWAY CA 92064-1209	13821310045
LEYSEN FAMILY TRUST	LEYSEN JAN U & LILLIAN A CO-TRS P O BOX 370475 LAS VEGAS NV 89137-0475	13820511006
LI ZIYI	SHEN YUHONG 15 TRIMBLE TURN HOCKESSIN de 19707	13820519003
LILLY PATRICIA	8804 CRESCENT RIDGE LN LAS VEGAS NV 89134-0304	13820613054
LIM FAMILY TRUST	LIM EDMOND M & ANNETTE TRS 6 ESTERO AVE SAN FRANCISCO CA 94127-2847	13820610009
LIMAS DAVID L	8828 BONTA CT LAS VEGAS NV 89134	13820313008
LINDSEY ANDREA	8321 CRETAN BLUE LN LAS VEGAS NV 89128-7468	13821212014
LIOTINE FAMILY REVOCABLE LIV TR	LIOTINE MICHAELANGELO & C TRS 8324 CRETAN BLUE LN LAS VEGAS NV 89128-7467	13821212028
LIPPERT TERRY L & JEROLYN J	8324 W CHARLESTON BLVD LAS VEGAS NV 89117-9200	13821210053
LITTLE BABY INVESTMENTS L L C	9119 130TH AVE NE KIRKLAND WA 98033-5923	13820711011
LIU CHO Y & KA LING FAMILY TRUST	953 HICKORY PARK ST LAS VEGAS NV 89138-7596	13820217021
LIVENGOOD FAMILY REVOCABLE LIV T	LIVENGOOD THOMAS J & MARY K TRS 2112 SNOWBIRD CT LAS VEGAS NV 89128	13821117032
LLOYD VANN MILLER & ANNABELLE R	8437 DUTCH HILL CT LAS VEGAS NV 89128-7624	13820513002
LOFFREDO STEPHANI & JERRY LIVING	LOFFREDO JERRY J & STEPHANI TRS 8608 MAGNOLIA RIDGE AVE LAS VEGAS NV 89134-0333	13820520020
LOHMANN TRAVIS	8920 WINDSOR LOCKS AVE LAS VEGAS NV 89134-0378	13820211024
LOMAN DOUGLAS E & VICTORIA L	8524 CHIQUITA DR LAS VEGAS NV 89128	13820813003
LOMBARDI ANGELO P & PAMELA F	8709 SHORT PUTT DR LAS VEGAS NV 89134-8417	13820510022
LOMBARDO ROCKY J & RUTH N	8332 BRITTANY HARBOR DR LAS VEGAS NV 89128-7492	13821215034
LOONEY MARK W & LYNN A	8224 EMERALD ISLE AVE LAS VEGAS NV 89128-7478	13821216021
LOTT FAMILY TRUST	LOTT THOMAS L & MARY V TRS 8829 CYPRESSWOOD AVE LAS VEGAS NV 89134	13820520079

Report of All Selected Parcels**Case Number:**

VAR-64887

Printed On: Thu: August 25, 2016

<u>Owner</u>	<u>Address</u>	<u>Parcel Number</u>
LOWELL SHAWN P	612 PIER 2 LINCOLN NE 68528	13821121005
LUGO ANNA B	8804 STAFFORD SPRINGS DR LAS VEGAS NV 89134-0373	13820616004
LUGO'S VINETREE-K20 RANCH L L C	5740 N JULIANO RD LAS VEGAS NV 89149-3906	13821215055
LUH HENRY & SONIA	LUH FRANK 1575 PASQUALLITO DR SAN MARINO CA 91108-2340	13821212006
LUKAC PETER & AMELIA	8341 EMERALD ISLE AVE LAS VEGAS NV 89128	13821215025
LUND KENNETH J	FLYNN BEATRIZ E 8629 PRAIRIE HILL DR LAS VEGAS NV 89134-8415	13820516004
LUXEMBOURG LAS VEGAS PROPERTY HO	P O BOX 751330 LAS VEGAS NV 89136	13820217018
LY KEAR THENG	19378 E PILARIO ST ROWLAND HTS CA 91748-3141	13820513005
LYONS FAMILY TRUST	LYONS STEVEN J & GAIL TRS 8820 MONTAGNA DR LAS VEGAS NV 89134-6146	13820315015
LYONS STEPHEN & MARLENE	5645 COE ESTATES CT LAS VEGAS NV 89149	13817811068
M B A TRUST	ADAWAY M BLAIR TRS 8609 CLIFFTOP DR LAS VEGAS NV 89134-8425	13820517049
MACDONALD WILLIAM F JR & E	8832 CORTILE DR LAS VEGAS NV 89134-6141	13820314022
MACHETTE FAMILY TRUST	MACHETTE WILLIAM & JULIE TRS 8704 CRESCENT RIDGE LN LAS VEGAS NV 89134-0302	13820613006
MAFIE SAM	ETEMADI AZAM 1933 SEDONA PASEO LN LAS VEGAS NV 89128	13820711002
MAHBOOBI FARAHNAZ	JAHED ATAULLAH 1476 WILLOWMONT AVE SAN JOSE CA 95118	13820520019
MAJESKI JOEL R	8605 PALE MOON CT LAS VEGAS NV 89134-0357	13820610017
MALARDIER GHISLAIN	BART NATASAH JEAN 8328 HOLLOW WHARF DR LAS VEGAS NV 89128-7427	13821121008
MALEK CAMERON J	722 CYPRESS HILLS RD ENCINATAS CA 92024	13820610003
MALLENKE ANTHONY DEAN LIVING TRUS	MALLENKE ANTHONY DEAN TRS 8244 SEDONA SUNSET DR LAS VEGAS NV 89128	13821210010
MANN ANNETTE L & LUCIENNE J	2005 SEDONA PATH WY LAS VEGAS NV 89128-7968	13821210067
MANUKYAN ARPINE	8325 CRETAN BLUE LN LAS VEGAS NV 89128-7468	13821212013
MARCEK CLIFF W	8325 PASEO VISTA DR LAS VEGAS NV 89128-8246	13821317019
MARCELLUS FAMILY TRUST	MARCELLUS SCOTT O & NANCY C TRS 8324 EMERALD ISLE AVE LAS VEGAS NV 89128-7479	13821215007
MARESH JEFFREY L & KAREN M	8324 PASEO VISTA DR LAS VEGAS NV 89128-8244	13821317025
MARGOLIN SANDY	8220 SEDONA SUNRISE DR LAS VEGAS NV 89128	13821310014
MARSH ROBERT & KELLY	8709 WINTRY GARDEN AVE LAS VEGAS NV 89134-0350	13820610039
MARSKE LARRY K & LORRAINE C	8909 WINDSOR LOCKS AVE LAS VEGAS NV 89134-0379	13820217006
MARTIN SHAUN H & ERIN-MARIE	2020 EVENING GLOW DR LAS VEGAS NV 89134-0322	13820613011
MARTINEZ JUSTEN	1729 WANDERING WINDS WY LAS VEGAS NV 89128-7978	13821210084
MARTINEZ JUSTEN	1729 WANDERING WINDS WY LAS VEGAS NV 89128-7978	13821210004
MARTINEZ TONY & ANNE M FAMILY TR	MARTINEZ TONY B & ANNE M TRS 8504 CHIQUITA DR LAS VEGAS NV 89128-7913	13820712013
MARTIN-PRICE CANDICE M	PRICE JARED I 8705 CRESCENT RIDGE LN LAS VEGAS NV 89134	13820613009

Report of All Selected Parcels**Case Number:**

VAR-64887

Printed On: Thu: August 25, 2016

<u>Owner</u>	<u>Address</u>	<u>Parcel Numbe</u>
MARUMOTO GLEN S	98-1798 KAAHUMANU ST #60D PEARL CITY HI 96782-1879	13820610012
MARVIN ALAN D	8809 STAFFORD SPRINGS DR LAS VEGAS NV 89134-0375	13820616024
MARVIN MARY LIVING TRUST	MARVIN MARY TRS 8616 PRAIRIE HILL DR LAS VEGAS NV 89134-8413	13820517038
MATSON GARFIELD & BRENDA	8624 PRAIRE HILL DR LAS VEGAS NV 89134	13820517036
MATTHIESSEN LIVING TRUST	MATTHIESSEN RONALD M & C E TRS 2251 N RAMPART BLVD LAS VEGAS NV 89128-7640	13820517044
MATUSIAK GEORGE & HALINA	2024 SEDONA CREEK CIR LAS VEGAS NV 89128-8215	13821210074
MAVADY KAYKKHAM	MCKAY-MAVADY KATHRYN ANN 1812 PASEO OVERLOOK CT LAS VEGAS NV 89128-8275	13821318007
MAXWELL WILLIAM H	8605 PRAIRIE HILL DR LAS VEGAS NV 89134-8415	13820516010
MAYER ROBERT L & ERICA E	2201 ORCHID BLOSSOM DR LAS VEGAS NV 89134-0321	13820520081
MAYORAL SERGIO ANDREW	2004 WATERBURY LN LAS VEGAS NV 89134-0383	13820217002
MAZZULLA DONALD S & L REV LIV TR	MAZZULLA DONALD S & LORA A TRS 8724 AZURE SKY DR LAS VEGAS NV 89129-2223	13821210017
MAZZULLA DONALD S & L REV LIV TR	MAZZULLA DONALD S & LORA A TRS 8724 AZURE SKY DR LAS VEGAS NV 89129-2223	13820711014
MCCANN BRETT W & VICKI A	2133 HILLSGATE ST LAS VEGAS NV 89134-0370	13820211031
MCCLELLAN MITCH C & MARY LOU	2140 HILLSGATE ST LAS VEGAS NV 89134	13820616028
MCCONNELL MICHAEL S & DEBORAH A	8201 SEDONA SUNSET DR LAS VEGAS NV 89128	13821210054
MCDONAL NEIL & KAREN LIVING TR	MCDONAL WARREN N & KAREN C TRS 2012 SEDONA MORNING DR LAS VEGAS NV 89128-8484	13820615012
MCDONALD JAMES & NANCY TRUST	MCDONALD JAMES R & NANCY A TRS 2404 DESERT GLEN DR LAS VEGAS NV 89134-8871	13820511003
MCFADDEN PATRICK & I G SR REV TR	MCFADDEN PATRICK SR & INCI TRS 2008 SEDONA PATH WAY LAS VEGAS NV 89128-7967	13821210066
MCFARLAND THERESA	2104 SNOWBIRD CT LAS VEGAS NV 89128-7622	13821117034
MCGOVERN TIMOTHY M & MEGAN M	2104 HILLSGATE ST LAS VEGAS NV 89134-0367	13820217025
MCGUIRE QUINN PHILLIP	8208 SEDONA SUNRISE DR LAS VEGAS NV 89128-7909	13821310017
MCMENEMY IAN & AMANDA J	8216 BRITTANY HARBOR DR LAS VEGAS NV 89128	13821216034
MEADOWS JAMES & ANDREA	8236 SEDONA SUNRISE DR LAS VEGAS NV 89128-7911	13821310010
MEADOWS SCHOOL	8601 SCHOLAR LN LAS VEGAS NV 89128-7302	13820701004
MEADOWS SCHOOL	8601 SCHOLAR LN LAS VEGAS NV 89128-7302	13820701005
MECH GREGORY A & KAREN R	2605 VERMONT AVE JOPLIN MO 64804-2958	13821212001
MEHOCIC GEORGE R & D 1989 LIV TR	MEHOCIC GEORGE R & DENISE A TRS 420 SAINT ANDREWS CT LAS VEGAS NV 89144-0815	13820517014
MEISEL STEVE & KATHLEEN	8217 CRETAN BLUE LN LAS VEGAS NV 89128-7474	13821216010
MEJIA SANDRA	8316 CRETAN BLUE LN LAS VEGAS NV 89128-7467	13821212026
MELWAK ERIN JEAN & JOHN	1913 SEDONA PASEO LN LAS VEGAS NV 89128	13820711007
MENAKER BERNARD & GARY S	8808 CYPRESS WOOD AVE LAS VEGAS NV 89134-0312	13820520072
MENCHACA JUAN G	TAPIA MARIAN IRAN 8704 DIAMOND CREEK CT LAS VEGAS NV 89134-0323	13820613013

Report of All Selected Parcels**Case Number:**

VAR-64887

Printed On: Thu: August 25, 2016

<u>Owner</u>	<u>Address</u>	<u>Parcel Number</u>
MENDIOLA ROMUALDO J REVOCABLE TR	MENDIOLA ROMUALDO J TRS 1452 VASCO RD #122 LIVERMORE CA 94551	13820613082
MENG DONALD B JR & KARLA FAM TR	MENG DONALD B JR & KARLA A TRS 8327 BOWMAN WOODS CIR LAS VEGAS NV 89129	13821118034
MEPPEN RUSSELL M & FRANCINE	MEPPEN NOAM P O BOX 16308 ENCINO CA 91416-6308	13820520077
METRIKIN ARKADIY & RITA	1601 N FULLER AVE #502 LOS ANGELES CA 90046	13821212037
MICEK MARC	TADANO HIROKO 8316 EMERALD ISLE AVE LAS VEGAS NV 89128-7479	13821215009
MICOZ GREG J & LINDA K	1965 CANYON BREEZE DR LAS VEGAS NV 89134-0328	13820613040
MILANOWSKI CYNTHIA G 1998 TRUST	MILANOWSKI CYNTHIA GUNTER TRS 8520 CHIQUITA DR LAS VEGAS NV 89128-7913	13820813002
MILES CHU LI TRUST	8220 CRETAN BLUE LN LAS VEGAS NV 89128-7465	13821216006
MILKE MICHAEL D	2133 DRIFTING CLOUD CIR LAS VEGAS NV 89134-0342	13820520038
MILKO PAUL & YVONNE L REV LIV TR	MILKO PAUL & YVONNE LAURA TRS 2125 FOUNTAIN VIEW DR LAS VEGAS NV 89134-0318	13820610025
MILLER JUDITH A	4396 E PHILLIPS PL CENTENNIAL CO 80122-3908	13820517032
MILLER LAWYER B & MARILYN P	8356 SHELTERED VALLEY DR LAS VEGAS NV 89128-7621	13821117020
MILLS HUNTER G	2012 SEDONA PATH WY LAS VEGAS NV 89128-7967	13821210065
MINASIAN KENNETH P	15 BROAD ST NASSUA NH 03064-2002	13820520047
MINGO FAMILY TRUST	MINGO EDWARD & BRENDA J TRS 8821 CORTILE DR LAS VEGAS NV 89134-6153	13820314012
MINX HUBERT & KATHRYN TRUST	MINX HUBERT JR &/OR KATHRYN E TR 1905 SEDONA PASEO LN LAS VEGAS NV 89128-8287	13820711009
MIRO-QUESADA JOSE LUIS	PORTUONDO MARIA 8705 WINTRY GARDEN AVE LAS VEGAS NV 89134-0350	13820610040
MITCHELL BENNETT E & DEBBIE T	8220 PASEO VISTA DR LAS VEGAS NV 89128-8240	13821216041
MITTENZWEI FAMILY TRUST	MITTENZWEI DAVID F & BETTY TRS 8217 EMERALD ISLE AVE LAS VEGAS NV 89128-7476	13821216025
MIYAGI TAMIKO JOBE	8449 SHELTERED VALLEY DR LAS VEGAS NV 89128-7633	13820513015
MLADENOFF DOREEN	6239 ORANGEWOOD DR ALTA LOMA CA 91701-3435	13820517042
MOLINA MANUEL & SANDRA J	8300 HOLLOW WHARF DR LAS VEGAS NV 89128-7423	13821212065
MOODY INCOME TRUST	10941 KEYMAR DR LAS VEGAS NV 89135	13820610019
MOORE THERESA H	8928 WINDSOR LOCKS AVE LAS VEGAS NV 89134-0378	13820211022
MOR ERICK & GRACE	2016 CANYON BREEZE DR LAS VEGAS NV 89134-0300	13820612007
MORGAN ALICE B	MORGAN WILMON L & ALICE B 2101 RICO PEAK CT LAS VEGAS NV 89128-7634	13820518004
MORRIS DELIA M	1937 SEDONA PASEO LN LAS VEGAS NV 89128	13820711001
MORRIS NANCE L & RUTH M	8528 CHIQUITA DR LAS VEGAS NV 89128-7913	13820816008
MOSES FLEMMING & ELIZABETH	2213 HARBOR CLIFF DR LAS VEGAS NV 89128-7419	13821118064
MOYER FAMILY TRUST	MOYER DALLAS H & VIRGINIA L TRS 1908 VERO DR LAS VEGAS NV 89134-6154	13820715003
MUELLER FAMILY TRUST	MUELLER MICHAEL J & DONNA L CO-T 2112 RICO PEAK CT LAS VEGAS NV 89128	13821117041
MUELLER JOSEPH M & MARGARET L	2136 HILLSGATE ST LAS VEGAS NV 89134-0368	13820616029

Report of All Selected Parcels**Case Number:**

VAR-64887

Printed On: Thu: August 25, 2016

<u>Owner</u>	<u>Address</u>	<u>Parcel Number</u>
MULTESCU DANIEL & CAMELIA	8328 BRITTANY HARBOR DR LAS VEGAS NV 89128-7489	13821215035
MUNOZ JULIAN & ROSE	3115 S GERONIMO DR OXNARD CA 93033-5637	13820520064
MURATORE MARY	8308 PASEO VISTA DR LAS VEGAS NV 89128	13821317029
MURRAH DANA & ROBERT	8304 PASEO VISTA DR LAS VEGAS NV 89128	13821317030
MURRAY ROBERT E II	GRAVES-MURRAY CATHERINE L 1901 SEDONA PASEO LN LAS VEGAS NV 89128-8287	13820711010
MUZDEKA SUSAN E WILHELM	2001 HARBOR CLIFF DR LAS VEGAS NV 89128	13821215057
MYCHAJLONKA RONALD J & MARY ANN	8737 SUNDIAL DR LAS VEGAS NV 89134-8424	13820510025
MYERS LONNY	2108 HILLSGATE ST LAS VEGAS NV 89134	13820217024
N C R TRUST	RADETICH NINA CATHERINE TRS 2232 FIERO DR LAS VEGAS NV 89134-6040	13820514008
NAGLE SUZANNE M	8924 WINDSOR LOCKS AVE LAS VEGAS NV 89134-0378	13820211023
NAHUM MOSHE	2029 PARADISE PEAK DR LAS VEGAS NV 89134-0309	13820612010
NAHUM MOSHE	2029 PARADISE PEAK DR LAS VEGAS NV 89134	13821110010
NARDONE SALVATORE M & LORI J	1821 DOLCE LN LAS VEGAS NV 89134-6151	13820713009
NAVARRO JOHN H & REMEDIOS V	2005 FAYWOOD AVE LAS VEGAS NV 89134-6211	13820610035
NEHORAOFF RICKY J	3663 LAS VEGAS BLVD SO #425 LAS VEGAS NV 89109-1978	13820610006
NEILL HELEN R LIVING TRUST	NEILL HELEN R TRS 8624 ESTRELITA DR LAS VEGAS NV 89128	13820818019
NEWLIFE TRUST	7832 COCOA BEACH CIR LAS VEGAS NV 89128	13821212067
NEWMAN CRAIG SAMUEL & DENISE	8829 CORTILE DR LAS VEGAS NV 89134-6142	13820314010
NICKLAUS TRUST	901 VILLE FRANCHE ST LAS VEGAS NV 89145	13820714005
NICOLIS TIMOTHY & ROBIN R	8313 CRETAN BLUE LN LAS VEGAS NV 89128-7466	13821212016
NITZ ASHLEY E	2104 FOUNTAIN VIEW DR LAS VEGAS NV 89134-0316	13820610014
NOBLE ALVIN	2028 WATERBURY LN LAS VEGAS NV 89134-0384	13820616013
NOCHO CARL J & JANE M	8316 SEDONA SUNRISE DR LAS VEGAS NV 89128-8257	13821310003
NOCIS JULIE ANN	1977 CANYON BREEZE DR LAS VEGAS NV 89134	13820613043
NOOSE FAMILY TRUST	NOOSE TERRENCE L & JOANNE TRS 1929 SEDONA PASEO LN LAS VEGAS NV 89128-8289	13820711003
NOPKARS SAIYON & PRANEE	2121 MISTY MEADOW DR LAS VEGAS NV 89134-0348	13820610045
NORDIC PONY L L C	1532 CHAMPION HILLS LN LAS VEGAS NV 89134	13820615015
NORMAN ROBERT	2108 FOUNTAIN VIEW DR LAS VEGAS NV 89134-0316	13820610015
NOYES KIMBERLY A	BELL JEFFERY A 8832 BONTA CT LAS VEGAS NV 89134	13820313007
O'BRIEN MARY ELLEN LIVING TRUST	WASAK VREONICA M TRS 8661 PRAIRIE HILL DR LAS VEGAS NV 89134	13820517012
O'BRIEN MAUREEN REVOCABLE TRUST	O'BRIEN MAUREEN TRS 8636 PRAIRIE HILL DR LAS VEGAS NV 89134	13820517033
OCKENFELS JASON & KRISTEN M	2008 EVENING GLOW DR LAS VEGAS NV 89134-0306	13820613017

Report of All Selected Parcels**Case Number:**

VAR-64887

Printed On: Thu: August 25, 2016

<u>Owner</u>	<u>Address</u>	<u>Parcel Number</u>
O'CONNELL EDWARD C JR & SUSAN L	8809 SILVER MOUNTAIN CT LAS VEGAS NV 89134-0361	13820613069
O'CONNOR ANNE K & JOSHUA P	8305 EMERALD ISLE AVE LAS VEGAS NV 89128-7477	13821215016
O'CONNOR DENNIS J & CECILIA M	8340 BRITTANY HARBOR DR LAS VEGAS NV 89128	13821215032
O'CONNOR MICHAEL PATRICK	OCONNOR MICHELLE MARIE 8833 CYPRESSWOOD AVE LAS VEGAS NV 89134	13820520080
O'FLAHERTY JOHN T & BECKY	P O BOX 990 LAS VEGAS NV 89125	13821211002
OH KATHRYN	OH-BILODEAU MARSHA 18011 S AVERY PL GARDENA CA 90248-3712	13821212069
O'HARE BRIAN J & ANGELA M	8236 SEDONA SUNSET DR LAS VEGAS NV 89128	13821210012
OLECH EWA	DAVIS CRAIG 1828 DOLCE DR LAS VEGAS NV 89134	13820713001
OLLIVIER KEVIN M & MASAKO M	8321 EMERALD ISLE AVE LAS VEGAS NV 89128-7480	13821215020
OMOHUNDRO TIPTON T & C L FAM TR	OMOHUNDRO TIPTON & CHARLOTTE TRS 2113 SNOWBIRD CT LAS VEGAS NV 89128-7622	13821117039
O'NEILL BARRY P	8300 BRITTANY HARBOR DR LAS VEGAS NV 89128-7495	13821215042
ORR CHARLES L & SUZANN C	2036 E OAK MANOR DR SANDY UT 84092-6224	13821210007
P M C L V L L C	3065 S JONES BLVD #201 LAS VEGAS NV 89146	13820614011
P M C L V L L C	3065 S JONES BLVD #201 LAS VEGAS NV 89146	13820614007
PAGDANGANAN BOBBY F & NORAIN	8708 CRESCENT RIDGE LN LAS VEGAS NV 89134-0302	13820613005
PAGLINI JOHN A & KAREN L	1836 DOLCE DR LAS VEGAS NV 89134-6150	13820715006
PAGONE JACQUELINE	8320 EMERALD ISLE AVE LAS VEGAS NV 89128-7479	13821215008
PALMER FAMILY 1991 REV LIV TR	PALMER STEPHEN M & MELISSA TRS 2746 HARTWICK LN LAS VEGAS NV 89134	13820517047
PANSEK DOROTHY REVOCABLE TRUST	8441 SHELTERED VALLEY DR LAS VEGAS NV 89128-7633	13820513017
PANTLE CURTIS & GERALDINE REV TR	PANTLE CURTIS & GERALDINE TRS 8300 PASEO VISTA DR LAS VEGAS NV 89128-8243	13821317031
PAPERNO HERBERT & JUDITH	2408 SPRINGRIDGE DR LAS VEGAS NV 89134-8843	13820512003
PAPPER ROBERT & CAROLE TRUST	PAPPER ROBERT & CAROLE CLARK TRS 8516 ESTRELITA DR LAS VEGAS NV 89128-7958	13820712001
PAQUETTE PATRICIA TRUST	PAQUETTE PATRICIA K TRS 2021 EVENING GLOW DR LAS VEGAS NV 89134	13820613078
PARHAMOVICH WALTER & GRACE MARY	8425 APPLE HILL CT LAS VEGAS NV 89128-7635	13820513009
PARK DANIEL & JI YOUNG	8801 BONTA CT LAS VEGAS NV 89134	13820313012
PARRALES MARTIN F & DEBORAH J	2009 CANYON BREEZE DR LAS VEGAS NV 89134-0301	13820613048
PARRILLO MARK A	XU YUN 8820 CYPRESSWOOD AVE LAS VEGAS NV 89134-0312	13820520069
PARRISH STEPHEN WAYNE & SUSAN L	1821 FRANCISCO PEAK PL LAS VEGAS NV 89128-8276	13821318010
PARSON TIMOTHY W & DEBRA	8216 EMERALD ISLE AVE LAS VEGAS NV 89128-7475	13821216019
PARTRIDGE W CRAIG & DOROTHY J	8904 STAFFORD SPRINGS DR LAS VEGAS NV 89134-0338	13820519002
PATTON RAMPART II L L C	41 CORPORATE PARK #250 IRVINE CA 92606-5179	13820522005
PATTON RAMPART L L C	41 CORPORATE PARK #250 IRVINE CA 92606-5179	13820522002

Report of All Selected Parcels**Case Number:**

VAR-64887

Printed On: Thu: August 25, 2016

<u>Owner</u>	<u>Address</u>	<u>Parcel Number</u>
PATTON RAMPART L L C	41 CORPORATE PARK #250 IRVINE CA 92606-5179	13820522003
PAXMONT TRUST	PAXTON KRISTIN R TRS 8301 PASEO VISTA DR LAS VEGAS NV 89128-8245	13821317014
PEACE REALTY L L C	16 WOODHILL RD TRUMBULL CT 06611-3356	13820613008
PEARCE FAMILY TRUST	PEARCE ROBERT S & ZENAIDA TRS 8437 APPLE HILL CT LAS VEGAS NV 89128-7635	13820513007
PECORE BART	5223 PORTLAND CT NORTH LAS VEGAS NV 89031-0502	13820510019
PENDLETON BRAD & DEBBIE	8301 HOLLOW WHARF DR LAS VEGAS NV 89128-7424	13821212046
PERKINS ROBERT	8333 EMERALD ISLE AVE LAS VEGAS NV 89128	13821215023
PERLIN LIVING TRUST	PERLIN HARRY M OR SUE TRS 2101 HARBOR CLIFF DR LAS VEGAS NV 89128-7460	13821212003
PERRIN DONALD REVOCABLE TRUST	PERRIN DONALD TRS 8225 SEDONA SUNSET DR LAS VEGAS NV 89128-7965	13821210060
PFERSCHING WILLIAM L	8448 SHELTERED VALLEY DR LAS VEGAS NV 89128-7632	13820513014
PHILLIPS DAMIAN A	2033 HARBOR CLIFFS DR LAS VEGAS NV 89128-7461	13821212005
PIERCE RICKY D LIVING TRUST	PIERCE RICKY DEAN TRS 2401 DESERT GLEN DR LAS VEGAS NV 89134	13820517041
PIKE ROBERT H III & ELAINE Z	2012 WATERBURY LN LAS VEGAS NV 89134-0383	13820616017
PISANI FRANK & ROSMARIE	8228 EMERALD ISLE AVE LAS VEGAS NV 89128-7478	13821215014
PISHKO MITCHELL & KRISTI	8817 MONTAGNA DR LAS VEGAS NV 89134-6147	13820315012
PITSICALIS ARLENE	8221 SEDONA SUNRISE DR LAS VEGAS NV 89128-7912	13821310035
PITTS BILL C TRUST	PITTS BILL C TRS 8649 PRAIRIE HILL DR LAS VEGAS NV 89134-8415	13820517015
PITTS GARY W	8353 SUGAR BOWL CT LAS VEGAS NV 89128-7607	13821112028
PLOTKIN FAMILY TRUST	PLOTKIN DIANE TRS 8566 COLUSA CIR #901-D HUNTINGTON BEACH CA 92646-5687	13820517039
PO GREGORY	P O BOX 370913 LAS VEGAS NV 89137	13820314018
PO PEARS L T D	8156 WALDEN LAKE ST LAS VEGAS NV 89131-6710	13820517001
POLITO NANCY G & FRANK J JR	8324 BRITTANY HARBOR DR LAS VEGAS NV 89128-7489	13821215036
PORTER WILLIAM D JR & DORIS A	8725 SMOKEY DR LAS VEGAS NV 89134-8421	13820515002
POSIN MITCHELL LEE	GRAMONT ANITA L 8429 PASEO VISTA DR LAS VEGAS NV 89128-8274	13820716008
POTTER STEVEN M	2128 HENNIKER WAY LAS VEGAS NV 89134	13820211014
POTTS GARTH & ANN	2204 BEAR VALLEY ST LAS VEGAS NV 89128	13821112031
PRASAD SANJEEV	9750 GLISTENING BROOK CT LAS VEGAS NV 89149	13820520033
PREDOI FLORIN A	8705 DIAMOND CREEK CT LAS VEGAS NV 89134	13820613016
PRIETO CHRISTI A & JILLIAN	1817 DOLCE DR LAS VEGAS NV 89134-6151	13820713008
PROGRESS RESIDENTIAL 2014-1 BORR	P O BOX 4090 SCOTTSDALE AZ 85261	13820612022
PROGRESS RESIDENTIAL 2015-1 BORR	P O BOX 4090 SCOTTSDALE AZ 85261	13820610028
PROTHRO LANCE B & STEPHANIE M	8309 SEDONA SUNRISE DR LAS VEGAS NV 89128-8258	13821310043

Report of All Selected Parcels**Case Number:**

VAR-64887

Printed On: Thu: August 25, 2016

Owner	Address	Parcel Number
PROVIDENT TRUST GROUP L L C	8665 PRAIRIE HILL DR LAS VEGAS NV 89134	13820517011
PUCKETT TRACY A	8217 SEDONA SUNRISE DR LAS VEGAS NV 89128-7910	13821310034
PUEBLO ASSISTED LIVING L P	21001 N TATUM BLVD #1630-630 PHOENIX AZ 85050	13820614013
PUEBLO COML CTR OWNRS ASSOC	10801 W CHARLESTON BLVD 3RD FL LAS VEGAS NV 89135-1200	13820614008
PUEBLO COML CTR OWNRS ASSOC	10801 W CHARLESTON BLVD 3RD FL LAS VEGAS NV 89135-1200	13820614010
PULIDO WALDO V & MICHELLE Z	1112 EMERALD TINT CT LAS VEGAS NV 89144	13821212066
QUINTERO ANTONIO BOGARIN	8332 CRETAN BLUE LN LAS VEGAS NV 89128-7467	13821212030
QUIROS IGNACIO & JOAN	1813 PASEO OVERLOOK CT LAS VEGAS NV 89128	13820716010
R J C B J C PROPERTIES LLC SER A	6521 BLUFF DWELLERS AVE LAS VEGAS NV 89131	13820613049
R N DEVELOPMENT L L C	2389 CENTURY HILL LOS ANGELES CA 90067-3508	13821117004
RAASCH THOMAS M & VICTORIA L	8620 ESTRELITA DR LAS VEGAS NV 89128-8232	13820714001
RAFIA FRED & SORAYA	1812 MADERA CANYON PL LAS VEGAS NV 89128-7949	13820712010
RAJNOOR ALEXIS ANN TRUST	RAJNOOR ALEXIS ANN 8700 MAGNOLIA RIDGE AVE LAS VEGAS NV 89134-0334	13820520013
RALEIGH EVA M	2020 CANYON BREEZE DR LAS VEGAS NV 89134	13820612008
RAMONETTE ANDREW	8713 WINTRY GARDEN AVE LAS VEGAS NV 89134	13820610038
RAMPART P H D L L C	10450 W CHEYENNE AVE #130 LAS VEGAS NV 89129	13820614009
RAMSEY ALVIN L & P A REV LIV TR	RAMSEY ALVIN L & PATRICIA A TRS 8717 MAGNOLIA RIDGE LAS VEGAS NV 89134-0364	13820520060
RANKIN CARMELITA C	2128 RAINBOW FALLS DR LAS VEGAS NV 89134-0331	13820520042
RAZA HAMID	613 LAKESIDE DR FULLERTON CA 92835-1510	13820616018
RCANNATA TRUST	CANNATA ROBERT A TRS 8800 CRESCENT RIDGE LN LAS VEGAS NV 89134-0304	13820613055
REALM INDUSTRIES L L C	P O BOX 530541 HENDERSON NV 89053	13820515003
REAM JAMES J	8501 CHIQUITA DR LAS VEGAS NV 89128-7914	13820813011
RED PLACE HOLDINGS L L C	10300 W CHARLESTON BLVD #13-621 LAS VEGAS NV 89135	13820613044
REDD SHEA & BETH	8720 CRESCENT RIDGE LN LAS VEGAS NV 89134-0302	13820613002
REED SANDRA D	FARGAS ANTONIO J 8208 EMERALD ISLE AVE LAS VEGAS NV 89128-7475	13821216017
REINSTADTLER DIANE & GREG	6104 COCKTAIL DR LAS VEGAS NV 89130-7073	13821212024
REMO PAUL J	2013 WATERBURY LN LAS VEGAS NV 89134	13820217012
RENAUD CAROLYN E & DANIEL G	1917 SEDONA PASEO LN LAS VEGAS NV 89128-8287	13820711006
RENFER EDWARD & GRACE	8313 BRITTANY HARBOR LAS VEGAS NV 89128-7490	13821215046
REYES GERRY B & MYRNA P	8805 SILVER MOUNTAIN CT LAS VEGAS NV 89134-0361	13820613068
REYES JOCELYN E	8436 APPLE HILL CT LAS VEGAS NV 89128-7635	13820513006
RICHARDSON AUBREY A	2100 FOUNTAIN VIEW DR LAS VEGAS NV 89134-0316	13820610013

Report of All Selected ParcelsCase Number:

VAR-64887

Printed On: Thu: August 25, 2016

<u>Owner</u>	<u>Address</u>	<u>Parcel Number</u>
RINEHART BRAD H & CATHARINE	1824 MADERA CANYON PL LAS VEGAS NV 89128	13820712007
RIVERA JOHNNY R & ANNA P	8816 VALLEY CREEK DR LAS VEGAS NV 89134-0371	13820613065
RIVERA MICHELLE HOUSE TRUST	BROOKS PETER D TRS 8820 VALLEY CREEK DR LAS VEGAS NV 89134	13820613064
RIZZO VINCENT J & DANCE J	8320 CRETAN BLUE LN LAS VEGAS NV 89128-7467	13821212027
ROBERT TODD E & MAUREEN	8312 PASEO VISTA DR LAS VEGAS NV 89128-8243	13821317028
ROBERTSON MARY NICOLE	2113 RAINBOW FALLS DR LAS VEGAS NV 89134-0332	13820520056
ROBINSON VAN P	2132 MISTY MEADOW DR LAS VEGAS NV 89134-0347	13820520026
ROCCHIO TINA L LIVING TRUST	ROCCHIO TINA L TRS 2229 ORCHID BLOSSOM DR LAS VEGAS NV 89134-0330	13820520003
ROCHA WALTER & YOLANDA	1972 EVENING GLOW DR LAS VEGAS NV 89134-0358	13820613024
RODRIGUEZ R GEORGE & ABIGAIL	1928 SEDONA PASEO LN LAS VEGAS NV 89128-8288	13820711017
ROESNER KENT W & YOLANDA LIV TR	2105 RICO PEAK LAS VEGAS NV 89128-7634	13820518003
ROGERS JILL	RODGERS WILIAM & JILL 2125 HARBOR CLIFF DR LAS VEGAS NV 89128-7460	13821121004
ROHAN FAMILY TRUST	ROHAN CHARLES M & MARLYNE L TRS 8209 SEDONA SUNRISE DR LAS VEGAS NV 89128-7910	13821310032
ROMITO RICHARD M & MAUREEN	8420 PASEO VISTA DR LAS VEGAS NV 89128-8274	13820716003
ROSEN MILTON	8729 SMOKEY DR LAS VEGAS NV 89134-8421	13820515001
ROSENBURG ROY	8309 BRITTANY HARBOR DR LAS VEGAS NV 89128-7490	13821215045
ROSOWSKY DAVID & CHERYL	1952 EVENING GLOW DR LAS VEGAS NV 89134	13820613033
ROSS ARLENE JEAN & MARK	8804 SILVER MOUNTAIN CT LAS VEGAS NV 89134-0360	13820613072
ROSS CHARLES D III TRUST	ROSS CHARLES D TRS 8513 WILEY POST AVE LOS ANGELES CA 90045	13820613041
ROSS DAMON	8501 ESTRELITA DR LAS VEGAS NV 89128-7959	13820712020
ROSS ERIC	560 W 43RD ST #16K NEW YORK NY 10036-4312	13820513013
ROSS SANFORD A	8632 PRAIRIE HILL DR LAS VEGAS NV 89134-8413	13820517034
ROTTENSTEIN SAM	9455 COLLINS AVE MIAMI BEACH FL 33154	13821317016
ROWE LISA TRUST	ROWE LISA TRS 2128 FOUNTAIN VIEW DR LAS VEGAS NV 89134-0317	13820610020
ROY CAROL A	8337 EMERALD ISLE AVE LAS VEGAS NV 89128-7501	13821215024
RUBENSTEIN MATTHEW J	STOLZER ROSEMARY 8616 ESTRELITA DR LAS VEGAS NV 89128-8232	13820714002
RUBIN IAN	9405 GRENVILLE AVE LAS VEGAS NV 89134	13821118060
RUECKL PENNY H	8600 ESTRELITA DR LAS VEGAS NV 89128-8232	13820714006
RUFO JORGE P & EMILY	2509 VALLECITO WY ANTIOCH CA 94531-9066	13820520045
RUIZ ANA L	8532 ESTRELITA DR LAS VEGAS NV 89128-7958	13820714007
RUIZ ELIAS N III & MARIA L	8925 STAFFORD SPRINGS DR LAS VEGAS NV 89134-0341	13820114011
RUNJE FAMILY TRUST	2109 HENNIKER WAY LAS VEGAS NV 89134	13820613039

Report of All Selected Parcels**Case Number:**

VAR-64887

Printed On: Thu: August 25, 2016

<u>Owner</u>	<u>Address</u>	<u>Parcel Number</u>
RUSSELL L MULLER REVOCABLE TRUST	MULLER RUSSELL L TRS P O BOX 2547 GILLETTE WY 82717	13820517051
S & S FAMILY TRUST	SCHNEIDER RICHARD E TRS 2033 SEDONA CREEK CIR LAS VEGAS NV 89128-8216	13821210080
S F R INVESTMENTS POOL 1 L L C	5030 PARADISE RD #B-214 LAS VEGAS NV 89119	13821117018
S G U S A INVESTMENT INC	3993 SPRING MOUNTAIN RD #307 LAS VEGAS NV 89102-8613	13820520065
SADLER STANLEY	8712 CYPRESSWOOD AVE LAS VEGAS NV 89134-0310	13820610030
SAFFRON AMI	3619 LOADSTONE DR SHERMAN OAKS CA 91403-4517	13820615011
SAINI HARVINDER S & GURDEEP K	787 REGENT PARK DR SAN JOSE CA 95123	13821212045
SAINTARD RONALD	LAIRD LASHONE 8340 EMERALD ISLE AVE LAS VEGAS NV 89128-7500	13821215003
SAL SHAI & TAMI	9404 CANALINO DR LAS VEGAS NV 89134	13821117036
SALCIDO FAMILY TRUST	SALCIDO PEDRO J & INEZ A TRS 8702 RIPPLING WATER DR SUGAR LAND TX 77479	13820710002
SALEI ISRAEL & MARINA	8801 MONTAGNA DR LAS VEGAS NV 89134-6147	13820713005
SALMEN JOHN & LYDIA	8356 SUGAR BOWL CT LAS VEGAS NV 89128-7606	13821112024
SAMRA JASWINDER S	CHOI ALICE 1804 PASEO OVERLOOK CT LAS VEGAS NV 89128-8275	13821318005
SAMRAR INVESTMENT L L C	2312 TIMBERLINE WAY LAS VEGAS NV 89117-5808	13820211029
SANCHEZ TOMAS D & MARIA E	SANCHEZ M E TEOHUA 2015 E SIERRA PL OXNARD CA 93033-5634	13820520039
SANDERS FAMILY TRUST	SANDERS EARL V & CLAUDETTE TRS 8320 SWAN LAKE AVE LAS VEGAS NV 89128-7414	13821118035
SANDERS STEVEN K	8800 VALLEY CREEK DR LAS VEGAS NV 89134-0371	13820613035
SANKEY LEAH E REVOCABLE LIV TR	SANKEY LEAH E TRS 2116 BACHELOR CT LAS VEGAS NV 89128-7620	13821117023
SANTO-PIETRO DAVID M & MICHALLE	8176 SEDONA SUNRISE DR LAS VEGAS NV 89128	13821310053
SAPYTA JAMIE K & FRANK R	8812 STAFFORD SPRING DR LAS VEGAS NV 89134	13820616002
SARVER SHANNON	2124 RAINBOW FALLS DR LAS VEGAS NV 89134	13820520043
SASHA TRUST	8196 SEDONA SUNRISE DR LAS VEGAS NV 89128-7310	13821310020
SAVAL-SILVA TRUST	SAVAL RICHARD TRS 8432 PASEO VISTA DR LAS VEGAS NV 89128-8274	13820716006
SAVILLE-MARTINEZ LAURA	725 PINNACLE HEIGHTS LN LAS VEGAS NV 89144	13820215003
SAWYER JOHN R	MITCHELL GRACE 1924 SEDONA PASEO LN LAS VEGAS NV 89128	13820711016
SBERNA FRANK M & DEBORAH B	2205 ORCHID BLOSSOM DR LAS VEGAS NV 89134-0321	13820520082
SCARBROUGH HARRIET A	2416 SPRINGRIDGE DR LAS VEGAS NV 89134-8843	13820512005
SCHINDLER CLIFFORD W & JONI	8721 MAGNOLIA RIDGE AVE LAS VEGAS NV 89134-0364	13820520061
SCHLISSUS SONYA	2004 SEDONA CREEK CIR LAS VEGAS NV 89128-8213	13820711020
SCHWABACHER FAMILY TRUST	SCHWABACHER MICHAEL F TRS 8224 SEDONA SUNRISE DR LAS VEGAS NV 89128-7911	13821310013
SCHWARTZ RICHARD B & JEANETTE A	8800 LUSSO CT LAS VEGAS NV 89134-6190	13820218005
SCIOTTO TONY LIVING TRUST	SCIOTTO TONY TRS 8805 CYPRESSWOOD AVE LAS VEGAS NV 89134-0362	13820610002

Report of All Selected Parcels**Case Number:**

VAR-64887

Printed On: Thu: August 25, 2016

Owner	Address	Parcel Number
SCOTT ELIZABETH	8232 BRITTANY HARBOR DR LAS VEGAS NV 89128-7495	13821216038
SEAMAN DELAGUERRA FAMILY TRUST	SEAMAN JOHN DAVID & VICTORIA TRS 8808 ROZETTA CT LAS VEGAS NV 89134-6179	13820317017
SEDILLO PATRICK J	6332 LORILLE LN LAS VEGAS NV 89108	13820511007
SEGGEV FAMILY TRUST	SEGGEV JORAM S & VARDA TRS 2108 RICO PEAK CT LAS VEGAS NV 89128-7634	13820518007
SEIDEWITZ SCOTT V	8336 PASEO VISTA DR LAS VEGAS NV 89128-8244	13821317022
SENIRES LORENZO JR & ELEANOR L	2384 SPRINGRIDGE DR LAS VEGAS NV 89134	13820516012
SEPULVEDA CHARLES & MERCEDES	18 GRAND AVE RIDGEFIELD PARK NJ 07660-1217	13821112025
SEXTON HOLDINGS L L C	8645 COLLEGE BLVD #100 OVERLAND PARK KS 66210-1801	13820218004
SHAHMIRZADI SHIBA	8617 ESTRELITA DR LAS VEGAS NV 89128	13820816001
SHAVINSKY SANDRA LIVING TR 1999	SHAVINSKY SANDRA TRS 8508 CHIQUITA DR LAS VEGAS NV 89128-7913	13820712014
SHEEHAN JOSEPH	8724 MAGNOLIA RIDGE AVE LAS VEGAS NV 89134-0365	13820520007
SHEPHERD THEODORE & KAREN	8616 MAGNOLIA RIDGE AVE LAS VEGAS NV 89134-0333	13820520018
SHERMAN VINCE ALAN & TYRA A	8317 BRITTANY HARBOR DR LAS VEGAS NV 89128-7490	13821215047
SHERWOOD FAMILY TRUST	SHERWOOD MORTON B & RENEE J TRS 2408 DESERT BUTTE DR LAS VEGAS NV 89134-8865	13820517028
SIEGEL ALAN B	8609 PALE MOON CT LAS VEGAS NV 89134-0357	13820610016
SIKAND FAMILY TRUST	8908 WINDSOR LOCKS AVE LAS VEGAS NV 89134-0377	13820217011
SIMONS DONNA E	8301 EMERALD ISLE AVE LAS VEGAS NV 89128-7477	13821215015
SIMS L DOUGLAS & DEBRA FAMILY TR	SIMS L DOUGLAS & DEBRA K TRS 2005 HARBOR CLIFF DR LAS VEGAS NV 89128-7461	13821215058
SINATRA FAMILY TRUST	SINATRA DUANE P & CARMELA TRS 1808 PASEO OVERLOOK CT LAS VEGAS NV 89128-8275	13821318006
SINGER RICHARD A & JOYCE REV TR	SINGER RICHARD A & JOYCE E TRS 8329 HOLLOW WHARF DR LAS VEGAS NV 89128-7428	13821212039
SKINNER JORGEANN REVOCABLE LIVIN	8328 SEDONA SUNSET DR LAS VEGAS NV 89128	13821210002
SKOWRONEK LAWRENCE M & SYLVIA	2137 FOUNTAIN VIEW DR LAS VEGAS NV 89134-0319	13820520024
SMITH BEVERLY & HERBERT	2400 DESERT BUTTE DR LAS VEGAS NV 89134-8865	13820517030
SMITH RAYMOND & DEBORAH	8705 CYPRESSWOOD AVE LAS VEGAS NV 89134-0313	13820610011
SMITH ROGER J & HELEN E	9913 LAUREL SPRINGS AVE LAS VEGAS NV 89134-6701	13820520055
SMITH'S FOOD & DRUG CENTERS INC	1014 VINE ST CINCINNATI OH 45202-1141	13820522001
SMOLZ FAMILY REVOCABLE LIVING TR	SMOLZ PHILLIP J & CHRISTINE TRS 8532 CHIQUITA DR LAS VEGAS NV 89128-7913	13820816007
SNOW CLIFFORD C & CHRISTINA E	2128 WATERBURY LN LAS VEGAS NV 89134-0387	13820616006
SNOW NANCY	LI MONICA X 8237 SEDONA SUNRISE DR LAS VEGAS NV 89128	13821310039
SODERSTROM PEDER N	COOLEY CHONDRA L 2104 RICO PEAK CT LAS VEGAS NV 89128-7634	13820518006
SOLO ROBERT H & JUDITH B TRUST	SOLO ROBERT H & JUDITH B TRS 11249 PARLEYS CONE CT LAS VEGAS NV 89135-1839	13820217010
SOMDAHL LEONARD E TRUST	MUELLER LARRY M & BEVERLY L P O BOX 4291 VENTURA CA 93007	13821212043

Report of All Selected ParcelsCase Number:

VAR-64887

Printed On: Thu: August 25, 2016

<u>Owner</u>	<u>Address</u>	<u>Parcel Number</u>
SOUTH SHORES PROFESSIONAL CTR	3863 S VALLEY VIEW BLVD LAS VEGAS NV 89103	13821211003
SOUTHWORTH FAMILY TRUST	SOUTHWORTH MILO D & BONNIE L TRS 2413 DESERT BUTTE DR LAS VEGAS NV 89134-8868	13820517025
SPAHLE ROBERT J & STACY M	2125 RAINBOW FALLS DR LAS VEGAS NV 89134-0332	13820520058
SPARKS KAREN A & DONALD E	2412 DESERT GLEN DR LAS VEGAS NV 89134-8871	13820511001
SPATARO JOSEPH & MILDRED	8817 STAFFORD SPRINGS DR LAS VEGAS NV 89134-0376	13820616026
SPECIAL FRANK G LIVING TRUST	SPECIAL FRANK G TRS 7620 PLEASANT COLONY CT LAS VEGAS NV 89131-4110	13820518005
SPINKS JEFFREY P & JACQUELINE D	19 SYLVAN LN BOYLSTON MA 01505-1434	13820217014
SPOON ROBERT & DIANN REV TR	2013 EVENING GLOW DR LAS VEGAS NV 89134-0307	13820613076
STANDISH FAMILY TRUST	STANDISH THOMAS & SANDRA TRS 8825 BONTA CT LAS VEGAS NV 89134-6132	13820313018
STASKIN MICHAEL D	CUCCO ROSSELLA 8808 BONTA CT LAS VEGAS NV 89134-6130	13820313011
STEFFEN INVESTMENT TRUST	STEFFEN JOHN T & STEPHANIE H TRS 2025 WATERBURY LN LAS VEGAS NV 89134-0386	13820217015
STEIGERWALD BRETT	8321 HOLLOW WHARF DR LAS VEGAS NV 89128	13821212041
STEIGMAN MICHAEL P & NONA A	8321 PASEO VISTA DR LAS VEGAS NV 89128-8246	13821317018
STERRETT BROGG	DOWNEY TERRENCE P 2004 SEDONA PATH WAY LAS VEGAS NV 89128-7967	13821310009
STEWART KEITH R	9101 W SAHARA #105-B32 LAS VEGAS NV 89117	13821215021
STOLBERG LAYKE M	8808 STAFFORD SPRINGS DR LAS VEGAS NV 89134-0373	13820616003
STREEPER SUZANNE M	1957 CANYON BREEZE DR LAS VEGAS NV 89134-0328	13820215005
STREETS DEREK & MARY	8341 HOLLOW WHARF DR LAS VEGAS NV 89128	13821212036
STROBECK MARGY M & STEVEN	LINDSETH KAREN STROBECK 9504 SUNDIAL DR LAS VEGAS NV 89134	13820517016
STRONG NADINE D LIVING TRUST	STRONG NADINE D TRS 2008 CANYON BREEZE DR LAS VEGAS NV 89134-0300	13820612005
SUAREZ CHRISTINE & ORLANDO	8600 MAGNOLIA RIDGE AVE LAS VEGAS NV 89134-0333	13820520022
SUDUL PAMELA E	1953 CANYON BREEZE DR LAS VEGAS NV 89134-0328	13820215004
SULLIVAN DANIEL & BETTY	2016 SEDONA MORNING DR LAS VEGAS NV 89128-8484	13820615013
SULLIVAN MICHELLE	1945 SEDONA PASEO LN LAS VEGAS NV 89128-8289	13820615007
SUMMERLIN COUNCIL	1910 SPRING GATE LN LAS VEGAS NV 89134-6213	13820701003
SUMMERLIN COUNCIL	1910 SPRING GATE LN LAS VEGAS NV 89134-6213	13821311009
SUMMERLIN NORTH COMMUNITY ASSN	2120 SNOW TRAIL LAS VEGAS NV 89134-6709	13820810012
SUPIN ROBERT W	8212 EMERALD ISLE AVE LAS VEGAS NV 89128-7475	13821216018
SUSA SUSAN	2125 MISTY MEADOW DR LAS VEGAS NV 89134-0348	13820520028
SWAIN KENNETH D & JUDITH K	8816 CYPRESSWOOD AVE LAS VEGAS NV 89134-0312	13820520070
SWAINSTON DARIN & ROBIN	8908 STAFFORD SPRINGS DR LAS VEGAS NV 89134-0338	13820519001
SWAINSTON IAN & LAURA REV LIV TR	SWAINSTON IAN & LAURA TRS 2112 HENNIKER WY LAS VEGAS NV 89134-0336	13820211018

Report of All Selected Parcels**Case Number:**

VAR-64887

Printed On: Thu: August 25, 2016

<u>Owner</u>	<u>Address</u>	<u>Parcel Number</u>
SWANK GERALDINE	8701 PRAIRIE HILL DR LAS VEGAS NV 89134-8416	13820517008
SWANSON JAMES Q & PATRICIA E	2236 FIERO DR LAS VEGAS NV 89134-6040	13820514007
SWINDELLS DOUGLAS R & CYNTHIA S	2104 HENNIKER WY LAS VEGAS NV 89134-0336	13820211020
SWORSY FAMILY TRUST	SWORSY THOMAS S & CAROL TRS 8613 CLIFFTOP DR LAS VEGAS NV 89134-8425	13820517050
SYPERT RICHARD L SR & J REV TR	SYPERT RICHARD L SR & J TRS 8512 CHIQUITA DR LAS VEGAS NV 89128-7913	13820712015
SYSLO MARIE	2420 SPRINGRIDGE DR LAS VEGAS NV 89134-8843	13820512006
SZURAN ANDREW & ALICE JT REV TR	SZURAN ANDREW & ALICE L TRS 8720 PRAIRIE HILL DR LAS VEGAS NV 89134-8414	13820510018
T J M TRUST	8704 SUMMER RIDGE DR LAS VEGAS NV 89134-0324	13820613020
T P INVESTMENTS INC	2480 N DECATUR BLVD #175 LAS VEGAS NV 89108	13821117030
T S H LIVING TRUST	HEUSER THOMAS L & SERENA M TRS 2000 WATERBURY LN LAS VEGAS NV 89134-0383	13820217003
TABASSI SANEE	2108 BACHELOR CT LAS VEGAS NV 89128-7620	13821117025
TALAVERA OMAR & DANA	8725 MAGNOLIA RIDGE AVE LAS VEGAS NV 89134	13820520062
TANG DAVID H & MEI	2120 WATERBURY LN LAS VEGAS NV 89134	13820616008
TAYLOR PHILLIP & CINDY FAMILY TR	TAYLOR PHILLIP MATHEW & CINDY LO 8305 SWAN LAKE AVE LAS VEGAS NV 89128-7413	13821118054
TAYLOR RANDALL S	8609 PRAIRIE HILL DR LAS VEGAS NV 89134-8415	13820516009
TEMPLE JERRY P & GRACE M	8724 CYPRESSWOOD AVE LAS VEGAS NV 89134-0310	13820610033
TEMPLE STREET HOMES L L C	909 N SEPULVEDA BLVD #840 EL SEGUNDO CA 90245	13821215052
THIELE ROSE-MARIE T REVOCABLE TR	THIELE ROSE MARIE T TRS 1925 SEDONA PASEO LN LAS VEGAS NV 89128-8287	13820711004
THOMAS 1979 TRUST	THOMAS MARGUERITE TRS 2005 SEDONA MORNING DR LAS VEGAS NV 89128-8484	13820615006
THOMAS LIVING TRUST	THOMAS DOUGLAS A & PATRICIA TRS 8809 MONTAGNA DR LAS VEGAS NV 89134-6147	13820713007
THOMAS LIVING TRUST	THOMAS ARTHUR DAYLE & MARY L TRS 8925 WINDSOR LOCKS AVE LAS VEGAS NV 89134-0380	13820211002
THOMAS THELMA B REVOCABLE TRUST	THOMAS THELMA B TRS 8312 BRITTANY HARBOR DR LAS VEGAS NV 89128-7489	13821215039
THOMAS VERNON E	2025 HARBOR CLIFF DR LAS VEGAS NV 89128-7461	13821215063
THORNDON L L C	3400 W DESERT INN RD #24 LAS VEGAS NV 89102-8355	13820521007
TISCHLER CARL E & JANENE	8225 EMERALD ISLE AVE LAS VEGAS NV 89128-7477	13821216023
TOBLER GARY W LIVING TRUST	TOBLER GARY WAYNE TRS 8317 EMERALD ISLE AVE LAS VEGAS NV 89128-7480	13821215019
TODAH 18 L L C	P O BOX 80652 LAS VEGAS NV 89180-0652	13821212018
TOFTE JAMES P & SUSAN KREKLING	2017 PARADISE PEAK DR LAS VEGAS NV 89134-0309	13820612013
TOM JANETTE J	2216 ANGELFIRE ST LAS VEGAS NV 89128-7610	13821117014
TOM MELVIN G & JUNE K	1324 KINA ST KAILUA HI 96734-3724	13820520066
TOTH HECTOR G & GINA M	ARPELLINO MARY A REVOCABLE TR 8333 BRITTANY HARBOR LAS VEGAS NV 89128-7493	13821218002

Report of All Selected Parcels**Case Number:**

VAR-64887

Printed On: Thu: August 25, 2016

<u>Owner</u>	<u>Address</u>	<u>Parcel Number</u>
TOTTORI DAVID H SEPARATE PPTY TR	TOTTORI CAROLYN L SEP PPTY TR 1912 VERO DR LAS VEGAS NV 89134-6154	13820715002
TOUNIAN ARVIN	1808 MADERA CANYON PL LAS VEGAS NV 89128-7949	13820712011
TOY FAMILY REVOCABLE LIVING TRUS	TOY HOWARD & LINDA TRS 8349 SUGAR BOWL CT LAS VEGAS NV 89128-7607	13821112029
TRAN RON X & MEI-HUI	1892 GROVESPRING ST LAS VEGAS NV 89135-1085	13820613031
TREMPUS FAMILY TRUST	TREMPUS JOSEPH M & BARBARA A TRS 8628 PRAIRIE HILL DR LAS VEGAS NV 89134-8413	13820517035
TRINIDAD MARTIN C & VICTORIA B	8204 SEDONA SUNSET DR LAS VEGAS NV 89128-7966	13821210019
TRIVISONNO DANNETTE	2128 HILLSGATE ST LAS VEGAS NV 89134-0368	13820217019
TRONTZ DAVID S & FERN R	8824 CORTILE DR LAS VEGAS NV 89134-6141	13820314021
TRUMAN RODNEY B & ERIN L	2124 WATERBURY LN LAS VEGAS NV 89134-0387	13820616007
TRUPIANO FRANK G	2109 HILLSGATE ST LAS VEGAS NV 89134-0369	13820211025
TRUST #8304	3603 LAS VEGAS BLVD N #116-47 LAS VEGAS NV 89115-0588	13821215041
TSUKADA TERRANCE R & WAN CHING	2009 SEDONA MORNING DR LAS VEGAS NV 89128-8484	13820615005
TUMANYAN VARSIK	8817 CORTILE DR LAS VEGAS NV 89134-6153	13820314013
TURNER KIMBERLY D	9217 BARINGCROSS ST LOS ANGELES CA 90044-4703	13820613019
TUTHILL FAMILY TRUST	TUTHILL TIMOTHY A & PEGGY J TRS 588 WINDSPIRIT CIR PRESCOTT AZ 86303	13821216022
TUTUNDZHIAN AREVAT & KRISTINE	1361 THOMPSON AVE GLENDALE CA 91201	13821117026
UCHIZONO FAMILY TRUST	UCHIZONO HOOVER J & TOSHIKO TRS 2052 POWDER SPRINGS ST HENDERSON NV 89052	13820520011
UHL DONALD P	2421 PALMRIDGE DR LAS VEGAS NV 89134	13820517053
URSEM FAMILY TRUST	URSEM MARY JANE TRS 8608 PRAIRIE HILL DR LAS VEGAS NV 89134-8413	13820517040
USIK OLENA V	8812 SILVER MOUNTAIN CT LAS VEGAS NV 89134	13820613071
VALDEZ CHRISTINA A	8812 VALLEY CREEK DR LAS VEGAS NV 89134-0371	13820613066
VALENTE LOUIS J	8829 VALLEY CREEK DR LAS VEGAS NV 89134-0372	13820215001
VANHOOVE JOHN & JERILYNN	8325 SEDONA SUNRISE DR LAS VEGAS NV 89128-8258	13821310047
VANWAGENEN STANLEY K	8917 WINDSOR LOCKS AVE LAS VEGAS NV 89134-0382	13820217008
VANWINKLE ANN	8733 CYPRESSWOOD AVE LAS VEGAS NV 89134-0314	13820610005
VASWANI RITA M	3667 DUTCH VALLEY DR LAS VEGAS NV 89147-6807	13821210018
VENEZIA LAUREL M	8736 CYPRESSWOOD AVE LAS VEGAS NV 89134-0311	13820610036
VERLINDEN FRED & JANA	8329 CRETAN BLUE LN LAS VEGAS NV 89128-7468	13821212012
VERMA TONIA S	2029 WATERBURY LN LAS VEGAS NV 89134-0386	13820217016
VILLANUEVA JULIAN U	CAMARENA MELISSA E 2213 ORCHID BLOSSOM DR LAS VEGAS NV 89134-0321	13820520084
VOGEL JAMES R & LORI A	8817 BONTA CT LAS VEGAS NV 89134	13820313016
VONROSEN FAMILY TRUST	VONROSEN THOMAS A & DAWN R TRS 12404 AVENIDA CONSENTIDO SAN DIEGO CA 92128	13820712002

Report of All Selected ParcelsCase Number:

VAR-64887

Printed On: Thu: August 25, 2016

<u>Owner</u>	<u>Address</u>	<u>Parcel Number</u>
W E C 97K-36 INVESTMENT TRUST	P O BOX 1159 DEERFIELD IL 60015	13820611001
WACHHORST WENDY C	HURLEY KEVIN R 3553 ALMA ST #1 PALO ALTO CA 94306	13820714008
WAFER MATTIE A & HOMER JR	2001 PARADISE PEAK DR LAS VEGAS NV 89134-0309	13820612017
WAGNER CHRIS & YVETTE	1015 SEA VILLAGE DR CARDIFF CA 92007-1433	13820520034
WALKER JEFFREY R	8432 SHELTERED VALLEY DR LAS VEGAS NV 89128	13820513010
WALKER RICHARD TRUST	WALKER RICHARD SCOTT JR TRS 8412 PASEO VISTA DR LAS VEGAS NV 89128-8274	13820716001
WALLACE DARCIE M	8300 ARROYO JUSTIN AVE LAS VEGAS NV 89128-8278	13821317013
WALSH FAMILY TRUST	WALSH FREDERICK J & JUDITH A TRS 2400 SUNUP DR LAS VEGAS NV 89134-8426	13820517021
WANG LIU TRUST 2001 LIU Q X TR A	LIU QIONG XIANG TRS 2108 SNOWBIRD CT LAS VEGAS NV 89128-7622	13821117033
WANG XINZHANG	SHI GE 2117 FOUNTAIN VIEW DR LAS VEGAS NV 89134-0318	13820610026
WASIELEWSKI ERIC	9253 MAGIC FLOWER AVE LAS VEGAS NV 89134-6068	13820610001
WEBSTER REVOCABLE FAMILY TRUST	11901 LUNA DEL MAR LN LAS VEGAS NV 89138	13820520015
WEEMS BARBARA R	8825 CYPRESSWOOD AVE LAS VEGAS NV 89134-0315	13820520078
WEIL SHAI	1215 S FORT APACHE RD #120 LAS VEGAS NV 89117	13820218009
WEIR MERRILL E REVOCABLE TRUST	WEIR MERRILL E TRS 8228 SEDONA SUNSET DR LAS VEGAS NV 89128-7964	13821210014
WEISER FAMILY TRUST	WEISER SANDRA K TRS 8741 SMOKEY DR LAS VEGAS NV 89134-8421	13820510009
WELLS RANDOL T & FLORENCE J	2212 SAPPHIRE VALLEY ST LAS VEGAS NV 89128-7615	13821117005
WELTMAN FAMILY TRUST	WELTMAN ROBERT & DEBBY TRS 1550 REEVES ST LOS ANGELES CA 90035	13820217005
WERT TAMERA S LIVING TRUST	WERT TAMERA S TRS 8812 CRESCENT RIDGE LN LAS VEGAS NV 89134-0304	13820613052
WEST RICHARD AARON	DAVIDSON-WEST KAREN 2012 PARADISE PEAK DR LAS VEGAS NV 89134-0308	13820613085
WESTFALL KENNEDY G & ANA REV TR	WESTFALL KENNEDY G & ANA R TRS 41543 JACARANDA ST PALMDALE CA 93551-2827	13820511005
WHYTE FAMILY TRUST	WHYTE CYNTHIA L TRS 2101 WATERBURY LN LAS VEGAS NV 89134-0388	13820217017
WILKIE MARY BETH	8637 PRAIRIE HILL DR LAS VEGAS NV 89134	13820516002
WILLIAMS CRAIG PATRICK & KAYNELL	2401 DESERT BUTTE DR LAS VEGAS NV 89134	13820517022
WILLIAMS JUANITA & HARVEY	2201 HARBOR CLIFF DR LAS VEGAS NV 89128-7419	13821118061
WILLIAMS SHEILA TRUST	WILLIAMS SHEILA A TRS 2212 ANGELFIRE ST LAS VEGAS NV 89128-7610	13821117015
WILLIAMS TERI R & JOSHUA P	8221 SEDONA SUNSET DR LAS VEGAS NV 89128-8293	13821210059
WILLIS BOBBY J & WILMA J	8180 SEDONA SUNSET DR LAS VEGAS NV 89128-7308	13821210021
WINER ADAM M	420 SILVER GROVE ST LAS VEGAS NV 89144	13820613004
WINSTON MICHAEL A & H L LIV TR	WINSTON MICHAEL A & HEIDI L TRS 8504 ESTRELITA DR LAS VEGAS NV 89128-7958	13820712004
WITCHER LAMONT M	8240 HOLLOW WHARF DR LAS VEGAS NV 89128-7423	13821212064
WOLFF CHARLES J REVOCABLE LIV TR	WOLFF CHARLES J TRS 8712 PRAIRIE HILL DR LAS VEGAS NV 89134-8414	13820510020

Report of All Selected Parcels**Case Number:**

VAR-64887

Printed On: Thu: August 25, 2016

<u>Owner</u>	<u>Address</u>	<u>Parcel Number</u>
WOODALL LARRY J	8800 SUMMER RIDGE DR LAS VEGAS NV 89134-0345	13820613073
WOODBERRY OSCAR & F D REV LIV TR	WOODBERRY OSCAR & FAITHLYN D TRS 8929 STAFFORD SPRINGS DR LAS VEGAS NV 89134-0341	13820114010
WOOTEN JEFFERY & DANIELLE	8324 SEDONA SUNSET DR LAS VEGAS NV 89128	13821210003
WRIGHT SUSAN V LIVING TRUST	WRIGHT SUSAN V TRS 3204 JEVONDA AVE HENDERSON NV 89044	13820520001
XU JIANQIANG	8333 PASEO VISTA DR LAS VEGAS NV 89128-8246	13821317021
XU WEI	ZHANG YAN 156 MORANDI LN MENLO PARK CA 94025-3755	13820613003
YAMIN REVOCABLE LIVING TRUST	8805 MONTAGNA DR LAS VEGAS NV 89134-6147	13820713006
YEE EDSON Q M & SHAWN M	8916 STAFFORD SPRINGS DR LAS VEGAS NV 89134-0338	13820114001
YEGHIAZARIAN SEVAN & EDIT	8237 SEDONA SUNSET DR LAS VEGAS NV 89128	13821210063
YERUSHALMI PROPERTIES L L C	2400 WESTERN AVE LAS VEGAS NV 89102-4816	13820611005
YIN KENNETH & XIN	138-10 FRANKLIN AVE #11A FLUSHING NY 11355	13820217001
YU JIE	YANG JIAN 17 PARMA IRVINE CA 92602-1656	13820613032
YU SUEMIN REVOCABLE TRUST	YU SUEMIN TRS 8317 SWAN LAKE AVE LAS VEGAS NV 89128-7415	13821118057
YU YONGQUAN	CHEN SHUHONG 8800 CORTILE DR LAS VEGAS NV 89134	13820715001
YUCEL FAMILY TRUST	8816 STAFFORD SPRINGS DR LAS VEGAS NV 89134-0374	13820616001
ZAARA INVESTMENTS L L C	2021 SEDONA MORNING DR LAS VEGAS NV 89128-8484	13820615003
ZADEH NADER & SORAYYA TRUST	ZADEH NADER TRS 4537 ELLENITA AVE TARZANA CA 91356-4929	13821210015
ZAPATA PEDRO C & SILVIA CRESTA	300 31ST AVE SAN MATEO CA 94403	13820218010
ZHANG WEI	LIU MIYE 8232 SEDONA SUNRISE DR LAS VEGAS NV 89128-7911	13821310011
ZHONG JOHN & CARY	8304 SEDONA SUNSET DR LAS VEGAS NV 89128	13821210008
ZILBERBERG DANIEL	23679 CALABASAS RD #691 CALABASAS CA 91302	13821215037