

City of Las Vegas
Office Of The City Clerk
495 S. Main St., City Hall
Las Vegas, Nevada 89101

PSRST STD
U.S. Postage
PAID
Las Vegas, NV
Permit No. 1630

Return Service Requested
Official Notice of Public Hearing

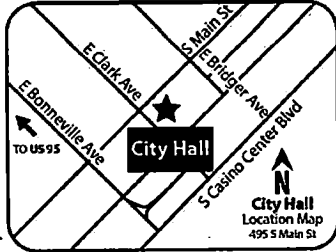

If you wish to file your protest or support on this request, check the appropriate box below and return this card in an envelope with postage to the Office Of The City Clerk at the address listed above, fax this side of this card to (702) 382-4803 or make your comments at www.lasvegasnevada.gov. If you would like to contact your Council Representative, please call (702) 229-6405.

I SUPPORT
this Request

I OPPOSE
this Request

Please use available blank space on card for your comments.

VAR-62407 & WVR-62353 & TMP-62358 [PRJ-62201]

City Council Meeting of February 17, 2016

Application Information

VAR-62407 - VARIANCE - PUBLIC HEARING - APPLICANT: DR HORTON, INC. - OWNER: 805 LAND, LLC - For possible action on a City Council Review on a Variance TO ALLOW A 27-FOOT PRIVATE STREET WHERE 47 FEET IS REQUIRED AND TO ALLOW NO AMENITY ZONES AND SIDEWALKS WHERE SUCH ARE REQUIRED FOR A PROPOSED RESIDENTIAL SUBDIVISION on 2.49 acres located approximately 200 feet east of Campbell Drive and approximately 700 feet north of Charleston Boulevard (APN 139-32-405-027), R-E (Residence Estates) Zone, Ward 1 (Tarkanian) [PRJ-62201].

WVR-62353 - WAIVER RELATED TO VAR-62407 - PUBLIC HEARING - APPLICANT: DR HORTON, INC. - OWNER: 805 LAND, LLC - For possible action on a City Council Review on a Waiver TO ALLOW NO STREETLIGHTS WHERE SUCH ARE REQUIRED FOR A PROPOSED RESIDENTIAL SUBDIVISION on 2.49 acres located approximately 200 feet east of Campbell Drive and approximately 700 feet north of Charleston Boulevard (APN 139-32-405-027), R-E (Residence Estates) Zone, Ward 1 (Tarkanian) [PRJ-62201].

TMP-62358 - TENTATIVE MAP RELATED TO VAR-62407, WVR-62353 AND VAC-62357 - 805 CAMPBELL - PUBLIC HEARING - APPLICANT: DR HORTON, INC. - OWNER: 805 LAND, LLC - For possible action on a City Council Review on a Tentative Map FOR A FOUR-LOT SINGLE FAMILY RESIDENTIAL SUBDIVISION on 2.49 acres located approximately 200 feet east of Campbell Drive and approximately 700 feet north of Charleston Boulevard (APN 139-32-405-027), R-E (Residence Estates) Zone, Ward 1 (Tarkanian)

Application Location

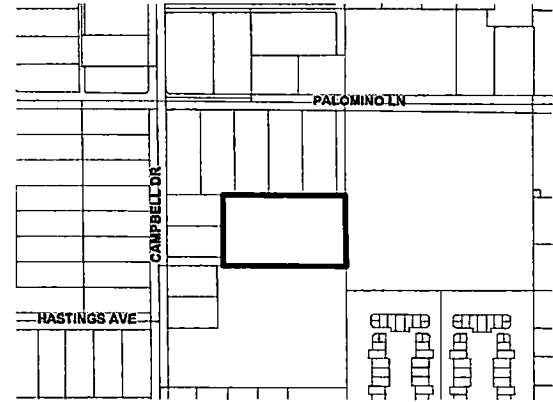

The proposed project may not pertain to the entire highlighted project site.

Public Hearing Information

Meeting: City Council
Date: *February 17, 2016*
Time: 1:00 P.M.
Location: City Council Chambers
495 South Main Street, 2nd Floor
Las Vegas, Nevada 89101

Any and all interested persons may appear and be heard at said meeting, or may, prior to this meeting, file a written objection thereto or approval thereof with the City Clerk, 2nd Floor, City Hall, 495 South Main Street, Las Vegas, Nevada 89101. For further information, including the full staff report, please call (702)229-6311 (7-1-1 Relay Nevada) or go to <http://www.lasvegasnevada.gov>.

Report of All Selected Parcels

Case Number: VAR-62407, WVR-62353, (62201) TMP-62358 (PRJ- **Printed On:** Wed: January 27, 2016

<u>Owner</u>	<u>Address</u>	<u>Parcel Number</u>
3040 W CHARLESTON L L C	9713 AMBER PEAK CT LAS VEGAS NV 89144-0806	13932405015
805 LAND L L C	3 SNOWY OWL LN LITTLETON CO 80127	13932405027
810 SHETLAND L L C	3004 CAMPBELL CIR LAS VEGAS NV 89107-3214	13932801013
A-1 BUILDING L L C	3101 ASHBY AVE LAS VEGAS NV 89102-1907	16205112007
ABRONSON WILLIAM & ELLEN LIV TR	11901 SANTA MONICA BLVD #328 LOS ANGELES CA 90025-1222	16205112005
ACCESSIBLE SPACE INC	2550 UNIVERSTIY AVE W 330 N ST PAUL MN 55114-2014	13932403003
ALDON PROPERTIES L L C	3202 W CHARLESTON BLVD LAS VEGAS NV 89102-1932	13932403012
ALKON FRIDA	815 S KENNY WY LAS VEGAS NV 89107-4437	13932404005
ALVAREZ BONITA R FAMILY TRUST	905 CASHMAN DR LAS VEGAS NV 89107-4429	13932403001
ARELLANO FELIX & ALIX	818 SHETLAND RD LAS VEGAS NV 89107-4520	13932801007
BABIN REX A	3111 HASTINGS AVE LAS VEGAS NV 89107-4431	13932403006
BALLE CENTER L L C	2801 W CHARLESTON BLVD #100 LAS VEGAS NV 89102-1965	16205510006
BANANA SPLIT SPENDTHRIFT TRUST	901 A ST SAN RAFAEL CA 94901-3043	13932306001
BARBERINI BONNIE B & LAURA	2951 PINTO LN LAS VEGAS NV 89107-4618	13932306026
BAUGHN DAVID W	HOOK-BAUGHN KIMBERLY K 814 S KENNY WY LAS VEGAS NV 89107-4436	13932410014
BERMAN ANDREW G	BERMAN WALTER & DOROTHY TR #1 1717 MAIN ST 12TH FLOOR TX1-2495 DALLAS TX 75201	13932412011
BREENE KATHLYN MILLER	3314 PALOMINO LN LAS VEGAS NV 89107-4415	13932310015
C R P ULTRA REVOCABLE LIVING TR	PRIBILA CRAIG R TRS 5925 SHAWNEE AVE LAS VEGAS NV 89107-2646	13932410010
CARMENA NEIL TRUST	CARMENA NEIL TRS 2825 PINTO LN LAS VEGAS NV 89107-4618	13932306004
CASHPA SUSANA	1109 CAMPBELL DR LAS VEGAS NV 89102-1915	16205115002
CASON JACK E & MAXINE FAMILY TR	CASON JACK E & MAXINE TRS 3208 ASHBY AVE LAS VEGAS NV 89102-1958	13932801012
CHAN ROSALIE Y REVOCABLE TRUST	CHAN JANE W TRS 1662 MAGNOLIA LN SAN LEANDRO CA 94577-2642	16205112006
CHAPMAN ROSE FAMILY TRUST	CHAPMAN ROSE TRS 3226 WEBER CT LAS VEGAS NV 89121-5762	13932410015
CHARLESTON/CAMPBELL PLAZA L L C	P O BOX 28910 LAS VEGAS NV 89126-2910	16205115001
D C D D 2005 FAMILY TRUST	3025 PALOMINO LN LAS VEGAS NV 89107-4509	13932405005
DIXON JEWEL L LIVING TRUST	DIXON JEWEL L TRS 612 CAMPBELL DR LAS VEGAS NV 89107-4445	13932303001
DOODLE PROPERTIES L L C #4	1055 W MOANA LN #104 RENO NV 89509-4764	13932403013
DUBOIS GERTRUDE	6210 W BROOKS AVE LAS VEGAS NV 89108-4302	13932405013
DWORAK-ROWLAND AMANDA	827 S KENNY WY LAS VEGAS NV 89107-4437	13932404009
ELLER CRYSTAL	8760 CAPTAINS PL LAS VEGAS NV 89117	13932405021
ESTEY DEVELOPMENT L L C	3051 ARABIAN RD LAS VEGAS NV 89107-4540	13932306019
FIALKIEWICZ DEREK E	909 CAHSMAN DR LAS VEGAS NV 89107-4429	13932403008

Report of All Selected Parcels

Case Number: VAR-62407, WVR-62353, TMP-62358 (PRJ- 62201) **Printed On:** Wed: January 27, 2016

<u>Owner</u>	<u>Address</u>	<u>Parcel Number</u>
FINKEL BARBARA	6957 EMERALD SPRINGS LN LAS VEGAS NV 89113	13932311013
FRANCIS MILES A & JENNIFER R	801 S KENNY WY LAS VEGAS NV 89107-4437	13932404001
GAUGHAN MICHAEL & MARTHA PAULA	9777 LAS VEGAS BLVD SO LAS VEGAS NV 89183-4013	13932306010
GAURINO ABIGAIL LEE	25518 PORTOLA LOOP LOMA LINDA CA 92354	13932404014
GOMEZ J ARNALDO & VIVIAN A	813 CAMPBELL DR LAS VEGAS NV 89107-4407	13932405024
GOMEZ ROSE	624 CAMPBELL DR LAS VEGAS NV 89107-4445	13932311012
GUARRELLA ROSALIA M & JOSEPH	704 CAMPBELL DR LAS VEGAS NV 89107-4408	13932404004
HAMILTON GREGORY M & EVELYN	806 CAMPBELL DR LAS VEGAS NV 89107-4446	13932404012
HANSON DENNIS R & CLAUDINE L	1610 HARDROCK ST LAS VEGAS NV 89156-7104	13932404003
HEJMANOWSKI P & C TRUST	HEJMANOWSKI PAUL & CHARLOTTE TRS 708 CAMPBELL DR LAS VEGAS NV 89107-4408	13932404006
HEJMANOWSKI P & C TRUST	HEJMANOWSKI PAUL & CHARLOTTE TRS 708 CAMPBELL DR LAS VEGAS NV 89107-4408	13932404008
HELMS TERRY R LIVING TRUST	809 UPLAND DR LAS VEGAS NV 89107	13932404010
HENDRICKSON ROSE MARIE TRUST	ROSS WILLIAM TRS 3037 PALOMINO LN LAS VEGAS NV 89107	13932405002
HINDELANG PAUL E JR	2700 PALOMINO WY LAS VEGAS NV 89107-4510	13932703008
HOOKS DALTON L JR	841 S KENNY WAY LAS VEGAS NV 89107	13932404013
IGLESIAS ANER JESUS	P O BOX 29269 LAS VEGAS NV 89126	13932306023
IGLESIAS ANER TRUST 1997	IGLESIAS ANER TRS P O BOX 29269 LAS VEGAS NV 89126	13932306022
IGLESIAS ANER TRUST 1997	IGLESIAS ANER TRS P O BOX 29269 LAS VEGAS NV 89126	13932703013
J K M TRUST	MULVEY JASON S & KATHRYN N TRS 721 CAMPBELL DR LAS VEGAS NV 89107-4405	13932405007
JANDA REVOCABLE LIVING TRUST	DECORTE JARRETT C & ADRIA S TRS 1108 CAMPBELL DR LAS VEGAS NV 89102-1916	16205112009
JARRELL JAMES H & LAURA E	725 S KENNY WY LAS VEGAS NV 89107-4427	13932311009
JENSEN FAMILY TRUST	JENSEN CARL R & ELLEN L TRS 6890 BARRED DOVE LN NORTH LAS VEGAS NV 89084-2656	13932310016
JEWELL ROBERTA J	PO BOX 28852 LAS VEGAS NV 89126	13932311008
JOHNSON AMIR	6080 CENTER DR 6TH FLR LOS ANGELES CA 90045	13932306024
KALFAYAN VOKI ETAL	HAMADA HELEN TRS 3121 HASTINGS AVE LAS VEGAS NV 89107-4431	13932403005
KENT JAMES C & MARZELLE E FAM TR	KENT JAMES C & MARZELLE E TRS 3033 PALOMINO LN LAS VEGAS NV 89107-4509	13932405003
KHOO SHERYL	11509 LAUREL AVE LOMA LINDA CA 92354	13932303003
KIRCH MARLENE REV SEP PPTY TR	KIRCH MARLENE J TRS 826 KENNY WY LAS VEGAS NV 89107-4436	13932410012
KNAPP PHILIP G & JO ELLEN JACOB	713 KENNY WY LAS VEGAS NV 89107-4427	13932311007
KOTCHKA-SMITH FAMILY TRUST	SMITH GREGORY E TRS 804 SHETLAND RD LAS VEGAS NV 89107-4520	13932801003
KUNG ANNIE J	214 S MARYLAND PKWY LAS VEGAS NV 89101-5319	13932703001
LAGSTEIN ZEV & RIVKA TRS	1013 CHAMPIONSHIP CT LAS VEGAS NV 89134-0513	16205510001

Report of All Selected Parcels**Case Number:** VAR-62407, WVR-62353, 62201)TMP-62358 (PRJ- **Printed On:** Wed: January 27, 2016

<u>Owner</u>	<u>Address</u>	<u>Parcel Number</u>
LANIAK RUSSELL	3041 PALOMINO LN LAS VEGAS NV 89107-4509	13932405001
LEAVITT GARY WAYNE	M H L FAMILY L P P O BOX 6111 MCKINNEY TX 75071-5103	13932405016
M Z R 2	19681 DA VINCI FOOTHILL RANCH CA 92610-2603	13932410011
MALONEY DONALD E	3029 PALOMINO LN LAS VEGAS NV 89107-4509	13932405004
MCDONALD RANDALL & TONI LIV TR	MCDONALD RANDALL LYLE & TONI TRS 808 SHETLAND RD LAS VEGAS NV 89107-4520	13932801004
MENNINGER CAROL A	3210 W CHARLESTON BLVD #1 LAS VEGAS NV 89102-1982	13932403011
MICAH 6:8 INVESTMENTS L L C	10420 DESIGNATA AVE LAS VEGAS NV 89135-2591	16205112008
MICHAEL ETHAN INVESTMENT L L C	3000 W CHARLESTON #3 LAS VEGAS NV 89102-1990	13932405023
MICHAEL ETHAN INVESTMENT L L C	3000 W CHARLESTON BLVD #3 LAS VEGAS NV 89102-1990	13932405020
MODERN MISHELL K	NAILOR MICHAEL J 2620 S MARYLAND PKWY STE 14 #226 LAS VEGAS NV 89109	13932404011
MOLASKY ANDREW REVOCABLE FAM TR	MOLASKY ANDREW TRS 100 N CITY PKWY #1700 LAS VEGAS NV 89106-4614	13932306011
MOLASKY ANDREW REVOCABLE FAM TR	MOLASKY ANDREW TRS 100 N CITY PKWY #1700 LAS VEGAS NV 89106-4614	13932306012
MOLLER-BURKEY TRUST	BURKEY ROBERT R TRS 801 CAMPBELL DR LAS VEGAS NV 89107-4407	13932405010
NEEDHAM HOWARD J & CHRISTINE S	3216 W CHARLESTON BLVD #D LAS VEGAS NV 89102-1983	13932403010
NGUYEN TAN	DANG THAO 900 CAMPBELL DR NORTH LAS VEGAS NV 89107-4451	13932403007
OMNINET WESTBAY L P	9420 WILSHIRE BLVD #400 BEVERLY HILLS CA 90212-3151	13932405017
OMNINET WESTBAY L P	9420 WILSHIRE BLVD #400 BEVERLY HILLS CA 90212-3151	13932405018
OMNINET WESTBAY L P	9420 WILSHIRE BLVD #400 BEVERLY HILLS CA 90212-3151	13932405026
O'REILLY JOHN & RENE LIVING TRUS	O'REILLY JOHN F TRS 3013 PINTO LN LAS VEGAS NV 89107-4631	13932305003
O'REILLY JOHN & RENE LIVING TRUS	O'REILLY JOHN F TRS 619 CAMPBELL DR LAS VEGAS NV 89107	13932305002
P J C TRUST	CASON PATRICK J TRS 700 SHETLAND RD LAS VEGAS NV 89107-4514	13932801011
POPPE JANE	P O BOX 30265 LAS VEGAS NV 89173	13932306020
QUAIL PARK IV L L C	195 E RENO AVE #A LAS VEGAS NV 89119-1123	13932412003
QUAIL PARK IV L L C	195 E RENO AVE #A LAS VEGAS NV 89119-1123	13932412005
QUAIL PARK IV L L C	195 E RENO AVE #A LAS VEGAS NV 89119-1123	13932411024
QUAIL PARK IV L L C	195 E RENO AVE #A LAS VEGAS NV 89119-1123	13932411026
QUAIL PARK IV L L C	195 E RENO AVE #A LAS VEGAS NV 89119-1123	13932411005
QUAIL PARK IV L L C	195 E RENO AVE #A LAS VEGAS NV 89119-1123	13932412026
QUAIL PARK IV L L C	195 E RENO AVE #A LAS VEGAS NV 89119-1123	13932411010
QUAIL PARK IV L L C	195 E RENO AVE #A LAS VEGAS NV 89119-1123	13932411031
QUAIL PARK IV L L C	195 E RENO AVE #A LAS VEGAS NV 89119-1123	13932411027
QUAIL PARK IV L L C	195 E RENO AVE #A LAS VEGAS NV 89119-1123	13932411042

Report of All Selected Parcels

Case Number: VAR-62407, WVR-62353, '62201)

TMP-62358 (PRJ- Printed On: Wed: January 27, 2016

<u>Owner</u>	<u>Address</u>	<u>Parcel Number</u>
QUAIL PARK IV L L C	195 E RENO AVE #A LAS VEGAS NV 89119-1123	13932412033
QUAIL PARK IV L L C	195 E RENO AVE #A LAS VEGAS NV 89119-1123	13932411011
QUAIL PARK IV L L C	195 E RENO AVE #A LAS VEGAS NV 89119-1123	13932411006
QUAIL PARK IV L L C	195 E RENO AVE #A LAS VEGAS NV 89119-1123	13932412032
QUAIL PARK IV L L C	195 E RENO AVE #A LAS VEGAS NV 89119-1123	13932411033
QUAIL PARK IV L L C	195 E RENO AVE #A LAS VEGAS NV 89119-1123	13932412017
QUAIL PARK IV L L C	195 E RENO AVE #A LAS VEGAS NV 89119-1123	13932411017
QUAIL PARK IV L L C	195 E RENO AVE #A LAS VEGAS NV 89119-1123	13932412006
QUAIL PARK IV L L C	195 E RENO AVE #A LAS VEGAS NV 89119-1123	13932412024
QUAIL PARK IV L L C	195 E RENO AVE #A LAS VEGAS NV 89119-1123	13932412023
QUAIL PARK IV L L C	195 E RENO AVE #A LAS VEGAS NV 89119-1123	13932412027
QUAIL PARK IV L L C	195 E RENO AVE #A LAS VEGAS NV 89119-1123	13932411002
QUAIL PARK IV L L C	195 E RENO AVE #A LAS VEGAS NV 89119-1123	13932411039
QUAIL PARK IV L L C	195 E RENO AVE #A LAS VEGAS NV 89119-1123	13932411023
QUAIL PARK IV L L C	195 E RENO AVE #A LAS VEGAS NV 89119-1123	13932411003
QUAIL PARK IV L L C	195 E RENO AVE #A LAS VEGAS NV 89119-1123	13932411032
QUAIL PARK IV L L C	195 E RENO AVE #A LAS VEGAS NV 89119-1123	13932412010
QUAIL PARK IV L L C	195 E RENO AVE #A LAS VEGAS NV 89119-1123	13932412029
QUAIL PARK IV L L C	195 E RENO AVE #A LAS VEGAS NV 89119-1123	13932412031
QUAIL PARK IV L L C	195 E RENO AVE #A LAS VEGAS NV 89119-1123	13932412022
QUAIL PARK IV L L C	195 E RENO AVE #A LAS VEGAS NV 89119-1123	13932412040
QUAIL PARK IV L L C	195 E RENO AVE #A LAS VEGAS NV 89119-1123	13932412028
QUAIL PARK IV L L C	195 E RENO AVE #A LAS VEGAS NV 89119-1123	13932412019
QUAIL PARK IV L L C	195 E RENO AVE #A LAS VEGAS NV 89119-1123	13932412001
QUAIL PARK IV L L C	195 E RENO AVE #A LAS VEGAS NV 89119-1123	13932412021
QUAIL PARK IV L L C	195 E RENO AVE #A LAS VEGAS NV 89119-1123	13932411007
QUAIL PARK IV L L C	195 E RENO AVE #A LAS VEGAS NV 89119-1123	13932411021
QUAIL PARK IV L L C	195 E RENO AVE #A LAS VEGAS NV 89119-1123	13932412030
QUAIL PARK IV L L C	195 E RENO AVE #A LAS VEGAS NV 89119-1123	13932412007
QUAIL PARK IV L L C	195 E RENO AVE #A LAS VEGAS NV 89119-1123	13932411019
QUAIL PARK IV L L C	195 E RENO AVE #A LAS VEGAS NV 89119-1123	13932411009
QUAIL PARK IV L L C	195 E RENO AVE #A LAS VEGAS NV 89119-1123	13932411041

Report of All Selected Parcels

Case Number: VAR-62407, WVR-62353, \62201)

; TMP-62358 (PRJ- Printed On: Wed: January 27, 2016

<u>Owner</u>	<u>Address</u>	<u>Parcel Number</u>
QUAIL PARK IV L L C	195 E RENO AVE #A LAS VEGAS NV 89119-1123	13932411040
QUAIL PARK IV L L C	195 E RENO AVE #A LAS VEGAS NV 89119-1123	13932412008
QUAIL PARK IV L L C	195 E RENO AVE #A LAS VEGAS NV 89119-1123	13932411022
QUAIL PARK IV L L C	195 E RENO AVE #A LAS VEGAS NV 89119-1123	13932411030
QUAIL PARK IV L L C	195 E RENO AVE #A LAS VEGAS NV 89119-1123	13932412037
QUAIL PARK IV L L C	195 E RENO AVE #A LAS VEGAS NV 89119-1123	13932411020
QUAIL PARK IV L L C	195 E RENO AVE #A LAS VEGAS NV 89119-1123	13932411018
QUAIL PARK IV L L C	195 E RENO AVE #A LAS VEGAS NV 89119-1123	13932411029
QUAIL PARK IV L L C	195 E RENO AVE #A LAS VEGAS NV 89119-1123	13932411001
QUAIL PARK IV L L C	195 E RENO AVE #A LAS VEGAS NV 89119-1123	13932412020
QUAIL PARK IV L L C	195 E RENO AVE #A LAS VEGAS NV 89119-1123	13932411028
QUAIL PARK IV L L C	195 E RENO AVE #A LAS VEGAS NV 89119-1123	13932412041
QUAIL PARK IV L L C	195 E RENO AVE #A LAS VEGAS NV 89119-1123	13932412009
QUAIL PARK IV L L C	195 E RENO AVE #A LAS VEGAS NV 89119-1123	13932412042
QUAIL PARK IV L L C	195 E RENO AVE #A LAS VEGAS NV 89119-1123	13932411012
QUAIL PARK IV L L C	195 E RENO AVE #A LAS VEGAS NV 89119-1123	13932411008
QUAIL PARK IV L L C	195 E RENO AVE #A LAS VEGAS NV 89119-1123	13932411037
QUAIL PARK IV L L C	195 E RENO AVE #A LAS VEGAS NV 89119-1123	13932412018
QUAIL PARK IV L L C	195 E RENO AVE #A LAS VEGAS NV 89119-1123	13932412038
QUAIL PARK IV L L C	195 E RENO AVE #A LAS VEGAS NV 89119-1123	13932412016
QUAIL PARK IV L L C	195 E RENO AVE #A LAS VEGAS NV 89119-1123	13932412012
QUAIL PARK IV L L C	195 E RENO AVE #A LAS VEGAS NV 89119-1123	13932412034
QUAIL PARK IV L L C	195 E RENO AVE #A LAS VEGAS NV 89119-1123	13932411016
QUAIL PARK IV L L C	195 E RENO AVE #A LAS VEGAS NV 89119-1123	13932411038
QUAIL PARK IV L L C	195 E RENO AVE #A LAS VEGAS NV 89119-1123	13932411036
QUAIL PARK IV L L C	195 E RENO AVE #A LAS VEGAS NV 89119-1123	13932412025
QUAIL PARK IV L L C	195 E RENO AVE #A LAS VEGAS NV 89119-1123	13932412035
QUAIL PARK IV L L C	195 E RENO AVE #A LAS VEGAS NV 89119-1123	13932411025
QUAIL PARK IV L L C	195 E RENO AVE #A LAS VEGAS NV 89119-1123	13932412002
QUAIL PARK IV L L C	195 E RENO AVE #A LAS VEGAS NV 89119-1123	13932411034
QUAIL PARK IV L L C	195 E RENO AVE #A LAS VEGAS NV 89119-1123	13932412039
QUAIL PARK IV L L C	195 E RENO AVE #A LAS VEGAS NV 89119-1123	13932411014

Report of All Selected Parcels**Case Number:** VAR-62407, WVR-62353, 62201) TMP-62358 (PRJ- **Printed On:** Wed: January 27, 2016

<u>Owner</u>	<u>Address</u>	<u>Parcel Number</u>
QUAIL PARK IV L L C	195 E RENO AVE #A LAS VEGAS NV 89119-1123	13932412004
QUAIL PARK IV L L C	195 E RENO AVE #A LAS VEGAS NV 89119-1123	13932412036
QUAIL PARK IV L L C	195 E RENO AVE #A LAS VEGAS NV 89119-1123	13932411015
QUAIL PARK IV L L C	195 E RENO AVE #A LAS VEGAS NV 89119-1123	13932412013
QUAIL PARK IV L L C	195 E RENO AVE #A LAS VEGAS NV 89119-1123	13932412015
QUAIL PARK IV L L C	195 E RENO AVE #A LAS VEGAS NV 89119-1123	13932411004
QUAIL PARK IV L L C	195 E RENO AVE #A LAS VEGAS NV 89119-1123	13932411035
QUAIL PARK IV L L C	195 E RENO AVE #A LAS VEGAS NV 89119-1123	13932411013
QUAIL PARK IV L L C	195 E RENO AVE #A LAS VEGAS NV 89119-1123	13932412014
RANDO FAMILY TRUST	RANDO ARTHUR J TRS 600 S CAMPBELL DR LAS VEGAS NV 89107-4445	13932311014
RODRIGUEZ BENJAMIN J	3000 W CHARLESTON BLVD #3 LAS VEGAS NV 89102-1990	13932405019
RODRIGUEZ NDAP TRUST	RODRIGUEZ BENJAMIN JOHN & TERI D 25 SOARING BIRD CT LAS VEGAS NV 89135	13932405022
ROGERS PERRY C TRUST	ROGERS PERRY C TRS 3000 ARABIAN RD LAS VEGAS NV 89107-4502	13932305004
RUBIN FAMILY TRUST	700 CAMPBELL DR LAS VEGAS NV 89107-4408	13932404002
RUBIN FAMILY TRUST	RUBIN ROBERT J TRS 711 CAMPBELL DR LAS VEGAS NV 89107-4405	13932306009
RUIMI FAMILY TRUST	RUIMI AVI & MARIA TRS 4322 W CHEYENNE AVE NORTH LAS VEGAS NV 89032	13932305001
SALVATION ARMY	P O BOX 28369 LAS VEGAS NV 89126-2369	13932306013
SAMUEL COLEMAN SIEGEL	26885 VIA LINDA MALIBU CA 90265-4453	13932404007
SANCHEZ AFRICA A	SANCHEZ-HERNANDEZ LEONEL 846 S KENNY WY LAS VEGAS NV 89107-4436	13932410009
SCENIC VISTAS L L C	1116 MARSHFIELD RD LAS VEGAS NV 89135-1324	16205501002
SCHOOL BOARD OF TRUSTEES	4190 MCLEOD DR 2ND FLR LAS VEGAS NV 89121	13932405006
SCHWARTZ JASON & SHARI	733 S KENNY WY LAS VEGAS NV 89107-4427	13932311010
SHELTON GARY ANTHONY & SHELLY M	845 KENNY WY LAS VEGAS NV 89107-4437	13932404015
SHETLAND LAND L L C	7301 PEAK DR #200 LAS VEGAS NV 89133	13932801008
SHETLAND LAND L L C	7301 PEAK DR #200 LAS VEGAS NV 89133	13932801009
SHETLAND LAND L L C	P O BOX 36900 LAS VEGAS NV 89133	13932801010
SHETLAND MUTUAL WATER ASSN	701 SHETLAND DR LAS VEGAS NV 89107-4519	13932801002
STATE BAR NEVADA	3100 W CHARLESTON BLVD LAS VEGAS NV 89102	13932403014
STILES GREGORY WAYNE	820 S KENNY WAY LAS VEGAS NV 89107-4436	13932410013
STONE JAMES D & JULIE T	3259 HASTINGS AVE LAS VEGAS NV 89107-4431	13932403002
STUHFF PAUL	724 S KENNY WY LAS VEGAS NV 89107-4426	13932310017
SWEET MARILYN WEEKS	848 N RAINBOW #2408 LAS VEGAS NV 89107-1103	13932403004

Report of All Selected Parcels

Case Number: VAR-62407, WVR-62353, (622U1) TMP-62358 (PRJ- **Printed On:** Wed: January 27, 2016

<u>Owner</u>	<u>Address</u>	<u>Parcel Numbe</u>
TITAN IRREVOCABLE TRUST	823 CAMPBELL DR LAS VEGAS NV 89107-4407	13932405025
TOM ENTERPRISES	820 RANCHO LN #85 LAS VEGAS NV 89106	16205510002
TOPSHAM L L C	129 HUGHES BAY RD LOPEZ ISLAND WA 98261-8573	13932303002
TRAN THANG-TOM THIEN M D PROF CO	P O BOX 27782 LAS VEGAS NV 89126-1782	16205115003
VELA ANTHONY & VIRGINIA	818 CAMPBELL DR LAS VEGAS NV 89107-4446	13932404016
VESELLA TRUST	VESELLA ADAM TRS 705 KENNY WY LAS VEGAS NV 89107-4427	13932311006
VISTA MEDICAL ASSOCIATES INC	221 PIAZZA DEL VERANO ST LAS VEGAS NV 89138-1549	16205510003
YAKAITIS STEPHEN A & BASIA P	800 S KENNY WY LAS VEGAS NV 89107-4436	13932410016
ZEHENDER G W DECLARATION TRUST	ZEHENDER GEORGE WILLIAM TRS 6231 EMBARCADERO DR STOCKTON CA 95219-3823	13932311011