



# Legal Notices Transmittal and Scanning Separator Sheet

---

## Legal Notice Type: Legal Mailings

---

Date of Transfer to ERM: 7/27/2011

Page Count: 10

---

Meeting Date: 8/17/2011

Meeting Type: City Council <=>

Case Number(s): VAR-41903 <=>

Subject of Affidavit: APPLICANT/OWNER: JIM PROPERTIES, LLC - 815 Shetland Road <=>

Record Series: Legal Notices

LRDA Number: 2007-1717

Retention: Permanent

File By: Meeting Date

---



Prepared By: acrolli  
**SCANNED**

Scanned By:  
JUL 27 2011

QC By: \_\_\_\_\_

## Application Information

VAR-41903 - APPLICANT/OWNER: JJM PROPERTIES, LLC -  
For possible action on a request for a Variance TO ALLOW A TWO-  
FOOT SIDE YARD SETBACK FOR A PROPOSED 500 SQUARE-  
FOOT ATTACHED CARPORT WHERE 15 FEET IS REQUIRED  
on 0.80 acres at 815 Shetland Road (APN 139-32-802-016), R-E  
(Residence Estates) Zone, Ward 1 (Tarkanian).

## Application Location

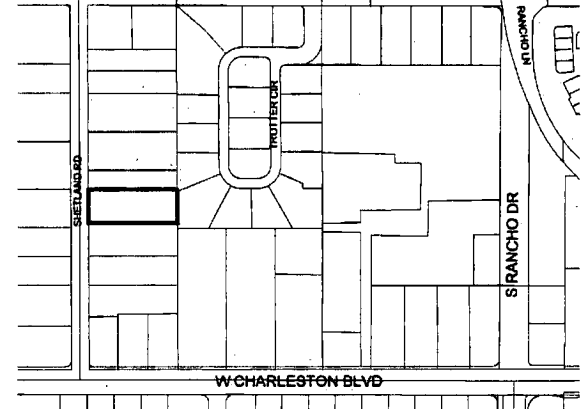

The proposed project may not pertain to the entire highlighted project site.

## Public Hearing Information

**Meeting:** City Council  
**Date:** August 17, 2011  
**Time:** 1:00 P.M.  
**Location:** City Council Chambers  
400 Stewart Avenue  
Las Vegas, Nevada

Any and all interested persons may appear and be heard at said meeting, or may, prior thereto, file written objections thereto or approvals thereof with the City Clerk, 1st Floor, City Hall, 400 Stewart Avenue, Las Vegas, Nevada, 89101. For further information, including the full staff report, please call (702) 229-6311 (TDD 386-9108) or go to <http://www.lasvegasnevada.gov>.

City of Las Vegas  
Office Of The City Clerk  
400 Stewart Avenue  
Las Vegas, Nevada 89101

**Return Service Requested**  
**Official Notice of Public Hearing**

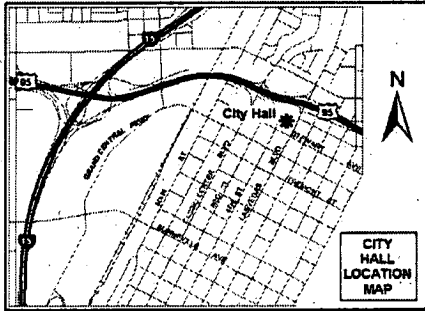

If you wish to file your protest or support on this request, check the appropriate box below and return this card in an envelope with postage to the Office Of The City Clerk at the address listed above or fax this side of this card to (702) 382-4803. If you would like to contact your Council Representative, please call (702) 229-6405.

I SUPPORT  
this Request

I OPPOSE  
this Request

Please use available blank space on card for your comments.

**VAR-41903**

City Council Meeting of 8/17/2011

CASE# VAR-41903

PARCEL#	OWNER	ADDRESS1	ADDRESS2	ADDRESS3	ADDRESS4	ADDRESS5
1	13932802031	2350 WEST CHARLESTON BLVD L L C	%L SHAPIRO	10300 W CHARLESTON BLVD #13-156	LAS VEGAS NV 89135-1037	
2	13932801013	810 SHETLAND L L C	3004 CAMPBELL CIR	LAS VEGAS NV 89107-3214		
3	13932306022	AGUILERA LILIA MARCELA HOLGIN	425 CAMINO REAL AVE	EL PASO TX 79922-2003		
4	13932802010	ALBISER BRIAN & JUDY	805 S SHETLAND RD	LAS VEGAS NV 89107-4519		8/17/2011 VAR-41903 Mr. Joseph Momot JJM Properties 815 Shetland Road Las Vegas, Nevada a89107
5	16205512019	ALLEN CHRISTOPHER S	1125 CAHLAN DR	LAS VEGAS NV 89102-2113		
6	16205512009	ARMSTRONG LESTER A & BINA M D	1110 STRONG DR	LAS VEGAS NV 89102-2134		
7	16205512007	B M K ENTERPRISES L L C	%T KERESTESI	%CRAGIN & PIKE	2603 W CHARLESTON BLVD	LAS VEGAS NV 89102-2121
8	13932802017	BALDWIN DAVID & JOAN	819 SHETLAND RD	LAS VEGAS NV 89107-4519		
9	16205510006	BALLE CENTER L L C	2801 W CHARLESTON BLVD #100	LAS VEGAS NV 89102-1965		
10	16205512005	BALLE FAMILY L P	6670 PALMYRA AVE	LAS VEGAS NV 89146-6539		
11	16205510004	BANK CENTENNIAL	18837 BROOKHURST ST #100	FOUNTAIN VALLEY CA 92708-7301		
12	13932412011	BERMAN ANDREW G	BERMAN WALTER & DOROTHY TR #1	%ORIX REAL EST CAPITAL MARKETS	%ESCROW ADMIN	1717 MAIN ST 12TH FLOOR TX1-2495 DALLAS TX 75201-4612
13	13932810017	BOUCHARD C H & JOYCE L	BOUCHARD TRACY R	849 TROTTER CIR	LAS VEGAS NV 89107-4508	
14	13932810024	BRUNI JUSTIN	832 TROTTER CIR	LAS VEGAS NV 89107-4501		

CASE# VAR-41903

PARCEL#	OWNER	ADDRESS1	ADDRESS2	ADDRESS3	ADDRESS4	ADDRESS5
15	13932702021	BRUNO RICHARD ALLEN TRUST	BRUNO RICHARD A TRS	2426 PALOMINO LN	LAS VEGAS NV 89107-4504	
16	16205511008	BUSTAN FAMILY REVOCABLE LIV TR	BUSTAN DAVID TRS	16600 SHERMAN WY #200	VAN NUYS CA 91406-3794	
17	13932802021	CARRILLO DEBRA L & RAYMOND J	825 SHETLAND RD	LAS VEGAS NV 89107-4519		
18	13932801012	CASON JACK E & MAXINE FAMILY TR	CASON JACK E & MAXINE TRS	2200 S HIGHLAND DR	LAS VEGAS NV 89102-4629	
19	13932801011	CASON PATRICK J TRUST	CASON PATRICK J TRS	700 SHETLAND RD	LAS VEGAS NV 89107-4514	
20	13932801008	CATANZARITE KENNETH J	2331 W LINCOLN AVE	ANAHEIM CA 92801-5103		
21	13932802032	CHARLESTON RANCHO L L C	%P SCHWARTZ	2877 PARADISE RD	LAS VEGAS NV 89109-5236	
22	16205511024	CHRISTENSEN JULIANE R & JOSEPH	2500 SHERMAN PL	LAS VEGAS NV 89102-2151		
23	13932702020	CLERMONT ANDRAYA	2500 PALOMINO LN	LAS VEGAS NV 89107-4512		
24	16205511005	COOK ALVY F	1117 STRONG DR	LAS VEGAS NV 89102-2133		
25	13932810019	CURTAS JOHN A	GORANSON ALEXANDRA	813 TROTTER CIR	LAS VEGAS NV 89107-4508	
26	13932703004	D A R LIVING TRUST	ROBINS DAVID M & ANNA M TRS	3100 CONNERS DR	LAS VEGAS NV 89107-3226	
27	16205512013	DRAGO ANTHONY R FAM TR	DRAGO MARY JANE TRS	2612 ASHBY AVE	LAS VEGAS NV 89102-2102	
28	16205512008	EGTEDAR ROBAB	2601 W CHARLESTON BLVD	LAS VEGAS NV 89102-2153		

CASE# VAR-41903

	PARCEL#	OWNER	ADDRESS1	ADDRESS2	ADDRESS3	ADDRESS4	ADDRESS5
29	13932810018	EVANS EARL & JOANNE TRUST	EVANS JOANNE S TRS	1710 BROCK CT	LAS VEGAS NV 89117-1625		
30	13932802018	F H S LAS VEGAS L P	STEPHENSON PATRICIA SUDDABY TR	%GOLDFARB & SIMENS	111 PINE ST 18TH FLOOR	SAN FRANCISCO CA 94111-5620	
31	13932801010	FAYLONA INVESTMENTS L L C	1827 INDIAN BEND DR	HENDERSON NV 89074-1032			
32	13932810001	FOGEL BONNIE L & HUGH A	2425 PALOMINO LN	LAS VEGAS NV 89107-4505			
33	13932810010	GARCIA MARIO A & ELSA F	824 TROTTER CIR	LAS VEGAS NV 89107-4501			
34	13932702019	GIBSON GARY D & JUANETA G FAM TR	GIBSON GARY D & JUANETA G TRS	2520 PALOMINO LN	LAS VEGAS NV 89107-4512		
35	16205512012	GILES DAVID M TRUST	GILES DAVID M CO-TRS	2608 ASHBY AVE	LAS VEGAS NV 89102-2102		
36	13932810021	GORDON HENRY & MARTHA FAMILY TR	800 TROTTER CIR	LAS VEGAS NV 89107-4501			
37	13932810016	GREEN BEUFORD LEON & PATRICIA A	848 TROTTER CIR	LAS VEGAS NV 89107-4501			
38	13932703006	GRONBACH C W & A REV LIV FAM TR	GRONBACH CHARLES W & ADELE M TRS	642 SHETLAND RD	LAS VEGAS NV 89107-4528		
39	13932802001	GUTHRIE ROBERT & PATRICIA FAM TR	701 SHETLAND RD	LAS VEGAS NV 89107-4519			
40	13932802009	GUZMAN ARNULFO V & JUANA	721 SHETLAND RD	LAS VEGAS NV 89107-4519			
41	13932702027	HADDAD PATRICK V	321 W LAKE MEAD PKWY	HENDERSON NV 89015-7029			
42	13932703008	HINDELANG PAUL E JR	296 LAS ENTRADAS DR	SANTA BARBARA CA 93108-2659			

CASE# VAR-41903

PARCEL#	OWNER	ADDRESS1	ADDRESS2	ADDRESS3	ADDRESS4	ADDRESS5
43	16205512010	HOWARD PRESTON B & ALEXIS	1124 STRONG DR	LAS VEGAS NV 89102-2134		
44	13932703013	IGLESIAS ANER TRUST 1997	IGLESIAS ANER TRS	166 CIRCLE DR	BRADBURY CA 91008-1005	
45	13932802016	J J M PROPERTIES L L C	520 S 4TH ST #300	LAS VEGAS NV 89101-6524		
46	13932703002	JABARA MICHAEL SEPARATE PPTY TR	JABARA MICHAEL TRS	2709 PINTO LN	LAS VEGAS NV 89107-4617	
47	16205512014	JAIN SHAILY	2700 ASHBY AVE	LAS VEGAS NV 89102-2135		
48	13932810008	JIANU FAMILY TRUST	JIANU TUDOR C & DOINA ROXANA TRS	816 TOTTER CIR	LAS VEGAS NV 89107-4501	
49	13932801007	KASS JOHN G & VIRGINIA A LIV TR	KASS JOHN G & VIRGINIA A TRS	818 SHETLAND RD	LAS VEGAS NV 89107-4520	
50	13932810009	KLOCHKO VITALI	820 TROTTER CIR	LAS VEGAS NV 89107-4501		
51	13932801003	KOTCHKA-SMITH FAMILY TRUST	SMITH GREGORY E TRS	804 SHETLAND RD	LAS VEGAS NV 89107-4520	
52	13932703003	KUNSBERG PHILIP	1254 CAMPBELL DR	LAS VEGAS NV 89102-1918		
53	13932702024	LACAYO ENRIQUE J & CAROLINE S	2400 PALOMINO LN	LAS VEGAS NV 89107-4504		
54	16205511011	LAS VEGAS MTGE CO INC	7160 AZURE DR	LAS VEGAS NV 89130-1014		
55	13932802024	LAS VEGAS SURGICARE INC	%HCA INDIRECT TAXES	P O BOX 1504	NASHVILLE TN 37202-1504	
56	13932801009	LOX OF BAGELS CORPORATION	11801 PRESTWICK RD	POTOMAC MD 20854-3631		

## CASE# VAR-41903

	PARCEL#	OWNER	ADDRESS1	ADDRESS2	ADDRESS3	ADDRESS4	ADDRESS5
57	13932802003	LUCK J P	%J DAGOSTINO	P M B 377	840 S RANCHO DR #4	LAS VEGAS NV 89106-3800	
58	16205512006	M G T ENTERPRISES L L C	%M MCKINLEY	%CRAGIN & PIKE	2603 W CHARLESTON BLVD	LAS VEGAS NV 89102-2121	
59	13932802006	MARCHAND CHRISTOPHER & STEPHANIE	2317 PALOMINO LN	LAS VEGAS NV 89107-4503			
60	16205511004	MARTIN DAVID KEVIN	1127 STRONG DR	LAS VEGAS NV 89102-2133			
61	13932802005	MASON THOMAS J & YOLANDA C	8108 SUNSET COVE DR	LAS VEGAS NV 89128-7714			
62	13932801004	MCDONALD RANDALL & TONI LIV TR	MCDONALD RANDALL LYLE & TONI TRS	808 SHETLAND RD	LAS VEGAS NV 89107-4520		
63	13932810014	MCINTIRE GREG & NADINE LIVING TR	MCINTIRE GREGORY W & NADINE TRS	840 TROTTER CIR	LAS VEGAS NV 89107-4501		
64	13932802011	MOLASKY ANDREW REVOCABLE FAM TR	MOLASKY ANDREW TRS	100 CITY PKWY #1700	LAS VEGAS NV 89106-4614		
65	13932810003	NAMBOT SURVIVORS TRUST	TOBMAN JEAN TRS	2433 PALOMINO LN	LAS VEGAS NV 89107-4505		
66	13932802036	NARAN JAIVADAN & HANSA JT LIV TR	NARAN JAIVADAN & HANSA TRS	2747 PARADISE RD #2701	LAS VEGAS NV 89109-9052		
67	13932802014	NELSON ALEDA C TRUST	NELSON ALEDA C TRS	3611 S LINDELL #201	LAS VEGAS NV 89103-1241		
68	16205510007	NEWBERRY DENNIS & SHIRLEY FAM TR	NEWBERRY DENNIS W & SHIRLEY TRS	1124 CAHLAN DR	LAS VEGAS NV 89102-2114		
69	16205511025	NEWTON THOMAS JERALD	1122 BUEHLER DR	LAS VEGAS NV 89102-2106			
70	16205511013	ORSOSITO L L C	2720 S BRONCO ST	LAS VEGAS NV 89146-5206			

CASE# VAR-41903

PARCEL#	OWNER	ADDRESS1	ADDRESS2	ADDRESS3	ADDRESS4	ADDRESS5
71	13932702011	PAGEAU FAMILY TRUST	KRISMAN-PAGEAU CAROLYN TRS	2525 PINTO LN	LAS VEGAS NV 89107-4625	
72	13932810022	PALOMINO GARDENS HOMEOWNERS ASSN	824 TROTTER CIR	LAS VEGAS NV 89107-4501		
73	13932703011	PALOMINO PONY L L C	413 PARKWAY EAST	LAS VEGAS NV 89106		
74	13932810015	PARIS CLARKE A & TRACIE A	844 TROTTER CIR	LAS VEGAS NV 89107-4501		
75	16205511006	PARK SUNG	11960 CENTRALIA BLVD #101	HAWAIIAN GARDENS CA 90716-2293		
76	16205511023	PETERSON MARIE	2420 SHERMAN PL	LAS VEGAS NV 89102-2150		
77	16205511022	PIAS-ARIAS EMILIO	2416 SHERMAN PL	LAS VEGAS NV 89102-2150		
78	13932703009	PLASTER BRIAN & MARGARET FAM TR	PLASTER BRIAN R & MARGARET B TRS	801 S RANCHO DR #E4	LAS VEGAS NV 89106-3812	
79	16205511010	PREMIER DENTAL ASSOCIATES L L C	2421 W CHARLESTON BLVD	LAS VEGAS NV 89102-2123		
80	13932412029	QUAIL PARK IV L L C	%RIBEIRO CO	195 E RENO AVE #A	LAS VEGAS NV 89119-1123	
81	13932802028	R A D MANAGEMENT L L C	10624 S EASTERN AVE #A425	HENDERSON NV 89052-2982		
82	16205511009	RED TWIG L L C	2501 W CHARLESTON BLVD	LAS VEGAS NV 89102-2127		
83	13932802002	ROBERTS JOSEPH G REV FAM TR	ROBERTS JOSEPH G TRS	711 RANCHO CIR	LAS VEGAS NV 89107-4619	
84	13932306013	SALVATION ARMY	P O BOX 28369	LAS VEGAS NV 89126-2369		

## CASE# VAR-41903

PARCEL#	OWNER	ADDRESS1	ADDRESS2	ADDRESS3	ADDRESS4	ADDRESS5
85	13932702018	SANTELMAN C W & J L REV LIV TR	SANTELMAN CHARLES W & JUDY L TRS	2550 PALOMINO LN	LAS VEGAS NV 89107-4512	
86	13932810020	SANWAL V P A TRUST	SANWAL VIRENDER & PREETHA TRS	837 TROTTER CIR	LAS VEGAS NV 89107-4508	
87	13932405006	SCHOOL BOARD OF TRUSTEES	2832 E FLAMINGO RD	LAS VEGAS NV 89121-5205		
88	13932801002	SHETLAND MUTUAL WATER ASSN	701 SHETLAND DR	LAS VEGAS NV 89107-4519		
89	13932802029	SILVA EDWARD C	2500 W CHARLESTON BLVD	LAS VEGAS NV 89102-2175		
90	16205501001	SOKA GAKKAI INTERNATIONAL-USA	606 WILSHIRE BLVD	SANTA MONICA CA 90401-1502		
91	13932802004	STANLEY DAVID A & EILEEN	957 WOODLAWN DR	THOUSAND OAKS CA 91360-2575		
92	13932703010	STONE ASSETS L L C	801 S RANCHO DR #E4	LAS VEGAS NV 89106-3812		
93	16205512004	T M S PPTYS	2701 W CHARLESTON BLVD	LAS VEGAS NV 89102-2154		
94	16205511007	TAN & RICA L L C	%M GAERLAN	10404 ORKINEY DR	LAS VEGAS NV 89144-4328	
95	13932703005	TARKANIAN PAMELA	KING ERIK	2601 PINTO LN	LAS VEGAS NV 89107-4614	
96	13932802026	VER-LEN CORP	P O BOX 30785	LAS VEGAS NV 89173-0785		
97	16205510003	VISTA MEDICAL ASSOCIATES INC	221 PIAZZA DEL VERANO ST	LAS VEGAS NV 89138-1549		
98	16205511012	WATERVIEW REAL PPTY GRP NV L L C	P O BOX 27691	LAS VEGAS NV 89126-1691		

CASE# VAR-41903

	PARCEL#	OWNER	ADDRESS1	ADDRESS2	ADDRESS3	ADDRESS4	ADDRESS5
99	13932802012	WEINGARTEN NOSTAT INC	BILLBOX #01-1914- 395	HOUSTON TX 77253			
100	16205512002	WEINSTEIN SUSAN & E LIV TR	WEINSTEIN SUSAN & EDWARD TRS	%H & L REALTY & MGT CO	P O BOX 7440	LAS VEGAS NV 89125-7440	
101	16205513013	WHEATLEY RONALD W & BARBARA	1126 BUEHLER DR	LAS VEGAS NV 89102-2106			
102	13932802025	WINCKLER GARTH R & KAREN C	835 SHETLAND RD	LAS VEGAS NV 89107-4519			
103	13932802019	WINDROSE MEDICAL PROPERTIES L P	%UNITED HEALTH CARE SERV INC	%LEASE ADMIN MN008-E305	9900 BRAN RD E	MINNETONKA MN 55343	
104	16205512015	YAKOUBOFF BIJAN TRUST	YAKOUBOFF BIJAN TRS	2706 ASHBY AVE	LAS VEGAS NV 89102-2135		
105	13932810007	YARBROUGH CHESTER D & MICHELLE B	7445 UTE MEADOWS CIR	LAS VEGAS NV 89129-5938			
106	13932810011	ZIPF NEVADA MANAGEMENT L L C	%D & C ZIPF, MGRS	828 TROTTER CIR	LAS VEGAS NV 89107-4501		