

City of Las Vegas  
Office Of The City Clerk  
495 South Main Street, 2<sup>nd</sup> Floor  
Las Vegas, Nevada 89101

PRSR  
FIRST CLASS MAIL  
U.S. Postage  
**PAID**  
Las Vegas, NV  
Permit No. 1630

**Return Service Requested**  
**Official Notice of Public Hearing**

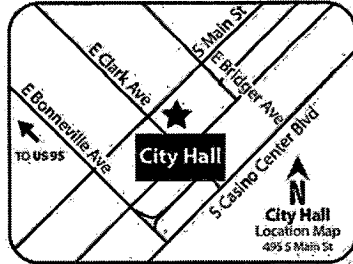

If you wish to file your protest or support on this request, check the appropriate box below and return this card in an envelope with postage to the Office Of The City Clerk at the address listed above or fax this side of this card to (702) 382-4803. If you would like to contact your Council Representative, please call (702) 229-6405.

I SUPPORT  
this Request

I OPPOSE  
this Request

Please use available blank space on card for your comments.

**SUP-64482 [PRJ-64426]**

City Council Meeting of July 20, 2016

## Application Information

**SUP-64482 - SPECIAL USE PERMIT - PUBLIC HEARING - APPLICANT: BOULEVARD MEDICAL, LLC - OWNER: FLORESTA INC.** - For possible action on a request for a Special Use Permit FOR A PROPOSED 11,040 SQUARE-FOOT MEDICAL MARIJUANA CULTIVATION FACILITY WITH A WAIVER TO ALLOW THE MEDICAL MARIJUANA CULTIVATION USE UNDER THE SAME ROOF AS ANOTHER USE at 3070 Sirius Avenue, Suite #103 (APN 162-08-303-032), M (Industrial) Zone, Ward 1 (Tarkanian) [PRJ-64426].

## Application Location

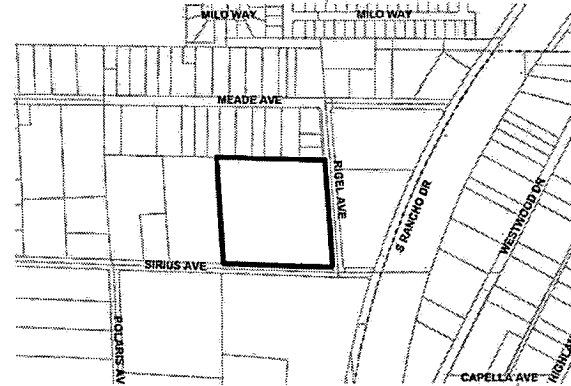

The proposed project may not pertain to the entire highlighted project site.

## Public Hearing Information

**Meeting:** City Council  
**Date:** *July 20, 2016*  
**Time:** 1:00 P.M.  
**Location:** City Council Chambers  
495 South Main Street, 2<sup>nd</sup> Floor  
Las Vegas, Nevada

Any and all interested persons may appear and be heard at said meeting, or may, prior thereto, file written objections thereto or approvals thereof with the City Clerk, 2<sup>nd</sup> Floor, City Hall, 495 South Main Street, Las Vegas, Nevada, 89101. For further information, please call (702) 229-6311 (TTY 7-1-1) or go to <http://www.lasvegasnevada.gov>. Note that postcards and comments received after an agenda posts will not be reflected online until after the meeting; however, the comments are made available to the members of the governing body for their consideration prior to the meeting.

**Report of All Selected Parcels**

**Case Number:**

SUP-64482

**Printed On:** Mon: June 27, 2016

<u>Owner</u>	<u>Address</u>	<u>Parcel Number</u>
3100 MEAD L L C	3100 MEADE AVE LAS VEGAS NV 89102-7892	16208301019
3100 MEAD L L C	3100 MEAD AVE LAS VEGAS NV 89102-7892	16208301023
3100 MEAD L L C	3100 MEAD AVE LAS VEGAS NV 89102-7892	16208201005
ACCESS BARGAIN STORAGE L L C	1331 N W LOVEJOY ST #755 PORTLAND OR 97209	16208802001
ANTOKU D J & M V REV LIV TR ETAL	ANTOKU TIMOTHY TAKASHI & CAROL A 2020 CLEMENT ST HONOLULU HI 96822	16208303029
ARANA MARISELA S	2821 SULTANA ST LAS VEGAS NV 89102-5978	16208211035
B M S D PROPERTIES L L C	5113 N TOMSIK ST LAS VEGAS NV 89149	16208303013
BARBOUR DESIREE A	2832 NORTHAM ST LAS VEGAS NV 89102-0130	16208210024
BLACKACRE PROPERTIES L L C SERIE	3878 W OQUENDO RD LAS VEGAS NV 89118-3009	16208703012
BORLASE/KNAUFF L L C	3120 MEADE AVE LAS VEGAS NV 89102-7892	16208301018
BUNCH FAMILY TRUST	BUNCH GERARD & TRACY TRS 3013 MILO WAY LAS VEGAS NV 89102-5983	16208211031
CHEN YING	12440 HAZELTINE DR TUSTIN CA 94520	16208212013
CLEMENS FAMILY TRUST	CLEMENS JANICE JOY TRS P O BOX 80927 LAS VEGAS NV 89180-0927	16208803002
CLUKA TYLOR M	2825 NORTHAM ST LAS VEGAS NV 89102-5986	16208210027
CRAB HOLDINGS L L C	2756 N GREEN VALLEY PKWY #197 HENDERSON NV 89014	16208301013
CRAB HOLDINGS L L C	2756 N GREEN VALLEY PKWY #197 HENDERSON NV 89014	16208301014
CROMER GEORGE A FAMILY TRUST	CROMER JAMES & GEORGE E CO-TRS P O BOX 1747 TEMPLETON CA 93465	16208703010
CROMER GEORGE A FAMILY TRUST	CROMER JAMES & GEORGE E CO-TRS P O BOX 1747 TEMPLETON CA 93465	16208703009
CROMER GEORGE A FAMILY TRUST	CROMER JAMES & GEORGE E CO-TRS P O BOX 1747 TEMPLETON CA 93465	16208703011
DIAZ ROBERTO ZAMORA	2825 SULTANA ST LAS VEGAS NV 89102	16208211034
DICKINSON ROBIN SEP PPTY TR	DICKINSON ROBIN TRS 3131 MEADE AVE LAS VEGAS NV 89102	16208303011
DUR MAY INVESTMENTS L L C	P O BOX 28639 LAS VEGAS NV 89126-2639	16208301022
EDEN LAS VEGAS L L C	299 PARK AVE 42ND FL NEW YORK NY 10171-4299	16208603001
EDEN LAS VEGAS L L C	299 PARK AVE 42ND FL NEW YORK NY 10171-4299	16208603002
EDEN LAS VEGAS L L C	299 PARK AVE 42ND FL NEW YORK NY 10171-4299	16208701005
EQUUS BUSINESS CENTER L P	4755 DEAN MARTIN DR LAS VEGAS NV 89103	16208415004
EQUUS BUSINESS CENTER L P	4755 DEAN MARTIN DR LAS VEGAS NV 89103	16208414001
EQUUS BUSINESS CENTER L P	4755 DEAN MARTIN DR LAS VEGAS NV 89103	16208412004
EQUUS BUSINESS CENTER L P	4755 DEAN MARTIN DR LAS VEGAS NV 89103	16208413001
EQUUS BUSINESS CENTER L P	4755 DEAN MARTIN DR LAS VEGAS NV 89103	16208411003
FISHER BROTHERS LAS VEGAS L L C	299 PARK AVE 42ND FL NEW YORK NY 10171-4299	16208702001
FISHER BROTHERS LAS VEGAS L L C	299 PARK AVE 42ND FL NEW YORK NY 10171-4299	16208701002

**Report of All Selected Parcels****Case Number:**

SUP-64482

**Printed On:** Mon: June 27, 2016

<u>Owner</u>	<u>Address</u>	<u>Parcel Number</u>
FISHER BROTHERS LAS VEGAS L L C	299 PARK AVE 42ND FL NEW YORK NY 10171-4299	16208303015
FISHER BROTHERS LAS VEGAS L L C	299 PARK AVE 42ND FL NEW YORK NY 10171-4299	16208303016
FISHER BROTHERS LAS VEGAS L L C	299 PARK AVE 42ND FL NEW YORK NY 10171-4299	16208701001
FISHER BROTHERS LAS VEGAS L L C	299 PARK AVE 42ND FL NEW YORK NY 10171-4299	16208701003
FISHER BROTHERS LAS VEGAS L L C	299 PARK AVE 42ND FL NEW YORK NY 10171-4299	16208303017
FISHER BROTHERS LAS VEGAS L L C	299 PARK AVE 42ND FL NEW YORK NY 10171-4299	16208702002
FISHER BROTHERS LAS VEGAS L L C	299 PARK AVE 42ND FL NEW YORK NY 10171-4299	16208303033
FISHER BROTHERS LAS VEGAS L L C	299 PARK AVE 42ND FL NEW YORK NY 10171-4299	16208303018
GAGNON GUY FAMILY TRUST	GAGNON GUY OR DIANA J TRS 2108 WESTLUND DR LAS VEGAS NV 89102-2049	16208303012
GRAY BERN HOLDINGS INC	P O BOX 660937 MD 3A-300 DALLAS TX 75266-0937	16208401001
GUTHRIE RONALD G	CORDELL TERRANCE A 3016 MILO WY LAS VEGAS NV 89102-5982	16208211029
HARSCH INVESTMENT PPTYS-NV L L C	P O BOX 2708 PORTLAND OR 97208-2708	16208401009
HARSCH INVESTMENT PPTYS-NV L L C	P O BOX 2708 PORTLAND OR 97208-2708	16208401007
HARSCH INVESTMENT PPTYS-NV L L C	P O BOX 2708 PORTLAND OR 97208-2708	16208401008
INTEGRAL PTNRS PARK PL L V LLC	299 PARK AVE 42ND FL NEW YORK NY 10171-4299	16208418002
J D B C ENTERPRISES L L C	795 S 1080 E OREM UT 84097	16208301007
J D B C ENTERPRISES L L C	795 S 1080 E OREM UT 84097	16208301006
JONATHAN PARK L L C	6050 S FORT APACHE RD #200A LAS VEGAS NV 89148	16208303028
JONATHAN PARK L L C	6050 S FORT APACHE RD #200A LAS VEGAS NV 89148	16208303004
JONATHAN PARK L L C	6050 S FORT APACHE RD #200A LAS VEGAS NV 89148	16208303027
KASSABIAN LARISSA	3220 WESTLEIGH AVE LAS VEGAS NV 89102-6121	16208211033
LAS VEGAS MEADOWS LTD	11100 SANTA MONICA BLVD #1150 LOS ANGELES CA 90025	16208201003
LEAVITT FAMILY TRUST	LEAVITT M LEONARD & DONNA J TRS 265 N HOLLYWOOD BLVD LAS VEGAS NV 89110	16208210023
LEE SIU CHING REVOCABLE LIV TR	LEE SIU CHING TR 2824 NORTHAM ST LAS VEGAS NV 89102-0130	16208210022
LI MING	5538 WELLAND AVE #3 TEMPLE CITY CA 91780	16208212012
LI QUINGHE	1755 29TH AVE SAN FRANCISCO CA 94122-4222	16208212015
M B T L V 2014 L L C	50 GRAND MASTERS DR LAS VEGAS NV 89141	16208303009
M B T L V 2014 L L C	50 GRAND MASTERS DR LAS VEGAS NV 89141	16208303010
MAGUIRE JOHN P & ALICE A FAM TR	MAGUIRE JOHN P & ALICE A TRS 3021 MILO WY LAS VEGAS NV 89102-5983	16208210049
MARTIN ROBERT E & KAYE	1500 MARBELLA RIDGE CT LAS VEGAS NV 89117	16208301017
MARTIN ROBERT E & KAYE B	1500 MARBELLA RIDGE CT LAS VEGAS NV 89117	16208303008
MINOLI MARGARITA REVOCABLE LIVIN	MINOLI MARGARITA TRS 2844 MILO WY LAS VEGAS NV 89102-5980	16208610057

**Report of All Selected Parcels****Case Number:**

SUP-64482

**Printed On:** Mon: June 27, 2016

<u>Owner</u>	<u>Address</u>	<u>Parcel Number</u>
NEWPORT GENE W	6020 W OQUENDO RD LAS VEGAS NV 89118	16208703008
NYCHI TRUST	3754 VIOLET ROSE CT LAS VEGAS NV 89147-7401	16208301021
NYCHI TRUST	3754 VIOLET ROSE CT LAS VEGAS NV 89147-7401	16208301020
PARADISE LAS VEGAS L L C	299 PARK AVE NEW YORK NY 10171-0002	16208701004
PARADISE LAS VEGAS L L C	299 PARK AVE 42ND FL NEW YORK NY 10171-4299	16208701007
PARADISE LAS VEGAS L L C	299 PARK AVE NEW YORK NY 10171-0002	16208418003
PARADISE LAS VEGAS L L C	299 PARK AVE 42ND FL NEW YORK NY 10171-4299	16208603003
PARAMOUNT INVESTMENTS CO	P O BOX 370261 LAS VEGAS NV 89137	16208303007
R & J EQUITIES L L C	5790 WYNN RD #2 LAS VEGAS NV 89118-3076	16208303005
ROBINSON PAUL & GRACE	1690 HARDROCK ST LAS VEGAS NV 89156	16208210025
RODRIGUEZ RAUL	2821 NORTHAM ST LAS VEGAS NV 89102-5986	16208210028
RUSSELL-WARNER INC	P O BOX 74 GENOA NV 89411	16208301012
SELBY ELIZABETH & DOUGLAS ALLEN	3017 W JAMESTOWN WY LAS VEGAS NV 89102-5923	16208211028
SOUTHERN NV RENTAL HOLDINGS	299 PARK AVE 42ND FL NEW YORK NY 10171-4299	16208212014
SOUTHERN NV RENTAL HOLDINGS	299 PARK AVE 42ND FL NEW YORK NY 10171-4299	16208610059
SOUTHERN NV RENTAL HOLDINGS	299 PARK AVE 42ND FL NEW YORK NY 10171-4299	16208610060
SOUTHERN NV RENTAL HOLDINGS	299 PARK AVE 42ND FLR NEW YORK NY 10171-0002	16208610062
SOUTHERN NV RENTAL HOLDINGS	299 PARK AVE 42ND FLR NEW YORK NY 10171-0002	16208610054
SOUTHERN NV RENTAL HOLDINGS	299 PARK AVE 42ND FLR NEW YORK NY 10171-4299	16208610052
SOUTHERN NV RENTAL HOLDINGS LLC	299 PARK AVE 42ND FL NEW YORK NY 10171-4299	16208610072
SOUTHERN NV RENTAL HOLDINGS LLC	299 PARK AVE 42ND FL NEW YORK NY 10171-4299	16208610066
SOUTHERN NV RENTAL HOLDINGS LLC	299 PARK AVE 42ND FL NEW YORK NY 10171-4299	16208610055
SOUTHERN NV RENTAL HOLDINGS LLC	299 PARK AVE 42ND FLR NEW YORK NY 10171-4299	16208610056
SOUTHERN NV RENTAL HOLDINGS LLC	299 PARK AVE 42ND FLR NEW YORK NY 10171-4299	16208212019
SOUTHERN NV RENTAL HOLDINGS LLC	299 PARK AVE 42ND FL NEW YORK NY 10171-4299	16208212011
SOUTHERN NV RENTAL HOLDINGS LLC	299 PARK AVE 42ND FLR NEW YORK NY 10171-4299	16208212016
SOUTHERN NV RENTAL HOLDINGS LLC	299 PARK AVE 42ND FL NEW YORK NY 10171-4299	16208610058
SOUTHERN NV RENTAL HOLDINGS LLC	299 PARK AVE 42ND FLR NEW YORK NY 10171-4299	16208610067
SOUTHERN NV RENTAL HOLDINGS LLC	299 PARK AVE 42ND FL NEW YORK NY 10171-4299	16208212018
SOUTHERN NV RENTAL HOLDINGS LLC	299 PARK AVE 42ND FLR NEW YORK NY 10171-4299	16208610051
SOUTHERN NV RENTAL HOLDINGS LLC	299 PARK AVE 42ND FL NEW YORK NY 10171-4299	16208212017
SOUTHERN NV RENTAL HOLDINGS LLC	299 PARK AVE NEW YORK NY 10171-0002	16208610032

**Report of All Selected Parcels****Case Number:**

SUP-64482

**Printed On:** Mon: June 27, 2016

<u>Owner</u>	<u>Address</u>	<u>Parcel Number</u>
SOUTHERN NV RENTAL HOLDINGS LLC	299 PARK AVE 42ND FLR NEW YORK NY 10171-4299	16208610070
SOUTHERN NV RENTAL HOLDINGS LLC	299 PARK AVE 42ND FLR NEW YORK NY 10171-4299	16208610063
SOUTHERN NV RENTAL HOLDINGS LLC	299 PARK AVE 42ND FLR NEW YORK NY 10171-4299	16208610069
SOUTHERN NV RENTAL HOLDINGS LLC	299 PARK AVE 42ND FLR NEW YORK NY 10171-4299	16208610061
SOUTHERN NV RENTAL HOLDINGS LLC	299 PARK AVE 42ND FL NEW YORK NY 10171-4299	16208610068
SOUTHERN NV RENTAL HOLDINGS LLC	299 PARK AVE 42ND FLR NEW YORK NY 10171-4299	16208212021
SOUTHERN NV RENTAL HOLDINGS LLC	299 PARK AVE 42ND FL NEW YORK NY 10171-4299	16208610053
SOUTHERN NV RENTAL HOLDINGS LLC	299 PARK AVE 42ND FL NEW YORK NY 10171-4299	16208610033
SOUTHERN NV RENTAL HOLDINGS LLC	299 PARK AVE 42ND FLR NEW YORK NY 10171-4299	16208212020
SOUTHERN NV RENTAL HOLDINGS LLC	299 PARK AVE 42ND FL NEW YORK NY 10171-4299	16208610065
SOUTHERN NV RENTAL HOLDINGS LLC	299 PARK AVE 42ND FLR NEW YORK NY 10171-4299	16208610064
SPILSBURY J & M INVEST CO	2448 W VALLEY VIEW HURRICANE UT 84737-3028	16208802003
STATEWOOD L L C	3163 S HIGHLAND LAS VEGAS NV 89109-1010	16208803001
STEWART JEFFREY & J FAMILY TR	STEWART JEFFERY D & JULIE 51 E ADAM LN WASHINGTON UT 84780-2443	16208802002
STORE-N-LOCK	2181 E FOOTHILL BLVD #105 PASADENA CA 91107-6825	16208303006
STORE-N-LOCK	565 BONITA AVE SAN MARINO CA 91108-1304	16208303021
STORE-N-LOCK	2181 E FOOTHILL BLVD #105 PASADENA CA 91107-6825	16208303030
TAHOE MEADE L L C	10940 WILSHIRE BLVD #600 LOS ANGELES CA 90024	16208301009
TAHOE MEADE L L C	10940 WILSHIRE BLVD #600 LOS ANGELES CA 90024	16208301010
TAHOE MEADE L L C	3300 MEADE AVE #A LAS VEGAS NV 89102-0749	16208301008
TAOS LAND COMPANY LLC	299 PARK AVE 42ND FL NEW YORK NY 10171-4299	16208701008
TRAN CHRISTOPHER	3009 MILO WY LAS VEGAS NV 89102-5983	16208211032
UNION ACQUISITION INC	5560 S FORT APACHE RD #100 LAS VEGAS NV 89148	16208303003
USAITIS STEVE	782 COLONIAL RD DURANGO CO 81303-6461	16208301011
VIPER LAND & INVESTMENTS L L C	850 S BOULDER HWY #444 HENDERSON NV 89015	16208301016
VIPER LAND & INVESTMENTS L L C	850 S BOULDER HWY #444 HENDERSON NV 89015	16208301015
VOTAW WILLIAM W	2820 NORTHAM ST LAS VEGAS NV 89102-0130	16208210021
W W LAND L L C	3130 WESTWOOD DR LAS VEGAS NV 89109-1067	16208803003
WANG JIE	LI QIAN QIAN 9237 LA ROSA DR TEMPLE CITY CA 91780	16208610071
WAREHOUSE PROPERTIES	4801 W BELL DR LAS VEGAS NV 89118	16208303031
WHITE FRANCIS A II & JENNIFER E	3017 MILO WY LAS VEGAS NV 89102-5983	16208211030
YOUNG C & E 1985 LIV TR SURV TR	8160 OBANNON DR LAS VEGAS NV 89117-1920	16208303014