



Legal Notices Transmittal and Scanning Separator Sheet

Legal Notice Type: Legal Mailings

Date of Transfer to ERM: 7/27/2011

Page Count: 25

Meeting Date: 8/17/2011

Meeting Type: City Council <=>

Case Number(s): SUP-41542 <=>

Subject of Affidavit: APPLICANT: PEARL OF THE ORIENT MASSAGE - OWNER: SUNSHINE ONE, LLC - 3909 West Sahara Avenue, Suite #6 <=>

Record Series: Legal Notices

LRDA Number: 2007-1717

Retention: Permanent

File By: Meeting Date

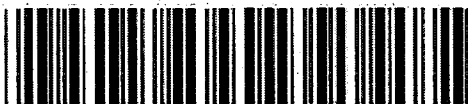

Prepared By: scroll

Scanned By:

SCANNED

JUL 27 2011

QC By:

City of Las Vegas
Office Of The City Clerk
400 Stewart Avenue
Las Vegas, Nevada 89101

Return Service Requested
Official Notice of Public Hearing

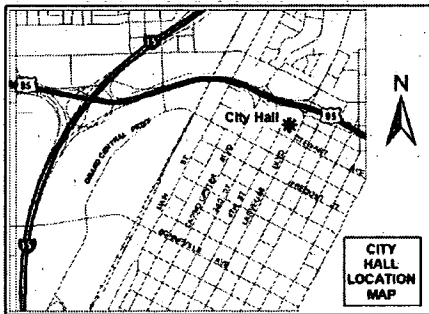

If you wish to file your protest or support on this request, check the appropriate box below and return this card in an envelope with postage to the Office Of The City Clerk at the address listed above or fax this side of this card to (702) 382-4803. If you would like to contact your Council Representative, please call (702) 229-6405.

I SUPPORT
this Request

I OPPOSE
this Request

Please use available blank space on card for your comments.

SUP-41542

City Council Meeting of 8/17/2011

Application Information

SUP-41542 - APPLICANT: PEARL OF THE ORIENT MASSAGE - OWNER: SUNSHINE ONE, LLC - For possible action on a request for a Special Use Permit FOR A 1,020 SQUARE-FOOT MASSAGE ESTABLISHMENT WITH WAIVERS TO ALLOW NO DISTANCE SEPARATION FROM ANOTHER MASSAGE ESTABLISHMENT WHERE 1,000 FEET IS REQUIRED, A 20-FOOT DISTANCE SEPARATION FROM A RESIDENTIAL USE WHERE 400 FEET IS REQUIRED AND 24-HOUR OPERATION WHERE HOURS OF OPERATION FROM 8:00 A.M. TO 9:00 P.M. ARE ALLOWED at 3909 West Sahara Avenue, Suite #6 (APN 162-07-512-001), C-1 (Limited Commercial) Zone, Ward 1 (Tarkanian).

Application Location

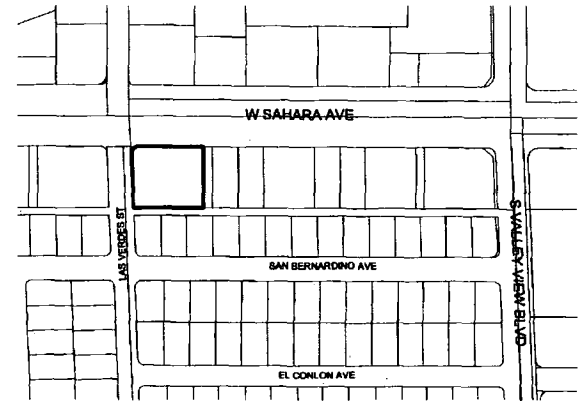

The proposed project may not pertain to the entire highlighted project site.

Public Hearing Information

Meeting: City Council
Date: August 17, 2011
Time: 1:00 P.M.
Location: City Council Chambers
400 Stewart Avenue
Las Vegas, Nevada

Any and all interested persons may appear and be heard at said meeting, or may, prior thereto, file written objections thereto or approvals thereof with the City Clerk, 1st Floor, City Hall, 400 Stewart Avenue, Las Vegas, Nevada, 89101. For further information, including the full staff report, please call (702) 229-6311 (TDD 386-9108) or go to <http://www.lasvegasnevada.gov>.

CASE# SUP-41542

PARCEL#	OWNER	ADDRESS1	ADDRESS2	ADDRESS3	ADDRESS4	ADDRESS5
1	16207511003	4121 W SAHARA L L C	4121 W SAHARA AVE	LAS VEGAS NV 89102-3704		
2	16206810107	ACOSTA JUAN RAUL	400 MAX CT	HENDERSON NV 89011-4046		
3	16206811011	AGUILAR BRAULIO E	39080 EL CAMINO AVE	LAS VEGAS NV 89102		
4	16206812072	AGUILAR LIDIA F	CANAS JOSE M	4101 VIA VAQUERO AVE	LAS VEGAS NV 89102-3769	
5	16207512005	ALLEN EDWARD H & CAROL	9480 W WASHBURN RD	LAS VEGAS NV 89149-2425		8/17/2011 SUP-41542 Mr. Paul Robarts Sunshine One, LLC 6450 Spring Mountain Road, Suite #12 Las Vegas, Nevada 89146
6	16207514019	ALTAMIRANO DAMIAN M	3901 SAN BERNADINO AVE	LAS VEGAS NV 89102-5866		
7	16207513079	AMARE ABEBAYEHU	4204 EL CONLON AVE	LAS VEGAS NV 89102-5725		
8	16207515016	ANH TONY	4020 SAN JOAQUIN AVE	LAS VEGAS NV 89102-5709		8/17/2011 SUP-41542 Mr. Zeping Wang Pearl of the Orient Massage 3909 West Sahara Avenue Las Vegas, Nevada 89102
9	16206812004	ARENAS STREET TRUST	900 S LAS VEGAS BLVD #810	LAS VEGAS NV 89101-6850		
10	16207513006	ARIAS ARISBEL	DELMONTE ODELKIS	4116 SAN BERNARDINO AVE	LAS VEGAS NV 89102-5789	
11	16207514050	ASCENCIO MIZRAIM	3809 EL CONLON AVE	LAS VEGAS NV 89102-5861		
12	16207513045	AURORA LOAN SERVICES L L C	10350 PARK MEADOWS DR	LITTLETON CO 80124-6800		
13	16207516014	AUSTIN BART	P O BOX 26747	LAS VEGAS NV 89126-0747		
14	16206811014	AUSTIN TERRY L & GLENDA M	3812 EL CAMINO AVE	LAS VEGAS NV 89102-3800		

CASE# SUP-41542

PARCEL#	OWNER	ADDRESS1	ADDRESS2	ADDRESS3	ADDRESS4	ADDRESS5
15	16207513035 AYALA BERTA DEYSI	2524 ARENAS ST	LAS VEGAS NV 89102-5721			
16	16206801007 B 2 L L C	3230 S BUFFALO #108	LAS VEGAS NV 89117-2506			
17	16207512006 B K B K INC	%B KATZ	10353 GRIZZLY CREEK ST	LAS VEGAS NV 89178-3532		
18	16207514055 BAC HOME LOANS SERVICING	400 COUNTRYWIDE WY SV-35	SIMI VALLEY CA 93065-6298			
19	16206812071 BAHARIAN OHANES	10113 MAIDENS WARPATH CT	LAS VEGAS NV 89183-7391			
20	16207516038 BALASON JOHN MACKE & ANNA	3708 SAN JOAQUIN AVE	LAS VEGAS NV 89102-5907			
21	16206812067 BANK AMERICA N A	P O BOX 9000	GETZVILLE NY 14068-9000			
22	16207514037 BANK DEUTSCHE NATIONAL TR CO TRS	%SAXON MTGE SERVS INC	4708 MERCANTILE DR N	FT WORTH TX 76137-3605		
23	16207513040 BANK FLAGSTAR F S B	5151 CORPORATE DR	MAIL STOP S-124-3	TROY MI 48098- 2639		
24	16207516048 BANK H S B C USA N A TRS	%WESTERN PROGRESSIVE LLC	2015 VAUGHN RD BLDG #400	KENNESAW GA 30144-7802		
25	16206811008 BANK NEW YORK TRS	4828 LOOP CENTRAL DR #600	HOUSTON TX 77081-2212			
26	16206812015 BANK U S N A	4801 FREDERICA ST	OWENSBORO KY 42301-7441			
27	16206810056 BANK U S NATIONAL ASSN TRS	3815 S W TEMPLE	SALT LAKE CITY UT 84115-4412			
28	16207515023 BARBER JACK O & MARIA D	4100 SAN ANGELO AVE	LAS VEGAS NV 89102-5702			

CASE# SUP-41542

	PARCEL#	OWNER	ADDRESS1	ADDRESS2	ADDRESS3	ADDRESS4	ADDRESS5
29	16207513021	BAROCIO ALICIA	2532 LAS VERDES ST	LAS VEGAS NV 89102-5914			
30	16206810019	BARRAZA BENITO & SYLVIA	4017 GASTER AVE	NO LAS VEGAS NV 89081-6697			
31	16207514049	BARROW ROBERT W & PENNY L	3813 EL CONLON AVE	LAS VEGAS NV 89102-5861			
32	16207515018	BEAMER HELEN K LIVING TRUST	848 RAINBOW BLVD #672	LAS VEGAS NV 89107-1103			
33	16206801005	BEARD FAMILY TRUST	BEARD EPHRAIM & ROBERTA E TRS	57 LINDA ISLE	NEWPORT BEACH CA 92660-7207		
34	16206812010	BELOVIN WILLIAM & CATHERINE	1848 ESCONDIDO TERR	HENDERSON NV 89074-5200			
35	16207515004	BELTRAN CONSTANCIO	2620 LAS VERDES ST	LAS VEGAS NV 89102-5900			
36	16207513024	BILAN AMER ROBERT	2520 LAS VERDES ST	LAS VEGAS NV 89102-5914			
37	16206812035	BINGHAM JEANETTE & MONICA S	4205 ESMEALDA AVE	LAS VEGAS NV 89102-3764			
38	16206810064	BISCOCHO MARTINIANO B & LYDIA V	4000 ESMEALDA AVE	LAS VEGAS NV 89102-3703			
39	16206812008	BLACKFORD NANCY A	4008 VIA VAQUERO AVE	LAS VEGAS NV 89102-3715			
40	16207514046	BLYTHE DIANE	BLYTHE H DALE & VIRGINIA	3905 EL CONLON AVE	LAS VEGAS NV 89102-5862		
41	16207511005	BOS FAMILY TRUST	MAURO LOUIS A & CARMELLA FAM TR	%M BOS	3757 ERVA ST	LAS VEGAS NV 89147-6891	
42	16207513033	BOUCHER PHILIPPE & REBECCA G	3266 VICTORIA WY	DULUTH GA 30096- 3668			

CASE# SUP-41542

	PARCEL#	OWNER	ADDRESS1	ADDRESS2	ADDRESS3	ADDRESS4	ADDRESS5
43	16207514044	BOYCE EVA G	3913 EL CONLON AVE	LAS VEGAS NV 89102-5862			
44	16207513015	BRAVO ADRIANA G	4012 SAN BERNARDINO AVE	LAS VEGAS NV 89102-5729			
45	16207514022	BRENNE DEAN A	3809 SAN BERNARDINO AVE	LAS VEGAS NV 89102-5865			
46	16207516008	BRIEN ELDA L	3812 SAN ANGELO AVE	LAS VEGAS NV 89102-0122			
47	16207513030	BROWN GERALD F REVOCABLE TRUST	BROWN GERALD F & FRANCINE H TRS	2605 ARENAS ST	LAS VEGAS NV 89102-0604		
48	16207511012	BROWN KIDS INC	1710 E CHARLESTON BLVD	LAS VEGAS NV 89104-1903			
49	16207514018	BURROLA LUIS & MARIA	3905 SAN BERNARDINO AVE	LAS VEGAS NV 89102-5866			
50	16207512007	C D K FAMILY TRUST	KATZ CYNTHIA J TRS	HCR-33 BOX 2627	LAS VEGAS NV 89161-9271		
51	16206811035	CALZODILLA PALMIRA D	MARTINEZ NILIA	3905 EL PORTAL AVE	LAS VEGAS NV 89102-3888		
52	16206810060	CAMACHO YOLANDA	4013 ESMERALDA AVE	LAS VEGAS NV 89102-3702			
53	16207514026	CAMPOS JOSE T & MARIA D	3709 SAN BERNARDINO AVE	LAS VEGAS NV 89102-5826			
54	16206812013	CANO OCTAVIO & BLANCA	4112 VIA VAQUERO AVE	LAS VEGAS NV 89102-3766			
55	16207515003	CARRASCO JAVIER	2616 LAS VERDES ST	LAS VEGAS NV 89102-5900			
56	16206810108	CASANOVA NOEL S	4009 EL CAMINO AVE	LAS VEGAS NV 89102-3601			

CASE# SUP-41542

PARCEL#	OWNER	ADDRESS1	ADDRESS2	ADDRESS3	ADDRESS4	ADDRESS5
57	16206810106	CASTRICONE FAMILY TRUST	CASTRICONE RICHARD & GLORIA TRS	4017 EL CAMINO AVE	LAS VEGAS NV 89102-3601	
58	16207513018	CERA ANGEL GESTAL	4000 SAN BERNARDINO AVE	LAS VEGAS NV 89102-5729		
59	16207513016	CERMINARA CRAIG	4008 SAN BERNARDINO AVE	LAS VEGAS NV 89102-5729		
60	16207513048	CERVANTES LEODEGARIO	2520 AMARILLO ST	LAS VEGAS NV 89102-5715		
61	16206810102	CHAMELIAN HAROUTIOUN OHANNES	11289 DULCET AVE	NORTHRIDGE CA 91326-2134		
62	16206810055	CHAN CHAN WAN	4126 SARILEE AVE	ROSEMEAD CA 91770-1360		
63	16207513014	CHAN MARVIN KIM	175 BEACON AVE 2ND FL	JERSEY CITY NJ 07306-2517		
64	16207513047	CHAVEZ ROSEMARY R FAMILY TRUST	2524 AMARILLO ST	LAS VEGAS NV 89102-5715		
65	16207514014	CHEN BAO WEN & LI YI	CHEN WAYMON	7859 MOSAIC HARBOR AVE	LAS VEGAS NV 89117-2574	
66	16207515005	CHINNOCK FAMILY TRUST	CHINNOCK MARY Z CO-TRS	4000 SAN JOAQUIN AVE	LAS VEGAS NV 89102-5708	
67	16207516039	CHOMINSEE THAMMACHART	3712 W SAN JOAQUIN AVE	LAS VEGAS NV 89102-5907		
68	16207514031	CISNEROS YVONNE & GUADALUPE	6687 KEYESPORT CT	LAS VEGAS NV 89148-5754		
69	16207516054	COLE FAMILY TRUST	COLE ROBERT D SUCC TRS	3705 SAN ANGELO AVE	LAS VEGAS NV 89102-5926	
70	16207515015	COLLETTE CAROLYN	2620 ARENAS ST	LAS VEGAS NV 89102-0603		

CASE# SUP-41542

PARCEL#	OWNER	ADDRESS1	ADDRESS2	ADDRESS3	ADDRESS4	ADDRESS5	
71	16208103011	CONSYST CONST INC	OLIPHANT BENJAMIN FRANKLIN	500 S GRAND CENTRAL PKWY	LAS VEGAS NV 89155		
72	16206811034	COONEY TERRY L LIVING TRUST	COONEY TERRY L TRS	3901 EL PORTAL AVE	LAS VEGAS NV 89102-3888		
73	16207514052	CORONA MARIA	3801 EL CONLON AVE	LAS VEGAS NV 89102-5861			
74	16207516044	CORONA-RIZO LUIS R	CORONA GRISELDA	3812 SAN JOAQUIN AVE	LAS VEGAS NV 89102-0154		
75	16207514027	CORRALES MANUELA	3705 SAN BERNARDINO AVE	LAS VEGAS NV 89102-5826			
76	16207516050	CRANDY NED F	KIDD MARY IRENE	3805 SAN ANGELO	LAS VEGAS NV 89102-0124		
77	16207513053	CREDICO BRIGITTE	2537 LENNA ST	LAS VEGAS NV 89102-5728			
78	16207514040	CRUZ ANNA F	3908 EL CONLON AVE	LAS VEGAS NV 89102-5860			
79	16206810069	CRUZ FELIPE	4020 ESMERALDA AVE	LAS VEGAS NV 89102-3703			
80	16206812009	D J M A L L C	3095 ROSANNA ST	LAS VEGAS NV 89117-3141			
81	16207514051	DAVID MARTIN	DAVID MARTIN & ROSA	3805 EL CONLON AVE	LAS VEGAS NV 89102-5861		
82	16207516002	DEAGATON MARIA PIZA	AGATON- SANTIAGO RICARDO	3704 SAN ANGELO AVE	LAS VEGAS NV 89102-5927		
83	16206812073	DELAPAZ MODESTA	5449 PALMYRA AVE	LAS VEGAS NV 89146-6820			
84	16207515013	DELATORRE ISAIAS VERDUZCO	VERDUZCO ADRIANA MARIA	520 CASTLE STONE CT	LAS VEGAS NV 89123-1259		

CASE# SUP-41542

PARCEL#	OWNER	ADDRESS1	ADDRESS2	ADDRESS3	ADDRESS4	ADDRESS5
85	16206812070	DEY FAMILY TRUST 2000	DEY EARL MELVIN & MARILYNN L TRS	4109 VIA VAQUERO AVE	LAS VEGAS NV 89102-3769	
86	16207513031	DIAZ LAZARO E	2604 ARENAS ST	LAS VEGAS NV 89102-0603		
87	16206812014	DIAZ ROBERTO	4200 VIA VAQUERO AVE	LAS VEGAS NV 89102-3767		
88	16206812069	DIAZ-ZAMORA ERNESTO	4113 VIA VAQUERO AVE	LAS VEGAS NV 89102-3769		
89	16206812002	DUCK HORN L L C ETAL	14737 E MARK LN	SCOTTSDALE AZ 85262-7814		
90	16207513004	DURAN FIDEL	HERRERA OFELIA	4204 SAN BERNARDINO AVE	LAS VEGAS NV 89102-5787	
91	16206810110	EDEJER MANNUEL & OLIVA B	4001 EL CAMINO AVE	LAS VEGAS NV 89102-3601		
92	16207514041	EL CONLON L L C	2985 LULLINGSTONE AVE	LAS VEGAS NV 89135-2246		
93	16206810018	ELLIOTT HARRY DELANO & MELBA	2216 LOS ALTOS ST	LAS VEGAS NV 89102-3773		
94	16207514004	EMMART EDITH R	3712 SAN BERNARDINO AVE	LAS VEGAS NV 89102-5827		
95	16206812007	ESTRADA JUAN & JUDY H	3726 HORSESHOE MESA ST	LAS VEGAS NV 89147-8039		
96	16207516024	EVERIST VIRGIL & ROSE E REV TR	EVERIST VIRGIL & ROSE CO-TRS	3905 SAN JOAQUIN AVE	LAS VEGAS NV 89102-5910	
97	16206810024	F L D LIVING TRUST	PENGELLY HELEN KALOGEROS	4016 EL CAMINO AVE	LAS VEGAS NV 89102-3626	
98	16207516009	FAMULARCANO TERESA	3816 SAN ANGELO AVE	LAS VEGAS NV 89102-0122		

CASE# SUP-41542

PARCEL#	OWNER	ADDRESS1	ADDRESS2	ADDRESS3	ADDRESS4	ADDRESS5
99	16206812006	FARINA JOSEPH & PATRICIA	4000 VIA VAQUERO AVE	LAS VEGAS NV 89102-3715		
100	16207514025	FELDMAN JUANITA	3713 SAN BERNARDINO AVE	LAS VEGAS NV 89102-5826		
101	16206812066	FINNIE EDWIN TAYLOR & AUDREY K	4209 VIA VAQUERO AVE	LAS VEGAS NV 89102-3770		
102	16207513029	FISHER SAMMY C	2601 ARENAS ST	LAS VEGAS NV 89102-0604		
103	16206810062	FLORES ADOLFO MEDINA ETAL	4005 ESMERALDA AVE	LAS VEGAS NV 89102-3702		
104	16207513013	FLORES VICTOR	20 SAN BERNARDINO AVE	LAS VEGAS NV 89102		
105	16207513050	FLOYD PATRICE SR	2525 LENNA ST	LAS VEGAS NV 89102-5728		
106	16207513042	FORNER TSUYUKO	2605 AMARILLO ST	LAS VEGAS NV 89102-0602		
107	16207516049	GALINDO JULIO & BARBARA S	3809 SAN ANGELO AVE	LAS VEGAS NV 89102-0124		
108	16207514048	GALLINA WILLIAM JR	3817 EL CONLON AVE	LAS VEGAS NV 89102-5861		
109	16206810104	GARBODEN ARTHUR R & CHARLOTTE J	1018 POND RD	EUGENE OR 97401-1400		
110	16207516005	GARCIA RONALD A & JOHN R	3660 CIENEGA DR	BONITA CA 91902-1101		
111	16207516022	GASPARI MARIA ELENA	3913 SAN JOAQUIN AVE	LAS VEGAS NV 89102-5910		
112	16206810023	GERIG HENRY FAMILY TRUST	GERIG HENRY TRS	4012 EL CAMINO AVE	LAS VEGAS NV 89102-3626	

CASE# SUP-41542

PARCEL#	OWNER	ADDRESS1	ADDRESS2	ADDRESS3	ADDRESS4	ADDRESS5
113	16206810021	GERLACH BEVERLY M REVOCABLE TR	GERLACH BEVERLY M TRS	5405 WARMAN LN	TEMPLE CITY CA 91780-3255	
114	16207516011	GLIDDEN LAURA MAY	17225 SE 283RD AVE	UMATILLA FL 32784-7719		
115	16207514035	GOLD EAGLE ENTERPRISES L L C	3250 S DUNEVILLE ST	LAS VEGAS NV 89146-6723		
116	16207514016	GOSEPA RILES & ROSEMARY	3913 SAN BERNARDINO AVE	LAS VEGAS NV 89102-5866		
117	16208101007	H J E E L L C	574 N EASTERN AVE	LAS VEGAS NV 89101-3423		
118	16207514030	HAN LIANG	124 S MARENGO AVE #3	ALHAMBRA CA 91801-7129		
119	16207515011	HARRISON PATRICIA ROSE	9933 HEFFNER HILLS CIR	LAS VEGAS NV 89117-0607		
120	16207512008	HERBS & RYE INC	%N MENDOZA	834 SOCORRO SONG LN	HENDERSON NV 89052-8642	
121	16207513055	HERNANDEZ DAVID & ELENA I	4203 EL CONLON AVE	LAS VEGAS NV 89102-0623		
122	16206812037	HERNANDEZ HIPOLITO M ETAL	4109 ESMEALDA AVE	LAS VEGAS NV 89102-3763		
123	16207515007	HERNANDEZ MARIA C & CLAUDIA J	4008 SAN JOAQUIN AVE	LAS VEGAS NV 89102-5708		
124	16207513007	HERRERA-LOPEZ ANGEL A	GAY-HERNANDEZ MARIA E	4112 SAN BERNARDINO AVE	LAS VEGAS NV 89102-5789	
125	16207516015	HERRINGTON ELENA	3900 SAN JOAQUIN AVE	LAS VEGAS NV 89102-5911		
126	16206810063	HOLDEN PATRICK & MARITES G	4001 ESMEALDA AVE	LAS VEGAS NV 89102-3702		

CASE# SUP-41542

	PARCEL#	OWNER	ADDRESS1	ADDRESS2	ADDRESS3	ADDRESS4	ADDRESS5
127	16207510006	HOPKINS DANIEL B & DIANA JEAN	1620 SONGLIGHT CT	LAS VEGAS NV 89117-1583			
128	16206810071	HUANG JACK	3395 S JONES #218	LAS VEGAS NV 89146-6729			
129	16207516023	HURTADO ANTONIO & SOLEDAD	3909 SAN JOAQUIN AVE	LAS VEGAS NV 89102-5910			
130	16207510003	HWANG FRANK S & PAO HUEY	69-30 222 ST	BAYSIDE NY 11364- 2620			
131	16208101005	JAK T D FAMILY L P	%GATSKI COML REAL EST SERV INC	4755 DEAN MARTIN DR	LAS VEGAS NV 89103-4141		
132	16207513012	JENNINGS DONALD R & BARBARA	4024 SAN BERNARDINO AVE	LAS VEGAS NV 89102-5729			
133	16207516004	JIANG PENG	3712 SAN ANGELO AVE	LAS VEGAS NV 89102-5927			
134	16207514032	JIAO JIAHE	SU WEN KUI	711 W VALLEY BLVD #210	ALHAMBRA CA 91803-3246		
135	16206811019	JIMENEZ BEN	3708 EL CAMINO AVE	LAS VEGAS NV 89102-3801			
136	16207515096	JIN CHI	P O BOX 30305	LAS VEGAS NV 89173-0305			
137	16206810072	JIU STEVEN & CHUI	4100 VIA OLIVERO AVE	LAS VEGAS NV 89102-3709			
138	16206813007	JO WADE CORPORATION	P O BOX 1888	PASO ROBLES CA 93447-1888			
139	16206812068	JOELIE ENTPRS L L C SERIES 1	9618 EL VENADO DR	WHITTIER CA 90603-1308			
140	16206812003	JOHNS RICK	4010 W SAHARA AVE	LAS VEGAS NV 89102-3724			

CASE# SUP-41542

PARCEL#	OWNER	ADDRESS1	ADDRESS2	ADDRESS3	ADDRESS4	ADDRESS5
141	16207514036 JOHNSON EARL & NANCY A	3812 EL CONLON AVE	LAS VEGAS NV 89102-5839			
142	16207516047 JOHNSON RONALD JOHN	3817 SAN ANGELO AVE	LAS VEGAS NV 89102-0124			
143	16207515097 JOHNSTON GWENETH LIVING TRUST	JOHNSTON GWENETH TRS	4001 SAN JOAQUIN AVE	LAS VEGAS NV 89102-5707		
144	16207516055 JUN MIAO SHI	4328 PACIFIC CREST AVE	LAS VEGAS NV 89115-6009			
145	16206811015 KAMINSKI STEVEN T	3808 EL CAMINO AVE	LAS VEGAS NV 89102-3800			
146	16206810073 KARR SUMRU G	3090 S BRONCO ST	LAS VEGAS NV 89146-6602			
147	16207515095 KLEE LIVING TRUST	LEE KATY L TRS	P O BOX 2309	SARATOGA CA 95070-0309		
148	16207514010 KUS ALICE LIVING TRUST	KUS ALICE TRS	3900 SAN BERNARDINO AVE	LAS VEGAS NV 89102-5864		
149	16207513025 LANDIS LLOYD WILLIAM & LESLIE K	13400 DEL MONTE DR #001L	SEAL BEACH CA 90740-4542			
150	16206810058 LARPCAROEN SUNIDTHA	4021 ESMEALDA AVE	LAS VEGAS NV 89102-3702			
151	16206813004 LARSON S FAMILY L P	%STEVE LARSON	2950 E FLAMINGO RD #H	LAS VEGAS NV 89121-5208		
152	16206811033 LE MELISSA	2144 PESCARA CT	LAS VEGAS NV 89123-3925			
153	16207516046 LEMOINE TODD & MELISSA LIVING TR	37 GULF PINES AVE	LAS VEGAS NV 89148-2839			
154	16207514056 LEMUS FRANCISCO E	3701 EL CONLON AVE	LAS VEGAS NV 89102-5819			

CASE# SUP-41542

PARCEL#	OWNER	ADDRESS1	ADDRESS2	ADDRESS3	ADDRESS4	ADDRESS5
155	16206812001	LESARDE ENTERPRISES LTD	%N CARABET	7730 GRAYSTONE DR	WEST HILLS CA 91304-6148	
156	16206811010	LEWIS DAYTON E	3912 EL CAMINO AVE	LAS VEGAS NV 89102-0500		
157	16207515019	LI MEI YU	219 AVONDALE AVE #A	MONTEREY PARK CA 91754-1661		
158	16207516042	LI WEN LING	ZHAO ZHENG QING	4516 NEW DUPELL	LAS VEGAS NV 89147-8528	
159	16207514002	LIANG HUAI XING	TAM HAN MING	2562 TENNIS LN	TRACY CA 95377-1125	
160	16207510007	LIBERTY LANDHOLDINGS LLC	631 N STEPHANIE ST #351	HENDERSON NV 89014-2633		
161	16207516051	LILLY EUGENE R	3801 SAN ANGELO AVE	LAS VEGAS NV 89102-0124		
162	16207513008	LIN XU	4885 HILLS DALE DR	LOS ANGELES CA 90032-1558		
163	16207516020	LOPEZ AGUSTINA	613 CARPENTER DR	LAS VEGAS NV 89107-3437		
164	16206812074	LOPEZ JUANA IRMA	GARCIA LUIS ALBERTO	4009 VIA VAQUERO AVE	LAS VEGAS NV 89102-3714	
165	16207513037	LOPEZ MARCELINA	LOPEZ-GARCIA VIRGINIA M	2521 AMARILLO ST	LAS VEGAS NV 89102-5714	
166	16207516043	LOPEZ MARTIN GUTIERREZ	GUTIERREZ GABREILA	3808 SAN JOAQUIN AVE	LAS VEGAS NV 89102-0154	
167	16207514047	LOPEZ R G TRUST	LOPEZ RAFAEL & GRACIELA TRS	3901 EL CONLON AVE	LAS VEGAS NV 89102-5862	
168	16206810025	LOREDO SALVADOR	4100 E EL CAMINO AVE	LAS VEGAS NV 89102-3739		

CASE# SUP-41542

	PARCEL#	OWNER	ADDRESS1	ADDRESS2	ADDRESS3	ADDRESS4	ADDRESS5
169	16207514011	LOUIE JONATHAN	LEE MEI CHUN	3904 SAN BERNARDINO AVE	LAS VEGAS NV 89102-5864		
170	16207516006	MAHON KELLIE	P O BOX 26683	LAS VEGAS NV 89126-0683			
171	16207513043	MANZ JEFFREY S	2604 AMARILLO ST	LAS VEGAS NV 89102-0639			
172	16207516052	MARHENKE STEVE K & JINDAPORN	3713 SAN ANGELO AVE	LAS VEGAS NV 89102-5926			
173	16208101008	MARIANA'S ENTERPRISES	%ACCOUNTS PAYABLE	2325 E CHEYENNE AVE	NO LAS VEGAS NV 89030-8400		
174	16207514028	MARKS STEPHANIE	3701 SAN BERNARDINO AVE	LAS VEGAS NV 89102-5826			
175	16207515012	MARQUEZ ALFONSO & TRANSITO	4004 SAN JOAQUIN AVE	LAS VEGAS NV 89102-5708			
176	16206811012	MARTI VIRGINIA	3904 EL CAMINO AVE	LAS VEGAS NV 89102-0500			
177	16207513054	MARTINEZ LINO & MARICELA	4201 EL CONLON AVE	LAS VEGAS NV 89102-0623			
178	16207513080	MARTINEZ MARICELA	4201 EL CONLON AVE	LAS VEGAS NV 89102-0623			
179	16207513044	MARTINEZ NILIA	2600 AMARILLO ST	LAS VEGAS NV 89102-0639			
180	16207516010	MCKEE TANEA	COHEN EDDIE J	3900 SAN ANGELO AVE	LAS VEGAS NV 89102-0123		
181	16206811017	MCSHARRY LINDA	3800 EL CAMINO AVE	LAS VEGAS NV 89102-3800			
182	16207514015	MENDOZA-FLORES JORGE	LOPEZ MARISELA GASPER	3917 SAN BERNARDINO AVE	LAS VEGAS NV 89102-5866		

CASE# SUP-41542

PARCEL#	OWNER	ADDRESS1	ADDRESS2	ADDRESS3	ADDRESS4	ADDRESS5
183	16207516013	MIAO SHI JUN	4328 PACIFIC CREST AVE	LAS VEGAS NV 89115-6009		
184	16206810017	MIJAREZ MARTHA	2212 LOS ALTOS ST	LAS VEGAS NV 89102-3773		
185	16206811016	MIMS WILLIAM J ETAL	3804 EL CAMINO AVE	LAS VEGAS NV 89102-3800		
186	16207516018	MOCTEZUMA-GUZMAN MAURILLIO	RAMIREZ HILDA	2617 LAS VERDES ST	LAS VEGAS NV 89102-5913	
187	16206810070	MONDRAGON FAVIOLA	4024 ESMEALDA AVE	LAS VEGAS NV 89102-3703		
188	16206812036	MOREJON BEATRIZ MARTINEZ	4201 ESMEALDA AVE	LAS VEGAS NV 89102-3764		
189	16207514007	MORGAN LUPE	MARTINEZ ESTHER	2310 S CIMARRON RD	LAS VEGAS NV 89117-1904	
190	16207514034	MORTET GEORGES C & M REV LIV TR	MORTET GEORGES C & MATHILDE TRS	3804 W EL CONLON AVE	LAS VEGAS NV 89102-5839	
191	16207513028	MORTON LEE REVOCABLE TRUST	MORTON LEE TRS	2533 ARENAS ST	LAS VEGAS NV 89102-5720	
192	16207515001	MORWOOD BILL TRUST	MORWOOD BILL TRS	2608 LAS VERDES ST	LAS VEGAS NV 89102-5900	
193	16207512010	MR K S L V L L C	1625 S DECATUR BLVD	LAS VEGAS NV 89102-8514		
194	16207513005	NAKANISHI FAMILY TRUST	NAKANISHI GENE & SOONBOK CO-TRS	7046 EL PARQUE AVE	LAS VEGAS NV 89117-2106	
195	16207511002	NAKANISHI GENE & SOONBOK	7046 EL PARQUE AVE	LAS VEGAS NV 89117-2106		
196	16207514039	NALL GARY R & MONA E	3904 EL CONLON AVE	LAS VEGAS NV 89102-5860		

CASE# SUP-41542

PARCEL#	OWNER	ADDRESS1	ADDRESS2	ADDRESS3	ADDRESS4	ADDRESS5
197	16207513017	NGUYEN DUNG THI & AMY	NGUYEN DUNG THI & AMY	4004 SAN BERNARDINO AVE	LAS VEGAS NV 89102-5729	
198	16207513022	NICOYCO PETE & LOLITA	2528 LAS VERDES ST	LAS VEGAS NV 89102-5914		
199	16207514057	NIEMAN DAWN	3700 SAN BERNARDINO AVE	LAS VEGAS NV 89102-5827		
200	16207513051	NIEVES PEDRO VIVAS	CHAVEZ-VIVAS MARIA E	2529 LENNA	LAS VEGAS NV 89102-5728	
201	16207514013	NORLANDER STEVEN & SARA	3912 SAN BERNARDINO AVE	LAS VEGAS NV 89102-5864		
202	16206810059	NORT CHARLOTTE	4017 ESERALDA AVE	LAS VEGAS NV 89102-3702		
203	16207514033	OLIVERIO BIAGIO & JOSEPHINE	32 TIMBER RIDGWAY	CALGARY AB T3R 1B9	CANADA	
204	16206812076	ONG BICHA THI	2122 E CHARLESTON BLVD	LAS VEGAS NV 89104-2061		
205	16207513010	OSAKA PENSION PLAN	7046 EL PARQUE AVE	LAS VEGAS NV 89117-2106		
206	16206810105	PAGLIA-KIRKPATRICK MICHELLE A	6618 VILLA BONITA RD	LAS VEGAS NV 89146-6590		
207	16207515084	PALMER CLAYTON J & KIM M	3145 MEDITERRANEAN DR	LAS VEGAS NV 89117-2333		
208	16206810020	PALMET HUMBERTO A & ANA J	4000 EL CAMINO AVE	LAS VEGAS NV 89102-3626		
209	16206810061	PANG YORK MEE STEPHANIE	2301 ASHLAND AVE	SANTA MONICA CA 90405-6029		
210	16207513052	PARK BONNIE & THOMAS	2533 LENNA ST	LAS VEGAS NV 89102-5728		

CASE# SUP-41542

	PARCEL#	OWNER	ADDRESS1	ADDRESS2	ADDRESS3	ADDRESS4	ADDRESS5
211	16207514020	PARKER G & S TRUST	PARKER GERALD S TRS	3817 SAN BERNARDINO AVE	LAS VEGAS NV 89102-5865		
212	16207516012	PAULUS EVERETT T & BARBARA A	2612 SONORA ST	LAS VEGAS NV 89102-5912			
213	16206811032	PAVEL ALAN D	MILES SHELLE R	3809 EL PORTAL AVE	LAS VEGAS NV 89102-3887		
214	16207516053	PETERSON WAYNE	3709 SAN ANGELO AVE	LAS VEGAS NV 89102-5926			
215	16206810068	PIACENZA CAROL J	4016 ESMEALDA AVE	LAS VEGAS NV 89102-3703			
216	16207514043	PICCIRILLO JOSEPH J & LUELLA	3917 EL CONLON AVE	LAS VEGAS NV 89102-5862			
217	16208101006	PIKOLYCKY JAROSLAW	6160 CAMINO DE LA COSTA	LA JOLLA CA 92037-6520			
218	16207513036	POLANCO RENE	MARIN ROSAURA M	2520 ARENAS ST	LAS VEGAS NV 89102-5721		
219	16206810066	PONCE GUSTAVO & HERMILA	4008 ESMEALDA AVE	LAS VEGAS NV 89102-3703			
220	16207513020	PORTILLO MOISES	CUELLAR SARA	2600 LAS VERDES ST	LAS VEGAS NV 89102-5900		
221	16207514009	POTESAK ROBERT	400 SERIES INC	3816 SAN BERNARDINO AVE	LAS VEGAS NV 89102-5863		
222	16207515083	PRINGLE THEODORE J & MARGARET A	P O BOX 477	SOUTH FORK CO 81154-0477			
223	16207513009	PROSPERO RITA R	4104 SAN BERNARDINO	LAS VEGAS NV 89102-5789			
224	16207513039	PROVOST ENY M	2529 AMARILLO ST	LAS VEGAS NV 89102-5714			

CASE# SUP-41542

	PARCEL#	OWNER	ADDRESS1	ADDRESS2	ADDRESS3	ADDRESS4	ADDRESS5
225	16206810054	QUINTERO ROBERTO ACUNA	4105 ESMERALDA AVE	LAS VEGAS NV 89102-3763			
226	16207516027	RAINES VICTORIA J	2654 REDWOOD ST	LAS VEGAS NV 89146-5109			
227	16207515020	RAMOS MANUEL D	2617 AMARILLO ST	LAS VEGAS NV 89102-0602			
228	16206810103	REGUS PARTNERS L L C	18448 NOTTINGHAM LN	RAWLAND HEIGHTS CA 91748-5171			
229	16206811009	RICHARDSON JANET	299 BARLETTA AVE	LAS VEGAS NV 89123-3082			
230	16206810022	RIVAS JOSE R	DERIVAS SILVIA	4008 EL CAMINO AVE	LAS VEGAS NV 89102-3626		
231	16207513081	ROA WINIFREDO & CAROLINA O	PAGADUAN MANOLO O	4201 SAN BERNARDINO AVE	LAS VEGAS NV 89102-5731		
232	16207511007	ROBARTS 1981 TRUST	ROBARTS MINNIE ANN TRS	2800 GILMARY AVE	LAS VEGAS NV 89102-2032		
233	16206810065	ROBINSON DONALD	4004 ESMERALDA AVE	LAS VEGAS NV 89102-3703			
234	16207514045	ROSELES RAUL	RUEDA MARIA E	3909 EL CONLON AVE	LAS VEGAS NV 89102-5862		
235	16207515094	RUIZ MARGARITA	TORRES JOSE L	4013 SAN JOAQUIN AVE	LAS VEGAS NV 89102-5707		
236	16205402002	S H B SAHARA L L C	%R STEWART	19118 PACIFIC COAST HWY	MALIBU CA 90265-5407		
237	16207513023	SADEN JOHN H & MARILYN J	2524 LAS VERDES ST	LAS VEGAS NV 89102-5914			
238	16207513019	SAGUM JESSIE M & EDELWINA M	2604 LAS VERDES ST	LAS VEGAS NV 89102-5900			

CASE# SUP-41542

PARCEL#	OWNER	ADDRESS1	ADDRESS2	ADDRESS3	ADDRESS4	ADDRESS5
239	16207511010 SAHARA 2 L L C	%BEST CO	6450 W SPRING MOUNTAIN RD #12	LAS VEGAS NV 89146-8836		
240	16207514042 SALADO OLGA L	3916 EL CONLON AVE	LAS VEGAS NV 89102-5860			
241	16207514005 SAMAYOA MANUEL A	3800 SAN BERNARDINO AVE	LAS VEGAS NV 89102-5863			
242	16207515085 SAUCEDO ALEJANDRA R	%M MAURICIO	2620 AMARILLO ST	LAS VEGAS NV 89102-5762		
243	16207513049 SAVOV GEORGI	%EXECUTIVE FIDUCIARY SERV	10170 W TROPICANA AVE #156-379	LAS VEGAS NV 89147-8465		
244	16207513011 SECRETARY HOUSING & URBAN DEV	%MICHAELSON CONNOR & BOUL	13832 N 32ND #D150	PHOENIX AZ 85032-5645		
245	16207515021 SERPAS GILMA	2613 AMARILLO ST	LAS VEGAS NV 89102-0602			
246	16206811013 SERVIN CELINA	3900 EL CAMINO AVE	LAS VEGAS NV 89102-0500			
247	16207516026 SHAMIR DAVID	3817 SAN JOAQUIN AVE	LAS VEGAS NV 89102-0155			
248	16206810109 SIBLEY KENNETH W	4005 EL CAMINO AVE	LAS VEGAS NV 89102-3601			
249	16207516041 SILVA JUAN A	COLON JUANA	3800 SAN JOAQUIN AVE	LAS VEGAS NV 89102-0154		
250	16206812011 SONG GUOFU	KANG JING	4104 VIA VAQUERO AVE	LAS VEGAS NV 89102-3766		
251	16205402001 SPOAKS	3055 SOFT HORIZON WY	LAS VEGAS NV 89135-1741			
252	16207513027 SPREEMAN MARK A & BRENDA D	2529 ARENAS ST	LAS VEGAS NV 89102-5720			

CASE# SUP-41542

PARCEL#	OWNER	ADDRESS1	ADDRESS2	ADDRESS3	ADDRESS4	ADDRESS5
253	16207513032 STAUFFER RONALD REID	CONLEY M ALISON	2600 ARENAS ST	LAS VEGAS NV 89102-0603		
254	16207516003 STEWART SANDRA	3809 FAIRWAY CIR	LAS VEGAS NV 89108-1106			
255	16207516021 SU SHU MEI CHEN	2605 LAS VERDES	LAS VEGAS NV 89102-5913			
256	16207514053 SU YANDONG	711 W VALLEY BLVD #210	ALHAMBRA CA 91803-3246			
257	16207516045 SUCCESS DEVOLOPMENT INC	639 OAKMONT AVE #3915	LAS VEGAS NV 89109-0191			
258	16208103006 SUNRISE GARDENS LV ASSOC L L C	%WESTERN AMERICA PPTYS INC	%J PERLEY	111 N SEPULVEDA BLVD #330	MANHATTAN BEACH CA 90266- 6813	
259	16207512001 SUNSHINE ONE L L C	%P ROBERTS	%BEST CO	6450 SPRING MOUNTAIN RD #12	LAS VEGAS NV 89146-8836	
260	16207513026 SYPIEN DON ERIC	2525 ARENAS ST	LAS VEGAS NV 89102-5720			
261	16206811036 SZLUHA MICHAEL	3909 EL PORTAL AVE	LAS VEGAS NV 89102-3888			
262	16207514029 TABACCHI UNA J	3700 EL CONLON AVE	LAS VEGAS NV 89102-5820			
263	16206812038 TAPIA DANIEL A	4101 VIA OLIVERO AVE	LAS VEGAS NV 89102-3720			
264	16207516007 TARAMAR TRUST	HOLMES JERRY B TRS	115 LAKE EMERALD DR #101	OAKLAND PARK FL 33309-6252		
265	16207514006 TARANTULA TRAIL L L C	HCR 33 BOX 2627	LAS VEGAS NV 89161-9271			
266	16206812012 TEPPER CARMEN	12895 HARWICK LN	SAN DIEGO CA 92130-2708			

CASE# SUP-41542

	PARCEL#	OWNER	ADDRESS1	ADDRESS2	ADDRESS3	ADDRESS4	ADDRESS5
267	16206810057	TEPPER PPTYS HOLDINGS L L C	12895 HARWICK LN	SAN DIEGO CA 92130-2708			
268	16207512002	THREE JS	18 COLLETON RIVER DR	HENDERSON NV 89052-6644			
269	16206813006	THRIFTY PAYLESS INC	%REAL EST TAX #6111	P O BOX 3165	HARRISBURG PA 17105-3165		
270	16207514003	TONG WEI	9745 MT CUPERTINO ST	LAS VEGAS NV 89178-7505			
271	16207515008	TORRES IGNACIO & LORENA	2621 ARENAS ST	LAS VEGAS NV 89102-0604			
272	16207510005	TOWN BUILDING CORPORATION	%F SCHNEIDER	7545 W SAHARA AVE #100	LAS VEGAS NV 89117-2755		
273	16206811018	TREJO DAVID	3712 EL CAMINO AVE	LAS VEGAS NV 89102-3801			
274	16207513034	TSACOYEANES GEORGE W REV TR	TSACOYEANES BEVERLY T REV TR	2660 S TORREY PINES	LAS VEGAS NV 89146-5139		
275	16206801006	TYLER FAMILY TRUST	TYLER INA W TRS	8325 HIGHLAND DR #114	SANDY UT 84093-1021		
276	16208101001	UNGAR INVESTMENTS L P	P O BOX 80246	LAS VEGAS NV 89180-0246			
277	16206801003	UNIVERSITY BOARD OF REGENTS	%UNIVERSITY NV SYSTEM	2601 ENTERPRISE RD	RENO NV 89512-1666		
278	16207516017	VALIZAN LOUIS JOHN & GLORIA H	3908 SAN JOAQUIN AVE	LAS VEGAS NV 89102-5911			
279	16207514038	VALLEJOS ERNESTO J	3900 EL CONLON AVE	LAS VEGAS NV 89102-5860			
280	16207513038	VAZQUEZ PROVIDENCIA & ANGEL	2525 AMARILLO ST	LAS VEGAS NV 89102-5714			

CASE# SUP-41542

PARCEL#	OWNER	ADDRESS1	ADDRESS2	ADDRESS3	ADDRESS4	ADDRESS5
281	16207515014	VELARDE JOSE ANGEL & ORLANDA	2616 ARENAS ST	LAS VEGAS NV 89102-0603		
282	16207515025	VELAZQUEZ KARLA	4108 SAN ANGELO AVE	LAS VEGAS NV 89102-5702		
283	16207516016	VERPLANCK RUTH J	3904 SAN JOAQUIN AVE	LAS VEGAS NV 89102-5911		
284	16207514024	VICCARO NICHOLAS & TERRI	3801 SAN BERNARDINO AVE	LAS VEGAS NV 89102-5865		
285	16207514054	VILLACORTA YESENIA	3709 EL CONLON AVE	LAS VEGAS NV 89102-5819		
286	16207516040	VIVA LA FAMILIA TRUST	RIVERA ROSA TRS	861 N 24TH ST	LAS VEGAS NV 89101-2258	
287	16207515022	VIVAS PEDRO	CHAVEZ-VIVAS MARIA E	2607 AMARILLO ST	LAS VEGAS NV 89102-0602	
288	16206811007	WALKER JOEL A	2217 LAS VERDES ST	LAS VEGAS NV 89102-3845		
289	16207515026	WALSTON JOHN R JR & ANN L	4112 SAN ANGELO AVE	LAS VEGAS NV 89102-5702		
290	16207510004	WANG HENRY HER-JEN	TANAKUL CHURAIRAT	2180 HORSE PRAIRIE DR	HENDERSON NV 89052-5834	
291	16207514021	WANG SHUXIA	P O BOX 26905	LAS VEGAS NV 89126-0905		
292	16207516028	WEI CUI	WANG YUFEN	927 E LASTUNAS DR	SAN GABRIEL CA 91776-1661	
293	16207515002	WEI TARA	2612 LAS VERDES ST	LAS VEGAS NV 89102-5900		
294	16207515010	WEI XIUJIE	3863 S VALLEY VIEW #16	LAS VEGAS NV 89103-2945		

CASE# SUP-41542

PARCEL#	OWNER	ADDRESS1	ADDRESS2	ADDRESS3	ADDRESS4	ADDRESS5
295	16206813001 WEISS ROBERT G ETAL	600 S LINCOLN #202	STEAMBOAT SPRINGS CO	80487-8917		
296	16207514023 WHITE ANDRE	3805 SAN BERNARDINO AVE	LAS VEGAS NV 89102-5865			
297	16206801002 WIJEKULARATNE GRASHANTHI & M	5834 W OAKY BLVD	LAS VEGAS NV 89146-1243			
298	16206812005 WILSON ALLYN M & SHIRLEY R TRUST	WILSON ALLYN M & SHIRLEY R TRS	2401 ARENAS ST	LAS VEGAS NV 89102-3701		
299	16207511004 WILSON JAMES B & DIXIE J REV TR	WILSON DIXIE J TRS	6309 JUMILLA AVE	WOODLAND HILLS CA 91367-2821		
300	16206810067 WOODARD AUSTIN W JR & SHAWN R	4012 ESMEALDA AVE	LAS VEGAS NV 89102-3703			
301	16207515017 WU SHUPING	4024 SAN JOAQUIN AVE	LAS VEGAS NV 89102-5709			
302	16207514008 YANEZ PRIMITIVO	4245 HARRIS AVE	LAS VEGAS NV 89110-2226			
303	16207513041 YANG STEVEN YEE BUN & AMY PING	2243 BENTLEY RIDGE RD	SAN JOSE CA 95138-2424			
304	16207516001 YANG ZHEN YI	%Z YU	187 POCONO MANOR CT	LAS VEGAS NV 89148-2632		
305	16207514012 YU JIANQIANG	2270 LYRICAL RD	HENDERSON NV 89052-6529			
306	16207513082 ZHANG SHAO HUA	ZHANG SHAO YI	4508 CINDERELLA LN	LAS VEGAS NV 89102-5700		
307	16207513046 ZHANG YU	1556 MADERA CIR	EL CERRITO CA 94530-2014			
308	16207516019 ZHAO ROGER	LIN LILY	1242 ORANGE GROVE AVE	SOUTH PASADA CA 91030-3602		

CASE# SUP-41542

	PARCEL#	OWNER	ADDRESS1	ADDRESS2	ADDRESS3	ADDRESS4	ADDRESS5
309	16207515009	ZHOU KAILI	322 N ALHAMBRA AVE #A	MONTEREY PARK CA 91755-1917			