

City of Las Vegas
Office Of The City Clerk
495 South Main Street
Las Vegas, Nevada 89101

Return Service Requested
Official Notice of Public Hearing

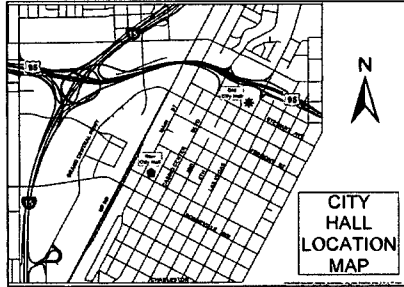

If you wish to file your protest or support on this request, check the appropriate box below and return this card in an envelope with postage to the Office Of The City Clerk at the address listed above or fax this side of this card to (702) 382-4803. If you would like to contact your Council Representative, please call (702) 229-6405.

I SUPPORT
this Request

I OPPOSE
this Request

Please use available blank space on card for your comments.

SDR-49181

City Council Meeting of 7/24/2013

Application Information

SDR-49181 - APPLICANT: BOULDER PLACEMENT SYSTEMS, INC. - OWNER: JADA HOLDINGS, LLC - For possible action on a request for a Site Development Plan Review FOR EXPANSION OF AN EXISTING BUILDING AND LANDSCAPE MATERIAL/LUMBER YARD WITH WAIVERS OF PERIMETER LANDSCAPE BUFFER STANDARDS TO ALLOW ZERO-FOOT BUFFERS ALONG THE EAST AND WEST PROPERTY LINES WHERE EIGHT FEET IS REQUIRED, AND A ZERO-FOOT LANDSCAPE BUFFER ALONG THE SOUTH PROPERTY LINE AND A PORTION OF THE NORTH PROPERTY LINE WHERE 15 FEET IS REQUIRED on 1.13 acres at 2049 and 2101 West Bonanza Road (APNs 139-28-401-006 and 139-29-802-006), C-M (Commercial/Industrial) and C-2 (General Commercial) Zones [PROPOSED: C-M (Commercial/Industrial)], Ward 5 (Barlow) [PRJ-49067].

Application Location

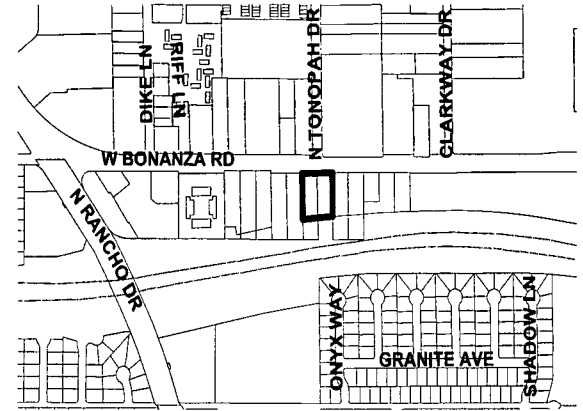

The proposed project may not pertain to the entire highlighted project site.

Public Hearing Information

Meeting: City Council
Date: *July 24, 2013*
Time: 1:00 P.M.
Location: City Council Chambers
495 South Main Street
Las Vegas, Nevada

Any and all interested persons may appear and be heard at said meeting, or may, prior thereto, file written objections thereto or approvals thereof with the City Clerk, 2nd Floor, City Hall, 495 South Main Street, Las Vegas, Nevada, 89101. For further information, including the full staff report, please call (702) 229-6311 (TDD 386-9108) or go to <http://www.lasvegasnevada.gov>

CASE# SDR-49181

	PARCEL#	OWNER	ADDRESS1	ADDRESS2	ADDRESS3	ADDRESS4	ADDRESS5
1	13928410115	ABRICA BENJAMIN	RODRIGUEZ MILAGRO	%LERETA CORP	1123 S PARKVIEW DR	COVINA CA 91724-3748	
2	13928410109	ALLEN EVELYN P	2016 W MESQUITE AVE	LAS VEGAS NV 89106-3761			
3	13928401031	ALL-STAR AUTOMOTIVE INC	P O BOX 36703	LAS VEGAS NV 89133-6703	7/24/2013	SDR-49181	
4	13928410049	ARGIER JOHN A	27 JADE CIR	LAS VEGAS NV 89106-3748	Mr. Jerry Appelhans JADA Holdings, LLC 210 North Royal Ascot Drive Las Vegas, Nevada 89144		
5	13928410050	ARGIER JOHN A & RUTH	23 JADE CIR	LAS VEGAS NV 89106-3748	7/24/2013	SDR-49181	
6	13929714072	ARIAS ARACELI ANGUIANO TRUST	2451 N RAINBOW #1079	LAS VEGAS NV 89108-4505	Ms. Peyta Balova Balova Engineering 6130 Elton Avenue Las Vegas, Nevada 89107		
7	13928410021	ARTABA ALTHEA & FELICIANO	27 ZIRCON CIR	LAS VEGAS NV 89106-3729			
8	13928410032	ASCENCIO-OJEDA MAYRA L	34 ZIRCON CIR	LAS VEGAS NV 89106-3727			
9	13929811025	AU JARED K ETAL	1088 BISHOP ST #1503	HONOLULU HI 96813-3119			
10	13928410014	AVILA ERNESTO LOPEZ	LOPEZ PATRICIA	18 ONYX WY	LAS VEGAS NV 89106-3726		
11	13929714074	AZMITIA XIOMARA M	2211 SLEEPY CT	LAS VEGAS NV 89106-3699			
12	13929704016	BACON PATRICK	720 CARTER ST	LAS VEGAS NV 89106-3622			
13	13928410006	BARRIENTOS JOSE & MARIA M	15996 HOLLY DR	FONTANA CA 92335-5428			
14	13928301023	BEHNEN BECKY BINION	1900 SILVER AVE	LAS VEGAS NV 89102-2431			

CASE# SDR-49181

	PARCEL#	OWNER	ADDRESS1	ADDRESS2	ADDRESS3	ADDRESS4	ADDRESS5
15	13928410035	BENAVIDES ANITA ANN	203 W CLEVELAND ST	PRARIE GROVE AR 72753-3125			
16	13929811043	BOHNET MICHAEL FREDERICK	9120 CLEAR SKY AVE	LAS VEGAS NV 89178-3543			
17	13929811048	BOLAN MARCO ANTONIO	1383 S 1470 E	PROVO UT 84606-6417			
18	13929704027	BONANZA MINI STORAGE L L C	%STOUT MGT CO	10151 PARK RUN DR	LAS VEGAS NV 89145-8859		
19	13929811033	BONANZA PARK PROPERTIES L L C	%R EISLER	840 S RANCHO DR #4221	LAS VEGAS NV 89106-3837		
20	13929811091	BONNOT MICHAEL	7108 RAWLINS CT	LAS VEGAS NV 89128-3345			
21	13928301021	BUCHANAN LARRY EUGENE	313 UPLAND BLVD	LAS VEGAS NV 89107-2648			
22	13929811058	C VERAPAPPA W W L L C	513 S MAIN ST	LAS VEGAS NV 89101-6319			
23	13928301019	CALCATERRA LEE L	721 CLARKWAY DR	LAS VEGAS NV 89106-3609			
24	13929714032	CARDENAS KARINA ALEJANDRA MENDEZ	MARTINEZ WILBERT ANTONIO JR	2115 SLEEPY CT	LAS VEGAS NV 89106-3675		
25	13929811046	CARO ISIDRO	2221 W BONANZA RD #46	LAS VEGAS NV 89106-4709			
26	13928301005	CARROLL BOBBY R	804 N TONOPAH DR	LAS VEGAS NV 89106-3600			
27	13929811019	CASTILLO ARTURO JR	15838 SILVERGROVE DR	WHITTIER CA 90604-3744			
28	13928410066	CHAVEZ CARLOS	NAVARRETE-SANCHEZ BERNA	15 DIAMOND CIRCLE	LAS VEGAS NV 89106-3750		

CASE# SDR-49181

	PARCEL#	OWNER	ADDRESS1	ADDRESS2	ADDRESS3	ADDRESS4	ADDRESS5
29	13929811004	CHESHER DWAYNE LEE	554 CHANDLER ST	HENDERSON NV 89014-3932			
30	13929811102	CHRISTENSEN EVA STARR S LIV TR	6660 BOXWOOD LN	LAS VEGAS NV 89103-1009			
31	13928410019	CINCOTTO F & F JOINT LIVING TR	CINCOTTO FRANK & FRANCES TRS	35 ZIRCON CIR	LAS VEGAS NV 89106-3729		
32	13929811097	COFRANCESCO LIVING TRUST 2009	936 MIDPRIDE ST	LAS VEGAS NV 89144-1304			
33	13929811056	COOK STEVEN J	3721 COLFAX CIR	LAS VEGAS NV 89108-5408			
34	13929714086	COUNTRY RIDGE III HOWNERS ASSN	%COMNTY MGT GROUP	3360 W SAHARA AVE #200	LAS VEGAS NV 89102-6069		
35	13928410036	CYR MALLORY	23 AMBER CIR	LAS VEGAS NV 89106-3749			
36	13928302034	D F A L L C	1401 MINERAL AVE	LAS VEGAS NV 89106-4342			
37	13928301020	D R E A 357 L L C	1528 CASTLE CREST DR	LAS VEGAS NV 89117-7008			
38	13928410033	DACUNOS TEODORA	35 AMBER CIR	LAS VEGAS NV 89106-3749			
39	13929714050	DAVTYAN ARMAN	P O BOX 36069	LAS VEGAS NV 89133-6069			
40	13928410108	DELRIO CESAR	MARQUEZ MARIA C	6019 PINE AVE	MAYWOOD CA 90270-3108		
41	13928301030	DEMARCO ANGELO THOMAS & JANET L	651 CLARKWAY DR	LAS VEGAS NV 89106-3629			
42	13929811088	DENEGRI ANGELO	222 E 93RD ST #39- K	NEW YORK NY 10128-3762			

CASE# SDR-49181

	PARCEL#	OWNER	ADDRESS1	ADDRESS2	ADDRESS3	ADDRESS4	ADDRESS5
43	13928410030	DILLINGHAM OLIVER F LIVING TRUST	DILLINGHAM OLIVER F TRS	7501 WISH AVE	VAN NUYS CA 91406-2536		
44	13928412001	DON & PAUL L L C	1401 MINERAL AVE	LAS VEGAS NV 89106-4342			
45	13929811026	DONLEY MICHELLE	5332 KOA AVE	LAS VEGAS NV 89122-5314			
46	13929704026	DREA 357 L L C	1528 CASTLE CREST DR	LAS VEGAS NV 89117-7008			
47	13928410043	DUNCAN PAUL K	22 AMBER CIR	LAS VEGAS NV 89106-3710			
48	13929714045	DURAZO LAURA	2139 SLEEPY CT	LAS VEGAS NV 89106-3696			
49	13928410107	ELLIS GLORIA	2008 W MESQUITE AVE	LAS VEGAS NV 89106-3761			
50	13928410022	ESPY DANIEL F	2825 DOTTED WREN AVE	NO LAS VEGAS NV 89084-2238			
51	13929811034	ESTRADA JUAN	3708 W BONANZA RD	LAS VEGAS NV 89107-2170			
52	13928410023	FELGAR DEIRDRE MCGRAW	19 ZIRCON CIR	LAS VEGAS NV 89106-3729			
53	13928301016	FINDLY CHERYL	7098 LOS BANDEROS AVE	LAS VEGAS NV 89179-1207			
54	13928302016	FLOWERS STEPHEN A	700 CLARKWAY DR	LAS VEGAS NV 89106-3642			
55	13929811059	FOLEY ELIZABETH J	10505 INDIA HAWTHORN	LAS VEGAS NV 89144-4486			
56	13929704031	FULTZ ENTERPRISES INC	2100 W BONANZA RD	LAS VEGAS NV 89106-4769			

CASE# SDR-49181

	PARCEL#	OWNER	ADDRESS1	ADDRESS2	ADDRESS3	ADDRESS4	ADDRESS5
57	13929811028	GAMBARDELLA JOSEPH	%ACE PPTY MGT	P O BOX 27377	LAS VEGAS NV 89126-1377		
58	13928410015	GANS CODY R	22 ONYX WY	LAS VEGAS NV 89106-3726			
59	13929712009	GARCIA MANUEL & LAURA	5653 S MOJAVE RD	LAS VEGAS NV 89120-1951			
60	13929712004	GARCIA MANUEL R & ELIZABETH	5653 S MOJAVE RD	LAS VEGAS NV 89120-1951			
61	13928301012	GOLDEN STAR INVEST PPTYS L L C	17332 IRVINE BLVD #100	TUSTIN CA 92780- 3021			
62	13929714030	GONZALEZ MARCIANO H	2119 SLEEPY CT	LAS VEGAS NV 89106-3676			
63	13928410111	GRANITE AVENUE TRUST	1132 PIAZZA NAVONA	HENDERSON NV 89052-4037			
64	13928410054	GRIFFITH JO ANN MARGARET	10 JADE CIR	LAS VEGAS NV 89106-3715			
65	13929714043	GUTIERREZ JEMIMA	1824 E ST LOUIS AVE	LAS VEGAS NV 89104-3747			
66	13929811060	HAFEN I L L C	161 KIMBERLY DR	HENDERSON NV 89015-7904			
67	13928410106	HANDY DONALD DEAN & JANE	2004 W MESQUITE AVE	LAS VEGAS NV 89106-3761			
68	13928410002	HASKINS MORRIS C & LORETTA L	3405 PINE HAVEN CIR	HAUGHTON LA 71037-9394			
69	13929704017	HAWKINS FRANK JR	P O BOX 270006	LAS VEGAS NV 89127-4006			
70	13929704037	HENRY-AUTRY CYNTHIA LOUISE	WILLIAMS HOWARD W REVOCABLE TR	5871 SHEILA AVE	LAS VEGAS NV 89108-3613		

CASE# SDR-49181

	PARCEL#	OWNER	ADDRESS1	ADDRESS2	ADDRESS3	ADDRESS4	ADDRESS5
71	13928410055	HERBORN FAMILY TRUST	HERBORN ARNOLD F & MARNA KAY TRS	14 JADE CIR	LAS VEGAS NV 89106-3715		
72	13929714044	HIRALES LIDIA	2991 PALM SHORE	LAS VEGAS NV 89101			
73	13929811022	ICKES JOHN W & CAROLE J	6641 TAMPA CT	LAS VEGAS NV 89108-7039			
74	13929811001	JACOBS JAMES E	P O BOX 270337	LAS VEGAS NV 89127-4337			
75	13929811016	JACOBS JIM	P O BOX 270337	LAS VEGAS NV 89127-4337			
76	13928401006	JADA HOLDINGS L L C	%J APPELHANS	%D TENNARIELLO- APPELHANS	210 N ROYAL ASCOT DR	LAS VEGAS NV 89144-4305	
77	13929811075	JAVORNICKY MICHAEL J II	3625 KING CHARLES ST	NO LAS VEGAS NV 89030-4422			
78	13929811100	JOHO STEVE	P O BOX 270179	LAS VEGAS NV 89127-4179			
79	13928410051	JOLLEY JOSEPH GARN	9524 BORGATA BAY BLVD	LAS VEGAS NV 89147-8010			
80	13928410008	KELLY WILLIE M	23 ONYX WAY	LAS VEGAS NV 89106-3732			
81	13929704029	KENSINGTON PARTNERS L L C	2775 S RAINBOW BLVD #101C	LAS VEGAS NV 89146-5192			
82	13929714029	KULBACK CHONG	9261 WILD STAMPEDE AVE	LAS VEGAS NV 89178-5523			
83	13929811080	LACOSSE JOE E	2221 W BONANZA RD #80	LAS VEGAS NV 89106-4713			
84	13929801010	LODGE MASONIC MEMORIAL TEMPLE	2200 W MESQUITE	LAS VEGAS NV 89106-3788			

CASE# SDR-49181

	PARCEL#	OWNER	ADDRESS1	ADDRESS2	ADDRESS3	ADDRESS4	ADDRESS5
85	13929811036	LONG JUDITH C	2633 SW OBSIDIAN #21	REDMOND OR 97756-7007			
86	13928410052	LONGO FABIO	15 JADE CIR	LAS VEGAS NV 89106-3748			
87	13929712017	LONGO INVESTMENTS II L L C	840 S RANCHO DR #4-100	LAS VEGAS NV 89106-3837			
88	13929714025	LUSTY MATTHEW SIMON	SHERMAN-LUSTY SHARON.DAWN	5440 W SAHARA AVE #300	LAS VEGAS NV 89146-0355		
89	13928410044	MAGAHAN ROBERT R & CHONG C	26 AMBER CIR	LAS VEGAS NV 89106-3710			
90	13929811003	MALIK ALEXANDER	205 E HARMON AVE #1006	LAS VEGAS NV 89169-6465			
91	13929714027	MAN PROPERTIES L L C	3430 BUNKERHILL DR #A	NO LAS VEGAS NV 89032-6011			
92	13929811077	MARR SHERRIE LEE & NANCY E	2221 W BONANZA RD #77	LAS VEGAS NV 89106-4713			
93	13928410001	MASONIC MEMORIAL TEMPLE INC	3160 W SAHARA AVE #A22	LAS VEGAS NV 89102-6096			
94	13929714008	MATCHING ESTATE L L C	20738 VERCELLI WY	NORTHRIDGE CA 91326-4159			
95	13928410067	MAXFIELD MICHAEL R	11 DIAMOND CIR	LAS VEGAS NV 89106-3750			
96	13929811085	MAXWELL CONSTANCE R & JEFFERY	6240 CARL AVE	LAS VEGAS NV 89108-2589			
97	13929714066	MAYS SAARD	2155 SLEEPY CT	LAS VEGAS NV 89106-3697			
98	13929714048	MCCULLOM ISHMINE	4141 S DEFRAME ST	MORRISON CO 80465-1089			

CASE# SDR-49181

	PARCEL#	OWNER	ADDRESS1	ADDRESS2	ADDRESS3	ADDRESS4	ADDRESS5
99	13928410113	MCLEOD ARLENE G LIVING TRUST	MCLEOD MICHAEL L	2005 GRANITE AVE	LAS VEGAS NV 89106-3753		
100	13928301011	MELVILLE MELVIN R	734 N TONOPAH DR	LAS VEGAS NV 89106-3606			
101	13928410028	MENDEZ MIGUEL JR	18 ZIRCON CIR	LAS VEGAS NV 89106-3727			
102	13929714073	MENG QING KAI TRUST	MENG QING KAI TRS	313 N 4TH ST #C	ALHAMBRA CA 91801-2209		
103	13929714076	MENJIVAR LUIS A	2215 SLEPPY CT	LAS VEGAS NV 89106-3699			
104	13928410056	MERRILL DAN B & KATHLEEN	18 JADE CIR	LAS VEGAS NV 89106-3715			
105	13929811066	METCALFE FAMILY TRUST	%N METCALFE	372 VENTURA ST	ALTADENA CA 91001-4632		
106	13928410057	MIKKELSON FAMILY TRUST	MIKKELSON JOHN E & BETTY J TRS	22 JADE CIR	LAS VEGAS NV 89106-3715		
107	13928410018	MISTIE JENNIE	34 ONYX WAY	LAS VEGAS NV 89106-3726			
108	13928410045	MONARREZ CESAR	30 AMBER CIR	LAS VEGAS NV 89106-3710			
109	13929714010	MONTALVO NICOLAS & CORINA	2105 SLEEPY CT	LAS VEGAS NV 89106-3675			
110	13929714026	MURILLO OLIVIA & JESUS	2127 SLEEPY CT	LAS VEGAS NV 89106-3676			
111	13929714065	NADELA EUTIQUIANO B & ALPIA M	148 BOTHWELL PL	SHERWOOD PARK AB T8H 2M7	CANADA		
112	13929811076	NEAL CHARLES G	2221 W BONANZA RD #76	LAS VEGAS NV 89106-4713			

CASE# SDR-49181

	PARCEL#	OWNER	ADDRESS1	ADDRESS2	ADDRESS3	ADDRESS4	ADDRESS5
113	13928410005	NEWMAN NGUAN	35 ONYX WY	LAS VEGAS NV 89106-3732			
114	13928410116	NGHIEM CUONG & REMEDIOS M	31 KNOLLVIEW DR	POMONA CA 91766- 4928			
115	13928410034	NOOCHLAOR KEERANA	2223 N COMMONWEALTH AVE	LOS ANGELES CA 90027-1201			
116	13929714064	OGALDEZ OSCAR O & ANGELICA MARIA	3550 WINTER SCENE CT	LAS VEGAS NV 89147-3718			
117	13928410009	ONYX WAY TRUST	1132 PIAZZA NAVONA	HENDERSON NV 89052-4037			
118	13928301015	PALACIOS MARICELA	815 CLARKWAY DR	LAS VEGAS NV 89106-3645			
119	13928301017	PALACIOS REYES G & MARIA DEJESUS	729 CLARKWAY DR	LAS VEGAS NV 89106-3609			
120	13928410007	PARTEE SAMUEL ALLAN	27 ONYX WY	LAS VEGAS NV 89106-3732			
121	13929714014	PARTIDA PEDRO & ROSA	2113 SLEEPY CT	LAS VEGAS NV 89106-3675			
122	13929714011	PEREZ-YUNITIS MARGARITA	2107 SLEEPY CT	LAS VEGAS NV 89106-3675			
123	13929714046	PUAPRASERI ONANONG	2141 SLEEPY CT	LAS VEGAS NV 89106-3696			
124	13928410029	PUCKETT RAYMOND A	22 ZIRCON CIR	LAS VEGAS NV 89106-3727			
125	13928410110	PUNTANILLA MANUELA M & SPLENDOR	2017 GRANITE AVE	LAS VEGAS NV 89106-3753			
126	13929813005	RANCHO CIRCLE SHOPPING CTR L L C	%J BAYER	3463 HAVERFORD AVE	LAS VEGAS NV 89121-3536		

CASE# SDR-49181

PARCEL#	OWNER	ADDRESS1	ADDRESS2	ADDRESS3	ADDRESS4	ADDRESS5
127	13929714028	RAZO JOSE L	2305 SILVEREYE DR	NO LAS VEGAS NV 89084-2262		
128	13929714031	RAZO JULIE	2117 SLEEPY CT	LAS VEGAS NV 89106-3676		
129	13929714067	REAL PROPERTIES OF AMERICA	1168 WIGWAM PKWY	HENDERSON NV 89074-8154		
130	13929811063	REAMES MICHAEL	P O BOX 758	BEATTY NV 89003- 0758		
131	13929714009	RENTERIA-ZAMORA ISRAEL	2608 E OWENS AVE	NO LAS VEGAS NV 89030-7292		
132	13929714012	REYES RAMON	2109 SLEEPY CT	LAS VEGAS NV 89106-3675		
133	13929811015	ROBERTS NATHAN	60 POST OAK PL	ROCKDALE TX 76567-2548		
134	13929811014	ROGERS CINDY LIVING TRUST	3704 W BONANZA RD	LAS VEGAS NV 89107-2170		
135	13928410037	ROGERS TERRANCE L	19 AMBER CIR	LAS VEGAS NV 89106-3749		
136	13929811095	ROMEWRIGHT PROPERTIES L L C	452 E SILVERADO RANCH BLVD #230	LAS VEGAS NV 89183-6290		
137	13928301006	ROSALES EDWIN M	2020 EKANGER CIR	LAS VEGAS NV 89106-3608		
138	13928301007	ROWDEN RICHARD L	2010 EKANGER CIR	LAS VEGAS NV 89106-3608		
139	13929712011	RUSSELL RICHARD F	2221 S TIOGA WY	LAS VEGAS NV 89117-2735		
140	13928410112	RUSSELL SUZANNE	2009 GRANITE AVE	LAS VEGAS NV 89106-3753		

CASE# SDR-49181

	PARCEL#	OWNER	ADDRESS1	ADDRESS2	ADDRESS3	ADDRESS4	ADDRESS5
141	13929811103	S A S INVESTMENTS L L C	2400 N TENAYA WY #101	LAS VEGAS NV 89128-0420			
142	13928410004	SANCHEZ INEZ M	39 ONYX WAY	LAS VEGAS NV 89106-3732			
143	13929811047	SANDERS CURTIS STRATTON	2221 W BONANZA RD #47	LAS VEGAS NV 89106-4709			
144	13928301014	SANDERSON THOMAS H & ANNA C	730 N TONOPAH DR	LAS VEGAS NV 89106-3606			
145	13928410053	SANDRIDGE FAMILY TRUST	SANDRIDGE JACK D & BOONYUEN TRS	1413 BRYN MAWR AVE	LAS VEGAS NV 89102-4448		
146	13929704022	SHAPIRO FAMILY TRUST	BARNEY FAMILY TRUST	8019 ECHO CLIFF LN	LAS VEGAS NV 89129-4880		
147	13928302015	SLACK ELWIN C	708 CLARKWAY DR	LAS VEGAS NV 89106-3642			
148	13928410048	SMITH JAMES R & KELLY J	31 JADE CIR	LAS VEGAS NV 89106-3748			
149	13929714063	SOLIS VIRGINIA P	2161 SLEEPY CT	LAS VEGAS NV 89106-3697			
150	13928410042	SOTO FRANCISCO JAVIER	18 AMBER CIR	LAS VEGAS NV 89106-3710			
151	13928410003	STAFFORD JEFF	SCHULER KRISTIN	43 ONYX WY	LAS VEGAS NV 89106-3732		
152	13929802009	STATE OF NEVADA TRANSPORTATION	%RIGHT OF WAY DIV	1263 S STEWART ST	CARSON CITY NV 89712-0001		
153	13928410016	STOCKHOLM TRUST	26 ONYX WY	LAS VEGAS NV 89106-3726			
154	13929712005	TAMONDONG REGINO L	316 LA TORTOLA DR	WALNUT CA 91789- 2229			

CASE# SDR-49181

	PARCEL#	OWNER	ADDRESS1	ADDRESS2	ADDRESS3	ADDRESS4	ADDRESS5
155	13929811086	TAYLOR DARRYL & ROXANNE	908 WHITE AVE #8	GRAND JUNCTION CO 81501-3418			
156	13928301026	TAYLOR JON LIVING TRUST	TAYLOR JON TRS	P O BOX 371747	LAS VEGAS NV 89137-1747		
157	13929811021	THOMASEEC LARRY ANTHONY	5785 SPRING MTN #2	LAS VEGAS NV 89146-8829			
158	13928410031	THORN MYRON E & DOLORES	7001 POWDERHORN CIR	LAS VEGAS NV 89128-3304			
159	13929714075	TORNO SUSANA S	2213 SLEEPY CT	LAS VEGAS NV 89106-3699			
160	13929714085	TRAYLOR SABRINA	2217 SLEEPY CT	LAS VEGAS NV 89106-5600			
161	13928410041	TRIGUEROS SILVIA	P O BOX 230834	LAS VEGAS NV 89105-0834			
162	13928410017	TRUJILLO GABRIELA	30 ONYX WAY	LAS VEGAS NV 89106-3726			
163	13929802012	TRUSTEE CLARK COUNTY TREASURER	%RUGGLES JACK D	2754 S HIGHLAND #F	LAS VEGAS NV 89109-1079		
164	13929811011	TSCHETTER DAN G	2115 BENTON	GRANITE CITY IL 62040-3327			
165	13929811090	TSCHETTER DANIEL G	2115 BENTON	GRANITE CITY IL 62040-3327			
166	13929811030	TYMCHYSHYN DEANNA L	RR #1	ANDREW AB	CANADA T0B 0C0 00000-0000		
167	13928401001	U-HAUL REAL ESTATE COMPANY	P O BOX 29046	PHOENIX AZ 85038- 9046			
168	13928410046	UMANA FELICIANA & RAUL G	34 AMBER CIR	LAS VEGAS NV 89106-3710			

CASE# SDR-49181

	PARCEL#	OWNER	ADDRESS1	ADDRESS2	ADDRESS3	ADDRESS4	ADDRESS5
169	13929714068	VELASCO-FLOWERS G SEP PPTY TR	VELASCO- FLOWERS GAZEL TRS	20608 VANDALE DR	LAKEWOOD CA 90715-1142		
170	13928410114	VILLALPANDO JUAN & MARIA T	2001 GRANITE AVE	LAS VEGAS NV 89106-3753			
171	13929714013	VILLEGAS JOSE MANUEL	NUNEZ ANGELA M	2111 SLEEPY CT	LAS VEGAS NV 89106-3675		
172	13929811029	WAY JOSEPH L	2221 W BONANZA RD #29	LAS VEGAS NV 89106-4708			
173	13929811089	WHITE LISA DAWN	1912 ST LAWRENCE DR	LAS VEGAS NV 89108-2103			
174	13929811101	WILL MICHAEL A	2221 W BONANZA RD #101	LAS VEGAS NV 89106-4715			
175	13929714047	WOODWARD KATINA A	3206 W GILMORE AVE	NO LAS VEGAS NV 89032-0435			
176	13929714049	ZHENG XIAOBAO MICHAEL	11753 ELIANTO ST	LAS VEGAS NV 89183-5550			
177	13928410020	ZIRCON CIRCLE TRUST	1132 PIAZZA NAVONA	HENDERSON NV 89052-4037			
178	13928410047	ZURITA DIEGO G	35 JADE CIR	LAS VEGAS NV 89106-3748			