

City of Las Vegas  
Office Of The City Clerk  
495 South Main Street, 2<sup>nd</sup> Floor  
Las Vegas, Nevada 89101

PRSRT  
FIRST CLASS MAIL  
U.S. Postage  
**PAID**  
Las Vegas, NV  
Permit No. 1630

**Return Service Requested**  
**Official Notice of Public Hearing**

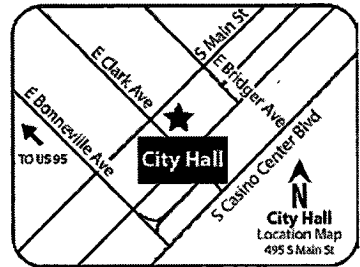

If you wish to file your protest or support on this request, check the appropriate box below and return this card in an envelope with postage to the Office Of The City Clerk at the address listed above or fax this side of this card to (702) 382-4803. If you would like to contact your Council Representative, please call (702) 229-6405.

I SUPPORT this Request       I OPPOSE this Request

Please use available blank space on card for your comments.

**RQR-63634**  
City Council Meeting of **07/20/16**

## Application Information

**RQR-63634 - REQUIRED REVIEW - PUBLIC HEARING - APPLICANT: LAMAR OUTDOOR ADVERTISING, LLC - OWNER: AMBER INVESTMENT COMPANY** - For possible action on a Required Review of an approved Special Use Permit (U-0052-95) WHICH ALLOWED A 40-FOOT TALL, 14-FOOT X 48-FOOT OFF-PREMISE SIGN at 336 West Sahara Avenue (APN 162-04-807-002), C-1 (Limited Commercial) Zone, Ward 3 (Coffin).

## Application Location

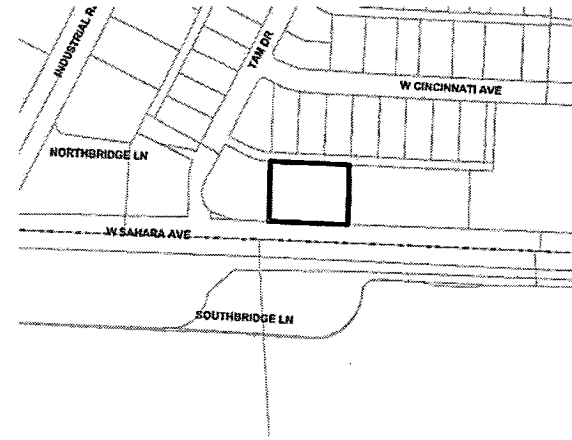

The proposed project may not pertain to the entire highlighted project site.

## Public Hearing Information

**Meeting:** City Council  
**Date:** *July 20, 2016*  
**Time:** 1:00 P.M.  
**Location:** City Council Chambers  
495 South Main Street, 2<sup>nd</sup> Floor  
Las Vegas, Nevada

Any and all interested persons may appear and be heard at said meeting, or may, prior thereto, file written objections thereto or approvals thereof with the City Clerk, 2<sup>nd</sup> Floor, City Hall, 495 South Main Street, Las Vegas, Nevada, 89101. For further information, please call (702) 229-6311 (TTY 7-1-1). **Note that postcards and comments received after an agenda posts will not be reflected online until after the meeting; however, the comments are made available to the members of the governing body for their consideration prior to the meeting.**

**Report of All Selected Parcels****Case Number:**

RQR-63634

**Printed On:** Thu: June 16, 2016

<u>Owner</u>	<u>Address</u>	<u>Parcel Number</u>
2201 L L C	2830 ELK CANYON CT LAS VEGAS NV 89117-2982	16204803009
2201 L L C	2830 ELK CANYON CT LAS VEGAS NV 89117-2982	16204803008
A G O PROPERTY HOLDINGS CORP	13 SEACLIFF COTO DE CAZA CA 92679-4814	16204815184
A M A REALTY L L C	10070 FRAGILE FIELDS ST LAS VEGAS NV 89183	16204813038
ALDANI SOUTH FLORIDA CORPORATION	%A VILLEGOS 901 BRICKELL KEY BLVD #806 MIAMI FL 33131-3734	16204815267
ALLADEEN SAL & ROBIN MARIE	54-30 65TH PLACE MASPETH NY 11378	16204815355
ALLGEIER MICHAEL C & THIDARAT	4664 MARBLEHEAD BAY DR OCEANSIDE CA 92057-4271	16204815316
ALLU 1903 CORPORATION	400 CAMERON STATION BLVD #328 ALEXANDRIA VA 22304-8229	16204815178
ALLURE 1406 L L C	1027 S RAINBOW BLVD #333 LAS VEGAS NV 89145	16204815121
ALLURE 1806 L L C	%D DICELLO 6120 EGAN CREST DR LAS VEGAS NV 89149-1253	16204815169
ALLURE HOMEOWNERS ASSN INC	8290 ARVILLE ST LAS VEGAS NV 89139	16204815067
ALLURE HOMEOWNERS ASSOCIATION IN	8290 ARVILLE ST LAS VEGAS NV 89139	16204815199
AMBER INVESTMENT COMPANY	132 9TH ST #200 OAKLAND CA 94607-4727	16204807002
ANSTETT BARRY T	BUFALINI SANDRA 9432 STONEYBROCK PL RAMCHO CUCAMONGA CA 91730-7970	16204815172
ANTHONY DENNIS J & ANTONIETTA S	21 RUTGERS ST WEST ORANGE NJ 07052	16204815149
ASHKINAZI ARTHUR LIVING TRUST	ASHKINAZI ARTHUR TRS 29482 MALIBU VIEW CT AGOURA CA 91301	16204815287
ASHKINAZI ARTUR	6736 VAN NUYS BLVD VAN NUYS CA 91405	16204815278
AYDIN SAHIN M & CHRISTINE I	2754 BROOKHILL AVE LA CRESCENTA CA 91214-2103	16204815366
AYKENS TRUST	ARPEGGIO HOLDINGS P T C LTD TRS %B MORSE 715 S 6TH ST LAS VEGAS NV 89101	16204815144
AYKENS TRUST	ARPEGGIO HOLDINGS P T C LTD TRS %B MORSE 715 S 6TH ST LAS VEGAS NV 89101	16204815032
AYKENS TRUST	ARPEGGIO HOLDINGS P T C LTD TRS %B MORSE 715 S 6TH ST LAS VEGAS NV 89101	16204815168
AYKENS TRUST	ARPEGGIO HOLDINGS LTD TRS %B MORSE 715 S 6TH ST LAS VEGAS NV 89101	16204815179
AYKENS TRUST	ARPEGGIO HOLDINGS P T C LTD TRS %B MORSE 715 S 6TH ST LAS VEGAS NV 89101	16204815071
AYKENS TRUST	ARPEGGIO HOLDINGS P T C LTD TRS %B MORSE 715 S 6TH ST LAS VEGAS NV 89101	16204815060
AYKENS TRUST	ARPEGGIO HOLDINGS P T C LTD TRS %B MORSE 715 S 6TH ST LAS VEGAS NV 89101	16204815132
B A C MANAGEMENT L L C	4070 THREE PENNY CT DE PERE WI 54115	16204815098
B E L L L C	2929 PLEASANT LAKE DR LAS VEGAS NV 89117	16204803007
BABY ORANGE L L C	3315 S DANIEL CT BLOOMINGTON IN 47401-7114	16204815035
BABY RED L L C	3315 S DANIEL CT BLOOMINGTON IN 47401-7114	16204815238
BABY YELLOW L L C	3315 S DANIEL CT BLOOMINGTON IN 47401-7114	16204815239
BALTIMORE GARDEMS LTD PTNRSHP	14125 CLAYTON RD CHESTERFIELD MO 63017-8355	16204810005
BALTIMORE GARDEMS LTD PTNRSHP	14125 CLAYTON RD CHESTERFIELD MO 63017-8355	16204810004

**Report of All Selected Parcels****Case Number:**

RQR-63634

**Printed On:** Thu: June 16, 2016

<u>Owner</u>	<u>Address</u>	<u>Parcel Number</u>
BALTIMORE GARDEMS LTD PTNRSHP	14125 CLAYTON RD CHESTERFIELD MO 63017-8355	16204810002
BALTIMORE GARDEMS LTD PTNRSHP	14125 CLAYTON RD CHESTERFIELD MO 63017-8355	16204810008
BALTIMORE GARDEMS LTD PTNRSHP	14125 CLAYTON RD CHESTERFIELD MO 63017-8355	16204810001
BALTIMORE GARDEMS LTD PTNRSHP	14125 CLAYTON RD CHESTERFIELD MO 63017-8355	16204810006
BALTIMORE GARDEMS LTD PTNRSHP	14125 CLAYTON RD CHESTERFIELD MO 63017-8355	16204810003
BALTIMORE GARDEMS LTD PTNRSHP	14125 CLAYTON RD CHESTERFIELD MO 63017-8355	16204810007
BALTIMORE GARDENS L P	14125 CLAYTON RD CHESTERFIELD MO 63017-8355	16204806001
BANKS VERLON & SUE	4236 HWY 15 WHITESBURG KY 41858-8576	16204815045
BARAL-REISINGER FAMILY TRUST ETA	REISINGER SUSAN A TRS 2304 CEDARDALE PL LAS VEGAS NV 89134-6719	16204815332
BARRACO JOSEPH A LIVING TRUST	PALUHA JAROSLAW LIVING TRUST 200 W SAHARA AVE #4003 LAS VEGAS NV 89102-5096	16204815425
BAUMOHL NICOLA	1700 RIVER BIRCH ST LAS VEGAS NV 89117	16204815089
BAY STATE REALTY L L C	6 GLEN DR LYNNFIELD MA 01940	16204815327
BECKMAN ROBERT	200 W SAHARA AVE #1701 LAS VEGAS NV 89102-5052	16204815152
BEMA L L C	935 MIDDLE NECK RD GREAT NECK NY 11024-1460	16204815136
BEMA L L C	935 MIDDLE NECK RD GREAT NECK NY 11024-1460	16204815112
BEMA L L C	935 MIDDLE NECK RD GREAT NECK NY 11024-1460	16204815124
BENEDICT SHELLEY	7797 N FIRST ST #118 FRESNO CA 93720	16204815367
BENEDICT SHELLEY R LIVING TRUST	BENEDICT SHIRLEY R TRS 7797 N FIRST ST #118 FRESNO CA 93720	16204815236
BLOCK DAVID J	SCHNABEL MARTIN B 1040 NE 96TH ST MIAMI SHORES FL 33138-2552	16204815040
BOERSMA JELLE PIETER	CHANG CHIA YU 200 W SAHARA AVE #3808 LAS VEGAS NV 89102-5094	16204815410
BORNSTEIN JAIME EFTER	4241 JUTLAND DR #212 SAN DIEGO CA 92117-3654	16204815069
BOSS L L C	%B JOHAR 200 W SAHARA AVE #2708 LAS VEGAS NV 89102-5083	16204815384
BOUET GARY R	MEAD JASON T 150 BERNERI DR LAS VEGAS NV 89138	16204815357
BOZZA-REILLY GINA	REILLY KENNETH SR 8879 MIA MOORE AVE LAS VEGAS NV 89147	16204815061
BRAUDIS RAYMOND E	322 KAREN AVE #1106 LAS VEGAS NV 89109	16204815074
BRAUER ADAM	119 ROCKLAND CENTER #90 NANUET NY 10954-2956	16204815076
BREAUX CHARLES & ARLENE	200 W SAHARA AVE #2712 LAS VEGAS NV 89102-5083	16204815282
C J P A L L L C	9015 WESTWIND RD LAS VEGAS NV 89139	16204815353
C N A ROYAL TRUST	TORKAN ROYA TRS 626 N RODEO DR BEVERLY HILLS CA 90210-3208	16204815102
C P P IMAGE SYSTEMS L L C	6975 WYNDHAM HILL DR RIVERSIDE CA 92506-7503	16204815016
CABRAL MARIO LUIS PEDROSA	ROSA VANESSA DE OLIVEIRA 200 W SAHARA AVE #205 LAS VEGAS NV 89102-5074	16204815005
CALDERON VLADIMIR	YU KERVIN 4903 FITZPATRICK WY NORCROSS GA 30092-1040	16204815077

**Report of All Selected Parcels****Case Number:**

RQR-63634

**Printed On:** Thu: June 16, 2016

<u>Owner</u>	<u>Address</u>	<u>Parcel Number</u>
CALLOWAY CRAIG I	200 W SAHARA AVE #3210 LAS VEGAS NV 89102-5088	16204815340
CAO ZHUO	8335 W FLAMINGO RD LAS VEGAS NV 89147	16204815020
CARLTON SHIRLEY L & GREG S	926 N SKY MEADOWS PL WALNUT CA 91789-1200	16204815092
CARR MICHAEL & SHERRYL	200 W SAHARA AVE #1703 LAS VEGAS NV 89102-5052	16204815154
CASEY PAUL	1501 CHAMBOLLE CT LAS VEGAS NV 89144-1137	16204815301
CASTRO DANIEL	10453 HOLMAN AVE LOS ANGELES CA 90024-6012	16204815399
CESAMA INC	12981 ODYSSEY LAKE WAY ORLANDO FL 32826-4639	16204815120
CEVALLOS HENRY TRUST	200 W SAHARA AVE #2608 LAS VEGAS NV 89102-5082	16204815266
CHACKO KALAYIL M & L REV FAM TR	CHACKO KALAYIL M & LEELAMMA TRS 19 SANTA CATALINA DRRANCHO PALO VERDES CA 90275-6608	16204815361
CHAMBERLAIN DAVID T & LINDA L	P O BOX 473 SURFSIDE CA 90743	16204811032
CHAMBERLAIN DAVID T & LINDA L	P O BOX 473 SURFSIDE CA 90743	16204811033
CHANG DONG LIANG & JUNG REV TR	CHANG DONG LIANG & JUNG CHEN TRS 1342 OAKWOOD DR ARCADIA CA 91006-2412	16204815344
CHANG IK HOON & SOON HEE	1722 CHANTILLY LN FULLERTON CA 92833	16204815401
CHAO JANET J ETAL	CHAO TILY HO 1027 S RAINBOW BLVD #333 LAS VEGAS NV 89145	16204815294
CHAO KWANG LEE & LUCIA YIHSIANG	200 W SAHARA AVE #3805 LAS VEGAS NV 89102	16204815407
CHAPMAN RICKY	2021 GROUSE ST LAS VEGAS NV 89134-6125	16204815253
CHATEAU INVESTMENTS L L C	512 MCCLURG CT #4709 CHICAGO IL 60611-4126	16204815085
CHEN CHAOLI	200 W SAHARA AVE #3608 LAS VEGAS NV 89102-5092	16204815386
CHEN DAVID T & DEBBIE L	2525 NW 141ST PL PORTLAND OR 97229	16204815044
CHEN KATY	200 W SAHARA AVE #2910 LAS VEGAS NV 89102	16204815004
CHEN KATY	200 W SAHARA AVE #2910 LAS VEGAS NV 89102-5085	16204815304
CHEN SHU HWA TRUST	SHEN CHU HWA TRS 3427 PALO VISTA DRRANCHO PALOS V ERDES CA 90275-6158	16204815299
CHEN SHU HWA TRUST	CHEN SHU HWA TRS 2429 ONEIDA ST #1 PASADENA CA 91107	16204815298
CHENG CHRISTOPHER	CHENG IVY & CHIEH-SAN 1731 HOLT AVE LOS ALTOS CA 94024-6925	16204815409
CHENG CHRISTOPHER	CHENG IVY & CHIEH-SAN 1731 HOLT AVE LOS ALTOS CA 94024-6925	16204815319
CHENNAREDDY VENKAREDDY & S	200 W SAHARA AVE #202 LAS VEGAS NV 89102-5074	16204815002
CHIN BRAD	848 HILLPOINT CT SAN JOSE CA 95120	16204813037
CHOO YOUNG WOOK & CHA HEE	823 W JADE WAY ANAHEIM CA 92805	16204813023
CHOU HUNG-LUNG	20265 VALLEY BLVD #0 WALNUT CA 91789-2654	16204815173
CIRCUS CIRCUS CASINOS INC	880 GRIER DR LAS VEGAS NV 89119	16209501001
CITY OF LAS VEGAS	333 N RANCHO DR 8TH FL LAS VEGAS NV 89106-3703	16204808001

**Report of All Selected Parcels****Case Number:**

RQR-63634

**Printed On:** Thu: June 16, 2016

<u>Owner</u>	<u>Address</u>	<u>Parcel Number</u>
CLEVELAND VALLEY L L C	4262 BLUE DIAMOND RD #102-391 LAS VEGAS NV 89139	16204813027
CLEVELAND VEGAS L L C	11952 WILSHIRE BLVD LOS ANGELES CA 90025-6608	16204813025
COLLINS PATRICK	200 W SAHARA AVE #708 LAS VEGAS NV 89102	16204815051
CORCHUELO MANUEL	224 W CINCINNATI AVE LAS VEGAS NV 89102-5009	16204813042
CORRIGAN ROGER & LOIS	1611 HILTON AVE FAIRBANKS AK 99701	16204815007
COVAL SANDRA L	200 W SAHARA AVE #1212 LAS VEGAS NV 89102-5070	16204815115
COX JAMES A	200 W SAHARA AVE #2301 LAS VEGAS NV 89102	16204815225
COX JAMES A	200 W SAHARA AVE #2301 LAS VEGAS NV 89102	16204815224
CRAWFORD JONATHAN	200 W SAHARA AVE #3612 LAS VEGAS NV 89102-5092	16204815390
CRICHLow DONALD & TRACY	678 W MENDOCINO ST ALTADENA CA 91001	16204811009
CRITELLI FAMILY TRUST	CRITELLI ANTHONY D & JEANNIE TRS 200 W SAHARA AVE #1504 LAS VEGAS NV 89102-5058	16204815131
D L W REVOCABLE TRUST	SWAIN SCOTT A TRS 848 N RAINBOW BLVD #5222 LAS VEGAS NV 89107	16204815402
D L W REVOCABLE TRUST	SWAIN SCOTT A TRS 848 N RAINBOW BLVD #5222 LAS VEGAS NV 89107	16204815391
DAHABURA ALBERTO EMILIO SALOME	200 W SAHARA #2104 LAS VEGAS NV 89102	16204815227
DANZI CAPITAL GROUP L L C	848 N RAINBOW BLVD #3045 LAS VEGAS NV 89107	16204815015
DANZI MICHAEL R	848 N RAINBOW BLVD #3045 LAS VEGAS NV 89107-1103	16204815206
DANZI MICHAEL R	848 N RAINBOW BLVD #3045 LAS VEGAS NV 89107-1103	16204815359
DANZI MIKE	848 N RAINBOW BLVD #3045 LAS VEGAS NV 89107-1103	16204815096
DEFINA MICHAEL J	200 W SAHARA AVE #2411 LAS VEGAS NV 89102-5080	16204815246
DELROSARIO DOMINGO & NOIDA	10848 CANARYWOOD CT SAN DIEGO CA 92131-2641	16204815255
DEMIRJIAN HAROUTYOUN & HASMIK Y	3612 LINDA VISTA GLENDALE CA 91206-1410	16204815214
DENAULT JOHN B TRUST	500 LINDEN AVE SOUTH SAN FRANCISCO CA 94066	16204803006
DEWICK GLENN LIVING TRUST	DEWICK GLENN TRS %DUNHAM TR CO 241 RIDGE ST #100 RENO NV 89501	16204815328
DINIZ RAPHAEL & JANET	4525 DEAN MARTIN DR #3206 LAS VEGAS NV 89103-8122	16204815151
DINIZ RAPHAEL A & JANET S	200 W SAHARA AVE #3512 LAS VEGAS NV 89117	16204815378
DUFRESNE D & D FAMILY TRUST	DUFRESNE GERARD A & DAUNE W TRS 1506 PACIFIC COAST HWY HUNTINGTON BEACH CA 92648-4407	16204815379
DUNN WALLACE E	561 W DIVERSEY #215 CHICAGO IL 60614-1682	16204815111
DZUNG HO VIET	200 W SAHARA AVE #1008 LAS VEGAS NV 89102-5070	16204815087
EDSCHIT TRUST	8880 W SUNSET RD #250 LAS VEGAS NV 89148-5006	16204811047
EMERY JAMES M REVOCABLE TRUST	EMERY JAMES M TRS 200 W SAHARA AVE #3208 LAS VEGAS NV 89102-5088	16204815338
ENGLERT BRAD & ROBYN	2935 S HIGHLAND DR LAS VEGAS NV 89109-1011	16204406006

**Report of All Selected Parcels****Case Number:**

RQR-63634

**Printed On:** Thu: June 16, 2016

<u>Owner</u>	<u>Address</u>	<u>Parcel Number</u>
EPSTEIN JASON	MICHALOVSKY EVAN 118 LEE AVE ROCKVILLE CENTRE NY 11570	16204815047
ERISMAN PORTER LIVING TRUST	3651 LINDELL RD #D160 LAS VEGAS NV 89103-1254	16204815400
F A M GLOBAL PROPERTIES & INVEST	130 N SAGE SPARROW CIR SPRING TX 77389-4887	16204815187
FAILLOUX EDWIGE	112 OCEAN HARBOR LN LAS VEGAS NV 89148	16204815161
FAIR PATRICIA L REVOCABLE LIVING	FAIR PATRICIA L TRS 200 W SAHARA AVE #601 LAS VEGAS NV 89102-5098	16204815036
FALLARINO DAVID	LAFERLA JOSEPH A JR TRS 315 W 33RD ST #32F NEW YORK NY 10001-2795	16204815345
FAN CHINLI	YU HONG 3484 WESTWOOD DR SALT LAKE CITY UT 84109-3239	16204815100
FAN CHINLI	YU HONG 3484 WESTWOOD DR SALT LAKE CITY UT 84109-3239	16204815333
FAT JEAN MARC MOO	GREIG CORINE 9015 WESTWIND RD LAS VEGAS NV 89139	16204815083
FECHSER T J SEPARATE PROPERTY TR	FECHSER T J TRS 3605 S TOWN CENTER DR #A LAS VEGAS NV 89135	16204815237
FEDERAL NATIONAL MORTGAGE ASSOCI	135 N LOS ROBLES AVE PASADENA CA 91101	16204815190
FEDERAL NATIONAL MORTGAGE ASSOCI	%GREEN TREE SRVCING LLC 7360 S KYRENE RD MAIL STOP T111 TEMPE AZ 85283	16204815027
FEDERAL NATIONAL MORTGAGE ASSOCI	%DITECH FIN LLC 7360 S KYRENE RD MAIL STOP T111 TEMPE AZ 85283	16204815021
FELISE LINO A	WOODWARD & JAMES W 200 W SAHARA #2612 LAS VEGAS NV 89102-5098	16204815034
FENTISOV LIVING TRUST	FENTISOV VIACHESLAV & ELENA TRS 200 W SAHARA AVE #4002 LAS VEGAS NV 89102-5096	16204815424
FERTIG ELIZABETH	200 W SAHARA AVE #2011 LAS VEGAS NV 89102-5076	16204815198
FINCH WILLIAM HUNTER	HUNTSMAN NORI 2892 ROXBOROUGH CT WEST VALLEY CITY UT 84119-5970	16204815123
FINK ROBERT J	ELLIS EDYE M 20 W 451 ARMY TRAIL RD ADDISON IL 60101	16204815081
FLEMING KENNETH E & JOY C LIV TR	FLEMING JOY C TRS 7850 WILLIAMSON VALLEY RD PRESCOTT AZ 86305	16204406009
FONE RIO L L C	23881 VIA FABRICANTE #501 MISSION VIEJO CA 92691-3139	16204815288
FONFA FAMILY 2011 TRUST	FONFA ANDREW & JODI TRS 200 W SAHARA AVE #4001 LAS VEGAS NV 89102	16204815368
FONFA FAMILY 2011 TRUST	FONFA ANDREW & JODI TRS 200 W SAHARA AVE #4001 LAS VEGAS NV 89102	16204815423
FREDERICKS REVOCABLE TRUST	FREDERICKS DENNIS E & SHARON TRS 116 JAMIE CT LOS GATOS CA 95032-5128	16204815334
G CAPITAL INVESTMENT L L C	4921 SUNDOWNER CT RANCHO CUCAMONGA CA 91737-6738	16204815428
GAMBOA VIVIAN L	218 W CLEVELAND AVE LAS VEGAS NV 89102	16204813029
GE HONGMING	22538 BIRDS EYE DR DIAMOND BAR CA 91765-2407	16204815284
GE HONGMING	DENG FEI 22538 BIRDS EYE DR DIAMOND BAR CA 91765-2407	16204815269
GILES DAVID C & ROBERTA SUE	200 W SAHARA AVE #2001 LAS VEGAS NV 89102	16204815221
GILES DAVID C & ROBERTA SUE	200 W SAHARA AVE #2001 LAS VEGAS NV 89102-5076	16204815188
GLENN MICHAEL	200 W SAHARA AVE #1502 LAS VEGAS NV 89102-5058	16204815129
GORELICK JEFF	1888 LAUREL RIDGE DR RENO NV 89523-3889	16204815414
GRAINGER W W INC	410 17TH ST #1175 DENVER CO 80202-4439	16204406010

**Report of All Selected Parcels****Case Number:**

RQR-63634

**Printed On:** Thu: June 16, 2016

<u>Owner</u>	<u>Address</u>	<u>Parcel Numbe</u>
GRAVES PHILIP E	1360 WALNUT ST #307 BOULDER CO 80302-5189	16204815054
GREEN CAPITAL DEVELOPMENT L L C	4921 SUNDOWNER CT RANCHO CUCAMONGA CA 91737	16204815056
GUPTA HEM C & KRISHNA	160 E SHELBOURNE AVE LAS VEGAS NV 89123-2150	16204811007
GUPTA HEM C & KRISHNA	160 E SHELBOURNE AVE LAS VEGAS NV 89123-2150	16204811008
H L J F L L C	9015 WESTWIND RD LAS VEGAS NV 89139	16204815300
HABBAS I I TRUST	HABBAS ISAM I TRS 11441 ALERTON PARK DR #214 LAS VEGAS NV 89135-3375	16204815155
HABEEB KHALIL	39 BRET HARTE RD SAN RAFAEL CA 94901	16204815006
HACIENDA LAS VEGAS L L C	2005 B POTOMAC DR HOUSTON TX 77057-2923	16204815245
HAMMER DICE & JOANN P	P O BOX 314 GREENWOOD VA 22943-0314	16204815427
HANG CHU L L C	722 N ROYAL CREST CIR #51 LAS VEGAS NV 89169-3851	16204811050
HANG CHU L L C	722 N ROYAL CREST CIR #51 LAS VEGAS NV 89169-3851	16204811048
HANG CHU L L C	722 N ROYAL CREST CIR #51 LAS VEGAS NV 89169-3851	16204811049
HENDERSON ROBERT & CATHERINE	200 W SAHARA AVE #710 LAS VEGAS NV 89102	16204815053
HIBBERD LARRY & DARLENE	8100 CREEK VIEW CT ARGYLE TX 76226	16204815274
HILTON RESORTS CORPORATION	6355 METRO WEST BLVD #180 ORLANDO FL 32835	16209613001
HO ALANA W & JOHN YIH-SHENG	3 DOUGLAS GROVE RD HENDERSON NV 89052-6704	16204815003
HO JOHN Y & ALANA W	3 DOUGLAS GROVE RD HENDERSON NV 89052-6704	16204815026
HORODESKY GREGORY & DAREL	304 LA CANTERA CT LAS VEGAS NV 89144-1532	16204815310
HUANG YINGSHU	%Y ZEN 5582 TABLE TOP LN LAS VEGAS NV 89135	16204815223
HUGHBANKS PROPERTIES II L L C	901 BAILEY DR PAPILLION NE 68046-7027	16204815343
HUGHBANKS PROPERTIES III L L C	901 BAILEY DR PAPILLION NE 68046-7027	16204815323
HUGHBANKS PROPERTIES IV L L C	901 BAILEY DR PAPILLION NE 68046	16204815165
HUGHBANKS PROPERTIES V L L C	901 BAILEY DR PAPELLION NE 68046	16204815290
HUGHBANKS PROPERTIES VI L L C	901 BAILEY DR PAPILLION NE 68046	16204815325
HUGHBANKS PROPERTIES VII L L C	901 BAILEY DR PAPILLION NE 68046	16204815369
HUGHBANKS PROPERTIES VIII L L C	901 BAILEY DR PAPILLION NE 68046	16204815303
HUGHBANKS PROPERTIES XII L L C	901 BAILEY DR PAPILLION NE 68046	16204815371
HUGHBANKS PROPERTIES XIV L L C	901 BAILEY DR PAPILLEON NE 68046	16204815324
HUGHBANKS PROPERTIES XIX L L C	901 BAILEY DR PAPILLION NE 68046	16204815349
HUGHBANKS PROPERTIES XVIII L L C	901 BAILEY DR PAPILLION NE 68046	16204815313
HUGHBANKS PROPERTIES XX L L C	901 BAILEY DR PAPILLION NE 68046	16204815350
HUGHBANKS PROPERTIES XXI L L C	901 BAILEY DR PAPILLION NE 68046	16204815397

**Report of All Selected Parcels****Case Number:**

RQR-63634

**Printed On:** Thu: June 16, 2016

<u>Owner</u>	<u>Address</u>	<u>Parcel Number</u>
HUGHBANKS SCOTT A	901 BAILEY DR PAPILLION NE 68046-7027	16204815075
HURLBUT ROY E	BAKER CHRISTINE E 14128 NE 63RD CT REDMOND WA 98052-4657	16204815210
HWANG NANCY C REVOCABLE TRUST	HWANG NANCY C TRS 12851 GABLES GREEN WY CATHARPIN VA 20143-2403	16204815281
I B I AMERICA	324 W CINCINNATI AVE #3 LAS VEGAS NV 89102-5066	16204811029
I B I AMERICA	324 W CINCINNATI AVE #3 LAS VEGAS NV 89102-5066	16204811018
I B I AMERICA	324 W CINCINNATI AVE #3 LAS VEGAS NV 89102-5066	16204811019
I B I AMERICA	324 W CINCINNATI AVE #3 LAS VEGAS NV 89102-5066	16204811023
I B I AMERICA	324 W CINCINNATI AVE #3 LAS VEGAS NV 89102-5066	16204811022
I B I AMERICA	324 W CINCINNATI AVE #3 LAS VEGAS NV 89102-5066	16204811020
I B I AMERICA	324 W CINCINNATI AVE #3 LAS VEGAS NV 89102-5066	16204811030
I B I AMERICA	324 W CINCINNATI AVE #3 LAS VEGAS NV 89102-5066	16204811025
I B I AMERICA	324 W CINCINNATI AVE #3 LAS VEGAS NV 89102-5066	16204811031
I B I AMERICA	324 W CINCINNATI AVE #3 LAS VEGAS NV 89102-5066	16204811021
I B I AMERICA	324 W CINCINNATI AVE #3 LAS VEGAS NV 89102-5066	16204811016
I B I AMERICA	324 W CINCINNATI AVE #3 LAS VEGAS NV 89102-5066	16204811017
I B I AMERICA	324 W CINCINNATI AVE #3 LAS VEGAS NV 89102-5066	16204811024
I S G 401 K PLAN	BATTAGLINI LORIE TRS 99 SE MIZNER BLVD #721 BOCA RATON FL 33432	16204815055
INDUSTRIAL L L C	6450 SPRING MOUNTAIN RD #12 LAS VEGAS NV 89146-8836	16204802006
INDUSTRIAL ROAD 2440-2497 L L C	3172 S BARRINGTON AVE #101 LOS ANGELES CA 90066	16204407001
IP KAM	106 LEE TRAVINO STEPHENVILLE TX 76401-5918	16204815014
J N J J L L C	356 FLINTRIDGE OAKS DR LA CANADA CA 91011	16204815244
J W SIMBA INVESTMENTS L L C	10001 PEACE WY #1192 LAS VEGAS NV 89147-8092	16204815271
J W SIMBA INVESTMENTS L L C	5350 HOLLYMEAD DR LAS VEGAS NV 89135-4021	16204815019
J W SIMBA INVESTMENTS L L C	5350 HOLLYMEAD DR LAS VEGAS NV 89135-4021	16204815080
J W SIMBA INVESTMENTS L L C	5350 HOLLYMEAD DR LAS VEGAS NV 89135-4021	16204815363
JACKSON LYNDON D	321 DVORAK CT STOUGHTON WI 53589	16204815126
JACOBS CRAIG	11174 COCO LN LAS VEGAS NV 89141	16204815024
JANEWAY L L C	2885 MANN ST LAS VEGAS NV 89146	16204406008
JANEWAY L L C	2885 MANN ST LAS VEGAS NV 89146-5230	16204406007
JARAMILLO HUMBERTO L	5571 N W 74TH AVE MIAMI FL 33166-4200	16204815291
JARANILLA JAWALI	11616 PROSPECT CURVE WOODBURY MN 55129-7783	16204815326
JESCO LIGHTING GROUP L L C	15 HARBOR PARK DR PORT WASHINGTON NY 11050	16204815311

**Report of All Selected Parcels****Case Number:**

RQR-63634

**Printed On:** Thu: June 16, 2016

<u>Owner</u>	<u>Address</u>	<u>Parcel Number</u>
JEWELER'S 401K PFT SHR PL & TR	2400 WESTERN AVE LAS VEGAS NV 89102-4816	16204406011
JOHNCYN IRR BUSINESS TRUST	WISE MICHELE TRS 6325 S JONES BLVD #500 LAS VEGAS NV 89118	16204813022
JOHNSON STEVEN P	33393 WARWICK HILLS RD YUCAIPA CA 92399	16204815108
JORDAN GARY & KIMBERLY	26742 CALLE ULTIMA CAPISTRANO BEACH CA 92624	16204815030
JOYNER-TUCKER A M SEP PPTY TR	JOYNER-TUCKER ARLENE M TRS 200 W SAHARA AVE #3408 LAS VEGAS NV 89102-5090	16204815362
K A S LIMITED PARTNERSHIP	628 GLORIETTA BLVD CORONADO CA 92118	16204815097
K J T INVESTMENTS L L C	2282 WIND RIVER LN ROWLAND HEIGHTS CA 91748-5025	16204815283
K J T INVESTMENTS L L C	2282 WIND RIVER LN ROWLAND HEIGHTS CA 91748-5025	16204815314
K J T INVESTMENTS L L C	2282 WIND RIVER LN ROWLAND HEIGHTS CA 91748-5025	16204815307
K J T INVESTMENTS L L C	2282 WIND RIVER LN ROWLAND HEIGHTS CA 91748-5025	16204815394
KAMPH REVOCABLE LIVING TRUST	KAMPH BRADLEY J & KELLI K CO-TRS 200 W SAHARA AVE #608 LAS VEGAS NV 89102-5099	16204815043
KANDHOROV ABRAM & ROZA	ONE BAY CLUB DR #21D BAYSIDE NY 11360-2913	16204815222
KANDHOROV IRINA & SIMHA	KANDHOROV ABRAM & ROZA 2 BAYCLUB DR #206 BAYSIDE NY 11360-2957	16204815113
KAWAGUCHI MICHAEL	CHANG HENRY 200 W SAHARA AVE #2605 LAS VEGAS NV 89102-5082	16204815263
KAWASE ERIC	1846 RAMBLING RD SIMI VALLEY CA 93065	16204815103
KIM CHANG S	1924 BROOKE LN FULLERTON CA 92833-1219	16204815305
KLASS KATHIE	ROLLINS BONNIE 5501 N 10TH ST ARLINGTON VA 22205-2416	16204815012
KNIGHT MICHAEL	200 W SAHARA AVE #602 LAS VEGAS NV 89102-5098	16204815037
KNOTTS MELTON E JR	BROWN MARK 39 HARVEST WIND PL THE WOODLANDS TX 77382-3602	16204815128
KOCHAR TAMANA	527 CARMINE AVE SOUTH PLAINFIELD NJ 07080	16204815101
KOHLMEIER DAVID	2988 SUN LAKE DR LAS VEGAS NV 89128	16204815033
KOZIK P FRANK & EDNA M	P O BOX 4365 R R #4 MOSCOW PA 18444-9398	16204815122
KRILOVS FILIPS	200 W SAHARA AVE #3603 LAS VEGAS NV 89102-5092	16204815381
KRISHNA DODDANNA	44215 15TH ST W #211 LANCASTER CA 93534	16204815066
KRISTINE TAYLOR PHILANTHROPIES	18301 VON KARMAN AVE #430 IRVINE CA 92612	16204815380
KRUPNICK STEVEN L	200 W SAHARA AVE #3411 LAS VEGAS NV 89102-5090	16204815365
KURUCZ NORBERT	31505 LINDERO CANYON RD #10 WESTLAKE VILLAGE CA 91361-4732	16204815285
KURZ KAREN	200 W SAHARA AVE #302 LAS VEGAS NV 89102-5097	16204815011
KWANG WAN-TSING	13510 QUEEN JOHANNA CT CORPUS CHRISTI TX 78418	16204815039
L B SAHARA INC	%D BEES 200 W SAHARA AVE #3803 LAS VEGAS NV 89102-5094	16204815405
L B SAHARA INC	%D BEES 200 W SAHARA AVE #3804 LAS VEGAS NV 89102-5094	16204815406
L H S SAHARA PROPERTY L L C	6 CORONADO POINTE LAGUNA NIGUEL CA 92677-5544	16204815331

**Report of All Selected Parcels****Case Number:**

RQR-63634

**Printed On:** Thu: June 16, 2016

<u>Owner</u>	<u>Address</u>	<u>Parcel Number</u>
LANDRON JOAN	8414 MAYPORT DR LAS VEGAS NV 89131-6701	16204815134
LAS #3404 L L C	860 NE 98TH ST MIAMI SHORES FL 33138-2533	16204815358
LAS FAILLOUX L L C	9015 WESTWIND RD LAS VEGAS NV 89139	16204815293
LAU IAN VAN & RUTH YEE CHE	249 WINDSOR DR POINT ROBERTS WA 98281-9313	16204815272
LEE CHI CHIANG	200 HOOVER AVE #806 LAS VEGAS NV 89101-6873	16204815171
LIN JOSEPH C & LILY C	17 LAURELFORD CT COCKEYSVILLE MD 21030-2236	16204815296
LUBRATICH SCOTT	606 JOYA CT DANVILLE CA 94506	16204815261
LUCIANO FAMILY TRUST	LUCIANO RICHARD J & K M TRS 759 REPOSADO DR LA HABRA HEIGHTS CA 90631-7837	16204815010
LUCKY DRAGON L P	3575 W POST RD #1 LAS VEGAS NV 89118	16204816001
LUO XIAO JU	11 E MAGNA VISTA AVE ARCADIA CA 91006-4002	16204815025
LUU NGA	PHAM SOPHIA LUU 104 ARBUSTO CIR SACRAMENTO CA 95831-4554	16204815009
M N R HOLDINGS L L C ALLURE 606	10624 S EASTERN AVE #A792 HENDERSON NV 89052-2982	16204815041
M N R HOLDINGS L L C ALLURE 607	10624 S EASTERN AVE #A-792 HENDERSON NV 89052	16204815042
MA KUEI-FEN	2407 CONOY ST #101 ALEXANDRIA VA 22301	16204815148
MA MARGARET	18543 DEVONSHIRE ST #229 NORTHRIDGE CA 91324-1308	16204815320
MA MINA	935 MIDDLE NECK RD GREAT NECK NY 11024-1460	16204815289
MA MINA	935 MIDDLE NECK RD GREAT NECK NY 11024-1460	16204815205
MACMILLAN BYRON F	P O BOX 46050 LAS VEGAS NV 89114	16204811002
MACMILLAN DOUGLAS JR	MACMILLAN MIRIAM ROSA & BYRON P O BOX 46050 LAS VEGAS NV 89114	16204811003
MAGAR JAMES G	1219 BARNARD DR LAS VEGAS NV 89102-1803	16204811026
MARQUEZ CARLA N TRUST	MARQUEZ CARLA N TRS P O BOX 23065 LOS ANGELES CA 90023	16204811001
MARSHALL FAMILY L P	P O BOX 46470 LAS VEGAS NV 89114-6470	16204802007
MARTIN CAROL F	200 W SAHARA AVE #3003 LAS VEGAS NV 89102-5086	16204815309
MARTINEZ ROCIO	BABIUK JAMES 18061 HAAS RD MOKENA IL 60448-8901	16204815329
MASON SIBLINGS L L C	4193 WOODLEIGH LANE LA CANADA FLINTRIDGE CA 91011	16204813030
MATSUNAGA SUMMER S & ELIZABETH S	26742 NOKOMIS RD RANCHO PALOS VERDES CA 90275	16204815360
MATSUNAGA SUMNER S & ELIZABETH S	26742 NUKOMIS RD RANCHO PALOS VERDES CA 90275	16204815117
MCCAM ALLURE L L C	%E CAMPAGNA 460 S LA FLORESTA DR #118 BREA CA 92823	16204815354
MCCAM ALLURE L L C	%E CAMPAGNA 460 S LA FLORESTA DR #118 BREA CA 92823	16204815342
MCCAM ALLURE L L C	%E CAMPAGNA 460 S LA FLORESTA DR #118 BREA CA 92823	16204815404
MCCAM ALLURE L L C	%E CAMPAGNA 460 S LA FLORESTA DR #118 BREA CA 92823	16204815421
MCCAM ALLURE L L C	%E CAMPAGNA 460 S LA FLORESTA DR #118 BREA CA 92823	16204815392

**Report of All Selected Parcels****Case Number:**

RQR-63634

**Printed On:** Thu: June 16, 2016

<u>Owner</u>	<u>Address</u>	<u>Parcel Number</u>
MCCAM ALLURE L L C	%E CAMPAGNA 460 S LA FLORESTA DR #118 BREA CA 92823	16204815235
MCCAM ALLURE L L C	%E CAMPAGNA 460 S LA FLORESTA DR #118 BREA CA 92823	16204815411
MCCLAY ROBERT	200 W SAHARA AVE #1804 LAS VEGAS NV 89102-5052	16204815167
MCCREA FAMILY TRUST	MCCREA DAN & TERESA I TRS 2700 LAS VEGAS BLVD S #4008 LAS VEGAS NV 89109	16204815219
MCDONALD JAMES & MARGARET REV TR	MCDONALD JAMES JR & MARGARET TRS 44848 N KINGTREE AVE LANCASTER CA 93534-2237	16204815118
MCGOWAN ALEX	200 W SAHARA AVE #2705 LAS VEGAS NV 89102-5083	16204815275
MEEKINS CORINA FAMILY TRUST	MEEKINS CORINA TRS 19135 SINGING WOOD DR ROWLAND HEIGHTS CA 91748-2265	16204815250
MELVID INC	4660 S EASTERN AVE #105 LAS VEGAS NV 89119-6138	16204811036
MENTRO GARY D JR & WENDY DAWN	326 LAKE SHORE RD FRIEDENS PA 15541	16204815063
MESHESKIY LEONID	FELDMAN LARISA 3347 ALGINET DR ENCINO CA 91436-4121	16204815286
MIKBRAN L L C	1960 CARLA RIDGE BEVERLY HILLS CA 90210	16204813024
MINNELLA FAMILY TRUST	INNELLA FRANKLIN D & PENSRI TRS 200 W SAHARA AVE #2908 LAS VEGAS NV 89102	16204815302
MISCH LINDA	4519 ADMIRALTY WAY #D MARINA DEL REY CA 90292	16204811004
MOCK PROTECTION TRUST	MOCK JAMES TRS 200 W SAHARA AVE #2008 LAS VEGAS NV 89102-5076	16204815195
MOHAMMED SHIRLINA	1431 WIRT RD #109 HOUSTON TX 77055-4916	16204815292
MONTAGUE MARILYN R	200 W SAHARA AVE #2604 LAS VEGAS NV 89102-5082	16204815262
MONTCLAIR APTS INC	327 W CINCINNATI ST LAS VEGAS NV 89102-5037	16204811035
MONTCLAIR APTS INC	327 W CINCINNATI ST LAS VEGAS NV 89102-5037	16204811034
MORRIS PROPERTIES L L C	2311 S INDUSTRIAL RD LAS VEGAS NV 89102-4801	16204803010
MUSETTI LAURA T	YANES ADOLFO M P O BOX 7012 COTATI CA 94931-7012	16204815094
NAKAMOTO BRYAN & LAURIE M	2766 MANOA RD HONOLULU HI 96822-7700	16204815145
NEBUCHADNEZZAR INVESTMENTS L L C	3 VALLEY VIEW LN DULUTH MN 55811	16204815146
NEVADA POWER COMPANY	P O BOX 10100 RENO NV 89520	16209104002
NGUYEN CHAFFEE & AMANDA FAM TR	NGUYEN CHAFFEE C & AMANDA TRS 19709 FALCON CIR CERRITOS CA 90703-7714	16204815091
NGUYEN TUAN ANH	200 W SAHARA AVE #3207 LAS VEGAS NV 89102-5088	16204815337
OH YOUNG KHAN	200 W SAHARA AVE #3402 LAS VEGAS NV 89102-5090	16204815356
ORTEGA EVELYN TORRES & ALBERTO	12 GEORGE RUSSELL WY CLIFTON NJ 07013-2600	16204815208
OTTENWELLER MATTHEW & JANET L	1301 WALL ST W #4209 LYNDHURST nj 07071	16204815280
OXFORD TECHNOLOGY	5010 S VALLEY VIEW BLVD LAS VEGAS NV 89118-1705	16204813033
OXFORD TECHNOLOGY INC	5010 S VALLEY VIEW BLVD LAS VEGAS NV 89118-1705	16204813035
OXFORD TECHNOLOGY INC	5010 VALLEY VIEW BLVD #B1 LAS VEGAS NV 89118-1705	16204813050
OXFORD TECHNOLOGY INC	5010 S VALLEY VIEW BLVD LAS VEGAS NV 89118-1705	16204813036

**Report of All Selected Parcels****Case Number:**

RQR-63634

**Printed On:** Thu: June 16, 2016

<u>Owner</u>	<u>Address</u>	<u>Parcel Number</u>
OXFORD TECHNOLOGY INC	5010 S VALLEY VIEW LAS VEGAS NV 89118-1705	16204813044
OXFORD TECHNOLOGY INC	5010 S VALLEY VIEW LAS VEGAS NV 89118-1705	16204813046
OXFORD TECHNOLOGY INC	5010 S VALLEY VIEW BLVD LAS VEGAS NV 89118-1705	16204813048
OXFORD TECHNOLOGY INC	5010 S VALLEY VIEW LAS VEGAS NV 89118-1705	16204813031
OXFORD TECHNOLOGY INC	5010 S VALLEY VIEW BLVD LAS VEGAS NV 89118-1705	16204813034
OXFORD TECHNOLOGY INC	5010 S VALLEY VIEW LAS VEGAS NV 89118-1705	16204813047
OXFORD TECHNOLOGY INC	5010 S VALLEY VIEW BLVD LAS VEGAS NV 89118-1705	16204813049
OXFORD TECHNOLOGY INC	5010 S VALLEY VIEW BLVD LAS VEGAS NV 89118-1705	16204813032
OXFORD TECHNOLOGY INC	5010 S VALLEY VIEW BLVD LAS VEGAS NV 89118-1705	16204813041
OXFORD TECHNOLOGY INC	5010 S VALLEY VIEW LAS VEGAS NV 89118-1705	16204813045
OYAMA KENICHI	3623 JASMINE AVE #108 LOS ANGELES CA 90034	16204815276
P F E VENTURES L L C	3651 LINDELL RD #D160 LAS VEGAS NV 89103-1254	16204815388
P F E VENTURES SUB 3 L L C	3651 LINDELL RD #D160 LAS VEGAS NV 89103-1254	16204815376
PAK MYONG HO & TAI SUN	200 W SAHARA AVE #3002 LAS VEGAS NV 89102	16204815308
PAK MYONG HO & TAI SUN	200 W SAHARA AVE #2005 LAS VEGAS NV 89102	16204815192
PAK MYONG HO & TAI SUN	200 W SAHARA AVE #3906 LAS VEGAS NV 89102	16204815418
PAK TAISUN & MYONGHO	200 W SAHARA AVE #3906 LAS VEGAS NV 89102	16204815038
PALECEK ROGER L	FREDRICKS ELIZABETH A 717 CRESTHAVEN DR COTTAGE GROVE WI 53527-9679	16204815139
PANORA ROBERT ANTHONY	SPENCER SUNIA 55 CLIFTON ST #2 CAMBRIDGE MA 02140-2428	16204815408
PAOLO VICTOR	P O BOX 1535 MILLBROOK NY 12545-1535	16204815104
PAPAGOLOS GUS & KAREN	37635 VIA MAJORCA MURRIETA CA 92562	16204815295
PAZ RICARDO & DALIT	19495 BISCAYNE BLVD #606 AVENTURA FL 33180-2318	16204815185
PEARSON M CURTIS	P O BOX 963 MABLETON GA 30126-0963	16204815127
PHAM JOHNNY Q	6105 OAK MEADOWS CT MIDLAND MI 48640-1973	16204815084
PHILLIPS MARK	916 FINCH AVE HIGH POINT NC 27263	16204815377
PICKERELL BLAIR C & SANDY L	%BLACKBIRD RLTY AND MGT INC P O BOX 60688 LAS VEGAS NV 89160	16204815119
PICKERELL BLAIR C & SANDY L	%BLACKBIRD RLTY AND MGT INC P O BOX 60688 LAS VEGAS NV 89160	16204815107
PICKERELL DAVID A	200 W SAHARA AVE #1006 LAS VEGAS NV 89102	16204815189
PRANGLE MIKE	142 AKENSIDE RD RIVERSIDE IL 60546-1811	16204815162
PRASAD RAJENDRA	200 W SAHARA AVE #810 LAS VEGAS NV 89102	16204815065
PUCKETT TIM	200 W SAHARA AVE #3605 LAS VEGAS NV 89102	16204815383
PULIDO FRANCISCO MACHADO	10305 N W 41ST #215 DORAL FL 33178-2976	16204815073

**Report of All Selected Parcels****Case Number:**

RQR-63634

**Printed On:** Thu: June 16, 2016

<u>Owner</u>	<u>Address</u>	<u>Parcel Numbe</u>
QUIRK/GOODEN FAMILY TRUST ETAL	GOODEN ALETHEIA S TRS 11269 SULPHER MOUNTAIN RD OJAI CA 93023-8316	16204815321
R A M - S P M L L C	8255 S LAS VEGAS BLVD #315 LAS VEGAS NV 89123	16204815174
R A M-S P M L L C	8255 S LAS VEGAS BLVD #315 LAS VEGAS NV 89123	16204815389
R A M-S P M L L C-ALLURE 2510	8255 S LAS VEGAS BLVD #315 LAS VEGAS NV 89123	16204815256
R H N REVOCABLE LIVING TRUST	NGUYEN ROSEMARY TRS 7602 E SANTIAGO CANYON RD ORANGE CA 92869	16204815079
R J L LIMITED PARTNERSHIP	14125 CLAYTON RD CHESTERFIELD MO 63017-8355	16204811005
R J L LIMITED PARTNERSHIP	14125 CLAYTON RD CHESTERFIELD MO 63017-8355	16204811006
RAHMAN UPAL & MASHIUR	%IIM INC 2850 HORIZON RIDGE PKWY #200 HENDERSON NV 89052-4395	16204815109
RAJSUMAN ROCHIT	990 JULIET AVE SAN JOSE CA 95127-3622	16204815317
REAVER LISA M	200 W SAHARA AVE #802 LAS VEGAS NV 89102-5072	16204815057
REDDY SHRUTI	848 N RAINBOW BLVD #1474 LAS VEGAS NV 89107-1103	16204815306
REMPLE ROBERT	P O BOX 2604 BELLINGHAM WA 98227-2604	16204815259
RESTREPO PATRICIA	BEATRIZ GLORIA 3100 NE 48TH ST #805 FT LAUDERDALE FL 33308-4948	16204815095
RIMAN RAMI	ZAGORSKY DANIELLE 2915 W 5TH ST #16C BROOKLYN NY 11224-3913	16204815180
RITTER SHARON D	2004 PLAZA DE SANTA FE LAS VEGAS NV 89102	16204813020
RITTER SHARON D	2004 PLAZA DE SANTA FE LAS VEGAS NV 89102	16204813019
RODGERS JERRY	4209 CAPILLA ST FORT WORTH TX 76133-5421	16204815417
ROOSE DON	7013 ROCKLYN CIR URBANDALE IA 50322-4866	16204815226
ROSAS CHRISTOPHER	200 W SAHARA AVE #3903 LAS VEGAS NV 89102	16204815415
RUMELT DANIEL	KLASS KATHIE 3972 GEORGETOWN CT N W WASHINGTON DC 20007-2127	16204815153
S & F LIMITED PARTNERSHIP	14125 CLAYTON RD CHESTERFIELD MO 63017-8355	16204811015
S & F LIMITED PARTNERSHIP	14125 CLAYTON RD CHESTERLAND MO 63017-8355	16204811012
S & F LIMITED PARTNERSHIP	14125 CLAYTON RD CHESTERFIELD MO 63017-8355	16204811010
S & F LIMITED PARTNERSHIP	14125 CLAYTON RD CHESTERFIELD MO 63017-8355	16204811011
S & F LIMITED PARTNERSHIP	14125 CLAYTON RD CHESTERFIELD MO 63017-8355	16204811013
S & F LIMITED PARTNERSHIP	14125 CLAYTON RD CHESTERFIELD MO 63017-8355	16204811014
S & J REALTY L L C	%H & J LEE 30 CLUB CT ROSLYN HARBOUR NY 11576-1002	16204815252
S & J REALTY L L C	%H & J LEE 30 CLUB CT ROSLYN HARBOUR NY 11576-1002	16204815150
S & J REALTY L L C	%H & J LEE 30 CLUB CT ROSLYN HARBOUR NY 11576-1002	16204815072
SALEH TIMARIO TRUST	SALEH ARYA TRS 2395 BUCKINGHAM LN LOS ANGELES CA 90077-1339	16204815114
SALEH TIMARIO TRUST	SALEH ARYA TRS 2395 BUCKINGHAM LN LOS ANGELES CA 90077-1339	16204815233
SARA MARK INVESTMENT GROUP LP	158 N JUNE ST LOS ANGELES CA 90004-1040	16204813026

**Report of All Selected Parcels****Case Number:**

RQR-63634

**Printed On:** Thu: June 16, 2016

<u>Owner</u>	<u>Address</u>	<u>Parcel Number</u>
SCHIFF MARVIN JAMES TR	SCHIFF MARVIN JAMES TRS 2401 INDUSTRIAL RD LAS VEGAS NV 89102-4817	16204803012
SCHMIDT MANFRED E	OCHOA MARTHA L %A PEREZ 3537 N W 61ST CIR BOCA RATON FL 33496-4002	16204815204
SEPEHRIPOUR MEHRNAZ	16530 VENTURAL BLVD #502 ENCINO CA 91436-5055	16204813043
SHAH CHANDRAKANT N & KIMBERLY	PATEL KANTI S & MANJU K 112 OLDE ASH LN CHARLESTON WV 25311-1700	16204815242
SHARPE STEPHEN R	P O BOX 1164 DOWNEY CA 90240-0164	16204815232
SHEN JIANZHONG	200 W SAHARA AVE #2910 LAS VEGAS NV 89102	16204815159
SHOEN FAMILY L L C	143 S CEDROS AVE #C-201 SOLANA BEACH CA 92075-1999	16204802017
SHYNK JOHN J & TOKIE L	P O BOX 55 SANTA BARBARA CA 93102	16204815243
SIMON PAMELA & JEFFREY	771 VALLEY RD GLENCOE IL 60022-1503	16204815141
SINCLAIR 3507 L L C	P O BOX 93663 LAS VEGAS NV 89193-3663	16204815373
SINCLAIR 3507 L L C	P O BOX 93663 LAS VEGAS NV 89193-3663	16204815336
SINCLAIR 3507 L L C	P O BOX 93663 LAS VEGAS NV 89193-3663	16204815202
SINGH JAIRAM & ROSE-MARIE	200 W SAHARA AVE #1410 LAS VEGAS NV 89102-5058	16204815125
SIZEMORE ARNO H	200 W SAHARA AVE #3604 LAS VEGAS NV 89102	16204815382
SMITH CHRISTOPHER	200 W SAHARA AVE #3908 LAS VEGAS NV 89102-5095	16204815420
SMITH LARRY KIM	7510 APPLGATE DR HELENA MT 59602-8195	16204815022
SNOW EVANGELINA	200 W SAHARA AVE #2202 LAS VEGAS NV 89102	16204815213
SOEPRONO HESRI ERMIN & NITAYA	2215 JOHN MATICH DR COLTON CA 92324-9513	16204815351
SONG HOWARD	86 MAPLETON IRVINE CA 92620	16204815088
SRABERG GERALD & ILENE	P O BOX 512037 LOS ANGELES CA 90051-0037	16204803011
SRABERG GERALD A & ILENE	SCHEELER 1999 REVOCABLE TRUST 400 N BRIDGE LN LAS VEGAS NV 89102-4802	16204803013
STANTON MICHAEL REV TR 2012	LINSK MICHAEL STANTON TRS 5290 OBANNON DR LAS VEGAS NV 89146-3342	16204815052
STANTON MICHAEL REV TR 2012	LINSK MICHAEL STANTON TRS 5290 O'BANNON DR LAS VEGAS NV 89146-3342	16204815339
STARK PATRICK & LISA MARIE	16231 WOODSTOCK LN HUNTINGTON BEACH CA 92647-3235	16204815116
STATE OF NEVADA TRANS LEASOR	USA MARSHALS SERVICE LEASEE 333 LAS VEGAS BLVD #2058 LAS VEGAS NV 89101	16204407002
STATE OF NEVADA TRANS LEASOR	USA MARSHALS SERVICE LEASEE 333 LAS VEGAS BLVD #2058 LAS VEGAS NV 89101	16209104001
STEPHENS GARY	SAFFRIN STUART 22500 CALVERT ST WOODLAND HILLS CA 91367-1704	16204815318
STIERS THOMAS & DEANNA	9438 U S HIGHWAY 19 #144 PORT RICHEY FL 34668	16204815029
STOUT HELEN KAY LIVING TRUST	STOUT HELEN KAY TRS 200 W SAHARA AVE #2311 LAS VEGAS NV 89102-5079	16204815234
STRZEMP JOHN TRUST	STRAEMP JOHN TRS 200 W SAHARA AVE #3506 LAS VEGAS NV 89102	16204815372
STUPAK SUBTRUST	STUPAK SUMMER PATRICIA TRS 4309 BRIARWOOD ST LOUISVILLE KY 40207-4037	16204813018
SUBOTIC NEBOJSA	3634 7TH AVE #4F SAN DIEGO CA 92103	16204815142

**Report of All Selected Parcels****Case Number:**

RQR-63634

**Printed On:** Thu: June 16, 2016

<u>Owner</u>	<u>Address</u>	<u>Parcel Number</u>
SUN & LY FAMILY TRUST	SUN JAMES CHANG MING TRS 2772 WHIPPOORWILL DR ROWLAND HEIGHTS CA 91748-4785	16204815193
SUN & LY FAMILY TRUST	SUN JAMES CHANG MING TRS 2772 WHIPPOORWILL DR ROWLAND HEIGHTS CA 91748-4785	16204815209
SUN JACOB JIYANG & LEON LILIANG	6329 LONG COVE DR FONTANA CA 92336	16204815241
SUN SUSIE FENG-I	2473 E ROUGHNECK PL BREA CA 92821	16204815137
SUN TINA FENG-PEI	66 SOMERTON IRVINE CA 92620	16204815138
SUNG SAMMY KUO CHIANG	WANG XIAO YAN 1060 WINDJAMMER CIR FOSTER CITY CA 94404-3057	16204815049
SWANSON JESSE	200 W SAHARA AVE #2903 LAS VEGAS NV 89102	16204815297
TAJIBOY PAULITA 2011-REV LIV TR	TAJIBOY PAULITA TRS 19706 HATTON ST WINNETKA CA 91306-2611	16204815031
TAM APARTMENTS L L C	1526 S BROADWAY LOS ANGELES CA 90015-3031	16204811040
TAM APARTMENTS L L C	1526 S BROADWAY LOS ANGELES CA 90015-3031	16204811044
TAM APARTMENTS L L C	1526 S BROADWAY LOS ANGELES CA 90015-3031	16204811046
TAM APARTMENTS L L C	1526 S BROADWAY LOS ANGELES CA 90015-3031	16204811045
TAM APARTMENTS L L C	1526 S BROADWAY LOS ANGELES CA 90015-3031	16204811043
TAM APARTMENTS L L C	1526 S BROADWAY LOS ANGELES CA 90015-3031	16204811042
TAM APARTMENTS L L C	1526 S BROADWAY LOS ANGELES CA 90015-3031	16204811041
TAM APARTMENTS L L C	1526 S BROADWAY LOS ANGELES CA 90015-3031	16204811039
TAN RAYMUNDO T REVOCABLE TRUST	TAN MARIA Y REVOCABLE TRUST 4525 DEAN MARTIN DR #1900 LAS VEGAS NV 89103-8116	16204815231
TASSIN JAY	DANNINGER BRENT 1001 W 17TH ST AUSTIN TX 78701-1008	16204815105
TAWIL OLGA	2064 OCEAN PKWY BROOKLYN NY 11223-4045	16204815048
TAWIL OLGA	2064 OCEAN PKWY BROOKLYN NY 11223-4045	16204815106
THOMAS FAMILY TRUST	THOMAS PATRICIA ANN TRS 200 W SAHARA AVE #1508 LAS VEGAS NV 89102	16204815135
TIZABGAR PAYAM	TIZABGAR & ABAYAHOU DIAN 2006 TR 12420 RIDGE RD LOS ANGELES CA 90049	16204803005
TIZABGAR PAYAM	TIZABGAR & ABAYAHOU DIAN 2006 TR 12420 RIDGE RD LOS ANGELES CA 90049	16204803004
TJANDRANEGARA ELEANA	GAERLAN ERICA & FILBERT 631 FOLSOM ST #PHA SAN FRANCISCO CA 94107-3609	16204815164
TSAO STEPHEN & MAJE	4881 S TORREY PINES DR #106 LAS VEGAS NV 89103	16204815017
UNGAR INVESTMENTS L P	P O BOX 80246 LAS VEGAS NV 89180-0246	16204811037
URBAN LAND NEVADA L L C	3271 S HIGHLAND DR #704 LAS VEGAS NV 89109-1051	16204807001
URDANETA LUIS E	72 CALLE RES VIRGINIA COUNTRY #9 MIAMI FL 33156	16204815216
VASQUEZ BEATRIZ E NUNEZ	200 W SAHARA AVE #804 LAS VEGAS NV 89102	16204815059
VAUGHN MICHAEL	700 NEW HAMPSHIRE AVE NW #1012 WASHINGTON DC 20037	16204815163
VEGAS WEST RE L L C	200 W SAHARA AVE #2009 LAS VEGAS NV 89102	16204815196
VERSI GAVIN	200 W SAHARA AVE #1911 LAS VEGAS NV 89102	16204815058

**Report of All Selected Parcels****Case Number:**

RQR-63634

**Printed On:** Thu: June 16, 2016

<u>Owner</u>	<u>Address</u>	<u>Parcel Number</u>
VERSI GAVIN AMIR	200 W SAHARA AVE #1911 LAS VEGAS NV 89102-5075	16204815186
VERZOSA ROSALIO & EVA	8788 JADE COAST DR SAN DIEGO CA 92126	16204815268
VETTER DOUGLAS G LIVING TRUST	VETTER DOUGLAS G TRS 19303 CHABLIS CT SARATOGA CA 95070	16204815240
VETTER DOUGLAS G LIVING TRUST	VETTER DOUGLAS G TRS 19303 CHABLIS CT SARATOGA CA 95070	16204815194
VINTAGE LAND HOLDINGS II L L C	3600 LAS VEGAS BLVD S LAS VEGAS NV 89109-4303	16209510002
VITALE ANTHONY P	1590 WOODBINE CT LIBERTY MO 64068-3548	16204815258
W CLEVELAND AVENUE TRUST	900 S LAS VEGAS BLVD #810 LAS VEGAS NV 89101-6850	16204813028
WAGNER WESLEY	7714 BIRCH BAY DR #407 BLAINE WA 98230	16204815090
WALDSTEIN TRUST	WALDSTEIN PETER S & LAURIE B TRS 2900 DEEP CANYON DR BEVERLY HILLS CA 90210	16204815176
WANG DAVID	1721 CHOICE HILLS DR HENDERSON NV 89012	16204815078
WANG XIAONING	GUO YU 1962 MASS AVE LUNENBURG MA 01462	16204815064
WANSBECK L L C	2827 E BLUERIDGE AVE ORANGE CA 92867	16204815385
WANSBECK L L C	2827 E BLUERIDGE AVE ORANGE CA 92867	16204815170
WARRENS NEWS & GIFT INC	631 STRANDER BLVD #F TUKWILA WA 98188-2963	16204815013
WEISBART FAMILY PROPERTIES L L C	3160 W SAHARA AVE #A-22 LAS VEGAS NV 89102	16204813039
WEISBART FAMILY PROPERTIES L L C	3160 W SAHARA AVE #A-22 LAS VEGAS NV 89102	16204813040
WELLS RICHARD	200 W SAHARA AVE #3907 LAS VEGAS NV 89102-5095	16204815419
WELTCH BRUCE	200 W SAHARA AVE #2707 LAS VEGAS NV 89102	16204815277
WESTERN RECOVERY REAL EST INVEST	P O BOX 530129 HENDERSON NV 89053-0129	16204815403
WESTERN RECOVERY REAL EST INVEST	P O BOX 530129 LAS VEGAS NV 89053	16204815001
WESTERN RECOVERY REAL EST INVEST	P O BOX 530129 LAS VEGAS NV 89053-0129	16204815412
WESTINVEST CAPITAL L L C	2133 STOCKTON ST #C307 SAN FRANCISCO CA 94133	16204815130
WHITE RONALD R & ROSE E	17602 17TH ST #102-241 TUSTIN CA 92780	16204815396
WIDNER PHILIP M & KIMBERLY J	P O BOX 1035 SOUTH CLE ELUM WA 98943-1035	16204815201
WIDNER PHILIP M & KIMBERLY J	P O BOX 1035 SOUTH CLE ELUM WA 98943-1035	16204815200
WONG SHARON M REVOCABLE LIV TR	WONG SHARON M TRS 848 RAINBOW BLVD #3324 LAS VEGAS NV 89107	16204815140
WONG STEPHEN A TRS	WONG VALERIE ANN 132 9TH ST #200 OAKLAND CA 94607-4727	16204807003
WOODWARD JAMES & VALERY	200 W SAHARA AVE #2612 LAS VEGAS NV 89102-5082	16204815270
WORD ALIVE CHURCH INC	3710 W SUNSET RD LAS VEGAS NV 89118-3804	16204811038
WRAY WILLIAM B & SARAH J	200 W SAHARA AVE #2602 LAS VEGAS NV 89102	16204815260
WRIGHT JEFFREY B	8908 BROOK HILL LN FORT WORTH TX 76244	16204815352
WRIGHT JOHN J	15989 GRANDVIEW AVE MONTE SERENO CA 95030-3117	16204815393

**Report of All Selected Parcels****Case Number:**

RQR-63634

**Printed On:** Thu: June 16, 2016

<u>Owner</u>	<u>Address</u>	<u>Parcel Number</u>
WRIGHT TRAVIS & KRISTIE	200 W SAHARA AVE LAS VEGAS NV 89102-5002	16204815220
WU DANYU	AO HONG 95 W SQUANTUM ST #1111 QUINCY MA 02171	16204815375
WU YONG CHUN	YANG JIAN 409 E WISTARIA AVE ARCADIA CA 91006-4830	16204815070
XU LILIAN	200 W SAHARA AVE #3901 LAS VEGAS NV 89102-5095	16204815413
XU LILIAN	200 W SAHARA AVE #3901 LAS VEGAS NV 89102-5095	16204815422
YEH 2013 REVOCABLE FAMILY TRUST	YEH TED HUA & DANA PEONY TRS 22418 STEEPLE CHASE DIAMOND BAR CA 91765-3639	16204815257
YEN CHINGHSI	19135 SINGING WOOD DR ROWLAND HEIGHTS CA 91748-2265	16204815251
YOO HEE M	200 W SAHARA AVE #3112 LAS VEGAS NV 89102-5087	16204815330
YOU ME L L C	3900 PARADISE RD #121 LAS VEGAS NV 89169	16204815158
YOU ME L L C	3900 PARADISE RD #121 LAS VEGAS NV 89169	16204815426
YOU ME SIX L L C	3900 PARADISE RD #121 LAS VEGAS NV 89169	16204815147
YOU ME SIX L L C	3900 PARADISE RD #121 LAS VEGAS NV 89169	16204815229
YOU ME SIX L L C	3900 PARADISE RD #121 LAS VEGAS NV 89169	16204815312
YOU ME SIX L L C	3900 PARADISE RD #121 LAS VEGAS NV 89169	16204815230
YOU ME SIX L L C	3900 PARADISE RD #121 LAS VEGAS NV 89169	16204815341
YOU ME SIX L L C	3900 PARADISE RD #121 LAS VEGAS NV 89169	16204815218
YOU ME SIX L L C	3900 PARADISE RD #121 LAS VEGAS NV 89169	16204815217
YUN MOON GIL REVOCABLE LIVING TR	YUN MOON GIL TRS 37964 PINNACLE CT MURRIETA CA 92562	16204815207
ZALACH ROI & KAREN	376 W SAHARA AVE LAS VEGAS NV 89102	16204803014
ZE REN INC	5130 S FORT APACHE RD #215-418 LAS VEGAS NV 89148-1719	16204815197
ZEE HOWELL	200 W SAHARA AVE # 3708 LAS VEGAS NV 89102-5093	16204815398
ZEIGLER JOHN	TSOI ANITA 4611 LAGUNA VISTA ST LAS VEGAS NV 89147	16204815348
ZHONG YIN LV GROUP INC	222 KAREN AVE #3907 LAS VEGAS NV 89109	16204815249
ZHONG YIN LV GROUP INC	222 KAREN AVE #3907 LAS VEGAS NV 89109	16204815068
ZHU APRIL JIANG	165 LYELL ST LOS ALTOS CA 94022	16204815315
ZUKOWSKI BARBARA	200 W SAHARA AVE #1207 LAS VEGAS NV 89102-5070	16204815110