

City of Las Vegas  
Office of City Clerk  
495 South Main Street, 2<sup>nd</sup> Floor  
Las Vegas, Nevada 89101

## Return Service Requested Official Notice of Public Hearing

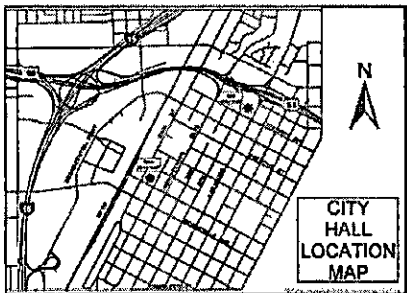

If you wish to file your protest or support on this request, check the appropriate box below and return this card in an envelope with postage to the Office Of The City Clerk at the address listed above or fax this side of this card to (702) 382-4803. If you would like to contact your Council Representative, please call (702) 229-6405.

I SUPPORT  
this Request

I OPPOSE  
this Request

Please use available blank space on card for your comments.

**RQR-58991**

City Council Meeting of **10/21/2015**

## Application Information

**RQR-58991 - REQUIRED REVIEW - PUBLIC HEARING -  
APPLICANT: REAGAN OUTDOOR ADVERTISING -  
OWNER: HIGHLAND INDUSTRIAL PARK PARTNERSHIP -**  
For possible action on a request for a Required Review of an approved Special Use Permit (SUP-1945) FOR AN EXISTING 45-FOOT TALL, 24-FOOT BY 28-FOOT OFF-PREMISE SIGN at 2901 Highland Drive (APN 162-08-611-011), M (Industrial) Zone, Ward 1 (Tarkanian).

## Application Location

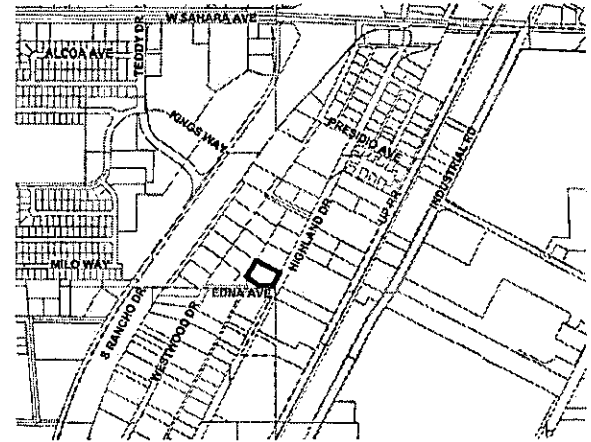

The proposed project may not pertain to the entire highlighted project site.

## Public Hearing Information

**Meeting:** City Council  
**Date:** *October 21, 2015*  
**Time:** 1:00 P.M.  
**Location:** City Council Chambers  
495 South Main Street  
Las Vegas, Nevada

Any and all interested persons may appear and be heard at said meeting, or may, prior thereto, file written objections thereto or approvals thereof with the City Clerk, 2nd Floor, City Hall, 495 South Main Street, Las Vegas, Nevada, 89101. For further information, including the full staff report, please call (702) 229-6311 (TDD 386-9108) or go to <http://www.lasvegasnevada.gov>,

**Report of All Selected Parcels****Case Number:**

RQR-58991

**Printed On:** Tue: September 8, 2015

<u>Owner</u>	<u>Address</u>	<u>Parcel Numbe</u>
2010-1 CRE NV-OFFICE L L C	2450 BROADWAY 6TH FLR SANTA MONICA CA 90404	16209302007
2861 S HIGHLAND DRIVE L L C	P O BOX 1305 CAMARILLO CA 93011-1305	16209201003
2900 HIGHLAND DRIVE L L C	14100 KINGSLEY DR GARDENA CA 90249	16209202008
2953 WESTWOOD LAS VEGAS L L C	10951 SORRENTO VALLEY RD #2A SAN DIEGO CA 92121	16208703002
2975 HIGHLAND L L C	8430 W LAKE MEAD BLVD #100 LAS VEGAS NV 89128	16208705004
ALDABBAGH OMAR	2025 REDBIRD DR LAS VEGAS NV 89134	16208705005
ALDABBAGH OMAR	2025 REDBIRD DR LAS VEGAS NV 89134	16208705006
B M HIGHLAND L L C	3030 S HIGHLAND DR LAS VEGAS NV 89109-1047	16209301004
B M HIGHLAND L L C	3030 S HIGHLAND DR LAS VEGAS NV 89109-1047	16208707002
D 2753 L L C	P O BOX 570427 HOUSTON TX 77257	16209102004
D 2765 L L C	8222 ANOINE DR #100 HOUSTON TX 77088	16209201001
D 2801 WESTWOOD INC	P O BOX 570413 HOUSTON TX 77257-0413	16208604001
E-J CLUB L L C	12740 E CONTROL TOWER RD #J8 ENGLEWOOD CO 80112	16209203005
ENGLERT HIGHLANDS PPTYS L L C	P O BOX 46650 LAS VEGAS NV 89114-6650	16208705001
ENGLERT HIGHLANDS PPTYS L L C	P O BOX 46650 LAS VEGAS NV 89114-6650	16208705002
F K C HIGHLAND L L C	180 N RIVERVIEW DR #100 ANAHEIM CA 92808	16208706001
F K C HIGHLAND L L C	180 N RIVERVIEW DR #100 ANAHEIM CA 92808	16208707001
F K C HIGHLAND L L C	180 N RIVERVIEW DR #100 ANAHEIM CA 92808	16209301003
F K C HIGHLAND L L C	180 N RIVERVIEW DR #100 ANAHEIM CA 92808	16209301002
F K C HIGHLAND L L C	180 N RIVERVIEW DR #100 ANAHEIM CA 92808	16209202012
H & H CORPORATION	6120 S TORREY PINES LAS VEGAS NV 89118-3209	16208705007
HIGHLAND INDUST PK PTNRSH	2500 W SAHARA AVE #211 LAS VEGAS NV 89102-4393	16208611012
HIGHLAND INDUST PK PTNRSH	2500 W SAHARA AVE #211 LAS VEGAS NV 89102-4393	16208611007
HIGHLAND INDUST PK PTNRSH	2500 W SAHARA AVE #211 LAS VEGAS NV 89102-4393	16208611002
HIGHLAND INDUST PK PTNRSH	2500 W SAHARA AVE #211 LAS VEGAS NV 89102-4393	16208611003
HIGHLAND INDUST PK PTNRSH	2500 W SAHARA AVE #211 LAS VEGAS NV 89102-4393	16209210001
HIGHLAND INDUST PK PTNRSH	2500 W SAHARA AVE #211 LAS VEGAS NV 89102-4393	16208611009
HIGHLAND INDUST PK PTNRSH	2500 W SAHARA AVE #211 LAS VEGAS NV 89102-4393	16208611010
HIGHLAND INDUST PK PTNRSH	2500 W SAHARA AVE #211 LAS VEGAS NV 89102-4393	16209210002
HIGHLAND INDUST PK PTNRSH	2500 W SAHARA AVE #211 LAS VEGAS NV 89102-4393	16208611016
HIGHLAND INDUST PK PTNRSH	2500 W SAHARA AVE #211 LAS VEGAS NV 89102-4393	16208611001
HIGHLAND INDUST PK PTNRSH	2500 W SAHARA AVE #211 LAS VEGAS NV 89102-4393	16208611008

**Report of All Selected Parcels****Case Number:**

RQR-58991

**Printed On:** Tue: September 8, 2015

<u>Owner</u>	<u>Address</u>	<u>Parcel Number</u>
HIGHLAND INDUST PK PTNRSH	2500 W SAHARA AVE #211 LAS VEGAS NV 89102-4393	16208611011
HIGHLAND INDUST PK PTNRSH	2500 W SAHARA AVE #211 LAS VEGAS NV 89102-4393	16208611006
HIGHLAND INDUST PK PTNRSH	2500 W SAHARA AVE #211 LAS VEGAS NV 89102-4393	16208611004
HIGHLAND INDUST PK PTNRSH	2500 W SAHARA AVE #211 LAS VEGAS NV 89102-4393	16208611014
HIGHLAND INDUST PK PTNRSH	2500 W SAHARA AVE #211 LAS VEGAS NV 89102-4393	16208611015
HIGHLAND INDUST PK PTNRSH	2500 W SAHARA AVE #211 LAS VEGAS NV 89102-4393	16208611005
HIGHLAND INDUSTRIAL PARK PTNRSH	2500 W SAHARA AVE #211 LAS VEGAS NV 89102-4393	16208604002
HIGHLAND INDUSTRIAL PARK PTNRSH	2500 W SAHARA AVE #211 LAS VEGAS NV 89102-4393	16208611013
HIGHLAND NEVADA PROPERTY L L C	1850 BUSINESS CENTER DR DUARTE CA 91010-2901	16209202014
J X E INVESTMENT L L C	10569 PURDEY RD EDEN PRAIRIE MN 55347-5224	16208703004
J X E INVESTMENT L L C	10569 PURDEY RD EDEN PRAIRIE MN 55347	16208703003
K J A N M L L C	6120 S TORREY PINES LAS VEGAS NV 89118-3209	16208705008
L'CHAIM WESTERN SUPPLY PPTY LLC	6130 W FLAMINGD RD #402 LAS VEGAS NV 89103-2280	16209201002
LEONARDI PROPERTIES	46 LOUISE ST SAN RAFAEL CA 94901-4718	16209203006
MARTIN ROBERT E & KAYE	1500 MARBELLA RIDGE CT LAS VEGAS NV 89117	16208703001
N P PALACE L L C	1505 S PAVILION CENTER DR LAS VEGAS NV 89135-1403	16208602005
N Y P CORPORATION	6120 S TORREY PINES LAS VEGAS NV 89118-3209	16209202013
NEVADA SPACE INC	1900 E DESERT INN RD LAS VEGAS NV 89169-3211	16209202007
PFIZENMAYER FAMILY TRUST	PFIZENMAYER GARY & ANGEL TRS 2338 READING HILLS AVE HENDERSON NV 89052-5836	16208705003
PLANET PROPERTIES L L C	1647 COLLINGWDOD DR SAN DIEGO CA 92109	16209202011
PLANET PROPERTIES L L C	1647 COLLINGWOOD DR SAN DIEGO CA 92109	16209202009
POSITIVE SPACE INC	18 STAR BROOK AVE HENDERSON NV 89052-6628	16209202010
R S G PARTNERS L L C	1625 SKYLINE DR FULLERTON CA 92831-1007	16208704001
S H A C M T L L C	11151 MISSOURI AVE LOS ANGELES CA 90025-5634	16209302006
SCHIFF MARVIN JAMES TRS	MASON FAMILY TRUST 2401 INDUSTRIAL RD LAS VEGAS NV 89102-4817	16209301001
STORAGE WORKS II L L C	2922 RED ARROW DR LAS VEGAS NV 89135	16208704003
TUFFLI COMPANY INC	2780 SKYPARK DR #410 TORRANCE CA 90505	16208703005
WESTWOOD RENTAL L L C	3592 PROCYON ST LAS VEGAS NV 89103-1908	16208704002
WESTWOOD STORAGE L L C	1469 MIDNIGHT COWBOY CT LAS VEGAS NV 89110	16208704004
WYANDOTTE HOLDINGS L L C	299 PARK AVE 42ND FL NEW YORK NY 10171-4299	16208610104