

S.V

City of Las Vegas
Office of City Clerk
495 South Main Street, 2nd Floor
Las Vegas, Nevada 89101

Return Service Requested Official Notice of Public Hearing

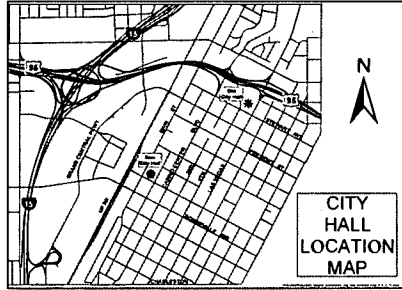

If you wish to file your protest or support on this request, check the appropriate box below and return this card in an envelope with postage to the Office Of The City Clerk at the address listed above or fax this side of this card to (702) 382-4803. If you would like to contact your Council Representative, please call (702) 229-6405.

I SUPPORT
this Request

I OPPOSE
this Request

Please use available blank space on card for your comments.

RQR-56768

City Council Meeting of **01/21/2015**

412

Application Information

RQR-56768 - REQUIRED REVIEW - PUBLIC HEARING - APPLICANT/OWNER: CHETAK DEVELOPMENT - For possible action on a Required Review of an approved Special Use Permit (SUP-1274) FOR AN EXISTING 55-FOOT TALL, 14-FOOT BY 48-FOOT OFF-PREMISE SIGN at 2252 Paradise Road (APN 162-03-411-011), C-2 (General Commercial) Zone, Ward 3 (Coffin).

Application Location

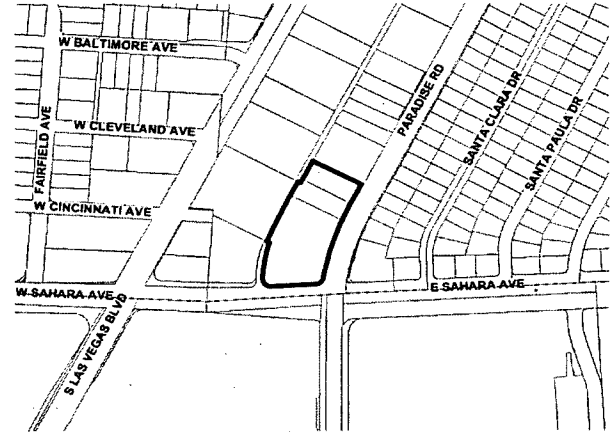

The proposed project may not pertain to the entire highlighted project site.

Public Hearing Information

Meeting: City Council
Date: *January 21, 2015*
Time: 1:00 P.M.
Location: City Council Chambers
495 South Main Street
Las Vegas, Nevada

Any and all interested persons may appear and be heard at said meeting, or may, prior thereto, file written objections thereto or approvals thereof with the City Clerk, 2nd Floor, City Hall, 495 South Main Street, Las Vegas, Nevada, 89101. For further information, including the full staff report, please call (702) 229-6311 (TDD 386-9108) or go to <http://www.lasvegasnevada.gov>.

Report of All Selected Parcels**Case Number:** RQR-56788**Printed On:** Mon: December 15, 2014

<u>Owner</u>	<u>Address</u>	<u>Parcel Number</u>
1999 LIU FAMILY TRUST	LIU STEPHEN C-P & RACHEL T TRS 3 CHUCKWAGON RD ROLLING HILLS CA 90274-5223	16210114627
2033 N PARADISE L L C	P O BOX 60187 BOULDER CITY NV 89006-0187	16203413012
2211 PARADISE INVESTMENT CORP	2211 PARADISE RD LAS VEGAS NV 89104-2514	16203413018
222 KAREN AVE L L C	%P STEPANEK 16000 VENTURA BLVD #600 ENCINO CA 91436	16210114321
222 KAREN AVENUE #1004W L L C	P O BOX 131237 CARLSBAD CA 92013	16210114386
222 KAREN AVENUE #1006 L L C	P O BOX 131237 CARLSBAD CA 92013	16210114388
222 KAREN AVENUE #1204 L L C	P O BOX 131237 CARLSBAD CA 92013	16210114402
222 KAREN AVENUE #1404 L L C	P O BOX 131237 CARLSBAD CA 92013	16210114410
2401 ALLURE L L C	%P SMURFIT 10773 NW 58TH ST #116 DORAL FL 33178-2801	16204815236
322 KAREN UNIT 2905 L L C	%B BINAFARD 1161 LOMA VISTA DR BEVERLY HILLS CA 90210-2622	16210114213
322 TURNBERRY CORPORATION	D & D MOATAZEDI 117 VIA EBOLI NEWPORT BEACH CA 92663	16210114131
432 E SAHARA L L C	432 W SAHARA AVE LAS VEGAS NV 89104	16203416023
7 STAR INVESTMENTS L L C	9609 ELAND CT LAS VEGAS NV 89149	16210114233
A B H NEVADA L L C	2980 S RAINBOW BLVD #100 LAS VEGAS NV 89146	16210114543
A G O PROPERTY HOLDINGS CORP	13 SEACLIFF COTO DE CAZA CA 92679-4814	16204815184
ABOUYAN ALEXANDER	269 S BEVERLY DR BEVERLY HILLS CA 90212	16210114364
ADDO-QUAYE BERNARD	9708 FOXTRAP AVE LAS VEGAS NV 89145-8663	16210114109
AGRAHARAPU MURTY & SANDHYA M	322 KAREN AVE #501 LAS VEGAS NV 89109	16210114025
AHLUWALIA BALJIT & RAJ FAMILY TR	AHLUWALIA BALJIT S & RAJ M K TRS 12 FAIR HARBOR NEWPORT COAST CA 92657-1710	16210114210
ALDANI SOUTH FLORIDA CORPORATION	%A VILLEGOS 901 BRICKELL KEY BLVD #806 MIAMI FL 33131-3734	16204815267
ALEDAV L L C	CR 7 #127-48 OF 701 BOGOTA 07603 COLOMBIA	16204815160
ALIYAR LIVING TRUST	ALIYAR PAREED & ARCHANA P TRS 590 HAGEN DR LAKE HAVASU CITY AZ 86406	16210114121
ALLADEEN SAL & ROBIN MARIE	54-30 65TH PLACE MASPETH NY 11378	16204815355
ALLGEIER MICHAEL C & THIDARAT	4664 MARBLEHEAD BAY DR OCEANSIDE CA 92057-4271	16204815316
ALLU 1903 CORPORATION	400 CAMERON STATION BLVD #328 ALEXANDRIA VA 22304-8229	16204815178
ALLURE 1406 L L C	1027 S RAINBOW BLVD #333 LAS VEGAS NV 89145	16204815121
ALLURE 1806 L L C	%D DICELLO 6120 EGAN CREST DR LAS VEGAS NV 89149-1253	16204815169
ALLURE HOMEOWNERS ASSN INC	8290 ARVILLE ST LAS VEGAS NV 89139	16204815067
ALTSHULER MICHAEL & Y 2012 TR	ALTSHULER MICHAEL & YELENA TRS 944 18TH ST #1 SANTA MONICA CA 90403-6838	16210114169
AMATORICA HOLDINGS L L C	P O BOX 50082 PASADENA CA 91115-0082	16210114172
AMMAR FAYEZ	IZMIRLI BERLANTAH 322 KAREN AVE #3307 LAS VEGAS NV 89109	16210114067
AMMAR FAYEZ	IZMIRLI BERLANTAH 322 E KAREN AVE #3307 LAS VEGAS NV 89109-0448	16210114044

Report of All Selected Parcels**Case Number:** RQR-56788**Printed On:** Mon: December 15, 2014

Owner	Address	Parcel Number
AMMAR TAMER & JENNIFER LYNN	322 KAREN AVE #2307 LAS VEGAS NV 89109	16210114167
AMMAR TAREK	322 KAREN AVE #3307 LAS VEGAS NV 89109	16210114031
AMMAR TAREK LIVING TRUST	AMMAR TAREK TRS 322 KAREN AVE #3307 LAS VEGAS NV 89109-0448	16210114245
ANDERSEN RYAN A & KHANH P	222 KAREN AVE #908 LAS VEGAS NV 89109	16210114382
ANDERSON HELEN K GENERATIONS TR	%M JAMISON 887 ROSASTONE TRL HOUSTON TX 77024	16204815135
ANSTETT BARRY T	BUFALINI SANDRA 9432 STONEYBROCK PL RAMCHO CUCAMONGA CA 91730-7970	16204815172
ANTHONY DENNIS J & ANTONIETTA S	21 RUTGERS ST WEST ORANGE NJ 07052	16204815149
ARIAS MARCOS S	2311 MASON AVE LAS VEGAS NV 89102-2172	16203416020
ARIAS MARCOS S & AILSA	2311 MASON AVE LAS VEGAS NV 89102-2172	16203415011
ARITA ADAM M D & MIYONG KRISTINE	9708 HIGHRIDGE DR LAS VEGAS NV 89134	16210114015
ASHKINAZI ARTHUR LIVING TRUST	ASHKINAZI ARTHUR TRS 3705 MARFIELD AVE TARZANA CA 91356	16204815287
ASSAF JAFAR & LUCY	7 OVERLOOK DR NEWPORT COAST CA 92657-1300	16210114096
ATHERTON SUSAN 2003 LIVING TR	ATHERTON SUSAN TRS 840 POWELL ST #602 SAN FRANCISCO CA 94108	16210114239
AYDIN SAHIN M & CHRISTINE I	2754 BROOKHILL AVE LA CRESCENTA CA 91214-2103	16204815366
AYKENS TRUST	ARPEGGIO HOLDINGS LTD TRS %B MORSE 200 W SAHARA AVE #401 LAS VEGAS NV 89102-5097	16204815179
AYKENS TRUST	ARPEGGIO HOLDINGS P T C LTD TRS %B MORSE 200 W SAHARA AVE #401 LAS VEGAS NV 89102-5097	16204815144
AYKENS TRUST	ARPEGGIO HOLDINGS P T C LTD TRS %B MORSE 200 W SAHARA AVE #401 LAS VEGAS NV 89102-5097	16204815032
AYKENS TRUST	ARPEGGIO HOLDINGS P T C LTD TRS %B MORSE 200 W SAHARA AVE #401 LAS VEGAS NV 89102-5097	16204815060
AYKENS TRUST	ARPEGGIO HOLDINGS P T C LTD TRS %B MORSE 200 W SAHARA AVE #401 LAS VEGAS NV 89102-5097	16204815071
AYKENS TRUST	ARPEGGIO HOLDINGS P T C LTD TRS %B MORSE 200 W SAHARA AVE #401 LAS VEGAS NV 89102-5097	16204815132
AYKENS TRUST	ARPEGGIO HOLDINGS P T C LTD TRS %B MORSE 200 W SAHARA AVE #401 LAS VEGAS NV 89102-5097	16204815168
AZTEC INN CASINO L P	601 S 10TH ST LAS VEGAS NV 89101-7027	16204813082
AZTEC INN CASINO L P	601 S 10TH ST LAS VEGAS NV 89101-7027	16204813079
AZTEC INN CASINO L P	601 S 10TH ST LAS VEGAS NV 89101-7027	16204813081
AZTEC INN CASINO L P	601 S 10TH ST LAS VEGAS NV 89101-7027	16204813077
AZTEC INN CASINO L P	601 S 10TH ST LAS VEGAS NV 89101-7027	16204813080
AZTEC INN CASINO L P	601 S 10TH ST LAS VEGAS NV 89101-7027	16204813076
AZTEC INN CASINO L P	601 S 10TH ST LAS VEGAS NV 89101-7027	16204813078

Report of All Selected Parcels**Case Number:** RQR-56788**Printed On:** Mon: December 15, 2014

<u>Owner</u>	<u>Address</u>	<u>Parcel Number</u>
B A C MANAGEMENT L L C	4070 THREE PENNY CT DE PERE WI 54115	16204815098
B D M D CORP	37-01 MAIN ST #306 FLUSHING NY 11354-4160	16210114217
B D M D CORP	37-01 MAIN ST #306 FLUSHING NY 11354-4160	16210114219
BABY ORANGE L L C	3315 S DANIEL CT BLOOMINGTON IN 47401-7114	16204815035
BABY RED L L C	3315 S DANIEL CT BLOOMINGTON IN 47401-7114	16204815238
BABY YELLOW L L C	3315 S DANIEL CT BLOOMINGTON IN 47401-7114	16204815239
BAILEY RICHARD C	2112 WATERBURY LN LAS VEGAS NV 89134-0387	16210114354
BAILEY W H FAMILY TRUST	BAILEY WILLIAM H & ANNA L TRS 3045 WATERSIDE CIR LAS VEGAS NV 89117-2277	16203413023
BAILEY W H FAMILY TRUST	BAILEY WILLIAM H & ANNA L TRS 3045 WATERSIDE CIR LAS VEGAS NV 89117-2277	16203413025
BAILEY W H FAMILY TRUST	BAILEY WILLIAM H & ANNA L TRS 3045 WATERSIDE CIR LAS VEGAS NV 89117-2277	16203413024
BAKER GERALD	222 KAREN AVE #1205 LAS VEGAS NV 89109	16210114403
BALADI GEORGE Y & LAYLA A	322 KAREN AVE #1507 LAS VEGAS NV 89109-0426	16210114103
BANK CIITIBANK N A	1000 TECHNOLOGY DR MS #314 OFALLON MO 63368	16210114184
BANK NEVADA	2700 W SAHARA AVE 5TH FLR LAS VEGAS NV 89102	16203413003
BANKS VERLON & SUE	4236 HWY 15 WHITESBURG KY 41858-8576	16204815045
BAR-K REALTY	2007 PARADISE RD LAS VEGAS NV 89104-2510	16203413005
BARKER ROBERT C	GHOLKAR SATISH K 95 LUNALILO ST WAILUKU HI 96793	16210114564
BARNA CIPRIAN	HYTHASON SIMONA BARNA 59 COLLEGE AVE #1 MEDFORD MA 02155-4562	16203414029
BARNES FREDERICK W JR & SANDRA F	449 S 12TH ST #2902 TAMPA FL 33602	16210114048
BARNETT JAMES H & AMY R	1101 CASTLEFORD RD MIDLAND TX 79705-2807	16210114201
BARRACO JOSEPH A LIVING TRUST	PALUHA JAROSLAW LIVING TRUST 200 W SAHARA AVE #4003 LAS VEGAS NV 89102-5096	16204815425
BASILIO ANGELINA G	2316 SANTA CLARA DR LAS VEGAS NV 89104-2621	16203413029
BAVEGAS L L C	1532 QUARRY CT VIRGINIA BEACH VA 23464-7215	16203414034
BAY STATE REALTY L L C	6 GLEN DR LYNNFIELD MA 01940	16204815327
BAYDOUN SALAH	MEADE JAMIE 322 KAREN AVE #2701 LAS VEGAS NV 89109-0441	16210114193
BECKMAN ROBERT	200 W SAHARA AVE #1701 LAS VEGAS NV 89102-5052	16204815152
BEHBOODI DEAN R	7634 N 3RD AVE PHOENIX AZ 85021-7207	16210114283
BELLA FRANK P & BETTY S FAM TR	D F A L L C 1401 MINERAL AVE LAS VEGAS NV 89106	16203413015
BELTRAN ALVARO	CARRERA 7 #24-89 OFC 3701 BOGOTA 07603 COLOMBIA	16204815215
BEMA L L C	935 MIDDLE NECK RD GREAT NECK NY 11024-1460	16204815136
BEMA L L C	935 MIDDLE NECK RD GREAT NECK NY 11024-1460	16204815124
BEMA L L C	935 MIDDLE NECK RD GREAT NECK NY 11024-1460	16204815112

Report of All Selected Parcels**Case Number:** RQR-56788**Printed On:** Mon: December 15, 2014

<u>Owner</u>	<u>Address</u>	<u>Parcel Number</u>
BENEDICT SHELLEY	7797 N FIRST ST #118 FRESNO CA 93720	16204815367
BENINATO FRANK P JR & HELENA	1207 E GRAND ST ELIZABETH NJ 07201-2319	16210114628
BENZAR ZINOVIY	YESELSON INNA 2930 W 5TH ST #23-C BROOKLYN NY 11224	16210114514
BERGEL CLIVE & HELLA	43 MARQUIS ON THE HUDSON EDGEWATER nj 07020	16210114272
BERGMAN MARTIN W LIVING TRUST	P O BOX 72676 LAS VEGAS NV 89170-2676	16203414028
BERLINER I Y & R P REV LIV TR	BERLINER MYRON & LILI SHI 19189 MISSION GROVE PKWY S RIVERSIDE CA 92508-6602	16210114264
BERLINER IRVING & R P REV LIV TR	BERLINER IRVING Y & ROBIN P TRS 19189 MISSION GROVE PKWY S RIVERSIDE CA 92508-6602	16210114451
BHALLA FAMILY TRUST	BHALLA BHALINDER & SHAHINA TRS 1644 20TH ST SANTA MONICA CA 90404-3818	16210114266
BILLAUD GERARD YVES	3914 GOLDEN SHORES DR MISSOURI CITY TX 77459-7618	16204815082
BLACK FAMILY TRUST	BLACK STEVEN M & ROBIN K TRS 1626 ABRAMSON RD SANTA ROSA CA 95401	16210114350
BLOCK DAVID J	SCHNABEL MARTIN B 1040 NE 96TH ST MIAMI SHORES FL 33138-2552	16204815040
BOECKMANN FAMILY REVOCABLE TRUST	BOECKMANN HERBERT II & JANE TRS %H BOECKMANN II 15505 ROSCOE BLVD NORTH HILLS CA 91343-6503	16204815382
BOERSMA JELLE PIETER	CHANG CHIA YU 200 W SAHARA AVE #3808 LAS VEGAS NV 89102-5094	16204815410
BOGOSIAN PETER	BOGOSIAN ANTHONY & CHRISTINE 3680 W BEVERLY BLVD LOS ANGELES CA 90004-3527	16210114432
BORNSTEIN JAIME EFTER	4241 JUTLAND DR #212 SAN DIEGO CA 92117-3654	16204815069
BOSS L L C	%B JOHAR 200 W SAHARA AVE #2708 LAS VEGAS NV 89102-5083	16204815384
BOUET GARY R	MEAD JASON T 21450 IGLESIA DR WOODLAND HILLS CA 91364-5420	16204815357
BOZZA-REILLY GINA	REILLY KENNETH SR 9236 LADY PALM CT LAS VEGAS NV 89147	16204815061
BRAKA BENJAMIN	450 7TH AVE 45TH FLR NEW YORK NY 10123-4599	16210114367
BRAUDIS RAYMOND E	322 KAREN AVE #1106 LAS VEGAS NV 89109	16204815074
BRAUER ADAM	119 ROCKLAND CENTER #90 NANUET NY 10954-2956	16204815076
BREAUX CHARLES & ARLENE	200 W SAHARA AVE #2712 LAS VEGAS NV 89102-5083	16204815282
BRINKER DAVID & SHERI	3209 GALLERIA #1702 EDINA MN 55435	16210114112
BROUGH ROBERT	222 KAREN AVE #702 LAS VEGAS NV 89109	16210114360
BROWN DONALD P FAMILY TRUST	BROWN ALBERTA HAP TRUST 222 KAREN AVE #207 LAS VEGAS NV 89109-5233	16210114325
BUHARI FRAM & BEHROZE	3826 FOURTEEN MILE DR STOCKTON CA 95219-3809	16210114620
BUHARI SHIRAZ	3826 FOURTEEN MILE DR STOCKTON CA 95219	16210114334
BUI STEVEN TRUC XUAN & ANNETTE T	20085 SAND DUNE LN HUNTINGTON BEACH CA 92648-2645	16210114618
BURAK J J TRUST	222 KAREN AVE #4507 LAS VEGAS NV 89109-5313	16210114635
BURGE WILLIAM R & MELISSA N	2321 FAIRWAY TERR CLOVIS NM 88101-2731	16210114327
BURNS MARTIN & HOLLIS	616 BOLSAÑA DR LAGUNA BEACH CA 92651-4136	16210114390

Report of All Selected Parcels**Case Number:** RQR-56788**Printed On:** Mon: December 15, 2014

Owner	Address	Parcel Number
C J P A L L L C	9015 WESTWIND RD LAS VEGAS NV 89139	16204815353
C N A ROYAL TRUST	TORKAN ROYA TRS 626 N RODEO DR BEVERLY HILLS CA 90210-3208	16204815102
C P P IMAGE SYSTEMS L L C	6975 WYNDHAM HILL DR RIVERSIDE CA 92506-7503	16204815016
CABRAL MARIO LUIS PEDROSA	ROSA VANESSA DE OLIVEIRA 200 W SAHARA AVE #205 LAS VEGAS NV 89102-5074	16204815005
CALCATERRA RICHARD L 1985 TRUST	CALCATERRA MELISSA F 1985 TRUST P O BOX 400 MENLO PARK CA 94026-0400	16203410006
CALDERON VLADIMIR	YU KERVIN 4903 FITZPATRICK WY NORCROSS GA 30092-1040	16204815077
CALLOWAY CRAIG I	200 W SAHARA AVE #3210 LAS VEGAS NV 89102-5088	16204815340
CAMPO FAMILY TRUST	CAMPO IVON N & LIDIA M TRS 23792 VIA BARLETTA MURRIETA CA 92562	16210114365
CAO ZHUO	8335 W FLAMINGO RD LAS VEGAS NV 89147	16204815020
CAPLAN IVAN L & LOIS G	142 TALL TREE TRL ARNOLD MD 21012-2235	16210114165
CARACCIO JOHN	222 KAREN AVE #202 LAS VEGAS NV 89109	16210114320
CARDENAS NELLY & ANA MERCEDES	304 E 65TH ST #24-A NEW YORK NY 10065-6785	16210114526
CARDOSO GEORGE H FAMILY TRUST	CARDOSO GEORGE H TRS 12955 HILLCREST DR CHINO CA 91710-2934	16210114570
CARLTON SHIRLEY L & GREG S	926 N SKY MEADOWS PL WALNUT CA 91789-1200	16204815092
CARMONA-MOLINA HOMERO	LOPEZ-MENDOZA MARIA G 2104 SANTA CLARA DR LAS VEGAS NV 89104	16203413040
CARNOVALI MASSIMO & NATASCHA	322 KAREN AVE #1906 LAS VEGAS NV 89109-0430	16210114134
CARPENTER DOLORES M	2505 LONG VIEW DR FAIRFIELD CA 94534-8625	16203414019
CARR MICHAEL & SHERRYL	200 W SAHARA AVE #1703 LAS VEGAS NV 89102-5052	16204815154
CARTWRIGHT STEPHEN B & JOAN C	2321 SANTA PAULA DR LAS VEGAS NV 89104-2634	16203415020
CASEY PAUL	1501 CHAMBOLLE CT LAS VEGAS NV 89144-1137	16204815301
CASTRO DANIEL	10453 HOLMAN AVE LOS ANGELES CA 90024-6012	16204815399
CATE FRANCO ENTERPRISES II L L C	%J ALVAREZ ~ %C PEREZ 2608 PREGO CT HENDERSON NV 89052-4119	16210114129
CECILE PROPERTIES L L C	420 E SAHARA AVE LAS VEGAS NV 89104-2572	16203416022
CESAMA INC	12981 ODYSSEY LAKE WAY ORLANDO FL 32826-4639	16204815120
CEVALLOS HENRY TRUST	200 W SAHARA AVE #2608 LAS VEGAS NV 89102-5082	16204815266
CHACKO KALAYIL M & L REV FAM TR	CHACKO KALAYIL M & LEELAMMA TRS 19 SANTA CATALINA DR RANCHO PALO VERDES CA 90275-6608	16204815361
CHAN TOMMY H & KATHY Y	18 WATERFORD POINTE CIR SUGARLAND TX 77479-5664	16210114302
CHAN WING SUNG & HIN	215 PARKROW #12A NEW YORK NY 10038-1121	16210114192
CHANG CHING L	222 KAREN AVE #1801 LAS VEGAS NV 89109	16210114439
CHANG DONG LIANG & JUNG REV TR	CHANG DONG LIANG & JUNG CHEN TRS 1342 OAKWOOD DR ARCADIA CA 91006-2412	16204815344
CHANG GEORGE	840 E GREEN ST #506 PASADENA CA 91101-5436	16210114380

Report of All Selected Parcels**Case Number:** RQR-56788**Printed On:** Mon: December 15, 2014

<u>Owner</u>	<u>Address</u>	<u>Parcel Number</u>
CHANG IK HOON & SOON HEE	322 KAREN AVE #3801 LAS VEGAS NV 89109	16210114271
CHANG IK HOON & SOON HEE	322 KAREN AVE #3801 LAS VEGAS NV 89109	16210114230
CHANG IK HOON & SOON HEE	322 KAREN AVE #3801 LAS VEGAS NV 89109	16204815401
CHANG JOHN C & SOOKANG	8 E KENNEDY LN #306 HINSDALE IL 60521	16210114449
CHANG PHILLIP	222 KAREN AVE #1807 LAS VEGAS NV 89109-5303	16210114445
CHANG REVOCABLE LIVING TRUST	CHANG STANLEY S & HAE OK TRS 15 LANDPORT NEWPORT BEACH CA 92660-9015	16210114069
CHANG SOLOMON	4231 NORWALK DR SPT 33-301 SAN JOSE CA 95129	16210114332
CHANG'S INVESTMENT L L C	328 W LONGDEN AVE ARCADIA CA 91007	16210114427
CHAO KWANG LEE & LUCIA YIHSIANG	200 W SAHARA AVE #3805 LAS VEGAS NV 89102	16204815407
CHAO TILY HO	1027 S RAINBOW BLVD #333 LAS VEGAS NV 89145	16204815294
CHAO WENDY YUEH LI	14031 W CENTER AVE LAKEWOOD CO 80228	16210114395
CHAPMAN RICKY	2021 GROUSE ST LAS VEGAS NV 89134-6125	16204815253
CHATEAU INVESTMENTS L L C	512 MCCLURG CT #4709 CHICAGO IL 60611-4126	16204815085
CHEMTOB CLAUDE	ONE WEST 67TH ST #606 NEW YORK NY 10023-6200	16210114379
CHEN CHAOLI	200 W SAHARA AVE #3608 LAS VEGAS NV 89102-5092	16204815386
CHEN CONRAD ELWYN	JIAVANONT PALERATH NATALIE 12924 DISCOVERY CRK PLAYA VISTA CA 90094	16210114422
CHEN DAVID T & DEBBIE L	2525 NW 141ST PL PORTLAND OR 97229	16204815044
CHEN KATY	200 W SAHARA AVE #204 LAS VEGAS NV 89102-5074	16204815004
CHEN KATY	200 W SAHARA AVE #2910 LAS VEGAS NV 89102-5085	16204815304
CHEN SHU HWA TRUST	CHEN SHU HWA TRS 3427 PALO VISTA DR RPV CA 90275-6158	16204815298
CHEN SHU HWA TRUST	SHEN CHU HWA TRS 3427 PALO VISTA DRRANCHO PALOS V ERDES CA 90275-6158	16204815299
CHENG CHRISTOPHER	CHENG IVY & CHIEH-SAN 1731 HOLT AVE LOS ALTOS CA 94024-6925	16204815409
CHENG CHRISTOPHER	CHENG IVY & CHIEH-SAN 1731 HOLT AVE LOS ALTOS CA 94024-6925	16204815319
CHENG LIL 2014 TRUST	CHENG LIL TRS 969 HILGARD AVE #9091 LOS ANGELES CA 90024-3018	16210114052
CHENNAREDDY VENKAREDDY & S	200 W SAHARA AVE #202 LAS VEGAS NV 89102-5074	16204815002
CHETAK DEVELOPMENT CORPORATION	820 RANCHO LN #85 LAS VEGAS NV 89106	16203411009
CHETAK DEVELOPMENT CORPORATION	820 RANCHO LN #85 LAS VEGAS NV 89106	16203411011
CHETAK DEVELOPMENT CORPORATION	820 RANCHO LN #85 LAS VEGAS NV 89106	16203411010
CHETAK DEVELOPMENT CORPORATION	820 RANCHO LN #85 LAS VEGAS NV 89106	16203410007
CHEUNG CHARLOTTE	30 VISTA HILL RD GREAT NECK NY 11021-1529	16210114221
CHIEU FRANK & BARBARA	LEE LILY TRS 29129 WARNICK RDRANCHO PALOS VER DES CA 90275-4612	16210114200
CHILLON HUGO ARMANDO FORERO	VARGAS HUGO ALBERTO FORERO CALLE 119 #4-22 APTO 810 BOGOTA 07603 COLOMBIA	16204815157

Report of All Selected Parcels

Case Number: RQR-56788

Printed On: Mon: December 15, 2014

<u>Owner</u>	<u>Address</u>	<u>Parcel Number</u>
CHINA TIMES INC	P O BOX 5919 FULLERTON CA 92838-0919	16210114385
CHINA TIMES INC	P O BOX 5919 FULLERTON CA 92838-0919	16210114611
CHIU KUO-YING A & RONG JENNIFER	CHIU JAMES JAU-KAI & JOANNE WANG 3180 E NUEVO PL BREA CA 92821	16210114604
CHIU WEI-CHUAN	HO CHIA YI 9405 S EASTERN AVE #1038 LAS VEGAS NV 89123	16210114150
CHMIELEWSKI MICHAEL S	2200 1ST ST #1514 ALAMOGORDO NM 88310-3423	16210114073
CHO EDUARDO MARCELO	520 S KINSLEY DR #507 LOS ANGELES CA 90020	16210114039
CHOI JEE HO	36 SPINNAKER DR MOUNT LAUREL NJ 08054	16210114047
CHOI JEE HO	36 SPINNAKER DR MOUNT LAUREL NJ 08054	16210114063
CHOI JEE HO	36 SPINNAKER DR MOUNT LAUREL NJ 08054	16210114071
CHOPRA RAJESHWAR & ANEETA	18426 WELLS DR TARZANA CA 91356-4221	16210114162
CHOPRA TRUST	CHOPRA SANJIV & RENU TRS 4866 BREWSTER DR TARZANA CA 91356-4806	16210114177
CHOU HUNG-LUNG	20265 VALLEY BLVD #0 WALNUT CA 91789-2654	16204815173
CHOW NATHAN	2700 LAS VEGA BLVD S #1811 LAS VEGAS NV 89109	16210114205
CIRELLA MARK J & LORI T	322 KAREN AVE #2607 LAS VEGAS NV 89109	16210114191
CLARK DELOS C LIVING TRUST	MAITLAND BIRCHEL L LIVING TRUST P O BOX 80202 LAS VEGAS NV 89180-0202	16203412001
CLARK DELOS C LIVING TRUST	MAITLAND BIRCHEL L LIVING TRUST P O BOX 80202 LAS VEGAS NV 89180-0202	16203412002
CLARK DELOS C LIVING TRUST	MAITLAND BIRCHEL L LIVING TRUST P O BOX 80202 LAS VEGAS NV 89180-0202	16203412031
CLARK DELOS C LIVING TRUST	MAITLAND BIRCHEL L LIVING TRUST P O BOX 80202 LAS VEGAS NV 89180-0202	16203412020
CLARK DELOS C LIVING TRUST	MAITLAND BIRCHEL L LIVING TRUST P O BOX 80202 LAS VEGAS NV 89180-0202	16203412021
CLARK DELOS C LIVING TRUST	MAITLAND BIRCHEL L LIVING TRUST P O BOX 80202 LAS VEGAS NV 89180-0202	16203412022
CLARK DELOS C LIVING TRUST	MAITLAND BIRCHEL L LIVING TRUST P O BOX 80202 LAS VEGAS NV 89180-0202	16203412023
CLARK DELOS C LIVING TRUST	MAITLAND BIRCHEL L LIVING TRUST P O BOX 80202 LAS VEGAS NV 89180-0202	16203412024
CLARK DELOS C LIVING TRUST	MAITLAND BIRCHEL L LIVING TRUST P O BOX 80202 LAS VEGAS NV 89180-0202	16203412025
CLARK DELOS C LIVING TRUST	MAITLAND BIRCHEL L LIVING TRUST P O BOX 80202 LAS VEGAS NV 89180-0202	16203412026
CLARK DELOS C LIVING TRUST	MAITLAND BIRCHEL L LIVING TRUST P O BOX 80202 LAS VEGAS NV 89180-0202	16203412027
CLARK DELOS C LIVING TRUST	MAITLAND BIRCHEL L LIVING TRUST P O BOX 80202 LAS VEGAS NV 89180-0202	16203412028
CLARK DELOS C LIVING TRUST	MAITLAND BIRCHEL L LIVING TRUST P O BOX 80202 LAS VEGAS NV 89180-0202	16203412019
CLARK DELOS C LIVING TRUST	MAITLAND BIRCHEL L LIVING TRUST P O BOX 80202 LAS VEGAS NV 89180-0202	16203412030
CLARK DELOS C LIVING TRUST	MAITLAND BIRCHEL L LIVING TRUST P O BOX 80202 LAS VEGAS NV 89180-0202	16203412032
CLARK DELOS C LIVING TRUST	MAITLAND BIRCHEL L LIVING TRUST P O BOX 80202 LAS VEGAS NV 89180-0202	16203412003
CLARK DELOS C LIVING TRUST	MAITLAND BIRCHEL L LIVING TRUST P O BOX 80202 LAS VEGAS NV 89180-0202	16203412033
CLARK DELOS C LIVING TRUST	MAITLAND BIRCHEL L LIVING TRUST P O BOX 80202 LAS VEGAS NV 89180-0202	16203412034

Report of All Selected Parcels**Case Number:** RQR-56788**Printed On:** Mon: December 15, 2014

<u>Owner</u>	<u>Address</u>	<u>Parcel Number</u>
CLARK DELOS C LIVING TRUST	MAITLAND BIRCHEL L LIVING TRUST P O BOX 80202 LAS VEGAS NV 89180-0202	16203412035
CLARK DELOS C LIVING TRUST	MAITLAND BIRCHEL L LIVING TRUST P O BOX 80202 LAS VEGAS NV 89180-0202	16203412036
CLARK DELOS C LIVING TRUST	MAITLAND BIRCHEL L LIVING TRUST P O BOX 80202 LAS VEGAS NV 89180-0202	16203412037
CLARK DELOS C LIVING TRUST	MAITLAND BIRCHEL L LIVING TRUST P O BOX 80202 LAS VEGAS NV 89180-0202	16203412038
CLARK DELOS C LIVING TRUST	MAITLAND BIRCHEL L LIVING TRUST P O BOX 80202 LAS VEGAS NV 89180-0202	16203412039
CLARK DELOS C LIVING TRUST	MAITLAND BIRCHEL L LIVING TRUST P O BOX 80202 LAS VEGAS NV 89180-0202	16203412040
CLARK DELOS C LIVING TRUST	MAITLAND BIRCHEL L LIVING TRUST P O BOX 80202 LAS VEGAS NV 89180-0202	16203412041
CLARK DELOS C LIVING TRUST	MAITLAND BIRCHEL L LIVING TRUST P O BOX 80202 LAS VEGAS NV 89180-0202	16203412029
CLARK DELOS C LIVING TRUST	MAITLAND BIRCHEL L LIVING TRUST P O BOX 80202 LAS VEGAS NV 89180-0202	16203412004
CLARK DELOS C LIVING TRUST	MAITLAND BIRCHEL L LIVING TRUST P O BOX 80202 LAS VEGAS NV 89180-0202	16203412008
CLARK DELOS C LIVING TRUST	MAITLAND BIRCHEL L LIVING TRUST P O BOX 80202 LAS VEGAS NV 89180-0202	16203412009
CLARK DELOS C LIVING TRUST	MAITLAND BIRCHEL L LIVING TRUST P O BOX 80202 LAS VEGAS NV 89180-0202	16203412010
CLARK DELOS C LIVING TRUST	MAITLAND BIRCHEL L LIVING TRUST P O BOX 80202 LAS VEGAS NV 89180-0202	16203412007
CLARK DELOS C LIVING TRUST	MAITLAND BIRCHEL L LIVING TRUST P O BOX 80202 LAS VEGAS NV 89180-0202	16203412011
CLARK DELOS C LIVING TRUST	MAITLAND BIRCHEL L LIVING TRUST P O BOX 80202 LAS VEGAS NV 89180-0202	16203412006
CLARK DELOS C LIVING TRUST	MAITLAND BIRCHEL L LIVING TRUST P O BOX 80202 LAS VEGAS NV 89180-0202	16203412005
CLARK DELOS C LIVING TRUST	MAITLAND BIRCHEL L LIVING TRUST P O BOX 80202 LAS VEGAS NV 89180-0202	16203412018
CLARK DELOS C LIVING TRUST	MAITLAND BIRCHEL L LIVING TRUST P O BOX 80202 LAS VEGAS NV 89180-0202	16203412012
CLARK DELOS C LIVING TRUST	MAITLAND BIRCHEL L LIVING TRUST P O BOX 80202 LAS VEGAS NV 89180-0202	16203412015
CLARK DELOS C LIVING TRUST	MAITLAND BIRCHEL L LIVING TRUST P O BOX 80202 LAS VEGAS NV 89180-0202	16203412017
CLARK DELOS C LIVING TRUST	MAITLAND BIRCHEL L LIVING TRUST P O BOX 80202 LAS VEGAS NV 89180-0202	16203412016
CLARK DELOS C LIVING TRUST	MAITLAND BIRCHEL L LIVING TRUST P O BOX 80202 LAS VEGAS NV 89180-0202	16203412014
CLARK DELOS C LIVING TRUST	MAITLAND BIRCHEL L LIVING TRUST P O BOX 80202 LAS VEGAS NV 89180-0202	16203412013
CLEARY LYNN	P O BOX 46661 LAS VEGAS NV 89114-6661	16203414012
COLLINS PATRICK	200 W SAHARA AVE #708 LAS VEGAS NV 89102	16204815051
CORIAT SIMON & MARIA	61-20 GRAND CENTRAL PKWY #B-403 FOREST HILLS NY 11375-1240	16210114238
CORIAT SIMON L L C	61-20 GRAND CENTRAL PKWY #B-403 FOREST HILLS NY 11375-1240	16210114225
CORRIGAN ROGÉR & LOIS	1611 HILTON AVE FAIRBANKS AK 99701	16204815007
COUNTY OF CLARK(PUBLIC WORKS)	500 S GRAND CENTRAL PKWY LAS VEGAS NV 89155	16210102001
COVAL SANDRA L	200 W SAHARA AVE #1212 LAS VEGAS NV 89102-5070	16204815115
COX JAMES A	200 W SAHARA AVE #2301 LAS VEGAS nv 89102	16204815224
COX JAMES A	200 W SAHARA AVE #2301 LAS VEGAS nv 89102	16204815225

Report of All Selected Parcels**Case Number:** RQR-56788**Printed On:** Mon: December 15, 2014

<u>Owner</u>	<u>Address</u>	<u>Parcel Number</u>
CRAWFORD JONATHAN	200 W SAHARA AVE #3612 LAS VEGAS NV 89102-5092	16204815390
CRITELLI ANTHONY D & JEANNIE	200 W SAHARA AVE #1504 LAS VEGAS NV 89102-5058	16204815131
CRITELLI ANTHONY D OR JEANNIE	PARK JEANNIE 200 W SAHARA AVE #1504 LAS VEGAS NV 89102-5058	16203414030
CRONFELD DARRYL & MARGARET ROSE	3534 LEOR CT LAS VEGAS NV 89121-3943	16203414027
CRUZ ELSY ABIGAIL	2212 SANTA RITA DR LAS VEGAS NV 89104-2623	16203415033
CRUZ JULIO	DECRUZ HAYDEE BENTANCOURT 2301 SANTA CLARA DR LAS VEGAS NV 89104-2620	16203414013
CRYSTAL SPRINGS PARTNERS L L C	222 KAREN AVE #3908 LAS VEGAS NV 89109	16210114600
D F A L L C	1401 MINERAL AVE LAS VEGAS NV 89106-4342	16203413014
D L W REVOCABLE TRUST	SWAIN SCOTT A TRS 848 N RAINBOW BLVD #5222 LAS VEGAS NV 89107	16204815391
DAHABURA ALBERTO EMILIO SALOME	200 W SAHARA #2104 LAS VEGAS NV 89102	16204815227
DANIEL GREGORY F	6379 CLOVERLEAF CIR EAST AMHERST NY 14051-2048	16210114176
DANZI CAPITAL GROUP L L C	848 N RAINBOW BLVD #3045 LAS VEGAS NV 89107	16204815015
DANZI MICHAEL R	848 N RAINBOW BLVD #3045 LAS VEGAS NV 89107-1103	16204815206
DANZI MICHAEL R	848 N RAINBOW BLVD #3045 LAS VEGAS NV 89107-1103	16204815359
DANZI MIKE	848 N RAINBOW BLVD #3045 LAS VEGAS NV 89107-1103	16204815096
DEBEVER-BARNISKE FAMILY TRUST	4116 BRIGHTHILL AVE LAS VEGAS NV 89121-6311	16203413042
DEBEVER-BARNISKE FAMILY TRUST	4116 BRIGHTHILL AVE LAS VEGAS NV 89121-6311	16203413043
DECAMPLI DAVID G & PAMELA D	3740 W CHEW ST ALLENTOWN PA 18104	16210114009
DECANNIZZO LAURA RENIU CASTELLO	CANNIZZO ROBERTO BOSQUE DE ALMENDROS 2 45 B DE LAS LOMAS DF 11700 MEXICO	16204815370
DEDOMENICO MARK 2010 REV TR	DEDOMENICO MARK TRS 4455 148TH AVE N E BELLEVUE WA 98007-3120	16210114304
DEFINA MICHAEL J	200 W SAHARA AVE #2411 LAS VEGAS NV 89102-5080	16204815246
DEGHERI BERNARD J & PATRICIA A	322 KAREN AVE #2903 LAS VEGAS NV 89109	16210114211
DEJOHNETTE EDWARD LEE	TRAN JANET NGUYET 322 KAREN AVE #2102 LAS VEGAS NV 89109	16210114146
DELPRINCIPE ROBERT M	2777 PARADISE ARD #2204 LAS VEGAS NV 89109-9114	16210114305
DELROSARIO DOMINGO & NOIDA	10848 CANARYWOOD CT SAN DIEGO CA 92131-2641	16204815255
DELUNA STEVE	BANTOG DULCE 408 SAN PABLO DR LAS VEGAS NV 89104-2602	16203416019
DELVECCHIO NICHOLAS A	2312 SANTA CLARA DR LAS VEGAS NV 89104-2621	16203413030
DEMIRJIAN HAROUTYOUN & HASMIK Y	3612 LINDA VISTA GLENDALE CA 91206-1410	16204815214
DESALOME CARLA BATARSE	BOSQUE DE CAPULINES #111 COLONIA BOSQUES DE LAS LOMAS MEXICO CITY DF 11700 MEXICO	16204815203
DEWICK GLENN LIVING TRUST	DEWICK GLENN TRS %PROVIDENT TR GROUP LLC 8880 W SUNSET RD #250 LAS VEGAS NV 89148	16204815328
DHIRMALANI MILDRED	30 SUNSET CT MONTVILLE NJ 07045-9648	16210114450

Report of All Selected Parcels**Case Number:** RQR-56788**Printed On:** Mon: December 15, 2014

<u>Owner</u>	<u>Address</u>	<u>Parcel Number</u>
DIAZ REYNALDO E & VICTORIA S	2100 SANTA CLARA DR LAS VEGAS NV 89104-2615	16203413041
DILL BRENT	P O BOX 3233 SAN LUIS OBISPO CA 93403	16204815108
DINIZ RAPHAEL & JANET	4525 DEAN MARTIN DR #3206 LAS VEGAS NV 89103-8122	16204815151
DINIZ RAPHAEL A & JANET S	200 W SAHARA AVE #3512 LAS VEGAS NV 89117	16204815378
DONOVAN TIM	12948 E MOUNTAIN VIEW RD SCOTTSDALE AZ 85259	16210114050
DORAL ASSOCIATES L L C	6930 HONEYSUCKLE TRL LAKEWOOD RANCH FL 34202-2925	16210114329
DOWDELL SEAN M & THORA A	1212 E APACHE BLVD #104 TEMPE AZ 85281-5838	16210114057
DOWTY MICHAEL SCOTT	322 KAREN AVE #701 LAS VEGAS NV 89109-0419	16210114107
DOWTY MICHAEL SCOTT	322 KAREN AVE #3108 LAS VEGAS NV 89109	16210114232
DU CHONGQING	222 KAREN AVE #3907 LAS VEGAS NV 89109-5309	16210114599
DUFF FAMILY TRUST	DUFF RICHARD P & MARCIA C TRS 3 GREEN BRIER CIR COTO DE CAZA CA 92679	16210114005
DUFRESNE D & D FAMILY TRUST	DUFRESNE GERARD A & DAUNE W TRS 1506 PACIFIC COAST HWY HUNTINGTON BEACH CA 92648-4407	16204815379
DUNN WALLACE E	561 W DIVERSEY #215 CHICAGO IL 60614-1682	16204815111
DZUNG HO VIET	200 W SAHARA AVE #1008 LAS VEGAS NV 89102-5070	16204815087
EATON ALBERT C & LINDA P	5128 LASHEART DR LA CANADA CA 91011-1725	16210114222
EBADI NAJIBULLAH	437 S GATE AVE DALY CITY CA 94015-3454	16210114108
EDIRISURIYA RAJA A & KAMINI M	3838 NEWARK CT CLAREMONT CA 91711-1459	16210114277
EGGE RONALD P	KRACH MARY L 322 KAREN AVE #4304 LAS VEGAS NV 89109-0458	16210114303
EMERY JAMES M REVOCABLE TRUST	EMERY JAMES M TRS 200 W SAHARA AVE #3208 LAS VEGAS NV 89102-5088	16204815338
ENG GILBERT & ELLIE	195 N HARBOR DR #703 CHICAGO IL 60601-7519	16204815192
EPSTEIN JASON	MICHALOVSKY EVAN 201 MARIN BLVD #1120 JERSEY CITY NJ 07302-6499	16204815047
ERICKSON JOHN C QUAL PERS RES TR	ERICKSON C M QUAL PERS RES TR 322 KAREN AVE #4005 LAS VEGAS NV 89109-0455	16210114637
ERISMAN PORTER LIVING TRUST	3651 LINDELL RD #D160 LAS VEGAS NV 89103-1254	16204815400
ESCALANTE ROMEO D & IRENE C	12363 DIVISION ST ANCHORAGE AK 99515	16210114520
ESPIRITU EDGARD F & ANNA MARIE	NARCISCO ANNA 1078 CANYON CREEK TERR FREMONT CA 94536-1800	16210114051
ETEHAD L L C	410 S BEVERLY DR BEVERLY HILLS CA 90212-4402	16203413006
EVANS PATRICIA	200 W SAHARA AVE #409 LAS VEGAS NV 89102-5098	16204815027
F A M GLOBAL PROPERTIES & INVEST	130 N SAGE SPARROW CIR SPRING TX 77389-4887	16204815187
FADDOUL ABDO & LINDA FAMILY 1989	FADDOUL ABDO J & LINDA L TRS 621 LIDO PARK DR #E2 NEWPORT BEACH CA 92663	16210114373
FAILLOUX EDWIGE	112 OCEAN HARBOR LN LAS VEGAS NV 89148	16204815161
FAIR PATRICIA L REVOCABLE LIV TR	200 W SAHARA AVE #601 LAS VEGAS NV 89102-5098	16204815036

Report of All Selected Parcels**Case Number:** RQR-56788**Printed On:** Mon: December 15, 2014

<u>Owner</u>	<u>Address</u>	<u>Parcel Number</u>
FAKHERI DARIUSH	FAKHERI ARIO S & ALAN A 6350 LAUREL CANYON BLVD #100 NORTH HOLLYWOOD CA 91606-3276	16210114289
FALLARINO DAVID	LAFERLA JOSEPH A JR TRS 315 W 33RD ST #32F NEW YORK NY 10001-2795	16204815345
FAN CHINLI	YU HONG 3484 WESTWOOD DR SALT LAKE CITY UT 84109-3239	16204815333
FAN CHINLI	YU HONG 3484 WESTWOOD DR SALT LAKE CITY UT 84109-3239	16204815100
FANGER LEWIS A	222 KAREN AVE #1207 LAS VEGAS NV 89109	16210114405
FAR WEST PROPERTIES INC	410 E SAHARA AVE LAS VEGAS NV 89104-2612	16203415024
FAR WEST PROPERTIES INC	410 E SAHARA LAS VEGAS NV 89104-2612	16203415026
FAR WEST PROPERTIES INC	410 E SAHARA AVE LAS VEGAS NV 89104-2612	16203415025
FARINA ALAN	89 E FULTON AVE ROSEVELT NY 11575-2212	16210114510
FAT JEAN MARC MOO	GREIG CORINE 9015 WESTWIND RD LAS VEGAS NV 89139	16204815083
FECHSER T J SEPARATE PROPERTY TR	FECHSER T J TRS 3605 S TOWN CENTER DR #A LAS VEGAS NV 89135	16204815237
FEDER MICHAEL	9628 SAVONA WINDS DR DELREY BEACH FL 33446-9755	16210114147
FELIKIAN GREGORY & GINA M	CABRALOFF AL & DIANE F 8112 STONERIDGE DR WHITTIER CA 90605-1372	16210114500
FELIX DONALD & RENEE LIVING TR	FELIX DONALD L & RENEE S TRS 10103 E JENSEN ST MESA AZ 85207-3635	16210114097
FELSMANN ODILY CLLAUDETTE	618 11TH ST HUNTINGTON BEACH CA 92648-4032	16204815063
FENTISOV LIVING TRUST	FENTISOV VIACHESLAV & ELENA TRS 200 W SAHARA AVE #4002 LAS VEGAS NV 89102-5096	16204815424
FERNMAR 031 032 033 L L C	P O BOX 400 MENLO PARK CA 94026-0400	16203410005
FERTIG ELIZABETH	200 W SAHARA AVE #2011 LAS VEGAS NV 89102-5076	16204815198
FIELDS ALAN M & NANCY J	2828 COCHRAN ST #501 SIMI VALLEY CA 93065	16210114255
FIELDSTAD JEFF & KELCEY	200 W SAHARA AVE #2707 LAS VEGAS NV 89102-5083	16204815277
FINCH WILLIAM HUNTER	HUNTSMAN NORI 2892 ROXBOROUGH CT WEST VALLEY CITY UT 84119-5970	16204815123
FINE FRANCINE	662 PICARDY CIR NORTHBROOK IL 60062	16210114369
FINK ROBERT J	ELLIS EDYE M 20 W 451 ARMY TRAIL RD ADDISON IL 60101	16204815081
FISHBACH STEVEN & JULIE	11078 E EVANS RD SCOTTSDALE AZ 85255-1604	16210114132
FIVE INVEST L L C	322 KAREN AVE #2802 WINCHESTER NV 89109	16210114202
FLORES MARIA V	2108 SANTA CLARA DR LAS VEGAS NV 89104-2615	16203413039
FLORES VICTOR M & PATRICIA L	4738 LIVE OAK CYN RD LA VERNE CA 91750	16210114358
FONE RIO L L C	23881 VIA FABRICANTE #501 MISSION VIEJO CA 92691-3139	16204815288
FONFA FAMILY 2011 TRUST	FONFA ANDREW & JODI TRS 32 PAINTED FEATHER WAY LAS VEGAS NV 89135-7855	16204815368
FONFA FAMILY 2011 TRUST	FONFA ANDREW & JODI TRS 32 PAINTED FEATHER WAY LAS VEGAS NV 89135-7855	16204815423
FORD ASTRID B	BENEFIELD GARY G 255 N SIERRA ST #1715 RENO NV 89501	16210114016

Report of All Selected Parcels**Case Number:** RQR-56788**Printed On:** Mon: December 15, 2014

<u>Owner</u>	<u>Address</u>	<u>Parcel Number</u>
FRANCISCO ROY B & MARELA H	1800 NORTHWESTERN AVE ANCHORAGE AK 99508	16210114511
FRANK & NANA L L C	%K YANG & Y LU 18058 VIA ROMA YORBA LINDA CA 92886	16210114161
FREDERICKS REVOCABLE TRUST	FREDERICKS DENNIS E & SHARON TRS 116 JAMIE CT LOS GATOS CA 95032-5128	16204815334
FRIEDMAN BERWYN L LIVING TRUST	FRIEDMAN BERWYN L TRS 222 KAREN AVE #1108 LAS VEGAS NV 89109	16210114398
G CAPITAL INVESTMENT L L C	4921 SUNDOWNER CT RANCHO CUCAMONGA CA 91737-6738	16204815428
G D W PROPERTIES L L C	%G WRUBLE 5414 N CLOVER DR MEMPHIS TN 38120-2743	16210114083
GALA STEVEN L & BRENDA K	1837 KALAKAUA AVE #2208 HONOLULU HI 96815	16210114064
GALENA L L C	2780 S JONES BLVD #3207 LAS VEGAS NV 89146-5628	16210114563
GARCIA ROBERT G & BLANCA M	2675 MONTEREY RD SAN MARIO CA 91108-1647	16210114090
GARFIELD BENNETT & NANCY H	2310 PHILLIPS DR GLENVIEW IL 60025	16210114494
GARSON JOSEPH A & SHAWN ELISE	222 KAREN AVE BLDG W #408 LAS VEGAS NV 89109	16210114342
GATES GREG & MARY	331 MELROSE CT IOWA CITY IA 52246-2017	16210114443
GE HONGMING	22538 BIRDS EYE DR DIAMOND BAR CA 91765-2407	16204815284
GE HONGMING	DENG FEI 22538 BIRDS EYE DR DIAMOND BAR CA 91765-2407	16204815269
GHASEDI GHOLAM R & JANET M	66 MEADOWBROOK C C BALLWIN MO 63011-1697	16210114557
GILES DAVID C & ROBERTA SUE	200 W SAHARA AVE #2210 LAS VEGAS NV 89102-5078	16204815221
GLENN MICHAEL	200 W SAHARA AVE #1502 LAS VEGAS NV 89102-5058	16204815129
GOLAND FAMILY TRUST	YAACOV & NILI GOLAND TRS 1726 MICHAEL LN PACIFIC PALISADES CA 90272-2037	16210114092
GOLDEN TITAN INVESTMENT L L C	ORCHARD P O BOX 133 912305 SINGAPORE	16204815387
GOLDIE & DAVEY L L C	5919 FOLIGNO WY SAN JOSE CA 95138-2226	16203413028
GOLDSTEIN S J L L C	%J GOLDSTEIN 1404 KINGDOM ST LAS VEGAS NV 89117-8309	16210114197
GONZALES ERICK	222 KAREN AVE #2108 LAS VEGAS NV 89109	16210114470
GORDON JEFFREY H	322 KAREN AVE #1405 LAS VEGAS NV 89109-0425	16210114093
GORDON KENNETH & KIMBERLY	3883 TURTLE CREEK BLVD #T-9 DALLAS TX 75219	16210114189
GORDON STEPHEN A & GAIL M FAM TR	GORDON STEPHEN A TRS P O BOX 11028 LAS VEGAS NV 89111-1028	16210114441
GORELICK JEFF	1888 LAUREL RIDGE DR RENO NV 89523-3889	16204815414
GOTT WALLACE D & BETTY D FAM TR	GOTT WALLACE D TRS 2415 LINDA LN UPLAND CA 91784-1168	16210114558
GOULD DALE & MULLINS V REV TR	GOULD DALE TRS ETAL 11771 BIG CANYON LN SAN DIEGO CA 92131	16210114438
GRAFMAN HOWARD & PAULETTE	16530 CHATTANOOGA PL PACIFIC PALISADES CA 90272	16210114160
GRAVES JONAS	322 KAREN AVE #2906 LAS VEGAS NV 89109	16210114214
GRAVES PHILIP E	1360 WALNUT ST #307 BOULDER CO 80302-5189	16204815054
GRAY EDITH J & GARY RAYMOND	2401 SANTA CLARA LAS VEGAS NV 89104-2650	16203414018

Report of All Selected Parcels**Case Number:** RQR-56788**Printed On:** Mon: December 15, 2014

Owner	Address	Parcel Number
GREEN CAPITAL DEVELOPMENT L L C	4921 SUNDOWNER CT RANCHO CUCAMONGA CA 91737	16204815056
GREEN EVAN	MASHAYEKHI LALEH 2700 LAS VEGAS BLVD #3908 LAS VEGAS NV 89109	16210114339
GREEN KAUAI L L C	31992 ISLE VISTA LAGUNA NIGUEL CA 92677-5441	16210114301
GREENBERG MICHAEL & WENDY FAM TR	GREENBERG MICHAEL & WENDY TRS 206 THE STRAND MANHATTAN BEACH CA 90266	16210114244
GRIGSBY GEORGE	322 KAREN AVE #2008 LAS VEGAS NV 89109-0433	16210114144
GUDAI JONATHAN	322 KAREN AVE #1701 LAS VEGAS NV 89109-0431	16210114113
GUERRERO-SORIANO JOCHEBED A A	2256 MOSS AVE LOS ANGELES CA 90065-3417	16210114345
GUERRETTAZ GREGORY T	2680 E MAIN ST #223 PLAINFIELD IN 46168-2828	16210114375
GUEVARRA GREGORIO M & TRICIA A	255 FRANKFORT ST DALY CITY CA 94014	16203415034
GUPTA KAVITA	322 KAREN AVE #1508 LAS VEGAS NV 89109	16210114104
GUTHRIE JAMES W & OLIVIA P	3401 LEE PKWY #1601 DALLAS TX 75219	16210114580
H L J F L L C	9015 WESTWIND RD LAS VEGAS NV 89139	16204815300
HABBAS I I TRUST	HABBAS ISAM I TRS 11441 ALERTON PARK DR #214 LAS VEGAS NV 89135-3375	16204815155
HABEEB KHALIL	39 BRET HARTE RD SAN RAFAEL CA 94901	16204815006
HACIENDA LAS VEGAS L L C	2005 B POTOMAC DR HOUSTON TX 77057-2923	16204815245
HADDAD EDUARDO	DEHADDAD SYLVIA BORGE TORIBIO MEDINA #10 PM COLONIA ALGARIN DF 06880 MEXICO	16204815191
HADDAD XAVIER & NICOLE DEJAR DE	TOEIBIO MEDINA #10 COLONIA ALGARIN DF 06880 MEXICO	16204815254
HAMILTON DIANE L L C	2780 S JONES BLVD #3207 LAS VEGAS NV 89146-5628	16210114575
HAMMER DICE & JOANN P	P O BOX 314 GREENWOOD VA 22943-0314	16204815427
HANDA REVA IRREVOCABLE TRUST	HANDA REVA TRS 30807 MARNE DRRANCHO PALOS VERDE S CA 90275-5609	16210114309
HANDA REVA IRREVOCABLE TRUST	HANDA REVA TRS R HANDA30807 MARNE DRRANCHO PALO S VERDES CA 90275-5609	16210114308
HART CALLUM & MARIANNE	17 ROSEBERY ST MOSMAN NSW 2088 AUSTRALIA	16210114376
HAYON IRWIN I	1509 PANDORA AVE LOS ANGELES CA 90024-6111	16210114393
HENDEE STEPHEN W	BORG CATHERINE C 3621 KESWICK RD BALTIMORE MD 21211-2533	16203415010
HENDERSON ROBERT & CATHERINE	200 W SAHARA AVE #710 LAS VEGAS NV 89102	16204815053
HENRY SHAWN	1007 W BLUFF ST FT WORTH TX 76102-1810	16210114290
HENRY SHAWN	1007 W BLUFF ST FT WORTH TX 76102-1810	16210114291
HENRY SHAWN	1007 W BLUFF ST FT WORTH TX 76102-1810	16210114294
HERRERA IDALIA	2300 SANTA PAULA DR LAS VEGAS NV 89104-2630	16203414033
HERSCHMAN DAVID ROBERT & LAURA	9801 COLLINS AVE #9J BAL HARBOUR FL 33154-1822	16210114394
HIBBERD LARRY & DARLENE	2151 F M 2181 CORNITH TX 76210	16204815274
HIGHLAND GARY J TRUST	HIGHLAND GARY J TRS 19700 FAIRCHILD #265 IRVINE CA 92612-2520	16210114243

Report of All Selected Parcels**Case Number:** RQR-56788**Printed On:** Mon: December 15, 2014

<u>Owner</u>	<u>Address</u>	<u>Parcel Number</u>
HO ALANA W & JOHN YIH-SHENG	3 DOUGLAS GROVE RD HENDERSON NV 89052-6704	16204815003
HO JOHN Y & ALANA W	3 DOUGLAS GROVE RD HENDERSON NV 89052-6704	16204815026
HOPFENSPIRGER KIM HENRY	HOPFENSPIRGER RHONDA KAY P O BOX 1093 MORRISON CO 80465-5093	16210114208
HORODESKY GREGORY & DAREL	304 LA CANTERA CT LAS VEGAS NV 89144-1532	16204815310
HOUCHENS RON	8079 S ONEIDA CT CENTENNIAL CO 80112-3133	16210114164
HOVSEPIAN SARKIS & ZARUI	1717 S BRAND BLVD GLENDALE CA 91204-2807	16210114182
HOWARD INA WIN TRUST	HOWARD INA WIN TRS 155 CORDOVA ST #502 PASADENA CA 91105	16210114333
HOWIN L L C	2212 CANYONVIEW DR HENDERSON NV 89044	16210114447
HSU-ADA-	180 N MADISON AVE PASADENA CA 91101-1710	16210114433
HSU SIMEON & TSUI-TI	322 KAREN AVE #1202 LAS VEGAS NV 89109-0436	16210114082
HUANG LEXIANG	200 W SAHARA AVE #2212 LAS VEGAS NV 89102-5078	16204815223
HUGHBANKS PROPERTIES II L L C	901 BAILEY DR PAPILLION NE 68046-7027	16204815343
HUGHBANKS PROPERTIES III L L C	901 BAILEY DR PAPILLION NE 68046-7027	16204815323
HUGHBANKS PROPERTIES IV L L C	901 BAILEY DR PAPILLION NE 68046	16204815165
HUGHBANKS PROPERTIES V L L C	901 BAILEY DR PAPELLION NE 68046	16204815290
HUGHBANKS PROPERTIES VI L L C	901 BAILEY DR PAPILLION NE 68046	16204815325
HUGHBANKS PROPERTIES VII L L C	901 BAILEY DR PAPILLION NE 68046	16204815369
HUGHBANKS PROPERTIES VIII L L C	901 BAILEY DR PAPILLION NE 68046	16204815303
HUGHBANKS PROPERTIES XII L L C	901 BAILEY DR PAPILLION NE 60845	16204815371
HUGHBANKS PROPERTIES XIV L L C	901 BAILEY DR PAPILLEON NE 68046	16204815324
HUGHBANKS SCOTT A	901 BAILEY DR PAPILLION NE 68046-7027	16204815075
HULTQUIST MICHAEL D & APRIL	6536 VALLEY VIEW RD ROGERS AR 72758	16210114017
HUNG LAWRENCE	LIN KATHY 3 BENJAMIN CT PRINCETON JUNCTION NJ 08550	16210114089
HUO FAMILY TRUST EXMT TR	HUO HEI KYUNG KIM TRS 3 STONE PINE DR NEWPORT COAST CA 92657	16210114135
HURLBUT ROY E	BAKER CHRISTINE E 14128 NE 63RD CT REDMOND WA 98052-4657	16204815210
HUSMAN JASON G	504 JOHN ST MANHATTAN BEACH CA 90266-5835	16210114553
HWA FAMILY LIVING TRUST	HWA CHIH SHING & FEI XU TRS 322 KAREN AVE #1602 LAS VEGAS NV 89109-0427	16210114106
HWA FAMILY TRUST	HWA CHIH SHING & FEI XU TRS 322 KAREN AVE #1602 LAS VEGAS NV 89109	16210114023
HWANG NANCY C REVOCABLE TRUST	HWANG NANCY C TRS 12851 GABLES GREEN WY CATHARPIN VA 20143-2403	16204815281
I S G 401 K PLAN	BATTAGLINI LORIE TRS 99 SE MIZNER BLVD #721 BOCA RATON FL 33432	16204815055
IBRAHIM SOBI	2217 SANTA PAULA DR LAS VEGAS NV 89104-2633	16203415014
IMETROSCOM CORPORATION	%D PERLA 104 WINDSOR GATE GREAT NECK NY 11020	16204815415

Report of All Selected Parcels**Case Number:** RQR-56788**Printed On:** Mon: December 15, 2014

<u>Owner</u>	<u>Address</u>	<u>Parcel Number</u>
IMHOFF W JOSEPH REV AGMT TR	IMHOFF ANN J REV AGMT TR 322 KAREN AVE #3808 LAS VEGAS NV 89109-0453	16210114276
IMHOFF W JOSEPH REVOCABLE TRUST	IMHOFF ANN J REVOCABLE TRUST 322 KAREN AVE #3808 LAS VEGAS NV 89109-0453	16210114247
IMHOFF W JOSEPH REVOCABLE TRUST	IMHOFF ANN J REVOCABLE TRUST 322 KAREN AVE #3808 LAS VEGAS NV 89109-0453	16210114153
INGCO AQUEDO MENOR & CARIDAD B IP KAM	18236 S W 26 CT MIRAMAR FL 33029-5149	16210114355
J G N K NEVADA INVESTMENTS L L C	106 LEE TRAVINO STEPHENVILLE TX 76401-5918	16204815014
J H TRUST	3720 S SUSAN ST #100 SANTA ANA CA 92704-6957	16210102002
J N J J L L C	HUSMAN JASON G TRS 504 JOHN ST MANHATTAN BEACH CA 90266	16210114633
J P TRADING L L C	1924 CALLE DULCE GLENDALE CA 91208-3021	16204815244
J R FORD INVESTMENTS L L C	3235 ROSANNA ST LAS VEGAS NV 89117-3137	16203416011
J T LIVING TRUST	2857 PARADISE RD #602 LAS VEGAS NV 89109-5290	16210114311
J W SIMBA INVESTMENTS L L C	TARANTINO JOSEPH A TRS 4909 WINTERSET DR LAS VEGAS NV 89130-3615	16203414005
J W SIMBA INVESTMENTS L L C	5350 HOLLYMEAD DR LAS VEGAS NV 89135-4021	16204815080
J W SIMBA INVESTMENTS L L C	5350 HOLLYMEAD DR LAS VEGAS NV 89135-4021	16204815019
J W SIMBA INVESTMENTS L L C	5350 HOLLYMEAD DR LAS VEGAS NV 89135-4021	16204815363
J W SIMBA INVESTMENTS L L C	10001 PEACE WY #1192 LAS VEGAS NV 89147-8092	16204815271
JACKSON LYNDON D	321 DVORAK CT STOUGHTON WI 53589	16204815126
JACOBS CRAIG	200 W SAHARA AVE #406 LAS VEGAS NV 89102-5098	16204815024
JAMIE JAMES & SHARON	322 KAREN AVE #207 LAS VEGAS NV 89109-0413	16210114007
JAMN L L C	10170 W TROPICANA AVE #156-222 LAS VEGAS NV 89147	16210114361
JAMN L L C	10170 W TROPICANA AVE #156-222 LAS VEGAS NV 89147	16210114378
JAMN L L C	10170 W TROPICANA AVE #156-222 LAS VEGAS NV 89147	16210114347
JAN YIH GUANG & CHIU KUEI	3819 E AMBERWOOD DR PHOENIX AZ 85048-7354	16210114014
JANIS RON & ESTELLE	209 S 3RD ST LANTANA FL 33462	16210114357
JARAMILLO HUMBERTO L	5571 N W 74TH AVE MIAMI FL 33166-4200	16204815291
JARANILLA JAWALI	11616 PROSPECT CURVE WOODBURY MN 55129-7783	16204815326
JAUREGUI FRANCISCO & ALBALUZ	6076 PARK CREST DR CHINO HILLS CA 91709-6315	16210114043
JENG & LEE FAMILY TRUST	JENG CHESTER TRS 1453 MAYAPAN RD LA HABRA HEIGHTS CA 90631-8429	16210114179
JESCO LIGHTING GROUP L L C	66-25 TRAFFIC AVE GLENDALE NY 11385-3348	16204815311
JEWELRY & MINERALS LAS VEGAS	2316 SANTA RITA DR LAS VEGAS NV 89104-2626	16203415027
JEWKES BRANDON & YESENIA	322 KAREN AVE #602 LAS VEGAS NV 89109-0418	16210114034
JOHANNESSEN RICHARD J & PENNY M	222 KAREN AVE #802 LAS VEGAS NV 89109	16210114368
JOHAR MOHAMMAD Z	2615 CYPRESS PT TUSTIN CA 92782	16204815278

Report of All Selected Parcels**Case Number:** RQR-56788**Printed On:** Mon: December 15, 2014

<u>Owner</u>	<u>Address</u>	<u>Parcel Number</u>
JOHNNY HOCK AUN KUEK	18 JALAN BATALONG SINGAPORE 509632 SINGAPORE	16204815264
JOHNSON FAMILY LIVING TRUST	JOHNSON CHARLES A & PATRICIA TRS 200 HARBOR DR #1603 SAN DIEGO CA 92101-6848	16210114084
JORDAN GARY & KIMBERLY	26742 CALLE ULTIMA CAPISTRANO BEACH CA 92624	16204815030
JORDAN KEITH C	ARUTYUNOV HAMLET 6431 COLLINGSWORTH ST LAS VEGAS NV 89131	16203413010
JOSEPH JOHN JR COMPANY L L C	10080 W ALTA DR #200 LAS VEGAS NV 89145	16203413020
JOSEPHS FAMILY LAND L P	5395 S POLARIS AVE LAS VEGAS NV 89118-2456	16203411007
JOSEPHS FAMILY LAND L P	5395 S POLARIS AVE LAS VEGAS NV 89118-2456	16203411008
JOYNER-TUCKER A M SEP PPTY TR	JOYNER-TUCKER ARLENE M TRS 200 W SAHARA AVE #3408 LAS VEGAS NV 89102-5090	16204815362
K A S LIMITED PARTNERSHIP	200 W SAHARA AVE #1106 LAS VEGAS NV 89102-5070	16204815097
K J T INVESTMENTS L L C	2282 WIND RIVER LN ROWLAND HEIGHTS CA 91748-5025	16204815307
K J T INVESTMENTS L L C	2282 WIND RIVER LN ROWLAND HEIGHTS CA 91748-5025	16204815394
K J T INVESTMENTS L L C	2282 WIND RIVER LN ROWLAND HEIGHTS CA 91748-5025	16204815283
K J T INVESTMENTS L L C	2282 WIND RIVER LN ROWLAND HEIGHTS CA 91748-5025	16204815314
K M C K - NEVADA L L C	94-350 UKEE ST WAIPAHI HI 96797	16210114478
KALISH MICHAEL R & STEPHEN M	222 KAREN AVE #2407 LAS VEGAS NV 89109	16210114493
KAMINO YOKO	LEE RICKY Y 322 KAREN AVE #203 LAS VEGAS NV 89109-0413	16210114003
KAMPH REVOCABLE LIVING TRUST	KAMPH BRADLEY J & KELLI K CO-TRS 200 W SAHARA AVE #608 LAS VEGAS NV 89102-5099	16204815043
KANAI SHOKAI & KUMIKO	3920 SPENCER ST LAS VEGAS NV 89119-5201	16210114022
KANDHOROV ABRAM & ROZA	ONE BAY CLUB DR #21D BAYSIDE NY 11360-2913	16204815222
KANDHOROV IRINA & SIMHA	KANDHOROV ABRAM & ROZA 2 BAYCLUB DR #206 BAYSIDE NY 11360-2957	16204815113
KARDOONI KAVEH & KHALIL	HAGHIR SHAHANDEH 222 KAREN AVE #1905 LAS VEGAS NV 89109	16210114142
KAREN COMMUNITY L L C	P O BOX 131237 CARLSBAD CA 92013	16210114537
KAREN COMMUNITY L L C	P O BOX 131237 CARLSBAD CA 92013	16210114541
KAREN COMMUNITY L L C	P O BOX 131237 CARLSBAD CA 92013	16210114540
KAREN COMMUNITY L L C	P O BOX 131237 CARLSBAD CA 92013	16210114588
KAREN COMMUNITY L L C	P O BOX 131237 CARLSBAD CA 92013	16210114589
KAREN COMMUNITY L L C	P O BOX 131237 CARLSBAD CA 92013	16210114616
KAREN COMMUNITY L L C	P O BOX 131237 CARLSBAD CA 92013	16210114590
KAREN COMMUNITY L L C	P O BOX 131237 CARLSBAD CA 92013	16210114591
KAREN COMMUNITY L L C	P O BOX 131237 CARLSBAD CA 92013	16210114592
KAREN COMMUNITY L L C	P O BOX 131237 CARLSBAD CA 92013	16210114539
KAREN COMMUNITY L L C	P O BOX 131237 CARLSBAD CA 92013	16210114593

Report of All Selected Parcels

Case Number: RQR-56788

Printed On: Mon: December 15, 2014

<u>Owner</u>	<u>Address</u>	<u>Parcel Number</u>
KAREN COMMUNITY L L C	P O BOX 131237 CARLSBAD CA 92013	16210114595
KAREN COMMUNITY L L C	P O BOX 131237 CARLSBAD CA 92013	16210114615
KAREN COMMUNITY L L C	P O BOX 131237 CARLSBAD CA 92013	16210114624
KAREN COMMUNITY L L C	P O BOX 131237 CARLSBAD CA 92013	16210114597
KAREN COMMUNITY L L C	P O BOX 131237 CARLSBAD CA 92013	16210114542
KAREN COMMUNITY L L C	P O BOX 131237 CARLSBAD CA 92013	16210114598
KAREN COMMUNITY L L C	P O BOX 131237 CARLSBAD CA 92013	16210114601
KAREN COMMUNITY L L C	P O BOX 131237 CARLSBAD CA 92013	16210114536
KAREN COMMUNITY L L C	P O BOX 131237 CARLSBAD CA 92013	16210114602
KAREN COMMUNITY L L C	P O BOX 131237 CARLSBAD CA 92013	16210114603
KAREN COMMUNITY L L C	P O BOX 131237 CARLSBAD CA 92013	16210114614
KAREN COMMUNITY L L C	P O BOX 131237 CARLSBAD CA 92013	16210114535
KAREN COMMUNITY L L C	P O BOX 131237 CARLSBAD CA 92013	16210114533
KAREN COMMUNITY L L C	P O BOX 131237 CARLSBAD CA 92013	16210114607
KAREN COMMUNITY L L C	P O BOX 131237 CARLSBAD CA 92013	16210114613
KAREN COMMUNITY L L C	P O BOX 131237 CARLSBAD CA 92013	16210114608
KAREN COMMUNITY L L C	P O BOX 131237 CARLSBAD CA 92013	16210114596
KAREN COMMUNITY L L C	P O BOX 131237 CARLSBAD CA 92013	16210114548
KAREN COMMUNITY L L C	P O BOX 131237 CARLSBAD CA 92013	16210114626
KAREN COMMUNITY L L C	P O BOX 131237 CARLSBAD CA 92013	16210114565
KAREN COMMUNITY L L C	P O BOX 131237 CARLSBAD CA 92013	16210114566
KAREN COMMUNITY L L C	P O BOX 131237 CARLSBAD CA 92013	16210114567
KAREN COMMUNITY L L C	P O BOX 131237 CARLSBAD CA 92013	16210114568
KAREN COMMUNITY L L C	P O BOX 131237 CARLSBAD CA 92013	16210114569
KAREN COMMUNITY L L C	P O BOX 131237 CARLSBAD CA 92013	16210114571
KAREN COMMUNITY L L C	P O BOX 131237 CARLSBAD CA 92013	16210114555
KAREN COMMUNITY L L C	P O BOX 131237 CARLSBAD CA 92013	16210114572
KAREN COMMUNITY L L C	P O BOX 131237 CARLSBAD CA 92013	16210114573
KAREN COMMUNITY L L C	P O BOX 131237 CARLSBAD CA 92013	16210114609
KAREN COMMUNITY L L C	P O BOX 131237 CARLSBAD CA 92013	16210114623
KAREN COMMUNITY L L C	P O BOX 131237 CARLSBAD CA 92013	16210114586
KAREN COMMUNITY L L C	P O BOX 131237 CARLSBAD CA 92013	16210114577

Report of All Selected Parcels

Case Number: RQR-56788

Printed On: Mon: December 15, 2014

<u>Owner</u>	<u>Address</u>	<u>Parcel Number</u>
KAREN COMMUNITY L L C	P O BOX 131237 CARLSBAD CA 92013	16210114617
KAREN COMMUNITY L L C	P O BOX 131237 CARLSBAD CA 92013	16210114578
KAREN COMMUNITY L L C	P O BOX 131237 CARLSBAD CA 92013	16210114579
KAREN COMMUNITY L L C	P O BOX 131237 CARLSBAD CA 92013	16210114622
KAREN COMMUNITY L L C	P O BOX 131237 CARLSBAD CA 92013	16210114621
KAREN COMMUNITY L L C	P O BOX 131237 CARLSBAD CA 92013	16210114547
KAREN COMMUNITY L L C	P O BOX 131237 CARLSBAD CA 92013	16210114619
KAREN COMMUNITY L L C	P O BOX 131237 CARLSBAD CA 92013	16210114582
KAREN COMMUNITY L L C	P O BOX 131237 CARLSBAD CA 92013	16210114584
KAREN COMMUNITY L L C	P O BOX 131237 CARLSBAD CA 92013	16210114546
KAREN COMMUNITY L L C	P O BOX 131237 CARLSBAD CA 92013	16210114585
KAREN COMMUNITY L L C	P O BOX 131237 CARLSBAD CA 92013	16210114544
KAREN COMMUNITY L L C	P O BOX 131237 CARLSBAD CA 92013	16210114559
KAREN COMMUNITY L L C	P O BOX 131237 CARLSBAD CA 92013	16210114549
KAREN COMMUNITY L L C	P O BOX 131237 CARLSBAD CA 92013	16210114424
KAREN COMMUNITY L L C	P O BOX 131237 CARLSBAD CA 92013	16210114457
KAREN COMMUNITY L L C	P O BOX 131237 CARLSBAD CA 92013	16210114408
KAREN COMMUNITY L L C	P O BOX 131237 CARLSBAD CA 92013	16210114409
KAREN COMMUNITY L L C	P O BOX 131237 CARLSBAD CA 92013	16210114411
KAREN COMMUNITY L L C	P O BOX 131237 CARLSBAD CA 92013	16210114412
KAREN COMMUNITY L L C	P O BOX 131237 CARLSBAD CA 92013	16210114413
KAREN COMMUNITY L L C	P O BOX 131237 CARLSBAD CA 92013	16210114215
KAREN COMMUNITY L L C	P O BOX 131237 CARLSBAD CA 92013	16210114415
KAREN COMMUNITY L L C	P O BOX 131237 CARLSBAD CA 92013	16210114417
KAREN COMMUNITY L L C	P O BOX 131237 CARLSBAD CA 92013	16210114419
KAREN COMMUNITY L L C	P O BOX 131237 CARLSBAD CA 92013	16210114207
KAREN COMMUNITY L L C	P O BOX 131237 CARLSBAD CA 92013	16210114420
KAREN COMMUNITY L L C	P O BOX 131237 CARLSBAD CA 92013	16210114406
KAREN COMMUNITY L L C	P O BOX 131237 CARLSBAD CA 92013	16210114423
KAREN COMMUNITY L L C	P O BOX 131237 CARLSBAD CA 92013	16210114404
KAREN COMMUNITY L L C	P O BOX 131237 CARLSBAD CA 92013	16210114425
KAREN COMMUNITY L L C	P O BOX 131237 CARLSBAD CA 92013	16210114199

Report of All Selected Parcels

Case Number: RQR-56788

Printed On: Mon: December 15, 2014

<u>Owner</u>	<u>Address</u>	<u>Parcel Number</u>
KAREN COMMUNITY L L C	P O BOX 131237 CARLSBAD CA 92013	16210114428
KAREN COMMUNITY L L C	P O BOX 131237 CARLSBAD CA 92013	16210114430
KAREN COMMUNITY L L C	P O BOX 131237 CARLSBAD CA 92013	16210114431
KAREN COMMUNITY L L C	P O BOX 131237 CARLSBAD CA 92013	16210114435
KAREN COMMUNITY L L C	P O BOX 131237 CARLSBAD CA 92013	16210114436
KAREN COMMUNITY L L C	P O BOX 131237 CARLSBAD CA 92013	16210114532
KAREN COMMUNITY L L C	P O BOX 131237 CARLSBAD CA 92013	16210114442
KAREN COMMUNITY L L C	P O BOX 131237 CARLSBAD CA 92013	16210114448
KAREN COMMUNITY L L C	P O BOX 131237 CARLSBAD CA 92013	16210114454
KAREN COMMUNITY L L C	P O BOX 131237 CARLSBAD CA 92013	16210114455
KAREN COMMUNITY L L C	P O BOX 131237 CARLSBAD CA 92013	16210114456
KAREN COMMUNITY L L C	P O BOX 131237 CARLSBAD CA 92013	16210114421
KAREN COMMUNITY L L C	P O BOX 131237 CARLSBAD CA 92013	16210114262
KAREN COMMUNITY L L C	P O BOX 131237 CARLSBAD CA 92013	16210114335
KAREN COMMUNITY L L C	P O BOX 131237 CARLSBAD CA 92013	16210114336
KAREN COMMUNITY L L C	P O BOX 131237 CARLSBAD CA 92013	16210114091
KAREN COMMUNITY L L C	P O BOX 131237 CARLSBAD CA 92013	16210114319
KAREN COMMUNITY L L C	P O BOX 131237 CARLSBAD CA 92013	16210114346
KAREN COMMUNITY L L C	P O BOX 131237 CARLSBAD CA 92013	16210114349
KAREN COMMUNITY L L C	P O BOX 131237 CARLSBAD CA 92013	16210114088
KAREN COMMUNITY L L C	P O BOX 131237 CARLSBAD CA 92013	16210114298
KAREN COMMUNITY L L C	P O BOX 131237 CARLSBAD CA 92013	16210114362
KAREN COMMUNITY L L C	P O BOX 131237 CARLSBAD CA 92013	16210114363
KAREN COMMUNITY L L C	P O BOX 131237 CARLSBAD CA 92013	16210114281
KAREN COMMUNITY L L C	P O BOX 131237 CARLSBAD CA 92013	16210114275
KAREN COMMUNITY L L C	P O BOX 131237 CARLSBAD CA 92013	16210114407
KAREN COMMUNITY L L C	P O BOX 131237 CARLSBAD CA 92013	16210114263
KAREN COMMUNITY L L C	P O BOX 131237 CARLSBAD CA 92013	16210114437
KAREN COMMUNITY L L C	P O BOX 131237 CARLSBAD CA 92013	16210114377
KAREN COMMUNITY L L C	P O BOX 131237 CARLSBAD CA 92013	16210114257
KAREN COMMUNITY L L C	P O BOX 131237 CARLSBAD CA 92013	16210114381
KAREN COMMUNITY L L C	P O BOX 131237 CARLSBAD CA 92013	16210114383

Report of All Selected Parcels

Case Number: RQR-56788

Printed On: Mon: December 15, 2014

<u>Owner</u>	<u>Address</u>	<u>Parcel Number</u>
KAREN COMMUNITY L L C	P O BOX 131237 CARLSBAD CA 92013	16210114384
KAREN COMMUNITY L L C	P O BOX 131237 CARLSBAD CA 92013	16210114252
KAREN COMMUNITY L L C	P O BOX 131237 CARLSBAD CA 92013	16210114251
KAREN COMMUNITY L L C	P O BOX 131237 CARLSBAD CA 92013	16210114387
KAREN COMMUNITY L L C	P O BOX 131237 CARLSBAD CA 92013	16210114389
KAREN COMMUNITY L L C	P O BOX 131237 CARLSBAD CA 92013	16210114391
KAREN COMMUNITY L L C	P O BOX 131237 CARLSBAD CA 92013	16210114392
KAREN COMMUNITY L L C	P O BOX 131237 CARLSBAD CA 92013	16210114397
KAREN COMMUNITY L L C	P O BOX 131237 CARLSBAD CA 92013	16210114400
KAREN COMMUNITY L L C	P O BOX 131237 CARLSBAD CA 92013	16210114080
KAREN COMMUNITY L L C	P O BOX 131237 CARLSBAD CA 92013	16210114501
KAREN COMMUNITY L L C	P O BOX 131237 CARLSBAD CA 92013	16210114497
KAREN COMMUNITY L L C	P O BOX 131237 CARLSBAD CA 92013	16210114485
KAREN COMMUNITY L L C	P O BOX 131237 CARLSBAD CA 92013	16210114519
KAREN COMMUNITY L L C	P O BOX 131237 CARLSBAD CA 92013	16210114489
KAREN COMMUNITY L L C	P O BOX 131237 CARLSBAD CA 92013	16210114527
KAREN COMMUNITY L L C	P O BOX 131237 CARLSBAD CA 92013	16210114490
KAREN COMMUNITY L L C	P O BOX 131237 CARLSBAD CA 92013	16210114491
KAREN COMMUNITY L L C	P O BOX 131237 CARLSBAD CA 92013	16210114492
KAREN COMMUNITY L L C	P O BOX 131237 CARLSBAD CA 92013	16210114495
KAREN COMMUNITY L L C	P O BOX 131237 CARLSBAD CA 92013	16210114525
KAREN COMMUNITY L L C	P O BOX 131237 CARLSBAD CA 92013	16210114458
KAREN COMMUNITY L L C	P O BOX 131237 CARLSBAD CA 92013	16210114524
KAREN COMMUNITY L L C	P O BOX 131237 CARLSBAD CA 92013	16210114483
KAREN COMMUNITY L L C	P O BOX 131237 CARLSBAD CA 92013	16210114499
KAREN COMMUNITY L L C	P O BOX 131237 CARLSBAD CA 92013	16210114484
KAREN COMMUNITY L L C	P O BOX 131237 CARLSBAD CA 92013	16210114502
KAREN COMMUNITY L L C	P O BOX 131237 CARLSBAD CA 92013	16210114503
KAREN COMMUNITY L L C	P O BOX 131237 CARLSBAD CA 92013	16210114505
KAREN COMMUNITY L L C	P O BOX 131237 CARLSBAD CA 92013	16210114506
KAREN COMMUNITY L L C	P O BOX 131237 CARLSBAD CA 92013	16210114507
KAREN COMMUNITY L L C	P O BOX 131237 CARLSBAD CA 92013	16210114508

Report of All Selected Parcels

Case Number: RQR-56788

Printed On: Mon: December 15, 2014

<u>Owner</u>	<u>Address</u>	<u>Parcel Number</u>
KAREN COMMUNITY L L C	P O BOX 131237 CARLSBAD CA 92013	16210114509
KAREN COMMUNITY L L C	P O BOX 131237 CARLSBAD CA 92013	16210114512
KAREN COMMUNITY L L C	P O BOX 131237 CARLSBAD CA 92013	16210114522
KAREN COMMUNITY L L C	P O BOX 131237 CARLSBAD CA 92013	16210114515
KAREN COMMUNITY L L C	P O BOX 131237 CARLSBAD CA 92013	16210114516
KAREN COMMUNITY L L C	P O BOX 131237 CARLSBAD CA 92013	16210114521
KAREN COMMUNITY L L C	P O BOX 131237 CARLSBAD CA 92013	16210114518
KAREN COMMUNITY L L C	P O BOX 131237 CARLSBAD CA 92013	16210114523
KAREN COMMUNITY L L C	P O BOX 131237 CARLSBAD CA 92013	16210114149
KAREN COMMUNITY L L C	P O BOX 131237 CARLSBAD CA 92013	16210114530
KAREN COMMUNITY L L C	P O BOX 131237 CARLSBAD CA 92013	16210114463
KAREN COMMUNITY L L C	P O BOX 131237 CARLSBAD CA 92013	16210114465
KAREN COMMUNITY L L C	P O BOX 131237 CARLSBAD CA 92013	16210114157
KAREN COMMUNITY L L C	P O BOX 131237 CARLSBAD CA 92013	16210114531
KAREN COMMUNITY L L C	P O BOX 131237 CARLSBAD CA 92013	16210114488
KAREN COMMUNITY L L C	P O BOX 131237 CARLSBAD CA 92013	16210114461
KAREN COMMUNITY L L C	P O BOX 131237 CARLSBAD CA 92013	16210114460
KAREN COMMUNITY L L C	P O BOX 131237 CARLSBAD CA 92013	16210114155
KAREN COMMUNITY L L C	P O BOX 131237 CARLSBAD CA 92013	16210114163
KAREN COMMUNITY L L C	P O BOX 131237 CARLSBAD CA 92013	16210114469
KAREN COMMUNITY L L C	P O BOX 131237 CARLSBAD CA 92013	16210114466
KAREN COMMUNITY L L C	P O BOX 131237 CARLSBAD CA 92013	16210114459
KAREN COMMUNITY L L C	P O BOX 131237 CARLSBAD CA 92013	16210114472
KAREN COMMUNITY L L C	P O BOX 131237 CARLSBAD CA 92013	16210114529
KAREN COMMUNITY L L C	P O BOX 131237 CARLSBAD CA 92013	16210114473
KAREN COMMUNITY L L C	P O BOX 131237 CARLSBAD CA 92013	16210114474
KAREN COMMUNITY L L C	P O BOX 131237 CARLSBAD CA 92013	16210114475
KAREN COMMUNITY L L C	P O BOX 131237 CARLSBAD CA 92013	16210114476
KAREN COMMUNITY L L C	P O BOX 131237 CARLSBAD CA 92013	16210114479
KAREN COMMUNITY L L C	P O BOX 131237 CARLSBAD CA 92013	16210114480
KAREN COMMUNITY L L C	P O BOX 131237 CARLSBAD CA 92013	16210114528
KAREN COMMUNITY L L C	P O BOX 131237 CARLSBAD CA 92013	16210114481

Report of All Selected Parcels**Case Number:** RQR-56788**Printed On:** Mon: December 15, 2014

Owner	Address	Parcel Number
KAREN COMMUNITY L L C	P O BOX 131237 CARLSBAD CA 92013	16210114467
KARP LAWRENCE M & BARBARA J	2128 SUTTON PL PLANO TX 75093-4322	16210114145
KASSIN ABRAHAM	SOCRATES 228 PRIMER PISO COLONIA POLANCODELEGACION MIGUEL HIDALGO 11560MEXICO	16204815143
KATEB AFSHIN & MINA	20 HACKAMORE LN BELL CANYON CA 91307	16210114337
KAWAGUCHI MICHAEL	CHANG HENRY 200 W SAHARA AVE #2605 LAS VEGAS NV 89102-5082	16204815263
KAWASE ERIC	1846 RAMBLING RD SIMIT VALLEY CA 93065	16204815103
KAZEE ALEXANDER	322 KAREN AVE #404 LAS VEGAS NV 89109-0415	16210114020
KEELEY DENNIS	13 CYPRESS WAY ROLLING HILLS ESTATES CA 90274	16210114330
KHORRAM FARHAD & FATEMEH	3117 FAIRWEATHER PINE HUNTS POINT WA 98004	16210114416
KHUBANI CHANDROO N & SUNDRI C	KHUBANI LACKMICHAND C P O BOX 307 MONTVILLE NJ 07045-0307	16210114426
KILUK LINDA A & LINDA	2122 LOST MAPLE ST LAS VEGAS NV 89115-5223	16203414015
KIM CHANG S	1924 BROOKE LN FULLERTON CA 92833-1219	16204815305
KIM EUI GYUN	322 KAREN AVE #3202 LAS VEGAS NV 89109	16210114234
KIM KITAE	222 KAREN AVE #2504 LAS VEGAS NV 89109-5305	16210114498
KIM SOOK YOUNG	322 KAREN AVE #2405 LAS VEGAS NV 89109	16210114173
KING FAMILY IRREVOCABLE TRUST	KING GREGORY TRS 1200 MENLO DR N W ATLANTA GA 30318-4170	16210114285
KIRITCHENKO PETER N	185 GILMARTIN RD BELVEDERE TIBURON CA 94920-1529	16210114269
KIRKMAN ALLAN C & DIANE M	232 MERION DR PITTSBURGH PA 15228-2349	16210114115
KIRSCH TOBY	17328 VENTURA BLVD #229 ENCINO CA 91316-3904	16210114186
KIVI GABRIELLE & NATHAN	222 KAREN AVE #602 LAS VEGAS NV 89109	16210114352
KK REAL ESTATE INVEST FUND L L C	8064 W SAHARA AVE #100 LAS VEGAS NV 89117	16210114127
KLASS KATHIE	ROLLINS BONNIE 5501 N 10TH ST ARLINGTON VA 22205-2416	16204815012
KNIGHT MICHAEL	200 W SAHARA AVE #602 LAS VEGAS NV 89102-5098	16204815037
KNOTTS MELTON E JR	BROWN MARK 39 HARVEST WIND PL THE WOODLANDS TX 77382-3602	16204815128
KNOX THOMAS M	CREECH CHO CHA 4250 DEERWOOD TRL MELBOURNE FL 32934-8474	16210114116
KOCHAR TAMANA	527 CARMINE AVE SOUTH PLAINFIELD NJ 07080	16204815101
KOELLERER WOLFGANG & PETER	FABRIKSTR 34 WELS AUSTRIA	16210114120
KOHLMEIER DAVID	2700 LAS VEGAS BLVD S #1607 LAS VEGAS NV 89123	16204815033
KOLESAR JERRY	SALAZAR NELSON 8 EXCALIBUR CT RANCHO MIRAGE CA 92270	16210114574
KO-WEN WANG	322 KAREN AVE #3602 LAS VEGAS NV 89109-0450	16210114260
KOZIK P FRANK & EDNA M	P O BOX 4365 R R #4 MOSCOW PA 18444-9398	16204815122

Report of All Selected Parcels**Case Number:** RQR-56788**Printed On:** Mon: December 15, 2014

Owner	Address	Parcel Number
KRAMER MARGUERITE	APPS GEOFFREY 322 KAREN AVE #3007 LAS VEGAS NV 89109	16210114223
KREITLOW WILLIAM & LYNDA FAM TR	KREITLOW WILLIAM A & LYNDA J TRS 2309 SANTA RITA DR LAS VEGAS NV 89104-2638	16203416013
KRILOVS FILIPS	200 W SAHARA AVE #3603 LAS VEGAS NV 89102-5092	16204815381
KRISHNA DODDANNA	200 W SAHARA AVE #811 LAS VEGAS NV 89102	16204815066
KRITCHEVSKY SUCHITRA	2211 SANTA CLARA DR LAS VEGAS NV 89104-2647	16203414011
KROLL TERRY D & SARALEE FAM TR	KROLL TERRY D & SARALEE TRS 2857 PARADISE RD #3401 LAS VEGAS NV 89109	16210114306
KROLL TERRY D & SARALEE FAM TR	KROLL TERRY D & SARALEE TRS 2857 PARADISE RD #3401 LAS VEGAS NV 89109	16210114288
KRUPNICK STEVEN L	200 W SAHARA AVE #3411 LAS VEGAS NV 89102-5090	16204815365
KUICK KENNETH J & LAURA J	322 KAREN AVE #3705 LAS VEGAS NV 89109	16210114268
KURUCZ NORBERT	31505 LINDERO CANYON RD #10 WESTLAKE VILLAGE CA 91361-4732	16204815285
KURZ KAREN	200 W SAHARA AVE #302 LAS VEGAS NV 89102-5097	16204815011
KWAN TRACY YA-YIN	200 W SAHARA AVE #2610 LAS VEGAS NV 89102-5082	16204815268
KWANG WAN-TSING	13510 BRISTOW DAWN SAN ANTONIO TX 78217-1379	16204815039
L B SAHARA INC	%D BEES 200 W SAHARA AVE #3804 LAS VEGAS NV 89102-5094	16204815406
L B SAHARA INC	%D BEES 200 W SAHARA AVE #3803 LAS VEGAS NV 89102-5094	16204815405
L H S SAHARA PROPERTY L L C	6 CORONADO POINTE LAGUNA NIGUEL CA 92677-5544	16204815331
L V FAIRFIELD HOLDINGS L L C	9017 S PECOS RD #4350 HENDERSON NV 89074-7496	16204813052
L V FAIRFIELD HOLDINGS L L C	9017 S PECOS RD #4350 HENDERSON NV 89074-7496	16204813051
L V FAIRFIELD HOLDINGS L L C	9017 S PECOS RD #4350 HENDERSON NV 89074-7496	16204813063
L V LAND VENTURES L L C	200 W SAHARA AVE #4001 LAS VEGAS NV 89102	16203413013
LACUNZA JOHN	322 KAREN AVE #3905 LAS VEGAS NV 89109	16210114280
LACUT INC	308 E SAHARA AVE LAS VEGAS NV 89104-2521	16203414025
LACUT INC	308 E SAHARA AVE LAS VEGAS NV 89104-2521	16203414026
LAM KEVIN	216 FAIRVIEW AVE ENGLEWOOD CLIFFS NJ 07632-2018	16210114078
LAM PHUONG & JENNY	1406 VIA CAMILLE MONTEBELLO CA 90640-3123	16203414038
LAMARQUE FAMILY TRUST	LAMARQUE HECTOR M & JANICE L TRS P O BOX 2438 CHINO CA 91708-2438	16210114261
LANDRON JOAN	8414 MAYPORT DR LAS VEGAS NV 89131-6701	16204815134
LANG PATRICIA A	4115 CLOVERDALE AVE LOS ANGELES CA 90008-1034	16210114203
LAPIN BENJAMIN	1484 E 27TH ST BROOKLYN NY 11210-5309	16203414016
LAS #3404 L L C	860 NE 98TH ST MIAMI SHORES FL 33138-2533	16204815358
LAS FAILLOUX L L C	9015 WESTWIND RD LAS VEGAS NV 89139	16204815293
LAU IAN VAN & RUTH YEE CHE	249 WINDSOR DR POINT ROBERTS WA 98281-9313	16204815272

Report of All Selected Parcels**Case Number:** RQR-56788**Printed On:** Mon: December 15, 2014

Owner	Address	Parcel Number
LAVENDER HILL PROPERTIES L L L P	%LUSARDI LAND CO 1570 LINDA VISTA DR SAN MARCOS CA 92078-3808	16210114038
LAVENDER HILL PROPERTIES L L L P	%LUSARDI LAND CO 1570 LINDA VISTA DR SAN MARCOS CA 92078	16210114300
LAVRETTA TED	ELWOOD LINDEN 12857 N MYSTIC VIEW PL ORO VALLEY AZ 85755-1882	16210114140
L'CHAIM IHOP PROPERTY L L C	6130 W FLAMINGO RD #402 LAS VEGAS NV 89103-2280	16204813075
LEAVITT FAMILY TRUST	LEAVITT MARION L & DONNA CO-TRS 5040 SANDRA RD LAS VEGAS NV 89110-1548	16203414023
LEAVITT FAMILY TRUST	LEAVITT LEONARD & DONNA J CO-TRS 5040 SANDRA RD LAS VEGAS NV 89110-1548	16203414024
LEE CHI CHIANG	200 HOOVER AVE #806 LAS VEGAS NV 89101-6873	16204815171
LEE DUK JOON	992 PINEHURST DR LAS VEGAS NV 89109-1569	16203413037
LEE.DUK JOON	992 PINEHURST DR LAS VEGAS NV 89109-1569	16203413009
LEE DUK JOON	992 PINEHURST DR LAS VEGAS NV 89109-1569	16203413036
LEE ERNEST T & TATIANA L	322 KAREN AVE #1707 LAS VEGAS NV 89109-0428	16210114119
LEE THOMAS Y & KEITH Y	13030 ALONDRA BLVD #201 CERRITOS CA 90703-2257	16210114576
LENZ DAUN MARIE	641 LUCKY PINE ST 2584 LAZY SADDLE DR HENDERSON NV 89002	16203414031
LENZNER JOHN E & GERALDINE F	619 DUFF RD SEWICKLEY PA 15143-9556	16210114136
LETOURNEAU JEFF	SCAGNELLI STELLA 3708 MIGUELS LN LAS VEGAS NV 89120-2546	16210114171
LEUNG KEN & CONNIE	107 LUNADO WAY SAN FRANCISCO CA 94127	16210114227
LEWIS HAROLD R & MARY L	LEWIS JONATHAN RYAN 2857 PARADISE RD #3201 LAS VEGAS NV 89109-9043	16210114253
LEWIS JENNIFER & HAROLD R	322 KAREN AVE #2407 LAS VEGAS NV 89109-0438	16210114175
LI JIE	222 KAREN AVE #2401 LAS VEGAS NV 89109	16210114487
LI LING	SHENG SHUJUN 205 ROBLAR AVE HILLSBOROUGH CA 94010-6845	16210114070
LI LIVING TRUST	LI STEPHEN CHI S & AMY HUEI TRS 322 KAREN AVE #1001 LAS VEGAS NV 89109-0422	16210114065
LIANG JIN JU	LIANG JIN WEN 2306 SANTA RITA DR LAS VEGAS NV 89104-2626	16203415029
LIANG JIN LONG & JIN ZHEN	7926 TEAL HARBOR AVE LAS VEGAS NV 89117-2509	16203415030
LIEN MICHAEL P	82 COVERED BRIDGE RD CARMICHAEL CA 95608	16210114341
LIM RAYMUND	222 KAREN AVE #3004 LAS VEGAS NV 89109-5306	16210114538
LIN ANDREW H & JUDY S	LIN PERRY P & JOYCE P 71 HOBART AVE SHORT HILLS NJ 07078-2005	16210114081
LIN JOSEPH C & LILY C	17 LAURELFORD CT COCKEYSVILLE MD 21030-2236	16204815296
LIN YANBOR ETAL	YU SZU-YUNG 222 KAREN AVE #302 LAS VEGAS NV 89109	16210114328
LIN'S FAMILY TRUST	LIN ALBERT C & YUEH-LEE C TRS 1644 S BEVERLY CT CHANDLER AZ 85286-7016	16210114370
LIPA AMPARO A	5016 MONTE DEL SOL LN NORTH LAS VEGAS NV 89031	16203413027
LIU SHOA-KAI & LI QING	322 KAREN AVE #1506 LAS VEGAS NV 89109-0426	16210114102
LIU SHOA-KAI & LI QING	19173 HASTINGS ST ROWLAND HEIGHTS CA 91748-4968	16210114036

Report of All Selected Parcels**Case Number:** RQR-56788**Printed On:** Mon: December 15, 2014

Owner	Address	Parcel Number
LIU STEPHEN & RACHEL	3 CHUCKWAGON RD ROLLING HILLS CA 90274-5223	16210114556
LO SO-YI	322 KAREN AVE #2007 LAS VEGAS NV 89109	16210114143
LOOTENS JONATHAN R	322 KAREN AVE #302 LAS VEGAS NV 89109-0414	16210114010
LOUIS-JACQUES MAC ANTOINE	2615 VIA CORONA BULLHEAD CITY AZ 86442-7963	16210114130
LUBRATICH SCOTT	606 JOYA CT DANVILLE CA 94506	16204815261
LUCACCIONI JOHN S & JANA G	222 KAREN AVE #206 LAS VEGAS NV 89109	16210114324
LUCIANO FAMILY TRUST	LUCIANO RICHARD J & K M TRS 759 REPOSADO DR LA HABRA HEIGHTS CA 90631-7837	16204815010
LUN SHEN L L C	8184 DOLCE VOLPE AVE LAS VEGAS NV 89178-8259	16203413026
LUND DOUG JEROME REVOCABLE TR	LUND DOUG JEROME TRS P O BOX 71 302 N W 1ST ST NEW RICHLAND MN 56072	16210114236
LUO XIAO JU	11 E MAGNA VISTA AVE ARCADIA CA 91006-4002	16204815025
LUU NGA	PHAM SOPHIA LUU 104 ARBUSTO CIR SACRAMENTO CA 95831-4554	16204815009
M I S L INVESTMENTS L L C	222 KAREN AVE #4007 LAS VEGAS NV 89109-5311	16210114605
M K T TRUST	QUINTERO ADOLFO CO-TRS 2501 LUBERON DR HENDERSON NV 89044	16210114636
M N R HOLDINGS L L C ALLURE 606	10624 S EASTERN AVE #A792 HENDERSON NV 89052-2982	16204815041
M N R HOLDINGS L L C ALLURE 607	10624 S EASTERN AVE #A-792 HENDERSON NV 89052	16204815042
MA CALVIN T	SITU ANGIE P 322 KAREN AVE #807 LAS VEGAS NV 89109	16210114055
MA JEFFREY C & STEPHEN	2225 W COMMONWEALTH AVE #307 ALHAMBRA CA 91803-1336	16210114075
MA KUEI-FEN	2407 CONOY ST #101 ALEXANDRIA VA 22301	16204815148
MA MARGARET	18543 DEVONSHIRE ST #229 NORTHRIDGE CA 91324-1308	16204815320
MA MINA	935 MIDDLE NECK RD GREAT NECK NY 11024-1460	16204815289
MA MINA	935 MIDDLE NECK RD GREAT NECK NY 11024-1460	16204815205
MACKENNA SANDRA J	2313 SANTA PAULA DR LAS VEGAS NV 89104-2634	16203415018
MAI SONNY	LYONG LEIN T 549 TIROL CT MILPITAS CA 95035-3640	16210114196
MALYALA FAMILY REVOCABLE TRUST	MALYALA VIKRANTH TRS 2144 TERRENA VALLEY DR SAN JOSE CA 95121	16210114174
MANHATTAN PHATTS L L C	222 KAREN AVE #2502 LAS VEGAS NV 89109	16210114496
MANN JOHN & SANDRA	200 HOOVER AVE #804 LAS VEGAS NV 89101	16210114326
MAPEL DALE LIVING TRUST	948 HIGHSIDE CT LAS VEGAS NV 89110-2910	16203413035
MAPEL SHARON A TRUST	2208 VAN PATTEN PL LAS VEGAS NV 89104-2754	16203414040
MARKS RUTH	8003 STIRLING FALLS CIR SARASOTA FL 34243-4206	16204815308
MARQUEZ RAQUEL	2300 SANTA CLARA DR LAS VEGAS NV 89104-2621	16203413032
MARTIN CAROL F	200 W SAHARA AVE #3003 LAS VEGAS NV 89102-5086	16204815309
MARTINDALE JAMES L	2210 SANTA PAULA DR LAS VEGAS NV 89104-2629	16203414035

Report of All Selected Parcels**Case Number:** RQR-56788**Printed On:** Mon: December 15, 2014

<u>Owner</u>	<u>Address</u>	<u>Parcel Number</u>
MARTINEZ ROCIO	BABIUK JAMES 18061 HAAS RD MOKENA IL 60448-8901	16204815329
MARTINI FRANCELA & AQUILES	1901 TRAILWOOD HEIGHTS LN #101 RALEIGH NC 27603	16204815163
MASROUR SIMA	1508 REGGIO AISLE IRVINE CA 92606-0825	16210114118
MATAMOROS WILLIAM & MARY L REV L	MATAMOROS WILLIAM & MARY L TRS 1244 ANNUNCIATION ST NEW ORLEANS LA 70130	16210114374
MATSUNAGA SUMMER S & ELIZABETH S	26742 NOKOMIS RD RANCHO PALOS VERDES CA 90275	16204815360
MATSUNAGA SUMNER S & ELIZABETH S	26742 NUKOMIS RD RANCHO PALOS VERDES CA 90275	16204815117
MATTHEWS PHILIP M & KAREN E	GINN PAMELA E 9430 S MAGNOLIA AVE OCALA FL 34476-7535	16210114594
MAZALTOV L L C	4832 SANTA BARBARA ST LAS VEGAS NV 89121	16204813062
MAZO ROBERT JOEL	SHAPIRO-MAZO YVONNE M 10739 NEW CASTLE PL POWELL OH 43065	16210114351
MCCAM ALLURE L L C	%E CAMPAGNA 460 S LA FLORESTA DR #118 BREA CA 92823	16204815421
MCCAM ALLURE L L C	%E CAMPAGNA 460 S LA FLORESTA DR #118 BREA CA 92823	16204815313
MCCAM ALLURE L L C	%E CAMPAGNA 460 S LA FLORESTA DR #118 BREA CA 92823	16204815342
MCCAM ALLURE L L C	%E CAMPAGNA 460 S LA FLORESTA DR #118 BREA CA 92823	16204815349
MCCAM ALLURE L L C	%E CAMPAGNA 460 S LA FLORESTA DR #118 BREA CA 92823	16204815350
MCCAM ALLURE L L C	%E CAMPAGNA 460 S LA FLORESTA DR #118 BREA CA 92823	16204815354
MCCAM ALLURE L L C	%E CAMPAGNA 460 S LA FLORESTA DR #118 BREA CA 92823	16204815392
MCCAM ALLURE L L C	%E CAMPAGNA 460 S LA FLORESTA DR #118 BREA CA 92823	16204815397
MCCAM ALLURE L L C	%E CAMPAGNA 460 S LA FLORESTA DR #118 BREA CA 92823	16204815404
MCCAM ALLURE L L C	%E CAMPAGNA 460 S LA FLORESTA DR #118 BREA CA 92823	16204815411
MCCAM ALLURE L L C	%E CAMPAGNA 460 S LA FLORESTA DR #118 BREA CA 92823	16204815235
MCCLAY ROBERT	200 W SAHARA AVE #1804 LAS VEGAS NV 89102-5052	16204815167
MCDONALD JAMES & MARGARET REV TR	MCDONALD JAMES JR & MARGARET TRS 44848 N KINGTREE AVE LANCASTER CA 93534-2237	16204815118
MCGOWAN ALEX	200 W SAHARA AVE #2705 LAS VEGAS NV 89102-5083	16204815275
MCMILLAN ALEXANDER & MARY	200 W SAHARA AVE #912 LAS VEGAS NV 89102-5070	16204815079
MEEKINS CORINA FAMILY TRUST	MEEKINS CORINA TRS 19135 SINGING WOOD DR ROWLAND HEIGHTS CA 91748-2265	16204815250
MENDOZA RAFAEL & NANCY	2305 SANTA PAULA DR LAS VEGAS NV 89104-2634	16203415016
MERRILL DEBRA M TRUST	MERRILL DEBRA M & GREGORY D TRS 5399 W HOOVER DR LITTLETON CO 80123	16210114024
MERTEL DEANNA D	7608 BLACKBIRD AVE LAS VEGAS NV 89145-5902	16203413034
MESHESKIY LEONID	FELDMAN LARISA 3347 ALGINET DR ENCINO CA 91436-4121	16204815286
MILLER LISA & PAUL	MILLER SHANNON 222 KAREN AVE #502W LAS VEGAS NV 89109-5233	16210114344
MINAI FAMILY TRUST	M & N FAMILY A B LIVING TRUST 26 POPPY HILLS RD LAGUNA NIGUEL CA 92677-1011	16210114139
MINAI FAMILY TRUST	MINAI MOHAMMAD H & MITRA A TRS 26 POPPY HILLS RD LAGUNA NIGUEL CA 92677-1011	16210114028

Report of All Selected Parcels**Case Number:** RQR-56788**Printed On:** Mon: December 15, 2014

Owner	Address	Parcel Number
MINAI MINA	MOVAFAGHI GOLNAZ 360 BOYLSTON ST #344D NEWTON CENTER MA 02459-2845	16210114030
MINAI MINA	MOVAFAGHI GOLNAZ 360 BOYSTON ST #344 D NEWTON CENTER MA 02459	16210114001
MINNELLA FAMILY TRUST	INNELLA FRANKLIN D & PENSRI TRS 200 W SAHARA AVE #2908 LAS VEGAS NV 89102	16204815302
MIRZAIE ANTHONY K	2731 S 1-35 SERVICE RD MOORE OK 73160	16210114284
MITCHELL CHRISTOPHER F & SANDRA	222 KAREN AVE #2308 LAS VEGAS NV 89109	16210114486
MOCK PROTECTION TRUST	MOCK JAMES TRS 200 W SAHARA AVE #2008 LAS VEGAS NV 89102-5076	16204815195
MODIANO FAMILY TRUST	MODIANO HAIM & ANI 1522 N RAYMOND AVE FULLERTON CA 92831-2054	16210114310
MOFFATT FAMILY TRUST	MOFFATT G E & JOY TRS 3101 PLAZA DE ERNESTO LAS VEGAS NV 89102-4022	16203411006
MOHAMMED SHIRLINA	1431 WIRT RD #109 HOUSTON TX 77055-4916	16204815292
MOK PETER T & CELESTE T	2713 EDEN LN MOUNTAIN VIEW CA 94040	16210114128
MOK PETER T & CELESTE T	2713 EDEN LN MOUNTAIN VIEW CA 94040	16210114006
MONTAGNA RONALD & MARIANNE	222 KAREN AVE #406 LAS VEGAS NV 89109-5233	16210114340
MONTAGUE MARILYN R	200 W SAHARA AVE #2604 LAS VEGAS NV 89102-5082	16204815262
MOORE NEIL J	14909 FIRST BAPTIST LN LAUREL MD 20707	16210114372
MORA MARIA	2309 SANTA PAULA DR LAS VEGAS NV 89104-2634	16203415017
MORENO LUIS & ROXANNE	5647 SPANISH VALOR RD LAS VEGAS NV 89135	16210114032
MORGAN NANCY	SANTELER CHRISTOPHER 25828 PASTORAL DR PLAINFIELD IL 60585	16210114045
MOSHAYEDI MANOUCHEHR	FAKHIMI BAHMAN 17 ROCHELLE NEWPORT BEACH CA 92657-0107	16210114297
MUENSTER RICHARD & SUSAN J	N67 W30825 CLUB CIRCLE E HATLAND WI 53029-9766	16210114534
MUSETTI LAURA T	YANES ADOLFO M P O BOX 7012 COTATI CA 94931-7012	16204815094
N L P TRUST	%NORTHERN TR ~ %A MARSCHIK 1995 VILLAGE CENTER CIR LAS VEGAS NV 89134-6237	16210114323
NA SANG W	322 KAREN AVE #701 LAS VEGAS NV 89109	16210114041
NADLER GLORIA	7 BETSY ROSS CT EAST BRUNSWICK NJ 08816-3264	16210114631
NAKAMOTO BRYAN & LAURIE M	2766 MANOA RD HONOLULU HI 96822-7700	16204815145
NANTAS PABLO B & SILVIA	NANTAS AMERICA M 1211 N COLE AVE LOS ANGELES CA 90038	16203414006
NATURE CREATION HOLDING CO L L C	5440 BLACK KNIGHT CIR LAS VEGAS NV 89119-1347	16203415023
NATURE CREATIONS L L C	5440 BLACK KNIGHT CIR LAS VEGAS NV 89119-1347	16203415021
NATURES CRÉATIONS	5440 BLACK KNIGHT CIR LAS VEGAS NV 89119-1347	16203415022
NEBAB NESTOR C	2075 CAMBRIDGE SPRINGS DR HENDERSON NV 89052-8753	16204815021
NEBUCHADNEZZAR INVESTMENTS L L C	211 S 70TH AVE W DULUTH MN 55807-1807	16204815146
NEST T T CORP	875 WEST END AVE #2E NEW YORK NY 10025-4951	16210114098
NGUYEN CHAFFEE & AMANDA FAM TR	NGUYEN CHAFFÉE C & AMANDA TRS 19709 FALCON CIR CERRITOS CA 90703-7714	16204815091

Report of All Selected Parcels**Case Number:** RQR-56788**Printed On:** Mon: December 15, 2014

<u>Owner</u>	<u>Address</u>	<u>Parcel Number</u>
NGUYEN TUAN ANH	200 W SAHARA AVE #3207 LAS VEGAS NV 89102-5088	16204815337
NIELD FLORENCE O LIVING TRUST	NIELD FLORENCE O TRS 2305 SANTA RITA DR LAS VEGAS NV 89104-2638	16203416012
NOONAN ANTHONY S IRA L L C	P O BOX 6898 INCLINE VILLAGE NV 89450	16210114086
NORRIS MERLE & SARA	322 KAREN AVE #1905 LAS VEGAS NV 89109	16210114133
OBAGI ZEIN & SAMAR	270 N CANNON DR #100 BEVERLY HILLS CA 90210-9395	16210114612
OH YOUNG KHAN	200 W SAHARA AVE #3402 LAS VEGAS NV 89102-5090	16204815356
O'KELLEY JOSEPH B	6092 HONEYGROVE AVE LAS VEGAS NV 89110-1887	16203414014
OROZCO PETE	221 W SHERWOOD DR HENDERSON NV 89015-7713	16203414009
ORR JAMES J	322 KAREN AVE #3508 LAS VEGAS NV 89109	16210114258
ORTEGA EVELYN TORRES & ALBERTO	12 GEORGE RUSSELL WY CLIFTON NJ 07013-2600	16204815208
ORTIZ RAMONITA H	2112 SANTA CLARA DR LAS VEGAS NV 89104-2615	16203413038
OSHTORY MONISHA	2408 BONNIEBROOK DR STOCKTON CA 95207-1524	16210114316
OSKAMP MARY WANG	199 CALIFORNIA DR #200 MILLBRAE CA 94030	16210114440
OSROW DOUG	322 KAREN AVE #2902 LAS VEGAS NV 89109	16210114228
O'SULLIVAN BARBARA	322 KAREN AVE #603 LAS VEGAS NV 89109-0418	16210114035
OTTENWELLER MATTHEW & JANET L	1301 WALL ST W #4209 LYNDHURST nj 07071	16204815280
OXFORD TECHNOLOGY INC	5010 VALLEY VIEW BLVD #B1 LAS VEGAS NV 89118-1705	16204813050
OXFORD TECHNOLOGY INC	5010 S VALLEY VIEW BLVD LAS VEGAS NV 89118-1705	16204813065
OXFORD TECHNOLOGY INC	5010 S VALLEY VIEW LAS VEGAS NV 89118-1705	16204813072
OXFORD TECHNOLOGY INC	5010 S VALLEY VIEW BLVD LAS VEGAS NV 89118-1705	16204813048
OXFORD TECHNOLOGY INC	5010 S VALLEY VIEW LAS VEGAS NV 89118-1705	16204813074
OXFORD TECHNOLOGY INC	5010 S VALLEY VIEW BLVD LAS VEGAS NV 89118-1705	16204813066
OXFORD TECHNOLOGY INC	5010 S VALLEY VIEW LAS VEGAS NV 89118-1705	16204813046
OXFORD TECHNOLOGY INC	5010 S VALLEY VIEW LAS VEGAS NV 89118-1705	16204813068
OXFORD TECHNOLOGY INC	5010 S VALLEY VIEW BLVD LAS VEGAS NV 89118-1705	16204813064
OXFORD TECHNOLOGY INC	5010 S VALLEY VIEW LAS VEGAS NV 89118-1705	16204813047
OXFORD TECHNOLOGY INC	5010 S VALLEY VIEW LAS VEGAS NV 89118-1705	16204813069
OXFORD TECHNOLOGY INC	5010 S VALLEY VIEW LAS VEGAS NV 89118-1705	16204813067
OXFORD TECHNOLOGY INC	5010 S VALLEY VIEW BLVD LAS VEGAS NV 89118-1705	16204813049
P F E VENTURES L L C	3651 LINDELL RD #D160 LAS VEGAS NV 89103-1254	16204815388
P F E VENTURES SUB 3 L L C	3651 LINDELL RD #D160 LAS VEGAS NV 89103-1254	16204815376
PACE INTERNATIONAL LTD	%P ZHAO 6116 185TH ST FRESH MEADOWS NY 11365	16210114359

Report of All Selected Parcels**Case Number:** RQR-56788**Printed On:** Mon: December 15, 2014

Owner	Address	Parcel Number
PAK MYONG HO & TAI SUN	200 W SAHARA AVE #3906 LAS VEGAS NV 89102	16204815418
PAK TAISUN & MYONGHO	200 W SAHARA AVE #3906 LAS VEGAS NV 89102	16204815038
PALECEK ROGER L	FREDRICKS ELIZABETH A 717 CRESTHAVEN DR COTTAGE GROVE WI 53527-9679	16204815139
PALE CZNY DANIEL T	2213 SANTA PAULA DR LAS VEGAS NV 89104-2633	16203415013
PAN WARREN H	2 W DELAWARE PL #1808 CHICAGO IL 60610-3411	16210114059
PANORA ROBERT ANTHONY	SPENCER SUNIA 55 CLIFTON ST #2 CAMBRIDGE MA 02140-2428	16204815408
PAN-YU L L C	322 KAREN AVE #1107 LAS VEGAS NV 89109-0424	16210114079
PAOLO VICTOR	P O BOX 1535 MILLBROOK NY 12545-1535	16204815104
PAPAGLOS GUS & KAREN	37635 VIA MAJORCA MURRIETA CA 92562	16204815295
PAPP KLARA TRUST	PAPP KLARA TRS P O BOX 343 LAS VEGAS NV 89125-0343	16203413031
PARADISE L V HOLDINGS L L C	3790 PARADISE RD #250 LAS VEGAS NV 89169-4640	16203411012
PARADISE LAND L L C	P O BOX 1354 CHICAGO IL 60690-1354	16210101004
PARADISE LAND L L C	P O BOX 1354 CHICAGO IL 60690	16210101005
PARADISE PLAZA L L C	11845 W OLYMPIC BLVD #1265W LOS ANGELES CA 90064-5083	16203413022
PARADISE PLAZA L L C	11845 W OLYMPIC BLVD #1265W LOS ANGELES CA 90064-5083	16203413021
PARADISE ROAD TRUST	8247 TURTLE CREEK LAS VEGAS NV 89113-0132	16203413017
PARK HAN K & YOUNG S	5325 MONTOYA DR EL PASO TX 79932-2534	16210114042
PARRIS ROBINSON EASTERN L L C	120 PRESIDENTIAL WAY #300 WOBURN MA 01801	16204812002
PATEL AVKASH	1195 BURNHAM DR SAN JOSE CA 95132	16203414020
PATEL AVKASH	1195 BURNHAM DR SAN JOSE CA 95132	16203414021
PATEL AVKASH	1195 BURNHAM DR SAN JOSE CA 95132	16203414022
PAULSON DARRELL TIMOTHY	2227 W PARK ROW DR #A PANTEGO TX 76013-3485	16210114313
PAZ RICARDO & DALIT	PAZ ARIE & ELENA %PAZ GLOBAL REAL EST 19495 BISCAYNE BLVD AVENTURA FL 33180-2318	16204815185
PEARSON M CURTIS	P O BOX 963 MABLETON GA 30126-0963	16204815127
PELED ORI	222 KAREN AVE #1906 LAS VEGAS NV 89109-5303	16210114033
PELED ORI	222 KAREN AVE #1906W LAS VEGAS NV 89109-5303	16210114452
PERFECT DEAL L L C	3235 ROSANNA ST LAS VEGAS NV 89117	16203415009
PHAM JOHNNY Q	6105 OAK MEADOWS CT MIDLAND MI 48640-1973	16204815084
PHANTASTICS DEAL L L C	P LAM 3235 ROSANNA ST LAS VEGAS NV 89117	16203414037
PHANTASTICS DEAL L L C	P LAM 3235 ROSANNA ST LAS VEGAS NV 89117	16203414007
PHILLIPS MARK	916 FINCH AVE HIGH POINT NC 27263	16204815377
PICKERELL DAVID A	200 W SAHARA AVE #1006 LAS VEGAS NV 89102	16204815189

Report of All Selected Parcels**Case Number:** RQR-56788**Printed On:** Mon: December 15, 2014

<u>Owner</u>	<u>Address</u>	<u>Parcel Number</u>
PINEDA MILLET	3234 ALAMEDA ST PASADENA CA 91107	16210114012
PISANELLI JAMES J	400 S 7TH ST #300 LAS VEGAS NV 89101	16210114282
POLIFRON DOUG & PAMELA C	88 LENOX RD WAYNE NJ 07470-5551	16210114054
POLL FAMILY TRUST	POLL ROBERT ALLEN & GAIL D TRS 2877 PARADISE RD #3203 LAS VEGAS NV 89109-5268	16210114026
POLLARD BRANT & CAROL	2887 MARGARITA PL CORVALLIS OR 97330-3461	16210114468
POPOVIC DRAGOLJUB & FADILA	2214 SANTA CLARA DR LAS VEGAS NV 89104-2644	16203413033
POSERIA HARSHVARDHAN	322 KAREN AVE #2108 LAS VEGAS NV 89109	16210114152
PRANGLE MIKE	142 AKENSIDE RD RIVERSIDE IL 60546-1811	16204815162
PRARTNADI SUPRADIT ADAM	VELUZ MARIETTA 17910 BURBANK BLVD #113 ENCINO CA 91316-1660	16210114396
PRASAD RAJENDRA & BRINDA	200 W SAHARA AVE #810 LAS VEGAS NV 89102	16204815065
PRELLER DAVID	14902 LIVE OAK SPRINGS CANYON RD CANYON COUNTRY CA 91387-4802	16210114126
PRODUS INVESTMENTS L L C	%S YI 2850 E VERNON AVE VERNON CA 90058-1804	16210114209
PUCKETT TIM	200 W SAHARA AVE #3605 LAS VEGAS NV 89102	16204815383
PULIDO FRANCISCO MACHADO	10305 N W 41ST #215 DORAL FL 33178-2976	16204815073
QUIRK/GOODEN FAMILY TRUST ETAL	GOODEN ALETHEIA S TRS 11269 SULPHER MOUNTAIN RD OJAI CA 93023-8316	16204815321
R A M - S P M L L C	8255 S LAS VEGAS BLVD #1019 LAS VEGAS NV 89123	16204815174
R A M-S P M L L C	8255 S LAS VEGAS BLVD #1019 LAS VEGAS NV 89123-1078	16204815389
R A M-S P M L L C-ALLURE 2510	8255 S LAS VEGAS BLVD #1019 LAS VEGAS NV 89123	16204815256
R K D A 2 L L C	2598 E BEECHNUT CT CHANDLER AZ 85249-3514	16210114021
R R K A L L C	%R AHLUWALIA 6672 ALAMITOS CIR HUNTINGTON BEACH CA 92648-1537	16210114241
RAEZ AGNES	MESSINGER ERWIN 2457 DESERT SANDS DR LAS VEGAS NV 89134-8864	16203414017
RAHIMI ALI R & MARGARET A	200 W SAHARA #507 LAS VEGAS NV 89102-5098	16204815034
RAHMAN UPAL & MASHIUR	%IIM INC 2850 HORIZON RIDGE PKWY #200 HENDERSON NV 89052-4395	16204815109
RAHMAT-SAMII YAHYA	HAMIDIEH LAYLA 4509 TOBIAS AVE SHERMAN OAKS CA 91403-2822	16210114166
RAJSUMAN ROCHIT	990 JULIET AVE SAN JOSE CA 95127-3622	16204815317
RAVAN HAMID & CHRISTINE	RAVAN ROBIN 850 LOMA VISTA DR BEVERLY HILLS CA 90210-2920	16210114056
RAZI OMID	RAZI B & M TRUST 435 TROUSDALE PL BEVERLY HILLS CA 90210-1903	16210114235
REARDON MARK	21146 JASMINE WAY LAKE FOREST CA 92630	16210114414
REAVES LISA M	200 W SAHARA AVE #802 LAS VEGAS NV 89102-5072	16204815057
RECTOR TONY KEMP	322 KAREN AVE #4207 LAS VEGAS NV 89109-0457	16210114231
RECTOR TONY KEMP	322 KAREN AVE #4207 LAS VEGAS NV 89109-0457	16210114299
REDDY SHRUTI	848 N RAINBOW BLVD #1474 LAS VEGAS NV 89107-1103	16204815306

Report of All Selected Parcels**Case Number:** RQR-56788**Printed On:** Mon: December 15, 2014

Owner	Address	Parcel Number
REEVE ROBERT C & KAREN C	3111 MONTE ROSA AVE LAS VEGAS NV 89120-3041	16203413004
REFUA PROPERTIES L L C	AVENIDA DE LAS AGUILAS #271 CASA 4 TECHMACHALCO 53950 MEXICO	16204815093
REISINGER SUSAN A	BARAL LANCE A 2304 CEDARDALE PL LAS VEGAS NV 89134-6719	16204815332
REMPLE ROBERT	P O BOX 2604 BELLINGHAM WA 98227-2604	16204815259
RESTREPO PATRICIA	BEATRIZ GLORIA 3100 NE 48TH ST #805 FT LAUDERDALE FL 33308-4948	16204815095
RHEE HAK EUN & SONG CHA TRUST	RHEE HAK E & SONG CHA TRS 8908 RAINBOW RIDGE DR LAS VEGAS NV 89117-5816	16203413002
RICHERT ALAN M	2321 SANTA RITA DR #2 LAS VEGAS NV 89104-2652	16203416021
RIMAN RAMI	ZAGORSKY DANIELLE 2915 W 5TH ST #16C BROOKLYN NY 11224-3913	16204815180
ROBINSON DONNA K	BALLOU LAURA K 2213 PARADISE RD LAS VEGAS NV 89104-2514	16203413019
ROBINSON MARY KAY	120 PRESIDENTIAL WAY #300 WOBURN MA 01801	16204812003
RODGERS JERRY	4209 CAPILLA ST FORT WORTH TX 76133-5421	16204815417
ROGERS BRYAN R SEPARATE PPTY TR	%B ROGERS 222 KAREN AVE #3707 LAS VEGAS NV 89109	16210114587
ROGERS BRYAN SEPARATE PPTY TR	ROGERS BRYAN R TRS 222 KAREN AVE #3701 LAS VEGAS NV 89109	16210114583
ROGERS ROBERT ALAN	2121 SANTA CLARA DR LAS VEGAS NV 89104-2614	16203414008
ROHANI PARSA J	ARJOMAND HOSSIEN AMIR 673 MYSTIC WY LAGUNA BEACH CA 92651-1924	16210114246
ROHLFS H WARREN & TATIANA	322 KAREN AVE #2207 LAS VEGAS NV 89109-0435	16210114159
ROMERO JORGE JRS L P	RODRIGUEZ JESSE A 18854 STONE CANYON LN SANTA CLARITA CA 91351-5026	16210114188
ROOSE DON	7013 ROCKLYN CIR URBANDEALE IA 50322-4866	16204815226
ROSS DAVID H	322 KAREN AVE #3205 LAS VEGAS NV 89109-0447	16210114237
ROSS LAUREN	WILLIS JEFF L 16060 COMET WAY CANYON COUNTRY CA 91387	16210114095
ROSSI ANTHONY	2316 ATLANTIC AVE ATLANTIC CITY NJ 08401-6619	16210114004
ROST JOHN	222 KAREN AVE #4502 LAS VEGAS NV 89109	16210114632
ROTH PATRICIA A	200 W SAHARA #3602 LAS VEGAS NV 89102-5092	16204815380
ROUHI ROB	3240 CORAL HARBOR DR LAS VEGAS NV 89117	16203415031
ROZELL ERIK SCOTT & TOMKORIA A K	TOMKORIA ANITA TRS 154 SIDNEY BAY DR NEWPORT COAST CA 92657	16210114477
RUBIN SCOTT A	322 KAREN AVE #1607 LAS VEGAS NV 89109-0431	16210114111
RUDOLPH JOSEPH & DOROTHY	222 KAREN AVE #3304 LAS VEGAS NV 89109	16210114561
RUMELT DANIEL	KLASS KATHIE 3972 GEORGETOWN CT N W WASHINGTON DC 20007-2127	16204815153
RUPPE EDWARD & DIANE	P O BOX 837 RUTHERFORDTON NC 28139	16210114545
RUTENBERG EMIL REVOCABLE LIV TR	RUTENBERG ARLENE REVOCABLE LIV T 719 S LOS ANGELES ST #718 LOS ANGELES CA 90014	16210114226
S & J REALTY L L C	%H & J LEE 30 CLUB CT ROSLYN HARBOUR NY 11576-1002	16204815150
S & J REALTY L L C	%H & J LEE 30 CLUB CT ROSLYN HARBOUR NY 11576-1002	16204815072

Report of All Selected Parcels**Case Number:** RQR-56788**Printed On:** Mon: December 15, 2014

<u>Owner</u>	<u>Address</u>	<u>Parcel Number</u>
S & J REALTY L L C	%H & J LEE 30 CLUB CT ROSLYN HARBOUR NY 11576-1002	16204815252
S W W DESIGN INVESTMENTS INC	222 KAREN AVE #1907 LAS VEGAS NV 89109	16210114552
SAHARA DEVELOPMENT L L C	299 S MAIN ST #2200 SALT LAKE CITY UT 84111	16204813070
SAHARA DEVELOPMENT L L C	299 S MAIN ST #2200 SALT LAKE CITY UT 84111	16204813071
SAHARA DEVELOPMENT L L C	299 S MAIN ST #2200 SALT LAKE CITY UT 84111	16203410008
SAHARA LAS VEGAS CORP	P O BOX 270820 LAS VEGAS NV 89127-4820	16209602005
SAHARA LAS VEGAS CORP	P O BOX 270820 LAS VEGAS NV 89127-4820	16209602001
SAHARA MEADOWS PROPERTIES INC	2200 LAS VEGAS BLVD S LAS VEGAS NV 89104-2527	16204813083
SAHOQ ANANDAMOY & TANNY	313 RIVERSHIRE CT LINCOLNSHIRE IL 60069	16210114141
SAHOTA SOMRATH SINGH	1430 N HARPER AVE #407 WEST HOLLYWOOD CA 90046-8416	16210114293
SALEH TIMARIO TRUST	SALEH ARYA TRS 2395 BUCKINGHAM LN LOS ANGELES CA 90077-1339	16204815233
SALEH TIMARIO TRUST	SALEH ARYA TRS 2395 BUCKINGHAM LN LOS ANGELES CA 90077-1339	16204815114
SALTER JAMES BERNARD	KEEVER PATRICIA SALTER 222 KAREN AVE #1607 LAS VEGAS NV 89109	16210114429
SAM RENTALS L L C	2208 VAN PATTEN PL LAS VEGAS NV 89104-2754	16203414039
SAMMAN BASHAR	JUNDI-SAMMAN RANDA 4950 LAKESHORE RD FORT GRARIET MD 48059-3539	16210114105
SAMMARCO DANIEL PETER	P O BOX 97092 LAS VEGAS NV 89193	16210114019
SAMUDRO STEPHANIE	37 LONG BAY DR NEWPORT BEACH CA 92660	16210114158
SAMWORTH SHERYL L 2014 REVOCABLE	SAMWORTH SHERYL L TRS 27389 PARKLANE WAY VALENCIA CA 91354	16204815297
SANCHEZ LUIS	14911 DON JULIAN RD CITY OF INDUSTRY CA 91746-3112	16210114180
SANCHEZ PRAXEDIS CELESTINO M	2216 SANTA RITA DR LAS VEGAS NV 89104-2623	16203415032
SANGHA KULJIT	254 N SAGEMORE ST ANAHEIM CA 92807-2811	16210114110
SAPPER MARY Y REVOCABLE TRUST	SAPPER MARY Y TRS 4171 COUNTRY WALK LN TURLOCK CA 95382-7450	16210114630
SCALA JOSEPH	%COURTESY G M C 6401 CENTENNIAL CENTER BLVD LAS VEGAS NV 89149-4532	16210114270
SCHAFFER GARY A & JOANNE	8788 HIDDEN FARM RD ALTA LOMA CA 91701-1432	16210114148
SCHAFFER RICHARD W	22261 KITTERY CIR HUNTINGTON BEACH CA 92646-8426	16210114060
SCHÉUFLEER PATRICK A & PATRICK J	323 SPRECKELS DR #A APTOS CA 95003-3974	16210114267
SCHMIDT MANFRED E	OCHOA MARTHA L %A PEREZ 3537 N W 61ST CIR BOCA RATON FL 33496-4002	16204815204
SCHWAB CORY W	222 KAREN AVE #606 LAS VEGAS NV 89101	16210114356
SCHWARTZ DANIEL M	322 KAREN AVE #3505 LAS VEGAS NV 89109	16210114256
SCHWARTZ ROBERT D	322 KAREN AVE #2702 LAS VEGAS NV 89109-0441	16210114194
SELECTIVE HOLDINGS L L C	%M/M W CHAPMAN 5507 MEADOWS DEL MAR SAN DIEGO CA 92130-4865	16204815402
SEYBOTH WILLIAM G	SCHMIDT SANDRA R 4719 N W COVES DR KANSAS CITY MO 64151-1140	16210114077

Report of All Selected Parcels**Case Number:** RQR-56788**Printed On:** Mon: December 15, 2014

Owner	Address	Parcel Number
SHAH CHANDRAKANT N & KIMBERLY	PATEL KANTI S & MANJU K 112 OLDE ASH LN CHARLESTON WV 25311-1700	16204815242
SHAPIRO LEONARD B	3335 TURTLE HEAD PEAK DR LAS VEGAS NV 89135-1677	16210114482
SHARGANI PROPERTIES L L C	%C SHARGANI 12121 WILSHIRE BLVD #1012 LOS ANGELES CA 90025-1176	16210114278
SHARK L L C	%A ROSENBERG 133 WINDWATCH DR HAUPPAUGE NY 11788-3351	16210114049
SHARPE STEPHEN R	P O BOX 1164 DOWNEY CA 90240-0164	16204815232
SHEN IRENE B	9 WYCKHAM HILL LN GREENWICH CT 06831-3049	16210114315
SHEN JIANZHONG	200 W SAHARA AVE #1112 LAS VEGAS NV 89102-5070	16204815159
SHIN KWANG HO LIVING TRUST	SHIN KWANG HO & INSOOK J TRS 69 GREENAWAY RD AMHERST NY 14226-4111	16210114279
SHIN SANG HO	2681 N FLAMINGO RD #2608 SUNRISE FL 33323-1778	16210114100
SHUBERT WILLIAM E	2117 WILLIAMSBRIDGE RD BRONX NY 10461-1601	16210114094
SHYNK JOHN J & TOKIE L	P O BOX 55 SANTA BARBARA CA 93102	16204815243
SIGNH BALBIR	2370 SPRING MEADOW DR CHINO HILLS CA 91709-1725	16210114307
SIMON PAMELA & JEFFREY	771 VALLEY RD GLENCOE IL 60022-1503	16204815141
SINCLAIR 3507 L L C	P O BOX 93663 LAS VEGAS NV 89193-3663	16204815373
SINCLAIR 3507 L L C	P O BOX 93663 LAS VEGAS NV 89193-3663	16204815202
SINCLAIR 3507 L L C	P O BOX 93663 LAS VEGAS NV 89193-3663	16204815336
SINGH JAIRAM & ROSE-MARIE	200 W SAHARA AVE #1410 LAS VEGAS NV 89102-5058	16204815125
SMITH CHRISTOPHER	200 W SAHARA AVE #3908 LAS VEGAS NV 89102-5095	16204815420
SMITH IRMCA SONJA	222 KAREN AVE #1201 LAS VEGAS NV 89109	16210114399
SMITH LARRY KIM	7510 APPLGATE DR HELENA MT 59602-8195	16204815022
SMITH MATTHEW A	WIENER-NATION BENJAMIN 1144 E CHARLESTON BLVD #110 LAS VEGAS NV 89104	16203416014
SNOW EVANGELINA	200 W SAHARA AVE #2202 LAS VEGAS NV 89102	16204815213
SOEPRONO HESRI ERMIN & NITAYA	2215 JOHN MATICH DR COLTON CA 92324-9513	16204815351
SON EUN HEE	KIM MOO KWON 13155 PINNACLE CT CHINO HILLS CA 91709-1177	16210114154
SONG HOWARD	86 MAPLETON IRVINE CA 92620	16204815088
SONG NATHAN NUAN	LEE CHIARU LISA 1646 ALBATROSS WAY ROCKLIN CA 95765	16210114076
SONI VINEY & JAY	2324 PORT DURNESS PL NEWPORT BEACH CA 92660-6804	16210114248
SPINNATO JOHN D & BETH L	2640 SOLAR CORONA LN HENDERSON NV 89044	16210114554
STANTON MICHAEL REV TR 2012	LINSK MICHAEL STANTON TRS 5290 OBANNON DR LAS VEGAS NV 89146-3342	16204815052
STANTON MICHAEL REV TR 2012	LINSK MICHAEL STANTON TRS 5290 O'BANNON DR LAS VEGAS NV 89146-3342	16204815339
STARK PATRICK & LISA MARIE	16231 WOODSTOCK LN HUNTINGTON BEACH CA 92647-3235	16204815116
STEPHENS GARY	SAFFRIN STUART 22500 CALVERT ST WOODLAND HILLS CA 91367-1704	16204815318

Report of All Selected Parcels**Case Number:** RQR-56788**Printed On:** Mon: December 15, 2014

<u>Owner</u>	<u>Address</u>	<u>Parcel Number</u>
STIERS THOMAS & DEANNA	9438 U S HIGHWAY 19 #144 PORT RICHEY FL 34668	16204815029
STOCKBRIDGE S B E HOLDINGS L L C	8000 BEVERLY BLVD LOS ANGELES CA 90048-4504	16209502001
STOUT HELEN KAY LIVING TRUST	STOUT HELEN KAY TRS 200 W SAHARA AVE #2311 LAS VEGAS NV 89102-5079	16204815234
STRAUSS JASON	2857 PARADISE RD #2203 LAS VEGAS NV 89109	16210114371
STRONG TRACY	200 W SAHARA AVE #1010 LAS VEGAS NV 89102	16204815089
STRZEMP JOHN TRUST	STRAEMP JOHN TRS 200 W SAHARA AVE #3506 LAS VEGAS NV 89102	16204815372
STUBBS DANIEL & LINDA TRUST	STUBBS DANIEL B & LINDA D TRS 322 KAREN AVE #2308 LAS VEGAS NV 89109-0437	16210114168
STUBBS SUZANNE & ALAN	222 KAREN AVE #2707 LAS VEGAS NV 89109	16210114517
SUBOTIC NEBOJSA	2465 ALA WAI BLVD PH2 HONOLULU HI 96815-3489	16204815142
SUN & LY FAMILY TRUST	SUN JAMES CHANG MING TRS 2772 WHIPPOORWILL DR ROWLAND HEIGHTS CA 91748-4785	16204815193
SUN & LY FAMILY TRUST	SUN JAMES CHANG MING TRS 2772 WHIPPOORWILL DR ROWLAND HEIGHTS CA 91748-4785	16204815209
SUN JACOB JIYANG & LEON LILIANG	6329 LONG COVE DR FONTANA CA 92336	16204815241
SUN SUSIE FENG-I	202 MIDVALE IRVINE ca 92620	16204815137
SUN TINA FENG-PEI	66 SOMERTON IRVINE CA 92620	16204815138
SUNG SAMMY KUO CHIANG	WANG XIAO YAN 1060 WINDJAMMER CIR FOSTER CITY CA 94404-3057	16204815049
SUNWEST TRUST INC	SWANK SCOTT IRA P O BOX 36371 ALBUQUERQUE NM 87176	16203415015
SW & SH FAMILY TRUST	PARK SUNG WON & SOON HI TRS 322 KAREN AVE #2502 LAS VEGAS NV 89109-0438	16210114178
SWANSON LELAND A REV LIV TR	SWANSON LELAND A TRS P O BOX 148 FARGO ND 58107-0148	16210114513
SWANSON LELAND A REV LIV TR	SWANSON LELAND A TRS P O BOX 148 FARGO ND 58107-0148	16210114629
SYRIUS PROPERTIES SERIES 1	AMMAR TAREK TRS %T AMMAR 322 KAREN AVE #3307 LAS VEGAS NV 89109	16210114099
T A J TRUST	DANESHFOROUZ MAJID TRS 2201 PARADISE RD LAS VEGAS NV 89104-2515	16203413016
T A M S CONNECTION L P	5201 MARINERS DR PLANO TX 75093-2506	16210114295
TAJIBOY PAULITA 2011 REV LIV TR	TAJIBOY PAULITA TRS 19706 HATTON ST WINNETKA CA 91306-2611	16204815031
TAMADDONI HAIDEH TOOTOONCHI	3627 CALLE JOAQUIN CALABASAS CA 91302	16210114198
TAN RAYMUNDO T REVOCABLE TRUST	TAN MARIA Y REVOCABLE TRUST 4525 DEAN MARTIN DR #1900 LAS VEGAS NV 89103-8116	16204815231
TAN YEE HUA	322 KAREN AVE 4105 LAS VEGAS NV 89109	16210114292
TANG SAMPSON O & ROSE	68 DORADO TERR SAN FRANCISCO CA 94112-1741	16210114124
TANO GENKO & MAXINE ANN	222 KAREN AVE #1806 LAS VEGAS NV 89109-5303	16210114444
TARANTO JAMES V	1450 W FULLERTON CHICAGO IL 60614-2031	16203414036
TARANTO JAMES V	1450 W FULLERTON AVE CHICAGO IL 60614-2031	16203414010
TASSIN JAY	DANNINGER BRENT 1001 W 17TH ST AUSTIN TX 78701-1008	16204815105
TAWGIN JOHN S	1070 BARNEGAT LN MANTOLOKING NJ 08738-1620	16210114138

Report of All Selected Parcels**Case Number:** RQR-56788**Printed On:** Mon: December 15, 2014

Owner	Address	Parcel Number
TAWIL OLGA	2064 OCEAN PKWY BROOKLYN NY 11223-4045	16204815106
TAWIL OLGA	2064 OCEAN PKWY BROOKLYN NY 11223-4045	16204815048
TAY GABRIEL KENG-MENG	LAI CHIEN-HUA 222 KAREN AVE #1808 LAS VEGAS NV 89109-5303	16210114446
TECHO SAM M D & C SAKUNASING	P O BOX 4007626 LAS VEGAS NV 89140	16210114343
TEO LEEP KOON	222 KAREN AVE #1203 LAS VEGAS NV 89109-5310	16210114401
THOMAS JOHN	P O BOX 4766 SAN CLEMENTE CA 92674-4766	16210114560
THOMPSON DAVID K TRUST	THOMPSON DAVID K TRS 322 KAREN AVE #2904 LAS VEGAS NV 89109	16210114212
THOMSON D & J REVOCABLE TRUST	THOMSON JAMES A & DARLENE TRS 2940 NEILSON WY #501 SANTA MONICA CA 90405-5371	16210114040
TJANDRANEGARA ELEANA	GAERLAN ERICA & FILBERT 631 FOLSOM ST #PHA SAN FRANCISCO CA 94107-3609	16204815164
TORELLI VIVIAN L	7453 COASTAL VIEW DR LOS ANGELES CA 90045	16210114464
TRAN NU T	5202 RIBLET VIEW LN SPOKANE WA 99212-1774	16210114434
TRAVEN ELENA G TRUST	TRAVEN ELENA G TRS 249 ALPINE ST #49 PASADENA CA 91106-4720	16210114046
TRUSTEE CLARK COUNTY TREASURER	%ESPIRITU EDGARD F & ANNA MARIE 1078 CANYON CREEK TERR FREMONT CA 94536-1800	16210114053
TRUSTEE CLARK COUNTY TREASURER	9762 SILVER DESERT AVE LAS VEGAS NV 89148-4681	16203415012
TRUSTEE CLARK COUNTY TREASURER	%KEE EU BENG 2 JALAN TAMAN THE ABERDEEN SINGAPORE 329023 SINGAPORE	16204815279
TRUSTEE CLARK COUNTY TREASURER	%CRANE JOSHUA 322 KAREN AVE #902 LAS VEGAS NV 89109-0421	16210114058
TSAI TERRY	HUANG STELLA 222 KAREN AVE #506 LAS VEGAS NV 89109	16210114348
TSAO STEPHEN & MAJE	4881 S TORREY PINES DR #106 LAS VEGAS NV 89103	16204815017
TURNBERRY 2001 L L C	%D ROSOW 123 WHITING ST #R PLAINVILLE CT 06062-2889	16210114137
TURNBERRY TOWERS EAST #4502 LLC	%E PACE 375 S 300 W SALT LAKE CITY UT 84101	16210114314
TURNBERRY TOWERS EAST 1705 L L C	%E PACE 2258 TEXAS SPRINGS RD NEW BRAUNFELS TX 78132	16210114117
TURNER ROBERT JR & KIMBERLY J	5415 S JASPER WY CENTENNIAL CO 80015-4225	16210114018
TYOMKIN 2012 TRUST	TYOMKIN IZAI & ASYA TRS 611 9TH ST #3 SANTA MONICA CA 90402-2838	16210114170
TYRE R & C HOLDINGS TRUST	TYRE ROBERT D & CARYN K TRS 2777 PARADISE RD #3502 LAS VEGAS NV 89109-9125	16210114550
UNITED INVESTMENTS L L C	%J KWAN 5000 S DECATUR LAS VEGAS NV 89118	16210114183
URDANETA LUIS E	72 CALLE RES VIRGINIA COUNTRY #9 MIAMI FL 33156	16204815216
VANDEVOORT JOEL & MARTHA REV TR	VANDEVOORT JOEL K & MARTHA J TRS 2877 PARADISE RD #302 LAS VEGAS NV 89109-5239	16210114008
VEGAS CONSTRUCTION L L C	9803 SAN FERNANDO RD PACOLMA CA 91331-2604	16204813110
VEGAS WEST RE L L C	P O BOX 945 ALIEF TX 77411	16204815196
VERSI GAVIN	200 W SAHARA AVE #1911 LAS VEGAS NV 89102	16204815058
VERSI GAVIN AMIR	200 W SAHARA AVE #1911 LAS VEGAS NV 89102-5075	16204815186
VETTER DOUG G	506 HILL ST SAN FRANCISCO CA 94114-2813	16204815194

Report of All Selected Parcels**Case Number:** RQR-56788**Printed On:** Mon: December 15, 2014

<u>Owner</u>	<u>Address</u>	<u>Parcel Number</u>
NETTER DOUGLAS G	506 HILL ST SAN FRANCISCO CA 94114-2813	16204815240
VIDOR ROBYN REVOCABLE TRUST	VIDOR ROBYN M & LUKE W TRS 14801 THICKET LN DAYTON MN 55327-9445	16210114224
VIGIL CELAURO & JUANA	2312 N HOBART BLVD LOS ANGELES CA 90027-1067	16210114122
VINTAGE LAND HOLDINGS II L L C	3600 LAS VEGAS BLVD S LAS VEGAS NV 89109-4303	16209510002
VITALE ANTHONY P	1590 WOODBINE CT LIBERTY MO 64068-3548	16204815258
VOLZ MICHAEL A & LAURA S	6189 S NEWARK WY ENGLEWOOD CO 80111-5852	16210114625
VOLZ STEVEN R	KLATT KAREN T N76 W16281 BRIAN CT MENOMONEE FALLS WI 53051	16210114185
VONDERAHE KAREN	322 KAREN AVE #3208 LAS VEGAS NV 89109	16210114240
VUCCI VEGAS L L C	1131 MAJESTIC CANYON ST HENDERSON NV 89052	16210114296
W2007 STRATOSPHERE LAND PROPCO	2000 S LAS VEGAS BLVD LAS VEGAS NV 89104-2507	16203411003
W2007 STRATOSPHERE LAND PROPCO	2000 S LAS VEGAS BLVD LAS VEGAS NV 89104-2507	16203410004
W2007 STRATOSPHERE LAND PROPCO	2000 S LAS VEGAS BLVD LAS VEGAS NV 89104-2507	16203411005
W2007 STRATOSPHERE LAND PROPCO	2000 S LAS VEGAS BLVD LAS VEGAS NV 89104-2507	16203410003
W2007 STRATOSPHERE LAND PROPCO	2000 S LAS VEGAS BLVD LAS VEGAS NV 89104-2507	16203411004
W2007 STRATOSPHERE LAND PROPCO	2000 S LAS VEGAS BLVD LAS VEGAS NV 89104-2507	16203410002
W2007 STRATOSPHERE LAND PROPCO	2000 S LAS VEGAS BLVD LAS VEGAS NV 89104-2507	16203410001
W2007 STRATOSPHERE PROPCO L L C	2000 S LAS VEGAS BLVD LAS VEGAS NV 89104-2507	16204813087
W2007 STRATOSPHERE PROPCO L L C	2000 S LAS VEGAS BLVD LAS VEGAS NV 89104-2507	16204813088
W2007 STRATOSPHERE PROPCO L L C	2000 S LAS VEGAS BLVD LAS VEGAS NV 89104-2507	16204813060
W2007 STRATOSPHERE PROPCO L L C	2000 S LAS VEGAS BLVD LAS VEGAS NV 89104-2507	16204813096
W2007 STRATOSPHERE PROPCO L L C	2000 S LAS VEGAS BLVD LAS VEGAS NV 89104-2507	16203301016
W2007 STRATOSPHERE PROPCO L L C	2000 S LAS VEGAS BLVD LAS VEGAS NV 89104-2507	16204710047
W2007 STRATOSPHERE PROPCO L L C	2000 S LAS VEGAS BLVD LAS VEGAS NV 89104-2507	16203401001
W2007 STRATOSPHERE PROPCO L L C	2000 S LAS VEGAS BLVD LAS VEGAS NV 89104-2507	16204710046
W2007 STRATOSPHERE PROPCO L L C	2000 S LAS VEGAS BLVD LAS VEGAS NV 89104-2507	16204813086
W2007 STRATOSPHERE PROPCO L L C	2000 S LAS VEGAS BLVD LAS VEGAS NV 89104-2507	16204710049
W2007 STRATOSPHERE PROPCO L L C	2000 S LAS VEGAS BLVD LAS VEGAS NV 89104-2507	16204813085
W2007 STRATOSPHERE PROPCO L L C	2000 S LAS VEGAS BLVD LAS VEGAS NV 89104-2507	16204813095
W2007 STRATOSPHERE PROPCO L L C	2000 S LAS VEGAS BLVD LAS VEGAS NV 89104-2507	16203401002
W2007 STRATOSPHERE PROPCO L L C	2000 S LAS VEGAS BLVD LAS VEGAS NV 89104-2507	16204813090
W2007 STRATOSPHERE PROPCO L L C	2000 S LAS VEGAS BLVD LAS VEGAS NV 89104-2507	16204813091
W2007 STRATOSPHERE PROPCO L L C	2000 S LAS VEGAS BLVD LAS VEGAS NV 89104-2507	16204813093

Report of All Selected Parcels**Case Number:** RQR-56788**Printed On:** Mon: December 15, 2014

Owner	Address	Parcel Number
W2007 STRATOSPHERE PROPCO L L C	2000 S LAS VEGAS BLVD LAS VEGAS NV 89104-2507	16204813084
W2007 STRATOSPHERE PROPCO L L C	2000 S LAS VEGAS BLVD LAS VEGAS NV 89104-2507	16204813061
W2007 STRATOSPHERE PROPCO L L C	2000 S LAS VEGAS BLVD LAS VEGAS NV 89104-2507	16204813097
W2007 STRATOSPHERE PROPCO L L C	2000 S LAS VEGAS BLVD LAS VEGAS NV 89104-2507	16204710048
W2007 STRATOSPHERE PROPCO L L C	2000 S LAS VEGAS BLVD LAS VEGAS NV 89104-2507	16204813059
W2007 STRATOSPHERE PROPCO L L C	2000 S LAS VEGAS BLVD LAS VEGAS NV 89104-2507	16204813092
W2007 STRATOSPHERE PROPCO L L C	2000 S LAS VEGAS BLVD LAS VEGAS NV 89104-2507	16204813094
W2007 STRATOSPHERE PROPCO L L C	2000 S LAS VEGAS BLVD LAS VEGAS NV 89104-2507	16204813089
WAGGONER SANDRA S & MICHAEL L	47 PRIMROSE LN CARBONDALE CO 81623	16210114453
WAGNER NESTOR O & NORA M	7449 VIA LORADO RANCHO PALOS VERDES CA 90275-442 5	16210114249
WAGNER WESLEY	7714 BIRCH BAY DR #407 BLAINE WA 98230	16204815090
WAITS BRUCE & RUTH	2912 S DETROIT AVE TULSA OK 74114-5227	16210114254
WALDSTEIN TRUST	WALDSTEIN PETER S & LAURIE B TRS 2900 DEEP CANYON DR BEVERLY HILLS CA 90210	16204815176
WALLACE MARYLN E	322 KAREN AVE #305 LAS VEGAS NV 89109-0414	16210114013
WALTON PAUL TALMAGE	200 WEST SAHARA AVE #2001 LAS VEGAS NV 89102-5076	16204815188
WANG BRITT G	3641 MT DIABLO BLVD #644 LAFAYETTE CA 94549	16203415035
WANG DAVID	6922 SPICKARD DR HUNTINGTON BEACH CA 92647	16204815078
WANG JACKSON	3026 LAZY MEADOW DR TORRANCE CA 90505-7119	16210114187
WANG LYNN & LEE	1219 N VERMONT ST ARLINGTON VA 22201	16210114087
WANG XIAONING	GUO YU 1962 MASS AVE LUNENBURG MA 01462	16204815064
WANSBECK L L C	2827 E BLUERIDGE AVE ORANGE CA 92867	16204815170
WANSBECK L L C	2827 E BLUERIDGE AVE ORANGE CA 92867	16204815385
WARD HERMAN JR TRUST	WARD HERMAN JR TRS 4536 DON FELIPE DR LOS ANGELES CA 90008-2826	16210114066
WARD HERMAN JR TRUST	WARD HERMAN JR TRS 4536 DON FELIPE DR LOS ANGELES CA 90008-2826	16210114068
WARREN JOHN P SEPARATE FAMILY TR	WARREN JOHN P TRS 222 KAREN AVE #404 LAS VEGAS NV 89101	16210114338
WARRENS NEWS & GIFT INC	631 STRANDER BLVD #F TUKWILA WA 98188-2963	16204815013
WATANABE CHRISTOPHER TRUST	WATANABE CHRISTOPHER TRS 322 KAREN AVE #3302 LAS VEGAS NV 89109	16210114242
WATERS KERRITT L & JAN L	704 S 9TH ST LAS VEGAS NV 89101-7015	16203416024
WEINBERG DAVID TRUST	WEINBERG DAVID TRS 2520 THE STRAND MANHATTAN BEACH CA 90266-2152	16210114250
WELLS RICHARD	200 W SAHARA AVE #3907 LAS VEGAS NV 89102-5095	16204815419
WERNER PAUL A & CONNIE M	222 KAREN AVE #3201 LAS VEGAS NV 89101	16210114551
WESTERN RECOVERY REAL EST INVEST	P O BOX 530129 LAS VEGAS NV 89053-0129	16204815412

Report of All Selected Parcels**Case Number:** RQR-56788**Printed On:** Mon: December 15, 2014

Owner	Address	Parcel Number
WESTERN RECOVERY REAL EST INVEST	P O BOX 530129 HENDERSON NV 89053-0129	16204815403
WESTERN RECOVERY REAL EST INVEST	P O BOX 530129 LAS VEGAS NV 89053	16204815001
WESTERN STATES HEALTHCARE SERV	GILL AMELOU %A GILL 1612 W GLENOAKS BLVD GLENDALE CA 91201-1814	16210114312
WESTINVEST CAPITAL L L C	2700 S LAS VEGAS BLVD #905 LAS VEGAS NV 89109-1149	16204815130
WESTWOOD ROCK L L C	84 BOWERY #3 NEW YORK NY 10013-4608	16210114027
WHITE CYNTHIA TRUST	WHITE CYNTHIA TRS 322 KAREN AVE #3805 LAS VEGAS NV 89109	16210114259
WHITE CYNTHIA TRUST	WHITE CYNTHIA TRS 322 KAREN AVE #3805 LAS VEGAS NV 89109	16210114274
WHITE RONALD R & ROSE E	17602 17TH ST #102-241 TUSTIN CA 92780	16204815396
WHITNEY BUILDING L L C	2003 LAS VEGAS BLVD S LAS VEGAS NV 89104-2522	16203310017
WHITNEY BUILDING L L C	P O BOX 4349 ANAHEIM CA 92803-4349	16203310014
WIDNER PHILIP M & KIMBERLY J	P O BOX 1035 SOUTH CLE ELUM WA 98943-1035	16204815201
WIDNER PHILIP M & KIMBERLY J	P O BOX 1035 SOUTH CLE ELUM WA 98943-1035	16204815200
WONG KWUNG YELL & LAI WAH	WONG WING HING 2317 SANTA PAULA DR LAS VEGAS NV 89104-2634	16203415019
WONG SHARON M REVOCABLE LIV TR	WONG SHARON M TRS 848 RAINBOW BLVD #3324 LAS VEGAS NV 89107	16204815140
WOODWARD JAMES & VALERY	200 W SAHARA AVE #2612 LAS VEGAS NV 89102-5082	16204815270
WORTHINGTON LISA U S TR	WORTHINGTON LAUREN C TRS 322 KAREN AVE #1102 LAS VEGAS NV 89109	16210114074
WRAY WILLIAM B & SARAH J	200 W SAHARA AVE #2602 LAS VEGAS NV 89102	16204815260
WRIGHT JEFFREY B	8908 BROOK HILL LN FORT WORTH TX 76244	16204815352
WRIGHT JOHN J	15989 GRANDVIEW AVE MONTE SERENO CA 95030-3117	16204815393
WRIGHT TRAVIS & KRISTIE	200 W SAHARA AVE LAS VEGAS NV 89102-5002	16204815220
WU DANYU	AO HONG 1 MILLWOOD CIR FRAMINGHAM MA 01701	16204815375
WU YONG CHUN	YANG JIAN 409 E WISTARIA AVE ARCADIA CA 91006-4830	16204815070
XU LILIAN	200 W SAHARA AVE #3901 LAS VEGAS NV 89102-5095	16204815413
XU LILIAN	200 W SAHARA AVE #3901 LAS VEGAS NV 89102-5095	16204815422
YARBROUGH THOMAS & NANCY LIV TR	2777 PARADISE RD #604 LAS VEGAS NV 89109-9101	16210114011
YEH 2013 REVOCABLE FAMILY TRUST	YEH TED HUA & DANA PEONY TRS 22418 STEEPLE CHASE DIAMOND BAR CA 91765-3639	16204815257
YEN CHINGHSI	19135 SINGING WOOD DR ROWLAND HEIGHTS CA 91748-2265	16204815251
YERUSHALMI DANIEL & SHOSHANA	121 HICKS LANES GREAT NECK NY 11024-2104	16210114206
YERUSHALMI ILAN & FRIDA	18 FARM LN ROSLYN HEIGHTS NY 11577-2604	16210114156
YERUSHALMI RAPHAEL	345 HILLSIDE AVE WILLISTON PARK ny 11596	16210114061
YERUSHALMI RAPHAEL	55 PEBBLE LN ROSLYN HEIGHTS NY 11577-2711	16210114418
YERUSHALMI RAPHAEL	345 HILLSIDE AVE WILLISTON PARK NY 11596-2130	16210114204

Report of All Selected Parcels**Case Number:** RQR-56788**Printed On:** Mon: December 15, 2014

<u>Owner</u>	<u>Address</u>	<u>Parcel Number</u>
YI FAMILY TRUST	YI STEVE EUN & JENNIFER MINA TRS 641 W LAS PALMAS DR FULLERTON CA 92835-1435	16210114181
YIP TIFFANY	14910 HAWTHORN AVE FLUSHING NY 11355-1717	16210114037
YOO HEE M	200 W SAHARA AVE #3112 LAS VEGAS NV 89102-5087	16204815330
YOU ME L L C	3900 PARADISE RD #121 LAS VEGAS NV 89169	16204815426
YOU ME L L C	3900 PARADISE RD #121 LAS VEGAS NV 89169	16204815158
YOU ME SIX L L C	3900 PARADISE RD #121 LAS VEGAS NV 89169	16204815229
YOU ME SIX L L C	3900 PARADISE RD #121 LAS VEGAS NV 89169	16204815230
YOU ME SIX L L C	3900 PARADISE RD #121 LAS VEGAS NV 89169	16204815218
YOU ME SIX L L C	3900 PARADISE RD #121 LAS VEGAS NV 89169	16204815217
YOU ME SIX L L C	3900 PARADISE RD #121 LAS VEGAS NV 89169	16204815312
YOU ME SIX L L C	3900 PARADISE RD #121 LAS VEGAS NV 89169	16210114195
YOU ME SIX L L C	3900 PARADISE RD #121 LAS VEGAS NV 89169	16204815147
YOU ME SIX L L C	3900 PARADISE RD #121 LAS VEGAS NV 89169	16204815341
YOUNG FRED W & KENNETH P	2221 W BONANZA #16 LAS VEGAS NV 89106-4707	16203415028
YU FAMILY TRUST	YU FRANKLIN C & ROSALIND T TRS P O BOX 5919 FULLERTON CA 92838-0919	16210114610
YU RYAN	YUDA AYUMI 2512-28 ST #104 SANTA MONICA CA 90405	16210114101
YU STEVE & JOANNE	WANG JERRY P O BOX 174 WEST COVINA CA 91793-0174	16210114218
YUAN FAMILY 2012 TRUST	YUAN JAMES & SHERRY TRS 2926 E HILLSIDE DR WEST COVINA CA 91791	16210114471
YUKIHIRO SATO	HEISOOK KIM 19121 BIDDLE DR IRVINE ca 92603	16210114072
YUN MOON GIL REVOCABLE LIVING TR	YUN MOON GIL TRS 37964 PINNACLE CT MURRIETA CA 92562	16204815207
Z Y Z Z X	P O BOX 36208 LAS VEGAS NV 89133	16210114190
ZAK FRANK J	3817 BUNTING AVE FORT WORK TX 76107-2608	16203414032
ZE REN INC	5130 S FORT APACHE RD #215-418 LAS VEGAS NV 89148-1719	16204815197
ZEBALLOS ABEL	1039 WHITE SAILS WAY CORONA DEL MAR CA 92625	16210114366
ZEE HOWELL	200 W SAHARA AVE # 3708 LAS VEGAS NV 89102-5093	16204815398
ZEIGLER JOHN	TSOI ANITA 4611 LAGUNA VISTA ST LAS VEGAS NV 89147	16204815348
ZHONG YIN LV GROUP INC	222 KAREN AVE #3907 LAS VEGAS NV 89109	16204815068
ZHONG YIN LV GROUP INC	222 KAREN AVE #3907 LAS VEGAS NV 89109	16204815249
ZHU, APRIL JIANG	165 LYELL ST LOS ALTOS CA 94022	16204815315
ZIC ZELJKO	HSU-ZIC SOPHIA 222 KAREN AVE #603 LAS VEGAS NV 89101	16210114353
ZUKOWSKI BARBARA	200 W SAHARA AVE #1207 LAS VEGAS NV 89102-5070	16204815110