

City of Las Vegas
Office of City Clerk
495 South Main Street, 2nd Floor
Las Vegas, Nevada 89101

Return Service Requested
Official Notice of Public Hearing

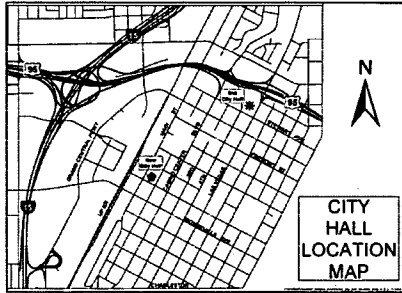

If you wish to file your protest or support on this request, check the appropriate box below and return this card in an envelope with postage to the Office Of The City Clerk at the address listed above or fax this side of this card to (702) 382-4803. If you would like to contact your Council Representative, please call (702) 229-6405.

I SUPPORT
this Request

I OPPOSE
this Request

Please use available blank space on card for your comments.

RQR-50937

City Council Meeting of 11/20/2013

Application Information

RQR-50937 - REQUIRED REVIEW - PUBLIC HEARING - APPLICANT: CBS OUTDOOR - OWNER: SAHARA RANCHO OFFICE CENTER, LLC - For possible action on a Required Review of an approved Variance (V-0154-94) WHICH ALLOWED A 90-FOOT TALL, 14-FOOT BY 48-FOOT OFF-PREMISE SIGN on 12.6 acres at 2320 South Rancho Drive (APN 162-04-412-005), C-1 (Limited Commercial) Zone, Ward 1 (Tarkanian).

Application Location

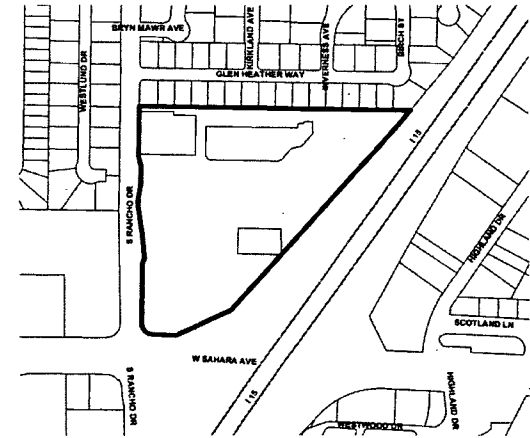

The proposed project may not pertain to the entire highlighted project site.

Public Hearing Information

Meeting: City Council
Date: *November 20, 2013*
Time: 1:00 P.M.
Location: City Council Chambers
495 South Main Street
Las Vegas, Nevada

Any and all interested persons may appear and be heard at said meeting, or may, prior thereto, file written objections thereto or approvals thereof with the City Clerk, 1st Floor, City Hall, 495 South Main Street, Las Vegas, Nevada, 89101. For further information, including the full staff report, please call (702) 229-6311 (TDD 386-9108) or go to <http://www.lasvegasnevada.gov>,

Report of All Selected Parcels**Case Number:** RQR-50937**Printed On:** Wed: October 16, 2013

<u>Owner</u>	<u>Address</u>	<u>Parcel Number</u>
1901 LOCH LOMOND WY TRUST	P O BOX 36208 LAS VEGAS NV 89133-6208	16204311018
2320 WESTERN L L C	%C SHAFFER JR 375 LAUREL DR BOULDER CITY NV 89005-2646	16204404003
2424 WESTERN REALTY INC	%M PUORRO 2424 WESTERN AVE LAS VEGAS NV 89102-4816	16204404017
2575 S HIGHLAND DRIVE L P	%CANTOR G & W NV HOLDINGS L P 2575 HIGHLAND DR LAS VEGAS NV 89109-1113	16209110018
2701 WESTWOOD L L C	%MR R BRANDY 1113 PINE ISLAND CT LAS VEGAS NV 89134-6330	16209102002
AD AMERICA INC	%J BIELINSKI 2310 HIGHLAND DR LAS VEGAS NV 89102-4809	16204402004
ADAJIAN GOHAR	803 1/2 N RIDGEWOOD PL LOS ANGELES CA 90038-3192	16205716032
ADAJIAN GOHAR	803 1/2 N RIDGEWOOD PL LOS ANGELES CA 90038-3192	16205813024
ADAMIAN ROBERT	2201 ALIA CT LAS VEGAS NV 89102-4378	16205815039
ALEXANDER MARK E & DEBORAH K	1613 KIRKLAND AVE LAS VEGAS NV 89102-4433	16204312014
ALVAREZ JAIRO	ANGEL CAROLINA 2101 NACO CT LAS VEGAS NV 89102-4379	16205813026
ALVAREZ MARIO A & ROSA	2149 ECHO PARK AVE LOS ANGELES CA 90026-1971	16205815009
AMOROSO JESSE J & JENNIFER A	1900 WESTLUND DR LAS VEGAS NV 89102-2015	16205717001
ANDERSON GENE R	2300 EL CORTEZ AVE LAS VEGAS NV 89102-2029	16205716001
AQUINO RAUL M	2105 NACO CT LAS VEGAS NV 89102-4379	16205813025
ARAGON KAREN D REV LIV TR	ARAGON KAREN D TRS P O BOX 572 GRANTS NM 87020-0572	16205815007
ARAGON KAREN D REVECABLE LIV TR	ARAGON KAREN D TRS %K ARAGON & D COFFMAN P O BOX 572 GRANTS NM 87020-0572	16205815034
ARAGON KAREN D REVOCABLE LIV TR	ARAGON KAREN D TRS %K ARAGON & D COFFMAN P O BOX 572 GRANTS NM 87020-0572	16205815044
ARAGON KAREN D REVOCABLE LIV TR	%K ARAGON & D COFFMAN P O BOX 572 GRANTS NM 87020-0572	16205815041
ARAGON KAREN D REVOCABLE LIV TR	%K ARAGON & D COFFMAN P O BOX 572 GRANTS NM 87020-0572	16205815043
ARAGON KAREN D REVOCABLE LIV TR	ARAGON KAREN D TRS P O BOX 572 GRANTS NM 87020-0572	16205813002
ARAGON KAREN D REVOCABLE TRUST	ARAGON KAREN D TRS %K ARAGON & D COFFMAN P O BOX 572 GRANTS NM 87020-0572	16205815003
ARAGON KAREN REVOCABLE TRUST	P O BOX 572 GRANTS NM 87020-0572	16205813001
ARNOLD RONALD & STACEY	10637 BIG CANOE BIG CANOE GA 30143-5131	16205715028
AYRES TRAVIS P	DONOCK KARLA S 9806 MEADOW VALLEY DR VIENNA VA 22181-3215	16204312004
BAGHDASARYAN MARINE & SARKIS	1831 N GRAMERCY PL #207 LOS ANGELES CA 90028-5842	16205813015
BAKER TIFFANY A	1524 INVERNESS AVE LAS VEGAS NV 89102-4422	16204312046
BARTON DORIS J	2301 EL CAMINO AVE LAS VEGAS NV 89102-2008	16205814001
BEALL VIRGINIA ROBBINS LIV TR	BEALL VIRGINIA ROBBINS TRS 1908 DE OSMA ST LAS VEGAS NV 89102-2024	16205716011
BECERRA GILBERTO SALAZAR	2208 GLEN HEATHER LAS VEGAS NV 89102-4420	16204410018
BOYER ELAINE	SCHWINGDORF LEONARD & L LIV TR 6245 GALILEO DR LAS VEGAS NV 89149-1385	16204404013
BOYER ELAINE	SCHWINGDORF LEONARD & L LIV TR 6245 GALILEO DR LAS VEGAS NV 89149-1385	16204404011

Report of All Selected Parcels**Case Number:** RQR-50937**Printed On:** Wed: October 16, 2013

<u>Owner</u>	<u>Address</u>	<u>Parcel Number</u>
BRADY DONALD B	2600 WESTWOOD DR LAS VEGAS NV 89109-1118	16209110004
BRADY DONALD B	2600 WESTWOOD DR LAS VEGAS NV 89109-1118	16209110005
BROSSEAU 1993 TRUST	BROSSEAU PAUL H TRS 2609 S HIGHLAND DR LAS VEGAS NV 89109-1156	16209110015
BURN PAUL & STACY	2209 WESTLUND DR LAS VEGAS NV 89102-6114	16205814015
BURROWS KEVYN BRACKETT	2509 LOURDES AVE LAS VEGAS NV 89102-4305	16205815017
BURTON KRISTA A & RYNN F	2612 GLENKERRY DR ANCHORAGE AK 99504-3241	16205813016
CANNON WALTER R & J FAM TR 1986	CANNON WALTER R & JEANETTE TRS 1909 VILLA DE CONDE WY LAS VEGAS NV 89102-2088	16205715027
CARL ROBERT SCOTT LIVING TR 2006	CARL ROBERT S TRS 2605 HIGHLAND DR LAS VEGAS NV 89109-1113	16209110016
CATABAS FAMILY TRUST	CATABAS REMEDIOS B TRS 2209 GLEN HEATHER WY LAS VEGAS NV 89102-4446	16204410004
CHACHAS JAMES C TRUST	CHACHAS JAMES C TRS 2400 EL CORTEZ LAS VEGAS NV 89102-6101	16205716005
CHAIRSELL WILLIAM & MARGARET TRS	2204 WESTLUND DR LAS VEGAS NV 89102-6113	16205814005
CLAREMONT HOTEL INC	%P CHOPRA 135 W 70TH ST #7CD NEW YORK NY 10023-4458	16209102005
CLARKSON ADAM	2505 CALLITA CT LAS VEGAS NV 89102-2094	16205715024
CLEWES MARK J & MARY E	1812 BIRCH ST LAS VEGAS NV 89102-4404	16204312040
COLAGROSSI RAMON & J M FAM TR	COLAGROSSI RAMON J & J M TRS 2312 EL CORTEZ AVE LAS VEGAS NV 89102-2029	16205716004
COLE FAMILY LIVING TRUST	COLE MICHAEL PIERCE TRS 1509 BRYN MAWR AVE LAS VEGAS NV 89102-4411	16204312001
CONTINI JOSEPH & CHRISTINE M	1804 IVANHOE WY LAS VEGAS NV 89102-4428	16204311010
CONWAY RAYMOND E & WILMA L	2204 DE OSMA ST LAS VEGAS NV 89102-2028	16205815047
CORBO LAWRENCE J	2221 DE OSMA ST LAS VEGAS NV 89102-2099	16205815006
CORON BRYAN P & HEIDI M	2304 EL CORTEZ AVE LAS VEGAS NV 89102-2029	16205716002
COSBY JANET	2205 ALIA CT LAS VEGAS NV 89102-4378	16205815040
COUTURE-WOODBURY SUZANNE M	WOODBURY BRUCE MALCOLM 1505 BRYN MAWR AVE LAS VEGAS NV 89102-4411	16204310007
CROCKETT JAMES E & DORIS T	2101 WESTLUND DR LAS VEGAS NV 89102-2052	16205814010
CROWLEY AARON	BLESSEY MOLLY 1609 BRYN MAWR AVE LAS VEGAS NV 89102-4450	16204312007
DAFT HENRY	2601 LOURDES AVE LAS VEGAS NV 89102-4306	16205815020
DEAGUIRRE GLAFIRA	1517 KIRKLAND AVE LAS VEGAS NV 89102-4431	16204312053
DIAMONOF 1991 TRUST	DIAMONOF CHARLES J & C J CO-TRS 1913 BIRCH ST LAS VEGAS NV 89102-4405	16204312058
DRUMMOND FAMILY TRUST	DRUMMOND LARRY E TRS 2009 DE OSMA ST LAS VEGAS NV 89102-2097	16205716025
DURAN MICHAEL E	2012 DE OSMA ST LAS VEGAS NV 89102-2095	16205716018
DUXBURY KIMBERLY	VANWORMER TIMOTHY W 250 W SHERWOOD DR HENDERSON NV 89015-7759	16204312029
E Z & D N L L C	%D NAKASH 9313 BURTON WAY #A BEVERLY HILLS CA 90210-3654	16204312024
EASLEY STEVE TRUST	EASLEY STEPHEN TRS 2308 EL CORTEZ AVE LAS VEGAS NV 89102-2029	16205716003

Report of All Selected Parcels**Case Number:** RQR-50937**Printed On:** Wed: October 16, 2013

<u>Owner</u>	<u>Address</u>	<u>Parcel Number</u>
EASTERDAY ROGER L	1520 BRYN MAWR AVE LAS VEGAS NV 89102-4447	16204312054
ELAM PAUL M & SHARON K	1808 IVANHOE WY LAS VEGAS NV 89102-4428	16204311011
ENGSTROM DEREK E & GLADYS REV TR	ENGSTROM DEREK E & GLADYS CO-TRS 1512 INVERNESS AVE LAS VEGAS NV 89102-4422	16204312049
ERICKSON MICHAEL & TERESA	1809 BIRCH ST LAS VEGAS NV 89102-4403	16204312042
EXLINE ELIZABETH	1908 WESTLUND DR LAS VEGAS NV 89102-2015	16205717003
FAVELA ERASMO	1821 LOCH LOMOND WY LAS VEGAS NV 89102-4437	16204311020
FEDERAL NATIONAL MORTGAGE ASSN	%COOPER CASTLE LAW FIRM 5275 S DURANGO DR LAS VEGAS NV 89113-0159	16205815004
FELDHEIM ROBERT	3540 W SAHARA AVE #303 LAS VEGAS NV 89102-5816	16205813009
FELDMAN SAM TRUST	FELDMAN ROBERT L TRS 800 N RAINBOW BLVD #208 LAS VEGAS NV 89107-1193	16204301010
FERRERA J-M FAMILY TRUST	FERRERA JOSEPH & MARY TRS 1905 WESTLUND DR LAS VEGAS NV 89102-2016	16205717011
FLEMING KENNETH E & JOY C LIV TR	FLEMING JOY C TRS 1841 NEWPORT BAY DR LAS VEGAS NV 89117-2057	16204406009
FLOWER WILLIAM P FAMILY TRUST	FLOWER WILLIAM P TRS 2606 BRYANT AVE LAS VEGAS NV 89102-2177	16204311015
FONSECA GUADALUPE	HERNANDEZ EVELIA 2129 GLEN HEATHER WY LAS VEGAS NV 89102-4417	16204410009
FORSTER JOEL S JR	2137 GLEN HEATHER WY LAS VEGAS NV 89102-4417	16204410007
FRIESEN JONATHAN K	7700 TOMICH AVE LAS VEGAS NV 89145-4002	16204312050
G J G DEVELOPMENT L L C	%J LUNT 6903 GOOSE RIVER AVE LAS VEGAS NV 89131-0121	16204301012
GAGNON GUY FAMILY TRUST	GAGNON JULES G & DIANA JOAN TRS 2108 WESTLUND DR LAS VEGAS NV 89102-2049	16205814007
GALLIGAN THOMAS L L C	2110 S HIGHLAND LAS VEGAS NV 89102-4622	16204301011
GAMEZ-CHIN KENIA	2200 GLEN HEATHER WAY LAS VEGAS NV 89102-4420	16204410016
GARRETT CAPITAL L L C	%SIEGEL GROUP/SASCO PPTYS 3790 PARADISE RD #250 LAS VEGAS NV 89169-4640	16209102010
GARRETT CAPITAL L L C	%SIEGEL GROUP/SASCO PPTYS 3790 PARADISE RD #250 LAS VEGAS NV 89169-4640	16209102008
GARRETT CAPITAL L L C	%SIEGEL GROUP/SASCO PPTYS 3790 PARADISE RD #250 LAS VEGAS NV 89169-4640	16209102009
GARRISON RODERICK E & V M FAM TR	GARRISON R E & V M CO-TRS 1904 BIRCH ST LAS VEGAS NV 89102-4443	16204312036
GIBSON HARRY & CHARLOTTE TRUST	SANDERS ELISABETH TRS P O BOX 2770 ALPINE CA 91903-2770	16204411006
GONZALEZ AHUIZOTL	1608 KIRKLAND LAS VEGAS NV 89102-4415	16204411002
GONZALEZ SOCORRO C	1829 RENADA CIR NO LAS VEGAS NV 89030-5058	16204312016
GRAINGER W W INC	%M POER & CO 410 17TH ST #1175 DENVER CO 80202-4439	16204406010
GRATT VENISE	1505 KIRKLAND AVE LAS VEGAS NV 89102-4431	16204310028
GRAY PATRICIA J	2016 DE OSMA ST LAS VEGAS NV 89102-2095	16205716019
GREGORY MARIA GABRIELA & RAY	2501 CALLITA CT LAS VEGAS NV 89102-2094	16205715025
GREMM MANFRED	GREMM MYRA 2405 HIGHLAND DR LAS VEGAS NV 89102-4803	16204404007
GRIFFIS CURTIS ALLEN	2412 WESTERN AVE LAS VEGAS NV 89102-4816	16204404012

Report of All Selected Parcels**Case Number:** RQR-50937**Printed On:** Wed: October 16, 2013

<u>Owner</u>	<u>Address</u>	<u>Parcel Number</u>
GRIFFITHS BRIAN KEITH	1615 8TH ST OAKLAND CA 94607-1354	16204411001
GUILLEN MICHAEL A & SHARON L	2217 GLEN HEATHER WY LAS VEGAS NV 89102-4446	16204410002
GUNTER EUGENE W & PAMELA A	1821 BIRCH ST LAS VEGAS NV 89102-4403	16204312045
HALL LESTER R 2002 LIVING TRUST	HALL LESTER R TRS P O BOX 80508 LAS VEGAS NV 89180-0508	16204410006
HEALTHY LIVING SOLUTIONS L L C	2965 REDWOOD ST LAS VEGAS NV 89146-6501	16204410001
HEISHMAN JOHN	7016 ACORN CT LAS VEGAS NV 89147-4712	16204312059
HELLER BERYL S	1908 INVERNESS AVE LAS VEGAS NV 89102-4423	16204312032
HERRING RODNEY T TRUST	HERRING RODNEY T TRS 820 S LACY DR LAS VEGAS NV 89107	16204311012
HIGGINS MICHAEL & CHERYL LIV TR	HIGGINS MICHAEL C & CHERYL D TRS 2610 SE BELLA VISTA RD VANCOUVER WA 98683-7616	16204312011
HIGHLAND BY THE HIGHWAY L L C	8275 S EASTERN AVE #200 LAS VEGAS NV 89123-2545	16209110017
HITT W DOUGLAS FAMILY TRUST	HITT W DOUGLAS TRS 2208 ALIA CT LAS VEGAS NV 89102-4333	16205815036
HOGAN ROBERT E & DOLORES F	1908 BIRCH ST LAS VEGAS NV 89102-4443	16204312035
HOLMES LESLIE M & STEPHANIE	2008 DE OSMA STREET LAS VEGAS NV 89102-2095	16205716017
HOWARD CARLEETA	2505 SIDONIA AVE LAS VEGAS NV 89102-4310	16205813030
HSING WILLIAM	2108 DE OSMA ST LAS VEGAS NV 89102-2096	16205813007
HUNT TERRY J	GODINA EUGENE 2501 FULANO WY LAS VEGAS NV 89102-2034	16205715017
ISRAEL JANE B	2408 EL CORTEZ AVE LAS VEGAS NV 89102-6101	16205716007
ITALY SERVICE INC	4652 GREEN CANYON LAS VEGAS NV 89103-4321	16204404009
JACKSON JO ANNA	2517 LOURDES AVE LAS VEGAS NV 89102-4305	16205815019
JAFFE GORDON FAMILY TRUST	JAFFE GORDON TRS 2000 WESTLUND DR LAS VEGAS NV 89102-2000	16205717004
JANEWAY COMPANY	2885 MANN ST LAS VEGAS NV 89146-5230	16204406008
JANEWAY L L C	2885 MANN ST LAS VEGAS NV 89146-5230	16204406007
JAROS PAULINE M	1817 LOCH LOMOND WY LAS VEGAS NV 89102-4437	16204311021
JAYASINGHA IMOGENE & GLADSTONE	JAYASINGHA GLADSTONE 2104 GLEN HEATHER WY LAS VEGAS NV 89102-4418	16204410010
JESSUP HARRY W & HELEN B	2009 WESTLUND DR LAS VEGAS NV 89102-6100	16205717007
JIMENEZ RAMON & SILVIA	11 CASTLE CREEK CT LAS VEGAS NV 89148-2721	16204410003
JOHNS CLEONE LIVING TRUST	%C JONES 2217 DE OSMA ST LAS VEGAS NV 89102-2099	16205815005
JOHNSEN BARBARA J	2404 EL CORTEZ AVE LAS VEGAS NV 89102-6101	16205716006
JOHNSON BERTHA	3963 S LASALLE AVE LOS ANGELES CA 90062	16204311014
JOHNSON FAMILY TRUST	JOHNSON THOMAS D & JEAN P TRS 1816 BIRCH ST LAS VEGAS NV 89102-4404	16204312039
JUMAT PON	MAYES JOHN 360 E DESERT ROSE DR HENDERSON NV 89015-8142	16204312051
K M X I 2000 LIVING TRUST	PAPPAS JOHNNY J & HARRY J TRS 1125 CASHMAN DR LAS VEGAS NV 89102-1911	16205716030

Report of All Selected Parcels**Case Number:** RQR-50937**Printed On:** Wed: October 16, 2013

<u>Owner</u>	<u>Address</u>	<u>Parcel Number</u>
KALKOWSKI LAARY & M 1993 REV TR	KALKOWSKI LARRY & MONICA CO-TRS 2100 WESTLUND DR LAS VEGAS NV 89102-2049	16205814009
KAREEM EHAB M ABDEL	8429 MOONDANCE CELLARS CT LAS VEGAS NV 89139-7162	16205815002
KAVANAGH KEVIN M	1605 BRYN MAWR AVE LAS VEGAS NV 89102-4450	16204312006
KELLER CHRISTOPHER M	1604 KIRKLAND AVE LAS VEGAS NV 89102-4415	16204312017
KELLER TOMA A	2001 WESTLUND DR LAS VEGAS NV 89102-6100	16205717009
KNIGHT ANTHONY	200 HOOVER AVE #1805 LAS VEGAS NV 89101	16205814006
KNOWLTON BRETT	2004 DE OSMA ST LAS VEGAS NV 89102-2095	16205716016
KOHLER ALEXANDER & MARION FAM TR	KOHLER ALEXANDER E & MARION TRS 1605 INVERNESS AVE LAS VEGAS NV 89102-4427	16204312028
KOLINOSKI DAVID J	1904 WESTLUND DR LAS VEGAS NV 89102-2015	16205717002
KORNER PETE	1605 KIRKLAND AVE LAS VEGAS NV 89102-4433	16204312012
KURAPATI MADHU-KUMAR EMMANUEL	9404 WARM WATERS AVE LAS VEGAS NV 89129-7866	16205815033
LANE HELENE L	4146 CHESHIRE DR CYPRESS CA 90630-2710	16205815046
LAURENDEAU PAUL & S FAM TR	LAURENDEAU PAUL & S CO-TRS 1917 DE OSMA ST LAS VEGAS NV 89102-2027	16205716028
LEE ESTHER	2212 DE OSMA ST LAS VEGAS NV 89102-2028	16205815045
LIU BIN	1513 BYRN MAWR AVE LAS VEGAS NV 89102-4411	16204312002
LOCH LOMOND IRREVOCABLE TRUST	TILROE JASON TRS 1825 LOCH LOMOND WY LAS VEGAS NV 89102-4437	16204311019
LONGSON LIONEL O	2100 DE OSMA ST LAS VEGAS NV 89102-2096	16205716021
LONGSON TIM & KATHY	LONGSON LIONEL & EUNICE 2100 DE OSMA ST LAS VEGAS NV 89102-2096	16205813006
LOPEZ CELIA R	1905 DE OSMA ST LAS VEGAS NV 89102-2027	16205716031
LOVO-BAIRES MARIA	2216 GLEN HEATHER WY LAS VEGAS NV 89102-4420	16204410020
LOZON WILLIAM J & MARCIA L S	2229 DE OSMA LAS VEGAS NV 89102-2099	16205815008
LU YUE	609 E LONGDEN AVE ARCADIA CA 91006-5444	16205716010
LUARCA JOSEPH M & TERRY L	2309 EL CAMINO AVE LAS VEGAS NV 89102-2008	16205814003
M K INVEST INC	3160 W SAHARA #A-22 LAS VEGAS NV 89102-6096	16205815018
MAGAR JAMES	3020 WATERSIDE CIR LAS VEGAS NV 89117-2276	16204410012
MAJORS MARGARET A	2105 DE OSMA ST LAS VEGAS NV 89102-2098	16205813004
MALONE PATRICK J	4616 W SAHARA AVE #489 LAS VEGAS NV 89102-3654	16204312055
MAPP AUSTIN	2005 DE OSMA ST LAS VEGAS NV 89102-2097	16205716026
MARCHAND ROLAND L REV TR AGMT	MARCHAND ROLAND L TRS 2513 SIDONIA AVE LAS VEGAS NV 89102-4310	16205813028
MARCUS TAMARA	2001 WHITE FALLS ST LAS VEGAS NV 89128-6751	16204312008
MARITAL DEDUCTION TRUST	RESIDUARY TRUST %KIM WHITE-PETERSON 13460 BAYLISS RD LOS ANGELES CA 90049-1833	16205815037
MARTIN ROBERT L & KATHLEEN P	2410 WESTERN AVE LAS VEGAS NV 89102-4816	16204404010

Report of All Selected Parcels**Case Number:** RQR-50937**Printed On:** Wed: October 16, 2013

<u>Owner</u>	<u>Address</u>	<u>Parcel Number</u>
MATHER STEPHEN C & KIMBERLY A	1608 BRYN MAWR AVE LAS VEGAS NV 89102-4416	16204312010
MCALLISTER ED	1517 BRYN MAWR AVE LAS VEGAS NV 89102-4411	16204312003
MCCONNELL DENISE L	2112 DE OSMA ST LAS VEGAS NV 89102-2096	16205813008
MCCOWAN LIVING TRUST	MCCOWAN CLARA B TRS 1808 BIRCH ST LAS VEGAS NV 89102-4404	16204312041
MCKINLEY RAYMOND & NINA	5109 GENTLE RIVER AVE LAS VEGAS NV 89130-2932	16204311017
MCKNIGHT KIRK	1909 LOCH LOMOND WAY LAS VEGAS NV 89102-4442	16204311016
MELTZER THERESA	2132 GLEN HEATHER WY LAS VEGAS NV 89102-4445	16204410015
MILLER GARY & VELMA TRUST	MILLER GARY H & VELMA L TRS 7634 TROPHY PLACE DR HUMBLE TX 77346-8003	16204312037
MILLER STEPHEN L FAMILY TRUST	2205 WESTLUND DR LAS VEGAS NV 89102-6114	16205814014
MIMS PETER C	2405 LOURDES AVE LAS VEGAS NV 89102-4338	16205815010
MONROE ROBERT L & ANN T	2305 ZAFRA CT LAS VEGAS NV 89102-6119	16205712029
MOON 1987 TRUST DECEDENT'S TR	MOON FRIEDA TRS 2504 CALITA CT LAS VEGAS NV 89102-2020	16205715018
MORAN KEVIN M & SHERRY L	1504 BRYN MAWR AVE LAS VEGAS NV 89102-4447	16204310008
MURPHREY THOMAS J	9580 W SAHARA AVE #150 LAS VEGAS NV 89117-8827	16205814012
MY SISTER'S COMPANY L L C	1220 ALDERTON LN LAS VEGAS NV 89144-6523	16204402001
N F C L L C	P O BOX 802206 DALLAS TX 75380-2206	16205802010
N F C L L C	%NEVADA FIN CTR 2300 W SAHARA #530 LAS VEGAS NV 89102-4368	16205802009
N F C L L C	%NEVADA FIN CTR 2300 W SAHARA #530 LAS VEGAS NV 89102-4368	16205802011
N P PALACE L L C	%GEN COUNSEL 1505 S PAVILION CENTER DR LAS VEGAS NV 89135-1403	16208502011
N P PALACE L L C	%GEN COUNSEL 1505 S PAVILION CENTER DR LAS VEGAS NV 89135-1403	16208502006
N P PALACE L L C	%GEN COUNSEL 1505 S PAVILION CENTER DR LAS VEGAS NV 89135-1403	16208502009
N P PALACE L L C	%GEN COUNSEL 1505 S PAVILION CENTER DR LAS VEGAS NV 89135-1403	16208502003
N P PALACE L L C	%GEN COUNSEL 1505 S PAVILION CENTER DR LAS VEGAS NV 89135-1403	16208502002
N P PALACE L L C	%GEN COUNSEL 1505 S PAVILION CENTER DR LAS VEGAS NV 89135-1403	16208502007
N P PALACE L L C	%GEN COUNSEL 1505 S PAVILION CENTER DR LAS VEGAS NV 89135-1403	16208502010
NEW INTERNATIONAL PROPERTIES LLC	713 E OGDEN LAS VEGAS NV 89101-4230	16204403003
NEW INTERNATIONAL PROPERTIES LLC	713 E OGDEN LAS VEGAS NV 89101-4230	16204403002
NGUYEN OLIVIA MYHONG	P O BOX 11905 SAN BERNARDINO CA 92423-1905	16204312026
NOOCHLAOR KEERANA	2223 N COMMONWEALTH AVE LOS ANGELES CA 90027-1201	16204311054
NUNEZ ISABEL J	1516 INVERNESS AVE LAS VEGAS NV 89102-4422	16204312048
O H D B L L C	%BLUE MOON RESORT 2651 WEST WOOD DR LAS VEGAS NV 89109-1117	16209102006
ORR LETA M 1993 TRUST	ORR DANIEL L II TRS 2040 W CHARLESTON #201 LAS VEGAS NV 89102-2287	16205716020

Report of All Selected Parcels**Case Number:** RQR-50937**Printed On:** Wed: October 16, 2013

<u>Owner</u>	<u>Address</u>	<u>Parcel Number</u>
PADILLA JOSE C R & YARELI	2208 WESTLUND DR LAS VEGAS NV 89102-6113	16205814004
PADRON VICTOR A	6767 COLLINS AVE #1508 MIAMI BEACH FL 33141-3266	16205815001
PANTOJA JESUS A	P O BOX 26264 LAS VEGAS NV 89126-0264	16205717010
PAPPAS HARRY	P O BOX 28668 LAS VEGAS NV 89126-2668	16205716013
PARENTE 1997 TRUST	PARENTE GIOVANNI & EDELTRAUD TRS 1516 KIRKLAND AVE LAS VEGAS NV 89102-4432	16204312020
PEREZ VENUS A	4605 CURDSEN WY LAS VEGAS NV 89110-1406	16205814013
PFRIMMER KAREN	2200 DE OSMA ST LAS VEGAS NV 89102-2028	16205815048
PFRIMMER WESLEY E	2213 ALIA CT LAS VEGAS NV 89102-4378	16205815042
PHILANA CORPORATION	%NV DEV & RLTY CO 2500 W SAHARA AVE #211 LAS VEGAS NV 89102-4393	16205818004
PIDCOCK MARY B TRUST 2008	PIDCOCK MARY BETHY TRS 2421 LOURDES AVE LAS VEGAS NV 89102-4338	16205815014
POPP RANDALL R ETAL	2004 WESTLUND DR LAS VEGAS NV 89102-2000	16205717005
PRINDL JASON	1820 BIRCH ST LAS VEGAS NV 89102-4404	16204312038
PROUD FAMILY TRUST	PROUD JACK T & JULIE A TRS 2509 CALLITA CT LAS VEGAS NV 89102-2094	16205715023
PROVINCE TIMMOTHY R & CYNTHIA A	1609 KIRKLAND AVE LAS VEGAS NV 89102-4433	16204312013
QUIGLESS MILTON	2308 RESERVE WAY NEWPORT NEWS VA 23602-5851	16205814008
R J R P FAMILY TRUST	ROSIK RICHARD J TRS 9920 WILEY BURKE AVE DOWNEY CA 90240-3716	16205715030
R J R P FAMILY TRUST	ROSIK RICHARD J TRS 9920 WILEY BURKE AVE DOWNEY CA 90240-3716	16205715029
R J R P FAMILY TRUST	ROSIK RICHARD J TRS 9920 WILEY BURKE AVE DOWNEY CA 90240-3716	16205715026
RAFALKO KIT	1909 BIRCH ST LAS VEGAS NV 89102-4405	16204312033
RAND GLORIA M & PAMELA JO	1513 KIRKLAND AVE LAS VEGAS NV 89102-4431	16204312052
REBEL OIL COMPANY INC	2200 S HIGHLAND DR LAS VEGAS NV 89102-4629	16204403004
REBEL OIL COMPANY INC	2200 S HIGHLAND DR LAS VEGAS NV 89102-4629	16204402005
REBEL OIL COMPANY INC	2200 S HIGHLAND DR LAS VEGAS NV 89102-4629	16204402006
REBEL OIL COMPANY INCORPORATED	2200 S HIGHLAND DR LAS VEGAS NV 89102-4629	16204404001
REBEL OIL COMPANY INCORPORATED	2200 S HIGHLAND DR LAS VEGAS NV 89102-4629	16204402007
RED OAK TRUST	CREEL ALLAN & DEBORAH TRS 6330 W SUNSET RD LAS VEGAS NV 89118-3318	16209110010
REED RICHARD J	1912 DE OSMA ST LAS VEGAS NV 89102-2024	16205716012
RESOLUTE PROPERTY MANAGEMENT LLC	P O BOX 50211 HENDERSON NV 89016-0211	16205716024
REYES MARICEL	3665 HILLARY ELAN CT LAS VEGAS NV 89139-8186	16204410005
RHOADS H KAY	2305 EL CAMINO AVE LAS VEGAS NV 89102-2008	16205814002
RHODES LIMITED-LIABILITY COMPANY	%HCA INDIRECT TAXES P O BOX 1504 NASHVILLE TN 37202-1504	16205802006
ROBBINS KATHLEEN K LIVING TRUST	ROBBINS KATHLEEN K TRS 2508 SIDONIA AVE LAS VEGAS NV 89102-4311	16205813010

Report of All Selected Parcels**Case Number:** RQR-50937**Printed On:** Wed: October 16, 2013

<u>Owner</u>	<u>Address</u>	<u>Parcel Number</u>
RODRIGUEZ NORMA E	2621 HIGHLAND DR LAS VEGAS NV 89109-1113	16209110014
ROTH RONALD M & SUSAN J	2301 ZAFRA CT LAS VEGAS NV 89102-6119	16205712030
SAHARA RANCHO OFFICE CTR L L C	2250 S RANCHO DR #225 LAS VEGAS NV 89102-4455	16204412004
SAHARA RANCHO OFFICE CTR L L C	2250 S RANCHO DR #225 LAS VEGAS NV 89102-4455	16204412002
SAHARA RANCHO OFFICE CTR L L C	2250 S RANCHO DR #225 LAS VEGAS NV 89102-4455	16204412003
SAHARA RANCHO OFFICE CTR L L C	2250 S RANCHO DR #225 LAS VEGAS NV 89102-4455	16204412005
SAHARA-SAB NEVADA L L C	700 CARNEGIE #4023 HENDERSON NV 89052-5633	16205818002
SAHARA-SAB NEVADA L L C	700 CARNEGIE #4023 HENDERSON NV 89052-5633	16205818003
SALTA DEBRA ANNE	CRISCI MAY F 2264 TEMPLE HILL DR LAGUNA BEACH CA 92651-2664	16205815013
SAMARASEKERA MULUGUNAGE & ARUNA	1913 DE OSMA ST LAS VEGAS NV 89102-2027	16205716029
SAMPAY JUNUIES	4734 SAN LEANDRO AVE LAS VEGAS NV 89120-1753	16204312009
SCARINCIO JASON M	2204 GLEN HEATHER WY LAS VEGAS NV 89102-4420	16204410017
SCHMIDT JAMES N	1805 LOCH LOMOND WY LAS VEGAS NV 89102-4437	16204311024
SCHRAGER BRADLEY S	BRAVO LETICIA 1512 KIRKLAND AVE LAS VEGAS NV 89102-4432	16204312021
SCHUERGER RUBY BACA & JOSEPH	12014 ELIJAH STAPP SAN ANTONIO TX 78253-5095	16204410014
SCHWINGDORF LEONARD & L LIV TR	SCHWINGDORF LEONARD JR & L TRS 6245 GALILEO DR LAS VEGAS NV 89149-1385	16204404015
SCHWINGDORF LEONARD & L LIV TR	SCHWINGDORF LEONARD JR & L TRS 6245 GALILEO DR LAS VEGAS NV 89149-1385	16204404014
SCOTT MARK C II & ELLEN P	1508 KIRKLAND AVE LAS VEGAS NV 89102-4432	16204312022
SCOTT TERESA I FAMILY TRUST	SCOTT TERESA INAGAWA TRS 1900 DE OSMA ST LAS VEGAS NV 89102-2024	16205716009
SEARS SANDRA J	2505 LOURDES AVE LAS VEGAS NV 89102-4305	16205815016
SEARS SANDRA J	2501 LOURDES AVE LAS VEGAS NV 89102-4305	16205815015
SEDLMEYER STEPHEN G & ANGELINA A	1809 LOCH LOMOND WY LAS VEGAS NV 89102-4437	16204311023
SEQUEIRA ROBERT J	SEQUEIRA TINH T 2737 BAYO CT LAS VEGAS NV 89102-2086	16204410008
SHARPE ALLEN L TRUST	SHARPE FLORENCE M TRUST 2855 BELCASTRO ST LAS VEGAS NV 89117-3035	16209110008
SHARPE ALLEN L TRUST	SHARPE FLORENCE M TRUST 2855 BELCASTRO ST LAS VEGAS NV 89117-3035	16209110009
SHARPE ALLEN L TRUST	SHARPE FLORENCE M TRUST 2855 BELCASTRO ST LAS VEGAS NV 89117-3035	16209110007
SHARPE ALLEN L TRUST	SHARPE FLORENCE M TRUST 2855 BELCASTRO ST LAS VEGAS NV 89117-3035	16209110006
SHELLEY MARY V	1817 BIRCH ST LAS VEGAS NV 89102-4403	16204312044
SHETLER TRAVIS & BRENDA	2509 SIDONIA AVE LAS VEGAS NV 89102-4310	16205813029
SILVIA MARY F TRUST	SILVIA MARY F TRS 1242 CAMPBELL DR LAS VEGAS NV 89102-1918	16204410019
SILVIA MARY F TRUST	SILVIA MARY F TRS 1242 CAMPBELL DR LAS VEGAS NV 89102-1918	16204311009
SIMONE SUSAN	1520 INVERNESS AVE LAS VEGAS NV 89102-4422	16204312047

Report of All Selected Parcels**Case Number:** RQR-50937**Printed On:** Wed: October 16, 2013

<u>Owner</u>	<u>Address</u>	<u>Parcel Number</u>
SPEER GERALD E	2000 DE OSMA ST LAS VEGAS NV 89102-2095	16205716015
SPINUZZI JOE & CARMELA	8644 HIGHLAND VIEW LAS VEGAS NV 89145-5710	16204410013
SPRINGBERG CINDY J	2021 DE OSMA ST LAS VEGAS NV 89102-2097	16205716022
STABILI MADELEINE	1614 INVERNESS AVE LAS VEGAS NV 89102-4423	16204312031
STAHL/MARCUS TRUST	STAHL STANLEY ROY TRS 2001 WHITE FALLS ST LAS VEGAS NV 89128-6751	16204410021
STASSI SUSANA	2512 SIDONIA AVE LAS VEGAS NV 89102-4311	16205813011
STATE OF NEVADA TRANSPORTATION	PALACE STA HOTEL & CASINO LEASE 2411 W SAHARA AVE LAS VEGAS NV 89102-4343	16208502012
STATE OF NEVADA TRANSPORTATION	GARRETT CAPITAL L L C LEASE %RIGHT OF WAY DIV %R PECHOUS 1263 S STEWART ST CARSON CITY NV 89701-5224	16209110042
STATE OF NEVADA TRANSPORTATION	SAHARA RV CENTER LEASE %G DONOVAN 1518 SCOTLAND LN LAS VEGAS NV 89102-4814	16204405001
STEELEY ABBY & DANIEL	1601 INVERNESS AVE LAS VEGAS NV 89102-4427	16204312027
STREED RUSSELL O	1808 LOCH LOMOND WAY LAS VEGAS NV 89102-4440	16204311053
SU ZHE	3495 WHISTLER AVE ELMONTE CA 91732-2667	16204411005
SUMNER MARYLYN E	2004 BIRCH ST LAS VEGAS NV 89102-4439	16204411009
SUN VALLEY TRUST	VOIGHT RONALD TRS 1612 KIRKLAND AVE LAS VEGAS NV 89102-4415	16204312015
T B S HIGHLAND PROPERTIES L L C	4720 N GRAND CANYON DR LAS VEGAS NV 89129-2662	16204301009
T T H LIVING TRUST	2409 LOURDES AVE LAS VEGAS NV 89102-4338	16205815011
THOMAS ALPHESIA & BESSIE	1813 BIRCH ST LAS VEGAS NV 89102-4403	16204312043
THOMPSON HEIDI	2113 GLEN HEATHER WY LAS VEGAS NV 89102-4417	16204411004
THORNTON FAMILY TRUST 1989	THORNTON DAVID B III & MARY TRS 2101 DE OSMA ST LAS VEGAS NV 89102-2098	16205813005
THYFAULT STEPHEN	1508 BRYN MAWR AVE LAS VEGAS NV 89102-4447	16204312057
TORRES MICHAEL & LOUISE	2107 KIRKLAND AVE LAS VEGAS NV 89102-4414	16204312023
TRUCE RICHARD A & KRISTINE S	1804 LOCH LOMOND WY LAS VEGAS NV 89102-4440	16204311052
TRUJILLO FAVIOLA	2008 WESTLUND DR LAS VEGAS NV 89102-2000	16205717006
TRUSTEE CLARK COUNTY TREASURER	%A D AMERICA INC 2310 HIGHLAND DR LAS VEGAS NV 89102-4809	16204402003
TRUSTEE CLARK COUNTY TREASURER	%AD AMERICA INC 2310 HIGHLAND DR LAS VEGAS NV 89102-4809	16204402002
TRUSTEE CLARK COUNTY TREASURER	%SCARBOROUGH 2008 TRUST SCARBOROUGH MARK TRS 2413 LOURDES AVE LAS VEGAS NV 89102-4338	16205815012
TRUSTEE CLARK COUNTY TREASURER	%AD AMERICA INC 2310 S HIGHLAND DR LAS VEGAS NV 89102-4809	16204404002
TULLY CARL & MICHELLE	2105 WESTLUND DR LAS VEGAS NV 89102-2052	16205814011
TUNGYOO BANCHA	SUBSUWAN NAREERUD 2520 SIDONIA AVE LAS VEGAS NV 89102-4311	16205813013
TUNGYOO BANCHA	SUBSUWAN NAREERUD 2524 SIDONIA AVE LAS VEGAS NV 89102-4311	16205813014
TURNER CAROL A LIVING TRUST	TURNER CAROL A TRS 2516 SIDONIA AVE LAS VEGAS NV 89102-4311	16205813012

Report of All Selected Parcels**Case Number:** RQR-50937**Printed On:** Wed: October 16, 2013

<u>Owner</u>	<u>Address</u>	<u>Parcel Number</u>
VANDIS ELEANORE MAHLEIN TRS	WALL IRVING M TRS 421 W 57TH ST NEW YORK NY 10019-1763	16204404016
VAUGHAN EYVONNE	2108 GLEN HEATHER WY LAS VEGAS NV 89102-4418	16204410011
VAZQUEZ FAMILY TRUST	10638 HABERSHAM CT LAS VEGAS NV 89183-4551	16205717008
VENTRE MARY ETTA	1512 BRYN MAWR AVE LAS VEGAS NV 89102-4447	16204312056
WARNER GRADON GEORGE REV TR	%G WARNER 112 W DOUGLAS AVE EL CAJON CA 92020-4402	16204312018
WATCHMAN FAMILY TRUST	VIRKLER JARRETT J & AMBER A TRS %J VIRKLER 1920 DE OSMA ST LAS VEGAS NV 89102-2024	16205716014
WEISS ROBERT MICHAEL	2113 NACO CT LAS VEGAS NV 89102-4379	16205813023
WESTERN PROPERTY HOLDINGS L L C	%J GALARDI 713 E OGDEN #B LAS VEGAS NV 89101-4230	16204403001
WESTERN PROPERTY HOLDINGS L L C	%J GALARDI 713 E OGDEN #B LAS VEGAS NV 89101-4230	16204302007
WESTERN PROPERTY HOLDINGS L L C	%J GALARDI 713 E OGDEN #B LAS VEGAS NV 89101-4230	16204302006
WHITE WALTER E & SHARON K	2001 DE OSMA ST LAS VEGAS NV 89102-2097	16205716027
WILLIAMS FAMILY TRUST	WILLIAMS ANTHONY & PATRICIA TRS 1 GOLF VIEW DR HENDERSON NV 89074-1717	16204411007
WILSON GARY & LEILA	2200 ALIA CT LAS VEGAS NV 89102-4333	16205815038
WINIARZ PAULINE H	2517 SIDONIA AVE LAS VEGAS NV 89102-4310	16205813027
WOKNERG FAMILY LIMITED PTNRSH	1601 BRYN MAWR AVE LAS VEGAS NV 89102-4450	16204312005
WOMMER DEBORAH N LIVING TRUST	WOMMER DEBORAH N TRS 2009 CALLE DE ESPANA LAS VEGAS NV 89102-4007	16205716023
WORTHY DARRIN	1900 LOCH LAMOND WAY LAS VEGAS NV 89102-4442	16204311013
WURDELLA MARGARET	DOLBERG NORMA JEAN 3683 DARREN THORNTON WY LAS VEGAS NV 89120-2640	16204411008
WYNN JASMINE THAN	SOHR WILLIAM ERIC 2212 ALIA CT LAS VEGAS NV 89102-4333	16205815035
YANG AMY	4220 SAN BERNARDINO AVE LAS VEGAS NV 89102-5787	16205813003
YAREMA 1979 TRUST	VARNER JO-ELLEN TRS 199 OAK GROVE AVE ATHERTON CA 94027-3217	16204312019
YAREMA PETER III	1517 INVERNESS AVE LAS VEGAS NV 89102-4421	16204312025
YERUSHALMI PROPERTIES V L L C	2400 WESTERN AVE LAS VEGAS NV 89102-4816	16204404006
YERUSHALMI PROPERTIES V L L C	2400 WESTERN AVE LAS VEGAS NV 89102-4816	16204404005
YERUSHALMI PROPERTIES VI L L	%M/M YERUSHALMI 8912 GREENSBORO LN LAS VEGAS NV 89134-0502	16204404004
YERUSHALMI PROPERTIES VII L L C	8912 GREENSBORO LN LAS VEGAS NV 89134-0502	16204404008
ZAVALA LUIS E & DORIS A	1613 INVERNESS AVE LAS VEGAS NV 89102-4427	16204312030
ZHANG AIMIN	2117 GLEN HEATHER WY LAS VEGAS NV 89102-4417	16204411003
ZHONG SHENG	RAINES TANGIE 2412 EL CORTEZ AVE LAS VEGAS NV 89102-6101	16205716008