



Legal Notices Transmittal and Scanning Separator Sheet

Legal Notice Type: Legal Mailings

Date of Transfer to ERM: 10/30/2012

Page Count: 10

Meeting Date: 11/7/2012

Meeting Type: City Council <=>

Case Number(s): RQR-46840 <=>

Subject of Affidavit: APPLICANT/OWNER: TRAISSMAN STEVEN LIVING TRUST - 4250 East Bonanza Road, Suite #10 <=>

Record Series: Legal Notices

LRDA Number: 2007-1717

Retention: Permanent

File By: Meeting Date



Prepared By: acrolli

Scanned By:

SCANNED

QC By: **OCT 30 2012**

City of Las Vegas
Office of City Clerk
495 South Main Street, 2nd Floor
Las Vegas, Nevada 89101

Return Service Requested Official Notice of Public Hearing

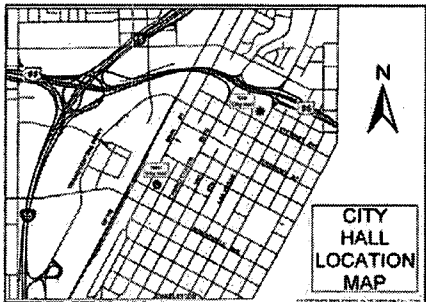

If you wish to file your protest or support on this request, check the appropriate box below and return this card in an envelope with postage to the Office Of The City Clerk at the address listed above or fax this side of this card to (702) 382-4803. If you would like to contact your Council Representative, please call (702) 229-6405.

I SUPPORT
this Request

I OPPOSE
this Request

Please use available blank space on card for your comments.

RQR-46840

City Council Meeting of **11/07/2012**

Application Information

RQR-46840 - REQUIRED REVIEW - PUBLIC HEARING - APPLICANT/OWNER: TRAISSMAN STEVEN LIVING TRUST

- For possible action on a request of a Required Review of an approved Special Use Permit (U-0069-02) FOR AN EXISTING BANQUET FACILITY at 4250 East Bonanza Road, Suite #10 (APN 140-30-802-004), C-1 (Limited Commercial), Zone, Ward 3 (Coffin).

Application Location

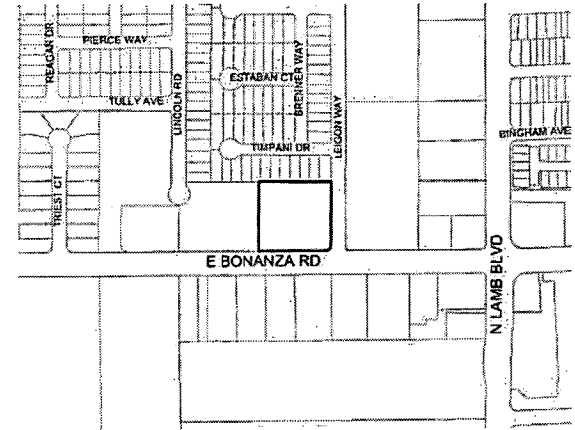

The proposed project may not pertain to the entire highlighted project site.

Public Hearing Information

Meeting: City Council
Date: *November 7, 2012*
Time: 1:00 P.M.
Location: City Council Chambers
495 South Main Street
Las Vegas, Nevada

Any and all interested persons may appear and be heard at said meeting, or may, prior thereto, file written objections thereto or approvals thereof with the City Clerk, 2nd Floor, City Hall, 495 South Main Street, Las Vegas, Nevada, 89101. For further information, including the full staff report, please call (702) 229-6311 (TDD 386-9108) or go to <http://www.lasvegasnevada.gov>.

Report of All Selected Parcels**Case Number:** RQR-46840**Printed On:** Mon: September 24, 2012

<u>Owner</u>	<u>Address</u>	<u>Parcel Number</u>
ACERO FELIPE	4149 HARRIS AVE LAS VEGAS NV 89110-2253	14030811013
ACEVEDO JAVIER	4208 TIMPANI DR LAS VEGAS NV 89110-2244	14030812056
ADAMS JERRY LEONARD SR & ALICE M	4153 HARRIS AVE LAS VEGAS NV 89110-2253	14030811014
ALVARADO ESTELA	4125 PIERCE WY LAS VEGAS NV 89110-2261	14030811054
ALVAREZ ERNESTO A	4137 PIERCE WY LAS VEGAS NV 89110-2261	14030811057
ALVAREZ ROSA	4217 HARRIS AVE LAS VEGAS NV 89110-2225	14030812005
ANDRADE MARIA	716 BRENNER WY LAS VEGAS NV 89110-2237	14030812081
ANGUIANO LUIS ARTURO	ANGUIANO LUIS A & ROSA V 21116 CLAIRAWAY AVE BEUD OR 97702-9347	14030812026
ARMENDARIZ SERGIO	4204 CALIPER DR LAS VEGAS NV 89110-2240	14030812025
ARTHUR JOHN DAVID	4141 PIERCE WY LAS VEGAS NV 89110-2261	14030811058
ASI SOUTHERN NEVADA INC	2550 UNIVERSITY AVE W #330N ST PAUL MN 55114-2014	14030802003
AVEN DAYSHA C & JOSEPH M	4217 ESTABAN CT LAS VEGAS NV 89110-2272	14030812047
AZAR LOUIS & NERI E	728 TAFT CT LAS VEGAS NV 89110-2262	14030811023
BARBOSA LUIS M	664 LINCOLN RD LAS VEGAS NV 89110-2232	14030812095
BARRAZA SHARLEAN	4225 TIMPANI DR LAS VEGAS NV 89110-2247	14030812065
BASCOS LINDA L REVOCABLE LIV TR	BASCOS LINDA L TRS 8801 SCENIC HARBOR DR LAS VEGAS NV 89117-2295	14030803010
BEACH CITIES INVESTMENTS L L C	2123 PULLMAN LN REDONDO BEACH CA 90278-4913	14030814002
BEACH CITIES INVESTMENTS L L C	2123 PULLMAN LN REDONDO BEACH CA 90278-4913	14030814009
BEACH CITIES INVESTMENTS L L C	2123 PULLMAN LN REDONDO BEACH CA 90278-4913	14030814008
BEACH CITIES INVESTMENTS L L C	2123 PULLMAN LN REDONDO BEACH CA 90278-4913	14030814004
BEACH CITIES INVESTMENTS L L C	2123 PULLMAN LN REDONDO BEACH CA 90278-4913	14030814005
BEACJ CITIES INVESTMENTS L L C	2123 PULLMAN LN REDONDO BEACH CA 90278-4913	14030814003
BENTON HOMEOWNERS ASSOCIATION	%ASSOCIATED COMMUNITY MGT 6625 S VALLEY VIEW #310 LAS VEGAS NV 89118-4557	14029415035
BIG DADDY 1 L L C	%F ALVANDI 3230 E FLAMINGO RD #8-352 LAS VEGAS NV 89121-4320	14031501013
BOLTON CLYDE E JR & ANN C	4225 CALIPER DR LAS VEGAS NV 89110-2243	14030812033
BONANZA PINES III L P	%M MULLIN 295 E WARM SPRINGS RD #101 LAS VEGAS NV 89119-4212	14030802007
BONANZA PINES L P	295 E WARM SPRINGS RD #101 LAS VEGAS NV 89119-4212	14030802006
BOYD DONALD E & DOROTHY M	4253 HARRIS AVE LAS VEGAS NV 89110-2226	14030812014
BOYD STEVEN C	724 BRENNER WY LAS VEGAS NV 89110-2237	14030812083
BREMBT VALERIE	LILLIE DWIGHT 271 DONNER AVE LIVERMORE CA 94551-4240	14030811056
BRIDGE MARIA DE JESUS	4225 ESTABAN CT LAS VEGAS NV 89110-2272	14030812049
BRINGHURST WILLIAM L	5473 E BURKSHIRE DR LAS VEGAS NV 89142-1140	14030812028

Report of All Selected Parcels**Case Number:** RQR-46840**Printed On:** Mon: September 24, 2012

<u>Owner</u>	<u>Address</u>	<u>Parcel Number</u>
BURKETT DENNIS L & MARGARET S	648 BRENNER WY LAS VEGAS NV 89110-2236	14030812072
CABRERA JOSE G	4213 ESTABAN CT LAS VEGAS NV 89110-2272	14030812046
CARO-FLORES GRISELDA	4217 TIMPANI LAS VEGAS NV 89110-2245	14030812063
CARPENTER FAMILY TRUST	CARPENTER WILLIAM P & MAYRA TRS 6240 APPLE ORCHARD DR LAS VEGAS NV 89142-0926	14030811033
CASILLOS VIRGINIA	4221 ESTABAN CT LAS VEGAS NV 89110-2272	14030812048
CASTANEDA ANTONIO	6706 BEQUETTE AVE PICO RIVERA CA 90660-3514	14029415028
CAZARES TEODORA C	CAZARES JOSE ELISEO & DANIEL 4425 COOL VALLEY DR LAS VEGAS NV 89110-2376	14029411083
CHAPMAN WILMA ETAL	4420 AVERY PARK AVE LAS VEGAS NV 89110-5488	14029415001
CHERNG FAMILY TRUST	CHERNG ANDREW J & PEGGY T CO-TRS 1683 WALNUT GROVE AVE #201 ROSEMEAD CA 91770-3711	14029401003
CHET PETER	807 SUN SHIMMER PL LAS VEGAS NV 89110-6800	14030814001
CIRCLE K STORES INC	%CIRCLE K STORES INC %PPTY TAX DEPT P O BOX 52085 DC-17 PHOENIX AZ 85072-2085	14030803011
CORONA RUBEN	1280 S LYON ST SANTA ANA CA 92705-4510	14030801008
CORONA RUBEN	1280 S LYON ST SANTA ANA CA 92705-4510	14030801009
CORTEZ JOSE VIDAL & GLORIA E	664 BRENNER WY LAS VEGAS NV 89110-2236	14030812076
CROUCH JERRY	BARTON HELEN 6017 JUBILEE GARDENS CIR LAS VEGAS NV 89131-2333	14030811061
CRUZ ISREAL	815 W 41ST LOS ANGELES CA 90037	14030812009
DELTORO VICTOR H	740 LINCOLN RD LAS VEGAS NV 89110-2233	14030812084
DEMURO LAURA H URCID	P O BOX 30854 LAS VEGAS NV 89173-0854	14030812004
DIAZ ADOLFO SR & MARIA G	8929 TEETERING ROCK AVE LAS VEGAS NV 89143-5404	14030811070
DIAZ PERLA	741 LINCOLN RD LAS VEGAS NV 89110-2235	14030811016
DOMINGO JESUS N & ANNABELLE P	4428 AVERY PARK AVE LAS VEGAS NV 89110-5488	14029415003
ENRIQUEZ SALVADOR & MARIA ISABEL	3504 KEMP ST NO LAS VEGAS NV 89032-7734	14030811034
ESPANA-HERNANDEZ MARIA	4404 BINGHAM AVE LAS VEGAS NV 89110-5433	14029411159
ESPARZA CRUZESETA S & ANDREW A	716 LINCOLN RD LAS VEGAS NV 89110-2233	14030812090
ESPARZA MANUEL GARCIA	DEGARCIA LETICIA GONZALEZ 4404 COOL VALLEY DR LAS VEGAS NV 89110-2375	14029411075
FEDERAL NATIONAL MORTGAGE ASSN	400 NATIONAL WAY SIMI VALLEY CA 93065-6414	14030814018
FEDERICO MARIA L	3757 SURFSIDE CT LAS VEGAS NV 89110	14030814013
FEDOREK JOHN J & JEANNIE M	4237 HARRIS AVE LAS VEGAS NV 89110-2226	14030812010
FERNANDEZ OLGA	4628 SILVER SHORE CT NO LAS VEGAS NV 89081-3246	14030812077
FIELDS GEORGE A	223 MIRA MAR AVE LONG BEACH CA 90803-6112	14030812075
FIRST AMER CAP REAL EST FUND LLC	24040 CAMINO DEL AVION #A152 MONARCH BEACH CA 92629-4005	14030812074

Report of All Selected Parcels**Case Number:** RQR-46840**Printed On:** Mon: September 24, 2012

<u>Owner</u>	<u>Address</u>	<u>Parcel Number</u>
FLADGER BRENDA D	4205 ESTABAN CT LAS VEGAS NV 89110-2270	14030812044
FRANCO GUADALUPE	720 LINCOLN RD LAS VEGAS NV 89110-2233	14030812089
FRANCO GUILLERMO JR	FRANCO ARACELI & GUILLERMO 639 HARNEY CT LAS VEGAS NV 89110-5487	14029415032
GAMOS GABRIEL & ELIZABETH	18045 RAYMER ST NORTHRIDGE CA 91325-3161	14029415031
GARCIA HUGO	4432 MAYCREST AVE LOS ANGELES CA 90032-1302	14030812039
GOC-ONG REY S	SARCO GIFT G 4432 AVERY PARK AVE LAS VEGAS NV 89110-5488	14029415004
GOMEZ MERLIN G & MARIA S	4208 ESTABAN CT LAS VEGAS NV 89110-2269	14030812040
GOMEZ-MERCADO RUBEN A	GOMEZ TERESA 4117 PIERCE WY LAS VEGAS NV 89110-2261	14030811052
GONZALEZ GERMAN G & MIRIAM M	%MOUNTAIN STATES MTGE CTR INC 1333 E 9400 S SANDY UT 84093-2903	14030811053
GONZALEZ-LOPEZ JORGE	4221 TAMPANI DR LAS VEGAS NV 89110-2247	14030812064
GROSSMAN IRWIN TRS	%WALGREEN CO #04086 %TAX DEPT MS #1435 104 WILMOT RD DEERFIELD IL 60015-5121	14029401004
GUERRERO RITA D	4417 COOL VALLEY DR LAS VEGAS NV 89110-2376	14029411081
GUILLEN JOSE & MARIA	P O BOX 1405 MESQUITE NV 89024-1405	14030812002
HALES TRUST 1988 ETAL	HALES GLADE C & FARRIS D TRS 7215 LAREDO ST LAS VEGAS NV 89117-3025	14030812041
HANSEN SANDRA A ETAL	725 LINCOLN RD LAS VEGAS NV 89110-2235	14030811020
HANSON SARAH E & JAMES E II	712 BRENNER WY LAS VEGAS NV 89110-2237	14030812080
HASSIDIM RAMIN & HILIT	5059 ZELZAH AVE ENCINO CA 91316-3628	14030814006
HAU DAT KIEN & MY	4120 TULLY AVE LAS VEGAS NV 89110-2248	14030811072
HAYDEN DEBORAH K	DEPAULA JOHN R 4208 CALIPER DR LAS VEGAS NV 89110-2240	14030812024
HEMMINGMOORE HEATHER	340 S LEMON AVE #8088N WALNUT CA 91789-2706	14030811015
HERNANDEZ ESTEBAN	737 TAFT CT LAS VEGAS NV 89110-2263	14030811030
HERRERA CONRADO	3710 E 5TH ST LOS ANGELES CA 90063-3905	14029415029
HERRERA REYNA A	4429 AVERY PARK AVE LAS VEGAS NV 89110-5488	14029415025
HILARIO VICTOR V & BEBS S	4213 TAMPANI DR LAS VEGAS NV 89110-2245	14030812062
HITCHEW JOSEPH MARK & ROSALIE M	4229 CALIPER DR LAS VEGAS NV 89110-2243	14030812034
HODSON HERBERT & M FAM TR ETAL	HODSON HERBERT R TRS ETAL 701 TEXAS ST REDLANDS CA 92374-3035	14031501016
HOUSING AUTHORITY SOUTHERN NV	%J HILL 340 N 11TH ST #370 LAS VEGAS NV 89101-3125	14031501017
HOUSING AUTHORITY SOUTHERN NV	%J HILL 340 N 11TH ST #170 LAS VEGAS NV 89101-3125	14030812086
HOVSEPIAN JIRAIR & NADEZHDA	4224 CALIPER LAS VEGAS NV 89110-2242	14030812020
HUNEBESONE L L C	3900 S HUALAPAI #125 LAS VEGAS NV 89147-5738	14030812052
IBARRA-GORDIAN MARIA M	733 LINCOLN RD LAS VEGAS NV 89110-2235	14030811018
JAMORA NESTOR G & ELIZABETH T	4212 CALIPER DR LAS VEGAS NV 89110-2240	14030812023

Report of All Selected Parcels**Case Number:** RQR-46840**Printed On:** Mon: September 24, 2012

<u>Owner</u>	<u>Address</u>	<u>Parcel Number</u>
JOHNSON PHILLIP S	4221 CALIPER DR LAS VEGAS NV 89110-2243	14030812032
JONATHAN INC	4301 E BONANZA RD LAS VEGAS NV 89110-2201	14031501010
K & K ASSET MANAGEMENT L L C	1759 ENGLISH ROSE DR LAS VEGAS NV 89142-0763	14029415026
KARAGDAG ROLANDO	2206 LITTLE RIVER CT LAS VEGAS NV 89156-6100	14030811055
KEOSAVANG SAM & KHAMPAH	4145 PIERCE WY LAS VEGAS NV 89110-2261	14030811059
KIM HUI JA	67-21 210 ST BAYSIDE NY 11364-2503	14029411157
KNIGHT DONNA JEAN 2008 TRUST	KNIGHT DONNA JEAN TRS 4413 COOL VALLEY DR LAS VEGAS NV 89110-2376	14029411079
KNIGHT DONNA JEAN 2008 TRUST	KNIGHT DONNA JEAN TRS 4413 COOL VALLEY DR LAS VEGAS NV 89110-2376	14029411080
KRIDER MAE R	4156 TULLY AVE LAS VEGAS NV 89110-2250	14030811063
KUSKOWSKI LINDA	4408 COOL VALLEY DR LAS VEGAS NV 89110-2375	14029411074
LAMANZA L L C	%PACIFIC PPTY GROUP 12100 WILSHIRE BLVD #1025 LOS ANGELES CA 90025-7129	14032101012
LANDEROS ANTONIO	MORENO LIDIA C 4152 TULLY AVE LAS VEGAS NV 89110-2250	14030811064
LAPARAN RODRIGO & ROWENA	863 N EDGEMONT ST LOS ANGELES CA 90029-2519	14029411001
LAPRAY RUSSELL D & DORIS A	4228 CALIPER DR LAS VEGAS NV 89110-2242	14030812019
LARA NICOLAS	632 LINCOLN RD LAS VEGAS NV 89110-2231	14030812103
LARGE EUGENE R	4236 CALIPER DR LAS VEGAS NV 89110-2242	14030812017
LEAVITT MELODY K	729 TAFT CT LAS VEGAS NV 89110-2263	14030811032
LEYVA MANUEL	CABRAL ROSA 4209 CALIPER DR LAS VEGAS NV 89110-2241	14030812029
LEYVA MONICO	4220 CALIPER DR LAS VEGAS NV 89110-2242	14030812021
LIANG CLARK	LIANG-CHIN GUI 7217 SHERBOURNE LN SAN DIEGO CA 92129-4658	14030814016
LIANG CLARK	LIANG-CHIN GUI 7217 SHERBOURNE LN SAN DIEGO CA 92129-4658	14030814015
LIANG CLARK	LIANG-CHIN GUI 7217 SHERBOURNE LN SAN DIEGO CA 92129-4658	14030814011
LISI THOMAS H & SUSAN C	CORONA RUBEN 1280 S LYON ST SANTA ANA CA 92705-4510	14030801010
LOPEZ PRESCILO K & GRACIA S	4424 AVERY PARK AVE LAS VEGAS NV 89110-5488	14029415002
LUCIANO EDDIE	700 LINCOLN RD LAS VEGAS NV 89110-2232	14030812094
LYNNMARIE HOMES L L C	9913 FOX SPRINGS DR LAS VEGAS NV 89117	14030812006
MANDAS PETER J TRUST	MANDAS PETER J & LINDA L TRS 4301 E BONANZA RD LAS VEGAS NV 89110-2201	14031501009
MANRIQUE MARIA G	737 LINCOLN RD LAS VEGAS NV 89110-2235	14030811017
MANZO TOMAS J	FLORES CAMERINA 4424 BINGHAM AVE LAS VEGAS NV 89110-5433	14029411156
MARQUEZ ISAURO	MORGA DALIA 5400 VERBENA CREEK CT LAS VEGAS NV 89131-2933	14029411158
MARTINEZ JESUS E	4201 TIMPANI DR LAS VEGAS NV 89110-2245	14030812059
MARTINEZ JOSE L & SONIA M	644 LINCOLN RD LAS VEGAS NV 89110-2231	14030812100

Report of All Selected Parcels**Case Number:** RQR-46840**Printed On:** Mon: September 24, 2012

<u>Owner</u>	<u>Address</u>	<u>Parcel Numbe</u>
MARTINEZ RAMON & MANUELA	4228 TIMPANI DR LAS VEGAS NV 89110-2246	14030812051
MATAMOROS ROGER A	HERNANDEZ ANA 4148 TULLY AVE LAS VEGAS NV 89110-2250	14030811065
MATSUO RYAN K & SOCORRO T	24946 LORNA DR MORENO VALLEY CA 92553-5883	14030811066
MCDANIEL RUTH	640 LINCOLN RD LAS VEGAS NV 89110-2231	14030812101
MEJIA ISMAEL & MARIA MERCEDES	660 LINCOLN RD LAS VEGAS NV 89110-2232	14030812096
MENDEZ-HERNANDEZ ARNULFO & M	4249 HARRIS AVE LAS VEGAS NV 89110-2226	14030812013
MONCAYO ELIZABETH	656 LINCOLN RD LAS VEGAS NV 89110-2232	14030812097
MONTANA DANIEL G	724 TAFT CT LAS VEGAS NV 89110-2262	14030811022
MONTES CARMEN M	4401 COOL VALLEY DR LAS VEGAS NV 89110-2376	14029411077
MONY TRUST	%R SAUCEDO 733 TAFT CT LAS VEGAS NV 89110-2263	14030812073
MORALES DIANA DEL BOSQUE	4245 HARRIS AVE LAS VEGAS NV 89110-2226	14030812012
MORENO-CUELLAR JORGE E	ALVARENGA MARIA A 6538 CANDY APPLE CIR LAS VEGAS NV 89142-0985	14030814007
MORENO-CUELLAR JORGE E	ALVARENGA MARIA A 6538 CANDY APPLE CIR LAS VEGAS NV 89142-0985	14030814014
NORMAN CHARMAIN J	4229 HARRIS AVE LAS VEGAS NV 89110-2226	14030812008
OAK ESTATES L L C COCOA SERIES	848 N RAINBOW BLVD #1427 LAS VEGAS NV 89107-1103	14030812093
OCHOA JAIME	701 REAGAN DR LAS VEGAS NV 89110-2256	14030811051
OH PHILLIP J	971 S HOOVER ST LOS ANGELES CA 90006-1913	14030814010
OLIVARES JESUS A & LUZ M	OLIVARES JUAN LUIS 728 LINCOLN RD LAS VEGAS NV 89110-2233	14030812087
ONTIVEROS JANET C	6628 CADDINGTON AVE LAS VEGAS NV 89110-1946	14030812068
OONCHARN KOBKUL	631 HARNEY CT LAS VEGAS NV 89110-5487	14029415030
OROPEZA EMILIO SR & YOLANDA L	P O BOX 364701 NO LAS VEGAS NV 89036-8701	14030811069
PACPROP SERVICE L L C	12100 WILSHIRE BLVD #1025 LOS ANGELES CA 90025-7129	14032101014
PEREZ BLANCA M	6670 TRANQUIL SEAS CT LAS VEGAS NV 89139-5332	14030814012
PEREZ TOMASA	139 N 21ST ST LAS VEGAS NV 89101-4501	14030812003
PERSAUD RONALD B & MAINAWATEE T	1568 JENSEN DR PITTSBURG CA 94565-6441	14030814017
PINEDA-RIVERA JESUS E	DEPINEDA BLANCA E PENA 4225 HARRIS AVE LAS VEGAS NV 89110-2225	14030812007
PINTAONE TOM	4124 TULLY AVE LAS VEGAS NV 89110-2248	14030811071
PROBST ENTERPRISES INC	%T PROBST 242 VALLE VISTA WY DURANGO CO 81301-6504	14031501014
PROBST ENTERPRISES INC	%T PROBST 242 VALLE VISTA WY DURANGO CO 81301-6504	14031501012
PYPER CRAIG NEWMAN & VALERIE J	4213 CALIPER DR LAS VEGAS NV 89110-2241	14030812030
QUIROZ MAYRA	4405 COOL VALLEY LAS VEGAS NV 89110-2376	14029411078
R & L 2011 HOLDINGS L L C	901 WHITE HILLS CIR HENDERSON NV 89011-3085	14030812011

Report of All Selected Parcels**Case Number:** RQR-46840**Printed On:** Mon: September 24, 2012

<u>Owner</u>	<u>Address</u>	<u>Parcel Number</u>
R F K HOLDING 9 L L C	905 CALVILLE ESTATES CT HENDERSON NV 89015-3004	14030811060
RAMIREZ POLETH	4400 COOL VALLEY DR LAS VEGAS NV 89110-2375	14029411076
RANDOLPH TAMISHA	628 LINCOLN RD LAS VEGAS NV 89110-2231	14030812104
RATTANA SAM & SIRAPRAPHA	4244 CALIPER DR LAS VEGAS NV 89110-2242	14030812015
REDDEN BILLY D	4212 TIMPANI DR LAS VEGAS NV 89110-2244	14030812055
REGALADO BERTHA	BELTRAN GUADALUPE SANDOVAL 4012 HARRIS AVE LAS VEGAS NV 89110-2254	14030812001
REGENCY INVESTMETNS L L C	P O BOX 35602 LOS ANGELES CA 90035-0602	14030812070
RENTERIA RAMON	4229 TIMPANI DR LAS VEGAS NV 89110-2247	14030812066
RIVERA JOSE M	10778 CHILLINGHAM DR LAS VEGAS NV 89183-4624	14030811019
RIVERA MARIA E	4209 ESTABAN CT LAS VEGAS NV 89110-2270	14030812045
RODRIGUEZ GEORGE & ELIZABETH	4140 TULLY AVE LAS VEGAS NV 89110-2250	14030811067
RODRIGUEZ JUAN	4200 TIMPANI DR LAS VEGAS NV 89110-2244	14030812058
ROOHANI RUSTAM & SHAHNAZ TRS	ROOHANI HOUSHANG FAMILY TRUST 9315 W SUNSET RD #100 LAS VEGAS NV 89148-5012	14030803009
ROSALES JUAN C	DEROSALES MARIA B 4216 CALIPER DR LAS VEGAS NV 89110-2240	14030812022
RUIZ GUADALUPE V	4635 57TH ST MAYWOOD CA 90270-2911	14030812031
RUIZ JOSE L	740 TAFT CT LAS VEGAS NV 89110-2262	14030811026
RUIZ MARIA GREGORIA & JOSE DAVID	4232 CALIPER DR LAS VEGAS NV 89110-2242	14030812018
RUIZ ROGELIO	709 REAGAN DR LAS VEGAS NV 89110-2256	14030811049
S C P 2006-C23-106 L L C	%CVS PHARMACY INC #8824-01 %STORE ACCOUNTING DEPT 1 CVS DR WOONSOCKET RI 02895-6146	14032101015
SAEVERDA GERARDO	22178 CENTER #A SANTA ANA CA 92704	14030811027
SALAS GONZALO	13016 TELFAIR AVE SYLMAR CA 91342-3547	14030812071
SALAS GONZALO	13016 TELFAIR AVE SYLMAR CA 91342-3547	14030812098
SALAZAR ROSA L	4405 HALBERT ST LAS VEGAS NV 89110-5465	14029411002
SALV L L C	10624 S EASTERN AVE #A-190 HENDERSON NV 89052-2982	14030812061
SAMANIEGO LUIS M	4412 COOL VALLEY DR LAS VEGAS NV 89110-2375	14029411073
SANCHEZ-LOPEZ PORFIRIO	601 TRIEST CT LAS VEGAS NV 89110-2209	14030814019
SANDHILL VILLAGE L L C	1000 CORPORATE CENTER DR #555 MONTEREY PARK CA 91754-7613	14030801006
SAUCEDO ROGELIO	733 TAFT CT LAS VEGAS NV 89110-2263	14030811031
SAUCEDO SECUNDINO	%NORTH AMER MTGE CO P O BOX 808031 PETALUMA CA 94975-8031	14030811021
SENIBALDI LOLLY E	724 LINCOLN RD LAS VEGAS NV 89110-2233	14030812088
SERNA EFRAIN	1121 PASSION FLOWER CIR LAS VEGAS NV 89108-1701	14029411155

Report of All Selected Parcels**Case Number:** RQR-46840**Printed On:** Mon: September 24, 2012

<u>Owner</u>	<u>Address</u>	<u>Parcel Number</u>
SIERRA-NEVADA MULTIFAMILY INVEST	%CAMDEN PPTY TRUST %B BANEY 3 GREENWAY PLAZA #1300 HOUSTON TX 77046-0391	14030801007
SILVA JOSE LUIS & LUCINA	4200 ESTABAN CT LAS VEGAS NV 89110-2269	14030812042
SINGH MELISSA	1173 MORNING SUN WY LAS VEGAS NV 89110-2903	14030812027
SMITH KELLY	CAZARES FERNANDO D 4240 CALIPER DR LAS VEGAS NV 89110-2242	14030812016
SMOG CHECK CAR WASH L L C	1011 MORNING SUN WY LAS VEGAS NV 89110-2929	14031501015
SO NV REGIONAL HOUSING AUTHORITY	%C ROWE 340 N 11 ST #170 LAS VEGAS NV 89101-3125	14030812085
SO NV REGIONAL HOUSING AUTHORITY	%C ROWE 340 N 11 ST #170 LAS VEGAS NV 89101-3125	14030812038
SO NV REGIONAL HOUSING AUTHORITY	%C ROWE 340 N 11 ST #170 LAS VEGAS NV 89101-3125	14030812067
SO NV REGIONAL HOUSING AUTHORITY	%C ROWE 340 N 11 ST #170 LAS VEGAS NV 89101-3125	14030811024
SO NV REGIONAL HOUSING AUTHORITY	%C ROWE 340 N 11 ST #170 LAS VEGAS NV 89101-3125	14030812069
SO NV REGIONAL HOUSING AUTHORITY	%C ROWE 340 N 11 ST #170 LAS VEGAS NV 89101-3125	14030811025
SO NV REGIONAL HOUSING AUTHORITY	%C ROWE 340 N 11 ST #170 LAS VEGAS NV 89101-3125	14030812057
SOLORZANO ADILIA G	4224 ESTABAN CT LAS VEGAS NV 89110-2271	14030812036
SOTO ROQUE	4433 AVERY PARK AVE LAS VEGAS NV 89110-5488	14029415024
SOUTHWEST CARPENTERS TRAINING	980 KELLY JOHNSON DR #180 LAS VEGAS NV 89119-3722	14031501002
TAPIA RAYMOND J	315 E 2ND ST HANFORD CA 93230-5104	14030811035
TORIBIO JOSE MANUEL GARCIA	ALVAREZ CLAUDIA GUZMAN 4421 COOL VALLEY DR LAS VEGAS NV 89110-2376	14029411082
TORRES EDUARDO & SAMUEL	712 LINCOLN RD LAS VEGAS NV 89110-2232	14030812091
TORRES MARIO & TRACY	720 BRENNER WY LAS VEGAS NV 89110-2237	14030812082
TORRES TOMAS	636 LINCOLN RD LAS VEGAS NV 89110-2231	14030812102
TRAISMAN STEVEN LIVING TRUST	TRAISMAN STEVEN TRS 7235 BERMUDA RD #A LAS VEGAS NV 89119-4315	14030802004
UNION I B E W LOCAL 357	808 N LAMB BLVD LAS VEGAS NV 89110-2304	14030803012
UNION INTL HODCARRIERS #872	2345 RED ROCK ST #330 LAS VEGAS NV 89146-3157	14031501003
UNION LOCAL 525 TRAINING TR NV	750 N LAMB BLVD LAS VEGAS NV 89110-2307	14030803013
UNION LOCAL 872 LABORER'S INTL	2345 RED ROCK ST #330 LAS VEGAS NV 89146-3157	14031501008
UNION LOCAL 872 LABORER'S INTL	2345 RED ROCK ST #330 LAS VEGAS NV 89146-3157	14031501006
UNION LOCAL 872 LABORER'S INTL	2345 RED ROCK ST #330 LAS VEGAS NV 89146-3157	14031501007
UNION LOCAL 872 LABORER'S INTL	2345 RED ROCK ST #330 LAS VEGAS NV 89146-3157	14031501005
UNION LOCAL 872 LABORER'S INTL	2345 RED ROCK ST #330 LAS VEGAS NV 89146-3157	14031501004
UNION PLUMBERS PIPEFITTERS #525	760 N LAMB BLVD LAS VEGAS NV 89110-2307	14030803002
UNION TEAMSTERS #631	700 N LAMB BLVD LAS VEGAS NV 89110-2307	14030803004
UNION TEAMSTERS LOCAL #631	700 N LAMB BLVD LAS VEGAS NV 89110-2307	14030803006

Report of All Selected Parcels**Case Number:** RQR-46840**Printed On:** Mon: September 24, 2012

<u>Owner</u>	<u>Address</u>	<u>Parcel Number</u>
UNION TEAMSTERS LOCAL #631	700 N LAMB BLVD LAS VEGAS NV 89110-2307	14030803007
VALLEJO MANUEL	4421 AVERY PARK AVE LAS VEGAS NV 89110-5488	14029415027
VALLEJO ROSANNA	587 W SIERRA VISTA CIR MESQUITE NV 89027-2547	14030812037
VARELA ANTHONY & CAROLYN	704 BRENNER WY LAS VEGAS NV 89110-2237	14030812078
VELASCO J REFUGIO	705 REAGAN DR LAS VEGAS NV 89110-2256	14030811050
VILLALOBOS ELVIA DIANA	5837 STATELINE WAY LAS VEGAS NV 89110-3854	14029411160
VIVIR JOSE L PAZ	4205 TIMPANI DR LAS VEGAS NV 89110-2245	14030812060
VON-HEEDER LISA M	648 LINCOLN RD LAS VEGAS NV 89110-2231	14030812099
WAHL LOUIS JOSEPH & MARY E	4136 TULLY AVE LAS VEGAS NV 89110-2248	14030811068
WALKER EUGENE & ADRIANA	515 CORAL TRACE BLVD EDGEWATER FL 32132-6944	14030812050
WALTERS JOHNNIE J LIVING TRUST	WALTERS JOHNNIE J TRS 601 S 10TH ST #203 LAS VEGAS NV 89101-7027	14030812043
WANG XIDAN	3640 LOS FELIZ BLVD #2 LOS ANGELES CA 90027-2435	14030812035
WELLS RONALD L & OK SUN	708 BRENNER WY LAS VEGAS NV 89110-2237	14030812079
WESCOMBE NANCY A	5821 W BARTLETT AVE LAS VEGAS NV 89108	14030811073
YAMIN FAMILY 1999 L P	%M YAMIN 640 CLINTON PL BEVERLY HILLS CA 90210-1917	14031501011
YEOMAN MARIA C	4216 TIMPANI DR LAS VEGAS NV 89110-2244	14030812054
ZARZA ROSA & JESUS	4157 PIERCE WY LAS VEGAS NV 89110-2261	14030811062
ZAYAS RICARDO M	QUINONES CARMEN 708 LINCOLN RD LAS VEGAS NV 89110-2232	14030812092
ZEPEDA IVAN LORENZO	4220 TIMPANI DR LAS VEGAS NV 89110-2246	14030812053