



**Legal Notices Transmittal and Scanning Separator Sheet**

**Legal Notice Type: Legal Mailings**

Date of Transfer to ERM: 10/30/2012

Page Count: 5

Meeting Date: 11/7/2012

Meeting Type: City Council <=>

Case Number(s): RQR-46754 <=>

Subject of Affidavit: APPLICANT: REAGAN OUTDOOR ADVERTISING - OWNER: HIGHLAND INDUSTRIAL PARK PARTNERSHIP - 2903 Highland Drive <=>

Record Series: Legal Notices

LRDA Number: 2007-1717

Retention: Permanent

File By: Meeting Date



Prepared By: acrolli

Scanned By:

**SCANNED**

QC By:

**OCT 30 2012**

City of Las Vegas  
Office of City Clerk  
495 South Main Street, 2<sup>nd</sup> Floor  
Las Vegas, Nevada 89101

## Return Service Requested Official Notice of Public Hearing

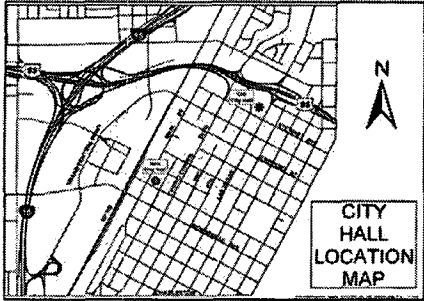

If you wish to file your protest or support on this request, check the appropriate box below and return this card in an envelope with postage to the Office Of The City Clerk at the address listed above or fax this side of this card to (702) 382-4803. If you would like to contact your Council Representative, please call (702) 229-6405.

I SUPPORT  
this Request

I OPPOSE  
this Request

Please use available blank space on card for your comments.

**RQR-46754**

City Council Meeting of **11/07/2012**

## Application Information

**RQR-46754 - REQUIRED REVIEW - PUBLIC HEARING -  
APPLICANT: REAGAN OUTDOOR ADVERTISING -  
OWNER: HIGHLAND INDUSTRIAL PARK PARTNERSHIP -**  
For possible action on a Required Review of an approved Special Use Permit (SUP-1876) FOR AN EXISTING 45-FOOT TALL, 24-FOOT BY 28-FOOT OFF-PREMISE SIGN at 2903 Highland Drive (APN 162-09-210-002), M (Industrial) Zone, Ward 1 (Tarkanian).

## Application Location

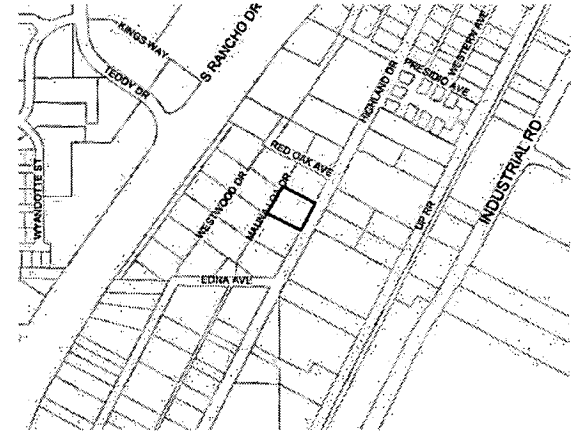

The proposed project may not pertain to the entire highlighted project site.

## Public Hearing Information

**Meeting:** City Council  
**Date:** *November 7, 2012*  
**Time:** 1:00 P.M.  
**Location:** City Council Chambers  
495 South Main Street  
Las Vegas, Nevada

Any and all interested persons may appear and be heard at said meeting, or may, prior thereto, file written objections thereto or approvals thereof with the City Clerk, 2nd Floor, City Hall, 495 South Main Street, Las Vegas, Nevada, 89101. For further information, including the full staff report, please call (702) 229-6311 (TDD 386-9108) or go to <http://www.lasvegasnevada.gov>,

**Report of All Selected Parcels****Case Number:** RQR-46754**Printed On:** Wed: September 26, 2012

<u>Owner</u>	<u>Address</u>	<u>Parcel Number</u>
2701 WESTWOOD L L C	%MR R BRANDY 1113 PINE ISLAND CT LAS VEGAS NV 89134-6330	16209102002
2861 S HIGHLAND DRIVE L L C	P O BOX 1305 CAMARILLO CA 93011-1305	16209201003
D 2753 L L C	%COLDWELL BANKER COML 5130 S FORT APACHE RD #215-419 LAS VEGAS NV 89148-1719	16209102003
D 2753 L L C	P O BOX 570427 HOUSTON TX 77257-0427	16209102004
D 2765 L L C	8222 ANOINE DR #100 HOUSTON TX 77088	16209201001
D 2801 WESTWOOD INC	P O BOX 570413 HOUSTON TX 77257-0413	16208604001
D'AQUINO GAETANO & SYLVIA FAM TR	D'AQUINO GAETANO TRS %D'AQUINO ITALIAN IMPORTING 1850 BUSINESS CENTER DR DUARTE CA 91010-2901	16209202014
DITEL L L C	6817 S EASTERN AVE #101 LAS VEGAS NV 89119-4684	16209203003
E-J CLUB L L C	%E WEDELSTEDT 4655 N COLORADO BLVD DENVER CO 80216-3217	16209203005
ENGLERT HIGHLANDS PPTYS L L C	P O BOX 46650 LAS VEGAS NV 89114-6650	16208705001
ENGLERT HIGHLANDS PPTYS L L C	P O BOX 46650 LAS VEGAS NV 89114-6650	16208705002
F K C HIGHLAND L L C	%L KRAEMER JR 101 S KRAEMER BLVD #136 PLACENTIA CA 92870-6190	16208706001
F K C HIGHLAND L L C	%L KRAEMER JR 101 S KRAEMER BLVD #136 PLACENTIA CA 92870-6190	16209301003
F K C HIGHLAND L L C	%L KRAEMER JR 101 S KRAEMER BLVD #136 PLACENTIA CA 92870-6190	16209301002
F K C HIGHLAND L L C	%L KRAEMER JR 101 S KRAEMER BLVD #136 PLACENTIA CA 92870-6190	16209202012
F K C HIGHLAND L L C	%L KRAEMER JR 101 S KRAEMER BLVD #136 PLACENTIA CA 92870-6190	16208707001
H & M INVESTMENTS I L L C	P O BOX 14845 LAS VEGAS NV 89114-4845	16208703003
HAAS FAMILY TRUST	HAAS ROBERT MELVIN & JO A TRS %SAHARA AIR 2718 HIGHLAND DR LAS VEGAS NV 89109-1004	16209211005
HAAS FAMILY TRUST	HAAS ROBERT MELVIN & JO A TRS %SAHARA AIR 2718 HIGHLAND DR LAS VEGAS NV 89109-1004	16209211006
HIGHLAND INDUST PK PTNRSH	2500 W SAHARA AVE #211 LAS VEGAS NV 89102-4393	16209210002
HIGHLAND INDUST PK PTNRSH	2500 W SAHARA AVE #211 LAS VEGAS NV 89102-4393	16208611009
HIGHLAND INDUST PK PTNRSH	2500 W SAHARA AVE #211 LAS VEGAS NV 89102-4393	16209210001
HIGHLAND INDUST PK PTNRSH	2500 W SAHARA AVE #211 LAS VEGAS NV 89102-4393	16208611007
HIGHLAND INDUST PK PTNRSH	2500 W SAHARA AVE #211 LAS VEGAS NV 89102-4393	16208611016
HIGHLAND INDUST PK PTNRSH	2500 W SAHARA AVE #211 LAS VEGAS NV 89102-4393	16208611001
HIGHLAND INDUST PK PTNRSH	2500 W SAHARA AVE #211 LAS VEGAS NV 89102-4393	16208611012
HIGHLAND INDUST PK PTNRSH	2500 W SAHARA AVE #211 LAS VEGAS NV 89102-4393	16208611006
HIGHLAND INDUST PK PTNRSH	2500 W SAHARA AVE #211 LAS VEGAS NV 89102-4393	16208611005
HIGHLAND INDUST PK PTNRSH	2500 W SAHARA AVE #211 LAS VEGAS NV 89102-4393	16208611010
HIGHLAND INDUST PK PTNRSH	2500 W SAHARA AVE #211 LAS VEGAS NV 89102-4393	16208611008

**Report of All Selected Parcels****Case Number:** RQR-46754**Printed On:** Wed: September 26, 2012

<u>Owner</u>	<u>Address</u>	<u>Parcel Numbe</u>
HIGHLAND INDUST PK PTNRSH	2500 W SAHARA AVE #211 LAS VEGAS NV 89102-4393	16208611011
HIGHLAND INDUST PK PTNRSH	2500 W SAHARA AVE #211 LAS VEGAS NV 89102-4393	16208611002
HIGHLAND INDUST PK PTNRSH	2500 W SAHARA AVE #211 LAS VEGAS NV 89102-4393	16208611015
HIGHLAND INDUST PK PTNRSH	2500 W SAHARA AVE #211 LAS VEGAS NV 89102-4393	16208611003
HIGHLAND INDUST PK PTNRSH	2500 W SAHARA AVE #211 LAS VEGAS NV 89102-4393	16208611014
HIGHLAND INDUST PK PTNRSH	2500 W SAHARA AVE #211 LAS VEGAS NV 89102-4393	16208611004
HIGHLAND INDUSTRIAL PARK PTNRSH	%NEVADA DEVELOPMENT & REALTY CO 2500 W SAHARA AVE #211 LAS VEGAS NV 89102-4393	16208611013
HIGHLAND INDUSTRIAL PARK PTNRSH	%NEVADA DEVELOPMENT & REALTY CO 2500 W SAHARA AVE #211 LAS VEGAS NV 89102-4393	16208604002
HUGHES FAMILY L L C #2	COURY FAMILY L L C #3 2975 S HIGHLAND DR LAS VEGAS NV 89109-1011	16208705004
INDUSTRIAL OFFICE COMPLEX L L C	%G KRSTANOVIC 2975 S INDUSTRIAL RD LAS VEGAS NV 89109-1134	16209302007
JACOBS JOSEPH & NANCY TRUST	JACOBS JOSEPH A & NANCY D TRS 3729 TOPAWA ST LAS VEGAS NV 89103-2435	16209211009
JACOBS JOSEPH & NANCY TRUST	JACOBS JOSEPH A & NANCY D TRS 3729 TOPAWA ST LAS VEGAS NV 89103-2435	16209111001
KHAZAI SHAHRIAR & ISABELA	P O BOX 25879 LOS ANGELES CA 90025-0879	16209202008
L'CHAIM WESTERN SUPPLY PPTY LLC	6130 W FLAMINGO RD #402 LAS VEGAS NV 89103-2280	16209201002
LEONARDI PROPERTIES	46 LOUISE ST SAN RAFAEL CA 94901-4718	16209203006
M T WAREHOUSE L L C	9030 W SAHARA AVE #299 LAS VEGAS NV 89117-5744	16209211004
MARTIN ROBERT E & KAYE	7045 LAREDO ST LAS VEGAS NV 89117-3021	16208703001
MAYORGA LOUIS A TRUST	MAYORGA LOUIS A TRS 5115 THATABOY CT LAS VEGAS NV 89130-2152	16208704002
MENDELL FAMILY PARTNERS L P	%S MENDELL P O BOX 8510 RANCHO SANTA FE CA 92067-8510	16208703002
MOMARY DOUGLAS R & EMILY J	BOND GEORGE T & PHYLLIS D 2708 HIGHLAND DR LAS VEGAS NV 89109-1004	16209111002
N P PALACE L L C	%GEN COUNSEL 1505 S PAVILION CENTER DR LAS VEGAS NV 89135-1403	16208602005
N P PALACE L L C	%GEN COUNSEL 1505 S PAVILION CENTER DR LAS VEGAS NV 89135-1403	16208502011
N Y P CORPORATION	6120 S TORREY PINES LAS VEGAS NV 89118-3209	16209202013
N Y P CORPORATION	6120 S TORREY PINES LAS VEGAS NV 89118-3209	16209202001
P L MOTOR L L C	6625 W BADURA AVE LAS VEGAS NV 89118-4673	16209211007
PFIZENMAYER FAMILY TRUST	PFIZENMAYER GARY & ANGEL TRS 2338 READING HILLS AVE HENDERSON NV 89052-5836	16208705003
PLANET PROPERTIES L L C	%FIRST REPUBLIC BANK %COML REAL ESTATE LOAN 111 PINE ST SAN FRANCISCO CA 94111-5602	16209202011
PLANET PROPERTIES L L C	%FIRST REPUBLIC BANK %COML REAL ESTATE LOAN 111 PINE ST SAN FRANCISCO CA 94111-5602	16209202009
POSITIVE SPACE INC	%B ALLEN PHOTOGRAPHY 18 STAR BROOK AVE HENDERSON NV 89052-6628	16209202010
R S G PARTNERS L L C	1625 SKYLINE DR FULLERTON CA 92831-1007	16208704001
S H A C M T L L C ETAL	%SHAC LLC %D TALLA 11151 MISSOURI AVE LOS ANGELES CA 90025-5634	16209302006

**Report of All Selected Parcels**

**Case Number:** RQR-46754

**Printed On:** Wed: September 26, 2012

<u>Owner</u>	<u>Address</u>	<u>Parcel Numbe</u>
SCHIFF MARVIN JAMES TRS	MASON FAMILY TRUST 2401 INDUSTRIAL RD LAS VEGAS NV 89102-4817	16209301001
SEDANO AIDA C & HIRAM H	2706 S HIGHLAND DR LAS VEGAS NV 89109-1004	16209211008
TRUSTEE CLARK COUNTY TREASURER	%NEVADA SPACE INC 1900 E DESERT INN RD LAS VEGAS NV 89169-3211	16209202007
W B P LEASING INC	621 NW 53RD ST #700 BOCA RATON FL 33487-8242	16209203004
WYANDOTTE HOLDINGS L L C	299 PARK AVE 42ND FL NEW YORK NY 10171-4299	16208610104