



Legal Notices Transmittal and Scanning Separator Sheet

Legal Notice Type: Legal Mailings

Date of Transfer to ERM: 1/28/2013

Page Count: 5

Meeting Date: 12/19/2012

Meeting Type: City Council <=>

Case Number(s): RQR-46132 <=>

Subject of Affidavit: APPLICANT: CLEAR CHANNEL OUTDOOR - OWNER: CLAREMONT HOTEL,
INC. - 2601 Westwood Drive <=>

Record Series: Legal Notices

LRDA Number: 2007-1717

Retention: Permanent

File By: Meeting Date



Prepared By: acrolli

Scanned By:

QC By:

UNSCANNED

JAN 29 2013

City of Las Vegas
Office of City Clerk
495 South Main Street, 2nd Floor
Las Vegas, Nevada 89101

Return Service Requested Official Notice of Public Hearing

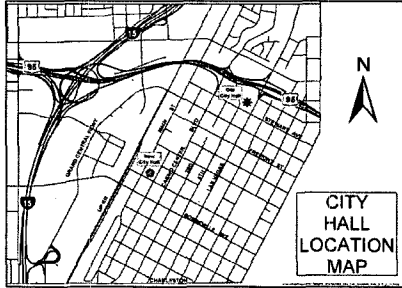

If you wish to file your protest or support on this request, check the appropriate box below and return this card in an envelope with postage to the Office Of The City Clerk at the address listed above or fax this side of this card to (702) 382-4803. If you would like to contact your Council Representative, please call (702) 229-6405.

I SUPPORT
this Request

I OPPOSE
this Request

Please use available blank space on card for your comments.

RQR-46132

City Council Meeting of **12/19/2012**

Application Information

RQR-46132 - REQUIRED REVIEW - PUBLIC HEARING - APPLICANT: CLEAR CHANNEL OUTDOOR - OWNER: CLAREMONT HOTEL, INC. - For possible action on a Required Review of an approved Special Use Permit (SUP-3140) FOR AN EXISTING 55-FOOT TALL, 26-FOOT X 24-FOOT OFF-PREMISE SIGN at 2601 Westwood Drive (APN 162-09-102-005), M (Industrial) Zone, Ward 1 (Tarkanian).

Application Location

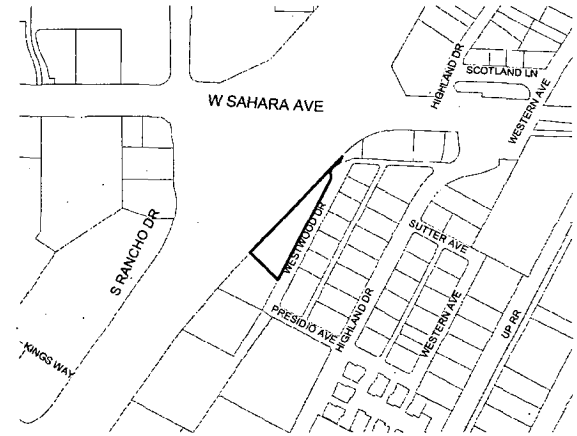

The proposed project may not pertain to the entire highlighted project site.

Public Hearing Information

Meeting: City Council
Date: *December 19, 2012*
Time: 1:00 P.M.
Location: City Council Chambers
495 South Main Street
Las Vegas, Nevada

Any and all interested persons may appear and be heard at said meeting, or may, prior thereto, file written objections thereto or approvals thereof with the City Clerk, 4th Floor, City Hall, 495 South Main Street, Las Vegas, Nevada, 89101. For further information, including the full staff report, please call (702) 229-6311 (TDD 386-9108) or go to <http://www.lasvegasnevada.gov>.

Report of All Selected Parcels**Case Number:** RQR-46132**Printed On:** Wed: September 12, 2012

<u>Owner</u>	<u>Address</u>	<u>Parcel Number</u>
2424 WESTERN REALTY INC	%M PUORRO 2424 WESTERN AVE LAS VEGAS NV 89102-4816	16204404017
2575 S HIGHLAND DRIVE L P	%CANTOR G & W NV HOLDINGS L P %GENERAL COUNSEL 110 E 59TH ST NEW YORK NY 10022-1304	16209110018
2620 HIGHLAND L L C	10300 W CHARLESTON BLVD #13-156 LAS VEGAS NV 89135-1037	16209110024
2620 HIGHLAND L L C	10300 W CHARLESTON BLVD #13-156 LAS VEGAS NV 89135-1037	16209110023
2701 WESTWOOD L L C	%MR R BRANDY 1113 PINE ISLAND CT LAS VEGAS NV 89134-6330	16209102002
2861 S HIGHLAND DRIVE L L C	P O BOX 1305 CAMARILLO CA 93011-1305	16209201003
AD AMERICA INC	%J BIELINSKI 2310 HIGHLAND DR LAS VEGAS NV 89102-4809	16204402004
BANYAN PROPERTIES L L C	9030 W SAHARA AVE #299 LAS VEGAS NV 89117-5744	16209211002
BARRY PATRICK & DAWN L	2664 HIGHLAND DR LAS VEGAS NV 89109-1116	16209110027
BOYER ELAINE	SCHWINGDORF LEONARD & L LIV TR 6245 GALILEO DR LAS VEGAS NV 89149-1385	16204404013
BOYER ELAINE	SCHWINGDORF LEONARD & L LIV TR 6245 GALILEO DR LAS VEGAS NV 89149-1385	16204404011
BRADY DONALD B	2600 WESTWOOD DR LAS VEGAS NV 89109-1118	16209110005
BRADY DONALD B	2600 WESTWOOD DR LAS VEGAS NV 89109-1118	16209110004
BROSSEAU 1993 TRUST	BROSSEAU PAUL H TRS 2609 S HIGHLAND DR LAS VEGAS NV 89109-1156	16209110015
CARL ROBERT SCOTT LIVING TR 2006	CARL ROBERT S TRS 2605 HIGHLAND DR LAS VEGAS NV 89109-1113	16209110016
CARTANIA INC	%PREMIER TRUST 4465 S JONES BLVD LAS VEGAS NV 89103-3307	16209110030
CARTANIA INC	%PREMIER TRUST 4465 S JONES BLVD LAS VEGAS NV 89103-3307	16209110029
CARTANIA INC	%PREMIER TRUST 4465 S JONES BLVD LAS VEGAS NV 89103-3307	16209110028
CLAREMONT HOTEL INC	2601 WESTWOOD DR LAS VEGAS NV 89109-1117	16209102005
D 2753 L L C	P O BOX 570427 HOUSTON TX 77257-0427	16209102004
D 2753 L L C	%COLDWELL BANKER COML 5130 S FORT APACHE RD #215-419 LAS VEGAS NV 89148-1719	16209102003
D 2765 L L C	8222 ANOINE DR #100 HOUSTON TX 77088	16209201001
D 2801 WESTWOOD INC	P O BOX 570413 HOUSTON TX 77257-0413	16208604001
D'AQUINO GAETANO & SYLVIA FAM TR	D'AQUINO GAETANO TRS %D'AQUINO ITALIAN IMPORTING 1850 BUSINESS CENTER DR DUARTE CA 91010-2901	16209202014
ENGLERT SUTTER PROPERTIES L L C	2935 S HIGHLAND DR LAS VEGAS NV 89109-1011	16209110034
GARRETT CAPITAL L L C	%SIEGEL GROUP/SASCO PPTYS 3790 PARADISE RD #250 LAS VEGAS NV 89169-4640	16209102008
GARRETT CAPITAL L L C	%SIEGEL GROUP/SASCO PPTYS 3790 PARADISE RD #250 LAS VEGAS NV 89169-4640	16209102009
GARRETT CAPITAL L L C	%SIEGEL GROUP/SASCO PPTYS 3790 PARADISE RD #250 LAS VEGAS NV 89169-4640	16209102010
GRIFFIS CURTIS ALLEN	2412 WESTERN AVE LAS VEGAS NV 89102-4816	16204404012
HAAS FAMILY TRUST	HAAS ROBERT MELVIN & JO A TRS %SAHARA AIR 2718 HIGHLAND DR LAS VEGAS NV 89109-1004	16209211006

Report of All Selected Parcels**Case Number:** RQR-46132**Printed On:** Wed: September 12, 2012

<u>Owner</u>	<u>Address</u>	<u>Parcel Number</u>
HAAS FAMILY TRUST	HAAS ROBERT MELVIN & JO A TRS %SAHARA AIR 2718 HIGHLAND DR LAS VEGAS NV 89109-1004	16209211005
HIGHLAND BY THE HIGHWAY L L C	8275 S EASTERN AVE #200 LAS VEGAS NV 89123-2545	16209110017
HIGHLAND STREET GROUP L L C	150 N DURANGO DR #290 LAS VEGAS NV 89145-5604	16209110021
HIGHLAND STREET GROUP L L C	6085 W TWAIN ST #200 LAS VEGAS NV 89103-1227	16209110035
JACOBS JOSEPH & NANCY TRUST	JACOBS JOSEPH A & NANCY D TRS 3729 TOPAWA ST LAS VEGAS NV 89103-2435	16209111001
JACOBS JOSEPH & NANCY TRUST	JACOBS JOSEPH A & NANCY D TRS 3729 TOPAWA ST LAS VEGAS NV 89103-2435	16209211009
JOHNSON FAMILY REVOCABLE TRUST	EARL HAROLD L & HORTENSE C TR %N THOMAS 2668 W 410 N HURRICANE UT 84737-3152	16209110011
K E N C O INVESTMENTS L L C	2504 SPRINGBROOK DR LAS VEGAS NV 89134-7584	16209110022
LC 111 L L C	P O BOX 81745 LAS VEGAS NV 89180-1745	16209110032
L'CHAIM WESTERN SUPPLY PPTY LLC	6130 W FLAMINGO RD #402 LAS VEGAS NV 89103-2280	16209201002
M T WAREHOUSE L L C	9030 W SAHARA AVE #299 LAS VEGAS NV 89117-5744	16209211003
M T WAREHOUSE L L C	9030 W SAHARA AVE #299 LAS VEGAS NV 89117-5744	16209211004
MOMARY DOUGLAS R & EMILY J	BOND GEORGE T & PHYLLIS D 2708 HIGHLAND DR LAS VEGAS NV 89109-1004	16209111002
N & J PROPERTIES NEVADA L L C	2305 WIMBLEDON LAS VEGAS NV 89107-2363	16209110025
N F C L L C	%NEVADA FIN CTR 2300 W SAHARA #530 LAS VEGAS NV 89102-4368	16205802009
N F C L L C	%NEVADA FIN CTR 2300 W SAHARA #530 LAS VEGAS NV 89102-4368	16205802011
N P PALACE L L C	%GEN COUNSEL 1505 S PAVILION CENTER DR LAS VEGAS NV 89135-1403	16208502003
N P PALACE L L C	%GEN COUNSEL 1505 S PAVILION CENTER DR LAS VEGAS NV 89135-1403	16208502006
N P PALACE L L C	%GEN COUNSEL 1505 S PAVILION CENTER DR LAS VEGAS NV 89135-1403	16208502009
N P PALACE L L C	%GEN COUNSEL 1505 S PAVILION CENTER DR LAS VEGAS NV 89135-1403	16208502010
N P PALACE L L C	%GEN COUNSEL 1505 S PAVILION CENTER DR LAS VEGAS NV 89135-1403	16208502011
N P PALACE L L C	%GEN COUNSEL 1505 S PAVILION CENTER DR LAS VEGAS NV 89135-1403	16208502007
N Y P CORPORATION	6120 S TORREY PINES LAS VEGAS NV 89118-3209	16209202013
N Y P CORPORATION	6120 S TORREY PINES LAS VEGAS NV 89118-3209	16209202001
NEBULOUS	2441 WESTERN AVE LAS VEGAS NV 89102-4815	16204406012
NEVADA POWER COMPANY	%LAND SERV STA #9 P O BOX 98910 LAS VEGAS NV 89193-8910	16209103002
NEVADA POWER COMPANY	%LAND SERV STA #9 P O BOX 98910 LAS VEGAS NV 89193-8910	16209103003
O H D B L L C	%BLUE MOON RESORT 2651 WEST WOOD DR LAS VEGAS NV 89109-1117	16209102006
P L MOTOR L L C	6625 W BADURA AVE LAS VEGAS NV 89118-4673	16209211007
REBEL OIL COMPANY INC	2200 S HIGHLAND DR LAS VEGAS NV 89102-4629	16204402006
REBEL OIL COMPANY INC	2200 S HIGHLAND DR LAS VEGAS NV 89102-4629	16204402005

Report of All Selected Parcels**Case Number:** RQR-46132**Printed On:** Wed: September 12, 2012

<u>Owner</u>	<u>Address</u>	<u>Parcel Number</u>
REBEL OIL COMPANY INCORPORATED	2200 S HIGHLAND DR LAS VEGAS NV 89102-4629	16204402007
RED OAK TRUST	CREEL ALLAN & DEBORAH TRS 6330 W SUNSET RD LAS VEGAS NV 89118-3318	16209110010
RED OAK TRUST	CREEL ALLAN & DEBORAH TRS 11 BURNING TREE CT LAS VEGAS NV 89113-1329	16209110013
RED OAK TRUST	CREEL ALLAN & DEBORAH TRS 11 BURNING TREE CT LAS VEGAS NV 89113-1329	16209110012
RODRIGUEZ NORMA E	2621 HIGHLAND DR LAS VEGAS NV 89109-1113	16209110014
SAHARA RANCHO OFFICE CTR L L C	2250 S RANCHO DR #225 LAS VEGAS NV 89102-4455	16204412005
SAHARA RANCHO OFFICE CTR L L C	2250 S RANCHO DR #225 LAS VEGAS NV 89102-4455	16204412004
SCHWINGDORF LEONARD & L LIV TR	SCHWINGDORF LEONARD JR & L TRS 6245 GALILEO DR LAS VEGAS NV 89149-1385	16204404015
SCHWINGDORF LEONARD & L LIV TR	SCHWINGDORF LEONARD JR & L TRS 6245 GALILEO DR LAS VEGAS NV 89149-1385	16204404014
SEDANO AIDA C & HIRAM H	2706 S HIGHLAND DR LAS VEGAS NV 89109-1004	16209211008
SHARPE ALLEN L TRUST	SHARPE FLORENCE M TRUST 2855 BELCASTRO ST LAS VEGAS NV 89117-3035	16209110006
SHARPE ALLEN L TRUST	SHARPE FLORENCE M TRUST 2855 BELCASTRO ST LAS VEGAS NV 89117-3035	16209110007
SHARPE ALLEN L TRUST	SHARPE FLORENCE M TRUST 2855 BELCASTRO ST LAS VEGAS NV 89117-3035	16209110009
SHARPE ALLEN L TRUST	SHARPE FLORENCE M TRUST 2855 BELCASTRO ST LAS VEGAS NV 89117-3035	16209110008
SOBEL WESTEX	P O BOX 14787 LAS VEGAS NV 89114-4787	16209110039
SOBEL WESTEX	%S FINDLEY P O BOX 14787 LAS VEGAS NV 89114-4787	16209110037
SOBEL WESTEX	P O BOX 14787 LAS VEGAS NV 89114-4787	16209110041
SOBEL WESTEX	P O BOX 14787 LAS VEGAS NV 89114-4787	16209110040
SOBEL WESTEX	P O BOX 14787 LAS VEGAS NV 89114-4787	16209110038
STATE OF NEVADA TRANSPORTATION	PALACE STA HOTEL & CASINO LEASE 2411 W SAHARA AVE LAS VEGAS NV 89102-4343	16208502012
STATE OF NEVADA TRANSPORTATION	SAHARA RV CENTER LEASE %G DONOVAN 1518 SCOTLAND LN LAS VEGAS NV 89102-4814	16204405001
STATE OF NEVADA TRANSPORTATION	GARRETT CAPITAL L L C LEASE %RIGHT OF WAY DIV %R PECHOUS 1263 S STEWART ST CARSON CITY NV 89712-0001	16209110042
THISTLE DANIEL J & J J FAM TR	THISTLE FAMILY TRUST 4850 BYZANTINE CT LAS VEGAS NV 89149-0904	16209211001
TRUSTEE CLARK COUNTY TREASURER	%NEVADA SPACE INC 1900 E DESERT INN RD LAS VEGAS NV 89169-3211	16209202007
URBAN LAND NEVADA	3271 S HIGHLAND DR #704 LAS VEGAS NV 89109-1051	16209110020
URBAN LAND NEVADA	3271 S HIGHLAND DR #704 LAS VEGAS NV 89109-1051	16209110019
VANDIS ELEANORE MAHLEIN TRS	WALL IRVING M TRS 421 W 57TH ST NEW YORK NY 10019-1763	16204404016
WADE JO FERN TRUST	SHANE DAVID L CO-TRS 200 N WESTLAKE BLVD #201 WESTLAKE VILLAGE CA 91362-3774	16209110026
WESTCOM DEVELOPMENT L L C	%K CANE 3273 E WARM SPRINGS RD LAS VEGAS NV 89120-3157	16209110033
X R A M L L C	MARX GORDON %G MARX 1931 BLACK WATER CT LAS VEGAS NV 89117-1949	16209110036
ZARGARYAN GAGIK & K REV TR AGMT	ZARGARYAN GAGIK & KNARIK CO-TRS 2920 S TIOGA WAY LAS VEGAS NV 89117-3202	16209110031