



Legal Notices Transmittal and Scanning Separator Sheet

Legal Notice Type: Legal Mailings

Date of Transfer to ERM: 8/6/2012

Page Count: 7

Meeting Date: 8/15/2012

Meeting Type: City Council <=>

Case Number(s): RENOTIFICATION - RQR-45467 <=>

Subject of Affidavit: APPLICANT/OWNER: MARSHALL FAMILY, LIMITED PARTNERSHIP - at 2330 Industrial Road (APN 162-04-802-007) <=>

Record Series: Legal Notices

LRDA Number: 2007-1717

Retention: Permanent

File By: Meeting Date



Prepared By: gportillo
SCANNED
AUG - 6 2012
Scanned By: _____

QC By: _____

City of Las Vegas
Office of City Clerk
495 South Main Street, 2nd Floor
Las Vegas, Nevada 89101

Return Service Requested Official Notice of Public Hearing

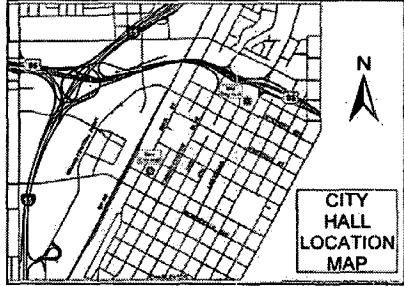

If you wish to file your protest or support on this request, check the appropriate box below and return this card in an envelope with postage to the Office Of The City Clerk at the address listed above or fax this side of this card to (702) 382-4803. If you would like to contact your Council Representative, please call (702) 229-6405.

I SUPPORT
this Request

I OPPOSE
this Request

Please use available blank space on card for your comments.

RQR-45467

City Council Meeting of **08/15/2012**

Application Information

RENOTIFICATION - RQR-45467 - REQUIRED REVIEW - PUBLIC HEARING - APPLICANT/OWNER: MARSHALL FAMILY, LIMITED PARTNERSHIP - For possible action on a request for a Required Review of an approved Special Use Permit (U-0126-94) FOR AN EXISTING 40-FOOT TALL, 14-FOOT BY 48-FOOT OFF-PREMISE SIGN at 2330 Industrial Road (APN 162-04-802-007), M (Industrial) Zone, Ward 3 (Coffin).

Application Location

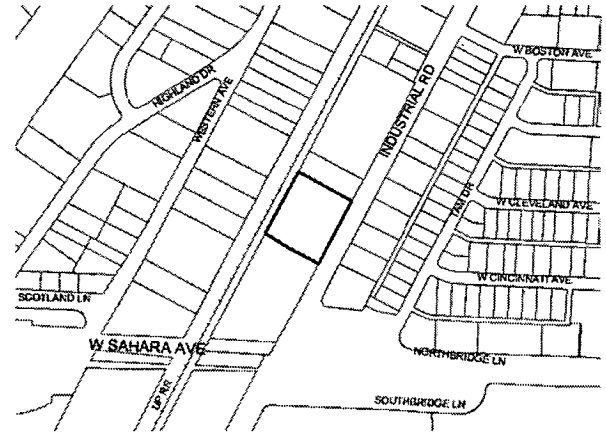

The proposed project may not pertain to the entire highlighted project site.

Public Hearing Information

Meeting: City Council
Date: August 15, 2012
Time: 1:00 P.M.
Location: City Council Chambers
495 South Main Street
Las Vegas, Nevada

Any and all interested persons may appear and be heard at said meeting, or may, prior thereto, file written objections thereto or approvals thereof with the City Clerk, 4th Floor, City Hall, 495 South Main Street, Las Vegas, Nevada, 89101. For further information, including the full staff report, please call (702) 229-6311 (TDD 386-9108) or go to <http://www.lasvegasnevada.gov>,

Report of All Selected Parcels**Case Number:** RQR-45467**Printed On:** Mon: June 18, 2012

<u>Owner</u>	<u>Address</u>	<u>Parcel Number</u>
2201 L L C	%A GILBERT 2830 ELK CANYON CT LAS VEGAS NV 89117-2982	16204803009
2201 L L C	%A GILBERT 2830 ELK CANYON CT LAS VEGAS NV 89117-2982	16204803008
2320 WESTERN L L C	%C SHAFFER JR 375 LAUREL DR BOULDER CITY NV 89005-2646	16204404003
2424 WESTERN REALTY INC	%M PUORRO 2424 WESTERN AVE LAS VEGAS NV 89102-4816	16204404017
309 CLEVELAND L L C	9550 S EASTERN AVE #253 LAS VEGAS NV 89123-8042	16204811009
4 A HOLDINGS L L C	P O BOX 28677 LAS VEGAS NV 89126	16204707006
A D AMERICA INC	2310 HIGHLAND DR LAS VEGAS NV 89102-4809	16204402003
AD AMERICA INC	2310 HIGHLAND DR LAS VEGAS NV 89102-4809	16204402002
AD AMERICA INC	%J BIELINSKI 2310 HIGHLAND DR LAS VEGAS NV 89102-4809	16204402004
AD AMERICA INC	2310 S HIGHLAND DR LAS VEGAS NV 89102-4809	16204404002
ALVERNAZ JOSEPH P & LINDA	235 UPPER CAMP LOOP RD ROSEBURG OR 97470-9483	16204406002
ALVERNAZ JOSEPH P & LINDA	235 UPPER CAMP LOOP RD ROSEBURG OR 97470-9483	16204406001
AMBER INVESTMENT COMPANY	%S WONG 132 9TH ST #200 OAKLAND CA 94607-4727	16204807002
B B H L L C	2000 WESTERN ST LAS VEGAS NV 89102-4619	16204302004
B B H L L C	2000 WESTERN AVE LAS VEGAS NV 89102-4619	16204302003
BALTIMORE GARDEMS LTD PTNRSH	%HEARTLAND BANK %COML SRVCING 14125 CLAYTON RD CHESTERFIELD MO 63017-8355	16204810006
BALTIMORE GARDEMS LTD PTNRSH	%HEARTLAND BANK %COML SRVCING 14125 CLAYTON RD CHESTERFIELD MO 63017-8355	16204810003
BALTIMORE GARDEMS LTD PTNRSH	%HEARTLAND BANK %COML SRVCING 14125 CLAYTON RD CHESTERFIELD MO 63017-8355	16204810005
BALTIMORE GARDEMS LTD PTNRSH	%HEARTLAND BANK %COML SRVCING 14125 CLAYTON RD CHESTERFIELD MO 63017-8355	16204810007
BALTIMORE GARDEMS LTD PTNRSH	%HEARTLAND BANK %COML SRVCING 14125 CLAYTON RD CHESTERFIELD MO 63017-8355	16204810004
BALTIMORE GARDEMS LTD PTNRSH	%HEARTLAND BANK %COML SRVCING 14125 CLAYTON RD CHESTERFIELD MO 63017-8355	16204810002
BALTIMORE GARDEMS LTD PTNRSH	%HEARTLAND BANK %COML SRVCING 14125 CLAYTON RD CHESTERFIELD MO 63017-8355	16204810001
BALTIMORE GARDENS L P	%HEARTLAND BANK %COML SRVCING 14125 CLAYTON RD CHESTERFIELD MO 63017-8355	16204806001
BELL REAL ESTATE L L C	%BELL TRANS 1910 INDUSTRIAL RD LAS VEGAS NV 89102-4610	16204704007
BELL REAL ESTATE L L C	%WHITTLESEA BLUE CAB CO 1910 INDUSTRIAL RD LAS VEGAS NV 89102-4610	16204802001
BELL REAL ESTATE L L C	%WHITTLESEA BLUE CAB CO 1910 INDUSTRIAL RD LAS VEGAS NV 89102-4610	16204802011
BELL REAL ESTATE L L C	%WHITTLESEA BLUE CAB CO 1910 INDUSTRIAL RD LAS VEGAS NV 89102-4610	16204802003
BELL REAL ESTATE L L C	1900 INDUSTRIAL RD LAS VEGAS NV 89102-4610	16204802018
BELL REAL ESTATE L L C	%WHITTLESEA BLUE CAB CO 1910 INDUSTRIAL RD LAS VEGAS NV 89102-4610	16204704008
BOYER ELAINE	SCHWINGDORF LEONARD & L LIV TR 6245 GALILEO DR LAS VEGAS NV 89149-1385	16204404011
BOYER ELAINE	SCHWINGDORF LEONARD & L LIV TR 6245 GALILEO DR LAS VEGAS NV 89149-1385	16204404013
CANAS EUGENIO A & MARIA E	10870 FES ST SUN VALLEY CA 91352-3340	16204811036

Report of All Selected Parcels**Case Number:** RQR-45467**Printed On:** Mon: June 18, 2012

<u>Owner</u>	<u>Address</u>	<u>Parcel Number</u>
CHAMBERLAIN DAVID T & LINDA L	10332 LASSEN ST LOS ALAMITOS CA 90720-2239	16204811033
CHAMBERLAIN DAVID T & LINDA L	10332 LASSEN ST LOS ALAMITOS CA 90720-2239	16204811032
CIRCUS CIRCUS CASINOS INC	%MGM RESORTS INTL %PROCESS ACCT/J LEHMAN 4882 FRANK SINATRA DR LAS VEGAS NV 89158-4316	16209501001
D K M DEVELOPMENT L L C	3273 E WARM SPRINGS RD LAS VEGAS NV 89120-3157	16204703009
DEMICH MICHAEL	P O BOX 7201 RANCHO SANTA FE CA 92067-7201	16204813024
DERRYBERRY 1997 FAMILY TRUST	DERRYBERRY BARBARA ANN TRS 1309 E ST LOUIS AVE #1 LAS VEGAS NV 89104-3405	16204811038
EMRANI DAVID	1526 S BROADWAY LOS ANGELES CA 90015	16204811044
EMRANI DAVID	1526 S BROADWAY LOS ANGELES CA 90015	16204811040
EMRANI DAVID	1526 S BROADWAY LOS ANGELES CA 90015	16204811042
EMRANI DAVID	1526 S BROADWAY LOS ANGELES CA 90015	16204811041
EMRANI DAVID	1526 S BROADWAY LOS ANGELES CA 90015	16204811045
EMRANI DAVID	1526 S BROADWAY LOS ANGELES CA 90015	16204811043
EMRANI DAVID	1526 S BROADWAY LOS ANGELES CA 90015	16204811039
EMRANI DAVID	1526 S BROADWAY LOS ANGELES CA 90014	16204811046
ENGLERT BRAD & ROBYN	2935 S HIGHLAND DR LAS VEGAS NV 89109-1011	16204406005
ENGLERT BRAD & ROBYN	2935 S HIGHLAND DR LAS VEGAS NV 89109-1011	16204406006
ESCAMILLA JOSE & IDALIA	11030 SUNNYBRAE AVE CHATSWORTH CA 91311-1651	16204811004
FELDMAN SAM TRUST	FELDMAN ROBERT L TRS 800 N RAINBOW BLVD #208 LAS VEGAS NV 89107-1193	16204301010
FLEMING KENNETH E & JOY C LIV TR	FLEMING JOY C TRS 1841 NEWPORT BAY DR LAS VEGAS NV 89117-2057	16204406009
GALLIGAN THOMAS L L C	2110 S HIGHLAND LAS VEGAS NV 89102-4622	16204301011
GIBSON JANET	2820 SPALDING DR LAS VEGAS NV 89134-7554	16204301012
GRAINGER W W INC	%M POER & CO 410 17TH ST #1175 DENVER CO 80202-4439	16204406010
GREMM MANFRED	GREMM MYRA 2405 HIGHLAND DR LAS VEGAS NV 89102-4803	16204404007
GRIFFIS CURTIS ALLEN	2412 WESTERN AVE LAS VEGAS NV 89102-4816	16204404012
GUPTA HEM C & KRISHNA	160 E SHELBOURNE AVE LAS VEGAS NV 89123-2150	16204811008
GUPTA HEM C & KRISHNA	160 E SHELBOURNE AVE LAS VEGAS NV 89123-2150	16204811007
HALEX HOLDINGS L L C	18-20 STEINWAY ST ASTORIA NY 11105-1011	16204406004
HALEX HOLDINGS L L C	18-20 STEINWAY ST ASTORIA NY 11105-1011	16204406003
HANG CHU L L C	5077 W EUGENE AVE LAS VEGAS NV 89108-3027	16204804001
HANG CHU L L C	5077 W EUGENE AVE LAS VEGAS NV 89108-3027	16204707007
HANG CHU L L C	5077 W EUGENE AVE LAS VEGAS NV 89108-3027	16204805001

Report of All Selected Parcels**Case Number:** RQR-45467**Printed On:** Mon: June 18, 2012

<u>Owner</u>	<u>Address</u>	<u>Parcel Number</u>
HANG CHU L L C	5077 W EUGENE AVE LAS VEGAS NV 89108-3027	16204805002
I B I AMERICA	324 W CINCINNATI AVE #3 LAS VEGAS NV 89102-5066	16204811016
I B I AMERICA	324 W CINCINNATI AVE #3 LAS VEGAS NV 89102-5066	16204811017
I B I AMERICA	324 W CINCINNATI AVE #3 LAS VEGAS NV 89102-5066	16204811019
I B I AMERICA	324 W CINCINNATI AVE #3 LAS VEGAS NV 89102-5066	16204811025
I B I AMERICA	324 W CINCINNATI AVE #3 LAS VEGAS NV 89102-5066	16204811022
I B I AMERICA	324 W CINCINNATI AVE #3 LAS VEGAS NV 89102-5066	16204811030
I B I AMERICA	324 W CINCINNATI AVE #3 LAS VEGAS NV 89102-5066	16204811031
I B I AMERICA	324 W CINCINNATI AVE #3 LAS VEGAS NV 89102-5066	16204811020
I B I AMERICA	324 W CINCINNATI AVE #3 LAS VEGAS NV 89102-5066	16204811023
I B I AMERICA	324 W CINCINNATI AVE #3 LAS VEGAS NV 89102-5066	16204811018
I B I AMERICA	324 W CINCINNATI AVE #3 LAS VEGAS NV 89102-5066	16204811024
I B I AMERICA	324 W CINCINNATI AVE #3 LAS VEGAS NV 89102-5066	16204811021
I B I AMERICA	324 W CINCINNATI AVE #3 LAS VEGAS NV 89102-5066	16204811029
INDUSTRIAL L L C	%BEST CO 6450 SPRING MOUNTAIN RD #12 LAS VEGAS NV 89146-8836	16204802006
INDUSTRIAL ROAD 2440-2497 L L C	1000 S WESTGATE AVE #100 LOS ANGELES CA 90049-7206	16204407001
ITALY SERVICE INC	4652 GREEN CANYON LAS VEGAS NV 89103-4321	16204404009
J & S H FAMILY L P ETAL	% INWECO CORP 2416 TAM DR LAS VEGAS NV 89102-4966	16204803014
JANEWAY COMPANY	2885 MANN ST LAS VEGAS NV 89146-5230	16204406008
JANEWAY L L C	2885 MANN ST LAS VEGAS NV 89146-5230	16204406007
JEWELER'S 401K PFT SHR PL & TR	2400 WESTERN AVE LAS VEGAS NV 89102-4816	16204406011
KARR JERRY K & JAMES N	2111 WESTERN AVE LAS VEGAS NV 89102-4621	16204801001
LUCKY DRAGON L L C	601 S 10TH ST #201 LAS VEGAS NV 89101-7027	16204811028
MACMILLAN BYRON F	%RE #040-404-006-87 P O BOX 7440 LAS VEGAS NV 89125-7440	16204811002
MACMILLAN DOUGLAS JR	MACMILLAN MIRIAM ROSA & BYRON %H & L REALTY P O BOX 7440 LAS VEGAS NV 89125-7440	16204811003
MAGAR JAMES G	1219 BARNARD DR LAS VEGAS NV 89102-1803	16204811026
MARSHALL FAMILY L P	%MARSHALL T P O BOX 46470 LAS VEGAS NV 89114-6470	16204802007
MARTIN ROBERT L & KATHLEEN P	2410 WESTERN AVE LAS VEGAS NV 89102-4816	16204404010
MONTCLAIR APTS INC	327 W CINCINNATI ST LAS VEGAS NV 89102-5037	16204811035
MONTCLAIR APTS INC	327 W CINCINNATI ST LAS VEGAS NV 89102-5037	16204811034
MORRIS PROPERTIES L L C	2311 S INDUSTRIAL RD LAS VEGAS NV 89102-4801	16204803010
MY SISTER'S COMPANY L L C	1220 ALDERTON LN LAS VEGAS NV 89144-6523	16204402001

Report of All Selected Parcels**Case Number:** RQR-45467**Printed On:** Mon: June 18, 2012

<u>Owner</u>	<u>Address</u>	<u>Parcel Number</u>
NEBULOUS	2441 WESTERN AVE LAS VEGAS NV 89102-4815	16204406012
NEVADA POWER COMPANY	%LAND SERV STA #9 P O BOX 98910 LAS VEGAS NV 89193-8910	16209103003
NEVADA POWER COMPANY	%LAND SERV STA #9 P O BOX 98910 LAS VEGAS NV 89193-8910	16209104002
NEVADA POWER COMPANY	%LAND SERV STA #9 P O BOX 98910 LAS VEGAS NV 89193-8910	16209103002
NEW INTERNATIONAL PROPERTIES LLC	713 E OGDEN LAS VEGAS NV 89101-4230	16204403003
NEW INTERNATIONAL PROPERTIES LLC	713 E OGDEN LAS VEGAS NV 89101-4230	16204403002
R J L LIMITED PARTNERSHIP	%HEARTLAND BANK %COML SRVCING 14125 CLAYTON RD CHESTERFIELD MO 63017-8355	16204811005
R J L LIMITED PARTNERSHIP	%HEARTLAND BANK %COML SRVCING 14125 CLAYTON RD CHESTERFIELD MO 63017-8355	16204811006
RAIN DANCE L L C	5050 DISCOVERY POINT DISCOVERY BAY CA 94505-9523	16204803007
RAKOV NATHAN	%CROMWELL MGT INC 2235-B RENAISSANCE DR LAS VEGAS NV 89119-6764	16204302005
REBEL OIL COMPANY INC	2200 S HIGHLAND DR LAS VEGAS NV 89102-4629	16204403004
REBEL OIL COMPANY INCORPORATED	2200 S HIGHLAND DR LAS VEGAS NV 89102-4629	16204404001
REGHETTI INDUSTRIAL L L C	5050 VISTA BLVD #103 SPARKS NV 89436-2845	16204803003
REGHETTI INDUSTRIAL L L C	5050 VISTA BLVD #103 SPARKS NV 89436-2845	16204803001
REGHETTI INDUSTRIAL L L C	5050 VISTA BLVD #103 SPARKS NV 89436-2845	16204803002
S & F LIMITED PARTNERSHIP	%HEARTLAND BANK %COML SRVCING 14125 CLAYTON RD CHESTERFIELD MO 63017-8355	16204811014
S & F LIMITED PARTNERSHIP	%HEARTLAND BANK %COML SRVCING 14125 CLAYTON RD CHESTERFIELD MO 63017-8355	16204811010
S & F LIMITED PARTNERSHIP	%HEARTLAND BANK %COML SRVCING 14125 CLAYTON RD CHESTERFIELD MO 63017-8355	16204811011
S & F LIMITED PARTNERSHIP	%HEARTLAND BANK %COML SRVCING 14125 CLAYTON RD CHESTERFIELD MO 63017-8355	16204811015
S & F LIMITED PARTNERSHIP	%HEARTLAND BANK %COML SRVCING 14125 CLAYTON RD CHESTERLAND MO 63017-8355	16204811012
S & F LIMITED PARTNERSHIP	%HEARTLAND BANK %COML SRVCING 14125 CLAYTON RD CHESTERFIELD MO 63017-8355	16204811013
SAHARA INVESTMENTS L L C	ROYAL ASSOCIATES 9710 W TROPICANA AVE #120 LAS VEGAS NV 89147-8498	16204807004
SCHHEELER SHANNON & PAMELA	400 N BRIDGE LN LAS VEGAS NV 89102-4802	16204803011
SCHIFF MARVIN JAMES TR	SCHIFF MARVIN JAMES TRS 2401 INDUSTRIAL RD LAS VEGAS NV 89102-4817	16204803012
SCHWINGDORF LEONARD & L LIV TR	SCHWINGDORF LEONARD JR & L TRS 6245 GALILEO DR LAS VEGAS NV 89149-1385	16204404015
SCHWINGDORF LEONARD & L LIV TR	SCHWINGDORF LEONARD JR & L TRS 6245 GALILEO DR LAS VEGAS NV 89149-1385	16204404014
SHOEN FAMILY L L C	143 S CEDROS AVE #C-201 SOLANA BEACH CA 92075-1999	16204802017
SPUR TIERRA L L C	P O BOX 379024 LAS VEGAS NV 89137-9024	16204811047
SRABERG GERALD A & ILENE	SCHHEELER 1999 REVOCABLE TRUST 400 N BRIDGE LN LAS VEGAS NV 89102-4802	16204803013
STATE OF NEVADA TRANS LEASOR	USA MARSHALS SERVICE LEASEE 333 LAS VEGAS BLVD #2058 LAS VEGAS NV 89101	16209104001
STATE OF NEVADA TRANS LEASOR	USA MARSHALS SERVICE LEASEE 333 LAS VEGAS BLVD #2058 LAS VEGAS NV 89101	16204407002
STATE OF NEVADA TRANSPORTATION	SAHARA RV CENTER LEASE %G DONOVAN 1518 SCOTLAND LN LAS VEGAS NV 89102-4814	16204405001

Report of All Selected Parcels**Case Number:** RQR-45467**Printed On:** Mon: June 18, 2012

<u>Owner</u>	<u>Address</u>	<u>Parcel Number</u>
STRATOS INVESTMENTS L L C	4012 S RAINBOW BLVD #K-311 LAS VEGAS NV 89103-2010	16204811001
SUCCESS TAM DRIVE INC	5220 INDIAN RIVER DR #295 LAS VEGAS NV 89103-7446	16204811048
SUCCESS TAM DRIVE INC	5220 INDIAN RIVER DR #295 LAS VEGAS NV 89103-7446	16204811049
SUCCESS TAM DRIVE INC	5220 INDIAN RIVER DR #295 LAS VEGAS NV 89103-7446	16204811050
SUNSWEEP INVESTMENTS L L C	8847 LAKERSHKM BLVD SUN VALLEY CA 91352	16204703011
TIZABGAR & ABAYAHOUDIAN 2006 TR	TIZABGAR PAYAM 15531 HAMNER DR LOS ANGELES CA 90077-1804	16204803006
TIZABGAR PAYAM	TIZABGAR & ABAYAHOUDIAN 2006 TR 15531 HAMNER DR LOS ANGELES CA 90077-1804	16204803004
TIZABGAR PAYAM	TIZABGAR & ABAYAHOUDIAN 2006 TR 15531 HAMNER DR LOS ANGELES CA 90077-1804	16204803005
UNGAR INVESTMENTS L P	P O BOX 80246 LAS VEGAS NV 89180-0246	16204811037
URBAN LAND NEVADA	%T LEE 3271 S HIGHLAND DR #704 LAS VEGAS NV 89109-1051	16204807001
VANDIS ELEANORE MAHLEIN TRS	WALL IRVING M TRS 421 W 57TH ST NEW YORK NY 10019-1763	16204404016
VINTAGE LAND HOLDINGS II L L C	%B AGUILERA 3600 LAS VEGAS BLVD S LAS VEGAS NV 89109-4303	16209510002
WADE JO FERN TRUST	SHANE DAVID L TRS 200 N WESTLAKE BLVD #201 WESTLAKE VILLAGE CA 91362-3774	16204703012
WESTERN PROPERTY HOLDINGS L L C	%J GALARDI 713 E OGDEN #B LAS VEGAS NV 89101-4230	16204302007
WESTERN PROPERTY HOLDINGS L L C	%J GALARDI 713 E OGDEN #B LAS VEGAS NV 89101-4230	16204302006
WESTERN PROPERTY HOLDINGS L L C	%J GALARDI 713 E OGDEN #B LAS VEGAS NV 89101-4230	16204403001
WILKIE RICHARD E REVOCABLE TRUST	7220 W CAMERO AVE LAS VEGAS NV 89113-4643	16204703010
WONG STEPHEN A ETAL	132 9TH ST #200 OAKLAND CA 94607-4727	16204807003
YERUSHALMI PROPERTIES V L L C	2400 WESTERN AVE LAS VEGAS NV 89102-4816	16204404006
YERUSHALMI PROPERTIES V L L C	2400 WESTERN AVE LAS VEGAS NV 89102-4816	16204404005
YERUSHALMI PROPERTIES VI L L C	%M/M YERUSHALMI 8912 GREENSBORO LN LAS VEGAS NV 89134-0502	16204404004
YERUSHALMI PROPERTIES VII L L C	%8912 GREENSBORO LN LAS VEGAS NV 89134-0502	16204404008