



# Legal Notices Transmittal and Scanning Separator Sheet

---

## Legal Notice Type: Affidavit of Mailings

---

Date of Transfer to ERM: 10/3/2011

Page Count: 27

---

Meeting Date: 10/5/2011

Meeting Type: City Council <=>

Case Number(s): ROC-43006 <=>

Subject of Affidavit: APPLICANT: NAKATA MARKET OF JAPAN - OWNER: OMNINET SAHARA  
CRAIG, LP - 2350 South Rainbow Boulevard, Suites 6 and 7 <=>

Record Series: Legal Notices

LRDA Number: 2007-1717

Retention: Permanent

File By: Meeting Date

---

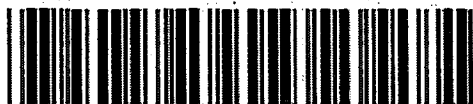

Prepared By: acrolli

SCANNED

QC By: OCT - 4 2011

City of Las Vegas  
Office Of The City Clerk  
400 Stewart Avenue  
Las Vegas, Nevada 89101

**Return Service Requested**  
**Official Notice of Public Hearing**

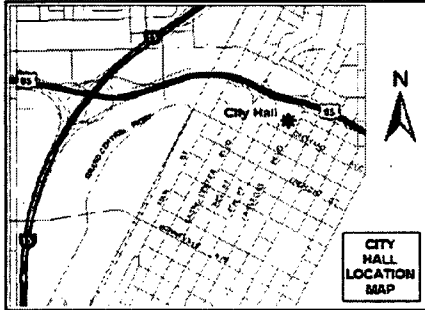

If you wish to file your protest or support on this request, check the appropriate box below and return this card in an envelope with postage to the City Clerk at the address listed above or fax this side of this card to (702) 382-4803. If you would like to contact your Council Representative, please call (702) 229-6405.

I SUPPORT  
this Request

I OPPOSE  
this Request

Please use available blank space on card for your comments.

**ROC-43006**

City Council Meeting of **10/05/2011**

## Application Information

**ROC-43006 - REVIEW OF CONDITION - PUBLIC HEARING**  
**- APPLICANT: NAKATA MARKET OF JAPAN - OWNER:**  
**OMNINET SAHARA CRAIG, LP** - For possible action on a request for a Review of Condition of a previously approved Special Use Permit (SUP-1700) TO DELETE CONDITION #5 THAT STATES, "THE SALE OF INDIVIDUAL CONTAINERS OF ANY SIZE OF BEER, WINE COOLERS OR SCREW CAP WINE IS PROHIBITED. ALL SUCH PRODUCTS SHALL REMAIN IN THEIR ORIGINAL CONFIGURATION AS SHIPPED BY THE MANUFACTURER. FURTHER, NO REPACKAGING OF CONTAINERS INTO GROUPS SMALLER THAN THE ORIGINAL SHIPPING CONTAINER SIZE SHALL BE PERMITTED" at 2350 South Rainbow Boulevard, Suites 6 & 7 (APN 163-02-415-015), C-1 (Limited Commercial) Zone, Ward 1 (Tarkanian).

## Application Location

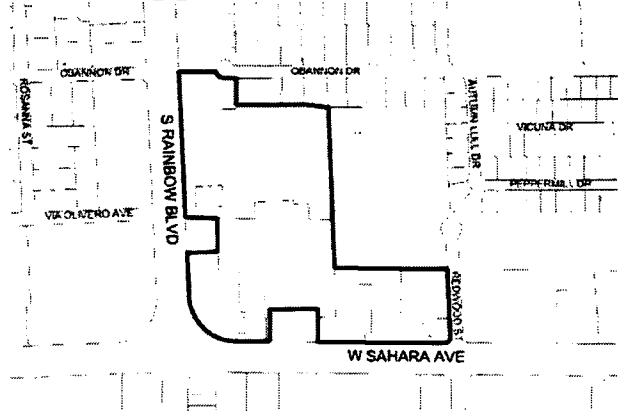

The proposed project may not pertain to the entire highlighted project site.

## Public Hearing Information

**Meeting:** City Council  
**Date:** *October 5, 2011*  
**Time:** 1:00 P.M.  
**Location:** City Council Chambers  
400 Stewart Avenue  
Las Vegas, Nevada

Any and all interested persons may appear and be heard at said meeting, or may, prior thereto, file written objections thereto or approvals thereof with the City Clerk, 1st Floor, City Hall, 400 Stewart Avenue, Las Vegas, Nevada 89101. For further information, please call 702-229-6301 (TDD 702-386-9108). <http://www.lasvegasnevada.gov>.

**Report of All Selected Parcels****Case Number:** ROC-43006**Printed On:** Thu: September 8, 2011

<u>Owner</u>	<u>Address</u>	<u>Parcel Number</u>
		16302213000
		16302411000
1901RAINBOW L L C	%M/M J MARTINEZ 131 E DELAMAR DR HENDERSON NV 89015-7928	16303703002
1950-2050 S RAINBOW BLVD L L C	%CWCAPITAL ASSET MGT LLC %M MCGREGOR 701 13TH ST N W #1000 WASHINGTON DC 20005-4047	16302313011
6 H C O LTD	380 RANCHO CIR LAS VEGAS NV 89107-4602	16311103016
7100 W SAHARA L L C	7300 W SAHARA BLVD LAS VEGAS NV 89117-2756	16303806002
7-ELEVEN INC	%AV TAX DEPT #0125 P O BOX 711 DALLAS TX 75221-0711	16311101002
7-ELEVEN INC	%AV TAX DEPT #0125 P O BOX 711 DALLAS TX 75221-0711	16311101001
AAG-REAL ESTATE LAS VEGAS L L C	%LEXUS OF LAS VEGAS %CONTROLLER 6600 W SAHARA BLVD LAS VEGAS NV 89146-2962	16302402003
ABERGEL JOSHUA TAYLOR & CAROL	6781 LAREDO ST LAS VEGAS NV 89146-5117	16311110023
ABNEY JANET T LIVING TRUST	ABNEY JANET T TRS 6823 ADOBE CT LAS VEGAS NV 89146-2920	16302310012
ACKERMAN EDWARD V & MISSIE L	6520 VICUNA DR LAS VEGAS NV 89146-2924	16302413010
ACOSTA EDUARDO P & ELVIRA B	6975 O'BANNON DR LAS VEGAS NV 89117-2121	16303804002
ADAMS JOHN D	MILLER MARCELLA 2630 SORREL ST LAS VEGAS NV 89146-5131	16311106003
ADAMSON LENNY	3 KARSTEN CREEK CT HENDERSON NV	16302213084
AGUILA NATALIE	1700 SANDECKER CT #201 LAS VEGAS NV	16302213068
ALCALA CARMEN F	12748 DEON PL GRANADA HILLS CA 91344-1001	16310511004
ALI GOKSEL A	BLAIR SYLVIA 2213 AUTUMN LULL DR LAS VEGAS NV 89146-2986	16302412008
ALLEN PHILIP W & JEAN L FAM TR	ALLEN PHILIP W & JEAN L TRS 2655 S ROSANNA ST LAS VEGAS NV 89117-3043	16310507008
ALTA QUAIL L P	%A & J INVEST 2615 PACIFIC COAST HWY #328 HERMOSA BEACH CA 90254-2227	16302415009
ANDERSON JAMES K	6516 PEPPERMILL DR LAS VEGAS NV 89146-2917	16302413019
ANDERSON PAUL & ELVADEEN FAM TR	ANDERSON ELVADEEN F TRS 2672 BARBARADALE CIR LAS VEGAS NV 89146-5160	16311111008
ANDERSON ROGER	P O BOX 36069 LAS VEGAS NV 89133-6069	16302414002
ANDERSON RONALD G & TERESA Z	6990 OBANNON DR LAS VEGAS NV 89117-2122	16303704004
ANDREWS KATHLEEN	6801 SAN RICARDO AVE #104 LAS VEGAS NV	16302213028
APCAR OLGA F	HANTIGOVA OLGA F 1499 CAYUGA PKWY LAS VEGAS NV 89169-3157	16303802014
ARIOLA GREGORY F & RICHARD	6608 PEPPERMILL DR LAS VEGAS NV 89146-2913	16302412016
ARMSTRONG GEOFFREY P	6617 PEPPERMILL DR LAS VEGAS NV 89146-2915	16302412009
ARREDONDO J & A FAM TR	ARREDONDO JOE L SR & ALICE C TRS 6605 OBANNON DR LAS VEGAS NV 89146-2945	16302412028
ARREOLA ROBERT A	2109 AUTUMN LULL DR LAS VEGAS NV 89146-2930	16302412003
ATKINS DOUGLAS S LIVING TRUST	ATKINS DOUGLAS S TRS 6500 VICUNA DR LAS VEGAS NV 89146-2924	16302414014

**Report of All Selected Parcels****Case Number:** ROC-43006**Printed On:** Thu: September 8, 2011

<u>Owner</u>	<u>Address</u>	<u>Parcel Number</u>
ATKINSON JAMES L & GENEVIEVE	26455 COUNTY HWY Y RICHLAND CENTER WI. 53581-8722	16302413020
B F D SAHARA L P	%S CARROW P O BOX 626 BASSETT VA 24055-0626	16310503006
B J H TRUST	HORNER BRIAN TRS 1552 W WARM SPRINGS RD #110 HENDERSON NV 89014-4328	16302310002
B P M.C LIVING TRUST	MCFARLAND CATHERINE GRAHAM TRS 4726 MOUNT ALIFAN DR SAN DIEGO CA 92111-2508	16302310030
BAKURA 1992 SURVIVOR'S TRUST	BAKURA 1992 DECEDENT'S TRUST %S RATLIFF P O BOX 68 HELENDALE CA 92342-0068	16302414003
BANK AMÉRICA N A	400 NATIONAL WY SIMI VALLEY CA	16302213036
BANK CITY NATIONAL	5830 W FLAMINGO RD LAS VEGAS NV 89103-0166	16311103019
BANK FIRST INTERNATIONAL	1912 AVE K PLANO TX 75074-5997	16302401008
BANK FIRST INTERSTATE NEVADA N A	%WELLS FARGO BANK %THOMSON PPTY TAX SERV P O BOX 2609 CARLSBAD CA 92018-2609	16310510002
BANK FIRST INTERSTATE NEVADA N A	%WELLS FARGO BANK %THOMSON PPTY TAX SERV P O BOX 2609 CARLSBAD CA 92018-2609	16310504001
BANKHEAD CHRISTINE J	ARNOT DANIELLE M 6811 LAREDO ST LAS VEGAS NV 89146-5119	16311110003
BAUMAN WILLIAM DENNIS	2625 ROSANNA ST LAS VEGAS NV 89117-3049	16310507006
BAWA JEANNE	6420 PEPPERMILL DR LAS VEGAS NV 89146-0801	16302414027
BEIERLE CONNIE W	6811 SAN RICARDO AVE LAS VEGAS NV	16302213021
BERGER SUSAN L	6767 TRINITY CT LAS VEGAS NV 89146-5171	16311110018
BERRY JÉRALD & CORA L	2671 BARBARADALE CIR LAS VEGAS NV 89146-5160	16311111007
BINGHAM CHAUNCEY & JO ANN	8028 MADDINGLEY AVE LAS VEGAS NV	16302213056
BLAIR WILLIAM J	1437 N.BUENA VISTA BURBANK CA 91505-1637	16302312001
BLUE RUTH M	1500 OSCAR CT LAS VEGAS NV	16302213003
BONO PEARL	1600 DAVILLA ST #104 LAS VEGAS NV	16302213034
BOROWIEC GRZEGORZ	260 RUTGERS LN PARSIPPANY NJ	16302213006
BOWLING MARY GRACE	6797 ELDORA AVE LAS VEGAS NV 89146-5123	16311210020
BOYLE JOSEPH & KATHLEEN M	1500 OSCAR CT #204 LAS VEGAS NV	16302213005
BRADY HORACE E SR & CHRISTINE	6795 O BANNON DR LAS VEGAS NV 89102-2905	16302401001
BRAMLETT SOLOMON JR	6409 PEPPERMILL DR LAS VEGAS NV 89146-0802	16302414033
BRANCHEV IVAN	3242 CALLE DE DÉBESA CAMARILLO CA 93010-8336	16302310022
BUAN ORLANDO C & ARMACILA G	6797 W LAREDO ST LAS VEGAS NV 89146-5117	16311110022
BURGER JEFFRY L & DIANE E REV TR	BURGER JEFFRY L & DIANE E TRS 6630 ELDORA ST LAS VEGAS NV 89146-5122	16311105010
BURROWS CARL E & MARIAN S FAM TR	BURROWS CARL E & MARIAN S TRS 6517 VICUNA DR LAS VEGAS NV 89146-2925	16302413012
BUSSELL VIRGINIA L	1500 OSCAR CT #101 LAS VEGAS NV	16302213001
C A L INVESTMENTS L L C	2331 ALCOVA RIDGE DR LAS VEGAS NV 89135-1522	16311104002
C N L FUNDING 2000-A L P	P O BOX 1671 ORLANDO FL 32802-1671	16302415011

**Report of All Selected Parcels****Case Number:** ROC-43006**Printed On:** Thu: September 8, 2011

<u>Owner</u>	<u>Address</u>	<u>Parcel Number</u>
C S S SAHARA L P	1148 ALPINE RD #100 WALNUT CREEK CA 94596-4444	16302801001
CALIFORNIA CROSSING L L C	6600 W CHARLESTON BLVD #122 LAS VEGAS NV	16302213044
CALLAWAY JAMES A & MARIA REV TR	CALLAWAY JAMES A & MARIA T TRS 2680 ROSANNA LAS VEGAS NV 89117-3050	16310511005
CALLEY SETH D	2674 REDWOOD ST LAS VEGAS NV 89146-5109	16311105013
CALLOTTA EDWARD A & TERESITA V	6809 SIERRA TRL LAS VEGAS NV 89146-2906	16302312006
CAMPBELL HUGH R	TURNER MICHAEL 2545 S TORREY PINES DR LAS VEGAS NV 89146-4007	16311103008
CAMPBELL JAMES WILLIAM	6635 LAREDO ST LAS VEGAS NV 89146-5115	16311105003
CANNON IVAN & HELEN C FAMILY TR	P O BOX 15291 LAS VEGAS NV 89114-5291	16303704006
CAO GINA	347 RIVIERA DR UNION CITY CA	16302213032
CAPO GRACE RUTH LIVING TRUST	CAPO GRACE RUTH TRS 6508 PEPPERMILL DR LAS VEGAS NV 89146-2917	16302413017
CAPOBIANCO LEO	7015 EL PARQUE AVE LAS VEGAS NV 89117-2105	16303702013
CARD PLAYER TOWERS L L C	6940 OBANNON DR LAS VEGAS NV 89117-2122	16303714008
CARMAX AUTO SUPERSTORES W COAST	%K MOYERS P O BOX 29965 RICHMOND VA 23242-2965	16311101013
CARPENTER BEULAH A LIVING TRUST	CARPENTER BEULAH A TRS 6508 VICUNA DR LAS VEGAS NV 89146-2924	16302413007
CARRILLO MARIO	2641 BARBARADALE CIR LAS VEGAS NV 89146-5160	16311111005
CARSON REBECCA J	1610 DAVILLA ST #203 LAS VEGAS NV	16302213042
CARTER GARRY W & VICTORIA	2231 ROSANNA ST LAS VEGAS NV 89117-2823	16303803011
CARUSO MICHAEL & DAVID M	CARUSO BRIAN G 5166 S ARVILLE ST LAS VEGAS NV 89118-1539	16302310036
CASAD DEVELOPMENTS L T D	1891 DEL FONT CT LAS VEGAS NV 89117-2100	16303712003
CAYLOR MARTA 1996 TRUST	CAYLOR MARTA TRS 6980 ELDORA AVE LAS VEGAS NV 89117-3012	16310511006
CENTENNIAL-AZURE L L C	%J STALUPPI JR 5850 CENTENNIAL CENTER BLVD LAS VEGAS NV 89149-4570	16303806013
CERVANTES JOSEPH	3808 CREST HORN DR LAS VEGAS NV 89147-4256	16302401002
CHAI SS18 L L C	P O BOX 36703 LAS VEGAS NV 89133-6703	16303804004
CHEN WEI W	6801 SAN RICARDO AVE #201 LAS VEGAS NV	16302213025
CHEN WEI W	6801 SAN RICARDO AVE #201 LAS VEGAS NV	16302213026
CHEN WEIMING	6405 VICUNA DR LAS VEGAS NV 89146-2997	16302414020
CHENG BEVIS K	6960 ELDORA AVE LAS VEGAS NV 89117-3012	16310511008
CHENG TOM KWOK & BETTY F ETAL	%M ELSON P O BOX 228 CALLICOON CENTER NY	16302213058
CHI KUO HUA & MAY FONG	1620 SANDECKER CT #201 LAS VEGAS NV	16302213062
CHURCH POTTER'S CHRISTIAN NEV	P O BOX 371375 LAS VEGAS NV 89137-1375	16302415007
CHURCH SPIRITUAL ASSEMBLY BAHAIS	3305 SPRING MOUNTAIN RD #52 LAS VEGAS NV 89102-8620	16303702024
CITY OF LAS VEGAS	%CITY CLERK 400 STEWART AVE LAS VEGAS NV 89101-2913	16302302001

**Report of All Selected Parcels****Case Number:** ROC-43006**Printed On:** Thu: September 8, 2011

<u>Owner</u>	<u>Address</u>	<u>Parcel Number</u>
CITY OF LAS VEGAS	%REAL EST & ASSETS 400 STEWART AVE 4TH FL LAS VEGAS NV 89101-2913	16302303001
CITY OF LAS VEGAS	400 E STEWART AVE LAS VEGAS NV 89101-2913	16303702007
CLEVELAND FAMILY TRUST	%C CLEVELAND 2895 SORRELL ST LAS VEGAS NV 89146-5130	16311105009
CLOOTEN KWANG OK	1620 DAVILLA ST LAS VEGAS NV	16302213049
COHEN JAY S	6766 TRINITY CT LAS VEGAS NV 89146-5167	16311110019
COLEMAN FAMILY TRUST	COLEMAN GARY E & MARY LEE TRS 6216 CAMINO DE LA COSTA LA JOLLA CA 92037-6522	16302313012
CONRAD CARL J & LISA	%OPTIM PPTY SOLUTIONS 8501 E PRINCESS DR #130 SCOTTSDALE AZ 85255-5481	16310508002
CONRAD CARL J & LISA	%OPTIM PPTY SOLUTIONS 8501 E PRINCESS DR #130 SCOTTSDALE AZ 85255-5481	16310508001
COPSEY GAY E & DARLENE LIVING TR	COPSEY GAY E & DARLENE TRS 6612 VICUNA DR LAS VEGAS NV 89146-2908	16302412025
CORREOS HAROLD S & ROSEMARIE	1830 DEL FONT CT LAS VEGAS NV 89117-2100	16303712010
CORSARO RUDOLPH & FANNIE KAYE	1501 OSCAR CT #201 LAS VEGAS NV	16302213008
COTE ALAN W	1027 S RAINBOW BLVD #251 LAS VEGAS NV 89145-6232	16303702014
COUNTY OF CLARK(PK & COMM SERV)	500 S GRAND CENTRAL PKWY LAS VEGAS NV 89155	16311203005
COWLES JENNY & JASON	2460 BROOKLYN BRIDGE ST LAS VEGAS NV 89135-1123	16302414006
COX DAVID R	PETTIT DIANE D 6412 PEPPERMILL DR LAS VEGAS NV 89146-0801	16302414025
COX NORMAN	VOGEL DEBRA 6613 OBANNON DR LAS VEGAS NV 89146-2945	16302412026
CUMMINGS PATRICK J & JUDY LIV TR	CUMMINGS PATRICK J & JUDY M TRS 6604 VICUNA DR LAS VEGAS NV 89146-2908	16302412023
D & K TRUST	6533 W SAHARA AVE LAS VEGAS NV 89146-2909	16311103003
D L J MORTGAGE CAPITAL INC	%SELECT PORTFOLIO SRVCING INC 3815 S.W. TEMPLE SALT LAKE CITY UT 84115-4412	16302412020
DAHLSTROM URSULA FAMILY TRUST	DAHLSTROM URSULA TRS 2015 REDWOOD ST LAS VEGAS NV 89146-2912	16302310021
DAIGLE ROBERT E TRUST	DIAGLE ROBERT E TRS 6505 O BANNON DR LAS VEGAS NV 89102-0854	16302413005
DALISAY CELIA A	6670 EKDIRA AVE LAS VEGAS NV 89146	16311105012
DANIELLE REALTY L L C	5850 CENTENNIAL CENTER BLVD LAS VEGAS NV 89149-4570	16303806012
DAPP DAVID O	1700 SANDECKER CT #202 LAS VEGAS NV	16302213069
DE LOS REYES VIVIANA & RAFAEL	6820 SAN RICARDO AVE #202 LAS VEGAS NV	16302213015
DEAN STEVEN	2290 MONTESSOURI ST LAS VEGAS NV 89117-2814	16303803009
DEGNER EARL W LIVING TRUST	DEGNER EARL W TRS %J DEGNER 6536 S HOLT AVE LOS ANGELES CA 90056-2210	16302410001
DELAVEGA MARLON B TRUST	413 CLIFTON HEIGHTS DR LAS VEGAS NV	16302213048
DELFANTE TRACY & ELIZABETH A	DELFANTE MIKE & SHERIE C 6770 W FARM RD LAS VEGAS NV 89131-2213	16303703006
DEROUEN DANIEL L & ELLI M TRUST	DEROUEN DANIEL L & ELLI M TRS 2090 ROSANNA ST LAS VEGAS NV 89117-2136	16303704003
DESERT BUICK-G M C TRUCKS INC	6400 W SAHARA AVE LAS VEGAS NV 89146-3033	16302402002
DIAL MILTON K & SHEILA J	6757 OBANNON DR LAS VEGAS NV 89146-2905	16302410003

**Report of All Selected Parcels****Case Number:** ROC-43006**Printed On:** Thu: September 8, 2011

<u>Owner</u>	<u>Address</u>	<u>Parcel Number</u>
DIAZ ELENA A	DIAZ ALFONSO A JR & DENISE 2637 S TORREY PINES DR LAS VEGAS NV 89146-5138	16311106013
DICHIARA ANTHONY & L 1995 REV TR	1620 DAVILLA ST #104 LAS VEGAS NV	16302213052
DIDENTE FRANK A TRUST	6768 ELDORA AVE LAS VEGAS NV 89146-5124	16311110013
DIEKMANN DOLORES	1854 CASA VISTA DR LAS VEGAS NV 89146-2922	16302310014
DIKIT JORGE V	1600 DAVILLA ST #204 LAS VEGAS NV	16302213035
DILLON JENNIFER	1610 DAVILLA ST #204 LAS VEGAS NV	16302213041
DIMOPOULOS FAMILY TRUST	1182 SONOMA DR ALTADENA CA	16302213010
DOERING MARK	MANCINI LAUREN 6404 VICUNA DR LAS VEGAS NV 89146-2996	16302414009
DONER DENISE A	1620 DAVILA ST #204 LAS VEGAS NV	16302213053
DOWN ROBERT L & MARYANN F	6745 ELDORA AVE LAS VEGAS NV 89146-5123	16311202001
DROODIANI JALAL JAY & BOBAK JEAN	1936 CASA VISTA DR LAS VEGAS NV 89146-2984	16302310017
DU ELLIS EATTY	6970 ELDORA ST LAS VEGAS NV 89117-3012	16310511007
EGGERTSSON SOLEY M	1501 OSCAR CT #204 LAS VEGAS NV	16302213011
EISEL JACK A SR & KAREN A	6521 OBANNON DR LAS VEGAS NV 89146-0854	16302413001
ELIADES LIZA A	6811 SAN RICARDO AVE #201 LAS VEGAS NV	16302213020
ELKOUBY ALBERT	%JH DESIGN GROUP INC 940 W WASHINGTON LOS ANGELES CA 90015-3312	16311101005
ESCOBAR DENNIS R	LE LINNG H 6840 SIERRA TRL LAS VEGAS NV 89146-2906	16302312003
EVANS MARCI QUAL PERS RES TR	KNOWLTON MARCI EVANS TRS 6513 VICUNA DR LAS VEGAS NV 89146-2925	16302413013
FARNEJAD CHANGIZ ETAL	6822 OBANNON DR LAS VEGAS NV 89146-2946	16302312008
FEDERAL HOME LOAN MORTGAGE CORP	%L ZIEVE 18377 BEACH BLVD #210 HUNTINGTON BEACH CA 92648-1349	16303804005
FEDERAL NATIONAL MORTGAGE ASSN	%ONEWEST BANK FSB 2900 ESPERANZA CROSSING AUSTIN TX 78758-3658	16302412004
FEDERAL NATIONAL MORTGAGE ASSN	400 COUNTRYWIDE WY SV-35 SIMI VALLEY CA 93065-6298	16302414012
FENTON-MULLEN JEANNE	2611 BARBARADALE CIR LAS VEGAS NV 89146-5160	16311111003
FIORE FRANK & SUSAN	6421 PEPPERMILL LAS VEGAS NV 89146-0802	16302414030
FITZGERALD REBECCA A	2196 CANYONVILLE DR HENDERSON NV 89044-4524	16302414007
FLANGAS WILLIAM	6799 TRINITY CT LAS VEGAS NV 89146-5171	16311110016
FLIPPIN KEOLA K & BARBARA A	6413 VICUNA DR LAS VEGAS NV 89146-2997	16302414018
FONTAINE RAYMOND	WILSON-FONTAINE KAREN 1763 BRADFORD WY LIVERMORE CA 94550-6461	16302415006
FORBES SCOTT D	2665 SORREL ST LAS VEGAS NV 89146-5130	16311105008
FOSKARIS FAMILY LIVING TRUST	FOSKARIS NICHOLAS G & D A CO-TRS 2780 EL CAMINO RD LAS VEGAS NV 89146-5221	16302312007
FRABBIELE SANDRA J	6811 SAN RICARDO AVE #203 LAS VEGAS NV	16302213024
FRANZESE KRISTI & RONALD	6409 VICUNA DR LAS VEGAS NV 89146-2997	16302414019

**Report of All Selected Parcels****Case Number:** ROC-43006**Printed On:** Thu: September 8, 2011

<u>Owner</u>	<u>Address</u>	<u>Parcel Number</u>
FUTRELL WILLIAM R & GAIL L	1610 SANDECKER CT #101 LAS VEGAS NV	16302213043
GALLAGHER FAMILY TRUST	GALLAGHER PATRICK J & KARI A TRS 6790 OBANNON DR LAS VEGAS NV 89146-2927	16302311007
GARBER DOUGLAS A & JUDITH S	6517 PEPPERMILL DR LAS VEGAS NV 89146-2918	16302413022
GARRISON LAURA	6765 W LAREDO ST LAS VEGAS NV 89146-5117	16311110024
GERSTNER DEREK	1007 CODY AVE HAYS KS	16302213054
GIANDJIAN AKOP	8864 DANERI PL LAS VEGAS NV 89147-6528	16303712007
GLIDEWELL JAMES W & LUCRETIA A	6401 VICUNA DR LAS VEGAS NV 89146-2997	16302414021
GOEBEL DIETER E & TONI FAMILY TR	GOEBEL DIETER E TRS 6513 PEPPERMILL DR LAS VEGAS NV 89146-2918	16302413023
GOENS EDWINA J	6400 VICUNA DR LAS VEGAS NV 89146-2996	16302414008
GRANT JAMES R	ARELLANO-GRANT MARIA 6609 OBANNON DR LAS VEGAS NV 89146-2945	16302412027
GRANT MARIA & JAMES	6408 PEPPERMILL DR LAS VEGAS NV 89146-0801	16302414024
HAAS DONALD R & ANNA M	6840 ADOBE CT LAS VEGAS NV 89146-2920	16302310010
HAECKE DENNIS	1810 S RAINBOW BLVD LAS VEGAS NV	16302213040
HAECKE DENNIS C	1810 S RAINBOW LAS VEGAS NV 89146-2911	16302301001
HAFEN I L L C	161 KIMBERLY DR HENDERSON NV 89015-7904	16303803018
HALE ARTHUR SEPARATE PROPERTY TR	HALE DORIS ANITA TRUST P O BOX 10101 PALM DESERT CA 92255-0101	16311106006
HALLE PROPERTIES L L C	%DEPT 1100-NVLO6 20225 N SCOTTSDALE RD SCOTTSDALE AZ 85255-6456	16311103015
HAMMANT FAMILY TRUST	HAMMANT GERALD W & PHYLLIS S TRS 6513 OBANNON DR LAS VEGAS NV 89146-0854	16302413003
HAN LIJUN	6416 PEPPERMILL DR LAS VEGAS NV 89146-0801	16302414026
HANTIGOVA OLGA	1499 CAYUGA PKWY LAS VEGAS NV 89169-3157	16303802013
HANTIGOVA OLGA	1499 CAYUGA PKWY LAS VEGAS NV 89169-3157	16303802012
HARDY SCOTT A	2640 ROSANNA ST LAS VEGAS NV 89117-3050	16310511003
HARRIS BARBARA D	1831 DEL FONT CT LAS VEGAS NV 89117-2100	16303712004
HARVEY NANJI M	HARVEY NANJI M & THOMAS J 6760 OBANNON DR LAS VEGAS NV 89146-2927	16302310037
HEESE FAMILY TRUST	HEESE JACQUELINE D & STEVEN TRS 6773 OBANNON DR LAS VEGAS NV 89146-2905	16302410002
HERMAN EDWARD T III & CHERYL L	6601 PEPPERMILL DR LAS VEGAS NV 89146-2915	16302412013
HILL JIM RUSSELL & LEATHA G	6504 PEPPERMILL DR LAS VEGAS NV 89146-2917	16302413016
HILL JOHN K	6421 VICUNA DR LAS VEGAS NV 89146-2997	16302414016
HINES ANNA M TRUST	1620 SANDECKER CT #202 LAS VEGAS NV	16302213063
HODSON CASEY	6830 TRINITY CT LAS VEGAS NV 89146-5168	16311110005
HOLPER PATRICIA A	2280 MONTESSOURI CIR LAS VEGAS NV 89117-2814	16303803008
HORN NORMAN RAY & JANE ANNE	1899 CASA VISTA DR LAS VEGAS NV 89146-2921	16302310007

**Report of All Selected Parcels****Case Number:** ROC-43006**Printed On:** Thu: September 8, 2011

<u>Owner</u>	<u>Address</u>	<u>Parcel Number</u>
HOUSER JAMES	2634 REDWOOD ST LAS VEGAS NV 89146-5109	16311105015
HUANG LIU CHU	224 CROOKED PUTTER DR LAS VEGAS NV 89148-5263	16302313004
HUFFMAN ROSE M	6731 SIERRA TRL LAS VEGAS NV 89146-2907	16302310032
HUGHES FAMILY TRUST	HUGHES DANIEL J SR & MARIA M TRS 2105 AUTUMN LULL DR LAS VEGAS NV 89146-2930	16302412002
HUME ROBERT B & SHIRLEY N	1962 CASA VISTA DR LAS VEGAS NV 89146-2984	16302310018
HUYNH BE THI & THUY VAN THI	6517 OBANNON DR LAS VEGAS NV 89146-0854	16302413002
HWANG LISA	1700 SANDECKER CT #101 LAS VEGAS NV	16302213067
ICE ANNE MARE REVOCABLE LIV TR	17120 GOLDWIN SOUTHFIELD MI	16302213082
ITZCHAKI DANIEL	2563 AVIV CT LAS VEGAS NV 89121-3947	16302313014
ITZHAKI TOMER & AVIV	5875 S RAINBOW BLVD #204 LAS VEGAS NV 89118-2556	16302313015
J E D FAMILY TRUST	DUNN JAMES L & EVELYN F TRS 6550 LAREDO ST LAS VEGAS NV 89146-5114	16311103012
J R J INVESTMENTS INC	6900 W SAHARA AVE LAS VEGAS NV 89117-2831	16303806010
JABARA MICHAEL D	2709 PINTO LN LAS VEGAS NV 89107-4617	16302412029
JADKOWSKI KATRINA	6821 SANTA ISABEL AVE #202 LAS VEGAS NV	16302213081
JAMES HADLEY D & EUNICE M	1991 CASA VISTA LAS VEGAS NV 89146-2923	16302311004
JARRETT CHILDRENS TRUST 1980	JARRETT REX A JR TRS 4150 WOODCREST RD LAS VEGAS NV 89121-4942	16303704009
JEGOUX HERELLE	6820 SAN RICARDO AVE #203 LAS VEGAS NV	16302213018
JENSEN JEFFERY J & CINDY M	2622 BARBARADALE CIR LAS VEGAS NV 89146-5160	16311111002
JERBIC BRADFORD R	7040 W OBANNON LAS VEGAS NV 89117-2124	16303702008
JOHNSON CINDY K	1600 DAVILLA ST #101 LAS VEGAS NV	16302213031
JOHNSON FAMILY TRUST	JOHNSON GARY A & MARY JANE TRS P O BOX 80063 LAS VEGAS NV 89180-0063	16302310009
JOSEPH JANNE S	1501 OSCAR CT #202 LAS VEGAS NV	16302213009
JUNGE STEVEN R & PAMELA L	6781 ELDORA AVE LAS VEGAS NV 89146-5123	16311210021
KP PARTNERS V L L C	1050 E SAHARA AVE #101 LAS VEGAS NV 89104-3204	16311104001
KALLMAN TRUST	KALLMAN RODERICK R & VICKI L TRS 6509 OBANNON DR LAS VEGAS NV 89146-0854	16302413004
KANE JUNE E	6745 SIERRA TRL LAS VEGAS NV 89146-2907	16302310031
KANTARI SUSAN	1955 ROSANNA ST LAS VEGAS NV 89117-2141	16303702018
KAPLAN FAMILY TRUST	KAPLAN D LORENE TRS P O BOX 82226 LAS VEGAS NV 89180-2226	16303804006
KELLOGG PAUL III & M FAM TR 2007	KELLOGG PAUL III & MARLYS R TRS 9065 S PECOS RD #120 HENDERSON NV 89074-7188	16311105004
KERBAJ ZIAD SALAH	1500 OSCAR CT #104 LAS VEGAS NV	16302213004
KERRY CECELIA	6821 SANTA ISABEL AVE #204 LAS VEGAS NV	16302213083
KETER YAEL	1610 SANDECKER CT #104 LAS VEGAS NV	16302213046

**Report of All Selected Parcels****Case Number:** ROC-43006**Printed On:** Thu: September 8, 2011

<u>Owner</u>	<u>Address</u>	<u>Parcel Number</u>
KEYES GEOFFREY O & ALICE K	H C 33 BOX 25 LAS VEGAS NV 89161-9210	16303803014
KILLIAN LOANA E	6512 VICUNA DR LAS VEGAS NV 89146-2924	16302413008
KING SHIRLEY F TRUST	6357 VICUNA DR LAS VEGAS NV 89146-3007	16302811033
KING WILLIAM F & BERNADETTE Y	2645 SORREL ST LAS VEGAS NV 89146-5130	16311105006
KINGDOM TRUST	HASTINGS JAMES F II & SUSAN TRS 2655 SORREL ST LAS VEGAS NV 89146-5130	16311105007
KLOPFENSTINE TRUST	KLOPFENSTINE MYRON & VIOLET TRS 1882 CASA VISTA DR LAS VEGAS NV 89146-2922	16302310015
KONDAUR CAPITAL CORPORATION	%FORECLOSURE DEPT ONE CITY BLVD W #1900 ORANGE CA 92868-3637	16302413011
KRAHN DAVID W & SHERI S	P O BOX 70722 RIVERSIDE CA 92513-0722	16311105005
KRAMAROV MARINA & BATIA	3864 BROADMEAD ST LAS VEGAS NV 89147-1055	16311111001
KRUEGAR SUSAN	6601 VICUNA DR LAS VEGAS NV 89146-2910	16302412021
LABELLARTE FAMILY TRUST	LABELLARTE NICHOLAS L & G TRS 5572 S HAWLEY CT LAS VEGAS NV 89118-1856	16310507003
LABORERS INTL UNION LOCAL 872	2345 RED ROCK ST LAS VEGAS NV 89146-3181	16310502013
LADEKI SAMI TRUST	%SAMMY'S WOODFIRED PIZZA 7596 EADS AVE #200 LA JOLLA CA 92037-4899	16302416006
LAIR FAMILY TRUST	LAIR GARY & MARGARET TRS 6612 PEPPERMILL DR LAS VEGAS NV 89146-2913	16302412017
LAM MEI YING	1501 OSCAR CT #203 LAS VEGAS NV	16302213012
LAMBERT JANIA	6420 VICUNA DR LAS VEGAS NV 89146-2996	16302414013
LANDSBERGER BRIAN & DONG	6775 SIERRA TRL LAS VEGAS NV	16302213014
LANDSBERGER BRIAN J & DONG M	6775 SIERRA TRL LAS VEGAS NV	16302213055
LANDSBERGER BRIAN J & DONG M	6775 SIERRA TRL LAS VEGAS NV 89146-2907	16302310029
LANDSBERGER BRIAN J & DONG M	6775 SIERRA TRL LAS VEGAS NV	16302213075
LANGE STEVE	6814 TRINITY CT LAS VEGAS NV 89146-5168	16311110004
LARA EDWARD H & NINA M	6965 O'BANNON DR LAS VEGAS NV 89117-2121	16303804001
LAREDO PROFESSIONAL PLAZA L L C	2500 W SAHARA AVE #211 LAS VEGAS NV 89102-4393	16310503004
LAREDO PROFESSIONAL PLAZA L L C	%NEVADA DEVELOPMENT & REALTY CO 2500 W SAHARA AVE #211 LAS VEGAS NV 89102-4393	16310503005
LARSON S FAMILY L P	2950 E FLAMINGO #H LAS VEGAS NV 89121-5208	16302313006
LAS VEGAS VALLEY WATER DISTRICT	%LAND ACQUISITION & MGMT 1001 S VALLEY VIEW BLVD #MS 95 LAS VEGAS NV 89107-4447	16303603010
LEAVITT RICHARD A & JOAN W	6841 W OAKLEY BLVD LAS VEGAS NV 89146-2902	16302310001
LEE CYNTHIA L REVOCABLE TRUST	LEE CYNTHIA L TRS 6800 PEPPERMILL DR LAS VEGAS NV 89146-2913	16302412014
LEE TERRY S & CLARE K	714 COTTONWOOD DR LANSING KS	16302213072
LEMASTER WILLIAM & JOYCE FAM TR	LEMASTER WILLIAM C TRS 6413 PEPPERMILL DR LAS VEGAS NV 89146-0802	16302414032
LEMICH MIKE & DOLORES A	6729 OBANNON DR LAS VEGAS NV 89146-2905	16302410005

**Report of All Selected Parcels****Case Number:** ROC-43006**Printed On:** Thu: September 8, 2011

<u>Owner</u>	<u>Address</u>	<u>Parcel Number</u>
LEUMI B L L C	8350 W SAHARA AVE #150 LAS VEGAS NV 89117-8954	16303704002
LEVIN DONALD B	6409 OBANNON DR LAS VEGAS NV 89146-2928	16302414005
LEVITZKY DANIEL L REVOCABLE TR	LEVITZKY DANIEL L TRS 6504 VICUNA DR LAS VEGAS NV 89146-2924	16302413006
LIM YEAM S & POK KEEN	6801 SAN RICARDO #202 LAS VEGAS NV	16302213027
LIN WILLIAM	YU RUI-JI 7045 EL PARQUE AVE LAS VEGAS NV 89117-2105	16303702015
LIPPINCOTT GAIL B & SANDRA K	6791 SIERRA TRL LAS VEGAS NV 89146-2907	16302311006
LISSAU STEVEN J	6130 W FLAMINGO #162 LAS VEGAS NV 89103-2280	16311106016
LITEX-COMMERCE INC	2250 MONTESSOURI ST LAS VEGAS NV 89117-2814	16303803005
LITEX-COMMERCE INC	2250 MONTESSOURI ST LAS VEGAS NV 89117-2814	16303803006
LIU NELSON & MARCOS	8850 MCLENNAN AVE SEPULVEDA CA	16302213060
LJUNGQUIST ROBERT & LINDA M	1827 S REDWOOD ST LAS VEGAS NV 89146-2912	16302310028
LOCATIONS INC 401K PROFIT SHR PL	Q A F INVEST LLC 401K PL TR 5560 S FORT APACHE RD #120 LAS VEGAS NV 89148-7699	16303802011
LOPEZ VICTORIA G	1501 OSCAR CT #101 LAS VEGAS NV	16302213007
LOS NEVADOS PARTNERS	7428 SILVER PALM AVE LAS VEGAS NV 89117-1442	16303714007
LOTUS RETAIL INVESTMENT L L C	%CAMBRIDGE GROUP LTD 1820 E WARM SPRINGS RD #120 LAS VEGAS NV 89119-4593	16302212001
LU ANNA WENAN	40767 CAPA DR FREMONT CA	16302213019
LU JUNJIE	2707 RED ROCK ST LAS VEGAS NV 89146	16311202002
LUO MALISA	2105 LINDA VISTA ST LAS VEGAS NV 89102-3721	16302312002
LUO XIAO LAN	5651 RITTER LN LAS VEGAS NV 89118-1351	16302412005
M E C G-RAINBOW PLAZA L L C ETAL	3993 HOWARD HUGHES PKWY #700 LAS VEGAS NV 89169-6760	16310512001
M E C G-RAINBOW PLAZA L L C ETAL	3993 HOWARD HUGHES PKWY #700 LAS VEGAS NV 89169-6760	16310508003
M E C G-RAINBOW PLAZA L L C ETAL	%MAMMOTH EQUITIES CAPITAL GROUP 29222 RANCHO VIEJO RD #203 SAN JUAN CAPISTRANO CA 92675-1045	16310512002
MACQUARRIE KIM	1701 SANDECKER CT #203 LAS VEGAS NV	16302213078
MANCINI ROBERT	6155 SWEETBRIAR CT LAS VEGAS NV 89146-3015	16311110001
MARKS KATHERINE A & DOUGLAS R	6820 SAN RICARDO AVE #204 LAS VEGAS NV	16302213017
MARLON JOHN A & DIANNE SUE	2016 CASA VISTA DR LAS VEGAS NV 89146-2985	16302310020
MARTIN ROBERT E & KAYE	7045 W LAREDO ST LAS VEGAS NV 89117-3021	16310507004
MASTALIR FAMILY TRUST	MASTALIR JOHN E & JANET K TRS 6516 VICUNA DR LAS VEGAS NV 89146-2924	16302413009
MAURER SUSAN REVOCABLE TRUST	MAURER SUSAN K TRS 1881 REDWOOD LAS VEGAS NV 89146-2912	16302310026
MAURO FAMILY TRUST	MAURO MARGIE TRS 1825 CASA VISTA DR LAS VEGAS NV 89146-2921	16302310004
MAY JAMES & PAULINE REV LIV TR	MAY JAMES R & PAULINE E TRS 6575 LAREDO ST LAS VEGAS NV 89146-5127	16311106001

**Report of All Selected Parcels****Case Number:** ROC-43006**Printed On:** Thu: September 8, 2011

<u>Owner</u>	<u>Address</u>	<u>Parcel Number</u>
MCCLAIN DONALD R & PATRICIA	1610 SANDECKER CT #204 LAS VEGAS NV	16302213047
MCCOY SUMMER R	6846 TRINITY CT LAS VEGAS NV 89146-5168	16311110006
MCDONALDS HAWAII DEVELOPMENT CO	%MCDONALDS CORP #027-0101 P O BOX 182571 COLUMBUS OH 43218-2571	16302401006
MCGALIS KAREN L REVOCABLE TRUST	MCGALIS KAREN L TRS 6839 ADOBE CT LAS VEGAS NV 89146-2920	16302310011
MCGHEE KENNETH T & DELORES	6816 ELDORA AVE LAS VEGAS NV 89146-5126	16311110010
MCNAMARA WILLIAM R & CAROL A	1875 CASA VISTA DR LAS VEGAS NV 89146-2921	16302310006
MCSHANE CATHERINE J	6820 SAN RICARDO AVE #101 LAS VEGAS NV	16302213013
MEDCALF JAN & MICHAEL L	WILLIAMS DORLEEN H 2230 MONTESSOURI ST LAS VEGAS NV 89117-2814	16303803003
MEINEN KIMBERLY M	1910 ROAN RD HENDERSON NV	16302213030
MELLO FAMILY REVOCABLE LIVING TR	MELLO MANUEL A & MARIA Z TRS P O BOX 155 SAN MARTIN CA 95046-0155	16303714006
MERCADO KALINDA	2121 ROSANNA ST LAS VEGAS NV 89117-2135	16303702010
MIKE'S PLAZA L L C	7421 DOW AVE LAS VEGAS NV 89117	16303804008
MILLER LUCKY L & LINDA J	6613 VICUNA DR LAS VEGAS NV 89146-2910	16302412018
MILTENBERGER DOUG	2270 MONTESSOURI ST LAS VEGAS NV 89117-2814	16303803007
MINI-SICKELS LAUREN	6730 O BANNON DR LAS VEGAS NV 89102-2927	16302310035
MONTAGUE MARTHA FAMILY TRUST	MONTAGUE MARTHA TRS 2061 ROSANNA ST LAS VEGAS NV 89117-2135	16303702012
MONTES DIEGO & SHELBY	2017 CASA VISTA DR LAS VEGAS NV 89146-2923	16302311005
MONTROSE ZENA LIVING TRUST	MONTROSE ZENA TRS 6613 PEPPERMILL DR LAS VEGAS NV 89146-2915	16302412010
MOORE OVID A & EDNA E TRUST	MOORE OVID A & EDNA E TRS P O BOX 26627 LAS VEGAS NV 89126-0627	16311103009
MOSTAFA SALWA	1700 SANDECKER CT #204 LAS VEGAS NV	16302213071
MUSGROVE LEWIS C & SUE A LIV TR	MUSGROVE LEWIS C & SUE ANN TRS 6408 VICUNA DR LAS VEGAS NV 89146-2996	16302414010
MUSTANG MAN L L C	8621 ROBINSON RIDGE LAS VEGAS NV 89117-5807	16302415012
MY WAY L L C	%D SIVERTSEN 1645 VILLAGE CENTER CIR #141 LAS VEGAS NV 89134-6371	16311201009
MYRDAHL JERRY P JR	6308 RACTOR AVE LAS VEGAS NV	16302213079
NAGATA NORMAN T & JANE T	1424 ALA KOPIKO ST HONOLULU HI 96818-1508	16302310016
NAJARIAN GEORGE A & CYNTHIA C	12873 VIA AVENTURA COWAN HEIGHTS CA	16302213002
NAKANISHI FAMILY TRUST	NAKANISHI GENE & AMY CO-TRS 7046 EL PARQUE AVE LAS VEGAS NV 89117-2106	16303702016
NELSON FAMILY TRUST	NELSON ROBERT F & THERESA J TRS 2221 ROSANNA ST LAS VEGAS NV 89117-2823	16303803012
NEVADA POWER COMPANY	%LAND SERV STA #9 P O BOX 98910 LAS VEGAS NV 89193-8910	16310503003
NEWMARK S & J LIV TR SURV TR	NEWMARK JUNE FTRES 2615 ROSANNA ST LAS VEGAS NV 89117-3049	16310507005
NG FAMILY TRUST	NG FANNY TRS 2371 RIDGEVIEW AVE ROWLAND HEIGHTS CA 91748-4863	16302415014
NICHOLS PAUL R & MOONYEAN A	6831 W TRINITY CT LAS VEGAS NV 89146-5172	16311110008

**Report of All Selected Parcels**

**Case Number:** ROC-43006

**Printed On:** Thu: September 8, 2011

<u>Owner</u>	<u>Address</u>	<u>Parcel Number</u>
NIEMS STUART & MAXINE	2220 MONTESSOURI ST LAS VEGAS NV 89117-2814	16303803002
NINIO SHIMON J & IDA FAMILY TR	NINIO SHIMON J & IDA TRS 2240 MONTESSORI ST LAS VEGAS NV 89117-2814	16303803004
NOONAN PERRY & CARROL TRUST	NOONAN PERRY & CARROL J TRS 6815 TRINITY CT LAS VEGAS NV 89146-5172	16311110009
OD SAHARA WEST L L C	P O BOX 19297 LAS VEGAS NV	16302411182
OD SAHARA WEST L L C	P O BOX 19297 LAS VEGAS NV	16302411287
OD SAHARA WEST L L C	P O BOX 19297 LAS VEGAS NV	16302411181
OD SAHARA WEST L L C	P O BOX 19297 LAS VEGAS NV	16302411180
OD SAHARA WEST L L C	P O BOX 19297 LAS VEGAS NV	16302411178
OD SAHARA WEST L L C	P O BOX 19297 LAS VEGAS NV	16302411177
OD SAHARA WEST L L C	P O BOX 19297 LAS VEGAS NV	16302411179
OD SAHARA WEST L L C	P O BOX 19297 LAS VEGAS NV	16302411190
OD SAHARA WEST L L C	P O BOX 19297 LAS VEGAS NV	16302411201
OD SAHARA WEST L L C	P O BOX 19297 LAS VEGAS NV	16302411200
OD SAHARA WEST L L C	P O BOX 19297 LAS VEGAS NV	16302411199
OD SAHARA WEST L L C	P O BOX 19297 LAS VEGAS NV	16302411198
OD SAHARA WEST L L C	P O BOX 19297 LAS VEGAS NV	16302411197
OD SAHARA WEST L L C	P O BOX 19297 LAS VEGAS NV	16302411196
OD SAHARA WEST L L C	P O BOX 19297 LAS VEGAS NV	16302411195
OD SAHARA WEST L L C	P O BOX 19297 LAS VEGAS NV	16302411194
OD SAHARA WEST L L C	P O BOX 19297 LAS VEGAS NV	16302411193
OD SAHARA WEST L L C	P O BOX 19297 LAS VEGAS NV	16302411185
OD SAHARA WEST L L C	P O BOX 19297 LAS VEGAS NV	16302411191
OD SAHARA WEST L L C	P O BOX 19297 LAS VEGAS NV	16302411183
OD SAHARA WEST L L C	P O BOX 19297 LAS VEGAS NV	16302411189
OD SAHARA WEST L L C	P O BOX 19297 LAS VEGAS NV	16302411285
OD SAHARA WEST L L C	P O BOX 19297 LAS VEGAS NV	16302411286
OD SAHARA WEST L L C	P O BOX 19297 LAS VEGAS NV	16302411188
OD SAHARA WEST L L C	P O BOX 19297 LAS VEGAS NV	16302411187
OD SAHARA WEST L L C	P O BOX 19297 LAS VEGAS NV	16302411174
OD SAHARA WEST L L C	P O BOX 19297 LAS VEGAS NV	16302411186
OD SAHARA WEST L L C	P O BOX 19297 LAS VEGAS NV	16302411288
OD SAHARA WEST L L C	P O BOX 19297 LAS VEGAS NV	16302411184

**Report of All Selected Parcels**

**Case Number:** ROC-43006

**Printed On:** Thu: September 8, 2011

<u>Owner</u>	<u>Address</u>	<u>Parcel Number</u>
O D SAHARA WEST L L C	P O BOX 19297 LAS VEGAS NV	16302411192
O D SAHARA WEST L L C	P O BOX 19297 LAS VEGAS NV	16302411033
O D SAHARA WEST L L C	P O BOX 19297 LAS VEGAS NV	16302411175
O D SAHARA WEST L L C	P O BOX 19297 LAS VEGAS NV	16302411021
O D SAHARA WEST L L C	P O BOX 19297 LAS VEGAS NV	16302411022
O D SAHARA WEST L L C	P O BOX 19297 LAS VEGAS NV	16302411023
O D SAHARA WEST L L C	P O BOX 19297 LAS VEGAS NV	16302411024
O D SAHARA WEST L L C	P O BOX 19297 LAS VEGAS NV	16302411025
O D SAHARA WEST L L C	P O BOX 19297 LAS VEGAS NV	16302411026
O D SAHARA WEST L L C	P O BOX 19297 LAS VEGAS NV	16302411027
O D SAHARA WEST L L C	P O BOX 19297 LAS VEGAS NV	16302411028
O D SAHARA WEST L L C	P O BOX 19297 LAS VEGAS NV	16302411019
O D SAHARA WEST L L C	P O BOX 19297 LAS VEGAS NV	16302411031
O D SAHARA WEST L L C	P O BOX 19297 LAS VEGAS NV	16302411018
O D SAHARA WEST L L C	P O BOX 19297 LAS VEGAS NV	16302411034
O D SAHARA WEST L L C	P O BOX 19297 LAS VEGAS NV	16302411035
O D SAHARA WEST L L C	P O BOX 19297 LAS VEGAS NV	16302411036
O D SAHARA WEST L L C	P O BOX 19297 LAS VEGAS NV	16302411037
O D SAHARA WEST L L C	P O BOX 19297 LAS VEGAS NV	16302411038
O D SAHARA WEST L L C	P O BOX 19297 LAS VEGAS NV	16302411039
O D SAHARA WEST L L C	P O BOX 19297 LAS VEGAS NV	16302411040
O D SAHARA WEST L L C	P O BOX 19297 LAS VEGAS NV	16302411041
O D SAHARA WEST L L C	P O BOX 19297 LAS VEGAS NV	16302411042
O D SAHARA WEST L L C	P O BOX 19297 LAS VEGAS NV	16302411043
O D SAHARA WEST L L C	P O BOX 19297 LAS VEGAS NV	16302411029
O D SAHARA WEST L L C	P O BOX 19297 LAS VEGAS NV	16302411007
O D SAHARA WEST L L C	P O BOX 19297 LAS VEGAS NV	16302411290
O D SAHARA WEST L L C	P O BOX 19297 LAS VEGAS NV	16302411176
O D SAHARA WEST L L C	P O BOX 19297 LAS VEGAS NV	16302411284
O D SAHARA WEST L L C	P O BOX 19297 LAS VEGAS NV	16302411291
O D SAHARA WEST L L C	P O BOX 19297 LAS VEGAS NV	16302411208
O D SAHARA WEST L L C	P O BOX 19297 LAS VEGAS NV	16302411001

**Report of All Selected Parcels****Case Number:** ROC-43006**Printed On:** Thu: September 8, 2011

<u>Owner</u>	<u>Address</u>	<u>Parcel Number</u>
O D SAHARA WEST L L C	P O BOX 19297 LAS VEGAS NV	16302411002
O D SAHARA WEST L L C	P O BOX 19297 LAS VEGAS NV	16302411003
O D SAHARA WEST L L C	P O BOX 19297 LAS VEGAS NV	16302411004
O D SAHARA WEST L L C	P O BOX 19297 LAS VEGAS NV	16302411020
O D SAHARA WEST L L C	P O BOX 19297 LAS VEGAS NV	16302411006
O D SAHARA WEST L L C	P O BOX 19297 LAS VEGAS NV	16302411289
O D SAHARA WEST L L C	P O BOX 19297 LAS VEGAS NV	16302411008
O D SAHARA WEST L L C	P O BOX 19297 LAS VEGAS NV	16302411009
O D SAHARA WEST L L C	P O BOX 19297 LAS VEGAS NV	16302411010
O D SAHARA WEST L L C	P O BOX 19297 LAS VEGAS NV	16302411011
O D SAHARA WEST L L C	P O BOX 19297 LAS VEGAS NV	16302411012
O D SAHARA WEST L L C	P O BOX 19297 LAS VEGAS NV	16302411013
O D SAHARA WEST L L C	P O BOX 19297 LAS VEGAS NV	16302411014
O D SAHARA WEST L L C	P O BOX 19297 LAS VEGAS NV	16302411015
O D SAHARA WEST L L C	P O BOX 19297 LAS VEGAS NV	16302411016
O D SAHARA WEST L L C	P O BOX 19297 LAS VEGAS NV	16302411017
O D SAHARA WEST L L C	P O BOX 19297 LAS VEGAS NV	16302411005
O D SAHARA WEST L L C	P O BOX 19297 LAS VEGAS NV	16302411270
O D SAHARA WEST L L C	P O BOX 19297 LAS VEGAS NV	16302411247
O D SAHARA WEST L L C	P O BOX 19297 LAS VEGAS NV	16302411246
O D SAHARA WEST L L C	P O BOX 19297 LAS VEGAS NV	16302411269
D D SAHARA WEST L L C	P O BOX 19297 LAS VEGAS NV	16302411245
O D SAHARA WEST L L C	P O BOX 19297 LAS VEGAS NV	16302411244
O D SAHARA WEST L L C	P O BOX 19297 LAS VEGAS NV	16302411243
O D SAHARA WEST L L C	P O BOX 19297 LAS VEGAS NV	16302411242
O D SAHARA WEST L L C	P O BOX 19297 LAS VEGAS NV	16302411207
O D SAHARA WEST L L C	P O BOX 19297 LAS VEGAS NV	16302411240
O D SAHARA WEST L L C	P O BOX 19297 LAS VEGAS NV	16302411268
O D SAHARA WEST L L C	P O BOX 19297 LAS VEGAS NV	16302411239
O D SAHARA WEST L L C	P O BOX 19297 LAS VEGAS NV	16302411238
O D SAHARA WEST L L C	P O BOX 19297 LAS VEGAS NV	16302411237
O D SAHARA WEST L L C	P O BOX 19297 LAS VEGAS NV	16302411236

**Report of All Selected Parcels****Case Number:** ROC-43006**Printed On:** Thu: September 8, 2011

<u>Owner</u>	<u>Address</u>	<u>Parcel Number</u>
OD SAHARA WEST L L C	P O BOX 19297 LAS VEGAS NV	16302411271
OD SAHARA WEST L L C	P O BOX 19297 LAS VEGAS NV	16302411235
OD SAHARA WEST L L C	P O BOX 19297 LAS VEGAS NV	16302411234
OD SAHARA WEST L L C	P O BOX 19297 LAS VEGAS NV	16302411233
OD SAHARA WEST L L C	P O BOX 19297 LAS VEGAS NV	16302411241
OD SAHARA WEST L L C	P O BOX 19297 LAS VEGAS NV	16302411252
OD SAHARA WEST L L C	P O BOX 19297 LAS VEGAS NV	16302411259
OD SAHARA WEST L L C	P O BOX 19297 LAS VEGAS NV	16302411260
OD SAHARA WEST L L C	P O BOX 19297 LAS VEGAS NV	16302411258
OD SAHARA WEST L L C	P O BOX 19297 LAS VEGAS NV	16302411257
OD SAHARA WEST L L C	P O BOX 19297 LAS VEGAS NV	16302411256
OD SAHARA WEST L L C	P O BOX 19297 LAS VEGAS NV	16302411255
OD SAHARA WEST L L C	P O BOX 19297 LAS VEGAS NV	16302411261
OD SAHARA WEST L L C	P O BOX 19297 LAS VEGAS NV	16302411254
OD SAHARA WEST L L C	P O BOX 19297 LAS VEGAS NV	16302411248
OD SAHARA WEST L L C	P O BOX 19297 LAS VEGAS NV	16302411262
OD SAHARA WEST L L C	P O BOX 19297 LAS VEGAS NV	16302411249
OD SAHARA WEST L L C	P O BOX 19297 LAS VEGAS NV	16302411263
OD SAHARA WEST L L C	P O BOX 19297 LAS VEGAS NV	16302411264
OD SAHARA WEST L L C	P O BOX 19297 LAS VEGAS NV	16302411265
OD SAHARA WEST L L C	P O BOX 19297 LAS VEGAS NV	16302411266
OD SAHARA WEST L L C	P O BOX 19297 LAS VEGAS NV	16302411251
OD SAHARA WEST L L C	P O BOX 19297 LAS VEGAS NV	16302411267
OD SAHARA WEST L L C	P O BOX 19297 LAS VEGAS NV	16302411250
OD SAHARA WEST L L C	P O BOX 19297 LAS VEGAS NV	16302411230
OD SAHARA WEST L L C	P O BOX 19297 LAS VEGAS NV	16302411253
OD SAHARA WEST L L C	P O BOX 19297 LAS VEGAS NV	16302411280
OD SAHARA WEST L L C	P O BOX 19297 LAS VEGAS NV	16302411232
OD SAHARA WEST L L C	P O BOX 19297 LAS VEGAS NV	16302411216
OD SAHARA WEST L L C	P O BOX 19297 LAS VEGAS NV	16302411215
OD SAHARA WEST L L C	P O BOX 19297 LAS VEGAS NV	16302411279
OD SAHARA WEST L L C	P O BOX 19297 LAS VEGAS NV	16302411214

**Report of All Selected Parcels****Case Number:** ROC-43006**Printed On:** Thu: September 8, 2011

<u>Owner</u>	<u>Address</u>	<u>Parcel Number</u>
OD SAHARA WEST L L C	P O BOX 19297 LAS VEGAS NV	16302411213
OD SAHARA WEST L L C	P O BOX 19297 LAS VEGAS NV	16302411212
OD SAHARA WEST L L C	P O BOX 19297 LAS VEGAS NV	16302411211
OD SAHARA WEST L L C	P O BOX 19297 LAS VEGAS NV	16302411278
OD SAHARA WEST L L C	P O BOX 19297 LAS VEGAS NV	16302411209
OD SAHARA WEST L L C	P O BOX 19297 LAS VEGAS NV	16302411277
OD SAHARA WEST L L C	P O BOX 19297 LAS VEGAS NV	16302411281
OD SAHARA WEST L L C	P O BOX 19297 LAS VEGAS NV	16302411225
OD SAHARA WEST L L C	P O BOX 19297 LAS VEGAS NV	16302411206
OD SAHARA WEST L L C	P O BOX 19297 LAS VEGAS NV	16302411205
OD SAHARA WEST L L C	P O BOX 19297 LAS VEGAS NV	16302411204
OD SAHARA WEST L L C	P O BOX 19297 LAS VEGAS NV	16302411282
OD SAHARA WEST L L C	P O BOX 19297 LAS VEGAS NV	16302411203
OD SAHARA WEST L L C	P O BOX 19297 LAS VEGAS NV	16302411202
OD SAHARA WEST L L C	P O BOX 19297 LAS VEGAS NV	16302411210
OD SAHARA WEST L L C	P O BOX 19297 LAS VEGAS NV	16302411222
OD SAHARA WEST L L C	P O BOX 19297 LAS VEGAS NV	16302411283
OD SAHARA WEST L L C	P O BOX 19297 LAS VEGAS NV	16302411229
OD SAHARA WEST L L C	P O BOX 19297 LAS VEGAS NV	16302411228
OD SAHARA WEST L L C	P O BOX 19297 LAS VEGAS NV	16302411227
OD SAHARA WEST L L C	P O BOX 19297 LAS VEGAS NV	16302411226
OD SAHARA WEST L L C	P O BOX 19297 LAS VEGAS NV	16302411032
OD SAHARA WEST L L C	P O BOX 19297 LAS VEGAS NV	16302411272
OD SAHARA WEST L L C	P O BOX 19297 LAS VEGAS NV	16302411044
OD SAHARA WEST L L C	P O BOX 19297 LAS VEGAS NV	16302411217
OD SAHARA WEST L L C	P O BOX 19297 LAS VEGAS NV	16302411223
OD SAHARA WEST L L C	P O BOX 19297 LAS VEGAS NV	16302411231
OD SAHARA WEST L L C	P O BOX 19297 LAS VEGAS NV	16302411221
OD SAHARA WEST L L C	P O BOX 19297 LAS VEGAS NV	16302411273
OD SAHARA WEST L L C	P O BOX 19297 LAS VEGAS NV	16302411220
OD SAHARA WEST L L C	P O BOX 19297 LAS VEGAS NV	16302411274
OD SAHARA WEST L L C	P O BOX 19297 LAS VEGAS NV	16302411219

**Report of All Selected Parcels**

**Case Number:** ROC-43006

**Printed On:** Thu: September 8, 2011

<u>Owner</u>	<u>Address</u>	<u>Parcel Number</u>
OD SAHARA WEST L L C	P O BOX 19297 LAS VEGAS NV	16302411275
OD SAHARA WEST L L C	P O BOX 19297 LAS VEGAS NV	16302411218
OD SAHARA WEST L L C	P O BOX 19297 LAS VEGAS NV	16302411276
OD SAHARA WEST L L C	P O BOX 19297 LAS VEGAS NV	16302411224
OD SAHARA WEST L L C	P O BOX 19297 LAS VEGAS NV	16302411131
OD SAHARA WEST L L C	P O BOX 19297 LAS VEGAS NV	16302411104
OD SAHARA WEST L L C	P O BOX 19297 LAS VEGAS NV	16302411124
OD SAHARA WEST L L C	P O BOX 19297 LAS VEGAS NV	16302411125
OD SAHARA WEST L L C	P O BOX 19297 LAS VEGAS NV	16302411126
OD SAHARA WEST L L C	P O BOX 19297 LAS VEGAS NV	16302411127
OD SAHARA WEST L L C	P O BOX 19297 LAS VEGAS NV	16302411128
OD SAHARA WEST L L C	P O BOX 19297 LAS VEGAS NV	16302411122
OD SAHARA WEST L L C	P O BOX 19297 LAS VEGAS NV	16302411130
OD SAHARA WEST L L C	P O BOX 19297 LAS VEGAS NV	16302411163
OD SAHARA WEST L L C	P O BOX 19297 LAS VEGAS NV	16302411132
OD SAHARA WEST L L C	P O BOX 19297 LAS VEGAS NV	16302411173
OD SAHARA WEST L L C	P O BOX 19297 LAS VEGAS NV	16302411172
OD SAHARA WEST L L C	P O BOX 19297 LAS VEGAS NV	16302411171
OD SAHARA WEST L L C	P O BOX 19297 LAS VEGAS NV	16302411292
OD SAHARA WEST L L C	P O BOX 19297 LAS VEGAS NV	16302411170
OD SAHARA WEST L L C	P O BOX 19297 LAS VEGAS NV	16302411169
OD SAHARA WEST L L C	P O BOX 19297 LAS VEGAS NV	16302411129
OD SAHARA WEST L L C	P O BOX 19297 LAS VEGAS NV	16302411113
OD SAHARA WEST L L C	P O BOX 19297 LAS VEGAS NV	16302411105
OD SAHARA WEST L L C	P O BOX 19297 LAS VEGAS NV	16302411106
OD SAHARA WEST L L C	P O BOX 19297 LAS VEGAS NV	16302411107
OD SAHARA WEST L L C	P O BOX 19297 LAS VEGAS NV	16302411108
OD SAHARA WEST L L C	P O BOX 19297 LAS VEGAS NV	16302411109
OD SAHARA WEST L L C	P O BOX 19297 LAS VEGAS NV	16302411110
OD SAHARA WEST L L C	P O BOX 19297 LAS VEGAS NV	16302411123
OD SAHARA WEST L L C	P O BOX 19297 LAS VEGAS NV	16302411112
OD SAHARA WEST L L C	P O BOX 19297 LAS VEGAS NV	16302411166

**Report of All Selected Parcels****Case Number:** ROC-43006**Printed On:** Thu: September 8, 2011

<u>Owner</u>	<u>Address</u>	<u>Parcel Number</u>
OD SAHARA WEST L L C	P O BOX 19297 LAS VEGAS NV	16302411114
OD SAHARA WEST L L C	P O BOX 19297 LAS VEGAS NV	16302411115
OD SAHARA WEST L L C	P O BOX 19297 LAS VEGAS NV	16302411116
OD SAHARA WEST L L C	P O BOX 19297 LAS VEGAS NV	16302411117
OD SAHARA WEST L L C	P O BOX 19297 LAS VEGAS NV	16302411118
OD SAHARA WEST L L C	P O BOX 19297 LAS VEGAS NV	16302411119
OD SAHARA WEST L L C	P O BOX 19297 LAS VEGAS NV	16302411120
OD SAHARA WEST L L C	P O BOX 19297 LAS VEGAS NV	16302411111
OD SAHARA WEST L L C	P O BOX 19297 LAS VEGAS NV	16302411152
OD SAHARA WEST L L C	P O BOX 19297 LAS VEGAS NV	16302411158
OD SAHARA WEST L L C	P O BOX 19297 LAS VEGAS NV	16302411157
OD SAHARA WEST L L C	P O BOX 19297 LAS VEGAS NV	16302411143
OD SAHARA WEST L L C	P O BOX 19297 LAS VEGAS NV	16302411156
OD SAHARA WEST L L C	P O BOX 19297 LAS VEGAS NV	16302411155
OD SAHARA WEST L L C	P O BOX 19297 LAS VEGAS NV	16302411144
OD SAHARA WEST L L C	P O BOX 19297 LAS VEGAS NV	16302411168
OD SAHARA WEST L L C	P O BOX 19297 LAS VEGAS NV	16302411153
OD SAHARA WEST L L C	P O BOX 19297 LAS VEGAS NV	16302411141
OD SAHARA WEST L L C	P O BOX 19297 LAS VEGAS NV	16302411151
OD SAHARA WEST L L C	P O BOX 19297 LAS VEGAS NV	16302411150
OD SAHARA WEST L L C	P O BOX 19297 LAS VEGAS NV	16302411149
OD SAHARA WEST L L C	P O BOX 19297 LAS VEGAS NV	16302411148
OD SAHARA WEST L L C	P O BOX 19297 LAS VEGAS NV	16302411145
OD SAHARA WEST L L C	P O BOX 19297 LAS VEGAS NV	16302411147
OD SAHARA WEST L L C	P O BOX 19297 LAS VEGAS NV	16302411146
OD SAHARA WEST L L C	P O BOX 19297 LAS VEGAS NV	16302411154
OD SAHARA WEST L L C	P O BOX 19297 LAS VEGAS NV	16302411136
OD SAHARA WEST L L C	P O BOX 19297 LAS VEGAS NV	16302411121
OD SAHARA WEST L L C	P O BOX 19297 LAS VEGAS NV	16302411165
OD SAHARA WEST L L C	P O BOX 19297 LAS VEGAS NV	16302411164
OD SAHARA WEST L L C	P O BOX 19297 LAS VEGAS NV	16302411133
OD SAHARA WEST L L C	P O BOX 19297 LAS VEGAS NV	16302411045

**Report of All Selected Parcels****Case Number:** ROC-43006**Printed On:** Thu: September 8, 2011

<u>Owner</u>	<u>Address</u>	<u>Parcel Number</u>
OD SAHARA WEST L L C	P O BOX 19297 LAS VEGAS NV	16302411030
OD SAHARA WEST L L C	P O BOX 19297 LAS VEGAS NV	16302411162
OD SAHARA WEST L L C	P O BOX 19297 LAS VEGAS NV	16302411159
OD SAHARA WEST L L C	P O BOX 19297 LAS VEGAS NV	16302411135
OD SAHARA WEST L L C	P O BOX 19297 LAS VEGAS NV	16302411142
OD SAHARA WEST L L C	P O BOX 19297 LAS VEGAS NV	16302411137
OD SAHARA WEST L L C	P O BOX 19297 LAS VEGAS NV	16302411138
OD SAHARA WEST L L C	P O BOX 19297 LAS VEGAS NV	16302411161
OD SAHARA WEST L L C	P O BOX 19297 LAS VEGAS NV	16302411139
OD SAHARA WEST L L C	P O BOX 19297 LAS VEGAS NV	16302411140
OD SAHARA WEST L L C	P O BOX 19297 LAS VEGAS NV	16302411160
OD SAHARA WEST L L C	P O BOX 19297 LAS VEGAS NV	16302411167
OD SAHARA WEST L L C	P O BOX 19297 LAS VEGAS NV	16302411134
OD SAHARA WEST L L C	P O BOX 19297 LAS VEGAS NV	16302411083
OD SAHARA WEST L L C	P O BOX 19297 LAS VEGAS NV	16302411088
OD SAHARA WEST L L C	P O BOX 19297 LAS VEGAS NV	16302411076
OD SAHARA WEST L L C	P O BOX 19297 LAS VEGAS NV	16302411077
OD SAHARA WEST L L C	P O BOX 19297 LAS VEGAS NV	16302411078
OD SAHARA WEST L L C	P O BOX 19297 LAS VEGAS NV	16302411103
OD SAHARA WEST L L C	P O BOX 19297 LAS VEGAS NV	16302411080
OD SAHARA WEST L L C	P O BOX 19297 LAS VEGAS NV	16302411075
OD SAHARA WEST L L C	P O BOX 19297 LAS VEGAS NV	16302411082
OD SAHARA WEST L L C	P O BOX 19297 LAS VEGAS NV	16302411074
OD SAHARA WEST L L C	P O BOX 19297 LAS VEGAS NV	16302411084
OD SAHARA WEST L L C	P O BOX 19297 LAS VEGAS NV	16302411085
OD SAHARA WEST L L C	P O BOX 19297 LAS VEGAS NV	16302411057
OD SAHARA WEST L L C	P O BOX 19297 LAS VEGAS NV	16302411079
OD SAHARA WEST L L C	P O BOX 19297 LAS VEGAS NV	16302411056
OD SAHARA WEST L L C	P O BOX 19297 LAS VEGAS NV	16302411087
OD SAHARA WEST L L C	P O BOX 19297 LAS VEGAS NV	16302411081
OD SAHARA WEST L L C	P O BOX 19297 LAS VEGAS NV	16302411068
OD SAHARA WEST L L C	P O BOX 19297 LAS VEGAS NV	16302411061

**Report of All Selected Parcels**

**Case Number:** ROC-43006

**Printed On:** Thu: September 8, 2011

<u>Owner</u>	<u>Address</u>	<u>Parcel Number</u>
OD SAHARA WEST L L C	P O BOX 19297 LAS VEGAS NV	16302411062
OD SAHARA WEST L L C	P O BOX 19297 LAS VEGAS NV	16302411063
OD SAHARA WEST L L C	P O BOX 19297 LAS VEGAS NV	16302411064
OD SAHARA WEST L L C	P O BOX 19297 LAS VEGAS NV	16302411065
OD SAHARA WEST L L C	P O BOX 19297 LAS VEGAS NV	16302411066
OD SAHARA WEST L L C	P O BOX 19297 LAS VEGAS NV	16302411058
OD SAHARA WEST L L C	P O BOX 19297 LAS VEGAS NV	16302411067
OD SAHARA WEST L L C	P O BOX 19297 LAS VEGAS NV	16302411086
OD SAHARA WEST L L C	P O BOX 19297 LAS VEGAS NV	16302411059
OD SAHARA WEST L L C	P O BOX 19297 LAS VEGAS NV	16302411069
OD SAHARA WEST L L C	P O BOX 19297 LAS VEGAS NV	16302411070
OD SAHARA WEST L L C	P O BOX 19297 LAS VEGAS NV	16302411071
OD SAHARA WEST L L C	P O BOX 19297 LAS VEGAS NV	16302411072
OD SAHARA WEST L L C	P O BOX 19297 LAS VEGAS NV	16302411073
OD SAHARA WEST L L C	P O BOX 19297 LAS VEGAS NV	16302411060
OD SAHARA WEST L L C	P O BOX 19297 LAS VEGAS NV	16302411099
OD SAHARA WEST L L C	P O BOX 19297 LAS VEGAS NV	16302411096
OD SAHARA WEST L L C	P O BOX 19297 LAS VEGAS NV	16302411094
OD SAHARA WEST L L C	P O BOX 19297 LAS VEGAS NV	16302411052
OD SAHARA WEST L L C	P O BOX 19297 LAS VEGAS NV	16302411097
OD SAHARA WEST L L C	P O BOX 19297 LAS VEGAS NV	16302411098
OD SAHARA WEST L L C	P O BOX 19297 LAS VEGAS NV	16302411051
OD SAHARA WEST L L C	P O BOX 19297 LAS VEGAS NV	16302411053
OD SAHARA WEST L L C	P O BOX 19297 LAS VEGAS NV	16302411050
OD SAHARA WEST L L C	P O BOX 19297 LAS VEGAS NV	16302411049
OD SAHARA WEST L L C	P O BOX 19297 LAS VEGAS NV	16302411089
OD SAHARA WEST L L C	P O BOX 19297 LAS VEGAS NV	16302411093
OD SAHARA WEST L L C	P O BOX 19297 LAS VEGAS NV	16302411095
OD SAHARA WEST L L C	P O BOX 19297 LAS VEGAS NV	16302411100
OD SAHARA WEST L L C	P O BOX 19297 LAS VEGAS NV	16302411092
OD SAHARA WEST L L C	P O BOX 19297 LAS VEGAS NV	16302411101
OD SAHARA WEST L L C	P O BOX 19297 LAS VEGAS NV	16302411048

**Report of All Selected Parcels****Case Number:** ROC-43006**Printed On:** Thu: September 8, 2011

<u>Owner</u>	<u>Address</u>	<u>Parcel Number</u>
O D SAHARA WEST L L C	P O BOX 19297 LAS VEGAS NV	16302411047
O D SAHARA WEST L L C	P O BOX 19297 LAS VEGAS NV	16302411091
O D SAHARA WEST L L C	P O BOX 19297 LAS VEGAS NV	16302411046
O D SAHARA WEST L L C	P O BOX 19297 LAS VEGAS NV	16302411102
O D SAHARA WEST L L C	P O BOX 19297 LAS VEGAS NV	16302411055
O D SAHARA WEST L L C	P O BOX 19297 LAS VEGAS NV	16302411090
O D SAHARA WEST L L C	P O BOX 19297 LAS VEGAS NV	16302411054
O'BANNON PLAZA L L C	%M ZACHA 4847 BONVUE AVE LOS ANGELES CA 90027-1104	16303804009
OCUMPAUGH ETHAN	6512 PEPPERMILL DR LAS VEGAS NV 89146-2917	16302413018
OELRICH FAMILY TRUST	OELRICH ROBERT V & BERYL S TRS 6004 STANTON SUMMIT DR NO LAS VEGAS NV 89081-6782	16302410004
OMNINET SAHARA L L C	%GATSKI COMMERCIAL REAL ESTATE 4755 DEAN MARTIN DR LAS VEGAS NV 89103-4141	16302415015
ORLOS PROPERTIES INC	GATELY MICHAEL O & NANCY K 20531 SUMMERTOWN ST WALNUT CA 91789-3628	16311201004
PACIFIC PENINSULA L L C	151 KALMUS DR #A-102 COSTA MESA CA 92626-5900	16311102001
PARHAM ROBERT & EDNA	6370 TEMPTING CHOICE AVE LAS VEGAS NV 89131-5915	16302413021
PARROTT JEAN	4334 MOUNTAIN VIEW BLVD LAS VEGAS NV 89102-3819	16302412015
PATTERSON RYKY	6501 PEPPERMILL DR LAS VEGAS NV 89146-2918	16302414029
PELZ FAMILY TRUST	15513 E CACTUS DR FOUNTAIN HILLS AZ	16302213064
PERREAULT FAMILY TRUST	PERREAULT WILLIAM & PATRICIA TRS 5018 PALMYRA AVE LAS VEGAS NV 89146-7026	16303803001
PETERSON GLENNIS RAE	6505 PEPPERMILL DR LAS VEGAS NV 89146-2918	16302413025
PHILIP BRENT M & SANDRA K	6381 APACHE RD WESTMINSTER CA 92683-2068	16303702009
PLOURD TERRENCE WEBSTER & ANDREA	6509 PEPPERMILL DR LAS VEGAS NV 89146-2918	16302413024
POMEROY CHARLES E	1621 SANDECKER CT #202 LAS VEGAS NV	16302213057
POPE FAMILY TRUST	POPE CHRIS B & ELIZABETH A TRS 6600 VICUNA DR LAS VEGAS NV 89146-2908	16302412022
QIN SHUHUA	1125 S CALIFORNIA ST SAN GABRIEL CA 91778-3001	16303712002
R B D - S H L L C	%MDL GROUP 3065 S JONES BLVD #201 LAS VEGAS NV 89146-6780	16302313013
R C D L L C	936 VISCANIO PL LAS VEGAS NV 89138-7577	16303704007
RADOMSKI CARL A	9360 W VERDE WY LAS VEGAS NV 89149-2507	16311105001
RAIANO ANNETTE KEEVER 1993 TRUST	RAIANO ANNETTE KEEVER TRS 6400 PEPPERMILL DR LAS VEGAS NV 89146-0801	16302414022
RAINBOW & OAKEY L L C	%LEES DISCOUNT LIQUOR 4427 E SUNSET RD HENDERSON NV 89014-2265	16302212004
RAINBOW AUTO CENTER L L C	P O BOX 35782 LAS VEGAS NV 89133-5782	16303704008
RAINBOW SAHARA CENTER #2	2615 PACIFIC COAST HWY #328 HERMOSA BEACH CA 90254-2227	16302415001
RAINBOW SAHARA CENTER #2	2615 PACIFIC COAST HWY #328 HERMOSA BEACH CA 90254-2227	16302415003

**Report of All Selected Parcels****Case Number:** ROC-43006**Printed On:** Thu: September 8, 2011

<u>Owner</u>	<u>Address</u>	<u>Parcel Number</u>
RAINBOW-OAKEY PLAZA L L C	P O BOX 50170 LIGHTHOUSE POINT FL 33074-0170	16303603011
RAINES VICTORIA	2654 REDWOOD ST LAS VEGAS NV 89146-5109	16311105014
RAMSEY MICHAEL C	2661 BARBARADALE CIR LAS VEGAS NV 89146-5160	16311111006
REALTY INCOME CORPORATION	%PORTFOLIO MGT P O BOX 460089 ESCONDIDO CA 92046-0069	16302301005
REIMER HOWARD L 1997 TRUST	LOTT PATRICIA ANN TRS 30 PHEASANT RIDGE DR HENDERSON NV 89014-2116	16311104003
RENT 2 OWN	S M P I R O L L C 8550 W CHARLESTON BLVD #102-392 LAS VEGAS NV 89117-9210	16302310003
RICHEY JAMES A & DIANA K	2625 BARBARADALE CIR LAS VEGAS NV 89146-5160	16311111004
ROBINS ALBERT G	2261 ROSANNA ST LAS VEGAS NV 89117-2823	16303803015
ROBINSON JUSTINE L	1620 DAVILLA ST #201 LAS VEGAS NV	16302213050
ROBISON MICHAEL S	2300 ROSANNA ST LAS VEGAS NV 89117-2809	16303804007
RODENBERG KIMBERLY L & RICHARD L	P O BOX 1205 TEMECULA CA 92593-1205	16303803013
ROMANCAL L L C	%R & C CALCZYNSKI 10109 LOS PADRES PL LAS VEGAS NV 89134-6913	16311103002
ROSE KENNETH A & CAROLYN J	2645 ROSANNA ST LAS VEGAS NV 89117-3043	16310507007
RUDEMAN DANIEL MARC	P O BOX 29245 LAS VEGAS NV 89126-3245	16302414031
S A R A	3055 SOFT HORIZON WY LAS VEGAS NV 89135-1741	16311101004
S A R A	3055 SOFT HORIZON WY LAS VEGAS NV 89135-1741	16311101003
S M K FAMILY TRUST	KERR STEPHEN A & MERNA S TRS 6713 OBANNON DR LAS VEGAS NV 89146-2905	16302410006
S R P PLAZA L P	3275 S JONES BLVD #105 LAS VEGAS NV 89146-6768	16310510001
S R P PLAZA L P	3275 S JONES BLVD #105 LAS VEGAS NV 89146-6768	16310510003
SAGEL WILLIAM R & ANNE C 2006 TR	SAGEL WILLIAM R JR & ANNE C TRS 6823 SIERRA TRL LAS VEGAS NV 89146-2906	16302312005
SAHARA & RAINBOW INVEST L L C	2560 MONTESSOURI ST #208 LAS VEGAS NV 89117-3064	16310514001
SAHARA-RAINBOW L L C	%A ELKOUBY 613 N APLINE DR BEVERLY HILLS CA 90210-3303	16311101006
SAMM RAINBOW L L C	2300 W SAHARA AVE #1110 LAS VEGAS NV 89102-4354	16302415016
SAMM RAINBOW L L C	2300 W SAHARA AVE #1110 LAS VEGAS NV 89102-4354	16302415002
SANDERS ROBERT M	6404 PEPPERMILL DR LAS VEGAS NV 89146-0801	16302414023
SANTA MARGARITA L L C	6572 ROUNDSTONE BOG AVE LAS VEGAS NV	16302213029
SASSE JON J & LISA	6809 ADOBE CT LAS VEGAS NV 89146-2920	16302311001
SAUCIER THERESE LIVING TRUST	%T SAUCIER 6980 O'BANNON DR LAS VEGAS NV 89117-2122	16303714004
SAUR TRUST	SAUR SHERILYN L TRS 2251 ROSANNA ST LAS VEGAS NV 89117-2823	16303803016
SAYCICH & SAYCICH	2540 S TORREY PINES DR LAS VEGAS NV 89146-5137	16311501012
SCHWARZBLATT & SIREBRENK	6755 W SAHARA AVE LAS VEGAS NV 89146-2965	16311101012
SCHWINDENHAMMER MICHAEL & LINDA	1971 DEL FONT CT LAS VEGAS NV 89117-2154	16303712001

**Report of All Selected Parcels****Case Number:** ROC-43006**Printed On:** Thu: September 8, 2011

<u>Owner</u>	<u>Address</u>	<u>Parcel Number</u>
SEIPEL CHARLES R & PHYLLIS L	2652 BARBARADALE CIR LAS VEGAS NV 89146-5160	16311111009
SERA RAYMOND M	LEONG LINDA S L 6838 O BANNON DR LAS VEGAS NV 89102-2946	16302312009
SERRANO JULIO J	ZURITA MARIELA 8908 TOMNITZ AVE LAS VEGAS NV 89178-7229	16311110012
SHARPE RONALD	3150 ARVILLE ST #52 LAS VEGAS NV	16302213023
SHAW DANNY E & KAREN L	1981 REDWOOD ST LAS VEGAS NV 89146-2912	16302310023
SHERIDAN ROBERT A TRUST	SHERIDAN ROBERT ALAN TRS 6832 ELDORA AVE LAS VEGAS NV 89146-5126	16311110011
SICA ANN	P O BOX 74 CORNWALL NY 12518-0074	16302311003
SICA GLORIA TURST	SICA MICHAEL F & GLORIA TRS 261 ROUND HILL RD GREENWICH CT 06831-3301	16302311002
SIGMARK REVOCABLE TRUST	VARELA IRMGARD TRS 1930 DEL FONT CT LAS VEGAS NV 89117-2153	16303712008
SILVER MEADOW PROPERTIES L L C	1580 S JONES BLVD LAS VEGAS NV 89146-1237	16311103018
SLATSKY WILLIAM	7841 MARKSVILLE ST LAS VEGAS NV 89149-1933	16303702017
SMALL TRAVIS G	2205 AUTUMN LULL DR LAS VEGAS NV 89146-2986	16302412006
SMITH LAURA L	ARMSTRONG DAVID B II 6798 TRINITY CT LAS VEGAS NV 89146-5167	16311110021
SNIDER ROBERT D & JUDITH L	6845 ELDORA AVE LAS VEGAS NV 89146-5125	16311210001
SNYDER BRIAN K & CINDY M	1701 SANDECKER CT #201 LAS VEGAS NV	16302213074
SNYDER TRUST ENTERPRISES	1890 BROADWAY #505 SAN FRANCISCO CA 94109-2217	16310604004
SOLIMAN AVI	LANDISH SHEYNA L 2620 SORREL ST LAS VEGAS NV 89146-5131	16311106002
SOMMER DONALD E	COSTA CATHARINA F 6530 LAREDO ST LAS VEGAS NV 89146-5114	16311103010
SOMMERFIELD WILLIAM L	6650 ELDORA AVE LAS VEGAS NV 89146-5122	16311105011
SONEPCO FEDERAL CREDIT UNION	6475 W SAHARA AVE LAS VEGAS NV 89146-3036	16311501010
SORENSEN CHAD B & TAMMY LIV TR	651 SWANTON AVE CASPER WY	16302213081
SOUDAH FADI & MOUNA	260 36 AVE SAN MATEO CA 94403-4202	16311105002
SPENCER EVERETT & VELMA TRUST	SPENCER EVERETT & VELMA W CO-TRS 6839 OBANNON DR LAS VEGAS NV 89146-2947	16302401004
SPENCER LYLE A REVOCABLE FAM TR	P O BOX 93685 LAS VEGAS NV	16302213070
STADDON JANET C	1610 DAVILLA ST #202 LAS VEGAS NV	16302213039
STAGGS DONNA MAY REV TR 2006	STAGGS DONNA MAY TRS 6401 PEPPERMILL DR LAS VEGAS NV 89146-0802	16302414035
STEARNS FAMILY TRUST	929 VILLA GRANDE WY BOULDER CITY NV	16302213066
STERLING THOMAS C	6811 SAN RICARDO AVE #104 LAS VEGAS NV	16302213022
STOCKER ROBERT R SR & JOAN J	1907 REDWOOD ST LAS VEGAS NV 89146-2912	16302310025
STUHFF MICHAEL V & SANDRA R	1915 ROSANNA ST LAS VEGAS NV 89117-2141	16303702019
SU STEVEN	HUANG LIRU 2133 MONTEVERDE DR CHINO HILLS CA 91709-4447	16303804003
SUBJECT EDWARD	2209 AUTUMN LULL DR LAS VEGAS NV 89146-2986	16302412007

**Report of All Selected Parcels****Case Number:** ROC-43006**Printed On:** Thu: September 8, 2011

<u>Owner</u>	<u>Address</u>	<u>Parcel Number</u>
SUITER FAMILY TRUST	SUITER ROY F & MARY M TRS 6608 VICUNA DR LAS VEGAS NV 89146-2908	16302412024
SUNNY ROCK L L C	6970 OBANNON BLDG 2 LAS VEGAS NV 89117-2122	16303714003
SUNSET MARKS PLAZA L L C	1401 S LAS VEGAS BLVD LAS VEGAS NV 89104-1327	16310503002
SWALLOW DAVID C & KRISTINA L	P O BOX 27808 LAS VEGAS NV 89126-1808	16302310038
SWARTZ CINDY T	1620 SANDECKER CT #204 LAS VEGAS NV	16302213065
SWEETMAN CAROL B	1610 SANDECKER CT #202 LAS VEGAS NV	16302213045
T S K IRREVOCABLE SPENDTHRIFT TR	KAITANI SAKIKO TRS 10039 FLOKTON AVE LAS VEGAS NV 89148-4573	16302312004
TANNENBAUM NATHAN & LINDA S	6609 VICUNA DR LAS VEGAS NV 89146-2910	16302412019
TANTLINGER DANIEL R & SUKKI	6509 VICUNA DR LAS VEGAS NV 89146-2925	16302413014
TAPIA RAUL A	889 S RAINBOW #529 LAS VEGAS NV 89145-6238	16302310005
TAXPAYER	LAS VEGAS NV 89000	16311106004
TAZAWA HIROKO	17972 CALLE SILVOSA ROWLAND HEIGHTS CA	16302213076
TEMPLE JEFFREY M	1621 SANDECKER CT #204 LAS VEGAS NV	16302213059
TEVEGAS INVESTMENT COMPANY	%H LIIBBE 2961 INDUSTRIAL RD #434 LAS VEGAS NV 89109-1134	16302812001
THOMAS JOHN R & LISA A	6847 TRINITY CT LAS VEGAS NV 89146-5172	16311110007
THOMASON RONALD M	6820 SAN RICARDO #104 LAS VEGAS NV	16302213016
THOMPSON MARTIN G	2081 ROSANNA ST LAS VEGAS NV 89117-2135	16303702011
THORMODSGARD JAMES N FAMILY TR	THORMODSGARD JAMES & RAQUEL TRS P O BOX 28609 LAS VEGAS NV 89126-2609	16311106005
TORRES REVOCABLE LIVING TRUST	%F & H TORRES 2620 ROSANNA ST LAS VEGAS NV 89117-3050	16310511002
TORRES REVOCABLE LIVING TRUST	TORRES FRANCISCO & HERLINDA TRS 2600 ROSANNA ST LAS VEGAS NV 89117-3050	16310511001
TRAN VU H	6505 VICUNA DR LAS VEGAS NV 89146-2925	16302413015
TRANS-AERO LAND & DEVELOPMENT CO	4560 S DECATUR BLVD #202 LAS VEGAS NV 89103-5252	16303703004
TRI-LIN HOLDINGS L L C	1801 S RAINBOW BLVD #270 LAS VEGAS NV 89146-0007	16303703007
TRUCHARD SEAN M & JANET L	2271 ROSANNA ST LAS VEGAS NV 89117-2823	16303803017
TRUMAN JUNE & KENNETH J	6413 OBANNON DR LAS VEGAS NV 89146-2928	16302414004
TRUSTEE CLARK COUNTY TREASURER	%D C L CORPORATION 1881 S RAINBOW BLVD LAS VEGAS NV 89146-0849	16303703003
TURNER MICHAEL	2545 S TORREY PINES LAS VEGAS NV 89146-4007	16311103011
UNDERHILL DARLYNE A	3954 DELOS DR LAS VEGAS NV	16302213038
VADEN TYLER	6829 LAREDO ST LAS VEGAS NV 89146-5119	16311110002
VALLADARES JENNIFER C	5746 CRSCENT LANDING ST LAS VEGAS NV 89113	16302310013
VALLE FRANK L & SHERRY L	6798 ELDORA AVE LAS VEGAS NV 89146-5124	16311110015
VANDEBUR WILLIAM L & KAREN J	1853 REDWOOD ST LAS VEGAS NV 89146-2912	16302310027

**Report of All Selected Parcels****Case Number:** ROC-43006**Printed On:** Thu: September 8, 2011

<u>Owner</u>	<u>Address</u>	<u>Parcel Number</u>
VARGO MICHAEL E	LI DI CHEN 6784 ELDORA AVE LAS VEGAS NV 89146-5124	16311110014
VAUSE FAMILY TRUST	VAUSE GARY & LINDA M TRS 3020 PLAZA DE MONTE LAS VEGAS NV 89102-4046	16303703001
VENTURA RICHARD & LAURA S	6353 PEPPERMILL DR LAS VEGAS NV 89146-3019	16302812030
VILLALOBOS ELFRIEDE	1610 DAVILLA ST #101 LAS VEGAS NV	16302213037
VITUCCI ANNETTE C REV LIV TR	104-A EAST SUTTON PL WAUKESHA WI	16302213051
WAGNER CHRIS B & CINDY S	6714 O'BANNON DR LAS VEGAS NV 89146-2927	16302310034
WAINER PETER R	1600 DAVILLA ST #202 LAS VEGAS NV	16302213033
WALKER RONALD E & KATHERINE L	6783 W TRINITY CT LAS VEGAS NV 89146-5171	16311110017
WALSH EVANGELINA	NISHIHAMA HEDEMI 6412 VICUNA DR LAS VEGAS NV 89146-2996	16302414011
WALTER PATRICIA L	6405 PEPPERMILL DR LAS VEGAS NV 89146-0802	16302414034
WANG MURRAY X	6609 W PEPPERMILL DR LAS VEGAS NV 89146-2915	16302412012
WANG WILSON W & MYRNA S	6609 PEPPERMILL DR LAS VEGAS NV 89146-2915	16302412011
WAROWAY ROBERT M	3471 SEGO GLEN CIR LAS VEGAS NV	16302213080
WARREN RANDY	6810 ADOBE CT LAS VEGAS NV 89146-2920	16302310008
WEBB GARY W & SHARON A FAMILY TR	WEBB GARY W & SHARON A TRS 1990 CASA VISTA DR LAS VEGAS NV 89146-2984	16302310019
WEGENER INGEBORG	6147 VICUNA DR LAS VEGAS NV 89146	16302414017
WEGNER FAMILY TRUST	WEGNER JUDY LYNN & BURKE O TRS 6501 O BANNON DR LAS VEGAS NV 89102-0854	16302414001
WERTH RONALD E & ANITA F	6715 SIERRA TRL LAS VEGAS NV 89146-2907	16302310033
WEST SAHARA ASSOCIATES	P O BOX 81441 LAS VEGAS NV 89180-1441	16302816001
WHETTON ALAN	BENIYAMA KAE 6829 ELDORA AVE LAS VEGAS NV 89146-5125	16311210002
WICHINSKY CLAUDIA	1970 DEL FONT CT LAS VEGAS NV 89117-2153	16303712009
WILLIAMS JOHN O	2101 AUTUMN LULL DR LAS VEGAS NV 89146-2930	16302412001
WILLIAMS LIVING TRUST	WILLIAMS DONALD R & FAYE K TRS 6991 EL PARQUE AVE LAS VEGAS NV 89117-2107	16303704001
WILLIAMS SHELBY	2627 S TORREY PINES DR LAS VEGAS NV 89146-5138	16311106014
WILSON & COMPANY BUILDING L L C	2688 S RAINBOW BLVD #A LAS VEGAS NV 89146-0063	16311104004
WINTERCORN TED W	7810 RAVENHOLLOW LN LAS VEGAS NV	16302213073
WISER FAMILY TRUST	WISER ELAINE R TRS 2624 REDWOOD ST LAS VEGAS NV 89146-5109	16311105016
WITTIE FRANK W & JEAN M	1800 DEL FONT CT LAS VEGAS NV 89117-2100	16303712005
WONG SIU HING	6790 W OAKY BLVD LAS VEGAS NV 89146-2914	16302202002
WONG STEPHANIE	6501 VICUNA DR LAS VEGAS NV 89146-2925	16302414015
WORTHEN FAMILY TRUST	WORTHEN JAMES L & LOA RAE TRS 6765 W ELDORA AVE LAS VEGAS NV 89146-5123	16311210022
WUAGNEUX EDWARD & FELICIDAD L	6500 PEPPERMILL DR LAS VEGAS NV 89146-2917	16302414028

**Report of All Selected Parcels**

**Case Number:** ROC-43006

**Printed On:** Thu: September 8, 2011

<u>Owner</u>	<u>Address</u>	<u>Parcel Number</u>
YOSEF AURORA SHEIK	6545 LAREDO ST LAS VEGAS NV 89146-5127	16311106015
YOUNG DAVID G & TARA L	1935 REDWOOD ST LAS VEGAS NV 89146-2912	16302310024
ZABROSKY JOHN & LOIS	6782 TRINITY CT LAS VEGAS NV 89146-5167	16311110020
ZHU CATHY	WANG SHILING 7271 MOUNTAIN MOSS DR LAS VEGAS NV 89147-3812	16302401003
ZHU XIA	2307 FALLEN DR ROWLAND HEIGHTS CA	16302213077
ZORA THOMAS R	6811 ELDORA AVE LAS VEGAS NV 89146-5125	16311210003