



Legal Notices Transmittal and Scanning Separator Sheet

Legal Notice Type: Legal Mailings

Date of Transfer to ERM: 8/29/2011

Page Count: 44

Meeting Date: 9/7/2011

Meeting Type: City Council <=>

Case Number(s): ROC-42637 <=>

Subject of Affidavit: New Albertson's, Inc. - 8410 Farm Road <=>

Record Series: Legal Notices

LRDA Number: 2007-1717

Retention: Permanent

File By: Meeting Date



Prepared By: gportillo

Scanned By:

QC By:

SCANNED
SCANNED
JUN 29 2011

AUG 29 2011

Application Information

ROC-42637 - REVIEW OF CONDITION - PUBLIC HEARING
- APPLICANT/OWNER: NEW ALBERTSON'S, INC. - For possible action on a request for a Review of Condition of a previously approved Special Use Permit (U-0027-00) TO DELETE CONDITION #2 THAT STATES, "THE SALE OF INDIVIDUAL CONTAINERS OF ANY SIZE OF BEER, WINE COOLERS OR SCREW CAP WINE IS PROHIBITED" at 8410 Farm Road (APN 125-17-610-014), TC (Town Center) Zone, Ward 6 (Ross).

Application Location

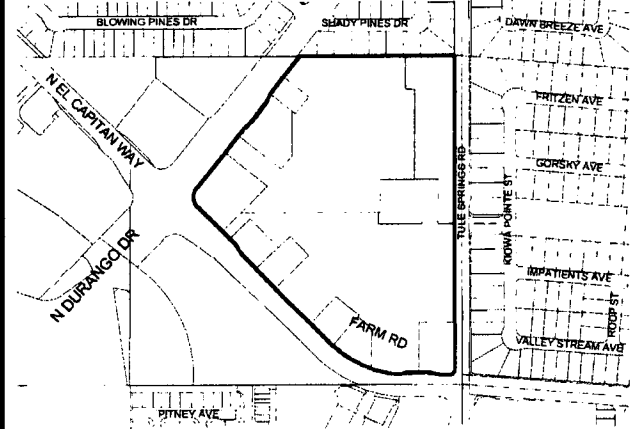

The proposed project may not pertain to the entire highlighted project site.

Public Hearing Information

Meeting: City Council
Date: *September 7, 2011*
Time: 1:00 P.M.
Location: City Council Chambers
400 Stewart Avenue
Las Vegas, Nevada

Any and all interested persons may appear and be heard at said meeting, or may, prior thereto, file written objections thereto or approvals thereof with the City Clerk, 1st Floor, City Hall, 400 Stewart Avenue, Las Vegas, Nevada 89101. For further information, please call 702-229-6301 (TDD 702-386-9108), <http://www.lasvegasnevada.gov>.

City of Las Vegas
Office Of The City Clerk
400 Stewart Avenue
Las Vegas, Nevada 89101

Return Service Requested
Official Notice of Public Hearing

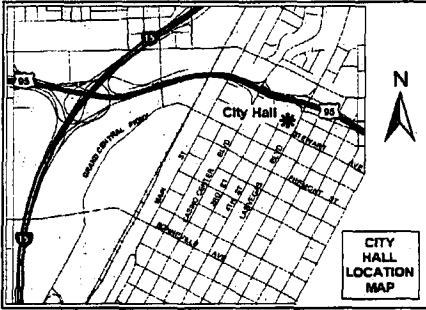

If you wish to file your protest or support on this request, check the appropriate box below and return this card in an envelope with postage to the City Clerk at the address listed above or fax this side of this card to (702) 382-4803. If you would like to contact your Council Representative, please call (702) 229-6405.

I SUPPORT
this Request

I OPPOSE
this Request

Please use available blank space on card for your comments.

ROC-42637

City Council Meeting of 09/07/2011

CC

PIL 1331
1066

Report of All Selected Parcels

Case Number: ROC-42637

Printed On: Wed: July 27, 2011

<u>Owner</u>	<u>Address</u>	<u>Parcel Number</u>
386 LIMITED PARTNERSHIP	%J KWEI 4533 PUGET DR VANCOUVER B C CANADA V6L 2V9	12517719000
69 NV PROPERTIES L L C	204 PLAYA DELLA ROSITA #6 WASHINGTON UT 84780-1474	12516319016
7785 NORTH DURANGO L L C	314 GRAND ST NEW YORK NY 10002-4502	12516117024
ABBATTE WILLIAM & PAMELA	7801 BRIGHT HEIGHTS ST LAS VEGAS NV 89131-4611	12517611003
ABBOTT FAMILY TRUST	ABBOTT CHARLES R & CONSTANCE TRS 8224 IMPATIENTS AVE LAS VEGAS NV 89131-4634	12516113002
ABRAM ADRIAN & ERICA	8600 HIDDEN PINES AVE LAS VEGAS NV 89143-1368	12516212037
ABREU ROVIRIO	8532 SHADY PINES DR LAS VEGAS NV 89143-4451	12517519012
ABULENCIA CARA	1316 RANGETON DR WALNUT CA 91789-3823	12517520010
ACOCA PERLA & SAMY LIVING TRUST	1316 RANGETON DR WALNUT CA 91789-3823	12516115056
ACOSTA JACOB & AWBREI	ACOCA SAMY & PERLA TRS 8309 DAWN BREEZE AVE LAS VEGAS NV 89131-4614	12516110024
ADAMS EDWARD JR & THERESA M	8345 SPRUCE MEADOWS AVE LAS VEGAS NV 89131-4582	12516312019
ADAMS KENDRIA E	8308 IMPATIENTS AVE LAS VEGAS NV 89131-4617	12516211039
ADAMSEN ARNOLD ALFRED	7432 FENCEROW ST LAS VEGAS NV 89131-4545	12516313047
ADKINS MARY JO & GRANT	8500 GRACIOUS PINE AVE LAS VEGAS NV 89143-4609	12517511009
ADLER ROBERT L & RENNE JT LIV TR	8272 AURORA PEAK AVE LAS VEGAS NV 89131-4627	12516111014
AGGIERI REGINA	ADLER ROBERT LEO & RENEE TRS 8217 QUAIL ARROYO AVE LAS VEGAS NV 89131-4674	12516115058
AGUILAR ROSARIO TRUST	8573 BLOWING PINES DR LAS VEGAS NV 89143-4462	12517527018
AGUILERA JOSE	AGUILAR ROSARIO TRS %LOS ANGELES NATIONAL BANK 1912 SUNSET BLVD LOS ANGELES CA 90026-3229	12516319004
AIKEN DONNA & PAUL	8501 TIMBER PINE AVE LAS VEGAS NV 89143-4611	12517517022
ALBERTSON'S INC	8563 SHADY PINES DR LAS VEGAS NV 89143-4451	12517526015
ALIZADEH HAMID	%PROPERTY TAX DEPT P O BOX 20 BOISE ID 83726-0020	12517610014
ALKSNE PAMELA & MILTON	8461 CHEERFUL BROOK AVE LAS VEGAS NV 89143-5191	12508815004
ALLEN MARY JEAN & JAY	7729 KIOWA POINTE ST LAS VEGAS NV 89131-4615	12516210008
ALMQUIST ASHLEY E	8621 HIDDEN PINES AVE LAS VEGAS NV 89143-1367	12517519028
ALVARADO ANA M	7520 FENCEROW ST LAS VEGAS NV 89131-4547	12516313054
ALVAREZ ARIEL V	8420 SHADY PINES DR LAS VEGAS NV 89131-8133	12517528024
ALVAREZ GLORIA	8609 GRAND PINE AVE LAS VEGAS NV 89143-1352	12517516003
AMAGAI YUKIHIKO	8617 HIDDEN PINES AVE LAS VEGAS NV 89143-1367	12517519029
AMATO JILLENE M	8628 HIDDEN PINES AVE LAS VEGAS NV 89143-1367	12517519005
AMERICAN GEAR REDUCTION INC	1728 PINTER WY NO LAS VEGAS NV 89032-7987	12517520011
	P O BOX 62467 BOULDER CITY NV 89006-2467	12517802005

ROC-42637
 Mr. John Boyd
 New Albertson's, Inc.
 PO Box 20
 Boise Idaho 83726

ROC-42637
 Mr. Tom Amick
 Kaempfer Growell, et al
 8345 West Sunset Road, Suite #250
 Las Vegas, Nevada 89113

Report of All Selected Parcels**Case Number:** ROC-42637**Printed On:** Wed: July 27, 2011

<u>Owner</u>	<u>Address</u>	<u>Parcel Numbe</u>
AMERICAN GENERAL FIN SERV INC	420 N NELLIS BLVD #A-8 LAS VEGAS NV 89110-5366	12517511001
AMICO ROBERT S & SHARON L	7709 KIOWA POINTE ST LAS VEGAS NV 89131-4615	12516210003
AMPER SERGIO F & JESUS A	8733 SHADY PINES DR LAS VEGAS NV 89143-4459	12517524004
ANDERSON ANDREA L	P O BOX 750635 LAS VEGAS NV 89136-0635	12516111045
ANDERSON ANTHONY M & DARLEEN W	8501 GRACIOUS PINE AVE LAS VEGAS NV 89143-4609	12517511022
ANDERSON BRIAN L	8548 GRACIOUS PINE AVE LAS VEGAS NV 89143-4610	12517510006
ANDERSON CRAIG A & SUZANNE R	8148 PEMBA AVE LAS VEGAS NV 89131-4642	12516213001
ANDERSON JAMES D & MICHELE M	8273 ORANGE VALE AVE LAS VEGAS NV 89131-4629	12516111032
ANDERSON MICHAEL T & ROCHELLE M	8545 SHADY PINES DR LAS VEGAS NV 89143-4451	12517521032
ANDERSON THOMAS M JR	8301 VALLEY STREAM AVE LAS VEGAS NV 89131-4616	12516211019
ANDREOLA MARK JOHN	8303 AMTRAK EXPRESS AVE LAS VEGAS NV 89131-4822	12509413038
ANGELES NATALIE & CRISTOPHER	2104 S 6TH ST LAS VEGAS NV 89104-2904	12516313033
ANTONIUK DANIEL S	8316 SPRUCE MEADOWS AVE LAS VEGAS NV 89131-4581	12516312011
AQUINO HILARIO & LILLY	7721 KIOWA POINTE ST LAS VEGAS NV 89131-4615	12516210006
ARANAYDO JOSEPH & APRIL U TRUST	ARANAYDO JOSEPH & APRIL U TRS 7540 FLAT ROCK ST LAS VEGAS NV 89131-4515	12516311075
ARELLANO ADRIAN L & ALBERT D	8404 TIMBER PINE AVE LAS VEGAS NV 89143-4614	12517517008
ARELLANO ELSA	7412 FLAT ROCK ST LAS VEGAS NV 89131-4518	12516311058
ARENT WILLIAM & VANESSA	2112 RICO PEAK CT LAS VEGAS NV 89128-7634	12517525010
ARNETT MELISSA	8149 BACKPACKER CT LAS VEGAS NV 89131-8111	12516316033
ARNOLD JEFFREY R S & MICHELLE M	8308 LAMBTIN QUAY AVE LAS VEGAS NV 89131-4814	12516117006
AURORA LOAN SERVICES L L C	327 S INVERNESS DR ENGLEWOOD CO 80112-6012	12516214004
AYUSTE EDWARD	8461 ORLY AVE LAS VEGAS NV 89143-6008	12517710006
B & B 1	%R BRAINARD P O BOX 9712 NELLIS AFB NV 89191-0712	12516319051
BABCOCK FAMILY LIVING TRUST	BABCOCK TIMOTHY A TRS 8316 GORSKY AVE LAS VEGAS NV 89131-4620	12516210027
BACA LUZ H	7532 FENCEROW ST LAS VEGAS NV 89131-4547	12516313057
BACHAALANI ROGER	8635 MAYPORT DR LAS VEGAS NV 89131-6703	12517519015
BALKO LARRY S	7923 KELBURN HILL ST LAS VEGAS NV 89131-4815	12516117020
BALL JAMES G	8608 MAJESTIC PINE AVE LAS VEGAS NV 89143-1349	12517514009
BANASZAK DONALD	8625 HIDDEN PINES AVE LAS VEGAS NV 89143-1367	12517519027
BANK DEUTSCHE NATIONAL TR CO TRS	3476 STATEVIEW BLVD MAC #X7801-013 FT MILL SC 29715-7203	12517522005
BANK DEUTSCHE NATIONAL TR CO TRS	%AMERICAN HOME MTGE SERV 4875 BELFORT RD JACKSONVILLE FL 32256-6058	12517527009
BANK DEUTSCHE NATIONAL TR CO TRS	%ONEWEST BANK FSB 888 E WALNUT ST PASADENA CA 91101-1802	12517511004

Report of All Selected Parcels**Case Number:** ROC-42637**Printed On:** Wed: July 27, 2011

<u>Owner</u>	<u>Address</u>	<u>Parcel Numbe</u>
BANK DEUTSCHE NATIONAL TR CO TRS	4875 BELFORT RD JACKSONVILLE FL 32256-6058	12516313031
BANK DEUTSCHE NATIONAL TR CO TRS	400 NATIONAL WY SIMI VALLEY CA 93065-6414	12517511008
BANK NEW YORK MELLON TRS	400 NATIONAL WY SIMI VALLEY CA 93065-6414	12516111003
BANK NEW YORK MELLON TRS	4828 LOOP CENTRAL DR #600 HOUSTON TX 77081-2212	12516313029
BANK NEW YORK MELLON TRS	400 NATIONAL WY SIMI VALLEY CA 93065-6414	12516312031
BANK NEW YORK MELLON TRS	400 NATIONAL WY SIMI VALLEY CA 93065-6414	12517527001
BANK NEW YORK MELLON TRS	400 NATIONAL WAY SIMI VALLEY CA 93065	12516212001
BANK U S N A	4801 FREDERICA ST OWENSBORO KY 42301-7441	12516312018
BANK U S N A	4801 FREDERICA ST OWENSBORO KY 42301-7441	12517524008
BANK U S NATIONAL ASSN TRS	%SELECT PORTFOLIO SERV INC 3815 S W TEMPLE SALT LAKE CITY UT 84115-4412	12516311015
BANK WELLS FARGO N A TRS	1610 E ST ANDREWS ST SANTA ANA CA 92705-4931	12516211010
BANK WELLS FARGO NATIONAL ASSN	3476 STATEVIEW BLVD MAC-X7801-013 FT MILL SC 29715-7203	12516311009
BANK WELLS FARGO NATL ASSN TRS	7255 BAYMEADOWS WY MAIL STOP JAXB2007 JACKSONVILLE FL 32256-6851	12516110039
BANKS TROY ROBERT & BARBARA S	8217 FRITZEN AVE LAS VEGAS NV 89131-4635	12516213021
BARAJAS EDWARD	CENTENO PERLA 8632 GRAND PINE AVE LAS VEGAS NV 89143-1353	12517516010
BARBER EMILY & DANIEL	8567 SHADY PINES DR LAS VEGAS NV 89143-4452	12517526014
BARRY ERIK & TAMALA	8740 SHADY PINES DR LAS VEGAS NV 89143-4460	12517524014
BATES NEILSON V & RUTH FAMILY TR	BATES NEILSON V & RUTH TRS 7727 MAPLE MEADOW ST LAS VEGAS NV 89131-4666	12516214008
BEANAN FRANCINE L & GREGORY G	8246 ORANGE VALE AVE LAS VEGAS NV 89131-4652	12516114041
BEARDMORE HOWARD C & FILIBERTHA	8275 AURORA PEAK AVE LAS VEGAS NV 89131-4627	12516111039
BECKMAN MICHAEL B & SUSAN G	86-911 ALMIHI PL WAIANAE HI 96792-2908	12517516020
BEDFORD MARTIN C	8213 IMPATIENTS AVE LAS VEGAS NV 89131-4634	12516212033
BENITES DAVID	8705 HIDDEN PINES AVE LAS VEGAS NV 89143-1366	12517519021
BENSON CARINA C	8428 BELLERY AVE LAS VEGAS NV 89143-1313	12517711028
BENSON RICHARD J	7605 KIOWA POINTE AVE LAS VEGAS NV 89131-4619	12516211008
BENTO ANTHONY	8201 VALLEY STREAM AVE LAS VEGAS NV 89131-4633	12516212011
BERG CHRISTOPHER J	7728 MAPLE MEADOW ST LAS VEGAS NV 89131-4666	12516214023
BERGSING DINEEN M	8548 SHADY PINES DR LAS VEGAS NV 89143-4451	12517521026
BERGRUD RHONDA	8311 FARM RD LAS VEGAS NV 89131-4606	12516301003
BERNETT DENISE	8352 JO MARCY DR LAS VEGAS NV 89131-4601	12516117048
BERRY MARK & TONI	7633 KIOWA POINTE ST LAS VEGAS NV 89131-4619	12516211001
BETTI THOMAS R & PAULA K	8224 GORSKY AVE LAS VEGAS NV 89131-4623	12516213031

Report of All Selected Parcels**Case Number:** ROC-42637**Printed On:** Wed: July 27, 2011

<u>Owner</u>	<u>Address</u>	<u>Parcel Number</u>
BHATTACHERJEE ANOL	18309 EASTWYCK DR TAMPA FL 33647-2931	12516313014
BIENIEK DANIEL K	8313 IMPATIENTS AVE LAS VEGAS NV 89131-4618	12516211033
BINDER TODD ALLAN & PATRICIA J	8220 VALLEY STREAM AVE LAS VEGAS NV 89131-4633	12516212025
BISHOP MORGAN & BETHANY	8581 BLOWING PINES ST LAS VEGAS NV 89143-4463	12517527016
BLACK DWIGHT D	DAVIS LOU A 7521 FENCEROW ST LAS VEGAS NV 89131-4548	12516313063
BLAIR RUTH E	VOTAW ANN T 7951 QUAIL HEAVEN ST LAS VEGAS NV 89131-4678	12516115023
BLAIR THERESE A	8544 HIDDEN PINES AVE LAS VEGAS NV 89143-1369	12517521007
BLAKE LESLIE W	8281 JO MARCY DR LAS VEGAS NV 89131-4625	12516111005
BLASCO MY HANH & ROGER	9845 MASTERFUL DR LAS VEGAS NV 89148-4535	12516313072
BLEIFUSS DENNIS & KAREN	8123 DESERT CLOUD AVE LAS VEGAS NV 89131-4667	12516215014
BLOMERT HERMAN & CAROLINE FAM TR	BLOMERT HERMAN C TRS 8568 BLOWING PINES DR LAS VEGAS NV 89143-4462	12517526017
BOBBERA JAMES C & KATHY	8201 GORSKY AVE LAS VEGAS NV 89131-4623	12516213038
BOILEAU THERESA & WILLIAM H	8314 FORT HALLOCK AVE LAS VEGAS NV 89131-8194	12516319035
BOKELMANN WILLIAM T & PAMELA D	2377 FLUTE AVE HENDERSON NV 89052-6415	12516319007
BOLANOS VICTOR H & JUDITH C	8325 FRITZEN AVE LAS VEGAS NV 89131-4608	12516210024
BONDIEK PATRICK W & CYNTHIA E	8216 VALLEY STREAM AVE LAS VEGAS NV 89131-4633	12516212026
BONI DANELLE	7428 ALPINE RIDGE ST LAS VEGAS NV 89131-4585	12516312005
BOOKER JENNIFER	8729 SHADY PINES DR LAS VEGAS NV 89143-4459	12517524005
BOOTH ROBERT L & FRANCES M	7808 RESTLESS PINES ST LAS VEGAS NV 89131-8134	12517528009
BORGERSEN NANCY L & WAYNE E	7816 WINDSWEPT ST LAS VEGAS NV 89131-4636	12516212006
BORO JOSEPH & SHIRLEY LIVING TR	8585 BLOWING PINES DR LAS VEGAS NV 89143-4463	12517527015
BOTROS BOTROS S & MAGGI L	7820 RESTLESS PINES ST LAS VEGAS NV 89131-8134	12517528012
BOULEVARD ENTERPRISES L L C	P O BOX 12649 MILL CREEK WA 98082-0649	12517712001
BOWEN MICHAEL & DANIELLE	7521 APPLE CIDER ST LAS VEGAS NV 89131-8116	12516317008
BOY LORI J	8311 FORT HALLOCK AVE LAS VEGAS NV 89131-8194	12516319032
BOYER MARK A & LAURA	8579 SHADY PINES DR LAS VEGAS NV 89143-4452	12517526011
BRANFORD JAMES W & ESTHER KEIKO	8620 CREST HILL AVE LAS VEGAS NV 89145-4867	12517521015
BRANHAM CHRISTOPHER & ELIZABETH	8321 FRITZEN AVE LAS VEGAS NV 89131-4608	12516210023
BRANSCOME ORRIN W & CHERYL E	8308 FRITZEN AVE LAS VEGAS NV 89131-4608	12516210015
BRASCIA ANTHONY R & RHONDA A	8607 SHADY PINES DR LAS VEGAS NV 89143-4453	12517526006
BRASI AIMEE E	7413 FLAT ROCK ST LAS VEGAS NV 89131-4519	12516311030
BRASI KEN	7405 FLAT ROCK ST LAS VEGAS NV 89131-4519	12516311032

Report of All Selected Parcels**Case Number:** ROC-42637**Printed On:** Wed: July 27, 2011

<u>Owner</u>	<u>Address</u>	<u>Parcel Numbe</u>
BRIAN SCOTT A	8736 SHADY PINES DR LAS VEGAS NV 89143-4460	12517524013
BRONSON DONALD C & JANET E	8224 FRITZEN AVE LAS VEGAS NV 89131-4635	12516213015
BROOKS CHRISTOPHER L	7612 ROOP ST LAS VEGAS NV 89131-4621	12516212021
BROOKS JEROD DAVID & COURTNEY E	8307 MARTINBOROUGH AVE LAS VEGAS NV 89131-4816	12516117034
BROOKS LIVING TRUST	BROOKS WILLIAM A & CYNTHIA TRS 7609 ROOP ST LAS VEGAS NV 89131-4621	12516211022
BROWN CHARLINE LIVING TRUST	RAY CHARLOTTE A TRS 6521 BLUFF DWELLERS AVE LAS VEGAS NV 89131-3027	12517710016
BROWN CHARLINE LIVING TRUST	RAY CHARLOTTE A TRS 6521 BLUFF DWELLERS AVE LAS VEGAS NV 89131-3027	12516215009
BROWN CLARENCE L & EMMA J	8317 JO MARCY DR LAS VEGAS NV 89131-4800	12516110035
BROWN JONATHAN & AMY	7401 FLAT ROCK ST LAS VEGAS NV 89131-4519	12516311033
BROWN OLLIS H	8233 VALLEY STREAM AVE LAS VEGAS NV 89131-4633	12516212019
BROWN TIMOTHY W & ROBIN T	P O BOX 3103 WEST WENDOVER NV 89883-3103	12516211020
BRUCE JEANETTE H 2003 LIVING TR	BRUCE JEANETTE H TRS 7848 WAVERING PINE DR LAS VEGAS NV 89143-1379	12517520033
BURKE KERRI & RUDY TRSUT	BURKE RUDY A & KERRIE H TRS 8127 DESERT CLOUD AVE LAS VEGAS NV 89131-4667	12516215013
BURTON LEIGH A	8221 QUAIL ARROYO AVE LAS VEGAS NV 89131-4674	12516115057
BURTON STEPHEN J & SUSAN	8325 GORSKY AVE LAS VEGAS NV 89131-4620	12516210038
BUSH REBECCA	8341 SPRUCE MEADOWS AVE LAS VEGAS NV 89131-4582	12516312020
BUSHMAN MICHAEL JAMES	45 PINWOOD DR MEDINA OH 44256-2893	12517520027
BUTLER DARRELL J & MALISSA R	8545 BLOWING PINES DR LAS VEGAS NV 89143-4461	12517520020
C M BOULEVARD 1/2 L L C	%A MENLOVE 1291 GALLERIA DR HENDERSON NV 89014-8605	12517713006
C M BOULEVARD 1/2 L L C	%A MENLOVE 1291 GALLERIA DR HENDERSON NV 89014-8605	12517713002
C M BOULEVARD 1/2 L L C	%A MENLOVE 1291 GALLERIA DR HENDERSON NV 89014-8605	12517713013
C M BOULEVARD 1/2 L L C	%A MENLOVE 1291 GALLERIA DR HENDERSON NV 89014-8605	12517713010
C M BOULEVARD 1/2 L L C	%A MENLOVE 1291 GALLERIA DR HENDERSON NV 89014-8605	12517713022
C M BOULEVARD 1/2 L L C	%A MENLOVE 1291 GALLERIA DR HENDERSON NV 89014-8605	12517713020
C M BOULEVARD 1/2 L L C	%A MENLOVE 1291 GALLERIA DR HENDERSON NV 89014-8605	12517713021
C M BOULEVARD 1/2 L L C	%A MENLOVE 1291 GALLERIA DR HENDERSON NV 89014-8605	12517713007
C M BOULEVARD 1/2 L L C	%A MENLOVE 1291 GALLERIA DR HENDERSON NV 89014-8605	12517713008
C M BOULEVARD 1/2 L L C	%A MENLOVE 1291 GALLERIA DR HENDERSON NV 89014-8605	12517713015
C M BOULEVARD 1/2 L L C	%A MENLOVE 1291 GALLERIA DR HENDERSON NV 89014-8605	12517713011
C M BOULEVARD 1/2 L L C	%A MENLOVE 1291 GALLERIA DR HENDERSON NV 89014-8605	12517713019
C M BOULEVARD 1/2 L L C	%A MENLOVE 1291 GALLERIA DR HENDERSON NV 89014-8605	12517713014
C M BOULEVARD 1/2 L L C	%A MENLOVE 1291 GALLERIA DR HENDERSON NV 89014-8605	12517713009

Report of All Selected Parcels**Case Number:** ROC-42637**Printed On:** Wed: July 27, 2011

<u>Owner</u>	<u>Address</u>	<u>Parcel Number</u>
C M BOULEVARD 1/2 L L C	%A MENLOVE 1291 GALLERIA DR HENDERSON NV 89014-8605	12517713012
C M BOULEVARD 1/2 L L C	%A MENLOVE 1291 GALLERIA DR HENDERSON NV 89014-8605	12517713018
C M BOULEVARD 1/2 L L C	%A MENLOVE 1291 GALLERIA DR HENDERSON NV 89014-8605	12517713023
C M BOULEVARD 1/2 L L C	%A MENLOVE 1291 GALLERIA DR HENDERSON NV 89014-8605	12517713004
C M BOULEVARD 1/2 L L C	%A MENLOVE 1291 GALLERIA DR HENDERSON NV 89014-8605	12517713003
C M BOULEVARD 1/2 L L C	%A MENLOVE 1291 GALLERIA DR HENDERSON NV 89014-8605	12517713017
C M BOULEVARD 1/2 L L C	%A MENLOVE 1291 GALLERIA DR HENDERSON NV 89014-8605	12517713016
C M BOULEVARD 1/2 L L C	%A MENLOVE 1291 GALLERIA DR HENDERSON NV 89014-8605	12517713005
C M BOULEVARD 1/2 L L C	%A MENLOVE 1291 GALLERIA DR HENDERSON NV 89014-8605	12517713024
CABERO CHARLENE TOLOSA	8220 IMPATIENTS AVE LAS VEGAS NV 89131-4634	12516212038
CABEZA ONELIO M & JULIA D FAM TR	CABEZA ONELIO M JR & JULIA D TRS 8221 GORSKY AVE LAS VEGAS NV 89131-4623	12516213033
CABRERA JUAN A GARCIA	7544 WANDERING ST LAS VEGAS NV 89131-4566	12516313020
CADMAN JAMES R	8405 SHADY PINES DR LAS VEGAS NV 89131-8133	12517528007
CALCLAGER EUGENE	3083 SEA FIELD CT SAN JOSE CA 95148-4044	12517528026
CALDWELL MORRIS A & LINDA D	4440 W 58TH PL LOS ANGELES CA 90043-3410	12517527006
CAMPBELL MICHAEL & KATHERINE	8328 IMPATIENTS AVE LAS VEGAS NV 89131-4617	12516211034
CANDELARIA GLEN C & MARLENE	8433 SHADY PINES DR LAS VEGAS NV 89131-8133	12517528001
CARDONA GARY & REBECCA M	8284 AURORA PEAK AVE LAS VEGAS NV 89131-4627	12516111017
CARLSON FAMILY 1989 TRUST	CARLSON HARRY J JR & DEBRA N TRS 8293 JO MARCY DR LAS VEGAS NV 89131-4625	12516111002
CARNEY BRIAN E	8424 SHADY PINES DR LAS VEGAS NV 89131-8133	12517528025
CAROLINE'S COURT L L C	10877 WILSHIRE BLVD #1407 LOS ANGELES CA 90024-4367	12517612005
CAROLINE'S COURT L L C	10877 WILSHIRE BLVD #1407 LOS ANGELES CA 90024-4367	12517612003
CAROLINE'S COURT L L C	10877 WILSHIRE BLVD #1407 LOS ANGELES CA 90024-4367	12517612006
CAROLINE'S COURT L L C	10877 WILSHIRE BLVD #1407 LOS ANGELES CA 90024-4367	12517214001
CAROLINE'S COURT L L C	10877 WILSHIRE BLVD #1407 LOS ANGELES CA 90024-4367	12517612008
CAROLINE'S COURT L L C	JACK IN THE BOX INC LEASE %M SNIDER 9330 BALBOA AVE SAN DIEGO CA 92123-1516	12517612007
CAROLINE'S COURT LL L L C	P O BOX 1000 MOORESVILLE NC 28115-1000	12517612002
CARPENTER JOSH	8141 PEMBA AVE LAS VEGAS NV 89131-4642	12516215002
CARQUE KELLY	8136 PEMBA AVE LAS VEGAS NV 89131-4642	12516214003
CARRILLO LETICIA L	7801 FALLING PINES PL LAS VEGAS NV 89143-4455	12517527008
CARROL JACK A	CARROLL EVA Y 7432 ALPINE RIDGE ST LAS VEGAS NV 89131-4585	12516312006
CARROLL RICHARD M & NATASCHA	8271 AURORA PEAK AVE LAS VEGAS NV 89131-4627	12516111040

Report of All Selected Parcels**Case Number:** ROC-42637**Printed On:** Wed: July 27, 2011

<u>Owner</u>	<u>Address</u>	<u>Parcel Number</u>
CARSON IVAN C & EILEEN P	5759 ALFRED DR LAS VEGAS NV 89108-3701	12516312029
CARTER CHARLES W & BOBBIE J	8556 HIDDEN PINES AVE LAS VEGAS NV 89143-1368	12517521010
CARTER MATTHEW B & LEANNE	7548 WANDERING ST LAS VEGAS NV 89131-4566	12516313021
CASAREZ SOMMER	7557 VIRGINIA DALE ST LAS VEGAS NV 89131-8191	12516319001
CASTANEDA GILBERT N & CONNIE C	8637 GRAND PINE AVE LAS VEGAS NV 89143-1353	12517518017
CASTANEDA MICHAEL A	7955 QUAIL HEAVEN ST LAS VEGAS NV 89131-4678	12516115022
CASTANEDA RICHARD U & IRENE	7940 CAPE BRETT ST LAS VEGAS NV 89131-4602	12516117003
CASTRO CHRISTOPHER JR & LORRAINE	8229 VALLEY STREAM AVE LAS VEGAS NV 89131-4633	12516212018
CASTRO JOSEPH J & WEENA R	8328 VALLEY STREAM AVE LAS VEGAS NV 89131-4616	12516211028
CASTRO LUIS F	7861 WAVERING PINE DR LAS VEGAS NV 89143-1379	12517520001
CATALDI GIULIO & CAROL	4655 REGALO BELLO ST LAS VEGAS NV 89135-2534	12516311012
CAUFIELD FREDERICK T	8509 TIMBER PINE AVE LAS VEGAS NV 89143-4611	12517517020
CHAMPLIN ROSE MARY	8209 VALLEY STREAM AVE LAS VEGAS NV 89131-4633	12516212013
CHANDLER HANS J	8316 IMPATIENTS AVE LAS VEGAS NV 89131-4617	12516211037
CHANG DANIEL YOK MAN	505 ZENITH RIDGE DR DANVILLE CA 94506-1356	12517516026
CHANG TA-LI & ANLEE	31 ALMOND TREE LN IRVINE CA 92612-2230	12516319010
CHAVEZ MARIE & JOSE ROSARIO	7509 WANDERING ST LAS VEGAS NV 89131-4584	12516313030
CHEKOVICH NATASHA	503 ESCOTO PL HENDERSON NV 89052-2816	12516311016
CHERLAND RANDY W & JOHANNA P	7417 FENCEROW ST LAS VEGAS NV 89131-4544	12516313074
CHIGI CAMILLE A	8128 DESERT CLOUD AVE LAS VEGAS NV 89131-4667	12516215027
CHRISTENSEN CARL S & SHANA M	8716 SHADY PINES DR LAS VEGAS NV 89143-4448	12517524022
CHRISTOPHER LEONARD III	8313 FRITZEN AVE LAS VEGAS NV 89131-4608	12516210021
CHRISTOPHER STEVEN D	8545 GRACIOUS PINE AVE LAS VEGAS NV 89143-4610	12517510019
CHURCH L D S PRESIDING BISHOP	%TAX DIV 50 E NORTH TEMPLE 22ND FLOOR SALT LAKE CITY UT 84150-0022	12516301017
CIALKOWSKI ANTHONY T & LOUISE A	8412 TIMBER PINE AVE LAS VEGAS NV 89143-4614	12517517009
CIMIC MARCELIE P & ALEN	10416 BRITTON HILL AVE LAS VEGAS NV 89129-4529	12517521021
CISMAR REVOCABLE LIVING TRUST	%M RAMOS P O BOX 120 HAYWARD CA 94543-0120	12517520025
CITY OF LAS VEGAS	400 STEWART AVE 4TH FLR LAS VEGAS NV 89101-2913	12516319037
CITY OF LAS VEGAS	400 STEWART AVE 4TH FLR LAS VEGAS NV 89101-2913	12516117036
CITY OF LAS VEGAS	8144 BACKPACKER CT LAS VEGAS NV 89131-8111	12516316030
CITY OF LAS VEGAS	DEPT OPERATIONS & MAINTENANCE %REAL ESTATE SECTION 333 N RANCHO DR 8TH FLR LAS VEGAS NV 89106-3703	12516313059

Report of All Selected Parcels**Case Number:** ROC-42637**Printed On:** Wed: July 27, 2011

<u>Owner</u>	<u>Address</u>	<u>Parcel Numbe</u>
CITY OF LAS VEGAS	%DEPT FIELD OPERATIONS 400 STEWART ST LAS VEGAS NV 89101-2913	12516313068
CLEMENS DEBORAH & JEFFREY	7816 GLOWING PEAK ST LAS VEGAS NV 89131-4612	12516110030
CLINE DANIEL T	8481 TRUDEAU AVE LAS VEGAS NV 89143-1309	12517711001
COASTSIDE L L C ETAL	4930 N CIMARRON RD LAS VEGAS NV 89149-4752	12517514008
COBB LEROY B & JEANETTE R LIV TR	COBB LEROY B & JEANETTE R TRS 1129 S MARYLAND PKWY LAS VEGAS NV 89104-1745	12516415040
COBB TONY	8417 TRUDEAU AVE LAS VEGAS NV 89143-1301	12517711024
COBB-ADAMS COATES III	324 PARKWAY WEST LAS VEGAS NV 89106	12516313027
COBLENTZ FREDERICK K & PATRICIA	8132 MARTIN POINTE AVE LAS VEGAS NV 89131-4664	12516214011
COCKRELL DIANA	2532 ALLANTE AVE LAS VEGAS NV 89120-3740	12517527013
COLBERT WARREN E & MARLENE R	8313 GORSKY AVE LAS VEGAS NV 89131-4620	12516210035
COLDON SHANNON & DAMIEN	7853 WAVERING PINE DR LAS VEGAS NV 89143-1379	12517520003
COLLUM DENICE	8613 GRAND PINE AVE LAS VEGAS NV 89143-1352	12517516004
COLOMA ALEJANDRO	8344 FORT SEDGWICK AVE LAS VEGAS NV 89131-8193	12516319009
COMBS CAROL A	8341 JO MARCY DR LAS VEGAS NV 89131-4607	12516114039
COMBS CAROL ANN TRUST	COMBS CAROL A TRS 8341 JO MARCY DR LAS VEGAS NV 89131-4607	12516110002
CONCEPCION AURORA L	6503 GREEN VALLEY CIR #107 CULVER CITY CA 90230-7023	12517520005
CONCEPCION NOEL	7808 NESTING PINE PL LAS VEGAS NV 89143-4468	12517524019
CONDOS GEORGE & KAREN	8331 FORT HALLOCK AVE LAS VEGAS NV 89131-8194	12516319027
CONNELLAN PATRICK M & AMANDA L	3720 GRANADA GORGE LN NO LAS VEGAS NV 89084-2332	12516215005
CONNERS JULIET M & MATTHEW L	8277 JO MARCY DR LAS VEGAS NV 89131-4625	12516111006
COOK ANGELA	8420 BELLERY AVE LAS VEGAS NV 89143-1313	12517711026
COOK GRACE	35 E FLORAL AVE ARCAIDA CA 91006-2343	12516311003
COOK JON A & ELIZABETH J	8532 GRACIOUS PINE AVE LAS VEGAS NV 89143-4610	12517510002
COOK MICHAEL L & KIMBERLY S	8636 HIDDEN PINES AVE LAS VEGAS NV 89143-1365	12517519003
COOPER DIANA	7717 KIOWA POINTE ST LAS VEGAS NV 89131-4615	12516210005
CORAL MEADOW HEIGHTS L L C	P M B 263 505 E WINDMILL LN #1B LAS VEGAS NV 89123-1870	12516110032
CORDOVA JORGE A & JACQUELINE D	WARRICK JAMES D & MARGARET L 8521 CHEERFUL BROOK AVE LAS VEGAS NV 89143-5192	12508815013
CORNETT TINA M	FASOLINE WAYNE S 7955 NAPIER ST LAS VEGAS NV 89131-4603	12516117061
CORNWELL JOSEPH H & THERESA K	7921 HOLLOW PINE ST LAS VEGAS NV 89143-4613	12517510010
CORNWELL SCOTT	8416 TRUDEAU AVE LAS VEGAS NV 89143-1301	12517717007
CORTEZ JOVENTINO R & SHAN-CHIH	7511 LITTLE LARAMIE ST LAS VEGAS NV 89131-8196	12516319020
CORUM RICKIE E	8200 GORSKY AVE LAS VEGAS NV 89131-4623	12516213025

Report of All Selected Parcels**Case Number:** ROC-42637**Printed On:** Wed: July 27, 2011

<u>Owner</u>	<u>Address</u>	<u>Parcel Number</u>
CORVALAN JUAN C & HECTOR	8705 SHADY PINES DR LAS VEGAS NV 89143-4459	12517524011
COSTA ALAN K	7824 RESTLESS PINES ST LAS VEGAS NV 89131-8134	12517528013
COUTURIER TERESITA L	8400 TIMBER PINE AVE LAS VEGAS NV 89143-4614	12517517007
COVARRUBIAS RICARDO	REIMER ROSEMARIE 7804 NESTING PINE PL LAS VEGAS NV 89143-4468	12517524020
COX CAROL LYNNE & JAMES DEAN	8640 GRAND PINE AVE LAS VEGAS NV 89143-1353	12517518015
COX DAVID A & KATHLEEN	8457 ORLY AVE LAS VEGAS NV 89143-6008	12517710007
CRABB TIMOTHY J & SHARON M	33925 N FISCHER DR INGLESIDE IL 60041-8904	12516213036
CRAWFORD TRAYLOR J	8209 IMPATIENTS AVE LAS VEGAS NV 89131-4634	12516212032
CREGAR JOSEPH M	GOTTLIEB JON & ANN MARIE 2974 KEDLESTON ST LAS VEGAS NV 89135-2232	12517516007
CRIFASI VINCENT	1006 WALT WHITMAN RD LEVITTOWN NY 11756	12517515005
CROWLEY JANET	7409 FLAT ROCK ST LAS VEGAS NV 89131-4519	12516311031
CRUZ TIMOTHY D	7533 WANDERING ST LAS VEGAS NV 89131-4584	12516313024
CUSUMANO ALICIA G	8328 DAWN BREEZE AVE LAS VEGAS NV 89131-4613	12516110040
CUTLER JACK C & CHARLOTTE M	7809 BRIGHT HEIGHTS ST LAS VEGAS NV 89131-4611	12516110015
D D M PROPERTIES L L C	425 ANTEN GULLEY CT LAS VEGAS NV 89148-2805	12508815011
D J C INVESTMENTS L L C	240 S BROADWAY #9 REDONDO BEACH CA 90277-3357	12516117045
DAKAKE EDWARD E & ELIZABETH	8541 TIMBER PINE AVE LAS VEGAS NV 89143-4612	12517515011
DANIELSON ERIC CHRISTIAN	MORANDI RITA 8259 AURORA PEAK AVE LAS VEGAS NV 89131-4627	12516111043
DANIELSON JOSHUA P & BETH R	8556 BLOWING PINES DR LAS VEGAS NV 89143-4461	12517520016
DANZAK RICHARD & GAYLE	8408 SHADY PINES DR LAS VEGAS NV 89131-8133	12517528021
DAVIDSON DIANE L	8332 FRITZEN AVE LAS VEGAS NV 89131-4608	12516210009
DAVIS ANGELA K	8529 GRACIOUS PINE AVE LAS VEGAS NV 89143-4610	12517510023
DAVIS JOYCE Y	8325 IMPATIENTS AVE LAS VEGAS NV 89131-4618	12516211030
DAVIS MARCIE & HARVEY	7300 HERITAGE HARBOR DR LAS VEGAS NV 89131-4326	12517515016
DAVIS MARTHA	7500 W LAKE MEAD BLVD #9496 LAS VEGAS NV 89128-0297	12517510008
DAY MAXIMILLIAN D	5850 W 3RD ST P M B 180 LOS ANGELES CA 90036-2837	12517515013
DECAPITO JOHN J III & JENNIFER S	7801 LIGHT BLOOM ST LAS VEGAS NV 89131-4626	12516111025
DECKER JOSEPH J & KATHLEEN L	7708 WINDSWEPT ST LAS VEGAS NV 89131-4637	12516213003
DELAPAZ-MEDINA MAIDELYN	7429 FENCEROW ST LAS VEGAS NV 89131-4546	12516313071
DELORIE JAMES W	7916 QUICK PINE ST LAS VEGAS NV 89143-1354	12517516022
DELORTO JAMES & ANITA	8300 IMPATIENTS AVE LAS VEGAS NV 89131-4617	12516211041
DEMSKI DENNIS JR & MARIA	8338 FORT HALLOCK AVE LAS VEGAS NV 89131-8195	12516319038

Report of All Selected Parcels**Case Number:** ROC-42637**Printed On:** Wed: July 27, 2011

<u>Owner</u>	<u>Address</u>	<u>Parcel Number</u>
DENTINGER ARNOLD D & MARGARET I	7413 MOUNTAIN THICKET ST LAS VEGAS NV 89131-4542	12516312039
DESCHAIINE PATRICIA & EDWARD	8109 DESERT CLOUD AVE LAS VEGAS NV 89131-4667	12516212003
DESERT WEST PROPERTIES	%A.HELLENBRAND 5272 RIPP RD MIDDLETON WI 53562-3949	12508815058
DEYARMIN DOUGLAS D	4116 STOCKMAN ST NO LAS VEGAS NV 89032-2704	12517510022
DIAZ PATRICIA	7716 WINDSWEPT ST LAS VEGAS NV 89131-4637	12516213005
DICAMPLI STEVEN D & DAWN M	8324 SPRUCE MEADOWS AVE LAS VEGAS NV 89131-4581	12516312013
DICHOSA MYRNA J & BENJAMIN A	DICHOSA FAMILY TRUST 1707 PASO REAL AVE ROWLAND HEIGHTS CA 91748-2947	12516117014
DICKINSON VINCENT G & LAURIE L	8317 VALLEY STREAM AVE LAS VEGAS NV 89131-4616	12516211015
DIETZ TOMI J	7963 NAPIER ST LAS VEGAS NV 89131-4603	12516117062
DIRAFFAELE FAMILY SELF-DEC TR	DIRAFFAELE SAMUEL & M CO-TRS 1009 E OAK AVE LA GRANGE PARK IL 60526-5728	12517528015
DIRECTO CONRAD & LOURDES H	11763 THOMAS HAYES LN SAN DIEGO CA 92126-1144	12516115038
DIXON CHRISTOPHER J & GERALDINE	7421 FENCEROW ST LAS VEGAS NV 89131-4546	12516313073
DODGE NORALEE	7437 FLAT ROCK ST LAS VEGAS NV 89131-4521	12516311024
DOLIBOA KIMBERLY	P O BOX 27971 LAS VEGAS NV 89126-1971	12516115031
DONDOYANO CARLO G & LINDSAY L	8429 BELLERY AVE LAS VEGAS NV 89143-1313	12517711045
DONHOU GAIL E TRUST	DONHOU GAIL E TRS 7432 FLAT ROCK ST LAS VEGAS NV 89131-4520	12516311063
DOW ALAN A & ROXANE	8336 SPRUCE MEADOWS AVE LAS VEGAS NV 89131-4582	12516312016
DOWELL MURLINE	8645 GRAND PINE AVE LAS VEGAS NV 89143-1353	12517518019
DOWNEY BRIAN T & JULIE	2376 CROCODILE AVE HENDERSON NV 89052-2383	12516313053
DOYLE GWENDOLYN	8572 SHADY PINES DR LAS VEGAS NV 89143-4452	12517525020
DUFFE KENNETH & JOY	7724 WINDSWEPT ST LAS VEGAS NV 89131-4637	12516213007
DUQUE MARCO	8600 BLOWING PINES DR LAS VEGAS NV 89143-4464	12517526025
DVORACEK PHYLLIS & BARBARA	8584 SHADY PINES DR LAS VEGAS NV 89143-4452	12517525017
DYBUNPIN JOSE J III	260 KING ST #651 SAN FRANCISCO CA 94107-6410	12517514019
E E J M J R L L C	%M MILLER 8467 BRODY MARCH AVE LAS VEGAS NV 89143-5152	12516213027
E M T REAL ESTATE LTD	3565 LAS VEGAS BLVD S #163 LAS VEGAS NV 89109-8919	12516319022
EAGAN JUSTIN	7963 CAPE BRETT ST LAS VEGAS NV 89131-4602	12516117074
EAVES GREGORY A TRUST	EAVES JODI MATSUURA TRUST 1920 PIIMAUNA PL HONULULU HI 96821-2614	12516117060
ECHAORE SANTIAGO & ANNABELLE	8354 FORT HALLOCK AVE LAS VEGAS NV 89131-8195	12516319042
ELLIS MICHAEL & HANNAH	8344 JO MARCY DR LAS VEGAS NV 89131-4601	12516117046
EMANUEL RONALD & NUBIA	7517 WANDERING ST LAS VEGAS NV 89131-4584	12516313028
EMILEE B LEE	8352 LAMBTIN QUAY AVE LAS VEGAS NV 89131-4814	12516117017

Report of All Selected Parcels**Case Number:** ROC-42637**Printed On:** Wed: July 27, 2011

<u>Owner</u>	<u>Address</u>	<u>Parcel Number</u>
ENGER JOANNE M	7720 MAPLE MEADOW ST LAS VEGAS NV 89131-4666	12516214025
EPLEY DAVID W & KAREN A	8504 STARSTRUCK AVE LAS VEGAS NV 89143-1394	12517514018
ERBELLA DOMINGO	7920 QUICK PINE ST LAS VEGAS NV 89143-1354	12517516021
ESTRADA CRISTOBAL & ALICIA	7925 HOLLOW PINE ST LAS VEGAS NV 89143-4613	12517510009
ESTRADA RHODERICK	7964 NAPIER ST LAS VEGAS NV 89131-4603	12516117063
ETCHEVERRY PHILLIP W	8517 CHEERFUL BROOK AVE LAS VEGAS NV 89143-5192	12508815012
EVANS ALLISON & JAMES J	8559 SHADY PINES DR LAS VEGAS NV 89143-4451	12517526016
FABRO JONATHAN A	8332 LAMBTIN QUAY AVE LAS VEGAS NV 89131-4814	12516117012
FAGAN MILDRED	8600 SHADY PINES DR LAS VEGAS NV 89143-4452	12517525015
FALCONE SUSAN B & MARC J	8316 DAWN BREEZE AVE LAS VEGAS NV 89131-4613	12516110043
FALLON CARLEEN	7931 NAPIER ST LAS VEGAS NV 89131-4603	12516117058
FANNIE MAE	135 N LOS ROBLES #300 PASADENA CA 91101-4529	12517510013
FARIS KEVIN & CAROL	7917 HOLLOW PINE ST LAS VEGAS NV 89143-4613	12517510011
FARM MINI STORAGE PARTNERS L L C	%J MESERVEY 2990 S DURANGO DR LAS VEGAS NV 89117-4412	12517610016
FARM ROAD RETAIL L L C	1770 N BUFFALO #101 LAS VEGAS NV 89128-2679	12517610003
FARM ROAD RETAIL L L C	1770 N BUFFALO #101 LAS VEGAS NV 89128-2679	12517610004
FARM ROAD RETAIL L L C	1770 N BUFFALO #101 LAS VEGAS NV 89128-2679	12517610005
FARM ROAD RETAIL L L C	1770 N BUFFALO #101 LAS VEGAS NV 89128-2679	12517610008
FARM ROAD RETAIL L L C	1770 N BUFFALO #101 LAS VEGAS NV 89128-2679	12517610006
FARM ROAD RETAIL L L C	1770 N BUFFALO #101 LAS VEGAS NV 89128-2679	12517610007
FAWCETT WILLIAM L & NIKKI N	8212 VALLEY STREAM AVE LAS VEGAS NV 89131-4633	12516212027
FEBO JULIO	MCKERVEY-FEBO JANE 1118 W MONTELUPO DR ORO VALLEY AZ 85755-8544	12517520012
FEDERAL HOME LOAN MORTGAGE CORP	7255 BAYMEADOWS WY MAIL STOP: JAXB2007 JACKSONVILLE FL 32256-6851	12517519026
FEDERAL HOME LOAN MORTGAGE CORP	400 COUNTRYWIDE WY MS SV-35 SIMI VALLEY CA 93065-6298	12516110036
FEDERAL HOME LOAN MORTGAGE CORP	400 COUNTRYWIDE WAY SIMI VALLEY CA 93065-6298	12517520026
FEDERAL NATIONAL MORTGAGE ASSN	400 COUNTRYWIDE WY SV-35 SIMI VALLEY CA 93065-6298	12517521028
FEDERAL NATIONAL MORTGAGE ASSN	400 NATIONAL WY SIMI VALLEY CA 93065-6414	12509413037
FEDERAL NATIONAL MORTGAGE ASSN	%CITIMORTGAGE INC %CR TITLE SERVICES 1000 TECHNOLOGY DR MS-314 O'FALLON MO 63368-2239	12508815014
FEDERAL NATIONAL MORTGAGE ASSN	400 NATIONAL WY SIMI VALLEY CA 93065-6414	12517510005
FEDERAL NATIONAL MORTGAGE ASSN	400 NATIONAL WAY SIMI VALLEY CA 93065-6414	12516211007
FEDERAL NATIONAL MORTGAGE ASSN	14221 DALLAS PKWY DALLAS TX 75254-2942	12516212024

Report of All Selected Parcels**Case Number:** ROC-42637**Printed On:** Wed: July 27, 2011

<u>Owner</u>	<u>Address</u>	<u>Parcel Numbe</u>
FEDERAL NATIONAL MORTGAGE ASSN	400 NATIONAL WAY SIMI VALLEY CA 93065-6414	12516212030
FEDERAL NATIONAL MORTGAGE ASSN	400 NATIONAL WY SIMI VALLEY CA 93065-6414	12516311002
FEELEY RYAN T & CYNTHIA A	8633 HIDDEN PINES LAS VEGAS NV 89143-1365	12517519025
FENSCH ROBERT G & NANCY J	7623 MAPLE MEADOW ST LAS VEGAS NV 89131-4665	12516215007
FENU MARIO	FITCH MARY CATHERINE 8304 IMPATIENTS AVE LAS VEGAS NV 89131-4617	12516211040
FERKO JOHN D & WILMA J	8204 GORSKY AVE LAS VEGAS NV 89131-4623	12516213026
FERNANDEZ JEFFREY	7939 KELBURN HILL ST LAS VEGAS NV 89131-4815	12516117018
FERNANDEZ JOSHUA L	7932 NAPIER ST LAS VEGAS NV 89131-4603	12516117067
FERRIOLO DANIELLE	8465 ORLY AVE LAS VEGAS NV 89143-6008	12517710005
FILIPAS DAVID A & PATTI K	8125 BLACK ORCHID AVE LAS VEGAS NV 89131-4659	12516214036
FLAACK CYNTHIA M	8520 HIDDEN PINES AVE LAS VEGAS NV 89143-1369	12517521001
FLOEN MONS K & THERESA	8131 DESERT CLOUD AVE LAS VEGAS NV 89131-4667	12516215012
FLYNN MICHAEL J & IRENE Q LIV TR	FLYNN MICHAEL J & IRENE Q TRS 23355 HARTLAND ST WEST HILLS CA 91307-2410	12516311026
FORCIER LUCILLE G TRUST	FORCIER LUCILLE G TRS 8309 FRITZEN AVE LAS VEGAS NV 89131-4608	12516210020
FOSTER YVETTE S	8213 GORSKY AVE LAS VEGAS NV 89131-4623	12516213035
FOTTRELL WILLIAM M & D M FAM TR	FOTTRELL WILLIAM M TRS 6175 N CONQUISTADOR ST LAS VEGAS NV 89149-1339	12516312038
FOWLER JAMES S	4212 BUTEO LN NO LAS VEGAS NV 89084-3507	12517524012
FOWLER K C & RAMONA L	8204 FRITZEN AVE LAS VEGAS NV 89131-4635	12516213010
FRAGOSO EPIFANIO M & ESPERANZA M	374 EL CAMINITO LIVERMORE CA 94550-5311	12516210031
FRANCIS ROBIN R	CAPRETTI BRIAN 8516 TIMBER PINE AVE LAS VEGAS NV 89143-4611	12517517015
FRANCO RICARDO & ERICA	8309 VALLEY STEAM AVE LAS VEGAS NV 89131	12516211017
FRANKE CHRISTOPHER	7508 FLAT ROCK ST LAS VEGAS NV 89131-4514	12516311067
FRANKFURT PROPERTIES II L L C	1040 E SAHARA AVE #201 LAS VEGAS NV 89104-3232	12516311008
FREELAND MARK A & ELIZABETH A	7541 VIRGINIA DALE ST LAS VEGAS NV 89131-8191	12516319005
FREEMAN ANTHONY D & VICTORIA A	7128 ST LUCIA ST LAS VEGAS NV 89131-1005	12516312030
FREEMAN MONICA	8257 ORANGE VALE AVE LAS VEGAS NV 89131-4629	12516111036
FREEMAN RICHARD L & JOANNE I	8329 IMPATIENTS AVE LAS VEGAS NV 89131-4618	12516211029
FRESH & EASY NEIGHBORHOOD MARKET	ATTN: TAX DEPT 2120 PARK PLACE #200 EL SEGUNDO CA 90245-4741	12517611004
FUENTES FAMILY TRUST	FUENTES EMMA & MARLONE T TRS 7532 WANDERING ST LAS VEGAS NV 89131-4583	12516313017
FULTON OSCAR & C R REV LIV TR	FULTON OSCAR & CHRISTINA R TRS 8300 SPRUCE MEADOWS AVE LAS VEGAS NV 89131-4581	12516312007
FUNG CINDY	33 LOS CHARROS LN PORTOLA VALLEY CA 94028-7914	12516117037
GAFFORD GEORGE R & HELEN L	8324 VALLEY STREAM LAS VEGAS NV 89131-4616	12516211027

Report of All Selected Parcels**Case Number:** ROC-42637**Printed On:** Wed: July 27, 2011

<u>Owner</u>	<u>Address</u>	<u>Parcel Number</u>
GALICIA THOMAS & CONCHITA	12330 NELSON RD MOORPARK CA 93021-8774	12516313012
GALLEGO JOHANNA	8552 SHADY PINES DR LAS VEGAS NV 89143-4451	12517521027
GALLEGOS JOHNNY VICTOR	8541 BLOWING PINES DR LAS VEGAS NV 89143-4461	12517520021
GALVAN MARGARITA	GALVAN-BARRERA JESUS 7928 QUICK PINE ST LAS VEGAS NV 89143-1354	12517516019
GALZA JASON & DENISE L	7948 QUAIL HEAVEN ST LAS VEGAS NV 89131-4678	12516115039
GARCIA RICHARD J	6218 BAYHAVEN CT LAS VEGAS NV 89131-2341	12516311025
GARONE MICHAEL	SMITH NICOLE 8263 AURORA PEAK AVE LAS VEGAS NV 89131-4627	12516111042
GARZA HECTOR R & ALICIA L	7901 WILLOW PINES PL LAS VEGAS NV 89143-1364	12517519017
GASPER DENISE LIVING TRUST	GASPER DENISE TRS 7333 ROAMER PL LAS VEGAS NV 89131-4507	12517514016
GEHRIG RICHARD B & REGINA L	8604 MAJESTIC PINE AVE LAS VEGAS NV 89143-1349	12517514010
GELLER YEFIM	BULASHOVA TAMARA 6252 MORSE AVE NORTH HOLLYWOOD CA 91606-2920	12516319049
GEORGE EUGENE	HARRIS JUDITH.M 7816 RESTLESS PINES ST LAS VEGAS NV 89131-8134	12517528011
GHOUKASSI ROBERT	17305 CARDINAL CT CASTRO VALLEY CA 94546-1349	12516313066
GIFFORD WILLIAM B & CHARLENE R	7601 KIOWA POINTE ST LAS VEGAS NV 89131-4619	12516211009
GILDORE GILBERT & MARLENE	8336 WILLOW BASIN CT LAS VEGAS NV 89131-4541	12516415069
GILKERSON KENNETH O & SANDRA	8317 FRITZEN AVE LAS VEGAS NV 89131-4608	12516210022
GILLAN JENNIFER L	7941 HOLLOW PINE ST LAS VEGAS NV 89143-4613	12517515003
GILMORE KAREN	8620 GRAND PINE AVE LAS VEGAS NV 89143-1352	12517516013
GIPSON FRED E & V N REV LIV TR	GIPSON FRED E & VIRGINIA N TRS 8212 IMPATIENTS AVE LAS VEGAS NV 89131-4634	12516212040
GIZZI PATRICK & LINDA	8473 ORLY AVE LAS VEGAS NV 89143-6008	12517710003
GLASSCOCK JERED G & RACHEL A	8709 HIDDEN PINES AVE LAS VEGAS NV 89143-1366	12517519020
GLAZEWSKI CHRISTINE	ZAZZERI CHRISTINE 8228 FRITZEN AVE LAS VEGAS NV 89131-4635	12516213016
GLESS JASON & MARIA	6381 GARDEN HILLS RIVERSIDE CA 92506-4674	12516117028
GOLDEN BROOKE L L C	%B WARREN ADVERTISING LLC 7120 SMOKE RANCH RD LAS VEGAS NV 89128-3157	12516117049
GOLDSTEIN ELIYHU	2332 THAYAN AVE HENDERSON NV 89074	12516319046
GOLDSTEIN ROBERT EUGENE & MAXENE	5840 W CRAIG RD #120-300 LAS VEGAS NV 89130-2561	12517711057
GONZALES ANGELO F	7937 HOLLOW PINE ST LAS VEGAS NV 89143-4613	12517515004
GONZALEZ B C & E-G Y P FAM TR	GONZALEZ BENJAMIN C TRS 8469 TRUDEAU AVE LAS VEGAS NV 89143-1309	12517711004
GOODMAN LAURA G LIVING TRUST	GOODMAN LAURA G TRS 615 CORONA RUN AVE LAS VEGAS NV 89123-6254	12516110031
GORDON HERBERT C & SHIRLEY A	8517 HIDDEN PINES AVE LAS VEGAS NV 89143-1369	12517520008
GOULET SHAWN & KIMBERLY	7821 NESTING PINE PL LAS VEGAS NV 89143-4468	12517523009
GOURLIAL RAFIE H & AVANTI	8429 SHADY PINES DR LAS VEGAS NV 89131-8133	12517528002

Report of All Selected Parcels**Case Number:** ROC-42637**Printed On:** Wed: July 27, 2011

<u>Owner</u>	<u>Address</u>	<u>Parcel Number</u>
GOVERNS R J & M K REV LIV TR	GOVERNS ROBERT J & MOLLY K TRS 8320 DAWN BREEZE AVE LAS VEGAS NV 89131-4613	12516110042
GOVORKO VASHTI N	8512 GRACIOUS PINE AVE LAS VEGAS NV 89143-4609	12517511012
GRAMMAS STEVEN & TIFFANY	8308 GORSKY AVE LAS VEGAS NV 89131-4620	12516210029
GRAND TETON LODGE LAND L L C	3399 S DURANGO DR #105 LAS VEGAS NV 89117-4128	12509401031
GRANGAARD CYL	7520 FLAT ROCK ST LAS VEGAS NV 89131-4515	12516311070
GRANTHAM CURTIS H III	8481 ORLY AVE LAS VEGAS NV 89143-6008	12517710001
GRAY DUANE G & GEORGENA M	8417 TIMBER PINE AVE LAS VEGAS NV 89143-4614	12517517002
GRAZIOSO DENNIS JOHN	7504 FENCEROW ST LAS VEGAS NV 89131-4545	12516313050
GREEN GERARD F & CAREN M	8321 GORSKY AVE LAS VEGAS NV 89131-4620	12516210037
GREENBAUM TERESA L	8615 SHADY PINES DR LAS VEGAS NV 89143-4453	12517526004
GREENE CLIFFORD	7470 PEMBER ST LAS VEGAS NV 89143-1312	12517711058
GRETTNER CHARLES CHRISTIAN	7964 KELBURN HILL ST LAS VEGAS NV 89131-4815	12516117051
GRIFFIN CHRISTIAN N & NICOLE M	7512 FLAT ROCK ST LAS VEGAS NV 89131-4514	12516311068
GRIFFIN MELISSIA	8310 FORT HALLOCK AVE LAS VEGAS NV 89131-8194	12516319034
GRONDAHL KELLY D & KRISTI M	7947 QUAIL HEAVEN ST LAS VEGAS NV 89131-4678	12516115024
GUERRERO ALEXIS & DAVID	7940 QUAIL HARBOR CT LAS VEGAS NV 89131-4676	12516115013
GUEVARA DELMY JUDITH	8329 JO MARCY DR LAS VEGAS NV 89131-4607	12516110005
GULLETT MICHAEL C	7450 PEMBER ST LAS VEGAS NV 89143-1312	12517711053
GUTIERREZ SALVADOR D	7500 FENCEROW ST LAS VEGAS NV 89131-4545	12516313049
GUTSWA LYNNE CHARLES & ANN MARIE	6624 CHINATOWN ST LAS VEGAS NV 89166-8031	12516319030
GUY SUZANNA	8633 MAJESTIC PINE AVE LAS VEGAS NV 89143-1350	12517514023
GUZMAN GILBERT & ADAMMAY	7825 FALLING PINES PL LAS VEGAS NV 89143-4455	12517527002
HABERMAN JOE R	8541 GRACIOUS PINE AVE LAS VEGAS NV 89143-4610	12517510020
HADIWINATA ANDRE	1360 BOBOLINK CIR SUNNYVALE CA 94087-3310	12516117022
HAGSTROM BRIAN M & MARIA E	8517 GRACIOUS PINE AVE LAS VEGAS NV 89143-4609	12517511018
HALLMAN PAUL	7629 KIOWA POINTE ST LAS VEGAS NV 89131-4619	12516211002
HALLSTROM DANIEL	7501 WANDERING ST LAS VEGAS NV 89131-4565	12516313032
HALPERIN JASON	8345 SEDGWICK AVE LAS VEGAS NV 89131	12516319045
HAM DONALD E & TERESA R REV TR	HAM DONALD E & TERESA R TRS 516 EL DORADO DR ESCONDIDO CA 92025-6311	12516212017
HAMILTON PAMELA	8413 BELLERY AVE LAS VEGAS NV 89143-1313	12517711049
HAMMOND SCOTT T & TONYA K	8408 GRACIOUS PINE AVE LAS VEGAS NV 89143-4608	12517511006
HANISCH PHILIP J	8249 QUAIL ARROYO AVE LAS VEGAS NV 89131-4674	12516115034

Report of All Selected Parcels**Case Number:** ROC-42637**Printed On:** Wed: July 27, 2011

<u>Owner</u>	<u>Address</u>	<u>Parcel Number</u>
HARDOY RENE MAURICE & PAMELA T	1700 RALPH LEE CT MORGAN HILL CA 95037-3351	12517521023
HARMONY SPRINGS L L C	8912 SPANISH RIDGE AVE #200 LAS VEGAS NV 89148-1312	12517716037
HARMONY SPRINGS L L C	8912 SPANISH RIDGE AVE #200 LAS VEGAS NV 89148-1312	12517711050
HARMONY SPRINGS L L C	8912 SPANISH RIDGE AVE #200 LAS VEGAS NV 89148-1312	12517716008
HARMONY SPRINGS L L C	8912 SPANISH RIDGE AVE #200 LAS VEGAS NV 89148-1312	12517716053
HARMONY SPRINGS L L C	8912 SPANISH RIDGE AVE #200 LAS VEGAS NV 89148-1312	12517715038
HARMONY SPRINGS L L C	8912 SPANISH RIDGE AVE #200 LAS VEGAS NV 89148-1312	12517714017
HARMONY SPRINGS L L C	8912 SPANISH RIDGE AVE #200 LAS VEGAS NV 89148-1312	12517711048
HARMONY SPRINGS L L C	8912 SPANISH RIDGE AVE #200 LAS VEGAS NV 89148-1312	12517711022
HARMONY SPRINGS L L C	8912 SPANISH RIDGE AVE #200 LAS VEGAS NV 89148-1312	12517711005
HARMONY SPRINGS L L C	8912 SPANISH RIDGE AVE #200 LAS VEGAS NV 89148-1312	12517715020
HARMONY SPRINGS L L C	8912 SPANISH RIDGE AVE #200 LAS VEGAS NV 89148-1312	12517715026
HARMONY SPRINGS L L C	8912 SPANISH RIDGE AVE #200 LAS VEGAS NV 89148-1312	12517714009
HARMONY SPRINGS L L C	8912 SPANISH RIDGE AVE #200 LAS VEGAS NV 89148-1312	12517716024
HARMONY SPRINGS L L C	8912 SPANISH RIDGE AVE #200 LAS VEGAS NV 89148-1312	12517715028
HARMONY SPRINGS L L C	8912 SPANISH RIDGE AVE #200 LAS VEGAS NV 89148-1312	12517716006
HARMONY SPRINGS L L C	8912 SPANISH RIDGE AVE #200 LAS VEGAS NV 89148-1312	12517711035
HARMONY SPRINGS L L C	8912 SPANISH RIDGE AVE #200 LAS VEGAS NV 89148-1312	12517716013
HARMONY SPRINGS L L C	8912 SPANISH RIDGE AVE #200 LAS VEGAS NV 89148-1312	12517716029
HARMONY SPRINGS L L C	8912 SPANISH RIDGE AVE #200 LAS VEGAS NV 89148-1312	12517716044
HARMONY SPRINGS L L C	8912 SPANISH RIDGE AVE #200 LAS VEGAS NV 89148-1312	12517711002
HARMONY SPRINGS L L C	8912 SPANISH RIDGE AVE #200 LAS VEGAS NV 89148-1312	12517716034
HARMONY SPRINGS L L C	8912 SPANISH RIDGE AVE #200 LAS VEGAS NV 89148-1312	12517716043
HARMONY SPRINGS L L C	8912 SPANISH RIDGE AVE #200 LAS VEGAS NV 89148-1312	12517716036
HARMONY SPRINGS L L C	8912 SPANISH RIDGE AVE #200 LAS VEGAS NV 89148-1312	12517716028
HARMONY SPRINGS L L C	8912 SPANISH RIDGE AVE #200 LAS VEGAS NV 89148-1312	12517711020
HARMONY SPRINGS L L C	8912 SPANISH RIDGE AVE #200 LAS VEGAS NV 89148-1312	12517711006
HARMONY SPRINGS L L C	8912 SPANISH RIDGE AVE #200 LAS VEGAS NV 89148-1312	12517711016
HARMONY SPRINGS L L C	8912 SPANISH RIDGE AVE #200 LAS VEGAS NV 89148-1312	12517716031
HARMONY SPRINGS L L C	8912 SPANISH RIDGE AVE #200 LAS VEGAS NV 89148-1312	12517714001
HARMONY SPRINGS L L C	8912 SPANISH RIDGE AVE #200 LAS VEGAS NV 89148-1312	12517716005
HARMONY SPRINGS L L C	8912 SPANISH RIDGE AVE #200 LAS VEGAS NV 89148-1312	12517716027

Report of All Selected Parcels**Case Number:** ROC-42637**Printed On:** Wed: July 27, 2011

<u>Owner</u>	<u>Address</u>	<u>Parcel Number</u>
HARMONY SPRINGS L L C	8912 SPANISH RIDGE AVE #200 LAS VEGAS NV 89148-1312	12517711044
HARMONY SPRINGS L L C	8912 SPANISH RIDGE AVE #200 LAS VEGAS NV 89148-1312	12517714011
HARMONY SPRINGS L L C	8912 SPANISH RIDGE AVE #200 LAS VEGAS NV 89148-1312	12517714023
HARMONY SPRINGS L L C	8912 SPANISH RIDGE AVE #200 LAS VEGAS NV 89148-1312	12517714007
HARMONY SPRINGS L L C	8912 SPANISH RIDGE AVE #200 LAS VEGAS NV 89148-1312	12517714020
HARMONY SPRINGS L L C	8912 SPANISH RIDGE AVE #200 LAS VEGAS NV 89148-1312	12517710018
HARMONY SPRINGS L L C	8912 SPANISH RIDGE AVE #200 LAS VEGAS NV 89148-1312	12517714015
HARMONY SPRINGS L L C	8912 SPANISH RIDGE AVE #200 LAS VEGAS NV 89148-1312	12517711062
HARMONY SPRINGS L L C	8912 SPANISH RIDGE AVE #200 LAS VEGAS NV 89148-1312	12517716020
HARMONY SPRINGS L L C	8912 SPANISH RIDGE AVE #200 LAS VEGAS NV 89148-1312	12517714003
HARMONY SPRINGS L L C	8912 SPANISH RIDGE AVE #200 LAS VEGAS NV 89148-1312	12517716014
HARMONY SPRINGS L L C	8912 SPANISH RIDGE AVE #200 LAS VEGAS NV 89148-1312	12517716011
HARMONY SPRINGS L L C	8912 SPANISH RIDGE AVE #200 LAS VEGAS NV 89148-1312	12517716004
HARMONY SPRINGS L L C	8912 SPANISH RIDGE AVE #200 LAS VEGAS NV 89148-1312	12517716017
HARMONY SPRINGS L L C	8912 SPANISH RIDGE AVE #200 LAS VEGAS NV 89148-1312	12517711018
HARMONY SPRINGS L L C	8912 SPANISH RIDGE AVE #200 LAS VEGAS NV 89148-1312	12517716007
HARMONY SPRINGS L L C	8912 SPANISH RIDGE AVE #200 LAS VEGAS NV 89148-1312	12517716010
HARMONY SPRINGS L L C	8912 SPANISH RIDGE AVE #200 LAS VEGAS NV 89148-1312	12517716038
HARMONY SPRINGS L L C	8912 SPANISH RIDGE AVE #200 LAS VEGAS NV 89148-1312	12517716035
HARMONY SPRINGS L L C	8912 SPANISH RIDGE AVE #200 LAS VEGAS NV 89148-1312	12517716030
HARMONY SPRINGS L L C	8912 SPANISH RIDGE AVE #200 LAS VEGAS NV 89148-1312	12517716052
HARMONY SPRINGS L L C	8912 SPANISH RIDGE AVE #200 LAS VEGAS NV 89148-1312	12517716023
HARMONY SPRINGS L L C	8912 SPANISH RIDGE AVE #200 LAS VEGAS NV 89148-1312	12517711033
HARMONY SPRINGS L L C	8912 SPANISH RIDGE AVE #200 LAS VEGAS NV 89148-1312	12517715011
HARMONY SPRINGS L L C	8912 SPANISH RIDGE AVE #200 LAS VEGAS NV 89148-1312	12517715013
HARMONY SPRINGS L L C	8912 SPANISH RIDGE AVE #200 LAS VEGAS NV 89148-1312	12517715005
HARMONY SPRINGS L L C	8912 SPANISH RIDGE AVE #200 LAS VEGAS NV 89148-1312	12517711031
HARMONY SPRINGS L L C	8912 SPANISH RIDGE AVE #200 LAS VEGAS NV 89148-1312	12517715007
HARMONY SPRINGS L L C	8912 SPANISH RIDGE AVE #200 LAS VEGAS NV 89148-1312	12517711032
HARMONY SPRINGS L L C	8912 SPANISH RIDGE AVE #200 LAS VEGAS NV 89148-1312	12517711046
HARMONY SPRINGS L L C	8912 SPANISH RIDGE AVE #200 LAS VEGAS NV 89148-1312	12517714043
HARMONY SPRINGS L L C	8912 SPANISH RIDGE AVE #200 LAS VEGAS NV 89148-1312	12517716051

Report of All Selected Parcels**Case Number:** ROC-42637**Printed On:** Wed: July 27, 2011

<u>Owner</u>	<u>Address</u>	<u>Parcel Numbe</u>
HARMONY SPRINGS L L C	8912 SPANISH RIDGE AVE #200 LAS VEGAS NV 89148-1312	12517714013
HARMONY SPRINGS L L C	8912 SPANISH RIDGE AVE #200 LAS VEGAS NV 89148-1312	12517714035
HARMONY SPRINGS L L C	8912 SPANISH RIDGE AVE #200 LAS VEGAS NV 89148-1312	12517715003
HARMONY SPRINGS L L C	8912 SPANISH RIDGE AVE #200 LAS VEGAS NV 89148-1312	12517711009
HARMONY SPRINGS L L C	8912 SPANISH RIDGE AVE #200 LAS VEGAS NV 89148-1312	12517711064
HARMONY SPRINGS L L C	8912 SPANISH RIDGE AVE #200 LAS VEGAS NV 89148-1312	12517711042
HARMONY SPRINGS L L C	8912 SPANISH RIDGE AVE #200 LAS VEGAS NV 89148-1312	12517711065
HARMONY SPRINGS L L C	8912 SPANISH RIDGE AVE #200 LAS VEGAS NV 89148-1312	12517714031
HARMONY SPRINGS L L C	8912 SPANISH RIDGE AVE #200 LAS VEGAS NV 89148-1312	12517711040
HARMONY SPRINGS L L C	8912 SPANISH RIDGE AVE #200 LAS VEGAS NV 89148-1312	12517714037
HARMONY SPRINGS L L C	8912 SPANISH RIDGE AVE #200 LAS VEGAS NV 89148-1312	12517716001
HARMONY SPRINGS L L C	8912 SPANISH RIDGE AVE #200 LAS VEGAS NV 89148-1312	12517711010
HARMONY SPRINGS L L C	8912 SPANISH RIDGE AVE #200 LAS VEGAS NV 89148-1312	12517714018
HARMONY SPRINGS L L C	8912 SPANISH RIDGE AVE #200 LAS VEGAS NV 89148-1312	12517714010
HARMONY SPRINGS L L C	8912 SPANISH RIDGE AVE #200 LAS VEGAS NV 89148-1312	12517714022
HARMONY SPRINGS L L C	8912 SPANISH RIDGE AVE #200 LAS VEGAS NV 89148-1312	12517715043
HARMONY SPRINGS L L C	8912 SPANISH RIDGE AVE #200 LAS VEGAS NV 89148-1312	12517714033
HARMONY SPRINGS L L C	8912 SPANISH RIDGE AVE #200 LAS VEGAS NV 89148-1312	12517714038
HARMONY SPRINGS L L C	8912 SPANISH RIDGE AVE #200 LAS VEGAS NV 89148-1312	12517711061
HARMONY SPRINGS L L C	8912 SPANISH RIDGE AVE #200 LAS VEGAS NV 89148-1312	12517711007
HARMONY SPRINGS L L C	8912 SPANISH RIDGE AVE #200 LAS VEGAS NV 89148-1312	12517714006
HARMONY SPRINGS L L C	8912 SPANISH RIDGE AVE #200 LAS VEGAS NV 89148-1312	12517714040
HARMONY SPRINGS L L C	8912 SPANISH RIDGE AVE #200 LAS VEGAS NV 89148-1312	12517714014
HARMONY SPRINGS L L C	8912 SPANISH RIDGE AVE #200 LAS VEGAS NV 89148-1312	12517716047
HARMONY SPRINGS L L C	8912 SPANISH RIDGE AVE #200 LAS VEGAS NV 89148-1312	12517716021
HARMONY SPRINGS L L C	8912 SPANISH RIDGE AVE #200 LAS VEGAS NV 89148-1312	12517715030
HARMONY SPRINGS L L C	8912 SPANISH RIDGE AVE #200 LAS VEGAS NV 89148-1312	12517715006
HARMONY SPRINGS L L C	8912 SPANISH RIDGE AVE #200 LAS VEGAS NV 89148-1312	12517715015
HARMONY SPRINGS L L C	8912 SPANISH RIDGE AVE #200 LAS VEGAS NV 89148-1312	12517715016
HARMONY SPRINGS L L C	8912 SPANISH RIDGE AVE #200 LAS VEGAS NV 89148-1312	12517715001
HARMONY SPRINGS L L C	8912 SPANISH RIDGE AVE #200 LAS VEGAS NV 89148-1312	12517711017
HARMONY SPRINGS L L C	8912 SPANISH RIDGE AVE #200 LAS VEGAS NV 89148-1312	12517714019

Report of All Selected Parcels

Case Number: ROC-42637

Printed On: Wed: July 27, 2011

<u>Owner</u>	<u>Address</u>	<u>Parcel Numbe</u>
HARMONY SPRINGS L L C	8912 SPANISH RIDGE AVE #200 LAS VEGAS NV 89148-1312	12517715025
HARMONY SPRINGS L L C	8912 SPANISH RIDGE AVE #200 LAS VEGAS NV 89148-1312	12517714028
HARMONY SPRINGS L L C	8912 SPANISH RIDGE AVE #200 LAS VEGAS NV 89148-1312	12517714008
HARMONY SPRINGS L L C	8912 SPANISH RIDGE AVE #200 LAS VEGAS NV 89148-1312	12517711012
HARMONY SPRINGS L L C	8912 SPANISH RIDGE AVE #200 LAS VEGAS NV 89148-1312	12517711014
HARMONY SPRINGS L L C	8912 SPANISH RIDGE AVE #200 LAS VEGAS NV 89148-1312	12517715044
HARMONY SPRINGS L L C	8912 SPANISH RIDGE AVE #200 LAS VEGAS NV 89148-1312	12517714002
HARMONY SPRINGS L L C	8912 SPANISH RIDGE AVE #200 LAS VEGAS NV 89148-1312	12517711036
HARMONY SPRINGS L L C	8912 SPANISH RIDGE AVE #200 LAS VEGAS NV 89148-1312	12517715031
HARMONY SPRINGS L L C	8912 SPANISH RIDGE AVE #200 LAS VEGAS NV 89148-1312	12517716041
HARMONY SPRINGS L L C	8912 SPANISH RIDGE AVE #200 LAS VEGAS NV 89148-1312	12517716046
HARMONY SPRINGS L L C	8912 SPANISH RIDGE AVE #200 LAS VEGAS NV 89148-1312	12517714021
HARMONY SPRINGS L L C	8912 SPANISH RIDGE AVE #200 LAS VEGAS NV 89148-1312	12517711011
HARMONY SPRINGS L L C	8912 SPANISH RIDGE AVE #200 LAS VEGAS NV 89148-1312	12517715021
HARMONY SPRINGS L L C	8912 SPANISH RIDGE AVE #200 LAS VEGAS NV 89148-1312	12517717013
HARMONY SPRINGS L L C	8912 SPANISH RIDGE AVE #200 LAS VEGAS NV 89148-1312	12517715017
HARMONY SPRINGS L L C	8912 SPANISH RIDGE AVE #200 LAS VEGAS NV 89148-1312	12517711047
HARMONY SPRINGS L L C	8912 SPANISH RIDGE AVE #200 LAS VEGAS NV 89148-1312	12517711063
HARMONY SPRINGS L L C	8912 SPANISH RIDGE AVE #200 LAS VEGAS NV 89148-1312	12517711013
HARMONY SPRINGS L L C	8912 SPANISH RIDGE AVE #200 LAS VEGAS NV 89148-1312	12517715010
HARMONY SPRINGS L L C	8912 SPANISH RIDGE AVE #200 LAS VEGAS NV 89148-1312	12517715008
HARMONY SPRINGS L L C	8912 SPANISH RIDGE AVE #200 LAS VEGAS NV 89148-1312	12517714027
HARMONY SPRINGS L L C	8912 SPANISH RIDGE AVE #200 LAS VEGAS NV 89148-1312	12517714036
HARMONY SPRINGS L L C	8912 SPANISH RIDGE AVE #200 LAS VEGAS NV 89148-1312	12517714034
HARMONY SPRINGS L L C	8912 SPANISH RIDGE AVE #200 LAS VEGAS NV 89148-1312	12517711034
HARMONY SPRINGS L L C	8912 SPANISH RIDGE AVE #200 LAS VEGAS NV 89148-1312	12517714025
HARMONY SPRINGS L L C	8912 SPANISH RIDGE AVE #200 LAS VEGAS NV 89148-1312	12517715029
HARMONY SPRINGS L L C	8912 SPANISH RIDGE AVE #200 LAS VEGAS NV 89148-1312	12517715027
HARMONY SPRINGS L L C	8912 SPANISH RIDGE AVE #200 LAS VEGAS NV 89148-1312	12517715004
HARMONY SPRINGS L L C	8912 SPANISH RIDGE AVE #200 LAS VEGAS NV 89148-1312	12517715002
HARMONY SPRINGS L L C	8912 SPANISH RIDGE AVE #200 LAS VEGAS NV 89148-1312	12517715014
HARMONY SPRINGS L L C	8912 SPANISH RIDGE AVE #200 LAS VEGAS NV 89148-1312	12517715012

Report of All Selected Parcels

Case Number: ROC-42637

Printed On: Wed: July 27, 2011

<u>Owner</u>	<u>Address</u>	<u>Parcel Numbe</u>
HARMONY SPRINGS L L C	8912 SPANISH RIDGE AVE #200 LAS VEGAS NV 89148-1312	12517714024
HARMONY SPRINGS L L C	8912 SPANISH RIDGE AVE #200 LAS VEGAS NV 89148-1312	12517715019
HARMONY SPRINGS L L C	8912 SPANISH RIDGE AVE #200 LAS VEGAS NV 89148-1312	12517716018
HARMONY SPRINGS L L C	8912 SPANISH RIDGE AVE #200 LAS VEGAS NV 89148-1312	12517716040
HARMONY SPRINGS L L C	8912 SPANISH RIDGE AVE #200 LAS VEGAS NV 89148-1312	12517715034
HARMONY SPRINGS L L C	8912 SPANISH RIDGE AVE #200 LAS VEGAS NV 89148-1312	12517714026
HARMONY SPRINGS L L C	8912 SPANISH RIDGE AVE #200 LAS VEGAS NV 89148-1312	12517714039
HARMONY SPRINGS L L C	8912 SPANISH RIDGE AVE #200 LAS VEGAS NV 89148-1312	12517716015
HARMONY SPRINGS L L C	8912 SPANISH RIDGE AVE #200 LAS VEGAS NV 89148-1312	12517714016
HARMONY SPRINGS L L C	8912 SPANISH RIDGE AVE #200 LAS VEGAS NV 89148-1312	12517714029
HARMONY SPRINGS L L C	8912 SPANISH RIDGE AVE #200 LAS VEGAS NV 89148-1312	12517714004
HARMONY SPRINGS L L C	8912 SPANISH RIDGE AVE #200 LAS VEGAS NV 89148-1312	12517715039
HARMONY SPRINGS L L C	8912 SPANISH RIDGE AVE #200 LAS VEGAS NV 89148-1312	12517714012
HARMONY SPRINGS L L C	8912 SPANISH RIDGE AVE #200 LAS VEGAS NV 89148-1312	12517714041
HARMONY SPRINGS L L C	8912 SPANISH RIDGE AVE #200 LAS VEGAS NV 89148-1312	12517710031
HARMONY SPRINGS L L C	8912 SPANISH RIDGE AVE #200 LAS VEGAS NV 89148-1312	12517715009
HARMONY SPRINGS L L C	8912 SPANISH RIDGE AVE #200 LAS VEGAS NV 89148-1312	12517716002
HARMONY SPRINGS L L C	8912 SPANISH RIDGE AVE #200 LAS VEGAS NV 89148-1312	12517710017
HARMONY SPRINGS L L C	8912 SPANISH RIDGE AVE #200 LAS VEGAS NV 89148-1312	12517716025
HARMONY SPRINGS L L C	8912 SPANISH RIDGE AVE #200 LAS VEGAS NV 89148-1312	12517716026
HARMONY SPRINGS L L C	8912 SPANISH RIDGE AVE #200 LAS VEGAS NV 89148-1312	12517716033
HARMONY SPRINGS L L C	8912 SPANISH RIDGE AVE #200 LAS VEGAS NV 89148-1312	12517714030
HARMONY SPRINGS L L C	8912 SPANISH RIDGE AVE #200 LAS VEGAS NV 89148-1312	12517714032
HARMONY SPRINGS L L C	8912 SPANISH RIDGE AVE #200 LAS VEGAS NV 89148-1312	12517716016
HARMONY SPRINGS L L C	8912 SPANISH RIDGE AVE #200 LAS VEGAS NV 89148-1312	12517716009
HARMONY SPRINGS L L C	8912 SPANISH RIDGE AVE #200 LAS VEGAS NV 89148-1312	12517716012
HARMONY SPRINGS L L C	8912 SPANISH RIDGE AVE #200 LAS VEGAS NV 89148-1312	12517716003
HARMONY SPRINGS L L C	8912 SPANISH RIDGE AVE #200 LAS VEGAS NV 89148-1312	12517716032
HARMONY SPRINGS L L C	8912 SPANISH RIDGE AVE #200 LAS VEGAS NV 89148-1312	12517715036
HARMONY SPRINGS L L C	8912 SPANISH RIDGE AVE #200 LAS VEGAS NV 89148-1312	12517716039
HARMONY SPRINGS L L C	8912 SPANISH RIDGE AVE #200 LAS VEGAS NV 89148-1312	12517716019
HARMONY SPRINGS L L C	8912 SPANISH RIDGE AVE #200 LAS VEGAS NV 89148-1312	12517716048

Report of All Selected Parcels**Case Number:** ROC-42637**Printed On:** Wed: July 27, 2011

<u>Owner</u>	<u>Address</u>	<u>Parcel Number</u>
HARMONY SPRINGS L L C	8912 SPANISH RIDGE AVE #200 LAS VEGAS NV 89148-1312	12517711027
HARMONY SPRINGS L L C	8912 SPANISH RIDGE AVE #200 LAS VEGAS NV 89148-1312	12517711060
HARMONY SPRINGS L L C	8912 SPANISH RIDGE AVE #200 LAS VEGAS NV 89148-1312	12517715041
HARMONY SPRINGS L L C	8912 SPANISH RIDGE AVE #200 LAS VEGAS NV 89148-1312	12517711029
HARMONY SPRINGS L L C	8912 SPANISH RIDGE AVE #200 LAS VEGAS NV 89148-1312	12517715040
HARMONY SPRINGS L L C	8912 SPANISH RIDGE AVE #200 LAS VEGAS NV 89148-1312	12517715037
HARMONY SPRINGS L L C	8912 SPANISH RIDGE AVE #200 LAS VEGAS NV 89148-1312	12517716045
HARMONY SPRINGS L L C	8912 SPANISH RIDGE AVE #200 LAS VEGAS NV 89148-1312	12517714042
HARMONY SPRINGS L L C	8912 SPANISH RIDGE AVE #200 LAS VEGAS NV 89148-1312	12517715042
HARMONY SPRINGS L L C	8912 SPANISH RIDGE AVE #200 LAS VEGAS NV 89148-1312	12517715032
HARMONY SPRINGS L L C	8912 SPANISH RIDGE AVE #200 LAS VEGAS NV 89148-1312	12517716049
HARMONY SPRINGS L L C	8912 SPANISH RIDGE AVE #200 LAS VEGAS NV 89148-1312	12517716050
HARMONY SPRINGS L L C	8912 SPANISH RIDGE AVE #200 LAS VEGAS NV 89148-1312	12517716022
HARMONY SPRINGS L L C	8912 SPANISH RIDGE AVE #200 LAS VEGAS NV 89148-1312	12517716042
HARMONY SPRINGS L L C	8912 SPANISH RIDGE AVE #200 LAS VEGAS NV 89148-1312	12517715035
HARMONY SPRINGS L L C	8912 SPANISH RIDGE AVE #200 LAS VEGAS NV 89148-1312	12517715033
HARMONY SPRINGS PARTNERS L L C	8912 SPANISH RIDGE AVE #200 LAS VEGAS NV 89148-1312	12517711059
HARRIS JUDY L	8360 FORT SEDGWICK AVE LAS VEGAS NV 89131-8193	12516319013
HARTER MICHAEL J & AMANDA L	7944 QUAIL HARBOR ST LAS VEGAS NV 89131-4676	12516115014
HARTMAN JERRY E & STACEY LYNN	HARTMAN JERRY E & STACEY LYNN 8212 FRITZEN AVE LAS VEGAS NV 89131-4635	12516213012
HARTY WILLIAM R & SUSANA C	8327 FORT HALLOCK AVE LAS VEGAS NV 89131-8194	12516319028
HARTZELL STEVEN & STEPHANIE	8513 TIMBER PINE AVE LAS VEGAS NV 89143-4611	12517517019
HAUG BRENT RANDALL	8504 GRACIOUS PINE AVE LAS VEGAS NV 89143-4609	12517511010
HAWVER MARY TRUST	KNOWLTON CHRISTINE TRUST 1111 KINGFISH PL APOLLO BEACH FL 33572-3057	12517520015
HAYDEN SPRINGS L L C	1291 GALLERIA DR #290 HENDERSON NV 89014-8605	12517710009
HAYES FAMILY TRUST	HAYES EDDIE R & LYNDA K TRS 8545 HIDDEN PINES AVE LAS VEGAS NV 89143-1369	12517521017
HEADRICK JERRY L JR	8532 HIDDEN PINES AVE LAS VEGAS NV 89143-1369	12517521004
HELLUMS THOMAS L & NORMA J	8328 BLUSHING HEIGHTS AVE LAS VEGAS NV 89131-4610	12516110010
HENDERSON HORRACE & V REV LIV TR	7513 FLAT ROCK LAS VEGAS NV 89131-4516	12516311020
HENDRICKSON SHERIE G	8368 FORT SEDGWICK AVE LAS VEGAS NV 89131-8193	12516319015
HENRIE CAL D & SARAH R	7458 PEMBER ST LAS VEGAS NV 89143-1312	12517711055
HERNANDEZ JOSE M	8325 VALLEY STREAM AVE LAS VEGAS NV 89131-4616	12516211013

Report of All Selected Parcels**Case Number:** ROC-42637**Printed On:** Wed: July 27, 2011

<u>Owner</u>	<u>Address</u>	<u>Parcel Numbe</u>
HERNANDEZ ROSALBA	8524 GRACIOUS PINE AVE LAS VEGAS NV 89143-4609	12517511015
HERRERA ANNA	3962 60TH ST #62 SAN DIEGO CA 92115-6539	12516311006
HERRERA KENNETH C & THERESA C	8601 HIDDEN PINES AVE LAS VEGAS NV 89143-1367	12517519033
HERRICK BRIAN S & SHANNON	7821 FALLING PINES PL LAS VEGAS NV 89143-4455	12517527003
HESS BARRY E & MAUREEN D	8309 JO MARCY DR LAS VEGAS NV 89131-4600	12516110037
HETU JASON	7524 WANDERING ST LAS VEGAS NV 89131-4583	12516313015
HICKS EDITH	8433 CHEERFUL BROOK AVE LAS VEGAS NV 89143-5191	12508815061
HICKSTEIN JEFFREY BRUCE & ZONA L	8529 TIMBER PINE AVE LAS VEGAS NV 89143-4612	12517515014
HIGA WILLIAM & LILLIAN	8587 SHADY PINES DR LAS VEGAS NV 89143-4452	12517526009
HILL WILLIAM L JR & STACEY M	9300 BRILLIANT ORE DR LAS VEGAS NV 89143-2305	12517520018
HILTON STEVE L & MARTITA	7719 MAPLE MEADOW ST LAS VEGAS NV 89131-4666	12516214006
HISCOCKS KENNETH G & NATALI A	7517 FENCEROW ST LAS VEGAS NV 89131-4548	12516313064
HOCKENBERRY STEVE M & MELINDA G	8520 GRACIOUS PINE AVE LAS VEGAS NV 89143-4609	12517511014
HOESEL DARIN & GINA	9420 SHELLFISH CT LAS VEGAS NV 89117-0267	12516212002
HOGAN KEITH	FEIN RUTHANNE 8323 FORT HALLOCK AVE LAS VEGAS NV 89131-8194	12516319029
HOLBROOK CLAYTON L	8324 DAWN BREEZE AVE LAS VEGAS NV 89131-4613	12516110041
HOLGUIN SILVERIO C & ROMELIA	8460 TRUDEAU AVE LAS VEGAS NV 89143-1309	12517710013
HOLYOAK ZACHARY D & JODEE	8529 CHEERFUL BROOK AVE LAS VEGAS NV 89143-5193	12508815015
HOOD LAURANN	8200 VALLEY STREAM AVE LAS VEGAS NV 89131-4633	12516212029
HOOPER TONI TRUST	HOOPER THELDA F TRS 8309 GORSKY DR LAS VEGAS NV 89131-4620	12516210034
HOPPING CHARLES A & CARMEN	NICODEMO ANTONIO N 8725 SHADY PINES DR LAS VEGAS NV 89143-4459	12517524006
HORSEMAN MARLIN L & DAWN M	8221 VALLEY STREAM AVE LAS VEGAS NV 89131-4633	12516212016
HOSKINS CANDICE	8588 BLOWING PINES DR LAS VEGAS NV 89143-4463	12517526022
HOUGH STEVEN DONALD & KAREN R	8212 GORSKY AVE LAS VEGAS NV 89131-4623	12516213028
HOWARD CHRISTOPHER	8346 FORT HALLOCKA AVE LAS VEGAS NV 89131-8195	12516319040
HOWARD JARED W	8303 MARTINBOROUGH AVE LAS VEGAS NV 89131-4816	12516117035
HOWELL ARIANA	HOWELL GARY & BARBARA 7533 FENCEROW ST LAS VEGAS NV 89131-4548	12516313060
HOWELL LANCE & AUBREY	8320 JO MARCY DR LAS VEGAS NV 89131-4601	12516117040
HOXHA ILIE & LAURESHA	350 11TH AVE #3 SAN FRANCISCO CA 94118-2132	12509413036
HUANG PEISONG	XU YING 1714 BIESTERFIELD RD ELK GROVE IL 60007-2772	12517521005
HUN L L C	%P VICZKO 9245 W CRAIG RD LAS VEGAS NV 89129-2655	12516111049
HUNT JASON T & TAMMI L	8552 HIDDEN PINES AVE LAS VEGAS NV 89143-1368	12517521009

Report of All Selected Parcels**Case Number:** ROC-42637**Printed On:** Wed: July 27, 2011

<u>Owner</u>	<u>Address</u>	<u>Parcel Numbe</u>
HUNTON LYNN M & WENDY R	8628 SHADY PINES DR LAS VEGAS NV 89143-4453	12517525008
HYMAN NELLIE TRUST	HYMAN NELLIE A TRS 8276 AURORA PEAK AVE LAS VEGAS NV 89131-4627	12516111015
IJIDAKINRO CLEMENT B	8605 BLOWING PINES DR LAS VEGAS NV 89143-4464	12517527010
IMHOFF DENNIS & MARIE	7549 FLAT ROCK ST LAS VEGAS NV 89131-4517	12516311011
ISZKIEWICZ JOSEPH	ISZKIEWICZ MARK 7924 NAPIER ST LAS VEGAS NV 89131-4603	12516117068
JACKLIN ANNE K	10029 SCENIC WALK AVE LAS VEGAS NV 89149-3774	12516213029
JACKMAN RACHELLE L	MONTGOMERY LESLEY JAMES 8217 GORSKY AVE LAS VEGAS NV 89131-4623	12516213034
JAEGER DELORES J	8208 VALLEY STREAM AVE LAS VEGAS NV 89131-4633	12516212028
JAKOBIAK CHRISTOPHER D	8416 SHADY PINES DR LAS VEGAS NV 89131-8133	12517528023
JAKOVAC THEODORE A 2008 REV TR	8544 TIMBER PINE AVE LAS VEGAS NV 89143-4612	12517515019
JAMES CAROLYN A	7800 WAVERING PINE DR LAS VEGAS NV 89143-1378	12517520022
JAMES STANLEY G & RHONDA J	8312 IMPATIENTS AVE LAS VEGAS NV 89131-4617	12516211038
JAX THAO T FAMILY REVOCABLE TR	JAX THAO T TRS 7417 FLAT ROCK ST LAS VEGAS NV 89131-4519	12516311029
JEFFRES RALPH & PAMELA L	8305 GORKSY AVE LAS VEGAS NV 89131	12516210033
JENKINS DAWN	7908 QUICK PINE ST LAS VEGAS NV 89143-1354	12517516024
JENNINGS NANCY REVOCABLE TRUST	JENNINGS NANCY TRS 9412 MT CASH AVE #101 LAS VEGAS NV 89129-7553	12516313058
JENSEN GARY W & CYNTHIA L	8324 IMPATIENTS AVE LAS VEGAS NV 89131-4617	12516211035
JIMENEZ ADRIAN D	HERNANDEZ VALERIE 8528 HIDDEN PINES AVE LAS VEGAS NV 89143-1369	12517521003
JIMENEZ MARK A	8292 AURORA PEAK AVE LAS VEGAS NV 89131-4628	12516111019
JOHN KENT D	8619 SHADY PINES DR LAS VEGAS NV 89143-4453	12517526003
JOHNSON MONA	7712 WINDSWEPT ST LAS VEGAS NV 89131-4637	12516213004
JONES FREDERICK S & SHIRLEY Y	7705 KIOWA POINTE ST LAS VEGAS NV 89131-4615	12516210002
JONES KENNETH L & MELINDA A	7245 SILVER CHARM CT NO LAS VEGAS NV 89131-4129	12516311065
JONES PEGGY S	8421 TIMBER PINE AVE LAS VEGAS NV 89143-4614	12517517001
JORDAN SIMON	8245 QUAIL ARROYO AVE LAS VEGAS NV 89131-4674	12516115035
JORDAN TIMOTHY & DAPHNE	8505 CHEERFUL BROOK AVE LAS VEGAS NV 89143-5192	12508815009
JORGENSEN NORMAN SR	7804 GLOWING PEAK ST LAS VEGAS NV 89131-4612	12516110028
JOSEPH GARY	MCCLANE LISA 8229 FRITZEN AVE LAS VEGAS NV 89131-4635	12516213018
K J D PROPERTIES L L C	2231 S MONTE CRISTO WY LAS VEGAS NV 89117-2713	12508815002
KADAGIAN FAMILY TRUST	11024 ARBOR PINE AVE LAS VEGAS NV 89144-1615	12516316031
KAHN BRUCE R	P O BOX 16724 MINNEAPOLIS MN 55416-0724	12516319006
KAHN ERLINDA B & RICHARD S	4602 KELLY ELLIOTT RD ARLINGTON TX 76017-1354	12517717003

Report of All Selected Parcels**Case Number:** ROC-42637**Printed On:** Wed: July 27, 2011

<u>Owner</u>	<u>Address</u>	<u>Parcel Number</u>
KALLERSON BERNADINE A	8265 QUAIL ARROYO AVE LAS VEGAS NV 89131-4674	12516115030
KAMPER KENNETH J & BARBARA A	DAVIS JOHN M 8305 DAWN BREEZE AVE LAS VEGAS NV 89131-4614	12516110025
KARIC CHRISTOPHER K & STEPHANIE	NAKAMAE ROBERT A & GWEN F 45894 BRIDGEPORT PL FREMONT CA 94539-6854	12517526008
KAROSA LAURA	8408 TOUGH PINE CT LAS VEGAS NV 89131-8153	12517528016
KAWAGUCHI KENNETH R	7523 LITTLE LARAMIE ST LAS VEGAS NV 89131-8196	12516319017
KEEBLER RANDOLPH S	7424 FLAT ROCK ST LAS VEGAS NV 89131-4520	12516311061
KEEFER MANDY J	7409 MOUNTAIN THICKET ST LAS VEGAS NV 89131-4542	12516415039
KEHOE RICHARD J JR	6780 ABRUZZI DR #102 NO LAS VEGAS NV 89084-5463	12516117056
KELLEY KELLY	8437 ORLY AVE LAS VEGAS NV 89143-6008	12517717001
KELLOGG GERALD	2075 VILLAGE CENTER CIR LAS VEGAS NV 89134-6251	12517521024
KELLOGG PHILLIP M & ROSELYNNE M	8225 GORSKY AVE LAS VEGAS NV 89131-4623	12516213032
KELLY DANIEL L & PATRICIA K	8316 VALLEY STREAM LAS VEGAS NV 89131-4616	12516211025
KELSEY MICHELE & EDWARD C	BEEBE SHIRLEY 8279 AURORA PEAK AVE LAS VEGAS NV 89131-4627	12516111038
KELSO BRENDA A & NEAL L	8213 VALLEY STREAM AVE LAS VEGAS NV 89131-4633	12516212014
KENNEDY GEORGIA TRUST	KENNEDY GEORGIA TRS 2044 PECAN TREE ST HEMET CA 92545-8181	12516117001
KERN MICHAEL W & LADAWN	3646 FERNDALE COVE DR LAS VEGAS NV 89129-7012	12517515015
KERTISS STUART A & MARCIA A	8317 GORSKY AVE LAS VEGAS NV 89131-4620	12516210036
KESLING CHARLES F & NORMA J	7624 WINDSWEPT ST LAS VEGAS NV 89131-4636	12516212004
KETTLESON KENNETH	7948 CAPE BRETT ST LAS VEGAS NV 89131-4602	12516117004
KIEHL WILLIAM A & SANDRA M	10408 ABISSO DR LAS VEGAS NV 89135-2571	12517524010
KILGORE THERESA M REVOCABLE TR	KILGORE THERESA M TRS 7537 FLAT ROCK ST LAS VEGAS NV 89131-4517	12516311014
KILIAN CHRISTINE MARIE	8305 VALLEY STREAM AVE LAS VEGAS NV 89131-4616	12516211018
KILLEBREW BONNIE J & ROBERT J	7625 KIOWA POINTE ST LAS VEGAS NV 89131-4619	12516211003
KIMBALL JAMES M	9085 W EL CAMPO GRANDE LAS VEGAS NV 89149-3318	12516110006
KIRCHNER STEVEN E	7923 NAPIER ST LAS VEGAS NV 89131-4603	12516117057
KITE ALAN J	6868 SKY POINT DR #2082 LAS VEGAS NV 89131-6117	12517715023
KJOS RONALD M	RICHTER ALEIT E 8221 IMPATIENTS AVE LAS VEGAS NV 89131-4634	12516212035
KLEIN DAVID	7936 QUAIL HEAVEN ST LAS VEGAS NV 89131-4678	12516115036
KLEISNER CARL J & CHRISTINA L	7433 FENCEROW ST LAS VEGAS NV 89131-4546	12516313070
KLESEL JACOB A	8577 HIDDEN PINES AVE LAS VEGAS NV 89143-1368	12517521011
KLOBCHAR JOHN JAMES	8521 HIDDEN PINES AVE LAS VEGAS NV 89143-1369	12517520007
KNIGHT VIRGLE	1351 N W LUOTO CT POULSBO WA 98370-8289	12517528014

Report of All Selected Parcels**Case Number:** ROC-42637**Printed On:** Wed: July 27, 2011

<u>Owner</u>	<u>Address</u>	<u>Parcel Numbe</u>
KNORR DAVID G & PATRICIA A	268 S CENTER ST ORANGE CA 92866-2075	12517525007
KOBIELSKY MICHAEL T	BOWERS ROBIN L 8316 LAMBTIN QUAY AVE LAS VEGAS NV 89131-4814	12516117008
KOEHLER STEPHEN A & CHERRY L	155 RICHLAND CT GALLATIN TN 37066-3018	12517710012
KOHN FAMILY TRUST	KOHN HARVEY L & ELAINE TRS 3001 ISAAC RIVER DR LAS VEGAS NV 89134-7521	12517521031
KONG MICHAEL H	8713 SHADY PINES DR LAS VEGAS NV 89143-4459	12517524009
KOSASIH BETTY	111 N CURTIS AVE #N ALHAMBRA CA 91801-6919	12516311066
KOVALCIN JOHN A	8018 BASE CAMP AVE LAS VEGAS NV 89178-4884	12516319044
KOWALSKI CRAIG	1905 RED ROBIN CT LAS VEGAS NV 89134-6157	12516311073
KREKORIAN TRUST	KREKORIAN KAISER & MARGUERITE 8297 JO MARCY DR LAS VEGAS NV 89131-4625	12516111001
KRIEGH B LANCE JR & MARIA	7540 WANDERING ST LAS VEGAS NV 89131-4566	12516313019
KRONENBERG GARY R	8316 BLUSHING HEIGHTS AVE LAS VEGAS NV 89131-4610	12516110007
KUNDINGER BRIAN H	8265 JO MARCY DR LAS VEGAS NV 89131-4625	12516111009
KURLISH DENNIS B & NANCY A	5825 REVITAL CT LAS VEGAS NV 89131-2855	12516312037
KYLE BRYAN & FADRA	916 WHITE FEATHER LAS VEGAS NV 89138-6056	12517710002
LAIRD STEPHEN W	MULLER MICHAEL K 4684 SADDLEHORN CIR LANGLEY BC V22 227 CANADA	12517527011
LAMOREAUX ROBERT C & SHERRY LEE	8249 AURORA PEAK AVE LAS VEGAS NV 89131-4632	12516114055
LAMUNYON SHIRLEE	8644 SHADY PINES LAS VEGAS NV 89143-4453	12517525004
LANAHAN JOSEPH L JR & JUNE A TR	LANAHAN JOSEPH L JR & JUNE A TRS 7608 ROOP ST LAS VEGAS NV 89131-4621	12516212022
LARSON GLEN LIVING TRUST	%G LARSON P O BOX 364857 NO LAS VEGAS NV 89036-8857	12516311057
LARSON KRISTOPHER D	8501 CHEERFUL BROOK AVE LAS VEGAS NV 89143-5192	12508815008
LAS VEGAS QUALITY HOMES L L C	6785 S EASTERN AVE #6 LAS VEGAS NV 89119	12516110026
LASKOWSKI GINA	BAILEY SILVIA CARMINA 8433 ORLY AVE LAS VEGAS NV 89143-6008	12517717002
LAUER HEINZ J	MCCARTNEY-LAUER LISA K 8324 GORSKY AVE LAS VEGAS NV 89131-4620	12516210025
LEAVITT MELVIN & ORA ANN	7445 WANDERING ST LAS VEGAS NV 89131-4540	12516313034
LEE SUN & ANGELA	3538 MAPLE LEAF DR GLENVIEW IL 60026-1159	12517519023
LEGORY LEE J	7525 WANDERING ST LAS VEGAS NV 89131-4584	12516313026
LEIB TIFFANIE	8569 HIDDEN PINES AVE LAS VEGAS NV 89143-1368	12517521013
LEIDY RONALD H & NANCY M	7841 WAVERING PINE DR LAS VEGAS NV 89143-1379	12517520006
LENGSAVATH CHANPHENG & MELINDA Y	LENGSAVATH RUBY M 2259 AUTUMN FIRE CT LAS VEGAS NV 89117-8955	12516215001
LEON ENRIQUE & ERIC	HERNANDEZ YOLANDA %ERIC LEON SR 204 SUNBEAM DR LAS VEGAS NV 89107-1716	12517514015
LEONARD GREG & CAROL	8204 IMPATIENTS AVE LAS VEGAS NV 89131-4634	12516212042
LEWIS DAVID A	8217 VALLEY STREAM AVE LAS VEGAS NV 89131-4633	12516212015

Report of All Selected Parcels**Case Number:** ROC-42637**Printed On:** Wed: July 27, 2011

<u>Owner</u>	<u>Address</u>	<u>Parcel Number</u>
LEWIS TORY A	8356 FORT SEDGWICK LAS VEGAS NV 89131-8193	12516319012
LEWTON BRADLEY A & STEPHANIE C	7600 WINDSWEPT ST LAS VEGAS NV 89131-4636	12516212010
LICCARDI EUGENE J & NANCY	8140 PEMBA AVE LAS VEGAS NV 89131-4642	12516214002
LIN CHIEN-TIN	NO 5 JIANG GUO RD PING TUNG COUNTY TAIWAN 91252	12516212012
LINDIG RICHARD D SR & SUSAN P	8521 TIMBER PINE AVE LAS VEGAS NV 89143-4611	12517517017
LIVINGSTON DARLA M	8592 BLOWING PINES DR LAS VEGAS NV 89143-4463	12517526023
LIVINGSTON F MARVIN & ADRIENNE C	8605 HIDDEN PINES AVE LAS VEGAS NV 89143-1367	12517519032
LOCCISANO NICHOLAS & CARMEN	9013 WIND WARRIOR AVE LAS VEGAS NV 89143-5414	12517510012
LOCKE JOHN R	8521 GRACIOUS PINE AVE LAS VEGAS NV 89143-4609	12517511017
LOHAN LIVING TRUST	LOHAN BERNARD & SHIRLEY E TRS 8609 MAJESTIC PINE AVE LAS VEGAS NV 89143-1349	12517514017
LOMPREY JEFFREY E	8353 FORT SEDGWICK AVE LAS VEGAS NV 89131-8193	12516319043
LONG RAYSEL	8557 HIDDEN PINES AVE LAS VEGAS NV 89143-1368	12517521014
LOPEZ OSCAR	7505 FLAT ROCK ST LAS VEGAS NV 89131-4516	12516311022
LOVE THOMAS T & SHIRLEY A	P O BOX 674 MEADOW VISTA CA 95722-0674	12516312003
LOWE MAURY	8560 SHADY PINES DR LAS VEGAS NV 89143-4451	12517521029
LOYA ARNOLDO	HERNANDEZ MARISA P O BOX 750772 LAS VEGAS NV 89136-0772	12517710008
LU SHI HUI	8981 OCEANSIDE SLOPES AVE LAS VEGAS NV 89178-7525	12517526013
LUBLIN FAMILY LIVING TRUST	LUBLIN DAVID & KAREN M TRS 8260 ORANGE VALE AVE LAS VEGAS NV 89131-4629	12516111044
LUCE PAMELA J	8541 HIDDEN PINES AVE LAS VEGAS NV 89143-1369	12517521018
LUNA FELIX M	7447 NICKLIN ST LAS VEGAS NV 89143-2000	12517715018
LUNSFORD JAMES W & BETTY REV TR	7945 HOLLOW PINE ST LAS VEGAS NV 89143-4613	12517515002
LURIE DAVID L	8312 SPRUCE MEADOWS AVE LAS VEGAS NV 89131-4581	12516312010
LYMAN RITCHEY & RITA	8136 MARIN POINTE AVE LAS VEGAS NV 89131-4664	12516214010
LYNCH MICHAEL B	7561 COSTANOA ST LAS VEGAS NV 89123-1585	12517524018
M & V ENTERPRISES L L C	11233 E RUSH ST S EL MONTE CA 91733-3550	12517516006
MACDONALD ERIC D	7621 KIOWA POINTE ST LAS VEGAS NV 89131-4619	12516211004
MACIAS JOSE A	8224 MORADI AVE LAS VEGAS NV 89131-4513	12516311007
MACIEL EDGAR SAUL & JACQUELINE	8608 SHADY PINES DR LAS VEGAS NV 89143-4453	12517525013
MACQUILLAN ANTHONY	7720 WINDSWEPT ST LAS VEGAS NV 89131-4637	12516213006
MAGAT RONALD F & CECILIA V	8509 CHEERFUL BROOK AVE LAS VEGAS NV 89143-5192	12508815010
MAH DIANA E	JIMENEZ JAMES A 7715 MAPLE MEADOW ST LAS VEGAS NV 89131-4666	12516214005
MAHALAK GREGORY E & JOSEFINA B	8216 IMPATIENTS AVE LAS VEGAS NV 89131-4634	12516212039

Report of All Selected Parcels**Case Number:** ROC-42637**Printed On:** Wed: July 27, 2011

<u>Owner</u>	<u>Address</u>	<u>Parcel Number</u>
MALINAK JOSEPH A & ROBERT J	7635 MAPLE MEADOW ST LAS VEGAS NV 89131-4665	12516215004
MALONE DANNY L	MILLER KELLY L 7943 QUAIL HEAVEN ST LAS VEGAS NV 89131-4678	12516115025
MALONEY DAVID M & MICHELE R	8409 TOUGH PINE CT LAS VEGAS NV 89131-8153	12517528020
MALONZO JOSE	8432 TRUDEAU AVE LAS VEGAS NV 89143-1307	12517717011
MANDAC MICHELLE	PACHECO BRADSHAW 7956 NAPIER ST LAS VEGAS NV 89131-4603	12516117064
MANOR JERMOND L	8257 QUAIL ARROYO AVE LAS VEGAS NV 89131-4674	12516115032
MANUELI EMILIO & ASSUNTA	10224 ALL SEASONS ST LAS VEGAS NV 89131-1535	12516210026
MARRUFO FORTUNATO & MARIA REV TR	MARRUFO FORTUNATO R & MARIA TRS 7505 FENCEROW ST LAS VEGAS NV 89131-4546	12516313067
MARSEE MICHELE R & VICKY S	7408 MOUNTAIN THICKET ST LAS VEGAS NV 89131-4542	12516415038
MARTENSEN JOHN W & JANICE F	8701 GRAND PINE AVE LAS VEGAS NV 89143-1356	12517518020
MARTINEZ FAMILY REVOCABLE LIV TR	MARTINEZ LOUIS & MARIA R TRS 7513 MOUNTAIN QUAIL AVE LAS VEGAS NV 89131-3216	12517519008
MARTINEZ JULIAN A & ALMA	7516 FLAT ROCK ST LAS VEGAS NV 89131-4515	12516311069
MARTINEZ STEVE & CARRIE	8209 FRITZEN AVE LAS VEGAS NV 89131-4635	12516213023
MATHEWS TIMOTHY O & JILL M	8604 SHADY PINES DR LAS VEGAS NV 89143-4452	12517525014
MATSON PAUL W & ROBYN	8312 VALLEY STREAM AVE LAS VEGAS NV 89131-4616	12516211024
MAY JESSICA R & MICHAEL A	8608 GRAND PINE AVE LAS VEGAS NV 89143-1352	12517516016
MCALPIN PHILIP B JR	7940 NAPIER ST LAS VEGAS NV 89131-4603	12516117066
MCBURNEY THERESA L	3 VISTA REAL DR ROLLING HILLS ESTATES CA 90274-4227	12517526018
MCCALL REESE	8335 FORT HALLOCK AVE LAS VEGAS NV 89131-8195	12516319026
MCCAY EDWARD G & RANDI F	8413 TIMBER PINE AVE LAS VEGAS NV 89143-4614	12517517003
MCDONALDS CORPORATION	%27-0281 P O BOX 182571 COLUMBUS OH 43218-2571	12517610010
MCGAUGHEY ADAM J	SPANGLER JENNIFER P O BOX 570296 LAS VEGAS NV 89157-0296	12517528010
MCGINN WILLIAM COLLINS & VERA M	8272 ORANGE VALE AVE LAS VEGAS NV 89131-4629	12516111047
MCLAUGHLIN DOUGLAS W	7800 GLOWING PEAK ST LAS VEGAS NV 89131-4612	12516110027
MCMAHAN DOUGLAS & ANN E	8288 AURORA PEAK AVE LAS VEGAS NV 89131-4628	12516111018
MCMURTREY ERIC K & APRIL J	1639 VASCO ST MANTECA CA 95337-8787	12517520030
MENDEZ TEODORO JR	PARRA-MENDEZ VERONICA 8616 SHADY PINES DR LAS VEGAS NV 89143-4453	12517525011
MERCADO ANTONIO & MARIA G	7508 WANDERING ST LAS VEGAS NV 89131-4583	12516313011
MERON MATT & SUZY	3613 ALCANTARA LN NO LAS VEGAS NV 89084-2342	12517527012
MERRIWEATHER DANTE L	8409 GRACIOUS PINE AVE LAS VEGAS NV 89143-4608	12517511002
METTLER JAMES F	7828 WAVERING PINE DR LAS VEGAS NV 89143-1378	12517520028
MEYER CHRISTOPHER & TAMARA	7940 QUAIL HEAVEN ST LAS VEGAS NV 89131-4678	12516115037

Report of All Selected Parcels**Case Number:** ROC-42637**Printed On:** Wed: July 27, 2011

<u>Owner</u>	<u>Address</u>	<u>Parcel Number</u>
MICHALEK CHARLES	8608 BLOWING PINES DR LAS VEGAS NV 89143-4464	12517526027
MICKELSON RALPH R & HEATHER L	7939 QUAIL PRAIRIE LAS VEGAS NV 89131-4677	12516115010
MIKHAIL HESHAM	DUVA-MIKHAIL DONNA M 8284 ORANGE VALE AVE LAS VEGAS NV 89131-4629	12516111050
MILLER EDWARD	7817 FALLING PINES PL LAS VEGAS NV 89143-4455	12517527004
MILLER JOSEPH H & BARBARA B	8250 ORANGE VALE AVE LAS VEGAS NV 89131-4652	12516114040
MILLER WILLIAM D & ANN M	7929 HOLLOW PINE ST LAS VEGAS NV 89143-4613	12517515006
MIRABEL CINDY L	P O BOX 2113 DOWNEY CA 90242-0113	12517520002
MIST L L C	1126 TEAKWOOD RANCH HENDERSON NV 89052-5832	12516111008
MITCHELL JONATHAN & AMANDA	8345 JO MARCY DR LAS VEGAS NV 89131-4607	12516110001
MITCHELL REGINALD M	8600 GRAND PINE AVE LAS VEGAS NV 89143-1352	12517516018
MITCHELL SCOTT C LIVING TRUST	MITCHELL SCOTT C TRS 7529 WANDERING ST LAS VEGAS NV 89131-4584	12516313025
MIZRAHI DAVID	6245 WHISPERING BROOK CT LAS VEGAS NV 89149-3215	12516215006
MOLINERI DANIEL & NICOLE	7817 LIGHT BLOOM LAS VEGAS NV 89131-4626	12516111022
MONARCO JAY A & MONICA	7951 QUAIL HARBOR ST LAS VEGAS NV 89131-4676	12516115041
MONGOLO JACK & BERTHA REV LIV TR	MONGOLO JACK V & BERTHA A TRS 8584 BLOWING PINES DR LAS VEGAS NV 89143-4463	12517526021
MONTECINO LANCE	7844 WAVERING PINE DR LAS VEGAS NV 89143-1379	12517520032
MONTESA L L C	3430 BUNKERHILL ST #A NO LAS VEGAS NV 89032-6011	12517524002
MONTOYA ANDRES	8328 FRITZEN AVE LAS VEGAS NV 89131-4608	12516210010
MONTOYA GILBERT & CAROLINE	5200 WHITE COYOTE PL LAS VEGAS NV 89130-1617	12516313016
MOORE FAMILY TRUST	MOORE MICKEY LEE & A SYLVIA TRS 7616 ROOP ST LAS VEGAS NV 89131-4621	12516212020
MORACHE NOLAN T	8612 HIDDEN PINES AVE LAS VEGAS NV 89143-1367	12517519009
MORALES RAYMOND J	80 BROOK AVE BAYSHORE NY 11706-7424	12517510018
MOREQUITY INC	350 HIGHLAND DR LEWISVILLE TX 75067-4177	12517519010
MORGAN JOSEPH B & CRYSTAL M	8457 BELLERY AVE LAS VEGAS NV 89143-1314	12517711038
MORHIG ALAN J	8416 BELLERY AVE LAS VEGAS NV 89143-1313	12517711025
MORRIS MATTHEW	8343 FORT HALLOCK AVE LAS VEGAS NV 89131-8195	12516319024
MORRIS T BROCK & MARIANNE	7611 MAPLE MEADOW LAS VEGAS NV 89131-4665	12516215010
MORRISON CHARLES JOHN ETAL	8332 JO MARCY DR LAS VEGAS NV 89131-4601	12516117043
MORRISON MICHAEL & AMANDA	MARSHALL MELINDA 8343 MARTINBOROUGH AVE LAS VEGAS NV 89131-4816	12516117025
MORRISON NATHAN A	HUMPHREY KARIN A 9024 SAW HORSE ST LAS VEGAS NV 89143-5421	12517517004
MORRISSEY DANIEL P	8464 TRUDEAU AVE LAS VEGAS NV 89143-1309	12517710014
MORTON BRITT L 2001 LIVING TRUST	MORTON TONIDIANE TRS 505 YACHT HARBOR DR LAS VEGAS NV 89145-5969	12516313013

Report of All Selected Parcels**Case Number:** ROC-42637**Printed On:** Wed: July 27, 2011

<u>Owner</u>	<u>Address</u>	<u>Parcel Numbe</u>
MOSIER PENNY R	8401 GRACIOUS PINE AVE LAS VEGAS NV 89143-4608	12517511003
MOSKAL JASON WALTER	7524 FLAT ROCK ST LAS VEGAS NV 89131-4515	12516311071
MOSS WILLIAM E & MARY P	8540 HIDDEN PINES AVE LAS VEGAS NV 89143-1369	12517521006
MOYES MALLORY	7809 LIGHT BLOOM ST LAS VEGAS NV 89131-4626	12516111023
MUCCIO ANTHONY V 2010 REV TR	8313 DAWN BREEZE AVE LAS VEGAS NV 89131-4614	12516110023
MUCKELVANE LYNN L & KAROLINE	7536 WANDERING ST LAS VEGAS NV 89131-4566	12516313018
MUNIZ HECTOR & KAREN J	7446 PEMBER ST LAS VEGAS NV 89143-1312	12517711052
MURPHY EUGENE & HATSUKO KIYUNA	8277 ORANGE VALE AVE LAS VEGAS NV 89131-4629	12516111031
MURRAY BEVERLY J	RUEGNER RAWNICA 8273 JO MARCY DR LAS VEGAS NV 89131-4625	12516111007
MUSINSKI CHRISTOPHER	8339 FORT HALLOCK AVE LAS VEGAS NV 89131-8195	12516319025
MYER DAVID & JENNIFER	8576 BLOWING PINES DR LAS VEGAS NV 89143-4462	12517526019
MYERS TODD & TAMMY	8208 FRITZEN AVE LAS VEGAS NV 89131-4635	12516213011
N S SOUTHWEST #4 L L C	%NOVA SOURCE DEV %B DAVIS 2180 S 1300 E #410 SALT LAKE CITY UT 84106-2813	12508813008
NAKAGUCHI WESLEY	6541 SHADY PINES DR LAS VEGAS NV 89143	12517521033
NAPIER NEAL E	KRUSE BOBBY 7912 QUICK PINE ST LAS VEGAS NV 89143-1354	12517516023
NATOUR ALEXANDER F	7856 WAVERING PINE DR LAS VEGAS NV 89143-1379	12517520035
NAVALTA DEAN O & JULIA V	8436 BELLERY AVE LAS VEGAS NV 89143-1313	12517711030
NEHME DORIS E	7860 WAVERING PINE DR LAS VEGAS NV 89143-1379	12517520036
NELSON BARBARA J	1124 SE SENTRY DR COLLEGE PLACE WA 99324-4007	12516111029
NELSON FAMILY TRUST	NELSON MICHAEL L & NOEL C TRS 8301 GORSKY AVE LAS VEGAS NV 89131-4620	12516210032
NELSON KRISTOFFER G	MCFARLAND CHEYANNE A 8315 FORT SEDGWICK AVE LAS VEGAS NV 89131-8192	12516319050
NEVADA NEW BUILDS L L C	%RANA JOHN F & CONNIE L 4239 FIORE BELLA BLVD LAS VEGAS NV 89135-2444	12516115042
NEVADA NEW BUILDS L L C	4239 FIORE BELLA BLVD LAS VEGAS NV 89135-2444	12517516002
NEVADA NEW BUILDS L L C	6130 W ELTON AVE #102 LAS VEGAS NV 89107-2538	12517524003
NEW ALBERTSON'S INC	%DEPT 70428-CORPORATE TAX 250 PARKCENTER BLVD P O BOX 20 BOISE ID 83726-0020	12517610011
NEWMAN BRANDY J & JAMES D	8297 ORANGE VALE AVE LAS VEGAS NV 89131-4630	12516111026
NEWTON TYLER W & CARRIE A	8304 SPRUCE MEADOWS AVE LAS VEGAS NV 89131-4581	12516312008
NGUYEN ANH THU T	8333 JO MARCY DR LAS VEGAS NV 89131-4607	12516110004
NIELSEN JOHN S JR & SUSAN K	7813 BRIGHT HEIGHTS ST LAS VEGAS NV 89131-4611	12516110014
NIELSON STEPHEN B & PATTY S TR	NIELSON STEPHEN B & PATTY S TRS 7605 ROOP ST LAS VEGAS NV 89131-4621	12516211023
NIETO KENNETH LEO	7425 ALPINE RIDGE ST LAS VEGAS NV 89131-4562	12516312032
NIEVES JULIO & BIANCA	7515 LITTLE LARAMIE ST LAS VEGAS NV 89131-8196	12516319019

Report of All Selected Parcels**Case Number:** ROC-42637**Printed On:** Wed: July 27, 2011

<u>Owner</u>	<u>Address</u>	<u>Parcel Numbe</u>
NIXON DANNY S & KELLY L	8717 HIDDEN PINES AVE LAS VEGAS NV 89143-1366	12517519018
NOLAND ROSEMARIE REVOCABLE TRUST	ROBINSON FRANK W SR TRS 7480 W VERDE WY LAS VEGAS NV 89149-5827	12517511016
NORDBYE GARY & TERRI	8253 QUAIL ARROYO AVE LAS VEGAS NV 89131-4674	12516115033
NORDEEN WILLIAM F & CAROL A	7821 BRIGHT HEIGHTS LAS VEGAS NV 89131-4611	12516110012
NORDIN WARD E	8528 SHADY PINES DR LAS VEGAS NV 89143-4451	12517520009
NORTHWEST 95 L L C	3455 CLIFF SHADOW PKWY #220 LAS VEGAS NV 89129-1077	12517702001
NOVAK SUSAN & THOMAS R	7805 BRIGHT HEIGHTS ST LAS VEGAS NV 89131-4611	12516113001
NOVICK ANNA MARIE	8609 HIDDEN PINES AVE LAS VEGAS NV 89143-1367	12517519031
NOVO LYDIA	8359 MARTINBOROUGH AVE LAS VEGAS NV 89131-4816	12516117021
O'BRIEN SIDNEY	CARTER GINA M 8624 GRAND PINE AVE LAS VEGAS NV 89143-1353	12517516012
OCAT CHARLES P	PESTILLOS LIZA S 1907 LAS GALLINAS AVE SAN RAFAEL CA 94903-1714	12517525002
OCHOA WILLIAM A	8329 DAWN BREEZE AVE LAS VEGAS NV 89131-4614	12516110019
O'DONNELL WILLIAM	8500 TIMBER PINE AVE LAS VEGAS NV 89143-4611	12517517012
OLGUIN STEVE & LINDA	7804 RESTLESS PINES ST LAS VEGAS NV 89131-8134	12517528008
OLIN KENNETH D & ROSE	7901 HOLLOW PINE ST LAS VEGAS NV 89143-4613	12517510015
OLYMPIC NEVADA G P	%OLYMPIA LAND CORP 11411 SOUTHERN HIGHLANDS PKWY #300 LAS VEGAS NV 89141-3265	12517601015
ORNELAS JOSE G	ORTIZ MARY ESTHER 13172 FALCON PL CHINO CA 91710-3890	12516117071
OROZCO RIGOBERTO JR & DEANNA	8745 SHADY PINES DR LAS VEGAS NV 89143-4449	12517524001
ORTIZ NICHOLAS R	8269 QUAIL ARROYO AVE LAS VEGAS NV 89131-4674	12516115029
OSBORN CELESTE H & KEVIN M	8528 GRACIOUS PINE AVE LAS VEGAS NV 89143-4610	12517510001
OSTLER WILLIAM KENT & S JUNE	7932 KELBURN HILLS ST LAS VEGAS NV 89131-4815	12516117055
P P LAND L P	%WALGREEN CO %TAX DEPT MS #1435 104 WILMOT RD DEERFIELD IL 60015-5121	12517611002
PACHECO BRANDON	8604 GRAND PINE AVE LAS VEGAS NV 89143-1352	12517516017
PACIFIC DREAMS L L C	848 N RAINBOW BLVD #1999 LAS VEGAS NV 89107-1103	12517528004
PADERNA FAMILY TRUST	PADERNA JOSE & VIOLETA TRS 8344 LAMBTIN QUAY AVE LAS VEGAS NV 89131-4814	12516117015
PADILLA MONICA A	9117 PICKET FENCE AVE LAS VEGAS NV 89143-5428	12517514007
PAGE LOY C & JODIE L	7413 FENCEROW ST LAS VEGAS NV 89131-4544	12516313075
PALMER REGINALD F & CHARLOTTE L	8473 TRUDEAU AVE LAS VEGAS NV 89143-1309	12517711003
PANNUCCI LEONARD J & VONDA M	7525 FLAT ROCK ST LAS VEGAS NV 89131-4517	12516311017
PARKER ANDREW	8321 FORT SEDGWICK AVE LAS VEGAS NV 89131-8192	12516319048
PARKER ANTONIO M & JUDITH N	8461 BELLERY AVE LAS VEGAS NV 89143-1314	12517711037
PARKER LAURIE M & JACK F	7612 WINDSWEPT ST LAS VEGAS NV 89131-4636	12516212007

Report of All Selected Parcels**Case Number:** ROC-42637**Printed On:** Wed: July 27, 2011

<u>Owner</u>	<u>Address</u>	<u>Parcel Number</u>
PARKS CAROL LIVING TRUST	8333 DAWN BREEZE AVE LAS VEGAS NV 89131-4614	12516110018
PATE ALEX R	8453 BELLERY AVE LAS VEGAS NV 89143-1314	12517711039
PAVO LANCE & BRIGITT	91-624 KIBAHA ST #11 ELLA BEACH HI 96708	12517511013
PAZ DANIEL & LISA M	8573 HIDDEN PINES AVE LAS VEGAS NV 89143-1368	12517521012
PEASE AMANDA	8536 GRACIOUS PINE AVE LAS VEGAS NV 89143-4610	12517510003
PEAT WILLIAM A	BAUER SHARON M 8268 AURORA PEAK AVE LAS VEGAS NV 89131-4627	12516111013
PEDROZA NATEEH R & ANTHONY M	1726 W GREGORY ST #1 CHICAGO IL 60640-1110	12516215011
PENA DANNY & GLORIA	7821 LIGHT BLOOM ST LAS VEGAS NV 89131-4626	12516111021
PENA JASON A	8600 MAJESTIC PINE AVE LAS VEGAS NV 89143-1349	12517514011
PENDLETON DANIEL J & JANET L	13880 SAGE MOUNTAIN LN JAMUL CA 91935-3008	12517521019
PEREIDA JASON M	8405 TIMBER PINE AVE LAS VEGAS NV 89143-4614	12517517005
PEREZ FRANK E & ANGELA M	8281 ORANGE VALE AVE LAS VEGAS NV 89131-4629	12516111030
PEREZ JOSE DEJESUS	8565 BLOWING PINES DR LAS VEGAS NV 89143-4462	12517527020
PERRY CHRISTOPHER A	7436 FLAT ROCK ST LAS VEGAS NV 89131-4520	12516311084
PERRY MATTHEW & ALEXANDRIA	8417 ORLY AVE LAS VEGAS NV 89143-6008	12517717006
PERSHA JANIS & THOMAS	8313 VALLEY STREAM AVE LAS VEGAS NV 89131-4616	12516211016
PETERS BARBARA L	7805 LIGHT BLOOM ST LAS VEGAS NV 89131-4626	12516111024
PETERSEN STEPHANIE A	7701 KIOWA POINTE ST LAS VEGAS NV 89131-4615	12516210001
PHILLIPS BRIAN D & LINDA H	8232 FRITZEN AVE LAS VEGAS NV 89131-4635	12516213017
PHIPPS TERRY L	BOLTRES PHYLLIS A 4935 N DAPPLE GRAY RD LAS VEGAS NV 89149-3539	12517517014
PICKERING FAMILY REV LIV TR	PICKERING DAVID W & DENISE D TRS 9317 YUCCA BLOSSOM DR LAS VEGAS NV 89134-8921	12517526024
PIECHURA FAMILY TRUST	PIECHURA DONALD & CHRISTINE TRS 4141 BALL RD P M B 275 CYPRESS CA 90630-3465	12516313065
PINE MEADOWS COMMUNITY ASSN	%RMI MGT LLC 630 TRADE CENTER DR #100 LAS VEGAS NV 89119-3712	12517519001
PINE MEADOWS COMMUNITY ASSN	%RMI MGT LLC 630 TRADE CENTER DR #100 LAS VEGAS NV 89119-3712	12517528027
PINSKE JEREMY	7931 KELBURN HILL ST LAS VEGAS NV 89131-4815	12516117019
PIPER CATHERINE J	8351 MARTINBOROUGH AVE LAS VEGAS NV 89131-4816	12516117023
PIROZZI GINA	8315 MARTINBOROUGH AVE LAS VEGAS NV 89131-4816	12516117032
PLAPPERT GERALD	8264 AURORA PEAK AVE LAS VEGAS NV 89131-4627	12516111012
PLAU TERRY & SUZANNE FAMILY TR	PLAU TERRY R TRS P O BOX 762 JULIAN CA 92036-0762	12516214024
POJANASOMBOON PICHAT & SAMAN	9000 EMERALD HILLS WY LAS VEGAS NV 89117-5740	12517601007
POJANASOMBOON PICHAT & SAMAN	9000 EMERALD HILLS WY LAS VEGAS NV 89117-5740	12517601010
PORHOLA CRAIG J	7436 FENCEROW ST LAS VEGAS NV 89131-4545	12516313048

Report of All Selected Parcels**Case Number:** ROC-42637**Printed On:** Wed: July 27, 2011

<u>Owner</u>	<u>Address</u>	<u>Parcel Number</u>
PORNILLOSA RODOLFO L & CLINIA L	8658 SHADY PINES DR LAS VEGAS NV 89143-4454	12517525001
PORTELLO JAMES M & ANDREA J	8321 VALLEY STREAM AVE LAS VEGAS NV 89131-4616	12516211014
POWELL KERRY & LISA K	8333 VALLEY STREAM AVE LAS VEGAS NV 89131-4616	12516211011
PRADIA FAMILY TRUST	PRADIA PAUL A & THERESA A TRS 7840 WAVERING PINE DR LAS VEGAS NV 89143-1378	12517520031
PRAIRIE ROSE HOMEOWNERS ASSN	%THE MASTERS ASSN MGT 7381 PRAIRIE FALCON RD #140 LAS VEGAS NV 89128-0812	12516111051
PRAIRIE ROSE HOMEOWNERS ASSN	%THE MASTERS ASSN MGT 7381 PRAIRIE FALCON RD #140 LAS VEGAS NV 89128-0812	12516110046
PRESS ROBERT & AMBER	8576 SHADY PINES DR LAS VEGAS NV 89143-4452	12517525019
PROKOPICH CANDICE A & KEVIN J	KAY SANDRA 8228 IMPATIENTS AVE LAS VEGAS NV 89131-4634	12516212036
PSETAS NICKOLAS W	7425 MOUNTAIN THICKET ST LAS VEGAS NV 89131-4542	12516312021
PUNZI RALPH G LIVING TRUST	PUNZI RALPH G & LINDA J TRS 7713 KIOWA POINTE LAS VEGAS NV 89131-4615	12516210004
PUTZ CARRYE D	8320 IMPATIENTS AVE LAS VEGAS NV 89131-4617	12516211036
RACHMEL JOAN B	WARREN RONALD L 8324 FRITZEN AVE LAS VEGAS NV 89131-4608	12516210011
RAFF DONALD D	KIMBLE CAROL A 8285 JO MARCY DR LAS VEGAS NV 89131-4625	12516111004
RAFFA DAVID A	LEONARD MARY MCCREA 8417 TOUGH PINE CT LAS VEGAS NV 89131-8153	12517528018
RAMBOYONG RAMON & VILMA	3329 QUESADA DR SAN JOSE CA 95148-2139	12516319031
RAMIREZ-MORAN SERGIO	8200 MORADI AVE LAS VEGAS NV 89131-4513	12516311001
RAMOS JOSE E	8137 PEMBA AVE LAS VEGAS NV 89131-4642	12516215003
RANDOLPH SAMI LIVING TRUST	RANDOLPH SAMI TRS 8336 JO MARCY DR LAS VEGAS NV 89131-4601	12516117044
RATH DJUNA C	8342 FORT HALLOCK AVE NO LAS VEGAS NV 89131-8195	12516319039
RAY LIVING TRUST	RAY TED W & KATHLEEN D TRS 1454 E WESTDALE RD HAYDEN ID 83835-8010	12517710011
REALIZED POTENTIAL ONE L L C	6130 W TROPICANA AVE #129 LAS VEGAS NV 89103-4604	12516319014
REDEWILL BRENT H	HOOD JANET L 7608 WINDSWEPT ST LAS VEGAS NV 89131-4636	12516212008
REED STEPHANIE	8637 HIDDEN PINES AVE LAS VEGAS NV 89143-1365	12517519024
REEDER ALBERT JR	8337 FORT SEDGEWICK AVE LAS VEGAS NV 89131-8193	12516319047
REEDY WILLIAM	7537 WANDERING ST LAS VEGAS NV 89131-4567	12516313023
REGAN TIMOTHY D & MARGARET B	8404 GRACIOUS PINE AVE LAS VEGAS NV 89143-4608	12517511005
REILLY KATELYNN E	PIZZELLO MARYANN 7617 KIOWA POINTE ST LAS VEGAS NV 89131-4619	12516211005
REININGER THOMAS E & BARBARA J	8236 MORADI AVE LAS VEGAS NV 89131-4513	12516311010
REYES ALLAN A	8468 BELLERY AVE LAS VEGAS NV 89143-1314	12517711015
REYES CARLITO & MA ADORA	REYES RAMON C 7939 NAPIER ST LAS VEGAS NV 89131-4603	12516117059
REYES JENNIFER	WALLACE DREW S 8420 TRUDEAU AVE LAS VEGAS NV 89143-1301	12517717008
REYES OLGA S & JOSE	SERRANO MARCIA M & CHARLIE 7507 LITTLE LARAMIE ST LAS VEGAS NV 89131-8196	12516319021

Report of All Selected Parcels**Case Number:** ROC-42637**Printed On:** Wed: July 27, 2011

<u>Owner</u>	<u>Address</u>	<u>Parcel Number</u>
REYES REINA	8328 JO MARCY DR LAS VEGAS NV 89131-4601	12516117042
RHODY MAX & SANDRA J	7723 MAPLE MEADOW ST LAS VEGAS NV 89131-4666	12516214007
RICH MARK	1028 SEABURY HILL CT LAS VEGAS NV 89128-2053	12516111033
RICHMOND AMERICAN HOMES NEVADA	7770 S DEAN MARTIN DR #410 LAS VEGAS NV 89139-6603	12516117029
RICHMOND AMERICAN HOMES NEVADA	7770 S DEAN MARTIN DR #410 LAS VEGAS NV 89139-6603	12516117027
RICHMOND AMERICAN HOMES NEVADA	7770 S DEAN MARTIN DR #410 LAS VEGAS NV 89139-6603	12516117072
RICHMOND AMERICAN HOMES NEVADA	7770 S DEAN MARTIN DR #410 LAS VEGAS NV 89139-6603	12516117031
RICHMOND STUART A	7948 KELBURN HILL ST LAS VEGAS NV 89131-4815	12516117053
RICKS MARTIN & CAROL INT VIV TR	3042 S DURANGO DR LAS VEGAS NV 89117-9186	12517514013
RIGGIO CYNTHIA	7832 WAVERING PINE DR LAS VEGAS NV 89143-1378	12517520029
RIGGS GAIL S	7524 FENCEROW ST LAS VEGAS NV 89131-4547	12516313055
RILEY CHESTER & VERA J	8258 QUAIL GORGE AVE LAS VEGAS NV 89131-4675	12516115020
RIVERA ALEJANDRA J	8588 SHADY PINES DR LAS VEGAS NV 89143-4452	12517525016
RIVERA ROSA M	7817 BRIGHT HEIGHTS ST LAS VEGAS NV 89131-4611	12516110013
ROBIN JEFFREY S	8633 GRAND PINE AVE LAS VEGAS NV 89143-1353	12517516009
ROBINS DONNA M & DEBRA A	7417 MOUNTAIN THICKET ST LAS VEGAS NV 89131-4542	12516312023
ROBINSON REGINALD	8603 SHADY PINES DR LAS VEGAS NV 89143-4452	12517526007
ROBINSON ROBERT E	12 BRIARWICK TRL SAINT PETERS MO 63376-3370	12516117005
RODRIGUEZ FAMILY TRUST	RODRIGUEZ JESUS & ANA TRS 1815 E HAWTHORNE ST ONTARIO CA 91764-2219	12517519034
RODRIGUEZ VICTOR M	7956 KELBURN HILL ST LAS VEGAS NV 89131-4815	12516117052
RODRIQUEZ ROBERT DANIEL & TINA N	8468 TRUDEAU AVE LAS VEGAS NV 89143-1309	12517710015
ROGERS JON M & JOSEPHINE M	7905 HOLLOW PINE ST LAS VEGAS NV 89143-4613	12517510014
ROGERS JOSHUA P	HARLEY JENNIFER A 8312 LAMBTIN QUAY AVE LAS VEGAS NV 89131-4814	12516117007
ROMAN BLANCA	NUNEZ HUMBERTO 7509 FLAT ROCK ST LAS VEGAS NV 89131-4516	12516311021
ROOSE JEREMY W	8589 BLOWING PINES DR LAS VEGAS NV 89143-4463	12517527014
ROSE JAMES H & JUDY F	8412 SHADY PINES DR LAS VEGAS NV 89131-8133	12517528022
ROSENBAUM DANIEL B	8636 SHADY PINES DR LAS VEGAS NV 89143-4453	12517525006
ROSS MICHAEL R	8624 SHADY PINES DR LAS VEGAS NV 89143-4453	12517525009
ROULEAU JACQUELINE	7731 MAPLE MEADOW ST LAS VEGAS NV 89131-4666	12516214009
ROWE CONRAD H	8513 GRACIOUS PINE AVE LAS VEGAS NV 89143-4609	12517511019
ROWE THOMAS S & JANET L	8544 BLOWING PINES DR LAS VEGAS NV 89143-4461	12517520013
ROZOVICS DAVID P & LINDA L	8583 SHADY PINES DR LAS VEGAS NV 89143-4452	12517526010

Report of All Selected Parcels**Case Number:** ROC-42637**Printed On:** Wed: July 27, 2011

<u>Owner</u>	<u>Address</u>	<u>Parcel Number</u>
RUBALCABA DALLAS R & RUBY	7517 FLAT ROCK ST LAS VEGAS NV 89131-4517	12516311019
RÜCKER LEMUEL C & MARY M	8144 GUAVA NECTAR AVE LAS VEGAS NV 89131-8115	12516317007
RUOTI RICHARD G	P O BOX 1266 DUBLIN PA 18917-1266	12516110020
RUZICKA ANNA	8617 GRAND PINE AVE LAS VEGAS NV 89143-1352	12517516005
RYAN THOMAS J	RYAN THOMAS J & SANDRA 8637 MAJESTIC PINE AVE LAS VEGAS NV 89143-1350	12517514024
SACHS WILLARD L & LINDA	8304 GORSKY AVE LAS VEGAS NV 89131-4620	12516210030
SAFARIAN ARTOUR	8348 JO MARCY DR LAS VEGAS NV 89131-4601	12516117047
SAGERT BRIAN A & DEBORAH A	P O BOX 35548 LAS VEGAS NV 89133-5548	12516311078
SAHAGUIAN HAMPARTZOOM	7107 ROUTE TRANSCANADIENNE #423 ST LAURENT QC H4T 1A2 CANADA	12517526005
SAHGAL AMIT	8641 GRAND PINE AVE LAS VEGAS NV 89143-1353	12517518018
SAIN SAMMY C & WINIFRED S TRS	8549 TIMBER PINE AVE LAS VEGAS NV 89143-4612	12517515009
SAKAY GABRIEL ANTHONY	8323 MARTINBOROUGH AVE LAS VEGAS NV 89131-4816	12516117030
SAMATULSKI WILLIAM C & DONNA L	8580 BLOWING PINES DR LAS VEGAS NV 89143-4463	12517526020
SAMPAIO CLAYTON K	MOSS AMANDA 8548 HIDDEN PINES AVE LAS VEGAS NV 89143-1369	12517521008
SAMPSON ROLAND JR & GLORIA D	8601 GRAND PINE AVE LAS VEGAS NV 89143-1352	12517516001
SANCHEZ FRANCISCO & ANA	8700 SHADY PINES DR LAS VEGAS NV 89143-4448	12517524023
SANCHEZ ROSA M & ALBERTO	8568 SHADY PINES DR LAS VEGAS NV 89143-4452	12517525021
SANCHEZ SERGIO I & DESIREE	231 E BETHANY RD #103 BURBANK CA 91504-4253	12517514012
SANDBERG DENNIS & HOLLY	7804 WAVERING PINE DR LAS VEGAS NV 89143-1378	12517520023
SANDCASTLE L P	%C LEVINS 61 PRINCEVILLE LAS VEGAS NV 89113-1369	12516301026
SANDERS MICHELE L	WEBER WENDY J 8216 FRITZEN AVE LAS VEGAS NV 89131-4635	12516213013
SANDLE FAMILY TRUST	SANDLE RICHARD T & NANCY H TRS 7619 MAPLE MEADOW ST LAS VEGAS NV 89131-4665	12516215008
SANDOVAL JOSE ANGEL	7808 WAVERING PINE DR LAS VEGAS NV 89143-1378	12517520024
SANGUINETTI JOSEPH H & MARIE	18505 E COPPEROPOLIS LINDEN CA 95236-9732	12516319003
SARGENT FAMILY TRUST	SARGENT PHILIP J & REBECCA L TRS 52 SWEETWATER CT DANVILLE CA 94506-1222	12516311013
SAVITT MARIJA	7955 CAPE BRETT ST LAS VEGAS NV 89131-4602	12516117073
SAWYER TODD & WENDY	8205 GORSKY AVE LAS VEGAS NV 89131-4623	12516213037
SAYNO ANTONETTE	7931 QUAIL HEAVEN ST LAS VEGAS NV 89131-4678	12516115028
SCAHILL BERNARD J III	8300 FRITZEN AVE LAS VEGAS NV 89131-4608	12516210017
SCHAUDT DAVID J & PADMA K	7716 MAPLE MEADOW ST LAS VEGAS NV 89131-4666	12516214026
SCHMITZ JOHN J	7939 QUAIL HEAVEN ST LAS VEGAS NV 89131-4678	12516115026
SCHOENFELD DEREK M & CONNIE A	7541 WANDERING ST LAS VEGAS NV 89131-4567	12516311078

Report of All Selected Parcels**Case Number:** ROC-42637**Printed On:** Wed: July 27, 2011

<u>Owner</u>	<u>Address</u>	<u>Parcel Number</u>
SCHOONMAKER RENA M	7620 WINDSWEPT LAS VEGAS NV 89131-4636	12516212005
SCHOTT TROY R & CYNTHIA A	8701 HIDDEN PINES AVE LAS VEGAS NV 89143-1366	12517519022
SCHRECKER RANDY P & YVONNE A	8221 FRITZEN AVE LAS VEGAS NV 89131-4635	12516213020
SCHREIB LINDA L	8623 SHADY PINES DR LAS VEGAS NV 89143-4453	12517526002
SCHUELER FAMILY TRUST	SCHUELER WALTER C & MARCIA A TRS 7936 QUAIL HARBOR ST LAS VEGAS NV 89131-4676	12516115012
SCHULTZ BRADFORD & YIRA	6524 KENTLAND AVE WEST HILLS CA 91307-3714	12517519002
SCHUMACHER RICHARD & JACQUELINE	7728 WINDSWEPT ST LAS VEGAS NV 89131-4637	12516213008
SCOGGINS JOHN R III & ELIZABETH	8328 LAMBTIN QUAY AVE LAS VEGAS NV 89131-4814	12516117011
SCOTT MICHELLE	8332 SPRUCE MEADOWS AVE LAS VEGAS NV 89131-4582	12516312015
SCOTT RANDALL L	7528 FENCEROW ST LAS VEGAS NV 89131-4547	12516313056
SECRETARY HOUSING & URBAN DEV	%MICHAELSON CONNOR & BOUL INC 13832 N 32ND ST #150 PHOENIX AZ 85032-5645	12516114037
SEDANO CESAR C & STACEY A	1445 HOLLYWOOD LAS VEGAS NV 89110-2022	12516111010
SÉGURA ROBERT F & LUZ E	8320 VALLEY STREAM AVE LAS VEGAS NV 89131-4616	12516211026
SERVIDO JOHN & CHERYL	8329 VALLEY STREAM AVE LAS VEGAS NV 89131-4616	12516211012
SETHNA JEHANGIR & BONNIE	4N405 WATERFORD LN W CHICAGO IL 60185-1297	12508815007
SEYMORE JUDY I	7540 FENCEROW ST LAS VEGAS NV 89131-4547	12516311077
SHAFFER JAMES D & ROBIN	SHAFFER BRIAN 6133 BLUEBELL AVE N HOLLYWOOD CA 91606-4414	12517510021
SHAFFER STEPHEN T	7421 FLAT ROCK ST LAS VEGAS NV 89131-4519	12516311028
SHALLENBERGER DALE & KRISTEEN	7512 FENCEROW ST LAS VEGAS NV 89131-4547	12516313052
SHARP STEVEN M & THERESA E	8549 HIDDEN PINES AVE LAS VEGAS NV 89143-1368	12517521016
SHARPLES SCOTT & KAREN	8533 HIDDEN PINES AVE LAS VEGAS NV 89143-1369	12517521020
SHEALY CHARLOTTE A & JOSHUA J	8336 LAMBTIN QUAY AVE LAS VEGAS NV 89131-4814	12516117013
SHEPARD APRIL L	8320 BLUSHING HEIGHTS AVE LAS VEGAS NV 89131-4610	12516110008
SHOPBELL JANICE MARILYN	8289 ORANGE VALE AVE LAS VEGAS NV 89131-4630	12516111028
SILVERMAN MARK & JOANNE	6904 DORITA AVE #202 LAS VEGAS NV 89108-8702	12516210012
SILVERSTEIN ADAM	5920 PALMILLA #9 NO LAS VEGAS NV 89031-4134	12517515020
SIMMONS LAWRENCE W & LEANNA C	8324 JO MARCY DR LAS VEGAS NV 89131-4601	12516117041
SIMON PAMELA C & JEROME E	7949 HOLLOW PINE ST LAS VEGAS NV 89143-4613	12517515001
SINGER JACOB M	GOSHOW CHARLES L JR 9628 BOYLAGH AVE LAS VEGAS NV 89129-7852	12517510007
SISCO MAUREEN L	8525 HIDDEN PINES AVE LAS VEGAS NV 89143-1369	12517521022
SKINNER SAM R & FLORENCE S	8553 TIMBER PINE AVE LAS VEGAS NV 89143-4612	12517515008
SLAUGHTER KAREN	8305 JO MARCY DR LAS VEGAS NV 89131-4600	12516110038

Report of All Selected Parcels**Case Number:** ROC-42637**Printed On:** Wed: July 27, 2011

<u>Owner</u>	<u>Address</u>	<u>Parcel Number</u>
SLAUGHTER KAREN	8212 MORADI AVE LAS VEGAS NV 89131-4513	12516311004
SLOSBERG FAMILY LIVING TRUST	SLOSBERG ROBERT I & SONJA P TRS 8208 IMPATIENTS AVE LAS VEGAS NV 89131-4634	12516212041
SMITH BRANDY S	SMITH S F & A C 2000 REV LIV TR 8505 GRACIOUS PINE AVE LAS VEGAS NV 89143-4609	12517511021
SMITH CHARLES E	8625 MAJESTIC PINE AVE LAS VEGAS NV 89143-1349	12517514021
SMITH DIANNE E	7420 FENCEROW ST LAS VEGAS NV 89131-4545	12516313044
SMITH DOLORES V	8585 HIDDEN PINES AVE LAS VEGAS NV 89143-1368	12517519035
SMITH FAMILY TRUST	SMITH VICTOR E & JAROSLAVA M TRS 6145 WITTIG AVE LAS VEGAS NV 89131-3013	12517516025
SMITH GINGER	7939 QUAIL HARBOR ST LAS VEGAS NV 89131-4676	12516115044
SMITH JAMIRA TREREBIA	8360 JO MARCY DR LAS VEGAS NV 89131-4601	12516117050
SMITH JOHN F & FAYE E FAM TR	SMITH JOHN F & FAYE E TRS 1723 LEONARD LN LAS VEGAS NV 89108-2369	12516312012
SMITH RICHARD W	8557 TIMBER PINE AVE LAS VEGAS NV 89143-4612	12517515007
SMITH ROBERT C & KRISTIN J	8536 TIMBER PINE AVE LAS VEGAS NV 89143-4612	12517515018
SMOLENYAK KYLE	CANNON NICOLE 8604 HIDDEN PINES AVE LAS VEGAS NV 89143-1367	12517519011
SMYTH KEVIN A	8549 BLOWING PINES DR LAS VEGAS NV 89143-4461	12517520019
SNYDER MATTHEW & SHAUNA	8557 BLOWING PINES DR LAS VEGAS NV 89143-4461	12517527022
SOIFERMAN DAVID	7905 WILLOW PINES PL LAS VEGAS NV 89143-1364	12517519016
SOKOLOWSKI MARK A & BRENDA S	8225 FRITZEN AVE LAS VEGAS NV 89131-4635	12516213019
SOLANO JUANA	8713 HIDDEN PINES AVE LAS VEGAS NV 89143-1366	12517519019
SOLE BREEZE L L C	P M B 263 505 E WINDMILL LN #1B LAS VEGAS NV 89123-1870	12516110044
SOLE BREEZE L L C	P M B 263 505 E WINDMILL LN #1B LAS VEGAS NV 89123-1870	12516110022
SOLOR ENTERPRISES L L C	8414 W FARM RD #180-254 LAS VEGAS NV 89131-8170	12516312028
SOLOR ENTERPRISES L L C	8414 W FARM RD #180-254 LAS VEGAS NV 89131-8170	12516415068
SOROM WILLIAM T & KATHLEEN W	7800 NESTING PINE PL LAS VEGAS NV 89143-4468	12517524021
SPILLER SHAUN L	SALCEDO VICTORIA A 8545 TIMBER PINE AVE LAS VEGAS NV 89143-4612	12517515010
SPRITZ DEBORAH N	NICHOLS MATTHEW F 7428 FLAT ROCK ST LAS VEGAS NV 89131-4520	12516311062
STAINBACK KENNETH	BROWAND-STAINBACK LAURA 8312 JO MARCY DR LAS VEGAS NV 89131-4601	12516117038
STAITI EILEEN C	8557 GRACIOUS PINE AVE LAS VEGAS NV 89143-4610	12517510016
STAJDUHAR WILLIAM C	7529 FENCE ROW ST LAS VEGAS NV 89131-4548	12516313061
STANFIELD GARY K & DOLORES V	8100 DAWNING FLOWER AVE LAS VEGAS NV 89131-4671	12516312014
STANLEY GEORGE A & KELLY J	8520 TIMBER PINE AVE LAS VEGAS NV 89143-4611	12517517016
STANSON MICHELLE L	8448 TRUDEAU AVE LAS VEGAS NV 89143-1307	12517710010
STASTNY STERLING C	HUEY BRYNN M 8421 TRUDEAU AVE LAS VEGAS NV 89143-1301	12517711023

Report of All Selected Parcels**Case Number:** ROC-42637**Printed On:** Wed: July 27, 2011

<u>Owner</u>	<u>Address</u>	<u>Parcel Number</u>
STEERMAN TIMOTHY A SR	8612 GRAND PINE AVE LAS VEGAS NV 89143-1352	12517516015
STEGMAN STEPHEN G & CYNTHIA A TR	STEGMAN STEPHEN G & CYNTHIA TRS 7932 CAPE BRETT ST LAS VEGAS NV 89131-4602	12516117002
STENGER WILLIAM L III	8308 SPRUCE MEADOWS AVE LAS VEGAS NV 89131-4581	12516312009
STERLING TONY D	7525 FENCEROW ST LAS VEGAS NV 89131-4548	12516313062
STERN SEAN S	8428 TRUDEAU AVE LAS VEGAS NV 89143-1307	12517717010
STETKA JOSEPH L	7428 FENCEROW ST LAS VEGAS NV 89131-4545	12516313046
STEWART JAMES N	8509 GRACIOUS PINE AVE LAS VEGAS NV 89143-4609	12517511020
STEWART KERRY	8312 FRITZEN AVE LAS VEGAS NV 89131-4608	12516210014
STEWART TIA A	8424 TRUDEAU AVE LAS VEGAS NV 89143-1301	12517717009
STOEFFLER SUSIE MARIE REV LIV TR	STOEFFLER SUSIE MARIE TRS 7421 MOUNTAIN THICKET ST LAS VEGAS NV 89131-4542	12516312022
STOKES RICHARD H & EVELYN F	8425 SHADY PINES DR LAS VEGAS NV 89131-8133	12517528003
STRAHLEM RICHARD T & LISA D	8268 ORANGE VALE AVE LAS VEGAS NV 89131-4629	12516111046
STRAYHORN JOZETTE R	8318 FORT HALLOCK AVE LAS VEGAS NV 89131-8194	12516319036
STRIPLING JOHN ROBERT IV	7931 CAPE BRETT ST LAS VEGAS NV 89131-4602	12516117070
STUART MONIQUE L	7816 NESTING PINE PL LAS VEGAS NV 89143-4468	12517524017
SUMNER RONALD & DIANA M	3928 RECKTENWALL AVE NO LAS VEGAS NV 89081-6678	12517514020
SUTHERLAND JOHN & TERESA	8705 GRAND PINE AVE LAS VEGAS NV 89143-1356	12517518021
SWANN MICHAEL WAYNE	8721 SHADY PINES DR LAS VEGAS NV 89143-4459	12517524007
SWANSON DENNIS J SR & LISA R	8205 FRITZEN AVE LAS VEGAS NV 89131-4635	12516213024
SWARTZ MARIA S	8339 MARTINBOROUGH AVE LAS VEGAS NV 89131-4816	12516117026
SWEENEY ARTHUR WILLIAM & GALYN A	8293 ORANGE VALE AVE LAS VEGAS NV 89131-4630	12516111027
SYPERT DESTA L & RICHARD JR	8612 SHADY PINES DR LAS VEGAS NV 89143-4453	12517525012
SYPHUS BRADY M	8445 BELLERY AVE LAS VEGAS NV 89143-1314	12517711041
SZYDLO FAMILY TRUST	SZYDLO PETER W & KELLIE N TRS 7935 QUAIL HARBOR ST LAS VEGAS NV 89131-4676	12516115045
TARALLO CHRISTINE	13855 ARCHWOOD ST VAN NUYS CA 91405-4802	12516415017
TAUBER BRIAN & LYNDA	8296 AURORA PEAK AVE LAS VEGAS NV 89131-4628	12516111020
TAXPAYER	LAS VEGAS NV 89000	12516114038
TAXPAYER	LAS VEGAS NV 89000	12517528005
TAXPAYER	LAS VEGAS NV 89000	12516213009
TAXPAYER	LAS VEGAS NV 89000	12516311059
TAXPAYER	LAS VEGAS NV 89000	12517710004
TAXPAYER	LAS VEGAS NV 89000	12516115021

Report of All Selected Parcels**Case Number:** ROC-42637**Printed On:** Wed: July 27, 2011

<u>Owner</u>	<u>Address</u>	<u>Parcel Number</u>
TAXPAYER	LAS VEGAS NV 89000	12516110045
TAYLOR KELLY J	8640 SHADY PINES DR LAS VEGAS NV 89143-4453	12517525005
TAYLOR NICOLE	A K A P L L C 7940 KELBURN HILL ST LAS VEGAS NV 89131-4815	12516117054
TAYLOR WILLIAM M	8301 FRITZEN AVE LAS VEGAS NV 89131-4608	12516210018
TEJADA JOSE	8636 GRAND PINE AVE LAS VEGAS NV 89143-1353	12517518016
TELESH JOYCE	8629 MAJESTIC PINE AVE LAS VEGAS NV 89143-1349	12517514022
TEMPLETON THOMAS J	8616 GRAND PINE AVE LAS VEGAS NV 89143-1352	12517516014
TENIFFOG TRUST	GOFFINET KIMBERLY & MICHAEL TRS 8304 FRITZEN AVE LAS VEGAS NV 89131-4608	12516210016
THIEU TENNIE	10229 PRAIRIE FAWN DR SAN DIEGO CA 92127-3409	12508815001
THOMAS ISABELLE	8517 TIMBER PINE AVE LAS VEGAS NV 89143-4611	12517517018
THOMAS KELLEY R & KATHERINE M	8409 SHADY PINES DR LAS VEGAS NV 89131-8133	12517528006
THOMPSON BRUCE	8220 GORSKY AVE LAS VEGAS NV 89131-4623	12516213030
THOMPSON BRUCE A & SUSANN J	8220 GORSKY AVE LAS VEGAS NV 89131-4623	12516211021
THOMPSON DARRYL E JR	8620 HIDDEN PINES AVE LAS VEGAS NV 89143-1367	12517519007
THOMPSON MARK D & JOYCE L	8128 CHESTNUT GLEN AVE LAS VEGAS NV 89131-4658	12516215041
THOMPSON MICHAEL L & SUSAN M	21065 ROOSEVELT RIDGE RD N W LEONARD MN 56652-4120	12517519004
TIAPON ENRIQUE & JENNY	8420 TIMBER PINE AVE LAS VEGAS NV 89143-4614	12517517011
TIBBITTS FLOYD PAUL JR	4403 CENTRAL AVE SAN DIEGO CA 92116-3830	12516319041
TICE BENJAMIN P & JANICE L	8421 TOUGH PINE CT LAS VEGAS NV 89131-8153	12517528017
TIGHE PRESTON SCOTT	7401 W WASHINGTON #1051 LAS VEGAS NV 89128-4308	12517517013
TINNEY J E FAMILY TRUST	TINNEY J E & VIRGINIA K TRS 8316 FRITZEN AVE LAS VEGAS NV 89131-4608	12516210013
TITTLE JULIE M	8912 SPANISH RIDGE AVE #200 LAS VEGAS NV 89148-1312	12517711008
TIVORSAK ALAN L TRUST ETAL	TIVORSAK ALAN L TRS 1716 COUNTRY LN ATCHISON KS 66002-1007	12517601013
TORRES JOSE A & ARACELI	8321 IMPATIENTS AVE LAS VEGAS NV 89131-4618	12516211031
TORRES THOMAS JR	RODRIGUEZ SHEINA 8213 FRITZEN AVE LAS VEGAS NV 89131-4635	12516213022
TOVAR RICARDO	8580 SHADY PINES DR LAS VEGAS NV 89143-4452	12517525018
TRAILWOOD HOA	%ASSOCIATED COMNTY MGT 4815 W RUSSELL RD #15-0 LAS VEGAS NV 89118-6241	12516319053
TRAILWOOD HOA	%ASSOCIATED COMNTY MGT 4815 W RUSSELL RD #15-0 LAS VEGAS NV 89118-6241	12516319058
TRAILWOOD HOA	%ASSOCIATED COMNTY MGT 4815 W RUSSELL RD #15-0 LAS VEGAS NV 89118-6241	12516319056
TRAILWOOD HOA	%ASSOCIATED COMNTY MGT 4815 W RUSSELL RD #15-0 LAS VEGAS NV 89118-6241	12516319054
TRAILWOOD HOA	%ASSOCIATED COMNTY MGT 4815 W RUSSELL RD #15-0 LAS VEGAS NV 89118-6241	12516319057
TRAILWOOD HOA	%ASSOCIATED COMNTY MGT 4815 W RUSSELL RD #15-0 LAS VEGAS NV 89118-6241	12516319052

Report of All Selected Parcels**Case Number:** ROC-42637**Printed On:** Wed: July 27, 2011

<u>Owner</u>	<u>Address</u>	<u>Parcel Numbe</u>
TRAILWOOD HOA	%ASSOCIATED COMNTY MGT 4815 W RUSSELL RD #15-0 LAS VEGAS NV 89118-6241	12516319055
TRAN LANG VAN	LY BOPHA 7808 GLOWING PEAK ST LAS VEGAS NV 89131-4612	12516110029
TRAVIS JUSTIN D	8347 FORT HALLOCK AVE LAS VEGAS NV 89131-8195	12516319023
TROPEA TRICIA K	8324 BLUSING HEIGHTS AVE LAS VEGAS NV 89131-4610	12516110009
TRUE CHARLES & CINDY	8317 IMPATIENTS AVE LAS VEGAS NV 89131-4618	12516211032
TRUJILLO ALFREDO T	8556 TIMBER PINE AVE LAS VEGAS NV 89143-4612	12517515021
TRUJILLO CHRISTINA M	8912 SPANISH RIDGE AVE #200 LAS VEGAS NV 89148-1312	12517711019
TRUONG ANDREW	NGUYEN CHRISTINE L LIVING TR %C NGUYEN TRS ETAL 12521 SEMORA ST CERRITOS CA 90703-8311	12516117009
TRUONG CHANH	7424 ALPINE RIDGE ST LAS VEGAS NV 89131-4585	12516312004
TRUSTEE CLARK COUNTY TREASURER	%C M BOULEVARD 1/2 L L C %A MENLOVE 1291 GALLERIA DR HENDERSON NV 89014-8605	12517713001
TRUSTEE CLARK COUNTY TREASURER	%HAYDEN SPRINGS PARTNERS L L C 1291 GALLERIA DR #220 HENDERSON NV 89014-8634	12517714005
TURNER RAYMOND E	7940 QUICK PINE ST LAS VEGAS NV 89143-1354	12517514014
TZOURAS ANDREAS & BESSIE	8283 AURORA PEAK AVE LAS VEGAS NV 89131-4627	12516111037
UNKNOWN TRUST	MCSWEENEY LEWIS J IV & LAURA TRS 8152 PEMBA AVE LAS VEGAS NV 89131-4642	12516213002
UPTON BRANDON C	8405 BELLERY AVE LAS VEGAS NV 89143-1313	12517711051
V H C 215 L L C	%M VILLALPANDO 7377 E DOUBLETREE RANCH RD #A-270 SCOTTSDALE AZ 85258-2053	12517610018
V H C 215 L L C	%M VILLALPANDO 7377 E DOUBLETREE RANCH RD #A-270 SCOTTSDALE AZ 85258-2053	12517610017
VALDEZ ISABELO JR & HEIDI	8604 BLOWING PINES DR LAS VEGAS NV 89143-4464	12517526026
VALDEZ JOSE LUIS & LIZ MONICA	7948 NAPIER ST LAS VEGAS NV 89131-4603	12516117065
VALDEZ JOVENCIO L & NENA A	8429 CHEERFUL BROOK AVE LAS VEGAS NV 89143-5191	12508815060
VALENCIA CHAD	10799 FLAME VINE CT LAS VEGAS NV 89135-2856	12517525022
VALENTINE ERIC J & JULIA	7519 LITTLE LARAMIE ST LAS VEGAS NV 89131-8196	12516319018
VALERIO MARINA S	8348 LAMBTIN QUAY AVE LAS VEGAS NV 89131-4814	12516117016
VANN ERIC L & DELIA L	7952 QUAIL HEAVEN ST LAS VEGAS NV 89131-4678	12516115040
VANWINKLE ROBERT LOYDE	VANWINKLE T S 8340 SPRUCE MEADOWS AVE LAS VEGAS NV 89131-4582	12516312017
VASEUR CLARENCE & CLAUDIA	7437 FENCEROW ST LAS VEGAS NV 89131-4546	12516313069
VAUGHAN TRICIA L	8508 GRACIOUS PINE AVE LAS VEGAS NV 89143-4609	12517511011
VELASQUEZ JONATHAN J & LETICIA G	8437 BELLERY AVE LAS VEGAS NV 89143-1313	12517711043
VELLIS MARIE J	8127 CHESTNUT GLEN AVE LAS VEGAS NV 89131-4658	12516215028
VENTURA JOSEPH	8304 BLUSHING HEIGHTS AVE LAS VEGAS NV 89131-4609	12516110033
VEVNA JULIAN B	8413 TOUGH PINE CT LAS VEGAS NV 89131-8153	12517528019

Report of All Selected Parcels**Case Number:** ROC-42637**Printed On:** Wed: July 27, 2011

<u>Owner</u>	<u>Address</u>	<u>Parcel Numbe</u>
VICE SHIRLEY A	7849 WAVERING PINE DR LAS VEGAS NV 89143-1379	12517520004
VILLAGE CENTENNIAL SPRINGS PTNRS	P O BOX 12649 MILL CREEK WA	12517719010
VILLAGE CENTENNIAL SPRINGS PTNRS	P O BOX 12649 MILL CREEK WA 98082-0649	12517712005
VILLAGE CENTENNIAL SPRINGS PTNRS	P O BOX 12649 MILL CREEK WA	12517719006
VILLAGE CENTENNIAL SPRINGS PTNRS	P O BOX 12649 MILL CREEK WA	12517719014
VILLAGE CENTENNIAL SPRINGS PTNRS	P O BOX 12649 MILL CREEK WA 98082-0649	12517712004
VILLAGE CENTENNIAL SPRINGS PTNRS	P O BOX 12649 MILL CREEK WA 98082-0649	12517712010
VILLAGE CENTENNIAL SPRINGS PTNRS	P O BOX 12649 MILL CREEK WA	12517719011
VILLAGE CENTENNIAL SPRINGS PTNRS	P O BOX 12649 MILL CREEK WA 98082-0649	12517712006
VILLAGE CENTENNIAL SPRINGS PTNRS	P O BOX 12649 MILL CREEK WA	12517719001
VILLAGE CENTENNIAL SPRINGS PTNRS	P O BOX 12649 MILL CREEK WA	12517719012
VILLAGE CENTENNIAL SPRINGS PTNRS	P O BOX 12649 MILL CREEK WA	12517719013
VILLAGE CENTENNIAL SPRINGS PTNRS	P O BOX 12649 MILL CREEK WA 98082-0649	12517718003
VILLAGE CENTENNIAL SPRINGS PTNRS	P O BOX 12649 MILL CREEK WA	12517719002
VILLAGE CENTENNIAL SPRINGS PTNRS	P O BOX 12649 MILL CREEK WA	12517719003
VILLAGE CENTENNIAL SPRINGS PTNRS	P O BOX 12649 MILL CREEK WA 98082-0649	12517712009
VILLAGE CENTENNIAL SPRINGS PTNRS	P O BOX 12649 MILL CREEK WA 98082-0649	12517712003
VILLAGE CENTENNIAL SPRINGS PTNRS	P O BOX 12649 MILL CREEK WA 98082-0649	12517712002
VILLAGE CENTENNIAL SPRINGS PTNRS	P O BOX 12649 MILL CREEK WA 98082-0649	12517712011
VILLAGE CENTENNIAL SPRINGS PTNRS	P O BOX 12649 MILL CREEK WA	12517719004
VILLAGE CENTENNIAL SPRINGS PTNRS	P O BOX 12649 MILL CREEK WA	12517719005
VILLAGE CENTENNIAL SPRINGS PTNRS	P O BOX 12649 MILL CREEK WA 98082-0649	12517718002
VILLAGE CENTENNIAL SPRINGS PTNRS	P O BOX 12649 MILL CREEK WA 98082-0649	12517712012
VILLAGE CENTENNIAL SPRINGS PTNRS	P O BOX 12649 MILL CREEK WA	12517719007
VILLAGE CENTENNIAL SPRINGS PTNRS	P O BOX 12649 MILL CREEK WA	12517719008
VILLAGE CENTENNIAL SPRINGS PTNRS	P O BOX 12649 MILL CREEK WA 98082-0649	12517712013
VILLAGE CENTENNIAL SPRINGS PTNRS	P O BOX 12649 MILL CREEK WA	12517719009
VISNAUSKAS MICHAEL MEMORIAL TR	VISNAUSKAS MICHAEL TRS 8575 SHADY PINES DR LAS VEGAS NV 89143-4452	12517526012
VOGEL JAMEY F & JAMES F	VOGEL JACQUELYNN J 7504 VIA SISTINA ST LAS VEGAS NV 89131-0110	12517711054
VOGT CURTIS C	8321 DAWN BREEZE AVE LAS VEGAS NV 89131-4614	12516110021
VOIGHT RON M	7613 KIOWA POINTE ST LAS VEGAS NV 89131-4619	12516211006
VONK MICHAEL JUNIOR	JACOBSON-VONK KAREN D 7425 FLAT ROCK ST LAS VEGAS NV 89131-4521	12516311027

Report of All Selected Parcels**Case Number:** ROC-42637**Printed On:** Wed: July 27, 2011

<u>Owner</u>	<u>Address</u>	<u>Parcel Numbe</u>
VOPINEK GEORGE H & JANET E	7935 QUAIL HEAVEN ST LAS VEGAS NV 89131-4678	12516115027
VOSS MICHAEL	8581 HIDDEN PINES AVE LAS VEGAS NV 89143-1368	12517519036
VOSSOUGH I JOHN & LISA TRUST	VOSSOUGH I JOHN D & LISA A TRS 1141 RUTH DR SAN JOSE CA 95125-4252	12517520034
VOYTICEK GREGORY	10260 S BRONCO ST LAS VEGAS NV 89141-8553	12517520017
W O M T VII L L C	1042 N'EL CAMINO REAL STE B-343 ENCINTAS CA 92024-1322	12516319002
WADLOW JAMES M & PATRICIA M	8200 IMPATIENTS AVE LAS VEGAS NV 89131-4634	12516212043
WAGNER HOMES INC	6985 W SAHARA #201 LAS VEGAS NV 89117-2822	12509413050
WAKED DANIEL & VICTORIA F	7952 QUAIL HARBOR ST LAS VEGAS NV 89131-4676	12516115043
WALKER KENDELL M	7805 FALLING PINES PL LAS VEGAS NV 89143-4455	12517527007
WALL MONTY W & CHRISTIE A	8308 BLUSHING HEIGHTS AVE LAS VEGAS NV 89131-4609	12516110034
WALTERS JOHN SCOTT	7864 WAVERING PINE DR LAS VEGAS NV 89143-1379	12517520037
WARD MURRAY C & DOROTHY S	8337 JO MARCY DR LAS VEGAS NV 89131-4607	12516110003
WASKEWICS JOHN & DOREEN	8532 TIMBER PINE AVE LAS VEGAS NV 89143-4612	12517515017
WATKINS DAVID F & RONDA L	7501 FLAT ROCK ST LAS VEGAS NV 89131-4516	12516311023
WAUGH JEFFREY A	6350 BUZZ ALDRIN DR LAS VEGAS NV 89149-1389	12517715022
WEAVER JULIE	8629 SHADY PINES DR LAS VEGAS NV 89143-4453	12517526001
WEDO SONDR A L	%M MASTI 3403 BADEN OAKS CT KATY TX 77494-7550	12517521002
WEEKS JEREMY A & LINDA G	8307 FORT HALLOCK AVE LAS VEGAS NV 89131-8194	12516319033
WEINBAUM RONNY B	8624 HIDDEN PINES AVE LAS VEGAS NV 89143-1367	12517519006
WEINBLATT PHILIP J & ELLEN F	8312 GORSKY AVE LAS VEGAS NV 89131-4620	12516210028
WEINER ADAM BRADLEY	94-726 LUMIAUAN ST K-4 WAIPAHU HI 96797-5082	12516313045
WEISSE JERRI	8561 BLOWING PINES DR LAS VEGAS NV 89143-4462	12517527021
WELLINGTON PLACE HOA ASSN	%ASSOCIATED COMMUNITY MANAGEMENT 4815 W RUSSELL RD #15-0 LAS VEGAS NV 89118-6241	12516117078
WELLINGTON PLACE HOA ASSN	%ASSOCIATED COMMUNITY MANAGEMENT 4815 W RUSSELL RD #15-0 LAS VEGAS NV 89118-6241	12516117077
WELLINGTON PLACE HOA ASSN	%ASSOCIATED COMMUNITY MANAGEMENT 4815 W RUSSELL RD #15-0 LAS VEGAS NV 89118-6241	12516117079
WELLINGTON PLACE HOA ASSN	%ASSOCIATED COMMUNITY MANAGEMENT 4815 W RUSSELL RD #15-0 LAS VEGAS NV 89118-6241	12516117080
WELLINGTON PLACE HOA ASSN	%ASSOCIATED COMMUNITY MANAGEMENT 4815 W RUSSELL RD #15-0 LAS VEGAS NV 89118-6241	12516117075
WELLINGTON PLACE HOA ASSN	%ASSOCIATED COMMUNITY MANAGEMENT 4815 W RUSSELL RD #15-0 LAS VEGAS NV 89118-6241	12516117076

Report of All Selected Parcels**Case Number:** ROC-42637**Printed On:** Wed: July 27, 2011

<u>Owner</u>	<u>Address</u>	<u>Parcel Number</u>
WELLS ROBERT THOMAS & LINDA L	8305 FRITZEN AVE LAS VEGAS NV 89131-4608	12516210019
WENZEL CATHERINE A	8425 CHEERFUL BROOK AVE LAS VEGAS NV 89143-5191	12508815059
WEPRYK JOHN & MARYANNE	2214 POPLAR ST PHILADELPHIA PA 19130-1310	12517715024
WERNER KATHLEEN	HERNANDEZ DAVID 7604 WINDSWEPT ST LAS VEGAS NV 89131-4636	12516212009
WESHO DAVID	WERNER REBECCA 8425 ORLY AVE LAS VEGAS NV 89143-6008	12517717004
WESTWOOD VICTOR & MONICA V	8401 TIMBER PINE AVE LAS VEGAS NV 89143-4614	12517517006
WHITSON SUSAN D & RONALD O TRUST	WHITSON SUSAN D & RONALD O TRS P M B 261 20403 N LAKE PLEASANT RD #117 PEORIA AZ 85382-9707	12516311018
WILFERD TERRANCE D & P D LIV TR	WILFERD TERRANCE D & PAMELA TRS 7420 FLAT ROCK ST LAS VEGAS NV 89131-4518	12516311060
WILLER RICHARD A & MARGARET A	6315 N PARK ST LAS VEGAS NV 89149-2349	12508815006
WILLIAMS HAZEL	8457 CHEERFUL BROOK AVE LAS VEGAS NV 89143-5191	12508815003
WILLIAMS JOHN A & GERRY	8267 AURORA PEAK AVE LAS VEGAS NV 89131-4627	12516111041
WILLIAMS NEAL H & MICHELLE E	8216 MORADI AVE LAS VEGAS NV 89131-4513	12516311005
WILLIAMS WALTON A	3 LONGVIEW DR CLIFTON PARK NY 12065-2320	12517527005
WILLMANN TODD A & LEILANI J	8421 ORLY AVE LAS VEGAS NV 89143-6008	12517717005
WILSON LEONARD R & PATRICIA M	7529 VIRGINIA DALE ST LAS VEGAS NV 89131-8191	12516319008
WILSON MARK T	8265 ORANGE VALE AVE LAS VEGAS NV 89131-4629	12516111034
WILSON WILLIAM M & JENNIFER K	8540 GRACIOUS PINE AVE LAS VEGAS NV 89143-4610	12517510004
WINBURN MARC A & ANGELA ANN	8537 TIMBER PINE AVE LAS VEGAS NV 89143-4612	12517515012
WINBUSH REGINALD & MERLINDA	8316 JO MARCY DR LAS VEGAS NV 89131-4601	12516117039
WINCHELL FAMILY LIVING TRUST	WINCHELL JAMES R OR CAROLYN TRS 7725 KIOWA POINTE ST LAS VEGAS NV 89131-4615	12516210007
WINSTON ERIC M & LISA L	9850 GRANITE REEF AVE LAS VEGAS NV 89147-8077	12517520014
WISE JOLÉNE	8429 TRUDEAU AVE LAS VEGAS NV 89143-1307	12517711021
WOJDAK WILLIAM	400 SPEAR ST #119 SAN FRANCISCO CA 94105-1692	12516111016
WOLATZ CAROL G	7825 BRIGHT HEIGHTS ST LAS VEGAS NV 89131-4611	12516110011
WOLATZ RICHARD	8260 AURORA PEAK AVE LAS VEGAS NV 89131-4627	12516111011
WOLF GERALD L & PATRICIA J	8217 IMPATIENTS AVE LAS VEGAS NV 89131-4634	12516212034
WOLTZ DEREK M	8628 GRAND PINE AVE LAS VEGAS NV 89143-1353	12517516011
WONDERS RUSTY A & M D REV LIV TR	WONDERS RUSTY A & MANDI D TRS 8144 PEMBA AVE LAS VEGAS NV 89131-4642	12516214001
WONG MARTIN K	1817 TRUDEAN WY SAN JOSE CA 95132-1541	12517519030
WOOD VICKI L LIVING TRUST	WOOD VICKI L TRS 7536 FLAT ROCK ST LAS VEGAS NV 89131-4515	12516311074
WOODLEY DORIS	8276 ORANGE VALE AVE LAS VEGAS NV 89131-4629	12516111048

Report of All Selected Parcels**Case Number:** ROC-42637**Printed On:** Wed: July 27, 2011

<u>Owner</u>	<u>Address</u>	<u>Parcel Number</u>
WOODS ANISA R	8352 FORT SEDGWICK AVE LAS VEGAS NV 89131-8193	12516319011
WORD SCOTT A & CARYN D	P O BOX 9544 NELLIS AFB NO LAS VEGAS NV 89131	12516111035
WRIGHT ADAM J	7528 FLAT ROCK ST LAS VEGAS NV 89131-4515	12516311072
WULF BRET	7923 CAPE BRETT ST LAS VEGAS NV 89131-4602	12516117069
WYATT MARK A	8153 BACK PACK LAS VEGAS NV 89131-8111	12516316032
WYKOFF NEWBERG CORP	P O BOX 62467 BOULDER CITY NV 89006-2467	12517802001
WYLIE SANDI	8412 GRACIOUS PINES LAS VEGAS NV 89143-4608	12517511007
WYNN RYAN & NATALIE	7935 QUAIL PRAIRIE ST LAS VEGAS NV 89131-4677	12516115011
YAMATAKE GARY M	BAYLESS-YAMATAKE JENNIFER L 8205 IMPATIENTS AVE LAS VEGAS NV 89131-4634	12516212031
YAMAZAKI JOHN J & LEAH T	8544 SHADY PINES DR LAS VEGAS NV 89143-4451	12517521025
YAN MARINA & GEORGE	P O BOX 96 WELLS NV 89835-0096	12517717012
YAN MARINA & GEORGE S	755 S HUMBOLT AVE WELLS NV 89835	12517711056
YIFTACH GUY	%A BLEDDIN 612 MEADOW GROVE LN WESTLAKE VILLAGE CA 91362-5606	12516313022
ZACHARA DOLORES R	SKELLY LINDA C 7421 ALPINE RIDGE ST LAS VEGAS NV 89131-4562	12516312033
ZANNONE NANCY & RICHARD	8577 BLOWING PINES DR LAS VEGAS NV 89143-4462	12517527017
ZARAGOZA ROSEMARY A	8416 TIMBER PINE AVE LAS VEGAS NV 89143-4614	12517517010
ZASTROW RONALD D	7604 ROOP ST LAS VEGAS NV 89131-4621	12516212023
ZELAYA GLORIA A	7508 FENCEROW ST LAS VEGAS NV 89131-4545	12516313051
ZELLER CARMEN L & SHAWN M	8324 LAMBTIN QUAY AVE LAS VEGAS NV 89131-4814	12516117010
ZEPEDA LUIS	8465 CHEERFUL BROOK AVE LAS VEGAS NV 89143-5191	12508815005
ZERRIEN ROSE	8648 SHADY PINES DR LAS VEGAS NV 89143-4454	12517525003
ZETTLER PAUL J & MARY E	8220 FRITZEN AVE LAS VEGAS NV 89131-4635	12516213014
ZHAO MING	GU RONGQING 1115 HUGO REID DR ARCADIA CA 91007-6163	12516117033
ZINOVITCH KYLE M	8553 GRACIOUS PINE AVE LAS VEGAS NV 89143-4610	12517510017
ZOLOTAS STEVE	6238 MOCKINGBIRD ST VENTURA CA 93003-6171	12517521030
ZORROS PAULA & VICTOR	ZORROS KEITH 8629 GRAND PINE AVE LAS VEGAS NV 89143-1353	12517516008
ZWIJAC WALTER & NANCY S	3935 WHITE FIR WY LAS VEGAS NV 89124-9209	12517517021
ZYBELMAN STEVEN TRUST	ZYBELMAN STEVEN TRS 7606 STEVENSON WY SAN DIEGO CA 92120-2229	12517527019