



Legal Notices Transmittal and Scanning Separator Sheet

Legal Notice Type: Legal Mailings

Date of Transfer to ERM: 8/29/2011

Page Count: 58

Meeting Date: 8/17/2011

Meeting Type: City Council <=>

Case Number(s): ROC-42427 <=>

Subject of Affidavit: Applicant: RAZMIK SARKISIAN; Owner: GWHC OF NEVADA, LLC <=>

Record Series: Legal Notices

LRDA Number: 2007-1717

Retention: Permanent

File By: Meeting Date



Prepared By: gportillo

Scanned By:

QC By:

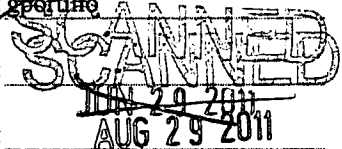

Application Information

ROC-42427 - REVIEW OF CONDITION - PUBLIC HEARING
- APPLICANT: RAZMIK SARKISIAN - OWNER: GWHC OF NEVADA, LLC - For possible action on a request for a Review of Condition of a previously approved Special Use Permit (SUP-6807) TO DELETE CONDITION #4 THAT STATES, "THE SALE OF INDIVIDUAL CONTAINERS OF ANY SIZE OF BEER, WINE COOLERS OR SCREW CAP WINE IS PROHIBITED. ALL SUCH PRODUCTS SHALL REMAIN IN THEIR ORIGINAL CONFIGURATIONS AS SHIPPED BY THE MANUFACTURER. FURTHER, NO REPACKAGING OF CONTAINERS INTO GROUPS SMALLER THAN THE ORIGINAL SHIPPING CONTAINER SIZE SHALL BE PERMITTED" at 8450 West Sahara Avenue, Suite #117 (APN 163-04-406-004), C-1 (Limited Commercial) Zone, Ward 2 (Wolfson).

Application Location

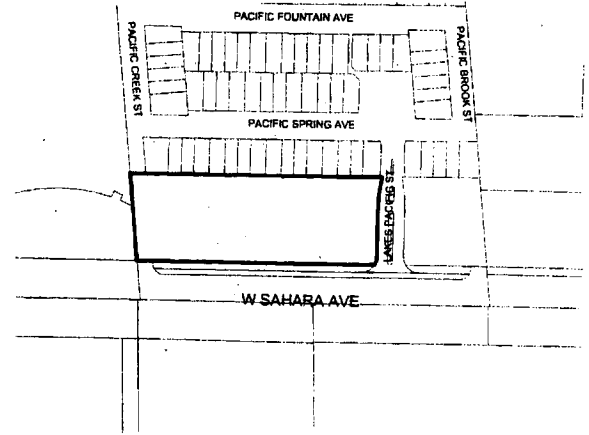

The proposed project may not pertain to the entire highlighted project site.

Public Hearing Information

Meeting: City Council
Date: August 17, 2011
Time: 1:00 P.M.
Location: City Council Chambers
400 Stewart Avenue
Las Vegas, Nevada

Any and all interested persons may appear and be heard at said meeting, or may, prior thereto, file written objections thereto or approvals there of with the City Clerk, 1st Floor, City Hall, 400 Stewart Avenue, Las Vegas, Nevada 89101. For further information, please call 702-229-6301 (TDD 702-386-9108), <http://www.lasvegasnevada.gov>.

City of Las Vegas
Office Of The City Clerk
400 Stewart Avenue
Las Vegas, Nevada 89101

Return Service Requested
Official Notice of Public Hearing

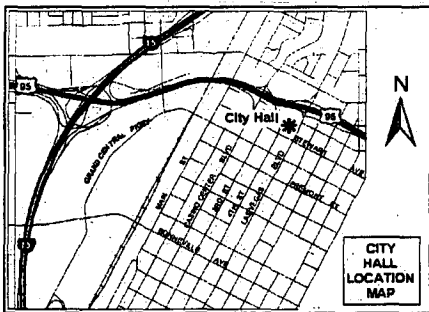

If you wish to file your protest or support on this request, check the appropriate box below and return this card in an envelope with postage to the City Clerk at the address listed above or fax this side of this card to (702) 382-4803. If you would like to contact your Council Representative, please call (702) 229-6405.

I SUPPORT
this Request

I OPPOSE
this Request

Please use available blank space on card for your comments.

ROC-42427

City Council Meeting of **08/17/2011**

CC

P/L 1113
927

Report of All Selected Parcels

Case Number: ROC-42427

Printed On: Thu: July 14, 2011

Owner

Address

Parcel Number

ROC-42427

Mr. Robinson Leung
GWHC of Nevada, LLC
2770 Churchill Drive
Hillsborough, California 94010

- 16309210246
- 16309111253
- 16309110011
- 16309110017
- 16309110071
- 16309110067
- 16309110050
- 16309110028
- 16309110045
- 16309110055
- 16309110038
- 16309111311
- 16309210311
- 16309111329
- 16309210268
- 16309112104
- 16309112112
- 16309112096
- 16309112172
- 16309112164
- 16309112132
- 16309112031
- 16309112023
- 16305813062
- 16309110034
- 16309110046
- 16309111219
- 16309111289
- 16309111343
- 16309111327
- 16309111313
- 16309110083

ROC-42427

Mr. Razmik Sarkisian
8450 West Sahara Avenue, Suite #117
Las Vegas, Nevada 89117

Report of All Selected Parcels

Case Number: ROC-42427

Printed On: Thu: July 14, 2011

Owner

Address

Parcel Number

16309110010
16309110015
16309110072
16309110068
16309110084
16309110025
16309111261
16309110057
16309110039
16309110032
16309210260
16309111204
16309111238
16309111186
16309111222
16309111287
16309111342
16309110052
16309111216
16309111217
16309210312
16309210245
16309210267
16309112103
16309112111
16309112095
16309112171
16309112163
16309112131
16309110132
16309112024
16309110149

Report of All Selected Parcels

Case Number: ROC-42427

Printed On: Thu: July 14, 2011

Owner

Address

Parcel Number

16309111252
16309111260
16309111200
16309111237
16309111269
16309111276
16309111284
16309111309
16309111360
16309111340
16309112032
16309110097
16309111201
16309111236
16309111268
16309111277
16309111285
16309111308
16309111361
16309111341
16309111325
16309110175
16309110126
16309110093
16309111206
16309110169
16309110103
16309110110
16309110166
16309110160
16309110143
16309110120

Report of All Selected Parcels

Case Number: ROC-42427

Printed On: Thu: July 14, 2011

Owner

Address

Parcel Number

16309110114
16309110138
16309110154
16309110180
16309111294
16309111184
16309111350
16309111208
16309111244
16309111188
16309111227
16309111293
16309111347
16309111331
16309111209
16309111225
16309111229
16309111190
16309111352
16309111332
16309111316
16309111207
16309111245
16309111189
16309111226
16309111300
16309111349
16309111333
16309111191
16309111224
16304416006
16304405003

Report of All Selected Parcels

Case Number: ROC-42427

Printed On: Thu: July 14, 2011

Owner

Address

Parcel Number

16304312005
16304312004
16304312003
16304312002
16304312001
16309111299
16309111297
16309111301
16309111296
16309111193
16309111239
16309111292
16309111353
16309111192
16309111223
16309111295
16309111351
16309111187
16309111228
16309111291
16309111348
16309111298
16309110016
16309110031
16309210259
16309111202
16309111240
16309111183
16309111218
16309111286
16309111346
16309111328

Report of All Selected Parcels

Case Number: ROC-42427

Printed On: Thu: July 14, 2011

Owner

Address

Parcel Number

16309111310
16309111315
16309110009
16309110044
16309110073
16309110065
16309110051
16309110026
16309110043
16309110058
16309110037
16309110033
16309210258
16309110179
16309110082
16309111290
16309111242
16309111182
16309111221
16309111288
16309111344
16309111330
16309111312
16309210257
16309111203
16309111241
16309110040
16309111220
16309110056
16309111345
16309111326
16309111314

Report of All Selected Parcels

Case Number: ROC-42427

Printed On: Thu: July 14, 2011

Owner

Address

Parcel Number

16309110081
16309110012
16309110018
16309110074
16309110066
16309110049
16309110027
16309111205
16309111185
16309112154
16309110021
16309112091
16309112062
16309112066
16309112122
16309112050
16309112086
16309112058
16309112054
16309112167
16309112078
16309112127
16309112107
16309112042
16309112046
16309112150
16309112038
16309112034
16309112027
16309112019
16309112010
16309112006

Report of All Selected Parcels

Case Number: ROC-42427

Printed On: Thu: July 14, 2011

Owner

Address

Parcel Number

16309112174
16309112159
16308512031
16309111324
16309110061
16309110059
16309110041
16309110035
16308512001
16308512025
16308512019
16308512049
16308512043
16309112082
16308512013
16309112002
16308512115
16308512121
16309210307
16309210241
16309210263
16309112114
16309112099
16309112070
16309112074
16309112118
16308512007
16308512045
16309110139
16309110115
16309110023
16309110133

Report of All Selected Parcels

Case Number: ROC-42427

Printed On: Thu: July 14, 2011

Owner

Address

Parcel Number

16309110063
16309110145
16309110127
16309110121
16308512003
16308512027
16309112146
16308512051
16309110105
16308512009
16308512015
16308512033
16308512117
16308512123
16309210000
16308512000
16309112000
16309110000
16309111000
16308512021
16309111280
16309110029
16309112178
16309112142
16309112138
16309112014
16309111212
16309111248
16309111256
16309111196
16309111232
16309110155

Report of All Selected Parcels

Case Number: ROC-42427

Printed On: Thu: July 14, 2011

Owner

Address

Parcel Numbe

16309111272
16309110161
16309111304
16309111356
16309111336
16309111320
16309110171
16309110089
16309110003
16309110007
16309110079
16309110099
16309112134
16309111264
16309111337
16309110047
16309112020
16309111213
16309111249
16309111257
16309111197
16309111233
16309111265
16309111273
16309111281
16309112128
16309111357
16309112160
16309111321
16309110172
16309110090
16309110004

Report of All Selected Parcels

Case Number: ROC-42427

Printed On: Thu: July 14, 2011

Owner

Address

Parcel Numbe

16309110008
16309110080
16309110100
16309110106
16309110162
16309110156
16309111305
16309110153
16309111317
16309110094
16309110098
16309110170
16309110104
16309110109
16309110165
16309110159
16309110144
16309110119
16309112028
16309110137
16309110024
16309110150
16309110131
16309110125
16309210308
16309210242
16309210264
16309112100
16309112108
16309112092
16309112168
16309110113

Report of All Selected Parcels

Case Number: ROC-42427

Printed On: Thu: July 14, 2011

Owner

Address

Parcel Numbe

16309111318
16309112017
16309111210
16309111246
16309111254
16309111194
16309111230
16309111262
16309111270
16309111278
16309111302
16309110140
16309111334
16309112157
16309110085
16309110087
16309110001
16309110005
16309110077
16309110013
16309110019
16309110075
16309110069
16309110053
16309111354
16308512016
16309110176
16309110134
16309110064
16309110146
16309110128
16309110122

Report of All Selected Parcels**Case Number:** ROC-42427**Printed On:** Thu: July 14, 2011**Owner****Address****Parcel Number**

1987 SOKOL FAMILY REVOCABLE TR 8685 INC	SOKAL KENNETH F & MARY ANN TRS 2317 WHISPERING HILLS CIR LAS VEGAS NV 89117-5849	16308512004
ACHTCHIAN SOUSANNA TRUST	P O BOX 3957 PALM DESERT CA 92261-3957	16308512028
ACHTCHIAN SOUSANNA TRUST	3334 ROYAL BAY DR LAS VEGAS NV	16308512022
AFSHANG MINU	3334 ROYAL BAY DR LAS VEGAS NV 89117-1000	16308512052
AGAZARYAN VACHE	2606 S DURANGO DR #239 LAS VEGAS NV 89117-2695	16309112025
AGHAKHANI ROUBINA	630 E WALNUT AVE BURBANK CA	16308512010
ALFAFARA RICARDO C & MINA	824 E VALENCIA AVE BURBANK CA	16309112125
ALIC JASMIN & LEJEA	2300 WHISPERING HILLS CIR LAS VEGAS NV 89117-5824	16308512034
ALICEA ERIC C	8484 PACIFIC FOUNTAIN AVE LAS VEGAS NV 89117-1860	16308512118
ALPERT TRUST AGREEMENT	2750 S DURANGO #1021 LAS VEGAS NV	16308512124
ALFRED DOROTHY TRUST	15760 VENTURA #1100 ENCINO CA	16309210305
	ALFRED DOROTHY TRS 8410 ELDORA AVE #2039 LAS VEGAS NV 89117-2678	16309210239
		16309210261
		16309112097
		16309112105
		16309112089
		16309112165
		16309110116
		16308512046
		16309111243
		16305812031
		16308510034
		16309112169
		16309112169
		16309111283
		16309112104
		16309112025
		16305812035
		16304412062
		16309210107
		16309110119
		16309112079

Report of All Selected Parcels**Case Number:** ROC-42427**Printed On:** Thu: July 14, 2011

<u>Owner</u>	<u>Address</u>	<u>Parcel Number</u>
ALRED DOROTHY TRUST	8410 ELDORA AVE #2039 LAS VEGAS NV	16309112079
ALVARADO GILBERTO	2750 S DURANGO DR #2098 LAS VEGAS NV	16309210320
ALVAREZ LINO D & INES E	ALVAREZ DOMINGO M & ALICE P 1 RANCHO DR SAN ANSELMO CA 94960-1312	16309110095
ALVAREZ LINO D & INES E	1 RANCHO DR SAN ANSELMO CA	16309110095
AMERICAN ACQUISITIONS INVEST TR	3901 W CHARLESTON BLVD #168 LAS VEGAS NV	16309110089
AMINOV VYACHESLAV	8410 ELDORA AVE #2056 LAS VEGAS NV	16309112112
AMITAI AMIRAM	8410 W ELDORA AVE LAS VEGAS NV	16309112036
AMITAI AMIRAM	8410 W ELDORA AVE LAS VEGAS NV 89117-2612	16309112036
ANDRES MARY LOIS TR	2908 W 95TH ST INGLEWOOD CA	16308512087
ANGNER BRETT	6510 HAZELTON LN #146 TEMPE AZ 85283-3226	16309111263
ANTHONY EDWARD TRUST	ANTHONY EDWARD TRS 8448 PACIFIC SPRING AVE LAS VEGAS NV 89117-1809	16304412035
ANTOS STEPHEN LIVING TRUST	2872 IVY HILL DR COMMERCE MI	16309112123
ANTOS STEPHEN LIVING TRUST	ANTOS STEPHEN TRS 2872 IVY HILL DR COMMERCE MI 48382-5129	16309112123
APPLETON PROPERTIES L L C	P O BOX 400700 LAS VEGAS NV 89140-0700	16304417018
ARNOLD SCOTT T	2750 S DURANGO DR #3070 LAS VEGAS NV	16309210093
AROYAN MELIK	2100 HILTON DR BURBANK CA 91504-1941	16309111231
ARTZ IRENE	2619 S DURANGO DR #204 LAS VEGAS NV 89117-2663	16308512054
ARTZ IRENE	2619 S DURANGO DR #204 LAS VEGAS NV	16308512054
ARZUMANYAN HARUTYUN	8413 PACIFIC SPRING AVE LAS VEGAS NV 89117-1810	16304412004
ASGARIAN FAMILY REVOCABLE TRUST	ASGARIAN SEAN TRS 10854 FRANKLIN HILLS AVE LAS VEGAS NV 89135-1725	16309111282
ASH KELLY M	8410 ELDORA AVE #1022 LAS VEGAS NV	16309112042
ASHMORE BUDDY E	8 PINEGROVE PL ST ALBERT ALBERTA CANADA T8N 4P9	16308512048
ASHMORE BUDDY E	8 PINEGROVE PL ST ALBERT ALBERTA CANADA T8N 4P9	16308512048
ASSEFA DANIEL	GIZAW ELLENI P O BOX 80906 SEATTLE WA 98108-0906	16304412042
ATANASOV KALOYAN	3333 W 2ND ST 51-317 LOS ANGELES CA	16309210039
ATKINSON CHERON	8455 W SAHARA AVE #134 LAS VEGAS NV	16309110063
AUREA SAMUEL M & CORAZON P	2750 S DURANGO DR #1065 LAS VEGAS NV	16309210080
AUTUMN GLEN HOMEOWNERS ASSOC	%ASSOC COMNTY MGT 4815 W RUSSELL RD #15-0 LAS VEGAS NV 89118-6241	16304417035
AUTUMN GLEN HOMEOWNERS ASSOC	%ASSOC COMNTY MGT 4815 W RUSSELL RD #15-0 LAS VEGAS NV 89118-6241	16304417036
AUTUMN GLEN HOMEOWNERS ASSOC	%ASSOC COMNTY MGT 4815 W RUSSELL RD #15-0 LAS VEGAS NV 89118-6241	16304417033
AUTUMN GLEN HOMEOWNERS ASSOC	%ASSOC COMNTY MGT 4815 W RUSSELL RD #15-0 LAS VEGAS NV 89118-6241	16304417032
AUTUMN GLEN HOMEOWNERS ASSOC	%ASSOC COMNTY MGT 4815 W RUSSELL RD #15-0 LAS VEGAS NV 89118-6241	16304417037

Report of All Selected Parcels**Case Number:** ROC-42427**Printed On:** Thu: July 14, 2011

<u>Owner</u>	<u>Address</u>	<u>Parcel Number</u>
AUTUMN GLEN HOMEOWNERS ASSOC	%ASSOC COMNTY MGT 4815 W RUSSELL RD #15-0 LAS VEGAS NV 89118-6241	16304417034
AVANES ANAHID	1711 GRISMER AVE #69 BURBANK CA 91504-3724	16309112119
AVANES ANAHID	1711 GRISMER AVE #69 BURBANK CA	16309112119
AVITA ERIC	2750 S DURANGO DR #2024 LAS VEGAS NV	16309210130
BABAKHANI SARO	YAGHOBIE OPHELIA 1520 GLENWOOD RD GLENDALE CA 91201-1906	16309111267
BABAUTA TINA	8410 ELDORA AVE #1084 LAS VEGAS NV	16309112166
BABAUTA TINA	AGUSTIN ATHENA 8410 ELDORA AVE #1084 LAS VEGAS NV 89117-2676	16309112166
BABI MICHELLE	14615 BURBANK BLVD #102 VAN NUYS CA	16309110056
BABITT GEORGE A	8925 OBANNON DR LAS VEGAS NV 89117	16304417013
BADALYAN SAMSON	2212 E 28TH ST BROOKLYN NY	16309210047
BADALYAN SAMSON	2212 E 28 ST BROOKLYN NY	16309210043
BADILLA JAIME	P O BOX 4982 LA PUENTE CA	16309210239
BAGHETTI VICTOR E	8324 W CHARLESTON BLVD #2070 LAS VEGAS NV	16309110150
BAGHETTI VICTOR E	8324 W CHARLESTON BLVD #2070 LAS VEGAS NV	16309110179
BAGHETTI VICTOR E	8324 W CHARLESTON BLVD #2070 LAS VEGAS NV	16309110161
BAGHETTI VICTOR E	8324 W CHARLESTON BLVD #2070 LAS VEGAS NV	16309110134
BAGIROV VICTORIA	2606 S DURANGO DR #205 LAS VEGAS NV 89117-2653	16309111359
BAHRY GUY	HAPRAHIM 7 APT 30 HERZELIA ISRAEL	16309110123
BAHRY GUY	HAPRAHIM 7 APT 30 HERZELIA ISRAEL	16309110123
BAIDWAN BELINDERJEET S & EVA M	2631 S DURANGO DR #102 LAS VEGAS NV	16308512086
BAIDWAN SURJEET S	2603 S DURANGO DR #202 LAS VEGAS NV	16308512004
BAINOTTI JOSEPH	2750 S DURANGO DR #1141 LAS VEGAS NV	16309210198
BAKER DAVID & PAULETTE E FAM TR	7228 GENTLE VALLEY ST LAS VEGAS NV	16309210110
BALDIS LISA MICHELLE	8410 ELDORA AVE #1036 LAS VEGAS NV	16309112070
BANK AMERICA N A	400 NATIONAL WY SIMI VALLEY CA	16309110078
BANK AMERICA N A	400 NATIONAL WY SIMI VALLEY CA 93065	16309110078
BANK DEUTSCHE NATIONAL TR CO TRS	400 NATIONAL WY SIMI VALLEY CA	16309110093
BANK H S B C USA NATL ASSN TRS	400 NATIONAL WY SIMI VALLEY CA	16309110109
BANK NEW YORK MELLON TRS	400 COUNTRYWIDE WY SV-35 SIMI VALLEY CA 93065-6298	16304412008
BANK NEW YORK MELLON TRS	400 COUNTRYWIDE WY SV-35 SIMI VALLEY CA	16309210040
BANK NEW YORK MELLON TRS	400 NATIONAL WAY SIMI VALLEY CA 93065	16304412015
BANK WELLS FARGO N A	4101 WISEMAN BLVD SAN ANTONIO TX	16309112008

Report of All Selected Parcels**Case Number:** ROC-42427**Printed On:** Thu: July 14, 2011

<u>Owner</u>	<u>Address</u>	<u>Parcel Number</u>
BANK WELLS FARGO N A	3476 STATEVIEW BLVD MAC #X7801-013 FT MILL SC 29715-7203	16304412028
BANK WELLS FARGO N A	4101 WISEMAN BLVD SAN ANTONIO TX 78251-4200	16309112008
BANK WELLS FARGO N A TRS	%BERKADIA COML MTGE LLC 700 N PEARL ST #2200 DALLAS TX 75201-4102	16308510028
BAO EDWARD Z	ZHOU JIN 7467 SECRETARIAT DR SALINE MI 48176-8027	16309112090
BAO EDWARD Z	7467 SECRETARIAT DR SALINE MI	16309112090
BARKER JULIE ANN	8449 PACIFIC SPRINGS AVE LAS VEGAS NV 89117-1810	16304412011
BARTSCH WANDA B	2607 S DURANGO DR #202 LAS VEGAS NV	16308512016
BASH ELIZABETH S	2635 S DURANGO DR #101 LAS VEGAS NV	16308512097
BAUTISTA DEBBIE	1804 MONTEREY RD SO PASADENA CA 91030-3934	16309111215
BEATHARD JANE	66 E FIFTH ST LONDON OH	16309210122
BEBEKYAN HAKOP	9920 TAMARACK LANDING WY LAS VEGAS NV 89117-0913	16309111339
BEBEKYAN KARO	8917 WALTZING WATERS CT LAS VEGAS NV 89147	16309111279
BELL MARY K & JOHN R	10344 HOWLING COYOTE AVE LAS VEGAS NV	16309210050
BENNETT DAVID P & JENNIFER D	2220 COUNTRY COTTAGE CT LAS VEGAS NV 89117-1845	16304411004
BENOIT SHERRY TRUST	BENOIT SHERRY A TRS 2116 DIAMOND PEAK CT LAS VEGAS NV 89117-1868	16304311020
BENTEL PATRICIA ANN	2635 S DURANGO DR #203 LAS VEGAS NV	16308512101
BERKE JOYCE B	2260 COUNTRY COTTAGE CT LAS VEGAS NV 89117-1845	16304411006
BIONDI ANTHONY F & ROSEMARIE	2108 DIAMOND BROOK CT LAS VEGAS NV 89117-1866	16304312022
BLACKSTART FINANCIAL INC	1401 QUAIL ST #100 DEWPORT BEACH CA	16309110011
BLAINE REVOCABLE FAMILY TRUST	P O BOX 15125 LAS VEGAS NV 89114-5125	16305812009
BLAND RITA L	2750 S DURANGO DR #1158 LAS VEGAS NV	16309210165
BLAYLOCK BRIAN	2637 S DURANGO DR #203 LAS VEGAS NV	16308512107
BLAYLOCK ZENaida F	2637 S DURANGO DR #203 LAS VEGAS NV	16308512033
BLOSSOM CAPITAL L L C	%J MEGY P O BOX 26014 COLORADO SPRINGS CO	16309210183
BOCCIA FRANCES & ALBERT	8457 PACIFIC FOUNTAIN RD LAS VEGAS NV 89117-1861	16304412057
BODUROW-ZARPAS KICHKA	ZARPAS CHRISTOS 2968 CROWN BLUFFS CT LAS VEGAS NV 89117-2577	16309111211
BONNELL ROBERT S SR TRUST	98-961 KAHAPILI ST AIEA HI	16308512120
BONNELL ROBERT S SR TRUST	BONNELL ROBERT S SR TRS 98-961 KAHAPILI ST AIEA HI 96701-2804	16308512120
BOONE STEVEN A	2750 S DURANGO DR #2095 LAS VEGAS NV	16309210317
BOROCHOFF JONATHAN	401 95TH ST SURFSIDE FL 33154-2422	16309112039
BOROCHOFF JONATHAN	401 95TH ST SURFSIDE FL	16309112039
BOULAMATSIS STEVE & AKATERINE A	2750 S DURANGO DR #3071 LAS VEGAS NV	16309210094

Report of All Selected Parcels**Case Number:** ROC-42427**Printed On:** Thu: July 14, 2011

<u>Owner</u>	<u>Address</u>	<u>Parcel Numbe</u>
BRADEN MARGUERITE	2645 S DURANGO DR #202 LAS VEGAS NV	16308512130
BRAWER MIN JA	8410 ELDORA AVE #2037 LAS VEGAS NV	16309112075
BRAWER MIN JA	8410 ELDORA AVE #2037 LAS VEGAS NV 89117-2678	16309112075
BRENNAN MICHAEL	8455 W SAHARA AVE #212 LAS VEGAS NV	16309110162
BRIZENDINE SHIRLEY ANNETTE	8455 W SAHARA #112 LAS VEGAS NV	16309110072
BRONGIL ROBERT JOHN	5059 SW ADMIRAL WY SEATTLE WA 98116-2314	16304412059
BROOKS GARY J & SUZANNE L	2105 DIAMOND PEAK CT LAS VEGAS NV 89117-1868	16304311004
BROWN CYNTHIA J	2750 SOUTH DURANGO DR #3021 LAS VEGAS NV	16309210114
BROWN LAURA LIVING TRUST	2627 S DURANGO DR #202 LAS VEGAS NV	16308512076
BROWN SCOT	MORENO REBECCA 1113 OLVERA WY LAS VEGAS NV 89128-0557	16304411009
BROWNE DAVID G SEPARATE PPTY TR	BROWNE SUSAN K SEPARATE PPTY TR 2201 COUNTRY COTTAGE CT LAS VEGAS NV 89117-1845	16304411002
BRUZZESE FAMILY TRUST	3954 COOLCREST CT LAS VEGAS NV	16309112053
BRUZZESE FAMILY TRUST	BRUZZESE DOMINIC & CATHERINE TRS 3954 COOLCREST CT LAS VEGAS NV 89103-2351	16309112053
BUCHANAN KIMBERLY A	8410 ELDORA AVE #2076 LAS VEGAS NV 89117-2679	16309112152
BUCHANAN KIMBERLY A	8410 ELDORA AVE #2076 LAS VEGAS NV	16309112152
BUENO LAURA	2750 S DURANGO DR #1005 LAS VEGAS NV	16309210157
BUHAY JONATHAN	8410 ELDORA AVE #1035 LAS VEGAS NV	16309112069
BUHAY JONATHAN	REIDY WILLIAM L 8410 ELDORA AVE #1035 LAS VEGAS NV 89117-2675	16309112069
BULLS INVESTMENTS L L C	19849 NORDHOFF ST NORTHRIDGE CA	16309110061
BUNKER FAMILY TRUST	BUNKER JONATHON W & SUSAN S TRS 2120 SHENLEY CT LAS VEGAS NV 89117-8924	16304316007
BUONOMO ROBERT GERARD	1516 FRONT ST SAN DIEGO CA 92101-2919	16304412071
BURCH GULA M	GRIFFIN MARGARET 8429 PACIFIC SPRING AVE LAS VEGAS NV 89117-1810	16304412006
BURKE MARIAN L TRUST 2006	BURKE MARIAN L TRS 2606 S DURANGO DR #186 LAS VEGAS NV 89117-2653	16309111198
BURKHARDT RUTH M TRUST	8410 ELDORA AVE #1006 LAS VEGAS NV	16309112010
C & A INVESTMENTS L L C	P O BOX 1984 CARSON CITY NV 89702-1984	16304414003
C & R TRUST	2509 WIMBLEDON DR LAS VEGAS NV 89107-2314	16304410008
C B H HOLDINGS L L C	1601 LOMA DR HERMOSA BEACH CA	16309112105
C J A ENTERPRISE L L C	7780 N JONES LAS VEGAS NV 89131-2121	16309102011
C S A B A MANAGEMENT TRUST	%E RICHARDS 8410 ELDORA AVE #2045 LAS VEGAS NV	16309112093
C S A B A MANAGEMENT TRUST	%E RICHARDS 8410 ELDORA AVE #2045 LAS VEGAS NV 89117-2678	16309112093
CABRAL DAVID & DIANE REV FAM TR	2316 GRASSY SPRING PL LAS VEGAS NV	16308512108

Report of All Selected Parcels**Case Number:** ROC-42427**Printed On:** Thu: July 14, 2011

<u>Owner</u>	<u>Address</u>	<u>Parcel Number</u>
CADILE BARBARA A	2613 S DURANGO DR #101 LAS VEGAS NV	16308512031
CALLAWAY PAMELA	8509 OBANNON DR LAS VEGAS NV 89117-8957	16304417017
CAMERON FOREST	2750 S DURANGO DR #1115 LAS VEGAS NV	16309210270
CAMPBELL ALBERT	8455 W SAHARA #122 LAS VEGAS NV	16309110069
CANTELLI JOHN A	8410 ELDORA #2001 LAS VEGAS NV 89117-2677	16309112003
CANTELLI JOHN A	8410 ELDORA #2001 LAS VEGAS NV	16309112003
CANYON BAY DEVELOPMENT NV L L C	%EQUITY GROUP 8367 W FLAMINGO #201 LAS VEGAS NV 89147-4153	16309101003
CANYON GATE LAS VEGAS INC	%PPTY TAX DEPT P O BOX 790830 SAN ANTONIO TX 78279-0830	16305711083
CARIAGA ALEX J & LUPE	5236 W AVE M QUARTZ HILL CA	16309112180
CARIAGA ALEX J & LUPE	5236 W AVE M QUARTZ HILL CA 93536-3013	16309112180
CARLIER JEAN PIERRE	1415 SANTA MARGARITA ST #H LAS VEGAS NV	16309110099
CARO MICHELE L	2623 S DURANGO DR #101 LAS VEGAS NV	16308512061
CARTER BARBARA JO	8476 PACIFIC SPRINGS AVE LAS VEGAS NV 89117-1809	16304412029
CARTER JASON	2604 S DURANGO DR #267 LAS VEGAS NV 89117-2614	16309111247
CARUSO FAMILY TRSUT	2333 WHISPERING HILLS CIR LAS VEGAS NV 89117-5849	16305812033
CASSETTA DANIEL	505 CLEARVIEW DR LOS GATOS CA	16309110043
CASTROGIOVANNI S & A	2287 AUTUMN FIRE CT LAS VEGAS NV 89117-8956	16304417002
CATAPANO GIANLUCA	2750 S DURANGO DR #2155 LAS VEGAS NV	16309210172
CHALLENGER RICHARD & NORINE	2750 S DURANGO DR #1055 LAS VEGAS NV	16309210002
CHANDLER MARY HANIEF LIVING TR	2623 S DURANGO DR #201 LAS VEGAS NV	16308512063
CHEN CHIA LING	8733 CARLITAS JOY CT LAS VEGAS NV	16309210247
CHEN JIA QI	2750 S DURANGO DR #2025 LAS VEGAS NV	16309210131
CHENG JYH HUEY	2504 GRANT AVE #2 REDONDO BEACH CA	16309210118
CHERNEY TRUST	2053 GRAVEL HILL ST #105 LAS VEGAS NV	16308512117
CHIARAMONTE VINCE P & JASMINE L	31 CHANCELLOR PARK #D MAYS LANDING NJ 08330-2047	16304412001
CHIRILLO ANITA C ETAL	8410 ELDORA AVE #1037 LAS VEGAS NV	16309112073
CHIRILLO ANITA C ETAL	8410 ELDORA AVE #1037 LAS VEGAS NV 89117-2675	16309112073
CHIZHIKYAN VAGAN	14818 ADDISON ST SHERMAN OAKS CA 91403-1603	16305812018
CHORPASH FAMILY REVOCABLE LIV TR	CHORPASH GERALD S & MARSHA TRS 2100 PLAZA DEL DIOS LAS VEGAS NV 89102-3973	16304412046
CHOW DAISY	6122 CORSICA CIR LONG BEACH CA	16309210181
CHOW DAISY	6122 CORSICA CIR LONG BEACH CA	16309210180
CHU HERRICK	5870 DUNEVILLE CT LAS VEGAS NV	16309210070

Report of All Selected Parcels**Case Number:** ROC-42427**Printed On:** Thu: July 14, 2011

<u>Owner</u>	<u>Address</u>	<u>Parcel Number</u>
CHU HERRICK	5870 DUNEVILLE CT LAS VEGAS NV	16309210074
CHUA KRISTINE	978 BAXTER PKWY BREA CA	16309110083
CHUNGSIVAPORN PONG NUNTIMA	WINGER WILLIAM R 2308 PACIFIC BROOK ST LAS VEGAS NV 89117-1813	16304412043
CHURCH LUTHERAN LAKES	8200 W SAHARA AVE LAS VEGAS NV 89117-1803	16304408003
CIMMARON PROPERTIES LTD	2575 MONTESSOURI ST #200 LAS VEGAS NV 89117-3060	16309102012
CIPRIANO THOMAS & JUSTINE	260-07 86TH AVE FLORAL PARK NY	16309210179
CLEGG THOMAS	1840 E 8TH ST JEFFERSONVILLE IN 47130-4867	16309110136
CLEGG THOMAS	1840 E 8TH ST JEFFERSONVILLE IN	16309110136
CLUFF ROBERT M & ROWENA L	8410 ELDORA AVE #1048 LAS VEGAS NV	16309112092
COATES HERBERT & EVA MARIE	2617 S DURANGO DR #201 LAS VEGAS NV	16308512045
COFFMAN TIMOTHY W	2611 S DURANGO DR #102 LAS VEGAS NV 89117-2660	16308512026
COFFMAN TIMOTHY W	2611 S DURANGO DR #102 LAS VEGAS NV	16308512026
COHEN JOE & JOAN	4330 S EASTERN AVE LAS VEGAS NV	16309112113
COHEN JOE & JOAN	4330 S EASTERN AVE LAS VEGAS NV 89119-6017	16309112113
COHEN SAGI	P O BOX 4672 PARKER CO	16309110122
COLE SCOTT	8410 ELDORA AVE #2038 LAS VEGAS NV	16309112076
COLE SCOTT	8410 ELDORA AVE #2038 LAS VEGAS NV 89117-2678	16309112076
COLIN RICHARD & BRENDA	1722 HAREMEYER LN REDONDO BEACH CA	16309110071
COLLINS BRIAN M SR FAMILY TRUST	COLLINS BRIAN SR TRS 2259 CASA BELLA CT LAS VEGAS NV 89117-8934	16304415007
COLLYMORE MOREENA	2750 S DURANGO #1036 LAS VEGAS NV	16309210054
COLON BELINDA	FENCHEL JILL 2244 OASIS PALM CT LAS VEGAS NV 89117-1807	16304410003
COMER WESLEY	2053-104 GRAVEL HILL ST LAS VEGAS NV	16309110035
COML LIQUIDATION PPTY 5 L L C	390 GREENWICH ST 6TH FLR NEW YORK NY	16309210067
COML LIQUIDATION PPTY 5 L L C	390 GREENWICH ST 6TH FLR NEW YORK NY	16309210310
COML LIQUIDATION PPTY 5 L L C	390 GREENWICH ST 6TH FLR NEW YORK NY	16309210214
COML LIQUIDATION PPTY 5 L L C	390 GREENWICH ST 6TH FLR NEW YORK NY	16309210069
COML LIQUIDATION PPTY 5 L L C	390 GREENWICH ST 6TH FLR NEW YORK NY	16309210213
COML LIQUIDATION PPTY 5 L L C	390 GREENWICH ST 6TH FLR NEW YORK NY	16309210212
COML LIQUIDATION PPTY 5 L L C	390 GREENWICH ST 6TH FLR NEW YORK NY	16309210311
COML LIQUIDATION PPTY 5 L L C	390 GREENWICH ST 6TH FLR NEW YORK NY	16309210211
COML LIQUIDATION PPTY 5 L L C	390 GREENWICH ST 6TH FLR NEW YORK NY	16309210072
COML LIQUIDATION PPTY 5 L L C	390 GREENWICH ST 6TH FLR NEW YORK NY	16309210210

Report of All Selected Parcels

Case Number: ROC-42427

Printed On: Thu: July 14, 2011

<u>Owner</u>	<u>Address</u>	<u>Parcel Number</u>
COML LIQUIDATION PPTY 5 L L C	390 GREENWICH ST 6TH FLR NEW YORK NY	16309210066
COML LIQUIDATION PPTY 5 L L C	390 GREENWICH ST 6TH FLR NEW YORK NY	16309210073
COML LIQUIDATION PPTY 5 L L C	390 GREENWICH ST 6TH FLR NEW YORK NY	16309210216
COML LIQUIDATION PPTY 5 L L C	390 GREENWICH ST 6TH FLR NEW YORK NY	16309210208
COML LIQUIDATION PPTY 5 L L C	390 GREENWICH ST 6TH FLR NEW YORK NY	16309210207
COML LIQUIDATION PPTY 5 L L C	390 GREENWICH ST 6TH FLR NEW YORK NY	16309210076
COML LIQUIDATION PPTY 5 L L C	390 GREENWICH ST 6TH FLR NEW YORK NY	16309210203
COML LIQUIDATION PPTY 5 L L C	390 GREENWICH ST 6TH FLR NEW YORK NY	16309210154
COML LIQUIDATION PPTY 5 L L C	390 GREENWICH ST 6TH FLR NEW YORK NY	16309210315
COML LIQUIDATION PPTY 5 L L C	390 GREENWICH ST 6TH FLR NEW YORK NY	16309210078
COML LIQUIDATION PPTY 5 L L C	390 GREENWICH ST 6TH FLR NEW YORK NY	16309210079
COML LIQUIDATION PPTY 5 L L C	390 GREENWICH ST 6TH FLR NEW YORK NY	16309210209
COML LIQUIDATION PPTY 5 L L C	390 GREENWICH ST 6TH FLR NEW YORK NY	16309210059
COML LIQUIDATION PPTY 5 L L C	390 GREENWICH ST 6TH FLR NEW YORK NY	16309210230
COML LIQUIDATION PPTY 5 L L C	390 GREENWICH ST 6TH FLR NEW YORK NY	16309210229
COML LIQUIDATION PPTY 5 L L C	390 GREENWICH ST 6TH FLR NEW YORK NY	16309210098
COML LIQUIDATION PPTY 5 L L C	390 GREENWICH ST 6TH FLR NEW YORK NY	16309210053
COML LIQUIDATION PPTY 5 L L C	390 GREENWICH ST 6TH FLR NEW YORK NY	16309210123
COML LIQUIDATION PPTY 5 L L C	390 GREENWICH ST 6TH FLR NEW YORK NY	16309210227
COML LIQUIDATION PPTY 5 L L C	390 GREENWICH ST 6TH FLR NEW YORK NY	16309210226
COML LIQUIDATION PPTY 5 L L C	390 GREENWICH ST 6TH FLR NEW YORK NY	16309210308
COML LIQUIDATION PPTY 5 L L C	390 GREENWICH ST 6TH FLR NEW YORK NY	16309210224
COML LIQUIDATION PPTY 5 L L C	390 GREENWICH ST 6TH FLR NEW YORK NY	16309210057
COML LIQUIDATION PPTY 5 L L C	390 GREENWICH ST 6TH FLR NEW YORK NY	16309210065
COML LIQUIDATION PPTY 5 L L C	390 GREENWICH ST 6TH FLR NEW YORK NY	16309210222
COML LIQUIDATION PPTY 5 L L C	390 GREENWICH ST 6TH FLR NEW YORK NY	16309210160
COML LIQUIDATION PPTY 5 L L C	390 GREENWICH ST 6TH FLR NEW YORK NY	16309210220
COML LIQUIDATION PPTY 5 L L C	390 GREENWICH ST 6TH FLR NEW YORK NY	16309210159
COML LIQUIDATION PPTY 5 L L C	390 GREENWICH ST 6TH FLR NEW YORK NY 10013-2375	16309210240
COML LIQUIDATION PPTY 5 L L C	390 GREENWICH ST 6TH FLR NEW YORK NY	16309210060
COML LIQUIDATION PPTY 5 L L C	390 GREENWICH ST 6TH FLR NEW YORK NY	16309210062
COML LIQUIDATION PPTY 5 L L C	390 GREENWICH ST 6TH FLR NEW YORK NY	16309210063

Report of All Selected Parcels

Case Number: ROC-42427

Printed On: Thu: July 14, 2011

<u>Owner</u>	<u>Address</u>	<u>Parcel Number</u>
COML LIQUIDATION PPTY 5 L L C	390 GREENWICH ST 6TH FLR NEW YORK NY	16309210358
COML LIQUIDATION PPTY 5 L L C	390 GREENWICH ST 6TH FLR NEW YORK NY	16309210309
COML LIQUIDATION PPTY 5 L L C	390 GREENWICH ST 6TH FLR NEW YORK NY	16309210218
COML LIQUIDATION PPTY 5 L L C	390 GREENWICH ST 6TH FLR NEW YORK NY	16309210352
COML LIQUIDATION PPTY 5 L L C	390 GREENWICH ST 6TH FLR NEW YORK NY	16309210215
COML LIQUIDATION PPTY 5 L L C	390 GREENWICH ST 6TH FLR NEW YORK NY	16309210058
COML LIQUIDATION PPTY 5 L L C	390 GREENWICH ST 6TH FLR NEW YORK NY	16309210328
COML LIQUIDATION PPTY 5 L L C	390 GREENWICH ST 6TH FLR NEW YORK NY	16309210081
COML LIQUIDATION PPTY 5 L L C	390 GREENWICH ST 6TH FLR NEW YORK NY	16309210341
COML LIQUIDATION PPTY 5 L L C	390 GREENWICH ST 6TH FLR NEW YORK NY	16309210324
COML LIQUIDATION PPTY 5 L L C	390 GREENWICH ST 6TH FLR NEW YORK NY	16309210325
COML LIQUIDATION PPTY 5 L L C	390 GREENWICH ST 6TH FLR NEW YORK NY	16309210103
COML LIQUIDATION PPTY 5 L L C	390 GREENWICH ST 6TH FLR NEW YORK NY	16309210104
COML LIQUIDATION PPTY 5 L L C	390 GREENWICH ST 6TH FLR NEW YORK NY	16309210326
COML LIQUIDATION PPTY 5 L L C	390 GREENWICH ST 6TH FLR NEW YORK NY	16309210106
COML LIQUIDATION PPTY 5 L L C	390 GREENWICH ST 6TH FLR NEW YORK NY	16309210340
COML LIQUIDATION PPTY 5 L L C	390 GREENWICH ST 6TH FLR NEW YORK NY	16309210338
COML LIQUIDATION PPTY 5 L L C	390 GREENWICH ST 6TH FLR NEW YORK NY	16309210344
COML LIQUIDATION PPTY 5 L L C	390 GREENWICH ST 6TH FLR NEW YORK NY 10013-2375	16309210309
COML LIQUIDATION PPTY 5 L L C	390 GREENWICH ST 6TH FLR NEW YORK NY	16309210323
COML LIQUIDATION PPTY 5 L L C	390 GREENWICH ST 6TH FLR NEW YORK NY 10013-2375	16309210243
COML LIQUIDATION PPTY 5 L L C	390 GREENWICH ST 6TH FLR NEW YORK NY 10013-2375	16309210265
COML LIQUIDATION PPTY 5 L L C	390 GREENWICH ST 6TH FLR NEW YORK NY	16309210337
COML LIQUIDATION PPTY 5 L L C	390 GREENWICH ST 6TH FLR NEW YORK NY	16309210329
COML LIQUIDATION PPTY 5 L L C	390 GREENWICH ST 6TH FLR NEW YORK NY	16309210113
COML LIQUIDATION PPTY 5 L L C	390 GREENWICH ST 6TH FLR NEW YORK NY	16309210124
COML LIQUIDATION PPTY 5 L L C	390 GREENWICH ST 6TH FLR NEW YORK NY	16309210330
COML LIQUIDATION PPTY 5 L L C	390 GREENWICH ST 6TH FLR NEW YORK NY	16309210117
COML LIQUIDATION PPTY 5 L L C	390 GREENWICH ST 6TH FLR NEW YORK NY	16309210333
COML LIQUIDATION PPTY 5 L L C	390 GREENWICH ST 6TH FLR NEW YORK NY	16309210335
COML LIQUIDATION PPTY 5 L L C	390 GREENWICH ST 6TH FLR NEW YORK NY	16309210336
COML LIQUIDATION PPTY 5 L L C	390 GREENWICH ST 6TH FLR NEW YORK NY	16309210327

Report of All Selected Parcels**Case Number:** ROC-42427**Printed On:** Thu: July 14, 2011

<u>Owner</u>	<u>Address</u>	<u>Parcel Number</u>
COML LIQUIDATION PPTY 5 L L C	390 GREENWICH ST 6TH FLR NEW YORK NY	16309210355
COML LIQUIDATION PPTY 5 L L C	390 GREENWICH ST 6TH FLR NEW YORK NY	16309210351
COML LIQUIDATION PPTY 5 L L C	390 GREENWICH ST 6TH FLR NEW YORK NY	16309210082
COML LIQUIDATION PPTY 5 L L C	390 GREENWICH ST 6TH FLR NEW YORK NY	16309210150
COML LIQUIDATION PPTY 5 L L C	390 GREENWICH ST 6TH FLR NEW YORK NY	16309210195
COML LIQUIDATION PPTY 5 L L C	390 GREENWICH ST 6TH FLR NEW YORK NY	16309210193
COML LIQUIDATION PPTY 5 L L C	390 GREENWICH ST 6TH FLR NEW YORK NY	16309210083
COML LIQUIDATION PPTY 5 L L C	390 GREENWICH ST 6TH FLR NEW YORK NY	16309210084
COML LIQUIDATION PPTY 5 L L C	390 GREENWICH ST 6TH FLR NEW YORK NY	16309210086
COML LIQUIDATION PPTY 5 L L C	390 GREENWICH ST 6TH FLR NEW YORK NY	16309210087
COML LIQUIDATION PPTY 5 L L C	390 GREENWICH ST 6TH FLR NEW YORK NY	16309210354
COML LIQUIDATION PPTY 5 L L C	390 GREENWICH ST 6TH FLR NEW YORK NY	16309210343
COML LIQUIDATION PPTY 5 L L C	390 GREENWICH ST 6TH FLR NEW YORK NY	16309210190
COML LIQUIDATION PPTY 5 L L C	390 GREENWICH ST 6TH FLR NEW YORK NY	16309210201
COML LIQUIDATION PPTY 5 L L C	390 GREENWICH ST 6TH FLR NEW YORK NY	16309210356
COML LIQUIDATION PPTY 5 L L C	390 GREENWICH ST 6TH FLR NEW YORK NY	16309210357
COML LIQUIDATION PPTY 5 L L C	390 GREENWICH ST 6TH FLR NEW YORK NY	16309210319
COML LIQUIDATION PPTY 5 L L C	390 GREENWICH ST 6TH FLR NEW YORK NY	16309210350
COML LIQUIDATION PPTY 5 L L C	390 GREENWICH ST 6TH FLR NEW YORK NY	16309210321
COML LIQUIDATION PPTY 5 L L C	390 GREENWICH ST 6TH FLR NEW YORK NY	16309210348
COML LIQUIDATION PPTY 5 L L C	390 GREENWICH ST 6TH FLR NEW YORK NY	16309210347
COML LIQUIDATION PPTY 5 L L C	390 GREENWICH ST 6TH FLR NEW YORK NY	16309210143
COML LIQUIDATION PPTY 5 L L C	390 GREENWICH ST 6TH FLR NEW YORK NY	16309210346
COML LIQUIDATION PPTY 5 L L C	390 GREENWICH ST 6TH FLR NEW YORK NY	16309210322
COML LIQUIDATION PPTY 5 L L C	390 GREENWICH ST 6TH FLR NEW YORK NY	16309210345
COML LIQUIDATION PPTY 5 L L C	390 GREENWICH ST 6TH FLR NEW YORK NY	16309210318
COML LIQUIDATION PPTY 5 L L C	390 GREENWICH ST 6TH FLR NEW YORK NY	16309210021
COML LIQUIDATION PPTY 5 L L C	390 GREENWICH ST 6TH FLR NEW YORK NY	16309210028
COML LIQUIDATION PPTY 5 L L C	390 GREENWICH ST 6TH FLR NEW YORK NY	16309210292
COML LIQUIDATION PPTY 5 L L C	390 GREENWICH ST 6TH FLR NEW YORK NY	16309210271
COML LIQUIDATION PPTY 5 L L C	390 GREENWICH ST 6TH FLR NEW YORK NY	16309210018
COML LIQUIDATION PPTY 5 L L C	390 GREENWICH ST 6TH FLR NEW YORK NY 10013-2375	16309210262

Report of All Selected Parcels

Case Number: ROC-42427

Printed On: Thu: July 14, 2011

<u>Owner</u>	<u>Address</u>	<u>Parcel Number</u>
COML LIQUIDATION PPTY 5 L L C	390 GREENWICH ST 6TH FLR NEW YORK NY	16309210293
COML LIQUIDATION PPTY 5 L L C	390 GREENWICH ST 6TH FLR NEW YORK NY	16309210268
COML LIQUIDATION PPTY 5 L L C	390 GREENWICH ST 6TH FLR NEW YORK NY	16309210267
COML LIQUIDATION PPTY 5 L L C	390 GREENWICH ST 6TH FLR NEW YORK NY	16309210020
COML LIQUIDATION PPTY 5 L L C	390 GREENWICH ST 6TH FLR NEW YORK NY	16309210266
COML LIQUIDATION PPTY 5 L L C	390 GREENWICH ST 6TH FLR NEW YORK NY	16309210291
COML LIQUIDATION PPTY 5 L L C	390 GREENWICH ST 6TH FLR NEW YORK NY	16309210263
COML LIQUIDATION PPTY 5 L L C	390 GREENWICH ST 6TH FLR NEW YORK NY	16309210290
COML LIQUIDATION PPTY 5 L L C	390 GREENWICH ST 6TH FLR NEW YORK NY	16309210022
COML LIQUIDATION PPTY 5 L L C	390 GREENWICH ST 6TH FLR NEW YORK NY	16309210262
COML LIQUIDATION PPTY 5 L L C	390 GREENWICH ST 6TH FLR NEW YORK NY	16309210023
COML LIQUIDATION PPTY 5 L L C	390 GREENWICH ST 6TH FLR NEW YORK NY	16309210228
COML LIQUIDATION PPTY 5 L L C	390 GREENWICH ST 6TH FLR NEW YORK NY	16309210024
COML LIQUIDATION PPTY 5 L L C	390 GREENWICH ST 6TH FLR NEW YORK NY	16309210234
COML LIQUIDATION PPTY 5 L L C	390 GREENWICH ST 6TH FLR NEW YORK NY	16309210261
COML LIQUIDATION PPTY 5 L L C	390 GREENWICH ST 6TH FLR NEW YORK NY	16309210026
COML LIQUIDATION PPTY 5 L L C	390 GREENWICH ST 6TH FLR NEW YORK NY	16309210027
COML LIQUIDATION PPTY 5 L L C	390 GREENWICH ST 6TH FLR NEW YORK NY	16309210260
COML LIQUIDATION PPTY 5 L L C	390 GREENWICH ST 6TH FLR NEW YORK NY	16309210265
COML LIQUIDATION PPTY 5 L L C	390 GREENWICH ST 6TH FLR NEW YORK NY	16309210299
COML LIQUIDATION PPTY 5 L L C	390 GREENWICH ST 6TH FLR NEW YORK NY	16309210294
COML LIQUIDATION PPTY 5 L L C	390 GREENWICH ST 6TH FLR NEW YORK NY	16309210288
COML LIQUIDATION PPTY 5 L L C	390 GREENWICH ST 6TH FLR NEW YORK NY	16309210287
COML LIQUIDATION PPTY 5 L L C	390 GREENWICH ST 6TH FLR NEW YORK NY	16309210286
COML LIQUIDATION PPTY 5 L L C	390 GREENWICH ST 6TH FLR NEW YORK NY	16309210295
COML LIQUIDATION PPTY 5 L L C	390 GREENWICH ST 6TH FLR NEW YORK NY	16309210298
COML LIQUIDATION PPTY 5 L L C	390 GREENWICH ST 6TH FLR NEW YORK NY	16309210285
COML LIQUIDATION PPTY 5 L L C	390 GREENWICH ST 6TH FLR NEW YORK NY	16309210003
COML LIQUIDATION PPTY 5 L L C	390 GREENWICH ST 6TH FLR NEW YORK NY	16309210283
COML LIQUIDATION PPTY 5 L L C	390 GREENWICH ST 6TH FLR NEW YORK NY	16309210005
COML LIQUIDATION PPTY 5 L L C	390 GREENWICH ST 6TH FLR NEW YORK NY	16309210302
COML LIQUIDATION PPTY 5 L L C	390 GREENWICH ST 6TH FLR NEW YORK NY	16309210281

Report of All Selected Parcels

Case Number: ROC-42427

Printed On: Thu: July 14, 2011

<u>Owner</u>	<u>Address</u>	<u>Parcel Number</u>
COML LIQUIDATION PPTY 5 L L C	390 GREENWICH ST 6TH FLR NEW YORK NY	16309210303
COML LIQUIDATION PPTY 5 L L C	390 GREENWICH ST 6TH FLR NEW YORK NY	16309210280
COML LIQUIDATION PPTY 5 L L C	390 GREENWICH ST 6TH FLR NEW YORK NY	16309210279
COML LIQUIDATION PPTY 5 L L C	390 GREENWICH ST 6TH FLR NEW YORK NY	16309210009
COML LIQUIDATION PPTY 5 L L C	390 GREENWICH ST 6TH FLR NEW YORK NY	16309210010
COML LIQUIDATION PPTY 5 L L C	390 GREENWICH ST 6TH FLR NEW YORK NY	16309210278
COML LIQUIDATION PPTY 5 L L C	390 GREENWICH ST 6TH FLR NEW YORK NY	16309210011
COML LIQUIDATION PPTY 5 L L C	390 GREENWICH ST 6TH FLR NEW YORK NY	16309210012
COML LIQUIDATION PPTY 5 L L C	390 GREENWICH ST 6TH FLR NEW YORK NY	16309210301
COML LIQUIDATION PPTY 5 L L C	390 GREENWICH ST 6TH FLR NEW YORK NY	16309210277
COML LIQUIDATION PPTY 5 L L C	390 GREENWICH ST 6TH FLR NEW YORK NY	16309210015
COML LIQUIDATION PPTY 5 L L C	390 GREENWICH ST 6TH FLR NEW YORK NY	16309210006
COML LIQUIDATION PPTY 5 L L C	390 GREENWICH ST 6TH FLR NEW YORK NY	16309210045
COML LIQUIDATION PPTY 5 L L C	390 GREENWICH ST 6TH FLR NEW YORK NY	16309210249
COML LIQUIDATION PPTY 5 L L C	390 GREENWICH ST 6TH FLR NEW YORK NY	16309210248
COML LIQUIDATION PPTY 5 L L C	390 GREENWICH ST 6TH FLR NEW YORK NY	16309210161
COML LIQUIDATION PPTY 5 L L C	390 GREENWICH ST 6TH FLR NEW YORK NY	16309210029
COML LIQUIDATION PPTY 5 L L C	390 GREENWICH ST 6TH FLR NEW YORK NY	16309210246
COML LIQUIDATION PPTY 5 L L C	390 GREENWICH ST 6TH FLR NEW YORK NY	16309210038
COML LIQUIDATION PPTY 5 L L C	390 GREENWICH ST 6TH FLR NEW YORK NY	16309210041
COML LIQUIDATION PPTY 5 L L C	390 GREENWICH ST 6TH FLR NEW YORK NY	16309210042
COML LIQUIDATION PPTY 5 L L C	390 GREENWICH ST 6TH FLR NEW YORK NY	16309210044
COML LIQUIDATION PPTY 5 L L C	390 GREENWICH ST 6TH FLR NEW YORK NY	16309210245
COML LIQUIDATION PPTY 5 L L C	390 GREENWICH ST 6TH FLR NEW YORK NY	16309210037
COML LIQUIDATION PPTY 5 L L C	390 GREENWICH ST 6TH FLR NEW YORK NY	16309210243
COML LIQUIDATION PPTY 5 L L C	390 GREENWICH ST 6TH FLR NEW YORK NY	16309210163
COML LIQUIDATION PPTY 5 L L C	390 GREENWICH ST 6TH FLR NEW YORK NY	16309210289
COML LIQUIDATION PPTY 5 L L C	390 GREENWICH ST 6TH FLR NEW YORK NY	16309210304
COML LIQUIDATION PPTY 5 L L C	390 GREENWICH ST 6TH FLR NEW YORK NY	16309210305
COML LIQUIDATION PPTY 5 L L C	390 GREENWICH ST 6TH FLR NEW YORK NY	16309210242
COML LIQUIDATION PPTY 5 L L C	390 GREENWICH ST 6TH FLR NEW YORK NY	16309210241
COML LIQUIDATION PPTY 5 L L C	390 GREENWICH ST 6TH FLR NEW YORK NY	16309210051

Report of All Selected Parcels**Case Number:** ROC-42427**Printed On:** Thu: July 14, 2011

<u>Owner</u>	<u>Address</u>	<u>Parcel Number</u>
COML LIQUIDATION PPTY 5 L L C	390 GREENWICH ST 6TH FLR NEW YORK NY	16309210240
COML LIQUIDATION PPTY 5 L L C	390 GREENWICH ST 6TH FLR NEW YORK NY	16309210052
COML LIQUIDATION PPTY 5 L L C	390 GREENWICH ST 6TH FLR NEW YORK NY	16309210162
COML LIQUIDATION PPTY 5 L L C	390 GREENWICH ST 6TH FLR NEW YORK NY	16309210238
COML LIQUIDATION PPTY 5 L L C	390 GREENWICH ST 6TH FLR NEW YORK NY	16309210237
COML LIQUIDATION PPTY 5 L L C	390 GREENWICH ST 6TH FLR NEW YORK NY	16309210244
COML LIQUIDATION PPTY 5 L L C	390 GREENWICH ST 6TH FLR NEW YORK NY	16309210257
COML LIQUIDATION PPTY 5 L L C	390 GREENWICH ST 6TH FLR NEW YORK NY	16309210036
COML LIQUIDATION PPTY 5 L L C	390 GREENWICH ST 6TH FLR NEW YORK NY	16309210255
COML LIQUIDATION PPTY 5 L L C	390 GREENWICH ST 6TH FLR NEW YORK NY	16309210032
COML LIQUIDATION PPTY 5 L L C	390 GREENWICH ST 6TH FLR NEW YORK NY	16309210256
COML LIQUIDATION PPTY 5 L L C	390 GREENWICH ST 6TH FLR NEW YORK NY	16309210031
COML LIQUIDATION PPTY 5 L L C	390 GREENWICH ST 6TH FLR NEW YORK NY 10013-2375	16309210266
COML LIQUIDATION PPTY 5 L L C	390 GREENWICH ST 6TH FLR NEW YORK NY	16309210035
COML LIQUIDATION PPTY 5 L L C	390 GREENWICH ST 6TH FLR NEW YORK NY 10013-2375	16309210244
COML LIQUIDATION PPTY 5 L L C	390 GREENWICH ST 6TH FLR NEW YORK NY 10013-2375	16309210310
COML LIQUIDATION PPTY 5 L L C	390 GREENWICH ST 6TH FLR NEW YORK NY	16309210258
COML LIQUIDATION PPTY 5 L L C	390 GREENWICH ST 6TH FLR NEW YORK NY	16309210258
COML LIQUIDATION PPTY 5 L L C	390 GREENWICH ST 6TH FLR NEW YORK NY	16309210030
COML LIQUIDATION PPTY 5 L L C	390 GREENWICH ST 6TH FLR NEW YORK NY	16309210251
COML LIQUIDATION PPTY 5 L L C	390 GREENWICH ST 6TH FLR NEW YORK NY	16309210164
COML LIQUIDATION PPTY 5 L L C	390 GREENWICH ST 6TH FLR NEW YORK NY	16309210254
CONGER MICHELLE D	8321 MONARCH BIRCH AVE LAS VEGAS NV 89117-1892	16304413030
CONNORS VICKI J	8456 PACIFIC SPRING AVE LAS VEGAS NV 89117-1809	16304412033
COOK SHERWOOD N QUAL PERS RES TR	COOK LYNETTE B QUAL PERS RES TR 8308 FULLMOON MAPLE AVE LAS VEGAS NV 89117-1895	16304413027
CORAN SAMUEL & MA CATALINA T	1015 RIVERVIEW CRESCENT PICKERING ON L1V 4M5 CANADA	16309110006
CORAN SAMUEL & MA CATALINA T	1015 RIVERVIEW CRESCENT PICKERING ON L1V 4M5 CANADA	16309110006
CORBU MARIAN	2629 S DECATUR BLVD #204 LAS VEGAS NV	16308512084
CORNETT TOM & MARY LIVING TRUST	2750 S DURANGO DR #1157 LAS VEGAS NV	16309210166
COSTELLO T E QUALIFIED RES TR	COSTELLO D S QUALIFIED RES TR 2200 TRIDENT MAPLE ST LAS VEGAS NV 89117-1893	16304413019
CRANSTON K B FAM INTER VIVAS REV	2865 CRESTVIEW DR SALT LAKE CITY UT	16309110057

Report of All Selected Parcels**Case Number:** ROC-42427**Printed On:** Thu: July 14, 2011

<u>Owner</u>	<u>Address</u>	<u>Parcel Number</u>
CRAVEN KATHRYN HASWELL	2121 S CIMARRON RD LAS VEGAS NV 89117-1919	16304307010
CRAWFORD RAYMONDE & DEBORAH A	8448 PACIFIC FOUNTAIN LAS VEGAS NV 89117-1860	16304412070
CRINER LISA MAE REVOCABLE LIV TR	8410 ELDORA ST #2048 LAS VEGAS NV	16309112096
CROCKER JOANNE M	8410 ELDORA AVE #1069 LAS VEGAS NV 89117-2676	16309112137
CROCKER JOANNE M	8410 ELDORA AVE #1069 LAS VEGAS NV	16309112137
CRUSE BRENDA C	12119 WASHINGTON RD WATERFORD CA 95386-9403	16309112173
CRUSE BRENDA C	12119 WASHINGTON RD WATERFORD CA	16309112173
CRUZ MARTHA D	8410 W ELDORA AVE #2005 LAS VEGAS NV 89117-2677	16309112011
CRUZ MARTHA D	8410 W ELDORA AVE #2005 LAS VEGAS NV	16309112011
CSIZMADIA TIMOTHY M & VICKI LEE	8410 ELDORA AVE #2041 LAS VEGAS NV 89117-2678	16309112083
CSIZMADIA TIMOTHY M & VICKI LEE	8410 ELDORA AVE #2041 LAS VEGAS NV	16309112083
CUA THERESA M & RAMON V	8521 O'BANNON DR LAS VEGAS NV 89117-8957	16304417014
CULLEN VIRGINIA & SCHUYLER	5622 ORA ST SAN JOSE CA	16309110127
CURTIS RALPH	4320 COPPER CLIFF LN MODESTO CA 95355-8966	16309110167
CURTIS RALPH	4320 COPPER CLIFF LN MODESTO CA	16309110167
CUTLER HAROLD REVOCABLE 1991 TR	5248 BREAKERS WY OXNARD CA	16309112045
CUTLER HAROLD REVOCABLE 1991 TR	CUTLER HAROLD TRS 5248 BREAKERS WY OXNARD CA 93035-1007	16309112045
DABOUR MICHAEL	P O BOX 250 BAKER CA 92309-0250	16304417016
DALASTA GARY M & BETTY J	2606 S DURANGO DR #233 LAS VEGAS NV 89117-2654	16309111319
DANTE ROBERT & SANDRA J	3515 E FARM RD 26 FIAR GROVE MO	16309210092
DAVIDSON RES REAL EST L L C	%S DAVIDSON 1920 COLUMBIA CREST CT LAS VEGAS NV 89117-8904	16304310004
DAVIS JOHN	8455 W SAHARA AVE #277 LAS VEGAS NV	16309110110
DAY GARY G QUALIFIED PERS RES TR	DAY GARY G TRS 2279 CASA BELLA CT LAS VEGAS NV 89117-8934	16304415005
DEAN WILLIAM H	8408 PACIFIC FOUNTAIN AVE LAS VEGAS NV 89117-1817	16304412079
DEDEAUX SHERMAN J	2900 S VALLEY VIEW #58 LAS VEGAS NV 89102-5930	16309110124
DEDEAUX SHERMAN J	2900 S VALLEY VIEW #58 LAS VEGAS NV	16309110124
DEIULIIS JENNIFER	8410 ELDORA AVE #2013 LAS VEGAS NV	16309112029
DEIULIIS JENNIFER	8410 ELDORA AVE #2013 LAS VEGAS NV 89117-2677	16309112029
DELAER JIM VAN	BAL ANJA R 2777 PARADISE RD #1703 LAS VEGAS NV 89109-1261	16309111234
DELANEY MELANIE	641 CABRILLO AVE SANTA CRUZ CA 95065-1150	16304412078
DELEVESQUE SILVANA CAROLINA K	2619 S DURANGO DR #102 LAS VEGAS NV	16308512050
DELEVESQUE SILVANA CAROLINA K	2619 S DURANGO DR #102 LAS VEGAS NV 89117-2662	16308512050

Report of All Selected Parcels**Case Number:** ROC-42427**Printed On:** Thu: July 14, 2011

<u>Owner</u>	<u>Address</u>	<u>Parcel Number</u>
DELISO MARIO	3457 STE-CATHERINE ST E #7 MONTREAL QUEBEC H1W2E3	16309110020
DELISO MARIO	3457 STE-CATHERINE ST E #7 MONTREAL QUEBEC H1W2E3	16309110020
DELROSARIO ARTHUR & LORRAINE	9604 CHALROVE VILLAGE AVE LAS VEGAS NV	16309210142
DENICK JOHN III	DZIALOWSKI ROSE SEGAL ESTATE 2611 S DURANGO DR #203 LAS VEGAS NV 89117-2660	16308512029
DENICK JOHN III	2611 S DURANGO DR #203 LAS VEGAS NV	16308512029
DEROSEMONT MOEAVA & ALEXANDRA	8000 W BADURA AVE #2126 LAS VEGAS NV 89113-2117	16309111250
DETAR FAMILY TRUST	DETAR WAYNE A & SARAH E TRS 8410 ELDORA AVE #1029 LAS VEGAS NV 89117-7609	16309112057
DETAR FAMILY TRUST	8410 ELDORA AVE #1029 LAS VEGAS NV	16309112057
DEWEY CHARLES & KITTIM	8410 ELDORA AVE SPRING VALLEY NV	16309112108
DIANELLA 1996 TRUST	2627 S DURANGO DR #101 LAS VEGAS NV	16308512073
DIASPARRA FAMILY TRUST	DIASPARRA SILVESTRO J & A T TRS 2300 TRIDENT MAPLE ST LAS VEGAS NV 89117-1894	16304413017
DIAZ GUERRERO & MARIA	2173 S LISA LN LAS VEGAS NV 89117-1833	16304401005
DIFIORE DIANE M	8410 ELDORA AVE BLDG 27 #2063 LAS VEGAS NV	16309112129
DIFIORE DIANE M	8410 ELDORA AVE BLDG 27 #2063 LAS VEGAS NV 89117-2612	16309112129
DILTZ ISABEL F	2615 S DURANGO DR #202 LAS VEGAS NV	16308512040
DIMERCURIO THOMAS	4312 E PATERO WY LONG BEACH CA	16309210232
DIMITROV PETRANKA	2902 WINDSET CT LAS VEGAS NV 89135-2301	16309111235
DINCEL AHMET	7911 AVALON ISLAND ST LAS VEGAS NV	16309210217
DININSKI IVAYLO MITSISLAVOV	P O BOX 71142 LAS VEGAS NV	16309112172
DISALVO MARILYN WALKER LIVING TR	8410 ELDORA AVE #1045 LAS VEGAS NV	16309112089
DISTASIO CYNTHIA H	8410 ELDORA AVE #1058 LAS VEGAS NV	16309112114
DIY ALFONSO R & RUTH MARY	313 W ACACIA AVE EL SEGUNDO CA	16309110113
DODGE SANDRA & ALBERT	7568 EVENING FALLS DR LAS VEGAS NV	16309112066
DOLMAYAN JOHN	7530 ATHERTIN LN WEST HILLS CA 91304-5207	16309112158
DOLMAYAN JOHN	7530 ATHERTIN LN WEST HILLS CA	16309112158
DOLMAYAN JOHN HOVIG	16000 VENTURA BLVD #600 ENCINO CA	16309112162
DOLMAYAN JOHN HOVIG	16000 VENTURA BLVD #600 ENCINO CA 91436-2753	16309112162
DONOHUE STEVEN & PATRICIA	2645 S DURANGO DR #201 LAS VEGAS NV	16308512129
DOUMANI SYDNEY	8617 LAKERIDGE CIR LAS VEGAS NV 89117-5828	16305812021
DOUMANI SYDNEY	8617 LAKERIDGE CIR LAS VEGAS NV 89117-5828	16305812022
DOWDEN VIRGIE W REVOCABLE LIV TR	4046 W SLAUSEN AVE LOS ANGELES CA 90043-2804	16304412050
DUNN WALLACE E	561 W DIVERSEY ST #204 CHICAGO IL	16309110135

Report of All Selected Parcels**Case Number:** ROC-42427**Printed On:** Thu: July 14, 2011

<u>Owner</u>	<u>Address</u>	<u>Parcel Number</u>
DUNN WALLACE E	561 W DIVERSEY #204 CHICAGO IL	16309110021
DUNN WALLACE E	561 W DIVERSEY ST #204 CHICAGO IL 60614-1682	16309110135
DYE RONALD FAMILY TRUST	DYE RONALD D & KATHIE Z TRS 2201 NORWAY MAPLE ST LAS VEGAS NV 89117-1896	16304413004
DYLE MARK K & DAWN E	5445 DESERT POINT DR #A LAS VEGAS NV 89118-6226	16305812010
E V HOLDINGS L P	7880 VIA OLIVERO LAS VEGAS NV 89117-1917	16309111251
EGE ROGER D	349 E 3350 N OGDEN UT	16309112016
EGE ROGER D	349 E 3350 N OGDEN UT 84414-1572	16309112016
EHLERT JOANN & DREW D	295 KELSEY PARK CIR PALM BEACH GARDENS FL	16309112074
EINHORN ARTHUR & CAROL	8671 CHRISTOPHER LEE CIR LAS VEGAS NV 89129-2204	16304417028
EISNER KAREN A	8616 LAKERIDGE CIR LAS VEGAS NV 89117-5829	16305812017
EKCHIAN JACQUELINE & JIRAYR	30 ESTERBROOKE AVE #311 NORTH YORK ON M2J 2C4 CANADA	16309110092
EKCHIAN JACQUELINE & JIRAYR	30 ESTERBROOKE AVE #311 NORTH YORK ON M2J 2C4 CANADA	16309110092
EKCHIAN JIRAYR & JACQUELINE	30 ESTERBROOK AVE #311 NORTH YORK ON M2J 2C4 CANADA	16309110062
EKCHIAN JIRAYR & JACQUELINE	30 ESTERBROOK AVE #311 NORTH YORK ON M2J 2C4 CANADA	16309110062
ELKOUBY ALBERT	613 N ALPINE DR BEVERLY HILLS CA 90210-3303	16309102002
ELNES 1991 TRUST	ELNES DAVID W & TONIA CO-TRS 2021 LORO CT LAS VEGAS NV 89117-1856	16304310009
EMELO JESSICA ALBA	10462 LYRIC ARBOR DR LAS VEGAS NV 89135-4037	16304417030
EMERY FAMILY LIVING TRUST 1980	EMERY WALTER A TRS %SPEEDEE MART INC 1188 WIGWAM PKWY HENDERSON NV 89074-8154	16304405002
EQUITY TRUST COMPANY CUST	P O BOX 1409 ELYRIA OH	16309110047
ESPOSITO AMBROSE	10197 W HIGGINS RD #206 ROSEMONT IL 60018-5618	16309112124
ESPOSITO AMBROSE	10197 W HIGGINS RD #206 ROSEMONT IL	16309112124
ESSAIAN ALEXANDER	5963 MOHAWK DR SAN JOSE CA	16309112177
ESSAIAN ALEXANDER	5963 MOHAWK DR SAN JOSE CA 95123-4112	16309112177
EXOZIAN ARTOUR	2268 AUTUMN FIRE CT LAS VEGAS NV 89117-8955	16304417024
EYLAR PAULA E LIVING TRUST 2006	P O BOX 370706 LAS VEGAS NV	16309112014
EYLAR PAULA E LIVING TRUST 2006	EYLAR PAULA E TRS P O BOX 370706 LAS VEGAS NV 89137-0706	16309112015
EYLAR PAULA E LIVING TRUST 2006	P O BOX 370706 LAS VEGAS NV	16309112015
F L T C LIVING TRUST	TSENG MING CHIH TRS 2309 WHISPERING HILLS CIR LAS VEGAS NV 89117-5849	16305812030
FAIERSTAIN MIHAELA	9025 CYPRESS POINT WY LAS VEGAS NV	16308512115
FAIRFIELD SHANNON A	8410 ELDORA AVE #2066 LAS VEGAS NV	16309112132
FANCHER PHILIP D & ARLENE E	2373 MARTINIQUE LN OXNARD CA	16309110007

Report of All Selected Parcels**Case Number:** ROC-42427**Printed On:** Thu: July 14, 2011

<u>Owner</u>	<u>Address</u>	<u>Parcel Number</u>
FANNIE MAE	%LENDER BUS PROCESS SERV 14523 SW MILLIKAN WY #200 BEAVERTON OR	16309210136
FANNIE MAE	%FED NATL MTGE ASSN 135 N LOS ROBLES #300 PASADENA CA	16309210109
FANNIE MAE	%LENDER BUSINESS PROCESS SERV 14523 S W MILLIKAN WY #200 BEAVERTON OR	16309210225
FARADON YAIR	P O BOX 4672 PARKER CO	16309110096
FARADON YAIR	P O BOX 4672 PARKER CO 80134-1460	16309110096
FARIAS DAVID A TRUST	7100 PIRATES COVE RD #1030 LAS VEGAS NV	16309112128
FEDERAL HOME LOAN MORTGAGE CORP	1000 TECHNOLOGY DR MS 314 OFALLON MO	16309110120
FEDERAL NATIONAL MORTGAGE ASSN	400 NATIONAL WY SIMI VALLEY CA. 93065-6414	16309112021
FEDERAL NATIONAL MORTGAGE ASSN	%RECONTRUST CO 400-NATIONAL WY SIMI VALLEY CA	16309110026
FEDERAL NATIONAL MORTGAGE ASSN	%RECONTRUST CO 400 COUNTRYWIDE WY SV-35 SIMI VALLEY CA	16309210089
FEDERAL NATIONAL MORTGAGE ASSN	135 N LOS ROBLES AVE PASADENA CA	16309210017
FEDERAL NATIONAL MORTGAGE ASSN	400 NATIONAL WY SIMI VALLEY CA	16309112021
FEDERAL NATIONAL MORTGAGE ASSN	14523 S W MILLIKAN WY #200 BEAVERTON OR 97005-2352	16304412002
FEDERAL NATIONAL MORTGAGE ASSN	400 NATIONAL WY SIMI VALLEY CA	16309210115
FEDERAL NATIONAL MORTGAGE ASSN	400 NATIONAL WY SIMI VALLEY CA	16309210307
FEDERAL NATIONAL MORTGAGE ASSN	400 COUNTRYWIDE WY SV-35 SIMI VALLEY CA	16309210192
FEDERAL NATIONAL MORTGAGE ASSN	%IBM LBPS 14523 S W MILLIKAN WY #200 BEAVERTON OR	16309210135
FEDERAL NATIONAL MORTGAGE ASSN	400 NATIONAL WY SIMI VALLEY CA	16309210091
FENG STANLEY & EUNICE YUI FIN	507 GORMAN AVE WOODBRIDGE NJ	16309210284
FERGUSON CYNTHIA L	8455 W SAHARA AVE #113 LAS VEGAS NV	16309110073
FERNANDEZ JOSE S & HELEN REV TR	FERNANDEZ JOSE S & HELEN CO-TRS 926 WEIBEL CIR OAKLEY CA 94561-3038	16309111199
FERNANDEZ MANUEL & MARY HELEN	5326 COVEY CREEK CT STOCKTON CA	16309110173
FERNANDEZ MANUEL & MARY HELEN	5326 COVEY CREEK CT STOCKTON CA 95207-5328	16309110173
FIELD HIDEMI	2116 DIAMOND BROOK CT LAS VEGAS NV 89117-1866	16304312024
FIORENTINO JOSEPH A TRUST	FIORENTINO JOSEPH A TRS 8489 PACIFIC SPRING AVE LAS VEGAS NV 89117-1863	16304412021
FISHER RITA ANN	2120 DIAMOND BROOK CT LAS VEGAS NV 89117-1866	16304312025
FOCAZIO GWEN W TRUST	FOCAZIO GWEN W TRS 19624 ROSCOE BLVD #A NORTHRIDGE CA 91324-4167	16304312023
FONSECA JOHN	222 JESSIE ST #H SAN FERNANDO CA	16308512096
FORREST SALLEY A	8410 ELDORA AVE #1065 LAS VEGAS NV	16309112127
FORTUNE 808 L L C	5527 S RAINBOW BLVD #B LAS VEGAS NV	16309210033
FOSELLI 1996 REVOCABLE TRUST	FOSELLI THOMAS & CAROL A CO-TRS 2113 DIAMOND PEAK CT LAS VEGAS NV 89117-1868	16304311002
FRANCO EDWARD C	2750 S DURANGO DR LAS VEGAS NV	16309210147

Report of All Selected Parcels**Case Number:** ROC-42427**Printed On:** Thu: July 14, 2011

<u>Owner</u>	<u>Address</u>	<u>Parcel Number</u>
FREEMAN RICHARD	12001 SE 17TH ST VANCOUVER WA	16309110049
FREEMAN ROBERT	8455 W SAHARA AVE #227 LAS VEGAS NV	16309110139
FRY RICHARD A & GLORIA J	2110 LORO CT LAS VEGAS NV 89117-1857	16304310006
FU XIAOYU & PHILLIP TINGXIANG	2600 HAYRIDE CT ROWLAND HEIGHTS CA	16309110138
FUSCO FAMILY TRUST	FUSCO ARTHUR A & JOELLEN TRS 8116 PEBBLESHIRE AVE LAS VEGAS NV 89117-1370	16309111259
G G LIVING TRUST	GOLDBERG GERTRUDE GERI TRS 2308 WHISPERING HILLS CIR LAS VEGAS NV 89117-5824	16305812034
G W H C NEVADA L L C	3065 S JONES BLVD #201 LAS VEGAS NV 89146-6780	16304406004
GALACHYAN GRACHYA	11008 FRUITLAND DR #6 STUDIO CITY CA	16308512025
GALLIHER FAMILY 1996 TRUST	GALLIHER KEITH JR & LINDA L TRS 8609 TITLEIST CIR LAS VEGAS NV 89117-5844	16305812015
GANTMAN SERGEY V	121 SINCLAIR AVE #239 GLENDALE CA	16309110128
GAO CHENYUN	5086 FALMOUTH DR TROY MI	16309112072
GAO CHENYUN	CHENG YANZHEN 5086 FALMOUTH DR TROY MI 48085-3214	16309112072
GAP-DS L L C	8350 W SAHARA AVE #210 LAS VEGAS NV 89117-8941	16304416004
GARBER BRIAN & SANDRA	973 PAINTED PONY HENDERSON NV 89014-3062	16304307011
GARCIA BENJAMIN C & VIOLETA P	2279 AUTUMN FIRE CT LAS VEGAS NV 89117-8956	16304417004
GARCIA RODRIGO	6291 CERRITOS AVE LONG BEACH CA	16309210221
GARCIA RODRIGO	6291 CERRITOS AVE LONG BEACH CA	16309210231
GARFINKEL LOUIS ETAL	10724 WEATHER TOP CT LAS VEGAS NV 89135-1801	16308512011
GARFINKEL LOUIS ETAL	10724 WEATHER TOP CT LAS VEGAS NV	16308512011
GEKCHYAN TIGRAN	5119 EL RIO AVE LOS ANGELES CA	16309112102
GEKCHYAN TIGRAN	5119 EL RIO AVE LOS ANGELES CA 90041-1118	16309112102
GENOVA DON	8455 W SAHARA AVE #123 LAS VEGAS NV	16309110068
GEORGE CONSTANTINE	2264 AUTUMN FIRE CT LAS VEGAS NV 89117-8955	16304417023
GEORGE DIANA M	2613 S DURANGO DR #204 LAS VEGAS NV	16308512036
GEORGE DIANA M	2613 S DURANGO DR #204 LAS VEGAS NV 89117-2624	16308512036
GERBINO ANTHONY & JOANNE	2245 OASIS PALM CT LAS VEGAS NV 89117-1807	16304410006
GEVORKIAN FAMILY TRUST	GEVORKIAN GRIGOR & AGHAVNI TRS 8609 LAKERIDGE CIR LAS VEGAS NV 89117-5828	16305812036
GILL J 1992 TRUST	GRADY R & J FAMILY TRUST 2240 COUNTRY COTTAGE CT LAS VEGAS NV 89117-1845	16304411005
GILMARTIN D & J 2003 TRUST	3651 LUMINAL LN LAS VEGAS NV	16308512074
GIRMA SEBSEBACHEW Y	2615 S DURANGO DR #101 LAS VEGAS NV	16308512037
GLACIER VINTAGE INC	%SENTINEL REAL EST CORP 1251 AVE OF THE AMERICAS NEW YORK NY 10020-1104	16309102013
GLEASON JOE & KAY	9669 GROUSE GROVE AVE LAS VEGAS NV 89148-4718	16309112044

Report of All Selected Parcels**Case Number:** ROC-42427**Printed On:** Thu: July 14, 2011

<u>Owner</u>	<u>Address</u>	<u>Parcel Number</u>
GLEASON JOE & KAY	9669 GROUSE GROVE AVE LAS VEGAS NV	16309112044
GLENN LORI	2625 S DURANGD DR #203 LAS VEGAS NV	16308512071
GLOVER WESLEY E & SHARON FJARE	1939 BELCASTRO ST LAS VEGAS NV 89117-2142	16304402003
GLOVER WESLEY E & SHARDN FJARE	1939 BELCASTRO ST LAS VEGAS NV 89117-2142	16304402002
GOINS BRENNAN	2750 S DURANGO #1045 LAS VEGAS NV	16309210025
GOLDEN JILL	121 HARRISON AVE SAN ANTONIO TX	16308512110
GOLDEN STATE R E O PROPERTIES	1005 LDS TUNAS DR #125 SAN GABRIEL CA	16309210055
GDMEZ AUGUSTO A	9688 MEEKS BAY AVE LAS VEGAS NV	16309110075
GODDARZI SANAZ	8455 W SAHARA #175 LAS VEGAS NV	16309110010
GDRDDN FAMILY IRREVOCABLE TRUST	SMITH RD NALD L TRS 8305 MONARCH BIRCH AVE LAS VEGAS NV 89117-1891	16304413024
GOSENG DEXTER	CAJANAP MA JEANNETH M 2033 W MDUNTAIN ST GLENDALE CA 91201-1259	16309110102
GOSENG DEXTER	2033 W MOUNTAIN ST GLENDALE CA	16309110102
GOSSER ESTHER	8410 ELDORA ST #2085 LAS VEGAS NV	16309112171
GOZANSKI ANTHONY P	17 E HAYES CT SUPERIOR WI	16308512121
GRAHAM PAULINE M	8436 PACIFIC SPRING AVE LAS VEGAS NV 89117-1809	16304412038
GRAVES BEVERLY	5225 CANYON CREST DR #71-204 RIVERSIDE CA	16309110041
GRAY ROBERT D & VIRGINIA R	8410 ELDORA AVE #1076 LAS VEGAS NV	16309112150
GREAT AMERICAN PLAZA L L C	8350 W SAHARA AVE #210 LAS VEGAS NV 89117-8941	16304416008
GREAT AMERICAN PLAZA OFFICE LLC	8350 W SAHARA #210 LAS VEGAS NV 89117-8941	16304416005
GREAT AMERICAN PLAZA PAD L L C	%GREAT AMER CAPITAL %A RDELINSKY 8350 W SAHARA AVE #210 LAS VEGAS NV 89117-8941	16304416002
GREAT AMERICAN PLAZA RETAIL LLC	8350 W SAHARA #210 LAS VEGAS NV 89117-8941	16304416003
GREAT AMERICAN PLAZA RETAIL LLC	8350 W SAHARA #210 LAS VEGAS NV 89117-8941	16304416007
GREENE JANICE L	2613 S DURANGD DR #203 LAS VEGAS NV 89117-2624	16308512035
GREENE JANICE L	2613 S DURANGD DR #203 LAS VEGAS NV	16308512035
GREENWALD JAMIE D	8472 PACIFIC FOUNTAIN AVE LAS VEGAS NV 89117-1860	16304412065
GRILL DDRDTHY	8410 ELDORA AVE #1012 LAS VEGAS NV	16309112020
GRINDEL PETER M & WILMA J	3103 SPRINGBROOK RD MEDFDRD OR	16308512032
GRINDEL PETER M & WILMA J	JAHANSOOZ KAYVAN & BARBARA 3103 SPRINGBROOK RD MEDFORD OR 97504-4900	16308512032
GRDLEMUND GERALD	2263 AUTUMN FIRE CT LAS VEGAS NV 89117-8955	16304417008
GUADIZ STEVEN	2461 WAGNER ST #8 PASADENA CA	16309110055
GUENTHER BRADLEY R & OLGA N	2112 DIAMOND PEAK CT LAS VEGAS NV 89117-1868	16304311019

Report of All Selected Parcels**Case Number:** ROC-42427**Printed On:** Thu: July 14, 2011

<u>Owner</u>	<u>Address</u>	<u>Parcel Number</u>
GUIDO ANDREW J	2750 S DURANGO DR #2026 LAS VEGAS NV	16309210132
HAAS JENNIFER	2617 S DURANGO DR #101 LAS VEGAS NV	16308512043
HADEN DOROTHY LOUISE	2623 S DURANGO DR #203 LAS VEGAS NV	16308512065
HAECKE DENNIS	2221 COUNTRY COTTAGE CT LAS VEGAS NV 89117-1845	16304411001
HAJJAR DIMITRI	P O BOX 890473 TEMECULA CA	16309210088
HALLUK JUAN	514 CANYON COVE W LETHBRIDGE AB T1K 2N4 CANADA	16309210013
HAMID MOHD FIRAS M	2750 S DURANGO DR #1023 LAS VEGAS NV	16309210125
HAMMOND JAYME	612 BAYSVILLE CT LAS VEGAS NV 89144-4414	16304412063
HAMPTON MANUEL JR & MARGARITA	10466 CADWELL RD SANTEE CA	16309112106
HAMPTON MANUEL JR & MARGARITA	10466 CADWELL RD SANTEE CA 92071-1076	16309112106
HAMPTON MANUEL JR & MARGARITA	10466 CADWELL RD SANTEE CA	16309112157
HANSEN SAMANTHA & JOHN	9782 S FLYNN RD LIVERMORE CA	16309110160
HARBER IRIS A	2607 S DURANGO DR #101 LAS VEGAS NV	16308512013
HARDY G A	8923 W CUSTER LN PEORIA AZ	16308512124
HARIOKA LIVING TRUST	HARIOKA DON A & BEATRIZ TRS 55 TORINO CT DANVILLE CA 94526-1930	16309114026
HARRELL SHARON G	2101 DIAMOND PEAK CT LAS VEGAS NV 89117-1868	16304311005
HARRIS JANA H	8410 ELDORA AVE #1007 LAS VEGAS NV 89117-2674	16309112013
HARRIS JANA H	8410 ELDORA AVE #1007 LAS VEGAS NV	16309112013
HARRIS SAOWAKON P	8455 W SAHARA AVE #281 LAS VEGAS NV	16309110106
HARVEY JAMES A	2750 S DURANGO #2106 LAS VEGAS NV	16309210312
HASSLER CLARA LIVING TRUST	8455 W SAHARA AVE #210 LAS VEGAS NV	16309110171
HAW ROBERT E JR & KATHERINE A	8417 PACIFIC FOUNTAIN AVE LAS VEGAS NV 89117-1859	16304412047
HAYES BETTY A	8410 ELDORA AVE #1049 LAS VEGAS NV	16309112097
HAZARD W EDDY & BETTY A	177 BACK ST HEBRON ME	16308512085
HEKIMYAN ARSEN	6653 N TROOST AVE NO HOLLYWOOD CA	16308512091
HENDERSON KENNETH J	2750 S DURANGO DR #1153 LAS VEGAS NV	16309210174
HENDERSON PEGGY E & JOSEPH F	435 OLYMPIA AVE LONGMONT CO	16309112110
HENDERSON PEGGY E & JOSEPH F	435 OLYMPIA AVE LONGMONT CO 80504-2332	16309112110
HENLIN ERIN	2750 S DURANGO DR #2150 LAS VEGAS NV	16309210194
HENRIE ROBERT	837 E SOUTH TEMPLE SALT LAKE CITY UT 84102-1304	16304412080
HERMAN WILLIAM J & EUGENIA M	5326 S NARRAGANSETT CHICAGO IL	16308512111
HERNANDEZ-TORRES ERIK	2635 S DURANGO DR #202 LAS VEGAS NV	16308512100

Report of All Selected Parcels**Case Number:** ROC-42427**Printed On:** Thu: July 14, 2011

<u>Owner</u>	<u>Address</u>	<u>Parcel Number</u>
HERRERIA MAURO A & LYDIA C	4380 KEAKA DR HONOLULU HI	16309210146
HERRINGTON MITCHELL E	2317 PACIFIC CREEK ST LAS VEGAS NV 89117-1812	16304412023
HESS MICHAEL J	8410 ELDORA ST #1019 LAS VEGAS NV 89117-2674	16309112037
HESS MICHAEL J	8410 ELDORA ST #1019 LAS VEGAS NV	16309112037
HIGGINSON MATTHEW	2750 S DURANGO DR #2154 LAS VEGAS NV	16309210177
HINCKLEY 2006 TRUST	HINCKLEY WILLIAM T TRS 8320 MONARCH BIRCH AVE LAS VEGAS NV 89117-1892	16304413003
HIRANO SHINGO & KYOKO M	8455 W SAHARA AVE #271 LAS VEGAS NV	16309110104
HISA JACK F	DU CAROLINE 2606 S DURANGO DR #177 LAS VEGAS NV 89117-2653	16309111214
HOADLEY SCOTT W & DONNA R	8455 W SAHARA AVE #226 LAS VEGAS NV	16309110155
HODSON D & J 1998 LIV TR AGMT	HODSON DERRICK I & JAN M TRS 2101 SHENLEY CT LAS VEGAS NV 89117-8924	16304316010
HOGAN KATHLEEN A TRUST	HOGAN KATHLEEN A TRS 2249 OASIS PALM CT LAS VEGAS NV 89117-1807	16304410007
HOLCOMBE FAMILY TRUST	HOLCOMBE JAMES II & BARBARA TRS 8316 MONARCH BIRCH AVE LAS VEGAS NV 89117-1892	16304413002
HOLCOMBE FAMILY TRUST	%J HOLCOMBE 8300 MONARCH BIRCH AVE LAS VEGAS NV 89117-1891	16304413020
HOLGUIN HEATHER & JAMES	2750 S DURANGO #1061 LAS VEGAS NV	16309210064
HOLLAND DIEDRE S	9912 COZY GLEN CIR LAS VEGAS NV	16308512104
HOLMES TIMOTHY T & MARIE GRACE	2309 PACIFIC CREEK ST LAS VEGAS NV 89117-1812	16304412025
HOMEIDAN MONA	10300 W CHARLESTON BLVD #13135 LAS VEGAS NV	16309110018
HONG RICHARD & SHERRI	140 SHEFFIELD RD ALAMEDA CA	16309110117
HONG RICHARD & SHERRI	140 SHEFFIELD RD ALAMEDA CA 94502-7421	16309110117
HOPPES SANDRA	VACCARIELLO RAY J 8875 TIDAL BAY DR LAS VEGAS NV 89117-1027	16304412074
HORN JOHN	4650 NELSON RD #224 LAKE CHARLES LA	16309110100
HOVANEK GEORGE T & GERALDINE A	19444 BUCKINGHAM SHIRE N ROYALTON OH	16309110054
HOVANEK GEORGE T & GERALDINE A	19444 BUCKINGHAM SHIRE N ROYALTON OH 44133-6061	16309110054
HOYOS OLMEDO	2580 S DECATUR BLVD #K4A LAS VEGAS NV 89102-8595	16309114027
HRYMACK DAVID M	2615 S DURANGO DR #203 LAS VEGAS NV	16308512041
HUDSON OMAR	1200 65TH ST #208 EMERYVILLE CA	16309110112
HUDSON OMAR	1200 65TH ST #208 EMERYVILLE CA 94608-1136	16309110112
HUSSON BRENT L & ANNA BELLE T	8410 ELDORA AVE #1003 LAS VEGAS NV	16309112005
HUSSON BRENT L & ANNA BELLE T	8410 ELDORA AVE #1003 LAS VEGAS NV 89117-2674	16309112005
HUYNH HANH	2750 S DURANGO DR #2070 LAS VEGAS NV	16309210090
HWANG HYA JA	8410 ELDORA AVE #2033 LAS VEGAS NV 89117-7611	16309112067
HWANG HYA JA	8410 ELDORA AVE #2033 LAS VEGAS NV	16309112067

Report of All Selected Parcels**Case Number:** ROC-42427**Printed On:** Thu: July 14, 2011

<u>Owner</u>	<u>Address</u>	<u>Parcel Number</u>
HWUNG DEE L L C	1312 MARENGO AVE SOUTH PASADENA CA	16309210095
IACOB CORNELIU J & ELENA	8433 PACIFIC FOUNTAIN AVE LAS VEGAS NV 89117-1861	16304412051
IANNUZZI VINCENT A JR & SONDA	2643 S DURANGO DR #102 LAS VEGAS NV 89117-2672	16308512122
IANNUZZI VINCENT A JR & SONDA	2643 S DURANGO DR #102 LAS VEGAS NV	16308512122
IMAHARA TSUYOSHI & TERUYO ETAL	8842 E FAIRVIEW AVE SAN GABRIEL CA 91775-1210	16309110147
IMAHARA TSUYOSHI & TERUYO ETAL	8842 E FAIRVIEW AVE SAN GABRIEL CA	16309110147
IMMANUEL'S TEMPLE SYSTEMS CHURCH	2610 FIRE MESA LAS VEGAS NV 89128-9043	16304404007
INDIA FAMILY TRUST	BONALY SURYA V TRS 2020 S LISA LN LAS VEGAS NV 89117-1805	16304305002
ING MICHAEL	20693 STORYBROOK CIR RIVERSIDE CA	16308512080
ING MICHAEL & LINDA	20693 STONY BROOK CIR RIVERSIDE CA	16309210068
INTING RICARDO & REYES S LIV TR	8455 W SAHARA AVE #280 LAS VEGAS NV	16309110107
INTING RICARDO & REYES S LIV TR	8455 W SAHARA AVE #280 LAS VEGAS NV 89117-1844	16309110107
IORLANO MARIA	8410 ELDORA AVE #2074 LAS VEGAS NV 89117-2679	16309112148
IORLANO MARIA	8410 ELDORA AVE #2074 LAS VEGAS NV	16309112148
ISGRIG FAMILY TRUST	6550 ELDORA ST LAS VEGAS NV	16309112122
ITKIS YURI & ANNA L LIVING TRUST	ITKIS YURI & ANNA L TRS 8620 LAKERIDGE CIR LAS VEGAS NV 89117-5829	16305812016
JACKSON LILLIE S	4459 DON MIGUEL DR LOS ANGELES CA 90008-2827	16304412036
JACOBSON KIRK R & BRENDA	2100 ALBERTI CT LAS VEGAS NV 89117-1851	16304310013
JACONETTI JOSEPH V & CYNTHIA A	1128 WILLOWCREEK DR YUBA CITY CA	16309210153
JAFFE LON S	2627 S DURANGO DR #204 LAS VEGAS NV	16308512078
JANUS SUSAN	22003 CACERAS ST SANTA CLARITA CA	16309210134
JELLEMA GERALD J	8183 MOSAIC HARBOR AVE LAS VEGAS NV	16309110103
JESSEE JOHN	11290 GRAYRIDGE DR CULVER CITY CA	16309110058
JETER PATRICIA L	13525 ARDMORE PL CHINO CA	16308512093
JEZZINI MARINA FAMILY TRUST	2762 SWEET WILLOW LN LAS VEGAS NV	16309112154
JEZZINI MARINA FAMILY TRUST ETAL	2762 SWEET WILLOW LN LAS VEGAS NV	16309112160
JOHNS ALVIN L JR	2750 S DURANGO #2118 LAS VEGAS NV	16309210252
JOHNSON ECATERINA	8410 ELDORA AVE #1055 LAS VEGAS NV	16309112107
JOHNSON LOUIS A JR & THERESA M	8445 PACIFIC SPRING AVE LAS VEGAS NV 89117-1810	16304412010
JOHNSON MARY ANN	8410 ELDORA ST #2010 LAS VEGAS NV	16309112022
JOHNSON MARY ANN	8410 ELDORA ST #2010 LAS VEGAS NV 89117-2677	16309112022
JOHNSON PATRICIA L	2750 S DURANGO DR #2029 LAS VEGAS NV	16309210100

Report of All Selected Parcels**Case Number:** ROC-42427**Printed On:** Thu: July 14, 2011

<u>Owner</u>	<u>Address</u>	<u>Parcel Number</u>
JOHNSTON FAMILY TRUST	JOHNSTON MICHAEL G & ELENA G TRS 2308 TRIDENT MAPLE ST LAS VEGAS NV 89117-1894	16304413015
JOHNSTON MYRNA J	8410 ELDORA AVE #1085 LAS VEGAS NV	16309112167
JONES CARRIE & CHRISTOPHER	2611 DURANGO BLVD #202 LAS VEGAS NV	16308512028
JONES FRANK & KIM	130 DORE CIRCLE SASKATOON SK S7K 4X7 CANADA	16309110116
JONES RHONDA L	5000 HOLLOW RIDGE CT ANTIOCH CA	16309112131
JONES THEODORE L JR & SHANTY Y	2256 AUTUMN FIRE CT LAS VEGAS NV 89117-8955	16304417021
JORDAHL RONALD M	8421 PACIFIC FOUNTAIN AVE LAS VEGAS NV 89117-1859	16304412048
JOSEPH DONALD C	8410 ELDORA AVE #2078 LAS VEGAS NV 89117-2679	16309112156
JOSEPH DONALD C	8410 ELDORA AVE #2078 LAS VEGAS NV	16309112156
JUDISH TOM & MAUREEN	3004 LASVEN CT CAJON CA 92019-4645	16308512014
JUDISH TOM & MAUREEN	3004 LASVEN CT CAJON CA	16308512014
JULAO MOISES G	JULANO SUSANA S 8410 ELDORA AVE #2079 LAS VEGAS NV 89117-2679	16309112161
JULAO MOISES G	8410 ELDORA AVE #2079 LAS VEGAS NV	16309112161
KAIN THOMAS L JR	9865 WITTIG AVE LAS VEGAS NV 89149-1364	16309112055
KAIN THOMAS L JR	9865 WITTIG AVE LAS VEGAS NV	16309112055
KAKO HIROKO	304-8811 LANSLOWNE RD RICHMOND B C CANADA V6X 3T4	16304412052
KAMACAPA PROPERTIES SERIES L L C	43 THORNTON ST HILLSBOROUGH NJ	16309210108
KAMBOJ EJAZ U	ALIM SABA K 8316 FULLMOON MAPLE AVE LAS VEGAS NV 89117-1895	16304413029
KAPTANJIAN WARTAN & AYKOUSH	3950 SPENCER ST LAS VEGAS NV	16309112061
KAPTANJIAN WARTAN & AYKOUSH	3950 SPENCER ST LAS VEGAS NV 89119-5201	16309112061
KAPTANJIAN WARTAN & AYKOUSH	3950 SPENCER ST LAS VEGAS NV	16309112031
KAPU VERN & LORI A	2310 DISTINCTIVE DR COLORADO SPRINGS CO	16309210196
KARACHEPONE ISSAC	2750 S DURANGO DR #1155 LAS VEGAS NV	16309210168
KARCE AYET	2069 E 26TH ST BROOKLYN NY 11229-2441	16308512006
KARCE AYET	2069 E 26TH ST BROOKLYN NY	16308512006
KARKLYS JULIA	8410 W ELDORA #1021 LAS VEGAS NV	16309112041
KARKLYS JULIA	8410 W ELDORA #1021 LAS VEGAS NV 89117-2674	16309112041
KARP ALLAN M & LEAH N	11509 VELICATA CT LAS VEGAS NV	16309112111
KATIGBAK LEONARDO P	3326 HILLSIDE GARDEN DR LAS VEGAS NV	16309110144
KATZ BARRY STEVEN	2629 S DURANGO DR #202 LAS VEGAS NV	16308512082
KAUFMAN ROBERT J & ARLEEN H	8550 W DESERT INN #102-355 LAS VEGAS NV	16309112142
KAVIANI JAVAD	22 BLOOMFIELD HILLS HENDERSON NV	16309110052

Report of All Selected Parcels**Case Number:** ROC-42427**Printed On:** Thu: July 14, 2011

<u>Owner</u>	<u>Address</u>	<u>Parcel Number</u>
KAY MAI TAM REVOCABLE TRUST	9747 CLAYBOURNE CT LAS VEGAS NV	16309112024
KE HARVEY	P O BOX 516 SAN GABRIEL CA	16308512069
KEANE MARY	3120 CENTAVO DR LAS VEGAS NV 89117-3344	16309111195
KEARNS PATRICIA M	8301 FULLMOON MAPLE AVE LAS VEGAS NV 89117-1895	16304413014
KEENAN AL D	221 DALMATION LN LAS VEGAS NV 89107-2304	16304412049
KEIDEL JOHN D & DIANE M	2100 DIAMOND PEAK CT LAS VEGAS NV 89117-1868	16304311016
KELLEY EDWARD E	9101 W SAHARA AVE #105-J27 LAS VEGAS NV 89117-5772	16309111322
KELLY JANE	P O BOX 750923 LAS VEGAS NV	16309112046
KEMMERER EVA LIVING TRUST ETAL	KEMMERER EVA TRS 18840 LOS ALIMOS ST NORTHRIDGE CA 91326-2747	16304412031
KENT IRENE J	3255 PHANTOM ROCK ST LAS VEGAS NV	16308512079
KENYON KATHRYN H	2619 S DURANGO DR #203 LAS VEGAS NV	16308512053
KENYON KATHRYN H	2619 S DURANGO DR #203 LAS VEGAS NV 89117-2663	16308512053
KEROPYAN ARAM	8456 PACIFIC FOUNTAIN AVE LAS VEGAS NV 89117-1860	16304412068
KERZETSKI BRIAN & HEATHER	2271 AUTUMN FIRE CT LAS VEGAS NV 89117-8956	16304417006
KERZETSKI DAVID	2275 AUTUMN FIVE CT LAS VEGAS NV 89117-8956	16304417005
KETCH ANNA D	2092 SOUTHWEST 17TH CIR DEERFIELD BEACH FL	16309210334
KETTLESON KORTNEY	8410 ELDORA AVE #2047 LAS VEGAS NV	16309112095
KHAZAI ARSHAM	8455 W SAHARA AVE BLDG 14 #214 LAS VEGAS NV	16309110164
KHAZAI ARSHAM	8455 W SAHARA AVE BLDG 14 #214 LAS VEGAS NV 89117-1838	16309110164
KIM RENEE CHI	2625 S DURANGO #204 LAS VEGAS NV	16308512072
KIM SANG SOON	8445 PACIFIC FOUNTAIN AVE LAS VEGAS NV 89117-1861	16304412054
KING 1997 TRUST	KING FRANK A JR & MARY J CO-TRS 8600 TITLEIST CIR LAS VEGAS NV 89117-5843	16305812012
KINSEI SOGO KAIHATSU KABUSHIKI	%SOUTHWEST MGT 2920 S RAINBOW #120 LAS VEGAS NV 89146-6214	16308512020
KINSEI SOGO KAIHATSU KABUSHIKI	%SOUTHWEST MGT 2920 S RAINBOW #120 LAS VEGAS NV 89146-6214	16308512024
KINSEI SOGO KAIHATSU KABUSHIKI	%SOUTHWEST MGT 2920 S RAINBOW #120 LAS VEGAS NV	16308512024
KINSEI SOGO KAIHATSU KABUSHIKI	%SOUTHWEST MGT 2920 S RAINBOW #120 LAS VEGAS NV	16308512023
KINSEI SOGO KAIHATSU KABUSHIKI	%SOUTHWEST MGT 2920 S RAINBOW #120 LAS VEGAS NV	16308512022
KINSEI SOGO KAIHATSU KABUSHIKI	%SOUTHWEST MGT 2920 S RAINBOW #120 LAS VEGAS NV	16308512021
KINSEI SOGO KAIHATSU KABUSHIKI	%SOUTHWEST MGT 2920 S RAINBOW #120 LAS VEGAS NV	16308512019
KINSEI SOGO KAIHATSU KABUSHIKI	%SOUTHWEST MGT 2920 S RAINBOW #120 LAS VEGAS NV	16308512020
KINSEI SOGO KAIHATSU KABUSHIKI	%SOUTHWEST MGT 2920 S RAINBOW #120 LAS VEGAS NV 89146-6214	16308512023
KISTREFF ANNE R	8410 ELDORA AVE #1052 LAS VEGAS NV	16309112100

Report of All Selected Parcels**Case Number:** ROC-42427**Printed On:** Thu: July 14, 2011

<u>Owner</u>	<u>Address</u>	<u>Parcel Number</u>
KLEIN ALLEN	1351 W ROSEDALE CHICAGO IL	16308512081
KLEIN WILLIAM FRANK & GABY	8410 ELDORA AVE #2089 LAS VEGAS NV	16309112179
KLEIN WILLIAM FRANK & GABY	8410 ELDORA AVE #2089 LAS VEGAS NV 89117-2679	16309112179
KLEITZ JASON	DIXON MARLA E 8409 PACIFIC SPRING AVE LAS VEGAS NV 89117-1810	16304412003
KNOTT 1999 TRUST	KNOTT JUDY ANN TRS 2111 LORO CT LAS VEGAS NV 89117-1858	16304310007
KOELLING DAVID	2750 S DURANGO DR #1025 LAS VEGAS NV	16309210127
KOERTGE WALTER G & JANET C	2305 PACIFIC CREEK ST LAS VEGAS NV 89117-1812	16304412026
KONO PANDORA L	8457 PACIFIC SPRING AVE LAS VEGAS NV 89117-1810	16304412013
KONOPA SUZANNE	8469 PACIFIC FOUNTAIN AVE LAS VEGAS NV 89117-1861	16304412060
KOREN TODD M	9220 WORSLEY PARK PL LAS VEGAS NV	16309110037
KOREN TODD M	9220 WORSLEY PARK PL LAS VEGAS NV	16309110025
KREIN VERNON & MARIAN I	904 MAPLEWOOD DR SE PELICAN RAPIDS MN	16309210105
KUMAR SUBODH & GAYANEH	11763 EDDLESTON DR NORTHRIDGE CA	16309210297
KURIAN LOVELY	JOSEPH BENNY 2296 AUTUMN FIRE CT LAS VEGAS NV 89117-8956	16304417031
KURILL JEREMY	2750 S DURANGO DR #2121 LAS VEGAS NV	16309210236
L A A C O LTD	431 W 7TH ST LOS ANGELES CA 90014-1601	16309102003
L V ISLAND PROPERTIES L L C	%D DECRISTOFORO 2224 FIERO DR LAS VEGAS NV	16309110067
LACZKOWSKI JEROME T & KAREN A	118 LEGACY PARK CIR DEARBORN HEIGHTS MI 48127-3485	16309112109
LACZKOWSKI JEROME T & KAREN A	118 LEGACY PARK CIR DEARBORN HEIGHTS MI	16309112109
LAGRAMADA HENRY & BERNARDITA	2750 S DURANGO DR #2113 LAS VEGAS NV	16309210276
LAM ROGER & MARSHA TRUST R-501	LAM ROGER P & MARSHA M TRS 2101 ALBERTI CT LAS VEGAS NV 89117-1852	16304310016
LAMERS MICHAEL	2104 DIAMOND BROOK CT LAS VEGAS NV 89117-1866	16304312021
LANCELLOTTI JO-ANNE TRUST	2631 S DURANGO DR #204 LAS VEGAS NV	16308512090
LANCIA T A & E REV FAM TR 1987	LANCIA THOMAS A & ELAINE M TRS 8617 TITLEIST CIR LAS VEGAS NV 89117-5844	16305812001
LAPO PHYLLIS & JON	8410 ELDORA AVE #2058 LAS VEGAS NV	16309112116
LAPO PHYLLIS & JON	8410 ELDORA AVE #2058 LAS VEGAS NV 89117-2678	16309112116
LAU PATRICIA F	628 LYNWOOD DR ENCINITAS CA	16309210116
LAUNAY LEONARD	2283 AUTUMN FIRE CT LAS VEGAS NV 89117-8956	16304417003
LAUREL ERICA A	944 TAFALLA CT LAS VEGAS NV 89138-4547	16309110177
LAUREL ERICA A	944 TAFALLA CT LAS VEGAS NV	16309110177
LEAVITT KATHLEEN A	P O BOX 7424 LAS VEGAS NV 89125-7424	16304412019
LEAVITT TERRY V & KATHLEEN A	601 S SIXTH ST LAS VEGAS NV 89101-6919	16304412018

Report of All Selected Parcels**Case Number:** ROC-42427**Printed On:** Thu: July 14, 2011

<u>Owner</u>	<u>Address</u>	<u>Parcel Number</u>
LEE NANCY S	817 W RAYMOND ST COMPTON CA	16309210185
LEE VICKI LYNN	RAMSAY DUANE R & MARLENE F 8432 PACIFIC FOUNTAIN AVE LAS VEGAS NV 89117-1860	16304412073
LENGSAVATH SISAMONE & SOMSAVAY	2259 AUTUMN FIRE CT LAS VEGAS NV 89117-8955	16304417009
LETTERO TOM & K REV FAM TR	LETTERO THOMAS A & KRISTINE TRS 2301 WHISPERING HILLS CIR LAS VEGAS NV 89117-5849	16305812029
LEUNG STANLEY & JOANNA	29 BRIARWOOD LN BETTENDORF IA	16309112038
LEUNG WINNIE	30741 CARR WY UNION CITY CA	16309210349
LEVICH ROBERT	2750 S DURANGO DR #1006 LAS VEGAS NV	16309210158
LEVINE MELVIN & SHEILA	10724 ROYAL CARIBBEAN CIR BOYNTON BEACH FL	16309112060
LEVINE MELVIN & SHEILA	10724 ROYAL CARIBBEAN CIR BOYNTON BEACH FL 33437-4282	16309112060
LEVITT ILYSE	2606 S DURANGO DR #115 LAS VEGAS NV 89117-2651	16309111338
LEW ECH QUANG L L C SERIES B	%Q LEW 10577 MEADOW MIST AVE LAS VEGAS NV	16309110084
LEW QUANG ECH L L C	%LEW QUANG ECH 10577 MEADOW MIST AVE LAS VEGAS NV	16309110085
LEW QUANG ECH L L C	%Q LEW 10577 MEADOW MIST AVE LAS VEGAS NV	16309110082
LEW RICKY J & JONG W	2280 AUTUMN FIRE CT LAS VEGAS NV 89117-8956	16304417027
LEWIS ANNE E	20845 TONAWANDA APPLE VALLEY CA 92307-5740	16309112175
LEWIS ANNE E	20845 TONAWANDA APPLE VALLEY CA	16309112175
LEWIS MICHAEL PAUL & PATRICIA E	2603 S DURANGO DR #201 LAS VEGAS NV	16308512003
LEWISON ROBERT J & LORRAINE ETAL	P O BOX 560354 MIAMI FL	16308512049
LI HAO	2750 S DURANGO DR #115 LAS VEGAS NV	16309210173
LI SHAO JU REVOCABLE LIVING TR	2750 S DURANGO DR #2021 LAS VEGAS NV	16309210111
LI XUE YING	8400 PACIFIC FOUNTAIN AVE LAS VEGAS NV 89117-1817	16304412081
LIANG WEI YI	8455 W SAHARA AVE #201 LAS VEGAS NV	16309110180
LICARI WEI & FRANK	2633 S DURANGO DR #203 LAS VEGAS NV	16308512095
LIGHTHOUSE PROPERTY 2 L L C	%J BECHTOLD P O BOX 370653 LAS VEGAS NV 89137-0653	16309111358
LIM RAYMOND K	12312 EDGECLIFF AVE SYLMAN CA	16308512094
LIMJUCO KIM	1534 W ALEXIS AVE ANAHEIM CA	16309110145
LIN HELEN	741 CLEMENT ST #302 SAN FRANCISCO CA 94118-2280	16309110118
LIN HELEN	741 CLEMENT ST #302 SAN FRANCISCO CA	16309110118
LIN MIMI W	8000 W BADURA AVE #1101 LAS VEGAS NV	16309210071
LIN MIMI W	8000 W BADURA AVE #1101 LAS VEGAS NV	16309210075
LISANDRO HOLDINGS INC	3111 BEL AIR DR #6G LAS VEGAS NV	16309210120
LONG LISA	45741 ELM PL TEMECULA CA 92592-2850	16309112030

Report of All Selected Parcels**Case Number:** ROC-42427**Printed On:** Thu: July 14, 2011

<u>Owner</u>	<u>Address</u>	<u>Parcel Number</u>
LONG LISA	45741 ELM PL TEMECULA CA	16309112030
LOOMIS HARLOW III & CONSTANCE B	2021 ALBERTI CT LAS VEGAS NV 89117-1854	16304310017
LORDS NICHOLAS E & KERI B	2110 SHENLEY CT LAS VEGAS NV 89117-8924	16304316006
LOVE DIANA C	8410 ELDORA ST #2031 LAS VEGAS NV	16309112063
LOVE DIANA C	8410 ELDORA ST #2031 LAS VEGAS NV 89117-7611	16309112063
LYSENKO MARINA	526 N ORLANDO AVE #301 LOS ANGELES CA	16309210296
MACAYO VEGAS INC	1480 E BETHANY HOME RD #130 PHOENIX AZ 85014-2022	16309102010
MAGRO ENZO & JOAN	47 ENVOY CRES WINNIPEG MB CANADA R2V3K5	16309111275
MAKSIMIK FAMILY TRUST	8296 ARDEN LADDER PL LAS VEGAS NV	16309210056
MALKIN BRADLEY A & F REV LIV TR	1205 MOSELLE CT LAS VEGAS NV	16309112146
MALMSTEDT FAMILY TRUST	MALMSTEDT FRANK H JR & CAROL TRS 2117 DIAMOND PEAK CT LAS VEGAS NV 89117-1868	16304311001
MANGANO IRENE VIOLET	2625 S DURANGO DR #203 LAS VEGAS NV	16308512056
MANIS ROBERT	848 N RAINBOW BLVD #2443 LAS VEGAS NV	16309110115
MANNELLA B ALLEN & MAUREEN M	138 RAYNOR RD RIDGE NY	16309210202
MANNING MAREN	8472 PACIFIC SPRING AVE LAS VEGAS NV 89117-1809	16304412030
MANZI DIANE J	8441 PACIFIC SPRING AVE LAS VEGAS NV 89117-1810	16304412009
MARCHEWITZ ERIC	5000 OAK BLUFF CT HOWELL MI	16309210250
MARDISTE ENDEL	2623 S DURANGO DR #204 LAS VEGAS NV	16308512066
MARGESON JULIE	8410 ELDORA AVE #1002 LAS VEGAS NV	16309112002
MARIC IGOR & ALEN	2321 PACIFIC CREEK ST LAS VEGAS NV 89117-1812	16304412022
MARKHAM JAMES W	2750 S DURANGO DR #2055 LAS VEGAS NV	16309210008
MARKUSIC PHILLIP	2247 AUTUMN FIRE CT LAS VEGAS NV 89117-8955	16304417012
MAROLF STEWART & LINDA	7909 RUSHMORE AVE LAS VEGAS NV	16309210235
MARRÉ DANIEL	%PERKINS COIE LLP 131 S DEARBORN ST #1700 CHICAGO IL	16308512109
MARTIN GLEN E & JUDITH C	8550 W DESERT INN RD #102-178 LAS VEGAS NV	16308512034
MARTIN JUAN GERARDO & XOCHITL	2601 28TH ST SANTA MONICA CA	16309210152
MARTIN MARIA S	8180 MANITOBA ST #109 PLAYA DEL REY CA 90293-8704	16309112081
MARTIN MARIA S	8180 MANITOBA ST #109 PLAYA DEL REY CA	16309112081
MARTIN MARIA S	HOLGUIN BIANCA MARTIN & ANDREW 8180 MANIRTOBA ST #109 PLAYA DEL REY CA 90293	16309112133
MARTIN MARIA S	8180 MANIRTOBA ST #109 PLAYA DEL REY CA	16309112133
MARTINESCU FLORIN & MIHAELA	3257 REDWOOD ST LAS VEGAS NV	16309210001
MARTINEZ HECTOR & SUSANA	261 LENAPE HEIGHT AVE LAS VEGAS NV 89148-2607	16308512126

Report of All Selected Parcels**Case Number:** ROC-42427**Printed On:** Thu: July 14, 2011

<u>Owner</u>	<u>Address</u>	<u>Parcel Number</u>
MARTINEZ HECTOR & SUSANA	261 LENAPE HEIGHT AVE LAS VEGAS NV	16308512126
MARTINEZ JOSEFINA	8455 W SAHARA AVE #158 LAS VEGAS NV	16309110033
MASTRANGIOLI BRUNO & THERESA TR	8410 ELDORA AVE #1088 LAS VEGAS NV	16309112174
MATECHICK NICK & JOAN A	2639 S DURANGO DR #202 LAS VEGAS NV	16308512112
MATHEW MERCY	KORAH MATHEW K 2251 AUTUMN FIRE CT LAS VEGAS NV 89117-8955	16304417011
MAYAN PROPERTIES L L C	%J DOLMAYAN 8410 ELDORA AVE #2080 LAS VEGAS NV	16309112040
MAYAN PROPERTIES L L C	%J DOLMAYAN 7530 ATHERTON LN WEST HILLS CA	16309112032
MAYAN PROPERTIES L L C	%J DOLMAYAN 8410 ELDORA AVE #2080 LAS VEGAS NV 89117-2679	16309112040
MAYAN PROPERTIES L L C	%J DOLMAYAN 8410 ELDORA AVE #2080 LAS VEGAS NV 89117-2679	16309112068
MAYAN PROPERTIES L L C	%J DOLMAYAN 8410 ELDORA AVE #2080 LAS VEGAS NV	16309112068
MAYAN PROPERTIES L L C	%J DOLMAYAN 8410 ELDORA AVE #2080 LAS VEGAS NV	16309112141
MAYAN PROPERTIES L L C	%J DOLMAYAN 8410 ELDORA AVE #280 LAS VEGAS NV	16309112082
MAYAN PROPERTIES L L C	%J DOLMAYAN 8410 ELDORA AVE #2080 LAS VEGAS NV 89117-2679	16309112141
MAYAN PROPERTIES L L C	%J DOLMAYAN 8410 ELDORA AVE #2080 LAS VEGAS NV	16309112163
MAYO MONROE M	8635 W SAHARA PMB-532 LAS VEGAS NV	16308512092
MCCRORY WILLIAM A	2643 S DURANGO DR #203 LAS VEGAS NV	16308512125
MCCRORY WILLIAM A	SMITH-MCCRORY LINDA J 2643 S DURANGO DR #203 LAS VEGAS NV 89117-2672	16308512125
MCGEE RICK L	2843 N LAKEWOOD CHICAGO IL 60657-4105	16304412064
MCGUCKIAN DONALD	21110 WATER OAK TERRACE BOCA RATON FL	16309112017
MEEKS BONNIE J LIVING TRUST	8410 ELDORA AVE #1018 LAS VEGAS NV	16309112034
MELLENDEZ-GOODRICH GENEROSA	1860 WHITE PLAINS RD BRONX NY	16309210085
MELTZER GLENN E	8410 ELDORA AVE #2049 LAS VEGAS NV	16309112101
MELTZER GLENN E	8410 ELDORA AVE #2049 LAS VEGAS NV 89117-2678	16309112101
MENDOZA EDMUNDO G & OLGA I	8410 ELDORA ST #1014 LAS VEGAS NV	16309112026
MENDOZA EDMUNDO G & OLGA I	8410 ELDORA ST #1014 LAS VEGAS NV 89117-2674	16309112026
MERCURO FAY E	8410 ELDORA AVE #2040 LAS VEGAS NV 89117-2678	16309112080
MERCURO FAY E	8410 ELDORA AVE #2040 LAS VEGAS NV	16309112080
MEREDITH JANELLE	8460 PACIFIC SPRING AVE LAS VEGAS NV 89117-1809	16304412032
MERIWETHER GARRETT R & GALYNA T	8601 TITLEIST CIR LAS VEGAS NV 89117-5844	16305812013
MESHEL RICKI	8605 TITLEIST CIR LAS VEGAS NV 89117-5844	16305812014
MEYER GRETCHEN	10113 VILLA RIDGE DR LAS VEGAS NV	16309210155
MIAN RAFIQUDDIN D & TAHIRA	10273 COPPARO PL LAS VEGAS NV 89134-2594	16309111258

Report of All Selected Parcels**Case Number:** ROC-42427**Printed On:** Thu: July 14, 2011

<u>Owner</u>	<u>Address</u>	<u>Parcel Number</u>
MICHAEL NINO & ALICE	2955 W CATALPA CHICAGO IL	16308512114
MILISIC FAMILY L P	%G MILISIC %L SCHAEFER 4782 MOUNT HELIX DR LA MESA CA	16308512007
MILLER JOLYNN	8410 ELDORA AVE #1083 LAS VEGAS NV	16309112165
MINER RICHARD	6130 W FLAMINGO RD 3310 LAS VEGAS NV	16309110050
MINOR BRIAN K	8473 PACIFIC SPRING AVE LAS VEGAS NV 89117-1810	16304412017
MIRZOIAN MELKON	3004 PIER HARBOR LAS VEGAS NV	16309110070
MIRZOIAN MELKON	3004 PIER HARBOR LAS VEGAS NV 89117-0909	16309110070
MITCHELL HERBERT N	8441 PACIFIC FOUNTAIN LAS VEGAS NV 89117-1861	16304412053
MITROVIC RADOVAN	2606 S DURANGO DR #213 LAS VEGAS NV 89117-2654	16309111335
MIYAYAMA MIKA	2750 S DURANGO DR #2139 LAS VEGAS NV	16309210206
MOELLER KATHY L	2929 E BROADWAY RD #69 MESA AZ 85204-1749	16304412016
MOHAMED HUSSEIN FAHMY	99 TOWER MUSTARD CT HENDERSON NV 89002-3315	16304413007
MOORE DONALD L & SALLY E FAM TR	P O BOX 80844 LAS VEGAS NV	16309112135
MOORE DONALD L & SALLY E FAM TR	MOORE DONALD L & SALLY E TRS P O BOX 80844 LAS VEGAS NV 89180-0844	16309112135
MORALES COLLEEN M	P O BOX 3170 MONUMENT CO	16308512131
MORRISON GEORGE P	%K RYEL 23204 HUBER AVE TORRANCE CA	16309210200
MORROW FAMILY TRUST	MORROW MARVIN D & NORMA J TRS 2104 DIAMOND PEAK CT LAS VEGAS NV 89117-1868	16304311017
MOUTAFOVA ANELIA	9909 MEANDERING CREEK CT LAS VEGAS NV 89117-0518	16309111266
MOYER TRUST	MOYER ROBERT F & LINDA M J TRS 8021 W OBANNON DR LAS VEGAS NV 89117-1943	16304404001
MROCZEK BEN ZBIGNIEW & MARY	15711 72ND ST EDMONTON AB T5Z 2Z6 CANADA	16309210313
MULLANEY JUDITH A	6045 LAUGHING CREEK ST LAS VEGAS NV	16309112084
MULLANEY JUDITH A	6045 LAUGHING CREEK ST LAS VEGAS NV 89148-5518	16309112084
MUNSON FAMILY TRUST	MUNSON PATRICK E & DOLORES M TRS 8309 MONARCH BIRCH AVE LAS VEGAS NV 89117-1891	16304413023
MURAD AMIRA A	29760 RED LEAF DR SOUTHFIELD MI 48076-2067	16309112136
MURAD AMIRA A	29760 RED LEAF DR SOUTHFIELD MI	16309112136
MURRAY MARY ANNE	2750 S DURANGO DR #2094 LAS VEGAS NV	16309210300
NABIZADA TARANA	24131 DELPHI ST MISSION VIEJO CA	16309112007
NABIZADA TARANA	24131 DELPHI ST MISSION VIEJO CA 92691-3906	16309112007
NAGUIB MICHAEL	34-05 BROADWAY ASTORIA NY 11106-1157	16304412039
NASSER KYLE	P O BOX 30576 LAS VEGAS NV	16309210112
NEIWEEM DOREEN L & JAMES P	8410 ELDORA AVE #1061 LAS VEGAS NV 89117-7610	16309112121

Report of All Selected Parcels**Case Number:** ROC-42427**Printed On:** Thu: July 14, 2011

<u>Owner</u>	<u>Address</u>	<u>Parcel Number</u>
NEIWEEM DOREEN L & JAMES P	8410 ELDORA AVE #1061 LAS VEGAS NV	16309112121
NEIWEEM DOREEN L & JAMES P	8410 ELDORA AVE #1061 LAS VEGAS NV	16309112117
NEIWEEM DOREEN L & JAMES P	8410 ELDORA AVE #1061 LAS VEGAS NV 89117-7610	16309112117
NELSON ROBERT W	2750 S DURANGO DR #3024 LAS VEGAS NV	16309210133
NESMITH ZANE D & MARIA HARUMI	8452 PACIFIC FOUNTAIN AVE LAS VEGAS NV 89117-1860	16304412069
NEVAREZ ANTONIA C	6789 CARRERA DR LAS VEGAS NV	16308512113
NEWKIRK MARK D	3967 DRIFTWOOD ST CHINO HILLS CA	16309112125
NEWNAN DON TRUST	NEWNAN DON TRS 2280 CASA BELLA CT LAS VEGAS NV 89117-8934	16304415001
NG ALAN	12 W SHORE RD MANHASSET NY 11030-1831	16309112009
NG ALAN	12 W SHORE RD MANHASSET NY	16309112009
NGUYEN LIVING TRUST	2750 S DURANGO DR #1088 LAS VEGAS NV	16309210339
NICODEMUS THOMAS P	2621 S DURANGO DR #101 LAS VEGAS NV	16308512055
NIP CHARLES	1695 30TH AVE SAN FRANCISCO CA	16309112001
NIP CHARLES	1695 30TH AVE SAN FRANCISCO CA 94122-3207	16309112001
NISHIE PRESTON & WAN HEE L	95-641 NAHOLOHOLO ST MILILANI HI 96789-1424	16309110042
NISHIE PRESTON & WAN HEE L	95-641 NAHOLOHOLO ST MILILANI HI	16309110042
NISSIM ZION & ROY	10416 SUNNY BRAE AVE CHATSWORTH CA	16309110149
NITTI ANTHONY T	1250 6TH ST #205 SANTA MONICA CA 90401-1637	16309102009
NOLAN FAMILY TRUST	9408 QUAL RIDGE DR LAS VEGAS NV	16308512099
NOVERO MARIE JOEY M	1400 SW 85TH TERR PEMBROKE PINES FL 33025-5311	16304417020
NUMRICH RICHARD & SHARON	9485 CATALINA COVE CIR LAS VEGAS NV	16309112145
NUMRICH RICHARD & SHARON	9485 CATALINA COVE CIR LAS VEGAS NV 89147-8007	16309112145
NYMAN JEFFREY	2720 TWIN PALMS CIR LAS VEGAS NV	16309110060
NYMAN JEFFREY	HENTGES-NYMAN LINDA 2720 TWIN PALMS CIR LAS VEGAS NV 89117	16309110060
ODELL CHARLES T & KELLY L	201 ALOSTA DR CAMARILLO CA	16309210141
OHIA DEBRA K	2750 S DURANGO #2145 LAS VEGAS NV	16309210189
OMNI FAMILY L P	2827 S MONTE CRISTO WY LAS VEGAS NV	16309110002
OMNI FAMILY L P	2827 S MONTE CRISTO WY LAS VEGAS NV 89117-2952	16309110002
OPSAHL JOHN M & IRENE G	8455 W SAHARA AVE #231 LAS VEGAS NV	16309110143
ORLANDO FAMILY REVOCABLE TRUST	2240 OASIS PALM CT LAS VEGAS NV 89117-1807	16304410004
OVSEPIAN ROUZANNA S	526 N VAN NESS #3 LOS ANGELES CA	16309112099
OVSEPYAN EMMA	6301 KITTY'S LN TAHONGA CA	16309112176

Report of All Selected Parcels**Case Number:** ROC-42427**Printed On:** Thu: July 14, 2011

<u>Owner</u>	<u>Address</u>	<u>Parcel Number</u>
OVSEPYAN EMMA	6301 KITTYS LN TAHONGA CA 91042-3476	16309112176
P C DEVELOPMENT INC	P O BOX 27260 LAS VEGAS NV 89126-1260	16309101006
P C DEVELOPMENT INC	P O BOX 27260 LAS VEGAS NV 89126-1260	16309101008
P C DEVELOPMENT INC	%KROGER CO %PPTY TAX 7TH FLR 1014 VINE ST CINCINNATI OH 45202-1141	16309101005
P C DEVELOPMENT INC	P O BOX 27260 LAS VEGAS NV 89126-1260	16309101007
PACIFIC CONSTRUCTION & DEV	%BENCHMARK ASSOC SVCS 1515 E TROPICANA AVE #350A LAS VEGAS NV 89119-6520	16304412082
PACIFICA L SEVENTEEN L L C	1785 HANCOCK ST #100 SAN DIEGO CA	16309210316
PADILLA DONNA C & ROBERT E	2625 S DURANGO DR #102 LAS VEGAS NV	16308512068
PADIS STEPHANIE J	3053 LIVE OAK CT DANVILLE CA	16309112164
PAGE CECILIA A DAVIS	2313 PACIFIC CREEK ST LAS VEGAS NV 89117-1812	16304412024
PANAYOTOV DILIANA & STEFAN	5929 EVER VIEW CT LAS VEGAS NV 89148-5527	16309112064
PANAYOTOV DILIANA & STEFAN	5929 EVER VIEW CT LAS VEGAS NV	16309112064
PANAYOTOV STEFAN & DILIANA	5929 EVER VIEW CT LAS VEGAS NV	16309112103
PARHAM BARBARA C & CARLOS A	2659 DECKER LN LIVERMORE CA	16309110125
PARIKH JANAK	650 PALO VERDE AVE PASADENA CA	16309210137
PARK MICHAEL J	2416 S EVERGREEN RD TEMPE AZ 85282-3035	16309112004
PARK MICHAEL J	2416 S EVERGREEN RD TEMPE AZ	16309112004
PARKS JOAN E	8410 ELDORA AVE #1015 LAS VEGAS NV	16309112027
PASCASCIO DENISE	2750 S DURANGO DR #2015 LAS VEGAS NV	16309210119
PASTOR MANUEL E & SUSANNA A	2267 AUTUMN FIRE CT LAS VEGAS NV 89117-8955	16304417007
PATTEN BRUCE P & VITALINA A	P O BOX 3913 PEABODY MA	16308512058
PEARCE MATTHEW & MARCY	%VOLCANO PROP 909 MARINA VILLAGE PKWY #341 ALAMEDA CA 94501-1048	16309110151
PEARCE MATTHEW & MARCY	%VOLCANO PROP 909 MARINA VILLAGE PKWY #341 ALAMEDA CA	16309110151
PEARSON RICHARD I JR & FRANK P	2981 HAMMERWOOD DR LAS VEGAS NV	16309112058
PETERS JOHN WILLIAM & LESLIE A	8455 W SAHARA AVE #228 LAS VEGAS NV	16309110140
PETERSON FAMILY TRUST	PETERSON BRADLEY G & KATHY G TRS 2205 NORWAY MAPLE ST LAS VEGAS NV 89117-1896	16304413005
PETRIE WILLIAM R SEP PPTY TR	PETRIE WILLIAM RAYMOND TRS 2101 LORO CT LAS VEGAS NV 89117-1858	16304310008
PETROUSKI DEBORAH	2750 S DURANGO DR #1156 LAS VEGAS NV	16309210167
PHADUNGSILP CHAIRIT & MARITZA	1117 BRAMFORD CT DIAMOND BAR CA	16309210140
PHAN LISA N & KHANH C	20 BRAELINN DR HENDERSON NV	16309112054
PHELAN JOSEPH V & CORA L	3261 SILVER BERRY AVE RIALTO CA	16309210204
PHOENIX L V REALTY PARTNERS LLC	1111 ALBERNI STREET #2012 VANCOUVER BC V6E 4V2 CANADA	16309110012

Report of All Selected Parcels**Case Number:** ROC-42427**Printed On:** Thu: July 14, 2011

<u>Owner</u>	<u>Address</u>	<u>Parcel Number</u>
PHOENIX L V REALTY PTNRS L L C	630 TRADE CENTER DR #101 LAS VEGAS NV	16309110016
PI ANDREW S & SHOUTZE	2603 S DURANGO DR #101 LAS VEGAS NV	16308512001
PIAROVA LUCIA REVOCABLE LIV TR	PIAROVA LUCIA TRS 8416 PACIFIC FOUNTAIN AVE LAS VEGAS NV 89117-1817	16304412077
PIAROVA LUCIA REVOCABLE LIV TR	PIAROVA LUCIA TRS 8416 PACIFIC FOUNTAIN AVE LAS VEGAS NV 89117-1817	16304412076
PITNER BARBARA ANN	2615 S DURANGO #204 LAS VEGAS NV	16308512042
PLANCK RONALD L	8410 ELDORA ST #2043 LAS VEGAS NV 89117-2678	16309112087
PLANCK RONALD L	8410 ELDORA ST #2043 LAS VEGAS NV	16309112087
POLLEY BRADFORD L & JANET L	2320 PACIFIC BROOK ST LAS VEGAS NV 89117-1813	16304412040
POOLEY CONSTANCE E	8424 PACIFIC FOUNTAIN AVE LAS VEGAS NV 89117-1817	16304412075
PORTNOFF FAMILY TRUST	PORTNOFF STEVEN TRS 1335 RADWICK DR LAS VEGAS NV 89110-2025	16304401002
POULIS TOM	6774 SHELTER LN LAS VEGAS NV	16308512083
PRIER SHARON	2108 DIAMOND PEAK CT LAS VEGAS NV 89117-1868	16304311018
PRISCO MARIE ROBUSTELLINI ETAL	%P ROBUSTELLINI GREEN 1579 CACTUS DR BAYFIELD CO	16309112134
PRIVATE RESTAURANT PPTYS L L C	2202 N WEST SHORE BLVD #05-3214 TAMPA FL 33607-5747	16308510006
PROIETTI MARY ANNE	8410 ELDORA AVE #2028 LAS VEGAS NV 89117-7611	16309112056
PROIETTI MARY ANNE	8410 ELDORA AVE #2028 LAS VEGAS NV	16309112056
PUA ROBERT & EVELYN LOPEZ	8733 RED BROOK DR #103 LAS VEGAS NV	16309110013
QIAN MING XUAN	8410 ELDORA AVE #1043 LAS VEGAS NV 89117-2675	16309112085
QIAN MING XUAN	8410 ELDORA AVE #1043 LAS VEGAS NV	16309112085
QUINN RANDALL & LINDA TRUST	P O BOX 11540 LAS VEGAS NV	16308512051
R J 1 L L C	%RJA INVESTMENTS INC 8400 W SAHARA AVE LAS VEGAS NV 89117-1836	16304406005
RABENHORST SALLY & ANGELA	2241 OASIS PALM CT LAS VEGAS NV 89117-1807	16304410005
RACoon ENTERPRISES L L C	10801 W CHARLESTON BLVD #575 LAS VEGAS NV	16308512059
RALPHS GEORGE L	2100 LORO CT LAS VEGAS NV 89117-1857	16304310005
RAM FAMILY TRUST	8063 ALPINE FIR AVE LAS VEGAS NV	16309210121
RAMIREZ ESPARANZA	2750 S DURANGO DR #1047 LAS VEGAS NV	16309210016
RAMOS BRYAN	%L RAMOS 8455 W SAHARA AVE #190 LAS VEGAS NV	16309110001
RAMOS JASON B & MELFRED	8455 W SAHARA AVE #168 LAS VEGAS NV	16309110027
RAPOSE JACK D & MICHELLE A	2280 COUNTRY COTTAGE CT LAS VEGAS NV 89117-1845	16304411007
RED DOGG ULTRA TRUST	3275 S JONES BLVD #104 LAS VEGAS NV 89146-6768	16304413013
REINEKE KURT B JR & CHERYL BETH	2204 TRIDENT MAPLE ST LAS VEGAS NV 89117-1893	16304413018
RENAUD ALBERTO	2750 S DURANGO DR #1024 LAS VEGAS NV	16309210126

Report of All Selected Parcels**Case Number:** ROC-42427**Printed On:** Thu: July 14, 2011

<u>Owner</u>	<u>Address</u>	<u>Parcel Number</u>
REVOCABLE LIVING TRUST	2290 S TENYA LAS VEGAS NV	16309210332
RIANCHO CHRISTIANE	3161 DARBY GARDEN CT LAS VEGAS NV	16309210191
RIASKA DONALD	2301 DUPONT DR #200 IRVINE CA 92612-7503	16309110091
RIASKA DONALD	2301 DUPONT DR #200 IRVINE CA	16309110091
RICH GARY & ROSEMARY	2111 ALBERTI CT LAS VEGAS NV 89117-1852	16304310015
RICHARDS YVETTE M	2550 OLINVILLE AVE #13K BRONX NY 10467-7446	16304410002
RICHARDSON ROBERT M & KATHERINE	8410 ELDORA AVE #2071 LAS VEGAS NV 89117-2679	16309112143
RICHARDSON ROBERT M & KATHERINE	8410 ELDORA AVE #2071 LAS VEGAS NV	16309112143
RICKEY ERIC M	8455 W SAHARA #165 LAS VEGAS NV	16309110030
RICKEY ERIC M	8455 W SAHARA #165 LAS VEGAS NV 89117-1841	16309110030
RICKS JODY BETH	2619 S DURANGO DR #202 LAS VEGAS NV	16308512052
RINGEL VALENTYNA & HENRY	8410 ELDORA AVE #2011 LAS VEGAS NV	16309112023
ROBERTS JOSEPH G REV FAM TR	711 RANCHO CIR LAS VEGAS NV	16309110039
ROBERTS JOSEPH G REV FAM TR	ROBERTS AURELIA ARNOLD TRS 711 RANCHO CIR LAS VEGAS NV 89107-4619	16309110108
ROBERTS JOSEPH G REV FAM TR	711 RANCHO CIR LAS VEGAS NV	16309110108
ROBINSON VIRGINIA LUAllen	2637 S DURANGO DR #101 LAS VEGAS NV	16308512103
ROBISON JULIE JEAN	2645 S DURANGO DR #102 LAS VEGAS NV	16308512128
ROCK SPRINGS VISTA DEV CO	P O BOX 28730 LAS VEGAS NV 89126-2730	16309112181
ROCK SPRINGS VISTA DEV CO	P O BOX 28730 LAS VEGAS NV	16309112181
RODDEN THOMAS A	2607 S DURANGO DR #203 LAS VEGAS NV	16308512017
RODDEN THOMAS A	2607 S DURANGO DR #203 LAS VEGAS NV 89117-2659	16308512017
RODGERS PAULA L RATNER	2611 S DURANGO DR #201 LAS VEGAS NV	16308512027
RODRIGUEZ BESS	7841 E BONNIE ROSE AVE SCOTTSDALE AZ	16309210139
RODRIGUEZ MARIA I & SANDRA	2750 S DURANGO #1077 LAS VEGAS NV	16309210331
ROE HARRY B	%J SHAFER ADMIN P O BOX 50790 HENDERSON NV 89016-0790	16304415004
ROGERS FAMILY TRUST	2750 S DURANGO DR #1146 LAS VEGAS NV	16309210184
ROLAND MARGARET	3653 CHAPMAN LN INGLEWOOD CA	16308512038
ROLOFF SHIRLEY E	8410 ELDORA ST #1004 LAS VEGAS NV	16309112006
ROMANO SHEILA WOODS REVOCABLE TR	2611 S DURANGO DR #204 LAS VEGAS NV	16308512030
ROMANO SHEILA WOODS REVOCABLE TR	ROMANO SHEILA WOODS TRS 2611 S DURANGO DR #204 LAS VEGAS NV 89117-2660	16308512030
RONTOURAGE ENTERPRISE L L C	3440 ARVILLE ST LAS VEGAS NV 89102-8167	16304412014
ROSEN-ZAMIR EMANUEL & J LIV TR	ZAMIR EMANUEL TRS 8455 W SAHARA AVE #230 LAS VEGAS NV 89117-1843	16309110142

Report of All Selected Parcels**Case Number:** ROC-42427**Printed On:** Thu: July 14, 2011

<u>Owner</u>	<u>Address</u>	<u>Parcel Number</u>
ROSEN-ZAMIR EMANUEL & J LIV TR	8455 W SAHARA AVE #230 LAS VEGAS NV	16309110142
ROSEQUIST DANIEL & LITANY	2165 S LISA LN LAS VEGAS NV 89117-1833	16304401003
ROSS PEGGY	8460 PACIFIC FOUNTAIN AVE LAS VEGAS NV 89117-1860	16304412067
ROTHKEGEL PATRICK C	8410 ELDORA #1081 LAS VEGAS NV	16309112159
ROWTON JASON R	2750 S DURANGO DR #2028 LAS VEGAS NV	16309210101
RUGGIERO RICHARD D REVOCABLE TR	3 JEAN CIR RANDOLPH MA	16308512089
RUNYON KEITH A & JANA E L	2020 ALBERTI CT LAS VEGAS NV 89117-1853	16304310012
RUSEK PATRICIA	4361 VENTURA CANYON #8 SHERMAN OAKS CA	16309210149
RUSHTON DIANE E	2607 S DURANGO DR #201 LAS VEGAS NV	16308512015
RUSSELL GLEN C	2750 S DURANGO DR #2114 LAS VEGAS NV	16309210275
RUSSELL RICHARD F & P M LIV TR	5805 W HARMON AVE #88 LAS VEGAS NV	16309210148
RYU GEORGE C & ERICA K	1870 S ORANGE GROVE AVE LOS ANGELES CA	16309110076
RYU GEORGE C & ERICA K	1870 S ORANGE GROVE AVE LOS ANGELES CA 90019-5049	16309110076
S & C FABELLA L P	204 CAMPBELL DR LAS VEGAS NV	16309110003
SAENZ JESUS M	2252 OASIS PALM CT LAS VEGAS NV 89117-1807	16304410001
SAENZ JOSE B	%EDMUNDA SAENZ 8455 W SAHARA AVE #101 LAS VEGAS NV	16309110090
SAHARA DURANGO L P	50 S JONES BLVD #100 LAS VEGAS NV 89107-2672	16308510009
SAHARA HAMRICK L L C	8290 W SAHARA #200 LAS VEGAS NV 89117-8937	16304414004
SAHARA HOSPITALITY L L C	545 W LAMBERT RD #D BREA CA 92821-3916	16308510010
SALVATORE JOHN C	8473 PACIFIC FOUNTAIN AVE LAS VEGAS NV 89117-1861	16304412061
SAMPAIO THERESA & RENATO	2750 S DURANGO DR #2023 LAS VEGAS NV	16309210129
SANCHEZ DANIEL L & MARY K	2750 S DURANGO DR #1064 LAS VEGAS NV	16309210061
SANDS SAHARA L L C	8230 W SAHARA AVE LAS VEGAS NV 89117-8959	16304414005
SANTAL CORPORATION	7785 W SAHARA #200 LAS VEGAS NV 89117-2789	16304405001
SANTOS NESTOR & J LORRAINE	20792-68 AVE LANGLEY BC V2Y 1R1 CANADA	16309210353
SARHAD VIOLET	27735 PINE STRAP CIR LAGUNA HILLS CA	16309210253
SARKISIAN PHILLIP	11848 ERWIN ST #10 NO HOLLYWOOD CA 91606-4723	16304412041
SARKISSYAN VARTAN	4132 S RAINBOW BLVD #221 LAS VEGAS NV	16309210182
SAVARONA L L C	33 TALL RUFF DR LAS VEGAS NV	16309110094
SAYERS JORUNN E	2325 WHISPERING HILLS CIR LAS VEGAS NV 89117-5849	16305812032
SAYKOV ADELAIDA & IVAN	2750 S DURANGO DR #1149 LAS VEGAS NV	16309210187
SAYLOR RICHARD & SUN CHA	2750 S DURANGO DR #1053 LAS VEGAS NV	16309210004

Report of All Selected Parcels**Case Number:** ROC-42427**Printed On:** Thu: July 14, 2011

<u>Owner</u>	<u>Address</u>	<u>Parcel Number</u>
SCARDINA ANTOINETTE	2750 S DURANGO DR #2056 LAS VEGAS NV	16309210007
SCHEINER MARK	9103 ALTA DR #1203 LAS VEGAS NV 89145-8501	16309112115
SCHEINER MARK	9103 ALTA DR #1203 LAS VEGAS NV 89145-8501	16309112012
SCHEINER MARK	9103 ALTA DR #1203 LAS VEGAS NV	16309112115
SCHEINER MARK	9103 ALTA DR #1203 LAS VEGAS NV	16309112012
SCHNEIDER ILYA ALEXANDER	3125 N BUFFALO DR #1107 LAS VEGAS NV	16309110044
SCHNEIDER LLYA ALEXANDER	3125 N BUFFALO DR #1107 LAS VEGAS NV 89128-7831	16309110048
SCHNEIDER LLYA ALEXANDER	3125 N BUFFALO DR #1107 LAS VEGAS NV	16309110048
SCHROEDER JANET E	8410 ELDORA AVE #2023 LAS VEGAS NV 89117-2677	16309112047
SCHROEDER JANET E	8410 ELDORA AVE #2023 LAS VEGAS NV	16309112047
SCHWARTZ RICHARD S IRR TR	564 VIA DEL MONTE PALOS VERDES ESTATES CA	16309110163
SCHWARTZ RICHARD S IRR TR	SCHWARTZ LESLIE I TRS 564 VIA DEL MONTE PALOS VERDES ESTATES CA 90274-1276	16309110163
SCHWIMMER JEFFREY 2009 TRUST	SWIMMER LEONARD TRS 8613 LAKERIDGE CIR LAS VEGAS NV 89117-5828	16305812020
SECCO JOSEPH & NANCY TRUST	SECCO JOSEPH & NANCY CO-TRS 8410 ELDORA AVE #1010 LAS VEGAS NV 89117-2674	16309112018
SECCO JOSEPH & NANCY TRUST	8410 ELDORA AVE #1010 LAS VEGAS NV	16309112018
SEDOTI FRANK N & JOANNE M	8410 ELDORA AVE #1060 LAS VEGAS NV	16309112118
SELFU SAHLITU	2606 S DURANGO DR #119 LAS VEGAS NV 89117-2651	16309111306
SENSENBRENNER GILLES ETAL	8312 FULLMOON MAPLE AVE LAS VEGAS NV 89117-1895	16304413028
SETAGHIAN EDVIN	1700 BELAIRE DR GLENDALE CA	16309112077
SETAGHIAN EDVIN	1700 BELAIRE DR GLENDALE CA 91201-1434	16309112077
SHAHVERDI HADI	7817 CALICO FLOWER AVE LAS VEGAS NV	16309210264
SHARABI AMIR	12405 VENICE BLVD #111 LOS ANGELES CA	16308512044
SHARABI AMIR	FELDSHER NAHAMA JULIE 12405 VENICE BLVD #111 LOS ANGELES CA 90066-3803	16308512044
SHARIATPOUR NASRIN	8410 ELDORA AVE #2075 LAS VEGAS NV	16309112151
SHARIATPOUR NASRIN	8410 ELDORA AVE #2075 LAS VEGAS NV 89117-2679	16309112151
SHARPS ALONIA C & LOUIS L	P O BOX 237 UPPER MARLBORO MD	16309210077
SHAVALIAN SHAPOOR	8455 W SAHARA AVE #246 LAS VEGAS NV 89117-1843	16309110129
SHAVALIAN SHAPOOR	8455 W SAHARA AVE #246 LAS VEGAS NV	16309110129
SHECKELLS ADA	2750 S DURANGO DR #1010 LAS VEGAS NV	16309210145
SHERMAN GREG	2606 S DURANGO DR #219 LAS VEGAS NV 89117-2654	16309111307
SHIMADA RENEE N	2750 S DURANGO DR #1116 LAS VEGAS NV	16309210269
SHOULTZ NORA	328 N VISTA DEL NORTE WALNUT CA	16309110019

Report of All Selected Parcels**Case Number:** ROC-42427**Printed On:** Thu: July 14, 2011

<u>Owner</u>	<u>Address</u>	<u>Parcel Number</u>
SHUMWAY JUDITH & ROBERT	8410 ELDORA AVE #1040 LAS VEGAS NV	16309112078
SILBAUGH NORMA L	2606 S DURANGO #244 LAS VEGAS NV 89117-2695	16309111271
SILLMAN DONALD A & GRACE	301 SW 135TH AVE #217C PEMBROKE PINES FL	16308512002
SILLMAN DONALD A & GRACE	301 SW 135TH AVE #217C PEMBROKE PINES FL 33027-1633	16308512002
SILVA JULIO ALBERTO	8410 ELDORA AVE #2073 LAS VEGAS NV	16309112147
SILVA JULIO ALBERTO	8410 ELDORA AVE #2073 LAS VEGAS NV 89117-2679	16309112147
SIMANSON JON SCOTT & LINDA A	8400 E DIVILETTE DR #163 SCOTTSDALE AZ 85262	16304412007
SIMONYAN GAGIK	1629 W GLENOAKS BLVD GLENDALE CA	16309112028
SINGH SAJJY	1335 12TH AVE SAN FRANCISCO CA	16309210233
SININS ELAINE M	2304 TRIDENT MAPLE ST LAS VEGAS NV 89117-1894	16304413016
SLADE STACY W & TERESA A	2121 SHENLEY CT LAS VEGAS NV 89117-8924	16304316008
SLOAN ARTHUR L & NAOMI B	2124 DIAMOND BROOK CT LAS VEGAS NV 89117-1866	16304312026
SLOMINSKI CHARLES DANIEL	2605 S DURANGO DR #204 LAS VEGAS NV 89117-2657	16308512012
SLOMINSKI CHARLES DANIEL	2605 S DURANGO DR #204 LAS VEGAS NV	16308512012
SMITH DASHA P	6072 MAGNOL LN WOODLAND HILLS CA 91367-7234	16304412005
SMITH JESSE V	2288 AUTUMN FIRE CT LAS VEGAS NV 89117-8956	16304417029
SMITH NAYDENE	5343 HILL VIEW CRES EDMONTON AB T6L 1V9 CANADA	16309110017
SNYDER PATRICK J FAMILY TRUST	SNYDER PATRICK J TRS 2299 CASA BELLA CT LAS VEGAS NV 89117-8934	16304415003
SNYDER VICTORIA	7046 ESPANA DR RIVERSIDE CA	16309110066
SOBREPENA-RAMOLETE ROSE	74-5483 KAIWI ST #150 KAILUA KONA HI	16309112094
SOBREPENA-RAMOLETE ROSE	74-5483 KAIWI ST #150 KAILUA KONA HI 96740-3186	16309112094
SOLENSKE REGINA	2635 S DURANGO DR #102 LAS VEGAS NV	16308512098
SOLIS RAUL	8410 ELDORA #1064 LAS VEGAS NV 89117-7610	16309112126
SOLIS RAUL	8410 ELDORA #1064 LAS VEGAS NV	16309112126
SOLOMON KENNETH N	P O BOX 1149 FORT COLLINS CO 80522-1149	16304412027
SPARKS ERIN	2631 S DURANGO DR #202 LAS VEGAS NV	16308512088
SPENS LENZI	WOODBURY BEN L 2260 AUTUMN FIRE CT LAS VEGAS NV 89117-8955	16304417022
SPICER DONALD G & LOIS	343 TREMONT AVE #201 BELLINGHAM WA	16309110053
STACY DON & CAROL	8517 OBANNON DR LAS VEGAS NV 89117-8957	16304417015
STALLINGS MICHAEL E	2641 S DURANGO DR LAS VEGAS NV	16308512119
STALLINGS MICHAEL E	2641 S DURANGO DR LAS VEGAS NV 89117-2887	16308512119
STANCOFF ROBERT J JR	8410 ELDORA ST #1017 LAS VEGAS NV	16309112033

Report of All Selected Parcels**Case Number:** ROC-42427**Printed On:** Thu: July 14, 2011

<u>Owner</u>	<u>Address</u>	<u>Parcel Number</u>
STANCOFF ROBERT J JR	8410 ELDORA ST #1017 LAS VEGAS NV 89117-2674	16309112033
STEELE NETTIE	2627 S DURANGO DR #201 LAS VEGAS NV	16308512075
STEPANYAN SAMVEL	3521 COUNTRY CLUB DR GLENDALE CA	16309210272
STEPUCHIN G K B FAMILY TRUST	2617 S DURANGO DR LAS VEGAS NV	16308512046
STERGION PETER	2750 S DURANGO DR #2140 LAS VEGAS NV	16309210205
STEVENS JOANNE D	8453 PACIFIC FOUNTAIN AVE LAS VEGAS NV 89117-1861	16304412056
STEWART GARY A & GINGER	5573 SAINT ANDREWS DR STOCKTON CA	16309210273
STEWART JOSEPH & ERMA REV LIV TR	4523 DON VALDES DR LOS ANGELES CA	16309112065
STEWART JOSEPH & ERMA REV LIV TR	4523 DON VALDES DR LOS ANGELES CA	16309112062
STEWART JOSEPH & ERMA REV LIV TR	STEWART JOSEPH S & ERMA L TRS 4523 DON VALDES DR LOS ANGELES CA 90008-4116	16309112065
STOCKETT FAMILY TRUST	STOCKETT JOE T TRS 8304 FULLMOON MAPLE AVE LAS VEGAS NV 89117-1895	16304413026
STOLLER BRUCE	130 MONTEREY BLVD HERMOSA BEACH CA 90254-5141	16309112052
STOLLER BRUCE	130 MONTEREY BLVD HERMOSA BEACH CA	16309112052
STONE MISA	VICE NORMAN P 8485 PACIFIC SPRING AVE LAS VEGAS NV 89117-1863	16304412020
STRATTON CLIFFORD R	5365 S CAMERON LAS VEGAS NV 89118-2202	16309111323
SU NATALIE	2750 S DURANGO DR #2048 LAS VEGAS NV	16309210019
SUITER WILLIAM C & PHYLLIS A	2269 CASA BELLA CT LAS VEGAS NV 89117-8934	16304415006
SUMTER TERENCE	P O BOX 61 HARBOR CITY CA	16308512039
SUNG EVA	2511 WOODRUFF LN ARCADIA CA	16309210169
SWACKHAMER MARY C	8410 ELDORA AVE #1086 LAS VEGAS NV	16309112168
SWEIS HANNA S & REEMA N	2161 S LISA LN LAS VEGAS NV 89117-1832	16304401004
SWITTEL SANG HUI	2605 S DURANGO DR #102 LAS VEGAS NV	16308512008
SWITTEL SANG HUI	2605 S DURANGO DR #102 LAS VEGAS NV 89117-2657	16308512008
SYCAMORE SQUARE L L C	%SYCAMORE ESTATES HOA %TERRAWEST PPTY MGT 2655 S RAINBOW BLVD #200 LAS VEGAS NV 89146-5185	16304413032
SYLVER MARSHALL W	8280 VIA OLIVERO AVE LAS VEGAS NV 89117-8951	16304404008
TEC LLC	%G FREY 870 SEVEN HILLS DR #201 HENDERSON NV	16309110032
TEC LLC	%G FREY 870 SEVEN HILLS DR #201 HENDERSON NV	16309110034
TEC LLC	%G FREY 870 SEVEN HILLS DR #201 HENDERSON NV 89052-4379	16309110088
TEC LLC	%G FREY 870 SEVEN HILLS DR #201 HENDERSON NV	16309110024
TEC LLC	%G FREY 870 SEVEN HILLS DR #201 HENDERSON NV	16309110133
TEC LLC	%G FREY 870 SEVEN HILLS DR #201 HENDERSON NV	16309110022

Report of All Selected Parcels

Case Number: ROC-42427

Printed On: Thu: July 14, 2011

<u>Owner</u>	<u>Address</u>	<u>Parcel Number</u>
TECCLLC	%G FREY 870 SEVEN HILLS DR #201 HENDERSON NV	16309110045
TECCLLC	%G FREY 870 SEVEN HILLS DR #201 HENDERSON NV	16309110029
TECCLLC	%G FREY 870 SEVEN HILLS DR #201 HENDERSON NV 89052-4379	16309110148
TECCLLC	%G FREY 870 SEVEN HILLS DR #201 HENDERSON NV 89052-4379	16309110086
TECCLLC	%G FREY 870 SEVEN HILLS DR #201 HENDERSON NV	16309110051
TECCLLC	%G FREY 870 SEVEN HILLS DR #201 HENDERSON NV	16309110015
TECCLLC	%G FREY 870 SEVEN HILLS DR #201 HENDERSON NV	16309110014
TECCLLC	%G FREY 870 SEVEN HILLS DR #201 HENDERSON NV	16309110148
TECCLLC	%G FREY 870 SEVEN HILLS DR #201 HENDERSON NV	16309110009
TECCLLC	%G FREY 870 SEVEN HILLS DR #201 HENDERSON NV	16309110152
TECCLLC	%G FREY 870 SEVEN HILLS DR #201 HENDERSON NV	16309110008
TECCLLC	%G FREY 870 SEVEN HILLS DR #201 HENDERSON NV	16309110153
TECCLLC	%G FREY 870 SEVEN HILLS DR #201 HENDERSON NV	16309110121
TECCLLC	%G FREY 870 SEVEN HILLS DR #201 HENDERSON NV	16309110005
TECCLLC	%G FREY 870 SEVEN HILLS DR #201 HENDERSON NV	16309110146
TECCLLC	%G FREY 870 SEVEN HILLS DR #201 HENDERSON NV	16309110087
TECCLLC	%G FREY 870 SEVEN HILLS DR #201 HENDERSON NV	16309110114
TECCLLC	%G FREY 870 SEVEN HILLS DR #201 HENDERSON NV	16309110111
TECCLLC	%G FREY 870 SEVEN HILLS DR #201 HENDERSON NV	16309110126
TECCLLC	%G FREY 870 SEVEN HILLS DR #201 HENDERSON NV	16309110105
TECCLLC	%G FREY 870 SEVEN HILLS DR #201 HENDERSON NV	16309110101
TECCLLC	%G FREY 870 SEVEN HILLS DR #201 HENDERSON NV	16309110098
TECCLLC	%G FREY 870 SEVEN HILLS DR #201 HENDERSON NV	16309110130
TECCLLC	%G FREY 870 SEVEN HILLS DR #201 HENDERSON NV	16309110097
TECCLLC	%G FREY 870 SEVEN HILLS DR #201 HENDERSON NV 89052-4379	16309110022
TECCLLC	%G FREY 870 SEVEN HILLS DR #201 HENDERSON NV 89052-4379	16309110101
TECCLLC	%G FREY 870 SEVEN HILLS DR #201 HENDERSON NV 89052-4379	16309110157
TECCLLC	%G FREY 870 SEVEN HILLS DR #201 HENDERSON NV	16309110046
TECCLLC	%G FREY 870 SEVEN HILLS DR #201 HENDERSON NV	16309110088
TECCLLC	%G FREY 870 SEVEN HILLS DR #201 HENDERSON NV	16309110132
TECCLLC	%G FREY 870 SEVEN HILLS DR #201 HENDERSON NV	16309110086
TECCLLC	%G FREY 870 SEVEN HILLS DR #201 HENDERSON NV	16309110081

Report of All Selected Parcels**Case Number:** ROC-42427**Printed On:** Thu: July 14, 2011

<u>Owner</u>	<u>Address</u>	<u>Parcel Numbe</u>
TECCLLC	%G FREY 870 SEVEN HILLS DR #201 HENDERSON NV	16309110080
TECCLLC	%G FREY 870 SEVEN HILLS DR #201 HENDERSON NV	16309110079
TECCLLC	%G FREY 870 SEVEN HILLS DR #201 HENDERSON NV	16309110077
TECCLLC	%G FREY 870 SEVEN HILLS DR #201 HENDERSON NV 89052-4379	16309110111
TECCLLC	%G FREY 870 SEVEN HILLS DR #201 HENDERSON NV	16309110065
TECCLLC	%G FREY 870 SEVEN HILLS DR #201 HENDERSON NV	16309110064
TECCLLC	%G FREY 870 SEVEN HILLS DR #201 HENDERSON NV	16309110059
TECCLLC	%G FREY 870 SEVEN HILLS DR #201 HENDERSON NV	16309110141
TECCLLC	%G FREY 870 SEVEN HILLS DR #201 HENDERSON NV 89052-4379	16309110014
TECCLLC	%G FREY 870 SEVEN HILLS DR #201 HENDERSON NV 89052-4379	16309110141
TECCLLC	%G FREY 870 SEVEN HILLS DR #201 HENDERSON NV 89052-4379	16309110178
TECCLLC	%G FREY 870 SEVEN HILLS DR #201 HENDERSON NV	16309110157
TECCLLC	%G FREY 870 SEVEN HILLS DR #201 HENDERSON NV	16309110158
TECCLLC	%G FREY 870 SEVEN HILLS DR #201 HENDERSON NV 89052-4379	16309110158
TECCLLC	%G FREY 870 SEVEN HILLS DR #201 HENDERSON NV	16309110176
TECCLLC	%G FREY 870 SEVEN HILLS DR #201 HENDERSON NV	16309110178
TECCLLC	%G FREY 870 SEVEN HILLS DR #201 HENDERSON NV	16309110169
TECCLLC	%G FREY 870 SEVEN HILLS DR #201 HENDERSON NV	16309110156
TECCLLC	%G FREY 870 SEVEN HILLS DR #201 HENDERSON NV	16309110168
TECCLLC	%G FREY 870 SEVEN HILLS DR #201 HENDERSON NV 89052-4379	16309110130
TECCLLC	%G FREY 870 SEVEN HILLS DR #201 HENDERSON NV 89052-4379	16309110174
TECCLLC	%G FREY 870 SEVEN HILLS DR #201 HENDERSON NV	16309110159
TECCLLC	%G FREY 870 SEVEN HILLS DR #201 HENDERSON NV	16309110166
TECCLLC	%G FREY 870 SEVEN HILLS DR #201 HENDERSON NV 89052-4379	16309110152
TECCLLC	%G FREY 870 SEVEN HILLS DR #201 HENDERSON NV	16309110165
TECCLLC	%G FREY 870 SEVEN HILLS DR #201 HENDERSON NV	16309110023
TECCLLC	%G FREY 870 SEVEN HILLS DR #201 HENDERSON NV	16309110004
TECCLLC	%G FREY 870 SEVEN HILLS DR #201 HENDERSON NV 89052-4379	16309110168
TECCLLC	%G FREY 870 SEVEN HILLS DR #201 HENDERSON NV	16309110170
TECCLLC	%G FREY 870 SEVEN HILLS DR #201 HENDERSON NV	16309110174
TECCLLC	%G FREY 870 SEVEN HILLS DR #201 HENDERSON NV	16309110154
TAJ MAHALS & S L L C	PMB D15 9101 W SAHARA #105 LAS VEGAS NV 89117-5799	16304305004

Report of All Selected Parcels**Case Number:** ROC-42427**Printed On:** Thu: July 14, 2011

<u>Owner</u>	<u>Address</u>	<u>Parcel Number</u>
TAYAG ERNESTO F	3270 N HERITAGE WY LAS VEGAS NV	16309210219
TAYLOR KATHRYN	4523 CROCKETT AVE MIDLAND TX	16309110074
TEDRICK TODD	2750 S DURANGO DR #1049 LAS VEGAS NV	16309210014
TEGANO CHRISTINA	2276 AUTUMN FIRE CT LAS VEGAS NV 89117-8956	16304417026
TELL MICHELE D & RITA	9988 RIDGE MANOR LAS VEGAS NV 89148-1608	16304412034
TER-HAROUTUNIAN MARINE	444 W KENNETH GLENDALE CA	16309110175
TESFAY YETBAREK	2750 S DURANGO DR #1104 LAS VEGAS NV	16309210306
TESFAY YETBAREK	2750 S DURANGO DR #1104 LAS VEGAS NV 89117-2640	16309210306
TESHOME M HEYI	SHIFERAW ZIMTA 8449 PACIFIC FOUNTAIN AVE LAS VEGAS NV 89117-1861	16304412055
TESTAMENTARY TRUST ETAL	2762 SWEET WILLOW LN LAS VEGAS NV	16309112149
TESTAMENTARY TRUST ETAL	JEZZINI MARINA TRS 2762 SWEET WILLOW LN LAS VEGAS NV 89135-2328	16309112149
THOMPSON JASON A	2750 S DURANGO DR #2058 LAS VEGAS NV	16309210048
THORLEY R & P FAMILY TRUST	THORLEY ROLLIN G & PAMELA B TRS 2111 SHENLEY CT LAS VEGAS NV 89117-8924	16304316009
THORNE HOWARD K	4107 PALOMAR DR FALLBROOK CA	16308512132
TIGHE JOHN J III	8410 ELDORA AVE #2070 LAS VEGAS NV	16309112140
TIGHE JOHN J III	8410 ELDORA AVE #2070 LAS VEGAS NV 89117-2679	16309112140
TILICONE ALBERTO	10 EAGLE RUN IRVINE CA	16309210223
TOKEV YELENA	6735 TRAMMER CT LAS VEGAS NV	16309210138
TOKUZ FRIATNA	8455 W SAHARA AVE #244 LAS VEGAS NV	16309110131
TOMKO MARY ALICE	8410 ELDORA AVE #1026 LAS VEGAS NV	16309112050
TOMOVA MONICA	5662 ETIWANDA AVE #9 TARZANA CA	16309210171
TORALBO ROBERT	P O BOX 31835 LAS VEGAS NV	16309210199
TORDJMAN THERESA	8300 FULLMOON MAPLE AVE LAS VEGAS NV 89117-1895	16304413025
TORRES HENRY R & JENNIE A	2750 S DURANGO DR #1026 LAS VEGAS NV	16309210128
TORRES MARTIN	2617 S DURANGO DR #203 LAS VEGAS NV 89117-2661	16308512047
TORRES MARTIN	2617 S DURANGO DR #203 LAS VEGAS NV	16308512047
TRAN FREDERICK L & LUCIA REV TR	TRAN FREDERICK L & LUCIA S L TRS 551 44TH AVE SAN FRANCISCO CA 94121-2538	16304412058
TRAN TUAN	BOX 42083 MILLBOURNE EDMONTON AB T6K 4C4 CANADA	16309210178
TRAVIESO ALICIA	8919 LANTA ISLAND AVE LAS VEGAS NV	16309112155
TRAVIESO ALICIA	8919 LANTA ISLAND AVE LAS VEGAS NV 89148-4985	16309112155
TRIMAS BRAD	8455 W SAHARA AVE #250 LAS VEGAS NV	16309110137
TRINSEY ROBERT	2750 S DURANGO #1150 LAS VEGAS NV	16309210188

Report of All Selected Parcels**Case Number:** ROC-42427**Printed On:** Thu: July 14, 2011

<u>Owner</u>	<u>Address</u>	<u>Parcel Number</u>
TRUSTEE CLARK COUNTY TREASURER	%PRENTKY STEVEN J 8410 ELDORA AVE #2064 LAS VEGAS NV	16309112130
TRUSTEE CLARK COUNTY TREASURER	%PRENTKY STEVEN J 8410 ELDORA AVE #2064 LAS VEGAS NV 89117-7612	16309112130
TRUSTEE CLARK COUNTY TREASURER	%TULLY ARMONDO 8805 ROBINSON RIDGE DR LAS VEGAS NV 89117-5812	16304305006
TSAI DAVID K & MAY L	47 BROWN CIR PARAMUS NJ	16309110038
TZONEVA MARIELA P	14928 MOORPARK ST #102 SHERMAN OAKS CA	16309210170
UMSTOTT TODD A	9044 HIGHLAND RD PITTSBURGH PA	16308512060
UPSTONE MICHAEL E & SHANNON	17412 W OCOTILLO RD WADDELL AZ 85355-9677	16309112153
UPSTONE MICHAEL E & SHANNON	17412 W OCOTILLO RD WADDELL AZ	16309112153
URIBE FELORETO	2750 S DURANGO DR #1060 LAS VEGAS NV	16309210046
USA	COUNTY OF CLARK LEASEE %K WILLIAMS PPTY ACQUISITION ADMIN REAL PROPERTY MGT 4TH FLOOR 500 SO GRAND CENTRAL PKWY LAS VEGAS NV 89155	16309201008
USA	WASHINGTON DC 20260	16309201007
V S MANAGEMENT INC	%S IWAMOTO 5527 S RAINBOW BLVD #B LAS VEGAS NV 89118-1882	16309111355
VAFADAR BIJAN	GHOORBANI-NIK MITRA 8410 ELDORA AVE #2084 LAS VEGAS NV 89117-2679	16309112170
VAFADAR BIJAN	8410 ELDORA AVE #2084 LAS VEGAS NV	16309112170
VALENTIN EDWIN	3540 W SAHARA #381 LAS VEGAS NV	16308512064
VANALSTYNE JAMES GIBSON	P O BOX 15703 LAS VEGAS NV 89114-5703	16308512005
VANALSTYNE JAMES GIBSON	P O BOX 15703 LAS VEGAS NV	16308512005
VANDERVELDT HERMAN & J A FAM TR	VANDERVELDT HERMAN & JUDITH TRS 8308 MONARCH BIRCH AVE LAS VEGAS NV 89117-1891	16304413022
VANMEETREN F L P	2 ANTHEM PT HENDERSON NV	16309210274
VANNAH MATTHEW & CATHERINE	43 PANORAMA CREST AVE LAS VEGAS NV 89135-7830	16304411008
VANREENAN MARCELLA R	8410 ELDORA AVE #1050 LAS VEGAS NV	16309112098
VANREENAN MARCELLA R	8410 ELDORA AVE #1050 LAS VEGAS NV 89117-2675	16309112098
VAROS SUZANNE	8453 PACIFIC SPRING AVE LAS VEGAS NV 89117-1810	16304412012
VARTAZARIAN VAHIK LIVING TR 2010	VARTAZARIAN VAHIK TRS 1025 N ISABEL ST GLENDALE CA 91207-1724	16309112059
VARTAZARIAN VAHIK LIVING TR 2010	1025 N ISABEL ST GLENDALE CA	16309112059
VEGAS INTERNATIONAL L L C	2085 SARATOGA ST LAS VEGAS NV 89146-3138	16309111274
VICKERS JASON & MICHELLE	2750 S DURANGO DR #1096 LAS VEGAS NV	16309210314
VILLA LAS PALMAS L L C	%C GENTZ 2200 COUNTRY COTTAGE CT LAS VEGAS NV 89117-1845	16304411003
VILLANUCCI JAMES A	100 JUNIPER HILL PL ALBUQUERQUE NM	16308512057
VINCI ANGELO S	2606 S DURANGO DR #229 LAS VEGAS NV 89117-2654	16309111303
VIRGA NICOLE	1275 SONATINA DR HENDERSON NV	16309110172

Report of All Selected Parcels**Case Number:** ROC-42427**Printed On:** Thu: July 14, 2011

<u>Owner</u>	<u>Address</u>	<u>Parcel Number</u>
VIRGILI TINA M	2623 S DURANGO DR #102 LAS VEGAS NV	16308512062
VOLOGIN OLEG & BOZA LIA	10050 LA CROSSE AVE SKOKIE IL	16308512070
VONTOBEL JACQUELINE NANCY ETAL	2301 NORWAY MAPLE ST LAS VEGAS NV 89117-1897	16304413006
WADE ANDRE C	2750 S DURANGO DR #2059 LAS VEGAS NV	16309210049
WADE DAN & DANA M	8920 CANYON SPRINGS DR LAS VEGAS NV 89117-5847	16304417019
WALKER LORNE D FAMILY TRUST	WALKER LORNE D TRS 8312 MONARCH BIRCH AVE LAS VEGAS NV 89117-1892	16304413001
WALKER ROBERT K & NINA O	2300 PACIFIC BROOK ST LAS VEGAS NV 89117-1813	16304412045
WALLIS JEFFREY & BARBARA	32515 THE OLD RD CASTAIC CA	16309210175
WALTERS LORAIN A	1173 DESHIELDS AVE LAS VEGAS NV 89123-5320	16309112043
WALTERS LORAIN A	1173 DESHIELDS AVE LAS VEGAS NV	16309112043
WANG MEI ZHEN	4404 HILLCREST AVE LAS VEGAS NV 89102-3508	16309112035
WANG MEI ZHEN	4404 HILLCREST AVE LAS VEGAS NV	16309112035
WANG MEIZHEN	4404 HILLCREST AVE LAS VEGAS NV	16309112091
WANG SHAOHUA & TAO HENRY	488 BLUSHING MARIE HENDERSON NV 89015-7480	16309110036
WANG SHAOHUA & TAO HENRY	488 BLUSHING MARIE HENDERSON NV	16309110036
WANG STEPHEN & ROSA	9065 CIRCLE LAKE DR GRAND BLANC MI 48439-9310	16304417010
WARD JEFFREY & ELLEN M	3366 SUFFOLK DOWNS STOW OH	16309210144
WARING MICHAEL JEFFERY & DIANE I	4725 TORREY PINES CHINO HILLS CA 91709-7804	16304412044
WEAVER ROBERT J & RUTH M	3395 S JONES BLVD #359 LAS VEGAS NV 89146-6729	16304413012
WEBB ALLAN TRUST	WEBB ALLAN TRS 200 ELM ST #212 SAN MATEO CA 94401-2638	16309112139
WEBB ALLAN TRUST	200 ELM ST #212 SAN MATEO CA	16309112139
WEBSTER DAVID L TRUST	%K VONDOLSON 1208 POINTE CENTRE DR #220 CHATTANOOGA TN	16309110028
WEISS SCOTT D	HOPKINS-WEISS DIANA L 8317 FULLMOON MAPLE AVE LAS VEGAS NV 89117-1895	16304413010
WELCH ROBERT J	2643 S DURANGO DR #201 LAS VEGAS NV	16308512123
WELLS JACQUELINE R	2750 S DURANGO #2008 LAS VEGAS NV	16309210151
WELZENBACH DENNIS P TRUST	WELZENBACH DENNIS P TRS 8468 PACIFIC FOUNTAIN AVE LAS VEGAS NV 89117-1860	16304412066
WENG WENDONG	XU BIN 3 PLEASANT VALLEY WY WEST WIDSOR NJ 08550-3309	16309112144
WENG WENDONG	3 PLEASANT VALLEY WY WEST WIDSOR NJ	16309112144
WERNER ROLAND & KAREL	8304 MONARCH BIRCH AVE LAS VEGAS NV 89117-1891	16304413021
WESSEL SCOTT L	9429 VALLEY HILLS AVE LAS VEGAS NV	16309112138
WESTMORELAND STEVE	%T WESTMORELAND 2309 NORWAY MAPLE ST LAS VEGAS NV 89117-1897	16304413008
WHITE LIVING TRUST	2750 S DURANGO DR #1151 LAS VEGAS NV	16309210176

Report of All Selected Parcels**Case Number:** ROC-42427**Printed On:** Thu: July 14, 2011

<u>Owner</u>	<u>Address</u>	<u>Parcel Number</u>
WHITE ROSE PROPERTIES L L C	6450 ALDEA AVE LAKE BALBOA CA	16308512010
WIESNER DANIEL A	8440 PACIFIC SPRING AVE LAS VEGAS NV 89117-1809	16304412037
WILCOX CHRIS LYNN & SONYA	2110 ALBERTI CT LAS VEGAS NV 89117-1851	16304310014
WILLETT ROBERT K H	2750 S DURANGO DR #1142 LAS VEGAS NV	16309210197
WILLIAMS GEORGENNE	8410 ELDORA AVE #2060 LAS VEGAS NV	16309112120
WILLIAMS GEORGENNE	8410 ELDORA AVE #2060 LAS VEGAS NV 89117-7612	16309112120
WILLIAMS LINDA C	2009 LOGGERHEAD RD LAS VEGAS NV	16308512106
WILMER RAYMOND E JR	8410 ELDORA ST #1090 LAS VEGAS NV	16309112178
WILSON ROBERT	2750 S DURANGO DR #1028 LAS VEGAS NV	16309210097
WINBARG LORRAINE A	8440 PACIFIC FOUNTAIN AVE LAS VEGAS NV 89117-1860	16304412072
WONG CLAN FAMILY TRUST	WONG MILTON & BRIDGET TRS 8321 FULLMOON MAPLE AVE LAS VEGAS NV 89117-1895	16304413009
WONG MICHAEL YE IRREVOCABLE TR	HUI WAHLING TRS 2290 CASA BELLA CT LAS VEGAS NV 89117-8934	16304415002
WOOD VIRGINIA TRUST	WOOD ALONDA B TRS 418 WOODCREST LN FRANKLIN TN 37067-8532	16308510004
WOOLSEY AMY	2627 S DURANGO DR #203 LAS VEGAS NV	16308512077
WORTHEN JR FAMILY TRUST	WORTHEN ROBERT T JR & DEBRA TRS 8317 MONARCH BIRCH AVE LAS VEGAS NV 89117-1892	16304413031
WRIGHT STEVEN K & CASEY M	2750 DURANGO DR #1148 LAS VEGAS NV	16309210186
WU ELISA & NUNO	2291 AUTUMN FIRE CT LAS VEGAS NV 89117-8956	16304417001
WU YIPING	5471 WATERFIELD CT ANN ARBOR MI	16309112048
WU YIPING	ZHANG JIN 5471 WATERFIELD CT ANN ARBOR MI 48108-2749	16309112048
WULFSBERG FAMILY TRUST	WULFSBERG BETTY LU TRS %C WUITSBERG 2109 DIAMOND PEAK CT LAS VEGAS NV 89117-1868	16304311003
WUNG TRUST	WUNG ERIC JEN H & SABRINA Y TRS %L HIDALGO 7785 W SAHARA BLVD #200 LAS VEGAS NV 89117-2789	16304405004
Y B PROPERTIES L L C	%TWAINY ASSOC %K RUBIN 101 CONVENTION CENTER DR #1002 LAS VEGAS NV	16309112086
Y B PROPERTIES L L C	%TWAINY ASSOC %K RUBIN 101 CONVENTION CENTER DR #1002 LAS VEGAS NV 89109-2033	16309112049
Y B PROPERTIES L L C	%TWAINY ASSOC %K RUBIN 101 CONVENTION CENTER DR #1002 LAS VEGAS NV	16309112049
YANG XI	2750 S DURANGO DR #1040 LAS VEGAS NV	16309210034
YANKOVICH JUSTINA	58 HOME RD HATBORO PA	16309210282
YAO MICHAEL & REBECCA S	P O BOX 370333 LAS VEGAS NV 89137-0333	16309112051
YAO MICHAEL & REBECCA S	P O BOX 370333 LAS VEGAS NV	16309112051
YEGHIAZARIAN NELLY LIVING TRUST	YEGHIAZARIAN NELLY TRS 2901 CHANNEL ROCK DR LAS VEGAS NV 89117-0623	16308512018
YEGHIAZARIAN NELLY LIVING TRUST	2901 CHANNEL ROCK DR LAS VEGAS NV	16308512018
YEGHIAZARIAN SAREH	2625 S DURANGO DR #101 LAS VEGAS NV	16308512067

Report of All Selected Parcels**Case Number:** ROC-42427**Printed On:** Thu: July 14, 2011

<u>Owner</u>	<u>Address</u>	<u>Parcel Number</u>
YOGI HENRY S	P O BOX 507 WAILUKU HI	16309210342
YOUNG EDWIN S W & JOAN TAY	P O BOX 701504 KAPOLEI HI	16308512105
YOUNG EDWIN S W & JOAN TAY	P O BOX 701504 KAPOLEI HI	16308512127
YUE JUNPING	45907 FOUNTAIN VIEW CANTON MI	16308512102
YULIS DIMITRI & MARIA CHRISTINA	8410 ELDORA AVE #1011 LAS VEGAS NV	16309112019
YUN MOON S	8604 TITLEIST CIR LAS VEGAS NV 89117-5843	16305812011
ZADIKIAN ROSA	6160 WHIBETT AVE #8 NORTH HOLLYWOOD CA	16309210156
ZAFRA MICHAEL	4438 TOLAND WY LOS ANGELES CA	16309110040
ZAROAS CHRISTOS S	2968 CROWN BLUFFS CT LAS VEGAS NV	16309210102
ZARPAS CHRISTOS S	2968 CROWN BLUFFS CT LAS VEGAS NV	16309210099
ZARPAS KICHKA	ZARPAS CHRIS 2968 CROWN BLUFFS CT LAS VEGAS NV 89117-2577	16309111255
ZEGARAC GEORGE & MARIE ROSE	5763 SHERMER CT LAS VEGAS NV	16308512118
ZEMBLE BERNARD B	P O BOX 81902 NO LAS VEGAS NV	16308512009
ZHANG QIUHUA	8455 W SAHARA AVE #160 LAS VEGAS NV	16309110031
ZHENG YOU CHANG	8410 ELDORA AVE #2044 LAS VEGAS NV	16309112088
ZHENG YOU CHANG	8410 ELDORA AVE #2044 LAS VEGAS NV 89117-2678	16309112088
ZHONG MENG	1481 FOOTHILLS VILLAGE DR HENDERSON NV	16309210096
ZHOU REJING	4656 OLD POND DR PLANO TX	16309112071
ZHOU REJING	JIANG HUI 4656 OLD POND DR PLANO TX 75024-4704	16309112071
ZOCKOLL FAMILY TRUST	ZOCKOLL TONY & DEBBIE L TRS 2920 EBONY CIR ST GEORGE UT 84790-6908	16304417025
ZOOK CAROLE J TRUST	2641 S DURANGO DR #102 LAS VEGAS NV	16308512116
ZOOK CAROLE J TRUST	ZOOK CAROLE J TRS 2641 S DURANGO DR #102 LAS VEGAS NV 89117-2633	16308512116
ZORBIST MARK & LINDA	8313 FULLMOON MAPLE AVE LAS VEGAS NV 89117-1895	16304413011