

City of Las Vegas  
Office Of The City Clerk  
495 S. Main St., City Hall  
Las Vegas, Nevada 89101

## Return Service Requested Official Notice of Public Hearing

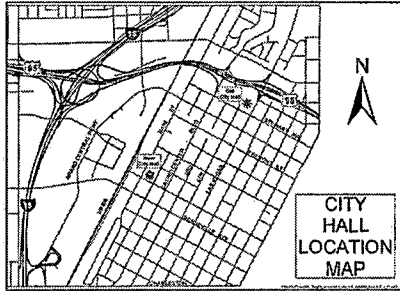

If you wish to file your protest or support on this request, check the appropriate box below and return this card in an envelope with postage to the Office Of The City Clerk at the address listed above, fax this side of this card to (702) 382-4803 or make your comments at [www.lasvegasnevada.gov](http://www.lasvegasnevada.gov). If you would like to contact your Council Representative, please call (702) 229-6405.

I SUPPORT  
this Request

I OPPOSE  
this Request

Please use available blank space on card for your comments.

**MOD-61253 [PRJ-60716]**

City Council Meeting of November 18, 2015

## Application Information

**MOD-61253 - MAJOR MODIFICATION - PUBLIC HEARING - APPLICANT/OWNER: FARM & DURANGO INVESTORS, LLC** - For possible action on a request for a Major Modification of the Town Center Land Use Plan to amend the Special Land Use Designation FROM: SC-TC (SERVICE COMMERCIAL - TOWN CENTER) TO: GC-TC (GENERAL COMMERCIAL - TOWN CENTER) on 1.62 acres on the east side of Durango Drive, approximately 375 feet south of Farm Road (APN 125-17-601-020), Ward 6 (Ross) [PRJ-60716].

## Application Location

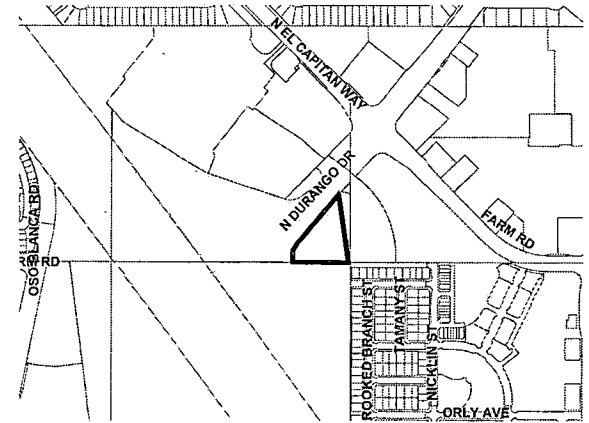

The proposed project may not pertain to the entire highlighted project site.

## Public Hearing Information

**Meeting:** City Council  
**Date:** *November 18, 2015*  
**Time:** 1:00 P.M.  
**Location:** City Council Chambers  
495 South Main Street, 2<sup>nd</sup> Floor  
Las Vegas, Nevada 89101

Any and all interested persons may appear and be heard at said meeting, or may, prior to this meeting, file a written objection thereto or approval thereof with the City Clerk, 2nd Floor, City Hall, 495 South Main Street, Las Vegas, Nevada 89101. For further information, including the full staff report, please call (702)229-6311 (7-1-1 Relay Nevada) or go to <http://www.lasvegasnevada.gov>.

## Report of All Selected Parcels

Case Number: MOD-61253; SUP-61067; SUP-61068; SUP-61071; SDR-61074 & TMP-61075

Printed On: Mon: October 26, 2015

<u>Owner</u>	<u>Address</u>	<u>Parcel Number</u>
2015-3 I H 2 BORROWER L P	901 MAIN ST #4700 DALLAS TX 75202	12517526016
2015-3 I H 2 BORROWER L P	901 MAIN ST #4700 DALLAS TX 75202	12517526006
7785 NORTH DURANGO L L C	69 ORCHARD ST NEW YORK NY 10002	12517611003
A B S NV-O L L C	P O BOX 990 MINNEAPOLIS MN 55440	12517610014
A H 4 R PROPERTIES L L C	30601 AGOURA RD #200 AGOURA HILLS CA 91301	12517519005
A M H 2014-1 BORROWER L L C	30601 AGOURA RD #200 AGOURA HILLS CA 91301	12517525021
A M H 2014-1 BORROWER L L C	30601 AGOURA RD #200 AGOURA HILLS CA 91301	12516319041
A R & B R L L C	5810 N BUTLER ST LAS VEGAS NV 89149	12517510014
ABBATTE WILLIAM & PAMELA	7801 BRIGHT HEIGHTS ST LAS VEGAS NV 89131-4611	12516113002
ABREU ROVIRIO	8532 SHADY PINES DR LAS VEGAS NV 89143-4451	12517520010
ACOSTA JACOB & AWBREI	8345 SPRUCE MEADOWS AVE LAS VEGAS NV 89131-4582	12516312019
ACUNA FERNANDO E SUITO	7550 CROOKED BRANCH ST LAS VEGAS NV 89143	12517716036
ADAMS DANIEL G	7537 NICKLIN ST LAS VEGAS NV 89143	12517716018
ADAMS EDWARD JR & THERESA M	8308 IMPATIENTS AVE LAS VEGAS NV 89131-4617	12516211039
AGAH SASAN	8548 BLOWING PINES DR LAS VEGAS NV 89143	12517520014
AGGIERI REGINA	8573 BLOWING PINES DR LAS VEGAS NV 89143-4462	12517527018
AGUILAR ROSARIO TRUST	1912 SUNSET BLVD LOS ANGELES CA 90026-3229	12516319004
AINO X 2 L L C	103 FOULK RD #900 WILMINGTON DE 19803	12516319043
ALEXANDER SHERIE G & STEVEN C	8368 FORT SEDGWICK AVE LAS VEGAS NV 89131-8193	12516319015
ALFARO MARIA G SANDOVAL	8516 TRUDEAU AVE LAS VEGAS NV 89143-1323	12517714012
ALKSNE PAMELA & MILTON	7729 KIOWA POINTE ST LAS VEGAS NV 89131-4615	12516210008
ALLEN FRANK H IV	860 CANTERRA ST #2036 LAS VEGAS NV 89138-4596	12517714024
ALLEN FRANK H IV	860 CANTERRA ST #2036 LAS VEGAS NV 89138	12517715008
ALVARADO ANA M	8420 SHADY PINES DR LAS VEGAS NV 89131-8133	12517528024
ALVAREZ GLORIA	8617 HIDDEN PINES AVE LAS VEGAS NV 89143-1367	12517519029
AMERICAN GEAR REDUCTION INC	P O BOX 62467 BOULDER CITY NV 89006-2467	12517802005
AMICO ROBERT S & SHARON L	7709 KIOWA POINTE ST LAS VEGAS NV 89131-4615	12516210003
AMPER SERGIO F & JESUS A	8733 SHADY PINES DR LAS VEGAS NV 89143-4459	12517524004
ANDERSON THOMAS M JR	8301 VALLEY STREAM AVE LAS VEGAS NV 89131-4616	12516211019
ANGEL KING L L C	7818 SPRING HILL ST CHINO CA 91708-7656	12517714008
ANGEL KING L L C	7818 SPRING HILL ST CHINO CA 91708-7656	12517714010
ANTONIUK DANIEL S	8316 SPRUCE MEADOWS AVE LAS VEGAS NV 89131-4581	12516312011

**Report of All Selected Parcels**

**Case Number:** MOD-61253; SUP-61067; SUP-61068; SUP-61071; SDR-61074 & TMP-61075 **Printed On:** Mon: October 26, 2015

<u>Owner</u>	<u>Address</u>	<u>Parcel Number</u>
AQUINO HILARIO & LILLY	7721 KIOWA POINTE ST LAS VEGAS NV 89131-4615	12516210006
ARCOS ROBERTO	7521 CROOKED BRANCH ST LAS VEGAS NV 89143	12517715036
ARRUDA ERIK P	7820 WAVERING PINE DR LAS VEGAS NV 89143-1378	12517520026
ATIENZA-JOHNSON ELENA	8541 SHADY PINES DR LAS VEGAS NV 89143-4451	12517521033
AYUSTE EDWARD	8461 ORLY AVE LAS VEGAS NV 89143-6008	12517710006
BABCOCK FAMILY LIVING TRUST	BABCOCK TIMOTHY A TRS 8316 GORSKY AVE LAS VEGAS NV 89131-4620	12516210027
BANASZAK DONALD	8625 HIDDEN PINES AVE LAS VEGAS NV 89143-1367	12517519027
BANAWEL LAARNI D	8517 STUCKEY AVE LAS VEGAS NV 89143-1209	12517715019
BANK AMERICA N A	400 NATIONAL WAY SIMI VALLEY CA 93065-6414	12516301003
BANK FIRST SAVINGS	2605 E FLAMINGO RD LAS VEGAS NV 89121-5241	12517715033
BANK U S NATIONAL ASSOCIATION TR	1000 TECHNOLOGY DR MS 92 O'FALLON MO 63368	12517520016
BARATTINO MATTHEW	7513 NICKLIN ST LAS VEGAS NV 89131	12517715022
BARBER EMILY & DANIEL	8567 SHADY PINES DR LAS VEGAS NV 89143-4452	12517526014
BARKER JENNIFER L	7554 CROOKED BRANCH ST LAS VEGAS NV 89143	12517716037
BARRY ERIK & TAMALA	8740 SHADY PINES DR LAS VEGAS NV 89143-4460	12517524014
BAXTER DAVID T & ADRIANNE	8300 SPRUCE MEADOWS AVE LAS VEGAS NV 89131-4581	12516312007
BELLO ROSITO L & ROSEMARIE E	98-1766 HALAKEA ST AIEA HI 96701-1706	12517711016
BENITES DAVID	8705 HIDDEN PINES AVE LAS VEGAS NV 89143-1366	12517519021
BENITEZ LAURA	8557 HIDDEN PINES AVE LAS VEGAS NV 89143-1368	12517521014
BENSON RICHARD J	7605 KIOWA POINTE AVE LAS VEGAS NV 89131-4619	12516211008
BENTO ANTHONY	8201 VALLEY STREAM AVE LAS VEGAS NV 89131-4633	12516212011
BENZEL TERRY	SHANI RAMI 8504 PITNEY AVE LAS VEGAS NV 89143	12517716001
BERG THOMAS A	8568 BLOWING PINES DR LAS VEGAS NV 89143	12517526017
BERGSING DINEEN M	8548 SHADY PINES DR LAS VEGAS NV 89143-4451	12517521026
BERRY JONATHAN	8469 BELLERY AVE LAS VEGAS NV 89143-1314	12517711035
BERRY MARK & TONI	7633 KIOWA POINTE ST LAS VEGAS NV 89131-4619	12516211001
BETTI THOMAS R & PAULA K TRUST	BETTI THOMAS R & PAULA K TRS 8224 GORSKY AVE LAS VEGAS NV 89131-4623	12516213031
BEVERS WESLEY E	7355 TENAYA WY LAS VEGAS NV 89131-0103	12517510013
BIENIEK DANIEL K	8313 IMPATIENTS AVE LAS VEGAS NV 89131-4618	12516211033
BINDER FAMILY TRUST	BINDER TODD ALLAN & PATRICIA J T 8220 VALLEY STREAM AVE LAS VEGAS NV 89131-4633	12516212025
BINYONS ENRIQUE A	NORIEGA-BINYONS SILVIA 8347 RAINBOW SKY ST LAS VEGAS NV 89131-0231	12517715015
BISHOP MORGAN & BETHANY	8581 BLOWING PINES ST LAS VEGAS NV 89143-4463	12517527016

**Report of All Selected Parcels**

**Case Number:** MOD-61253; SUP-61067; SUP-61068; SUP-61071; SDR-61074 & TMP-61075 **Printed On:** Mon: October 26, 2015

<u>Owner</u>	<u>Address</u>	<u>Parcel Number</u>
BLACK DWIGHT D	DAVIS LOU A 7521 FENCEROW ST LAS VEGAS NV 89131-4548	12516313063
BLAIR THERESE A	8544 HIDDEN PINES AVE LAS VEGAS NV 89143-1369	12517521007
BLAKE CARMEN JEAN	8412 SHADY PINES DR LAS VEGAS NV 89131-8133	12517528022
BLUE FRANCES	8224 IMPATIENTS AVE LAS VEGAS NV 89131	12516212037
BOILEAU THERESA & WILLIAM H	8314 FORT HALLOCK AVE LAS VEGAS NV 89131-8194	12516319035
BOKELMANN FAMILY TRUST	BOKELMANN WILLIAM T & PAMELA D T 2377 FLUTE AVE HENDERSON NV 89052-6415	12516319007
BOLANOS VICTOR H & JUDITH C	8325 FRITZEN AVE LAS VEGAS NV 89131-4608	12516210024
BOLOSAN JAVIE-ANNE	7565 CROOKED BRANCH ST LAS VEGAS NV 89143-1134	12517716040
BONDIEK PATRICK W	8216 VALLEY STREAM AVE LAS VEGAS NV 89131	12516212026
BOOKER JENNIFER	8729 SHADY PINES DR LAS VEGAS NV 89143-4459	12517524005
BOOTH ROBERT L & FRANCES M	7808 RESTLESS PINES ST LAS VEGAS NV 89131-8134	12517528009
BORO JOSEPH & SHIRLEY	8585 BLOWING PINES DR LAS VEGAS NV 89143-4463	12517527015
BOTROS TAMER B	7820 RESTLESS PINES ST LAS VEGAS NV 89131-8134	12517528012
BOUTANG KIONA F	8449 TRUDEAU AVE LAS VEGAS NV 89143	12517711009
BOY LORI J	8311 FORT HALLOCK AVE LAS VEGAS NV 89131-8194	12516319032
BOYER MARK A & LAURA	8579 SHADY PINES DR LAS VEGAS NV 89143-4452	12517526011
BRANFORD FAMILY REVOCABLE LIVING	BRANFORD JAMES WILLIAM & ESTHER 8620 CREST HILL AVE LAS VEGAS NV 89145-4867	12517521015
BRANSCOME ORRIN W & CHERYL E	8308 FRITZEN AVE LAS VEGAS NV 89131-4608	12516210015
BRAUN JOSHUA	7109 FEATHER PINE ST LAS VEGAS NV 89131	12517527011
BRIAN SCOTT A	8736 SHADY PINES DR LAS VEGAS NV 89143-4460	12517524013
BROADNAX DECRECIA D	8051 W CHARLESTON BLVD #58 LAS VEGAS NV 89117	12517526023
BROOKS CHRISTOPHER L	7612 ROOP ST LAS VEGAS NV 89131-4621	12516212021
BROOKS LIVING TRUST	BROOKS WILLIAM A & CYNTHIA TRS 7609 ROOP ST LAS VEGAS NV 89131-4621	12516211022
BROWN CHARLINE LIVING TRUST	CANFIELD BEVERLY J TRS 6521 BLUFF DWELLERS AVE LAS VEGAS NV 89131-3027	12517710016
BROWN OLLIS H	8233 VALLEY STREAM AVE LAS VEGAS NV 89131-4633	12516212019
BROWN TIMOTHY W & ROBIN T	7617 ROOP ST LAS VEGAS NV 89131-4621	12516211020
BRUCE JEANETTE H 2003 LIVING TR	BRUCE JEANETTE H TRS 6455 BLUFF DWELLERS AVE LAS VEGAS NV 89131-3027	12517520033
BRUNER JANA	8484 GARSIDE DR LAS VEGAS NV 89145	12517713005
BURKE SEAN & SABRINA	8300 GORSKY AVE LAS VEGAS NV 89131	12516210031
BURTON STEPHEN J & SUSAN	8325 GORSKY AVE LAS VEGAS NV 89131-4620	12516210038
BURTON XERES ELIZABETH	7542 TAMANY ST LAS VEGAS NV 89143-1212	12517716020
BUSH REBECCA	8341 SPRUCE MEADOWS AVE LAS VEGAS NV 89131-4582	12516312020

## Report of All Selected Parcels

Case Number: MOD-61253; SUP-61067; SUP-61068; SUP-61071; SDR-61074 & TMP-61075

Printed On: Mon: October 26, 2015

<u>Owner</u>	<u>Address</u>	<u>Parcel Number</u>
BUSHMAN MICHAEL JAMES	45 PINWOOD DR MEDINA OH 44256-2893	12517520027
C A H 2014-1 BORROWER L L C	9305 E VIA DE VENTURA #201 SCOTTSDALE AZ 85258	12517524018
C A H 2014-1 BORROWER L L C	9305 E VIA DE VENTURA #201 SCOTTSDALE AZ 85258	12517521011
C A H 2014-1 BORROWER L L C	9305 E VIA DE VENTURA #201 SCOTTSDALE AZ 85258	12516311076
C A H 2014-2 BORROWER L L C	9305 E VIA DE VENTURA #201 SCOTTSDALE AZ 85258	12517519028
C A H 2015-1 BORROWER L L C	9305 E VIA DE VENTURA #201 SCOTTSDALE AZ 85258	12516319023
C M L-N V CSPRINGS L L C	730 NW 107 AVE #400 MIAMI FL 33172-3104	12517719003
C M L-N V CSPRINGS L L C	730 NW 107 AVE #400 MIAMI FL 33172-3104	12517719001
C M L-N V CSPRINGS L L C	730 NW 107 AVE #400 MIAMI FL 33172-3104	12517719005
C M L-N V CSPRINGS L L C	730 NW 107 AVE #400 MIAMI FL 33172-3104	12517719004
C M L-N V CSPRINGS L L C	730 NW 107 AVE #400 MIAMI FL 33172-3104	12517718006
C M L-N V CSPRINGS L L C	730 NW 107 AVE #400 MIAMI FL 33172-3104	12517719002
C M L-N V CSPRINGS L L C	730 NW 107 AVE #400 MIAMI FL 33172-3104	12517719014
C M L-N V CSPRINGS L L C	730 NW 107 AVE #400 MIAMI FL 33172-3104	12517712012
C M L-N V CSPRINGS L L C	730 NW 107 AVE #400 MIAMI FL 33172-3104	12517718003
C M L-N V CSPRINGS L L C	730 NW 107 AVE #400 MIAMI FL 33172-3104	12517712010
C M L-N V CSPRINGS L L C	730 NW 107 AVE #400 MIAMI FL 33172-3104	12517712011
C M L-N V CSPRINGS L L C	730 NW 107 AVE #400 MIAMI FL 33172-3104	12517712013
C M L-N V CSPRINGS L L C	730 NW 107 AVE #400 MIAMI FL 33172-3104	12517718004
C M L-N V CSPRINGS L L C	730 NW 107 AVE #400 MIAMI FL 33172-3104	12517712002
C M L-N V CSPRINGS L L C	730 NW 107 AVE #400 MIAMI FL 33172-3104	12517719013
C M L-N V CSPRINGS L L C	730 NW 107 AVE #400 MIAMI FL 33172-3104	12517712009
C M L-N V CSPRINGS L L C	730 NW 107 AVE #400 MIAMI FL 33172-3104	12517712004
C M L-N V CSPRINGS L L C	730 NW 107 AVE #400 MIAMI FL 33172-3104	12517712006
C M L-N V CSPRINGS L L C	730 NW 107 AVE #400 MIAMI FL 33172-3104	12517719010
C M L-N V CSPRINGS L L C	730 NW 107 AVE #400 MIAMI FL 33172-3104	12517719012
C M L-N V CSPRINGS L L C	730 NW 107 AVE #400 MIAMI FL 33172-3104	12517719007
C M L-N V CSPRINGS L L C	730 NW 107 AVE #400 MIAMI FL 33172-3104	12517719006
C M L-N V CSPRINGS L L C	730 NW 107 AVE #400 MIAMI FL 33172-3104	12517719011
C M L-N V CSPRINGS L L C	730 NW 107 AVE #400 MIAMI FL 33172-3104	12517712003
C M L-N V CSPRINGS L L C	730 NW 107 AVE #400 MIAMI FL 33172-3104	12517719009
C M L-N V CSPRINGS L L C	730 NW 107 AVE #400 MIAMI FL 33172-3104	12517719008

**Report of All Selected Parcels**

**Case Number:** MOD-61253; SUP-61067; SUP-61068; SUP-61071; SDR-61074 & TMP-61075 **Printed On:** Mon: October 26, 2015

<u>Owner</u>	<u>Address</u>	<u>Parcel Number</u>
C M L-NV CSPPRINGS L L C	850 3RD AVE #16-B NEW YORK NY 10022-7269	12517712001
C M L-NV CSPPRINGS L L C	850 3RD AVE #16-B NEW YORK NY 10022-7269	12517712005
CABERO CHARLENE TOLOSA	8220 IMPATIENTS AVE LAS VEGAS NV 89131-4634	12516212038
CABEZA ONELIO M & JULIA D FAM TR	CABEZA ONELIO M JR & JULIA D TRS 8221 GORSKY AVE LAS VEGAS NV 89131-4623	12516213033
CADMAN JAMES R	8405 SHADY PINES DR LAS VEGAS NV 89131-8133	12517528007
CAINGLET CONCEPCION	7845 WAVERING PINE DR LAS VEGAS NV 89143	12517520005
CALDERON BELTER & LISETH	8452 BELLERY AVE LAS VEGAS NV 89143	12517711011
CAMP SANDRA	7805 WAVERING PINE DR LAS VEGAS NV 89143-1378	12517520011
CAMPBELL MICHAEL & KATHERINE	8328 IMPATIENTS AVE LAS VEGAS NV 89131-4617	12516211034
CANDELARIA GLEN C & MARLENE	8433 SHADY PINES DR LAS VEGAS NV 89131-8133	12517528001
CANLAPAN CHRISTOPHER C & MARIA C	7446 GILBERT RIDGE ST LAS VEGAS NV 89143-1203	12517714017
CAO GUXIONG & JIANG	378 FRINGE RUFF DR LAS VEGAS NV 89148	12517714022
CARNEY BRIAN E	8424 SHADY PINES DR LAS VEGAS NV 89131-8133	12517528025
CARREON EDWARD & SHARON	7420 MOUNTAIN THICKET ST LAS VEGAS NV 89131-4542	12516312029
CARRILLO JAZMIN	7728 WAVERING PINE DR LAS VEGAS NV 89143	12517520028
CARRILLO LETICIA L	7801 FALLING PINES PL LAS VEGAS NV 89143-4455	12517527008
CARROLL LATOYA	8322 FORT HALLOCK AVE LAS VEGAS NV 89131-8194	12516319037
CARTER CHARLES W & BOBBIE J	8556 HIDDEN PINES AVE LAS VEGAS NV 89143-1368	12517521010
CASAREZ SOMMER	7557 VIRGINIA DALE ST LAS VEGAS NV 89131-8191	12516319001
CASTLE JAMES ESTLE JR & DEBRA E	8336 SPRUCE MEADOWS AVE LAS VEGAS NV 89131	12516312016
CASTRO CHRISTOPHER JR & LORRAINE	8229 VALLEY STREAM AVE LAS VEGAS NV 89131-4633	12516212018
CASTRO JOSEPH J & WEENA R	8328 VALLEY STREAM AVE LAS VEGAS NV 89131-4616	12516211028
CATALDI GIULIO & CAROL	4655 REGALO BELLO ST LAS VEGAS NV 89135-2534	12516311012
CHACON EDWARD & ANA MARIE	7717 KIOWA POINTE ST LAS VEGAS NV 89131	12516210005
CHAMPLIN ROSE MARY	8209 VALLEY STREAM AVE LAS VEGAS NV 89131-4633	12516212013
CHANG DANIEL YOK MAN	505 ZENITH RIDGE DR DANVILLE CA 94506-1356	12517516026
CHANG FAMILY REVOCABLE TRUST	31 ALMOND TREE LN IRVINE CA 92612-2230	12516319010
CHEN ZHENYI	XIAO FEI 378 FRINGE RUFF DR LAS VEGAS NV 89148	12517714006
CHIN KAI C	HUANG ZHENG J 876 LEYLAND DR DIAMOND BAR CA 91765-4612	12516311016
CHOUDHARI BADAL	864 DEL RIO CT MILPITAS CA 95035	12517711008
CHRISTOFFERSON MARGARET & JOEL A	7425 MOUNTAIN THICKET ST LAS VEGAS NV 89131-4542	12516312021
CHURCH L D S PRESIDING BISHOP	50 E NORTH TEMPLE 22ND FLOOR SALT LAKE CITY UT 84150-0022	12516301017

**Report of All Selected Parcels****Case Number:** MOD-61253; SUP-61067; SUP-61068; SUP-61071; SDR-61074 & TMP-61075**Printed On:** Mon: October 26, 2015

<u>Owner</u>	<u>Address</u>	<u>Parcel Numbe</u>
CIFUENTES TAYLOR	8421 TRUDEAU AVE LAS VEGAS NV 89131	12517711023
CIMIC MARCELIE P & ALEN	10416 BRITTON HILL AVE LAS VEGAS NV 89129-4529	12517521021
CITY OF LAS VEGAS	333 N RANCHO DR 8TH FLR LAS VEGAS NV 89106	12516311070
CITY OF LAS VEGAS	333 N RANCHO DR 8TH FLR LAS VEGAS NV 89106	12516211015
CITY OF LAS VEGAS	495 S MAIN ST LAS VEGAS NV 89101-6318	12516311025
CLINE DEBORA M	8433 TRUDEAU AVE LAS VEGAS NV 89143-1307	12517711020
COBLE JERAMY PHILLIP & KRISTY A	8737 SHADY PINES DR LAS VEGAS NV 89143-4459	12517524003
COCKRELL DIANA	2532 ALLANTE AVE LAS VEGAS NV 89120-3740	12517527013
COLBERT WARREN E & MARLENE R	8313 GORSKY AVE LAS VEGAS NV 89131-4620	12516210035
COLDON SHANNON & DAMIEN	7853 WAVERING PINE DR LAS VEGAS NV 89143-1379	12517520003
COLFIN AI-NV 2 L L C	9305 E VIA DE VENTURA #201 SCOTTSDALE AZ 85258	12516311020
COLON CRISTOBAL JR & LINDA	8312 GORSKY AVE LAS VEGAS NV 89131-4620	12516210028
COMPAGNO ROBIN M	6400 DORRELL LN LAS VEGAS NV 89131	12517713001
CONCEPCION NOEL	7808 NESTING PINE PL LAS VEGAS NV 89143-4468	12517524019
CONDOS GEORGE & KAREN	8331 FORT HALLOCK AVE LAS VEGAS NV 89131-8194	12516319027
COOK ANGELA K	8420 BELLERY AVE LAS VEGAS NV 89143-1313	12517711026
CORDERO ALEX R	CORDERO ANA & RAMON 7628 BOKHARA ST LAS VEGAS NV 89149-0449	12517211070
CORTEZ REVOCABLE LIVING TRUST	CORTEZ JOVENTINO & SHAN-CHIH TRS 7445 W EDNA AVE LAS VEGAS NV 89117-2958	12516319020
CORVALAN JUAN C & HECTOR	8705 SHADY PINES DR LAS VEGAS NV 89143-4459	12517524011
COVARRUBIAS RICARDO	REIMER ROSEMARIE 7804 NESTING PINE PL LAS VEGAS NV 89143-4468	12517524020
COX DAVID A & KATHLEEN	8457 ORLY AVE LAS VEGAS NV 89143-6008	12517710007
COX DEIONE J & DANA	8473 BELLERY AVE LAS VEGAS NV 89143-1314	12517711034
COY JOHN L	7546 TAMANY ST LAS VEGAS NV 89143-1212	12517716021
CRABB SHARON M REVOCABLE TR	CRABB SHARON M TRS 33925 N FISCHER DR INGLESIDE IL 60041-8904	12516213036
CRAIG SHERYL A	8563 SHADY PINES DR LAS VEGAS NV 89143-4451	12517526015
CUTLER JACK C & CHARLOTTE M	7809 BRIGHT HEIGHTS ST LAS VEGAS NV 89131-4611	12516110015
DALESSANDRO VITO	5726 CHANDLER CT RANCHO CUCAMONGA CA 91739	12516210026
DAVIS TWANNA JACKSON	7644 BOKHARA ST LAS VEGAS NV 89149-0450	12517211066
DAWES KRISTOPHER M	9731 RANGEVIEW DR NORTH TUSTIN CA 92705	12517527006
DELAND RICHARD D & JENNIFER L	7454 GILBERT RIDGE ST LAS VEGAS NV 89143-1203	12517714015
DENNIS JEFFREY JAMES	7601 KIOWA POINTE ST LAS VEGAS NV 89131-4619	12516211009
DENTINGER ARNOLD D & MARGARET I	7413 MOUNTAIN THICKET ST LAS VEGAS NV 89131-4542	12516312039

**Report of All Selected Parcels****Case Number:** MOD-61253; SUP-61067; SUP-61068; SUP-61071; SDR-61074 & TMP-61075**Printed On:** Mon: October 26, 2015

<u>Owner</u>	<u>Address</u>	<u>Parcel Number</u>
DERR JEREMY M	7624 BOKHARA ST LAS VEGAS NV 89149-0449	12517211071
DERSARKISSIAN HAROUTIOUN	12534 COMPSTON ST VALLEY VILLAGE CA 91607	12516210021
DESERT PALM PROPERTIES L L C	2445 W HORIZON RIDGE PKWY #100 HENDERSON NV 89052	12516319038
DICAMPLI STEVEN D & DAWN M	8324 SPRUCE MEADOWS AVE LAS VEGAS NV 89131-4581	12516312013
DIGEORGE A T	7454 PEMBER ST LAS VEGAS NV 89143	12517711054
DODGE NORALEE	7437 FLAT ROCK ST LAS VEGAS NV 89131-4521	12516311024
DOMIAN JAMES S & SHIRLEY ANN TRU	DOMIAN JAMES S TRS 2817 LEGEND DR LAS VEGAS NV 89134	12517715011
DONLEY JERAD M	8520 STUCKEY AVE LAS VEGAS NV 89143-1209	12517715013
DOYLE GWENDOLYN	8572 SHADY PINES DR LAS VEGAS NV 89143-4452	12517525020
DUDEHOFER TROY J & VALERIE M	8513 BELLERY AVE LAS VEGAS NV 89143-1316	12517714032
DUNN SARA R & REBEKAH M	8344 SPRUCE MEADOWS AVE LAS VEGAS NV 89131	12516312018
DUQUE MARCO	8600 BLOWING PINES DR LAS VEGAS NV 89143-4464	12517526025
DURAN AL C	7259 CROOKED BRANCH ST LAS VEGAS NV 89143	12517715038
DURANGO 95 MINI STORAGE PTNRS L	2990 S DURANGO DR LAS VEGAS NV 89117	12517301011
DURANGO I-95 L L C	4221 WILSHIRE BLVD #390 LOS ANGELES CA 90010	12517612003
DURANGO I-95 L L C	4221 WILSHIRE BLVD #390 LOS ANGELES CA 90010	12517612008
DURANGO I-95 L L C	4221 WILSHIRE BLVD #390 LOS ANGELES CA 90010	12517612006
DURANGO I-95 L L C	4221 WILSHIRE BLVD #390 LOS ANGELES CA 90010	12517612007
DURANGO I-95 L L C	4221 WILSHIRE BLVD #390 LOS ANGELES CA 90010	12517214001
DURANGO I-95 L L C	4221 WILSHIRE BLVD #390 LOS ANGELES CA 90010	12517612005
DVORACEK PHYLLIS & BARBARA	8584 SHADY PINES DR LAS VEGAS NV 89143-4452	12517525017
E M-50 U A V SLBCO L L C	2120 PERK PL #200 EL SEGUNDO CA 90245	12517611004
EDWARDS WILLIAM J	LEVERETT KIMBERLY A 8619 SHADY PINES DR LAS VEGAS NV 89143-4453	12517526003
ELLINGTON JOSEPH M & LINDSAY RAE	7561 NICKLIN ST LAS VEGAS NV 89143	12517716012
ELLIOT WALTER J & MARTHA E	3005 RIPON DR LAS VEGAS NV 89134-7523	12517715005
ELSINORE VI L L C	3430 BUNKERVILLE DR #A NORTH LAS VEGAS NV 89032	12516313064
EMERALD HOLDINGS L L C-SERIES I	9236 DALMAHOY PL LAS VEGAS NV 89145	12517715003
ENGLER JEFFREY E	WESTON DESIREE Y 7609 KIOWA POINTE ST LAS VEGAS NV 89131-4619	12516211007
ENSLOW SARAH & TIMOTHY	8485 BELLERY AVE LAS VEGAS NV 89143	12517711031
EQUITY TRUST COMPANY	225 BURNS RD ELYRIA OH 44035	12517528021
ERBER DEAN D & LOUIS A	8304 IMPATIENTS AVE LAS VEGAS NV 89131-4617	12516211040
ETTINGER BRENDEN DAVID	8529 STUCKEY AVE LAS VEGAS NV 89143-1209	12517715016

**Report of All Selected Parcels****Case Number:** MOD-61253; SUP-61067; SUP-61068; SUP-61071; SDR-61074 & TMP-61075**Printed On:** Mon: October 26, 2015

<u>Owner</u>	<u>Address</u>	<u>Parcel Number</u>
EWELL JOHN B & AMY	8445 BELLERY AVE LAS VEGAS NV 89143	12517711041
FAGAN MILDRED	8600 SHADY PINES DR LAS VEGAS NV 89143-4452	12517525015
FALKOWITZ MICHAEL	8090 VILLA DEL CIELO ST LAS VEGAS NV 89131	12517521003
FALTER MELISSA	7604 SCROLLING CREST CT LAS VEGAS NV 89149-0455	12517210134
FANG CHENG	JI LINGHONG 5 PINE GROVE RD WESTFORD MA 01886-3207	12517524001
FARM & DURANGO INVESTORS L L C	848 N RAINBOW BLVD #5465 LAS VEGAS NV 89107	12517601021
FARM & DURANGO INVESTORS L L C	848 N RAINBOW BLVD #6465 LAS VEGAS NV 89107	12517601007
FARM & DURANGO INVESTORS L L C	848 N RAINBOW BLVD #5465 LAS VEGAS NV 89107	12517601020
FARM & DURANGO INVESTORS L L C	848 N RAINBOW BLVD #5465 LAS VEGAS NV 89107	12517601010
FARM & DURANGO INVESTORS L L C	848 N RAINBOW BLVD #5465 LAS VEGAS NV 89107	12517601013
FARM CAPITAL MANAGEMENT L L C	7155 S RAINBOW BLVD #200 LAS VEGAS NV 89118-3271	12517610017
FARM CAPITAL MANAGEMENT L L C	7155 S RAINBOW BLVD #200 LAS VEGAS NV 89118-3271	12517610018
FARM MINI STORAGE PARTNERS L L C	2990 S DURANGO DR LAS VEGAS NV 89117-4412	12517610016
FARM ROAD RETAIL L L C	1770 N BUFFALO #101 LAS VEGAS NV 89128-2679	12517610008
FARM ROAD RETAIL L L C	1770 N BUFFALO #101 LAS VEGAS NV 89128-2679	12517610005
FARM ROAD RETAIL L L C	1770 N BUFFALO #101 LAS VEGAS NV 89128-2679	12517610006
FARM ROAD RETAIL L L C	1770 N BUFFALO #101 LAS VEGAS NV 89128-2679	12517610004
FARM ROAD RETAIL L L C	1770 N BUFFALO #101 LAS VEGAS NV 89128-2679	12517610007
FARM ROAD RETAIL L L C	1770 N BUFFALO #101 LAS VEGAS NV 89128-2679	12517610003
FAWCETT WILLIAM L & NIKKI N	8212 VALLEY STREAM AVE LAS VEGAS NV 89131-4633	12516212027
FEDERAL NATIONAL MORTGAGE ASSN	8950 CYPRESS WATERS BLVD COPPELL TX 75019	12516313061
FENG WEI 2013 TRUST	FENG WEI TRS 6584 PROVENCE RD SAN GABRIEL CA 91775	12517713002
FERRIOLO DANIELLE	8465 ORLY AVE LAS VEGAS NV 89143-6008	12517710005
FIRST ACORN NEVADA L L C	2015 HIDDEN RIDGE LN HIGHLAND PARK IL 60035	12517612002
FIRST SAVINGS BANK	2605 E FLAMINGO RD LAS VEGAS NV 89121-5241	12517710004
FLYNN MICHAEL J & IRENE Q LIV TR	FLYNN MICHAEL J & IRENE Q TRS 23355 HARTLAND ST WEST HILLS CA 91307-2410	12516311026
FONTENOT CLYDE FAMILY TRUST	FONTENOT JOHN CLYDE & JULIA D TR 7613 KIOWA POINTE ST LAS VEGAS NV 89131-4619	12516211006
FORCIER LUCILLE G TRUST	FORCIER LUCILLE G TRS 8309 FRITZEN AVE LAS VEGAS NV 89131-4608	12516210020
FOREMASTER JUDD	7801 WAVERING PINE DR LAS VEGAS NV 89143	12517520012
FORERO ADRIAN D	7447 CROOKED BRANCH ST LAS VEGAS NV 89143-1121	12517714029
FORERO JENIFER	RUBIO MICHAEL 7561 CROOKED BRANCH ST LAS VEGAS NV 89143-1134	12517716041
FORNASIR LINO	7608 SCROLLING CREST CT LAS VEGAS NV 89149-0455	12517210133

**Report of All Selected Parcels**

**Case Number:** MOD-61253; SUP-61067; SUP-61068; SUP-61071; SDR-61074 & TMP-61075 **Printed On:** Mon: October 26, 2015

<u>Owner</u>	<u>Address</u>	<u>Parcel Number</u>
FOSTER LEONARD M & CHARLENE D	8744 SHADY PINES DR LAS VEGAS NV 89143-4460	12517524015
FOSTER YVETTE S	8213 GORSKY AVE LAS VEGAS NV 89131-4623	12516213035
FRANCO RICARDO & ERICA	8309 VALLEY STEAM AVE LAS VEGAS NV 89131	12516211017
FRANKE CHRISTOPHER	7508 FLAT ROCK ST LAS VEGAS NV 89131-4514	12516311067
FRANKFURT PROPERTIES II L L C	1040 E SAHARA AVE #201 LAS VEGAS NV 89104-3232	12516311008
FREELAND MARK A & ELIZABETH A	7541 VIRGINIA DALE ST LAS VEGAS NV 89131-8191	12516319005
FREEMAN RICHARD L & JOANNE I	8329 IMPATIENTS AVE LAS VEGAS NV 89131-4618	12516211029
GADDIS NICOLLEE	8544 PITNEY AVE LAS VEGAS NV 89143-1204	12517716011
GALLEGRO JOHANNA	8552 SHADY PINES DR LAS VEGAS NV 89143-4451	12517521027
GALLEGOS 2015 FAMILY TRUST	GALLEGOS JOHNNY V & LINDA J TRS 8541 BLOWING PINES DR LAS VEGAS NV 89143-4461	12517520021
GARCIA CASSIUS E	8761 SHADY PINES LAS VEGAS NV 89143-4449	12517522002
GARZA HECTOR R & ALICIA L	7901 WILLOW PINES PL LAS VEGAS NV 89143-1364	12517519017
GAVISH IDDO	GAVISH HAMUTAL 8201 IMPATIENTS AVE LAS VEGAS NV 89131-4634	12516212030
GELLER YEFIM	BULASHOVA TAMARA 6252 MORSE AVE NORTH HOLLYWOOD CA 91606-2920	12516319049
GEORGE EUGENE	HARRIS JUDITH M 7816 RESTLESS PINES ST LAS VEGAS NV 89131-8134	12517528011
GHAFFARIAN ENTERPRISES L L C	6222 HEUGHS CANYON DR SALT LAKE CITY UT 84121	12517520023
GHOUKASSI ROBERT	17305 CARDINAL CT CASTRO VALLEY CA 94546-1349	12516313066
GIBBS STEVEN M	7562 TAMANY ST LAS VEGAS NV 89143	12517716025
GIPSON FRED E & V N REV LIV TR	GIPSON FRED E & VIRGINIA N TRS 8212 IMPATIENTS AVE LAS VEGAS NV 89131-4634	12516212040
GIZZI PATRICK & LINDA	8473 ORLY AVE LAS VEGAS NV 89143-6008	12517710003
GLASSCOCK JERED G & RACHEL A	8709 HIDDEN PINES AVE LAS VEGAS NV 89143-1366	12517519020
GLOBAL OPPORTUNITY DEV LTD	8690 S MARYLAND PKWY #140 LAS VEGAS NV 89123	12516212028
GOLDSHTAIN ELIYAHU	GOLDSHTEIN DALIA P O BOX 531048 HENDERSON NV 89053	12516319046
GOLDSTEIN ROBERT EUGENE & MAXENE	5840 W CRAIG RD #120-300 LAS VEGAS NV 89130-2561	12517711057
GONZALES EDUARDO P	7562 CROOKED BRANCH ST LAS VEGAS NV 89143-1134	12517716039
GONZALES MICHAEL S T	7816 NESTING PINE PL LAS VEGAS NV 89143-4468	12517524017
GONZALEZ & EMETERIO-GONZALES TR	GONZALEZ BENJAMIN C TRS 8469 TRUDEAU AVE LAS VEGAS NV 89143-1309	12517711004
GONZALEZ ANA	8757 SHADY PINES DR LAS VEGAS NV 89143-4449	12517522003
GONZALEZ ROQUE & GINA REV LIV TR	GONZALES ROQUE & GINA S TRS 8625 ROSEY CT LAS VEGAS NV 89149	12517526019
GORDON HERBERT C & SHIRLEY A	8517 HIDDEN PINES AVE LAS VEGAS NV 89143-1369	12517520008
GOULET FAMILY LIVING TRUST	GOULET SHAWN J & KIMBERLY M TRS 7821 NESTING PINE PL LAS VEGAS NV 89143-4468	12517523009
GOURIAL RAFIE H & AVANTI	8429 SHADY PINES DR LAS VEGAS NV 89131-8133	12517528002

**Report of All Selected Parcels****Case Number:** MOD-61253; SUP-61067; SUP-61068; SUP-61071; SDR-61074 & TMP-61075**Printed On:** Mon: October 26, 2015

<u>Owner</u>	<u>Address</u>	<u>Parcel Number</u>
GRANT GLEN & LORETTA	8301 GORSKY AVE LAS VEGAS NV 89131-4620	12516210032
GRANTHAM CURTIS H III	7703 WILLIAM BONNEY SAN ANTONIO TX 78254	12517710001
GREEN GERARD F & CAREN M	8321 GORSKY AVE LAS VEGAS NV 89131-4620	12516210037
GREENBAUM TERESA L	8615 SHADY PINES DR LAS VEGAS NV 89143-4453	12517526004
GREENE CLIFFORD	7470 PEMBER ST LAS VEGAS NV 89143-1312	12517711058
GRIFFIN CHRISTIAN N & NICOLE M	7512 FLAT ROCK ST LAS VEGAS NV 89131-4514	12516311068
GRIFFIN MELISSIA	8310 FORT HALLOCK AVE LAS VEGAS NV 89131-8194	12516319034
GSCHWEND BRENT H & KAROL KORRINE	8741 SHADY PINES DR LAS VEGAS NV 89143-4459	12517524002
GUERRY CYNDY K	7557 TAMANY ST LAS VEGAS NV 89143	12517716027
GUGLIUZZA KRISTEL LEE	8417 TRUDEAU AVE LAS VEGAS NV 89143-1301	12517711024
GULEWICZ FELECIA ANNE	STOLL DEBRA L 8508 ORLY AVE LAS VEGAS NV 89143	12517715025
GUTSWA LYNNE CHARLES & ANN MARIE	6624 CHINATOWN ST LAS VEGAS NV 89166-8031	12516319030
GUZMAN GILBERT & ADAMMAY	7825 FALLING PINES PL LAS VEGAS NV 89143-4455	12517527002
HAFERNIK CLAYTON	8464 TRUDEAU AVE LAS VEGAS NV 89143-1309	12517710014
HALLMAN PAUL	7629 KIOWA POINTE ST LAS VEGAS NV 89131	12516211002
HALPERIN JASON	8345 SEDGWICK AVE LAS VEGAS NV 89131	12516319045
HAM DONALD E & TERESA R REV TR	HAM DONALD E & TERESA R TRS 516 EL DORADO DR ESCONDIDO CA 92025-6311	12516212017
HANSEN CAROL L	8224 VALLEY STREAM AVE LAS VEGAS NV 89131-4633	12516212024
HARDOY RENE MAURICE & PAMELA T	P O BOX 2111 MORGAN HILL CA 95038	12517521023
HARRIS JUDY L	ROSALES JESSICA 8360 FORT SEDGWICK AVE LAS VEGAS NV 89131-8193	12516319013
HARRISON RICHARD B & JOANNE R	9025 EDMONDS LAS VEGAS NV 89139-7555	12516319050
HART DONNA M & WALTER G	8476 BELLERY AVE LAS VEGAS NV 89143-1315	12517711017
HARTY WILLIAM R & SUSANA C	8327 FORT HALLOCK AVE LAS VEGAS NV 89131-8194	12516319028
HAVIS CHRISTINA	8311 FORT SEDGWICK AVE LAS VEGAS NV 89131	12516319051
HAWVER MARY TRUST	KNOWLTON CHRISTINE TRUST 2841 MANZANILLA WAY LAS VEGAS NV 89128	12517520015
HEADRICK JERRY L JR	8532 HIDDEN PINES AVE LAS VEGAS NV 89143-1369	12517521004
HEINTZELMAN DANIEL L & MIA L	7463 CROOKED BRANCH ST LAS VEGAS NV 89143-1121	12517714025
HELM THOMAS D & MEDINA A	8748 SHADY PINES DR LAS VEGAS NV 89143-4449	12517522006
HENDERSON DANIEL A	8337 VALLEY STREAM AVE LAS VEGAS NV 89131-4616	12516211010
HENRY SHARON L	8517 ORLY AVE LAS VEGAS NV 89143-6002	12517714004
HERNANDEZ CARLOS A	7545 NICKLIN ST LAS VEGAS NV 89143	12517716016
HERNANDEZ JOSE M	8325 VALLEY STREAM AVE LAS VEGAS NV 89131-4616	12516211013

**Report of All Selected Parcels****Case Number:** MOD-61253; SUP-61067; SUP-61068; SUP-61071; SDR-61074 & TMP-61075**Printed On:** Mon: October 26, 2015

<u>Owner</u>	<u>Address</u>	<u>Parcel Number</u>
HERRERA ANNA	3962 60TH ST #62 SAN DIEGO CA 92115-6539	12516311006
HERRERA KENNETH C & THERESA C	8601 HIDDEN PINES AVE LAS VEGAS NV 89143-1367	12517519033
HERRICK BRIAN S & SHANNON	7821 FALLING PINES PL LAS VEGAS NV 89143-4455	12517527003
HEU JAMES M	JENSEN RON E 7776 TOLAND AVE LOS ANGELES CA 90045-3245	12517715039
HIGASHIDA WILLIAM	7509 FLAT ROCK ST LAS VEGAS NV 89131-4516	12516311021
HILL WILLIAM L JR & STACEY M	9300 BRILLIANT ORE DR LAS VEGAS NV 89143-2305	12517520018
HO ANDREA	P O BOX 881 MONTROSE CA 91021	12517715040
HOGAN KEITH & RUTHANNE	8323 FORT HALLOCK AVE LAS VEGAS NV 89131-8194	12516319029
HOLGUIN SILVERIO C & ROMELIA	8460 TRUDEAU AVE LAS VEGAS NV 89143-1309	12517710013
HOOD LAURANN	8200 VALLEY STREAM AVE LAS VEGAS NV 89131-4633	12516212029
HOOPER TONI TRUST	HOOPER THELDA F TRS 8309 GORSKY DR LAS VEGAS NV 89131-4620	12516210034
HOPPING CHARLES A & CARMEN	NICODEMO ANTONIO N 8725 SHADY PINES DR LAS VEGAS NV 89143-4459	12517524006
HOWARD CHRISTOPHER	8346 FORT HALLOCKA AVE LAS VEGAS NV 89131-8195	12516319040
HOWELL ARIANA	HOWELL GARY & BARBARA 7533 FENCEROW ST LAS VEGAS NV 89131-4548	12516313060
HOWES KEVIN R JR	7558 TAMANY ST LAS VEGAS NV 89143	12517716024
HUANG HENRY	MA XIAO LING 4135 FAIRCOVE CT POMONA CA 91766-4636	12517715029
HUANG PEISONG	XU YING 1714 BIESTERFIELD RD ELK GROVE IL 60007-2772	12517521005
HUBERT CORNEL	8344 FORT SEDGWICK AVE LAS VEGAS NV 89131-8193	12516319009
HUDSON PAUL & LYDDA	8116 CHESTNUT HOLLOW AVE LAS VEGAS NV 89131-4802	12517520031
HUGHES TODD CHRISTIAN & TINA MAR	8528 ORLY AVE LAS VEGAS NV 89143	12517715030
HUNKINS JAMES M & NANCEE L	7632 BOKHARA ST LAS VEGAS NV 89149	12517211069
HUNT JASON T & TAMMI L	8552 HIDDEN PINES AVE LAS VEGAS NV 89143-1368	12517521009
I H 3 PROPERTY NEVADA L P	2470 ST ROSE PKWY #214 HENDERSON NV 89074	12517520032
I H 4 PROPERTY NEVADA L P	21001 N TATUM BLVD #1630-630 PHOENIX AZ 85050	12517520004
IBARRA ARMANDO & LORENA	8717 SHADY PINES DR LAS VEGAS NV 89143	12517524008
IJIDAKINRO CLEMENT B	8605 BLOWING PINES DR LAS VEGAS NV 89143-4464	12517527010
IMHOFF DENNIS & MARIE	7549 FLAT ROCK ST LAS VEGAS NV 89131-4517	12516311011
INTERIANO AVRIL M	8525 STUCKEY AVE LAS VEGAS NV 89143-1209	12517715017
ISAACS DEAN A	7416 MOUNTAIN THICKET ST LAS VEGAS NV 89131-4542	12516312028
J M T ASSOCIATES NEVADA L L C	3107 SUMMIT HILL PL CHAMPAIGN IL 61822-6190	12517520034
JACKMAN RACHELLE L	MONTGOMERY LESLEY JAMES 8217 GORSKY AVE LAS VEGAS NV 89131-4623	12516213034
JAKOBIAK CHRISTOPHER D	8416 SHADY PINES DR LAS VEGAS NV 89131-8133	12517528023

**Report of All Selected Parcels****Case Number:** MOD-61253; SUP-61067; SUP-61068; SUP-61071; SDR-61074 & TMP-61075**Printed On:** Mon: October 26, 2015

<u>Owner</u>	<u>Address</u>	<u>Parcel Number</u>
JAMES CAROLYN A	7800 WAVERING PINE DR LAS VEGAS NV 89143-1378	12517520022
JAMES STANLEY G & RHONDA J	8312 IMPATIENTS AVE LAS VEGAS NV 89131-4617	12516211038
JAVIER EDGARDO J & MARIVIC	7525 CROOKED BRANCH ST LAS VEGAS NV 89143-1134	12517715037
JEFFRES RALPH & PAMELA L	8305 GORKSY AVE LAS VEGAS NV 89131	12516210033
JENKINS DAWN	7908 QUICK PINE ST LAS VEGAS NV 89143-1354	12517516024
JENSEN GARY W & CYNTHIA L	8324 IMPATIENTS AVE LAS VEGAS NV 89131-4617	12516211035
JOHANSON JACOB & CAMILLA	8336 WILLOW BASIN CT LAS VEGAS NV 89131-4541	12516415069
JOHNSON RHONDA Y	7636 BOKHARA ST LAS VEGAS NV 89149-0450	12517211068
JOHNSON SETH	2200 FIRST STREET #2104 ALAMOGORDO NM 88310	12517711028
JOHNSON TAYLOR K	8505 BELLERY AVE LAS VEGAS NV 89143-1316	12517714034
JONES FREDERICK S & SHIRLEY Y	7705 KIOWA POINTE ST LAS VEGAS NV 89131-4615	12516210002
JONES KENNETH L & MELINDA A	7245 SILVER CHARM CT NORTH LAS VEGAS NV 89131-4129	12516311065
JONES MICHAELYN T	7541 NICKLIN ST LAS VEGAS NV 89143	12517716017
K L A D MANAGEMENT GROUP LTD	365 VELINO AVE LAS VEGAS NV 89123-7404	12516313065
KAHN BRUCE R	6604 LUBARRETT WAY MOBILE AL 36695	12516319006
KAHN ERLINDA B & RICHARD S	4602 KELLY ELLIOTT RD ARLINGTON TX 76017-1354	12517717003
KAPOLEI MEDICAL PARK VENTURE	27372 CALLE ARROYO SAN JUAN CAPISTRANO CA 92675	12517711055
KAROSA LAURA	8408 TOUGH PINE CT LAS VEGAS NV 89131-8153	12517528016
KAWAGUCHI KENNETH R	7523 LITTLE LARAMIE ST LAS VEGAS NV 89131-8196	12516319017
KEDZIORA VICTOR & MARY	8321 DAWN BREEZE AVE LAS VEGAS NV 89131	12516110021
KELLER RACHEL L & PAUL	8312 FRITZEN AVE LAS VEGAS NV 89131-4608	12516210014
KELLEY STEVEN P	160 SCENIC OUTLOOK AVE HENDERSON NV 89002	12517522004
KELLOGG GERALD	2075 VILLAGE CENTER CIR LAS VEGAS NV 89134-6251	12517521024
KELLOGG PHILLIP M & ROSELYNNE M	8225 GORSKY AVE LAS VEGAS NV 89131-4623	12516213032
KELLY DANIEL L & PATRICIA K	8316 VALLEY STREAM LAS VEGAS NV 89131-4616	12516211025
KELSO BRENDA	8213 VALLEY STREAM AVE LAS VEGAS NV 89131-4633	12516212014
KERRIGAN FAMILY TRUST	KERRIGAN JOHN B & THERESA M TRS 232 NORTHWOOD DR SAN FRANCISCO CA 94080	12517715010
KERTISS STUART A & MARCIA A	8317 GORSKY AVE LAS VEGAS NV 89131-4620	12516210036
KHA TIA	6529 ESPLANADE PLAYA DEL REY CA 90293-7521	12517527001
KHURANA KRISHAN MD INC RTMT PL 4	55 SKYRIDGE NEWPORT COAST CA 92657	12516319033
KIEHL WILLIAM A & SANDRA M	10408 ABISSO DR LAS VEGAS NV 89135-2571	12517524010
KILIAN CHRISTINE MARIE	8305 VALLEY STREAM AVE LAS VEGAS NV 89131-4616	12516211018

**Report of All Selected Parcels**

**Case Number:** MOD-61253; SUP-61067; SUP-61068; SUP-61071; SDR-61074 & TMP-61075 **Printed On:** Mon: October 26, 2015

<u>Owner</u>	<u>Address</u>	<u>Parcel Number</u>
KILLEBREW BONNIE J & ROBERT J	7625 KIOWA POINTE ST LAS VEGAS NV 89131-4619	12516211003
KJOS RONALD M	RICHTER ALEIT E 8221 IMPATIENTS AVE LAS VEGAS NV 89131-4634	12516212035
KLOBCHAR JOHN JAMES	8521 HIDDEN PINES AVE LAS VEGAS NV 89143-1369	12517520007
KNELL AARON P & MAUREEN G	5434 PORCUPINE RIM ST LAS VEGAS NV 89130-4802	12517714023
KNORR DAVID G & PATRICIA A	266 S CENTER ST ORANGE CA 92866-2075	12517525007
KOEHLER STEPHEN A & CHERRY L	155 RICHLAND CT GALLATIN TN 37066-3018	12517710012
KOHN BRIAN & SANDRA	KOHN FAMILY TRUST 8549 SHADY PINES DR LAS VEGAS NV 89143-4451	12517521031
KONG MICHAEL H	PHAN TRAN 8713 SHADY PINES DR LAS VEGAS NV 89143-4459	12517524009
KOSASIH BETTY	111 N CURTIS AVE #N ALHAMBRA CA 91801-6919	12516311066
KOSMICKI MORGAN A	7455 CROOKED BRANCH ST LAS VEGAS NV 89143-1121	12517714027
KOWALSKI CRAIG	1905 RED ROBIN CT LAS VEGAS NV 89134-6157	12516311073
KRAEMER BEVERLY A & GREGORY A	8608 SHADY PINES DR LAS VEGAS NV 89143-4453	12517525013
KUFNER RICHARD & GLORIA	8300 IMPATIENTS AVE LAS VEGAS NV 89131	12516211041
KYLE BRYAN & FADRA	916 WHITE FEATHER LAS VEGAS NV 89138-6056	12517710002
LACEY RICK A & ROSE M	8517 BELLERY AVE LAS VEGAS NV 89143-1316	12517714031
LAMBERT JOE A	7450 PEMBER ST LAS VEGAS NV 89143-1312	12517711053
LAMUNYON SHIRLEE	8644 SHADY PINES LAS VEGAS NV 89143-4453	12517525004
LARSEN CHRISTOPHER J & KRISTEN M	8448 BELLERY AVE LAS VEGAS NV 89143-1314	12517711010
LASKOWSKI GINA	BAILEY SILVIA CARMINA 8433 ORLY AVE LAS VEGAS NV 89143-6008	12517717002
LAU CHRISTINA	3055 APPERSON RIDGE DR SAN JOSE CA 95148-3682	12517716028
LAU CHRISTINA	3055 APPERSON RIDGE DR SAN JOSE CA 95148	12517714005
LAU DONALD	300 BROOME ST 2ND FLR NEW YORK ny 10002	12517716042
LAUER HEINZ J	MCCARTNEY-LAUER LISA K 8324 GORSKY AVE LAS VEGAS NV 89131-4620	12516210025
LEE ANDREW II	KELLER TIAUNKA T 8620 SHADY PINES DR LAS VEGAS NV 89143	12517525010
LEE SUN & ANGELA	3538 MAPLE LEAF DR GLENVIEW IL 60026-1159	12517519023
LEGNER PETER T	8480 GARSIDE DR LAS VEGAS NV 89143	12517713004
LEIB TIFFANIE	8569 HIDDEN PINES AVE LAS VEGAS NV 89143-1368	12517521013
LEIDY RONALD H & NANCY M	7841 WAVERING PINE DR LAS VEGAS NV 89143-1379	12517520006
LEONARD GREG & CAROL	8204 IMPATIENTS AVE LAS VEGAS NV 89131-4634	12516212042
LEONG GEORGE M & PASHA M	8221 VALLEY STREAM AVE LAS VEGAS NV 89131-4633	12516212016
LEWIS DAVID A	8217 VALLEY STREAM AVE LAS VEGAS NV 89131-4633	12516212015
LEWIS TORY A	8356 FORT SEDGWICK LAS VEGAS NV 89131-8193	12516319012

**Report of All Selected Parcels****Case Number:** MOD-61253; SUP-61067; SUP-61068; SUP-61071; SDR-61074 & TMP-61075**Printed On:** Mon: October 26, 2015

<u>Owner</u>	<u>Address</u>	<u>Parcel Number</u>
LI CHUNE	600 N NICHOLSON AVE #H MONTEREY PARK CA 91755-2341	12517715002
LIBORO MARICEL	8524 TRUDEAU AVE LAS VEGAS NV 89143-1323	12517714014
LIM HARRY E	CHEUNG KATHERINE 2299 BOOKSIN AVE SAN JOSE CA 95125-4703	12517714019
LIN SHUIMING	ZHOU YONGLE 19558 WINDROSE DR ROWLAND HEIGHTS CA 91748	12517524007
LIU SIYAN	560 E VILLA ST #321 PASADENA CA 91101	12517716002
LOPEZ OSCAR	7505 FLAT ROCK ST LAS VEGAS NV 89131-4516	12516311022
LOPEZ WALTER A	8629 HIDDEN PINES AVE LAS VEGAS NV 89143-1367	12517519026
LU EGAN	9750 MAPLE SUGAR LEAF PL LAS VEGAS NV 89148	12517717010
LU EGAN	8420 TRUDEAU AVE LAS VEGAS NV 89143	12517717008
LU SHI HUI	8981 OCEANSIDE SLOPES AVE LAS VEGAS NV 89178-7525	12517526013
LU WENZHI	WANG AMY QIU 12634 LIDDINGTON ST CERRITOS CA 90703	12517715006
LUCE PAMELA J	8541 HIDDEN PINES AVE LAS VEGAS NV 89143-1369	12517521018
LUJAN CHE	8609 HIDDEN PINES AVE LAS VEGAS NV 89143	12517519031
LUNA FELIX M	7447 NICKLIN ST LAS VEGAS NV 89143-2000	12517714018
LUNDEEN FAMILY TRUST	LUNDEN ARTHUR G III & PATRICIA T 4 WEATHERLY DR COTO DE CASA CA 92679	12517716034
LURIE DAVID L	8312 SPRUCE MEADOWS AVE LAS VEGAS NV 89131-4581	12516312010
LUZ ELAINE	HIDALGO ALEXANDER P O BOX 2851 ALAMEDA CA 94501	12517713006
MACIAS JOSE A	8224 MORADI AVE LAS VEGAS NV 89131-4513	12516311007
MACK CLARISSE M	8460 BELLERY AVE LAS VEGAS NV 89143-1314	12517711013
MACK JOSHUA J	8405 BELLERY AVE LAS VEGAS NV 89143-1313	12517711051
MAGNOLIA CIRCLE L L C SERIES 16	2595 S CIMARRON RD #204 LAS VEGAS NV 89117	12517525011
MAHALAK GREGORY E & JOSEFINA B	8216 IMPATIENTS AVE LAS VEGAS NV 89131-4634	12516212039
MAI KAI	21034 GRANITE WELLS RD WALNUT CA 91789	12517715020
MAINOR CLIFFORD L JR & LORI A	8229 FRITZEN AVE LAS VEGAS NV 89131-4635	12516213018
MAK KAI	21034 GRANITE WELLS RD WALNUT CA 91789	12517711059
MALONE WILLIAM J	7616 BOKHARA ST LAS VEGAS NV 89149-0449	12517210131
MALONEY DAVID M & MICHELE R	8409 TOUGH PINE CT LAS VEGAS NV 89131-8153	12517528020
MALONZO JOSE	8432 TRUDEAU AVE LAS VEGAS NV 89143-1307	12517717011
MANLEY STEVEN J	7620 BOKHARA ST LAS VEGAS NV 89149-0449	12517211072
MAO ZHONG MING	WANG HE YING 280 BROKEN PAR DR LAS VEGAS NV 89148	12517711002
MARIONNEAUX CARMELITA	7600 SCROLLING CREST CT LAS VEGAS NV 89149-0455	12517210135
MARK-LOYER MARSHA E	LOYER WILLIAM 8216 GORSKY AVE LAS VEGAS NV 89131	12516213029

**Report of All Selected Parcels**

**Case Number:** MOD-61253; SUP-61067; SUP-61068; SUP-61071; SDR-61074 & TMP-61075 **Printed On:** Mon: October 26, 2015

<u>Owner</u>	<u>Address</u>	<u>Parcel Numbe</u>
MARTIN JOEL A	8580 SHADY PINES DR LAS VEGAS NV 89143-4452	12517525018
MARTINEZ FAMILY REVOCABLE LIV TR	MARTINEZ LOUIS & MARIA R TRS 7513 MOUNTAIN QUAIL AVE LAS VEGAS NV 89131-3216	12517519008
MARTINEZ FAMILY TRUST	MARTINEZ MANUEL & PATRICIA TRS 6608 N VISTA ST SAN GABRIEL CA 91775	12516319044
MASON JONATHON D	7546 CROOKED BRANCH LAS VEGAS NV 89143-1134	12517716035
MATSON PAUL W & ROBYN	8312 VALLEY STREAM AVE LAS VEGAS NV 89131-4616	12516211024
MATWICK SEWARD & KIMBERLY BROOKE	7115 SADDLE BACK PEAK ST LAS VEGAS NV 89166	12517711044
MCBURNEY THERESA L TRUST	MCBURNEY THERESA L TRS 3 VISTA REAL DRROLLING HILLS EST ATEES CA 90274-4227	12517526018
MCCALL REESE	8335 FORT HALLOCK AVE LAS VEGAS NV 89131-8195	12516319026
MCCLELLAND JACOB W & ERIN L G	8429 BELLERY AVE LAS VEGAS NV 89143-1313	12517711045
MCCLEVE VANESSA	NACHTIGAL MARTIN 8417 BELLERY AVE LAS VEGAS NV 89143-1313	12517711048
MCDONALDS CORPORATION	P O BOX 182571 COLUMBUS OH 43218-2571	12517610010
MCGAUGHEY ADAM J	SPANGLER JENNIFER P O BOX 570296 LAS VEGAS NV 89157-0296	12517528010
MCGLADE RANDY E & KIMBERLY A	8332 FRITZEN AVE LAS VEGAS NV 89131-4608	12516210009
MEADOW DANIELLE B	7550 TAMANY ST LAS VEGAS NV 89143	12517716022
MEADOWS FRANK	GEORGESON BARBARA M 7621 KIOWA POINTE ST LAS VEGAS NV 89131-4619	12516211004
MÉETER JOSHUA & CANDICE	6004 CABO SAN LUCAS AVE LAS VEGAS NV 89131-3919	12517526022
MELTON RUSSELL A	8529 KELLMAN AVE LAS VEGAS NV 89143-1324	12517715001
MEYERSOHN CHARLES & CATHERINE	P O BOX 7989 OCEAN ISLE BEACH NC 28469-1989	12517711049
MICHALEK CHARLES	8608 BLOWING PINES DR LAS VEGAS NV 89143-4464	12517526027
MILLER BRITAINY & KRISTOPHER R	8517 KELLMAN AVE LAS VEGAS NV 89143-1324	12517715004
MILLER DANIELLE R	7557 NICKLIN ST LAS VEGAS NV 89143	12517716013
MILLER EDWARD	7817 FALLING PINES PL LAS VEGAS NV 89143-4455	12517527004
MITCHELL TANIA	8228 IMPATIENTS AVE LAS VEGAS NV 89131-4634	12516212036
MOLINA REYNALDO IVAN	8428 SHADY PINES DR LAS VEGAS NV 89131	12517528026
MONGOLO JACK & BERTHA REV LIV TR	MONGOLO JACK V & BERTHA A TRS 8584 BLOWING PINES DR LAS VEGAS NV 89143-4463	12517526021
MONTOYA ANNA	8328 FRITZEN AVE LAS VEGAS NV 89131-4608	12516210010
MOORE ERIK E	7509 NICKLIN ST LAS VEGAS NV 89143	12517715023
MOORE FAMILY TRUST	MOORE MICKEY LEE & A SYLVIA TRS 7616 ROOP ST LAS VEGAS NV 89131-4621	12516212020
MORACHE NOLAN T & ELISA R	8612 HIDDEN PINES AVE LAS VEGAS NV 89143-1367	12517519009
MORALES RAYMOND J	80 BROOK AVE BAYSHORE NY 11706-7424	12517510018
MORGAN JOSEPH B & CRYSTAL M	8457 BELLERY AVE LAS VEGAS NV 89143-1314	12517711038
MORHIG ALAN J	8416 BELLERY AVE LAS VEGAS NV 89143-1313	12517711025

**Report of All Selected Parcels****Case Number:** MOD-61253; SUP-61067; SUP-61068; SUP-61071; SDR-61074 & TMP-61075**Printed On:** Mon: October 26, 2015

<u>Owner</u>	<u>Address</u>	<u>Parcel Number</u>
MORRIS MATTHEW	8343 FORT HALLOCK AVE LAS VEGAS NV 89131-8195	12516319024
MOSKAL JASON C TRUST	FRASER TERRI TRS 7524 FLAT ROCK ST LAS VEGAS NV 89131-4515	12516311071
MOSS MARY P & WILLIAM E	8540 HIDDEN PINES AVE LAS VEGAS NV 89143-1369	12517521006
MOUNTAINVIEW INVESTMENTS L L C	P O BOX 2620 WRIGHTWOOD CA 92397-2620	12516319019
MTS HOMES L L C	4540 N DRIFTING SANDS RD RIMROCK AZ 86335	12516311075
MULHERN SANDRA	9608 GRAND ISLE LN LAS VEGAS NV 89144	12517525008
MUNIZ HECTOR & KAREN J	7446 PEMBER ST LAS VEGAS NV 89143-1312	12517711052
MUNOZ TATIANA	7640 BOKHARA ST LAS VEGAS NV 89149-0450	12517211067
MURAKAMI LEILANI GRACE	8424 TRUDEAU AVE LAS VEGAS NV 89143-1301	12517717009
MUSINSKI CHRISTOPHER	8339 FORT HALLOCK AVE LAS VEGAS NV 89131-8195	12516319025
MUZZY STEVEN T & SUZANNE M	8516 ORLY AVE LAS VEGAS NV 89143	12517715027
NARDONI JOANN R & AUGUST	9124 RUSTY RIFLE LAS VEGAS NV 89143-1167	12517522005
NATOUR ALEXANDER F	7856 WAVERING PINE DR LAS VEGAS NV 89143-1379	12517520035
NAVALTA DEAN O & JULIA V	8436 BELLERY AVE LAS VEGAS NV 89143-1313	12517711030
NEWTON TYLER W & CARRIE A	8304 SPRUCE MEADOWS AVE LAS VEGAS NV 89131-4581	12516312008
NIELSEN JOHN S JR & SUSAN K	7813 BRIGHT HEIGHTS ST LAS VEGAS NV 89131-4611	12516110014
NIELSON STEPHEN B & PATTY S TR	NIELSON STEPHEN B & PATTY S TRS 7605 ROOP ST LAS VEGAS NV 89131-4621	12516211023
NIEMCZYCKI THOMAS J	P O BOX 5709 MONTEREY CA 93944-0709	12517714003
NIETO KENNETH LEO	7425 ALPINE RIDGE ST LAS VEGAS NV 89131-4562	12516312032
NIXON DANNY S & KELLY L	8717 HIDDEN PINES AVE LAS VEGAS NV 89143-1366	12517519018
NORDIN WARD E	8528 SHADY PINES DR LAS VEGAS NV 89143-4451	12517520009
NORTHWEST 95 L L C	3455 CLIFF SHADOWS PKWY LAS VEGAS NV 89129-1062	12517701001
NORTHWEST 95 L L C	3455 CLIFF SHADOW PKWY #220 LAS VEGAS NV 89129-1077	12517702001
NOVAK FAMILY TRUST	NOVAK THOMAS & SUSAN TRS 7805 BRIGHT HEIGHTS ST LAS VEGAS NV 89131-4611	12516113001
OBESO JESUS M	FLORES ALICIA R 874 W 7TH ST SAN PEDRO CA 90731-3013	12517711047
OCAT CHARLES P	PESTILLOS LIZA S 1907 LAS GALLINAS AVE SAN RAFAEL CA 94903-1714	12517525002
OCHOA WILLIAM A	8329 DAWN BREEZE AVE LAS VEGAS NV 89131-4614	12516110019
OKELEY SANDRA L	4233 CINDY LN MICHIGAN CITY IN 46360	12516311004
OLGUIN STEVE & LINDA	7804 RESTLESS PINES ST LAS VEGAS NV 89131-8134	12517528008
OLIN KENNETH D & ROSE	7901 HOLLOW PINE ST LAS VEGAS NV 89143-4613	12517510015
OLIVE RENE L & SPENCER E	7533 FLAT ROCK ST LAS VEGAS NV 89131-4517	12516311015
OLSON ERIK & TANYA	8509 BELLERY AVE LAS VEGAS NV 89143-1316	12517714033

**Report of All Selected Parcels****Case Number:** MOD-61253; SUP-61067; SUP-61068; SUP-61071; SDR-61074 & TMP-61075**Printed On:** Mon: October 26, 2015

<u>Owner</u>	<u>Address</u>	<u>Parcel Number</u>
OLYMPIC NEVADA GENERAL PARTNERSH	11411 S HIGHLANDS PKWY #300 LAS VEGAS NV 89118	12517301013
ONE TOO MANY L L C	700 CARNEIGIE ST #3213 HENDERSON NV 89052	12517713023
ONE TOO MANY L L C	700 CARNEIGIE ST #3213 HENDERSON NV 89052	12517713008
ONE TOO MANY L L C	700 CARNEIGIE ST #3213 HENDERSON NV 89052	12517713009
ONE TOO MANY L L C	700 CARNEIGIE ST #3213 HENDERSON NV 89052	12517713014
ONE TOO MANY L L C	700 CARNEIGIE ST #3213 HENDERSON NV 89052	12517713024
ONE TOO MANY L L C	700 CARNEIGIE ST #3213 HENDERSON NV 89052	12517713010
ONE TOO MANY L L C	700 CARNEIGIE ST #3213 HENDERSON NV 89052	12517713015
ONE TOO MANY L L C	700 CARNEIGIE ST #3213 HENDERSON NV 89052	12517713022
ONE TOO MANY L L C	700 CARNEIGIE ST #3213 HENDERSON NV 89052	12517713012
ONE TOO MANY L L C	700 CARNEIGIE ST #3213 HENDERSON NV 89052	12517713016
ONE TOO MANY L L C	700 CARNEIGIE ST #3213 HENDERSON NV 89052	12517713011
ONE TOO MANY L L C	700 CARNEIGIE ST #3213 HENDERSON NV 89052	12517713017
ONE TOO MANY L L C	700 CARNEIGIE ST #3213 HENDERSON NV 89052	12517713021
ONE TOO MANY L L C	700 CARNEIGIE ST #3213 HENDERSON NV 89052	12517713019
ONE TOO MANY L L C	700 CARNEIGIE ST #3213 HENDERSON NV 89052	12517713007
ONE TOO MANY L L C	700 CARNEIGIE ST #3213 HENDERSON NV 89052	12517713018
ONE TOO MANY L L C	700 CARNEIGIE ST #3213 HENDERSON NV 89052	12517713020
ONE TOO MANY L L C	700 CARNEIGIE ST #3213 HENDERSON NV 89052	12517713013
O'NEILL RYAN B	1224 S RIVER RD #B215 SAINT GEORGE UT 84790	12517210448
OROZCO VIOLETA G	8232 MORADI AVE LAS VEGAS NV 89131	12516311009
OUK SARUN	8465 BELLERY AVE LAS VEGAS NV 89143-1314	12517711036
OWENS SHANE R	8701 SHADY PINES DR LAS VEGAS NV 89143-4459	12517524012
P H H MORTGAGE CORPORATION	2001 BISHOPS GATE BLVD MOUNT LAUREL NJ 08054	12517510017
P P LAND L P	P O BOX 1159 DEERFIELD IL 60015	12517611002
PACIFIC DREAMS L L C	848 N RAINBOW BLVD #1999 LAS VEGAS NV 89107-1103	12517528004
PALM ENTERPRISES L L C	15341 WINDEMERE ST SOUTHGATE MI 48195-3821	12517510016
PALMER REGINALD F & CHARLOTTE L	8473 TRUDEAU AVE LAS VEGAS NV 89143-1309	12517711003
PANNUCCI LEONARD J & VONDA M	7525 FLAT ROCK ST LAS VEGAS NV 89131-4517	12516311017
PARK JUSTIN M & ELISABETH C	8205 VALLEY STREAM AVE LAS VEGAS NV 89131	12516212012
PARKER ANDREW	8321 FORT SEDGWICK AVE LAS VEGAS NV 89131-8192	12516319048
PARKER ANTONIO M & JUDITH N	8461 BELLERY AVE LAS VEGAS NV 89143-1314	12517711037

**Report of All Selected Parcels****Case Number:** MOD-61253; SUP-61067; SUP-61068; SUP-61071; SDR-61074 & TMP-61075**Printed On:** Mon: October 26, 2015

<u>Owner</u>	<u>Address</u>	<u>Parcel Number</u>
PARKS CAROL LIVING TRUST	8333 DAWN BREEZE AVE LAS VEGAS NV 89131-4614	12516110018
PASCUA ROELIZA E & BENJAMIN	4591 TERRA PL SAN JOSE CA 95121-3218	12517716044
PASCUA ROELIZA E & BENJAMIN	4591 TERRA PL SAN JOSE CA 95121	12517716043
PATE ALEX R	8453 BELLERY AVE LAS VEGAS NV 89143-1314	12517711039
PAUER MARIUS R	6243 PORT ASTORIA CT LAS VEGAS NV 89122	12517520025
PAULE APRIL	7561 TAMANY ST LAS VEGAS NV 89143-1212	12517716026
PAWLOSKI JAMES A & ANASTASIA	8481 BELLERY AVE LAS VEGAS NV 89143-1315	12517711032
PAZ DANIEL & LISA M	8573 HIDDEN PINES AVE LAS VEGAS NV 89143-1368	12517521012
PENDLETON DANIEL J & JANET L	13880 SAGE MOUNTAIN LN JAMUL CA 91935-3008	12517521019
PENNA CRYSTAL	8480 TRUDEAU AVE LAS VEGAS NV 89143-1309	12517710018
PEPLINSKI ALLEN & REBECCA	7843 SOARING BROOK ST LAS VEGAS NV 89131	12517521029
PEREZ JOHN	7467 NICKLIN ST LAS VEGAS NV 89143-2000	12517714009
PEREZ JOSE DEJESUS	8565 BLOWING PINES DR LAS VEGAS NV 89143-4462	12517527020
PERRY CHRISTOPHER A	8854 KENZIE COVE ST LAS VEGAS NV 89131	12516311064
PERRY MATTHEW	8417 ORLY AVE LAS VEGAS NV 89143-6008	12517717006
PERSHA THOMAS	7866 W SAHARA AVE LAS VEGAS NV 89117	12516211016
PETERSEN STEPHANIE A	7701 KIOWA POINTE ST LAS VEGAS NV 89131-4615	12516210001
PETERSON MICHAEL TODD & RACHEL	8409 BELLERY AVE LAS VEGAS NV 89143-1313	12517711050
PETRIE PHYLLIS J & GREG L	8529 ORLY AVE LAS VEGAS NV 89143-6002	12517714001
PICKERING FAMILY REV LIV TR	PICKERING DAVID W & DENISE D TRS 9317 YUCCA BLOSSOM DR LAS VEGAS NV 89134-8921	12517526024
PLEMMONS GEORGE E & SHARON M	8321 VALLEY STREAM AVE LAS VEGAS NV 89131-4616	12516211014
PORNILLOSA RODOLFO L & CLINIA L	8658 SHADY PINES DR LAS VEGAS NV 89143-4454	12517525001
POWELL KERRY & LISA K	8333 VALLEY STREAM AVE LAS VEGAS NV 89131-4616	12516211011
PRATER FAMILY TRUST	PRATER DAVID D & SHERYL D TRS 8533 HIDDEN PINES AVE LAS VEGAS NV 89143-1369	12517521020
PRESS AMBER	8576 SHADY PINES DR LAS VEGAS NV 89143-4452	12517525019
PROGRESS RESIDENTIAL 2014-1 BORR	909 N SEPULVEDA BLVD #840 EL SEGUNDO CA 90245	12516319021
PROGRESS RESIDENTIAL 2014-1 BORR	909 N SEPULVEDA BLVD #840 EL SEGUNDO CA 90245	12516311014
PROGRESS RESIDENTIAL 2015-1 BORR	7702 E DOUBLETREE RANCH RD #100 SCOTTSDALE AZ 85258	12517519012
PROGRESS RESIDENTIAL 2015-1 BORR	7702 E DOUBLETREE RANCH RD #100 SCOTTSDALE AZ 85258	12517526008
PROGRESS RESIDENTIAL 2015-1 BORR	7702 E DOUBLETREE RANCH RD #100 SCOTTSDALE AZ 85258	12516415039
PROGRESS RESIDENTIAL 2015-1 BORR	7702 E DOUBLETREE RANCH RD #100 SCOTTSDALE AZ 85258	12516311069
PROGRESS RESIDENTIAL 2015-1 BORR	7702 E DOUBLETREE RANCH RD #100 SCOTTSDALE AZ 85258	12517525014

**Report of All Selected Parcels**

**Case Number:** MOD-61253; SUP-61067; SUP-61068; SUP-61071; SDR-61074 & TMP-61075 **Printed On:** Mon: October 26, 2015

<u>Owner</u>	<u>Address</u>	<u>Parcel Number</u>
PROGRESS RESIDENTIAL 2015-2 BORR	7702 E DOUBLETREE RANCH RD #100 SCOTTSDALE AZ 85258	12516211037
PROGRESS RESIDENTIAL 2015-2 BORR	7702 E DOUBLETREE RANCH RD #100 SCOTTSDALE AZ 85258	12517710015
PROVIDENT TRUST GROUP L L C	7392 S DELAINE DR OAK CREEK WI 53154	12517713003
PUTZ CARRYE D	8320 IMPATIENTS AVE LAS VEGAS NV 89131-4617	12516211036
QIAN JIAN WEN	8532 PITNEY AVE LAS VEGAS NV 89143	12517716008
R J AMERICAN HOMES 4 RENT INVEST	30601 AGOURA RD #200 AGOURA HILLS CA 91301	12516312017
RACHMEL JOAN B .	WARREN RONALD L 8324 FRITZEN AVE LAS VEGAS NV 89131-4608	12516210011
RAFFA DAVID A	LEONARD MARY MCCREA 8417 TOUGH PINE CT LAS VEGAS NV 89131-8153	12517528018
RAMBOYONG RAMON & VILMA	3329 QUESADA DR SAN JOSE CA 95148-2139	12516319031
RAMOS MICHAEL A	7479 CROOKED BRANCH ST LAS VEGAS NV 89143-1121	12517714021
RAND JASON M	8509 STUCKEY AVE LAS VEGAS NV 89143	12517715021
RATH DJUNA C	8342 FORT HALLOCK AVE NORTH LAS VEGAS NV 89131-8195	12516319039
RAVELO FAMILY LIVING TRUST	RAVELO HENRY R & NORA M TRS 5775 CANNES PL SAN JOSE CA 95138	12517714028
RAY LIVING TRUST	RAY TED W & KATHLEEN D TRS 1454 E WESTDALE RD HAYDEN ID 83835-8010	12517710011
REALIZED POTENTIAL ONE L L C	P O BOX 335141 NORTH LAS VEGAS NV 89033-5141	12516319014
RED ROCK 55 L L C	8337 W SUNSET RD #150 LAS VEGAS NV 89113	12517210132
REED STEPHANIE	8637 HIDDEN PINES AVE LAS VEGAS NV 89143-1365	12517519024
REEDER ALBERT JR	8337 FORT SEDGEWICK AVE LAS VEGAS NV 89131-8193	12516319047
REEDER JENI L	8457 TRUDEAU AVE LAS VEGAS NV 89143-1307	12517711007
REILLY KATELYNN E	PIZZELLO MARYANN 7617 KIOWA POINTE ST LAS VEGAS NV 89131-4619	12516211005
REININGER THOMAS E & BARBARA J	8236 MORADI AVE LAS VEGAS NV 89131-4513	12516311010
REMINGTON COMMERCIAL VIII L L C	5920 S RAINBOW BLVD #11 LAS VEGAS NV 89118	12517301012
REYES ALLAN A	8468 BELLERY AVE LAS VEGAS NV 89143-1314	12517711015
RIGGIO CYNTHIA	7832 WAVERING PINE DR LAS VEGAS NV 89143-1378	12517520029
RIVERA ALEJANDRA J	8588 SHADY PINES DR LAS VEGAS NV 89143-4452	12517525016
RIVERA PATRICIA D	8700 SHADY PINES DR LAS VEGAS NV 89143-4448	12517524023
ROBINS DEBRA A	7417 MOUNTAIN THICKET ST LAS VEGAS NV 89131-4542	12516312023
ROBINSON DEANNO	8512 TRUDEAU AVE LAS VEGAS NV 89143-1323	12517714011
ROBINSON REGINALD	8603 SHADY PINES DR LAS VEGAS NV 89143-4452	12517526007
ROCHA DANTE	8716 SHADY PINES DR LAS VEGAS NV 89143-4448	12517524022
RODRIGUEZ FAMILY TRUST	RODRIGUEZ JESUS & ANA TRS 1815 E HAWTHORNE ST ONTARIO CA 91764-2219	12517519034
ROPER STEPHANIE M & JAMES R	8501 BELLERY AVE LAS VEGAS NV 89143-1316	12517714035

**Report of All Selected Parcels**

Case Number: MOD-61253; SUP-61067; SUP-61068; SUP-61071; SDR-61074 & TMP-61075 Printed On: Mon: October 26, 2015

<u>Owner</u>	<u>Address</u>	<u>Parcel Number</u>
ROSENBAUM FAMILY REVOCABLE LIVIN	ROSENBAUM DANIEL & JENNETTE DOLD 8636 SHADY PINES DR LAS VEGAS NV 89143-4453	12517525006
ROSS MICHAEL R	8624 SHADY PINES DR LAS VEGAS NV 89143-4453	12517525009
ROTTERDAM PETER & JOSEPHINE	8213 IMPATIENTS AVE LAS VEGAS NV 89131	12516212033
ROTHSTEIN HADAR & REBECCA JANE R	ROTHSTEIN HADAR & REBECCA JANE T 1418 S CREST DR LOS ANGELES CA 90035	12517527014
ROWE THOMAS S & JANET L	8544 BLOWING PINES DR LAS VEGAS NV 89143-4461	12517520013
ROZOVICS DAVID P & LINDA L	8583 SHADY PINES DR LAS VEGAS NV 89143-4452	12517526010
RUBALCABA DALLAS R & RUBY	7517 FLAT ROCK ST LAS VEGAS NV 89131-4517	12516311019
RUESCH SHARON L	7459 CROOKED BRANCH ST LAS VEGAS NV 89143-1121	12517714026
RUOTI RICHARD G	P O BOX 232080 LAS VEGAS NV 89105	12516110020
S B Y 2014-1 BORROWER L L C	9406 W LAKE MEAD BLVD #101 LAS VEGAS NV 89134	12517520020
S K J L K PROPERTIES L L C	2075 VILLAGE CENTER CIR LAS VEGAS NV 89134-6251	12516211026
S K J L K PROPERTIES L L C	2075 VILLAGE CENTER CIR LAS VEGAS NV 89134-6251	12517519025
SACHS JEFFREY A & KRISTEN L	BURNETT JUDY A 8220 GORSKY AVE LAS VEGAS NV 89131-4623	12516213030
SACHS WILLARD L & LINDA	8304 GORSKY AVE LAS VEGAS NV 89131-4620	12516210030
SAMATULSKI WILLIAM C & DONNA L	8580 BLOWING PINES DR LAS VEGAS NV 89143-4463	12517526020
SAMPAIO CLAYTON K	MOSS AMANDA 8548 HIDDEN PINES AVE LAS VEGAS NV 89143-1369	12517521008
SANCHEZ GUSTAVO	8354 FORT HALLOCK AVE LAS VEGAS NV 89131-8195	12516319042
SANDCASTLE L P	61 PRINCEVILLE LAS VEGAS NV 89113-1369	12516301026
SANDOVAL EDUARDO	JACINTO ARLAE 7450 GILBERT RIDGE ST LAS VEGAS NV 89143-1203	12517714016
SANDOVAL JOSE ANGEL	7808 WAVERING PINE DR LAS VEGAS NV 89143-1378	12517520024
SANGUINETTI JOSEPH H & MARIE	18505 E COPPEROPOLIS LINDEN CA 95236-9732	12516319003
SANTOME ADAM C & EMILY A	8461 TRUDEAU AVE LAS VEGAS NV 89143-1309	12517711006
SARGENT FAMILY TRUST	SARGENT PHILIP J & REBECCA L TRS 52 SWEETWATER CT DANVILLE CA 94506-1222	12516311013
SASSO LAUREN ALYSSA	7424 MOUNTAIN THICKET ST LAS VEGAS NV 89131	12516312030
SCHMITT ROXANN	7443 CROOKED BRANCH ST LAS VEGAS NV 89143-1121	12517714030
SCHOTT TROY R & CYNTHIA A	8701 HIDDEN PINES AVE LAS VEGAS NV 89143-1366	12517519022
SCHRECKER RYAN L	7538 TAMANY ST LAS VEGAS NV 89143-1212	12517716019
SCHREIB LINDA L	8623 SHADY PINES DR LAS VEGAS NV 89143-4453	12517526002
SCHUTZ GARRETT A	8424 BELLERY AVE LAS VEGAS NV 89143-1313	12517711027
SCOTT MICHELLE	8332 SPRUCE MEADOWS AVE LAS VEGAS NV 89131-4582	12516312015
SEE HEATHER	8608 HIDDEN PINES AVE LAS VEGAS NV 89143-1367	12517519010
SENFT CHRISTINA M	7501 CROOKED BRANCH ST LAS VEGAS NV 89143	12517715031

**Report of All Selected Parcels****Case Number:** MOD-61253; SUP-61067; SUP-61068; SUP-61071; SDR-61074 & TMP-61075 **Printed On:** Mon: October 26, 2015

<u>Owner</u>	<u>Address</u>	<u>Parcel Number</u>
SERVIDO JOHN & CHERYL	8329 VALLEY STREAM AVE LAS VEGAS NV 89131-4616	12516211012
SEYMORE JUDY I	7540 FENCEROW ST LAS VEGAS NV 89131-4547	12516311077
SHAFFER RICHARD P III	7545 CROOKED BRANCH ST LAS VEGAS NV 89143	12517716045
SHAPIRO JOEL S & ANNE M	8317 FRITZEN AVE LAS VEGAS NV 89131-4608	12516210022
SHARP JEFFREY A & DONNA M	8605 HIDDEN PINES AVE LAS VEGAS NV 89143	12517519032
SHARP STEVEN M & THERESA E	8549 HIDDEN PINES AVE LAS VEGAS NV 89143-1368	12517521016
SHIA SANLEE	CHOU YU MEI AMY 21304 STOCKTON PASS RD WALNUT CA 91789-5111	12517716032
SILVERMAN MARK & JOANNE	6904 DORITA AVE #202 LAS VEGAS NV 89108-8702	12516210012
SINIBALDI ANGELA	7455 NICKLIN ST LAS VEGAS NV 89143-2000	12517714020
SIPES SHAUN T	7549 NICKLIN ST LAS VEGAS NV 89143	12517716015
SIRIPIPAT PALLOP & AMPAI	TIVORSAK ALAN L TRS 1716 COUNTRY LN ATCHISON KS 66002-1007	12517601003
SISCO MAUREEN L	8525 HIDDEN PINES AVE LAS VEGAS NV 89143-1369	12517521022
SLOSBERG FAMILY LIVING TRUST	SLOSBERG ROBERT I & SONJA P TRS 8208 IMPATIENTS AVE LAS VEGAS NV 89131-4634	12516212041
SMITH ALTON M JR	7529 NICKLIN ST LAS VEGAS NV 89143	12517715007
SMITH DOLORES V	8585 HIDDEN PINES AVE LAS VEGAS NV 89143-1368	12517519035
SMITH FAMILY TRUST	SMITH VICTOR E & JAROSLAVA M TRS 6145 WITTIG AVE LAS VEGAS NV 89131-3013	12517516025
SMITH JOHN F & FAYE E FAM TR	SMITH JOHN F & FAYE E TRS 1723 LEONARD LN LAS VEGAS NV 89108-2369	12516312012
SMOLENYAK KYLE	CANNON NICOLE 8604 HIDDEN PINES AVE LAS VEGAS NV 89143-1367	12517519011
SNELL WESLEY C & DANYEL	7429 ALPINE RIDGE ST LAS VEGAS NV 89131-4562	12516312031
SOHR DONNA	8324 VALLEY STREAM LAS VEGAS NV 89131-4616	12516211027
SOLANO JUANA	8713 HIDDEN PINES AVE LAS VEGAS NV 89143-1366	12517519019
SOLOR ENTERPRISES L L C	2215 RIMROCK RD GRAND JUNCTION CO 81507	12516415068
SONG XIUQIN	FENG JIANMING 11816 DEANA ST EL MONTE CA 91732-2390	12517716046
SOROM WILLIAM T & KATHLEEN W	7800 NESTING PINE PL LAS VEGAS NV 89143-4468	12517524021
SOTO APRIL VALENTINE	7537 FENCEROW ST LAS VEGAS NV 89131	12516313059
STANFIELD GARY K & DOLORES V	8100 DAWNING FLOWER AVE LAS VEGAS NV 89131-4671	12516312014
STANSON MICHELLE L	8448 TRUDEAU AVE LAS VEGAS NV 89143-1307	12517710010
STATE NEVADA HOUSING DIVISION	5001 KINGSLEY DR MAILDROP 1MOBBW CINCINNATI OH 45255	12517521001
STENGER WILLIAM L III	8308 SPRUCE MEADOWS AVE LAS VEGAS NV 89131-4581	12516312009
STERLING TONY D	7525 FENCEROW ST LAS VEGAS NV 89131-4548	12516313062
STEVENS BRIAN R & TAMMY L	8325 IMPATIENTS AVE LAS VEGAS NV 89131	12516211030
STEVENS JAMES A & LEANA W	2320 BROADWATER DR PAPILLION NE 68046-4574	12517715012

**Report of All Selected Parcels**

**Case Number:** MOD-61253; SUP-61067; SUP-61068; SUP-61071; SDR-61074 & TMP-61075 **Printed On:** Mon: October 26, 2015

<u>Owner</u>	<u>Address</u>	<u>Parcel Number</u>
STOEFLER SUSIE MARIE REV LIV TR	STOEFLER SUSIE MARIE TRS 7421 MOUNTAIN THICKET ST LAS VEGAS NV 89131-4542	12516312022
STOKES EVELYN F	8425 SHADY PINES DR LAS VEGAS NV 89131	12517528003
STRANDBERG MICHAEL R	2317 QUINTON AVE ROCKWELL CITY IA 50579-7456	12517715018
STRAYHORN JOZETTE R	8318 FORT HALLOCK AVE LAS VEGAS NV 89131-8194	12516319036
STURMAN DANIEL L & SARAH A	8321 FRITZEN AVE LAS VEGAS NV 89131-4608	12516210023
SUN RENJIANG	HUANG HUILI 29 GIBSON ST MEDFORD MA 02155	12517715009
SUN RENJIANG	HUANG HUILI 29 GIBSON ST MEDFORD MA 02155-4830	12517711022
SUNNY RENTALS L L C	6629 HYDE AVE LAS VEGAS NV 89107	12516210004
SYLVESTER PAUL & KATHRYN	8609 BLOWING PINES DR LAS VEGAS NV 89143-4464	12517527009
SYPERT DESTA L & RICHARD JR	8612 SHADY PINES DR LAS VEGAS NV 89143-4453	12517525012
TANG FAMILY TRUST	TANG KUN & LINDA TRS 11 CAPOBELLA IRVINE CA 92614	12517711012
TANG JIE	500 N MOORE AVE #G MONTEREY PARK CA 91754-7700	12517711014
TANG JOHNNY MAN HO	3806 ALPINE CIR MISSOURI CITY TX 77459-3840	12517716007
TANG JOHNNY MAN HO	3806 ALPINE CIR MISSOURI CITY TX 77459-3840	12517716006
TANKERSLEY BRENDAN S & SARAH B	8545 SHADY PINES DR LAS VEGAS NV 89143	12517521032
TAPESTRY TOWN CENTER H O A	6628 SKY POINTE DR #290 LAS VEGAS NV 89131-4073	12517211321
TAYLOR KELLY J	8640 SHADY PINES DR LAS VEGAS NV 89143-4453	12517525005
TESORO REFINING & MARKETING CO	P O BOX 592809 SAN ANTONIO TX 78259	12517610011
THOMAS DEBORAH S	8544 SHADY PINES DR LAS VEGAS NV 89143	12517521025
THOMAS KELLEY R & KATHERINE M	8409 SHADY PINES DR LAS VEGAS NV 89131-8133	12517528006
THOMPSON BRUCE A & SUSANN J	6086 ALPINE ESTATES CIR LAS VEGAS NV 89149-2024	12516211021
THOMPSON DARRYL E JR	8620 HIDDEN PINES AVE LAS VEGAS NV 89143-1367	12517519007
TICE BENJAMIN P & JANICE L	8421 TOUGH PINE CT LAS VEGAS NV 89131-8153	12517528017
TINNEY J E FAMILY TRUST	TINNEY VIRGINIA K TRS 8316 FRITZEN AVE LAS VEGAS NV 89131-4608	12516210013
TOLLER JAMES D III	AYALA MARINA L 8437 TRUDEAU AVE LAS VEGAS NV 89143	12517711019
TOM & JERRY L L C	7476 E 29TH AVE DENVER CO 80238	12517527012
TORRES JOSE A & ARACELI	8321 IMPATIENTS AVE LAS VEGAS NV 89131-4618	12516211031
TOWNSELL ANGELA M	8520 PITNEY AVE LAS VEGAS NV 89143-1204	12517716005
TPG PALACIO ACQUISITION LLC	TPG PALACIO ACQUISITION NO 2 LLC 30950 RANCHO VIEJO RDSAN JUAN CA PISTRANO CA 92675-1764	12517311452
TRAILWOOD HOA	4815 W RUSSELL RD #15-0 LAS VEGAS NV 89118-6241	12516319055
TRAILWOOD HOA	4815 W RUSSELL RD #15-0 LAS VEGAS NV 89118-6241	12516319052

**Report of All Selected Parcels****Case Number:** MOD-61253; SUP-61067; SUP-61068; SUP-61071; SDR-61074 & TMP-61075**Printed On:** Mon: October 26, 2015

<u>Owner</u>	<u>Address</u>	<u>Parcel Number</u>
TRAILWOOD HOA	4815 W RUSSELL RD #15-0 LAS VEGAS NV 89118-6241	12516319056
TRAILWOOD HOA	4815 W RUSSELL RD #15-0 LAS VEGAS NV 89118-6241	12516319054
TRAILWOOD HOA	4815 W RUSSELL RD #15-0 LAS VEGAS NV 89118-6241	12516319057
TRAILWOOD HOA	4815 W RUSSELL RD #15-0 LAS VEGAS NV 89118-6241	12516319058
TRAILWOOD HOA	4815 W RUSSELL RD #15-0 LAS VEGAS NV 89118-6241	12516319053
TRUE CINDY	8317 IMPATIENTS AVE LAS VEGAS NV 89131-4618	12516211032
TULE SPRINGS EIGHT L L C	8370 EAGLE ESTATES CT LAS VEGAS NV 89131	12517718005
UTT CAROLYNNE	7608 ROOP ST LAS VEGAS NV 89131-4621	12516212022
V G A C FAMILY TRUST	GOREN VITALY TRS 1444 N FULLER AVE #A LOS ANGELES CA 90046	12517521017
VALDEZ ISABELO JR & HEIDI	8604 BLOWING PINES DR LAS VEGAS NV 89143-4464	12517526026
VALDOVINOS STEPHANIE	7528 FLAT ROCK ST LAS VEGAS NV 89131-4515	12516311072
VALENCIA CHAD	10799 FLAME VINE CT LAS VEGAS NV 89135-2856	12517525022
VALENTINE ERIC J & JULIA	7519 LITTLE LARAMIE ST LAS VEGAS NV 89131-8196	12516319018
VARGAS CLEMENTE III & CATHERINE	8301 FRITZEN AVE LAS VEGAS NV 89131-4608	12516210018
VELASQUEZ JOSEPH	8437 BELLERY AVE LAS VEGAS NV 89143-1313	12517711043
VENETIKU ERION	5789 WILLOW CREEK DR CANTON MI 48187	12517714013
VEVNA JULIAN B	8413 TOUGH PINE CT LAS VEGAS NV 89131-8153	12517528019
VICTORIANO ELSIE	TORRES ALEXANDER J 8616 PITNEY AVE LAS VEGAS NV 89143	12517716004
VILLAGE CENTENNIAL SPRINGS HOA	P O BOX 12117 LAS VEGAS NV 89112	12517710031
VILLAGE CENTENNIAL SPRINGS HOA	P O BOX 12117 LAS VEGAS NV 89112	12517716053
VILLAGE CENTENNIAL SPRINGS HOA	P O BOX 12117 LAS VEGAS NV 89112	12517714037
VILLAGE CENTENNIAL SPRINGS HOA	P O BOX 12117 LAS VEGAS NV 89112	12517716047
VILLAGE CENTENNIAL SPRINGS HOA	P O BOX 12117 LAS VEGAS NV 89112	12517716052
VILLAGE CENTENNIAL SPRINGS HOA	P O BOX 12117 LAS VEGAS NV 89112	12517715044
VILLAGE CENTENNIAL SPRINGS HOA	P O BOX 12117 LAS VEGAS NV 89112	12517714043
VILLAGE CENTENNIAL SPRINGS HOA	P O BOX 12117 LAS VEGAS NV 89112	12517716051
VILLAGE CENTENNIAL SPRINGS HOA	P O BOX 12117 LAS VEGAS NV 89112	12517715043
VILLAGE CENTENNIAL SPRINGS HOA	P O BOX 12117 LAS VEGAS NV 89112	12517711065
VILLAGE CENTENNIAL SPRINGS HOA	P O BOX 12117 LAS VEGAS NV 89112	12517711062
VILLAGE CENTENNIAL SPRINGS HOA	P O BOX 12117 LAS VEGAS NV 89112	12517711064
VILLAGE CENTENNIAL SPRINGS HOA	P O BOX 12117 LAS VEGAS NV 89112	12517715041
VILLAGE CENTENNIAL SPRINGS HOA	P O BOX 12117 LAS VEGAS NV 89112	12517716048

**Report of All Selected Parcels**

Case Number: MOD-61253; SUP-61067; SUP-61068; SUP-61071; SDR-61074 & TMP-61075

Printed On: Mon: October 26, 2015

<u>Owner</u>	<u>Address</u>	<u>Parcel Number</u>
VILLAGE CENTENNIAL SPRINGS HOA	P O BOX 12117 LAS VEGAS NV 89112	12517716049
VILLAGE CENTENNIAL SPRINGS HOA	P O BOX 12117 LAS VEGAS NV 89112	12517714039
VILLAGE CENTENNIAL SPRINGS HOA	P O BOX 12117 LAS VEGAS NV 89112	12517714038
VILLAGE CENTENNIAL SPRINGS HOA	P O BOX 12117 LAS VEGAS NV 89112	12517711063
VILLAGE CENTENNIAL SPRINGS HOA	P O BOX 12117 LAS VEGAS NV 89112	12517711060
VILLAGE CENTENNIAL SPRINGS HOA	P O BOX 12117 LAS VEGAS NV 89112	12517717013
VILLAGE CENTENNIAL SPRINGS HOA	P O BOX 12117 LAS VEGAS NV 89112	12517714041
VILLAGE CENTENNIAL SPRINGS HOA	P O BOX 12117 LAS VEGAS NV 89112	12517715042
VILLAGE CENTENNIAL SPRINGS HOA	P O BOX 12117 LAS VEGAS NV 89112	12517711061
VILLAGE CENTENNIAL SPRINGS HOA	P O BOX 12117 LAS VEGAS NV 89112	12517716050
VILLAGE CENTENNIAL SPRINGS HOA	P O BOX 12117 LAS VEGAS NV 89112	12517714042
VILLAGE CENTENNIAL SPRINGS HOA	P O BOX 12117 LAS VEGAS NV 89112	12517714040
VILLAGE CENTENNIAL SPRINGS HOA	P O BOX 12117 LAS VEGAS NV 89112	12517714036
VONK MICHAEL JUNIOR	JACOBSON-VONK KAREN D 7425 FLAT ROCK ST LAS VEGAS NV 89131-4521	12516311027
VOSS MICHAEL	8581 HIDDEN PINES AVE LAS VEGAS NV 89143-1368	12517519036
VOYTICEK GREGORY	10260 S BRONCO ST LAS VEGAS NV 89141-8553	12517520017
VUE YA & RUOLI	7513 CROOKED BRANCH ST LAS VEGAS NV 89143-1134	12517715034
VUYOVICH DANIEL	8209 IMPATIENTS AVE LAS VEGAS NV 89131-4634	12516212032
W O M T VII L L C	1042 N EL CAMINO REAL STE B-343 ENCINTAS CA 92024-1322	12516319002
WADE EDWIN	ABERCROMBIE RHODORA 7541 TAMANY ST LAS VEGAS NV 89143-1212	12517716031
WADLOW FAMILY TRUST	WADLOW PATRICIA M TRS 8200 IMPATIENTS AVE LAS VEGAS NV 89131-4634	12516212043
WALKER KENDELL M	7805 FALLING PINES PL LAS VEGAS NV 89143-4455	12517527007
WALKER MELVIN L & LURIA L	3665 ASH SPRINGS WAY LAS VEGAS NV 89129-5509	12517527022
WARE ISAAC I	8453 ORLY AVE LAS VEGAS NV 89143	12517710008
WARREN MARCUS	7558 CROOKED BRANCH ST LAS VEGAS NV 89143-1134	12517716038
WATKINS DAVID F & RONDA L	7501 FLAT ROCK ST LAS VEGAS NV 89131-4516	12516311023
WEATHERS SHEILA J	8441 BELLERY AVE LAS VEGAS NV 89143-1314	12517711042
WEAVER JULIE	8629 SHADY PINES DR LAS VEGAS NV 89143-4453	12517526001
WEBB HAROLD O & CAROL J	2017-270TH ST ROCKWELL IA 50579-7621	12517715035
WEBB HAROLD WEBB O & CAROL	2017 207TH ST ROCKWELL CITY IA 50579	12517711001
WEDO SONDRAL	WEDO ANTHONY & MICHELE 3403 BADEN OAKS CT KATY TX 77494	12517521002
WEINBAUM RONNY B SEP PPTY TR	WEINBAUM RONNY B TRS 8624 HIDDEN PINES AVE LAS VEGAS NV 89143-1367	12517519006

**Report of All Selected Parcels**

**Case Number:** MOD-61253; SUP-61067; SUP-61068; SUP-61071; SDR-61074 & TMP-61075 **Printed On:** Mon: October 26, 2015

<u>Owner</u>	<u>Address</u>	<u>Parcel Number</u>
WEISSE JERRI	8561 BLOWING PINES DR LAS VEGAS NV 89143-4462	12517527021
WELLS ROBERT THOMAS & LINDA L	8305 FRITZEN AVE LAS VEGAS NV 89131-4608	12516210019
WEPRYK JOHN & MARYANNE	7505 NICKLIN ST LAS VEGAS NV 89143	12517715024
WESHO DAVID	WERNER REBECCA 8425 ORLY AVE LAS VEGAS NV 89143-6008	12517717004
WHITE HAROLD DEAN REV LIV TR	WHITE HAROLD DEAN TRS 9340 OLYMPIA FALLS AVE LAS VEGAS NV 89149	12517520030
WHITSON SUSAN D & RONALD O TRUST	WHITSON SUSAN D & RONALD O TRS PMB 251 20403 N LAKE PLEASANT RD #117 PEORIA AZ 85382-9707	12516311018
WICK BRITTINIE A & NICHOLAS E	7545 TAMANY ST LAS VEGAS NV 89143	12517716030
WILCOX SCOTT A & ELIZABETH	8520 ORLY AVE LAS VEGAS NV 89143-6002	12517715028
WILKINS TAMARA	713 W DUARTE RD #G254 ARCADIA CA 91007	12517710009
WILLIAMS NEAL H & MICHELLE E	8216 MORADI AVE LAS VEGAS NV 89131-4513	12516311005
WILLIAMS WALTON A	3 LONGVIEW DR CLIFTON PARK NY 12065-2320	12517527005
WILLIAN L L C - SHADY PINES	11768 GOLDEN MOMENTS AVE LAS VEGAS NV 89138-1568	12517526009
WILLMANN TODD A & JANET	8421 ORLY AVE LAS VEGAS NV 89143-6008	12517717005
WILSON KIM JR	8524 STUCKEY AVE LAS VEGAS NV 89143-1209	12517715014
WILSON LEONARD R & PATRICIA M	7529 VIRGINIA DALE ST LAS VEGAS NV 89131-8191	12516319008
WINCH DALE & LOIS	632 JAMES BLVD WORTHINGTON MN 56187	12517716033
WINCHELL FAMILY LIVING TRUST	WINCHELL JAMES R OR CAROLYN TRS 7725 KIOWA POINTE ST LAS VEGAS NV 89131-4615	12516210007
WISE JOLENE	8429 TRUDEAU AVE LAS VEGAS NV 89143-1307	12517711021
WOLF GERALD L & PATRICIA J	8217 IMPATIENTS AVE LAS VEGAS NV 89131-4634	12516212034
WONG MARTIN K	1817 TRUDEAN WY SAN JOSE CA 95132-1541	12517519030
WOOD VICKI L LIVING TRUST	WOOD VICKI L TRS 7536 FLAT ROCK ST LAS VEGAS NV 89131-4515	12516311074
WOODS ANISA R	8352 FORT SEDGWICK AVE LAS VEGAS NV 89131-8193	12516319011
WYKOFF NEWBERG CORP	P O BOX 62467 BOULDER CITY NV 89006-2467	12517802001
XIE SHOUMING	LI WEIFEN 7554 TAMANY ST LAS VEGAS NV 89143-1212	12517716023
YAMATAKE GARY M	BAYLESS-YAMATAKE JENNIFER L 8205 IMPATIENTS AVE LAS VEGAS NV 89131-4634	12516212031
YAN MARINA & GEORGE	P O BOX 96 WELLS NV 89835-0096	12517717012
YAN MARINA & GEORGE S	755 S HUMBOLT AVE WELLS NV 89835-8001	12517711056
YEAMAN JUDITH M	7421 FLAT ROCK ST LAS VEGAS NV 89131	12516311028
YIN GEORGE & EMILY	8577 BLOWING PINES LAS VEGAS NV 89143	12517527017
ZASTROW RONALD D	7604 ROOP ST LAS VEGAS NV 89131-4621	12516212023
ZERRIEN ROSE	8648 SHADY PINES DR LAS VEGAS NV 89143-4454	12517525003

**Report of All Selected Parcels**

**Case Number:** MOD-61253; SUP-61067; SUP-61068; SUP-61071; SDR-61074 & TMP-61075 **Printed On:** Mon: October 26, 2015

<u>Owner</u>	<u>Address</u>	<u>Parcel Number</u>
ZHANG NAJIAN	ZHANG MAY XIONGMEI 5 ROOSEVELT CIR DOWNINGTON PA 19335-5320	12517711005
ZHANG WEN BING	4967 LOMA AVE TEMPLE CITY CA 91780	12517715032
ZHANG WEN BING	4967 LOMA AVE TEMPLE CITY CA 91780	12517716010
ZHANG YUE FANG	378 FRINGE RUFF DR LAS VEGAS NV 89143	12517710017
ZHAO THOMAS & JACQUELINE	1086 KING ST SAN GABRIEL CA 91776	12516319022
ZHENG JAMES & DEANNA	807 TUKER RD #F TEHACHAPI CA 93561	12517716014
ZHENG JAMES & DEANNA GUOCHEN	807 TUCKER RD #F TEHACHAPI CA 93561	12517716003
ZHENG JAMES & DEANNA GUOCHEN	807 TUKER RD #F TEHACHAPI CA 93561	12517716029
ZHENG JAMES & DEANNA GUOCHEN	807 TUKER RD #F TEHACHAPI CA 93561	12517714007
ZHOU JERRY	143 LOBOS ST SAN FRANCISCO CA 94112	12517526012
ZOLOTAS STEVE	6238 MOCKINGBIRD ST VENTURA CA 93003-6171	12517521030
ZYBELMAN STEVEN TRUST	ZYBELMAN STEVEN TRS 7606 STEVENSON WY SAN DIEGO CA 92120-2229	12517527019