

City of Las Vegas
Office Of The City Clerk
495 South Main Street, 2nd Floor
Las Vegas, Nevada 89101

PRSR
FIRST CLASS MAIL
U.S. Postage
PAID
Las Vegas, NV
Permit No. 1630

Return Service Requested
Official Notice of Public Hearing

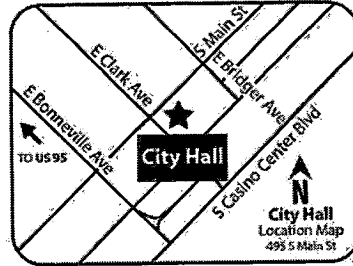

If you wish to file your protest or support on this request, check the appropriate box below and return this card in an envelope with postage to the Office Of The City Clerk at the address listed above or fax this side of this card to (702) 382-4803. If you would like to contact your Council Representative, please call (702) 229-6405.

I SUPPORT
this Request

I OPPOSE
this Request

Please use available blank space on card for your comments.

GPA-63571 & ZON-63573 [PRJ-63423]

City Council Meeting of July 20, 2016

Application Information

GPA-63571 - GENERAL PLAN AMENDMENT - PUBLIC HEARING - APPLICANT/OWNER: JOHN M. BAILEY - For possible action on a request for a General Plan Amendment FROM: DR (DESERT RURAL DENSITY RESIDENTIAL) TO: SC (SERVICE COMMERCIAL) on 1.05 acres at 5455 North Rainbow Boulevard (APN 125-35-101-005), Ward 4 (Anthony) [PRJ-63423].

ZON-63573 - REZONING RELATED TO GPA-63571 - PUBLIC HEARING - APPLICANT/OWNER: JOHN M. BAILEY - For possible action on a request for a Rezoning FROM: R-E (RESIDENCE ESTATES) TO: C-1 (LIMITED COMMERCIAL) on 1.05 acres at 5455 North Rainbow Boulevard (APN 125-35-101-005), Ward 4 (Anthony) [PRJ-63423].

Application Location

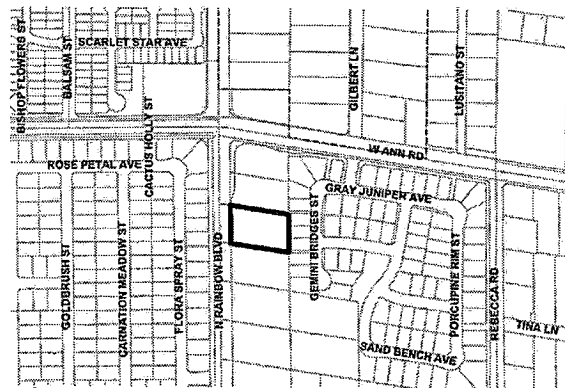

The proposed project may not pertain to the entire highlighted project site.

Public Hearing Information

Meeting: City Council
Date: *July 20, 2016*
Time: 1:00 P.M.
Location: City Council Chambers
495 South Main Street, 2nd Floor
Las Vegas, Nevada

Any and all interested persons may appear and be heard at said meeting, or may, prior thereto, file written objections thereto or approvals thereof with the City Clerk, 2nd Floor, City Hall, 495 South Main Street, Las Vegas, Nevada, 89101. For further information, please call (702) 229-6311 (TTY 7-1-1) or go to <http://www.lasvegasnevada.gov>. Note that postcards and comments received after an agenda posts will not be reflected online until after the meeting; however, the comments are made available to the members of the governing body for their consideration prior to the meeting.

Report of All Selected Parcels**Case Number:** GPA-63571, ZON-63573.**Printed On:** Mon: June 27, 2016

<u>Owner</u>	<u>Address</u>	<u>Parcel Number</u>
A H 4 R PROPERTIES L L C	30601 AGOURA RD #200 AGOURA HILLS CA 91301	12527815021
A M H 2014-1 BORROWER L L C	30601 AGOURA RD #200 AGOURA HILLS CA 91301	12534513010
A M H ROMAN TWO N V L L C	30601 AGOURA #200 AGOURA HILLS CA 91301	12535111032
A V V RESIDENTIAL L L C	2075 VILLAGE CENTER CIR LAS VEGAS NV 89134-6251	12534512043
ADIMEY DEBRA LIVING TRUST	ADIMEY DEBRA TRS 5673 GILBERT LN LAS VEGAS NV 89130	12526410011
AIKEN PETER J III & GINA M	5513 PORCUPINE RIM ST LAS VEGAS NV 89130-4803	12535111036
ALBERICI JOHN & PATRICIA FAM TR	ALBERICI JOHN S & PATRICIA A TRS 5425 CARNATION MEADOW ST LAS VEGAS NV 89130-3822	12534513034
ALBERT DIANE L	6704 FRUIT FLOWER AVE LAS VEGAS NV 89130-3848	12534514018
ALBERTY L D REVOCABLE LIV TR	ALBERTY L D TRS 145 LA MIRADA DR HENDERSON NV 89015	12535103008
ALEXANDER NAGUIB M & G Z TRUST	ALEXANDER NAGUIB M & G Z TRS 6812 ROSE PETAL AVE LAS VEGAS NV 89130-1657	12534511004
ALLEN GREGORY & EMELIA	6609 GRAY JUNIPER AVE LAS VEGAS NV 89130-4806	12535111025
APEL JOAN M & CHARLES G	6700 WHITE LAKES AVE LAS VEGAS NV 89130-1663	12534614016
AQUA BAMBOO L L C	6717 CAMBIUM PINE AVE LAS VEGAS NV 89130-1420	12526410004
ASENCIOS CHRISTIAN & KEIKO	5629 BALSAM ST LAS VEGAS NV 89130	12527819066
ASTANTIS L L C	201 E MAYFLOWER AVE NORTH LAS VEGAS NV 89030	12534513023
AYALA ERICK A	5508 ROSE THICKET ST LAS VEGAS NV 89130-1652	12534511044
BAILEY JOHN M	5455 N RAINBOW BLVD LAS VEGAS NV 89130-1608	12535101005
BAILEY RICHARD L	5416 FLORA SPRAY ST LAS VEGAS NV 89130-3843	12534514035
BAIN JAMES A & MAUREEN	6617 MANZANITA GLEN AVE LAS VEGAS NV 89130-4997	12535111015
BANK CITIBANK N A TRS	3217 S DECKER LAKE DR SALT LAKE CITY UT 84119	12534511037
BANK MORGAN J P CHASE NATL ASSN	10790 RANCHO BERNARDO RD SAN DIEGO CA 92127	12535111039
BANK U S TRUST N A TRS	16745 W BERNARDO DR #300 SAN DIEGO CA 92127	12534513040
BARCARSE DEMETRIO	10972 TOPEKA DR PORTER RANCH CA 91326-2322	12527815018
BARCLAY DONALD L JR & ANNETTE M	5412 ROSE THICKET ST LAS VEGAS NV 89130-1674	12534512035
BARNES JAMES A & MERELIN	5412 GOLDBRUSH ST LAS VEGAS NV 89130-1671	12534512002
BARTHA LIDIA	5412 CARNATION MEADOW ST LAS VEGAS NV 89130-3821	12534513028
BASILIO MARK	5512 ROSE THICKET ST LAS VEGAS NV 89130-1652	12534511045
BEATTIE TRACY	5630 AFRICAN LILLY CT LAS VEGAS NV 89130-4992	12527815037
BECERRIL XAVIER G	5421 FLORA SPRAY ST LAS VEGAS NV 89130-3844	12534514022
BELOSKUR FAMILY TRUST	BELOSKUR LEONARD & PATRICIA A TR 5413 GOLDBRUSH ST LAS VEGAS NV 89130	12534512045
BENAVIDEZ RAUL	GARCIA ELIO & SANDRA 6516 GRAY JUNIPER AVE LAS VEGAS NV 89130	12535111049
BENAVIDEZ RAUL Z & ANA V	6516 GRAY JUNIPER AVE LAS VEGAS NV 89130-4807	12535111074

Report of All Selected Parcels**Case Number:** GPA-63571, ZON-63573.**Printed On:** Mon: June 27, 2016

<u>Owner</u>	<u>Address</u>	<u>Parcel Number</u>
BERENDS JAMES & TERESA	6820 ROSE PETAL AVE LAS VEGAS NV 89130-1657	12534511006
BINAMIRA IMELDA L	5644 BALSAM ST LAS VEGAS NV 89130-1106	12527815045
BLAZZARD DEANNE	5828 JASPER RIDGE ST LAS VEGAS NV 89130	12534513022
BLINN DARREN	TRAN DUYEN 5606 BISHOP FLOWERS ST LAS VEGAS NV 89130	12527819075
BLODGETT MILAGROS	5625 BALSAM ST LAS VEGAS NV 89130	12527819065
BONNET GUILLERMO A	705 SARAJANE LANE LAS VEGAS NV 89107-1582	12535111066
BOWMAN-WALKLIN ELVIRA A	5517 REBECCA RD LAS VEGAS NV 89130-1706	12535102014
BOYAKINS GREGORY D	6700 ROSE PETAL AVE LAS VEGAS NV 89130-1686	12534513005
BRADY SCOTT M	5442 PORCUPINE ST LAS VEGAS NV 89130-4802	12535111062
BREWSTER STANLEY B	6709 FRUIT FLOWER AVE LAS VEGAS NV 89130-3849	12534514005
BROWN ANTHONY L	5511 GEMINI BRIDGES ST LAS VEGAS NV 89130-4996	12535111009
BROWN GABRIEL B & MELISSA J	5408 GOLDBRUSH ST LAS VEGAS NV 89130-1671	12534512003
BROWN JOHN T & GLORIA J	5516 CARNATION MEADOW ST LAS VEGAS NV 89130-1692	12534513020
BROWNING PHILLIP MARK & LEANN	5417 CARNATION MEADOW ST LAS VEGAS NV 89130-3822	12534513032
BUCK MICHAEL D & RAQUEL	6517 TAYLOR CREEK AVE LAS VEGAS NV 89130-4805	12535111043
BURCHARD FAMILY TRUST	BURCHARD CARL L & THANH T TRS 5500 GOLDBRUSH ST LAS VEGAS NV 89130-1655	12534511027
BURMEISTER ROBERT F & JANICE J	6513 SAND BENCH AVE LAS VEGAS NV 89130-4800	12535111057
BURNS IAN R & KIM	1110 JENNIE RIDGE TRL KISSIMMEE FL 34747-1926	12535111012
C A H 2014-1 BORROWER L L C	8665 E HARTFORD DR #200 SCOTTSDALE AZ 85255	12527815026
C A H 2014-1 BORROWER L L C	8665 E HARTFORD DR #200 SCOTTSDALE AZ 85255	12527815049
C A H 2014-1 BORROWER L L C	8665 E HARTFORD DR #200 SCOTTSDALE AZ 85255	12527815008
C A H 2015-1 BORROWER L L C	8665 E HARTFORD DR #200 SCOTTSDALE AZ 85255	12534513035
CALIGURL L L C	9721 CAMDEN HILLS AVE LAS VEGAS NV 89145-8611	12534511001
CALLEJO MARIANO A	5638 AFRICAN LILLY CT LAS VEGAS NV 89130	12527815035
CAMPBELL DEREK GRANT	DUBOIS MARIN LINDSAY 6612 W GRAY JUNIPER AVE LAS VEGAS NV 89130-4806	12535111078
CANITES MARY ANNE B	6747 SCARLET STAR AVE LAS VEGAS NV 89130-4995	12527815034
CANOVAS CYRUS A	9136 DOANE AVE LAS VEGAS NV 89143	12534513012
CARABALLO GERMAN JR & ELIZABETH	9376 THUNDER BASIN AVE LAS VEGAS NV 89149-0127	12535111051
CARABALLO GERMAN JR & ELIZABETH	9376 THUNDER BASIN AVE LAS VEGAS NV 89149-0127	12535111050
CARCELLI LOUISE A	5405 CARNATION MEADOW ST LAS VEGAS NV 89130-3822	12534514013
CARTER DARRYL GREGG	5512 CARNATION MEADOW ST LAS VEGAS NV 89130-1692	12534513021
CASTILLO ANA M	5529 FLORA SPRAY ST LAS VEGAS NV 89130-1697	12534513016

Report of All Selected Parcels**Case Number:** GPA-63571, ZON-63573.**Printed On:** Mon: June 27, 2016

<u>Owner</u>	<u>Address</u>	<u>Parcel Numbe</u>
CASTRO-PIREZ LAZARO	5634 AFRICIAN LILLY CT LAS VEGAS NV 89130-4992	12527815036
CHE POMS TRUST ETAL	6804 ROSE PETAL AVE LAS VEGAS NV 89130-1662	12534511002
CHICO SILVIA	6601 W HAMMER LN LAS VEGAS NV 89130	12535201016
CHUI CHING	CHEUNG KIT POH P O BOX 911 BRASELTON GA 30517	12527815033
COULOUTE PIERRE	5409 GOLDBRUSH ST LAS VEGAS NV 89130-1678	12534512044
CRAMER ERNEST W	CRANMER-CRAMER JANIS C 5420 GOLDBRUSH ST LAS VEGAS NV 89130	12534511025
CROWTHER TROY & CHERYL	6820 BOTTLE SAGE AVE LAS VEGAS NV 89130-1648	12534511043
CRUM DEAN R & JENNIFER	5501 REBECCA RD LAS VEGAS NV 89130-1706	12535102018
CSOENDES IRREVOCABLE PPTY TR	SZOKE LASZLO TRS 8600 SCHOLAR LN #1008 LAS VEGAS NV 89128	12534513019
CURDY ROBERT H & DANA E	6708 FRUIT FLOWER AVE LAS VEGAS NV 89130-3848	12534514017
CURTIS JOSEPH W & BETTY	6801 FRUIT FLOWER AVE LAS VEGAS NV 89130-3851	12534514008
CUSHING GARY	5673 ORANGEROOT CT LAS VEGAS NV 89130-4994	12527815019
D Z ANN RAINBOW L L C	5920 S RAINBOW #11 LAS VEGAS NV 89118	12526410007
DAVIS KENNETH L & CHERYL	5500 CARNATION MEADOW LAS VEGAS NV 89130-1692	12534513024
DAVIS TONY	6 RUE DU PALAIS CT HENDERSON NV 89011-2009	12527818006
DEPOSADA K C L SEP PPTY TR	5522 MOONLIGHT GARDEN ST LAS VEGAS NV 89130-4998	12535111029
DEVIN PAT R & ANITA R	P O BOX 78420 PHOENIX AZ 85062	12534513004
DIAMOND JACK K & GAIL FAMILY TRU	DIAMOND JACK K & GAIL TRS 5509 FLORA SPRAY ST LAS VEGAS NV 89130-1695	12534514028
DIETRICH FAMILY TRUST	DIETRICH JASON E & KIMBERLY TRS 5417 GOLDBRUSH ST LAS VEGAS NV 89130-1678	12534512046
DONOHUE PATRICK & JUDITH	5715 GILBERT LN LAS VEGAS NV 89130-1225	12526410013
DOROBANTU MARIAN & CRISTINA	4358 DEFOREST ST LAS VEGAS NV 89103	12534513030
DUKE CRAIG D & REGINA L	5521 PORCUPINE RIM ST LAS VEGAS NV 89130	12535111034
DUKE PARTNERS L L C	2320 POTOSI ST #130 LAS VEGAS NV 89146	12534514027
DUMAS ROSALIND BRANNON	5661 AFRICAN LILLY CT LAS VEGAS NV 89130-4992	12527815006
DUQUE DAVID & VALERIE	5535 GEMINI BRIDGES ST LAS VEGAS NV 89130	12535111003
DURANDETTO KENNETH TODD	BROOKS IMELDA H 5637 AFRICAN LILLY CT LAS VEGAS NV 89130-4992	12527815042
DUTSON DEREK M	5425 N RAINBOW BLVD LAS VEGAS NV 89130	12535103003
ELLEFSON GLEN P JR & MARLENA K	5424 CARNATION MEADOW ST LAS VEGAS NV 89130-3821	12534513025
ELLSWORTH BRIAN	5617 BALSAM ST LAS VEGAS NV 89130	12527819063
ELZABEN KHALED SOHAIL & SUN	5409 FLORA SPRAY ST LAS VEGAS NV 89130-3844	12534514019
ENCIZO RICHARD & LORENA	5528 GOLDBRUSH ST LAS VEGAS NV 89130	12534511034
ESTRADA PEDRO A & GRISELDA	5524 GOLDBRUSH ST LAS VEGAS NV 89130-1655	12534511033

Report of All Selected Parcels**Case Number:** GPA-63571, ZON-63573.**Printed On:** Mon: June 27, 2016

<u>Owner</u>	<u>Address</u>	<u>Parcel Number</u>
EVERHART ROBERT L & JOANNE S	5521 FLORA SPRAY ST LAS VEGAS NV 89130	12534513014
EXCELLENT INVESTMENTS L P	3635 S FORT APACHE RD #200-7 LAS VEGAS NV 89147	12535111077
FARR STEPHEN W	5435 N RAINBOW BLVD LAS VEGAS NV 89130	12535103002
FARR STEPHEN W	5435 N RAINBOW BLVD LAS VEGAS NV 89130	12535103004
FEDERAL NATIONAL MORTGAGE ASSOCI	7360 S KYRENE RD MAIL STOP T111 TEMPE AZ 85283	12527815012
FERRARA LORRAINE	5528 FLORA SPRAY ST LAS VEGAS NV 89130-1696	12534513007
FICHTENBAUM ERIC & SHARON REV TR	7294 ELESSAR AVE LAS VEGAS NV 89178	12527815017
FITZGERALD GREGORY A & KATHRYN S	5534 PORCUPINE RIM ST LAS VEGAS NV 89130-4803	12535111070
FITZPATRICK PETER W & CAROL A	5504 GOLDBRUSH ST LAS VEGAS NV 89130-1655	12534511028
FOULKES MARK S & SABINE E	6520 TAYLOR CREEK AVE LAS VEGAS NV 89130	12535111040
FRAZIER MICHAEL & TAEM	5433 FLORA SPRAY ST LAS VEGAS NV 89130	12534514025
FRIENDS MOOSE REVOCABLE LIV TR	NEAL JOE DENNIS TRS 6212 LULLABY PINE CT LAS VEGAS NV 89130-1404	12526402006
FROISTAD FREDRICK H	WALLACE-FROISTAD DANELLE L 6613 TAYLOR CREEK AVE LAS VEGAS NV 89130-4804	12535111041
GAITAN VIDAL A & IMELDA D	5438 PORCUPINE RIM ST LAS VEGAS NV 89130	12535111061
GALANGA CEASAR	6620 GRAY JUNIPER AVE LAS VEGAS NV 89130-4806	12535111001
GAMBOA RUEL L & LUCIEN A	7147 32ND AVE S SEATTLE WA 98118-3503	12534513009
GARAVITO JOSE	3695 N LAS VEGAS BLVD LAS VEGAS NV 89115-0511	12535103009
GARDNER TAUREAN & DIONNDRA S	5668 AFRICAN LILLY CT LAS VEGAS NV 89130	12527815013
GASTELUM OLVIDO A	5532 FLORA SPRAY ST LAS VEGAS NV 89130-1696	12534513006
GIARMO ANNA FAMILY TRUST	GIARMO ANNA TRS 6717 FRUIT FLOWER AVE LAS VEGAS NV 89130-3849	12534514007
GIARMO CHERYL L	5611 LUSITANO ST LAS VEGAS NV 89130-1262	12526411016
GLORIOSO CLAUDIO G & MARIA L	GLORIOSO MARIA C & CLARIZA 6735 SCARLET STAR AVE LAS VEGAS NV 89130-4995	12527818008
GODOY RICARDO C & CHRISTINA M	6620 MANZANITA GLEN AVE LAS VEGAS NV 89130-4997	12535111021
GOLD L T R E L L C #6	9159 W FLAMINGO RD #102 LAS VEGAS NV 89147-6454	12535101007
GONZALES JEANINE J	5625 AFRICAN LILLY CT LAS VEGAS NV 89130-4991	12527815039
GRAY TARA DONENE	5640 BALSAM ST LAS VEGAS NV 89130-1106	12527815046
GUILIANO LORI M	6520 GRAY JUNIPER AVE LAS VEGAS NV 89130-4807	12535111075
GUTIERREZ DANIEL & MONICA	5613 BALSAM ST LAS VEGAS NV 89130	12527819062
GUTIERREZ MARIA ESTHER	6808 FRUIT FLOWER AVE LAS VEGAS NV 89130-1664	12534512006
HAGEN CHARLES & DEBRA	6808 WHITE LAKES AVE LAS VEGAS NV 89130-1659	12534614008
HALL JOHN R & GLÉNDÁ S	DILLER RICHARD C & JHONNA G 5398 N RAINBOW LAS VEGAS NV 89130-1607	12535201018
HALL LEROY E & BRANDY T	5508 FLORA SPRAY ST LAS VEGAS NV 89130-1694	12534514029

Report of All Selected Parcels**Case Number:** GPA-63571, ZON-63573.**Printed On:** Mon: June 27, 2016

<u>Owner</u>	<u>Address</u>	<u>Parcel Number</u>
HAMILTON DEIDRA	HUFNAGLE AARON 6719 SCARLET STAR AVE LAS VEGAS NV 89130-4995	12527818004
HARMON CATHIE	5509 CARNATION MEADOW ST LAS VEGAS NV 89130-1693	12534513037
HARRIS ELBERT	6701 WHITE LAKES AVE LAS VEGAS NV 89130-1663	12534614017
HARRISON MERCY	6715 SCARLET STAR AVE LAS VEGAS NV 89130	12527818003
HARTOUNIAN INVESTMENTS L L C	416 AUDRAINE AVE GLENDALE CA 91202	12527815016
HE XIN PING	6513 TAYLOR CREEK AVE LAS VEGAS NV 89130-4805	12535111044
HECKARD DAVID L & D'ANDREA P	5510 PORCUPINE RIM ST LAS VEGAS NV 89130-4803	12535111064
HEISTER JAY B	5533 REBECCA RD LAS VEGAS NV 89130-1706	12535102011
HENDRICKSON ALLEN L & ARLENE L	HENDRICKSON ALLEN STEVE 5509 GOLDBRUSH ST LAS VEGAS NV 89130-1656	12534511040
HENRIQUEZ JULIO C & VILMA	6821 BOTTLE SAGE AVE LAS VEGAS NV 89130-1649	12534511022
HICKS BRIAN C & BRENDA A	6550 W HAMMER LN LAS VEGAS NV 89130-1707	12535103010
HICKS JANICE SUSAN & KEVIN	6540 W HAMMER LN LAS VEGAS NV 89130-1707	12535103011
HIGHLAND GROVE HOMEOWNERS ASSN	630 TRACE CENTER DR #100 LAS VEGAS NV 89119	12527815052
HIGHLAND GROVE HOMEOWNERS ASSN	630 TRACE CENTER DR #100 LAS VEGAS NV 89119	12527815053
HIGHLAND GROVE HOMEOWNERS ASSN	630 TRACE CENTER DR #100 LAS VEGAS NV 89119	12527815054
HIGHLAND GROVE HOMEOWNERS ASSN	630 TRACE CENTER DR #100 LAS VEGAS NV 89119	12527815057
HIGHLAND GROVE HOMEOWNERS ASSN	630 TRACE CENTER DR #100 LAS VEGAS NV 89119	12527815058
HIGHLAND GROVE HOMEOWNERS ASSN	630 TRACE CENTER DR #100 LAS VEGAS NV 89119	12527815056
HIGHLAND GROVE HOMEOWNERS ASSN	630 TRACE CENTER DR #100 LAS VEGAS NV 89119	12527815055
HILL CHRISTOPHER & CHANOTIP	CHINASAI CHALIE 6504 GRAY JUNIPER AVE LAS VEGAS NV 89130-4807	12535111071
HIRO KAZU TRUST ETAL	YAMAMOTO YUMI L TRS 6621 GRAY JUNIPER AVE LAS VEGAS NV 89130-4806	12535111022
HOOPER DAN	9048 LITTLE ARROW CT LAS VEGAS NV 89143	12534513033
HOPKINS DANIEL B & DIANA J	1620 SONLIGHT CT LAS VEGAS NV 89117-1583	12534511003
HOWELL GARY D & GAYE LEINN	5627 LUSITANO ST LAS VEGAS NV 89130-1262	12526411018
HUDSON WILLIAM & C FAM TR	HUDSON CHARLAINE TRS 5619 LUSITANO ST LAS VEGAS NV 89130-1262	12526411017
INCHAUSTI DANIEL C	5530 MOONLIGHT GARDEN ST LAS VEGAS NV 89130-4998	12535111031
J & J REVOCABLE TRUST	FARR STEPHEN W TRS 5435 N RAINBOW BLVD LAS VEGAS NV 89130	12535103001
JENSEN RONALD L & KITTY L	5631 GILBERT LN LAS VEGAS NV 89130-1225	12526410009
JENSON FREDRICK M	1013 COBBLESTONE COVE RD NORTH LAS VEGAS NV 89081-3071	12534513018
JOHNSON DEREK	6708 WHITE LALES AVE LAS VEGAS NV 89130	12534614014
JOHNSON FORREST D REV LIV TR	JOHNSON FORREST DALE TRS 6252 FISHER AVE LAS VEGAS NV 89130-2144	12534511042
JOHNSON JOANN	5416 CARNATION MEADOW ST LAS VEGAS NV 89130-3821	12534513027

Report of All Selected Parcels**Case Number:** GPA-63571, ZON-63573,**Printed On:** Mon: June 27, 2016

<u>Owner</u>	<u>Address</u>	<u>Parcel Numbe</u>
JURKOFKY ROBERT L & ELAINE S	6609 SAND BENCH AVE LAS VEGAS NV 89130-4801	12535111054
K V PROPERTIES TWO L L C	27372 CALLE ARROYO SAN JUAN CAPISTRANO CA 92675	12534511031
KAL LIVING TRUST	LETUS KEITH TRS 6604 W MANZANITA GLEN AVE LAS VEGAS NV 89130-4997	12535111017
KANIPE JOAN	O'BRIEN CYNTHIA 5809 GLENMERE AVE LAS VEGAS NV 89131	12534511007
KARYDAS KONSTANTINOS & SHAWN	5641 AFRICAN LILLY CT LAS VEGAS NV 89130	12527815043
KATRI LENORE J	4145 S SILVERADO DR IDAHO FALLS ID 83404-7788	12527818007
KATTERHEINRICH ANITA J	1599A 39TH ST LOS ALAMOS NM 87544-2899	12526402014
KELLY RICHARD & RACHEL E	5501 FLORA SPRAY ST LAS VEGAS NV 89130-1695	12534514026
KEMPF LAURENCE M & MAUREEN	6613 MANZANITA GLEN AVE LAS VEGAS NV 89130-4997	12535111016
KERR TAMMY L	5522 PORCUPINE RIM ST LAS VEGAS NV 89130-4803	12535111067
KLINKNER KELLY & DIANNA	5604 LUSITANO ST LAS VEGAS NV 89130-1262	12526411014
KNELL AARON & MAUREEN	5434 PORCUPINE RIM ST LAS VEGAS NV 89130-4802	12535111060
KNELL TERRY & WAYNE	6517 SAND BENCH AVE LAS VEGAS NV 89130	12535111056
KNOBLE LAQUAL N & JARED M	5517 PORCUPINE RIM ST LAS VEGAS NV 89130-4803	12535111035
KNOX FAMILY LIVING TRUST ETAL	KNOX TYRONE TRS P O BOX 570954 LAS VEGAS NV 89157-0954	12535111042
KRAFT ERIC B & DAWN M	5514 PORCUPINE RIM ST LAS VEGAS NV 89130	12535111065
KWON GENE & ZEENATROOHI	5673 DANCING ORCHID CT LAS VEGAS NV 89130-4993	12527815029
LAAM GLORIA W LIVING TRUST	508 GOLDBRUSH ST LAS VEGAS NV 89130	12534511029
LAMBERT CARL E & BRONIE S	5428 FLORA SPRAY ST LAS VEGAS NV 89130-3839	12534514032
LARSON STEVEN R & SHARON	6712 ROSE PETAL LAS VEGAS NV 89130-1687	12534513003
LERNER LISA BETH HESTRIN 1993 TR	LERNER LISA BETH HESTRIN TRS 17325 PALORA ST ENCINO CA 91316	12527815014
LEYVA JOSE LUIS	ARCHIBEQUE CIARA 5529 CARNATION MEADOW ST LAS VEGAS NV 89130	12534513042
LINNEAR BEVERLY ART	6704 WHITE LAKES AVE LAS VEGAS NV 89130-1663	12534614015
LOVEGROVE LYNNE A & DOUGLAS R	HARDY GAIL E 6500 W HAMMER LN LAS VEGAS NV 89130-1707	12535103013
LUCIANI ROBERT & HEIKE	6701 FRUIT FLOWER AVE LAS VEGAS NV 89130-3849	12534514003
LUKER CHELSEA E	5524 FLORA SPRAY ST LAS VEGAS NV 89130-1696	12534513008
LUKEY'S FAMILY TRUST	CORRAL LUCRETIA G TRS 5760 GILBERT LN LAS VEGAS NV 89130-1228	12526402004
LUNSFORD THOMAS W	5420 FLORA SPRAY ST LAS VEGAS NV 89130-3843	12534514034
LUONG TAM TRONG	6816 ROSE PETAL AVE LAS VEGAS NV 89130-1657	12534511005
LYNCH CARL R & ROSE MARIE	5513 CARNATION MEADOW ST LAS VEGAS NV 89130-1693	12534513038
MAANAO PETER J JR	5507 GEMINI BRIDGES ST LAS VEGAS NV 89130	12535111010
MALLINGER ALICE C	5621 AFRICAN LILLY CT LAS VEGAS NV 89130	12527815038

Report of All Selected Parcels**Case Number:** GPA-63571, ZON-63573.**Printed On:** Mon: June 27, 2016

<u>Owner</u>	<u>Address</u>	<u>Parcel Number</u>
MARCOM NORA H	5524 ROSE THICKET ST LAS VEGAS NV 89130-1652	12534511048
MARTINEZ MICHAEL ANTHONY	5605 BALSAM ST LAS VEGAS NV 89130	12527819060
MARTINEZ RICHARD ANTHONY JR	5416 ROSE THICKET ST LAS VEGAS NV 89130-1674	12534512034
MATA ROBINSON R	6608 MANZANITA GLEN AVE LAS VEGAS NV 89130-4997	12535111018
MCALPIN MICHAEL L	MCALPIN EDWARD D & THELMA F 5611 GILBERT LN LAS VEGAS NV 89130-1225	12526410008
MCCAMISH KELLY	5635 LUSITANO ST LAS VEGAS NV 89130-1262	12526411019
MCCARTHY MICHAEL E & SUSAN L	5401 CARNATION MEADOW ST LAS VEGAS NV 89130-3822	12534514012
MCCLURE KENNETH R & JACKIE A REV	MCCLURE KENNETH R & JACKIE A TRS 5504 FLORA SPRAY ST LAS VEGAS NV 89130-1694	12534514030
MCGOWAN SHANNON	5420 CARNATION MEADOW ST LAS VEGAS NV 89130-3821	12534513026
MCKNIGHT CECILIA	6713 FRUIT FLOWER AVE LAS VEGAS NV 89130-3849	12534514006
MCMANUS MATAGI S & MARY A	5412 FLORA SPRAY ST LAS VEGAS NV 89130	12534514036
MCMCGARRY RICHARD L	HOFFMAN-KYLE LYNN 5612 LUSITANO ST LAS VEGAS NV 89130-1262	12526411013
MECHAM YVONNE M	6800 FRUIT FLOWER AVE LAS VEGAS NV 89130-3850	12534514011
MELTON STEPHANIE	6812 BOTTLE SAGE AVE LAS VEGAS NV 89130-1648	12534511041
MENDOZA JOSE L	6509 SAND BEACH AVE LAS VEGAS NV 89130	12535111058
MERCURIO CURTIS G	SWANSON STEPHANIE L 5519 GEMINI BRIDGES ST LAS VEGAS NV 89130-4996	12535111007
MONAGHAN FARMS INC	P O BOX 1159 DEERFIELD IL 60015	12527803007
MOONEY LYNN M	5517 FLORA SPRAY ST LAS VEGAS NV 89130-1697	12534513013
MOORE RHIANNON & JASON	5610 BISHOP FLOWERS ST LAS VEGAS NV 89130	12527819074
MORAWSKI FAMILY TRUST	MORAWSKI CHRISTOPHER & I TRS 9408 BRILLIANT ORE DR LAS VEGAS NV 89143	12534513015
MORGAN GUY A & JOY L	3450 N HUALAPAI #1004 LAS VEGAS NV 89129	12535111014
MROSEK ROBERT	5517 GOLDBRUSH ST LAS VEGAS NV 89130	12534511038
MYERS BERNARD D & SU CHOL	MYERS STEVE & NATHALIE 5417 FLORA SPRAY ST LAS VEGAS NV 89130-3844	12534514021
NATH JEFFREY ALAN & MARISA TELEN	5512 GOLDBRUSH ST LAS VEGAS NV 89130-1655	12534511030
NEAFSEY BRIAN & LOIS	5620 LUSITANO ST LAS VEGAS NV 89130-1262	12526411012
NETSKI TRUST	NETSKI JUDITH ANNE TRS 5400 FLORA SPRAY LAS VEGAS NV 89130-3838	12534514002
NETZ RAYMOND L	6551 HAMMER LN LAS VEGAS NV 89130-1702	12535215001
NGUYEN LINA N	5530 PORCUPINE RIM ST LAS VEGAS NV 89130-4803	12535111069
NOVOTNY FAMILY LIVING REV TR	6660 W ANN RD LAS VEGAS NV 89130-1214	12526402012
O'CONNOR JAMES C & SHARON E	5424 GOLDBRUSH ST LAS VEGAS NV 89130-1671	12534511026
OLARTE JAVIER	5664 ORANGEROOT CT LAS VEGAS NV 89130-4994	12527815024
OLZASKI DENISE R	5512 FLORA SPRAY ST LAS VEGAS NV 89130-1696	12534513039

Report of All Selected Parcels

Case Number: GPA-63571, ZON-63573.

Printed On: Mon: June 27, 2016

<u>Owner</u>	<u>Address</u>	<u>Parcel Number</u>
OLZASKI-THOMAS DENISE	5512 FLORA SPRAY ST LAS VEGAS NV 89130-1696	12534513011
O'MALLEY TONI J & BRIAN P	6512 GRAY JUNIPER AVE LAS VEGAS NV 89130-4807	12535111073
ORTEGA CARLOS	5525 GOLDBRUSH ST LAS VEGAS NV 89130-1656	12534511036
OSOS JAMES ERICH & DEBORAH J	8289 JO MARCY DR LAS VEGAS NV 89131-4625	12534614009
P & J KLIMEK TRUST	KLIMEK PHILLIP & JODIE LYNN TRS 6705 FRUIT FLOWER AVE LAS VEGAS NV 89130-3849	12534514004
PACIFIC COAST DEVELOPEMENT	6293 DEAN MARTIN DR #G LAS VEGAS NV 89118-3845	12526411036
PACIFIC COAST DEVELOPEMENT	6293 DEAN MARTIN DR #G LAS VEGAS NV 89118-3845	12526411037
PAGE MICHAEL S	5525 PORCUPINE RIM ST LAS VEGAS NV 89130-4803	12535111033
PAINE SHAWN R	1 W SUPERIOR #1209 CHICAGO IL 60654	12527815041
PAYGUN FAMILY TRUST	DODDS WALTER TADD & DEBI E TRS 5640 GILBERT LN LAS VEGAS NV 89130-1228	12526402013
PAYNE ANTHONY	BOYD-PAYNE LAKESHA 6817 BOTTLE SAGE AVE LAS VEGAS NV 89130	12534511023
PEARSON FAMILY TRUST	PEARSON KEITH H & MARIA T TRS 5710 N RAINBOW BLVD LAS VEGAS NV 89130-1247	12526410003
PEREZ FERNANDO	5669 DANCING ORCHID CT LAS VEGAS NV 89130	12527815028
PHAM ANH N	6612 MANZANITA GLEN AVE LAS VEGAS NV 89130-4997	12535111019
PICKENS KAREN	5609 BALSAM ST LAS VEGAS NV 89130	12527819061
PITCHER ROBERT W & MARIA L	5520 ROSE THICKET ST LAS VEGAS NV 89130	12534511047
POLIZZI BLANCA A	5677 DANCING ORCHID CT LAS VEGAS NV 89130	12527815030
PROGRESS RESIDENTIAL 2014-1 BORR	P O BOX 4090 SCOTTSDALE AZ 85261	12534513036
PROGRESS RESIDENTIAL 2014-1 BORR	P O BOX 4090 SCOTTSDALE AZ 85261	12527815022
PROGRESS RESIDENTIAL 2014-1 BORR	P O BOX 4090 SCOTTSDALE AZ 85261	12534512042
PRUSS JONATHAN	5618 BISHOP FLOWERS ST LAS VEGAS NV 89130	12527819072
RABIN HARRY & SYLVIA REV TR ETAL	RABIN DAVID & JEANNIE TRS 2869 LOS CEDROS CIR CAMARILLO CA 93012	12535111026
RAINBOW ANN 1 L L C	719 OAKBRIDGE CT NORTH LAS VEGAS NV 89032	12535101002
RAINBOW ANN 1 L L C	719 OAKBRIDGE CT NORTH LAS VEGAS NV 89032	12535101001
RAINES JAMES W & AUDREY E	6616 MANZANITA GLEN AVE LAS VEGAS NV 89130-4997	12535111020
RAMOS JOSE T & CLAUDIA	5523 GEMINI BRIDGES ST LAS VEGAS NV 89130-4996	12535111006
RATNER DALE & MARTA	6813 BOTTLE SAGE AVE LAS VEGAS NV 89130-1649	12534511024
REED THEODORE J & MARCIA A	6504 SAND BENCH AVE LAS VEGAS NV 89130-4800	12535111047
RENOUDE VICTORIA R	CANTRELL TRACY R 5404 GOLDBRUSH ST LAS VEGAS NV 89130-1671	12534512004
REOCH DEBRA J	5640 N RAINBOW BLVD LAS VEGAS NV 89130-1236	12526410006
RIDEOUT DIANE E	5416 GOLDBRUSH ST LAS VEGAS NV 89130-1671	12534512001
ROADVILLE JOHN M & PATTI JO	6809 FRUIT FLOWER AVE LAS VEGAS NV 89130-1665	12534512007

Report of All Selected Parcels

Case Number: GPA-63571, ZON-63573.

Printed On: Mon: June 27, 2016

<u>Owner</u>	<u>Address</u>	<u>Parcel Numbe</u>
ROBINSON LEE & KATHY	5525 CARNATION MEADOW ST LAS VEGAS NV 89130	12534513041
ROSALES GLORIA	5665 AFRICAN LILY CT LAS VEGAS NV 89130-4992	12527815007
ROSSETTI DENICE M	5610 GILBERT LN LAS VEGAS NV 89130-1228	12526402011
S F R INVESTMENTS POOL I L L C	5030 PARADISE RD #B-214 LAS VEGAS NV 89119	12535111004
SAKERS YU CHAI	2115 8TH ST DR WATSONTOWN PA 17777-8006	12534512005
SALAS DEVAN DAWN & ARISTOTLE D	5620 BALSAM ST LAS VEGAS NV 89130-1106	12527815051
SALDANA VERONICA	5645 AFRICAN LILLY CT LAS VEGAS NV 89130-4992	12527815044
SALERNO RICHARD J OR PAULA	1131 BROWN HILL CT HENDERSON NV 89011	12535102001
SALLOVITZ AZUL	5526 PORCUPINE RIM ST LAS VEGAS NV 89130-4803	12535111068
SAMPSON BARBARA C	5424 FLORA SPRAY ST LAS VEGAS NV 89130-3839	12534514033
SAMSAMSHARIAT SPRING	1175 E KENNEDY BLVD #N631 TAMPA FL 33602	12535111048
SANDERELLA TRUST ETAL	LOVE SANDRA LEE TRS 6613 SAND BEACH AVE LAS VEGAS NV 89130	12535111053
SANDY NANCIE LEAH	6711 SCARLET STAR AVE LAS VEGAS NV 89130-4995	12527818002
SATICOY BAY L L C	P O BOX 36208 LAS VEGAS NV 89133	12535111030
SCHENCK STEVEN G & JOANNE K	6804 FRUIT FLOWER AVE LAS VEGAS NV 89130-3850	12534514010
SCHLEGEL ROBERT E	5695 N GILBERT LN LAS VEGAS NV 89130-1225	12526410012
SCHOUTEN 1983 TRUST	SCHOUTEN ALBERT & MARILYN L TRS 8987 KING JOHN CT LAS VEGAS NV 89149-3221	12535103014
SCHOUTEN 1983 TRUST	SCHOUTEN ALBERT & MARILYN L TRS 8987 KING JOHN CT LAS VEGAS NV 89149-3221	12535103016
SCHUMAN FAMILY REVOCABLE LIV TR	SCHUMAN BRUCE J & SHARON J TRS 5404 N CARNATION MEADOW ST LAS VEGAS NV 89130-3821	12534514014
SCOGGINS MICHELLE JUNE	KEMP KANNON KAY 5632 BALSAM ST LAS VEGAS NV 89130-1106	12527815048
SEABORG WENDELL D & TERRY	5528 ROSE THICKET ST LAS VEGAS NV 89130-1652	12534511049
SECRETARY VETERANS AFFAIRS	810 VERMONT AVE N W WASHINGTON DC 20420	12535111072
SEVIGNY ELIZABETH R	6716 WHITE LAKES AVE LAS VEGAS NV 89130-1663	12534614012
SHUGARMAN ALAN	3635 S FORT APACHE RD #200-7 LAS VEGAS NV 89147	12535111027
SIMPSON REX JAY & COLLEEN MARIE	5408 ROSE THICKET ST LAS VEGAS NV 89130-1674	12534512036
SIMS CANDICE & RICHARD	5527 GEMINI BRIDGES ST LAS VEGAS NV 89130	12535111005
SKARL DALE & SUSIE	1219 STRONG DR LAS VEGAS NV 89102	12534514031
SMITH GORDON RENE & LINDA	5515 GEMINI BRIDGES ST LAS VEGAS NV 89130-4996	12535111008
SMITH MICHAEL H & CHERALYN Y	6613 GRAY JUNIPER AVE LAS VEGAS NV 89130-4806	12535111024
SMITH RICHARD F & JULIA A	5404 ROSE THICKET ST LAS VEGAS NV 89130-1674	12534512037
SNODDY JOHN H & SHIRLEY A	5528 CARNATION MEADOW ST LAS VEGAS NV 89130-1692	12534513017

Report of All Selected Parcels**Case Number:** GPA-63571, ZON-63573.**Printed On:** Mon: June 27, 2016

<u>Owner</u>	<u>Address</u>	<u>Parcel Number</u>
SPARKS CASEY JONAS & SACHA ELENA	5425 FLORA SPRAY ST LAS VEGAS NV 89130-3840	12534514023
SRODES L L C	5913 CASTLEBERRY PEAK AVE LAS VEGAS NV 89131-2043	12527803005
STALEY TROY & AMANDA	5621 BALSAM ST LAS VEGAS NV 89130	12527819064
STANIULIS ANTHONY JR	5506 PORCUPINE RIM ST LAS VEGAS NV 89130-4803	12535111063
STONE LINA F	6504 TAYLOR CREEK AVE LAS VEGAS NV 89130-4805	12535111037
STONE ZULMA L	5508 GEMINI BRIDGES ST LAS VEGAS NV 89130-4996	12535111013
SUNSTRUM JOSEPH & GEORGIA	6720 ROSE PETAL AVE LAS VEGAS NV 89130-1687	12534513001
SUTHERLAND RODNEY D	STIMPFL MARAGARET S 6624 GRAY JUNIPER AVE LAS VEGAS NV 89130-4806	12535111002
SWEET TRUST	SWEET DAVID M TRS 5668 ORANGEROOT CT LAS VEGAS NV 89130	12527815023
TABBERNER RAYMOND S JR & RHONDA	6505 SAND BENCH AVE LAS VEGAS NV 89130-4800	12535111059
TAFF JACQUELINE J SEP PPTY TR	TAFF JACQUELINE J TRS P O BOX 19549 SACRAMENTO CA 95819	12526410010
TANDY NOLAN W & LOIS J	5516 ROSE THICKET ST LAS VEGAS NV 89130-1652	12534511046
TAPCOM INVESTMENTS L L C	3017 BEACH VIEW CT LAS VEGAS NV 89117	12527815040
TARIN RODOLFO JR & MARTHA P	5429 FLORA SPRAY ST LAS VEGAS NV 89130-3840	12534514024
TAYLOR BRIAN & APRIL	6720 WHITE LAKES AVE LAS VEGAS NV 89130	12534614011
TAYLOR LISA A & ADAM	5664 N RAINBOW LAS VEGAS NV 89130-1236	12526410005
THARP DEBRA	6712 WHITE LAKES AVE LAS VEGAS NV 89130-1663	12534614013
THEAN KIMHEAN	6716 ROSE PETAL AVE LAS VEGAS NV 89130	12534513002
THOROUGHGOOD RICKY V & COLLEEN	5400 CARNATION MEADOW ST LAS VEGAS NV 89130-3821	12534514015
TIMBER CREEK HOMEOWNERS' ASSN	3651 LINDELL RD #H LAS VEGAS NV 89103-1200	12535111083
TIMBER CREEK HOMEOWNERS' ASSN	3651 LINDELL RD #H LAS VEGAS NV 89103-1200	12535111080
TIMBER CREEK HOMEOWNERS' ASSN	3651 LINDELL RD #H LAS VEGAS NV 89103-1200	12535111079
TIMBER CREEK HOMEOWNERS' ASSN	3651 LINDELL RD #H LAS VEGAS NV 89103-1200	12535111085
TIMBER CREEK HOMEOWNERS' ASSN	3651 LINDELL RD #H LAS VEGAS NV 89103-1200	12535111086
TIMBER CREEK HOMEOWNERS' ASSN	3651 LINDELL RD #H LAS VEGAS NV 89103-1200	12535111082
TIMBER CREEK HOMEOWNERS' ASSN	3651 LINDELL RD #H LAS VEGAS NV 89103-1200	12535111081
TIMBER CREEK HOMEOWNERS' ASSN	3651 LINDELL RD #H LAS VEGAS NV 89103-1200	12535111084
TIMBER CREEK HOMEOWNERS' ASSN	3651 LINDELL RD #H LAS VEGAS NV 89103-1200	12535111087
TORRALBA EUGENE Y & HELEN E	9275 JUNE BERRY LN NORTH HILLS CA 91343-7821	12535111038
TRIPP LAUREN N	5636 BALSAM ST LAS VEGAS NV 89130-1106	12527815047
TULE VICTOR	5520 GOLDBRUSH ST LAS VEGAS NV 89130-1655	12534511032
UDARBE JOEL U & ANTONIO T	UDARBE PATROCINIA U 6604 GRAY JUNIPER AVE LAS VEGAS NV 89130-4806	12535111076

Report of All Selected Parcels**Case Number:** GPA-63571, ZON-63573.**Printed On:** Mon: June 27, 2016

<u>Owner</u>	<u>Address</u>	<u>Parcel Numbe</u>
VACKICEV ELIO	BUERS-VACKICEV HILDA 5413 FLORA SPRAY ST LAS VEGAS NV 89130-3844	12534514020
VALENZUELA DANIEL	5660 BALSAM ST LAS VEGAS NV 89130	12527815005
VEGA JAIME R	6723 SCARLET STAR AVE LAS VEGAS NV 89130-4995	12527818005
VELAZQUEZ JATHNIEL	6805 FRUIT FLOWER AVE LAS VEGAS NV 89130-3851	12534514009
VELAZQUEZ VILMA	6739 SCARLET STAR AVE LAS VEGAS NV 89130-4995	12527815032
VIERRA JERRY	6617 GRAY JUNIPER AVE LAS VEGAS NV 89130-4806	12535111023
VILLANUEVA FRANK M & SUSIE C	6612 SAND BENCH AVE LAS VEGAS NV 89130-4801	12535111052
VIZMANOS VIVIAN D	5660 ORANGEROOT CT LAS VEGAS NV 89130-4994	12527815025
VUONG RANDY T	5503 GEMINI BRIDGES ST LAS VEGAS NV 89130-4996	12535111011
W G H NEVADA L L C	103 FOULK RD #900 WILMINGTON DE 19803	12535111045
WANG MINGYU	SUN HAOQING 1211 HAMIDA CT SAN JOSE CA 95120-5538	12527815020
WEBER PAUL L & JOYCE A	6520 W HAMMER LN LAS VEGAS NV 89130-1707	12535103012
WENDELIN DOUGLAS RAY JR	5513 GOLDBRUSH ST LAS VEGAS NV 89130	12534511039
WEST BEATRICE F	5603 LUSITANO ST LAS VEGAS NV 89130-1262	12526411015
WHEELER DAYNON & SHIRLEY C	5529 GOLDBRUSH ST LAS VEGAS NV 89130-1656	12534511035
WILLIAMS CHRISTOPHER	5614 BISHOP FLOWERS ST LAS VEGAS NV 89130	12527819073
WINDHAVEN HOMEOWNERS ASSN	2555 W CHEYENNE AVE NORTH LAS VEGAS NV 89032	12527819102
WINDHAVEN HOMEOWNERS ASSN	2555 W CHEYENNE AVE NORTH LAS VEGAS NV 89032	12527819097
WINTON CHRIS J	6800 WHITE LAKES AVE LAS VEGAS NV 89130	12534614010
WISHENGRAD STUART & CYNTHIA L	6117 LONESOME CACTUS ST LAS VEGAS NV 89130-1054	12534513031
WITHERALL SCOTT	O'NEILL JOSEPH 5518 MOONLIGHT GARDEN ST LAS VEGAS NV 89130-4998	12535111028
WOODBURY SCOTT L TRUST NO 1	WOODBURY ANNETTE M TRUST NO 1 205 KISIWA PKWY HUTCHINSON KS 67502	12534514001
YAMAMOTO YOUN	6605 SAND BENCH AVE LAS VEGAS NV 89130-4801	12535111055
YAMAMOTO YUJI T	6505 TAYLOR CREEK AVE LAS VEGAS NV 89130-4805	12535111046
YAPCHING WILFREDO	5408 CARNATION MEADOW ST LAS VEGAS NV 89130	12534513029
YEN KEVIN C & ELISE	618 S BROADWAY #B REDONDO BEACH CA 90277	12527815027
YOGI HENRY	218 KONA PL KAHULUI MAUI HI 96732	12527818001
YOGI HENRY SEICHI TRUST	YOGI HENRY S TRS 218 KONA PL KAHULUI HI 96732	12527815050
ZHOU CHONGYU	FANG DONGRUI 48 MONTEVIDEO CIR FREMONT CA 94539-5350	12527815015
ZINK TRUST	ZINK BARBARA E TRS 421 MILTON DR SAN GABRIEL CA 91775-2822	12526403014