

City of Las Vegas
Office Of The City Clerk
495 S. Main St., City Hall
Las Vegas, Nevada 89101

SW

Return Service Requested Official Notice of Public Hearing

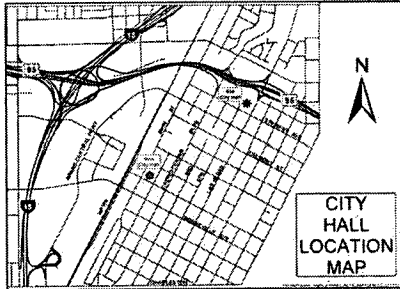

If you wish to file your protest or support on this request, check the appropriate box below and return this card in an envelope with postage to the Office Of The City Clerk at the address listed above, fax this side of this card to (702) 382-4803 or make your comments at www.lasvegasnevada.gov. If you would like to contact your Council Representative, please call (702) 229-6405.

I SUPPORT
this Request

I OPPOSE
this Request

Please use available blank space on card for your comments.

GPA-58144 & ZON-58146 [PRJ-58037]

City Council Meeting of May 20, 2015

2A ✓

Application Information

GPA-58144 - GENERAL PLAN AMENDMENT - PUBLIC HEARING - APPLICANT/OWNER: THOMAS LOZZI AND VALARIE ADAIR - For possible action on a request for a General Plan Amendment FROM: R (RURAL DENSITY RESIDENTIAL) TO: SC (SERVICE COMMERCIAL) on 0.82 acres located at 5620 North Rainbow Boulevard (APN 125-26-410-007), Ward 6 (Ross) [PRJ-58037].

ZON-58146 - REZONING RELATED TO GPA-58144 - PUBLIC HEARING - APPLICANT/OWNER: THOMAS LOZZI AND VALARIE ADAIR - For possible action on a request for a Rezoning FROM: R-E (RESIDENCE ESTATES) TO: C-1 (LIMITED COMMERCIAL) on 0.82 acres located at 5620 North Rainbow Boulevard (APN 125-26-410-007), Ward 6 (Ross) [PRJ-58037].

Application Location

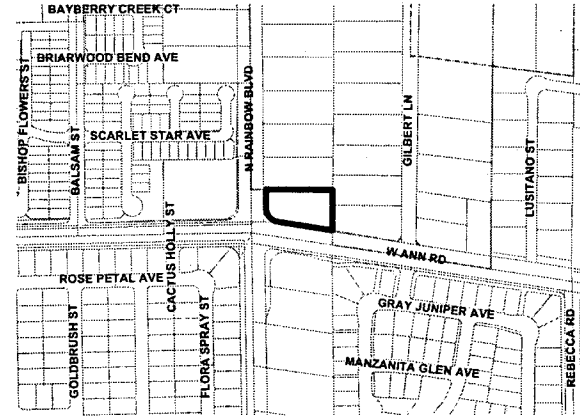

The proposed project may not pertain to the entire highlighted project site.

Public Hearing Information

Meeting: City Council
Date: *May 20, 2015*
Time: 1:00 P.M.
Location: City Council Chambers
495 South Main Street, 2nd Floor
Las Vegas, Nevada 89101

Any and all interested persons may appear and be heard at said meeting, or may, prior to this meeting, file a written objection thereto or approval thereof with the City Clerk, 2nd Floor, City Hall, 495 South Main Street, Las Vegas, Nevada 89101. For further information, including the full staff report, please call (702)229-6311 (7-1-1 Relay Nevada) or go to <http://www.lasvegasnevada.gov>.

S.✓

CASE# GPA-58144 ZON-58146

	PARCEL#	OWNER	ADDRESS1	ADDRESS2	ADDRESS3	ADDRESS4	ADDRESS5
1	12534513010	A M H 2014-1 BORROWER L L C	30601 AGOURA RD #200	AGOURA HILLS CA 91301			
2	12527815021	A R P PHOENIX FUND I L P	7047 E GREENWAY PKWY #350	SCOTTSDALE AZ 85254-8117			
3	12535111036	AIKEN PETER J III & GINA M	5513 PORCUPINE RIM ST	LAS VEGAS NV 89130-4803			
4	12535111027	AKI TRUST	SHUGARMAN ALAN TRS	3635 S FORT APACHE RD #200-7	LAS VEGAS NV 89147		
5	12534513034	ALBERICI JOHN & PATRICIA FAM TR	ALBERICI JOHN S & PATRICIA A TRS	5425 CARNATION MEADOW ST	LAS VEGAS NV 89130-3822		
6	12534511004	ALEXANDER NAGUIB M & G Z TRUST	ALEXANDER NAGUIB M & G Z TRS	6812 ROSE PETAL AVE	LAS VEGAS NV 89130-1657		
7	12535111025	ALLEN GREGORY & EMELIA	6609 GRAY JUNIPER AVE	LAS VEGAS NV 89130-4806			
8	12527815001	ALLEN MICHAEL J	17117 JOURNEYS END DR	ODESSA FL 33556			
9	12527816034	ALLEN VALERIE M	6810 BRIARWOOD BEND	LAS VEGAS NV 89130-5005			
10	12526410004	AQUA BAMBOO L L C	6717 CAMBIUM PINE AVE	LAS VEGAS NV 89130-1420			
11	12526402003	AQUIAR HERIBERTO VALENTE	VALENTE MICHAEL NICOLA TRUST	6625 W EL CAMPO GRANDE AVE	LAS VEGAS NV 89130-1203		
12	12534513023	ASTANTIS L L C	201 E MAYFLOWER AVE	NORTH LAS VEGAS NV 89030			
13	12527819025	B D S INVESTMENT L L C	2660 S RAINBOW BLVD #H-108	LAS VEGAS NV 89146			
14	12527819021	BACALLAO ARAMIS	5688 BISHOP FLOWERS ST	LAS VEGAS NV 89130			

24✓

	PARCEL#	OWNER	ADDRESS1	ADDRESS2	ADDRESS3	ADDRESS4	ADDRESS5
15	12535101005	BAILEY JOHN M	5455 N RAINBOW BLVD	LAS VEGAS NV 89130-1608			
16	12535111015	BAIN JAMES A & MAUREEN	6617 MANZANITA GLEN AVE	LAS VEGAS NV 89130-4997			
17	12527819078	BALAYAN KRISTINA	SHIAN RAYMOND	5623 BISHOP FLOWERS ST	LAS VEGAS NV 89130		
18	12535111039	BANK MORGAN J P CHASE NATL ASSN	10790 RANCHO BERNARDO RD	SAN DIEGO CA 92127			
19	12527815018	BARCARSE DEMETRIO	10972 TOPEKA DR	PORTER RANCH CA 91326-2322			
20	12527817001	BATES SPENCER	42 SHERWOOD POINT NW	CALGARY AB T3R 1P2	CANADA		
21	12527815037	BEATTIE TRACY	5630 AFRICAN LILLY CT	LAS VEGAS NV 89130-4992			
22	12534514022	BECERRIL XAVIER G	5421 FLORA SPRAY ST	LAS VEGAS NV 89130-3844			
23	12535111074	BENAVIDEZ RAUL Z & ANA V	6516 GRAY JUNIPER AVE	LAS VEGAS NV 89130-4807			
24	12534511006	BERENDS JAMES & TERESA	6820 ROSE PETAL AVE	LAS VEGAS NV 89130-1657			
25	12526402001	BERG DANA	5800 GILBERT LN	LAS VEGAS NV 89130-1219			
26	12527815045	BINAMIRA IMELDA L	5644 BALSAM ST	LAS VEGAS NV 89130-1106			
27	12534513022	BLAZZARD DEANNE	7108 DILLSEED DR	LAS VEGAS NV 89131-8154			
28	12527819075	BLINN DARREN	TRAN DUYEN	5606 BISHOP FLOWERS ST	LAS VEGAS NV 89130		

	PARCEL#	OWNER	ADDRESS1	ADDRESS2	ADDRESS3	ADDRESS4	ADDRESS5
29	12535101001	BOLV RE HOLDINGS VII L L C	1700 W HORIZON RIDGE PKWY #100	HENDERSON NV 89012			
30	12535111066	BONNET GUILLERMO A	705 SARAJANE LANE	LAS VEGAS NV 89107-1582			
31	12534513005	BOYAKINS GREGORY D	6700 ROSE PETAL AVE	LAS VEGAS NV 89130-1686			
32	12527803004	BRAY MARY MAGGIE & DAVID ROBERT	5945 N EL CAPITAN WAY	LAS VEGAS NV 89149			
33	12535111009	BROWN JACQUELYN D	5511 GEMINI BRIDGES ST	LAS VEGAS NV 89130-4996			
34	12534513020	BROWN JOHN T & GLORIA J	5516 CARNATION MEADOW ST	LAS VEGAS NV 89130-1692			
35	12535111043	BUCK MICHAEL D & RAQUEL	6517 TAYLOR CREEK AVE	LAS VEGAS NV 89130-4805			
36	12534511027	BURCHARD FAMILY TRUST	BURCHARD CARL L & THANH T TRS	5500 GOLDBRUSH ST	LAS VEGAS NV 89130-1655		
37	12535111012	BURNS IAN R & KIM	1110 JENNIE RIDGE TRL	KISSIMMEE FL 34747-1926			
38	12527819081	BUSH LAURENS A IV	WILSON MARISSA R	5635 BISHOP FLOWERS ST	LAS VEGAS NV 89130		
39	12535111072	BYRD JENNIFER L & SHAUNTE M	6508 GRAY JUNIPER AVE	LAS VEGAS NV 89130-4807			
40	12527816024	C A H 2014-1 BORROWER L L C	9305 E VIA DE VENTURA #201	SCOTTSDALE AZ 85258			
41	12534511001	CALIGURL L L C	%S FULFER	9721 CAMDEN HILLS AVE	LAS VEGAS NV 89145-8611		
42	12527815035	CALLEJO MARIANO A	5638 AFRICAN LILLY CT	LAS VEGAS NV 89130			

	PARCEL#	OWNER	ADDRESS1	ADDRESS2	ADDRESS3	ADDRESS4	ADDRESS5
43	12535111078	CAMPBELL DEREK GRANT	DUBOIS MARIN LINDSAY	6612 W GRAY JUNIPER AVE	LAS VEGAS NV 89130-4806		
44	12527815034	CANITES MARY ANNE B	6747 SCARLET STAR AVE	LAS VEGAS NV 89130-4995			
45	12527816002	CANTILLO CARLOS	6817 BRIARWOOD BEND AVE	LAS VEGAS NV 89130-5005			
46	12534513021	CARTER DARRYL GREGG	5512 CARNATION MEADOW ST	LAS VEGAS NV 89130-1692			
47	12535111032	CARTER KHALIL J	5529 PORCUPINE RIM ST	LAS VEGAS NV 89130-4803			
48	12534511002	CARVOTTA PASCAL F	HENDRICKSON ALLEN STEVE	6804 ROSE PETAL AVE	LAS VEGAS NV 89130-1662		
49	12534513016	CASTILLO ANA M	5529 FLORA SPRAY ST	LAS VEGAS NV 89130-1697			
50	12527815036	CASTRO-PIREZ LAZARO	5634 AFRICIAN LILLY CT	LAS VEGAS NV 89130-4992			
51	12526411010	CHENE CHEN & VIVIAN M	5636 LUSITANO ST	LAS VEGAS NV 89130-1262			
52	12526411009	CHESS ROBERT W & PATRICIA L	5644 LUSITANO ST	LAS VEGAS NV 89130-1262			
53	12527816006	CHOUNLAMOUNTRY VIMARANH	6777 BRIARWOOD BEND AVE	LAS VEGAS NV 89130-5005			
54	12527815033	CHUI CHING	CHEUNG KIT POH	P O BOX 911	BRASELTON GA 30517		
55	12527815002	COHU VICTORIA L	12543 CATARA ST	NO HOLLYWOOD CA 91605			
56	12534513035	COLFIN AH-NEVADA 3 L L C	%CAH MGT	9305 E VIA DE VENTURA #201	SCOTTSDALE AZ 85258		

	PARCEL#	OWNER	ADDRESS1	ADDRESS2	ADDRESS3	ADDRESS4	ADDRESS5
57	12527815011	COLFIN AI-NV 2 L L C	8155 E INDIAN BEND RD #109	SCOTTSDALE AZ 85250-4827			
58	12527817003	COLLIER TERRENCE D	5720 WINTER CHERRY AVE	LAS VEGAS NV 89130-5006			
59	12527803002	COMPAGNO JOHN	9811 W CHARLESTON BLVD #2792	LAS VEGAS NV 89117			
60	12527819035	COVERT LORETTA & DARREN	5683 BALSAM ST	LAS VEGAS NV 89130			
61	12527816023	COWPERTHWAIT TODD & SHELLEY	6802 BAYBERRY CREEK CT	LAS VEGAS NV 89130-4999			
62	12534511038	CROSSLIN SHERRY A	RAY JAMES P	110 E CENTER ST #1142	MADISON SD 57042-2908		
63	12534513019	CSOENDES IRREVOCABLE PPTY TR	SZOKE LASZLO TRS	8600 SCHOLAR LN #1008	LAS VEGAS NV 89128		
64	12527819023	CUETO JOSE III	VILLANUEVA MARIA	5680 BISHOP FLOWERS ST	LAS VEGAS NV 89130		
65	12527815019	CUSHING GARY	5673 ORANGEROOT CT	LAS VEGAS NV 89130-4994			
66	12527819079	DANG VINCENT & BETTY	33142 VINO WAY	TEMECULA CA 92591			
67	12534513024	DAVIS KENNETH L & CHERYL	5500 CARNATION MEADOW	LAS VEGAS NV 89130-1692			
68	12527818006	DAVIS TONY	6 RUE DU PALAIS CT	HENDERSON NV 89011-2009			
69	12526401001	DECISIVE PURSUIT L L C	28 QUIET MOON LN	LAS VEGAS NV 89135			
70	12535111029	DEPOSADA K C L SEP PPTY TR	5522 MOONLIGHT GARDEN ST	LAS VEGAS NV 89130-4998			

	PARCEL#	OWNER	ADDRESS1	ADDRESS2	ADDRESS3	ADDRESS4	ADDRESS5
71	12534513004	DEVIN PAT R & ANITA R	P O BOX 78420	PHOENIX AZ 85062			
72	12527816025	DEWIT YOLANDA C	123 S FIGUEROA #1231	LOS ANGELES CA 90012-5478			
73	12534514028	DIAMOND JACK K & GAIL FAMILY TRU	DIAMOND JACK K & GAIL TRS	5509 FLORA SPRAY ST	LAS VEGAS NV 89130-1695		
74	12527816027	DIAZ JOSE & FRANCINE REV 1993 TR	DIAZ JOSE LUIS & FRANCINE J TRS	9821 TERRADELL ST	PICO RIVERA CA 90660-5645		
75	12527816004	DIXON MARION	728 DIAMOND ST	SAN FRANCISCO CA 94114			
76	12526410013	DONOHUE PATRICK & JUDITH	5715 GILBERT LN	LAS VEGAS NV 89130-1225			
77	12526410011	DONOHUE TARA	DONAHUE PATRICK & JUDITH	5715 GILBERT LN	LAS VEGAS NV 89130-1225		
78	12535111034	DUKE CRAIG D	5521 PORCUPINE RIM ST	LAS VEGAS NV 89130-4803			
79	12527815006	DUMAS ROSALIND BRANNON	5661 AFRICAN LILLY CT	LAS VEGAS NV 89130-4992			
80	12527815042	DURANDETTO KENNETH TODD	BROOKS IMELDA H	5637 AFRICAN LILLY CT	LAS VEGAS NV 89130-4992		
81	12535103003	DUTSON DEREK M	5425 N RAINBOW BLVD	LAS VEGAS NV 89130			
82	12534513025	ELLEFSON GLEN P JR & MARLENA K	5424 CARNATION MEADOW ST	LAS VEGAS NV 89130-3821			
83	12527819022	ESTOUP MEGAN NICOLE	5684 BISHOP FLOWERS ST	LAS VEGAS NV 89130			
84	12534511033	ESTRADA PEDRO A & GRISELDA	5524 GOLDBRUSH ST	LAS VEGAS NV 89130-1655			

	PARCEL#	OWNER	ADDRESS1	ADDRESS2	ADDRESS3	ADDRESS4	ADDRESS5
85	12534513014	EVERHART ROBERT L & JOANNE S	5521 FLORA SPRAY ST	LAS VEGAS NV 89130			
86	12535103002	FARR STEPHEN W	5435 N RAINBOW BLVD	LAS VEGAS NV 89130			
87	12534511034	FEDERAL NATIONAL MORTGAGE ASSN	135 N LOS ROBLES AVE	PASADENA CA 91101			
88	12534513007	FERRARA LORRAINE	5528 FLORA SPRAY ST	LAS VEGAS NV 89130-1696			
89	12527815017	FICHTENBAUM ERIC & SHARON REV TR	7294 ELESSAR AVE	LAS VEGAS NV 89178			
90	12535111070	FITZGERALD GREGORY A & KATHRYN S	5534 PORCUPINE RIM ST	LAS VEGAS NV 89130-4803			
91	12534511028	FITZPATRICK PETER W & CAROL A	5504 GOLDBRUSH ST	LAS VEGAS NV 89130-1655			
92	12527819024	FLEWELLEN DANNY & PATSY	5676 BISHOP FLOWERS ST	LAS VEGAS NV 89130			
93	12535111040	FOULKES MARK S & SABINE E	6520 TAYLOR CREEK AVE	LAS VEGAS NV 89130			
94	12534514025	FRAZIER MICHAEL & TAEM	5433 FLORA SPRAY ST	LAS VEGAS NV 89130			
95	12527816013	FRIEDMAN SCOTT	FRIEDMAN JOEL & DIANA	6786 WEEPING FIG CT	LAS VEGAS NV 89130		
96	12526402006	FRIENDS MOOSE REVOCABLE LIV TR	NEAL JOE DENNIS TRS	6212 LULLABY PINE CT	LAS VEGAS NV 89130-1404		
97	12535111041	FROISTAD FREDRICK H	WALLACE- FROISTAD DANELLE L	6613 TAYLOR CREEK AVE	LAS VEGAS NV 89130-4804		
98	12535111001	GALANGA CEASAR	6620 GRAY JUNIPER AVE	LAS VEGAS NV 89130-4806			

	PARCEL#	OWNER	ADDRESS1	ADDRESS2	ADDRESS3	ADDRESS4	ADDRESS5
99	12534513009	GAMBOA RUEL L & LUCIEN A	7147 32ND AVE S	SEATTLE WA 98118-3503			
100	12527815029	GARCIA-LOPEZ RICHARD	DEGARCIA MILITZA I FERNANDEZ	5673 DANCING ORCHID CT	LAS VEGAS NV 89130-4993		
101	12527815013	GARDNER TAUREAN	5668 AFRICAN LILLY CT	LAS VEGAS NV 89130			
102	12534513006	GASTELUM OLVIDO A	5532 FLORA SPRAY ST	LAS VEGAS NV 89130-1696			
103	12527819032	GAUFF AIRON	5671 BALSAM ST	LAS VEGAS NV 89130			
104	12526411016	GIARMO CHERYL L	5611 LUSITANO ST	LAS VEGAS NV 89130-1262			
105	12527818008	GLORIOSO CLAUDIO G & MARIA L	GLORIOSO MARIA C & CLARIZA	6735 SCARLET STAR AVE	LAS VEGAS NV 89130-4995		
106	12535111021	GODOY RICARDO C & CHRISTINA M	6620 MANZANITA GLEN AVE	LAS VEGAS NV 89130-4997			
107	12535101007	GOLD L T R E L L C #6	9159 W FLAMINGO RD #102	LAS VEGAS NV 89147-6454			
108	12527815039	GONZALES JEANINE J	5625 AFRICAN LILLY CT	LAS VEGAS NV 89130-4991			
109	12527815046	GRAY TARA DONENE	5640 BALSAM ST	LAS VEGAS NV 89130-1106			
110	12534511031	GUERRERO ARMANDO & MARIA	5516 GOLDBRUSH	LAS VEGAS NV 89130-1655			
111	12534513012	GUEVARA CARLO T	5513 FLORA SPRAY ST	LAS VEGAS NV 89130-1697			
112	12535111075	GUILIANO LORI M	6520 GRAY JUNIPER AVE	LAS VEGAS NV 89130-4807			

	PARCEL#	OWNER	ADDRESS1	ADDRESS2	ADDRESS3	ADDRESS4	ADDRESS5
113	12527819033	GUTIERREZ RAUL JR	LEAL IVONNE	5675 BALSAM ST	LAS VEGAS NV 89130		
114	12534514029	HALL LEROY E & BRANDY T	5508 FLORA SPRAY ST	LAS VEGAS NV 89130-1694			
115	12527818004	HAMILTON DEIDRA	HUFNAGLE AARON	6719 SCARLET STAR AVE	LAS VEGAS NV 89130-4995		
116	12534513037	HARMON CATHIE	5509 CARNATION MEADOW ST	LAS VEGAS NV 89130-1693			
117	12527818003	HARRISON MERCY	6715 SCARLET STAR AVE	LAS VEGAS NV 89130			
118	12527815016	HARTOUNIAN VAHIK	416 AUDREYNE AVE	GLENDALE CA 91202			
119	12527816005	HAYASHI ALAN M & ESTELLE M	1947 9TH AVE	HONOLULU HI 96816			
120	12534511040	HENDRICKSON ALLEN L & ARLENE L	HENDRICKSON ALLEN STEVE	5509 GOLDBRUSH ST	LAS VEGAS NV 89130-1656		
121	12527817004	HENRIQUEZ RUSSELL L & GUADALUPE	5726 WINTER CHERRY ST	LAS VEGAS NV 89130-5006			
122	12527815055	HIGHLAND GROVE HOMEOWNERS ASSN	%RMI MGT LLC	630 TRACE CENTER DR #100	LAS VEGAS NV 89119		
123	12535111071	HILL CHRISTOPHER & CHANOTIP	CHINASAI CHALIE	6504 GRAY JUNIPER AVE	LAS VEGAS NV 89130-4807		
124	12527819071	HIRSCHUBER JOSHUA & KELLY	5622 BISHOP FLOWERS ST	LAS VEGAS NV 89130			
125	12527819077	HOLST CLEM & DIANE TRUST	HOLST CLEMENT L & YVONNE D TRS	720 ARBOR POINTE AVE	GUSTINE CA 95322		
126	12534513033	HOOPER DAN	9048 LITTLE ARROW CT	LAS VEGAS NV 89143			

	PARCEL#	OWNER	ADDRESS1	ADDRESS2	ADDRESS3	ADDRESS4	ADDRESS5
127	12534511003	HOPKINS DANIEL B & DIANA J	1620 SONGLIGHT CT	LAS VEGAS NV 89117-1583			
128	12526411018	HOWELL GARY D & GAYE LEINN	5627 LUSITANO ST	LAS VEGAS NV 89130-1262			
129	12526411017	HUDSON WILLIAM & C FAM TR	HUDSON CHARLAINE TRS	5619 LUSITANO ST	LAS VEGAS NV 89130-1262		
130	12527817006	HUFF JAN	5740 WINTER CHERRY ST	LAS VEGAS NV 89130-5006			
131	12535111031	INCHAUSTI DANIEL C	5530 MOONLIGHT GARDEN ST	LAS VEGAS NV 89130-4998			
132	12527815038	JACOBS NICOLETTE & DONTA LEVITE	5621 AFRICAN LILLY CT	LAS VEGAS NV 89130-4991			
133	12526410009	JENSEN RONALD L & KITTY L	5631 GILBERT LN	LAS VEGAS NV 89130-1225			
134	12534513018	JENSON FREDRICK M	1013 COBBLESTONE COVE RD	NORTH LAS VEGAS NV 89081-3071			
135	12535111003	JOB LISA M	5535 GEMINI BRIDGES ST	LAS VEGAS NV 89130			
136	12534513027	JOHNSON JOANN	5416 CARNATION MEADOW ST	LAS VEGAS NV 89130-3821			
137	12534511007	KANIPE JOAN	O'BRIEN CYNTHIA	5809 GLENMERE AVE	LAS VEGAS NV 89131		
138	12527815043	KARYDAS KONSTANTINOS & SHAWN	5641 AFRICAN LILLY CT	LAS VEGAS NV 89130			
139	12527818007	KATRI LENORE J	4145 S SILVERADO DR	IDAHO FALLS ID 83404-7788			
140	12526402014	KATTERHEINRICH ANITA J	1599A 39TH ST	LOS ALAMOS NM 87544-2899			

	PARCEL#	OWNER	ADDRESS1	ADDRESS2	ADDRESS3	ADDRESS4	ADDRESS5
141	12534514026	KELLY RICHARD & RACHEL E	5501 FLORA SPRAY ST	LAS VEGAS NV 89130-1695			
142	12535111016	KEMPF LAURENCE M & MAUREEN	6613 MANZANITA GLEN AVE	LAS VEGAS NV 89130-4997			
143	12535111067	KERR STANLEY F JR & TAMMY L	5522 PORCUPINE RIM ST	LAS VEGAS NV 89130-4803			
144	12526411014	KLINKNER KELLY & DIANNA	5604 LUSITANO ST	LAS VEGAS NV 89130-1262			
145	12527816033	KLINKNER PAMELA GAIL & M REV TR	KLINKNER PAMELA GAIL & M E TRS	158 OAKRIDGE DR	DAYTON NV 89403		
146	12527816028	KNELL AARON P & MAUREEN	6817 BAYBERRY CREEK CT	LAS VEGAS NV 89130-5004			
147	12527816029	KNELL AARON P & MAUREEN G	5434 PORCUPINE RIM ST	LAS VEGAS NV 89130-4802			
148	12535111035	KNOBLE LAQUAL N & JARED M	5517 PORCUPINE RIM ST	LAS VEGAS NV 89130-4803			
149	12535111042	KNOX FAMILY LIVING TRUST ETAL	KNOX TYRONE TRS	P O BOX 570954	LAS VEGAS NV 89157-0954		
150	12534511029	LAAM GLORIA W LIVING TRUST	508 GOLDBRUSH ST	LAS VEGAS NV 89130			
151	12534514032	LAMBERT CARL E & BRONIE S	5428 FLORA SPRAY ST	LAS VEGAS NV 89130-3839			
152	12534513003	LARSON STEVEN R & SHARON	6712 ROSE PETAL	LAS VEGAS NV 89130-1687			
153	12535111017	LETUS KEITH A	6604 W MANZANITA GLEN AVE	LAS VEGAS NV 89130-4997			
154	12534513042	LEYVA JOSE L	ARCHIBEQUE CIARA A	5529 CARNATION MEADOW ST	LAS VEGAS NV 89130		

	PARCEL#	OWNER	ADDRESS1	ADDRESS2	ADDRESS3	ADDRESS4	ADDRESS5
155	12527816026	LI TAO & SERENE	12814 SEABREEZE FARMS DR	SAN DIEGO CA 92130			
156	12527815009	LIRA ERICA M	5673 AFRICAN LILLY CT	LAS VEGAS NV 89130-4992			
157	12527815005	LLOYD DAVID E & NANCY J	4636 WOODBURN RD	W VANCOUVER BC V75 2W6	CANADA		
158	12527816035	LOPEZ SAMUEL	6818 BRIARWOOD BEND AVE	LAS VEGAS NV 89130-5005			
159	12526410007	LOZZI THOMAS	ADAIR VALERIE	9340 PITCHING WEDGE DR	LAS VEGAS NV 89134-6336		
160	12534513008	LUKER CHELSEA E	5524 FLORA SPRAY ST	LAS VEGAS NV 89130-1696			
161	12526402004	LUKEY'S FAMILY TRUST	CORRAL LUCRETIA G TRS	5760 GILBERT LN	LAS VEGAS NV 89130-1228		
162	12534514034	LUNSFORD THOMAS W	5420 FLORA SPRAY ST	LAS VEGAS NV 89130-3843			
163	12534511005	LUONG TAM TRONG	6816 ROSE PETAL AVE	LAS VEGAS NV 89130-1657			
164	12534513038	LYNCH CARL R & ROSE MARIE	5513 CARNATION MEADOW ST	LAS VEGAS NV 89130-1693			
165	12527819080	LYNCH WYATT	5631 BISHOP FLOWERS ST	LAS VEGAS NV 89130			
166	12535111010	MAANAO PETER J JR	5507 GEMINI BRIDGES ST	LAS VEGAS NV 89130			
167	12534511048	MARCOM NORA H	5524 ROSE THICKET ST	LAS VEGAS NV 89130-1652			
168	12527816022	MARTINEZ JOSE A	6794 BAYBERRY CREEK CT	LAS VEGAS NV 89130-4999			

	PARCEL#	OWNER	ADDRESS1	ADDRESS2	ADDRESS3	ADDRESS4	ADDRESS5
169	12535111018	MATA ROBINSON R	6608 MANZANITA GLEN AVE	LAS VEGAS NV 89130-4997			
170	12526410008	MCALPIN MICHAEL L	MCALPIN EDWARD D & THELMA F	5611 GILBERT LN	LAS VEGAS NV 89130-1225		
171	12526411019	MCCAMISH KELLY	MCCAMISH KEVIN & DONNA	5635 LUSITANO ST	LAS VEGAS NV 89130-1262		
172	12534514030	MCCLURE KENNETH R & JACKIE A	5504 FLORA SPRAY ST	LAS VEGAS NV 89130-1694			
173	12526411020	MCEVOY EDWARD G III & ELLEN T	5643 LUSITANO ST	LAS VEGAS NV 89130-1262			
174	12534513026	MCGOWAN SHANNON	5420 CARNATION MEADOW ST	LAS VEGAS NV 89130-3821			
175	12526411013	MCMCGARRY RICHARD L	HOFFMAN-KYLE LYNN	5612 LUSITANO ST	LAS VEGAS NV 89130-1262		
176	12535111007	MERCURIO CURTIS G	SWANSON STEPHANIE L	5519 GEMINI BRIDGES ST	LAS VEGAS NV 89130-4996		
177	12527803001	MILTON JO A	REESE KIMBERLY	5785 N RAINBOW BLVD	LAS VEGAS NV 89130-1230		
178	12527817002	MOLINO-CARMONA SUZETTE	5714 WINTER CHERRY ST	LAS VEGAS NV 89130-5006			
179	12527803007	MONAGHAN FARMS INC	%WALGREEN CO #06310	P O BOX 1159	DEERFIELD IL 60015		
180	12534513013	MOONEY MILDRED F & LYNN M	5517 FLORA SPRAY ST	LAS VEGAS NV 89130-1697			
181	12534513015	MORAWSKI FAMILY TRUST	MORAWSKI CHRISTOPHER & I TRS	9408 BRILLIANT ORE DR	LAS VEGAS NV 89143		
182	12535111014	MORGAN GUY A & JOY L	2140 HOT OAK RIDGE ST	LAS VEGAS NV 89134			

	PARCEL#	OWNER	ADDRESS1	ADDRESS2	ADDRESS3	ADDRESS4	ADDRESS5
183	12534511030	NATH JEFFREY ALAN & MARISA TELEN	5512 GOLDBRUSH ST	LAS VEGAS NV 89130-1655			
184	12526411012	NEAFSEY BRIAN & LOIS	5620 LUSITANO ST	LAS VEGAS NV 89130-1262			
185	12527819037	NEWMAN AUSTIN & KATIE	5691 BALSAM ST	LAS VEGAS NV 89130			
186	12535111069	NGUYEN LINA N	5530 PORCUPINE RIM ST	LAS VEGAS NV 89130-4803			
187	12526402012	NOVOTNY FAMILY LIVING REV TR	%M & H NOVOTNY	6660 W ANN RD	LAS VEGAS NV 89130-1214		
188	12527815024	OLARTE JAVIER	5664 ORANGEROOT CT	LAS VEGAS NV 89130-4994			
189	12534513039	OLZASKI DENISE R	5512 FLORA SPRAY ST	LAS VEGAS NV 89130-1696			
190	12534513011	OLZASKI-THOMAS DENISE	5512 FLORA SPRAY ST	LAS VEGAS NV 89130-1696			
191	12535111073	O'MALLEY TONI J & BRIAN P	6512 GRAY JUNIPER AVE	LAS VEGAS NV 89130-4807			
192	12534511036	ORTEGA CARLOS	5525 GOLDBRUSH ST	LAS VEGAS NV 89130-1656			
193	12526411037	PACIFIC COAST DEVELOPEMENT	6293 DEAN MARTIN DR #G	LAS VEGAS NV 89118-3845			
194	12527816021	PAGE JEFFREY & JENNIFER	6793 WEEPING FIG CT	LAS VEGAS NV 89130-5007			
195	12535111033	PAGE MICHAEL S	5525 PORCUPINE RIM ST	LAS VEGAS NV 89130-4803			
196	12527815041	PAINÉ SHAWN R	1 W SUPERIOR #1209	CHICAGO IL 60654			

	PARCEL#	OWNER	ADDRESS1	ADDRESS2	ADDRESS3	ADDRESS4	ADDRESS5
197	12527816020	PAVLIGA STEVEN	LODGE KELLY	6801 WEEPING FIG CT	LAS VEGAS NV 89130-5007		
198	12526402013	PAYGUN FAMILY TRUST	DODDS WALTER TADD & DEBI E TRS	5640 GILBERT LN	LAS VEGAS NV 89130-1228		
199	12526410003	PEARSON FAMILY TRUST	PEARSON KEITH H & MARIA T TRS	5710 N RAINBOW BLVD	LAS VEGAS NV 89130-1247		
200	12526411008	PECHACEK NATHAN & LISA	6543 LOKAI AVE	LAS VEGAS NV 89130-1261			
201	12534513002	PENA CARLOS M	6716 ROSE PETAL AVE	LAS VEGAS NV 89130-1687			
202	12527815028	PEREZ FERNANDO	5669 DANCING ORCHID CT	LAS VEGAS NV 89130			
203	12527815012	PETKOVICH MARIE	5672 AFRICAN LILLY CT	LAS VEGAS NV 89130-4992			
204	12527816001	PETRIANO RICHARD	6825 BRIARWOOD BEND AVE	LAS VEGAS NV 89130-5005			
205	12535111019	PHAM ANH N	6612 MANZANITA GLEN AVE	LAS VEGAS NV 89130-4997			
206	12534511047	PITCHER ROBERT W & MARIA L	5520 ROSE THICKET ST	LAS VEGAS NV 89130			
207	12534513040	POCINO CHRISTOPHER L & VERONICA	5521 CARNATION MEADOW ST	LAS VEGAS NV 89130-1693			
208	12535103001	PRACTICAL RENEWABLE ENERGY CORP	5435 N RAINBOW BLVD	LAS VEGAS NV 89130			
209	12527815022	PROGRESS RESIDENTIAL 2014-1 BORR	909 N SEPULVEDA BLVD #840	EL SEGUNDO CA 90245			
210	12535111026	RABIN HARRY & SYLVIA REV TR ETAL	RABIN DAVID & JEANNIE TRS	2869 LOS CEDROS CIR	CAMARILLO CA 93012		

	PARCEL#	OWNER	ADDRESS1	ADDRESS2	ADDRESS3	ADDRESS4	ADDRESS5
211	12535111020	RAINES JAMES W & AUDREY E	6616 MANZANITA GLEN AVE	LAS VEGAS NV 89130-4997			
212	12535111006	RAMOS JOSE T & CLAUDIA	5523 GEMINI BRIDGES ST	LAS VEGAS NV 89130-4996			
213	12526410006	REOCH DEBRA J	5640 N RAINBOW BLVD	LAS VEGAS NV 89130-1236			
214	12527816003	RICHARDS CHRISTOPHER & JENNIFER	6809 BRIARWOOD BEND AVE	LAS VEGAS NV 89130-5005			
215	12527816038	RICHMOND AMERICAN HOMES NEVADA	4350 S MONACO ST #400	DENVER CO 80237- 3400			
216	12527819028	RICHMOND AMERICAN HOMES NV INC	%S KLEID	4350 S MONACO ST	DENVER CO 80237		
217	12534513041	ROBINSON LEE & KATHY	5525 CARNATION MEADOW ST	LAS VEGAS NV 89130			
218	12527815003	ROCHA BRYAN & TENICE C	5668 BALSAM ST	LAS VEGAS NV 89130-1106			
219	12527815007	ROSALES GLORIA	5665 AFRICAN LILY CT	LAS VEGAS NV 89130-4992			
220	12526402011	ROSSETTI DENICE M	5610 GILBERT LN	LAS VEGAS NV 89130-1228			
221	12535111004	S F R INVESTMENTS POOL I L L C	5030 PARADISE RD #B-214	LAS VEGAS NV 89119			
222	12527815051	SALAS DEVAN DAWN & ARISTOTLE D	5620 BALSAM ST	LAS VEGAS NV 89130-1106			
223	12527815044	SALDANA VERONICA	5645 AFRICAN LILLY CT	LAS VEGAS NV 89130-4992			
224	12534514033	SAMPSON BARBARA C	5424 FLORA SPRAY ST	LAS VEGAS NV 89130-3839			

	PARCEL#	OWNER	ADDRESS1	ADDRESS2	ADDRESS3	ADDRESS4	ADDRESS5
225	12527815030	SANCHEZ RAUL SOSA	5677 DANCING ORCHID CT	LAS VEGAS NV 89130-4993			
226	12535111068	SANDERS JOSEPH & SHEILA L	5526 PORCUPINE RIM ST	LAS VEGAS NV 89130-4803			
227	12527818002	SANDY NANCIE LEAH	6711 SCARLET STAR AVE	LAS VEGAS NV 89130-4995			
228	12527819038	SANTOS SUZETTE & RAYMOND	5695 BALSAM ST	LAS VEGAS NV 89130			
229	12535111030	SATICOY BAY LLC 5526 MOONLIGHT G	P O BOX 36208	LAS VEGAS NV 89133			
230	12534511026	SCALES RYAN EARL & REBECCA	5424 GOLDBRUSH ST	LAS VEGAS NV 89130-1671			
231	12527819057	SCANLAN JOHN L & CAROL L	2505 ANTHEM VILLAGE DR #E608	HENDERSON NV 89052			
232	12526410012	SCHLEGEL ROBERT E	5695 N GILBERT LN	LAS VEGAS NV 89130-1225			
233	12527815048	SCOGGINS MICHELLE JUNE	KEMP KANNON KAY	5632 BALSAM ST	LAS VEGAS NV 89130-1106		
234	12534511049	SEABORG WENDELL D & TERRY	5528 ROSE THICKET ST	LAS VEGAS NV 89130-1652			
235	12535111077	SHUGARMAN ALAN	3635 S FORT APACHE RD #200-7	LAS VEGAS NV 89147			
236	12535111005	SIMS CANDICE & RICHARD	5527 GEMINI BRIDGES ST	LAS VEGAS NV 89130			
237	12534514031	SKARL DALE & SUSIE	1219 STRONG DR	LAS VEGAS NV 89102			
238	12535111008	SMITH GORDON RENE & LINDA	5515 GEMINI BRIDGES ST	LAS VEGAS NV 89130-4996			

	PARCEL#	OWNER	ADDRESS1	ADDRESS2	ADDRESS3	ADDRESS4	ADDRESS5
239	12535111024	SMITH MICHAEL H & CHERALYN Y	6613 GRAY JUNIPER AVE	LAS VEGAS NV 89130-4806			
240	12527815004	SMITH SCOTT & MIN	9490 COMPASS POINT DR SOUTH #4	SAN DIEGO CA 92126			
241	12534513017	SNODDY JOHN H & SHIRLEY A	5528 CARNATION MEADOW ST	LAS VEGAS NV 89130-1692			
242	12526411011	SNYDER PAUL B & VIRGINIA T	1283 GRANADA ST	UPLAND CA 91784			
243	12534514023	SPARKS CASEY JONAS & SACHA ELENA	5425 FLORA SPRAY ST	LAS VEGAS NV 89130-3840			
244	12527819076	SPURK LORI A & MATTHEW A	5615 BISHOP FLOWERS ST	LAS VEGAS NV 89130			
245	12527803005	SRODES L L C	5913 CASTLEBERRY PEAK AVE	LAS VEGAS NV 89131-2043			
246	12527819070	STATON GREGORY & NORIKO	5626 BISHOP FLOWERS ST	LAS VEGAS NV 89130			
247	12535111037	STONE LINA F	6504 TAYLOR CREEK AVE	LAS VEGAS NV 89130-4805			
248	12535111013	STONE ZULMA L	5508 GEMINI BRIDGES ST	LAS VEGAS NV 89130-4996			
249	12527816031	STUART JAMES E & CHERYL Y	6793 BAYBERRY CREEK CT	LAS VEGAS NV 89130-4999			
250	12534513001	SUNSTRUM JOSEPH & GEORGIA	6720 ROSE PETAL AVE	LAS VEGAS NV 89130-1687			
251	12535111002	SUTHERLAND RODNEY D	STIMPFL MARAGARET S	6624 GRAY JUNIPER AVE	LAS VEGAS NV 89130-4806		
252	12527819034	SWANSON DUSTIN & NATALIE	5679 BALSAM ST	LAS VEGAS NV 89130			

	PARCEL#	OWNER	ADDRESS1	ADDRESS2	ADDRESS3	ADDRESS4	ADDRESS5
253	12527815023	SWEET TRUST	SWEET DAVID M TRS	5668 ORANGEROOT CT	LAS VEGAS NV 89130		
254	12526410010	TAFF JACQUELINE J SEP PPTY TR	TAFF JACQUELINE J TRS	P O BOX 19549	SACRAMENTO CA 95819		
255	12534511046	TANDY NOLAN W & LOIS J	5516 ROSE THICKET ST	LAS VEGAS NV 89130-1652			
256	12527815040	TAPCOM INVESTMENTS L L C	3017 BEACH VIEW CT	LAS VEGAS NV 89117			
257	12534514024	TARIN RODOLFO JR & MARTHA P	5429 FLORA SPRAY ST	LAS VEGAS NV 89130-3840			
258	12526410005	TAYLOR LISA A & ADAM	5664 N RAINBOW	LAS VEGAS NV 89130-1236			
259	12526410015	TENDVAHL FAMILY TRUST	TENDVAHL EUGENE D & M M CO-TRS	6727 W EL CAMPO GRANDE AVE	LAS VEGAS NV 89130-1238		
260	12527815014	TERESO CESAR	6746 SCARLETT STAR AVE	LAS VEGAS NV 89130-4995			
261	12535111084	TIMBER CREEK HOMEOWNERS' ASSN	%ELITE MGT	3651 LINDELL RD #H	LAS VEGAS NV 89103-1200		
262	12535111038	TORRALBA EUGENE Y & HELEN E	9275 JUNE BERRY LN	NORTH HILLS CA 91343-7821			
263	12527816032	TRIMAX CAPITAL L L C	269 S BEVERLY DR #1826	BEVERLY HILLS CA 90212-3851			
264	12527815047	TRIPP LAUREN N	5636 BALSAM ST	LAS VEGAS NV 89130-1106			
265	12526402002	TUBIN BRAD REVOCABLE TRUST	TUBIN BRADLEY G TRS	%J ROSENBERGER CO-TRS	3291 E WARM SPRINGS RD #400	LAS VEGAS NV 89120	
266	12534511032	TULE VICTOR	5520 GOLDBRUSH ST	LAS VEGAS NV 89130-1655			

	PARCEL#	OWNER	ADDRESS1	ADDRESS2	ADDRESS3	ADDRESS4	ADDRESS5
267	12527816036	TURPIN NATHAN & ANA C	6824 BRIARWOOD BEND AVE	LAS VEGAS NV 89130-5005			
268	12535111076	UDARBE JOEL U & ANTONIO T	UDARBE PATROCINIA U	6604 GRAY JUNIPER AVE	LAS VEGAS NV 89130-4806		
269	12527816030	VALENCIA TIFFANY	6801 BAYBERRY CREEK CT	LAS VEGAS NV 89130-4999			
270	12527818005	VEGA JAIME R	6723 SCARLET STAR AVE	LAS VEGAS NV 89130-4995			
271	12526401002	VEGAS VALLEY LAND ENTPRS L L C	5598 S FORT APACHE	LAS VEGAS NV 89148			
272	12527817005	VELAZQUEZ EDGAR	5732 WINTER CHERRY AVE	LAS VEGAS NV 89130-5006			
273	12527815032	VELAZQUEZ VILMA	6739 SCARLET STAR AVE	LAS VEGAS NV 89130-4995			
274	12535111023	VIERRA JERRY	6617 GRAY JUNIPER AVE	LAS VEGAS NV 89130-4806			
275	12535111052	VILLANUEVA FRANK M & SUSIE C	6612 SAND BENCH AVE	LAS VEGAS NV 89130-4801			
276	12527815025	VIZMANOS VIVIAN D	5660 ORANGEROOT CT	LAS VEGAS NV 89130-4994			
277	12535111011	VUONG RANDY T	5503 GEMINI BRIDGES ST	LAS VEGAS NV 89130-4996			
278	12527815010	W O W PROPERTIES L L C	3100 S GRAND AVE	LOS ANGELES CA 90007-3815			
279	12527816019	WALCZAK ROBERT & ANNA	6809 WEEPING FIG CT	LAS VEGAS NV 89130-5007			
280	12527815020	WANG MINGYU	SUN HAOQING	1211 HAMIDA CT	SAN JOSE CA 95120-5538		

	PARCEL#	OWNER	ADDRESS1	ADDRESS2	ADDRESS3	ADDRESS4	ADDRESS5
281	12534511039	WENDELIN DOUGLAS RAY JR	5513 GOLDBRUSH ST	LAS VEGAS NV 89130			
282	12526411015	WEST BEATRICE F	5603 LUSITANO ST	LAS VEGAS NV 89130-1262			
283	12534511035	WHEELER DAYNON & SHIRLEY C	5529 GOLDBRUSH ST	LAS VEGAS NV 89130-1656			
284	12534511037	WILEY WESLEY L	5521 GOLDBRUSH ST	LAS VEGAS NV 89130-1656			
285	12527819073	WILLIAMS CHRISTOPHER	5614 BISHOP FLOWERS ST	LAS VEGAS NV 89130			
286	12526410014	WILLIAMS MARC & SARA	5737 GILBERT LN	LAS VEGAS NV 89130-1225			
287	12527819095	WINDHAVEN HOMEOWNERS ASSN	%THOROUGHbred MGMT	2555 W CHEYENNE AVE	NORTH LAS VEGAS NV 89032		
288	12535111028	WITHERALL SCOTT	O'NEILL JOSEPH	5518 MOONLIGHT GARDEN ST	LAS VEGAS NV 89130-4998		
289	12526410002	WITT FAMILY TRUST	WITT ROBERT L & JUDY A TRS	8712 BECKETT RIDGE AVE	LAS VEGAS NV 89149-4017		
290	12526410001	WITT RANDY L	5756 N RAINBOW BLVD	LAS VEGAS NV 89130-1247			
291	12535111022	YAMAMOTO YUMI L	FELLER JOHANN A	6621 GRAY JUNIPER AVE	LAS VEGAS NV 89130-4806		
292	12527815027	YEN KEVIN C & ELISE	618 S BROADWAY #B	REDONDO BEACH CA 90277			
293	12534514027	YENOR BECKY	5505 FLORA SPRAY ST	LAS VEGAS NV 89130-1695			
294	12527818001	YOGI HENRY	218 KONA PL	KAHULUI MAUI HI 96732			

CASE# GPA-58144 ZON-58146

	PARCEL#	OWNER	ADDRESS1	ADDRESS2	ADDRESS3	ADDRESS4	ADDRESS5
295	12527815050	YOGI HENRY SEICHI TRUST	YOGI HENRY S TRS	218 KONA PL	KAHULUI HI 96732		
296	12527815015	ZHOU CHONGYU	FANG DONGRUI	48 MONTEVIDEO CIR	FREMONT CA 94539-5350		
297	12526403014	ZINK TRUST	ZINK BARBARA E TRS	421 MILTON DR	SAN GABRIEL CA 91775-2822		
298	12527819058	ZITIELLO DOMINIC M	5665 BISHOP FLOWERS ST	LAS VEGAS NV 89130			