



Legal Notices Transmittal and Scanning Separator Sheet

Legal Notice Type: Legal Mailings

Date of Transfer to ERM: 10/15/2012

Page Count: 20

Meeting Date: 10/17/2012

Meeting Type: City Council <=>

Case Number(s): EOT-46607 <=>

Subject of Affidavit: APPLICANT/OWNER: LMP, LLC - 1966 North Rainbow Boulevard <=>

Record Series: Legal Notices

LRDA Number: 2007-1717

Retention: Permanent

File By: Meeting Date



Prepared By: sacrolli

Scanned By:

**SCANNED**

**OCT 16 2012**

QC By:

City of Las Vegas  
Office of City Clerk  
495 South Main Street, 2<sup>nd</sup> Floor  
Las Vegas, Nevada 89101

**Return Service Requested**  
**Official Notice of Public Hearing**

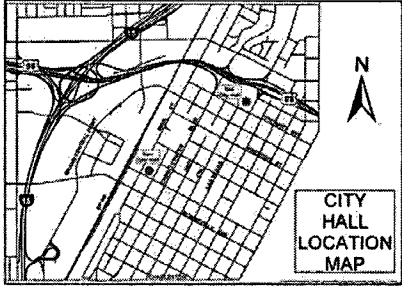

If you wish to file your protest or support on this request, check the appropriate box below and return this card in an envelope with postage to the Office Of The City Clerk at the address listed above or fax this side of this card to (702) 382-4803. If you would like to contact your Council Representative, please call (702) 229-6405.

I SUPPORT  
this Request

I OPPOSE  
this Request

Please use available blank space on card for your comments.

**EOT-46607**

City Council Meeting of **10/17/2012**

## Application Information

**EOT-46607 - NON-CONFORMING - PUBLIC HEARING - APPLICANT/OWNER: LMP, LLC** - For possible action on a request for an Extension of Time FOR A NON-CONFORMING NON-RESTRICTED GAMING ESTABLISHMENT at 1966 North Rainbow Boulevard (APN 138-23-301-002) C-1 (Limited Commercial) Zone, Ward 5 (Barlow).

## Application Location

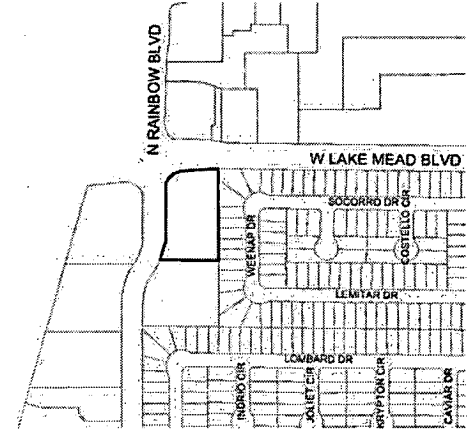

The proposed project may not pertain to the entire highlighted project site.

## Public Hearing Information

**Meeting:** City Council  
**Date:** *October 17, 2012*  
**Time:** 1:00 P.M.  
**Location:** City Council Chambers  
495 South Main Street  
Las Vegas, Nevada

Any and all interested persons may appear and be heard at said meeting, or may, prior thereto, file written objections thereto or approvals thereof with the City Clerk, 4th Floor, City Hall, 495 South Main Street, Las Vegas, Nevada, 89101. For further information, including the full staff report, please call (702) 229-6311 (TDD 386-9108) or go to <http://www.lasvegasnevada.gov>.

**Report of All Selected Parcels****Case Number:** EOT-46607**Printed On:** Mon: September 10, 2012

<u>Owner</u>	<u>Address</u>	<u>Parcel Number</u>
		13823213000
		13823210000
		13823212000
		13823214000
4 M'S 3 L L C	5531 BRITTANY ANN CT NO LAS VEGAS NV 89031-3541	13823311035
4 M'S 3 L L C	5531 BRITTANY ANN CT NO LAS VEGAS NV 89031-3541	13823311027
ABATO LYUBOV T	6500 W LAKE MEAD BLVD #123 BLDG B1 LAS VEGAS NV 89108-7030	13823214090
ABRAHAM'S DOOR L L C	1533 PONY RANCH CIR HENDERSON NV 89014-0349	13823210045
ADAMS LEWIS C	6576 LOMBARD DR LAS VEGAS NV 89108-2731	13823312004
ADKINS ELZINA B	8610 MUIRFIELD VILLAGE CT LAS VEGAS NV 89131-1748	13823212053
AGUINSKY RICHARD & ADRIANA	4394 MILLER AVE PALO ALTO CA 94306-4410	13823311002
AGUIRRE JESUS	6636 FREDONIA DR LAS VEGAS NV 89108-2721	13823410011
AKANA ALEXANDER Y S & VANESSA P	175 ULUPA ST KAILUA HI 96734-2355	13823212039
AKOP OJI	9438 TREBERT PL TUJUNGA CA 91042-3343	13823212060
ALBERS TRAVIS J	29 LAKEWOOD COVE N SPRUCE GROVE AB T7X 4B4 CANADA	13823210006
ALE-RODRIGUEZ ANGEL	REYES-ALVIZA VIVIAN 6592 SOCORRO DR LAS VEGAS NV 89108-2778	13823310013
ALEXANDER JOE T	NICHOLS RAMA R 2021 WILLOWBURY DR #C LAS VEGAS NV 89108-7060	13823213039
ALEXANDER WIMBERLY	HUNTER BILLY 6621 LEMITAR DR LAS VEGAS NV 89108-2760	13823310035
ALLEMAN ADELE M	P O BOX 26493 LAS VEGAS NV 89126-0493	13823210055
ALMENDRA ISMAEL	2110 BAVINGTON DR #A LAS VEGAS NV 89108-7087	13823212049
ALVARADO MARIA	2128 WILLOWBURY DR #D LAS VEGAS NV 89108-3490	13823210068
AN BAOFENG	%H YEZHENG 5191 PIONEER AVE #202 LAS VEGAS NV 89146-8193	13823310069
ANDERSON MICHAEL C & NANCY K	2136 WILLOWBURY DR #4D LAS VEGAS NV 89108-3493	13823210016
ANDERSON RONALD R	SCHRAMM STEVEN L 6589 LEMITAR DR LAS VEGAS NV 89108-2757	13823310043
ANG SAMSON C	ESTEY-ANG AUSTYN & ANDREW 28292 HARVEST VIEW LN TRABUCO CANYON CA 92679-1195	13823212028
AQUINO RENATO A & MARIANA V	1977 JAMES BILBRAY DR LAS VEGAS NV 89108-2769	13823310061
ARANDA MILAGRO HERNANDEZ	P O BOX 3302 BEVERLY HILLS CA 90212-0302	13823314028
ARCINIEGA-GRANADOS SALVADOR	6561 LEMITAR DR LAS VEGAS NV 89108-2756	13823310050
ARDMORE PRESS INC	%C SEPAHPOUR 2040 BAVINGTON DR #A LAS VEGAS NV 89108-7083	13823213005
ARNOLD BETTY J	2124 WILLOWBURY DR #8B LAS VEGAS NV 89108-3489	13823210030
ARNOLD JOHN & DAEDREON	6572 GAZELLE DR LAS VEGAS NV 89108-2753	13823314029
ARNOLD LAWRENCE J	2112 WILLOWBURY DR #C LAS VEGAS NV 89108-3484	13823212015

**Report of All Selected Parcels****Case Number:** EOT-46607**Printed On:** Mon: September 10, 2012

<u>Owner</u>	<u>Address</u>	<u>Parcel Numbe</u>
ARNOLD MARK L & JOLENE J	2116 WILLOWBURY DR #D LAS VEGAS NV 89108-3486	13823212020
ASHKHAN L L C	5625 N CHIEFTAIN ST LAS VEGAS NV 89149-2388	13823314032
ASHKHAN L L C	5625 N CHIEFTAIN ST LAS VEGAS NV 89149-2388	13823311010
AVINA-GUZMAN ALVARO	6568 SOCORRO DR LAS VEGAS NV 89108-2774	13823310007
B K B CAPITAL L L C	1707 VILLAGE CENTER CIR #170 LAS VEGAS NV 89134-0515	13823314042
BALL BRYAN A	DETERMAYER ANNA-KATHARINA A 6581 LEMITAR DR LAS VEGAS NV 89108-2757	13823310045
BANK AMERICA N A	400 NATIONAL WAY SIMI VALLEY CA 93065	13823210010
BANK DEUTSCHE NATIONAL TR CO TRS	400 NATIONAL WAY SIMI VALLEY CA 93065-6414	13823210046
BANKSTON LYNN D	2490 PASEO VERDE PKWY #100 HENDERSON NV 89074-7124	13823410001
BECK FAMILY LIVING TRUST	BECK GARY A & TERRY L TRS 5101 FUTURE DR LAS VEGAS NV 89130-0149	13823314021
BEHRENS CATHERINE	1917 INDRIO CIR LAS VEGAS NV 89108-2701	13823311039
BELL ALLAN M JR	2040 BAVINGTON DR #B LAS VEGAS NV 89108-7083	13823213006
BELLEQUE ROSE A & SHAWN	1916 HARVEST DR LAS VEGAS NV 89108-7774	13823311003
BERUMEN LUIS F & CONSUELO S	7724 BENTONITE CIR LAS VEGAS NV 89128-3824	13823314040
BIRKHOLZ JAY E & DEBRA	1956 WEENAP DR LAS VEGAS NV 89108-2781	13823310087
BLANCHETTE ROSALYN	2128 WILLOWBURY DR LAS VEGAS NV 89108-3490	13823210066
BLOSSER MARY JUNE	3817 EL CONLON AVE LAS VEGAS NV 89102-5861	13823210024
BOEDER JEROME PAUL	5560 MT DIABLO DR LAS VEGAS NV 89118-1933	13823314048
BOON TEW KIA	LEANG CHAN SIEW 27 JALAN SS 14 2D SUBANG JAYA 47500 PETALING JAYA SELANGOR MALAYSIA	13823310006
BOQUECOSA EDDIE	2112 BAVINGTON DR #D LAS VEGAS NV 89108-7088	13823212004
BOURASSA ALFRED J & LUCILLE Y	2120 WILLOWBURY DR #9A LAS VEGAS NV 89108-3487	13823210033
BOYACK EDWARD & HELEN	10237 SUNSET GARDENS DR LAS VEGAS NV 89135-2895	13823214095
BOYACK EDWARD D & HELEN	10237 SUNSET GARDENS DR LAS VEGAS NV 89135-2895	13823214069
BRAMLETT ROSINA TRACY & CHRIS R	9314 PENCIL CEDAR AVE LAS VEGAS NV 89149-0515	13823310062
BRAZIEL ALLEN II	6500 W LAKE MEAD BLVD #117 LAS VEGAS NV 89108-7030	13823214112
BREAUX CHARLES	2137 WILLOWBURY DR #A LAS VEGAS NV 89108-7065	13823210009
BRILL RON	6568 LEMITAR DR LAS VEGAS NV 89108-2755	13823310100
BROWN JOSHUA M & MARIA M	2104 WILLOWBURY DR #C LAS VEGAS NV 89108-3481	13823212031
BURKS LULA BELL	%A PARKINSON 1712 WESTMEADOW TRL ROUND ROCK TX 78665-1238	13823311053
BURNHAM ROBERT W IV	KANTRONG PATCHAREE 2036 BAVINGTON DR #C LAS VEGAS NV 89108-7002	13823213003
BURNS HUGH C LIVING TRUST	BURNS HUGH C TRS 871 N COTTAGE ST PORTERVILLE CA 93257-1587	13823210003

**Report of All Selected Parcels****Case Number:** EOT-46607**Printed On:** Mon: September 10, 2012

<u>Owner</u>	<u>Address</u>	<u>Parcel Number</u>
C A S TRUST	STONAKER CAROL A TRS 6664 FREDONIA DR LAS VEGAS NV 89108-2721	13823410004
CABRERA JOSE & BERTHA	MESINAS ANGELICA M 2116 BAVINGTON DR #A LAS VEGAS NV 89108-3469	13823212005
CAMPOS TEODULO	7337 WELLSFORD AVE WHITTIER CA 90606-2046	13823212065
CARBAUGH CHRISTOPHER J	ALSPAUGH CRYSTAL G 1936 HARVEST DR LAS VEGAS NV 89108-2729	13823311008
CARDENAS MAYRA	2516 RIALTO RD LAS VEGAS NV 89108	13823212043
CARR ALLEN D & KIRSTEN L	1829 SPRING SUMMIT LN LAS VEGAS NV 89134-2539	13823410010
CARR IRENE T & MICHAEL R	1916 JOLIET CIR LAS VEGAS NV 89108-2745	13823311036
CASPARY PAUL D	6656 W FREDONIA DR LAS VEGAS NV 89108-2721	13823410006
CASS ADRIENNE M	2041 CHERTSEY DR #A LAS VEGAS NV 89108-7086	13823213021
CASTELAN ANTONINO G	1949 WEENAP DR LAS VEGAS NV 89108-2782	13823310031
CAUDILL LAURA	2121 WILLOWBURY DR #A LAS VEGAS NV 89108-3488	13823210037
CEBRA ELLA M & MIKE	%H STUDER 311 MARKET ST GENOA IL 60135-1432	13823213036
CERVANTES ALICIA	6649 GAZELLE DR LAS VEGAS NV 89108-2724	13823314010
CHAFFEE GUY LEWIS & JANA L	5935 N CAMPBELL RD LAS VEGAS NV 89149-3323	13823212006
CHAMBERS ARNOLD B	6617 LEMITAR DR LAS VEGAS NV 89108-2760	13823310036
CHAN BOB	6500 W LAKE MEAD BLVD #209 BLDG A3 LAS VEGAS NV 89108-7031	13823214088
CHAN COREY T & RINA	838 CRYSTAL WATER LN WALNUT CA 91789-1464	13823310055
CHARASKA JOHN F	1981 WEENAP DR LAS VEGAS NV 89108-2784	13823310023
CHARASKA JOHN F	1981 WEENAP DR LAS VEGAS NV 89108-2784	13823310022
CHAVEZ DAVID	2140 BAVINGTON DR #A LAS VEGAS NV 89108-7091	13823210005
CHOMES WILLIAM & DOLORES	7848 TURTLE COVE AVE LAS VEGAS NV 89128-6728	13823214076
CITIMORTGAGE INC	1000 TECHNOLOGY DR MS 314 O FALLON MO 63368-2239	13823210053
CITY OF LAS VEGAS	400 STEWART AVE LAS VEGAS NV 89101-2913	13823312021
CITY OF LAS VEGAS	400 E STEWART LAS VEGAS NV 89101-2913	13823311030
CLEVELAND ROBERT E & T LIV TR	6644 GAZELLE DR LAS VEGAS NV 89108-2722	13823314044
COLLASO ERNESTINE LIVING TRUST	COLLASO ERNESTINE E TRS 2028 BAVINGTON DR #C LAS VEGAS NV 89108-7001	13823213055
COMER KEN E JR & MELINDA S	2021 WILLOWBURY DR #A LAS VEGAS NV 89108-7060	13823213037
CONROY MICHAEL L	GUINN SHEILA K 6641 GAZELLE DR LAS VEGAS NV 89108-2724	13823314012
COOK DAVID & NANCY M	1610 PROMONTORY RIDGE WY VISTA CA 92081-5432	13823214120
CORREA RICHARD	2104 BAVINGTON DR #B LAS VEGAS NV 89108-3465	13823212042
CORTEZ ESMERALDA	1916 KRYPTON CIR LAS VEGAS NV 89108-2746	13823312035
COSTA MARILYN & SAMUEL J	2120 WILLOWBURY DR #B LAS VEGAS NV 89108-3487	13823210034

**Report of All Selected Parcels****Case Number:** EOT-46607**Printed On:** Mon: September 10, 2012

<u>Owner</u>	<u>Address</u>	<u>Parcel Number</u>
COUCH PATRICIA H	2032 BAVINGTON DR #B LAS VEGAS NV 89108-7082	13823213050
COX MARGARET	2121 CHERTSEY DR #A LAS VEGAS NV 89108-3498	13823210025
CRABILL BETH A	6609 GAZELLE DR LAS VEGAS NV 89108-2724	13823314020
CREADEV MASTERS INC	P O BOX 98202 LAS VEGAS NV 89193-8202	13823312006
CRUŽ JOSE M	4324 S UNION AVE CHICAGO IL 60609-3459	13823310034
CUEVAS MARIA S	6632 LOMBARD DR LAS VEGAS NV 89108-2742	13823311018
CULWICK VICTORIA ABBOTT	1900 INDRIO CIR LAS VEGAS NV 89108-2701	13823311044
D B B T M B L L C	7701 RICARDO CT EL CERRITO CA 94530-3344	13823312027
DAI YI	3404 E TONI DR WESTCOVINA CA 91791-2335	13823311024
DALY BRUCE J & MICHAEL V	7421 BUSH GARDEN AVE LAS VEGAS NV 89129-5977	13823212038
D'AMBROSIO NICHOLAS J	7901 BASE CAMP AVE LAS VEGAS NV 89178-4840	13823214106
DAVID-DOMINGUEZ ABIGAIL	6596 LEMITAR DR LAS VEGAS NV 89108-2758	13823310093
DAVIS LAURA J	6637 GAZELLE DR LAS VEGAS NV 89108-2724	13823314013
DAVIS SPENCER G & LILIANA E	7041 BROWN DERBY CIR LAS VEGAS NV 89128-3424	13823310002
DAWSON LYNAL & MAUDIE	6556 SOCORRO DR LAS VEGAS NV 89108-2774	13823310004
DEAN SHARON A	2117 WILLOWBURY DR #C LAS VEGAS NV 89108-7062	13823212011
DEANTA ALFONSO	1960 WEENAP DR LAS VEGAS NV 89108-2781	13823310086
DECLARATION OF TRUST	BORGES DEBRA LEHUA M CO-TRS 6763 DOMINION CT LAS VEGAS NV 89103-4374	13823312002
DELOPEZ NANCY MORAN	1912 CAVIAR DR LAS VEGAS NV 89108-2750	13823312020
DEMAIDANA CLAUDIA S JAIME	P O BOX 34222 LAS VEGAS NV 89133-4222	13823410007
DENNIS LORI	6580 GAZELLE DR LAS VEGAS NV 89108-2753	13823314031
DESAUTELS ROGER & ROBERTA	58 LEXINGTON CLOSE LACOMBE ALBERTA T4L 2J3 CANADA	13823214074
DISABATO THOMAS E	6608 GAZELLE DR LAS VEGAS NV 89108-2722	13823314035
DISKIN RACHEL L	6585 LEMITAR DR LAS VEGAS NV 89108-2757	13823310044
DOLORFINO CECILIA	2112 BAVINGTOD DR #A LAS VEGAS NV 89108-7088	13823212001
DOOBIES BROTHERS L L C	%LOIC PILLON P O BOX 401613 LAS VEGAS NV 89140-1613	13823310038
DUBY EDWARD	2140 BAVINGTON DR #D LAS VEGAS NV 89108-3476	13823210008
DUOME WALTER T & MARIE	85-05 67 AVE REGO PARK NY 11374-5213	13823212041
EARLY SUSAN R	6560 SOCORRO DR LAS VEGAS NV 89108-2774	13823310005
ECKERT SCOTT B & K A REV TR	ECKERT SCOTT B & KATHLEEN A TRS 9358 SVL BOX VICTORVILLE CA 92395-5137	13823212057
EDWARDS BARBARA S	6557 LEMITAR DR LAS VEGAS NV 89108-2756	13823310051
EDWARDS BRENDA	2041 CHERTSEY DRIVE #D LAS VEGAS NV 89108-7086	13823213024

**Report of All Selected Parcels****Case Number:** EOT-46607**Printed On:** Mon: September 10, 2012

<u>Owner</u>	<u>Address</u>	<u>Parcel Number</u>
ELIYAHU IRIT	10284 DUNLEER DR LOS ANGELES CA 90064-4709	13823214082
ELLIOTT EMILY GAYLE	3411 BOSAL CT NO LAS VEGAS NV 89032-2466	13823214100
ENNIS RUSSELL & HEGMAN-ENNISS TR	HEGMAN-ENNISS PAULA L TRS 6653 GAZELLE DR LAS VEGAS NV 89108-2724	13823314009
ERICKSON MARILYN K	2041 WILLOWBURY DR #A LAS VEGAS NV 89108-7046	13823213009
ERJAVEC SPENCER TROY	1908 KRYPTON CIR LAS VEGAS NV 89108-2746	13823312033
ESCOBAR MARIA L	12824 VICTORY BLVD N HOLLYWOOD CA 91606-3013	13823212019
ESTA LOURDES RADOVAN	23-45 ALA WAI 2112 HONOLULU HI 96815-2906	13823310030
ESTEVEZ ANA & LUIS	1929 HARVEST LAS VEGAS NV 89108-2730	13823311050
EVERWIN INVESTMENT INC	2275 HUNTINGTON DR #309 SAN MARINO CA 91108-2640	13823214080
FARIAS HERIBERTO R & REBECA F	6560 LEMITAR DR LAS VEGAS NV 89108-2755	13823310102
FATEMI NOORALDIN N	6636 LOMBARD AVE LAS VEGAS NV 89108-2742	13823311017
FAULK LARRY K	6616 SOCORRO DR LAS VEGAS NV 89108-2775	13823310019
FAUVEL LESLIE ANNE	6118 ADA BLVD EDMONDON ALBERTA CANADA T5W4N9	13823312011
FEDERAL NATIONAL MORTGAGE ASSN	%IBM LENDER BUS PROCESS SERVS 14523 SW MILLIKAN WY #200 BEAVERTON OR 97005-2352	13823310095
FERNANDEZ FERNANDO U	1916 INDRIO CIR LAS VEGAS NV 89108-2701	13823311048
FIDELMAN JANET E TRUST	FIDELMAN JANET E TRS 2140-A WILLOWBURY DR LAS VEGAS NV 89108-3495	13823210017
FILUTZE MICHAEL M & BARBARA K	336 E 39TH ST BLVD ERIE PA 16504-2072	13823311019
FIORE MAUREEN C	2110 BAVINGTON DR #C LAS VEGAS NV 89108-3468	13823212051
FLORES JUAN M	1960 COSTELLO CIR LAS VEGAS NV 89108-2772	13823310066
FLOWERS TRACY	2040 WILLOWBURY #AE LAS VEGAS NV 89108-7360	13823213017
FONSECA MARY A	2036 WILLOWBURY DR #C LAS VEGAS NV 89108-7008	13823213015
FORD KYLE A	6668 LOMBARD DR LAS VEGAS NV 89108-2742	13823311009
FORT VICKIE A TRUST	FORT VICKIE A TRS 5701 JANELL DR LAS VEGAS NV 89149-4915	13823310053
FRANCO ANA	2120 WILLOWBURY DR #C LAS VEGAS NV 89108-3487	13823210035
FRELOT-HAYNES GENELL	2124 BAVINGTON DR #11C LAS VEGAS NV 89108-3471	13823210043
FRIEGANG ROBERT H & DIANE G	FRIEGANG JESSE 6500 W LAKE MEAD #125 BLDG #1 LAS VEGAS NV 89108-7030	13823214092
GAON JAIME P JR	1852 N DECATUR BLVD #201 LAS VEGAS NV 89108-2276	13823214093
GARBAN GRANT & KATHY	6657 GAZELLE DR LAS VEGAS NV 89108-2724	13823314008
GARCIA ANITA F REVOCABLE LIV TR	GARCIA ANITA F TRS 1957 WEENAP DR LAS VEGAS NV 89108-2782	13823310029
GARCIA BERNARDO J	1921 INDRIO CIR LAS VEGAS NV 89108-2701	13823311038
GARCIA LUIS	2036 WILLOW BURY DR #B LAS VEGAS NV 89108-7008	13823213014

**Report of All Selected Parcels****Case Number:** EOT-46607**Printed On:** Mon: September 10, 2012

<u>Owner</u>	<u>Address</u>	<u>Parcel Number</u>
GARCIA SALVADOR	6577 SOCORRO DR LAS VEGAS NV 89108-2779	13823310070
GARCIA-GONZALEZ BENJAMIN	2112 WILLOWBURY DR #D LAS VEGAS NV 89108-3484	13823212016
GARG DEVENDRA	JAIN YASHIKA 5764 CRESCENT LANDING LAS VEGAS NV 89113-0223	13823213058
GATCHALIAN NEBUCCHADNEZAR	1849 PINCHOT ST LAS VEGAS NV 89156-7127	13823410014
GAZELLE TRUST	%NEEDHAM LAW FIRM 3216 W CHARLESTON BLVD LAS VEGAS NV 89102-2044	13823314030
GESTAUTAS CESLOVAS	1128 20TH ST #2 SANTA MONICA CA 90403-5637	13823214081
GIANGIACOMO RONALD S & MARY LOU	35445 MONDAMIN DR EASTLAKE OH 44095-1913	13823210032
GILLES ROBERT A II & JANICE R	1904 KRYPTON CIR LAS VEGAS NV 89108-2746	13823312032
GILLIANA ALLEN	3149 FLUSHING MEADOWS MODESTO CA 95355-8437	13823210050
GLAZE NIJOLE	1953 ERIN WY GLENDALE CA 91206-1007	13823214108
GLAZE NIJOLE	1953 ERIN WY GLENDALE CA 91206-1007	13823214117
GLEN CHRISTOPHER R	6500 W LAKE MEAD BLVD #104 BLDG A2 LAS VEGAS NV 89108-7030	13823214073
GOLDENBERG FAMILY TRUST	GOLDENBERG ALEXANDER & CIMA TRS 5936 INDIAN POINTE DR SIMI VALLEY CA 93063-5762	13823214116
GONZALEZ DIANA ETAL	6604 GAZELLE DR LAS VEGAS NV 89108-2722	13823314034
GONZALEZ JULIE	2028 WILLOWBURY DR #C LAS VEGAS NV 89108-7006	13823213063
GONZALEZ MAYELIN	6572 LEMITAR DR LAS VEGAS NV 89108-2758	13823310099
GONZALEZ OCTAVIO I	6553 LEMITAR DR LAS VEGAS NV 89108-2756	13823310052
GOODNER GROVER S JR & JANE D	2024 WILLOWBURY DR #A LAS VEGAS NV 89108-7061	13823213029
GRAHAM BONNIE J	JOHNSON JAMES R 1921 KRYPTON CIR LAS VEGAS NV 89108-2746	13823312025
GREEN MICHELE	GREEN SILAS W & GAYLE E P O BOX 25865 HONOLULU HI 96825-0865	13823212056
GREENE RICHARD T & THERESA Y	2133 WILLOWBURG DR #D LAS VEGAS NV 89108	13823210060
GROSS RHONDA S	2141 CHERTSEY DR #B LAS VEGAS NV 89108-7095	13823210022
GRUBER DENIS R	GRAHAM LINDA L 6572 LOMBARD DR LAS VEGAS NV 89108-2731	13823312005
GRUBER FRANCIS X	266 CLEARFIELD WILLIAMSVILLE NY 14221-2336	13823311033
GUALAZZINI UGO	%M DELACRUZ P O BOX 33053 LAS VEGAS NV 89133-3053	13823214114
GUERRERO JUAN	6588 SOCORRO DR LAS VEGAS NV 89108-2778	13823310012
GUERRERO PATRICIA	GALVAN ZUHEY 6648 GAZELLE DR LAS VEGAS NV 89108-2722	13823314045
GURLITZ ALLEN	1908 CAVIAR DR LAS VEGAS NV 89108-2750	13823312019
GUTIERREZ GARIBALDI & ASCENSION	6612 SOCORRO DR LAS VEGAS NV 89108-2775	13823310018
GUZMAN ALBERTO	6629 LEMITAR DR LAS VEGAS NV 89108-2760	13823310033
GUZMAN VERONICA A & JOSE F	6616 LOMBARD DR LAS VEGAS NV 89108-2742	13823311022
H P T M I I I PROPERTIES TRUST	%MARRIOTT BUSINESS SERV %PPTY TAX DEPT P O BOX 579 LOUISVILLE TN 37777-0579	13822713006

**Report of All Selected Parcels****Case Number:** EOT-46607**Printed On:** Mon: September 10, 2012

<u>Owner</u>	<u>Address</u>	<u>Parcel Number</u>
HAIDUK STANLEY & JUDITH M	148 COOPER RD DOVER DE 19901-4926	13823210041
HANAOKA JENNIE	12888 SUNDOWN LN CHINO HILLS CA 91709-1011	13823210026
HARE EDWIN A & JENNIE L	6600 GAZELLE DR LAS VEGAS NV 89108-2722	13823314033
HARENBERG TANYA	2200 LESTER DR NE #370 ALBUQUERQUE NM 87112-2635	13823213047
HARO EDUARDO & CLEMENTINA	2111 E 4TH ST LONG BEACH CA 90814-1004	13823312029
HARO ORACIO	638 W LAXFORD ST GLENDORA CA 91740-5439	13823314036
HARRELL FREDRIC W	6668 FREDONIA DR LAS VEGAS NV 89108-2721	13823410003
HART DONALD & THERESA	2040 WILLOWBURY DR #C LAS VEGAS NV 89108-7085	13823213019
HAVERTY JOHN JAMES & HELEN B	6604 SOCORRO DR LAS VEGAS NV 89108-2775	13823310016
HEALEY WILLIAM F LIVING TRUST	HEALEY WILLIAM F TRS 84 SUNLIT DR W SANTA FE NM 87508	13823213022
HEATH EDDIE L	2109 CHERTSEY DR #D LAS VEGAS NV 89108-3497	13823212068
HEISER PATRICK W	2132 WILLOWBURY DR #C LAS VEGAS NV 89108-3491	13823210063
HEMMINGMOORE HEATHER HENRIETTA	340 S LEMON AVE #8088N WALNUT CA 91789-2706	13823314005
HENTGES JEFF	6624 GAZELLE DR LAS VEGAS NV 89108-2722	13823314039
HERNANDEZ MANUEL	6673 GAZELLE DR LAS VEGAS NV 89108-2724	13823314004
HERNANDEZ-LOPEZ DELMI	1900 JOLIET CIR LAS VEGAS NV 89108-2745	13823311032
HIBDON RONALD L & PATSY E FAM TR	HIBDON RONALD L & PATSY E TRS 6608 LEMITAR DR LAS VEGAS NV 89108-2759	13823310090
HOLGATE BRIAN E	1920 INDRIO CIR LAS VEGAS NV 89108-2701	13823311049
HOLLIDAY EARL D & SHEILA FAM TR	HOLLIDAY EARL D & SHEILA V TRS 6608 SOCORRO DR LAS VEGAS NV 89108-2775	13823310017
HSU JUDY M	2953 CLOWN BLUFFS CT LAS VEGAS NV 89117-2577	13823214085
HUERTA MARIA G	2124 BAVINGTON DR #D LAS VEGAS NV 89108-7090	13823210044
HUGHES LARRY	7233 BOYD LN LAS VEGAS NV 89131-2504	13823311026
HUPP ERIC L & CAROLE A	207 SHAGBARK DR WESTERVILLE OH 43081-4532	13823212035
HUTCHESON WILLIAM F & JOSEPHINE	1972 WEENAP DR LAS VEGAS NV 89108-2783	13823310083
ILARIO DANIEL	5406 INDIAN HILLS DR SIMI VALLEY CA 93063-2033	13823212067
IXTA JORGE	1952 WEENAP DR LAS VEGAS NV 89108-2781	13823310088
J A S TRUST	VOLLAND SABRINA TRS 3120 W CAREFREE HWY #I-536 PHOENIX AZ 85086-3201	13823212010
J G R I M M L L C	8555 W SAHARA #240 LAS VEGAS NV 89117-1819	13823314003
JACKSON LACY R	1977 WEENAP DR LAS VEGAS NV 89108-2784	13823310024
JACKSON MARCIE	2121 WILLOWBURY DR #B LAS VEGAS NV 89108-3488	13823210038
JACKSON RICHARD	1913 INDRIO CIR LAS VEGAS NV 89108-2701	13823311040
JAIME CLAUDIA SOLEDAD	P O BOX 34222 LAS VEGAS NV 89133-4222	13823314047

**Report of All Selected Parcels****Case Number:** EOT-46607**Printed On:** Mon: September 10, 2012

<u>Owner</u>	<u>Address</u>	<u>Parcel Number</u>
JAIN YASHIKA	GARG BINNY 5764 CRESCENT LANDING LAS VEGAS NV 89113-0223	13823210059
JEAN MARK	1705 REDESDALE AVE LOS ANGELES CA 90026-1211	13823310064
JENKINS MARIANN E	1209 WIGWAM ST MESQUITE NV 89027-6708	13823213011
JERMAC	%LAS VEGAS ATHLETIC CLUB 2655 S MARYLAND PKWY #201 LAS VEGAS NV 89109-1646	13822812001
JEROMIN JOHN & SHERYL	4835 CEDAR LN BLAINE WA 98230-9687	13823213035
JIMENEZ LISA M	6652 LOMBARD DR LAS VEGAS NV 89108-2742	13823311013
JOHANSSON LARRY	2121 WILLOWBURY DR #C LAS VEGAS NV 89108-3488	13823210039
JOHANSSON RHONDA	2141 CHERTSEY DR #B LAS VEGAS NV 89108-7095	13823210049
JOHANSSON RHONDA S	2141 CHERTSEY DR #B LAS VEGAS NV 89108-7095	13823212009
JOHNSON BARBARA	1961 CLOVIS CIR LAS VEGAS NV 89108-2771	13823310077
JOHNSON GLENN ETAL	2118 6TH ST N CRANBROOK BC V1C 5E2 CANADA	13823214067
JOHNSON JESSE W	340 E 64TH ST #15K NEW YORK NY 10065-0059	13823214096
JOHNSON THEODORE U & VICKIE E	6500 W LAKE MEAD BLVD #216 LAS VEGAS NV 89108-7031	13823214119
JOHNSON VERA	2120 BAVINGTON DR #C LAS VEGAS NV 89108-3470	13823210047
JONES FRANK	1610 WILLOWGATE DR SAN JOSE CA 95118-1658	13823310084
JONES WALTER T	320 CITY CENTER DR ROHNERT PARK CA 94928-2176	13823212023
JOYA JOSE FERNANDO	6500 W LAKE MEAD BLVD #229 LAS VEGAS NV 89108-7031	13823214104
KALINOV HAKAN	6613 GAZELLE DR LAS VEGAS NV 89108-2724	13823314019
KAMBER SIMON	2804 W ESTES CHICAGO IL 60645-2904	13823214109
KAMEENUI HARRY H K REVOCABLE TR	KAMEENUI KAREN U REVOCABLE TRUST 1242 LUNALILO HOME RD HONOLULU HI 96825-3202	13823212058
KAPUSTINA ELENA N	2040 WILLOWBURY DR #D LAS VEGAS NV 89108-7085	13823213020
KAVIANI JAVAD	2451 N RAINBOW BLVD #2040 LAS VEGAS NV 89108-4510	13823310021
KELL RICHARD & VIRGINIA	P O BOX 798 SEASIDE OR 97138-0798	13823212007
KELLY RAYMOND W	6605 SOCORRO DR LAS VEGAS NV 89108-2777	13823310080
KESHISHIAN SERJIK	1932 HARVEST DR LAS VEGAS NV 89108-2729	13823311007
KILBURG MARY V & JOHN A JR	5916 GLEN EAGLES LN LAS VEGAS NV 89108-1552	13823212044
KILGORE EVA S	16971 CONCORD LN HUNTINGTON BEACH CA 92649-4203	13823213052
KING JEFFERY M	2100 WILLOWBURY DR #B LAS VEGAS NV 89108-3479	13823212034
KIRK DAVID W & THERESA	6576 LEMITAR DR LAS VEGAS NV 89108-2758	13823310098
KIZNIS ZYGIMANTAS & MONIKA	1953 ERIN WAY GLENDALE CA 91206-1007	13823214087
KLOS BLAINE	2564 PLAENTINA ST HENDERSON NV 89044-4420	13823212054
KONG CHERYL CHUN REV LIV TR ETAL	KONG MELVIN KUI T & CHERYL C TRS 2318 KAALA ST HONOLULU HI 96822-2201	13823213044

**Report of All Selected Parcels****Case Number:** EOT-46607**Printed On:** Mon: September 10, 2012

<u>Owner</u>	<u>Address</u>	<u>Parcel Number</u>
KRUDO AVRAHAM	1316 CALLE MONTEREY LAS VEGAS NV 89117-6695	13823310081
KUNITAKE CHESTER C & JUDITH S	1815 ALA AOLANI ST HONOLULU HI 96819-1416	13823213038
L B PROPERTIES SECOND L L C	%M/M L LONG P O BOX 80282 LAS VEGAS NV 89180-0282	13823312001
L M 2009 TRUST	MAYOROVA LIUDMILA A TRS 6500 W LAKE MEAD BLVD #215 LAS VEGAS NV 89108-7031	13823214118
L M P L L C	8090 S DURANGO DR #115 LAS VEGAS NV 89113-4427	13823301002
LAM WARREN	6597 LEMITAR DR LAS VEGAS NV 89108-2757	13823310041
LANDOVSKY ROSEMARY R	2124 BAVINGTON DR #B LAS VEGAS NV 89108-7089	13823210042
LANE DAVID S & MICHELE	1928 CAVIAR DR LAS VEGAS NV 89108-2751	13823312024
LARE HOLDINGS L L C	1900 PREMIER CT ANCHORAGE AK 99502-1113	13823212059
LARSON GEORGE LOUIS	5142 CANOGA AVE WOODLAND HILLS CA 91364-3211	13823212055
LEAVITT SCOTT & ELLEN	1961 WEENAP DR LAS VEGAS NV 89108-2784	13823310028
LEE KUN CHIH	WANG BEI 2101 CHERTSEY DR #B LAS VEGAS NV 89108-3496	13823212026
LEE MI YOUNG & KYUNG UK	33240 45TH WY S AUBURN WA 98001-5149	13823213034
LEIGH WESLEY	264 S LA CIENEGA BLVD #1097 BEVERLY HILLS CA 90211-3302	13823214079
LEONARD MICHAEL R & DIANA	6601 GAZELLE DR LAS VEGAS NV 89108-2724	13823314022
LEVESQUE MARY GERACI	168 SOUTHWIND DR PLEASANT HILL CA 94523-1069	13823311006
LEVINE DOLORES E TRUST	LEVINE DOLORES E TRS 2031 WILLOWBURY DR #A LAS VEGAS NV 89108-7045	13823213057
LEVIT GENNADY & BETSY	6042 DELPHI ST LOS ANGELES CA 90042	13823312030
LI YAN & LIAN GANG	6369 CORAL FLOWER CT LAS VEGAS NV 89141-8515	13823311045
LITOWSKY MIRIAM & CHAVA	1901 INDRIO CIR LAS VEGAS NV 89108-2701	13823311043
LOGAN FRED R & DELILAH E	11 ANDREW RD AMERICAN CANYON CA 94503-1104	13823214113
LONG ANTHONY LEE KOK	EILEEN TAN HWEE PHENG BLOCK 108C #15-216 MCNAIR ROAD SINGAPORE 324108 SINGAPORE	13823312034
LOPEZ MARCOS	FIGUEROA YURIDIA 1976 WEENAP DR LAS VEGAS NV 89108-2783	13823310082
LOPEZ ROGELIO C	2957 CHANNEL BAY LAS VEGAS NV 89128-7288	13823212045
LOSS MARCY S	2112 BAVINGTON DR #B LAS VEGAS NV 89108-7088	13823212002
LPSK ENTERPRISES L L C	%H SPRINGHART 8656 BIG SAGEBRUSH AVE LAS VEGAS NV 89117-1043	13823213030
LUCAS MANUEL A	8356 GARNET CANYON LN LAS VEGAS NV 89129-4896	13823311015
LUONG QUYEN	2108 WILLOWBURY DR #A LAS VEGAS NV 89108-3482	13823212061
M E A I L L C	500 MERSEYSIDE DR LAS VEGAS NV 89178-1243	13823311041
MABIN EDWARD W & DARLIS	4016 MOUNTAIN TREK LAS VEGAS NV 89129-3668	13823212032
MADRID FATIMA	2024 WILLOWBURY DR #D LAS VEGAS NV 89108-7061	13823213032

**Report of All Selected Parcels****Case Number:** EOT-46607**Printed On:** Mon: September 10, 2012

<u>Owner</u>	<u>Address</u>	<u>Parcel Number</u>
MANCUSO-COTTEN MARY V TRUST	MANCUSO-COTTEN MARY V TRS 3508 WINTERHAVEN ST #101 LAS VEGAS NV 89108-5045	13823213008
MANSON LISA	1913 JOLIET CIR LAS VEGAS NV 89108-2745	13823311028
MARENTES-CASILLAS FRANCISCO J	RAMOS ANDREA MARTINEZ 2024 BAVINGTON DR #B LAS VEGAS NV 89108-7081	13823213042
MARINO MICHAEL	2124 WILLOWBURY DR #A LAS VEGAS CA 89108-7063	13823210029
MARKYM PROPERTY INDUSTRIES L L C	97 JOLINE AVE LONG BRANCH NJ 07740-7430	13823210054
MARSHALL RENEE	2028 BAVINGTON DR LAS VEGAS NV 89108-7035	13823213053
MARTIN ERNEST D	2041 WILLOWBURY DR #B LAS VEGAS NV 89108-7046	13823213010
MARTIN JONATHAN T	PERKINS-MARTIN LAURA E 3809 ROSE CANYON DR NO LAS VEGAS NV 89032-3166	13823212025
MARTIN MICHAEL T	2031 CHERTSEY DR #A LAS VEGAS NV 89108-7010	13823213065
MARTINEZ JAVIER & MARITZA	3954 COYOTE BRUSH CT LAS VEGAS NV 89129-8243	13823410009
MARTINEZ LIDIA	6621 GAZELLE DR LAS VEGAS NV 89108-2724	13823314017
MARTY-VEDANIA JOHN	6557 SOCORRO DR LAS VEGAS NV 89108-2776	13823310063
MARWAHA ASHOK K & NEETI	824 S CALLE VENADO ANAHEIM CA 92807-5004	13823212050
MASSEY TERESA DEANN	2028 BAVINGTON DR #D LAS VEGAS NV 89108-7001	13823213056
MASUDA FAMILY TRUST-U C R TRUST	MASUDA NORMA S TRS 1201 W 185TH ST GARDENA CA 90248-4023	13823311052
MATA-REYES VICTOR	1961 BILBRAY DR LAS VEGAS NV 89108-2769	13823310057
MATULE DANIEL & A REV LIV TRUST	MATULE DANIEL M & ANNABEL P TRS 604 BLUE YUCCA ST LAS VEGAS NV 89144-4569	13823314014
MCDOWELL MICHELLE S	1920 HARVEST DR LAS VEGAS NV 89108-2729	13823311004
MCINERNEY DANIEL J	14500 DALLAS PKWY #1171 DALLAS TX 75254-8329	13823213004
MCKAY THOMAS R	2136 WILLOWBURY DR #B LAS VEGAS NV 89108-7064	13823210014
MCMURRAY JOHN J	2112 BAVINGTON DR #C LAS VEGAS NV 89108-7088	13823212003
MEINHOLD JUDITH M & ELIZABETH	2020 BAVINGTON DR #D LAS VEGAS NV 89108-7000	13823213048
MEKONNEN ELIYAS	2128 WILLOWBURY DR #C LAS VEGAS NV 89108-3490	13823210067
MENDEZ AGNES & AGNES J	1925 HARVEST DR LAS VEGAS NV 89108-2730	13823311051
MENDOZA-BERNAL JORGE	BERNAL PATRICIA 6593 SOCORRO DR LAS VEGAS NV 89108-2780	13823310074
METZGER EDWARD & CHERYL	10233 CLARK WOOLDRIDGE CT LAS VEGAS NV 89129-5003	13823214086
METZGER EDWARD & CHERYL	10233 CLARK WOOLDRIDGE CT LAS VEGAS NV 89129-5003	13823214121
MILLAN JORGE	2112 WILLOWBURY DR #A LAS VEGAS NV 89108-3484	13823212013
MILMAN ARABELLA	4733 HASKELL AVE #30 ENCINO CA 91436-1658	13823214075
MINUTEMAN PROPERTIES L L C	3828 KOHLER WY NO LAS VEGAS NV 89032-0439	13823210007
MITCHELL MAUREEN E	1901 JOLIET CIR LAS VEGAS NV 89108-2745	13823311031
MONTEITH JENNIFER L	2141 CHERTSEY DR #C LAS VEGAS NV 89108-7095	13823210023

**Report of All Selected Parcels****Case Number:** EOT-46607**Printed On:** Mon: September 10, 2012

<u>Owner</u>	<u>Address</u>	<u>Parcel Numbe</u>
MORENO LAURA	6661 GAZELLE DR LAS VEGAS NV 89108-2724	13823314007
MUN POKNOK & CYLVIA YUNJA	6600 SOCORRO DR LAS VEGAS NV 89108-2775	13823310015
MUNOZ RENE	1920 KRYPTON CIR LAS VEGAS NV 89108-2746	13823312036
MYERS ANDREW J LIVING TRUST	MCKENNA KAREN & DUSTIN %N DUNCAN 3430 E RUSSELL RD #301-22 LAS VEGAS NV 89120-2201	13823210013
NAMUO ALVIN & WINONA	6500 W LAKE MEAD BLVD #227 LAS VEGAS NV 89108-7031	13823214102
NEIGHBORHOOD STABILIZATION PRGM	CITY OF LAS VEGAS 400 STEWART AVE LAS VEGAS NV 89101-2913	13823310065
NEON PROPERTIES L L C	8337 W SUNSET RD #150 LAS VEGAS NV 89113-2201	13823311021
NEW PRIVATE RESTAURANT PPTYS LLC	%N O'HALLORAN %O'HALLORAN RYAN L L P 711 THIRD AVE 20TH FLR NEW YORK NY 10017-4031	13823301004
NEWSOM MARJORIE L TRUST	NEWSOM MARJORIE L TRS 2032-C BAVINGTON DR LAS VEGAS NV 89108-7082	13823213051
NICHOLAS VERNON JOSEPH III	2108 WILLOWBURY DR #D LAS VEGAS NV 89108-3482	13823212064
NIE ZHONG BIN	HAN LI JUAN 532 E FAIRMOUNT RD BURBANK CA 91501-1708	13823214068
NIP RUBY C TRUST	NIP RUBY C TRS 810 RICHARDS ST #633 HONOLULU HI 96813-4714	13823213043
NOLAN JOHN C & FRANCESCA C	3750 UNIVERSITY AVE #250 RIVERSIDE CA 92501-3335	13823212040
NORDYKE KATHY	6552 SOCORRO DR LAS VEGAS NV 89108-2774	13823310003
NUDD DOREEN L	6628 FREDONIA DR LAS VEGAS NV 89108-2721	13823410013
OBRIEN JAMES F & JANICE M	2104 WILLOWBURY DR #8A LAS VEGAS NV 89108-3481	13823212029
OGANESIAN MIKHAEL	2255 24TH AVE SAN FRANCISCO CA 94116	13823214062
O'GRADY JOEL	2041 CHERTSEY DR #C LAS VEGAS NV 89108-7086	13823213023
OGURO THOMAS M & LORRAINE R	2261 WILSON ST HONOLULU HI 96819-3637	13823310073
OLIVIER DARRYL E	2117 CHERTSEY DR #B LAS VEGAS NV 89108-7094	13823212022
OLSON HOWARD W & MARY L	2020 WILLOWBURY DR #A LAS VEGAS NV 89108-7003	13823213033
ORION 6 PROPERTY INVEST L L C	9030 W SAHARA #229 LAS VEGAS NV 89117-5744	13823310049
ORION 6 PROPERTY INVESTMENTS LLC	9030 W SAHARA BLVD #229 LAS VEGAS NV 89117-5744	13823213049
ORSO-CHANG BRANDON	3316 ATTERBERRY LN LAS VEGAS NV 89117-0737	13823210031
OSTROWSKI 1991 TRUST	OSTROWSKI ANN M TRS 6564 LEMITAR DR LAS VEGAS NV 89108-2755	13823310101
OVREBO MARK E & DEIDRE MARIE	2608 CATHEDRAL LN LAS VEGAS NV 89108-4447	13823310058
PALLA VITA CHRISTINE LIVING TR	PALLA VITA CHRISTINE TRS 2041 WILLOWBURY DR #D LAS VEGAS NV 89108-7046	13823213012
PANGELINAN SURVIVORS TRUST	PANGELINAN THOMAS T TRS 107 LARKWOOD CIR DANVILLE CA 94526-3029	13823214099
PAPPAS STEVEN D & GINA M	10320 TOWER RIDGE AVE LAS VEGAS NV 89129-8124	13823213041
PAPPAS STEVEN D & GINA M	10320 TOWER RIDGE AVE LAS VEGAS NV 89129-8124	13823213026
PARK JONG SOUK	6600 LEMITAR DR LAS VEGAS NV 89108-2759	13823310092

**Report of All Selected Parcels****Case Number:** EOT-46607**Printed On:** Mon: September 10, 2012

<u>Owner</u>	<u>Address</u>	<u>Parcel Numbe</u>
PARKIN CHARLES & LORRAINE	2021 CHERTSEY DR #D LAS VEGAS NV 89108-7009	13823213028
PATTERSON JO BETH	2136 BAVINGTON DR #1B LAS VEGAS NV 89108-3474	13823210002
PENNY GAIL C	2100 WILLOWBURY DR #A LAS VEGAS NV 89108-3479	13823212033
PEREZ FAMILY TRUST	PEREZ LUCY TRS 5798 BEACON HILL ST LAS VEGAS NV 89120-3445	13823210065
PERUCH NATHAN & RACHAEL W	2040 WILLOWBURY DR #B LAS VEGAS NV 89108-7085	13823213018
PETEFISH TIMOTHY G	1904 HARVEST DR LAS VEGAS NV 89108-7774	13823314001
PETERSEN MARSHA	2036 WILLOWBURY DR #A LAS VEGAS NV 89108-7084	13823213013
PETRILLO MARGARET MCNEAL	2028 WILLOWBURY DR #B LAS VEGAS NV 89108-7006	13823213062
PHAN ALLYSON	P O BOX 230922 LAS VEGAS NV 89105-0922	13823210001
PHILLIPS THERESA S LIVING TRUST	2101 WILLOWBURY DR #A LAS VEGAS NV 89108-3480	13823212037
PK I RAINBOW PROMENADE L L C	3333 NEW HYDE PARK DR NEW HYDE PARK NY 11042-1204	13822603001
PLANO DONALD & LORETTA	HARO ORACIO 638 W LAXFORD ST GLENDORA CA 91740-5439	13823311034
PLANO LORETTA L	13437 CUMBERLAND PL FONTANA CA 92336-5449	13823311029
PLUMMER BENJAMIN	RUEDENAUER-PLUMMER HEIKE 1973 JAMES BILBRAY DR LAS VEGAS NV 89108-2769	13823310060
PRICE ROBERTA G	6564 LOMBARD DR LAS VEGAS NV 89108-2731	13823312007
QIU WEI	2021 CHERTSEY DR BLDG 7 #A LAS VEGAS NV 89108-7135	13823213025
QUEMUEL RUFO JR	3501 KETCH AVE OXNARD CA 93035-3132	13823212017
QUISPE GONZALO	6613 LEMITAR DR LAS VEGAS NV 89108-2760	13823310037
RAMIREZ ABRIL	6556 LEMITAR DR LAS VEGAS NV 89108-2755	13823310103
RAMOS SARAY & ADOLFO JR	RAMOS CARIDAD 6544 SOCORRO DR LAS VEGAS NV 89108-2774	13823310001
RANSOM ROBERT J & HEATHER A	6580 LOMBARD DR LAS VEGAS NV 89108-2731	13823312003
RAYA CARMEN	6601 LEMITAR DR LAS VEGAS NV 89108-7728	13823310040
RECINOS MONICA N	6672 FREDONIA DR LAS VEGAS NV 89108-2721	13823410002
RENTERIA JUAN	6581 SOCORRO DR LAS VEGAS NV 89108-2780	13823310071
RENZETTI MICHAEL P & DONNA M	45 SAMUEL DR NORTH GRAFTON MA 01536-1137	13823212018
RESKA STEPHEN G & JOANNE M	34 RUSSET RD BILLERICA MA 01821-3148	13823212062
RESTAURANT ROW L L C	%SEARS ROEBUCK & CO %W MYERS 3333 BEVERLY RD #B2-214-B HOFFMAN ESTATES IL 60192-3322	13822713004
RESTAURANT ROW L L C	3903 BELLAIRE BLVD HOUSTON TX 77025-1119	13822713002
RESTAURANT ROW L L C	%NEVADA STATE BANK %D HOLT P O BOX 990 LAS VEGAS NV 89125-0990	13822713005
RESTAURANT ROW L L C	%RESTAURANT MANAGEMENT CO 3514 N POWER RD #121 MESA AZ 85215-2909	13822713003
REYES EFREN P & ROSEMARIE	OPTIMUM ENTERPRISES L L C 29116 SMOKEWOOD DR MURIETTA CA 92563-2729	13823311023

**Report of All Selected Parcels****Case Number:** EOT-46607**Printed On:** Mon: September 10, 2012

<u>Owner</u>	<u>Address</u>	<u>Parcel Number</u>
REYES GERARDO JERRY & MELSINA G	1957 JAMES BILBRAY DR LAS VEGAS NV 89108-2769	13823310056
RHODE KATHLEEN A	1965 CLOVIS CIR LAS VEGAS NV 89108-2771	13823310078
RHODES GAYLOR	6616 FREDONIA DR LAS VEGAS NV 89108-2721	13823410016
RHODES PAULA R	2040 BAVINGTON DR #C LAS VEGAS NV 89108-7083	13823213007
RICE LLOYD W & MARILYN J	2024 WILLOWBURY DR #C LAS VEGAS NV 89108-7061	13823213031
RIGNANESI BRENT & IRENE	BOX 2 SITE 6 RI CARVEL AB TOE 0H0 CANADA	13823210020
RIGNANESI BRENT & IRENE	BOX 2 SITE 6 RR1 CARVEL AB T0E 0H0 CANADA	13823212030
RITCHIE RICHARD CHARLES & LESLEY	7261 201B ST LANGLEY BC CANADA V2Y 3G4	13823213040
ROBERTS ANDRE D	6500 W LAKE MEAD BLVD BLDG A2 #103 LAS VEGAS NV 89108-7346	13823214072
ROBINSON PATRICIA MARIE WALLACE	101 LAFAYETTE AVE #3J BROOKLYN NY 11217-1639	13823212036
ROCHA ENRIQUE V	4812 APAWUNA LN LAS VEGAS NV 89108-1300	13823214070
ROGERS EDDIE	PLUMBERG RICKEY J 94-495 KIILANI ST MILILANI HI 96789-2226	13823213045
ROJAS JORGE	CORONA-PEREZ HEIMI 1965 COSTELLO CIR LAS VEGAS NV 89108-2773	13823310068
ROLLINS MARJORIE V REV TR AGMT	ROLLINS MARJORIE V TRS 3600 CONSHOHOCKEN AVE #1712 PHILADELPHIA PA 19131-5332	13823312028
ROSALES JULIA	6648 FREDONIA DR LAS VEGAS NV 89108-2721	13823410008
ROSS RICK	1908 INDRIO CIR LAS VEGAS NV 89108-2701	13823311046
ROZWOD PETER J	6645 GAZELLE DR LAS VEGAS NV 89108-2724	13823314011
RUBIO RODOLFO	6620 GAZELLE DR LAS VEGAS NV 89108-2722	13823314038
RUBIO ROSALINA	1964 CLOVIS CIR LAS VEGAS NV 89108-2770	13823310075
RUEMMELE PATRICIA ANN LIVING TR	4301 SHANNON VALLEY AVE NO LAS VEGAS NV 89031-0232	13823311012
RYALS DAVID E	6632 GAZELLE DR LAS VEGAS NV 89108-2722	13823314041
SABA LEAR L L C	7440 CASTILLO PEAK ST LAS VEGAS NV 89139-5518	13823310094
SABO JOHN JR & BETTY M	2132 BAVINGTON DR #13D LAS VEGAS NV 89108-3473	13823210052
SACDALAN FERNANDO & ADELA	2005 S E CESAR E CHAVEZ BLVD PORTLAND OR 97214-5911	13823310020
SALZANO SERGIO & CHERYL FAM TR	SALZANO SERGIO & CHERYL TRS 4935 BUCKHORN BUTTE CT LAS VEGAS NV 89149-5259	13823310026
SANTANA REUBEN P & CHRISTINE D	1512 W RAMONA RD ALHAMBRA CA 91803-3934	13823310089
SAUCEDA ERMA M	2109 CHERTSEY DR #B LAS VEGAS NV 89108-3497	13823212066
SCHMIDT ALLEN L ETAL	200 BUNDY ST HENDERSON NV 89074-5400	13823212012
SEATON MARY E	2137-C WILLOWBURY DR LAS VEGAS NV 89108-7065	13823210011
SEDILLO AZTLAN S	TENNANT MELODY K 8237 FAWN HEATHER CT LAS VEGAS NV 89149-4515	13823310079
SEPULVEDA SANTIAGO & MARIA F	2205 CANTERBURY AVE POMONA CA 91768-1010	13823310009
SHADDOCK ELAINE G	2116-D BAVINGTON DR LAS VEGAS NV 89108-3469	13823212008

**Report of All Selected Parcels****Case Number:** EOT-46607**Printed On:** Mon: September 10, 2012

<u>Owner</u>	<u>Address</u>	<u>Parcel Number</u>
SHARA REALTY INVESTMENTS L L C	848 N RAINBOW BLVD #455 LAS VEGAS NV 89107-1103	13823312008
SHEPHEARD JOHN T & DORLA T	6605 LEMITAR DR LAS VEGAS NV 89108-2760	13823310039
SHETH ABHIJIT	3 GREENWICH DR #94 JERSEY CITY NJ 07305-1158	13823214110
SHIEH JOHN CHUNG	LIU MEI-I 6500 W LAKE MEAD BLVD #120 LAS VEGAS NV 89108-7030	13823214063
SHULMAN KEITH L & FLORENCE	7021 LOREL AVE SKOKIE IL 60077-3489	13823311016
SILBER MOSHE & CHAYA ESTEE	P O BOX 48528 LOS ANGELES CA 90048-0528	13823214115
SILVERMAN PAUL	6500 W LAKE MEAD BLVD #204 LAS VEGAS NV 89108-7030	13823214077
SILVEYRA FAMILY LIVING TRUST	SILVEYRA ABEL A & ANGELICA TRS 7690 N JONES BLVD LAS VEGAS NV 89131-2119	13823212047
SILVEYRA FAMILY LIVING TRUST	SILVEYRA ABEL A & ANGELICA TRS 7690 N JONES BLVD LAS VEGAS NV 89131-2119	13823213060
SIM JAE YUL	2136 WILLOWBURY DR LAS VEGAS NV 89108-3493	13823210015
SIMLAK HAROLD	2036 BAVINGTON DR #B LAS VEGAS NV 89108-7002	13823213002
SIMPKINS MARY A	2028 WILLOWBURY DR #D LAS VEGAS NV 89108-7006	13823213064
SINGH ROMEET RAJ	201 E UNIVERSITY AVE LAS CRUCES NM 88005-3340	13823310010
SKEEN JOHNNY	4785 S DURANGO DR #204 LAS VEGAS NV 89147-8168	13823311005
SKY LV PROPERTIES L L C	9440 GIDLY ST TEMPLE CITY CA 91780-4211	13823310046
SLATER 1997 TRUST	SLATER FREDERICK E & MARY K TRS 2901 HAWKSDALE DR LAS VEGAS NV 89134-8965	13823210062
SLOAT CAROL A	6528 MURIETTA AVE VAN NUYS CA 91401-1511	13823214078
SMILEY SANDRA C & KIMBERLY J K	45-175 LILIPUNA RD LOT E KANEOHE HI 96744-3000	13823213059
SMITH HELEN C	2031 CHERTSEY DR #B LAS VEGAS NV 89108-7010	13823213066
SO NV REGIONAL HOUSING AUTHORITY	%C ROWE 340 N 11 ST #170 LAS VEGAS NV 89101-3125	13823311054
SO NV REGIONAL HOUSING AUTHORITY	%C ROWE 340 N 11 ST #170 LAS VEGAS NV 89101-3125	13823310054
SO NV REGIONAL HOUSING AUTHORITY	%C ROWE 340 N 11 ST #170 LAS VEGAS NV 89101-3125	13823310014
SO NV REGIONAL HOUSING AUTHORITY	%C ROWE 340 N 11 ST #170 LAS VEGAS NV 89101-3125	13823310091
SO NV REGIONAL HOUSING AUTHORITY	%C ROWE 340 N 11 ST #170 LAS VEGAS NV 89101-3125	13823310067
SO NV REGIONAL HOUSING AUTHORITY	%C ROWE 340 N 11 ST #170 LAS VEGAS NV 89101-3125	13823314018
SOOHOO ANITA	P O BOX 1719 ALAMEDA CA 94501-0191	13823314043
SOON EDWIN	564 W 24TH AVE VANCOUVER BC V5L 3C1 CANADA	13823212048
SOTELO MARIBEL	1912 INDRIO CIR LAS VEGAS NV 89108-2701	13823311047
SPRAGUE EDMOND & NANCY	6593 LEMITAR DR LAS VEGAS NV 89108-2757	13823310042
SQUIRE DEBBIE M	KLIFFER SYD 6500 W LAKE MEAD #110 LAS VEGAS NV 89108-7030	13823214083
STEEN TERRY	6552 LOMBARD DR LAS VEGAS NV 89108-2731	13823312010
STINSON HEATH	P O BOX 30748 LAUGHLIN NV 89028-0748	13823212046

**Report of All Selected Parcels****Case Number:** EOT-46607**Printed On:** Mon: September 10, 2012

<u>Owner</u>	<u>Address</u>	<u>Parcel Numbe</u>
STIVERSON MAX L LIVING TRUST	STIVERSON MAX L TRS 1920 JOLIET CIR BOX 7 LAS VEGAS NV 89108-2745	13823311037
SUH EDWARD	224 EMERALD VISTA WAY LAS VEGAS NV 89144-4145	13823213067
SUNSHINE VEGAS L L C	P O BOX 48528 LOS ANGELES CA 90048-0528	13823214111
SYLVESTER STACEY A	1924 CAVIAR LAS VEGAS NV 89108-2751	13823312023
TADMOR SARAH	2117 CHERTSEY DR #A LAS VEGAS NV 89108-7094	13823212021
TAIRA RICHARD S & BETTY A	1470 LALAMILO ST HONOLULU HI 96819-1655	13823212014
TALON KRIS CORAZON B	4616 W SAHARA AVE #170 LAS VEGAS NV 89102-3654	13823214071
TAMURA ALVIN B & PATTI A	%RESYS REAL ESTATE 6910 EDNA AVE LAS VEGAS NV 89117-3004	13823312012
TANITA ANITA & VINCENT	6556 LOMBARD DR LAS VEGAS NV 89108-2731	13823312009
TARMANN FRED & PHYLLIS FAMILY TR	TARMANN FREDERICK & PHYLLIS TRS 35534 WOODBRIDGE PL FREMONT CA 94536-3378	13823310032
TASH AMBER	6665 GAZELLE DR LAS VEGAS NV 89108-2724	13823314006
TAXPAYER	LAS VEGAS NV 89000	13823314037
TEAFORD TOM J	2021 CHERTSEY DR #C LAS VEGAS NV 89108-7009	13823213027
TENA MULUNEH W	1964 WEENAP DR LAS VEGAS NV 89108-2783	13823310085
TESHIMA ERNEST E	79-7251 MAMALAHOA HWY KEALAKEKUA HI 96750-7912	13823210040
THOMAS KEITH & ALEXIA	19 KERNA RD WEST ROXBURY MA 02132-6201	13823212063
THOMAS LILLIAN R	2141 CHERTSEY DR #A LAS VEGAS NV 89108-7095	13823210021
THOMAS MARVA	18311 E FARJARDO ST ROWLAND HEIGHTS CA 91748-4410	13823310025
THOMAS WILLA	2028 BAVINGTON DR #B LAS VEGAS NV 89108-7001	13823213054
THOMPSON ALIKI C	6620 FREDONIA DR LAS VEGAS NV 89108-2721	13823410015
THOMPSON ERMA G	2036 WILLOWBURY DR #D LAS VEGAS NV 89108-7008	13823213016
THOMPSON SOLOMON C III	6500 W LAKE MEAD BLVD #122 LAS VEGAS NV 89108-7030	13823214065
THROCKMORTON ROBERT ALLEN & ANNA	1965 WEENAP DR LAS VEGAS NV 89108-2784	13823310027
TIERNEY JAMES M	6625 GAZELLE DR LAS VEGAS NV 89108-2724	13823314016
TIMM JETHRO E	6584 SOCORRO DR LAS VEGAS NV 89108-2778	13823310011
TOM LISA & LESLIE	264 JAMES CT BENICIA CA 94510-1806	13823212024
TONEL ESTRELLA T	538 LONDON ST SAN FRANCISCO CA 94112-3410	13823210057
TONEL ESTRELLA T	538 LONDON ST SAN FRANCISCO CA 94112-3410	13823210058
TORRES GUILLERMO ADRIAN	ADRIAN ELIA V 2031 CHERTSEY DR #D LAS VEGAS NV 89108-7010	13823213068
TOTH GEORGINA	7159 S DURANGO DR #312 LAS VEGAS NV 89113-2037	13823210019
TRAXLER SOM P	1522 GREENPORT AVE ROWLAND HEIGHTS CA 91748-2125	13823212027
TRIPLE 5 PROPERTIES L L C	22137 AVENUE SAN LUIS WOODLAND HILLS CA 91364-1618	13823311001

**Report of All Selected Parcels****Case Number:** EOT-46607**Printed On:** Mon: September 10, 2012

<u>Owner</u>	<u>Address</u>	<u>Parcel Number</u>
TUGADE WILSIE A & LORNA R	87 SIMKIN DR WINNEPEG MANITOBA R2P 2K6 CANADA	13823310008
URIE PROPERTIES INC	303 MAGNOLIA DR LAGUNA BEACH CA 92651-1720	13823214066
URQUHART JODY	7211 FARRELL RD S E CALGARY ALBERTA T2H0T7 CANADA	13823214107
VALDEZ CORINA	2121 CHERTSEY DR #D LAS VEGAS NV 89108-3498	13823210028
VALDIVIA-VEGA MARIA C	VALDIVIA FRANCISCO JAVIER CELIS 1905 INDRIO CIR LAS VEGAS NV 89108-2701	13823311042
VALLECILLO VICTOR NUNEZ	6624 LOMBARD DR LAS VEGAS NV 89108-2742	13823311020
VANMEETREN FAMILY LIMITED PTN	2 ANTHEM POINTE HENDERSON NV 89052-6605	13823214091
VENDITTO JOHN V	9000 LAS VEGAS BLVD #1052 LAS VEGAS NV 89123-3369	13823213046
VILLASENOR SAMUEL	DAMIAN ENRIQUETA 6660 FREDONIA DR LAS VEGAS NV 89108-2721	13823410005
VILLWOCK MARY JO	MACIEL JORGE 6660 LOMBARD DR LAS VEGAS NV 89108-2742	13823311011
VIOLA MARIA R FIERRO	2132 WILLOWBURY DR #D LAS VEGAS NV 89108-3491	13823210064
VIXIE KIMBERLY A & KEITH T	2136 BAVINGTON DR #D LAS VEGAS NV 89108-3474	13823210004
VIZCARRA GILDARDO	DELATORRE MARISELA 6328 RADFORD AVE NO LAS VEGAS NV 91606	13823311014
VLASENKO LUDMILLA	1917 KRYPTON CIR LAS VEGAS NV 89108-2746	13823312026
VO THANH HUU	2140 WILLOWBURY DR #B LAS VEGAS NV 89108-3495	13823210018
VOJTASEK VERONICA L	6584 LEMITAR DR LAS VEGAS NV 89108-2758	13823310096
W R I BEST IN THE WEST	PETSMART LEASE 19601 N 27TH AVE PHOENIX AZ 85027-4008	13823215024
W R I BEST IN THE WEST L L C	HOMEPLACE LEASE P O BOX 924133 HOUSTON TX 77292-4133	13823215026
W R I BEST IN THE WEST L L C	BORDERS BOOKS LEASE P O BOX 924133 HOUSTON TX 77292-4133	13823215015
W R I BEST IN THE WEST L L C	BEST BUY LEASE 7601 PENN AVE RICHFIELD MN 55423-3645	13823215028
W R I BEST IN THE WEST L L C	F C A OHIO INC LEASE P O BOX 924133 HOUSTON TX 77292-4133	13823215020
W R I BEST IN THE WEST L L C	TOY'S R US BABIES R US LEASE ONE GEOFFREY WY WAYNE NJ 07470-2035	13823215010
W R I BEST IN THE WEST L L C	OFFICE DEPOT LEASE %LEASE ADMIN 6600 N MILITARY TRL BOCA RATON FL 33496-2434	13823215027
W R I BEST IN THE WEST L L C	TONY ROMAS LEASE 1700 ALMA DR #400 PLANO TX 75075-6964	13823215005
W R I BEST IN THE WEST L L C	SWEET TOMATOES LEASE 15822 BERNARDO CENTER DR #A SAN DIEGO CA 92127-2362	13823215012
W R I BEST IN THE WEST L L C	ORGANIZED LIVING LEASE P O BOX 924133 HOUSTON TX 77292-4133	13823215017
W R I BEST IN THE WEST L L C	APPLEBEES INTERNATIONAL LEASE 4551 W 107TH ST #100 OVERLAND PARK KS 66207-4037	13823215003
W R I BEST IN THE WEST L L C	GAP INC LEASE P O BOX 924133 HOUSTON TX 77292-4133	13823215016
W R I BEST IN THE WEST L L C	ATLANTIC RICHFIELD COMPANY LEASE 7465 W LAKE MEAD #100 LAS VEGAS NV 89128-1033	13823215008
W R I BEST IN THE WEST L L C	MCDONALDS CORP LEASE %MCDONALDS CORPORATION #27-0157 P O BOX 182571 COLUMBUS OH 43218-2571	13823215004
W R I BEST IN THE WEST L L C	STERLING JEWELERS LEASE P O BOX 924133 HOUSTON TX 77292-4133	13823215023

**Report of All Selected Parcels****Case Number:** EOT-46607**Printed On:** Mon: September 10, 2012

<u>Owner</u>	<u>Address</u>	<u>Parcel Number</u>
W R I BEST IN THE WEST L L C	ULTRA 3 COSMETICS & SALON LEASE P O BOX 924133 HOUSTON TX 77292-4133	13823215006
W R I BEST IN THE WEST L L C	P O BOX 924133 HOUSTON TX 77292-4133	13823215013
W R I BEST IN THE WEST L L C	COPELANDS SPORTS LEASE %SPORTS AUTHORITY 1050 W HAMPDEN AVE ENGLEWOOD CO 80110-2118	13823215018
W R I BEST IN THE WEST L L C	COX P C ASSETS LEASE %S PEEBLES P O BOX 8430 KANSAS CITY MO 64114-0430	13823215025
WAIDE SANDRA E	1900 KRYPTON CIR LAS VEGAS NV 89108-2746	13823312031
WALKER KEVIN	6632 FREDONIA DR LAS VEGAS NV 89108-2721	13823410012
WANG GUI YING	2110 BAVINGTON DR #13-D LAS VEGAS NV 89108-3467	13823212052
WARD JEAN RUPPERT	2036 BAVINGTON DR #A LAS VEGAS NV 89108-7002	13823213001
WATANABE JAMES Y & LINDA Y	630 KAUMAKA PL HONOLULU HI 96825-2411	13823310072
WATERS ZACHARY P	6500 W LAKE MEAD BLVD #205 BLDG #A3 LAS VEGAS NV 89108-7031	13823214084
WATKINS LONNIE E & THELMA	2132 BAVINGTON DR #C LAS VEGAS NV 89108-3473	13823210051
WEAVER FAMILY TRUST	WEAVER CHARLIE V & MARY E TRS 5855 CORAZON DR LAS VEGAS NV 89103-2345	13823210012
WENTWORTH STEVEN & SALLIE A	P O BOX 61334 LAS VEGAS NV 89160-1334	13823311055
WEST ROB	6500 W LAKE MEAD BLVD #230 BLDG#B1 LAS VEGAS NV 89108-7346	13823214105
WHITE JON M	6573 LEMITAR DR LAS VEGAS NV 89108-2757	13823310047
WHITEMAN GARY	522 N I ST #107 TACOMA WA 98403-2025	13823214098
WILLIAMS CATHERINE C TRUST	WILLIAMS CATHERINE C TRS 2700 NEILSON WY #534 SANTA MONICA CA 90405-4015	13823210056
WILLIAMS O NEIL B & JACQUELINE J	6569 LEMITAR DR LAS VEGAS NV 89108-2756	13823310048
WILLIS FAMILY TRUST	WILLIS CALVIN M & GLADYS D TRS 2671 PREAKNESS WY NORCO CA 92860-4201	13823311025
WILLISTON JUDY G	2132 WILLOWBURY DR #A LAS VEGAS NV 89108-3491	13823210061
WINFIELD JHIRMAL E & SHANNON R	6500 W LAKE MEAD BLVD #127 LAS VEGAS NV 89108-7320	13823214094
WINTERROWD RANDI	6652 GAZELLE DR LAS VEGAS NV 89108-2722	13823314046
WOODWARD RICHARD H & TARY L	1920 CAVIAR LAS VEGAS NV 89108-2751	13823312022
WRENN MARY E	2028 WILLOWBURY DR #A LAS VEGAS NV 89108-7006	13823213061
WYNNE ANGELITA L	1960 CLOVIS CIR LAS VEGAS NV 89108-2770	13823310076
XING HUILAN	405 BALLYTORE RD WYNNEWOOD PA 19096-2308	13823214101
YAFCHAK JOAN R	6580 LEMITAR DR LAS VEGAS NV 89108-2758	13823310097
YAJNIK SAMIR	PATEL PRAVIN 3221 BUCHANAN ST #6 SAN FRANCISCO CA 94123-3529	13823214097
YAN MIN JUAN	P O BOX 35491 LAS VEGAS NV 89133-5491	13823214103
YAN SHAN	7638 GROVE WY FONTANA CA 92336-3058	13823314002
YATSO LISA S	1969 JAMES BILBRAY DR LAS VEGAS NV 89108-2769	13823310059

**Report of All Selected Parcels**

**Case Number:** EOT-46607

**Printed On:** Mon: September 10, 2012

<u>Owner</u>	<u>Address</u>	<u>Parcel Numbe</u>
YONG LIN AI	WW SOONG VIVIAN 98-057 LOKOWAI ST AIEA HI 96701-5224	13823210048
YOUNGBERG JOHN & RANDI	2121 CHERTSEY DR #C LAS VEGAS NV 89108-3498	13823210027
YOUR MARKET REAL ESTATE L L C	6212 SILVER VEIN ST NO LAS VEGAS NV 89031-1198	13823214064
Z Z HOLDINGS L L C	P O BOX 592239 SAN ANTONIO TX 78259-0161	13823214089
ZOCKOLL FAMILY TRUST	ZOCKOLL TONY & DEBBIE L TRS 2920 EBONY CIR ST GEORGE UT 84790-6908	13823210036
ZOOK FAMILY TRUST	ZOOK LARRY ALAN & JOYCE E CO-TRS 6025 SUGAR CREEK DR NO LAS VEGAS NV 89081-3302	13823314015