



Legal Notices Transmittal and Scanning Separator Sheet

Legal Notice Type: Legal Mailings

Date of Transfer to ERM: 5/23/2011

Page Count: 22

Meeting Date: 6/15/2011

Meeting Type: City Council <=>

Case Number(s): SUP-41200 <=>

Subject of Affidavit: APPLICANT/OWNER: OASIS LAS VEGAS, LLC - 110 North Jones Boulevard <=>

Record Series: Legal Notices

LRDA Number: 2007-1717

Retention: Permanent

File By: Meeting Date



Prepared By: aoroli

SCANNED

Scanned By: 

JUN - 1 - 2011

QC By: _____

City of Las Vegas
Office Of The City Clerk
400 Stewart Avenue
Las Vegas, Nevada 89101

Return Service Requested
Official Notice of Public Hearing

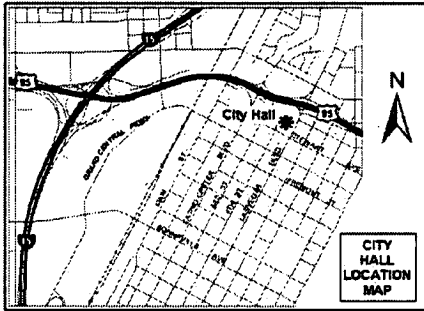

If you wish to file your protest or support on this request, check the appropriate box below and return this card in an envelope with postage to the Office Of The City Clerk at the address listed above or fax this side of this card to (702) 382-4803. If you would like to contact your Council Representative, please call (702) 229-6405.

I SUPPORT
this Request

I OPPOSE
this Request

Please use available blank space on card for your comments.

SUP-41200

City Council Meeting of 6/15/2011

Application Information

SUP-41200 - APPLICANT/OWNER: OASIS LAS VEGAS, LLC - Request for a Special Use Permit FOR A 50-FOOT TALL, 14-FOOT X 48-FOOT OFF-PREMISE SIGN at 110 North Jones Boulevard (APN 138-25-404-008), C-1 (Limited Commercial) Zone, Ward 1 (Tarkanian).

Application Location

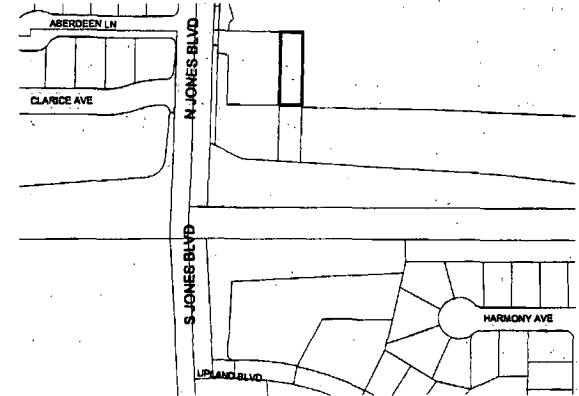

The proposed project may not pertain to the entire highlighted project site.

Public Hearing Information

Meeting: City Council
Date: June 15, 2011
Time: 1:00 P.M.
Location: City Council Chambers
400 Stewart Avenue
Las Vegas, Nevada

Any and all interested persons may appear and be heard at said meeting, or may, prior thereto, file written objections thereto or approvals thereof with the City Clerk, 1st Floor, City Hall, 400 Stewart Avenue, Las Vegas, Nevada, 89101. For further information, including the full staff report, please call (702) 229-6311 (TDD 386-9108) or go to <http://www.lasvegasnevada.gov>.

CASE# SUP-41200

PARCEL#	OWNER	ADDRESS1	ADDRESS2	ADDRESS3	ADDRESS4	ADDRESS5
1	13826813007 ABERIN VICTORIANO N & REMEDIOS V	6101 EMPIRE CIR	LAS VEGAS NV 89107-1471			
2	13836110004 ADAMS COLIN N	204 UPLAND BLVD	LAS VEGAS NV 89107-2660			
3	13826811080 AGUILERA JOHNNY V	204 N WALLACE DR	LAS VEGAS NV 89107-1423			
4	13826811151 AGUIRRE SERGIO & SYLVIA	6200 LAWTON AVE	LAS VEGAS NV 89107-1330			
5	13825410008 ALMOND TREE APARTMENTS L L C	9179 W FLAMINGO RD #100	LAS VEGAS NV 89147-6462			
6	13825411032 AMOS JANET & FRANK E	5907 BROMLEY AVE	LAS VEGAS NV 89107-1559			6/15/2011 SUP-41200 Mr. Ray Koroghli Oasis Las Vegas, LLC 2711 West Windmill Lane Las Vegas, Nevada 89123
7	13836115031 ANDERSON ARDIS JEAN	201 UPLAND BLVD	LAS VEGAS NV 89107-2661			
8	13836110007 ANDERSON FAMILY TRUST	ANDERSON HAROLD D SR & PATTY TRS	216 UPLAND BLVD	LAS VEGAS NV 89107-2660		6/15/2011 SUP-41200 Ms. Lora Dreja Brown Brown & Premsrirut 520 South Fourth Street Las Vegas, Nevada 89101
9	13825411023 ARROWSMITH IRREVOCABLE TRUST	P O BOX 14129	LAS VEGAS NV 89114-4129			
10	13825411024 ARROWSMITH WILLIAM	5925 BROMLEY AVE	LAS VEGAS NV 89107-1559			
11	13836110017 ARTEAGA BENITO M	5924 HARMONY CIR	LAS VEGAS NV 89107-2632			
12	13825411033 AUSTIN TERESA D	5905 BROMLEY AVE	LAS VEGAS NV 89107-1559			
13	13826713063 AVELLANEDA VIVIAN J	6105 FAWN CIR	LAS VEGAS NV 89107-1470			
14	13836110011 BALDWIN LEE F & LUCILLE C	1970 N LESLIE #301	PAHRUMP NV 89060-3678			

CASE# SUP-41200

	PARCEL#	OWNER	ADDRESS1	ADDRESS2	ADDRESS3	ADDRESS4	ADDRESS5
15	13826713070	BANK DEUTSCHE NATIONAL TR CO TRS	%SPECIALIZED LOAN SRVCING	P O BOX 266005	LITTLETON CO 80163-6005		
16	13826813012	BANK U S NATIONAL ASSN TRS	2001 AUSTRALIAN AVE	BAY 2	RIVIERA BEACH FL 33404-5344		
17	13826813013	BANK WELLS FARGO NATL ASSN TRS	2001 AUSTRALIAN AVE BAY 2	RIVIERA BEACH FL 33404-5344			
18	13836110024	BARRERA-SEVILLA COSME	1300 N 21ST ST	LAS VEGAS NV 89101-1361			
19	13826813026	BECERRIL ABDON	6116 CHELSEA CIR	LAS VEGAS NV 89107-1412			
20	13836110018	BECKER BARRY W SR & SUSAN D	5920 HARMONY AVE	LAS VEGAS NV 89107-2632			
21	13836112003	BECKER EQUITIES L L C	%BEKS GROUP LLC	8090 S DURANGO DDR #115	LAS VEGAS NV 89113-4427		
22	13836101001	BECKER INVESTMENT CO L P	%BECKER INVEST	50 S JONES #100	LAS VEGAS NV 89107-2672		
23	13825411041	BERNALES LAWRENCE	904 BREANNA ST	LAS VEGAS NV 89107-3748			
24	13825412025	BIG BLUE LIVING TRUST	6353 PLAZA VERDE PL	LAS VEGAS NV 89108-3948			
25	13825411043	BIRT JOHN FRANKLIN	5821 BROMLEY AVE	LAS VEGAS NV 89107-1562			
26	13825412034	BLACK THOMAS	2752 STARGATE ST	LAS VEGAS NV 89108-4063			
27	13825412054	BLANKENSOP MARK J	3013 TREASURE ISLAND RD	LAS VEGAS NV 89128-7014			
28	13826813024	BREWER GERALD W	BREWER GERALD W & MONICA E	P O BOX 176	ATOKA OK 74525-0176		

CASE# SUP-41200

PARCEL#	OWNER	ADDRESS1	ADDRESS2	ADDRESS3	ADDRESS4	ADDRESS5
29	13825411048	BROOKS JOHN	5809 BROMLEY AVE	LAS VEGAS NV 89107-1562		
30	13825411004	BROWN TEENA M	6037 BROMLEY AVE	LAS VEGAS NV 89107-1525		
31	13836112005	BRYAN GREGORY K	10013 SIENNA PEAK CT	LAS VEGAS NV 89144-1507		
32	13836113002	BUCHER DENISE ALPHONSINE LIV TR	BUCHER DENISE ALPHONSINE TRS	5065 ELLIS GODFREY DR	FAIRFIELD CA 94533-8959	
33	13825411028	BUI AN-DON	911 S BEWLEY ST	SANTA ANA CA 92704-2301		
34	13826811152	BURG JEAN-CLAUDE & MARIE-FRANCE	BURG VANESSA	91 E AGATE AVE #409	LAS VEGAS NV 89123-6056	
35	13825411050	BURGESS GENE	1633 B KAMAMALU AVE	HONOLULU HI 96813-1722		
36	13826713069	BURKES DEBRA J & MILTON	6116 EMPIRE CIR	LAS VEGAS NV 89107-1451		
37	13826813011	BURTON FAMILY TRUST	BURTON LEONARD & ABREHET CO- TRS	6112 DENVER CIR	LAS VEGAS NV 89107-1413	
38	13825412019	CACHE OTTO P	1812 GRAMERCY AVE	TORRENCE CA 90501-3537		
39	13826813031	CALVILLO MIGUEL A & ROSA L	4369 W BUNKER CIR	SOUTH JORDAN UT 84095-9774		
40	13836115028	CAMINO ALFONSO A & MELISSA R	806 BUCHANAN BLVD #115-333	BOULDER CITY NV 89005-2130		
41	13825410020	CAPRICORN SERIES L L C XI	3450 W SAHARA #156	LAS VEGAS NV 89102-5891		
42	13826811088	CARPENTER CATHLEEN JEAN	300 N WALLACE DR	LAS VEGAS NV 89107-0215		

CASE# SUP-41200

PARCEL#	OWNER	ADDRESS1	ADDRESS2	ADDRESS3	ADDRESS4	ADDRESS5
43	13826813027 CARTER DAVID W	CARTER MICHAEL R & CORA DEAN	6120 CHELSEA CIR	LAS VEGAS NV 89107-1412		
44	13826713065 CASTELLVI-FUENTES ROBERTO	DOCAMPO- HENRIQUEZ LILIAM ROSA	1600 EMPIRE CIR	LAS VEGAS NV 89107		
45	13825411009 CASTRO-MORENO SALVADOR	6025 BROMLEY AVE	LAS VEGAS NV 89107-1525			
46	13826814017 CATALINA APARTMENTS L L C	%C FREEMAN	117 N FULLER	LOS ANGELES CA 90036-2811		
47	13836113006 CHAN WILLIAM & VIRGINIA LIV TR	CHAN WILLIAM TUNG TRS	P O BOX 61385	SUNNYVALE CA 94088-1385		
48	13826813020 CHEN MING H	YANG LI Z	32-07 69TH ST	WOODSIDE NY 11377-2036		
49	13836113003 CHINELLI PETRA	103 S MALLARD ST	LAS VEGAS NV 89107-2651			
50	13836113001 CHIODINI 2002 REVOCABLE LIV TR	CHIODINI RONALD V & VERLENE TRS	195 UPLAND BLVD	LAS VEGAS NV 89107-2659		
51	13836112001 CHRISTIANSEN L L C	100 S JONES BLVD	LAS VEGAS NV 89107-2614			
52	13826811036 CLARICE AVENUE TRUST	6200 CLARICE AVE	LAS VEGAS NV 89107-1302			
53	13835518014 CLARK COUNTY CREDIT UNION	P O BOX 36490	LAS VEGAS NV 89133-6490			
54	13826813006 CLOUD GEORGE P III	6105 EMPIRE CIR	LAS VEGAS NV 89107-1471			
55	13825412038 COLE MICHELE O	304 N ORLAND ST #38	LAS VEGAS NV 89107-1656			
56	13825412030 CONTILIVING TRUST	5387 WINNING SPIRIT LN	LAS VEGAS NV 89113-1830			

CASE# SUP-41200

	PARCEL#	OWNER	ADDRESS1	ADDRESS2	ADDRESS3	ADDRESS4	ADDRESS5
57.	13826811037	CONVERSE J LEON & MARY R	6204 CLARICE AVE	LAS VEGAS NV 89107-1302			
58	13825412062	COOK BILL & BETTY FAMILY TRUST	1775 MT HOOD ST	LAS VEGAS NV 89156-7049			
59	13836113007	CORDOBA DAVID & MARIA	1008 WILSON CLIFFS RD	LAS VEGAS NV 89128-4041			
60	13825410018	CORRAL JOSE D & MARIA	8501 EDDYSTONE AVE	LAS VEGAS NV 89117-1218			
61	13836110003	CORRALES-ESPINOZA SANTOS	CORRALES LETICIA	200 UPLAND BLVD	LAS VEGAS NV 89107-2660		
62	13836110027	COX DOUGLAS W & LAWANDA M	5812 HARMONY ST.	LAS VEGAS NV 89107-2626			
63	13826813014	CRAIG GRACIELA	6124 DENVER CIR.	LAS VEGAS NV 89107-1413			
64	13825315021	CROUCH GARY & TARA	6017 FAWN AVE	LAS VEGAS NV 89107-1418			
65	13825412060	CUDEMO MARIO	848 15TH ST #3	SANTA MONICA CA 90403-1830			
66	13825404004	D & W INC	%GENERAL GROWTH PROPERTIES	P O BOX 617905	CHICAGO IL 60661-7905		
67	13825412022	DANA JAMES G & MARTHA M	P O BOX 506	DOUGLAS MA 01516-0506			
68	13825411012	DANG TYFFANI MAI	911 S BEWLEY ST	SANTA ANA CA 92704-2301			
69	13835518006	DANOSKI CLUTTS PPTY GROUP L L C	6110 ELTON AVE	LAS VEGAS NV 89107-2538			
70	13825410007	DARUGAR SAIFUDDIN H & MUSTAFA	DARUGAR SHAKEEL	%UNIK CUSTOM GLASS & MIRROR	6944 EL CAJON BLVD	SAN DIEGO CA 92115-1738	

CASE# SUP-41200

PARCEL#	OWNER	ADDRESS1	ADDRESS2	ADDRESS3	ADDRESS4	ADDRESS5
71	13826813030	DAVIS AARON	1807 S GARFIELD	KENNEWICK WA 99337-4846		
72	13836110022	DEMARTINEZ VERONICA MARQUEZ	5904 HARMONY CIR	LAS VEGAS NV 89107-2632		
73	13826813025	DIAZ ALAN E	DIAZ-SANCHEZ JOSE G	6112 CHELSEA CIR	LAS VEGAS NV 89107-1412	
74	13825411051	DIZON ARLENE G	5803 BROMLEY AVE	LAS VEGAS NV 89107-1562		
75	13825411052	DREICER BENJAMIN	16456 ROYAL HILLS DR	ENCINO CA 91436- 4218		
76	13825411002	DREICER MARAT	16456 ROYAL HILLS DR	ENCINO CA 91436- 4218		
77	13836110062	DUDMAN THOMAS L & BARBARA REV TR	DUDMAN THOMAS L & BARBARA K TRS	5809 HARMONY AVE	LAS VEGAS NV 89107-2628	
78	13826813023	DUKART PATRICIA ANN BEESON	6104 CHELSEA CIR	LAS VEGAS NV 89107-1412		
79	13836110006	DVORDZA TERI	212 UPLAND BLVD	LAS VEGAS NV 89107-2660		
80	13826813029	EDMONDSON BARBARA	6125 W CHELSEA CIR	LAS VEGAS NV 89107-1473		
81	13825412046	ELDRED MICHAEL E SEP PTY TR	P O BOX 13618	LAS VEGAS NV 89112-1618		
82	13825411045	ELIZARDE ANTHONY LAWRENCE	333 CART CROSSING WY	LAS VEGAS NV 89148-5213		
83	13825412047	ENGLISH DARLENE J	304 ORLAND ST #47	LAS VEGAS NV 89107-1656		
84	13825412045	ESPARZA MIGUEL A	304 ORLAND ST #45	LAS VEGAS NV 89107-1656		

CASE# SUP-41200

PARCEL#	OWNER	ADDRESS1	ADDRESS2	ADDRESS3	ADDRESS4	ADDRESS5
85	13825412014	FARMER TIMOTHY D	208 ORLAND ST #14	LAS VEGAS NV 89107-1653		
86	13826815004	FAUDO A SALVADOR	6113 ABERDEEN LN	LAS VEGAS NV 89107-1472		
87	13826815005	FEDERAL HOME LOAN MORTGAGE CORP	%CITIMORTGAGE INC	1000 TECHNOLOGY DR MS 314	O'FALLON MO 63368-2239	
88	13826713067	FELICITY HOUSING L L C	2805 BAGUIO VILLA	550 VICTORIA RD	HONG KONG CHINA	
89	13825410021	FERNMAR 025 026 027 L L C	%R & F CALCATERRA	P O BOX 400	MENLO PARK CA 94026-0400	
90	13836115029	FLORES MANUEL & MAGDALENA	209 UPLAND BLVD	LAS VEGAS NV 89107-2661		
91	13836112002	FREMONT WEST SHOPPING CENTER	50 S JONES #100	LAS VEGAS NV 89107-2672		
92	13826813039	GARCIA AMINADAB	6112 ABERDEEN LN	LAS VEGAS NV 89107-1411		
93	13826811086	GARCIA-RODRIGUEZ YAILIN	228 N WALLACE DR	LAS VEGAS NV 89107-1423		
94	13825315005	GATCHELL RONALD W	6001 FAWN AVE	LAS VEGAS NV 89107-1418		
95	13825411015	GEIL SCOTT E	1980 MCKINNEY WY #13Q	SEAL BEACH CA 90740-4425		
96	13825411030	GIGUERE JEAN MERRILL	1945 LATHAM ST #5	MOUNTAIN VIEW CA 94040-2119		
97	13825411003	GLASS D L	1706 SAND STORM DR	HENDERSON NV 89074-1741		
98	13825412058	GLINES SHAWN	312 ORLAND ST #58	LAS VEGAS NV 89107-1658		

CASE# SUP-41200

PARCEL#	OWNER	ADDRESS1	ADDRESS2	ADDRESS3	ADDRESS4	ADDRESS5
99	13825412063	GLINSKI HARVEY	2021 WENGERT	LAS VEGAS NV 89104-2037		
100	13826713066	GONZALEZ ROGELIO G	6104 EMPIRE CIR	LAS VEGAS NV 89107-1451		
101	13825411020	GRANADOS GLADYS	4011 E RENO AVE	LAS VEGAS NV 89120-1418		
102	13825412029	GREEN KELTON	6740 SPRING PARK AVE #216	LOS ANGELES CA 90056-2332		
103	13825412036	GRIFFIN JAMES K & KRISTINA K	212 ORLAND ST #36	LAS VEGAS NV 89107-1655		
104	13836110014	GUINTO ABRAHAN G	5913 HARMONY CIR	LAS VEGAS NV 89107-2632		
105	13825412037	GURULE GILBERT	5605 ALTA DR	LAS VEGAS NV 89107-3657		
106	13826811033	GUY STACY	7500 W LAKE MEAD #9-601	LAS VEGAS NV 89128-0297		
107	13825412032	HADLER ROBERT WILLIAM	212 ORLAND DR #32	LAS VEGAS NV 89107-1655		
108	13825412020	HEADLEY VIRGINIA L	3409 SLIDING ROCK DR	MCKINNEY TX 75070-4813		
109	13826813022	HECHAVARRIA LUIS	6100 CHELSEA CIR	LAS VEGAS NV 89107-1412		
110	13825411049	HERNANDEZ IRMA	5807 BROMLEY AVE	LAS VEGAS NV 89107-1562		
111	13836117003	HERNANDEZ USBALDO	5816 CHURCHILL ST	LAS VEGAS NV 89107-2633		
112	13826811087	HERRINGTON ROBERT M	232 N WALLAVE DR	LAS VEGAS NV 89107		

CASE# SUP-41200

	PARCEL#	OWNER	ADDRESS1	ADDRESS2	ADDRESS3	ADDRESS4	ADDRESS5
113	13836110013	HERRMANN DEWAYNE & NONA	5909 HARMONY AVE	LAS VEGAS NV 89107-2632			
114	13825412049	HODGSON MARK DAVID	304 ORLAND ST #49	LAS VEGAS NV 89107-1658			
115	13825412043	HOLDER LILA CAROLE	304 ORLAND ST #43	LAS VEGAS NV 89107-1656			
116	13825315009	HORNER MICHAEL J & JAMIE R	5909 FAWN AVE	LAS VEGAS NV 89107-1468			
117	13825412059	HOROWITZ EDWARD	312 ORLAND ST #59	LAS VEGAS NV 89107-1658			
118	13826813019	IBARRA ERNESTO & BERTHA JUAREZ	6109 DENVER CIR	LAS VEGAS NV 89107-1469			
119	13825412013	JECKEWICZ ELIZABETH	P O BOX 27292	LAS VEGAS NV 89126-1292			
120	13825412031	JENNINGS REX E & MARGUERITE F	4525 FOUNTAIN BROOK DR	WATERLOO IL 62298-2748			
121	13825411036	JIMENEZ MARIA ELENA	5837 BROMLEY AVE	LAS VEGAS NV 89107-1562			
122	13825412057	JIMENEZ TANYA S	312 ORLAND ST #57	LAS VEGAS NV 89107-1658			
123	13836110002	JOHNS MICHAEL A & MONIQUE M	198 UPLAND BLVD	LAS VEGAS NV 89107-2660			
124	13825412012	JOHNSTON LARRY R & CAROL JEAN	208 ORLAND ST #12	LAS VEGAS NV 89107-1653			
125	13825412035	JONES GLEN	212 ORLAND ST #35	LAS VEGAS NV 89107-1655			
126	13826813035	JUDD GARY & BEVERLY	6101 CHELSEA CIR	LAS VEGAS NV 89107-1473			

CASE# SUP-41200

PARCEL#	OWNER	ADDRESS1	ADDRESS2	ADDRESS3	ADDRESS4	ADDRESS5
127	13825412044	KEANE FRANK FAMILY TRUST	5581 MCLEOD DR	LAS VEGAS NV 89120-3332		
128	13836110028	KNOWLDEN MICHAEL H & LEISA M	5808 HARMONY ST	LAS VEGAS NV 89107-2626		
129	13836115033	KRONENBERG BRUCE J	108 S MALLARD ST	LAS VEGAS NV 89107-2652		
130	13836117001	LAKHANI DIPAK & JYOTI REV LIV TR	LAKHANI DIPAK M & JYOTI D TRS	3036 E RUSSELL RD	LAS VEGAS NV 89120-3415	
131	13826812010	LALANNE HORACIO M	308 N WALLACE DR	LAS VEGAS NV 89107-0215		
132	13825412055	LALLY EMMETT F	304 ORLAND ST #55	LAS VEGAS NV 89107-1657		
133	13826811082	LARSON RANDALL M	212 N WALLACE DR	LAS VEGAS NV 89107-1423		
134	13825412007	LEACH PETER M	204 ORLAND ST #7	LAS VEGAS NV 89107-1652		
135	13825411039	LEPOME PENELOPE M TRUST	635 N RIO BRAVO	RIDGECREST CA 93555-3353		
136	13825411019	LETTSSOME MARTHA	6001 BROMLEY AVE	LAS VEGAS NV 89107-1525		
137	13826811085	LEWIS KENT	224 N WALLACE DR	LAS VEGAS NV 89107-1423		
138	13826813017	LIMLEY MILDRED D	6117 DENVER CIR	LAS VEGAS NV 89107-1469		
139	13836113005	LINDELL FAMILY TRUST	LINDELL JAC TRS	107 S MALLARD ST	LAS VEGAS NV 89107-2651	
140	13836113004	LINDELL JAC	107 MALLARD ST	LAS VEGAS NV 89107-2651		

CASE# SUP-41200

PARCEL#	OWNER	ADDRESS1	ADDRESS2	ADDRESS3	ADDRESS4	ADDRESS5
141	13825411010	LITTLE RICKY FAMILY TRUST	10809 BERINGER DR	LAS VEGAS NV 89144-1121		
142	13825315006	LITTLEFIELD STEVEN E & CARMEN S	5921 FAWN AVE	LAS VEGAS NV 89107-1468		
143	13826811153	LOCASH THERESA A	6205 PARSIFAL PL	LAS VEGAS NV 89107-1335		
144	13836110019	LUDWIG ALBERT R JR & PAULA K	5916 HARMONY CIR	LAS VEGAS NV 89107-2632		
145	13825410005	M B G GONZALEZ FAMILY TRUST	GONZALEZ ARMANDO & MARIA B TRS	15057 ARARAT ST	LOS ANGELES CA 91342-2030	
146	13825412051	MACAYANAN B	304 ORLAND ST #51	LAS VEGAS NV 89107-1656		
147	13825411035	MAHILL L L C	8144 MADDINGLEY AVE	LAS VEGAS NV 89117-7638		
148	13826713071	MAINE PAUL KENNETH TRS	4133 N TORREY PINES	LAS VEGAS NV 89108-5538		
149	13836110023	MARQUEZ VERONICA	100 TEMPLE DR	LAS VEGAS NV 89107-2642		
150	13825412061	MARTINEZ GLORIA I	312 ORLAND ST #61	LAS VEGAS NV 89107-1658		
151	13826811150	MARTINEZ-CRUZ JOSE G	MARTINEZ SANDRA M	6204 LAWTON AVE	LAS VEGAS NV 89107-1330	
152	13825411021	MARTINI SANDRA & STEVEN	6620 ROY ROGERS DR	LAS VEGAS NV 89108-5531		
153	13825412042	MASON DENNY	%A2Z REALTY & MGT CONPAMY	P O BOX 570307	LAS VEGAS NV 89157-0307	
154	13825412017	MATTHEWS JON E & WILLA D	8600 SCHOLAR LN #2054	LAS VEGAS NV 89128-8490		

CASE# SUP-41200

	PARCEL#	OWNER	ADDRESS1	ADDRESS2	ADDRESS3	ADDRESS4	ADDRESS5
155	13826813028	MCDONALD 1978 TRUST	MCDONALD JAMES E TRS	6124 CHELSEA CIR	LAS VEGAS NV 89107-1412		
156	13825412016	MCGEE ROBERT M	208 ORLAND ST #10	LAS VEGAS NV 89107-1653			
157	13825412023	MEDINA JAVIER A & ANA M	3330 E UNIVERSITY	LAS VEGAS NV 89121-5139			
158	13826811081	MEDINA-CRUZ TRINIDAD	208 N WALLACE DR	LAS VEGAS NV 89107-1423			
159	13825315010	MENDEZ SERGIO H & BLANCA E	8720 CASTLE HILL AVE	LAS VEGAS NV 89129-7668			
160	13825411013	MITCHELL WILLIE L	328 LAGUNA GLEN DR	HENDERSON NV 89014-7593			
161	13825411031	MONJE ROLANDO	5909 BROMLEY AVE	LAS VEGAS NV 89107-1559			
162	13826813041	MONTOYA ELISEO M JR	6120 ABERDEEN LN	LAS VEGAS NV 89107-1411			
163	13826813038	MORENO-NIETO ALFREDO	6108 ABERDEEN LN	LAS VEGAS NV 89107-1411			
164	13825411037	MORISHIGE NEAL MATSUO JR	1616 KEWALO ST #508	HONOLULU HI 96822-3190			
165	13826813001	NAAS BRIAN	6125 EMPIRE CIR	LAS VEGAS NV 89107-1471			
166	13826813034	NAVARRO ELYDIA	6105 CHELSEA CIR	LAS VEGAS NV 89107-1473			
167	13826811034	NEDEDOG TOMAS & MARIA	4613 SOPHIA WY	NO LAS VEGAS NV 89032-0314			
168	13826815003	NESHEIWAT MAJIDA W 2008 TRUST	NESHEIWAT MAJIDA W TRS	4634 LANCER WY	LAS VEGAS NV 89121-6119		

CASE# SUP-41200

	PARCEL#	OWNER	ADDRESS1	ADDRESS2	ADDRESS3	ADDRESS4	ADDRESS5
169	13825411008	NORTHRIDGE TOWNHOUSE CONDOMINIUM	2881 S VALLEY VIEW DR #5	LAS VEGAS NV 89102-0145			
170	13836110008	NUSSBAUM LANCE	116 TEMPLE DR	LAS VEGAS NV 89107-2642			
171	13826813018	NV R E O HOLDINGS L L C	2850 BOTTICELII DR	LAS VEGAS NV 89052-3110			
172	13825404007	OASIS LAS VEGAS L L C	%J BENDHEIM	361 N CANON DR	BEVERLY HILLS CA 90210-4704		
173	13826813004	OBRIEN LORETTA	6113 EMPIRE CIR	LAS VEGAS NV 89107-1471			
174	13825315008	OLHEISER JOHN DAVID & PATRICIA B	5913 FAWN AVE	LAS VEGAS NV 89107-1468			
175	13825401001	OLIVE TREE APARTMENTS L L C	633 FERN GLEN	LA JOLLA CA 92037-5419			
176	13826813010	ORSENO MARY B	6108 DENVER CIR	LAS VEGAS NV 89107-1413			
177	13825315012	ORTIZ IVAN & KENIA	5825 FAWN AVE	LAS VEGAS NV 89107-1428			
178	13825315011	ORTIZ MARCO A	5901 FAWN AVE	LAS VEGAS NV 89107-1468			
179	13835518002	P B T K 95 JONES L L C	6100 ELTON AVE #1000	LAS VEGAS NV 89107-0123			
180	13826813042	PACE PAUL L & VERNA B	6124 ABERDEEN LN	LAS VEGAS NV 89107-1411			
181	13825412052	PACIFICA L SEVENTEEN L L C	1785 HANCOCK ST #100	SAN DIEGO CA 92110-2051			
182	13825410019	PALACIOS ROGER H & J REV FAM TR	PALACIOS ROGER & JEANINE CO-TRS	1526 STARLIGHT CANYON AVE	LAS VEGAS NV 89183-6327		

CASE# SUP-41200

	PARCEL#	OWNER	ADDRESS1	ADDRESS2	ADDRESS3	ADDRESS4	ADDRESS5
183	13825412024	PALMER ROSEMARY & CANDACE LYNN	212 ORLAND ST #24	LAS VEGAS NV 89107-1654			
184	13825411042	PANTOJA AGUSTIN	5823 BROMLEY AVE	LAS VEGAS NV 89107-1562			
185	13825412004	PARK RIDGE CONDOMINIUM	1421 N JONES	P M B 196	LAS VEGAS NV 89108-1610		
186	13826811038	PAVON ROBERTO F	RODRIGUEZ AIMEE E	6208 CLARICE AVE	LAS VEGAS NV 89107-1302		
187	13825315003	PEREZ LAURA A & MIGUEL	6009 FAWN AVE	LAS VEGAS NV 89107-1418			
188	13826811035	PERIDA JAMES D & LISA A	6201 LAWTON AVE	LAS VEGAS NV 89107-1329			
189	13826713068	PIERRE RICHARD ST	6112.EMPIRE CIR	LAS VEGAS NV 89107-1451			
190	13826811089	POCASANGRE WILSON D	DONIS MIRNA	304 N WALLACE DR	LAS VEGAS NV 89107-0215		
191	13826813033	PORTER CATHERINE J	6109 CHELSEA CIR	LAS VEGAS NV 89107-1473			
192	13825412006	PREM DEFERRED TRUST	8350 W SAHARA #150	LAS VEGAS NV 89117-8954			
193	13825315007	PRINCE J KAY	5917 W FAWN AVE	LAS VEGAS NV 89107-1468			
194	13826812011	PRY MIMI MICHELLE M & LANCE A	312 N WALLACE DR	LAS VEGAS NV 89107-0215			
195	13825411006	QUITO NORBERTO R	6031 BROMLEY AVE	LAS VEGAS NV 89107-1525			
196	13825412018	R L B L L C	73 CABANA BLANCA	HENDERSON NV 89012-5689			

CASE# SUP-41200

	PARCEL#	OWNER	ADDRESS1	ADDRESS2	ADDRESS3	ADDRESS4	ADDRESS5
197	13826813002	RAMIREZ EDUARDO	CAMPINS CARMEN ROSA	6121 EMPIRE CIR	LAS VEGAS NV 89107-1471		
198	13826815002	RAMIREZ JUAN	AVELLANET LUISA	6121 ABERDEEN LN	LAS VEGAS NV 89107-1472		
199	13826813005	RAMIREZ MAGNO F & MARGARITA R	6109 EMPIRE CIR	LAS VEGAS NV 89107-1471			
200	13826813003	RAMIREZ-GARCIA JUAN JOSE	6117 EMPIRE CIR	LAS VEGAS NV 89107-1471			
201	13825412039	REASON NANCY I	304 ORLAND ST #39	LAS VEGAS NV 89107-1656			
202	13826713062	REIF ALBERT E JR & GERMANE	3139 TONY RAM CIR	LAS VEGAS NV 89146-6713			
203	13825411027	REINHARDT IVONNE & DIRK	5919 BROMLEY AVE	LAS VEGAS NV 89107-1559			
204	13825411047	RICHARDSON ELAINE L & BRADLEY J	2405 WIMBLEDON DR	LAS VEGAS NV 89107-2357			
205	13825411016	RICHTER JOYCE	6007 BROMLEY AVE	LAS VEGAS NV 89107-1525			
206	13825412056	RODELES ABELARDO JR & KRISTIENA	304 ORLAND ST #56	LAS VEGAS NV 89107-1657			
207	13826811090	RODRIGUEZ A JR & S REV LIV TR	RODRIGUEZ ALBERT JR & SHARON TRS	6200 PARSIFAL PL	LAS VEGAS NV 89107-1336		
208	13825411026	RODRIGUEZ CARLA GONZALEZ	5921 BROMLEY AVE	LAS VEGAS NV 89107-1559			
209	13826811084	ROTHFUSS SALLY D	220 N WALLACE DR	LAS VEGAS NV 89107-1423			
210	13836110015	ROZHON DANIEL G	5917 HARMONY CIR	LAS VEGAS NV 89107-2632			

CASE# SUP-41200

PARCEL#	OWNER	ADDRESS1	ADDRESS2	ADDRESS3	ADDRESS4	ADDRESS5
211	13825411007	RUDEL SUNNIE L	6029 BROMLEY AVE	LAS VEGAS NV 89107-1525		
212	13836110005	RUNDQUIST FAMILY TRUST	RUNDQUIST WENDELL & VERLETTA TRS	208 UPLAND BLVD	LAS VEGAS NV 89107-2660	
213	13825411040	S F R PROPERTIES L L C	P O BOX 4034	LAGUNA BEACH CA 92652-4034		
214	13826813032	SADRY NAUZAD	6113 CHELSEA CIR	LAS VEGAS NV 89107-1473		
215	13825412026	SALAZAR JULIE & ROBERT	212 ORLAND ST #26	LAS VEGAS NV 89107-1655		
216	13825411022	SALAZAR TRUST	%E & D GONZALEZ	309 BENT CREEK DR	LAS VEGAS NV 89107-2464	
217	13825412008	SALCEDO EDUARDO	204 ORLAND ST #A	LAS VEGAS NV 89107-1652		
218	13836110016	SANCHEZ DANIEL & LIDIA C	5921 HARMONY CIR	LAS VEGAS NV 89107-2632		
219	13825411044	SANCHEZ JUAN JOSE	5819 BROMLEY AVE	LAS VEGAS NV 89107-1562		
220	13836115032	SANCHEZ LUCIA G	104 S MALLARD ST	LAS VEGAS NV 89107-2652		
221	13826713061	SANDERS MARK A & TAWNDA J	6113 FAWN CIR	LAS VEGAS NV 89107-1470		
222	13825315019	SARAF YADIDIA	376 W SAHARA AVE	LAS VEGAS NV 89102-5011		
223	13826813040	SARMIENTO FELIPE & ESTHER	6116 ABERDEEN LN	LAS VEGAS NV 89107-1411		
224	13826713064	SAUCEDO ELVIA	2110 MARLIN AVE	LAS VEGAS NV 89101-4030		

CASE# SUP-41200

	PARCEL#	OWNER	ADDRESS1	ADDRESS2	ADDRESS3	ADDRESS4	ADDRESS5
225	13836110063	SAUCEDO RAFAELA & JAIME	3213 W 109TH ST	INGLEWOOD CA 90303-2022			
226	13825411018	SAYBE L L C	6352 W PLACER DR	LAS VEGAS NV 89103-4529			
227	13826813016	SCHWEITZER LEONARD G	6121 DENVER CR	LAS VEGAS NV 89107-1469			
228	13825410002	SCOTT FAMILY TRUST	SCOTT WILLIAM JR & PATRICIA TRS	11656 CURRY AVE	GRANADA HILLS CA 91344-2416		
229	13836110021	SELIG MARK H & DEANA G	5908 HARMONY CIR	LAS VEGAS NV 89107-2632			
230	13825412040	SHENASSA MEHRDAD	8624 TRIANON LN	LAS VEGAS NV 89145-4875			
231	13825411025	SHULER AL RAYMOND	5923 BROMLEY AVE	LAS VEGAS NV 89107-1559			
232	13836110064	SKONE-PALMER ROBIN TRUST	SKONE-PALMER ROBIN TRS	5817 HARMONY ST	LAS VEGAS NV 89107-2628		
233	13826813008	SMIRK J & FORTE-SMIRK REV LIV TR	SMIRK JOHN W TRS	9904 MOONRIDGE CT	LAS VEGAS NV 89134-6743		
234	13825412002	SMITH ADELINA P REVOCABLE TRUST	1308 N JONES BLVD	LAS VEGAS NV 89108-1612			
235	13825412001	SMITH ADELINE P REVOCABLE LIV TR	1308 N JONES	LAS VEGAS NV 89108-1612			
236	13825412050	SMITH RANDY LEE	304 ORLAND ST #50	LAS VEGAS NV 89107-1656			
237	13825411005	SOBONJA FAMILY TRUST	6035 BROMLEY AVE	LAS VEGAS NV 89107-1525			
238	13825411029	SONGAILO PATRICIA	5913 BROMLEY AVE	LAS VEGAS NV 89107-1559			

CASE# SUP-41200

	PARCEL#	OWNER	ADDRESS1	ADDRESS2	ADDRESS3	ADDRESS4	ADDRESS5
239	13825411001	SOSA VICTOR	6043 BROMLEY AVE	LAS VEGAS NV 89107-1525			
240	13825412021	SPEARS CHERYL & BERNARD III	9101 S 4TH AVE	INGLEWOOD CA 90305-2817			
241	13826813037	STATE OF NEVADA TRANSPORTATION	%RIGHT-OF-WAY DIV	P O BOX 170	LAS VEGAS NV 89125-0170		
242	13825315004	STETSON CHARLES T	6005 FAWN AVE	LAS VEGAS NV 89107-1418			
243	13825412041	STEWART JOSEPH & ERMA REV LIV TR	4523 DON VALDES DR	LOS ANGELES CA 90008-4116			
244	13825412009	STOSZKUS DAVID	208 ORLAND ST #9	LAS VEGAS NV 89107-1653			
245	13836110026	TAPIA ADRIAN	5816 HARMONY AVE	LAS VEGAS NV 89107-2626			
246	13836110025	TAYLOR KELLY A	SLACK ERIC D	5820 HARMONY AVE	LAS VEGAS NV 89107-2626		
247	13825411017	THILL JOHN P JR & LORRAINE	6005 BROMLEY AVE	LAS VEGAS NV 89107-1525			
248	13826813021	TORRES SOCORRO	6001 MADRE MESA DR	LAS VEGAS NV 89108-3810			
249	13835518012	TRINE INC	6130 ELTON AVE	LAS VEGAS NV 89107-2538			
250	13836110009	TUMINARO JOSEPH	112 TEMPLE DR	LAS VEGAS NV 89107-2642			
251	13825412005	VALENCIA ALEX C	25732 SHANNON CIR	HEMET CA 92544- 5376			
252	13825411034	VANDERPOOL BRENT	3458 PECOS WY	LAS VEGAS NV 89121-2454			

CASE# SUP-41200

	PARCEL#	OWNER	ADDRESS1	ADDRESS2	ADDRESS3	ADDRESS4	ADDRESS5
253	13826811083	VAZQUEZ MARIA H	216 N WALLACE DR	LAS VEGAS NV 89107-1423			
254	13826813015	VILLANUEVA EVELIN	6125 DENVER CIR	LAS VEGAS NV 89107-1469			
255	13825412011	WADSWORTH DOLORES L	5741 FRENCH CREEK RD	SHINGLE SPRINGS CA 95682-9723			
256	13836115030	WANG JERRY	205 UPLAND BLVD	LAS VEGAS NV 89107-2661			
257	13825412003	WATTENBARGER MARC & JESSICA ETAL	5125 BROMLEY AVE	LAS VEGAS NV 89107-1737			
258	13825412010	WATTENBARGER MARC W & JESSICA H	5125 BROMLEY AVE	LAS VEGAS NV 89107-1737			
259	13825412048	WELLMAN EDGAR E & SHEAYLE L	4240 N DECATUR BLVD	LAS VEGAS NV 89130-2704			
260	13826813009	WHITE JUDD C	6104 DENVER CIR	LAS VEGAS NV 89107-1413			
261	13836110020	WOOD RICHARD M & BOBBIE K	1421 N JONES BLVD #108	LAS VEGAS NV 89108-1610			
262	13825411011	WYNNE SHERRILL A	6019 BROMLEY AVE	LAS VEGAS NV 89107-1525			
263	13825411014	YAMAT BERNARD G & CHERRIE D	6013 BROMLY AVE	LAS VEGAS NV 89107-1525			
264	13825412053	YERUKIM L V L L C	P O BOX 25928	LOS ANGELES CA 90025-0928			
265	13825412064	YUAN JIMMY J	10931 WESTMORE LN	SAN DIEGO CA 92126-2114			
266	13826815001	ZAHORSKY EDWARD D & NANCY M	200 N WALLACE DR	LAS VEGAS NV 89107-1423			

CASE# SUP-41200

	PARCEL#	OWNER	ADDRESS1	ADDRESS2	ADDRESS3	ADDRESS4	ADDRESS5
267	13836110010	ZEHNDER MIRIAM JOYCE LIVING TR	2729 MANTERO CT	HENDERSON NV 89052			
268	13836110065	ZINCHUK MARGO M	5821 HARMONY ST	LAS VEGAS NV 89107-2628			