



Legal Notices Transmittal and Scanning Separator Sheet

Legal Notice Type: Legal Mailings

Date of Transfer to ERM: ~~2/16/2011~~ *3-03-2011* Page Count: 18

Meeting Date: 3/16/2011

Meeting Type: City Council <=>

Case Number(s): SUP-40520 <=>

Subject of Affidavit: APPLICANT/OWNER: FREMONT PLACE, LLC - 228 North Las Vegas Boulevard
<=>

Record Series: Legal Notices

LRDA Number: 2007-1717

Retention: Permanent

File By: Meeting Date



Prepared By: *[Signature]*

Scanned By: *[Signature]*

QC By: _____

SCANNED

MAR - 8 2011

CASE# SUP-40520

PARCEL#	OWNER	ADDRESS1	ADDRESS2	ADDRESS3	ADDRESS4	ADDRESS5
1	13934501009	201 NORTH THIRD ST L V LLC	%CIM GROUP INC	%ACCT DEPT	6922 HOLLYWOOD BLVD 9TH FLR	LOS ANGELES CA 90028-6129
2	13934610024	212 LAS VEGAS BLVD L L C	%PAWN SHOP MGMT/CKJ LLC	6859 S EASTERN AVE #101	LAS VEGAS NV 89119-0003	
3	13934514009	220 NORTH 4TH STREET L V L L C	%CIM GROUP INC	%ACCT DEPT	6922 HOLLYWOOD BLVD 9TH FLR	LOS ANGELES CA 90028-6129
4	13934514008	221 NORTH 3RD STREET L V L L C	%CIM GROUP INC	%ACCT DEPT	6922 HOLLYWOOD BLVD 9TH FLR	LOS ANGELES CA 90028-6129
5	13927804001	530 HOLDINGS L L C	3900 PARADISE RD #101	LAS VEGAS NV 89169-0932		3/16/2011 Mr. Nissan Koroghls Fremont Place, LLC 11007 Fishers Island Street Las Vegas, Nevada 89141
6	13934612029	750 FREEMONT L L C	125 N HALSTED ST #203	CHICAGO IL 60661-2159		SUP-40520
7	13927805002	7-ELEVEN INC	%AV TAX DEPT	P O BOX 711	DALLAS TX 75221-0711	
8	13934601005	7TH STREET PROPERTIES L L C	%F ELAM	1023 WHITNEY RANCH DR	HENDERSON NV 89014-3073	
9	13934612028	801 FREMONT LLC	%GB PPTY MGT INC	%G BERKOWITZ	125 N HALSTEAD #203	CHICAGO IL 60661-2159
10	13934512079	8TH STREET HOLDINGS L L C	%J JOLIET	21777 HOOVER RD	WARREN MI 48089-2544	
11	13934611053	A T & T COMMUNICATIONS NV INC	RM 3E-300E	2600 CAMINO RAMON	SAN ROMON CA 94583-5000	
12	13934512061	ACEVES EDDIE	5421 LIVERPOOL RD	LAS VEGAS NV 89107-3751		
13	13934612042	AFTON HOLDINGS TRUST	2251 N RAMPART BLVD #193	LAS VEGAS NV 89128-7640		
14	13934612045	ALPINE MOTEL L L C	213 N 9TH ST	LAS VEGAS NV 89101-4226		

CASE# SUP-40520

PARCEL#	OWNER	ADDRESS1	ADDRESS2	ADDRESS3	ADDRESS4	ADDRESS5
15	13934612068	AMISTAD CRISTIANA	4152 RIDGECREST DR	LAS VEGAS NV 89121-4928		
16	13935211003	AMISTAD CRISTIANA INC	%J MENCHACA	901 E STEWART	LAS VEGAS NV 89101-4223	
17	13934512072	ARCE ALFREDO & GUADALUPE	517 N 8TH ST	LAS VEGAS NV 89101-3017		
18	13934512085	ARMAND MIKE	6711 ROYAL STALLION CT	LAS VEGAS NV 89131-3715		
19	13934512090	AUSTIN LINDA	P O BOX 19425	JEAN NV 89019- 9425		
20	13934510014	B F TRUST	BOCK HOWARD & CARYL TRS	%JOHN'S LOANS & JEWELRY	2230 S PARADISE RD	LAS VEGAS NV 89104-2516
21	13934111012	B J P INVESTMENTS L L C	30 SAWGRASS CT	LAS VEGAS NV 89113-1324		
22	13934111053	B O G O L C	PURKISS FAMILY TRUST	202 FREMONT ST	LAS VEGAS NV 89101-5606	
23	13934111009	BAERG FAMILY TRUST	BAERG WILLIAM & MARTHA HELEN TRS	3386 SAINT MICHAEL DR	PALO ALTO CA 94306-3057	
24	13934610031	BANK NEVADA STATE	P O BOX 990	LAS VEGAS NV 89125-0990		
25	13934512044	BANK U S NATIONAL ASSN TRS	%AMER SRVCING CO	1 HOME CAMPUS X2504-017	DES MOINES IA 50328-0001	
26	13934610041	BARDEN NEVADA GAMING L L C	%C BROWN	301 FREMONT ST	LAS VEGAS NV 89101-5600	
27	13927804002	BONANZA SPRINGS SUITES L L C	3900 PARADISE RD #101	LAS VEGAS NV 89169-0932		
28	13935112001	BRACY JAMES JR & ELIZABETH F	330 N 9TH ST	LAS VEGAS NV 89101-3033		

CASE# SUP-40520

PARCEL#	OWNER	ADDRESS1	ADDRESS2	ADDRESS3	ADDRESS4	ADDRESS5
29	13934612040	BRISCOE DONALD L & MARGARET L	3815 REMOUNT DR	LAS VEGAS NV 89121-4448		
30	13934610008	BROOKS ALAN DOUGLAS ETAL	150 BORDER COVE LN	LUBEC ME 04652-3012		
31	13934512045	BUCKLEY THOMAS R & BECKY M	1930 KACHINA MOUNTAIN DR	HENDERSON NV 89012-2216		
32	13934611023	BURBANK L L C	%TOWN & COUNTRY BANK	%T ROGERS	8620 W TROPICANA AVE	LAS VEGAS NV 89147-8172
33	13934510021	C I M 116 N 3RD L V L L C	%CIM GROUP INC	%ACCT DEPT	6922 HOLLYWOOD BLVD 9TH FLR	LOS ANGELES CA 90028-6129
34	13934613131	C K ENTERPRISES L L C	1256 ANNAPOLIS WY	GRAYSON GA 30017-2900		
35	13927402009	CALIFORNIA HOTEL & CASINO	%BOYD GAMING	6465 S RAINBOW BLVD	LAS VEGAS NV 89118-3215	
36	13934512071	CAMPOS SALVADOR	1800 W BETTERAVIA RD #D	SANTA MARIA CA 93455-1065		
37	13934512064	CANIZALES BLANCA	329 1/2 N 8TH ST	LAS VEGAS NV 89101-3014		
38	13927811037	CAPRICORN SERIES L L C VI	3540 W SAHARA #156	LAS VEGAS NV 89102-5816		
39	13934111063	CARROLL THOMAS L EST ETAL	%FOUR QUEENS HOTEL	202 FREMONT ST	LAS VEGAS NV 89101-5606	
40	13934611028	CARSON AVENUE PARTNERS L L C	P O BOX 18119	LONG BEACH CA 90807-8119		
41	13934512089	CATHOLIC CHARITIES SOUTHERN NV	1501 LAS VEGAS BLVD N	LAS VEGAS NV 89101-1120		
42	13934111019	CATS MEOW ETAL	%VINTAGE VEGAS GAMING INC	128 E FREMONT ST	LAS VEGAS NV 89101-5604	

CASE# SUP-40520

PARCEL#	OWNER	ADDRESS1	ADDRESS2	ADDRESS3	ADDRESS4	ADDRESS5
43	13934611055	CENTRAL TELEPHONE CO	%PPTY TAX DEPT	P O BOX 7909	OVERLAND PARK KS 66207-0909	
44	13935211001	CHAKHBEKIAN ARMEN	314 N 9TH ST	LAS VEGAS NV 89101-3033		
45	13934612048	CHESTERFIELD MORTGAGE INVESTORS	1420 5TH AVE #1850	SEATTLE WA 98101-4091		
46	13934612062	CHURCH FIRST UNIVERSAL	901 E OGDEN AVE	LAS VEGAS NV 89101-4234		
47	13934612050	CHURCH SAINT JOSEPH CATHOLIC	131 N 9TH ST	LAS VEGAS NV 89101-4225		
48	13934612035	CHURCH ST JOSEPH CATHOLIC INC	131 N 9TH ST	LAS VEGAS NV 89101-4225		
49	13934510001	CIM/BG LAS VEGAS L L C	%RESORT GAMING GROUP LLC	%A DONNER	206 N 3RD ST	LAS VEGAS NV 89101-2931
50	13934613185	CIN CITY L L C	4171 S PURPLE SAGE DR	CHANDLER AZ 85248-4847		
51	13934512049	CIPRO PETER & SHEILA	P O BOX 94582	LAS VEGAS NV 89193-4582		
52	13934111064	CITY OF LAS VEGAS REDEVELOPMENT	FREMONT EXPERIENCE L L C	%FINANCE DEPT	425 FREMONT ST	LAS VEGAS NV 89101-5620
53	13934512046	CLARK ED & ELIZABETH	514 N 7TH ST	LAS VEGAS NV 89101-3012		
54	13927805003	CLOUDBREAK LAS VEGAS L L C	414 S MARENGO AVE	PASADENA CA 91101-3113		
55	13934510028	COHEN 1969 TRUST	COHEN PHILIP JOSEPH TRS	1620 S DECATUR BLVD #G	LAS VEGAS NV 89102-5586	
56	13935110010	CORRAL JUAN MANUEL & EVA	436 N 9TH ST	LAS VEGAS NV 89101-3035		

CASE# SUP-40520

	PARCEL#	OWNER	ADDRESS1	ADDRESS2	ADDRESS3	ADDRESS4	ADDRESS5
57	13934510005	COURT TRUST #79145	SIMON PETER & JANET II TR R-501	P O BOX 19088	JEAN NV 89019- 9088		
58	13935110011	CRANE NANCY C & GARY G	FRANKLIN SEVE K	190 N PAINTED HILLS	IVINS UT 84738- 6016		
59	13934611044	CREST BUDGET INN L L C	2775 S RAINBOW BLVD #101C	LAS VEGAS NV 89146-5192			
60	13934612049	D M D LIVING TRUST	DILLARD DOYLE M & MARY M TRS	1908 POPLAR AVE	LAS VEGAS NV 89101-4122		
61	13934612064	DEMASSI DOUGH & HEATHER	2716 BAYO CT	LAS VEGAS NV 89102-2018			
62	13934510029	DERRYBERRY 1997 FAMILY TRUST	DERRYBERRY BARBARA ANN TRS	1309 E ST LOUIS AVE #1	LAS VEGAS NV 89104-3405		
63	13934610007	DOKTER GARY R ETAL	%FITZGERALDS CASINO & HOTEL	P O BOX 7600	LAS VEGAS NV 89125-7600		
64	13934512067	DORADO RIGOBERTO & IRMA	405 N 8TH ST	LAS VEGAS NV 89101-3015			
65	13934111005	DOWNEY NANCY L	P O BOX 585	GENOA NV 89411- 0585			
66	13934612013	DOWNTOWNER 2007 TRUST	KOVAK-COHEN 1989 TRUST	129 N 8TH ST	LAS VEGAS NV 89101-4207		
67	13934512096	DREXLER MICHAEL	750 S ROYAL CREST CIR #146	LAS VEGAS NV 89169-8319			
68	13934512087	E VILLAGE L L C	800 E CHARLESTON	LAS VEGAS NV 89104-1512			
69	13935112004	EAST VILLAGE L L C	6525 COLLINS AVE	MIAMI BEACH FL 33141-4755			
70	13934611052	EDEN ONE LIMITED PARTNERSHIP	3538 EL CAMINO REAL	ATASCADERO CA 93422-2532			

CASE# SUP-40520

PARCEL#	OWNER	ADDRESS1	ADDRESS2	ADDRESS3	ADDRESS4	ADDRESS5
71	13934613015 EDWARDS JAMES K & RETA E	150 LAS VEGAS BLVD N #815	LAS VEGAS NV 89101-2925			
72	13934611019 ENCRYPTIC L L C	%R STURMAN	114 N 3RD ST	LAS VEGAS NV 89101-2926		
73	13934613170 ENTERPRIZZZ L L C	150 LAS VEGAS BLVD N #815	LAS VEGAS NV 89101-2925			
74	13934512088 E-VILLAGE L L C	2945 S MONTE CRISTO	LAS VEGAS NV 89117-3224			
75	13934512027 EXBER INC	107 N 6TH ST 3RD FLOOR	LAS VEGAS NV 89101-4239			
76	13934513002 F A E C HOLDINGS WIRRULLA L L C	%M MATKINS	450 FREMONT ST #285	LAS VEGAS NV 89101-5627		
77	13934613065 FEDERAL NATIONAL MORTGAGE ASSN	%NATIONSTAR MTGE LLC	350 HIGHLAND DR	LEWISVILLE TX 75067-4177		
78	13934111062 FINLEY COMPANY	%FOUR QUEENS HOTEL	202 FREMONT ST	LAS VEGAS NV 89101-5606		
79	13935211002 FIRST NATL REALTORS MTGE CORP	16430 VENTURA BLVD #208	ENCINO CA 91436-2141			
80	13934512063 FLORES ARACELI	ALDANA PAULO C	2231 BELMONT AVE	LONG BEACH CA 90815-2502		
81	13934613013 FONTAINE EMMANUEL	14499 W VIRGINIA AVE	GOODYEAR AZ 85395-2029			
82	13934111061 FOUR QUEENS INC	FOUR QUEENS HOTEL	202 FREMONT ST	LAS VEGAS NV 89101-5606		
83	13934512007 FREMONT PLACE L L C	3055 VIA SARAFINA DR	HENDERSON NV 89052-4031			
84	13934610045 FREMONT ST EXPERIENCE PARKING	425 FREMONT ST	LAS VEGAS NV 89101-5620			

CASE# SUP-40520

PARCEL#	OWNER	ADDRESS1	ADDRESS2	ADDRESS3	ADDRESS4	ADDRESS5
85	13934111050 G N L V CORP	P O BOX 610	LAS VEGAS NV 89125-0610			
86	13934612016 GALARDI CHILDRENS IRR TR AGMT	MCRIMMON SIDNEY ARCHIE JR TRS	713 E OGDEN AVE #B	LAS VEGAS NV 89101-4230		
87	13934510007 GAREHIME FAM TR 1993- SURV ETAL	GAREHIME BETTY JANE TRS	5085 ALFINGO ST	LAS VEGAS NV 89135-3214		
88	13934514007 GARSIDE BETH ETAL	%CIM GROUP INC	%ACCT DEPT	6922 HOLLYWOOD BLVD 9TH FLR	LOS ANGELES CA 90028-6129	
89	13934510022 GEORGE 1979 TRUST ETAL	GEORGE WILLIAM S TRS	208 STONEWOOD CT	LAS VEGAS NV 89107-3250		
90	13934501014 GOLD SPIKE HOLDINGS L L C	%SIEGEL GROUP NEVADA INC	3900 PARADISE RD #101	LAS VEGAS NV 89169-0932		
91	13934611039 GOOD EARTH ENTERPRISES INC	785 COLUMBUS AVE	SAN FRANCISCO CA 94133-2732			
92	13934512102 GULLO RUSSELL A	405 N 6TH ST	LAS VEGAS NV 89101-3004			
93	13934510024 H S FAMILY L P	714 LACEY LN	LAS VEGAS NV 89107-4440			
94	13934111026 HALE BLAIR R & NORMA FAM TR ETAL	%VINTAGE VEGAS GAMING INC	128 E FREMONT ST	LAS VEGAS NV 89101-5604		
95	13934611007 HAM A W III TRUST	HAM A W III TRS	2008 GRAY EAGLE WY	LAS VEGAS NV 89117-5738		
96	13934611004 HAM ARTEMUS W III	2008 GRAY EAGLE WY	LAS VEGAS NV 89117-5738			
97	13934612044 HAWAII PLACE L L C	7259 W SAHARA AVE #110	LAS VEGAS NV 89117-2853			
98	13934612063 HAWAIIAN-I L L C	%HAWAIIAN EYE LLC	2716 BAYO CT	LAS VEGAS NV 89102-2018		

CASE# SUP-40520

	PARCEL#	OWNER	ADDRESS1	ADDRESS2	ADDRESS3	ADDRESS4	ADDRESS5
99	13934613028	HEE WILLIAM K M & SHIRLEY Y	3009 WOODLAWN DR	HONOLULU HI 96822-1563			
100	13934610030	HEHER TIMOTHY PATRICK	SLAVIN PATRICIA ANN HEHER	1704 BROOKHAVEN DR	AUSTIN TX 78704- 2747		
101	13934511008	HENRY J PROPERTIES LAS VEGAS LLC	%G HAGOOD	P O BOX 55777	LITTLE ROCK AR 72215-5777		
102	13934512084	HIMES FAMILY TRUST	5620 DARBY AVE	LAS VEGAS NV 89146-7916			
103	13934501012	HISTORIC CLARK COTTAGES L L C	%J & W CLARK	502 N 7TH ST	LAS VEGAS NV 89101-3012		
104	13934612041	HOLLYWOOD MANOR L L C	%L LOVE	P O BOX 417	LAS VEGAS NV 89125-0417		
105	13927811036	HOPELESS IN L V L L C	%L THOMPSON	P O BOX 28399	LAS VEGAS NV 89126-2399		
106	13934512059	HUI JOHN	5560 S FT APACHE #100	LAS VEGAS NV 89148-7699			
107	13934512092	HYMAN ALFRED H & L FAM TR 1995	HYMAN LILLIE TRS	10737 RIVERSIDE DR	NORTH HOLLYWOOD CA 91602-2324		
108	13934612038	I & A LAND L L C	265 PILOT RD	LAS VEGAS NV 89119-3533			
109	13934613220	INGRAM LAWRENCE E	150 LAS VEGAS BLVD N #2109	LAS VEGAS NV 89101-2952			
110	13934512091	INTHAVONG CHINDAVONG & MANEEVANH	331 N 9TH ST	LAS VEGAS NV 89101-3032			
111	13934512076	IRICK CHRIS A	410 N 8TH ST	LAS VEGAS NV 89101-3016			
112	13934111065	ISOLA LINDA J PRESENT INT TR	SELLERS BRETT K TRS	%VINTAGE VEGAS GAMING INC	128 E FREMONT ST	LAS VEGAS NV 89101-5604	

CASE# SUP-40520

	PARCEL#	OWNER	ADDRESS1	ADDRESS2	ADDRESS3	ADDRESS4	ADDRESS5
113	13934511009	J HENRY PROPERTIES LAS VEGAS LLC	%G HAGOOD	P O BOX 55777	LITTLE ROCK AR 72215-5777		
114	13934612085	J R F L P	QUAM THOMAS J & DIANE K	806 BUCHANAN BLVD #115-336	BOULDER CITY NV 89005-2130		
115	13934612001	JASAA INC	1255 CORPORATE CENTER #PH-10	MONTEREY PARK CA 91754-7615			
116	13934111011	JORAI ENTPRS	RAIZIN LEONARD & CAROL TRS	2 THAYNES CANYON WY	PARK CITY UT 84060-7237		
117	13934512062	JORDAN PATRICIA A	1579 DALTON AVE	DALTON GARDENS ID 83815-9624			
118	13934611038	K M X I 2000 LIVING TRUST	PAPPAS CAROL J TRS	1125 CASHMAN DR	LAS VEGAS NV 89102-1911		
119	13934512070	KHOUDARY DONNA	9917 LONG CATTLE AVE	LAS VEGAS NV 89117-6943			
120	13934612034	KOVAC-COHEN 1989 TRUST	DOWNTONWER 2007 TRUST	1 HUGHES CTR #701	LAS VEGAS NV 89169-6730		
121	13934210064	KRAMER JOHN A SR TRS	%FITZGERALDS CASINO & HOTEL	P O BOX 7600	LAS VEGAS NV 89125-7600		
122	13934613244	KRUPNCIK STEVEN L	9 ISLAND AVE #1603	MIAMI BEACH FL 33139-1360			
123	13934613001	L V B-OGDEN MARKETING CORP	%S HEWITT	3959 N LINCOLN AVE	CHICAGO IL 60613- 2481		
124	13934612011	LA PALOMA BLANCA L L C	8801 SCENIC HARBOR DR	LAS VEGAS NV 89117-2295			
125	13934613208	LAM KATHARINE K	210 GOODWIN DR	SAN BRUNO CA 94066-1668			
126	13934613039	LANCASTER JACK D & HILDE C	8 FAIRFAX RD	BAKERSFEILD CA 93307-3008			

CASE# SUP-40520

	PARCEL#	OWNER	ADDRESS1	ADDRESS2	ADDRESS3	ADDRESS4	ADDRESS5
127	13934512066	LANDEROS MANUEL & MARCELINO	400 N 8TH ST	LAS VEGAS NV 89101-3016			
128	13934612052	LAS VEGAS DRAGON HOTEL L L C	150 VALLEY OAK DR	NAPA CA 94558-5666			
129	13934611030	LAU JEFFREY & SOPHIE	%GOOD EARTH ENTPRS INC	785 COLUMBUS AVE	SAN FRANCISCO CA 94133-2732		
130	13934510023	L'CHAIM FREMONT ASSOC PPTY INC	6130 W FLAMINGO RD #402	LAS VEGAS NV 89103-2280			
131	13934610010	L'CHAIM WESTERN VILAGE PPTY LLC	%H GABAY	6130 W FLAMINGO RD #402	LAS VEGAS NV 89103-2280		
132	13934510002	LEEBOVE SYDELL ETAL	9901 COVINGTON CROSS DR #190	LAS VEGAS NV 89144-6595			
133	13934611041	LIG LAND DEVELOPMENT L L C	785 COLUMBUS AVE	SAN FRANCISCO CA 94133-2732			
134	13934512040	LITVAK DAVID M	2005 PINTO LN	LAS VEGAS NV 89106-4018			
135	13934612054	LODGE ARTESIA #43 IOOF	LODGE OASIS REBEKAH #31	%E TAYLOR	867 N LAMB #40	LAS VEGAS NV 89110-2312	
136	13927804004	LODGE ELKS PAST RULERS #1468	4100 W CHARLESTON BLVD	LAS VEGAS NV 89102-1623			
137	13934610006	LODGE MASONIC #32	301 E FREMONT ST BOX 7600	LAS VEGAS NV 89125-7600			
138	13934613167	MADAYAG CHRISTINE & JUANITO O	4225 PERFECT DRIFT ST	LAS VEGAS NV 89129-6073			
139	13934512002	MAGHAMFAR HAMID R	329 LAS VEGAS BLVD	LAS VEGAS NV 89101-2965			
140	13934510027	MARSHALL FAMILY L P	%T MARSHALL	P O BOX 46470	LAS VEGAS NV 89114-6470		

CASE# SUP-40520

	PARCEL#	OWNER	ADDRESS1	ADDRESS2	ADDRESS3	ADDRESS4	ADDRESS5
141	13934512069	MARTIN FAMILY TRUST	MARTIN RICHARD A & ELIZABETH TRS	6917 E BONANZA RD	LAS VEGAS NV 89110-4225		
142	13934612084	MARTINEZ DAN & STEPHANY	%J MARTINEZ	1729 WANDERING WINDS WY	LAS VEGAS NV 89128-7978		
143	13934613069	MCNAMEE KEVIN P	2755 GREAT SMOKEY CT	WESTLAKE VILLAGE CA 91362- 3727			
144	13934611051	MELE PONO HOLDING CO	%EQUITY GROUP	8367 W FLAMINGO RD #201	LAS VEGAS NV 89147-4153		
145	13934601002	MELE PONO HOLDING COMPANY	%EQUITY GROUP	8367 W FLAMINGO RD #201	LAS VEGAS NV 89147-4153		
146	13934111008	MILLER C W	%BOYD GAMING- TAX DEPT	6465 S RAINBOW BLVD	LAS VEGAS NV 89118-3215		
147	13934111006	MILLER RALPH W JR	MILLER TRUST	4437 ANNETTE PARK DR	BOZEMAN MT 59715-9273		
148	13927812006	MORENO ANTONIO	P O BOX 21679	LONG BEACH CA 90801-4679			
149	13934512068	MORENO JOSE A	408 N 8TH ST #B	LAS VEGAS NV 89101-3084			
150	13934510010	MORGAN GEORGE WILLIAM	MORGAN FAMILY TRUST	%BOYD GAMING- TAX DEPT	6465 S RAINBOW BLVD	LAS VEGAS NV 89118-3215	
151	13934612037	MUNICIPAL HOLDINGS L L C	%J KUYKENDALL	%CITICORP USA INC	1801 CALIFORNIA ST #3700	DENVER CO 80202- 2642	
152	13934611015	NATIONWIDE CHECK SERVICE INC	515 FREMONT ST	LAS VEGAS NV 89101-5611			
153	13934512030	NEIGHBORHOOD HOUSING SERV S NV	1849 CIVIC CENTER DR	NO LAS VEGAS NV 89030-7131			
154	13935112002	NEVADA DEVELOPMENTS L L C	316 N 9TH ST #12	LAS VEGAS NV 89101-3068			

CASE# SUP-40520

	PARCEL#	OWNER	ADDRESS1	ADDRESS2	ADDRESS3	ADDRESS4	ADDRESS5
155	13934611050	NEVADA HORIZON HOLDING L L C	SOLARIUM ENTERPRISES L P	888 S FIGUEROA ST #1900	LOS ANGELES CA 90017-5324		
156	13934613106	NICDAO CARMELITA O	928 SAN RAPHAEL ST	KISSIMMEE FL 34759-3907			
157	13934111055	NOBLITT 2004 TRUST ETAL	NOBLITT ROGER L TRS	%FOUR QUEENS HOTEL & CASINO	202 FREMONT ST	LAS VEGAS NV 89101-5606	
158	13934210063	NOLEN 1983 TRUST	TINKLER RICHARD J & EDITH CO-TRS	2344 ELBURY CT	THOUSAND OAKS CA 91361-5095		
159	13934512086	NORTH WILSON LIMITED PARTNERSHIP	%MAE WEST PPTY LLC	29-26 163RD ST	FLUSHING NY 11358-1424		
160	13934111007	OCCIDENTAL COLLEGE	%BOYD GAMING-TAX DEPT	6465 S RAINBOW BLVD	LAS VEGAS NV 89118-3215		
161	13934613149	OKUNA THOMAS M REVOCABLE LIV TR	101 AUPUNI ST #703	HILO HI 96720-4256			
162	13934613100	OLSON MARLAN V & MICHELLE D	14029 WAGON WY	SILVER SPRINGS MD 20906-2065			
163	13934111057	PETO FAMILY TRUST	HAM A W JR GIFT TR	%FOUR QUEENS HOTEL & CASINO	202 FREMONT ST	LAS VEGAS NV 89101-5606	
164	13934612005	PINI DARIO	1335 MISSION RIDGE RD	SANTA BARBARA CA 93103-2056			
165	13934612017	PINJUV MATTHEW ETAL	2908 SARINA AVE	HENDERSON NV 89074-2848			
166	13934510043	PLUG IT IN II L L C	3900 PARADISE RD #101	LAS VEGAS NV 89169-0932			
167	13934512075	POTTER MARK	100 E SUN MARCOS BLVD #400	SAN MARCOS CA 92069-2988			
168	13934612047	PRESARIO PROPERTIES L L C	2559 BEECHWOOD VILLAGE CT	HENDERSON NV 89052-7139			

CASE# SUP-40520

	PARCEL#	OWNER	ADDRESS1	ADDRESS2	ADDRESS3	ADDRESS4	ADDRESS5
169	13934111004	R & S P FAMILY TRUST ETAL	PECCOLE ROBERT N JR TRS	8981 W SAHARA AVE #120	LAS VEGAS NV 89117-5894		
170	13934612012	RAFFI BEN	100 S DOHENY DR #1007	LOS ANGELES CA 90048-2932			
171	13934512060	REYNOSO ESTELA	7040 PALMYRA AVE	LAS VEGAS NV 89117-3108			
172	13934510008	RILEY MARJORIE R LIV TR #2 ETAL	HALLIDAY JUSTINE TRS	P O BOX 291099	LOS ANGELES CA 90029-9099		
173	13934512093	ROBERTS BRADFORD	TOYODA KUMIKO	1810 E SAHARA AVE #100	LAS VEGAS NV 89104-3735		
174	13934510048	ROCKWELL LEON H SR GIFT TR ETAL	%J HALLIDAY	P O BOX 291099	LOS ANGELES CA 90029-9099		
175	13934512065	RODRIGUEZ ABRAHAM & P JT REV TR	RODRIGUEZ ABRAHAM & PEACHES TRS	2325 BOULDER LN	BELOIT WI 53511- 6709		
176	13927811038	ROMANO DANIEL ALLEN	733 N 10TH ST	LAS VEGAS NV 89101-2503			
177	13934111017	RONNOW J L ETAL	%BOYD GAMING CORP	6465 S RAINBOW BLVD 4TH FL	LAS VEGAS NV 89118-3215		
178	13934512041	RYAN CO L L C	436 S 10 W	FARMINGTON UT 84025-2203			
179	13934512029	S & J GROUP INC	209 N 7TH ST	LAS VEGAS NV 89101-4205			
180	13934111025	SAGE REALTY CO	SPEAKEASY GAMING FREMONT- IMPS	128 EAST FREMONT ST	LAS VEGAS NV 89101-5604		
181	13934111015	SAM-WILL INC	%BOYD GAMING	6465 S RAINBOW BLVD	LAS VEGAS NV 89118-3215		
182	13934111058	SCHAEFFER KEITH F REV TR ETAL	SCHAEFFER KEITH F TRS	%FOUR QUEENS HOTEL & CASINO	202 FREMONT ST LAS VEGAS NV 89101		

CASE# SUP-40520

PARCEL#	OWNER	ADDRESS1	ADDRESS2	ADDRESS3	ADDRESS4	ADDRESS5
183	13934610009	SCHIFF ROBERT	1004 NEW ROAD	NORTHFIELD NJ 08225-1661		
184	13934512095	SCOTT STEPHEN	413 N 9TH ST	LAS VEGAS NV 89101-3034		
185	13934611024	SEARS JANET D ETAL	%H & L REALTY	P O BOX 7440	LAS VEGAS NV 89125-7440	
186	13934611043	SENIOR NEVADA BENEFIT GROUP L P	1600 BECKE CIR	LAS VEGAS NV 89104-3322		
187	13934512043	SEQUEIRA JOSE R JR & MARIA G	P O BOX 43222	LAS VEGAS NV 89116-1222		
188	13934613203	SEYMOUR RAYMOND P & JOETTA B	9 TEAL	IRVINE CA 92604- 4526		
189	13934612006	SHREE GANESHA INC	700 E FREMONT ST	LAS VEGAS NV 89101-5616		
190	13934613063	SHUSTREAM L L C	928 SAN RAPHAEL ST	KISSIMMEE FL 34759-3907		
191	13934613179	SIEMERS DONALD	150 LAS VEGAS BLVD #1904	LAS VEGAS NV 89101-2949		
192	13934613083	SMITH LANNY LEE	10024 CLOVERCREST DR	COLORADO SPRINGS CO 80920- 5503		
193	13934613040	SMITH LANNY LEE II	10024 CLOVECREST DR	COLORADO SPRINGS CO 80920- 5503		
194	13934512077	SMITH RUBY V	SMITH RUBY V REVOCABLE LIVING TR	401 N 8TH ST	LAS VEGAS NV 89101-3015	
195	13934512078	SMITH RUBY V REVOCABLE LIVING TR	SMITH RUBY V TRS	401 N 8TH ST	LAS VEGAS NV 89101-3015	
196	13934111059	SOSS DAVID A ETAL	%FOUR QUEENS HOTEL & CASINO	202 FREMONT ST	LAS VEGAS NV 89101-5606	

CASE# SUP-40520

PARCEL#	OWNER	ADDRESS1	ADDRESS2	ADDRESS3	ADDRESS4	ADDRESS5
197	13934613161	SPAIN DIXON L	3595 SANTA FE AVE SPC 181	LONG BEACH CA 90810-4359		
198	13927803007	STATE OF NEVADA	CARSON CITY NV 89701			
199	13927804003	T L C PROPERTIES INC	1863 HELM DR	LAS VEGAS NV 89119-3911		
200	13934613061	TAKAMIYA ROBERT & DEIRDRE	95-1091 LALAI ST	MILILANI HI 96789-3712		
201	13934611016	T-BREO II L L C	1 MAIN ST	LAS VEGAS NV 89101-6370		
202	13934512082	THAJJ L L C	%J J LEAVITT	704 S 9TH ST	LAS VEGAS NV 89101-7015	
203	13934612069	THOMAS GEORGE ETAL	2945 S MONTE CRUST WY	LAS VEGAS NV 89117		
204	13934510026	THREE TWENTY TWO L L C	9030 W FLAMINGO RD #190	LAS VEGAS NV 89147-6471		
205	13934610040	TINKLER REVOCABLE TRUST #1	TINKLER RICHARD J & EDITH E TRS	2344 ELBURY CT	THOUSAND OAKS CA 91361-5095	
206	13934612061	TRUSTEE CLARK COUNTY TREASURER	%BAPTIST MISSION TO ENGLAND INC	P O BOX 16217	TALLAHASSE FL 32317-6217	
207	13934612060	T-W H R L L C	1 MAIN ST	LAS VEGAS NV 89101-6370		
208	13934210066	V F CARSON L L C	%THOMPSON NATL PPTYS LLC	%TAX DEPT	3131 S VAUGHN WY #301	AURORA CO 80014-3509
209	13934612019	VALLEY OF THE SUN LAS VEGAS LLC	1345 S LEWIS ST	ANAHEIM CA 92805-6431		
210	13934111014	VINTAGE VEGAS GAMING INC	%R SZEPELAK	128 E FREMONT ST	LAS VEGAS NV 89101-5604	

CASE# SUP-40520

	PARCEL#	OWNER	ADDRESS1	ADDRESS2	ADDRESS3	ADDRESS4	ADDRESS5
211	13934613014	WALTER BRENT JAMES & ANITA LYNN	2417 32ND AVE S W	CALGARY ALBERTA	CANADA TNT1X4 00000-0000		
212	13935110013	WALTERS EDWARD	402 N 9TH ST	LAS VEGAS NV 89101-3035			
213	13934512057	WANDERER JOHN FAMILY TRUST	1711 S 15TH ST	LAS VEGAS NV 89104-3102			
214	13934613175	WATTS LEONARD F	550 STONEYWOOD TERR	MABLETON GA 30126-0000			
215	13934512083	WELCKER LEO A	313 N 8TH ST	LAS VEGAS NV 89101-3014			
216	13935110012	WOOFER ROY A SEPARATE PPTY TR	GAGLIONE- WOOFER D L SEP PPTY TR	2655 S MONTE CRISTO WY	LAS VEGAS NV 89117-2948		

City of Las Vegas
Office Of The City Clerk
333 North Rancho Drive, 3rd Floor
Las Vegas, Nevada 89107

Return Service Requested
Official Notice of Public Hearing

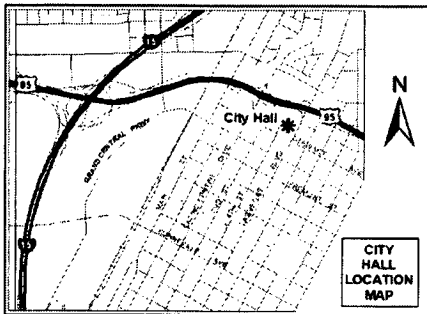

If you wish to file your protest or support on this request, check the appropriate box below and return this card in an envelope with postage to the Office Of The City Clerk at the address listed above or fax this side of this card to (702) 382-4803. If you would like to contact your Council Representative, please call (702) 229-6405.

I SUPPORT
this Request

I OPPOSE
this Request

Please use available blank space on card for your comments.

SUP-40520

City Council Meeting of 3/16/2011

Application Information

SUP-40520 - APPLICANT/OWNER: FREMONT PLACE, LLC - Request for a Special Use Permit FOR A 100 SQUARE-FOOT ACCESSORY PACKAGE LIQUOR, OFF-SALE ESTABLISHMENT IN CONJUNCTION WITH AN EXISTING 3,553 SQUARE-FOOT CONVENIENCE STORE at 228 North Las Vegas Boulevard (APN 139-34-501-016), C-2 (General Commercial) Zone, Ward 5 (Barlow).

Application Location

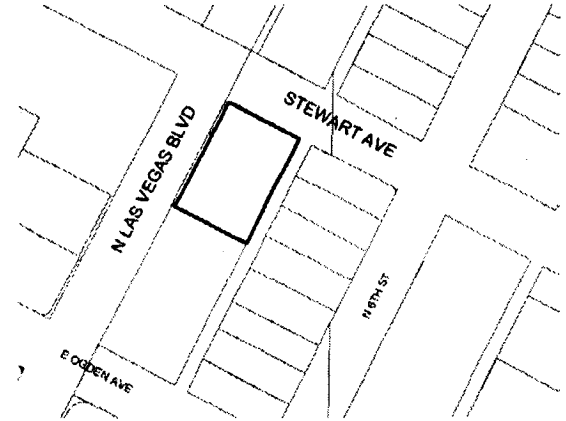

The proposed project may not pertain to the entire highlighted project site.

Public Hearing Information

Meeting: City Council
Date: *March 16, 2011*
Time: 1:00 P.M.
Location: City Council Chambers
400 Stewart Avenue
Las Vegas, Nevada

Any and all interested persons may appear and be heard at said meeting, or may, prior thereto, file written objections thereto or approvals thereof with the City Clerk, 1st Floor, City Hall, objection thereto or approval thereof with the Planning and Development Department, Development Services Center, 333 North Rancho Drive, 3rd Floor, Las Vegas, Nevada 89101. Final Action on General Plan For further information, including the full staff report, please call (702) 229-6311 (TDD 386-9108) or go to <http://www.lasvegasnevada.gov>.