

CASE# VAR-40579, SUP-40577

PARCEL#	OWNER	ADDRESS1	ADDRESS2	ADDRESS3	ADDRESS4	ADDRESS5
1	13802813009 ADAMS CHARLES HOWARD	4108 ROXANNE DR	LAS VEGAS NV 89108-5218			
2	13811510001 ADDISON ROSALINDA M & SHAWN P	6333 W ALEXANDER RD	LAS VEGAS NV 89108-5215			
3	13802814019 ARETE L L C	%W JONDAHL	7465 W LAKE MEAD BLVD #100	LAS VEGAS NV 89128-1033		
4	13802416037 ARRIAZA EDGAR & MARIA ELENA	4009 MIRA LN	LAS VEGAS NV 89108-5534			
5	13802412009 BAMBOO 6437 FAMILY L P	%E BRECLAW	6437 BAMBOO CT	LAS VEGAS NV 89108-5614		
6	13802412019 BANFIELD MARY G	6405 BAMBOO PL	LAS VEGAS NV 89108-5603			
7	13802811008 BANICH B MICHAEL	GAEB-BANICH SANDRA K	4101 JORY TRL	LAS VEGAS NV 89108-5206		
8	13802811004 BANK DEUTSCHE NATIONAL TR CO TRS	4828 LOOP CENTRAL DR #600	HOUSTON TX 77081-2212		3/16/2011 VAR-40579 & SUP-40577	
9	13802814025 BANK FIRST SAVINGS	2605 E FLAMINGO RD	LAS VEGAS NV 89121-5241		Mr. and Mrs. Conan Turner 6308 Jennifer Court Las Vegas, Nevada 89108	
10	13802810008 BANK U S NATIONAL ASSN TRS	%HOME LOAN SERVICES	150 ALLEGHENY CENTER	PITTSBURG PA 15212-5335		
11	13802813001 BARLOW SCOTT L & DEBRA L	4001 ROXANNE DR	LAS VEGAS NV 89108-5212			
12	13802416051 BEARD SHEILA J PIERSON	4005 MONTE GRANDE CIR	LAS VEGAS NV 89108-5516			
13	13802416023 BELBOT MICHAEL R	4017 RUBIDOUX DR	LAS VEGAS NV 89108-5514			
14	13802811028 BENEFIEL JACK W & DOLORES A	6305 JENNIFER CT	LAS VEGAS NV 89108-5201			

CASE# VAR-40579, SUP-40577

	PARCEL#	OWNER	ADDRESS1	ADDRESS2	ADDRESS3	ADDRESS4	ADDRESS5
15	13802316005	BENNETT TRUST	BENNETT HERBERT M & JOAN F TRS	6428 BAMBOO CT	LAS VEGAS NV 89108-5614		
16	13802416024	BERGERSON WILLIAM B & BONNIE J	4013 RUBIDOUX DR	LAS VEGAS NV 89108-5514			
17	13802416039	BERRANG ERIC A	6425 OUIDA WY	LAS VEGAS NV 89108-5526			
18	13802812004	BITTNER SHAWN & MELANIE	4001 N TORREY PINES DR	LAS VEGAS NV 89108-5501			
19	13802711001	BLANDORI EDWARD H	4233 JORY TRL	LAS VEGAS NV 89108-5210			
20	13802811019	BLUE FAMILY TRUST	BLUE RONALD A & DIANE E TRS	4017 RHONDA DR	LAS VEGAS NV 89108-5208		
21	13802416011	BRADLEY ROBERT	6500 OUIDA WY	LAS VEGAS NV 89108-5542			
22	13802710002	BROGAN RODNEY M & VICTORIA R	4240 JORY TRL	LAS VEGAS NV 89108-5207			
23	13802813004	BROWN MARION R & MARGARET J	4025 ROXANNE DR	LAS VEGAS NV 89108-5212			
24	13802810001	BRUCE FAMILY TRUST	BRUCE ROSALIE DAWN TRS	4141 N TORREY PINES DR	LAS VEGAS NV 89108-5538		
25	13802416047	BUCHANAN AUDRY WAYNE & CAROL J	4012 RUBIDOUX DR	LAS VEGAS NV 89108-5518			
26	13802812002	BUCKEY JAY F	4017 N TORREY PINES	LAS VEGAS NV 89108-5501			
27	13811510006	BUCKINGHAM WILLIAM H JR TRUST	BUCKINGHAM WILLIAM H JR TRS	6241 ALEXANDER RD	LAS VEGAS NV 89108-5216		
28	13811111113	BURROUGHS HOOVER E & VIOLA	6416 PEAR CREST RD	LAS VEGAS NV 89108-5306			

CASE# VAR-40579, SUP-40577

	PARCEL#	OWNER	ADDRESS1	ADDRESS2	ADDRESS3	ADDRESS4	ADDRESS5
29	13811510005	BURTON DONALD J LIVING TRUST	BURTON DONALD J TRS	6301 ALEXANDER RD	LAS VEGAS NV 89108-5215		
30	13802414010	CANADA-BONES TERESA	BONES STEPHEN W	6500 ROY ROGERS DR	LAS VEGAS NV 89108-5529		
31	13811111013	CHAMBERS MAUREEN A & JEFFRY L	3940 N TORREY PINES DR	LAS VEGAS NV 89108-5900			
32	13802414027	CHAN COREY T & RINA	828 CRYSTAL WATER LN	WALNUT CA 91789- 1464			
33	13802811027	CHESS ROBERT W & PATRICIA L	6301 JENNIFER CT	LAS VEGAS NV 89108-5201			
34	13802711005	CHILDRESS JAMES & GEORGIA FAM TR	CHILDRESS JAMES D & GEORGIA TRS	4201 JORY TRL	LAS VEGAS NV 89108-5210		
35	13802814021	CHIRINKIN ALEXEI	N V P K INTERNATIONAL L L C	21 THE GRESSLANDS	WOODBURY NY 11797-1120		
36	13802416018	CHMARA MICHAEL J	DENTON HELGA M	6404 OUIDA WY	LAS VEGAS NV 89108-5527		
37	13802712007	CHURCH CALVARY CHAPEL MINISTRIES	4295 N RANCHO DR	LAS VEGAS NV 89130-3449			
38	13802412014	CIMPERMAN BRIAN	6412 BAMBOO PL	LAS VEGAS NV 89108-5615			
39	13802316003	CLARK CHARLES O	%M COLBERT	2412 GOLDFIRE CIR	HENDERSON NV 89052-2667		
40	13802416041	COOK RICHARD C LIVING TRUST	COOK RICHARD C TRS	6417 OUIDA WY	LAS VEGAS NV 89108-5526		
41	13811510007	COPPER WILLIAM R	6233 W ALEXANDER RD	LAS VEGAS NV 89108-5216			
42	13802811023	COSTELLO MARK & LORRAINE	4004 RHONDA DR	LAS VEGAS NV 89108-5209			

	PARCEL#	OWNER	ADDRESS1	ADDRESS2	ADDRESS3	ADDRESS4	ADDRESS5
43	13802701003	COUNTY OF CLARK(UMC)	%ACCTS PAYABLE	1800 W CHARLESTON BLVD	LAS VEGAS NV 89102-2329		
44	13802416016	DAGUE JIMMY J	6637 STAR VIEW CT	LAS VEGAS NV 89118-1829			
45	13802414025	DASILVA JOSE VITORINO	RAMOS-LARA ALEJANDRO ANTONIO	6401 ROY ROGERS DR	LAS VEGAS NV 89108-5522		
46	13802414009	DEARMAS ILLIAN MIZO	6504 ROY ROGERS DR	LAS VEGAS NV 89108-5529			
47	13802811006	DELAFUENTE FAMILY 2003 TRUST	DELAFUENTE JESUS TRS	4117 JORY TRL	LAS VEGAS NV 89108-5206		
48	13802301003	DELEON EFREN N & NEVARRIE P	4325 N TORREY PINES DR	LAS VEGAS NV 89108-5510			
49	13802416036	DIETZ BETH ANN	4518 CHECKER WY	NO LAS VEGAS NV 89031-6230			
50	13802416050	DIETZ TERRY LEE & CAROL	6412 MIRAGRANDE DR	LAS VEGAS NV 89108-5533			
51	13802416049	DIXON ELBERT SR	HALEY MARILYN	4008 RUBIDOUX DR	LAS VEGAS NV 89108-5518		
52	13802813005	DIXON WILLIAM LOYD & DOLORES	4101 ROXANNE DR	LAS VEGAS NV 89108-5219			
53	13802412026	DOMKE DEBRA L	6433 DELPHINIUM AVE	LAS VEGAS NV 89108-5623			
54	13802811033	DORSEY PATSY LEE	4200 JORY TRL	LAS VEGAS NV 89108-5207			
55	13802416045	DUNLAP SANDRA F	6401 OUIDA WY	LAS VEGAS NV 89108-5526			
56	13802813006	ELLIANO JACK & ANIETA FAMILY TR	ELLIANO JACK L JR & ANICETA TRS	4117 ROXANNE DR	LAS VEGAS NV 89108-5219		

	PARCEL#	OWNER	ADDRESS1	ADDRESS2	ADDRESS3	ADDRESS4	ADDRESS5
57	13802813007	ELLIANO JACK L & ANICETA	4117 ROXANNE DR	LAS VEGAS NV 89108-5219			
58	13802711003	ENSLEY JAMES P & LINDA A	4217 JORY TRL	LAS VEGAS NV 89108-5210			
59	13802412013	FAVATA SALVATORE & ANTHONY	4117 THUNDER TWICE ST	LAS VEGAS NV 89129-6067			
60	13802414022	FEDERAL NATIONAL MORTGAGE ASSN	%ONEWEST BANK FSB	888 E WALNUT ST	PASADENA CA 91101-1802		
61	13802811029	FERRANTI PETER W & CAROL	6309 JENNIFER CT	LAS VEGAS NV 89108-5201			
62	13802414020	FERRIGNO JOSEPH M & ALISA A	4125 RUBIDOUX DR	LAS VEGAS NV 89108-5511			
63	13802414021	FLEISCHMAN FAMILY TRUST	FLEISCHMAN JEFFREY L & CHERI M	4121 RUBIDOUX DR	LAS VEGAS NV 89108-5511		
64	13802416044	FORTE DANA M	6405 OUIDA WY	LAS VEGAS NV 89108-5526			
65	13802414029	GARDNER GERALD J & LOU CEAL M	6417 ROY ROGERS DR	LAS VEGAS NV 89108-5522			
66	13802416046	GASPAR LUCIANA	4016 RUBIDOUX DR	LAS VEGAS NV 89108-5518			
67	13802315050	GAVELEK BRIAN E	4221 JASPER AVE	LAS VEGAS NV 89108-5638			
68	13802414012	GENICK PAUL S	4116 MONTEMESA CIR	LAS VEGAS NV 89108-5528			
69	13802711004	GILCHRIST LIVING TRUST	GILCHRIST PHILIP L TRS	4209 JORY TRAIL	LAS VEGAS NV 89108-5210		
70	13802315053	GONZALEZ JUAN G & EVA	6405 HARTMAN ST	LAS VEGAS NV 89108-5628			

	PARCEL#	OWNER	ADDRESS1	ADDRESS2	ADDRESS3	ADDRESS4	ADDRESS5
71	13802711006	GORSLINE MICHAEL J & KATHRINE	4216 JORY TRL	LAS VEGAS NV 89108-5207			
72	13802416027	GOSSELIN RICHARD R & STANETTE L	4001 RUBIDOUX DR	LAS VEGAS NV 89108-5517			
73	13802416034	GRAHAM LIVING TRUST	GRAHAM WILLIAM R & SHERI L TRS	6425 MIRAGRANDE DR	LAS VEGAS NV 89108-5532		
74	13802813013	GRANT 1997 TRUST	GRANT RICHARD L & JOAN TRS	4024 ROXANNE DR	LAS VEGAS NV 89108-5213		
75	13802416029	GREEN EDWARD C II & MARIA LINDA	GREEN LINDA C & EDWARD C II	6405 MIRA GRANDE DR	LAS VEGAS NV 89108-5532		
76	13802301002	HABRASCHKA KURT & HANNELORE	4329 N TORREY PINES DR	LAS VEGAS NV 89108-5510			
77	13802416048	HALEY MARILYN M REVOCABLE LIV TR	HALEY MARILYN M TRS	4008 RUBIDOUX DR	LAS VEGAS NV 89108-5518		
78	13802416012	HAMM PATRICIA	6428 OUIDA WY	LAS VEGAS NV 89108-5527			
79	13802416055	HANES JACK DALLAS & TERESA A	P O BOX 364971	NO LAS VEGAS NV 89036-8971			
80	13802811020	HANSEN KAREN A	4009 RHONDA DR	LAS VEGAS NV 89108-5208			
81	13802416013	HANSEN PAUL B	6424 OUIDA WY	LAS VEGAS NV 89108-5527			
82	13802416020	HANSEN ROY HENRY	COTICHIO CATHERINE	4105 RUBIDOUX DR	LAS VEGAS NV 89108-5500		
83	13802811025	HERRMANN RICHARD & KERRIE A	4012 RHONDA DR	LAS VEGAS NV 89108-5209			
84	13802813010	HESS BRIAN D & BRIAN DALE	4100 ROXANNE DR	LAS VEGAS NV 89108-5218			

	PARCEL#	OWNER	ADDRESS1	ADDRESS2	ADDRESS3	ADDRESS4	ADDRESS5
85	13802414019	HOLLEY GERALD R JR & PAMELA K	4124 RUDIDOUX DR	LAS VEGAS NV 89108			
86	13802301001	HOUGHLAND JOHN F & IRENE A	4333 N TORREY PINES DR	LAS VEGAS NV 89108-5510			
87	13802414015	JAMES LUCY ANN	4121 MONTEMESA CIR	LAS VEGAS NV 89108-5528			
88	13802412028	JANOS FAMILY LIVING TRUST	JANOS LEWIS J & JANICE E TRS	5653 EL CARO CT	LAS VEGAS NV 89122-4730		
89	13802811034	JENACARO VICTOR A	4208 JORY TRL	LAS VEGAS NV 89108-5207			
90	13802813015	JOHNSON CRAIG & GWEN	48 HASSAYAMPA TRL	HENDERSON NV 89052-6667			
91	13802416017	JOHNSON MICHAEL T	6408 OUIDA WY	LAS VEGAS NV 89108-5527			
92	13802412008	JOHNSON THOMAS & JEWELENE LIV TR	6760 ROCKING HORSE AVE	LAS VEGAS NV 89108-5922			
93	13802712005	JORDAN JUDY K FAMILY TRUST	JORDAN JUDY KAY TRS	%CHOI INTERNATIONAL	1215 HUNAKAI ST #200	HONOLULU HI 96816-4661	
94	13802412025	KACHUR STEVE J	6429 DELPHINIUM AVE	LAS VEGAS NV 89108-5623			
95	13802412022	KENDLE DEAN R	6417 BAMBOO	LAS VEGAS NV 89108-5603			
96	13802811002	KERN JUNE	4149 JORY TRL	LAS VEGAS NV 89108-5206			
97	13811111015	KIRKER WILLIAM J & A L REV TR	4320 IVORY CIR	LAS VEGAS NV 89130-2539			
98	13802416031	KOPECKY EDWARD L & MAUREEN M	6413 MIRAGRANDE DR	LAS VEGAS NV 89108-5532			

	PARCEL#	OWNER	ADDRESS1	ADDRESS2	ADDRESS3	ADDRESS4	ADDRESS5
99	13802416030	KOPECKY FAMILY TRUST 2006 TRUST	KOPECKY MAUREEN M & EDWARD L TRS	604 CAMPBELL DR	LAS VEGAS NV 89107-4445		
100	13811111014	KYNASTON ANDREW L & AMELIA R	7105 SPRING BEAUTY AVE	LAS VEGAS NV 89131-0136			
101	13802712011	L S R E F 2 NOVA INVESTMENTS III	%HUDSON ADVISORS	%LEGAL DEPT	2711 N HASKELL AVE #1700	DALLAS TX 75204- 2922	
102	13802412027	LAMPKINS GENE	6437 DELPHINIUM AVE	LAS VEGAS NV 89108-5623			
103	13802412015	LEE EDWARD	6408 BAMBOO PL	LAS VEGAS NV 89108-5615			
104	13802416054	LESLIE WILLIAM W	6420 MIRAGRANDE DR	LAS VEGAS NV 89108-5503			
105	13802812001	LIMANDRI TRUST	LIMANDRI FILIPPO S & JULIE A TRS	4025 N TORREY PINES DR	LAS VEGAS NV 89108-5501		
106	13802710001	LOPEZ GERARDO MEZA TRUST	LOPEZ GERARDO MEZA TRS	4241 JORY TRAIL	LAS VEGAS NV 89108-5210		
107	13802416015	LOPEZ LIVIER OROZCO & REYMUNDO	6416 QUIDA WY	LAS VEGAS NV 89108			
108	13802811024	LYNNMARIE HOMES L L C	9913 FOX SPRINGS DR	LAS VEGAS NV 89117-0942			
109	13802712012	M S C I 2006-IQII RANCHO DR LLC	%EQUITY GROUP	8367 W FLAMINGO #201	LAS VEGAS NV 89147-4153		
110	13802813011	MAGUINNESS FAMILY TRUST	MAGUINNESS THOMAS S & E TRS	7504 VIA SIGNORELLI ST	LAS VEGAS NV 89131-0125		
111	13802810002	MAINE PAUL KENNETH TRUST	MAINE PAUL KENNETH TRS	4133 TORREY PINES	LAS VEGAS NV 89108-5538		
112	13802416038	MARIDON TRUST	MARIDON JOSEPH R & BETTY L TRS	6429 OUIDA WY	LAS VEGAS NV 89108-5526		

CASE# VAR-40579, SUP-40577

PARCEL#	OWNER	ADDRESS1	ADDRESS2	ADDRESS3	ADDRESS4	ADDRESS5
113	13811510003	MARISCAL ROGELIO	HOLLY SHEENA LEEAN	6317 W ALEXANDER RD	LAS VEGAS NV 89108-5215	
114	13802416021	MATSON DANIEL J	4101 RUBIDOUX DR	LAS VEGAS NV 89108-5500		
115	13802811031	MAZZOLA FAMILY LIV TR 09-23-06	6304 JENNIFER CT	LAS VEGAS NV 89108-5201		
116	13802416033	MCNULTY JOHN II & MICHELE FAM TR	MCNULTY JOHN C II & MICHELE TRS	6421 MIRAGRANDE DR	LAS VEGAS NV 89108-5532	
117	13802813016	MIKAMI LISA	98-627 KAAHELE ST	AIEA HI 96701-2705		
118	13802416043	MILLER GLORIA BLAIR	6409 OUIDA WY	LAS VEGAS NV 89108-5526		
119	13802416052	MILLER JOHN J	4008 MONTE GRANDE CIR	LAS VEGAS NV 89108-5516		
120	13802416019	MITCHELL WILLIAM DOUGLAS	P O BOX 26	RANCHO CORDOVA CA 95741-0026		
121	13802711002	MORALES ERNESTO	4225 JORY TRL	LAS VEGAS NV 89108-5210		
122	13802414023	MURDOCH JOHN N III & CYNTHIA L	4113 RUBIDOUX DR	LAS VEGAS NV 89108-5500		
123	13802814028	N RANCHO DR & W CRAIG RD L L C	%BANK NV/J NICHOLS	2700 W SAHARA AVE	LAS VEGAS NV 89102-1700	
124	13802813008	NAYLOR JEROME E & SHARON L	NAYLOR DEBRA	4116 ROXANNE DR	LAS VEGAS NV 89108-5218	
125	13802811009	NESCHKE MICHAEL	4057 JORY TRL	LAS VEGAS NV 89108-5202		
126	13802412016	NICOLAOU GEORGE E	P.O BOX 334	GOFFSTOWN NH 03045-0334		

CASE# VAR-40579, SUP-40577

PARCEL#	OWNER	ADDRESS1	ADDRESS2	ADDRESS3	ADDRESS4	ADDRESS5
127	13802811005	OLSEN MITCHEL A	RIETH CYNTHIA I	4125 JORY TRL	LAS VEGAS NV 89108-5206	
128	13802414030	OLSEN MITCHELL	4125 JORY TRL	LAS VEGAS NV 89108-5206		
129	13802316006	PELLETIER ELEANOR	HOPE CHARLES MICHAEL	6432 BAMBOO CT	LAS VEGAS NV 89108-5614	
130	13802814003	PEP BOYS MANNY MOE & JACK CA	4141 N RANCHO	LAS VEGAS NV 89130-3411		
131	13802412007	PIEPER DANIEL G	6428 DELPHINIUM	LAS VEGAS NV 89108-5624		
132	13802412021	PIERCE FAMILY TRUST	PIERCE RICHARD L & DIAN L TRS	4420 MILLRUN CT	NO LAS VEGAS NV 89032-0108	
133	13802414013	PIO GIG DE	KENNEDY YOLANDA G	4120 MONTEMESA CIR	LAS VEGAS NV 89108-5528	
134	13802810006	PLEHN THOMAS R SEPARATE PPTY TR	PLEHN THOMAS R TRS	4101 N TORREY PINES DR	LAS VEGAS NV 89108-5538	
135	13802414032	PREM DEFERRED TRUST	%P COFFMAN	8350 W SAHARA #150	LAS VEGAS NV 89117-8954	
136	13802811026	PRINGLE LORI	4016 RHONDA DR	LAS VEGAS NV 89108-5209		
137	13811510004	RAVELL GREGORY P & MICHELLE	6309 W ALEXANDER RD	LAS VEGAS NV 89108-5215		
138	13802810003	RENEL R D LIVING TRUST	RENEL RICHARD D TRS	4125 N TORREY PINES DR	LAS VEGAS NV 89108-5538	
139	13802414028	REQUENA SALLY A REVOCABLE LIV TR	REQUENA SALLY A TRS	6413 ROY ROGERS DR	LAS VEGAS NV 89108-5522	
140	13802811022	RESMA TONY R & MONA D	4000 RHONDA DR	LAS VEGAS NV 89108-5209		

CASE# VAR-40579, SUP-40577

PARCEL#	OWNER	ADDRESS1	ADDRESS2	ADDRESS3	ADDRESS4	ADDRESS5
141	13802811007	RHIZOR SHARON A & STEVEN T	4109 JORY TRL	LAS VEGAS NV 89108-5206		
142	13811111114	RHODES JACKIE	7800 ASTRAL AVE	LAS VEGAS NV 89149-6626		
143	13802316004	RODRIGUES WILLIAM & CLARA	4208 JASPER AVE	LAS VEGAS NV 89108-5639		
144	13802414016	ROLFE EUGENE L & PATTI L	4117 MONTEMESA CIR	LAS VEGAS NV 89108-5528		
145	13802416040	ROWLAND RICHARD L SR & PAULA M	6421 OUIDA WY	LAS VEGAS NV 89108-5526		
146	13802412020	RUDOLPH ROBBY J	6409 BAMBOO PL	LAS VEGAS NV 89108-5603		
147	13802811001	RUSSEL YVONNE	4157 JORY TRL	LAS VEGAS NV 89108-5206		
148	13802414018	RUST GLEN & KIMBERLY	4120 RUBIDOUX DR	LAS VEGAS NV 89108-5511		
149	13802315057	RUYBAL FAMILY TRUST	RUYBAL ERNEST & SYLVIA TRS	4237 AMETHYST AVE	LAS VEGAS NV 89108-5610	
150	13802712009	S L P NORTHBROOKE 3 L L C	P O BOX 6220	SAN DIEGO CA 92166-0220		
151	13802712010	S L P NORTHBROOKE 5 L L C	P O BOX 6220	SAN DIEGO CA 92166-0220		
152	13802416032	SAINSBURY SAMUEL & S K JT LIV TR	6417 MIRAGRANDE DR	LAS VEGAS NV 89108-5532		
153	13802712006	SAKURAI FAMILY TRUST	SAKURAI YUICHIRO & AKEMI TRS	2871 WOODBRIDGE CT	DIAMOND BAR CA 91765-3667	
154	13802412017	SANDERS GEORGE H	4217 BEGONIA CT	LAS VEGAS NV 89108-5616		

PARCEL#	OWNER	ADDRESS1	ADDRESS2	ADDRESS3	ADDRESS4	ADDRESS5
155	13802811012	SHELL RODGER	4033 JORY TRL	LAS VEGAS NV 89108-5202		
156	13802416026	SCHIMMELS KAREN	4005 RUBIDOUX DR	LAS VEGAS NV 89108-5517		
157	13802416022	SCOTT GWENDOLYN & LEON JR	5775 EL PARQUE AVE	LAS VEGAS NV 89146-1245		
158	13802813003	SHROCK SANDRA L	7621 COWBOY TRAIL	LAS VEGAS NV 89131-2130		
159	13802813014	SIMONSEN-BUECHE CAROL L	6790 ROYAL STALLION CT	LAS VEGAS NV 89131-3715		
160	13802416028	SJOBLOM CHRISTOPHER & ELIZABETH	6401 MIRAGRANDE DR	LAS VEGAS NV 89108-5532		
161	13802810005	SOTELO JOSE M	4109 N TORREY PINES DR	LAS VEGAS NV 89108		
162	13811111012	SOTO E E TRUST	SOTO ERNEST E TRS	3932 N TORREY PINES DR	LAS VEGAS NV 89108-5900	
163	13802814029	SPECKMAN DAVID	835 5TH AVE #301	SAN DIEGO CA 92101-6136		
164	13802414033	SPENCER FRANK Y & CAROLINE S	6501 ROY ROGERS DR	LAS VEGAS NV 89108-5541		
165	13802811011	STANLEY DANA SHEREE	4041 JORY TRL	LAS VEGAS NV 89108-5202		
166	13802315049	STEPHENS GWENDOLYN & TIMOTHY D	4217 JASPER AVE	LAS VEGAS NV 89108-5638		
167	13802811010	STEPHENSON MARK L & BARBARA G	4049 JORY TRL	LAS VEGAS NV 89108-5202		
168	13802316001	STEVENS MARIAN E LIVING TRUST	STEVENS MARIAN E TRS	4213 JASPER AVE	LAS VEGAS NV 89108-5638	

	PARCEL#	OWNER	ADDRESS1	ADDRESS2	ADDRESS3	ADDRESS4	ADDRESS5
169	13802811032	STIRLING DEAN F & LESLIE S	6300 JENNIFER CT	LAS VEGAS NV 89108-5201			
170	13802315051	SUITOR M & L FAMILY TRUST	SUITOR MICHAEL D & LYNN A TRS	10220 FOUR VIEWS ST	LAS VEGAS NV 89143-1028		
171	13802414011	SYLVIA MICHAEL & W REV LIV TR	SYLVIA MICHAEL & WINONA TRS	6428 ROY ROGERS DR	LAS VEGAS NV 89108-5523		
172	13802416014	TAHA MOHAMMAD A & DEANNA MARY TR	TAHA MOHAMMAD A & DEANNA M TRS	6420 OUIDA WY	LAS VEGAS NV 89108-5527		
173	13802412024	TAULKER GERALD L	6425 DELPHINIUM AVE	LAS VEGAS NV 89108-5623			
174	13802811021	THOM ARTHUR J & SUSAN A	4001 RHONDA DR	LAS VEGAS NV 89108-5208			
175	13802315054	THOMPSON ALICE	6401 HARTMAN ST	LAS VEGAS NV 89108-5628			
176	13802813002	THOMPSON BOBBY GLENN & BECKY	4009 ROXANNE DR	LAS VEGAS NV 89108-5212			
177	13802412018	THOMPSON JEANNETTE REV LIV TR	THOMPSON JEANNETTE TRS	6401 BAMBOO PL	LAS VEGAS NV 89108-5603		
178	13802414026	THOMPSON JOHN & GRACIELA LIV TR	THOMPSON JOHN & GRACIELA A TRS	1916 HOT OAK RIDGE ST	LAS VEGAS NV 89134-5514		
179	13802416035	THOMPSON TIMOTHY W & ANDREA	4001 MIRA LN	LAS VEGAS NV 89108-5534			
180	13802412023	TOMLINSON JOANNA	6421 BAMBOO PL	LAS VEGAS NV 89108-5603			
181	13802414031	TSIMALIS PAVLOS	TSIMALIS PAVLOS JR	6425 ROY ROGERS DR	LAS VEGAS NV 89108-5522		
182	13802414024	TSUCHIMORI TIMOTHY	4109 RUBIDOUX DR	LAS VEGAS NV 89108-5500			

CASE# VAR-40579, SUP-40577

	PARCEL#	OWNER	ADDRESS1	ADDRESS2	ADDRESS3	ADDRESS4	ADDRESS5
183	13802811030	TURNER CONAN & JESSICA	6308 JENNIFER CT	LAS VEGAS NV 89108-5201			
184	13802315048	VARNEY FAMILY TRUST	VARNEY ROGER D & GRETCHEN A TRS	6425 HARTMAN ST	LAS VEGAS NV 89108-5664		
185	13802416053	VAVREK JOHN F JR & JOYCE B	4004 MONTE GRANDE CIR	LAS VEGAS NV 89108-5516			
186	13802412012	WALLACE ELMER JOE & LAVONNA JO	4201 JASPER AVE	LAS VEGAS NV 89108-5638			
187	13802812003	WEBSTER STEPHEN C & CHERYL W	4009 N TORREY PINES DR	LAS VEGAS NV 89108-5501			
188	13802315056	WEST CORDELIA M & RODNEY H	4233 AMETHYST AVE	LAS VEGAS NV 89108-5610			
189	13811510002	WHEATON MARY BURNS	6325 W ALEXANDER RD	LAS VEGAS NV 89108-5215			
190	13802416025	WHITAKER MONICA J M	4009 RUBIDOUX DR	LAS VEGAS NV 89108-5517			
191	13802813012	WILLIAMS JON E	4041 N TORREY PINES	LAS VEGAS NV 89108-5501			
192	13802810007	WILLIAMS JON EDWARD	4041 N TORREY PINES DR	LAS VEGAS NV 89108-5501			
193	13802316002	WOJTOWICZ STANLEY & VALERIE	WOJTOWICZ STANLEY & V REV TR	4209 JASPER	LAS VEGAS NV 89108-5638		
194	13802414017	ZAIC LEWIS & STEVE	ZAIC JOYCE	8625 HIGHLAND VIEW CT	LAS VEGAS NV 89145-5709		
195	13802315052	ZUERN BRIAN W & THERESA M	6409 HARTMAN ST	LAS VEGAS NV 89108-5628			

City of Las Vegas
Office Of The City Clerk
333 North Rancho Drive, 3rd Floor
Las Vegas, Nevada 89107

Return Service Requested
Official Notice of Public Hearing

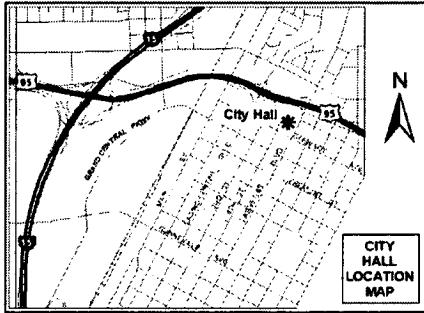

If you wish to file your protest or support on this request, check the appropriate box below and return this card in an envelope with postage to the Office Of The City Clerk at the address listed above or fax this side of this card to (702) 382-4803. If you would like to contact your Council Representative, please call (702) 229-6405.

I SUPPORT
this Request

I OPPOSE
this Request

Please use available blank space on card for your comments.

VAR-40579 & SUP-40577

City Council Meeting of 3/16/2011

Application Information

VAR-40579 - APPLICANT/OWNER: CONAN AND JESSICA TURNER - Request for a Variance TO ALLOW TWO PROPOSED ACCESSORY STRUCTURES (CLASS I AND CLASS II) WITH A COMBINED FLOOR AREA OF 3,467 SQUARE FEET WHERE 809 SQUARE FEET IS THE MAXIMUM ALLOWED, TO ALLOW AN ACCESSORY STRUCTURE (CLASS II) TO NOT BE AESTHETICALLY COMPATIBLE (METAL) WITH THE PRINCIPAL DWELLING UNIT (STUCCO), AND TO ALLOW BOTH ACCESSORY STRUCTURES TO BE 13 FEET SIX INCHES WHERE 13 FEET IS THE MAXIMUM ALLOWED on 0.45 acres at 6308 Jennifer Court (APN 138-02-811-030), R-E (Residence Estates) Zone, Ward 6 (Ross).

SUP-40577 - APPLICANT/OWNER: CONAN AND JESSICA TURNER - Request for a Special Use Permit FOR A PROPOSED 1,067 SQUARE-FOOT ACCESSORY STRUCTURE (CLASS I) WITH KITCHEN at 6308 Jennifer Court (APN 138-02-811-030), R-E (Residence Estate) Zone, Ward 6 (Ross).

Application Location

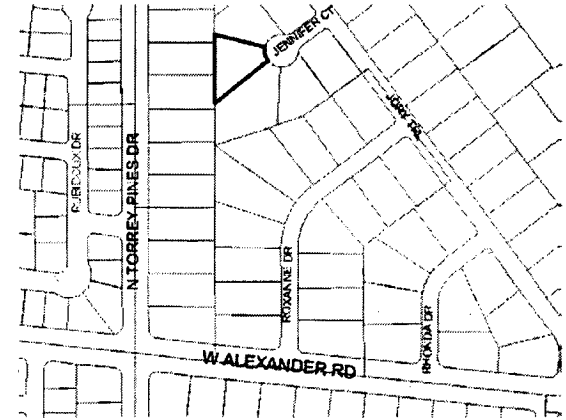

The proposed project may not pertain to the entire highlighted project site.

Public Hearing Information

Meeting: City Council
Date: *February 08, 2011*
Time: 1:00 P.M.
Location: City Council Chambers
400 Stewart Avenue
Las Vegas, Nevada

Any and all interested persons may appear and be heard at said meeting, or may, prior thereto, file written objections thereto or approvals thereof with the City Clerk, 1st Floor, City Hall, objection thereto or approval thereof with the Planning and Development Department, Development Services Center, 333 North Rancho Drive, 3rd Floor, Las Vegas, Nevada 89107. Final Action on General Plan For further information, including the full staff report, please call (702) 229-6311 (TDD 386-9108) or go to <http://www.lasvegasnevada.gov>.