



Legal Notices Transmittal and Scanning Separator Sheet

Legal Notice Type: Legal Mailings

Date of Transfer to ERM: 11/5/2010

Page Count: 16

Meeting Date: 11/17/2010

Meeting Type: City Council <=>

Case Number(s): GPA-39192 & ZON-39193 <=>

Subject of Affidavit: City of Las Vegas 5.76 acres on the so side of U.S. 95, east of Casino Center Blvd <=>

Record Series: Legal Notices

LRDA Number: 2007-1717

Retention: Permanent

File By: Meeting Date



Prepared By: acrolli

Scanned By: _____

QC By: _____

City of Las Vegas
Office Of The City Clerk
400 Stewart Avenue
Las Vegas, Nevada 89101

Return Service Requested
Official Notice of Public Hearing

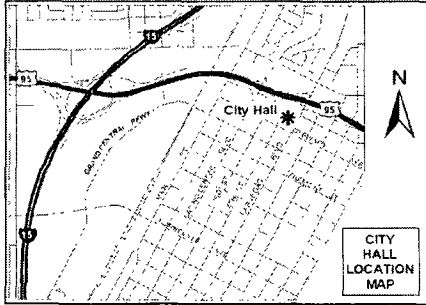

If you wish to file your protest or support on this request, check the appropriate box below and return this card in an envelope with postage to the Office Of The City Clerk at the address listed above or fax this side of this card to (702) 382-4803. If you would like to contact your Council Representative, please call (702) 229-6405.

I SUPPORT
this Request

I OPPOSE
this Request

Please use available blank space on card for your comments.

GPA-39192 & ZON-39193

City Council Meeting of 11/17/2010

Application Information

GPA-39192 - APPLICANT/OWNER: CITY OF LAS VEGAS - Request for a General Plan Amendment FROM: PF (PUBLIC FACILITIES) TO: C (COMMERCIAL) on 5.76 acres on the south side of U.S. 95, east of Casino Center Boulevard (APNs 139-34-501-004, 008, 139-34-510-045, 139-34-512-001 and 005), Ward 5 (Barlow).

ZON-39193 - APPLICANT/OWNER: CITY OF LAS VEGAS - Request for a Rezoning FROM: C-V (CIVIC) TO: C-2 (GENERAL COMMERCIAL) on 4.07 acres on the south side of U.S. 95, east of Casino Center Boulevard (APNs 139-34-501-004, 008 and 139-34-512-001), Ward 5 (Barlow).

Application Location

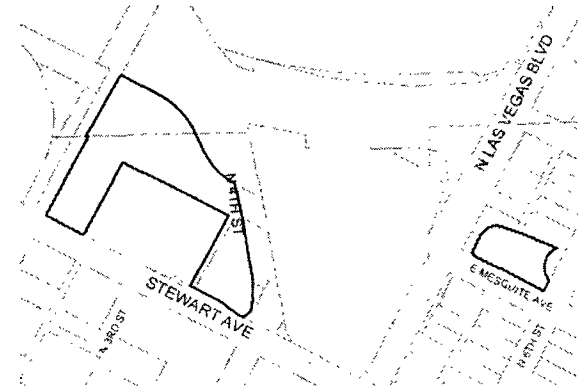

The proposed project may not pertain to the entire highlighted project site.

Public Hearing Information

Meeting: City Council
Date: *November 11, 2010*
Time: 1:00 P.M.
Location: City Council Chambers
400 Stewart Avenue
Las Vegas, Nevada

Any and all interested persons may appear and be heard at said meeting, or may, prior thereto, file written objections thereto or approvals thereof with the City Clerk, 1st Floor, City Hall, 400 Stewart Avenue, Las Vegas, Nevada, 89101. For further information, including the full staff report, please call (702) 229-6311 (TDD 386-9108) or go to <http://www.lasvegasnevada.gov>.

PARCEL#	OWNER	ADDRESS1	ADDRESS2	ADDRESS3	ADDRESS4	ADDRESS5
1	13927810036	10 E BONANZA L L C	P O BOX 28399	LAS VEGAS NV 89126-2399		
2	13934501009	201 NORTH THIRD ST L V L L C	%CIM GROUP INC	%ACCT DEPT	6922 HOLLYWOOD BLVD 9TH FLR	LOS ANGELES CA 90028-6117
3	13934514009	220 NORTH 4TH STREET L V L L C	%CIM GROUP INC	%ACCT DEPT	6922 HOLLYWOOD BLVD 9TH FLR	LOS ANGELES CA 90028-6117
4	13927811037	400 BONANZA L L C	%L THOMPSON	P O BOX 28399	LAS VEGAS NV 89126-2399	
5	13927804001	530 HOLDINGS L L C	3900 PARADISE RD #101	LAS VEGAS NV 89169-0932		
6	13927805002	7-ELEVEN INC	%AV TAX DEPT	P O BOX 711	DALLAS TX 75221- 0711	
7	13934601005	7TH STREET PROPERTIES L L C	%F ELAM	1023 WHITNEY RANCH DR	HENDERSON NV 89014-3073	
8	13934512079	8TH STREET HOLDINGS L L C	%J JOLIET	21777 HOOVER RD	WARREN MI 48089- 2544	
9	13927810002	A F G NETWORK II L L C	100 JACKSON ST #201	DENVER CO 80206- 7507		
10	13934611053	A T & T COMMUNICATIONS NV INC	RM 3E-300E	2600 CAMINO RAMON	SAN ROMON CA 94583-5000	
11	13934512061	ACEVES EDDIE	5421 LIVERPOOL RD	LAS VEGAS NV 89107-3751		
12	13927810033	ANGUIANO HUGO & MARIA C	2004 SAN JOSE AVE	LAS VEGAS NV 89104-3832		
13	13927811047	ANSARI ABDUL R & NASEEMA F	8701 KNOLLMIST DR	LAS VEGAS NV 89147-6500		
14	13934512072	ARCE ALFREDO & GUADALUPE	517 N 8TH ST	LAS VEGAS NV 89101-3017		

11/17/2010 GPA-39192 & ZON-39193
 Mr. Andy Reed
 City of Las Vegas
 Planning and Development Department
 731 South Fourth Street, 2nd Floor
 Las Vegas, Nevada 89101

PARCEL#	OWNER	ADDRESS1	ADDRESS2	ADDRESS3	ADDRESS4	ADDRESS5
15	13934512085	ARMAND MIKE	6711 ROYAL STALLION CT	LAS VEGAS NV 89131-3715		
16	13934510014	B F TRUST	BOCK HOWARD & CARYL TRS	%JOHN'S LOANS & JEWELERY	2230 S PARADISE RD	LAS VEGAS NV 89104-2516
17	13934111012	B J P INVESTMENTS L L C	30 SAWGRASS CT	LAS VEGAS NV 89113-1324		
18	13934111009	BAERG FAMILY TRUST	BAERG WILLIAM & MARTHA HELEN TRS	3386 SAINT MICHAEL DR	PALO ALTO CA 94306-3057	
19	13934512044	BANK U S NATIONAL ASSN TRS	%AMER SRVCING CO	1 HOME CAMPUS X2504-017	DES MOINES IA 50328-0001	
20	13934610041	BARDEN NEVADA GAMING L L C	%C BROWN	301 FREMONT ST	LAS VEGAS NV 89101-5600	
21	13927811025	BJELICICH GEORGE & VIDINKA	4019 WALDORF CT	LAS VEGAS NV 89103-2341		
22	13934512073	BLASKO MICHAEL J & JANICE L	523 N 8TH ST	LAS VEGAS NV 89101-3017		
23	13927804002	BONANZA SPRINGS SUITES L L C	3900 PARADISE RD #101	LAS VEGAS NV 89169-0932		
24	13934610008	BROOKS ALAN DOUGLAS ETAL	150 BORDER COVE LN	LUBEC ME 04652- 3012		
25	13934512045	BUCKLEY THOMAS R & BECKY M	1930 KACHINA MOUNTAIN DR	HENDERSON NV 89012-2216		
26	13927810027	BURRIS ROSALIE L	FEENEY HARRIETT L LIVING TRUST	%L FEENEY	435 ARLINGTON RD	REDWOOD CITY CA 94062-1838
27	13934510021	C I M 116 N 3RD L V L L C	%CIM GROUP INC	%ACCT DEPT	6922 HOLLYWOOD BLVD 9TH FLR	LOS ANGELES CA 90028-6117
28	13934613131	C K ENTERPRISES L L C	1256 ANNAPOLIS WY	GRAYSON GA 30017-2900		

CASE# GPA-39192_ZON-39193

PARCEL#	OWNER	ADDRESS1	ADDRESS2	ADDRESS3	ADDRESS4	ADDRESS5
29	13927402009	CALIFORNIA HOTEL & CASINO	%BOYD GAMING	6465 S RAINBOW BLVD	LAS VEGAS NV 89118-3215	
30	13934512071	CAMPOS SALVADOR	1800 W BETTERAVIA RD #D	SANTA MARIA CA 93455-1065		
31	13934512064	CANIZALES BLANCA	329 1/2 N 8TH ST	LAS VEGAS NV 89101-3014		
32	13934111019	CATS MEOW ETAL	%VINTAGE VEGAS GAMING INC	128 E FREMONT ST	LAS VEGAS NV 89101-5604	
33	13934611055	CENTRAL TELEPHONE CO	%PPTY TAX DEPT	P O BOX 7909	OVERLAND PARK KS 66207-0909	
34	13927810026	CHADDAH VIKAS	P O BOX 7440	LAS VEGAS NV 89125-7440		
35	13934514008	CHASE T S L L C	%CIM GROUP INC	%ACCT DEPT	6922 HOLLYWOOD BLVD 9TH FLR	LOS ANGELES CA 90028-6117
36	13927810022	CHRISTIANSON LOUIS D	%S DAY REALTY INC	5460 S EASTERN DR	LAS VEGAS NV 89119-2313	
37	13934613185	CIN CITY L L C	4171 S PURPLE SAGE DR	CHANDLER AZ 85248-4847		
38	13934512049	CIPRO PETER & SHEILA	P O BOX 94582	LAS VEGAS NV 89193-4582		
39	13934111064	CITY OF LAS VEGAS REDEVELOPMENT	FREMONT EXPERIENCE L L C	%FINANCE DEPT	425 FREMONT ST	LAS VEGAS NV 89101-5620
40	13927812005	CIVIC CENTER PLAZA L L C	%EQUITY GROUP	8367 W FLAMINGO #201	LAS VEGAS NV 89147-4153	
41	13934512046	CLARK ED & ELIZABETH	514 N 7TH ST	LAS VEGAS NV 89101-3012		
42	13927805003	CLOUDBREAK LAS VEGAS L L C	414 S MARENGO AVE	PASADENA CA 91101-3113		

CASE# GPA-39192_ZON-39193

PARCEL#	OWNER	ADDRESS1	ADDRESS2	ADDRESS3	ADDRESS4	ADDRESS5
43	13927812007	COBLENTZ ALEXANDER & T LIV TR	610 L L C	%T COBLENTZ	%S & A FELD	3207 BEL AIR DR LAS VEGAS NV 89109-1518
44	13934510028	COHEN 1969 TRUST	COHEN PHILIP JOSEPH TRS	1620 S DECATUR BLVD #G	LAS VEGAS NV 89102-5586	
45	13934510005	COURT TRUST #79145	SIMON PETER & JANET II TR R-501	P O BOX 19088	JEAN NV 89019- 9088	
46	13934512094	CRANE NANCY C & GARY G	FRANKLIN STEVEN K	190 N PAINTED HILLS	IVINS UT 84738- 6016	
47	13927812018	CROWE DEBORAH	608 ENCANTO DR	LAS VEGAS NV 89101-2018		
48	13934510029	DERRYBERRY 1997 FAMILY TRUST	DERRYBERRY BARBARA ANN TRS	1309 E ST LOUIS AVE #1	LAS VEGAS NV 89104-3405	
49	13934610007	DOKTER GARY R ETAL	%FITZGERALDS CASINO & HOTEL	P O BOX 7600	LAS VEGAS NV 89125-7600	
50	13934512067	DORADO RIGOBERTO & IRMA	405 N 8TH ST	LAS VEGAS NV 89101-3015		
51	13934111005	DOWNEY NANCY L	P O BOX 585	GENOA NV 89411- 0585		
52	13934612013	DOWNTOWNER 2007 TRUST	KOVAK-COHEN 1989 TRUST	129 N 8TH ST	LAS VEGAS NV 89101-4207	
53	13934512096	DREXLER MICHAEL	750 S ROYAL CREST CIR #146	LAS VEGAS NV 89169-8319		
54	13934611052	EDEN ONE LIMITED PARTNERSHIP	3538 EL CAMINO REAL	ATASCADERO CA 93422-2532		
55	13934613015	EDWARDS JAMES K & RETA E	150 LAS VEGAS BLVD N #815	LAS VEGAS NV 89101-2925		
56	13934611019	ENCRYPTIC L L C	%R STURMAN	114 N 3RD ST	LAS VEGAS NV 89101-2926	

PARCEL#	OWNER	ADDRESS1	ADDRESS2	ADDRESS3	ADDRESS4	ADDRESS5
57	13934512026 EXBER INC	107 N 6TH ST 3RD FLOOR	LAS VEGAS NV 89101-4239			
58	13934513002 F A E C HOLDINGS WIRRULLA L L C	%M MATKINS	450 FREMONT ST #285	LAS VEGAS NV 89101-5627		
59	13934613065 FEDERAL NATIONAL MORTGAGE ASSN	%NATIONSTAR MTGE LLC	350 HIGHLAND DR	LEWISVILLE TX 75067-4177		
60	13934111062 FINLEY COMPANY	%FOUR QUEENS HOTEL	202 FREMONT ST	LAS VEGAS NV 89101-5606		
61	13934512058 FIRST NATL REALTORS MTGE CORP	16430 VENTURA BLVD #208	ENCINO CA 91436-2141			
62	13934512063 FLORES ARACELI	ALDANA PAULO C	2231 BELMONT AVE	LONG BEACH CA 90815-2502		
63	13934613013 FONTAINE EMMANUEL	14499 W VIRGINIA AVE	GOODYEAR AZ 85395-2029			
64	13934111061 FOUR QUEENS INC	FOUR QUEENS HOTEL	202 FREMONT ST	LAS VEGAS NV 89101-5606		
65	13934501016 FREMONT PLACE L L C	3055 VIA SARAFINA DR	HENDERSON NV 89052-4031			
66	13934610045 FREMONT ST EXPERIENCE PARKING	425 FREMONT ST	LAS VEGAS NV 89101-5620			
67	13934612016 GALARDI CHILDRENS IRR TR AGMT	MCRIMMON SIDNEY ARCHIE JR TRS	713 E OGDEN AVE #B	LAS VEGAS NV 89101-4230		
68	13934510007 GAREHIME FAM TR 1993-SURV ETAL	GAREHIME BETTY JANE TRS	5085 ALFINGO ST	LAS VEGAS NV 89135-3214		
69	13934514007 GARSIDE BETH ETAL	%CIM GROUP INC	%ACCT DEPT	6922 HOLLYWOOD BLVD 9TH FLR	LOS ANGELES CA 90028-6117	
70	13934510022 GEORGE 1979 TRUST ETAL	GEORGE WILLIAM S TRS	208 STONEWOOD CT	LAS VEGAS NV 89107-3250		

PARCEL#	OWNER	ADDRESS1	ADDRESS2	ADDRESS3	ADDRESS4	ADDRESS5
71	13934501013	GOLD SPIKE HOLDINGS L L C	%SIEGEL GROUP NEVADA INC	3900 PARADISE RD #101	LAS VEGAS NV 89169-0932	
72	13934111031	GRANITE PROPERTIES I L L C	111 NORTH 1ST ST	LAS VEGAS NV 89101-2912		
73	13934111029	GRANITE PROPERTIES II L L C	%GRANITE GAMING GROUP LLC	111 NORTH FIRST ST	LAS VEGAS NV 89101-2912	
74	13934111032	GRANITE PROPERTIES IV L L C	%S BURNSTINE	111 N 1ST ST	LAS VEGAS NV 89101-2912	
75	13934613069	GREEN TREE INVESTMENTS L L C	2755 GREAT SMOKEY CT	WESTLAKE VILLAGE CA 91362-3727		
76	13934512102	GULLO RUSSELL A	405 N 6TH ST	LAS VEGAS NV 89101-3004		
77	13934510024	H S FAMILY L P	714 LACEY LN	LAS VEGAS NV 89107-4440		
78	13927810030	HAAG R WAYNE & DIANE C	516 N 1ST ST	LAS VEGAS NV 89101-1902		
79	13934111026	HALE BLAIR R & NORMA FAM TR ETAL	%VINTAGE VEGAS GAMING INC	128 E FREMONT ST	LAS VEGAS NV 89101-5604	
80	13934611007	HAM A W III TRUST	HAM A W III TRS	2008 GRAY EAGLE WY	LAS VEGAS NV 89117-5738	
81	13934611004	HAM ARTEMUS W III	2008 GRAY EAGLE WY	LAS VEGAS NV 89117-5738		
82	13934613028	HEE WILLIAM K M & SHIRLEY Y	3009 WOODLAWN DR	HONOLULU HI 96822-1563		
83	13934511008	HENRY J PROPERTIES LAS VEGAS LLC	%G HAGOOD	P O BOX 55777	LITTLE ROCK AR 72215-5777	
84	13934512084	HIMES FAMILY TRUST	5620 DARBY AVE	LAS VEGAS NV 89146-7916		

CASE# GPA-39192_ZON-39193

PARCEL#	OWNER	ADDRESS1	ADDRESS2	ADDRESS3	ADDRESS4	ADDRESS5
85	13934501012	HISTORIC CLARK COTTAGES L L C	%J & W CLARK	502 N 7TH ST	LAS VEGAS NV 89101-3012	
86	13934512042	HOOPER INDUST LTD	2954 SUN LAKE DR	LAS VEGAS NV 89128-7712		
87	13927811046	HOPELESS IN L V L L C	%L THOMPSON	P O BOX 28399	LAS VEGAS NV 89126-2399	
88	13927811040	HOPELESS IN LAS VEGAS L L C	%L THOMPSON	P O BOX 28399	LAS VEGAS NV 89126-2399	
89	13934510001	HORSESHOE GARAGE	9901 COVINGTON CROSS DR #190	LAS VEGAS NV 89144-6595		
90	13934512059	HUI JOHN	5560 S FT APACHE #100	LAS VEGAS NV 89148-7699		
91	13934512092	HYMAN ALFRED H & L FAM TR 1995	HYMAN LILLIE TRS	10737 RIVERSIDE DR	NORTH HOLLYWOOD CA 91602-2324	
92	13934613220	INGRAM LAWRENCE E	150 LAS VEGAS BLVD N #2109	LAS VEGAS NV 89101-2952		
93	13934512076	IRICK CHRIS A	410 N 8TH ST	LAS VEGAS NV 89101-3016		
94	13934111065	ISOLA LINDA J PRESENT INT TR	SELLERS BRETT K TRS	%VINTAGE VEGAS GAMING INC	128 E FREMONT ST LAS VEGAS NV 89101-5604	
95	13934511009	J HENRY PROPERTIES LAS VEGAS LLC	%G HAGOOD	P O BOX 55777	LITTLE ROCK AR 72215-5777	
96	13934612001	JASAA INC	1255 CORPORATE CENTER #PH-10	MONTEREY PARK CA 91754-7615		
97	13934111011	JORAI ENTPRS	RAIZIN LEONARD & CAROL TRS	600 PILOT RD #D	LAS VEGAS NV 89119-9011	
98	13934512062	JORDAN PATRICIA A	1579 DALTON AVE	DALTON GARDENS ID 83815-9624		

	PARCEL#	OWNER	ADDRESS1	ADDRESS2	ADDRESS3	ADDRESS4	ADDRESS5
99	13934512070	KHOUDARY DONNA	9917 LONG CATTLE AVE	LAS VEGAS NV 89117-6943			
100	13934613130	KOH AMBROCIO & ZAIDA	150 N LAS VEGAS BLVD #1609	LAS VEGAS NV 89101-2947			
101	13934613244	KRUPNCIK STEVEN L	9 ISLAND AVE #1603	MIAMI BEACH FL 33139-1360			
102	13934613001	L V B-OGDEN MARKETING CORP	%S HEWITT	3959 N LINCOLN AVE	CHICAGO IL 60613-2481		
103	13934612011	LA PALOMA BLANCA L L C	8801 SCENIC HARBOR DR	LAS VEGAS NV 89117-2295			
104	13934613208	LAM KATHARINE K	210 GOODWIN DR	SAN BRUNO CA 94066-1668			
105	13934613039	LANCASTER JACK D & HILDE C	8 FAIRFAX RD	BAKERSFEILD CA 93307-3008			
106	13934512066	LANDEROS MANUEL & MARCELINO	400 N 8TH ST	LAS VEGAS NV 89101-3016			
107	13934111028	L'CHAIM 24 FREMONT PPTY L L C	24 FREMONT ST	LAS VEGAS NV 89101-5601			
108	13934510023	L'CHAIM FREMONT ASSOC PPTY INC	6130 W FLAMINGO RD #402	LAS VEGAS NV 89103-2280			
109	13934610010	L'CHAIM WESTERN VILAGE PPTY LLC	%H GABAY	6130 W FLAMINGO RD #402	LAS VEGAS NV 89103-2280		
110	13934510002	LEEBOVE SYDELL ETAL	9901 COVINGTON CROSS DR #190	LAS VEGAS NV 89144-6595			
111	13934512040	LITVAK DAVID M	2005 PINTO LN	LAS VEGAS NV 89106-4018			
112	13927708007	LODGE AMERICAN LEGION POST #8	733 VETERANS MEMORIAL DR	LAS VEGAS NV 89101-1945			

PARCEL#	OWNER	ADDRESS1	ADDRESS2	ADDRESS3	ADDRESS4	ADDRESS5
113	13927804004	LODGE ELKS PAST RULERS #1468	4100 W CHARLESTON BLVD	LAS VEGAS NV 89102-1623		
114	13934610006	LODGE MASONIC #32	301 E FREMONT ST BOX 7600	LAS VEGAS NV 89125-7600		
115	13927402007	M S W INC	%BOYD GAMING	6465 S RAINBOW BLVD	LAS VEGAS NV 89118-3215	
116	13934613167	MADAYAG CHRISTINE & JUANITO O	4225 PERFECT DRIFT ST	LAS VEGAS NV 89129-6073		
117	13934512002	MAGHAMFAR HAMID R	329 LAS VEGAS BLVD	LAS VEGAS NV 89101-2965		
118	13934510027	MARSHALL FAMILY L P	%T MARSHALL	P O BOX 46470	LAS VEGAS NV 89114-6470	
119	13934512069	MARTIN FAMILY TRUST	MARTIN RICHARD A & ELIZABETH TRS	6917 E BONANZA RD	LAS VEGAS NV 89110-4225	
120	13934601002	MELE PONO HOLDING COMPANY	%EQUITY GROUP	8367 W FLAMINGO RD #201	LAS VEGAS NV 89147-4153	
121	13934111008	MILLER C W	%BOYD GAMING- TAX DEPT	6465 S RAINBOW BLVD	LAS VEGAS NV 89118-3215	
122	13934111006	MILLER RALPH W JR	MILLER TRUST	4437 ANNETTE PARK DR	BOZEMAN MT 59715-9273	
123	13927812006	MORENO ANTONIO	P O BOX 21679	LONG BEACH CA 90801-4679		
124	13934512068	MORENO JOSE A	408 N 8TH ST #B	LAS VEGAS NV 89101-3084		
125	13934510010	MORGAN GEORGE WILLIAM	MORGAN FAMILY TRUST	%BOYD GAMING- TAX DEPT	6465 S RAINBOW BLVD	LAS VEGAS NV 89118-3215
126	13927811044	MORTON JENNIE B FAMILY TRUST	MORTON JENNIE B TRS	305 BONANZA WY	LAS VEGAS NV 89101-2014	

PARCEL#	OWNER	ADDRESS1	ADDRESS2	ADDRESS3	ADDRESS4	ADDRESS5
127	13934611015	NATIONWIDE CHECK SERVICE INC	515 FREMONT ST	LAS VEGAS NV 89101-5611		
128	13934512030	NEIGHBORHOOD HOUSING SERV S NV	1849 CIVIC CENTER DR	NO LAS VEGAS NV 89030-7131		
129	13934613106	NICDAO CARMELITA O	928 SAN RAPHAEL ST	KISSIMMEE FL 34759-3907		
130	13934512086	NORTH WILSON LIMITED PARTNERSHIP	%MAE WEST PPTY LLC	29-26 163RD ST	FLUSHING NY 11358-1424	
131	13934111007	OCCIDENTAL COLLEGE	%BOYD GAMING-TAX DEPT	6465 S RAINBOW BLVD	LAS VEGAS NV 89118-3215	
132	13934613149	OKUNA THOMAS M REVOCABLE LIV TR	101 AUPUNI ST #703	HILO HI 96720-4256		
133	13934613100	OLSON MARLAN V & MICHELLE D	14029 WAGON WY	SILVER SPRINGS MD 20906-2065		
134	13927811045	PEELE HELEN MAY REVOCABLE TRUST	PEELE HELEN MAY TRS	875 N 10TH ST	NAPLES FL 34102-5417	
135	13934612017	PINJUV MATTHEW ETAL	2908 SARINA AVE	HENDERSON NV 89074-2848		
136	13934510034	PLUG IT IN II L L C	3900 PARADISE RD #101	LAS VEGAS NV 89169-0932		
137	13934512075	POTTER MARK	100 E SUN MARCOS BLVD #400	SAN MARCOS CA 92069-2988		
138	13927810011	PROVONSHA KAREN RAE	607 BILTMORE DR	LAS VEGAS NV 89101-1910		
139	13934111003	R & S P FAMILY TRUST ETAL	PECCOLE ROBERT N JR TRS	8981 W SAHARA AVE #120	LAS VEGAS NV 89117-5894	
140	13934512074	R R R HOMES L L C	P O BOX 98378	LAS VEGAS NV 89193-8378		

PARCEL#	OWNER	ADDRESS1	ADDRESS2	ADDRESS3	ADDRESS4	ADDRESS5
141	13934612012 RAFFI BEN	100 S DOHENY DR #1007	LOS ANGELES CA 90048-2932			
142	13927810020 REGUERO RAFAEL	615 BILTMORE DR	LAS VEGAS NV 89101-1910			
143	13934512060 REYNOSO ESTELA	7040 PALMYRA AVE	LAS VEGAS NV 89117-3108			
144	13934510008 ROCKWELL FAMILY LP ETAL	%R ROCKWELL	P O BOX 27361	FRESNO CA 93729- 7361		
145	13934510047 ROCKWELL FAMILY LTD PARTNERSHIP	ROCKWELL L H SR % B MEMORIAL TR	%R ROCKWELL	P O BOX 27361	FRESNO CA 93729- 7361	
146	13934512065 RODRIGUEZ ABRAHAM & P JT REV TR	RODRIGUEZ ABRAHAM & PEACHES TRS	2325 BOULDER LN	BELOIT WI 53511- 6709		
147	13927811038 ROMANO DANIEL ALLEN	733 N 10TH ST	LAS VEGAS NV 89101-2503			
148	13934111017 RONNOW J L ETAL	%BOYD GAMING CORP	6465 S RAINBOW BLVD 4TH FL	LAS VEGAS NV 89118-3215		
149	13934512041 RYAN CO L L C	436 S 10 W	FARMINGTON UT 84025-2203			
150	13934512029 S & J GROUP INC	209 N 7TH ST	LAS VEGAS NV 89101-4205			
151	13934111025 SAGE REALTY CO	SPEAKEASY GAMING FREMONT- IMPS	128 EAST FREMONT ST	LAS VEGAS NV 89101-5604		
152	13934111015 SAM-WILL INC	%BOYD GAMING	6465 S RAINBOW BLVD	LAS VEGAS NV 89118-3215		
153	13934610009 SCHIFF ROBERT	1004 NEW ROAD	NORTHFIELD NJ 08225-1661			
154	13934512095 SCOTT STEPHEN	413 N 9TH ST	LAS VEGAS NV 89101-3034			

PARCEL#	OWNER	ADDRESS1	ADDRESS2	ADDRESS3	ADDRESS4	ADDRESS5
155	13934512043	SEQUEIRA JOSE R JR & MARIA G	P O BOX 43222	LAS VEGAS NV 89116-1222		
156	13934613203	SEYMOUR RAYMOND P & JOETTA B	14 MANDARIN	IRVINE CA 92604- 3631		
157	13934612006	SHREE GANESHA INC.	700 E FREMONT ST	LAS VEGAS NV 89101-5616		
158	13934613063	SHUSTREAM L L C	928 SAN RAPHAEL ST	KISSIMMEE FL 34759-3907		
159	13934613083	SMITH LANNY LEE	10024 CLOVERCREST DR	COLORADO SPRINGS CO 80920- 5503		
160	13934613040	SMITH LANNY LEE II	10024 CLOVECREST DR	COLORADO SPRINGS CO 80920- 5503		
161	13934512077	SMITH RUBY V	SMITH RUBY V REVOCABLE LIVING TR	401 N 8TH ST	LAS VEGAS NV 89101-3015	
162	13934512078	SMITH RUBY V REVOCABLE LIVING TR	SMITH RUBY V TRS	401 N 8TH ST	LAS VEGAS NV 89101-3015	
163	13934613161	SPAIN DIXON L	3595 SANTA FE AVE SPC 181	LONG BEACH CA 90810-4359		
164	13927810021	STARCHER JAMEY L & ALPHA C	65 PINE AVE #176	LONG BEACH CA 90802-4718		
165	13927803007	STATE OF NEVADA	CARSON CITY NV 89701			
166	13927402005	STATE OF NEVADA TRANS LEASOR	M S W INC LEASE	%BOYD GAMING- TAX DEPT	6465 S RAINBOW BLVD	LAS VEGAS NV 89118-3215
167	13934111023	STAUFFER FAMILY TRUST ETAL	STAUFFER DARLENE J TRS	128 E FREMONT ST	LAS VEGAS NV 89101-5604	
168	13927804003	T L C PROPERTIES INC	1863 HELM DR	LAS VEGAS NV 89119-3911		

CASE# GPA-39192_ZON-39193

	PARCEL#	OWNER	ADDRESS1	ADDRESS2	ADDRESS3	ADDRESS4	ADDRESS5
169	13934613061	TAKAMIYA ROBERT & DEIRDRE	95-1091 LALAI ST	MILILANI HI 96789-3712			
170	13927810007	TALLARD MAURICE E 2000 LIVING TR	TALLARD KEVIN TRS	P O BOX 81814	LAS VEGAS NV 89180-1814		
171	13927810010	TAYLOR ELANDERS & LUCENA F	601 BILTMORE DR	LAS VEGAS NV 89101-1910			
172	13934611016	T-BREO II L L C	1 MAIN ST	LAS VEGAS NV 89101-6370			
173	13934512082	THAJJ L L C	%J J LEAVITT	704 S 9TH ST	LAS VEGAS NV 89101-7015		
174	13927810012	THOMPSON ERIC & LYNDA ETAL	5003 ARVADA ST	TORRANCE CA 90503-1453			
175	13934510026	THREE TWENTY TWO L L C	9030 W FLAMINGO RD #190	LAS VEGAS NV 89147-6471			
176	13927810028	TINNEY RICHARD M & CAROL L	513 N 1ST ST	LAS VEGAS NV 89101-1902			
177	13934111033	T-L V C R L L C	1 MAIN ST	LAS VEGAS NV 89101-6370			
178	13934613170	VANALSTYNE JAMES G	P O BOX 17154	LAS VEGAS NV 89114-7154			
179	13934111014	VINTAGE VEGAS GAMING INC	%R SZEPELAK	128 E FREMONT ST	LAS VEGAS NV 89101-5604		
180	13934613014	WALTER BRENT JAMES & ANITA LYNN	2417 32ND AVE S W	CALGARY ALBERTA	CANADA TNT1X4 00000-0000		
181	13934512057	WANDERER JOHN FAMILY TRUST	1711 S 15TH ST	LAS VEGAS NV 89104-3102			
182	13934613175	WATTS LEONARD F	550 STONEYWOOD TERR	MABLETON GA 30126-0000			

CASE# GPA-39192_ZON-39193

PARCEL#	OWNER	ADDRESS1	ADDRESS2	ADDRESS3	ADDRESS4	ADDRESS5
183	13934512083 WELCKER LEO A	313 N 8TH ST	LAS VEGAS NV 89101-3014			
184	13927810009 WOLF PAC FAMILY TRUST	AUSTIN LINDA LOU TRS	P O BOX 19425	JEAN NV 89019- 9425		
185	13927811039 YIMLAMAI BOONCHAI & SOMLEE	2203 W ALMOND AVE	ORANGE CA 92868- 3405			
186	13927810008 YUAN SHIH-KUAN	602 N 1ST ST	LAS VEGAS NV 89101-1904			