

City of Las Vegas
Office Of The City Clerk
400 Stewart Avenue
Las Vegas, Nevada 89101

Return Service Requested Official Notice of Public Hearing

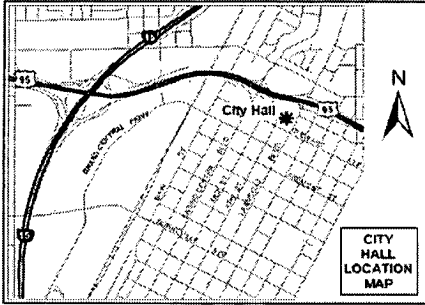

If you wish to file your protest or support on this request, check the appropriate box below and return this card in an envelope with postage to the Office Of The City Clerk at the address listed above or fax this side of this card to (702) 382-4803. If you would like to contact your Council Representative, please call (702) 229-6405.

I SUPPORT
this Request

I OPPOSE
this Request

Please use available blank space on card for your comments.

VAR-37831

City Council Meeting of 7/7/2010

Application Information

VAR-37831 - APPLICANT/OWNER: SANDRA LIPPINCOTT - Request for a Variance TO ALLOW AN EXISTING 316 SQUARE-FOOT ACCESSORY STRUCTURE (CLASS II) WITH A ZERO-FOOT SIDE YARD SETBACK WHERE THREE FEET IS REQUIRED on 0.46 acres at 6791 Sierra Trail (APN 163-02-311-006), R-E (Residence Estates) Zone, Ward 1 (Tarkanian).

Application Location

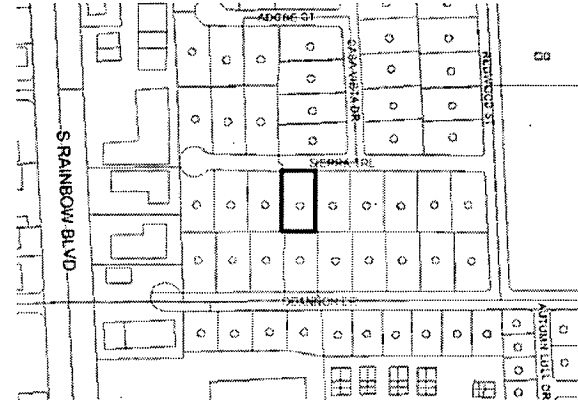

The proposed project may not pertain to the entire highlighted project site.

Public Hearing Information

Meeting: City Council
Date: *July 7, 2010*
Time: 1:00 P.M.
Location: City Council Chambers
400 Stewart Avenue
Las Vegas, Nevada

Any and all interested persons may appear and be heard at said meeting, or may, prior thereto, file written objections thereto or approvals thereof with the City Clerk, 1st Floor, City Hall, 400 Stewart Avenue, Las Vegas, Nevada, 89101. For further information, including the full staff report, please call (702) 229-6311 (TDD 386-9108) or go to <http://www.lasvegasnevada.gov>.

PARCEL#	OWNER	ADDRESS1	ADDRESS2	ADDRESS3	ADDRESS4	ADDRESS5
1	16303703002 1901RAINBOW L L C	%M/M J MARTINEZ	131 E DELAMAR DR	HENDERSON NV 89015-7928		
2	16302310012 ABNEY JANET T LIVING TRUST	ABNEY JANET T TRS	6823 ADOBE CT	LAS VEGAS NV 89146-2920		
3	16303714004 ABYSS GROUP L L C	6980 OBANNON DR #1	LAS VEGAS NV 89117-2122			
4	16302412008 ALI GOKSEL A	BLAIR SYLVIA	2213 AUTUMN LULL DR	LAS VEGAS NV 89146-2986		
5	16302313011 AMAPOLA ORANGE L L C	251 S ORANGE ACRES DR	ANAHEIM HILLS CA 92807-3617		07/07/2010 Ms. Sandra Lippincott 6791 Sierra Trail Las Vegas, Nevada 89146	VAR-37831
6	16302412028 ARREDONDO J & A FAM TR	ARREDONDO JOE L SR & ALICE C TRS	6605 OBANNON DR	LAS VEGAS NV 89146-2945		
7	16302412003 ARREOLA ROBERT A	2109 AUTUMN LULL DR	LAS VEGAS NV 89146-2930			
8	16302310002 B J H TRUST	HORNER BRIAN TRS	1552 W WARM SPRINGS RD #110	HENDERSON NV 89014-4328	07/07/2010 Mr. and Mrs. Brent Conrad 5336 Elkhorn Road Las Vegas, Nevada 89131	VAR-37831
9	16302310030 B P M C LIVING TRUST	MCFARLAND CATHERINE GRAHAM TRS	4726 MOUNT ALIFAN DR	SAN DIEGO CA 92111-2508		
10	16302310017 BANK WELLS FARGO N A TRS	6501 IRVINE CENTER DR	IRVINE CA 92618-2118			
11	16302312001 BLAIR WILLIAM J	6810 SIERRA TRL	LAS VEGAS NV 89146-2906			
12	16302401001 BRADY HORACE E SR & CHRISTINE	6795 O BANNON DR	LAS VEGAS NV 89102-2905			
13	16302310022 BRANCHEV IVAN	3242 CALLE DE DEBESA	CAMARILLO CA 93010-8336			
14	16302312006 CALLOTTA EDWARD A & TERESITA V	6809 SIERRA TRL	LAS VEGAS NV 89146-2906			

	PARCEL#	OWNER	ADDRESS1	ADDRESS2	ADDRESS3	ADDRESS4	ADDRESS5
15	16303704006	CANNON IVAN & HELEN C FAMILY TR	P O BOX 15291	LAS VEGAS NV 89114-5291			
16	16303714008	CARD PLAYER TOWERS L L C	6940 OBANNON DR	LAS VEGAS NV 89117-2122			
17	16302310036	CARUSO MICHAEL & DAVID M	CARUSO BRIAN G	5166 S ARVILLE ST	LAS VEGAS NV 89118-1539		
18	16302401002	CERVANTES JOSEPH	3808 CREST HORN DR	LAS VEGAS NV 89147-4256			
19	16302313012	COLEMAN FAMILY TRUST	COLEMAN GARY E & MARY LEE TRS	6216 CAMINO DE LA COSTA	LA JOLLA CA 92037-6522		
20	16302412025	COPSEY GAY E & DARLENE LIVING TR	COPSEY GAY E & DARLENE TRS	6612 VICUNA DR	LAS VEGAS NV 89146-2908		
21	16302412026	COX NORMAN	VOGEL DEBRA	6613 OBANNON DR	LAS VEGAS NV 89146-2945		
22	16302412023	CUMMINGS PATRICK J & JUDY LIV TR	CUMMINGS PATRICK J & JUDY M TRS	6604 VICUNA DR	LAS VEGAS NV 89146-2908		
23	16303703003	D C L CORPORATION	1881 S RAINBOW BLVD	LAS VEGAS NV 89146-0849			
24	16302310021	DAHLSTROM URSULA FAMILY TRUST	DAHLSTROM URSULA TRS	2015 REDWOOD ST	LAS VEGAS NV 89146-2912		
25	16302410001	DEGNER EARL W LIVING TRUST	LANZISERA FAMILY TRUST	1134 SUNNYHILLS AVE	BREA CA 92821- 2314		
26	16302410003	DIAL MILTON K & SHEILA J	6757 OBANNON DR	LAS VEGAS NV 89146-2905			
27	16302310014	DIEKMANN DOLORES	1854 CASA VISTA DR	LAS VEGAS NV 89146-2922			
28	16302312003	ESCOBAR DENNIS R	LE LINNG H	6840 SIERRA TRL	LAS VEGAS NV 89146-2906		

PARCEL#	OWNER	ADDRESS1	ADDRESS2	ADDRESS3	ADDRESS4	ADDRESS5
29	16302312008 FARNEJAD CHANGIZ ETAL	6822 OBANNON DR	LAS VEGAS NV 89146-2946			
30	16302401003 FEDERAL NATIONAL MORTGAGE ASSN	400 COUNTRYWIDE WY SV-35	SIMI VALLEY CA 93065-6298			
31	16302312007 FOSKARIS FAMILY LIVING TRUST	FOSKARIS NICHOLAS G & D A CO-TRS	2780 EL CAMINO RD	LAS VEGAS NV 89146-5221		
32	16302415015 G H B HOLDING-SAHARA RAINBOW LLC	%GATSKI COML REAL ESTATE SVCS	4755 DEAN MARTIN DR	LAS VEGAS NV 89103-4141		
33	16302310010 GABLE DEBBIE LIVING TRUST	LANZA BETHANY LIVING TRUST	6840 ADOBE CT	LAS VEGAS NV 89146-2920		
34	16302311007 GALLAGHER FAMILY TRUST	GALLAGHER PATRICK J & KARI A TRS	6790 OBANNON DR	LAS VEGAS NV 89146-2927		
35	16302412027 GRANT JAMES R	ARELLANO-GRANT MARIA	6609 OBANNON DR	LAS VEGAS NV 89146-2945		
36	16302301001 HAECKE DENNIS C	1810 S RAINBOW	LAS VEGAS NV 89146-2911			
37	16302310037 HARVEY NANCI M	HARVEY NANCI M & THOMAS J	6760 OBANNON DR	LAS VEGAS NV 89146-2927		
38	16302410002 HEESE FAMILY TRUST	HEESE JACQUELINE D & STEVEN TRS	6773 OBANNON DR	LAS VEGAS NV 89146-2905		
39	16302313015 HETLY NATALIE	2563 AVIV CT	LAS VEGAS NV 89121-3947			
40	16302310007 HORN NORMAN RAY & JANE ANNE	1899 CASA VISTA DR	LAS VEGAS NV 89146-2921			
41	16302313004 HUANG LIU CHU	224 CROOKED PUTTER DR	LAS VEGAS NV 89148-5263			
42	16302310032 HUFFMAN ROSE M	6731 SIERRA TRL	LAS VEGAS NV 89146-2907			

	PARCEL#	OWNER	ADDRESS1	ADDRESS2	ADDRESS3	ADDRESS4	ADDRESS5
43	16302412002	HUGHES FAMILY TRUST	HUGHES DANIEL J SR & MARIA M TRS	2105 AUTUMN LULL DR	LAS VEGAS NV 89146-2930		
44	16302310018	HUME ROBERT B & SHIRLEY N	1962 CASA VISTA DR	LAS VEGAS NV 89146-2984			
45	16302313014	ITZCHAKI DANIEL	2563 AVIV CT	LAS VEGAS NV 89121-3947			
46	16302412029	JABARA MICHAEL D	2709 PINTO LN	LAS VEGAS NV 89107-4617			
47	16302311004	JAMES HADLEY D & EUNICE M	1991 CASA VISTA	LAS VEGAS NV 89146-2923			
48	16303704009	JARRETT CHILDRENS TRUST 1980	JARRETT REX A JR TRS	4150 WOODCREST RD	LAS VEGAS NV 89121-4942		
49	16302310009	JOHNSON FAMILY TRUST	JOHNSON GARY A & MARY JANE TRS	P O BOX 80063	LAS VEGAS NV 89180-0063		
50	16302312004	KAITANI TOYOHEI & SAKIKO	10039 FLOKTON AVE	LAS VEGAS NV 89148-4573			
51	16302310031	KANE JUNE E	6745 SIERRA TRL	LAS VEGAS NV 89146-2907			
52	16302310015	KLOPFENSTINE TRUST	KLOPFENSTINE MYRON & VIOLET TRS	1882 CASA VISTA DR	LAS VEGAS NV 89146-2922		
53	16302412017	LAIR GARY W & MARGARET F	6612 PEPPERMILL DR	LAS VEGAS NV 89146-2913			
54	16302310029	LANDSBERGER BRIAN J & DONG M	6775 SIERRA TRL	LAS VEGAS NV 89146-2907			
55	16302313006	LARSON S FAMILY L P	2950 E FLAMINGO #H	LAS VEGAS NV 89121-5208			
56	16302310001	LEAVITT RICHARD A & JOAN W	6841 W OAKY BLVD	LAS VEGAS NV 89146-2902			

PARCEL#	OWNER	ADDRESS1	ADDRESS2	ADDRESS3	ADDRESS4	ADDRESS5
57	16302410005 LEMICH MIKE & DOLORES A	6729 OBANNON DR	LAS VEGAS NV 89146-2905			
58	16302311006 LIPPINCOTT GAIL B & SANDRA K	6791 SIERRA TRL	LAS VEGAS NV 89146-2907			
59	16302310028 LJUNGQUIST ROBERT & LINDA M	1827 S REDWOOD ST	LAS VEGAS NV 89146-2912			
60	16302312002 LUO MALISA	2105 LINDA VISTA ST	LAS VEGAS NV 89102-3721			
61	16302412005 LUO XIAO LAN	5651 RITTER LN	LAS VEGAS NV 89118-1351			
62	16302310020 MARLON JOHN A & DIANNE SUE	2016 CASA VISTA DR	LAS VEGAS NV 89146-2985			
63	16302310026 MAURER SUSAN REVOCABLE TRUST	MAURER SUSAN K TRS	1881 REDWOOD	LAS VEGAS NV 89146-2912		
64	16302310004 MAURO FAMILY TRUST	MAURO MARGIE TRS	1825 CASA VISTA DR	LAS VEGAS NV 89146-2921		
65	16302310011 MCGALIS KAREN L REVOCABLE TRUST	MCGALIS KAREN L TRS	6839 ADOBE CT	LAS VEGAS NV 89146-2920		
66	16302310006 MCNAMARA WILLIAM R & CAROL A	1875 CASA VISTA DR	LAS VEGAS NV 89146-2921			
67	16302202005 MEAD DIDI FAMILY TRUST	MEAD DIDI ELSA ELISABETH TRS	6760 W OAKEY BLVD	LAS VEGAS NV 89146-2914		
68	16302412018 MILLER LUCKY L & LINDA J	6613 VICUNA DR	LAS VEGAS NV 89146-2910			
69	16302310035 MINI-SICKELS LAUREN	6730 O BANNON DR	LAS VEGAS NV 89102-2927			
70	16302311005 MONTES DIEGO & SHELBY	2017 CASA VISTA DR	LAS VEGAS NV 89146-2923			

PARCEL#	OWNER	ADDRESS1	ADDRESS2	ADDRESS3	ADDRESS4	ADDRESS5
71	16302310016	NAGATA NORMAN T & JANE T	1424 ALA KOPIKO ST	HONOLULU HI 96818-1508		
72	16302411001	O D SAHARA WEST L L C	P O BOX 19297	LAS VEGAS NV 89132-0297		
73	16303804009	O'BANNON PLAZA L L C	%M ZACHA	4847 BONVUE AVE	LOS ANGELES CA 90027-1104	
74	16302410004	OELRICH FAMILY TRUST	OELRICH ROBERT V & BERYL S TRS	6004 STANTON SUMMIT DR	NO LAS VEGAS NV 89081-6782	
75	16302412004	PAYNE ANTHONY R & RACHEL	2113 AUTUMN LULL DR	LAS VEGAS NV 89146-2930		
76	16302313013	R B D - S H L L C	%MDL GROUP	3065 S JONES BLVD #201	LAS VEGAS NV 89146-6780	
77	16303704007	R C D L L C	936 VISCANIO PL	LAS VEGAS NV 89138-7577		
78	16303704008	RAINBOW AUTO CENTER L L C	P O BOX 35782	LAS VEGAS NV 89133-5782		
79	16302415001	RAINBOW SAHARA CENTER #2	2615 PACIFIC COAST HWY #328	HERMOSA BEACH CA 90254-2227		
80	16302301005	REALTY INCOME CORPORATION	%PORTFOLIO MGT	P O BOX 460069	ESCONDIDO CA 92046-0069	
81	16302410006	S M K FAMILY TRUST	KERR STEPHEN A & MERNA S TRS	6713 OBANNON DR	LAS VEGAS NV 89146-2905	
82	16302310003	S M P I R O L L C	8550 W CHARLESTON BLVD #102	LAS VEGAS NV 89117-9086		
83	16302312005	SAGEL WILLIAM R & ANNE C 2006 TR	SAGEL WILLIAM R JR & ANNE C TRS	6823 SIERRA TRL	LAS VEGAS NV 89146-2906	
84	16302415002	SAMM RAINBOW L L C	2300 W SAHARA AVE #1110	LAS VEGAS NV 89102-4354		

PARCEL#	OWNER	ADDRESS1	ADDRESS2	ADDRESS3	ADDRESS4	ADDRESS5
85	16302311001	SASSE JON J & LISA	6809 ADOBE CT	LAS VEGAS NV 89146-2920		
86	16302312009	SERA RAYMOND M	LEONG LINDA S L	6838 O BANNON DR	LAS VEGAS NV 89102-2946	
87	16302310023	SHAW DANNY E & KAREN L	1961 REDWOOD ST	LAS VEGAS NV 89146-2912		
88	16302311003	SICA ANN	P O BOX 74	CORNWALL NY 12518-0074		
89	16302311002	SICA GLORIA TURST	SICA MICHAEL F & GLORIA TRS	261 ROUND HILL RD	GREENWICH CT 06831-3301	
90	16302412006	SMALL TRAVIS G	2205 AUTUMN LULL DR	LAS VEGAS NV 89146-2986		
91	16302401004	SPENCER EVERETT & VELMA TRUST	SPENCER EVERETT & VELMA W CO-TRS	6839 OBANNON DR	LAS VEGAS NV 89146-2947	
92	16302310025	STOCKER ROBERT R SR & JOAN J	1907 REDWOOD ST	LAS VEGAS NV 89146-2912		
93	16302412007	SUBJECT EDWARD	2209 AUTUMN LULL DR	LAS VEGAS NV 89146-2986		
94	16302412024	SUITER FAMILY TRUST	SUITER ROY F & MARY M TRS	6608 VICUNA DR	LAS VEGAS NV 89146-2908	
95	16303714003	SUNNY ROCK L L C	6970 OBANNON BLDG 2	LAS VEGAS NV 89117-2122		
96	16302310038	SWALLOW DAVID C & KRISTINA L	P O BOX 27808	LAS VEGAS NV 89126-1808		
97	16302412019	TANNENBAUM NATHAN & LINDA S	6609 VICUNA DR	LAS VEGAS NV 89146-2910		
98	16302310005	TAPIA RAUL A	889 S RAINBOW #529	LAS VEGAS NV 89145-6238		

	PARCEL#	OWNER	ADDRESS1	ADDRESS2	ADDRESS3	ADDRESS4	ADDRESS5
99	16303703004	TRANS-AERO LAND & DEVELOPMENT CO	4560 S DECATUR BLVD #202	LAS VEGAS NV 89103-5252			
100	16302310013	VALLADARES JENNIFER C	5746 CRSCENT LANDING ST	LAS VEGAS NV 89113			
101	16302310027	VANDEBUR WILLIAM L & KAREN J	1853 REDWOOD ST	LAS VEGAS NV 89146-2912			
102	16303703001	VAUSE FAMILY TRUST	VAUSE GARY & LINDA M TRS	3020 PLAZA DE MONTE	LAS VEGAS NV 89102-4046		
103	16302310034	WAGNER CHRIS B & CINDY S	6714 O'BANNON DR	LAS VEGAS NV 89146-2927			
104	16302310008	WARREN RANDY	6810 ADOBE CT	LAS VEGAS NV 89146-2920			
105	16302310019	WEBB GARY W & SHARON A FAMILY TR	WEBB GARY W & SHARON A TRS	1990 CASA VISTA DR	LAS VEGAS NV 89146-2984		
106	16302310033	WERTH RONALD E & ANITA F	6715 SIERRA TRL	LAS VEGAS NV 89146-2907			
107	16302412001	WILLIAMS JOHN O	2101 AUTUMN LULL DR	LAS VEGAS NV 89146-2930			
108	16302202002	WONG SIU HING	6790 W OAKY BLVD	LAS VEGAS NV 89146-2914			
109	16302310024	YOUNG DAVID G & TARA L	1935 REDWOOD ST	LAS VEGAS NV 89146-2912			