

015084

CITY of LAS VEGAS



MAYOR
JAN LAVERTY JONES

COUNCILMEN
ARNIE ADAMSEN
MICHAEL J. MCDONALD
GARY REESE
LARRY BROWN

CITY MANAGER
VIRGINIA VALENTINE

March 15, 1999

Ms. Loretta Bowman, County Clerk
County of Clark
200 South Third Street
Las Vegas, Nevada 89155

Re: **City of Las Vegas Annexation (A-11-99(A))**
United States Department of the Interior
Bureau of Land Management
4765 W. Vegas Drive
Las Vegas, NV 89108-2135
Parcel #'s 138-08-501-005

Dear Ms. Bowman:

Please be advised that a Petition of Annexation has been submitted for approximately 2.5 acres generally located in the vicinity of the southwest corner of Durango and Alexander.

A copy of the Petition of Annexation is attached for your further detailed information. This Petition will be considered by the Planning Commission on March 25, 1999, and will subsequently be heard by the City Council.

Sincerely,

Barbara Jo Ronemus
City Clerk

/jw



PLANNING AND DEVELOPMENT DEPARTMENT

APPLICATION/PETITION FORM (Must Be Printed or Typed)

Date: 1/8/99

Current Planning Division

APPLICATION/PETITION FOR: ANNEXATION (Type of Action Requested)

Project Address (Location): VICINITY OF THE SWC DURANGO AND ALEXANDER
Proposed Use: Assessor's Parcel No.: 138-08-561-005
Project Name: Ward No.: 4
Existing General Plan: L Sixteenth Section: NE4 of the NE4 of Section: 8 Township: 20 Range: 60
Proposed General Plan: L Existing Zoning: Proposed Zoning:
Gross Acres: 2.5 Lots/Units: Density: Commercial Sq. Ft.:
Comments/Additional Information/Special Notification:

APPLICANT INFORMATION:

Property Owner(s): V.S.A. Contact: ROBIN RYDOKUM
Address:
City: State: Zip: Tel: 647-5087 Fax:
Applicant: CITY OF LAS VEGAS Contact: KYLE WALTON
Address: 400 E. STEWART
City: LAS VEGAS State: NV Zip: 89101 Tel: 229-6884 Fax: 474-7463
Represented By: CITY OF LAS VEGAS Contact:
Address: 400 E. STEWART
City: LAS VEGAS State: NV Zip: 89101 Tel: 229-6884 Fax: 474-7463

SIGNATURE OF PROPERTY OWNER(S) OR AUTHORIZED AGENT (SIGN AND PRINT OR TYPE NAME)
Property Owner(s): [Signature]
Subscribed and sworn before me this 25 day of January 19 99
Notary Public: [Signature]

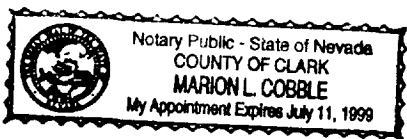

FOR DEPARTMENT USE ONLY
Case No.: A-11-99(A)
Meeting Date: 3/25/99
Required Signs:
Map No.: L-08-2
Total Fee(s):
Receipt No.:
Date Accepted: 1/13/99
Accepted By: [Signature]

CASE #

1 NE4NW4, SECTION 6, TOWNSHIP 19, RANGE 60
2 SE4NE4, SECTION 1, TOWNSHIP 19, RANGE 59
3 SE4SE4, SECTION 2, TOWNSHIP 19, RANGE 59
4 SECTION 12, TOWNSHIP 19, RANGE 59
5 N2NW4, SECTION 18, TOWNSHIP 19, RANGE 60
6 N2NE4, SECTION 18, TOWNSHIP 19, RANGE 60
7 NE4NE4, SECTION 18, TOWNSHIP 19, RANGE 60
8 N2NW4, SECTION 11, TOWNSHIP 19, RANGE 60
9 S2NW4, SECTION 11, TOWNSHIP 19, RANGE 60
10 NE4NE4, SECTION 21, TOWNSHIP 19, RANGE 60
11 SE4NE4, SECTION 21, TOWNSHIP 19, RANGE 60
12 NE4SE4, SECTION 21, TOWNSHIP 19, RANGE 60
13 SE4NE4, SECTION 29, TOWNSHIP 19, RANGE 60
14 S2NE4, SECTION 1, TOWNSHIP 20, RANGE 59
15 E2SE4, SECTION 1, TOWNSHIP 20, RANGE 59
16 S2SW4, SECTION 6, TOWNSHIP 20, RANGE 60
17 NW4SE4, SECTION 6, TOWNSHIP 20, RANGE 60
18 SE4SW4, SECTION 6, TOWNSHIP 20, RANGE 60
19 SE4SE4, SECTION 6, TOWNSHIP 20, RANGE 60
20 **NE4NE4, SECTION 8, TOWNSHIP 20, RANGE 60**
22 NE4NE4, SECTION 7, TOWNSHIP 20, RANGE 60
23 NE4NE4, SECTION 7, TOWNSHIP 20, RANGE 60
24 NENW4, SECTION 8, TOWNSHIP 20, RANGE 60
25 SE4NW4, SECTION 12, TOWNSHIP 20, RANGE 59
26 NW4SW4, SECTION 12, TOWNSHIP 20, RANGE 59
27 SW4SW4, SECTION 12, TOWNSHIP 20, RANGE 59

PLANNING &
DEVELOPMENT



Development
Services Center
731 S. Fourth Street
Las Vegas NV 89101

TDD 702-386-9108
Voice
Administration 229-6353
Comp. Planning 229-6022
Current Planning 229-6301
www.ci.las-vegas.nv.us

December 17, 1998

RE: Justification Letter

To Whom It May Concern,

Annexation of this property is necessary so the City may be able to better control of the types of uses that this property can be used for and to further the future public purpose activities of the City.

Sincerely,

Kyle C. Walton, AICP
Senior Planner
Comprehensive Planning Division
Planning and Development Department

Mayor
Jan Lavery Jones

Councilmen
Anne Adamsen
Michael J. McDonald
Gary Reese
Larry Brown

City Manager
Virginia Valentine





United States Department of the Interior

Bureau of Land Management
Las Vegas Field Office
4765 W. Vegas Drive
Las Vegas, Nevada, 89108-2135

In Reply Refer To:

2000
(NV-053)

CERTIFIED MAIL NO. **2526640**
RETURN RECEIPT REQUESTED

FEB 26 1998

Walter Cairns, Acting Director
Comprehensive Planning
City of Las Vegas
731 S. Fourth Street
Las Vegas, NV 89101

Dear Mr. Cairns:

This letter is in response to your request, dated January 14, 1998, concerning your action to annex of the lands described on the attached list. Please consider this our notification that the Bureau of Land Management has no objection to the request as it pertains to public lands.

Sincerely,

Mark R. Chatterton
Assistant District Manager
Non-Renewable Resources

Enclosure as stated

This map is for assessment use only and does NOT represent a survey
No liability is assumed for the accuracy of the data delineated herein.

Information on roads and other non-assessed parcels may be obtained
from the Road Document Listing in the Assessor's Office.

This map is compiled from official records, including surveys and deeds,
but only contains the information required for assessment. See the
recorded documents for more detailed legal information.

NOTES

MAP LEGEND

AVERAGE
QA VALUE
72

- PARCEL BOUNDARY
- SUBD BOUNDARY
- - - ROAD EASEMENT
- PW/LD BOUNDARY
- NON-PARCEL LOT LINE
- MATCH LINE
- 001 ROAD ID NUMBER

- 001 PARCEL NUMBER
- 1.00 ACREAGE
- 202 PARCEL SUB/SED NUMBER
- PR 25-43 PLAT RECORDING NUMBER
- 5 BLOCK NUMBER
- 5 LOT NUMBER
- GL5 GOV. LOT NUMBER

T20S R60E

08

N 2 NE 4

138-08-5

RS9C	R60E	R61E
128	125	124
137	138	139
121S	120S	119S
164	163	162

8	9	4	3	2	1
7	8	9	10	11	12
16	17	18	19	20	21
26	27	28	29	30	31
32	33	34	35	36	37

8	4	8	4
5	1	5	1
6	2	6	2
7	3	7	3
8	4	8	4

Scale: 1"=200'

Rev: 10/01/98

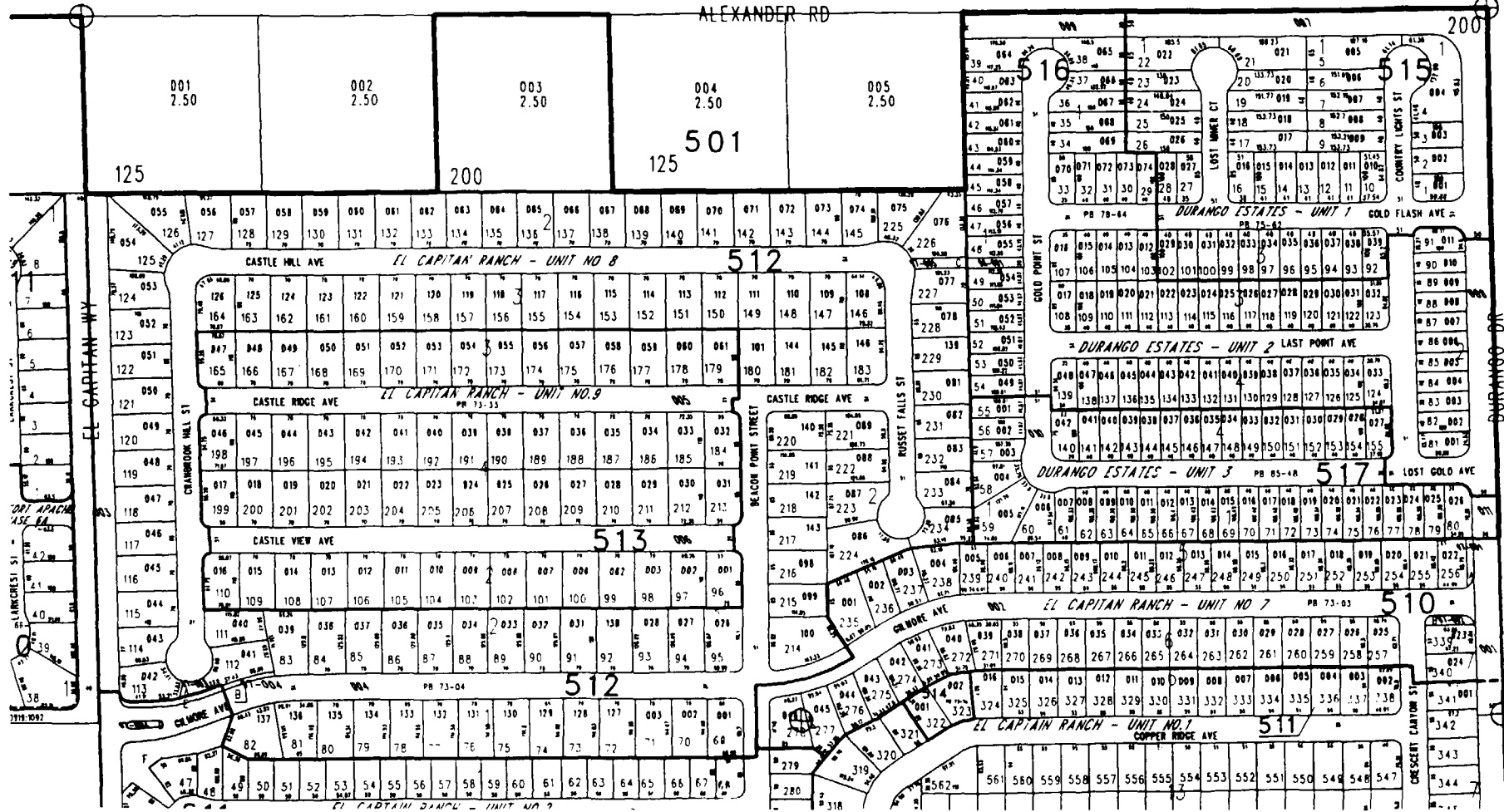
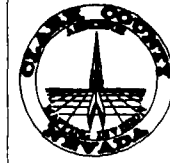

TAX DIST 125,200