



021661

March 2, 2000

Department of Taxation
1550 East College Parkway, Suite 115
Carson City, Nevada 89706

Re: Annexation A-42-99(A)

Gentlemen:

In compliance with Nevada Revised Statutes 268.597, a copy of an Annexation Ordinance for A-42-99(A) and recorded Accurate map are referred to your office. Please note that the effective date of the Ordinance is December 10, 1999.

The annexation area consists of approximately 10.312 acres located at the northeast corner of Gilmore Avenue and Tee Pee Lane.

If there are any questions regarding this annexation, please advise.

Very truly yours,

Robert S. Genzer, Deputy Director
Planning and Development Department

RSG:va

Attachment:

1. Annexation Ordinance #5184
2. Accurate Map

cc: City Clerk
Director of Finance
(w/Annexation Ordinance &
Location Map)

RECEIVED
CITY CLERK
MAR 10 10 31 AM '00

MAYOR
OSCAR B. GOODMAN

CITY COUNCIL
MICHAEL J. McDONALD
(MAYOR PRO-TEM)
GARY REESE
LARRY BROWN
LYNETTE B. McDONALD
LAWRENCE WEEKLY
MICHAEL MACK

CITY MANAGER
VIRGINIA VALENTINE

CITY OF LAS VEGAS
400 STEWART AVENUE
LAS VEGAS, NEVADA 89101

VOICE 702.229.6011
TDD 702.386.9108
www.ci.las-vegas.nv.us



CASE: A-42-99(A)

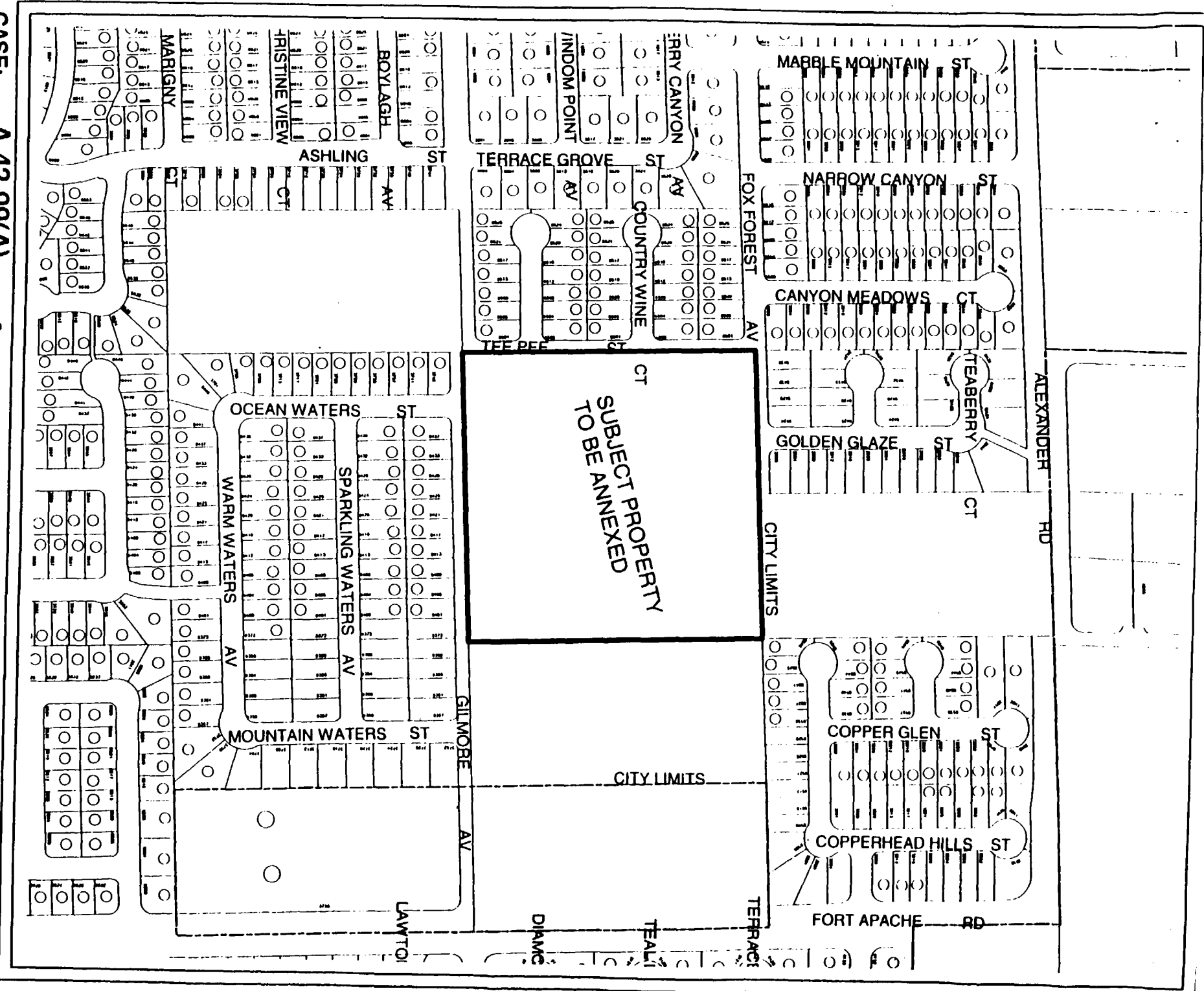

Bill No. 99-64

Ordinance No. 5184

AN ORDINANCE EXTENDING THE CORPORATE LIMITS OF THE CITY OF LAS VEGAS, NEVADA, TO INCLUDE WITHIN, ANNEX TO AND MAKE A PART OF SAID CITY CERTAIN SPECIFICALLY DESCRIBED TERRITORY ADJOINING AND CONTIGUOUS TO THE CORPORATE LIMITS OF SAID CITY; DECLARING SAID TERRITORY AND THE INHABITANTS THEREOF TO BE ANNEXED TO SAID CITY AND SUBJECT TO ALL DEBTS, LAWS, ORDINANCES AND REGULATIONS IN FORCE IN SAID CITY; ORDERING A MAP OR PLAT OF SAID DESCRIBED TERRITORY TO BE RECORDED IN THE OFFICE OF THE COUNTY RECORDER OF THE COUNTY OF CLARK, STATE OF NEVADA; DESIGNATING THE ZONING CLASSIFICATION(S) APPLICABLE TO SAID TERRITORY; PROVIDING FOR OTHER MATTERS PROPERLY RELATING THERETO; AND REPEALING ALL ORDINANCES AND PARTS OF ORDINANCES IN CONFLICT HEREWITH. (A-42-99(A))

Sponsored by: Councilman Larry Brown
Summary: Annexes property described generally as located at the northeast corner of Gilmore Avenue and Tee Pee Lane.

THE CITY COUNCIL OF THE CITY OF LAS VEGAS DOES HEREBY ORDAIN AS FOLLOWS:

SECTION 1: The corporate limits of the City of Las Vegas, Nevada, are hereby extended to include, annex to, and make a part of the City of Las Vegas, Nevada, the following described real property, to-wit:

The Southwest Quarter (SW ¼) of the Northeast Quarter (NE ¼) of the Northeast Quarter (NE ¼) of Section 7, Township 20 South, Range 60 East, M.D.M., in the County of Clark, State of Nevada.

SECTION 2: That said City Council has determined and does hereby determine, that said described territory meets the requirements provided by law for annexation to the City of Las Vegas for the following reasons:

- A. The area to be annexed was contiguous to the City's boundaries at the time the annexation proceedings were instituted;
- B. More than one-eighth (1/8) of the aggregate external boundaries of the area are contiguous to the City of Las Vegas;
- C. The territory proposed to be annexed is not included within the boundaries of another incorporated city or within the boundaries of any unincorporated town as those boundaries existed as of July 1, 1983;

APN: 138-07-501-012

CERTIFIED AS A TRUE COPY
Brenda K. Brinson
CITY CLERK, CITY OF LAS VEGAS
NEVADA (4/22/99 - 12/8/99)

1 D. The City of Las Vegas is eligible to annex the area described in this report
2 since the landowners have signed a petition constituting one hundred percent
3 (100%) of the owners of record of individual lots or parcels of land within the
4 annexation area.

5 SECTION 3: The City of Las Vegas will provide police protection through the Las
6 Vegas Metropolitan Police Department, fire protection, street maintenance, and library services
7 immediately upon annexation. Garbage collection by the company franchised by the City will also
8 be provided immediately. The City sanitary sewer system will serve the proposed annexation area.
9 Any connection to or extension of this sewer line to serve the annexation area shall be at the expense
10 of the landowners. Other services, such as participation in the City's recreational programs, special
11 education classes and programs, public works planning, building inspections, and other City services
12 will also be available immediately. Utilities such as gas, electricity, telephone, and water are provided
13 by private utility companies and other services to the area will not be affected by annexation. Street
14 paving, curbs and gutters, sidewalks and street lights which are not in place at the time of annexation
15 will be installed in the presently developed areas upon the request of the property owners and at their
16 expense by means of special assessment districts. Such improvements will be extended into the
17 undeveloped areas as development takes place and the need therefor arises, and will be located
18 according to the needs of the area at that time. Such installations will also be made at the expense of
19 the property owners, either by means of special assessment districts or as prerequisites to the approval
20 of subdivision plats, building permits or other land use or development applications.

21 SECTION 4: The annexation of said described territory shall become effective on the
22 10th day of December, 1999, and on such date the City of Las Vegas will have the funds appropriated
23 in sufficient amount to finance the extension into said described territory of police protection, fire
24 protection, street maintenance, street sweeping, and street lighting maintenance.

25 SECTION 5: Said described territory, together with the inhabitants and property
26 thereof, shall, from and after the 10th day of December, 1999, be subject to all debts, laws, ordinances
27 and regulations in force in the City of Las Vegas and shall be entitled to the same privileges and
28 benefits as other parts of said City, and shall be subject to municipal taxes levied by the City of Las

1 Vegas, Nevada.

2 SECTION 6: The City Engineer of the City of Las Vegas, Nevada, is hereby instructed
3 to cause to be prepared an accurate map or plat of said described territory and to record the same,
4 together with a certified copy of this ordinance in the office of the County Recorder of Clark County,
5 Nevada, which said recording shall be done prior to the 10th day of December, 1999.

6 SECTION 7: The said described territory, which heretofore has been zoned R-E
7 (County of Clark classification), is hereby classified as U (ML) (City of Las Vegas classification),
8 which is deemed to be the City equivalent of said County classification.

9 SECTION 8: If any section, subsection, subdivision, paragraph, sentence, clause or
10 phrase in this ordinance or any part thereof, is for any reason held to be unconstitutional, or invalid
11 or ineffective by any court of competent jurisdiction, such decision shall not affect the validity or
12 effectiveness of the remaining portions of this ordinance or any part thereof. The City Council of the
13 City of Las Vegas hereby declares that it would have passed each section, subsection, subdivision,
14 paragraph, sentence, clause or phrase thereof irrespective of the fact that any one or more sections,
15 subsections, subdivisions, paragraphs, sentences, clauses or phrases be declared unconstitutional,
16 invalid or ineffective.

17 SECTION 9: All ordinances or parts of ordinances, sections, subsections, phrases,
18 sentences, clauses or paragraphs contained in the Municipal Code of the City of Las Vegas, Nevada,
19 1983 Edition, in conflict herewith are hereby repealed.

20 PASSED, ADOPTED and APPROVED this 1st day of December 1999.



21 APPROVED:

22 *Oscar B. Goodman*
23 OSCAR B. GOODMAN, Mayor

24 ATTEST:

25 *Barbara Jo Ronemus*
26 BARBARA JO RONEMUS, City Clerk

27 APPROVED AS TO FORM:

28 *Val Steef* 10-21-99
Date

The above and foregoing ordinance was first proposed and read by title to the City Council on the 3rd day of November, 1999 and referred to the following committee composed of Councilmen Brown and M. McDonald for recommendation; thereafter the said committee reported favorably on said ordinance on the 1st day of December, 1999 which was a regular meeting of said Council; that at said regular meeting, the proposed ordinance was read by title to the City Council as first introduced and adopted by the following vote:

VOTING "AYE": Mayor Goodman and Councilmembers M. McDonald, Reese Brown and L. McDonald
VOTING "NAY": NONE
EXCUSED: NONE

APPROVED:



Oscar B. Goodman
OSCAR B. GOODMAN, Mayor

ATTEST:

Barbara Jo Ronemus
BARBARA JO RONEMUS, City Clerk

When Recorded Please Mail To:
ROBERT S. GENZER, DEPUTY DIRECTOR
Planning and Development Department
731 South Fourth Street
Las Vegas, Nevada 89101

APPLICATION/PETITION FORM

Date: _____

APPLICATION/PETITION FOR: ANNEXATION

(Type of Action Requested)

Project Address (Location): GILMORE AVENUE / CHIEFTON STREET

Proposed Use: ELEMENTARY SCHOOL Assessor's Parcel No(s): 138-07-501-012

Project Name: GILMORE-TEE PEE ELEMENTARY SCHOOL

Existing General Plan Designation: _____ Proposed General Plan Designation: _____

Existing Zoning: R-E Proposed Zoning: CV Ward No.: 4

Commercial Sq. Ft.: _____ Floor Area Ratio: _____

Gross Acres: 10.0 Lots/Units: _____ Density: _____

Additional Information: A-14-99(A)

RECEIVED CITY CLERK
999 AUG 23 A

APPLICANT INFORMATION:

Property Owner(s): CLARK COUNTY SCHOOL DISTRICT

Address: 4828 S. PEARL STREET

City: LAS VEGAS

Contact: BARBARA RODGERS

Tel: 799-7600 ext. 219 Fax: 799-7716

State: NEVADA Zip: 89121

Applicant: CLARK COUNTY SCHOOL DISTRICT

Address: 4828 S. PEARL STREET

City: LAS VEGAS

Contact: BARBARA RODGERS

Tel: 799-7600 ext. 219 Fax: 799-7716

State: NEVADA Zip: 89121

Represented By: PBS&J

Address: 901 N GREEN VALLEY PKWY #100

City: HENDERSON

Contact: DARLA MILLIS

Tel: 263-7275 Fax: 263-7200

State: NEVADA Zip: 89014

SIGNATURE OF PROPERTY OWNER(S) OR AUTHORIZED AGENT (SIGN AND PRINT OR TYPE NAME)

PROPERTY OWNER(S): Frederick C. Smith

Print First & Last Name: FREDERICK C. SMITH

Subscribed and sworn before me this 17th day of AUGUST 19 99

Ruth Boothe

Notary Public

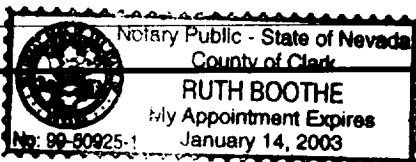

FOR DEPARTMENT USE ONLY

Case No.: A-42-99

Meeting Date: 09/23/99 PC

No. Signs Required: - No. Provided: -

Map No.: L-7-2

Total Fee(s): N/A

Receipt No.: N/A

Date Accepted: 08/18/99

Accepted By: Hilleri

Form 2912-1
(April 1992)

UNITED STATES
DEPARTMENT OF THE INTERIOR
BUREAU OF LAND MANAGEMENT
RECREATION OR PUBLIC PURPOSES LEASE
Act of June 17, 1926, as amended (43 U.S.C. 869 et seq.)

Serial Number

N-41567-30

This lease entered into on this 18th day of November, 1998, by the United States of America, the lessor, through the authorized officer of the Bureau of Land Management, and

Clark County School District
2832 East Flamingo Road
Las Vegas, Nevada 89121

hereinafter called the lessee, pursuant and subject to the terms and provisions of the Recreation and Public Purposes Act and to all reasonable regulations of the Secretary of the Interior now or hereafter in force when not inconsistent with any express and specific provisions herein, which are made a part hereof,

WITNESSETH

Sec. 1. The lessor, in consideration of the rents to be paid and the conditions to be observed as hereinafter set forth, does hereby grant and lease to the lessee the right and privilege of using for the purposes hereinafter set forth in the following described lands: together with an option to purchase during the term of the lease upon a showing of substantial compliance with the approved plan of development filed August 30, 1982.

Mount Diablo Meridian, Nevada

T. 20 S., R. 60 E.,
sec. 7, SW~~1/4~~NE~~1/4~~.

containing 10.0 acres, together with the right to construct and maintain thereon all buildings or other improvements necessary for such use for a period of 10 years, the rental to be \$25.00 per annum. If, at the expiration date of the lease the authorized officer shall determine that the lease may be renewed, the lessee herein will be accorded the privilege of renewal upon such terms as may be fixed by the lessor. The lessee may use the premises for an elementary school. This lease includes the authorization for all necessary utilities to include electricity, telephone, water, sewer and cable television.

Post-It* Fax Note 7671		Date 8-4-99	# of pages 1
To <i>Kusler</i>	From <i>Barbara R</i>		
Co/Dept. <i>PB, J+J</i>	Co. <i>CCSD</i>		
Phone #	Phone # <i>799-7571 x219</i>		
Fax # <i>213-7200</i>	Fax #		

Sec. 2. There are reserved to the United States all mineral deposits in said lands, together with the right to mine and remove the same under applicable laws and regulations to be established by the Secretary of the Interior.

Sec. 3. The lessor reserves the right of entry, or use, by

- (a) any authorized person, upon the leased area and into the buildings constructed thereon for the purpose of inspection;
- (b) Federal agents and game warden upon the leased area on official business;
- (c) the United States, its permittees and licensees, to mine and remove the mineral deposits referred to in Sec. 2, above

Sec. 4. In consideration of the foregoing, the lessee hereby agrees:

(a) To improve and manage the leased area in accordance with the plan of development and management ~~documents~~ filed on August 30, 1982

and approved by an authorized officer on February 6, 1996 or any modification thereof hereinafter approved by an authorized officer, and to maintain all improvements, during the term of this lease, in a reasonably good state of repair.

(b) To pay the lessor the annual rental above set forth in advance during the continuance of this lease.