

054508

RECEIVED
CITY CLERK

June 24, 2005

2005 JUN 30 A 9: 02.

Department of Taxation
1550 East College Parkway, Suite 115
Carson City, Nevada 89706

Re: Annexation ANX-6042
Parcel Number(s): 125-26-704-002, 125-26-707-002 and 005

Gentlemen:

In compliance with Nevada Revised Statutes 268.597, a copy of an Annexation Ordinance for ANX-6042 and recorded Accurate map are referred to your office. Please note that the effective date of the Ordinance is June 10, 2005.

The annexation area consists of approximately 9.633 acres, generally located on the west side of Jones Boulevard, between Tropical Parkway and El Campo Grande Avenue.

If there are any questions regarding this annexation, please advise.

Very truly yours,

Thomas A. Perrigo
Planning and Development Department

TAP:tm

Attachment:

- 1. Annexation Ordinance 5775
- 2. Accurate Map

cc: City Clerk
(w/Annexation Ordinance & Location Map)

LAS VEGAS CITY COUNCIL

OSCAR B. GOODMAN
MAYOR

GARY REESE
MAYOR PRO TEM

LARRY BROWN
LAWRENCE WEEKLY
MICHAEL MACK
STEVE WOLFSON
LOIS TARKANIAN

DOUGLAS A. SELBY
CITY MANAGER

CITY OF LAS VEGAS
400 STEWART AVENUE
LAS VEGAS, NEVADA 89101

VOICE 702.229.6011
TTY 702.386.9108

www.lasvegasnevada.gov
18112-001-1-05
CLV 7009



Requestor:
CITY CLERK-LAS VEGAS CITY
06/10/2005 14:19:10 T20050106874
Book/Instr: 20050610-0003475
Ordinance Page Count: 7
Fees: \$0.00 N/C Fee: \$0.00

1 APNs: 125-26-704-002

2
3
4
5
6
7
8
9
10
11
12
13
14
15
16
17
18
19
20
21
22
23
24
25
26
27
28

Bevly K. Deane
250-618/08
COPY

Frances Deane
Clark County Recorder

BILL NO. 2005-28

ORDINANCE NO. 5775

AN ORDINANCE TO EXTEND THE BOUNDARIES OF THE CITY, TO PARTICULARLY DESCRIBE THE LAND TO BE ANNEXED, TO MAKE ITS INHABITANTS SUBJECT TO THE LAWS, OBLIGATIONS AND BENEFITS OF THE CITY, AND TO PROVIDE FOR OTHER RELATED MATTERS. (ANX-6042)

Sponsored by: Councilman Michael Mack Summary: Annexes property described generally as located on the west side of Jones Boulevard, between Tropical Parkway and El Campo Grande Avenue.

THE CITY COUNCIL OF THE CITY OF LAS VEGAS DOES HEREBY ORDAIN AS FOLLOWS:

SECTION 1: The corporate limits of the City of Las Vegas, Nevada, are hereby extended to annex, include, and make a part of the City of Las Vegas, Nevada, the following described real property:

That portion of the Northeast Quarter (NE 1/4) of the Southeast Quarter (SE 1/4) of Section 26, Township 19 South, Range 60 East, M.D.M., in the County of Clark, State of Nevada, together with the adjoining half street right-of-way of JONES BOULEVARD (width varies), TROPICAL PARKWAY (40.00 feet wide as measured from the centerline thereof), CORBET STREET (30.00 feet wide as measured from the centerline thereof), and EL CAMPO GRANDE AVENUE (30.00 feet wide as measured from the centerline thereof) described as follows:

BEGINNING at the east quarter corner of said Section 26, said corner also being the centerline intersection of said JONES BOULEVARD and TROPICAL PARKWAY; thence westerly along the centerline of said TROPICAL PARKWAY and the north line of the Southeast Quarter (SE 1/4) of said Section 26, North 84°36'52" West 307.36 feet; thence departing said north line, southerly along the west line of the East Half (E 1/2) of the Northeast Quarter (NE 1/4) of the Northeast Quarter (NE 1/4) of the

1 Southeast Quarter (SE 1/4) of said Section 26, South 00°28'45" West 657.93
2 feet to the south line of said East Half (E 1/2), also being the centerline of
3 CORBET STREET; thence westerly along the centerline of said CORBET
4 STREET, North 83°43'00" West 10.05 feet to the northerly projection of the
5 east line of PARCEL 2 as shown on CORPORATION GRANT, BARGAIN,
6 SALE DEED, from SIGAL AND COMPANY to TOM C. CHAN, ET AL,
7 recorded July 10, 1979 in Book 1083 as Instrument Number 1042668 of
8 Clark County, Nevada Records; thence southerly along said east line South
9 00°28'46" West 328.89 feet to the north line of PARCEL 4 as shown on
10 Parcel Map in File 2, Page 42 recorded April 24, 1974 of Clark County,
11 Nevada Records; thence westerly along the north line of said PARCEL 4
12 North 83°16'19" West 20.57 feet to the northwest corner of said PARCEL 4;
13 thence southerly along the west line and the southerly projection of said
14 PARCEL 4, South 00°24'18" West 328.77 feet to the south line of the
15 Northeast Quarter (NE 1/4) of the Southeast Quarter (SE 1/4) of said Section
16 26, also being the centerline of EL CAMPO GRANDE AVENUE; thence
17 easterly along said south line, South 82°49'48" East 341.55 feet to the east
18 line of the Northeast Quarter (NE 1/4) of the Southeast Quarter (SE 1/4) of
19 said Section 26, also being the centerline intersection of EL CAMPO
20 GRANDE AVENUE and JONES BOULEVARD; thence northerly along
21 said east line and the centerline of said JONES BOULEVARD, North
22 00°21'04" East 1325.85 feet to the POINT OF BEGINNING.

23 BASIS OF BEARINGS: North 00°21'04" East being the east line of the
24 Northeast Quarter (NE 1/4) of the Southeast Quarter (SE 1/4) of Section 26,
25 Township 19 South, Range 60 East, M.D.M., as shown on Parcel Map in File
26 2, Page 42 of Clark County, Nevada Records.

27 Written by:
28 Brian Yu PLS
City of Las Vegas, Public Works,
731 S. Fourth Street
Las Vegas, NV 89101

SECTION 2: The City Council hereby determines that the described territory
meets the requirements provided by law for annexation to the City for the following reasons:

- A. The area to be annexed was contiguous to the City's boundaries at the time the annexation proceedings were instituted;
- B. More than one-eighth (1/8) of the aggregate external boundaries of the area are contiguous to the City;
- C. The territory proposed to be annexed is not included within the boundaries of another incorporated city or within the boundaries of any unincorporated town as those boundaries existed as of July 1, 1983;
- D. The City is eligible to annex the described territory since the

1 landowners have signed a petition constituting one hundred percent
2 (100%) of the owners of record of individual lots or parcels of land
3 within the annexation area.

4 SECTION 3: The City will provide police protection through the Las Vegas
5 Metropolitan Police Department, fire protection, street maintenance, and library services
6 immediately upon annexation. Garbage collection by the company franchised by the City
7 will also be provided immediately. The City sanitary sewer system will serve the proposed
8 annexation area. Any connection to or extension of this sewer line to serve the annexation
9 area shall be at the expense of the landowners. Other services, such as participation in the
10 City's recreational programs, special education classes and programs, public works planning,
11 building inspections, and other City services will also be available immediately. Utilities
12 such as gas, electricity, telephone, and water are provided by private utility companies and
13 other services to the area will not be affected by annexation. Street paving, curbs and gutters,
14 sidewalks and street lights which are not in place at the time of annexation will be installed
15 in the presently developed areas upon the request of the property owners and at their expense
16 by means of special assessment districts. Such improvements will be extended into the
17 undeveloped areas as development takes place and the need therefor arises, and will be
18 located according to the needs of the area at that time. Such installations will also be made
19 at the expense of the property owners, either by means of special assessment districts or as
20 prerequisites to the approval of subdivision plats, building permits or other land use or
21 development applications.

22 SECTION 4: The annexation of the described territory shall become
23 effective on the 10th day of June, 2005, and on that date the City will have the funds
24 appropriated in sufficient amount to finance the extension into the described territory of
25 police protection, fire protection, street maintenance, street sweeping, and street lighting
26 maintenance.

27 SECTION 5: The described territory, together with the inhabitants and
28 property thereof, shall, from and after the 10th day of June, 2005, be subject to all debts,

1 | laws, ordinances and regulations in force in the City and shall be entitled to the same
2 | privileges and benefits as other parts of the City, and shall be subject to municipal taxes
3 | levied by the City.

4 | SECTION 6: The City Engineer is hereby instructed to cause to be prepared
5 | an accurate map or plat of the described territory and to record the map or plat, together with
6 | a certified copy of this ordinance, in the office of the County Recorder of Clark County,
7 | Nevada, which recording shall be done prior to the 10th day of June, 2005.

8 | SECTION 7: The described territory, which previously has been zoned R-E
9 | (County of Clark classification), is hereby classified as U (R) (City of Las Vegas
10 | classification), which is deemed to be the City equivalent of the County classification.

11 | SECTION 8: If any section, subsection, subdivision, paragraph, sentence,
12 | clause of phrase in this ordinance or any part thereof, is for any reason held to be
13 | unconstitutional, or invalid or ineffective by any court of competent jurisdiction, such
14 | decision shall not affect the validity or effectiveness of the remaining portions of this
15 | ordinance or any part thereof. The City Council of the City of Las Vegas hereby declares that
16 | it would have passed each section, subsection, subdivision, paragraph, sentence, clause or
17 | phrase thereof irrespective of the fact that any one or more sections, subsections,
18 | subdivisions, paragraphs, sentences, clauses or phrases be declared unconstitutional, invalid
19 | or ineffective.

20 | ...
21 | ...
22 | ...
23 | ...
24 | ...
25 | ...
26 | ...
27 | ...
28 | ...

1
2
3
4
5
6
7
8
9
10
11
12
13
14
15
16
17
18
19
20
21
22
23
24
25
26
27
28

SECTION 9: All ordinances or parts of ordinances, sections, subsections, phrases, sentences, clauses or paragraphs contained in the Municipal Code of the City of Las Vegas, Nevada, 1983 Edition, in conflict herewith are hereby repealed.

PASSED, ADOPTED and APPROVED this 1st day of June, 2005.

APPROVED:

By 
OSCAR B. GOODMAN, Mayor

ATTEST:

BARBARA JO RONEMUS, City Clerk

APPROVED AS TO FORM:

Val Steed 4-20-05
Date

1
2
3
4
5
6
7
8
9
10
11
12
13
14
15
16
17
18
19
20
21
22
23
24
25
26

The above and foregoing ordinance was first proposed and read by title to the City Council on the 4th day of May, 2005, and referred to a committee for recommendation; thereafter the committee reported favorably on said ordinance on the 1st day of June, 2005, which was a regular meeting of said Council; that at said regular meeting, the proposed ordinance was read by title to the City Council as first introduced and adopted by the following vote:

VOTING "AYE": Mayor Goodman
Councilmembers: Reese, Brown, Weekly, Mack, Wolfson and Tarkanian

VOTING "NAY": None

EXCUSED: None

ABSTAINED: None

APPROVED:



OSCAR B. GOODMAN, Mayor

ATTEST:



BARBARA JO RONEMUS, City Clerk

WHEN RECORDED PLEASE MAIL TO:
THOMAS A. PERRIGO
Planning and Development Department
731 South Fourth Street
Las Vegas, Nevada 89101

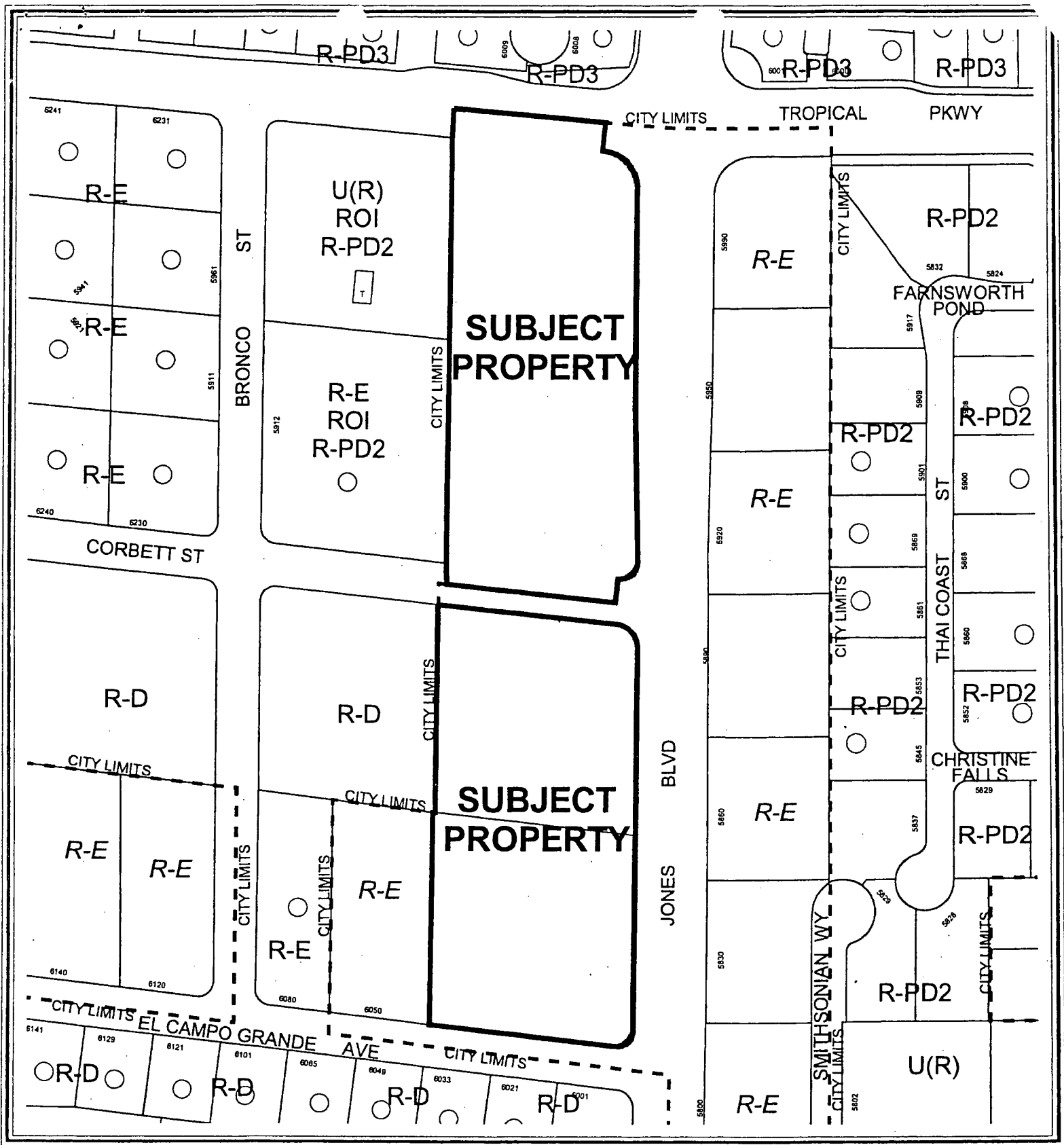

CASE: ANX-6042

