

SUMMERLIN

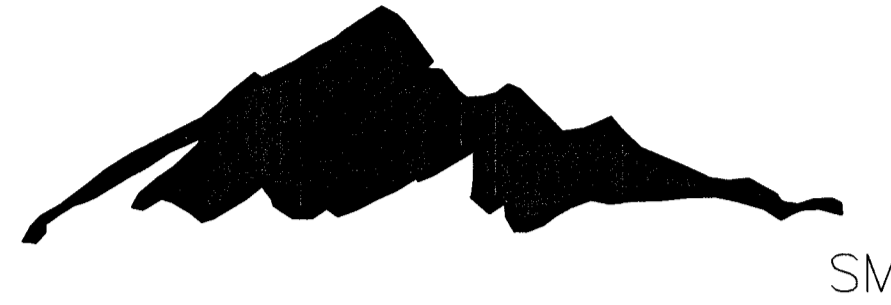

TRAFFIC SIGNAL SYSTEM AT DESERT FOOTHILLS DRIVE/ALTA DRIVE 2017

SID 808 PROJECT NO 37

DEVELOPER

HOWARD HUGHES COMPANY, LLC.
10801 W. CHARLESTON BLVD., 3RD FLOOR
LAS VEGAS, NEVADA 89135
OFFICE PHONE NO. (702) 791-4300
OFFICE FAX NO. (702) 791-4450

ENGINEER

GCV ENGINEERS \ SURVEYORS
1555 S. RAINBOW BLVD.
LAS VEGAS, NV 89146
T: 702.804.2000
F: 702.804.2299
gcvengineering.com

CAUTION TO CONTRACTOR

THE CONTRACTOR SHALL BE RESPONSIBLE TO INVESTIGATE AND VERIFY THE ACTUAL LOCATION AND DEPTH OF ALL EXISTING UNDERGROUND FACILITIES AT LEAST 48 HOURS IN ADVANCE OF THE PERFORMANCE OF ANY WORK.

HOWARD HUGHES COMPANY, LLC.

Kevin Orrock
KEVIN ORROCK
VICE PRESIDENT

4-17-17
DATE

APPROVED FOR CONSTRUCTION

Y. Dishoo
LAS VEGAS VALLEY WATER DISTRICT ENGINEERING SERVICES MANAGER

PROJECT NO. 125355 DATE: 5/1/17
SHEETS: 1, 3, 4

CLV PLANNING DEPARTMENT

THIS PLAN MEETS THE APPLICABLE STANDARDS OF THE PLANNING AND DEVELOPMENT DEPARTMENT

NA
CHRIS KNIGHT, BUILDING AND SAFETY DIRECTOR

DATE

APPROVAL OF THESE PLANS IS LIMITED TO THOSE IMPROVEMENTS CONSTRUCTED IN THE DEDICATED RIGHTS-OF-WAY AND / OR DEDICATED EASEMENTS. THIS APPROVAL DOES NOT AUTHORIZE THE CONSTRUCTION OF ANY IMPROVEMENTS THAT DEVIATE FROM ADOPTED STANDARDS AND / OR SPECIFICATIONS, EXCEPT THOSE SPECIFICALLY LISTED UNDER DEVIATIONS FROM STANDARD. THE ENGINEER SHALL RESOLVE ANY DEVIATION OTHER THAN THOSE LISTED IN DEVIATIONS FROM STANDARDS IN FAVOR OF THE UNIFORM STANDARD DRAWINGS AND SPECIFICATIONS CLARK COUNTY AREA NEVADA.

Allen Pavelka
ALLEN PAVELKA, P.E., P.E. #9029
CITY ENGINEER
CITY OF LAS VEGAS, NEVADA

7-17-17
DATE

INDEX OF SHEETS

SHEET NO.	SHEET DESCRIPTION
1	COVER SHEET
2	LEGEND, ABBREVIATIONS, AND VICINITY MAP
3	GENERAL NOTES
4	TRAFFIC SIGNAL PLAN
5	TRAFFIC SIGNAL SCHEDULES AND DETAILS
6	SIGNING AND STRIPING PLAN
7	ITS IMPROVEMENTS

UTILITY/AGENCY APPROVALS

Mike Watt
COX COMMUNICATIONS LAS VEGAS, INC. 4/25/17
DATE

Norio Figueroa
CENTRAL TELEPHONE COMPANY, D/B/A CENTURYLINK 4-24-17
DATE

THE AFFIXED CENTURYLINK APPROVAL DOES NOT ASSUME OR GUARANTEE LIABILITY FOR KNOWN OR UNKNOWN CONFLICTS WITH EXISTING OR PROPOSED IMPROVEMENTS. RESOLUTION OF ANY CONFLICT WILL BE ACCOMPLISHED PURSUANT TO LOCAL ORDINANCES, NEVADA REVISED STATUTES AND/OR PUBLIC UTILITY COMMISSION RULES AND REGULATIONS.

Barbara Garrison
NV ENERGY - DISTRIBUTION 4-24-17
DATE

NV ENERGY ACKNOWLEDGES THAT WE HAVE RECEIVED YOUR PLANS AND WILL PROVIDE SERVICE TO ALL ELECTRICAL NEEDS ASSOCIATED WITH THIS PROJECT. NV ENERGY RESERVES THE RIGHT TO ADDRESS ANY EXISTING OR FUTURE CONFLICTS ONCE THE FINAL DESIGN IS COMPLETED. THE NEW SERVICE AND THE RESOLUTION OF ANY CONFLICTS WILL BE ACCOMPLISHED PURSUANT TO THE NEVADA PUBLIC UTILITY COMMISSION'S RULES AND REGULATIONS.

Jim Hany
NV ENERGY - TRANSMISSION ENGINEERING 4-24-17
DATE

SWGC
SOUTHWEST GAS CORP. 5/15/17
DATE

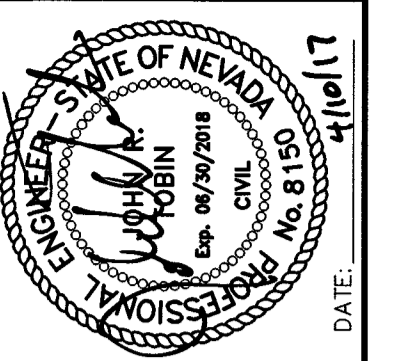

PROJECT NO.	DESIGN:	DRAWN:	CHECK:	PLOT DATE:	REV	DATE	DESCRIPTION	AGEN APP	DATE	GCW APP	DATE
62023-707	JRT	TJD	JRT	04-10-17							
				10.26.42							

1555 S. RAINBOW BLVD.
LAS VEGAS, NV 89146
T: 702.804.2000
F: 702.804.2299
gcvengineering.com
GCV ENGINEERS \ SURVEYORS
F:\Projects\600\62023-707\DWG\Production\01_DFA_COVER.dwg
Dillon Hines

THE HOWARD HUGHES COMPANY, LLC
TRAFFIC SIGNAL SYSTEM AT
DESERT FOOTHILLS DR/ALTA DR
COVER SHEET
DRAWING
L-69512 1
1 OF 7 SHTS
PROJ# 125355 QS137-34-NE
2017.04.22

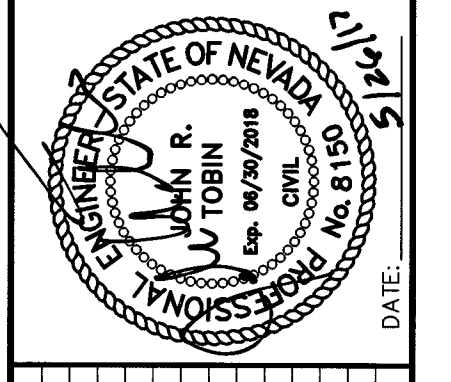

LEGEND	
TEL 4-4"	EXISTING TELEPHONE CABLE
10" SS	EXISTING SANITARY SEWER LINE
8" W	EXISTING WATER LINE
18" SD	EXISTING STORM DRAIN LINE
ELE	EXISTING ELECTRICAL LINE
OHP	EXISTING OVERHEAD POWER LINE
4" PE GAS	EXISTING GAS LINE
CATV FO	EXISTING CABLE TELEVISION LINE
(S)	EXISTING CURB & GUTTER
(M)	EXISTING MANHOLE
(V)	EXISTING VALVE (GAS OR WATER)
(F)	EXISTING FIRE HYDRANT
(X)	EXISTING CONDUIT RUN NO.
(---)	PROPOSED CONDUIT
(---)	EXISTING CONDUIT
(---)	RIGHT-OF-WAY LINE
(---)	EASEMENT LINE
(---)	PROPERTY LINE
(---)	CENTERLINE
(S)	EXISTING STREETLIGHT (SUMMERLIN)
(PP)	EXISTING POWER POLE
(P)	EXISTING SERVICE PEDESTAL
(T)	EXISTING NVE TRANSFORMER
(S)	EXISTING NO. 3 1/2 PULL BOX
(S)	EXISTING NO. 5 PULL BOX
(S)	EXISTING NO. 7 PULL BOX
(S)	EXISTING P30 PULL BOX
(S)	EXISTING TYPE 200 SPLICE VAULT
(S)	PROPOSED LED LUMINAIRE (400W HPS EQUIVALENT-SUMMERLIN)
(S)	PROPOSED NO. 3 1/2 PULL BOX
(S)	PROPOSED NO. 5 PULL BOX
(S)	PROPOSED NO. 7 PULL BOX
(S)	PROPOSED P30 PULL BOX
(S)	PROPOSED TYPE 200 SPLICE VAULT
(S)	PROPOSED CONTROLLER CABINET
(S)	PROPOSED SIGNAL POLE
(S)	PROPOSED TRAFFIC SIGN
(S)	PROPOSED STREET NAME SIGN (INTERNALLY ILLUMINATED)
(S)	PROPOSED OPTICOM DETECTOR
(S)	PROPOSED PEDESTRIAN SIGNAL HEAD
(S)	PROPOSED PEDESTRIAN PUSH BUTTON
(S)	PROPOSED CONDUIT RUN NO.
(S)	PROPOSED DETECTOR LOOP (SIZE AS SHOWN)
(S)	PROPOSED SIGNAL HEAD

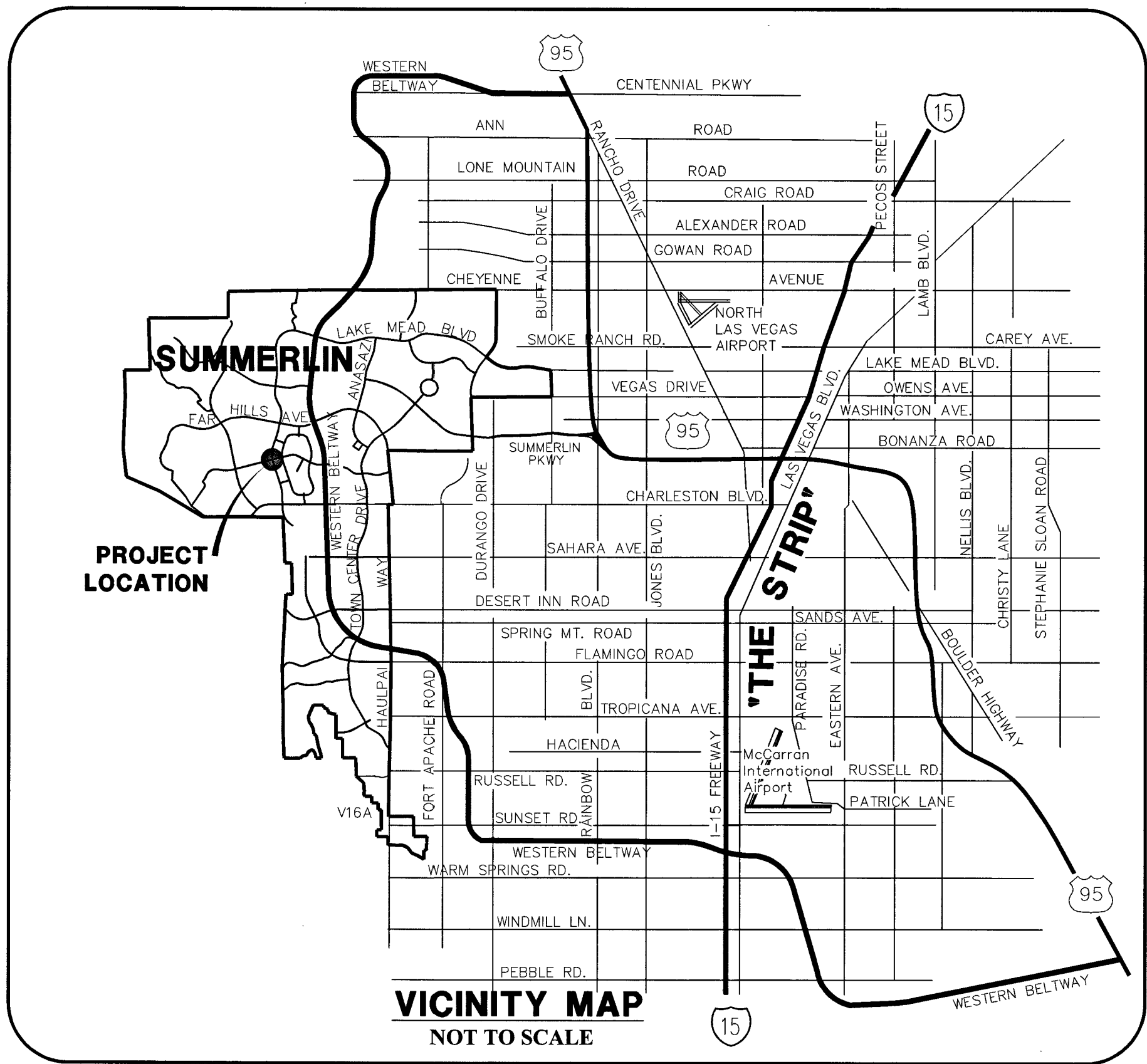

ABBREVIATIONS	
ADV	ADVANCED
AL	ALTA DRIVE @
ASTM	AMERICAN SOCIETY FOR TESTING & MATERIALS
CATV	CABLE TELEVISION
CCPW	CLARK COUNTY PUBLIC WORKS
CCRFCD	CLARK COUNTY REGIONAL FLOOD CONTROL DISTRICT
CS	CURB & GUTTER
DET	DETECTION
"DF"	DESERT FOOTHILLS DRIVE @
DOC	DOCUMENT
DR	DRIVE
DS	DOUBLE STACKED
DWG	DRAWING
E	EAST
ELEC	ELECTRIC
EOP	EDGE OF PAVEMENT
ESMT	EASEMENT
EX/EXIST	EXISTING
FAST	FREEWAY & ARTERIAL SYSTEM OF TRANSPORTATION
FG	FINISHED GRADE
FT	FEET
G	GAS
LT	LEFT
LUM.	LUMINAIRE
MIN.	MINIMUM
N	NORTH
NO.	NUMBER
NVE	NV ENERGY
OHP	OVERHEAD POWER
OP	OPTICOM
P.B.	PULLBOX
PE	POLYETHYLENE
PED.	PEDESTRIAN
PMF	PAVEMENT MARKING FILM
PPM	POLYUREA PAVEMENT MARKINGS
QUAD.	QUADRANT
RD	ROAD
RPM	RAISED PAVEMENT MARKINGS
RT	RIGHT
R/W	RIGHT-OF-WAY
S	SOUTH
SD	STORM DRAIN
S.P.	SERVICE PEDESTAL
SW	SIDEWALK
SIG.	SIGNAL
ST	STREET
STLT	STREETLIGHT
SS	SANITARY SEWER
STA	STATION
STD	STANDARD
S.V.	SPLICE VAULT
TEL	TELEPHONE
TYP.	TYPICAL
UDACS	UNIFORM DESIGN AND CONSTRUCTION STANDARDS
USDCCA	UNIFORM STANDARD DRAWINGS
W	WEST OR WATER
W/	WITH

BENCHMARK
CITY OF LAS VEGAS VERTICAL CONTROL POINT 'SLV09 34NE6', BEING A RIVET & PLATE IN TOP OF CURB AT NE CORNER OF DESERT FOOTHILLS & ALTA.
ELEVATION: 3304.45 (FEET)
1007.197 (METERS)
CITY OF LAS VEGAS VERTICAL CONTROL-DATE RE-OBSERVED: 2005-2007
BASED ON NORTH AMERICAN VERTICAL DATUM OF 1988 (NAVD 88).

BASIS OF BEARING
NORTH 89°45'05" EAST BEING THE SOUTH LINE OF THE SOUTHWEST QUARTER (SW 1/4) OF SECTION 35, TOWNSHIP 20 SOUTH, RANGE 59 EAST, M.D.M., AS SHOWN BY MAP ON FILE IN FILE 91, PAGE 28 OF PARCEL MAPS IN THE CLARK COUNTY RECORDER'S OFFICE, CLARK COUNTY, NEVADA.

PROJECT NO. 62023-707	DESIGN: JRT	DRAWN: TJD	CHECK: JRT	PLOT DATE: 05-26-17	PLOT TIME: 09:14:46
PROJECT NO. 62023-707	1555 S. RAINBOW BLVD. LAS VEGAS, NV 89146 T: 702.804.2000 F: 702.804.2299 gownengineering.com				
THE HOWARD HUGHES COMPANY, LLC TRAFFIC SIGNAL SYSTEM AT DESERT FOOTHILLS DR/ALTA DR LEGEND, ABBREVIATIONS, AND VICINITY MAP					
DRAWING					
L-64512 2					
2 of 7 SHTS					

FIBER OPTIC NOTES

1. CONTRACTOR SHALL CONTACT JESUS MARMOLEGO AT 702-604-7078 TWO(2) WEEKS IN ADVANCE FOR FIBRE OPTIC SPLICE DETAILS.
2. SLACK SHALL BE PROVIDED IN EACH P30 P.B. (30 FT) AND TYPE 200 S.V. (120 FT) UNLESS OTHERWISE NOTED. SEE PULLBOX SCHEDULE FOR P30 LOCATIONS.
3. PULL BOXES/VAULTS SHALL NOT BE INSTALLED IN SIDEWALK RAMPS OR DRIVEWAYS.
4. CONDUIT ROUTING IS SCHEMATIC FOR THE PURPOSE OF CLARITY AND MAY DIFFER FROM ACTUAL INSTALLATION. FINAL LOCATION SHALL BE DETERMINED IN THE FIELD BY THE ENGINEER.
5. ALL EXISTING ITS INFRASTRUCTURE SHALL BE MAINTAINED UNLESS OTHERWISE SPECIFIED OR DIRECTED BY THE ENGINEER.
6. PULL BOXES, VAULTS, AND CONDUIT SHALL BE INSTALLED WITHIN RIGHT-OF-WAY OR EASEMENTS. CONTRACTOR SHALL VERIFY PRIOR TO INSTALLATION.
7. LOCATIONS OF THE PROPOSED FIBER OPTIC SYSTEM PULL BOXES AND VAULTS SHOWN ON THE PLANS ARE APPROXIMATE. THE CONTRACTOR SHALL BE RESPONSIBLE FOR MARKING THE LOCATIONS IN THE FIELD. THESE LOCATIONS SHALL BE SUBJECT TO APPROVAL BY THE ENGINEER BEFORE INSTALLATION.
8. WHERE NEW CONDUIT CROSSES EXISTING SEWER AND WATERLINES, PROTECT SEWER AND WATERLINE IN PLACE. WHERE NEW CONDUIT IS PARALLEL TO EXISTING SEWER AND WATERLINES, MAINTAIN MINIMUM HORIZONTAL CLEARANCE OF 3 FEET. MAINTAIN MINIMUM 6" CLEARANCES AT ALL CROSSINGS.
9. WHERE NEW CONDUIT CROSSES EXISTING GAS LINES, PROTECT GAS LINES IN PLACE.
10. PROTECT IN PLACE EXISTING STORM DRAIN AND SANITARY SEWER MAINS, LATERALS AND MANHOLES AND STORM DRAIN DROP INLETS DURING CONSTRUCTION.
11. IF EXISTING SIDEWALKS AND/OR CURB AND GUTTER IS DAMAGED DURING CONSTRUCTION, CONTRACTOR SHALL REPLACE TO NEAREST EXISTING CONSTRUCTION JOINTS.

CONSTRUCTION NOTES

- 1 REMOVE EXISTING PULL BOX
- 2 INSTALL TYPE 100 VAULT (SEE DETAIL "A" ON SHEET 5)
- 3 INSTALL 72-STRAND FIBER OPTIC CABLE WITH 6PR #22 PE CABLE IN EXISTING CONDUIT FROM EXISTING TYPE 200 S.V. AT NEC OF CHARLESTON/DESERT FOOTHILLS TO EXISTING TYPE 200 S.V. AT SEC ALTA/DESERT FOOTHILLS. SEE PULL BOX SCHEDULE FOR P30 LOCATIONS
- 4 INSTALL 12-STRAND CDCA IN EXISTING CONDUIT
- 5 INSTALL SPLICE ENCLOSURE AND PERFORM FIBER OPTIC SPLICE
- 6 FURNISH TO RTC/FAST A LAYER 2 FIELD-HARDENED ETHERNET SWITCH FOR EACH CDCA (USS. SECTION 684)

PULL BOX SCHEDULE

STATION	LOCATION	REMARKS
"DF" 105+50	MEDIAN	EXISTING P30
"DF" 109+98	MEDIAN	EXISTING P30
"DF" 113+94	MEDIAN	EXISTING P30
"DF" 124+45	MEDIAN	EXISTING P30
"DF" 128+48	MEDIAN	EXISTING P30
"DF" 132+51	MEDIAN	EXISTING P30
"DF" 134+28	MEDIAN	EXISTING P30
"DF" 138+06	MEDIAN	EXISTING P30
"DF" 142+28	MEDIAN	EXISTING P30

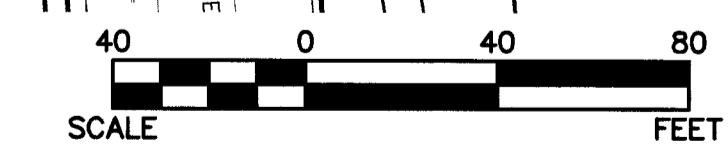
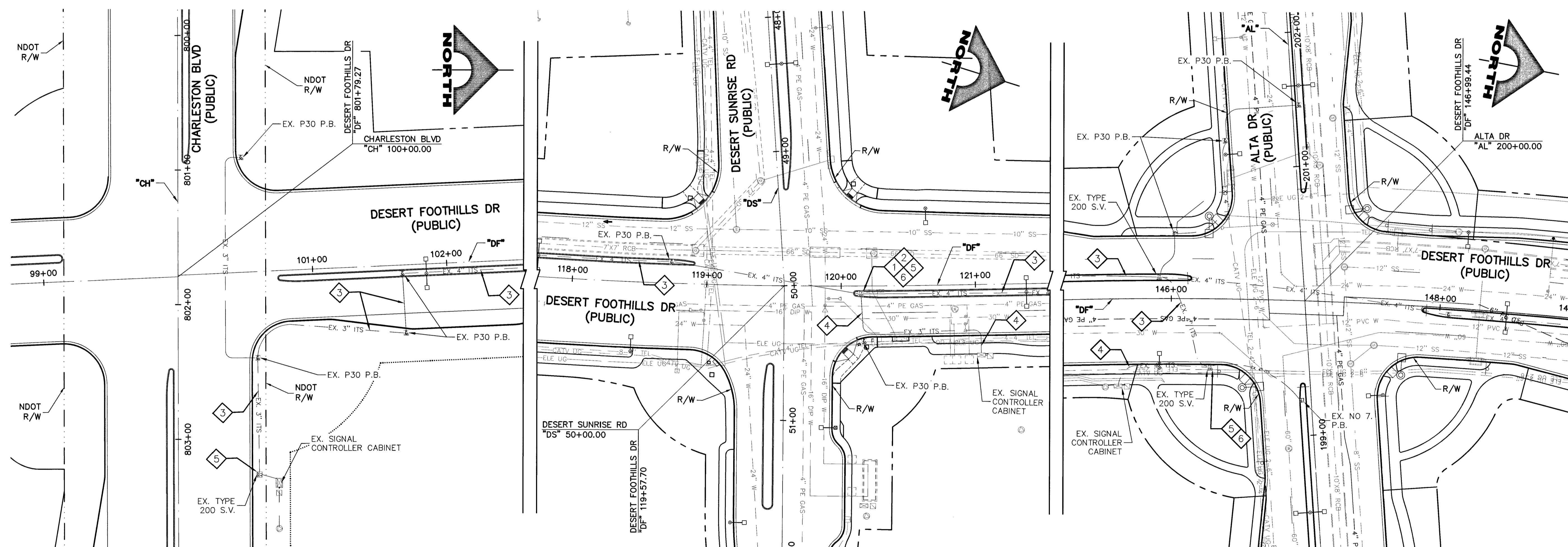

FAST
Call before you Dig
UnderGround.
1-702-432-5300
FREEMAN AND ARTERIAL SYSTEM OF TRANSPORTATION

Call before you Dig
Avoid cutting underground utility lines. IT'S COSTLY.
Call 811
1-800-227-2600

Call before you Overhead
Avoid HITTING OVERHEAD POWER LINES. IT'S COSTLY.
Call 1-702-227-2929

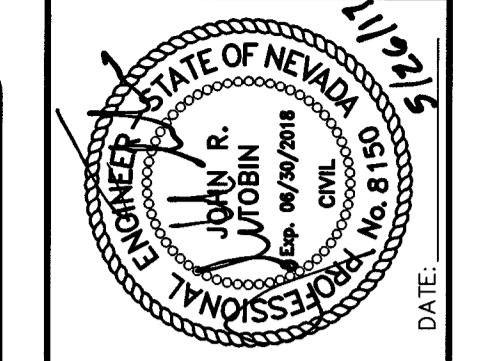

REV	DATE	DESCRIPTION	AGN APP	DATE	CSW APP

PROJECT NO. 62023-707
DESIGN: JRT
DRAWN: TJD
CHECK: JRT
PLOT DATE: 05-26-17
PLOT TIME: 09:12:12

1555 S. RAINBOW BLVD.
LAS VEGAS, NV 89146
T: 702.804.2000
F: 702.804.2299
gowingengineering.com
GOWING ENGINEERS & SURVEYORS

THE HOWARD HUGHES COMPANY, LLC
TRAFFIC SIGNAL SYSTEM AT
DESERT FOOTHILLS DR/ALTA DR
ITS IMPROVEMENTS
DRAWING
L-69512-7
7 OF 7 SHTS