

# LAKES KINGDOM HALL OF JEHOVAH'S WITNESSES

CITY OF LAS VEGAS, NEVADA  
APN NO 163-03-301-002  
7792 EL PARQUE AVENUE

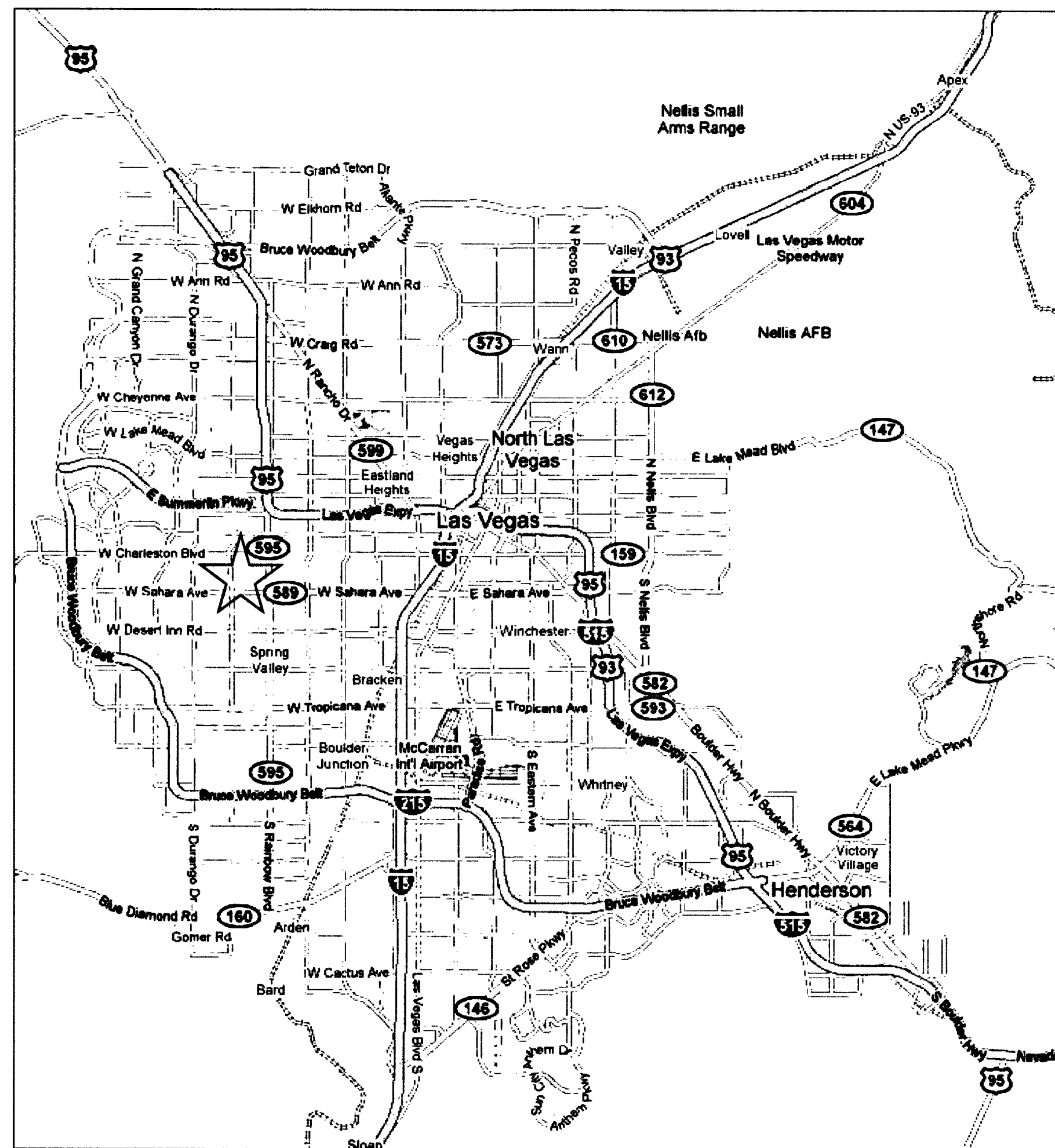

VICINITY MAP

NORTH  
The LanDesign Consultant  
NOT TO SCALE

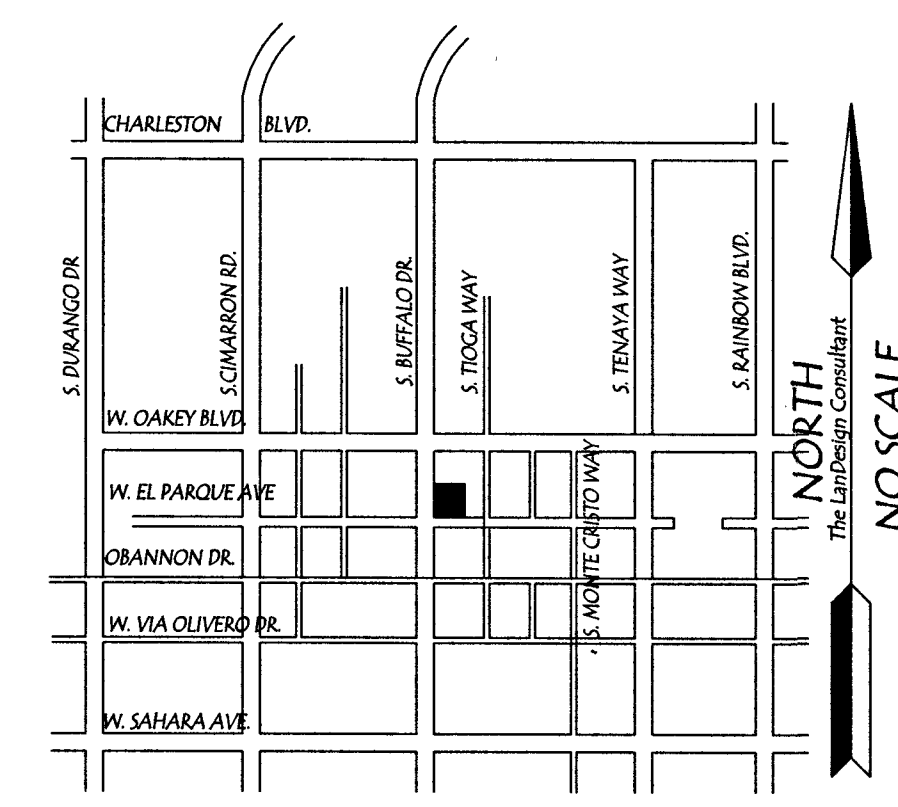

AREA MAP  
NO SCALE

**SHEET INDEX**  
SHEET 1 - COVER SHEET  
SHEET 2 - UTILITY NOTES  
SHEET 3 - UTILITY AND HORIZONTAL CONTROL  
SHEET 4 - GRADING PLAN  
SHEET 5 - DETAILS

**BENCHMARK**  
CITY OF LAS VEGAS BENCHMARK NO. 01V10-484  
PIVOT AND PLATE IN TOP OF CURB @ NW CORNER OF BUFFALO & OAKLEY  
ELEVATION = 771.95 METERS (NAVD 88) V.2008  
ELEVATION = 2531.48 US FEET (NAVD 88) V.2008  
CONVERSION:  
1 METER \* (3937/1200) = 1 US SURVEY FOOT

**BASIS OF BEARING**  
NORTH 04°03'40" WEST BEING THE BEARING OF THE WEST LINE OF GOVERNMENT LOT 84 OF SECTION 3, TOWNSHIP 21 SOUTH, RANGE 40 EAST, M.D.M. CLARK COUNTY, NEVADA, AS SHOWN ON THAT CERTAIN MAP ON FILE IN THE CLARK COUNTY RECORDERS OFFICE IN BOOK 78 OF PLATS, AT PAGE 01.

**LEGAL DESCRIPTION**  
A PORTION OF THE NORTH HALF (IN 1/2) OF THE SOUTHWEST QUARTER (QW 1/4) OF SECTION 3, TOWNSHIP 21 SOUTH, RANGE 40 EAST, NDM.

**OWNER / DEVELOPER**  
LAKES CONGREGATION JEHOVAH'S NV  
7184 APORE HILLS AVE  
LAS VEGAS NV 89115-3036

**DEVIATION FROM STANDARDS**  
1) NONE

**NOTE:**  
A PRE-DEVELOPMENT MEETING WITH DEPARTMENT OF PUBLIC WORKS DEVELOPMENT REVIEW DIVISION, OFF-SITE INSPECTOR IS REQUIRED. PLEASE CONTACT THE INSPECTOR AT 455-4610

**NOTE:**  
The LanDesign Consultant  
ASSUMES NO RESPONSIBILITY FOR EXISTING UTILITY LOCATIONS, SHOWN OR NOT SHOWN. THE UTILITIES SHOWN ON THIS DRAWING HAVE BEEN PLOTTED FROM RECORD INFORMATION AND ARE ONLY INTENDED FOR THE CONVENIENCE OF THE CONTRACTOR. THE CONTRACTOR IS RESPONSIBLE TO FIELD VERIFY THE DEPTHS AND LOCATIONS OF ANY AND ALL RELEVANT UTILITIES PRIOR TO COMMENCING WITH CONSTRUCTION. THE CONTRACTOR IS RESPONSIBLE TO NOTIFY THE ENGINEER OF RECORD, IN WRITING, OF ANY CONFLICTS OR DISCREPANCIES, IMMEDIATELY.

AVOID HITTING UNDERGROUND TRAFFIC SIGNAL SYSTEMS AND STREET LIGHT SYSTEMS CONDUITS, IT'S COSTLY	AVOID HITTING OVERHEAD POWER LINES, IT'S COSTLY	CALL BEFORE YOU DIG AVOID CUTTING UNDERGROUND UTILITIES, IT'S COSTLY
CALL BEFORE YOU UNDERGROUND 702-452-5900 LAS VEGAS COMPUTERIZED TRAFFIC SYSTEM	CALL BEFORE YOU OVERHEAD 1-702-227-2929	CALL 811 1-800-227-2600 AND CLARK COUNTY TRAFFIC OPERATIONS 1-702-455-7544

APPROVED  
BY: *Nancy Haines* DATE: 10-3-2014  
NV ENERGY  
NV ENERGY ACKNOWLEDGES THAT WE HAVE RECEIVED YOUR PLANS AND WILL PROVIDE SERVICE TO ALL ELECTRICAL NEEDS ASSOCIATED WITH THIS PROJECT. NV ENERGY RESERVES THE RIGHT TO ADDRESS ANY EXISTING OR FUTURE CONFLICTS ONCE THE FINAL DESIGN IS COMPLETED. THE NEW SERVICE AND THE RESOLUTION OF ANY CONFLICTS WILL BE ACCOMPLISHED PURSUANT TO THE NEVADA UTILITY COMMISSION'S RULES AND REGULATIONS.

APPROVED  
BY: *Roshanda Sacha* DATE: 6-3-14  
COX COMMUNICATIONS  
LAS VEGAS, INC

APPROVED  
BY: *Nancy Washington-Hawes* DATE: 10-3-14  
CENTRAL TELEPHONE COMPANY  
PRA CENTURY LINK  
THE AFFIXED CENTURY LINK APPROVAL DOES NOT ASSUME OR GUARANTEE LIABILITY FOR KNOWN OR UNKNOWN CONFLICTS WITH EXISTING OR PROPOSED IMPROVEMENTS. RESOLUTION OF ANY CONFLICT WILL BE ACCOMPLISHED PURSUANT TO LOCAL ORDINANCES, NEVADA REVISED STATUTES AND/OR PUBLIC UTILITY COMMISSION RULES AND REGULATIONS.

APPROVED  
BY: *Deak Pendergast* DATE: 4/15/14  
SOUTHWEST GAS  
PRINTED NAME: Deak Pendergast

APPROVED  
BY: *Chris Knight* DATE: 8/19/14  
CITY ENGINEER  
CITY ENGINEER - CIVIL POWER PE, REG #16736  
APPROVAL OF THESE PLANS IS LIMITED TO THOSE IMPROVEMENTS CONSTRUCTED IN THE DEDICATED RIGHT OF WAY AND/OR DEDICATED EASEMENTS. THIS APPROVAL DOES NOT AUTHORIZE THE CONSTRUCTION OF ANY IMPROVEMENTS THAT DEVIATE FROM ADOPTED STANDARDS AND/OR SPECIFICATIONS, EXCEPT THOSE SPECIFICALLY LISTED UNDER DEVIATIONS FROM STANDARD. THE ENGINEER SHALL RESOLVE ANY DEVIATION OTHER THAN THOSE LISTED IN DEVIATIONS FROM STANDARDS IN FAVOR OF THE UNIFORM STANDARD DRAWINGS AND SPECIFICATIONS CLARK COUNTY AREA NEVADA.

APPROVED  
BY: *Chris Knight* DATE: 8-12-14  
LAND USE  
CHRIS KNIGHT, DIRECTOR  
BUILDING & SAFETY DEPARTMENT CITY OF LAS VEGAS  
THIS PLAN MEETS THE APPLICABLE STANDARDS OF THE PLANNING DEPARTMENT

APPROVED  
BY: *K. Smith* DATE: 6/5/14  
LAS VEGAS FIRE & RESCUE

APPROVED FOR CONSTRUCTION  
BY: *Y. Disha* DATE: 11/11/14  
LAS VEGAS VALLEY WATER DISTRICT ENGINEERING SERVICES MANAGER  
PROJECT NO. 122540  
SHEETS: 1, 2, 3

REVISION	DATE	DESCRIPTION	APPROVED BY	DATE
1	8-19-14	REVISE NTR CONNECTION	S.B.	10/22/14
2	1-13-17	REVISE PUT WITH PUT SIGN ON SITE, REVISE BUD LAYOUT & GRADING SURROUNDING, ADDED BMP SWALES SHEET 3, 5, 15	Lm	7/13/17

## COVER SHEET

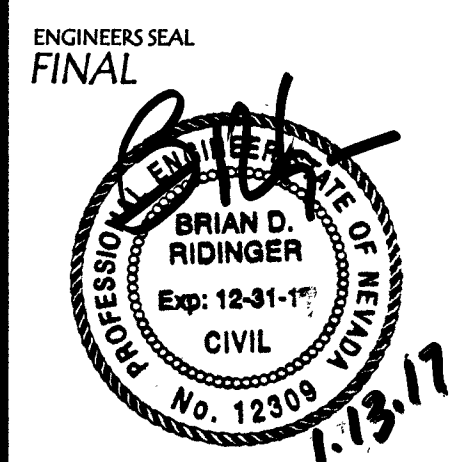

LAKES KINGDOM HALL  
OF  
JEHOVAH'S WITNESSES

SHEET 1 OF 5  
OF  
The LanDesign Consultant  
insightful solutions for land development

JOB NUMBER: KH\_104  
DATE: 11-13-17  
FILENAME: CIVIL\_CD  
XREF FILES:  
XREF FILES:

LVVWD 122540  
CLV 52215 107N 6250  
1134 Castle Point Ave  
Henderson, NV 89074  
TEL: 702-547-0047



APN 163-03-301-012  
BARTSAS MARY 13 LLC  
N88°51'34"E 20031209-01571 287.09'

APN 163-03-301-002  
LAKES CONGREGATION OF  
JEHOVAH'S WITNESSES  
FF 2530.60

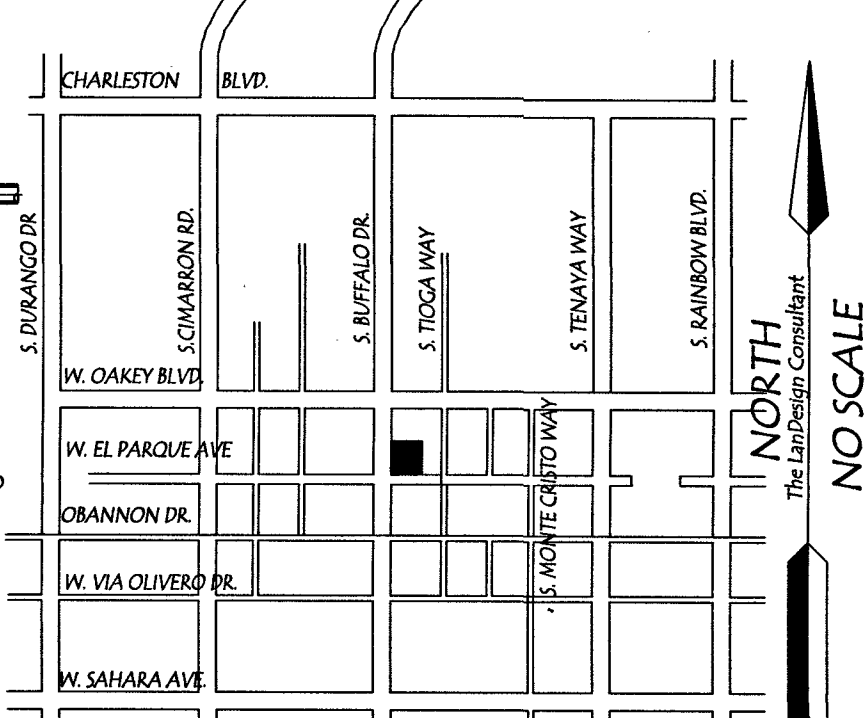
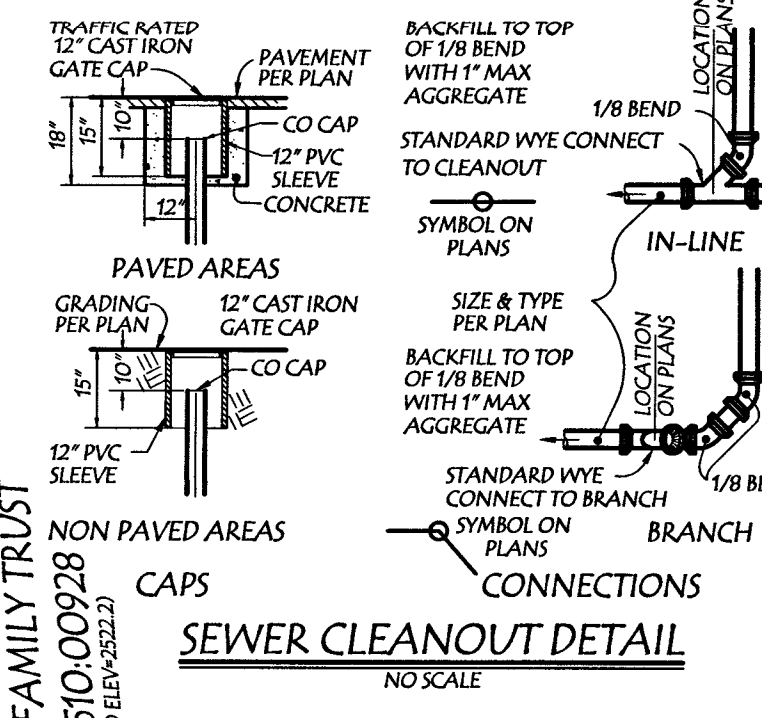
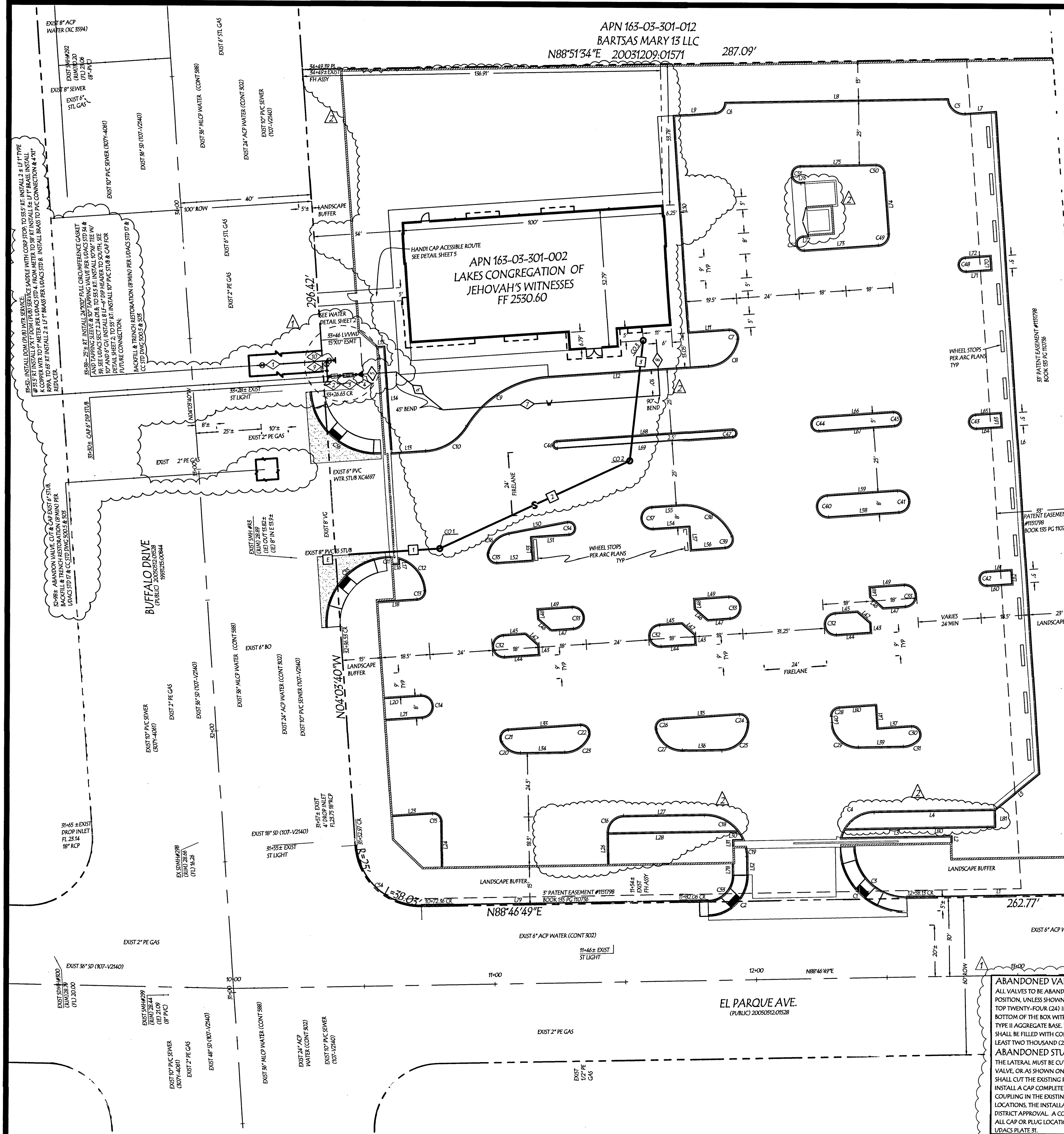

**SEWER PIPE SCHEDULE**

PIPE LABEL	MANHOLE LABEL	DIST	SIZE (IN)	PIPE MATERIAL	PIPE SLOPE (%)	LENGTH (FT)	DS IE	US IE	COMMENTS
E	R5	STUB	20.00	8.00 PVC	2.00%	18.25	15.90	14.27	PUBLIC (PUB) PRIVATE (PVT) EXIST STUB TO SITE, PVT-CONNECTED TO EXIST SMH AS CONTINUE LINE AND GRADE TO CO1-PVT
1	STUB	CO1	34.80	8.00 PVC	2.00%	34.77	14.27	14.96	PVT-CONNECT PER PLUMBING PLAN
2	CO1	CO2	80.00	6.00 PVC	9.00%	80.00	14.36	22.16	PVT-CONNECT PER PLUMBING PLAN
5	CO2	CO3	46.19	6.00 PVC	7.00%	46.19	22.16	25.59	PVT-CONNECT PER PLUMBING PLAN

**SEWER MANHOLE SCHEDULE**

SMH #	RIM ELEV	IE OUT	IE IN	DROP IN SMH	PIPE LABEL	NORTH AZIMUTH	COMMENTS
R5	28.89	15.82	15.90		E		EXIST SMH - PVT-CONNECT TO EXISTING STUB-CONTINUE LINE AND GRADE
STUB	N/A	14.27	14.27	0.00	N/A	N/A	SWR CO PER DETAIL - PVT
CO1	29.05	14.96	14.96	0.00	N/A	N/A	SWR CO PER DETAIL - PVT
CO2	29.90	22.16	22.16	0.00	N/A	N/A	SWR CO PER DETAIL - PVT
CO3	30.35	25.59		0.00	N/A	N/A	SWR CO PER DETAIL - PVT

**WATER PIPE SCHEDULE**

PIPE LABEL	PIPE LENGTH	PIPE LABEL	PIPE LENGTH	PIPE LABEL	PIPE LENGTH
10" PVC MAIN, PUB	1' 8.85	DOM. PUB	4' 2.15	4" PVC DOM. PVT	21' 1.00
10" 5.5 LF	4	2 LF			
6" DIP MAIN, PUB	4' 2.15	4" PVC DOM. PVT			
9" COPPER, DOM. PUB	5	15' LF			
2	2' 1.15	7	14.85		

**FIRE FLOW DATA CALCULATIONS**

BUILDING HEIGHT: 18'-6" FT

NUMBER OF STORIES: 1 FLOOR(S)

TYPE OF CONSTRUCTION: A-3

LARGEST BUILDING AREA: 4,972 SQ FT

LARGEST AREA BETWEEN 4-HR AREA SEPARATION WALLS: N/A FT

HIGH PILED STORAGE: NO

FULL AUTOMATIC FIRE SPRINKLER SYSTEM: NO

MINIMUM FIRE FLOW REQUIRED: 2,000 GPM

AT 20 PSI RESIDUAL

CALCULATIONS:  
FIRE FLOW REQUIREMENT, BASED ON UFC APPENDIX A-III-A-1: 2,000 GPM  
REDUCTION FOR FIRE SPRINKLERS: 0 - 0 GPM  
CALC: 2,000 - 0 = 2,000

AVOID HITTING UNDERGROUND TRAFFIC SIGNAL SYSTEMS & STREET LIGHT SYSTEMS CONDUITS. IT'S COSTLY. CALL BEFORE YOU DIG UNDERGROUND.

AVOID HITTING OVERHEAD POWER LINES, IT'S COSTLY. CALL BEFORE YOU OVERHEAD.

AVOID CUTTING UNDERGROUND UTILITIES, IT'S COSTLY. CALL BEFORE YOU DIG.

1-702-482-5900  
FRESHWAY & ARTERIAL SYSTEMS OF TRANSPORTATION

1-702-227-2929

CALL 811 OR 1-800-227-2600

**NOTE:**  
The LanDesign Consultant ASSUMES NO RESPONSIBILITY FOR EXISTING UTILITY LOCATIONS, SHOWN OR NOT SHOWN. THE UTILITIES SHOWN ON THIS DRAWING HAVE BEEN PLOTTED FROM RECORD INFORMATION AND ARE ONLY INTENDED FOR THE CONVENIENCE OF THE CONTRACTOR. THE CONTRACTOR IS RESPONSIBLE TO FIELD VERIFY THE DEPTHS AND LOCATIONS OF ANY AND ALL RELEVANT UTILITIES PRIOR TO COMMENCING WITH CONSTRUCTION. THE CONTRACTOR IS RESPONSIBLE TO NOTIFY THE ENGINEER OF RECORD, IN WRITING, OF ANY CONFLICTS OR DISCREPANCIES, IMMEDIATELY.

**NOTE:**  
THE DISTRICT CANNOT GUARANTEE A WATERTIGHT SHUTDOWN WHERE CONNECTIONS OR REPAIRS TO EXISTING FACILITIES ARE REQUIRED. THE CONTRACTOR SHALL ENSURE ALL LABOR AND EQUIPMENT IS AVAILABLE TO REMOVE FLUCTUATING WATER THAT MAY IMPROPERLY OCCUR AT ALL TIMES. COORDINATION WITH INSPECTION DIVISION MUST TAKE PLACE PRIOR TO ANY TRAIL SHUTDOWN. CONTRACTOR TO INSTALL TEMPORARY SERVICE TO ENSURE PROPER SHUTDOWN IN THE EVENT NO OTHER APPEARANCES ARE AVAILABLE.

**SVZ NOTE:**  
NO WALLS, FENCES, TREES, SHRUBS, UTILITY APPURTENANCES OR ANY OTHER OBJECT, OTHER THAN TRAFFIC CONTROL DEVICES AND STREET LIGHT POLES, MAY BE CONSTRUCTED OR INSTALLED WITHIN THE SIGHT VISIBILITY ZONE UNLESS SAID OBJECT IS MAINTAINED AT LESS THAN 24 INCHES IN HEIGHT, MEASURED FROM THE TOP OF THE ADJACENT PROPOSED CURB.

**WASTEWATER FLOW CALCULATIONS**  
FACILITY TYPE: CHURCH  
TOTAL UNITS: 1  
AVERAGE FLOW IN MGD: 0.0007  
PEAK FLOW IN MGD: 0.0024  
EST FLOW RATE: 0.25 ERU/S  
NO OF FIXTURES: 11  
AVERAGE FLOW: 11 \* 0.25 ERU/S \* 0.00280 MGD \* 0.0007 MGD  
PEAK FACTOR FROM TABLE C, PAGE T-3, DPCWCS: 53 GENERAL CURVE  
PEAK FLOW: AVERAGE FLOW \* 53 = 0.0024 MGD

**REDUCED PRESSURE PRINCIPLE ASSEMBLY**  
1 - 1" APPROVED REDUCED PRESSURE PRINCIPLE ASSEMBLY(S) SHALL BE INSTALLED PER THE UDAC'S PLATE NO 8. NO WATER SHALL BE TAKEN FROM A SERVICE REQUIRING BACKFLOW PREVENTION UNTIL THE REDUCED PRESSURE PRINCIPLE ASSEMBLY HAS BEEN SUCCESSFULLY TESTED BY THE DISTRICT. ANY BLOCK WALL OR OTHER FENCE MATERIAL SHALL BE DESIGNED AND CONSTRUCTED AROUND THE OUTSIDE OF THE EASEMENTS TO ALLOW THE DISTRICT DIRECT ACCESS FROM THE ADJACENT RIGHT-OF-WAY.

**EASEMENT WITH TREES, SHRUBS, DECORATIVE ROCKS, BLOCK WALL, OR FENCE**  
TREES, SHRUBS, OR DECORATIVE ROCKS, AND ANY BLOCK WALL OR OTHER FENCE MATERIAL, SHALL BE DESIGNED AND CONSTRUCTED AROUND THE EASEMENTS TO ALLOW THE DISTRICT DIRECT ACCESS TO THE VALUETS, BACKFLOW ASSEMBLIES, AND PIPING FROM THE ADJACENT RIGHT-OF-WAY.

**CONSTRUCTION NOTE:**  
ALL EXISTING UTILITY STRUCTURES WITHIN CONSTRUCTION AREA SHALL BE ADJUSTED TO MATCH FINISH GRADE. (IE. WAX, BOX, W/MH, ANNODE BOX, FH, TEL BOX, ETC)

**NOTE:**  
ALL DIMENSIONS TO UTILITIES ARE TO CENTERLINE OF PIPE UNLESS INDICATED OTHERWISE. CONTRACTOR SHALL VERIFY HORIZONTAL AND VERTICAL ALIGNMENT OF EXISTING UTILITIES AND NOTIFY THE ENGINEER OF WORK IMMEDIATELY OF ANY DISCREPANCIES PRIOR TO CONSTRUCTION.

**APPROVED**  
BRIAN D. RIDINGER  
Exp. 12-31-17  
CIVIL  
No. 12309

DATE: 5/23/17

**HORIZONTAL CONTROL AND UTILITY PLAN**

ENGINEERS SEAL  
FINAL

LAKES KINGDOM HALL OF JEHOVAH'S WITNESSES

SHEET 3 OF 5

The LanDesign Consultant

insightful solutions for land development

1154 Castle Point Ave  
Henderson, NV 89074  
TEL: 702-347-0047

JOB NUMBER: 104\_KH  
DATE: JAN 15, 2017 R2  
FILENAME: CIVIL\_CD  
XREF FILES: CIVIL\_SITE  
XREF FILES:

LVWD 122540  
#52215 1076250

**LEGEND**

DESCRIPTION	1" CURB	6" 2" CURB	WALL RESTAINING	WALL PRESUMED	FENCE	VALLEY CUTTER	P/MT EDGE SARK/VT	CONDUIT	3" LIFE CONDUIT	ST LIGHT	TRAFFIC SIGN	CONTOUR	ELEV TAG	SLOPE TAG	SLOPE	SWALE	FH/VALVE/RECYCLER	SWR/INT/ROD	VALVE / PP	METER RPPA/DC/AR/PPA	ABBREVIATIONS	CLEANOUT	ELEC P/MT EDGE	FIRE DEPT CONNECT	GR GRADE BREAK	NG NATURAL GRADE	NATURAL GRADE	PP PROPERTY LINE	R/W RIGHT OF WAY	S/Z SIGHT VISIBILITY ZONE
BOUNDARY	PROPOSED	EXISTING																			AC ASPHALT	CO CONC	ELEC P/MT EDGE	FG FINISH GRADE	IE INVERT ELEV	NG NATURAL GRADE	PP PROPERTY LINE	R/W RIGHT OF WAY	S/Z SIGHT VISIBILITY ZONE	
LIGHT OF WAY																					CAV CABLE TV	DI DOM	EMT EXIST	FG FINISH GRADE	IE INVERT ELEV	NG NATURAL GRADE	PP PROPERTY LINE	R/W RIGHT OF WAY	S/Z SIGHT VISIBILITY ZONE	
CENTERLINE																					CR CURB RETURN	DWY DRIVEWAY	EMT EXIST	FG FINISH GRADE	IE INVERT ELEV	NG NATURAL GRADE	PP PROPERTY LINE	R/W RIGHT OF WAY	S/Z SIGHT VISIBILITY ZONE	
LOTLINE																						FF FINISH FLOOR	FG FINISH GRADE	IE INVERT ELEV	NG NATURAL GRADE	PP PROPERTY LINE	R/W RIGHT OF WAY	S/Z SIGHT VISIBILITY ZONE		



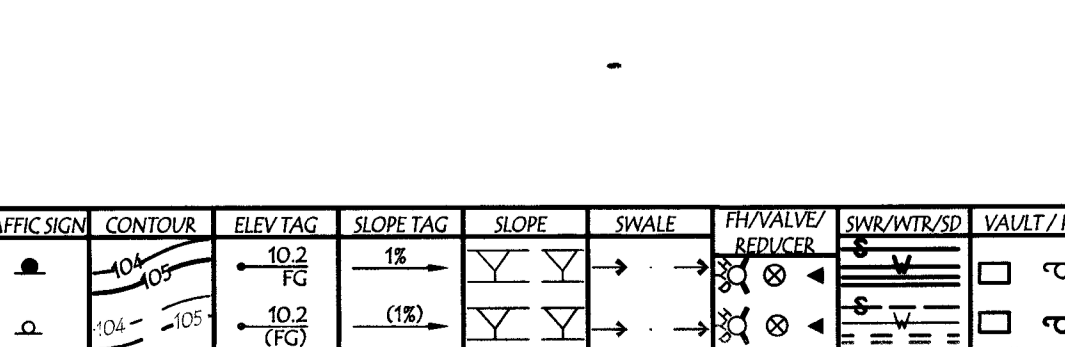
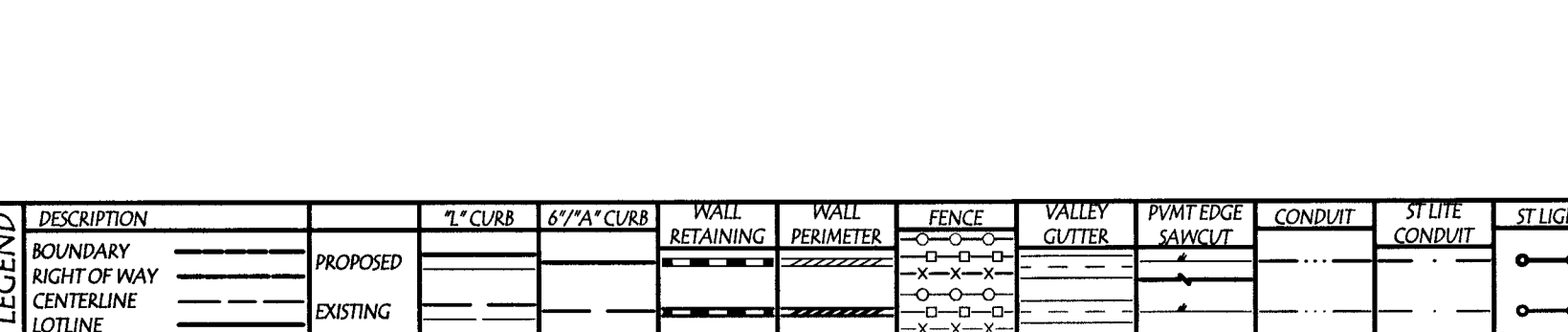
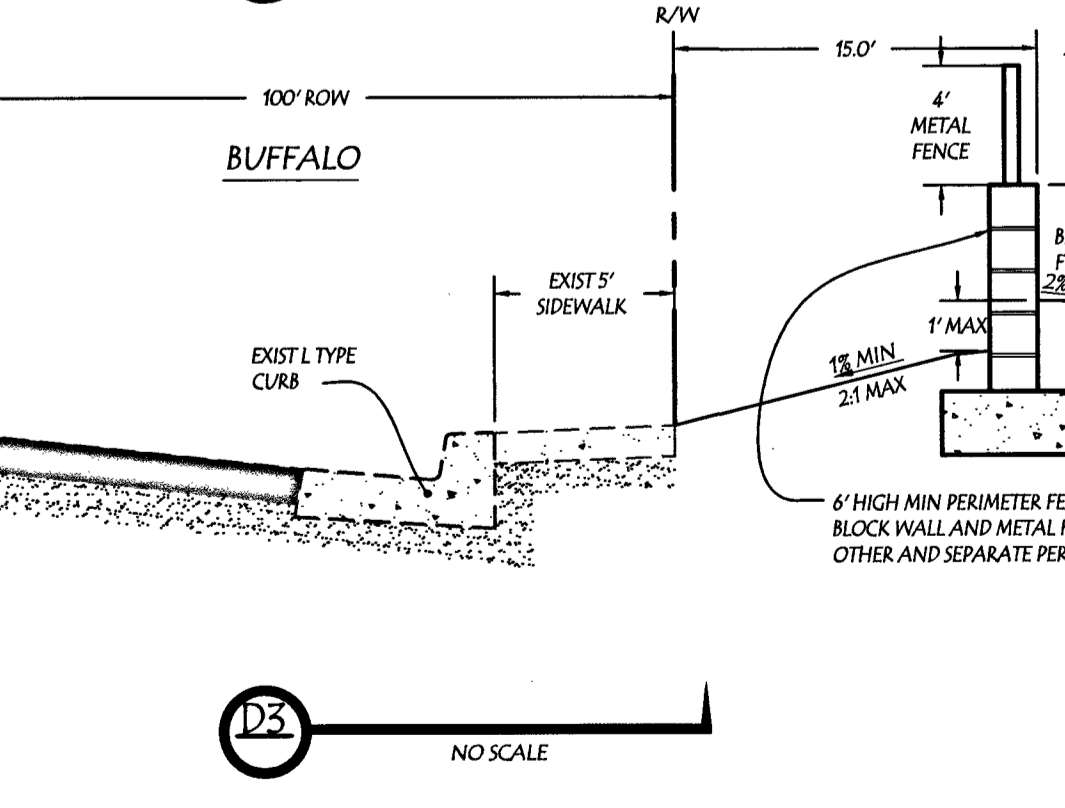
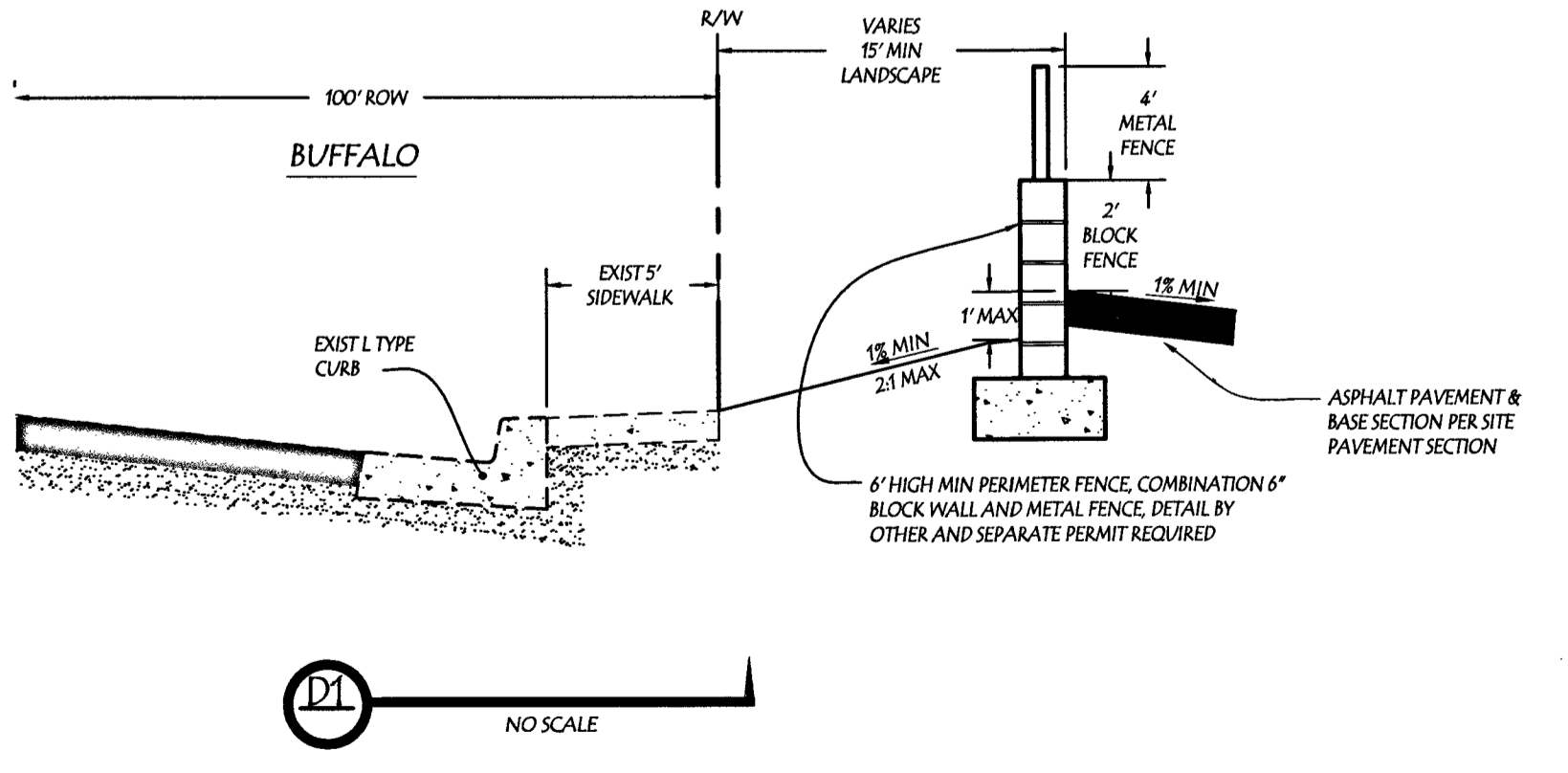
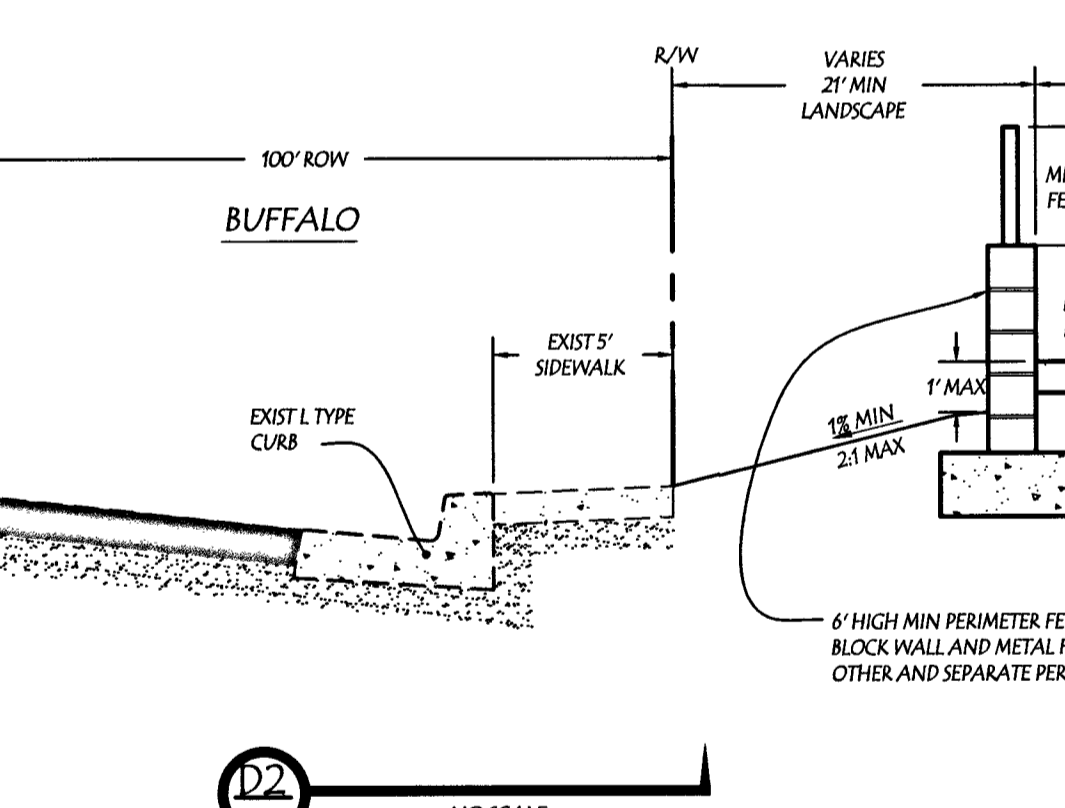
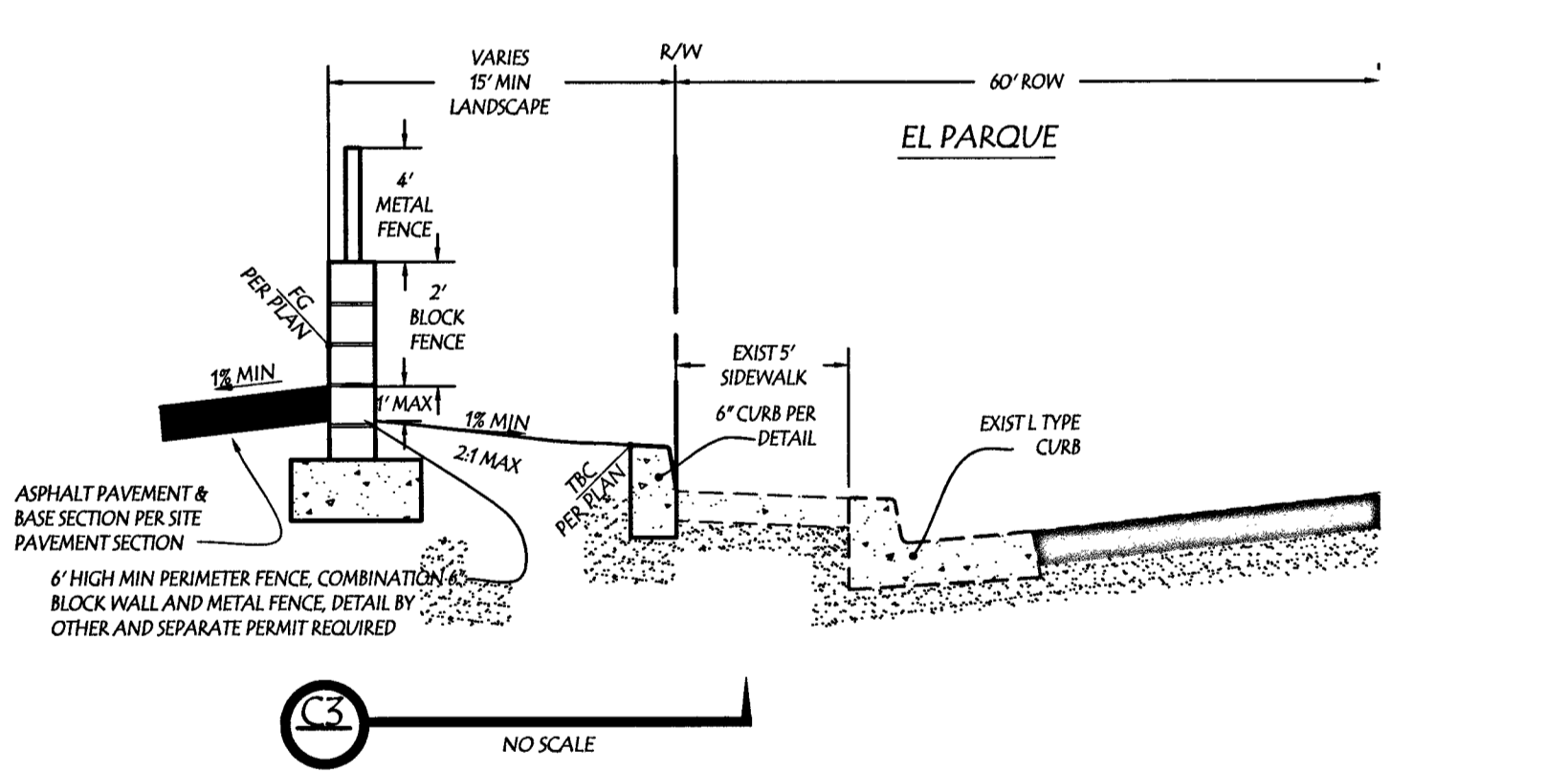
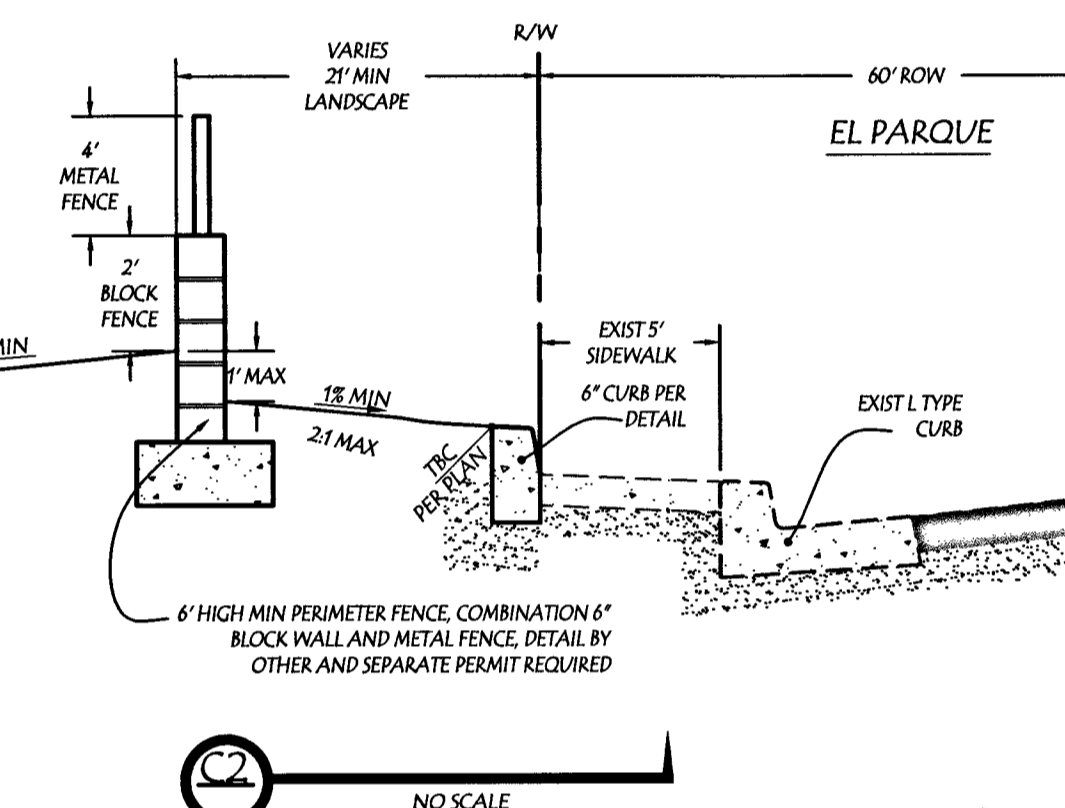
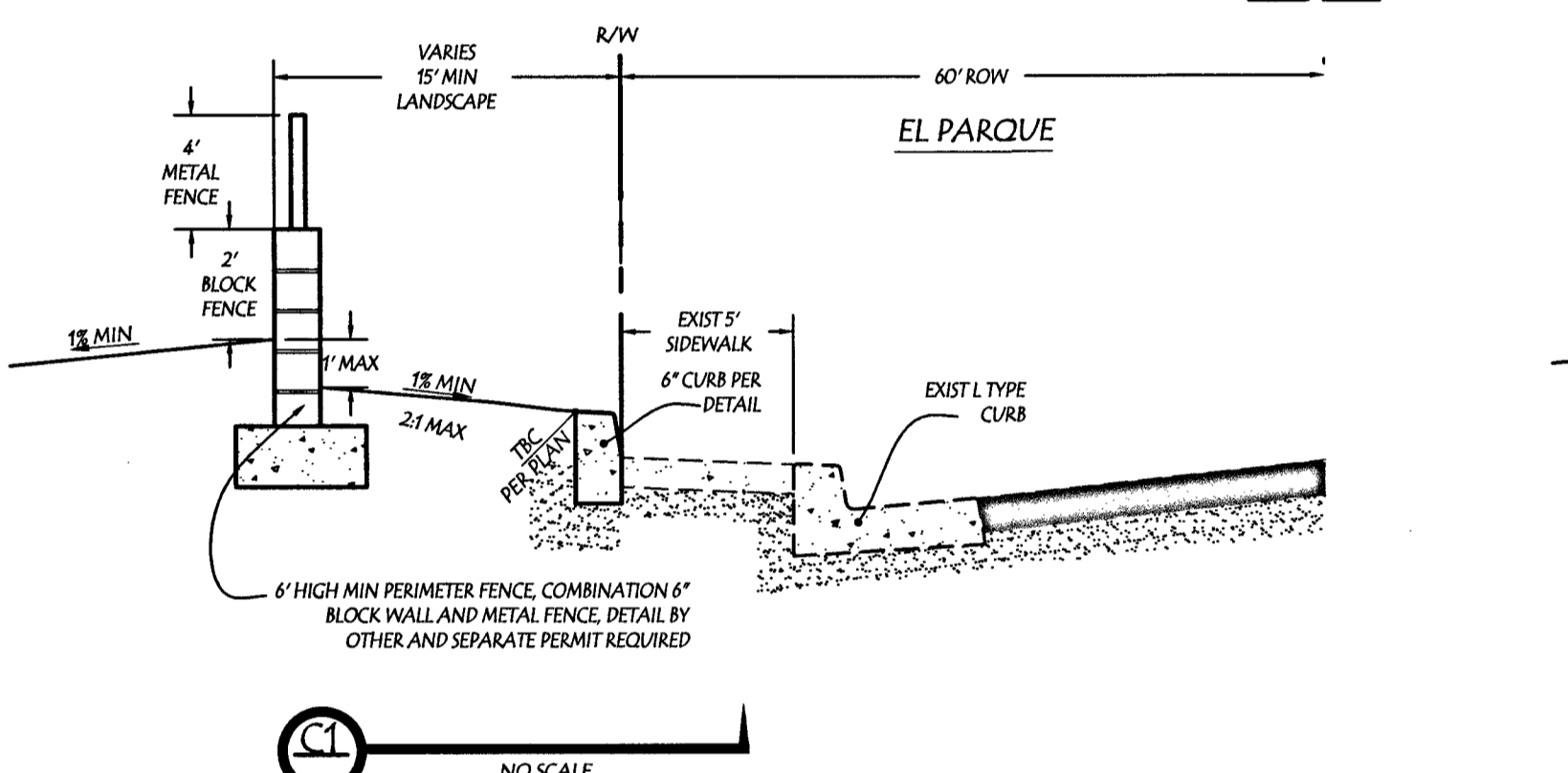
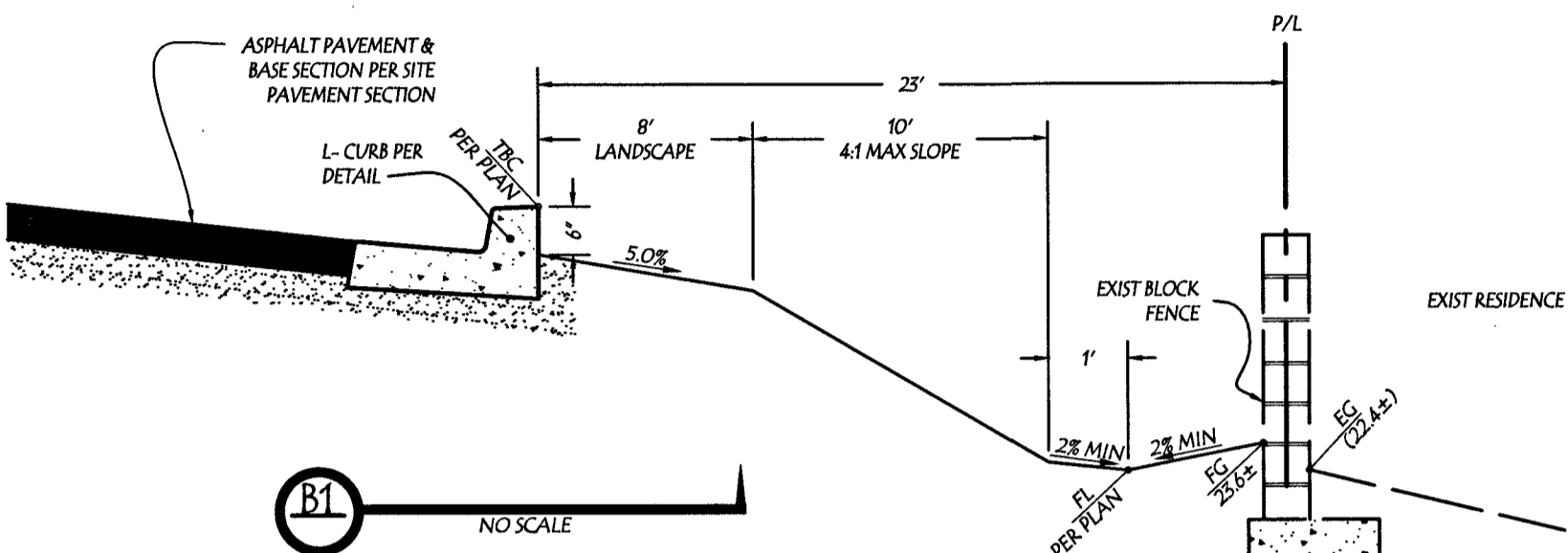
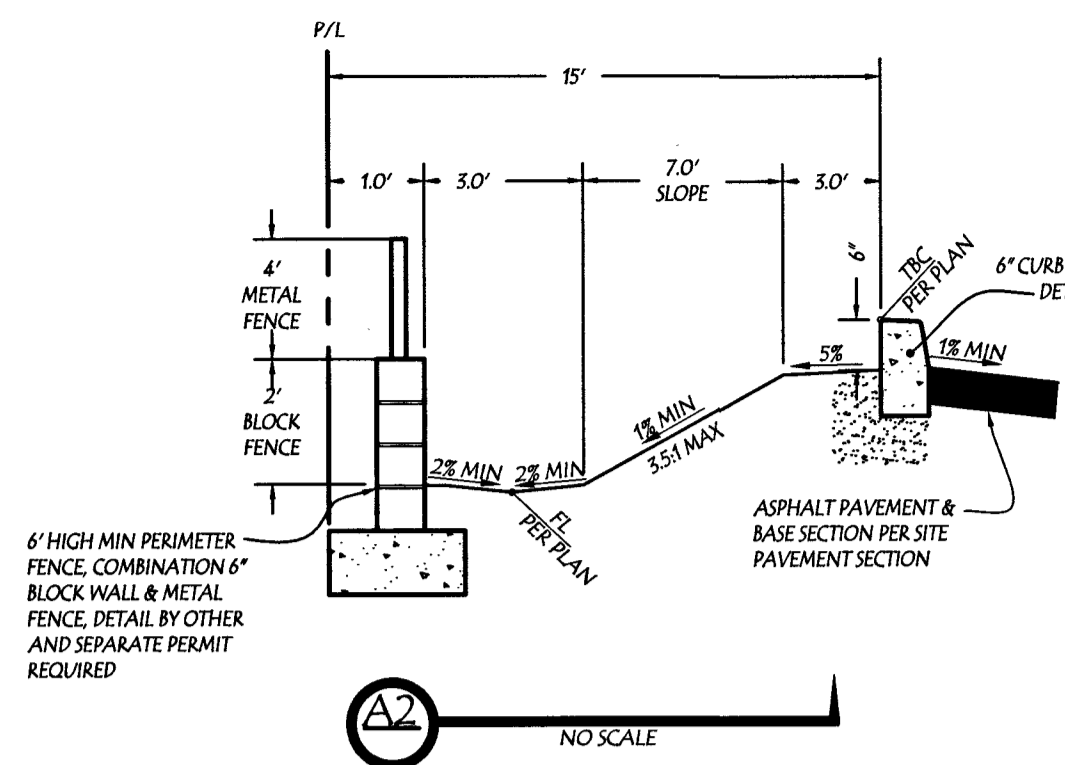
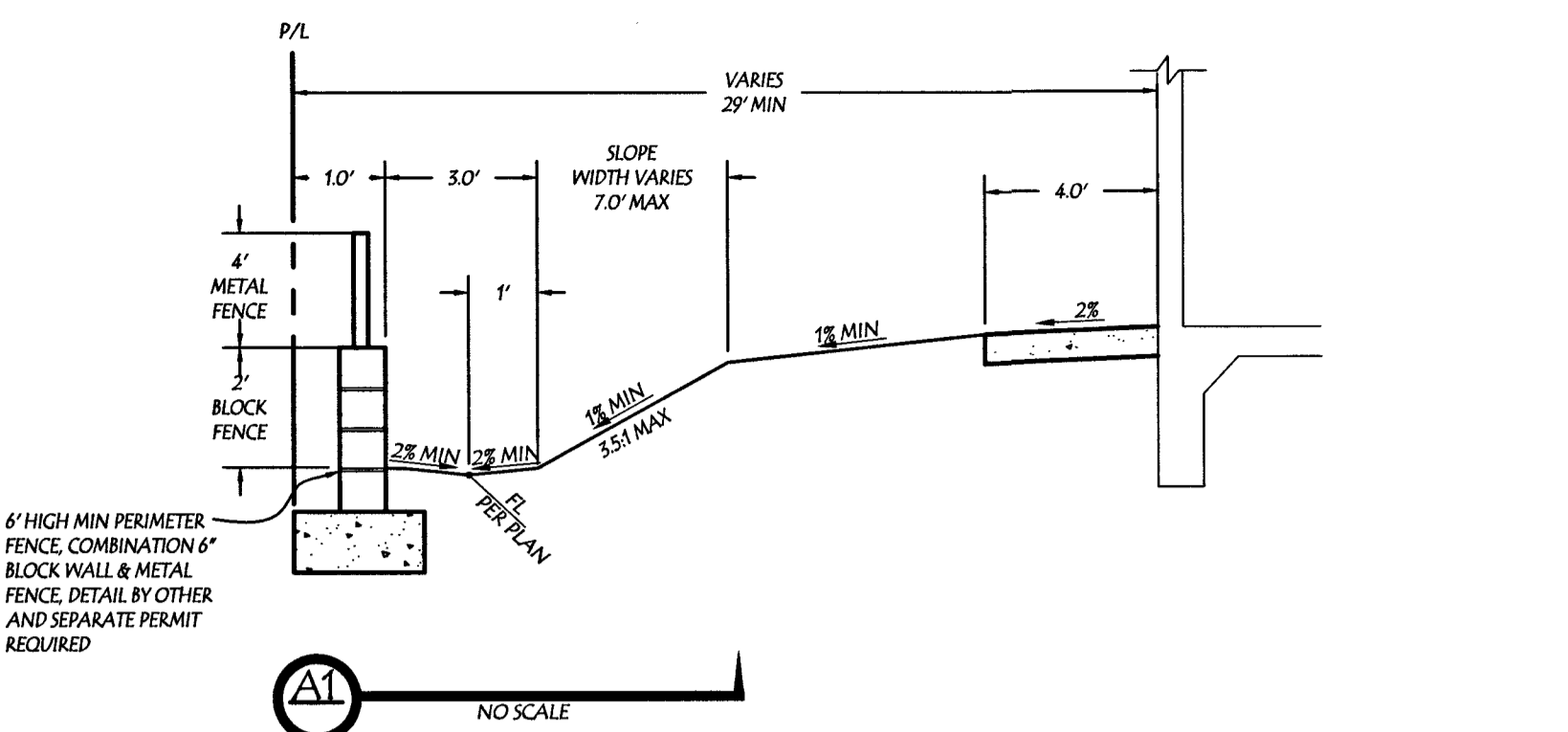

**STORMWATER MANAGEMENT NOTES**

1. THE OWNER, SITE DEVELOPER, CONTRACTOR AND/OR THEIR AUTHORIZED AGENTS SHALL EACH DAY REMOVE ALL SEDIMENT, MUD, CONSTRUCTION DEBRIS OR OTHER POTENTIAL POLLUTANTS THAT MAY HAVE BEEN DISCHARGED TO, OR ACCUMULATED IN, THE PUBLIC RIGHTS OF WAY OF THE CITY OF LAS VEGAS AS A RESULT OF CONSTRUCTION ACTIVITIES ASSOCIATED WITH THIS SITE DEVELOPMENT OR CONSTRUCTION PROJECT. SUCH MATERIALS SHALL BE PREVENTED FROM ENTERING THE STORM SEWER SYSTEM.
2. ADDITIONAL CONSTRUCTION SITE DISCHARGE BEST MANAGEMENT PRACTICES MAY BE REQUIRED OF THE OWNER AND HIS OR HER AGENTS DUE TO UNFORESEEN EROSION PROBLEMS OR IF THE SUBMITTED PLAN DOES NOT MEET THE PERFORMANCE STANDARDS SPECIFIED IN THE CLARK COUNTY BUILDING ADMINISTRATIVE CODE 24.40 AND THE LAS VEGAS VALLEY CONSTRUCTION SITE BMP GUIDANCE MANUAL.
3. TEMPORARY OR PERMANENT STABILIZATION PRACTICES WILL BE INSTALLED ON DISTURBED AREAS AS SOON AS PRACTICABLE AND NO LATER THAN 14 DAYS AFTER THE CONSTRUCTION ACTIVITY IN THAT PORTION OF THE SITE HAS TEMPORARILY OR PERMANENTLY CEASED. SOME EXCEPTIONS MAY APPLY; REFER TO THE NEVADA STORMWATER GENERAL PERMIT FOR CONSTRUCTION ACTIVITY NVR 100000, SECTION III.A.5.
4. AT A MINIMUM, THE CONTRACTOR OR HIS AGENT SHALL INSPECT ALL DISTURBED AREAS, AREAS USED FOR STORAGE OF MATERIALS AND EQUIPMENT THAT ARE EXPOSED TO PRECIPITATION, VEHICLE ENTRANCE AND EXIT LOCATIONS, AND ALL BMPs WEEKLY, AND WITHIN 24 HOURS AFTER ANY RAIN EVENT OF 0.5 INCHES OR MORE. THE CONTRACTOR OR HIS AGENT SHALL UPDATE OR MODIFY THE STORMWATER POLLUTION PREVENTION PLAN AS NECESSARY. SOME EXCEPTIONS TO WEEKLY INSPECTION MAY APPLY, SUCH AS SUSPENSION OF LAND DISTURBANCE ACTIVITIES. REFER TO THE NEVADA STORMWATER GENERAL PERMIT FOR CONSTRUCTION ACTIVITY NVR 100000, SECTION III.A.12.
5. ACCUMULATED SEDIMENT IN BMPs SHALL BE REMOVED WITHIN SEVEN DAYS AFTER A STORMWATER RUNOFF EVENT OR PRIOR TO THE NEXT ANTICIPATED STORM EVENT, WHICHEVER IS EARLIER. SEDIMENT MUST BE REMOVED WHEN BMP DESIGN CAPACITY HAS BEEN REDUCED BY 90 PERCENT OR MORE.

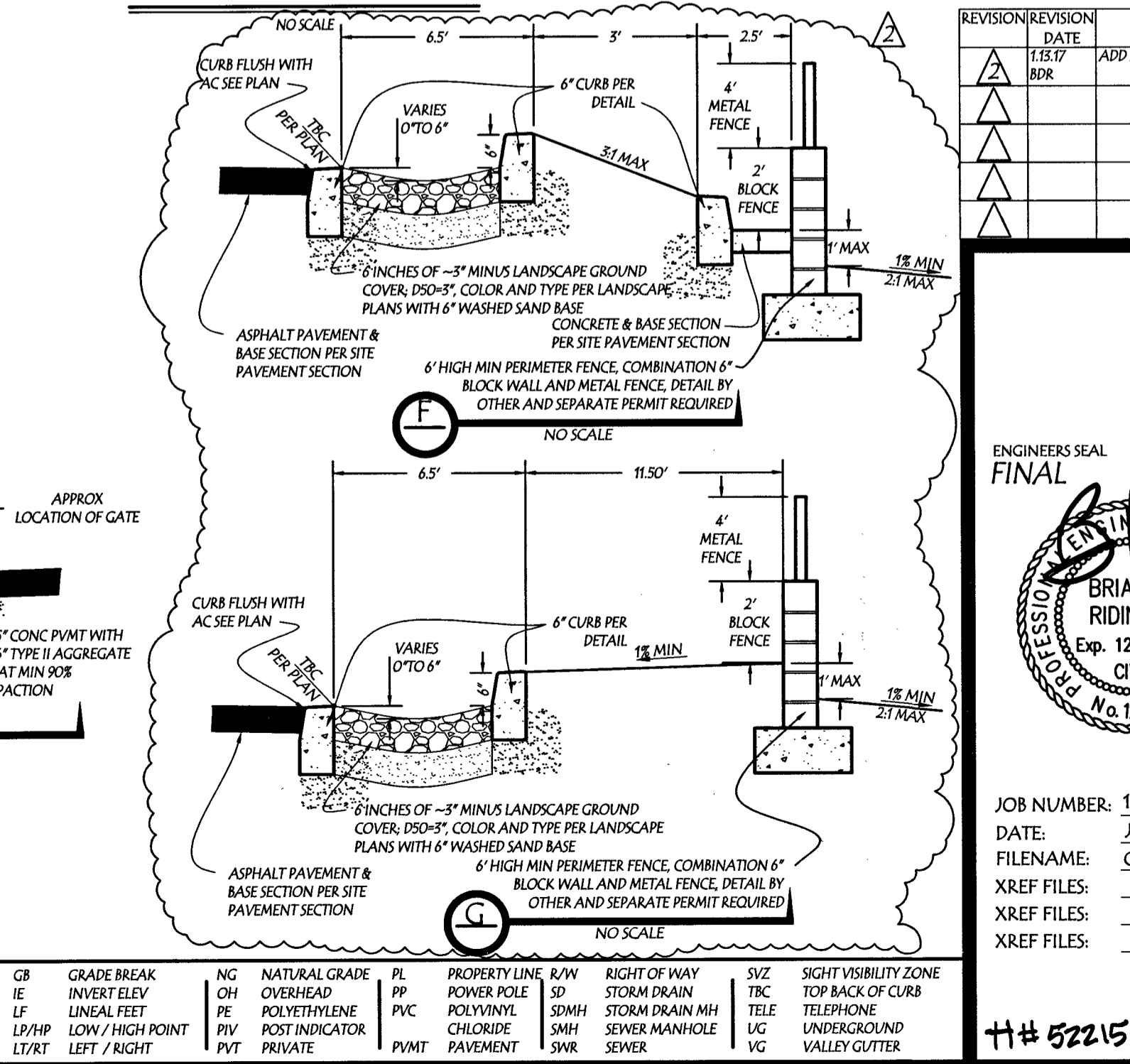
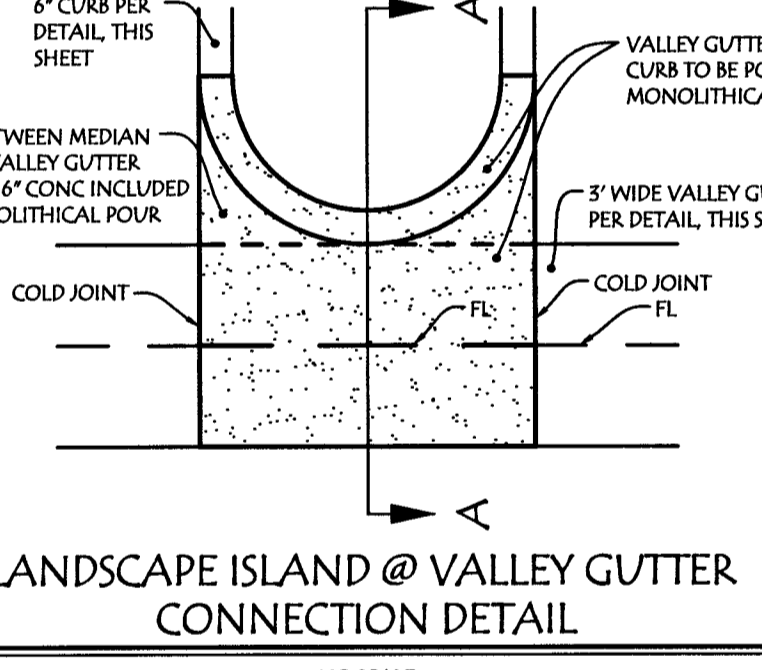
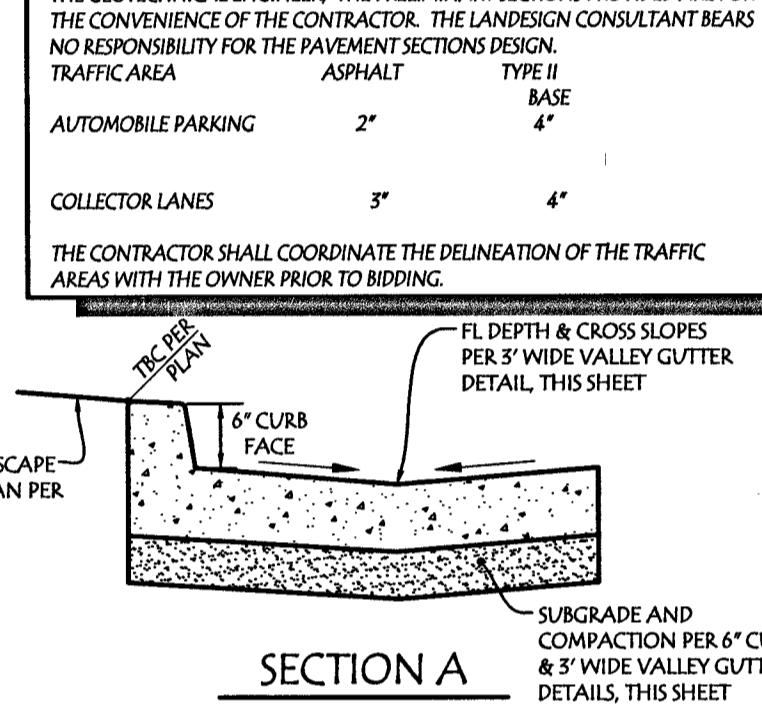
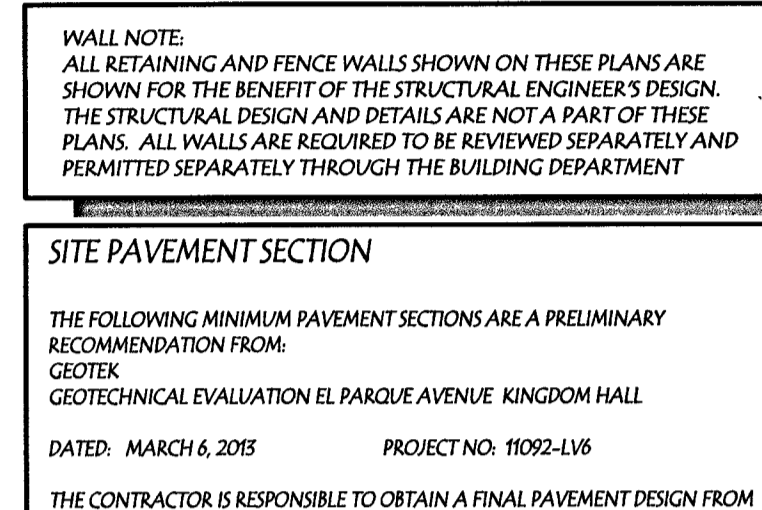
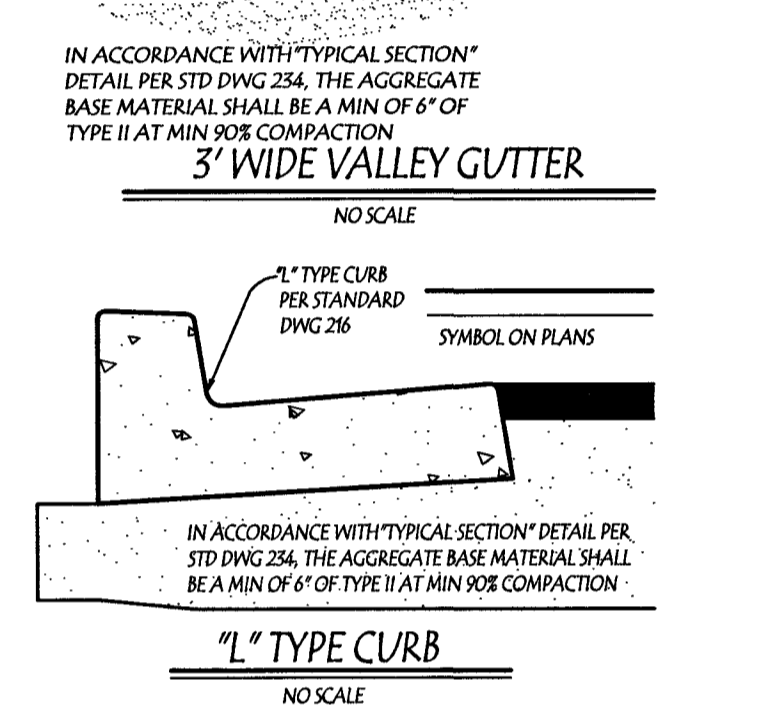
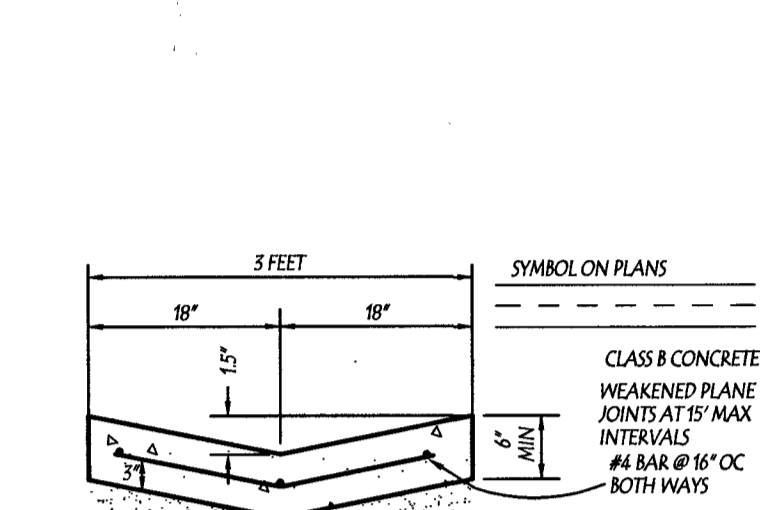
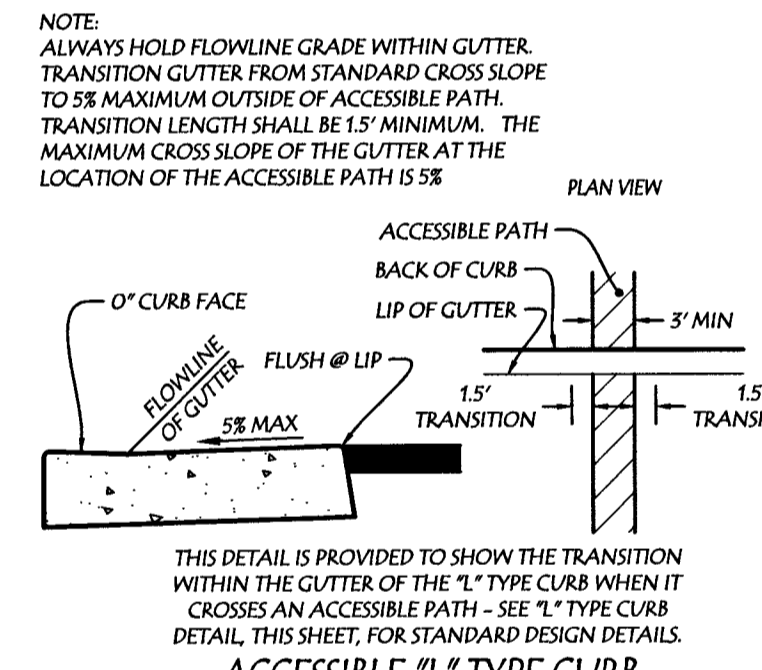
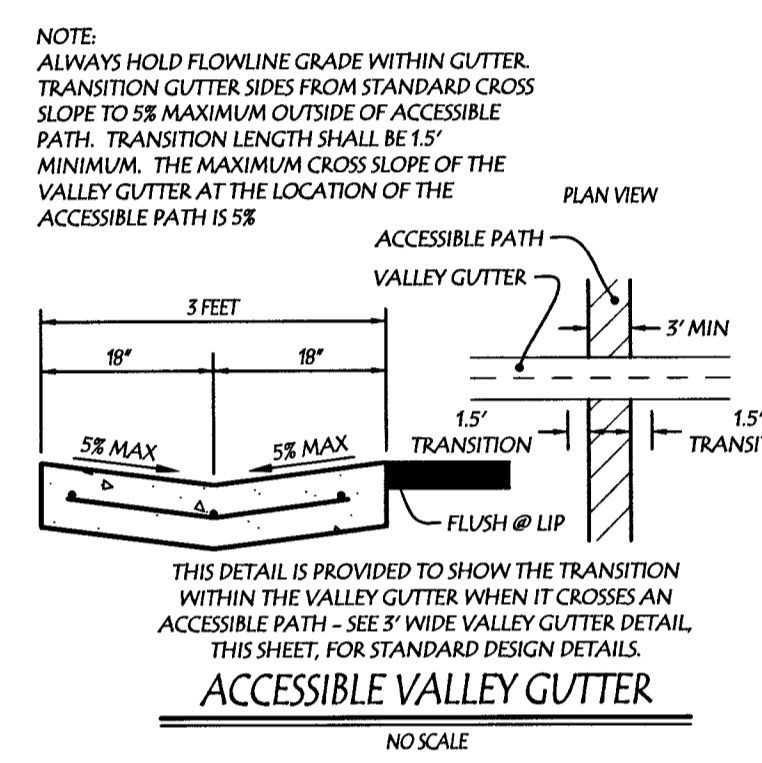
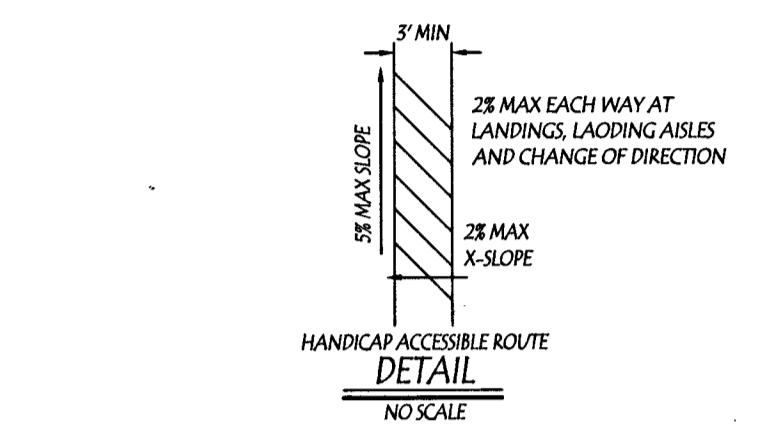

REVISION	DATE	DESCRIPTION	APPROVED
1	1/15/17	ADD SECTION DETAILS F & G	JRM 7/13/15

**DETAILS**

**LAKES KINGDOM HALL OF JEHOVAH'S WITNESSES**

**SHEET 5 OF 5**

**The LanDesign Consultant**

154 Castle Point Ave Henderson, NV 89074 TEL: 702-547-0047

ENGINEERS SEAL FINAL

**BRIAN D. RIDINGER**  
Exp. 12-31-17  
CIVIL  
No. 12309

JAN 13, 2017 R2

FILENAME: CIVIL\_CD

JOB NUMBER: 104\_KH

DATE: JAN 13, 2017 R2

FILENAME: CIVIL\_CD

XREF FILES:

XREF FILES:

# 52215 107V6250

LEGEND	DESCRIPTION	SYMBOL
BOUNDARY	PROPOSED	---
BOUNDARY	EXISTING	---
RIGHT OF WAY	PROPOSED	---
RIGHT OF WAY	EXISTING	---
CENTERLINE	PROPOSED	---
CENTERLINE	EXISTING	---
LOTLINE	PROPOSED	---
LOTLINE	EXISTING	---
1" CURB	---	---
6\"/>		