

SANITARY SEWER FINAL LOCATION MAP FOR LONE MOUNTAIN 2 SENIOR APARTMENTS

BEING LOT 4 OF PARCEL MAP FILE 35 PAGE 37

SITUATED IN THE NORTH HALF (N 1/2) OF THE NORTHWEST QUARTER (NW 1/4) OF SECTION 2, TOWNSHIP 20 SOUTH, RANGE 60 EAST M.D.M., CITY OF LAS VEGAS, CLARK COUNTY, NEVADA

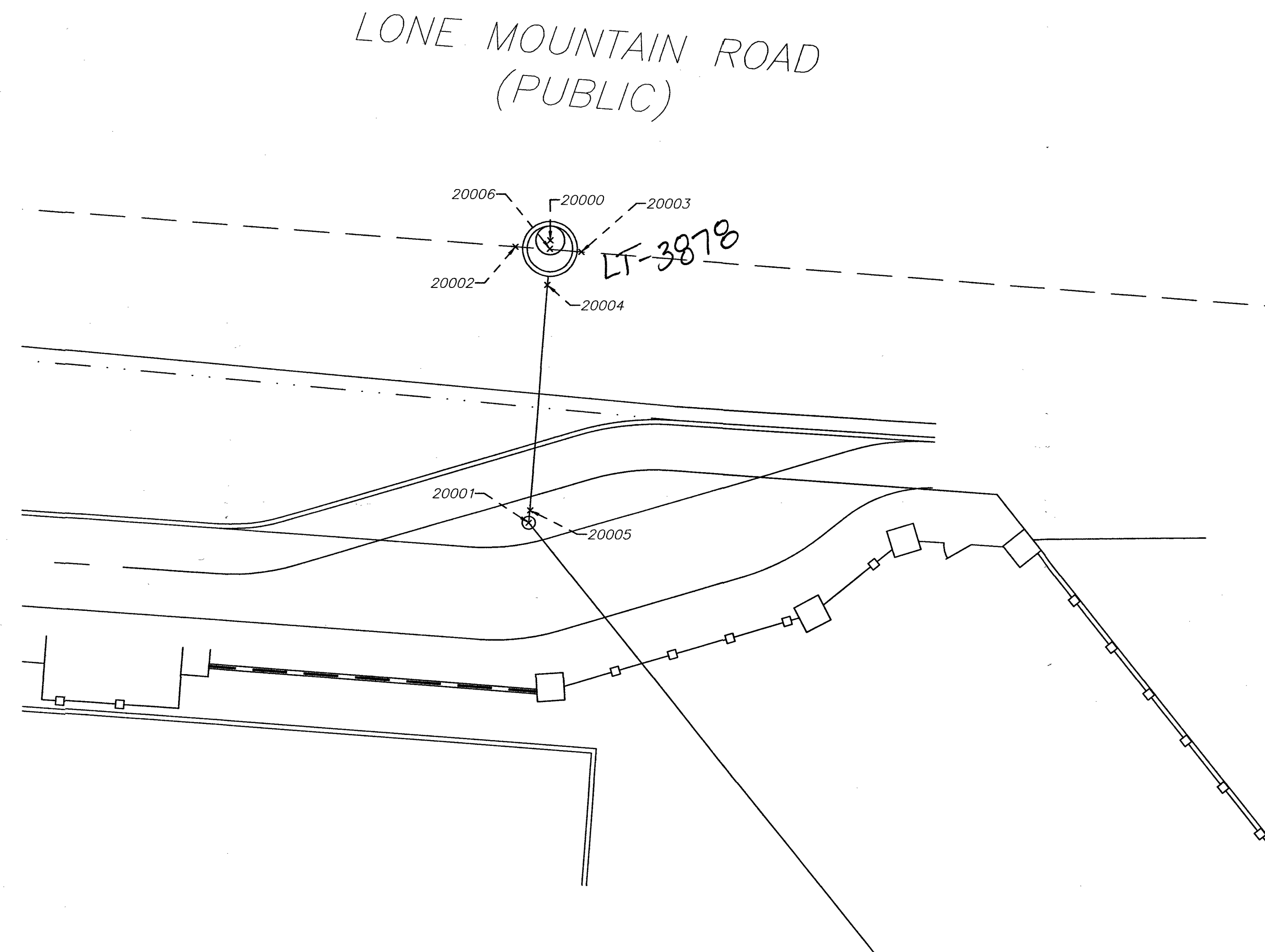

SURVEYOR'S STATEMENT

- 1) SURVEY WAS COMPLETED ON APRIL 19, 2017.
- 2) THE POSITIONAL CERTAINTY FOR THIS SURVEY IS 0.3' HORIZONTAL AND 0.3' VERTICAL BASED ON NAD83(2011), EPOCH 2010.00
- 3) THE POSITIONAL CERTAINTY STATED DOES NOT TAKE INTO ACCOUNT ANY MODIFICATIONS TO THE PIPE, MANHOLES OR LATERALS COMPLETED AFTER THE DATE OF SURVEY.

LANCE M. WEST
PROFESSIONAL LAND SURVEYOR
NEVADA LICENSE NO. 18232

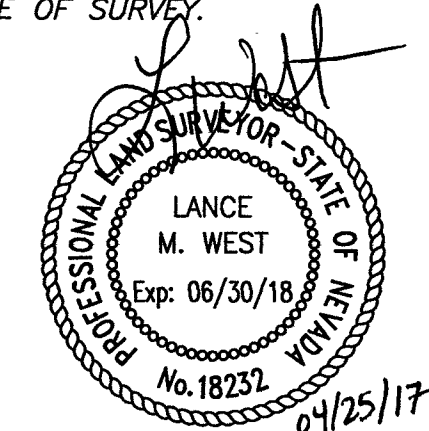

BASIS OF BEARINGS

GRID NORTH AS DEFINED BY THE CENTRAL MERIDIAN OF THE NEVADA COORDINATE REFERENCE SYSTEM (NCRS), LAS VEGAS AND LAS VEGAS HIGH ELEVATION ZONES, NORTH AMERICAN DATUM OF 1983; SAID MERIDIAN BEING COINCIDENT WITH 114°58' WEST OF THE GREENWICH MERIDIAN.

ZONE: LAS VEGAS ZONE

DATUM (REFERENCE FRAME): NAD 1983(2011) EPOCH 2010.00

SYSTEM: NEVADA COORDINATE REFERENCE SYSTEM (NCRS)

PROJECTION: TRANSVERSE MERCATOR

STANDARD PARALLEL (AND LATITUDE OF GRID ORIGIN): 36°15'00"N

LONGITUDE OF CENTRAL MERIDIAN: 114°58'00"W

NORTHING AT GRID ORIGIN: 200,000.00 M (656,166.6667 FEET US)

EASTING AT CENTRAL MERIDIAN: 100,000.00 M (328,083.3333 FEET US)

SCALE FACTOR ON CENTRAL MERIDIAN: 1.0001 (EXACT)

NOTES:

1. ALL DISTANCES AND BEARINGS SHOWN HEREON ARE PROJECTED (GRID) VALUES BASED ON THE PRECEDING PROJECTION DEFINITION.
2. GRID BEARING SHOWN HEREON (OR IMPLIED BY GRID COORDINATES) DO NOT EQUAL GEODETIC BEARING DUE TO MERIDIAN CONVERGENCE.

BENCHMARK

0LV9034SES - BEING A RIVET AND PLATE IN TOP OF CURB AT NW CORNER OF LONE MOUNTAIN ROAD AND RAINBOW BLVD.

2319.50 US SURVEY FEET

706.986 METERS

N.A.V.D. 88 DATUM

NOTES

- 1) SEE ELECTRONIC FILE "LONE-MOUNTAIN-SS-PNTS-NCRS.TXT" FOR COORDINATES.

LEGEND

—	RIGHT-OF-WAY LINE	CL BARREL	CENTER OF MANHOLE BARREL
—	STREET CENTERLINE	SWR-MH	SHOT TAKEN AT CENTER OF LID
—	SEWER LINE	PIPE-TOP	SHOT TAKEN ON TOP OF PIPE
x	POINT LOCATION		
23118	POINT NUMBER		

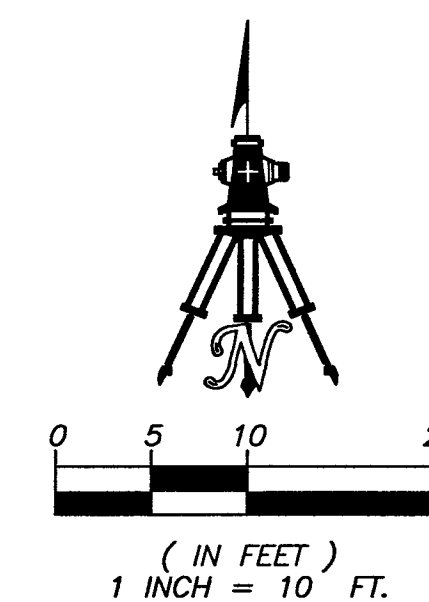

SHEET 1 OF 1

H# 56537
CLV DWG 107Y6389

SANITARY SEWER FINAL LOCATION MAP
LONE MOUNTAIN 2 SENIOR APARTMENTS
BEING LOT 4 OF PARCEL MAP FILE 35 PAGE 37
SITUATED IN THE NORTH HALF (N 1/2) OF THE NORTHWEST QUARTER (NW 1/4)
OF SECTION 2, TOWNSHIP 20 SOUTH, RANGE 60 EAST M.D.M., CITY OF LAS
VEGAS, CLARK COUNTY, NEVADA

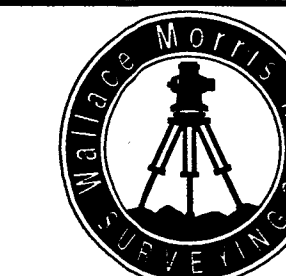

WALLACE · MORRIS · KLINE
SURVEYING, INC.
LAND SURVEY CONSULTING
5740 SOUTH ARVILLE STREET, #206
LAS VEGAS, NEVADA 89118
PH: 702.212.3967 FX: 702.212.3963

Memorandum

Department of Public Works
City Engineer Division
Survey Section
333 North Rancho Dr., 8th Floor
Las Vegas, Nevada 89106

Phone (702) 229-6217
Fax (702) 804-8582

To: Michael Cunningham, Manager
Building and Safety Department

From: Alan R. Riecki, PLS
City Surveyor

C: Lance M. West, PLS
Wallace Morris Kline Surveying

Tim Parks, P.E., Engineering Project Manager
Sanitary Sewers Section, Engineering Planning

Date: May 9, 2017

Re: Sanitary Sewer Final Location Map
LONE MOUNTAIN 2 SENIOR APARTMENTS
(Drawing No. 107V6389, L-Civil No. 56537)

The Survey Section has reviewed the Final Location Map and as far as our jurisdiction of this project is concerned, we find that the map is:

Acceptable: May 9, 2017



Signature

City Surveyor
Title

Public Works/Survey
Department/Division

ARR/OS:js

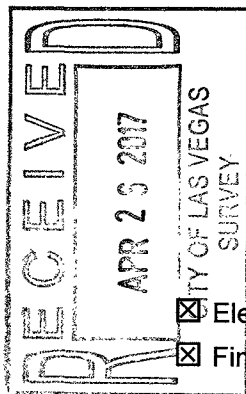

CITY OF LAS VEGAS

BUILDING AND SAFETY DEPARTMENT

OFFSITE INSPECTION & TESTING
333 NORTH RANCHO DRIVE
LAS VEGAS, NV 89106
PHONE: (702) 229-6337
FAX: (702) 363-1051

DEVELOPER'S SUBMITTAL OF GPS COORDINATES

Sewer Storm Drain

Electronic Comma Delineated File

Final Location Map (2)

NOTE: THE TOP PART OF THIS FORM MUST BE FILLED OUT IN ITS ENTIRETY

PROJECT NAME: LONE MOUNTAIN 2 SENIOR APARTMENT UNIT: N/A PHASE: N/A

PROJECT LOCATION: LONE MOUNTAIN RD & RAINBOW BLVD.

CLV PLAN #: 56537 CLV PROJECT #: 107Y6389 SHEET NO. (S): 1

OF MANHOLES 1 PUB. SEWER/STORM DRAIN LIN. FT. 29 # OF PRIVATE LATERALS N/A

DEVELOPER: OVATION DEVELOPMENT PHONE: 702-990-2390 FAX: 702-990-2391

SURVEY CO.: WALLACE MORRIS KLINE PHONE: 702-212-3967 FAX: 702-212-3963

CONTRACTOR: NATIONAL PIPELINE PHONE: 702-361-820 FAX: _____

CONTRACTOR'S SUPERVISOR NAME: DUSTIN SCHWEI MOBILE: 702-361-8020

DATE OF REQUEST: 4/20/17

THIS SEWER HAS BEEN SURVEYED BY NEVADA LICENSED LAND SURVEYOR:

Company Name WALLACE MORRIS KLINE Surveyor Name LANCE WEST

License # 18232 License exp. Date: 06/30/18

CITY USE ONLY

DATE SR. INSPECTOR RECEIVED: _____ SR. INSPECTOR INITIALS: _____

DATE RECEIVED FROM SR. INSPECTOR AND SENT TO CITY SURVEYOR: _____

ACCEPTABLE BY CITY SURVEYOR DATE: 5/9/17 NOT ACCEPTABLE BY CITY SURVEYOR DATE _____

CLV SURVEYOR'S SIGNATURE: [Signature] DATE: 5/9/17

THE CITY OF LAS VEGAS RECOMMENDS THAT ALL DEFICIENCIES NOTED ON THE ATTACHED SURVEY REPORT BE CORRECTED PRIOR TO THE FINAL ACCEPTANCE.

For Sanitary Sewer To Complete and Return to Offsite Inspection & Testing:

RECEIVED BY: _____
(PLEASE PRINT)

SIGNATURE: _____ DATE: _____

For Flood Control To Complete and Return to Offsite Inspection & Testing:

RECEIVED BY: _____
(PLEASE PRINT)

SIGNATURE: _____ DATE: _____



City of Las Vegas
Department of Public Works
Survey Section

REVIEW CHECKLIST
SANITARY SEWER
FINAL LOCATION MAP

JOB NUMBER H56537 SS1
PROJECT NAME LONE MOUNTAIN 2 SENIOR APARTMENTS
WORK AUTH. NO. P28000
SUBMITTED BY Wallace Morris Kline (Lance West)
PROJECT TYPE CIP Land Dev Street Rehab
DATE 5/8/17
REVIEWED BY D. SANTANA

REVIEW DETERMINATION

- Approved
 Not Acceptable

TO BE RE-SUBMITTED

- Two bond copies (no mylar)
 Electronic media with comma-separated coordinate file

REVIEW ITEM	OK	SEE R/L	N/A	COMMENTS
Submittal Contents				
Two bond copies (no mylar)	<input checked="" type="checkbox"/>	<input type="checkbox"/>	<input type="checkbox"/>	
Electronic media containing comma-separated coordinate file	<input checked="" type="checkbox"/>	<input type="checkbox"/>	<input type="checkbox"/>	
General Map Contents				
Sheet size 24" x 36"	<input checked="" type="checkbox"/>	<input type="checkbox"/>	<input type="checkbox"/>	
Sheet number and number of sheets	<input checked="" type="checkbox"/>	<input type="checkbox"/>	<input type="checkbox"/>	
North arrow (pointing up, left or right)	<input checked="" type="checkbox"/>	<input type="checkbox"/>	<input type="checkbox"/>	
Scale (written & graphic, correctly shown, appropriate scale used)	<input checked="" type="checkbox"/>	<input type="checkbox"/>	<input type="checkbox"/>	
Lettering legibility (minimum text size 0.08")	<input checked="" type="checkbox"/>	<input type="checkbox"/>	<input type="checkbox"/>	
Map title shown ("Sanitary Sewer Final Location Map")	<input checked="" type="checkbox"/>	<input type="checkbox"/>	<input type="checkbox"/>	
CLV project name shown	<input checked="" type="checkbox"/>	<input type="checkbox"/>	<input type="checkbox"/>	
CLV Hansen No. shown	<input checked="" type="checkbox"/>	<input type="checkbox"/>	<input type="checkbox"/>	
CLV Drawing No. shown	<input type="checkbox"/>	<input checked="" type="checkbox"/>	<input type="checkbox"/>	107V 6389
Preparer's company name and contact information shown	<input checked="" type="checkbox"/>	<input type="checkbox"/>	<input type="checkbox"/>	
Legend (all linetypes and symbols defined)	<input checked="" type="checkbox"/>	<input type="checkbox"/>	<input type="checkbox"/>	
Non-standard abbreviations defined	<input checked="" type="checkbox"/>	<input type="checkbox"/>	<input type="checkbox"/>	
Distances, coordinates and elevations labeled using decimal feet	<input checked="" type="checkbox"/>	<input type="checkbox"/>	<input type="checkbox"/>	
Approximate limits of streets shown (improvements or right-of-way)	<input checked="" type="checkbox"/>	<input type="checkbox"/>	<input type="checkbox"/>	
Street names labeled (identified as public or private)	<input checked="" type="checkbox"/>	<input type="checkbox"/>	<input type="checkbox"/>	

REVIEW CHECKLIST – SANITARY SEWER FINAL LOCATION MAP

REVIEW ITEM	OK	SEE R/L	N/A	COMMENTS
Sanitary Sewer Improvements Data				
*NOTE As of December 1, 2015 manhole cover locations are no longer required.				
Manhole Barrel/Base: (measured horizontally at centerline of structure barrel/base, vertical location does not apply)	<input checked="" type="checkbox"/>	<input type="checkbox"/>	<input type="checkbox"/>	
Vaults and Junction Structures: (measured horizontally at all outer extents of structure, vertically at top of structure)	<input type="checkbox"/>	<input type="checkbox"/>	<input checked="" type="checkbox"/>	
Lateral/Main/Interceptor Pipes: locate at all connections to other pipes and structures, all horizontal and vertical deflections, points of termination (stubs), point at which pipe exits the public right-of-way or easement (measured horizontally at centerline of pipe, vertically at top of pipe)	<input checked="" type="checkbox"/>	<input type="checkbox"/>	<input type="checkbox"/>	
*NOTE All pipe connections to manholes and other structures should be located at outside face of structure before backfilling due to accuracy limitations of pipe measurements from the structure's surface access point.				
Coordinate Information				
Data acquisition completion date indicated	<input checked="" type="checkbox"/>	<input type="checkbox"/>	<input type="checkbox"/>	
Coordinate system indicated (only CLV approved coordinate systems are to be used)	<input checked="" type="checkbox"/>	<input type="checkbox"/>	<input type="checkbox"/>	
Horizontal datum, datum adjustment, and epoch date indicated (only CLV approved datums are to be used)	<input checked="" type="checkbox"/>	<input type="checkbox"/>	<input type="checkbox"/>	
Benchmark ID, description, elevation indicated	<input checked="" type="checkbox"/>	<input type="checkbox"/>	<input type="checkbox"/>	
Statement of positional accuracy per the tolerances indicated below	<input checked="" type="checkbox"/>	<input type="checkbox"/>	<input type="checkbox"/>	
*NOTE For all projects with improvement plans approved prior to March 1, 2015 coordinates provided must be accurate to within ± 0.5 feet horizontally and vertically. For all projects with improvement plans approved after March 1, 2015 coordinates provided must be accurate to within ± 0.3 feet horizontally and vertically.				
Coordinate accuracy QA/QC (when available)	<input type="checkbox"/>	<input type="checkbox"/>	<input checked="" type="checkbox"/>	

ADDITIONAL COMMENTS