

FREMONT & 9TH STREET

PREPARED FOR:
 901 FREMONT DEVELOPMENT PARTNERS, LP.
 APN: 139-34-601-012
 CITY OF LAS VEGAS, NEVADA
 SWC OF 9TH STREET & FREMONT STREET

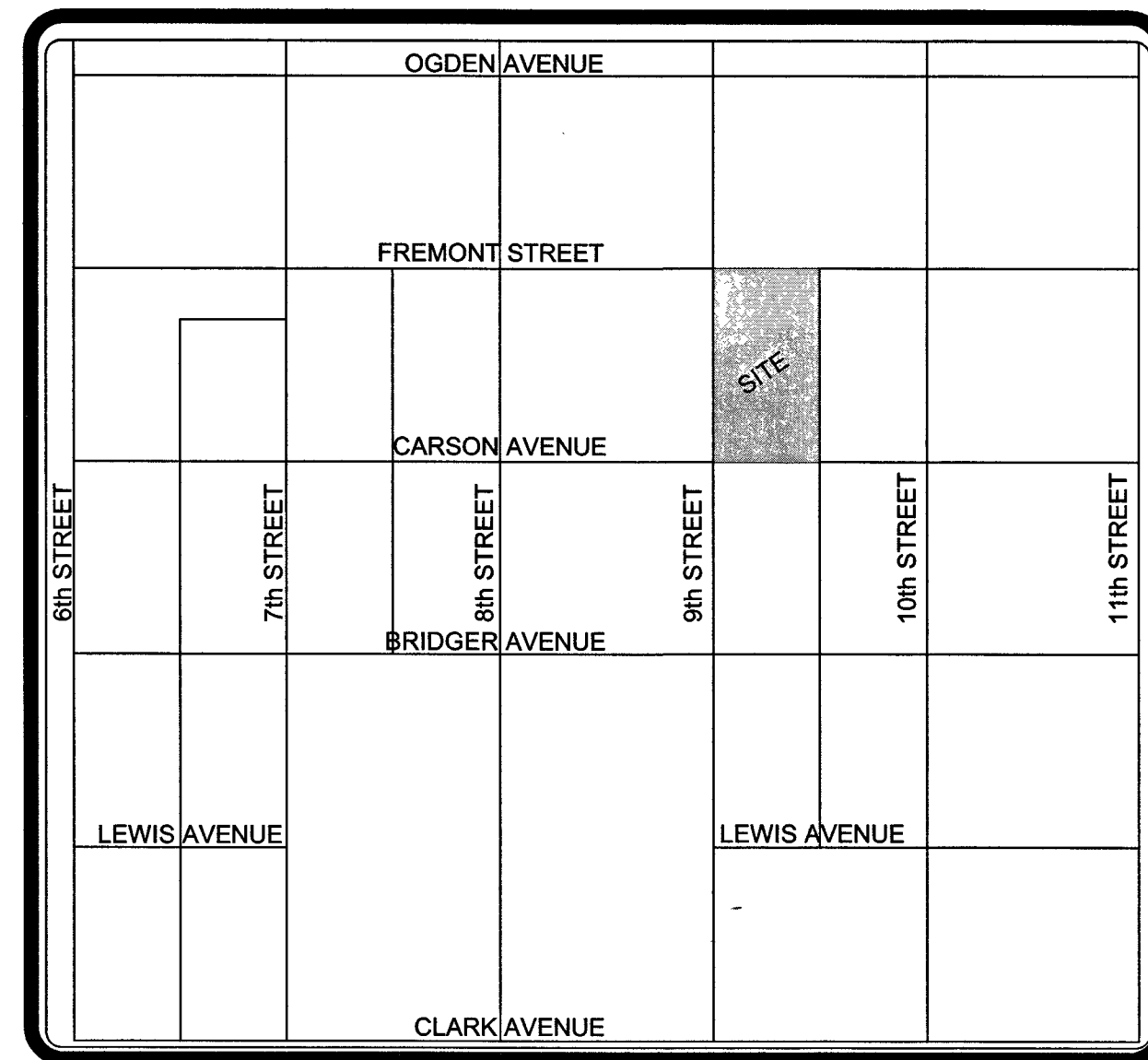

VICINITY MAP
 SCALE: NTS

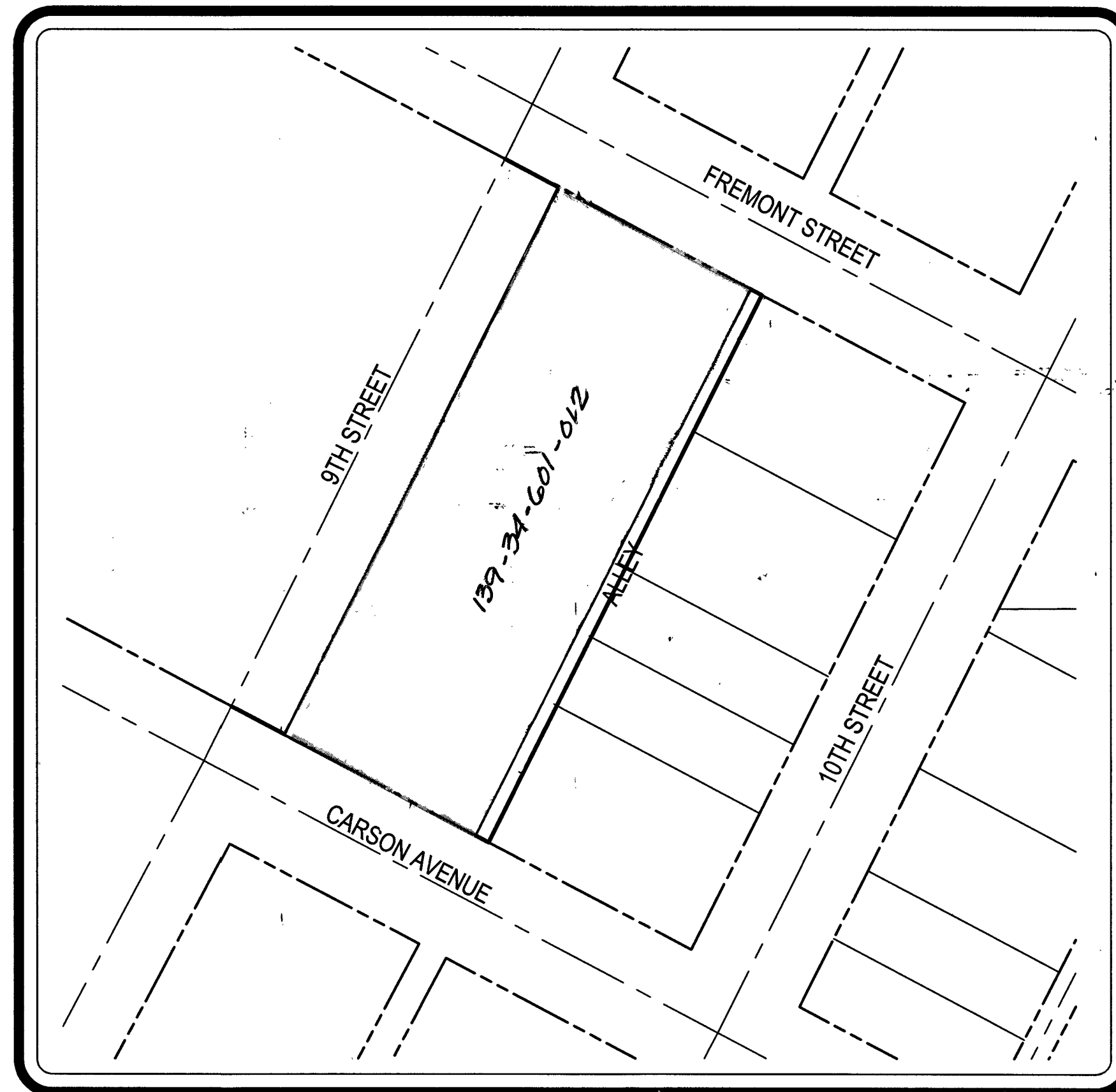

SITE MAP
 SCALE: NTS

PROJECT TEAM:

OWNER: 901 FREMONT DEVELOPMENT PARTNERS, LP.
 261 N. LAS VEGAS BLVD., SUITE 110
 LAS VEGAS, NEVADA 89101
 CONTACT: TODD KESSLER

CIVIL ENGINEER: CARDNO
 7115 AMIGO STREET SUITE 100
 LAS VEGAS, NEVADA 89119
 PHONE: 702-990-9300
 CONTACT: DAVID LOGSDON II

ARCHITECT: HUMPHRIES & PARTNERS
 5339 ALPHA ROAD, SUITE 300
 DALLAS, TEXAS 75240
 PHONE: 972-701-9636

UTILITY CONTACTS:

POWER: NV ENERGY
 ATTN: NEW DEVELOPMENT
 7155 LINDELL ROAD
 LAS VEGAS, NEVADA 89118
 PHONE: 702-402-8400

WATER: LAS VEGAS VALLEY WATER DISTRICT
 ATTN: ENGINEERING SERVICES
 1001 S. VALLEY VIEW BOULEVARD
 LAS VEGAS, NEVADA 89153
 PHONE: 702-258-3165

SEWER: CITY OF LAS VEGAS PUBLIC WORKS
 ATTN: ENGINEERING PLANNING
 333 N. RANCHO DRIVE 7TH FLOOR
 LAS VEGAS, NEVADA 89106
 PHONE: 702-229-2178

GAS: SOUTHWEST GAS CORPORATION
 ATTN: ENGINEERING PLANNING
 6355 SHATZ STREET
 NORTH LAS VEGAS, NEVADA 89115

BASIS OF BEARINGS:

SOUTH 62°04'40" EAST, BEING THE CENTERLINE OF A PORTION OF FREMONT STREET AS SHOWN BY MAP IN THE OFFICE OF THE CLARK COUNTY, NEVADA RECORDER IN FILE 67, PAGE 79 OF SURVEYS.

BENCHMARK:

CITY OF LAS VEGAS STATION CHAS 5 RIVET AND PLATE IN TOP OF CURB AT THE NORTHEAST CORNER OF LAS VEGAS BOULEVARD AND CHARLESTON BOULEVARD.

ELEVATION:
 FEET = 2019.57' (NAVD88)
 METERS = 615.566 M (NAVD88)

SHEET INDEX

- C1 COVER
- C2 NOTES
- C3 HORIZONTAL CONTROL PLAN
- C4 GRADING PLAN
- C5 DETAILS
- C6 PLAN AND PROFILE - FREMONT STREET
- C7 PLAN AND PROFILE - CARSON AVENUE
- C8 PLAN AND PROFILE - 9TH STREET
- C9 PLAN AND PROFILE - 9TH STREET
- C10 PLAN AND PROFILE - ALLEY
- C11 UTILITY PLAN
- C12 TRAFFIC CONTROL PLAN

APPROVALS

Allen Pavelka 03-16-16
 ALLEN PAVELKA PE, PE# 9029
 CITY ENGINEER - CITY OF LAS VEGAS

APPROVAL OF THESE PLANS BY THE CITY ENGINEER IS LIMITED TO THOSE IMPROVEMENTS CONSTRUCTED IN THE DEDICATED RIGHT-OF-WAY AND/OR DEDICATED EASEMENTS. THIS APPROVAL DOES NOT AUTHORIZE THE CONSTRUCTION OF ANY IMPROVEMENTS THAT DEVIATE FROM ADOPTED STANDARDS AND/OR SPECIFICATIONS EXCEPT THOSE SPECIFICALLY LISTED UNDER DEVIATIONS FROM STANDARD THE ENGINEER SHALL RESOLVE ANY DEVIATION OTHER THAN THOSE LISTED IN DEVIATIONS FROM STANDARDS IN FAVOR OF THE UNIFORM STANDARD DRAWINGS AND SPECIFICATIONS CLARK COUNTY AREA NEVADA.

Chris Knight 3/16/16
 CHRIS KNIGHT, DIRECTOR, BUILDING AND SAFETY

THIS PLAN MEETS THE APPLICABLE STANDARDS OF THE PLANNING DEPARTMENT

Las Vegas Fire & Rescue
 LAS VEGAS FIRE & RESCUE

NV Energy
 NV ENERGY

NV ENERGY ACKNOWLEDGES THAT WE HAVE RECEIVED YOUR PLANS AND WILL PROVIDED SERVICE TO ALL ELECTRICAL NEEDS ASSOCIATED WITH THIS PROJECT. NV ENERGY RESERVES THE RIGHT TO ADDRESS ANY EXISTING OR FUTURE CONFLICTS ONCE THE FINAL DESIGN IS COMPLETED. THE NEW SERVICE AND THE RESOLUTION OF ANY CONFLICTS WILL BE ACCOMPLISHED PURSUANT TO THE NEVADA PUBLIC UTILITY COMMISSION'S RULES AND REGULATIONS

Pamela Kennedy 12-7-15
 SOUTHWEST GAS CORPORATION

Central Telephone DBA Century Link
 CENTRAL TELEPHONE DBA CENTURY LINK

"THE AFFIXED CENTURY LINK APPROVAL DOES NOT ASSUME OR GUARANTEE LIABILITY FOR KNOWN OR UNKNOWN CONFLICTS WITH EXISTING OR PROPOSED IMPROVEMENTS. RESOLUTION OR PROPOSED IMPROVEMENTS, RESOLUTION OF ANY CONFLICT WILL BE ACCOMPLISHED PURSUANT TO LOCAL ORDINANCES, NEVADA REVISED STATUTES AND/OR PUBLIC UTILITY COMMISSION RULES AND REGULATIONS."

Cox Communications Las Vegas, Inc 12-4-15
 COX COMMUNICATIONS LAS VEGAS, INC

APPROVED FOR CONSTRUCTION
Edgar Leon
 LAS VEGAS VALLEY WATER DISTRICT ENGINEERING SERVICES MANAGER
 PROJECT No. 123905 DATE: 2/29/16
 (SHEETS: C1, C2, C7-C11)

COVER
 FREMONT & 9TH STREET
 901 FREMONT, LLC.
 CITY OF LAS VEGAS, NEVADA

#	DATE	DESCRIPTION	BY
1	5-12-14	REVISE SHEETS C10 & C11	EL
2	5-7-17	REVISE BUILDING INTERIOR & EL AND REALIGN WATER LINE 158'	EL

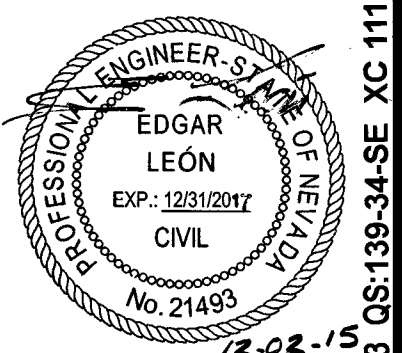

DATE: 12-2-2015
 DRAWN: IBP
 DESIGNED: IBP
 CHECKED: EL
 PROJECT #: 131509350
 SHEET TITLE: COVER
 SHEET NUMBER: 4 of 12
 SHEET: C1
 1070 b576
 SHEET 1 OF 12