

LEGEND

1	INSTALL B-36 PULL BOX (24"x36"x24")
2	EXISTING B-36 PULL BOX (24"x36"x24")
3	INSTALL B-50 PULL BOX (13"x24"x24")
4	EXISTING B-50 PULL BOX (13"x24"x24")
5	INSTALL B-100 PULL BOX (24"x36"x24")
6	EXISTING B-100 PULL BOX (24"x36"x24")
7	INSTALL T-200 CATV VAULT (30"x48"x36")
8	EXISTING T-200 CATV VAULT (30"x48"x36")
9	INSTALL T-400 CATV VAULT (36"x60"x36")
10	EXISTING T-400 CATV VAULT (36"x60"x36")
11	INSTALL T-600 CATV VAULT (48"x72"x36")
12	EXISTING T-600 CATV VAULT (48"x72"x36")
13	INSTALL NEW CATV PEDESTAL
14	EXISTING NEW CATV PEDESTAL
15	R&R S/W SLAB(S)
16	POTHOLE
17	---S--- SIDEWALK/DIRT TRENCH INSTALL
18	---A--- ASPHALT/STREET TRENCH INSTALL
19	---B--- PROPOSED BORE
20	---X--- EXISTING CATV CONDUIT(S)
21	---OHC--- PROPOSED OVERHEAD FIBER OPTIC CABLE OR COAX INSTALL
22	---XOHC--- EXISTING OVERHEAD FIBER OPTIC CABLE OR COAX
23	--- --- U.G. FIBER/COAX PULL
24	--- --- RIGHT OF WAY LINE
25	--- --- LOT/PROPERTY LINE
26 EDGE OF PAVEMENT
27	[P] EXISTING NVE PULL BOX
28	[T] EXISTING TELCO PULL BOX
29	[TM] EXISTING TELCO MANHOLE
30	[T] EXISTING TELCO POLE
31	[NVE] EXISTING NVE POLE
32	[NVE] EXISTING NVE TRANSMISSION POLE
33	[X] EXISTING JOINT POLE
34	[X] EXISTING JOINT POLE WITH TRANSFORMER
35	[A] POLE ANCHOR
36	[TS] EXISTING NVE TRANSFORMER TRANSFORMER PAD
37	[TS] SNWA TEST STATION
38	[TS] COX POWER SUPPLY (49"x24"x52")
39	[RC] INSTALL RHINO CABINET
40	[R] RISER POLE/QUADRANT DETAIL RISER OWNERSHIP NOTED
41	[R] RAILROAD
42	[MH] EXISTING MANHOLE (SS),(SD)...ECT
43	--- --- 1in CONDUIT LATERAL
44	
45	

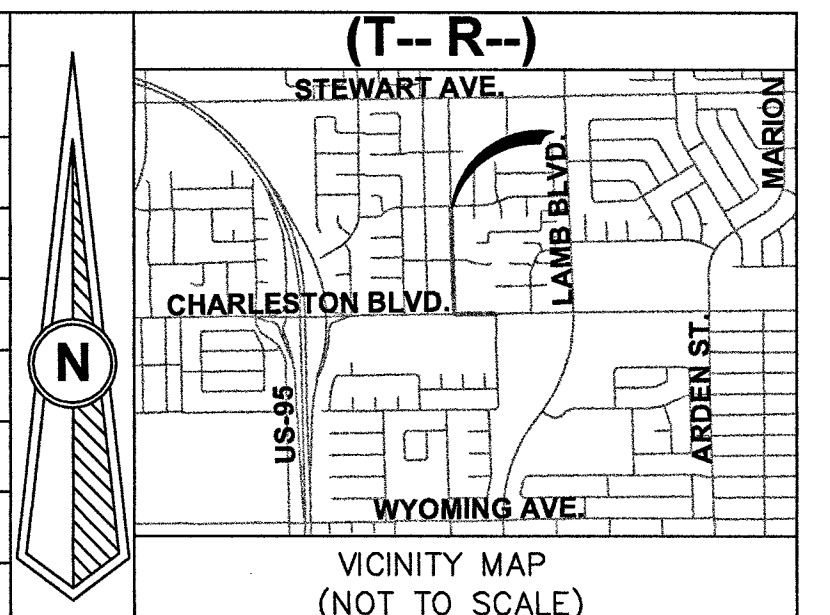

REVISIONS

REV	DESCRIPTION	DATE	BY
1			
2			
3			
4			
5			
6			
7			
8			
9			
10			
11			
12			
13			
14			
15			
16			
17			
18			
19			
20			
21			
22			
23			
24			
25			
26			
27			
28			
29			
30			
31			
32			
33			
34			
35			
36			
37			
38			
39			
40			
41			
42			
43			
44			
45			

ALL CONSTRUCTION AND MATERIALS SHALL BE IN ACCORDANCE WITH THE "UNIFORM STANDARD SPECIFICATIONS FOR PUBLIC WORKS CONSTRUCTION OFF-SITE IMPROVEMENTS, CLARK COUNTY AREA NEVADA" LATEST ISSUE; THE "UNIFORM STANDARD DRAWINGS FOR PUBLIC WORKS CONSTRUCTION, CLARK COUNTY AREA NEVADA" LATEST ISSUE; AND OTHER APPLICABLE APPROVED STANDARDS ISSUED BY THE CONTROLLING AGENCY; ALL LOCAL CITY CODES AND ORDINANCES APPLICABLE.

APPROVED FOR CONSTRUCTION
 THIS APPROVAL IS FOR WORK IN CLV R/W OR CLV EASEMENT ONLY. OBTAINING PERMISSION OR EASEMENT FOR WORK SHOWN IN PRIVATE PROPERTY IS THE RESPONSIBILITY OF THE UTILITY.

APPROVAL: [Signature] DATE: 5/23/17

PERMIT #	13189-05
DRAWN BY:	70524
WTB	109V6821-CBL
DATE:	
SCALE:	3-4-17
SCALE:	1:40
NODE:	N/A
DESIGNER:	40505170000REB3RDP
TECH #	702-210-7012
APPROVED BY:	NICK MUSCARI

COX
 1700 VEGAS DRIVE
 LAS VEGAS, NEVADA 89106
 PHONE: (702) 545-1606
 FAX: (702) 545-2606

DISCLAIMER NOTE
 UTILITY LOCATIONS SHOWN HEREON ARE APPROXIMATE ONLY. IT SHALL BE THE CONTRACTOR'S RESPONSIBILITY TO DETERMINE THE EXACT HORIZONTAL AND VERTICAL LOCATION OF ALL EXISTING UNDERGROUND AND OVERHEAD UTILITIES PRIOR TO COMMENCING CONSTRUCTION. NO REPRESENTATION IS MADE THAT ALL EXISTING UTILITIES ARE SHOWN HEREON. THE ENGINEER ASSUMES NO RESPONSIBILITY FOR UTILITIES NOT SHOWN OR UTILITIES NOT SHOWN IN THEIR PROPER LOCATIONS.

BEFORE YOU DIG
 OR 1-800-227-2600
 UNDERGROUND SERVICE (USA)

BEFORE YOU OVERHEAD
 CALL BEFORE YOU UNDERGROUND
 1-702-227-2929
 NEVADA POWER ENVIRONMENT AND SAFETY SERVICE DEPARTMENT

TOTAL BORE	0'
TOTAL DIRT TRENCH	0'
TOTAL ASPHALT TRENCH	0'
TOTAL TRENCH	0'
SIDEWALK REMOVAL/REPAIR	
TOTAL S/W PANELS	0'
TOTAL LINEAR FOOTAGE	0

CITY OF LAS VEGAS
 333 N. RANCHO DRIVE
 LAS VEGAS, NEVADA 89106
 (702) 229-6885

PROJECT LOCATION: PRINCE LN & E CHARLESTON BLVD
 SUB-CONTRACTOR: CLOVER
 ENTITY NOTES:

SHEET No: **1**
 SHEET 1 OF 2

5/15/17
 #70524
 TrueNet# 10841

