

# CALIFORNIA HOTEL PARKING LOT DRIVEWAY IMPROVEMENTS

FOR  
BOYD GAMING CORPORATION

APN: 139-27-402-009  
100 STEWART STREET  
CITY OF LAS VEGAS, NEVADA

## PROJECT CONTACTS

CIVIL ENGINEER  
KIMLEY-HORN AND ASSOCIATES, INC.  
6671 LAS VEGAS BOULEVARD SOUTH, SUITE 320  
LAS VEGAS, NEVADA 89119

CONTACT: RICHARD MOLES, P.E.  
(702) 862-3600

OWNER/DEVELOPER  
BOYD GAMING CORPORATION  
6465 S. RAINBOW BLVD.  
LAS VEGAS, NEVADA 89118

CONTACT: MELISSA KINDHART  
(702) 696-1152

## PROJECT INFORMATION

ACREAGE: 0.40 AC.

ZONING: GENERAL COMMERCIAL DISTRICT (C-2)

## FLOOD ZONE NOTE

THE FEDERAL EMERGENCY MANAGEMENT AGENCY (FEMA) INDICATES THAT THE SITE IS LOCATED IN ZONE "X" OF THE FLOOD INSURANCE RATE MAP (FIRM) No. 32003C2170F AS SHOWN ON THE FIRM INDEX, REVISED NOVEMBER 16, 2011. ZONE "X" IS DEFINED BY FEMA AS "AREAS DETERMINED TO BE OUTSIDE THE 0.2% ANNUAL CHANCE FLOODPLAIN."

## BENCHMARK

CITY OF LAS VEGAS 1LV0134NE6  
RIVET AND PLATE IN TOP OF CURB AT SE CORNER OF STEWART & LAS VEGAS BLVD.

ELEVATION 611.087 (METERS) / 2,004.87 (U.S. SURVEY FEET)  
NORTH AMERICAN VERTICAL DATUM OF 1988 (NAVD88)

## BASIS OF BEARING

SOUTH 62°04'45" EAST, BEING THE CENTERLINE OF STEWART AVENUE BETWEEN MAIN STREET AND 1ST STREET AS SHOWN IN FILE 104, PAGE 88 OF SURVEYS, ONFILE AT THE CLARK COUNTY, NEVADA RECORDER'S OFFICE.

## UTILITY NOTE

KIMLEY-HORN AND ASSOCIATES TAKES NO RESPONSIBILITY FOR EXISTING UTILITIES SHOWN HEREIN. THE EXISTING UTILITIES SHOWN ARE BASED ON INFORMATION PROVIDED BY OTHER PARTIES. IT IS THE RESPONSIBILITY OF THE CONTRACTOR TO LOCATE AND VERIFY THE LOCATIONS AND INVERTS OF THE EXISTING WITHIN THE VICINITY OF CONSTRUCTION ACTIVITIES. IF A CONFLICT IS FOUND TO EXIST, THE CONTRACTOR SHALL COORDINATE THE PROJECT ENGINEER, PROJECT ARCHITECT, AND THE OWNER IMMEDIATELY.

## SHEET INDEX

No.	SHEET	DESCRIPTION
1	C0.1	COVER
2	C0.2	GENERAL NOTES
3	C1.0	DEMOLITION, HORIZONTAL CONTROL, AND GRADING PLAN
4	C2.0	DETAIL SHEET

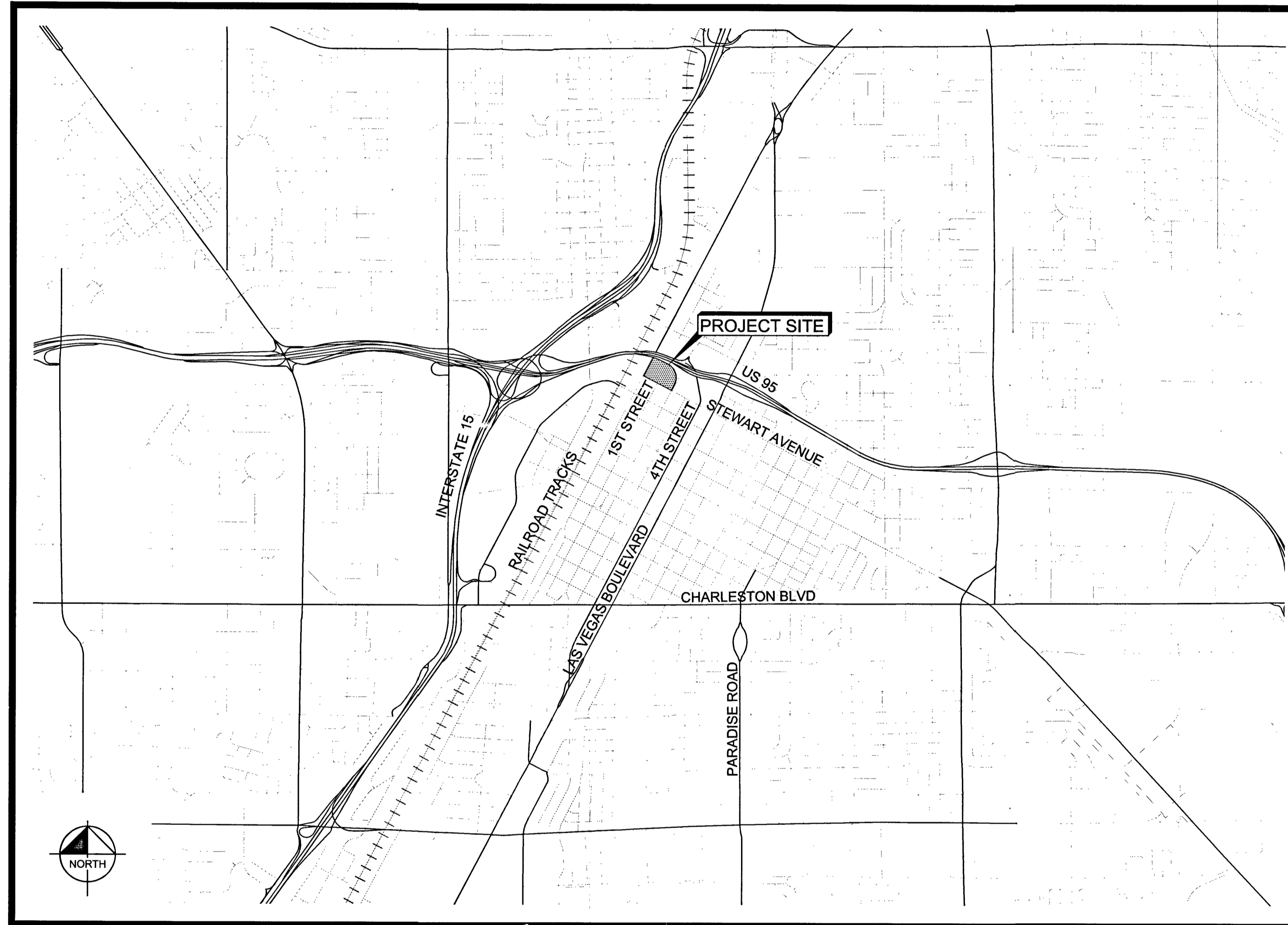

PROJECT VICINITY  
NTS

## APPROVALS

*Allen Pavelka* 3-23-17  
CITY ENGINEER - ALLEN PAVELKA, PE, PE#9029 DATE

APPROVAL OF THESE PLANS BY THE CITY ENGINEER IS LIMITED TO THOSE IMPROVEMENTS CONSTRUCTED IN THE DEDICATED RIGHT-OF-WAY, AND/OR DEDICATED EASEMENTS. THIS APPROVAL DOES NOT AUTHORIZE CONSTRUCTION OF ANY IMPROVEMENTS THAT DEVIATE FROM ADOPTED STANDARDS AND/OR SPECIFICATIONS EXCEPT THOSE SPECIFICALLY LISTED UNDER THE DEVIATION FORM STANDARDS. THE ENGINEER SHALL RESOLVE ANY DEVIATION OTHER THAN THOSE LISTED IN DEVIATIONS FROM STANDARDS IN FAVOR OF THE UNIFORM STANDARD DRAWINGS AND SPECIFICATIONS, CLARK COUNTY AREA, NEVADA.

*K. G. Smith* 12/19/16  
LAS VEGAS FIRE AND RESCUE DATE

NA  
CHRIS KNIGHT, DIRECTOR  
BUILDING AND SAFETY DEPARTMENT DATE  
THIS PLAN MEETS THE APPLICABLE STANDARDS OF THE PLANNING DEPARTMENT

NA  
CENTRAL TELEPHONE COMPANY, D/B/A CENTURYLINK DATE  
THE AFFIXED CENTURYLINK NEVADA APPROVAL DOES NOT ASSUME OR GUARANTEE LIABILITY FOR KNOWN OR UNKNOWN CONFLICTS WITH EXISTING OR PROPOSED IMPROVEMENTS. RESOLUTION OF ANY CONFLICT WILL BE ACCOMPLISHED PURSUANT TO LOCAL ORDINANCES, NEVADA REVISED STATUTES AND/OR PUBLIC UTILITY COMMISSION STANDARD REGULATIONS.

APPROVED FOR CONSTRUCTION  
*Y. D. Shari for JS*  
LAS VEGAS VALLEY WATER DISTRICT ENGINEERING SERVICES MANAGER  
PROJECT No. 125320 DATE: 2/22/17  
SHEETS: C0.1, C0.2, C1.0, C2.0 (NO NEW WATER FACILITIES)  
LVWMD APPROVED FIRE FLOW: 1,500 GPM AT 20 PSI RESIDUAL  
APPROVAL BY THE FIRE DEPARTMENT HAVING JURISDICTION IS REQUIRED PRIOR TO OBTAINING FINAL APPROVAL FROM THE LAS VEGAS VALLEY WATER DISTRICT.

(NO NEW FACILITIES)  
NA  
NV ENERGY DATE  
NV ENERGY ACKNOWLEDGES THAT WE HAVE RECEIVED YOUR PLANS AND WILL PROVIDE SERVICE TO ALL ELECTRICAL NEEDS ASSOCIATED WITH THIS PROJECT. NV ENERGY RESERVES THE RIGHT TO ADDRESS ANY EXISTING OR FUTURE CONFLICTS ONCE THE FINAL DESIGN IS COMPLETED. THE NEW SERVICE AND THE RESOLUTION OF ANY CONFLICTS WILL BE ACCOMPLISHED PURSUANT TO THE NEVADA PUBLIC UTILITY COMMISSION'S RULES AND REGULATIONS.

NA  
SOUTHWEST GAS DATE

NA  
COX COMMUNICATIONS LAS VEGAS, INC. DATE

**Kimley-Horn**  
© 2015 KIMLEY-HORN AND ASSOCIATES, INC.  
6671 LAS VEGAS BLVD. S., SUITE 320, LAS VEGAS, NV 89119  
PHONE: 702-862-3600  
WWW.KIMLEY-HORN.COM

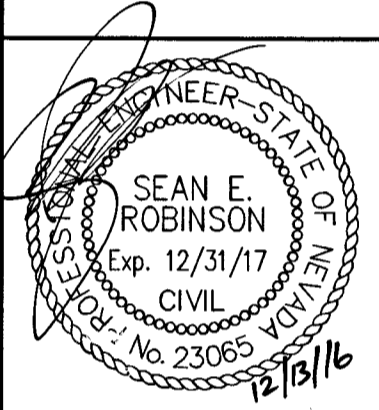

KHA PROJECT: 092373005  
DATE: 12/13/2016  
SCALE: AS SHOWN  
DESIGNED BY: SER  
DRAWN BY: MAH  
CHECKED BY: RAM

COVER SHEET

CALIFORNIA HOTEL  
PARKING  
PREPARED FOR  
BOYD GAMING  
CITY OF LAS VEGAS  
NEVADA  
PRO.#: 125320 QS:17627-SW  
SHEET NUMBER  
C0.1



Printed By: James Christion, Sheet: Calif. Hotel Parking - Layout C0.1 - December 15, 2016, 10:42:08am, K:\AV\COA\092373005 - Collapsed - sheet - Project\CA\Drawings\092373005-C0.1.dwg  
 This document, together with the concepts and designs presented herein, is an instrument of service, and its use is limited to the specific purpose and client for which it was prepared. Reuse of any portion hereof for any other purpose without the written authorization and approval of Kimley-Horn and Associates, Inc. shall be strictly prohibited.



CALIFORNIA HOTEL AND CASINO  
APN 139-27-402-009

CALIFORNIA HOTEL AND CASINO  
APN 139-27-402-009

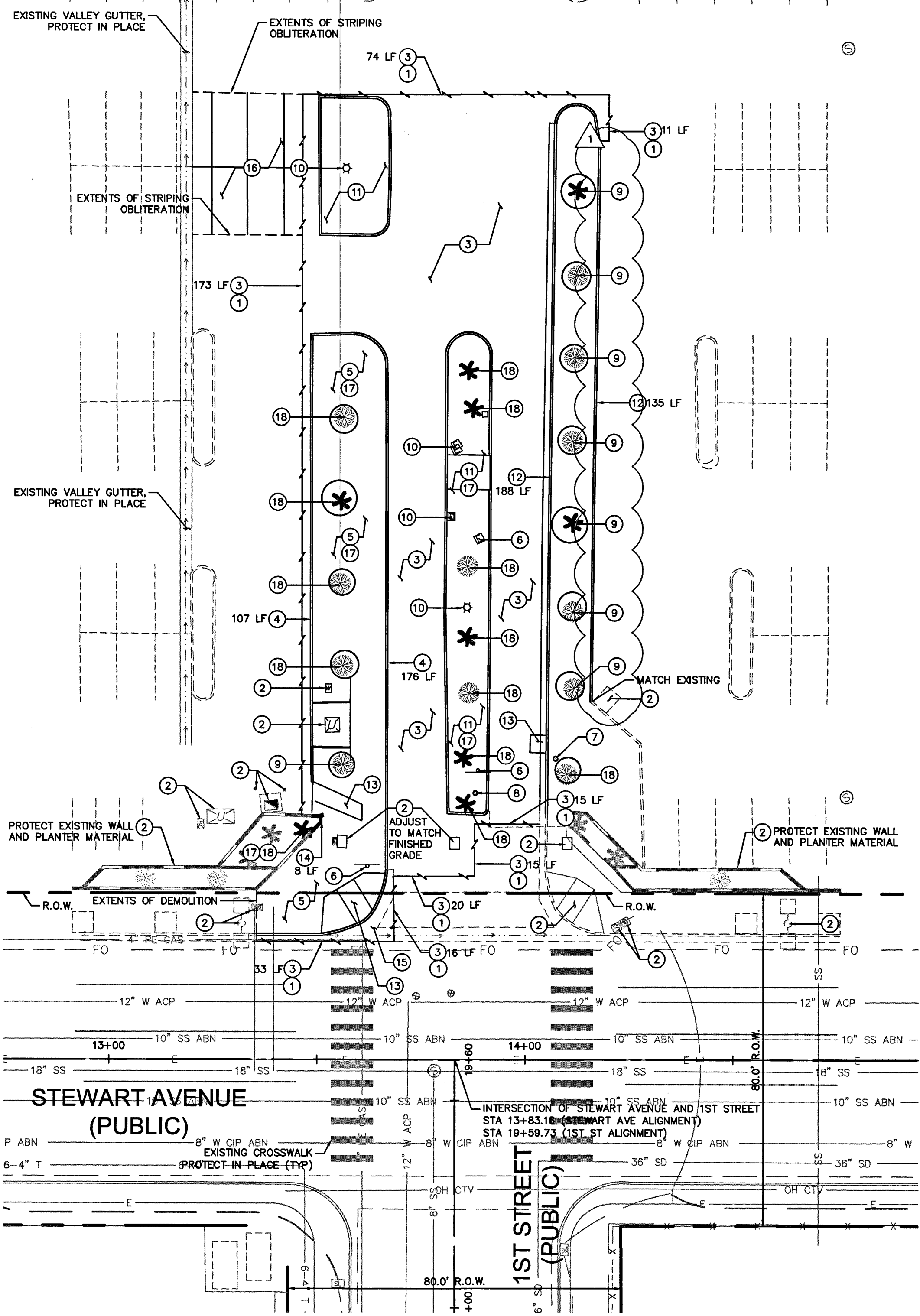

DEMOLITION PLAN

SCALE: 1"=20'

GENERAL NOTES

- CONTRACTOR TO VERIFY EXISTING IMPROVEMENTS SHOWN ON THE PLAN.
- CONTRACTOR TO PROTECT IN PLACE, DURING DEMOLITION AND CONSTRUCTION, ALL EXISTING IMPROVEMENTS THAT ARE TO REMAIN AS NOTED ON THE PLAN.
- ANY EXISTING STRUCTURE, IMPROVEMENT, OR APPURTENANCE TO REMAIN THAT IS DAMAGED DURING DEMOLITION OR CONSTRUCTION SHALL BE IMMEDIATELY REPAIRED OR REPLACED BY THE CONTRACTOR AT THE CONTRACTOR'S EXPENSE.
- CONTRACTOR SHALL VERIFY AND LOCATE ALL EXISTING UNDERGROUND UTILITIES BEFORE CONSTRUCTION AND PROTECT IN PLACE UNLESS NOTED ON THE PLANS.
- ALL DIMENSIONS ARE MEASURED FROM BACK OF CURB UNLESS OTHERWISE NOTED ON PLANS.
- ADD 2000 FT TO ALL ELEVATION CALLOUTS
- CONTRACTOR IS RESPONSIBLE FOR RAISING ALL UTILITY BOXES
- SAWCUT 2' FROM EXTENTS OF PROPOSED CONSTRUCTION

NOTE TO CONTRACTOR

- CONTRACTOR TO COORDINATE CONDUIT RUNS AND ENTRANCE GATE. CONDUIT STUBS AND WIRE PULLS ARE TO BE INSTALLED PRIOR TO CONSTRUCTION OF ENTRANCE.
- ENTRANCE EQUIPMENT AND ELECTRICAL UNITS TO BE DESIGNED BY OTHERS AND INSTALLED PER MANUFACTURERS RECOMMENDATIONS.
- CONCRETE THICKNESS REQUIRED FOR MOUNTING AND BOLT CONFIGURATIONS OF PROPOSED EQUIPMENT TO BE COORDINATED BY OTHERS.
- THESE CIVIL PLANS COVER ONLY A PORTION (1A) OF THE PROPOSED IMPROVEMENTS PRESENTED IN THE DOWNTOWN PARKING REVENUE IMPROVEMENTS PACKAGE, DATED MAY 2015.
- CONTRACTOR IS TO COORDINATE WITH GATE EQUIPMENT SUPPLIER/VENDOR FOR BOLLARD AND EQUIPMENT RELATED TO GATE EQUIPMENT, AS THESE DETAILS ARE NOT PER THIS PLAN
- CONTRACTOR IS TO COORDINATE IRRIGATION ROUTING TO RELOCATED TREES

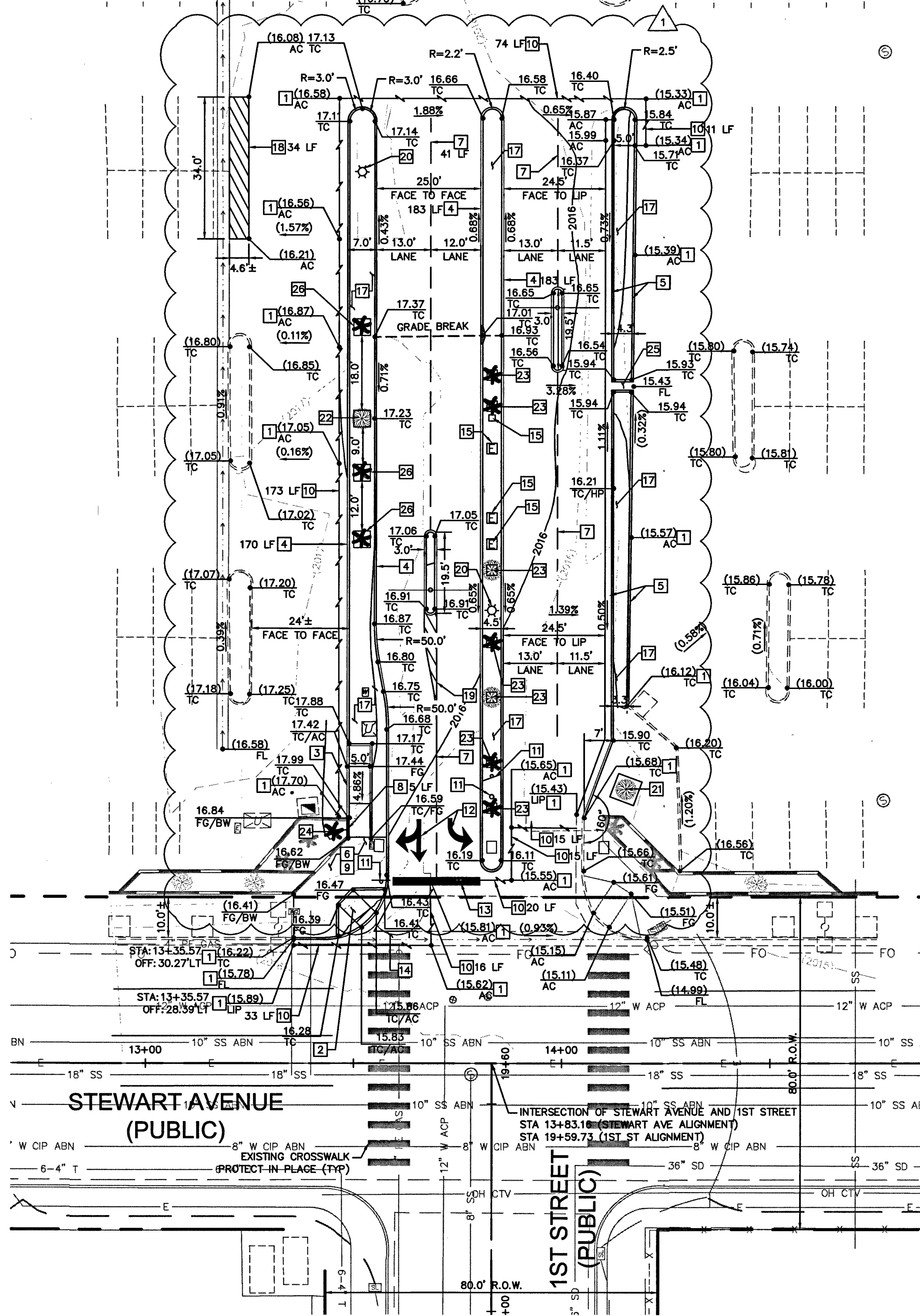

CONSTRUCTION PLAN

SCALE: 1"=20'

BENCHMARK

CITY OF LAS VEGAS 1LV0134NE6  
RIVET AND PLATE IN TOP OF CURB AT SE CORNER OF STEWART & LAS VEGAS BLVD.  
ELEVATION 611.087 (METERS) / 2,004.87 (U.S. SURVEY FEET)  
NORTH AMERICAN VERTICAL DATUM OF 1988 (NAVD88)

BASIS OF BEARING

SOUTH 62°44'5" EAST, BEING THE CENTERLINE OF STEWART AVENUE BETWEEN MAIN STREET AND 1ST STREET AS SHOWN IN FILE 104, PAGE 88 OF SURVEYS, ONFILE AT THE CLARK COUNTY, NEVADA RECORDER'S OFFICE.

DEMOLITION NOTES

- MATCH EXISTING.
- PROTECT IN PLACE.
- REMOVE EXISTING PAVEMENT AND MATCH AT SAWCUT LINE. REPLACE AC PAVEMENT AND BASE MATERIAL TO MATCH EXISTING AC AND BASE MATERIAL SECTION.
- REMOVE EXISTING 6" CURB, LENGTH PER PLAN.
- REMOVE EXISTING SIDEWALK.
- RELOCATE EXISTING SIGN AND POST PER CONSTRUCTION PLAN.
- REMOVE EXISTING BOLLARD.
- RELOCATE EXISTING MIRROR AND POST PER CONSTRUCTION PLAN.
- REMOVE EXISTING TREE AND RETURN TO OWNER.
- RELOCATE EXISTING UTILITY PER CONSTRUCTION PLAN.
- REMOVE EXISTING MEDIAN ISLAND AND 6" CURB.
- REMOVE EXISTING 6" CURB AND GUTTER, LENGTH PER PLAN.
- REMOVE EXISTING CONCRETE RAMP.
- REMOVE EXISTING WALL AND PLANTER MATERIAL.
- DEMO AND REMOVE EXISTING CONCRETE DRIVEWAY APRON, LIMITS PER PLAN.
- OLBTERATE EXISTING PARKING STRIPING.
- CONTRACTOR IS TO COORDINATE IRRIGATION ROUTING TO RELOCATED TREES.
- RELOCATE EXISTING TREE PER CONSTRUCTION PLAN.

CONSTRUCTION NOTES

- MATCH EXISTING.
- CONSTRUCT CASE II CURB RAMP PER CCAUSD No. 235 AND DETAILS ON SHEET C2.0, AND MAINTAIN ADA COMPLIANCE.
- CONSTRUCT TRANSITION CURB AND RAMP PER DETAIL ON SHEET C2.0.
- CONSTRUCT MODIFIED TYPE 'A' CURB PER DETAIL ON SHEET C2.0
- CONSTRUCT TYPE 'L' CURB AND GUTTER PER CCAUSD No. 219.
- CONSTRUCT SIDEWALK PER CCAUSD No. 234. CONSTRUCT TO NEAREST JOINT ALONG STEWART AVENUE AND MAINTAIN ADA COMPLIANCE. STAINED AND STAMPED CONCRETE PATTERN TO MATCH EXISTING, SEE DETAIL ON SHEET C2.0.
- INSTALL 4" (WHITE) STRIPE PER CITY OF LAS VEGAS STANDARDS AND SPECIFICATIONS.
- INSTALL PLANTER/RETAINING WALL TO MATCH EXISTING PER SOUTHERN NEVADA BUILDING OFFICIALS REGIONAL STANDARD DRAWING No. B-100-1 AND CONNECTION DETAIL NOTE ON SHEET C2.0.  
2% MAX. IN ALL DIRECTIONS.
- SAWCUT, MATCH EXISTING.
- RELOCATE EXISTING SIGN AND EMBEDDED RELOCATED POST PER CCAUSD No. 249.1.
- INSTALL (WHITE) PAVEMENT MARKINGS CENTERED IN LANE PER CITY OF LAS VEGAS STANDARDS AND SPECIFICATIONS.
- INSTALL 24" WIDE (WHITE) STOP BAR PER CCAUSD No. 254 AND CITY OF LAS VEGAS STANDARDS AND SPECIFICATIONS.
- CONCRETE DRIVEWAY TO BE REMOVED AT PREMOLDED EXPANSION JOINT AND EXTENDED PER PLAN AND PER CCAUSD No. 228. STAINED AND STAMPED CONCRETE PATTERN TO MATCH EXISTING.
- RELOCATE EXISTING UTILITY AND RAISE TO MATCH FINISHED GRADE.
- CONSTRUCT CONCRETE SIDEWALK, SLOPE PER PLAN, CONCRETE WALK PER CITY OF LAS VEGAS STANDARDS AND SPECIFICATIONS.
- INSTALL NO PARKING ZONE, 4" (WHITE) STRIPES AT 36" O.C. (TYP.) PER CITY OF LAS VEGAS STANDARDS AND SPECIFICATIONS, AND DETAIL ON SHEET C2.0.
- INSTALL NO DRIVE ZONE STRIPING, 4" (WHITE) STRIPES AT 36" O.C. (TYP.) PER CITY OF LAS VEGAS STANDARDS AND SPECIFICATIONS, AND DETAIL ON SHEET C2.0.
- RELOCATE EXISTING LUMINAIRE AND POLE AND INSTALL NEW FOUNDATION PER SOUTHERN NEVADA BUILDING OFFICIALS REGIONAL STANDARD E-101.
- SAWCUT 6'x6' PLANTER SECTION IN SIDEWALK AND INSTALL RELOCATED TREE.
- SAWCUT 4'x4' PLANTER SECTION IN SIDEWALK AND INSTALL RELOCATED TREE.
- SAWCUT 2.5'x2.5' PLATER SECTION IN SIDEWALK AND INSTALL RELOCATED TREE.
- RELOCATE EXISTING PALM TREE IN PLANTER WALL SO ROOT BALL WILL NOT BE IMPACTED BY WALL MODIFICATION.
- CONTRACTOR TO RELOCATE IRRIGATION
- SAWCUT 4'x4' PLANTER SECTION IN SIDEWALK AND INSTALL NEW PALMS.

LEGEND

--- (Right-of-Way)	18" SS	EXISTING SANITARY SEWER
--- (Centerline)	8" W CIP ABN	EXISTING WATER
--- (Proposed Curb)	OH CTV	EXISTING CABLE TV/COMMUNICATIONS
--- (Proposed Wall)	E	EXISTING ELECTRIC LINE
--- (Existing Wall)	FO	EXISTING FIBER OPTIC LINE
--- (Existing Parking Striping)	---	---
--- (Existing Curb)	---	---
--- (Existing Storm Drain)	---	---

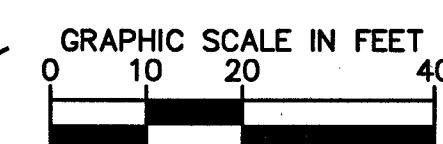
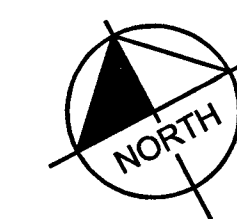

**Kimley»Horn**  
© 2015 KIMLEY-HORN AND ASSOCIATES, INC.  
6671 LAS VEGAS BLVD S., SUITE 320, LAS VEGAS, NV 89119  
PHONE: 702-862-3600  
WWW.KIMLEY-HORN.COM

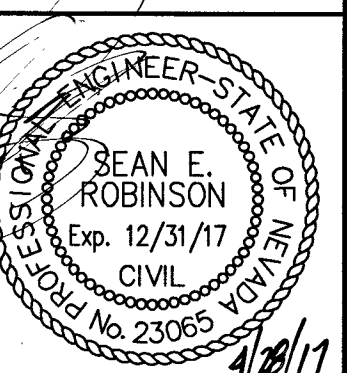

KHA PROJECT	DATE	SCALE	DESIGNED BY	DRAWN BY	CHECKED BY
092373005	4/7/2017	AS SHOWN	SEAN E. ROBINSON	MAH	RAM

DEMOLITION,  
HORIZONTAL  
CONTROL, AND  
GRADING PLAN

CALIFORNIA HOTEL  
PARKING  
PREPARED FOR  
BOYD GAMING  
CITY OF LAS VEGAS

512-91  
H # 61232  
SHEET NUMBER  
C1.0

Plotted By: H:\Projects\2017\04-27-2017\04-27-2017 - California Hotel Parking Layout.C1.0 - April 27, 2017, 04:32:41pm K:\AV\Civil\092373005 - California Hotel Parking CAD\Plan sheets\092373005-DM\_HIC\_CD.dwg  
 This document, together with the concepts and designs presented herein, is intended only for the specific purpose and client for which it was prepared. Reuse of and improper reliance on this document without written authorization and adaptation by Kimley-Horn and Associates, Inc. shall be without liability to Kimley-Horn and Associates, Inc.

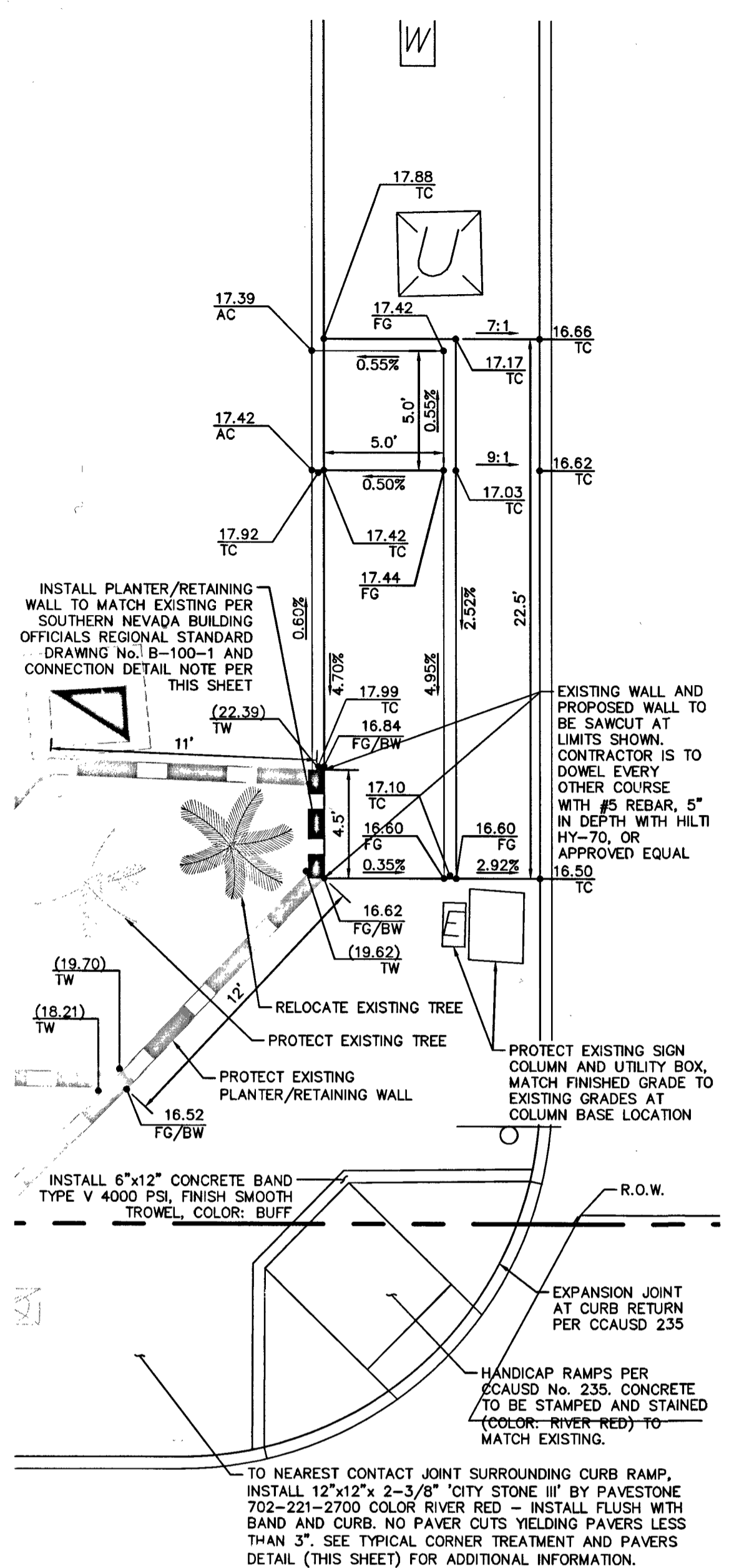

**ADA ACCESS RAMP DETAIL** SCALE: 1"=5'

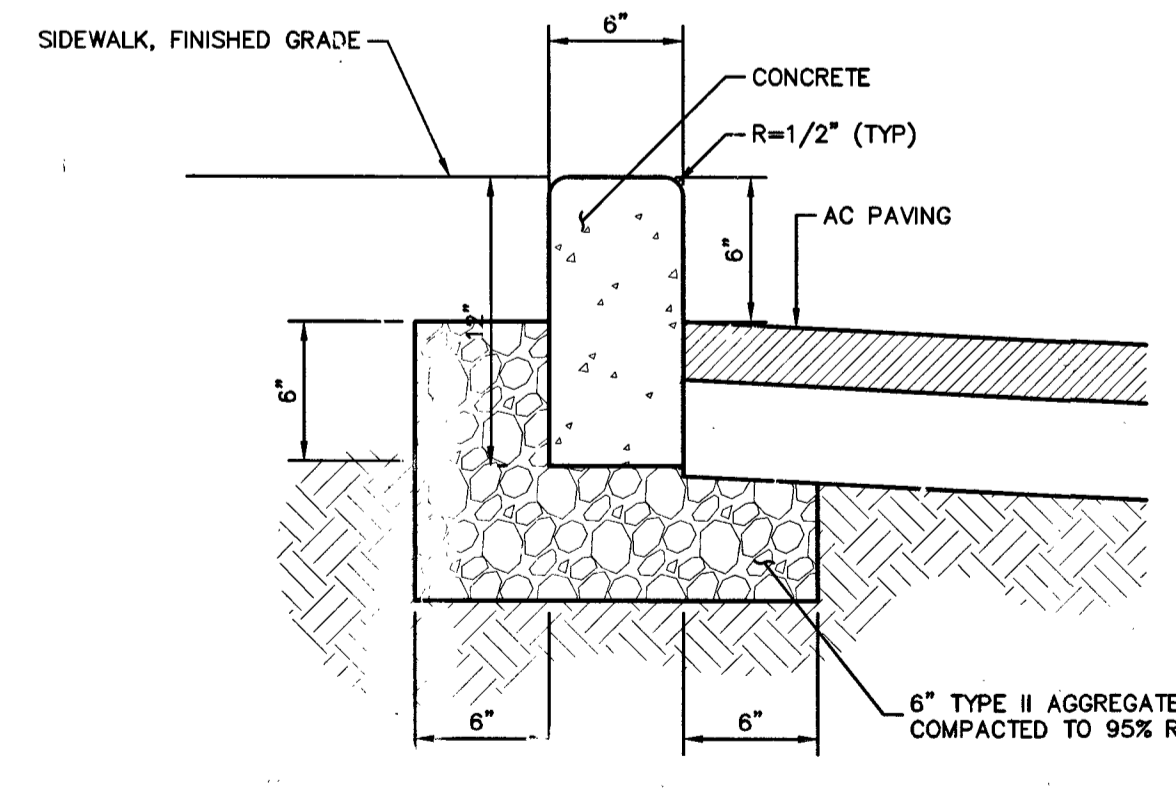

**MODIFIED TYPE 'A' CURB** N.T.S.

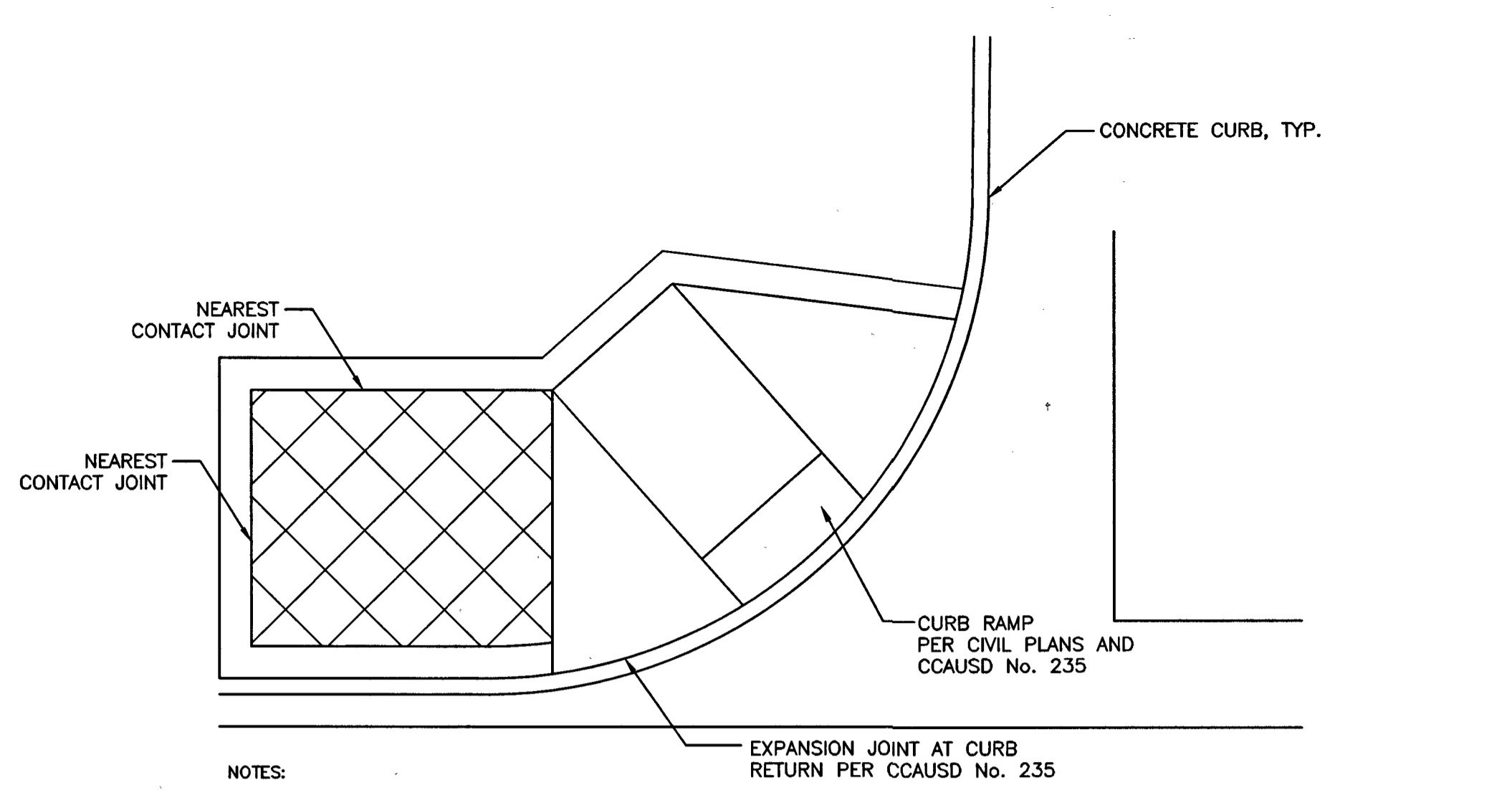

**TYPICAL CORNER TREATMENT** N.T.S.

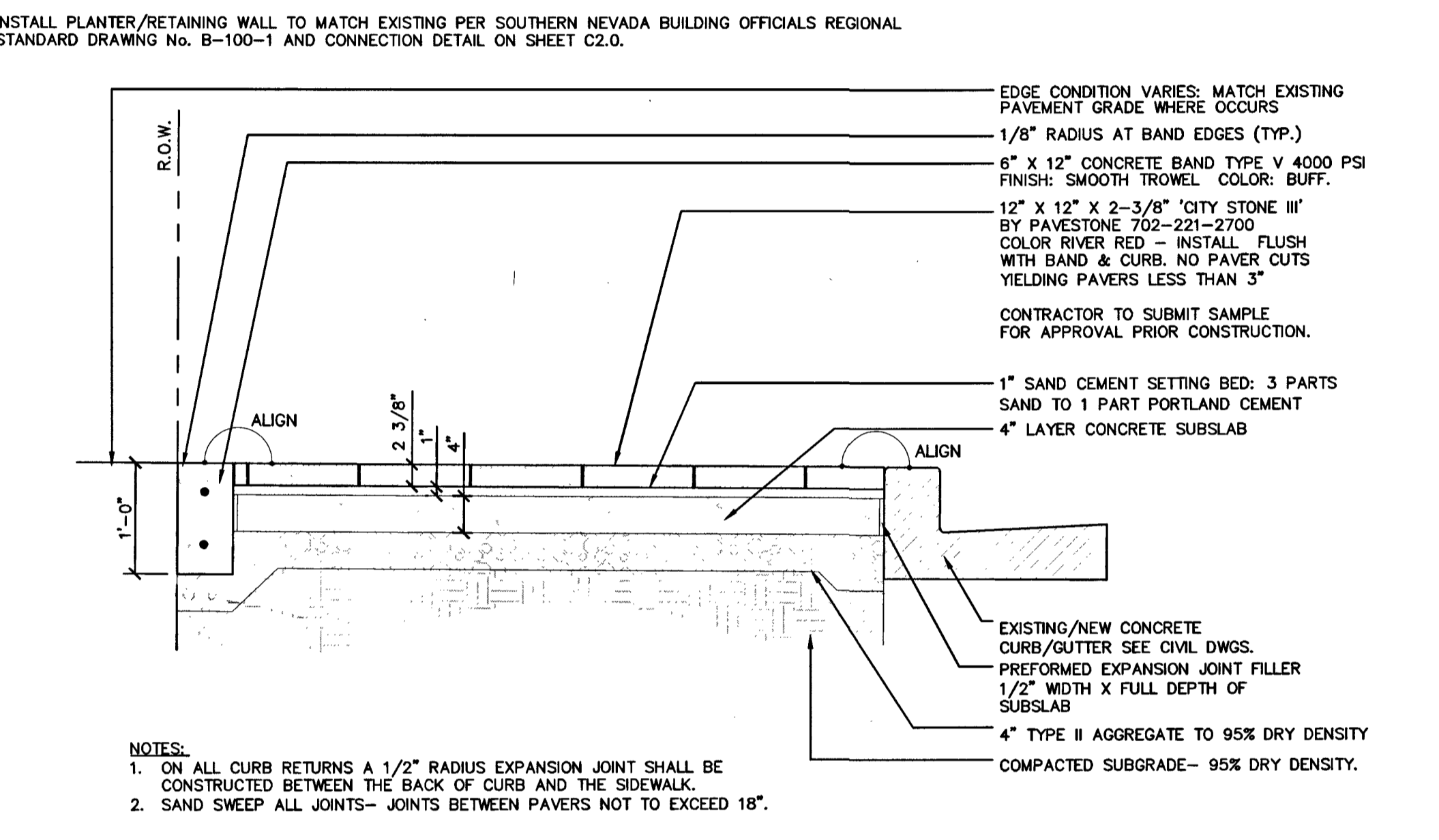

**PAVERS** N.T.S.

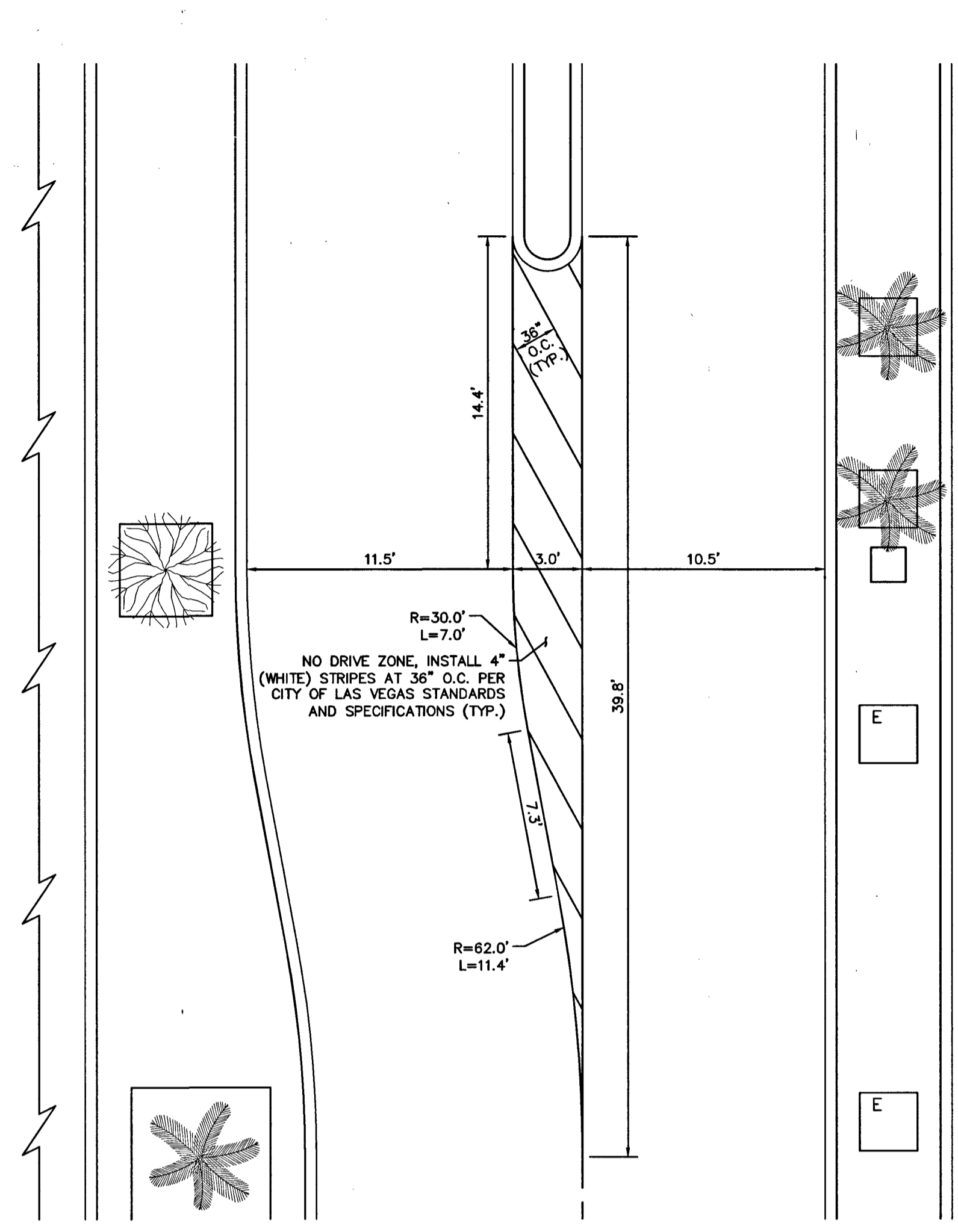

**NO DRIVE ZONE STRIPING DETAIL** SCALE: 1"=5'

**SOUTHERN NEVADA BUILDING OFFICIALS REGIONAL STANDARDS BOLTED LIGHT POLE BASE DETAIL**

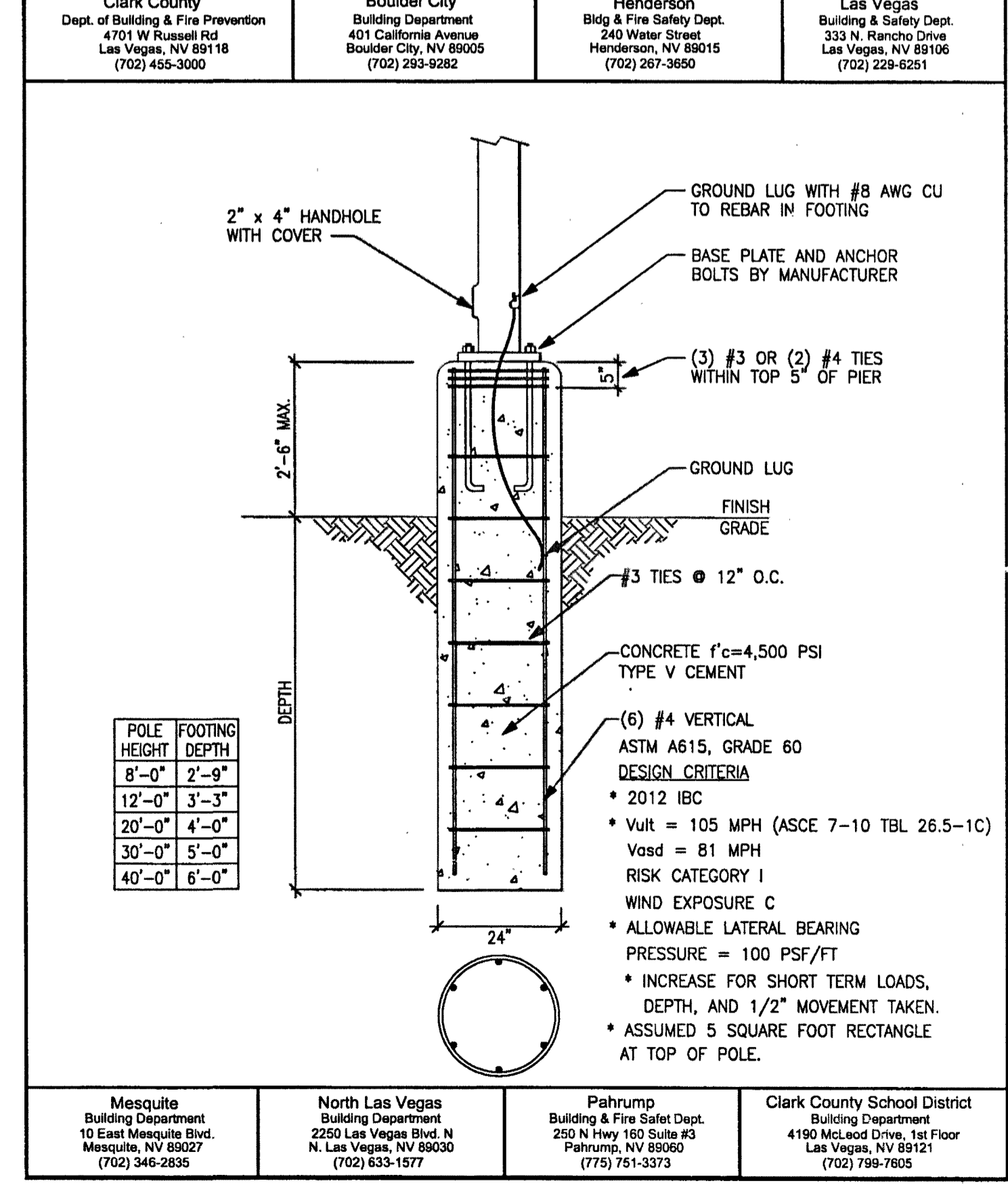

**TYPICAL LIGHT POLE FOUNDATION** N.T.S.

No.	REVISIONS	DATE	BY

**Kimley»Horn**  
 © 2015 KIMLEY-HORN AND ASSOCIATES, INC.  
 6671 LAS VEGAS BLVD S., SUITE 370, LAS VEGAS, NV 89119  
 PHONE: 702-862-3600  
 WWW.KIMLEY-HORN.COM

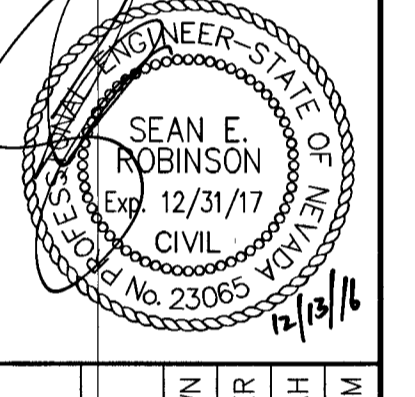

KHA PROJECT	092373005
DATE	12/13/2016
SCALE	AS SHOWN
DESIGNED BY	SER
DRAWN BY	MAH
CHECKED BY	RAM

**DETAIL SHEET**

**CALIFORNIA HOTEL**  
**PARKING**  
 PREPARED FOR  
**BOYD GAMING**  
 CITY OF LAS VEGAS  
 PRO.#: 125320 QS-176-27-SW

APPROVED FOR CONSTRUCTION  
*Y. Dishaieker*  
 LAS VEGAS VALLEY WATER DISTRICT ENGINEERING SERVICES MANAGER  
 DATE 2/22/17 PROJECT No. 125320

Call before you Dig  
 Call before you Dig  
 Call before you Dig  
 1-702-432-5300  
 1-800-227-2600  
 1-702-227-2929