

Plotted By: Smith, Doylein Sheet Set: KHA Layout: KHA October 01, 2025 08:29:04am k:\AV\Civil\192084001-DeCATUR Evergreen MultiFamily Reports\DRAINAGE 02-ADD\Figures\CAD\192084001-EX.dwg

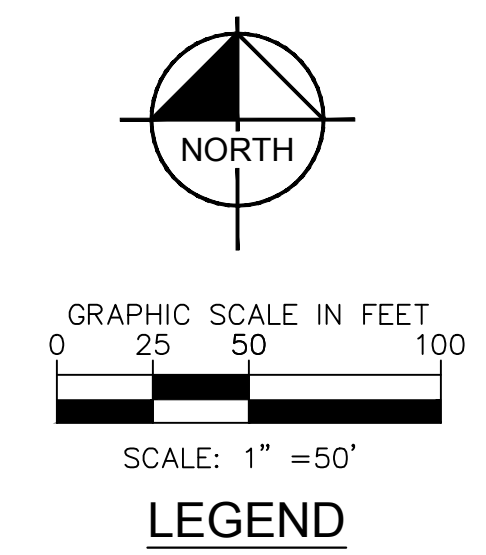
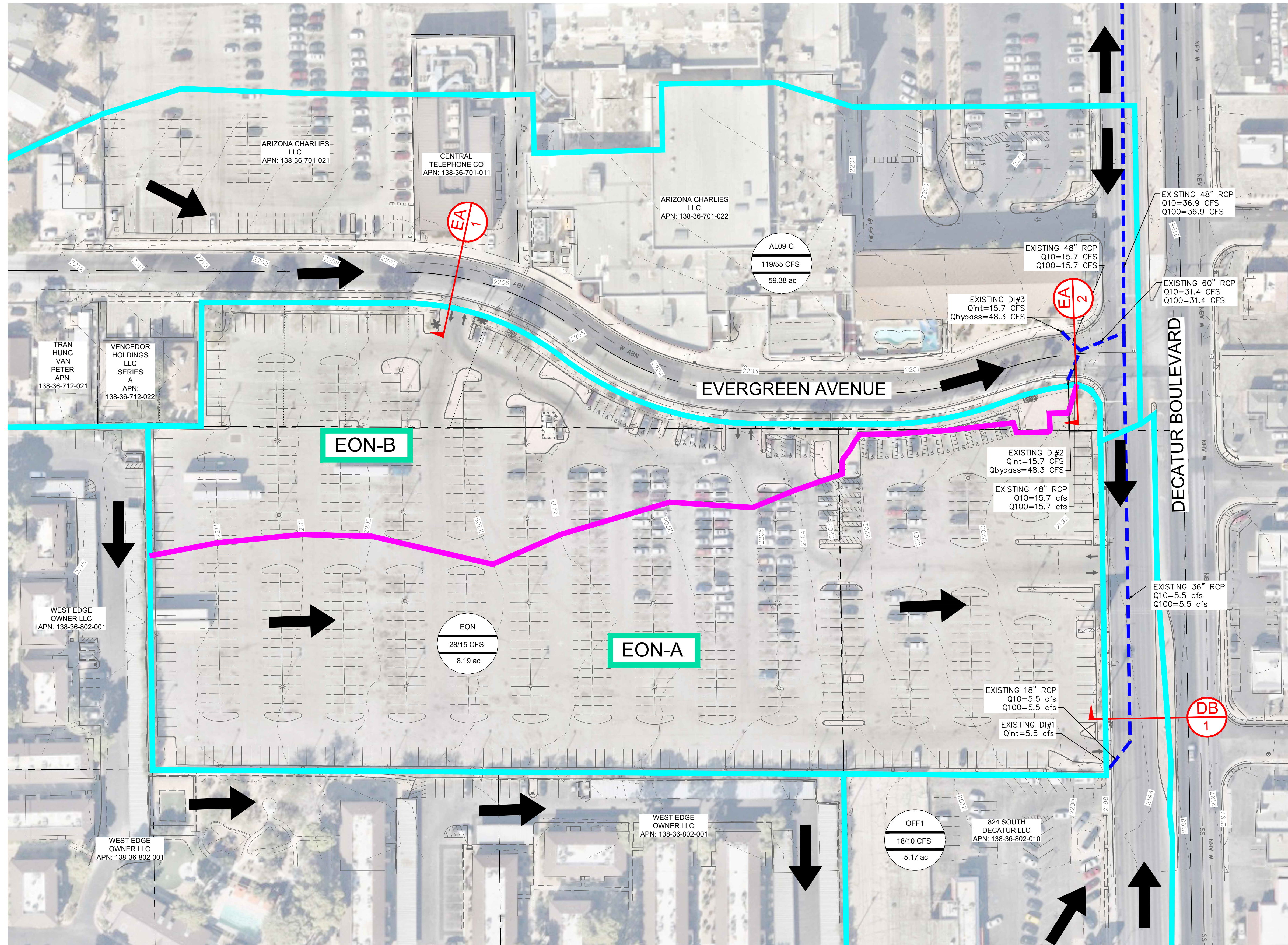

- LEGEND**
- OFF1 BASIN ID
 - 18/10 CFS BASIN ID
 - 5.17 ac BASIN ID
 - PRORATED BASIN BOUNDARY
 - BASIN BOUNDARY
 - XX CFS 100/10YR CFS
 - ➔ FLOW ARROW
 - EXISTING STORM DRAIN
 - XX SECTION ID

EXISTING CONDITION FLOW SUMMARY TABLE

BASIN ID/ COMB. PT.	BASIN AREA (ac)	100-YR FLOW (cfs)	10-YR FLOW (cfs)
AL09-C*	59.38	119	55
EON	8.19	28	15
OFF1	5.17	18	10

*Referenced/Revised from 2023 MPU

EXISTING CONDITION PRORATED FLOW SUMMARY

SUBBASIN	Existing Onsite			
	Q ₁₀₀ (cfs)	Q ₁₀ (cfs)	AREA (ac)	CFS/ACRE ₁₀₀ CFS/ACRE ₁₀
EON	28	15	8.19	3.42 1.83
Existing Onsite Prorated Basins				
SUBBASIN	Q ₁₀₀ (cfs)	Q ₁₀ (cfs)	AREA (ac)	CFS/ACRE ₁₀₀ CFS/ACRE ₁₀
EON-A	19	10	5.57	3.42 1.83
EON-B	9	5	2.62	3.42 1.83
TOTAL	28	15	8.19	NA NA

DROP INLET SUMMARY TABLE

DROP INLET ID	TRIBUTARY BASINS	Q ₁₀₀ (cfs)	SLOPE (%)	FLOW DEPTH (ft)	Q _{INT} (cfs)	Q _{BYP} (cfs)	DI TYPE
DI#1	EON-A + OFF1	37	SUMP	0.5	5.5	31.5	10' Type C
DI#2	AL09-C + EON-B	64	1.2	0.97	15.7	48.3	20' Type C
DI#3	AL09-C + EON-B	64	1.2	0.97	15.7	48.3	20' Type C

EXISTING CONDITIONS STREET HYDRAULIC SECTIONS

STREET SECTION	TRIBUTARY BASINS	STREET HYDRAULIC SECTIONS									
		SLOPE (%)	Q ₁₀₀ (cfs)	FLOW DEPTH (ft)	VELOCITY (ft/s)	D ^{*V} (ft ² /s)	Q ₁₀ (cfs)	FLOW DEPTH (ft)	VELOCITY (ft/s)	D ^{*V} (ft ² /s)	DRY LANE
DB1	EON-A + OFF1 - intercepted	0.46	31.5	0.71	2.78	1.97	14.5	0.57	2.22	1.27	NO
EA1	EON-B + AL09-C	1.30	128.0	0.97	5.86	5.68	60.0	0.82	4.34	3.56	N/A
EA2	AL09-C + EON-B - intercepted	1.20	96.6	0.82	5.43	4.45	28.6	0.57	3.68	2.10	N/A

Kimley-Horn

© 2025 KIMLEY-HORN AND ASSOCIATES, INC.
6871 LAS VEGAS BLVD. S., SUITE 320, LAS VEGAS, NV 89119
PHONE: 702-862-3600
WWW.KIMLEY-HORN.COM

NO. _____

REVISIONS _____

DATE _____

KHA PROJECT: 192084001

DATE: 08/28/2025

SCALE: AS SHOWN

DESIGNED BY: CH

DRAWN BY: DS

CHECKED BY: JZ

ONSITE EXISTING CONDITIONS BASIN MAP

DECATUR & EVERGREEN MIXED-USE PROJECT

PREPARED FOR FORE GREEN DEVELOPMENT LLC

CITY OF LAS VEGAS, NEVADA

EX-2