

**LEGEND**

- EXISTING STORM DRAIN
- PROPOSED STORM DRAIN

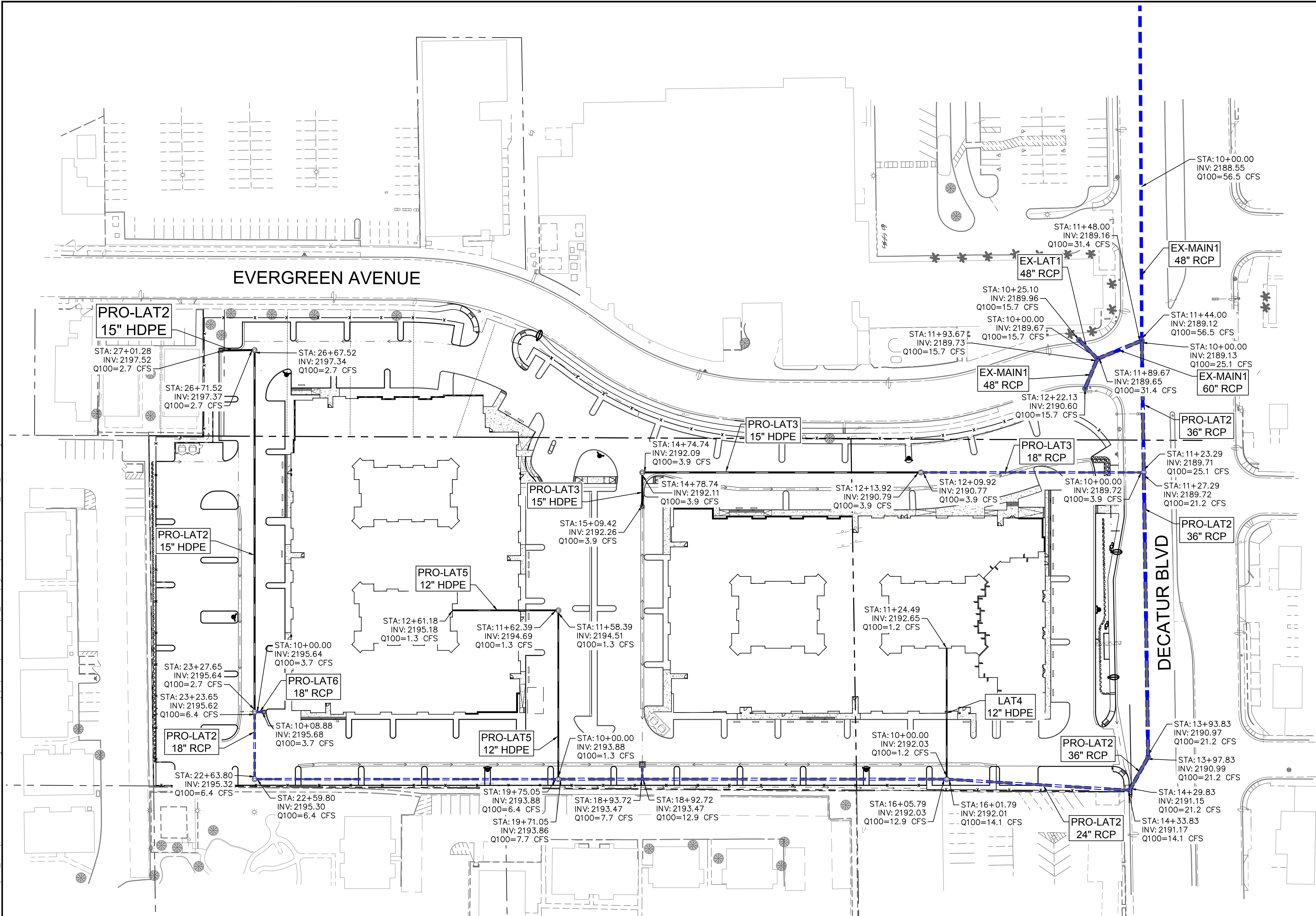

EVERGREEN AVENUE

DECATUR BLVD

PRO-MAIN1					
Station	Invert	Q <sub>100</sub> (cfs)	WSPGW Depth (ft)	Pipe size	CP/Basin
10+00.00	2188.55	56.5	4.00	48" RCP	AL09-C + DON1
11+44.00	2189.12	56.5	3.60	48" RCP	
11+48.00	2189.16	31.4	3.95	60" RCP	
11+89.67	2189.65	31.4	3.45	60" RCP	
11+93.67	2189.73	15.7	3.47	48" RCP	
12+22.129	2190.60	15.7	2.58	36" RCP	

PRO-LAT1					
Station	Invert	Q <sub>100</sub> (cfs)	WSPGW Depth (ft)	Pipe size	CP/Basin
10+00.00	2189.67	15.7	3.53	48" RCP	AL09-C + DON1-C
10+25.10	2189.96	15.7	3.24	48" RCP	

PRO-LAT2					
Station	Invert	Q <sub>100</sub> (cfs)	WSPGW Depth (ft)	Pipe size	CP/Basin
10+00.00	2189.13	25.10	3.98	36" RCP	DON1-B + DON1-A + DON1-D
11+23.29	2189.71	25.10	3.58	36" RCP	
11+27.29	2189.73	21.20	3.67	36" RCP	
13+93.83	2190.97	21.20	2.67	36" RCP	+ DON1-E + DON1-H + OFF1 + DON1-F
13+97.83	2190.99	21.20	2.65	36" RCP	
14+29.83	2191.15	21.20	2.51	36" RCP	DON1-B + DON1-A + DON1-D
14+33.83	2191.17	14.10	2.73	36" RCP	
16+01.79	2192.01	14.10	2.54	24" RCP	+ DON1-E + DON1-H + OFF1
16+05.79	2192.03	12.90	2.63	24" RCP	
18+05.79	2192.03	12.90	2.63	24" RCP	+ DON1-E + DON1-H
18+92.72	2193.47	12.90	2.13	24" RCP	
18+93.72	2193.47	7.70	2.47	24" RCP	DON1-B + DON1-A + DON1-D
18+97.72	2193.47	7.70	2.47	24" RCP	
19+71.05	2193.86	7.70	2.17	24" RCP	+ DON1-E
19+75.05	2193.88	6.40	2.21	24" RCP	
22+59.80	2195.30	6.40	1.84	18" RCP	DON1-B + DON1-A + DON1-D
22+63.80	2195.32	6.40	1.91	18" RCP	
23+23.65	2195.62	6.40	1.83	18" RCP	DON1-B + DON1-A
23+27.65	2195.64	2.70	2.16	15" HDPE	
26+67.52	2197.34	2.70	1.02	15" HDPE	DON1-B
26+71.52	2197.37	2.70	0.99	15" HDPE	
27+01.28	2197.52	2.70	0.88	15" HDPE	

PRO-LAT3					
Station	Invert	Q <sub>100</sub> (cfs)	WSPGW Depth (ft)	Pipe size	CP/Basin
10+00.00	2189.72	3.9	3.68	18" RCP	DON1-F
12+09.92	2190.77	3.9	2.92	18" RCP	
12+13.92	2190.79	3.9	2.91	15" HDPE	
14+74.74	2192.09	3.9	2.56	15" HDPE	
14+78.74	2192.11	3.9	2.61	15" HDPE	
15+09.42	2192.26	3.9	2.57	15" HDPE	

PRO-LAT5					
Station	Invert	Q <sub>100</sub> (cfs)	WSPGW Depth (ft)	Pipe size	CP/Basin
10+00.00	2193.88	1.30	2.21	12" HDPE	DON1-D
11+58.39	2194.51	1.30	1.79	12" HDPE	
11+62.39	2194.69	1.30	1.63	12" HDPE	
12+61.18	2195.18	1.30	1.27	12" HDPE	

PRO-LAT6					
Station	Invert	Q <sub>100</sub> (cfs)	WSPGW Depth (ft)	Pipe size	CP/Basin
10+00.00	2195.64	3.7	2.16	18" RCP	DON1-A
10+08.88	2195.684	3.7	2.127	18" RCP	

PRO-LAT4					
Station	Invert	Q <sub>100</sub> (cfs)	WSPGW Depth (ft)	Pipe size	CP/Basin
10+00.00	2192.03	1.20	2.64	12" HDPE	DON1-H
11+24.49	2192.65	1.20	2.16	12" HDPE	

NO.
REVISIONS
DATE
BY

© 2025 KIMLEY-HORN AND ASSOCIATES, INC.  
6671 LAS VEGAS BLVD S., SUITE 300, LAS VEGAS, NV 89119  
PHONE: 702-862-3600  
WWW.KIMLEY-HORN.COM

**PROPOSED CONDITION  
WSPG EXHIBIT**

KHA PROJECT  
192084001

DATE  
07/28/2025

SCALE AS SHOWN

DESIGNED BY CH

DRAWN BY DS

CHECKED BY JZ

**DECATUR & EVERGREEN  
MIXED-USE PROJECT**  
PREPARED FOR  
FORE GREEN DEVELOPMENT LLC

WSPG2

CITY OF LAS VEGAS NEVADA

Plotted By: Smith, Doin Sheet Set: KHA Layout: KHA July 28, 2025 10:29:37am K:\AV\_Civil\192084001-Decoratur Evergreen MultiFamily\Reports\DRAINAGE\01-TDS\Figures\CAD\192084001\_PRO\_WSPG.dwg