

## Application Information

25-0141-RQR1 - REQUIRED REVIEW - PUBLIC HEARING - APPLICANT: OUTFRONT MEDIA - OWNER: WMC PAVILIONS SPE, LLC - For possible action on a Land Use Entitlement project request for a Required Review of an approved Rezoning (Z-0100-97) THAT ALLOWED AN EXISTING 80-FOOT TALL, 14-FOOT BY 48-FOOT OFF-PREMISE SIGN on property bounded by U.S. 95, Interstate 15 and Grand Central Parkway (APN 139-33-511-004), PD (Planned Development) Zone, Ward 5 (Summers-Armstrong). Staff recommends APPROVAL.

## Application Location



The proposed project may not pertain to the entire highlighted project site.

## Public Hearing Information

**Meeting:** City Council  
**Date:** 05/07/2025  
**Location:** City Council Chambers  
495 South Main St, 2<sup>nd</sup> Fl.  
Las Vegas, Nevada  
**Time:** 9:30 a.m.

Any and all interested persons may appear and be heard at said meeting, or may, prior thereto, file written objections thereto or approvals thereof with the City Clerk, 2nd Floor, City Hall, 495 South Main Street, Las Vegas, Nevada, 89101. For more information, go to [www.lasvegasnevada.gov/meetings](http://www.lasvegasnevada.gov/meetings) or call (702) 229-6311 (TTY 7-1-1). Note that postcards received after an agenda posts will not be reflected online until after the meeting; however they are made available to the members of the governing body for their consideration prior to the meeting.

## Application Information

25-0141-RQR1 - REQUIRED REVIEW - PUBLIC HEARING - APPLICANT: OUTFRONT MEDIA - OWNER: WMC PAVILIONS SPE, LLC - For possible action on a Land Use Entitlement project request for a Required Review of an approved Rezoning (Z-0100-97) THAT ALLOWED AN EXISTING 80-FOOT TALL, 14-FOOT BY 48-FOOT OFF-PREMISE SIGN on property bounded by U.S. 95, Interstate 15 and Grand Central Parkway (APN 139-33-511-004), PD (Planned Development) Zone, Ward 5 (Summers-Armstrong). Staff recommends APPROVAL.

## Application Location



The proposed project may not pertain to the entire highlighted project site.

## Public Hearing Information

**Meeting:** City Council  
**Date:** 05/07/2025  
**Location:** City Council Chambers  
495 South Main St, 2<sup>nd</sup> Fl.  
Las Vegas, Nevada  
**Time:** 9:30 a.m.

Any and all interested persons may appear and be heard at said meeting, or may, prior thereto, file written objections thereto or approvals thereof with the City Clerk, 2nd Floor, City Hall, 495 South Main Street, Las Vegas, Nevada, 89101. For more information, go to [www.lasvegasnevada.gov/meetings](http://www.lasvegasnevada.gov/meetings) or call (702) 229-6311 (TTY 7-1-1). Note that postcards received after an agenda posts will not be reflected online until after the meeting; however they are made available to the members of the governing body for their consideration prior to the meeting.

City of Las Vegas, Office of The City Clerk  
495 South Main Street, 2<sup>nd</sup> Floor  
Las Vegas, Nevada 89101

**Return Service Requested**  
**Official Notice of Public Hearing**

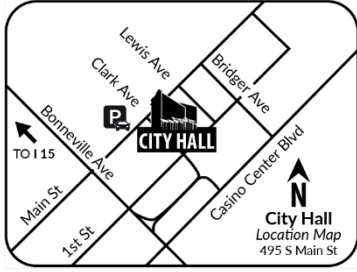

Scan or go to:

[www.lasvegasnevada.gov/meetings](http://www.lasvegasnevada.gov/meetings)

For additional information, scan the QR Code, select the meeting date shown below and then find the referenced project. To file your protest or support on this request, check one box below and return this card in an envelope with postage to the Office Of The City Clerk at the above address or fax this side of this card to (702) 382-4803. If you would like to contact your Council Representative, please call (702) 229-6405.

I SUPPORT  
this Request

I OPPOSE  
this Request

Please use available blank space on card for your comments.

**25-0141-RQR1**

City Council Meeting of **05/07/2025**

25-0141-RQR1  
13927401001  
A N C ASSOCIATES L L C  
2790 S TORREY PINES AVE  
LAS VEGAS NV 89146

PRSRT  
FIRST CLASS MAIL  
U.S. Postage  
**PAID**  
Las Vegas, NV  
Permit No. 1630

City of Las Vegas, Office of The City Clerk  
495 South Main Street, 2<sup>nd</sup> Floor  
Las Vegas, Nevada 89101

**Return Service Requested**  
**Official Notice of Public Hearing**

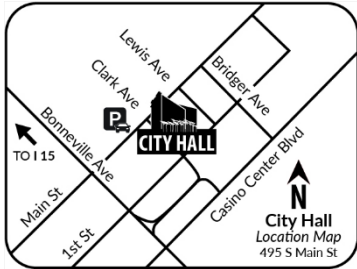

Scan or go to:

[www.lasvegasnevada.gov/meetings](http://www.lasvegasnevada.gov/meetings)

For additional information, scan the QR Code, select the meeting date shown below and then find the referenced project. To file your protest or support on this request, check one box below and return this card in an envelope with postage to the Office Of The City Clerk at the above address or fax this side of this card to (702) 382-4803. If you would like to contact your Council Representative, please call (702) 229-6405.

I SUPPORT  
this Request

I OPPOSE  
this Request

Please use available blank space on card for your comments.

**25-0141-RQR1**

City Council Meeting of **05/07/2025**

25-0141-RQR1  
13927401002  
NEVADA READY MIX CORPORATION  
151 CASSIA WAY  
HENDERSON NV 89014-6616

PRSRT  
FIRST CLASS MAIL  
U.S. Postage  
**PAID**  
Las Vegas, NV  
Permit No. 1630

Label Total 86						
PARCEL	OWNER	ADDRESS1	ADDRESS2	ADDRESS3	ADDRESS4	CASE
13927401001	A N C ASSOCIATES L L C	2790 S TORREY PINES AVE	LAS VEGAS NV 89146			25-0141-RQR1
13927401002	NEVADA READY MIX CORPORATION	151 CASSIA WAY	HENDERSON NV 89014-6616			25-0141-RQR1
13927401003	UNION PACIFIC RAILROAD COMPANY	1400 DOUGLAS	STOP 1640	OMAHA NE 68179-0001		25-0141-RQR1
13927401004	MAXIMUS PRIME PROPERTIES L L C	716 W MESQUITE AVE	LAS VEGAS NV 89106-4612			25-0141-RQR1
13927401005	MAXIMUS PRIME PROPERTIES L L C	716 W MESQUITE AVE	LAS VEGAS NV 89106-4612			25-0141-RQR1
13927401006	NEVADA READY MIX CORPORATION	151 CASSIA WAY	HENDERSON NV 89014-6616			25-0141-RQR1
13927401007	NEVADA READY MIX CORPORATION	151 CASSIA WAY	HENDERSON NV 89014-6616			25-0141-RQR1
13927401010	MAMMOTH UNDERGROUND L L C	421 W BONANZA RD	LAS VEGAS NV 89106			25-0141-RQR1
13927401011	MAMMOTH UNDERGROUND L L C	421 W BONANZA RD	LAS VEGAS NV 89106			25-0141-RQR1
13927401012	WORTHEN RONALD W FAMILY TRUST	108 WORTHEN CIR	LAS VEGAS NV 89145			25-0141-RQR1
13927401019	KURTH REVOCABLE TRUST	KURTH ROBERT O & LAURA L TRS	6220 BRENT LN	LAS VEGAS NV 89131		25-0141-RQR1
13927401020	KURTH REVOCABLE TRUST	KURTH ROBERT O & LAURA L TRS	6220 BRENT LN	LAS VEGAS NV 89131		25-0141-RQR1
13927401021	MAMMOTH UNDERGROUND L L C	421 W BONANZA RD	LAS VEGAS NV 89106			25-0141-RQR1
13927401022	TSAGRINOS VASSILIOS	6715 ARVILLE ST	LAS VEGAS NV 89118			25-0141-RQR1
13927401027	UNION PACIFIC RAILROAD COMPANY	1400 DOUGLAS	STOP 1640	OMAHA NE 68179-0001		25-0141-RQR1
13927401030	UNION PACIFIC RAILROAD COMPANY	1400 DOUGLAS	STOP 1640	OMAHA NE 68179-0001		25-0141-RQR1
13927401039	MESQUITEWOOD L L C	830 PARK PASEO	LAS VEGAS NV 89104			25-0141-RQR1
13927401041	301 MESQUITE L L C	3201 CAHUENGA BLVD W	LOS ANGELES CA 90068			25-0141-RQR1
13927401042	CITY PARKWAY V INC	495 S MAIN ST 6TH FLR	LAS VEGAS NV 89101-6318			25-0141-RQR1
13927401043	UNION PACIFIC RAILROAD COMPANY	1400 DOUGLAS	STOP 1640	OMAHA NE 68179-0001		25-0141-RQR1
13927402008	M S W INC	6465 S RAINBOW BLVD	LAS VEGAS NV 89118-3215			25-0141-RQR1
13927410005	W M C PAVILIONS S P E L L C	475 S GRAND CENTRAL PKWY # 1615	LAS VEGAS NV 89106			25-0141-RQR1
13927410011	P H G S A L L C	100 N CITY PKWY # 140	LAS VEGAS NV 89106			25-0141-RQR1
13927410014	SOUTHERN NEVADA WATER AUTHORITY	PO BOX 99956	LAS VEGAS NV 89193-9956			25-0141-RQR1
13927410015	SOUTHERN NEVADA WATER AUTHORITY	PO BOX 99956	MAIL STOP 95	LAS VEGAS NV 89193		25-0141-RQR1
13927410016	SOUTHERN NEVADA WATER AUTHORITY	PO BOX 99956	MAIL STOP 95	LAS VEGAS NV 89193		25-0141-RQR1
13927410018	SOUTHERN NEVADA WATER AUTHORITY	1001 S VALLEY VIEW BLVD	LAS VEGAS NV 89153			25-0141-RQR1
13927410019	SOUTHERN NEVADA WATER AUTHORITY	1001 S VALLEY VIEW BLVD	LAS VEGAS NV 89153			25-0141-RQR1
13927410020	SOUTHERN NEVADA WATER AUTHORITY	1001 S VALLEY VIEW BLVD	LAS VEGAS NV 89153			25-0141-RQR1
13927410021	PARKWAY CENTER L L C	100 N CITY PKWY # 140	LAS VEGAS NV 89106			25-0141-RQR1
13927410022	PARKWAY CENTER L L C	100 N CITY PKWY # 140	LAS VEGAS NV 89106			25-0141-RQR1
13927410023	PARKWAY CENTER L L C	100 N CITY PKWY # 140	LAS VEGAS NV 89106			25-0141-RQR1
13927410024	PARKWAY CENTER L L C	100 N CITY PKWY # 140	LAS VEGAS NV 89106			25-0141-RQR1
13927410025	PARKWAY CENTER L L C	100 N CITY PKWY # 140	LAS VEGAS NV 89106			25-0141-RQR1
13927410026	PARKWAY CENTER L L C	100 N CITY PKWY # 140	LAS VEGAS NV 89106			25-0141-RQR1
13928801015	S G PROPERTIES L L C	2001 JOSHUA RD	LAFAYETTE HILL PA 19444			25-0141-RQR1
13928802001	N V D D HOLDING R P 5 L L C	4830 E CARTIER AVE	LAS VEGAS NV 89115			25-0141-RQR1
13933501019	COUNTY OF CLARK	500 S GRAND CENTRAL PKWY 4TH FLOOR	LAS VEGAS NV 89155			25-0141-RQR1
13933501021	S P M L K L L C	8965 S EASTERN AVE # 360	LAS VEGAS NV 89123			25-0141-RQR1
13933501024	M L K SPUR L L C	8965 S EASTERN AVE # 360	LAS VEGAS NV 89123			25-0141-RQR1
13933501027	UNITED WAREHOUSE L P ETAL	UNITED LANDCO L P	8965 S EASTERN AVE STE 360	LAS VEGAS NV 89123		25-0141-RQR1

PARCEL	OWNER	ADDRESS1	ADDRESS2	ADDRESS3	ADDRESS4	CASE
13933510002	ASHLEY REAL ESTATE L L C	1 ASHLEY WAY	ARCADIA WI 54612-1218			25-0141-RQR1
13933510004	ASHLEY REAL ESTATE L L C	1 ASHLEY WAY	ARCADIA WI 54612-1218			25-0141-RQR1
13933510005	ASHLEY REAL ESTATE L L C	1 ASHLEY WAY	ARCADIA WI 54612-1218			25-0141-RQR1
13933510009	ASHLEY REAL ESTATE L L C	ONE ASHLEY WAY	ARCADIA WI 54612			25-0141-RQR1
13933510010	COUNTY OF CLARK	500 S GRAND CENTRAL PKWY 4TH FLOOR	LAS VEGAS NV 89155			25-0141-RQR1
13933511004	W M C PAVILIONS S P E L L C	475 S GRAND CENTRAL PKWY # 1615	LAS VEGAS NV 89106			25-0141-RQR1
13933511009	SYMPHONY PARK MASTER ASSN INC	495 S MAIN ST 6TH FLR	LAS VEGAS NV 89101			25-0141-RQR1
13933511010	SYMPHONY PARK MASTER ASSN INC	495 S MAIN ST 6TH FLR	LAS VEGAS NV 89101			25-0141-RQR1
13933511014	SYMPHONY PARK VEGAS C L L C	ATTN LEGAL DEPT	3990 HILLSBORO PIKE STE 400	NASHVILLE TN 37215		25-0141-RQR1
13933610023	W M C V PHASE 1 S P E L L C	475 S GRAND CENTRAL PKWY # 1615	LAS VEGAS NV 89106			25-0141-RQR1
13933610027	CLEVELAND CLINIC FOUNDATION	9500 EUCLID AVE # HS120	CLEVELAND OH 44195			25-0141-RQR1
13933610028	CITY PARKWAY V INC	495 S MAIN ST 6TH FLOOR	LAS VEGAS NV 89101			25-0141-RQR1
13933610029	J S C SYMPHONY PARK HOTEL L L C	4890 ALPHA RD STE 100	DALLAS TX 75244			25-0141-RQR1
13933610031	W M C V PHASE 3 S P E L L C	475 S GRAND CENTRAL PKWY # 1615	LAS VEGAS NV 89106			25-0141-RQR1
13934101004	T-U P R L L C	1 S MAIN ST	LAS VEGAS NV 89101			25-0141-RQR1
13934101005	T-U P R I I L L C	1 S MAIN ST	LAS VEGAS NV 89101			25-0141-RQR1
13934101006	T-U P R L L C	1 S MAIN ST	LAS VEGAS NV 89101			25-0141-RQR1
13934101007	T-U P R L L C	1 S MAIN ST	LAS VEGAS NV 89101			25-0141-RQR1
13934101009	T-U P R I I L L C	1 S MAIN ST	LAS VEGAS NV 89101			25-0141-RQR1
13934101015	CITY OF LAS VEGAS DOWNTOWN REDEV	425 FREMONT ST	LAS VEGAS NV 89101			25-0141-RQR1
13934110005	P Q HOLDINGS L L C	1 FREMONT ST	LAS VEGAS NV 89101			25-0141-RQR1
13934110009	G T I S-S L C SYMPHONY PARK PROP	3990 HILLSBORO PIKE STE 400	NASHVILLE TN 37215			25-0141-RQR1
13934110011	P Q HOLDINGS L L C	1 FREMONT ST	LAS VEGAS NV 89101			25-0141-RQR1
13934110013	CITY PARKWAY V INC	495 S MAIN ST 6TH FLOOR	LAS VEGAS NV 89101			25-0141-RQR1
13934110014	BRECKENRIDGE GROUP LAS VEGAS NEV	1301 S CAPITAL OF TEXAS HWY # B-201	AUSTIN TX 78746			25-0141-RQR1
13934110015	SYMPHONY PARK VEGAS D L L C	ATTN LEGAL DEPT	3990 HILLSBORO PIKE STE 400	NASHVILLE TN 37215		25-0141-RQR1
13934110016	CITY PARKWAY V INC	495 S MAIN ST 6TH FLR	LAS VEGAS NV 89101-6318			25-0141-RQR1
13934110017	CITY PARKWAY V INC	495 S MAIN ST 6TH FLR	LAS VEGAS NV 89101-6318			25-0141-RQR1
13934112001	18 FREMONT STREET ACQUISTION L L	301 FREMONT ST	LAS VEGAS NV 89111			25-0141-RQR1
13934211001	SMITH CENTER PERFORMING ARTS	361 SYMPHONY PARK AVE	LAS VEGAS NV 89106-1409			25-0141-RQR1
13934211005	CITY PARKWAY V INC	495 S MAIN ST 6TH FLOOR	LAS VEGAS NV 89101			25-0141-RQR1
13927410005	W M C PAVILIONS S P E L L C	475 S GRAND CENTRAL PKWY # 1615	LAS VEGAS NV 89106			25-0141-RQR1
13927410011	P H G S A L L C	100 N CITY PKWY # 140	LAS VEGAS NV 89106			25-0141-RQR1
13927410014	SOUTHERN NEVADA WATER AUTHORITY	PO BOX 99956	LAS VEGAS NV 89193-9956			25-0141-RQR1
13927410015	SOUTHERN NEVADA WATER AUTHORITY	PO BOX 99956	MAIL STOP 95	LAS VEGAS NV 89193		25-0141-RQR1
13927410016	SOUTHERN NEVADA WATER AUTHORITY	PO BOX 99956	MAIL STOP 95	LAS VEGAS NV 89193		25-0141-RQR1
13927410018	SOUTHERN NEVADA WATER AUTHORITY	1001 S VALLEY VIEW BLVD	LAS VEGAS NV 89153			25-0141-RQR1
13927410019	SOUTHERN NEVADA WATER AUTHORITY	1001 S VALLEY VIEW BLVD	LAS VEGAS NV 89153			25-0141-RQR1
13927410020	SOUTHERN NEVADA WATER AUTHORITY	1001 S VALLEY VIEW BLVD	LAS VEGAS NV 89153			25-0141-RQR1
13927410021	PARKWAY CENTER L L C	100 N CITY PKWY # 140	LAS VEGAS NV 89106			25-0141-RQR1
13927410022	PARKWAY CENTER L L C	100 N CITY PKWY # 140	LAS VEGAS NV 89106			25-0141-RQR1
13927410023	PARKWAY CENTER L L C	100 N CITY PKWY # 140	LAS VEGAS NV 89106			25-0141-RQR1

PARCEL	OWNER	ADDRESS1	ADDRESS2	ADDRESS3	ADDRESS4	CASE
13927410024	PARKWAY CENTER L L C	100 N CITY PKWY # 140	LAS VEGAS NV 89106			25-0141-RQR1
13927410025	PARKWAY CENTER L L C	100 N CITY PKWY # 140	LAS VEGAS NV 89106			25-0141-RQR1
13927410026	PARKWAY CENTER L L C	100 N CITY PKWY # 140	LAS VEGAS NV 89106			25-0141-RQR1

## Application Information

25-0145-RQR1 - REQUIRED REVIEW - PUBLIC HEARING - APPLICANT: OUTFRONT MEDIA - OWNER: 300 CHARLESTON APARTMENTS QOZB, LLC - For possible action on a Land Use Entitlement project request for a Required Review of an approved Special Use Permit (U-0008-96) FOR A 40-FOOT TALL, 14-FOOT BY 24-FOOT OFF-PREMISE SIGN at 330 East Charleston Boulevard (APN 162-03-115-001), C-1 (Limited Commercial) Zone, Ward 3 (Diaz). Staff recommends APPROVAL.

## Application Location



The proposed project may not pertain to the entire highlighted project site.

## Public Hearing Information

**Meeting:** City Council  
**Date:** 05/07/2025  
**Location:** City Council Chambers  
495 South Main St, 2<sup>nd</sup> Fl.  
Las Vegas, Nevada  
**Time:** 9:30 a.m.

Any and all interested persons may appear and be heard at said meeting, or may, prior thereto, file written objections thereto or approvals thereof with the City Clerk, 2nd Floor, City Hall, 495 South Main Street, Las Vegas, Nevada, 89101. For more information, go to [www.lasvegasnevada.gov/meetings](http://www.lasvegasnevada.gov/meetings) or call (702) 229-6311 (TTY 7-1-1). Note that postcards received after an agenda posts will not be reflected online until after the meeting; however, they are made available to the members of the governing body for their consideration prior to the meeting.

## Application Information

25-0145-RQR1 - REQUIRED REVIEW - PUBLIC HEARING - APPLICANT: OUTFRONT MEDIA - OWNER: 300 CHARLESTON APARTMENTS QOZB, LLC - For possible action on a Land Use Entitlement project request for a Required Review of an approved Special Use Permit (U-0008-96) FOR A 40-FOOT TALL, 14-FOOT BY 24-FOOT OFF-PREMISE SIGN at 330 East Charleston Boulevard (APN 162-03-115-001), C-1 (Limited Commercial) Zone, Ward 3 (Diaz). Staff recommends APPROVAL.

## Application Location



The proposed project may not pertain to the entire highlighted project site.

## Public Hearing Information

**Meeting:** City Council  
**Date:** 05/07/2025  
**Location:** City Council Chambers  
495 South Main St, 2<sup>nd</sup> Fl.  
Las Vegas, Nevada  
**Time:** 9:30 a.m.

Any and all interested persons may appear and be heard at said meeting, or may, prior thereto, file written objections thereto or approvals thereof with the City Clerk, 2nd Floor, City Hall, 495 South Main Street, Las Vegas, Nevada, 89101. For more information, go to [www.lasvegasnevada.gov/meetings](http://www.lasvegasnevada.gov/meetings) or call (702) 229-6311 (TTY 7-1-1). Note that postcards received after an agenda posts will not be reflected online until after the meeting; however, they are made available to the members of the governing body for their consideration prior to the meeting.

City of Las Vegas, Office of The City Clerk  
495 South Main Street, 2<sup>nd</sup> Floor  
Las Vegas, Nevada 89101

**Return Service Requested**  
**Official Notice of Public Hearing**

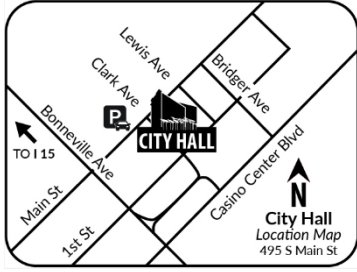

Scan or go to:

[www.lasvegasnevada.gov/meetings](http://www.lasvegasnevada.gov/meetings)

PRSR  
FIRST CLASS MAIL  
U.S. Postage  
**PAID**  
Las Vegas, NV  
Permit No. 1630

For additional information, scan the QR Code, select the meeting date shown below and then find the referenced project. To file your protest or support on this request, check one box below and return this card in an envelope with postage to the Office Of The City Clerk at the above address or fax this side of this card to (702) 382-4803. If you would like to contact your Council Representative, please call (702) 229-6405.

I SUPPORT  
this Request

I OPPOSE  
this Request

Please use available blank space on card for your comments.

**25-0145-RQR1**

City Council Meeting of **05/07/2025**

25-0145-RQR1  
13933801021  
1060 BROADWAY L L C  
1620 S LOS ANGELES ST # C  
LOS ANGELES CA 90015

City of Las Vegas, Office of The City Clerk  
495 South Main Street, 2<sup>nd</sup> Floor  
Las Vegas, Nevada 89101

**Return Service Requested**  
**Official Notice of Public Hearing**

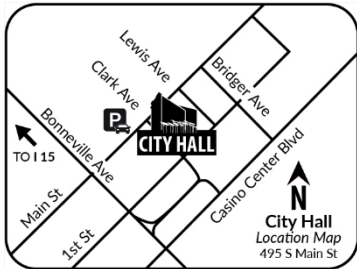

Scan or go to:

[www.lasvegasnevada.gov/meetings](http://www.lasvegasnevada.gov/meetings)

PRSR  
FIRST CLASS MAIL  
U.S. Postage  
**PAID**  
Las Vegas, NV  
Permit No. 1630

For additional information, scan the QR Code, select the meeting date shown below and then find the referenced project. To file your protest or support on this request, check one box below and return this card in an envelope with postage to the Office Of The City Clerk at the above address or fax this side of this card to (702) 382-4803. If you would like to contact your Council Representative, please call (702) 229-6405.

I SUPPORT  
this Request

I OPPOSE  
this Request

Please use available blank space on card for your comments.

**25-0145-RQR1**

City Council Meeting of **05/07/2025**

25-0145-RQR1  
13933801022  
1025 MAIN ST L L C  
1620 S LOS ANGELES ST # C  
LOS ANGELES CA 90015

Label Total 511						
PARCEL	OWNER	ADDRESS1	ADDRESS2	ADDRESS3	ADDRESS4	CASE
13933801021	1060 BROADWAY L L C	1620 S LOS ANGELES ST # C	LOS ANGELES CA 90015			25-0145-RQR1
13933801022	1025 MAIN ST L L C	1620 S LOS ANGELES ST # C	LOS ANGELES CA 90015			25-0145-RQR1
13933801023	ZLIFE AT 1025 MAIN ST L L C	3960 W POINT LOMA BLVD # H-365	SAN DIEGO CA 92110			25-0145-RQR1
13933801024	ARTS CORNER L L C	1620 S LOS ANGELES ST U# C	LOS ANGELES CA 90015			25-0145-RQR1
13933801025	1021 MAIN STREET L L C	1620 SOUTH LOS ANGELES ST UNIT C	LOS ANGELES CA 90015			25-0145-RQR1
13933811015	MOLASKY VENTURES LLC	920 S COMMERCE ST	LAS VEGAS NV 89106			25-0145-RQR1
13933811024	CORDON RODRIGO SALGUARO	IBARRA JOSE A	1019 S MAIN ST	LAS VEGAS NV 89101-6428		25-0145-RQR1
13933811025	MAIN M F L L C	2120 PLAZA DEL PADRE	LAS VEGAS NV 89102			25-0145-RQR1
13933811026	GERBY INVESTMENTS I L L C	2870 S TENAYA WAY	LAS VEGAS NV 89117			25-0145-RQR1
13933811027	M8TRIX L L C	3960 W POINT LOMA BLVD SUITE H 365	SAN DIEGO CA 92110			25-0145-RQR1
13933811029	LAS VEGAS ARTS DISTRICT DEVELOPM	1620 S LOS ANGELES ST # C	LOS ANGELES CA 90015			25-0145-RQR1
13934401004	R R PROPERTIES L L C	801 S 4TH ST	LAS VEGAS NV 89101-6708			25-0145-RQR1
13934401008	JUHL SOUTH L L C	PO BOX 98438	LAS VEGAS NV 89193			25-0145-RQR1
13934401009	JUHL SOUTH L L C	PO BOX 98438	LAS VEGAS NV 89193			25-0145-RQR1
13934401010	M 8 T R I X L L C	3960 W POINT LOMA BLVD STE H # 365	SAN DIEGO CA 92110			25-0145-RQR1
13934401011	CHICKS DIG SCARS L L C	5030 PARADISE RD STE C-214	LAS VEGAS NV 89119			25-0145-RQR1
13934401012	P R M D L L C	823 LAS VEGAS BLVD S # 200	LAS VEGAS NV 89101			25-0145-RQR1
13934401014	NEW BUILDING BLOCK L L C	29 BROADWAY 31ST FLR	NEW YORK NY 10006			25-0145-RQR1
13934401021	R R PROPERTIES L L C	801 S 4TH ST	LAS VEGAS NV 89101			25-0145-RQR1
13934401022	ZOFIA HOLDINGS L L C	3636 BIRCH ST STE 190	NEWPORT BEACH CA 92660			25-0145-RQR1
13934401023	AVANTE L V 6TH ST L L C	3601 W SAHARA AVE STE 207	LAS VEGAS NV 89102			25-0145-RQR1
13934401025	BRIDALVEIL L L C	2601 W DUNLAP AVE # 10	PHOENIX AZ 85021			25-0145-RQR1
13934410011	NEVADA POWER COMPANY	PO BOX 98910	LAS VEGAS NV 89193-8910			25-0145-RQR1
13934410015	M 8 T R I X L L C	3960 W POINT LOMA BLVD STE H # 365	SAN DIEGO CA 92110			25-0145-RQR1
13934410016	M 8 T R I X L L C	3960 W POINT LOMA BLVD STE H # 365	SAN DIEGO CA 92110			25-0145-RQR1
13934410017	M 8 T R I X L L C	3960 W POINT LOMA BLVD STE H # 365	SAN DIEGO CA 92110			25-0145-RQR1
13934410018	MIDTOWN DEVELOPMENT GROUP L L C	3960 W POINT LOMA BLVD STE H-365	SAN DIEGO CA 92110			25-0145-RQR1
13934410019	LEGAL EXPRESS	911 S 1ST ST	LAS VEGAS NV 89101-6414			25-0145-RQR1
13934410020	C A C L L C	2231 E DESERT INN	LAS VEGAS NV 89169			25-0145-RQR1
13934410032	SIEGEL SUNSET L L C	353 E BONNEVILLE AVE # 621	LAS VEGAS NV 89101			25-0145-RQR1
13934410033	SIEGEL SUNSET L L C	353 E BONNEVILLE AVE # 621	LAS VEGAS NV 89101			25-0145-RQR1
13934410034	SIEGEL SUNSET L L C	353 E BONNEVILLE AVE # 621	LAS VEGAS NV 89101			25-0145-RQR1
13934410035	SIEGEL SUNSET L L C	353 E BONNEVILLE AVE # 621	LAS VEGAS NV 89101			25-0145-RQR1
13934410036	SIEGEL SUNSET L L C	353 E BONNEVILLE AVE # 621	LAS VEGAS NV 89101			25-0145-RQR1
13934410037	SIEGEL SUNSET L L C	353 E BONNEVILLE AVE # 621	LAS VEGAS NV 89101			25-0145-RQR1
13934410038	SIEGEL SUNSET L L C	353 E BONNEVILLE AVE # 621	LAS VEGAS NV 89101			25-0145-RQR1
13934410043	MISSION LINEN BUILDING L L C	1620 S LOS ANGELES ST # 620	LOS ANGELES CA 90015			25-0145-RQR1
13934410044	LAS VEGAS ARTS DISTRICT DEVELOPM	1620 S LOS ANGELES ST # C	LOS ANGELES CA 90015			25-0145-RQR1
13934410045	MISSION LINEN BUILDING L L C	1620 S LOS ANGELES ST # 620	LOS ANGELES CA 90015			25-0145-RQR1
13934410047	201 CHARLESTON L L C	7 COMMERCE CENTER DR	HENDERSON NV 89014			25-0145-RQR1
13934410056	SOLTERRA NEVADA L L C	460 FRASER VIEW PL	DELTA BC CANADA V3M 6H4	CANADA		25-0145-RQR1
13934410057	SOLTERRA NEVADA L L C	460 FRASER VIEW PL	DELTA BC CANADA V3M 6H4	CANADA		25-0145-RQR1
13934410058	SOLTERRA NEVADA L L C	460 FRASER VIEW PL	DELTA BC CANADA V3M 6H4	CANADA		25-0145-RQR1
13934410059	SOLTERRA NEVADA L L C	460 FRASER VIEW PL	DELTA BC CANADA V3M 6H4	CANADA		25-0145-RQR1
13934410060	GROOV STUDIOS L L C	400 S RAMPART BLVD # 220	LAS VEGAS NV 89145			25-0145-RQR1
13934410061	TEMRAZ YASAMAN	425 IRIS AVE	CORONA DEL MAR CA 92625			25-0145-RQR1
13934410077	BLAKE REALTY VENTURES L L C	10912 MOUNT STELLAR ST	LAS VEGAS NV 89179			25-0145-RQR1
13934410078	211 HOOVER L L C	10217 IMPERIAL POINTE AVE	LAS VEGAS NV 89134			25-0145-RQR1
13934410079	SOLTERRA NEVADA L L C	# 1-460 FRASERVIEW PL	DELTA BC CANADA V3M 6H4	CANADA		25-0145-RQR1
13934410080	SOLTERRA NEVADA L L C	# 1-460 FRASERVIEW PL	DELTA BC CANADA V3M 6H4	CANADA		25-0145-RQR1
13934410081	SOLTERRA NEVADA L L C	# 1-460 FRASERVIEW PL	DELTA BC CANADA V3M 6H4	CANADA		25-0145-RQR1
13934410082	SOLTERRA NEVADA L L C	# 1-460 FRASERVIEW PL	DELTA BC CANADA V3M 6H4	CANADA		25-0145-RQR1
13934410083	SOLTERRA NEVADA L L C	# 1-460 FRASERVIEW PL	DELTA BC CANADA V3M 6H4	CANADA		25-0145-RQR1

PARCEL	OWNER	ADDRESS1	ADDRESS2	ADDRESS3	ADDRESS4	CASE
13934410084	SOLTERRA NEVADA L L C	# 1-460 FRASERVIEW PL	DELTA BC CANADA V3M 6H4	CANADA		25-0145-RQR1
13934410085	SOLTERRA NEVADA L L C	# 1-460 FRASERVIEW PL	DELTA BC CANADA V3M 6H4	CANADA		25-0145-RQR1
13934410086	SOLTERRA NEVADA L L C	# 1-460 FRASERVIEW PL	DELTA BC CANADA V3M 6H4	CANADA		25-0145-RQR1
13934410087	WATTENBARGER SURVIVORS TRUST ETA	WATTENBARGER ALVIN W & MARC WILLIAM TRS	1331 DARMAK DR	LAS VEGAS NV 89102		25-0145-RQR1
13934410088	MOVING TO VEGAS LTD	8291 CAMPANA DR	LAS VEGAS NV 89147			25-0145-RQR1
13934410089	P P K L L C	7424 ALICE SPRINGS CIR	LAS VEGAS NV 89129			25-0145-RQR1
13934410090	P P K L L C	7424 ALICE SPRINGS CIR	LAS VEGAS NV 89129			25-0145-RQR1
13934410097	JUHL SOUTH L L C	PO BOX 98438	LAS VEGAS NV 89193			25-0145-RQR1
13934410098	JUHL SOUTH L L C	PO BOX 98438	LAS VEGAS NV 89193			25-0145-RQR1
13934410099	JUHL SOUTH L L C	PO BOX 98438	LAS VEGAS NV 89193			25-0145-RQR1
13934410100	JUHL SOUTH L L C	PO BOX 98438	LAS VEGAS NV 89193			25-0145-RQR1
13934410101	JUHL SOUTH L L C	CITY OF LAS VEGAS LEASE	PO BOX 98438	LAS VEGAS NV 89193		25-0145-RQR1
13934410104	THIRD STREET DWELLINGS L L C	1406 S 3RD ST	LAS VEGAS NV 89104			25-0145-RQR1
13934410105	L C R 823 SOUTH 3RD ST II L L C	111 S WACKER DR STE 3350	CHICAGO IL 60606			25-0145-RQR1
13934410106	TEMRAZ YASAMAN	425 IRIS AVE	CORONA DEL MAR CA 92625			25-0145-RQR1
13934410107	TEMRAZ YASAMAN	9 MACARTHUR PL # N1509	SANTA ANA CA 92707			25-0145-RQR1
13934410108	TEMRAZ YASAMAN	9 MACARTHUR PL # N1509	SANTA ANA CA 92707			25-0145-RQR1
13934410124	LEIGH LYNN & JAMES L L C	800 S 4TH ST	LAS VEGAS NV 89101-6709			25-0145-RQR1
13934410125	H G SUNFLOWER L L C	PEREZ NORBERTO	850 E DESERT INN # 1008	LAS VEGAS NV 89109		25-0145-RQR1
13934410126	COLLURA LIVINGS FAMILY REVOCABLE	COLLURA JOSEPH WILLIAM TRS	3220 BRYANT AVE	LAS VEGAS NV 89102-2055		25-0145-RQR1
13934410131	JUHL SOUTH L L C	PO BOX 98438	LAS VEGAS NV 89193			25-0145-RQR1
13934410132	T & N INVESTMENTS L L C	2340 PASEO DEL PRADO # D307	LAS VEGAS NV 89102-4342			25-0145-RQR1
13934410133	T & N INVESTMENTS L L C	2340 PASEO DEL PRADO # D307	LAS VEGAS NV 89102-4342			25-0145-RQR1
13934410137	4TH & CHARLESTON L L C	3571 PAMA LN	LAS VEGAS NV 89120-2948			25-0145-RQR1
13934410138	CHARLESTON SUITES L L C	3790 PARADISE RD # 250	LAS VEGAS NV 89169-4640			25-0145-RQR1
13934410139	L V B D CHARLESTON LAND HOLDINGS	3790 PARADISE RD STE 250	LAS VEGAS NV 89169			25-0145-RQR1
13934410140	CENTRO 910 L L C	910 S LAS VEGAS BLVD	LAS VEGAS NV 89101-6823			25-0145-RQR1
13934410142	R R PROPERTIES L L C	801 S FOURTH STREET	LAS VEGAS NV 89101-6708			25-0145-RQR1
13934410143	R R PROPERTIES L L C	801 S FOURTH ST	LAS VEGAS NV 89101-6708			25-0145-RQR1
13934410144	R R PROPERTIES L L C	801 S FOURTH ST	LAS VEGAS NV 89101-6708			25-0145-RQR1
13934410160	E T Z G B L V B L L C	PO BOX 51089	SPARKS NV 89435			25-0145-RQR1
13934410161	E T Z G B L V B L L C	PO BOX 51089	SPARKS NV 89435			25-0145-RQR1
13934410162	E T Z G B L V B L L C	PO BOX 51089	SPARKS NV 89435			25-0145-RQR1
13934410164	CENTRO 910 L L C	910 S LAS VEGAS BLVD	LAS VEGAS NV 89101-6823			25-0145-RQR1
13934410165	L V B D CHARLESTON LAND HOLDINGS	3790 PARADISE RD STE 250	LAS VEGAS NV 89169			25-0145-RQR1
13934410166	SIMON INC	2624 SPALDING DR	LAS VEGAS NV 89134-7550			25-0145-RQR1
13934410167	GAY & LESBIAN COMMUNITY CENTER S	401 S MARYLAND PKWY	LAS VEGAS NV 89101			25-0145-RQR1
13934410168	GAY & LESBIAN COMMUNITY CENTER S	401 S MARYLAND PKWY	LAS VEGAS NV 89101			25-0145-RQR1
13934410169	GAY & LESBIAN COMMUNITY CENTER S	401 S MARYLAND PKWY	LAS VEGAS NV 89101			25-0145-RQR1
13934410170	P R M D L L C	823 LAS VEGAS BLVD S # 200	LAS VEGAS NV 89101			25-0145-RQR1
13934410200	GAY & LESBIAN COMMUNITY CENTER S	401 S MARYLAND PKWY	LAS VEGAS NV 89101			25-0145-RQR1
13934410201	DIAMOND RICHARD & S 2004 REV TR	DIAMOND RICHARD N & SUSAN TRS	24518-B WINDSOR DR	VALENCIA CA 91355-4427		25-0145-RQR1
13934410202	DIAMOND RICHARD & S 2004 REV TR	DIAMOND RICHARD N & SUSAN TRS	24518-B WINDSOR DR	VALENCIA CA 91355-4427		25-0145-RQR1
13934410252	CLARK COUNTY AUCTION BUILDING L	930 S FOURTH ST # 125	LAS VEGAS NV 89101			25-0145-RQR1
13934410257	251 CHARLESTON L L C	200 HOOVER AVE # 2111	LAS VEGAS NV 89101-6886			25-0145-RQR1
13934410262	201 CHARLESTON L L C	11771 KINGLAND AVE	LAS VEGAS NV 89138			25-0145-RQR1
13934410263	201 CHARLESTON L L C	11771 KINGLAND AVE	LAS VEGAS NV 89138			25-0145-RQR1
16203101001	LVOZ L L C	465 S MEADOWS PKWY # 6	RENO NV 89521			25-0145-RQR1
16203102001	777 SOUTH 4TH L L C	555 S 3RD ST	LAS VEGAS NV 89101			25-0145-RQR1
16203105002	AMBER KIMBALL LIMITED PARTNERSHI	6230 MCLEOD DR # 100	LAS VEGAS NV 89120			25-0145-RQR1
16203105006	B K NEVADA INVESTMENTS L L C	BLVD SERIES 1 L L C	3726 LAS VEGAS BLVD S # 3005W	LAS VEGAS NV 89158		25-0145-RQR1
16203105007	2113 INVESTORS L L C	4185 W POST RD STE F	LAS VEGAS NV 89118			25-0145-RQR1
16203105009	197 E CALIFORNIA STREET L L C	197 E CALIFORNIA AVE STE 201	LAS VEGAS NV 89104			25-0145-RQR1
16203105010	MAIN STREET INVESTMENTS II L L C	PO BOX 93033	LAS VEGAS NV 89193			25-0145-RQR1

PARCEL	OWNER	ADDRESS1	ADDRESS2	ADDRESS3	ADDRESS4	CASE
16203105011	CORNER BUILDING L L C	1000 N GREEN VALLEY PKWY STE 440-350	HENDERSON NV 89074			25-0145-RQR1
16203105012	GLASER G BARRY J ETAL	LEW DAVID L	2470 OAK ST	SANTA MONICA CA 90405		25-0145-RQR1
16203105014	ARTHAUS DE L L C	2808 ASHWORTH CIR	LAS VEGAS NV 89107			25-0145-RQR1
16203105016	JET MAIN HOLDINGS L L C	3534 COCHISE LN	LAS VEGAS NV 89169			25-0145-RQR1
16203105017	3RD STREET L L C	2921 N TENAYA WAY	LAS VEGAS NV 89128			25-0145-RQR1
16203105019	VEGAS ARTS OWNER L L C	3990 HILLSBORO PIKE STE 400	NASHVILLE TN 37215			25-0145-RQR1
16203105020	VEGAS ARTS OWNER L L C	3990 HILLSBORO PIKE STE 400	NASHVILLE TN 37215			25-0145-RQR1
16203105021	VEGAS ARTS OWNER L L C	3990 HILLSBORO PIKE STE 400	NASHVILLE TN 37215			25-0145-RQR1
16203106001	941 N MARTEL AVE L L C	5722 SOTO ST L L C	9201 WILSHIRE BLVD # 202	BEVERLY HILLS CA 90210		25-0145-RQR1
16203110002	OEHLER 1992 TRUST	OEHLER ROBERT J & MARILYN CO-TRS	2115 TENAYA WAY	LAS VEGAS NV 89117-2008		25-0145-RQR1
16203110003	OEHLER 1992 TRUST	OEHLER ROBERT J & MARILYN CO-TRS	2115 TENAYA WAY	LAS VEGAS NV 89117-2008		25-0145-RQR1
16203110004	OEHLER 1992 TRUST	OEHLER ROBERT J & MARILYN CO-TRS	2115 TENAYA WAY	LAS VEGAS NV 89117-2008		25-0145-RQR1
16203110011	BELVILLAGE VEGAS L L C	10800 BISCAYNE BLVD STE 620	N MIAMI FL 33161			25-0145-RQR1
16203110024	VILLAGE COURTYARD SERIES IV L L	2005 PINTO LN	LAS VEGAS NV 89106-4018			25-0145-RQR1
16203110025	VILLAGE COURTYARD SERIES III L L	2005 PINTO LN	LAS VEGAS NV 89106-4018			25-0145-RQR1
16203110026	VILLAGE COURTYARD SERIES II L L	2005 PINTO LN	LAS VEGAS NV 89106-4018			25-0145-RQR1
16203110027	VILLAGE COURTYARD SERIES I L L C	2005 PINTO LN	LAS VEGAS NV 89106-4018			25-0145-RQR1
16203110034	LEGACY INVESTMENT L L C SERIES 8	7489 THORNSBY CT	LAS VEGAS NV 89120			25-0145-RQR1
16203110035	NUWU ART L L C	2620 S MARYLAND PKWY STE 14-167	LAS VEGAS NV 89109			25-0145-RQR1
16203110036	3RD & CHARLESTON L L C	9911 COVINGTON CROSS DR # 100	LAS VEGAS NV 89144			25-0145-RQR1
16203110037	NUWU ART L L C	2620 S MARYLAND PKWY STE 14-167	LAS VEGAS NV 89109			25-0145-RQR1
16203110038	CHARLEY L L C	2231 E DESERT INN RD	LAS VEGAS NV 89169			25-0145-RQR1
16203110039	CHARLEY L L C	2331 E DESERT INN RD	LAS VEGAS NV 89169			25-0145-RQR1
16203110040	CHARLEY L L C	2331 E DESERT INN RD	LAS VEGAS NV 89169			25-0145-RQR1
16203110044	K L A CAPITAL SERIES L L C SER 7	1818 INDUSTRIAL RD UNIT 101	LAS VEGAS NV 89102			25-0145-RQR1
16203110045	4 A M I S L L C	36 QUIET MOON LN	LAS VEGAS NV 89135			25-0145-RQR1
16203110047	ADAMS BRIAN M	712 S 8TH ST	LAS VEGAS NV 89101-7007			25-0145-RQR1
16203110048	ADAMS BRIAN M	712 S 8TH ST	LAS VEGAS NV 89101-7007			25-0145-RQR1
16203110049	ADAMS BRIAN M	712 S 8TH ST	LAS VEGAS NV 89101			25-0145-RQR1
16203110050	LV BUILDINGS L L C	2595 FREMONT	LAS VEGAS NV 89104-2203			25-0145-RQR1
16203110051	S H R A INVESTMENT L L C	8440 W LAKE MEAD BLVD	LAS VEGAS NV 89128			25-0145-RQR1
16203110052	BRUNO IRR SPENDTHRIFT TR AGMT	SPOSITO GINA M CO-TRS	3127 SUNDOWN DR	LAS VEGAS NV 89169-2544		25-0145-RQR1
16203110053	RAW REMEDIES L L C	247 WINDSONG DR	HENDERSON NV 89115			25-0145-RQR1
16203110054	RAW REMEDIES L L C	1901 S 16TH ST	LAS VEGAS NV 89104			25-0145-RQR1
16203110055	YANG FAMILY TRUST	YANG HENRY & JEFFREY TRS	1432 RICHARDS AVE	SAN JOSE CA 95125		25-0145-RQR1
16203110056	ICONIUM CORPORATION L L C	2877 PARADISE RD # 2206	LAS VEGAS NV 89109			25-0145-RQR1
16203110063	E A E PROPERTY L L C	8440 W LAKE MEAD BLVD # 100	LAS VEGAS NV 89128			25-0145-RQR1
16203110064	MAMA'S HOUSE L L C	232 EMERALD VISTA WAY	LAS VEGAS NV 89144			25-0145-RQR1
16203110065	LOPEZ MARIO & MARTHA REBECCA	1400 LANDING BAY AVE	HENDERSON NV 89074-6083			25-0145-RQR1
16203110066	1212 CASINO CENTER L L C	400 S RAMPART BLVD STE 220	LAS VEGAS NV 89145			25-0145-RQR1
16203110067	DOWNTOWN PARKING L L C	PO BOX 93033	LAS VEGAS NV 89193			25-0145-RQR1
16203110071	ARTS CENTER L V L L C	25 MEADOWLARK DR	HENDERSON NV 89014			25-0145-RQR1
16203110072	1108 CASINO CENTER L L C	1108 S CASINO CENTER BLVD	LAS VEGAS NV 89104			25-0145-RQR1
16203110074	B K NEVADA INVESTMENTS L L C	BLVD SERIES 2 L L C	3726 LAS VEGAS BLVD S # 3005W	LAS VEGAS NV 89158		25-0145-RQR1
16203110075	4 CHARLESTON PARTNERS L L C	L & J INVESTMENT L L C	3049 S LAS VEGAS BLVD STE 11N	LAS VEGAS NV 89109		25-0145-RQR1
16203110076	L & J INVESTMENT L L C	625 NORTH WEST KNOLL DR	WEST HOLLYWOOD CA 90069			25-0145-RQR1
16203110077	L & J INVESTMENT L L C	625 NORTH WEST KNOLL DR	WEST HOLLYWOOD CA 90069			25-0145-RQR1
16203110078	1119 HOLDINGS L L C	840 S RANCHO DR ST 4-631	LAS VEGAS NV 89106			25-0145-RQR1
16203110079	1121 MAIN L L C	650 S MAIN ST	LAS VEGAS NV 89101			25-0145-RQR1
16203110082	MAIN STREET INVESTMENTS I L L C	PO BOX 93033	LAS VEGAS NV 89193			25-0145-RQR1
16203110083	MAIN STREET LAS VEGAS L L C	3395 S JONES BLVD # 202	LAS VEGAS NV 89146-6729			25-0145-RQR1
16203110105	TSAI FAMILY LIMITED PARTNERSHIP	323 E MAIN ST	ALHAMBRA CA 91801-3958			25-0145-RQR1
16203110106	1120 VEGAS L L C	227 MIDLAND AVE # 11B	BASALT CO 81621-8114			25-0145-RQR1
16203110107	ZANTAN PROPERTIES L L C	8709 RED RIO DR # 103	LAS VEGAS NV 89128-8433			25-0145-RQR1

PARCEL	OWNER	ADDRESS1	ADDRESS2	ADDRESS3	ADDRESS4	CASE
16203110108	1100 S MAIN L L C	105 W CHARLESTON BLVD	LAS VEGAS NV 89102			25-0145-RQR1
16203110140	ART DISTRICT PARTNERS INVESTMENT	625 N WEST KNOLL DR	WEST HOLLYWOOD CA 90069			25-0145-RQR1
16203110141	ART DISTRICT PARTNERS INVESTMENT	625 N WEST KNOLL DR	WEST HOLLYWOOD CA 90069			25-0145-RQR1
16203111012	SOUTH FOURTH ST L L C	1200 S 4TH ST # 102	LAS VEGAS NV 89104			25-0145-RQR1
16203112001	MEGDAL BLUE L L C ETAL	MEGDAL INDIGO L L C	252 S BEVERLY DR STE C	BEVERLY HILLS CA 90212		25-0145-RQR1
16203112002	SSTI 1120 S LAS VEGAS BLVD L L C	PO BOX 800729	DALLAS TX 75380			25-0145-RQR1
16203112003	Y S B M INVESTMENT L L C	8360 W SAHARA AVE STE 260	LAS VEGAS NV 89117			25-0145-RQR1
16203112004	Y S B M INVESTMENT L L C	8360 W SAHARA AVE STE 260	LAS VEGAS NV 89117			25-0145-RQR1
16203112005	1200 S LAS VEGAS BLVD L L C	9201 WILSHIRE BLVD STE 202	BEVERLY HILL CA 90210			25-0145-RQR1
16203112012	PISTOL RAYMOND	724 CLAYTON AVE	LAS VEGAS NV 89110			25-0145-RQR1
16203112013	TARIGHI BAHMAN & FARIDEH	1300 LAS VEGAS BLVD S	LAS VEGAS NV 89104-1325			25-0145-RQR1
16203112017	1200 S LAS VEGAS BLVD L L C	9201 WILSHIRE BLVD STE 202	BEVERLY HILLS CA 90210			25-0145-RQR1
16203112018	BLVD L L C	1050 RANCHO CIR	LAS VEGAS NV 89107-4623			25-0145-RQR1
16203112021	3250 SPRING MOUNTAIN TRUST	LOVE LANNY D TRS	3850 W TROPICANA AVE # D	LAS VEGAS NV 89103		25-0145-RQR1
16203112022	516 PARK PASEO L L C	9201 WILSHIRE BLVD # 202	BEVERLY HILLS CA 90210			25-0145-RQR1
16203112028	1213 S LAS VEGAS BLVD L L C	CAPITAL FORESIGHT GOLF & FITNESS L L C	9201 WILSHIRE BLVD # 202	BEVERLY HILLS CA 90210		25-0145-RQR1
16203112029	1215 S LAS VEGAS BLVD L L C	C F SATICOY L P	9201 WILSHIRE BLVD # 202	BEVERLY HILLS CA 90210		25-0145-RQR1
16203112030	777 SOUTH 4TH L L C	555 S 3RD ST	LAS VEGAS NV 89101			25-0145-RQR1
16203112031	777 SOUTH 4TH L L C	555 S 3RD ST	LAS VEGAS NV 89101			25-0145-RQR1
16203112032	SHALIMAR HOTEL ENTERPRISES	1401 S LAS VEGAS BLVD	LAS VEGAS NV 89104-1327			25-0145-RQR1
16203112033	CAPITAL FORESIGHT GOLF & FITNESS	1215 LAS VEGAS BLVD L L C	9201 WILSHIRE BLVD # 202	BEVERLY HILLS CA 90210		25-0145-RQR1
16203112034	L D L TRUST	LOVE LANNY D TRS	3850 W TROPICANA AVE	LAS VEGAS NV 89103		25-0145-RQR1
16203112035	L D L TRUST	LOVE LANNY DEAN TRS	3850 W TROPICANA # D	LAS VEGAS NV 89103		25-0145-RQR1
16203112036	L D L TRUST	LOVE LANNY DEAN TRS	3850 W TROPICANA # D	LAS VEGAS NV 89103		25-0145-RQR1
16203112041	CHARLESTON 550 L L C	550 E CHARLESTON BLVD	LAS VEGAS NV 89104-1576			25-0145-RQR1
16203112042	6TH & CHARLESTON L L C	26 MEADOWHAWK LN	LAS VEGAS NV 89135			25-0145-RQR1
16203113001	PORJES DANIEL MARC	1100 5TH PL	LAS VEGAS NV 89104			25-0145-RQR1
16203113002	MARYNOW ROBERT S	1414 HINSON ST	LAS VEGAS NV 89102-3803			25-0145-RQR1
16203113003	AREA IDM L L C	1110 5TH PL	LAS VEGAS NV 89104			25-0145-RQR1
16203113004	LOFTSGAARDEN COURTNEY ELIZABETH	1112 5TH PL	LAS VEGAS NV 89104			25-0145-RQR1
16203113005	1213 S LAS VEGAS BLVD L L C	CAPITAL FORESIGHT GOLF & FITNESS L L C	9201 WILSHIRE BLVD # 202	BEVERLY HILLS CA 90210		25-0145-RQR1
16203113006	ORTIZ JOSE CHARLES	THOMPSON KELLIE	1114 5TH PL	LAS VEGAS NV 89104		25-0145-RQR1
16203113007	SMARK INVESTMENTS L L C	6742 BEL CANTO CT	LAS VEGAS NV 89139			25-0145-RQR1
16203113008	NOTABARTOLO JOHN V & LEANNE	1122 5TH PL	LAS VEGAS NV 89104			25-0145-RQR1
16203113013	KORGAN FAMILY TRUST	KORGAN TODD M & KATHRYN M TRS	400 PARK WAY E	LAS VEGAS NV 89106		25-0145-RQR1
16203113014	ST FRANCIS SAVES THE ANIMALS TRU	WINKELHORN KARIN-MARIE KUTUZOV TRS	1107 S 5TH PL	LAS VEGAS NV 89104-1413		25-0145-RQR1
16203113015	NEILLUKE L L C SERIES 19	56-155 KAMEHAMEHA HWY UNIT D	KAHUKU HI 96731			25-0145-RQR1
16203113016	GANSON MICHAEL	1100 S 6TH ST	LAS VEGAS NV 89104-1540			25-0145-RQR1
16203114002	LAKEWEST LAS VEGAS PPTYS L L C	PO BOX 1159	DEERFIELD IL 60015			25-0145-RQR1
16203114003	1121 LAS VEGAS BLVD L L C	3850 W TROPICANA AVE # D	LAS VEGAS NV 89103			25-0145-RQR1
16203115001	300 CHARLESTON APARTMENTS Q O Z	26050 BUREAU RD STE 101	CALABASAS CA 91302			25-0145-RQR1
16203115002	300 CHARLESTON APARTMENTS Q O Z	26050 BUREAU RD STE 101	CALABASAS CA 91302			25-0145-RQR1
16203116001	1200 S LAS VEGAS BLVD L L C	9201 WILSHIRE BLVD STE 202	BEVERLY HILLS CA 90210			25-0145-RQR1
16203116002	1200 S LAS VEGAS BLVD L L C	9201 WILSHIRE BLVD STE 202	BEVERLY HILL CA 90210			25-0145-RQR1
16203116003	1200 S LAS VEGAS BLVD L L C	9201 WILSHIRE BLVD STE 202	BEVERLY HILL CA 90210			25-0145-RQR1
16203116004	1200 S LAS VEGAS BLVD L L C	9201 WILSHIRE BLVD STE 202	BEVERLY HILLS CA 90210			25-0145-RQR1
16203116005	1200 S LAS VEGAS BLVD L L C	9201 WILSHIRE BLVD STE 202	BEVERLY HILLS CA 90210			25-0145-RQR1
16203116006	WRIGHT YESENIA	4117 CRYSTAL ISLAND AVE	NORTH LAS VEGAS NV 89081			25-0145-RQR1
16203116007	DESERT STAR MOTEL ENTERPRISES	1401 LAS VEGAS BLVD S	LAS VEGAS NV 89104-1327			25-0145-RQR1
16203116008	CAPREOLA LTD	609 CHASE TREE ST	LAS VEGAS NV 89126			25-0145-RQR1
16203116009	1200 S LAS VEGAS BLVD L L C	9201 WILSHIRE BLVD STE 202	BEVERLY HILLS CA 90210			25-0145-RQR1
16203117001	YANG FAMILY TRUST ETAL	YANG HENRY & CONNIE TRS	1432 RICHARDS AVE	SAN JOSE CA 95125		25-0145-RQR1
16203201001	LVOZ L L C	465 S MEADOWS PKWY # 6	RENO NV 89521			25-0145-RQR1
16203202001	SHALIMAR HOTEL ENTERPRISES	1401 LAS VEGAS BLVD S	LAS VEGAS NV 89104			25-0145-RQR1

PARCEL	OWNER	ADDRESS1	ADDRESS2	ADDRESS3	ADDRESS4	CASE
16203213054	SHALIMAR HOTEL ENTERPRISES	1401 LAS VEGAS BLVD S	LAS VEGAS NV 89104-1327			25-0145-RQR1
16203501001	HELLFIRE MEDIA L L C	33 PROMONTORY RIDGE DR	LAS VEGAS NV 89135			25-0145-RQR1
16203501005	HELLFIRE MEDIA L L C	33 PROMONTORY RIDGE DR	LAS VEGAS NV 89135			25-0145-RQR1
13934411001	REILLY MICHAEL D & PATRICIA REV TR	REILLY MICHAEL D & PATRICIA TRS	38045 S GOLF COURSE DR	TUCSON AR 85739		25-0145-RQR1
13934411002	VULETIC DANIJEL	900 S LAS VEGAS BLVD UNIT 702	LAS VEGAS NV 89101			25-0145-RQR1
13934411003	BOOK LINDA S REVOCABLE TRUST	BOOK LINDA S TRS	3944 PARKVIEW DR	SALT LAKE CITY UT 84124-2324		25-0145-RQR1
13934411004	BURDA DOUGLAS BENJAMIN	8876 SPANISH RIDGE AVE STE 204	LAS VEGAS NV 89148			25-0145-RQR1
13934411005	MANAGEMENT AND MEDIA GROUP L L C	900 S LAS VEGAS BLVD UT 705	LAS VEGAS NV 89101			25-0145-RQR1
13934411006	MCGEE RONALD	900 LAS VEGAS BLVD S # 706	LAS VEGAS NV 89101			25-0145-RQR1
13934411007	COLE DARREN LEE	900 LAS VEGAS BLVD S # 707	LAS VEGAS NV 89101-6848			25-0145-RQR1
13934411008	A J W 708 TRUST ETAL	ZBORONOVA ZUZANA TRS	900 LAS VEGAS BLVD S # 708	LAS VEGAS NV 89101		25-0145-RQR1
13934411009	SORAYA MEHRAN	BOHN CASEY	PO BOX 5523	EDMOND OK 73083		25-0145-RQR1
13934411010	STEINMAN STUART & FRANCISCA	371 ADAMS	SIERRA MADRE CA 91204			25-0145-RQR1
13934411011	STAMAT DYLAN TRAVIS	900 S LAS VEGAS BLVD # 711	LAS VEGAS NV 89101			25-0145-RQR1
13934411012	HARVEY NOEL	PAK-HARVEY HELEN	3211 US HWY 70 W	EFLAND NC 27243		25-0145-RQR1
13934411013	SEGAL ADAM P	900 S LAS VEGAS BLVD # 713	LAS VEGAS NV 89101			25-0145-RQR1
13934411014	Z-VEGAS HOLDINGS L L C	1500 BROADWAY 24TH FL	NEW YORK NY 10036			25-0145-RQR1
13934411015	MORRISSEY MARY TRUST	MORRISSEY MARY CECELIA TRS	806 O ST	PORT TOWNSEND WA 98368		25-0145-RQR1
13934411016	SINGH FAMILY TRUST	SINGH BEDI AJAY & BHARATHI GOVINDASWAMI TRS	2216 MANHATTAN AVE	MANHATTAN BEACH CA 90266		25-0145-RQR1
13934411017	GOEKEN CODY MICHAEL	900 S LAS VEGAS BLVD UNIT 801	LAS VEGAS NV 89101			25-0145-RQR1
13934411018	EMPIRE S K 1 L L C	900 S LAS VEGAS BLVD # 803	LAS VEGAS NV 89101-6850			25-0145-RQR1
13934411019	EMPIRE S K MASTER L L C	900 S LAS VEGAS BLVD # 803	LAS VEGAS NV 89101-6850			25-0145-RQR1
13934411020	VITALE GILLES	2877 PARADISE RD # 1004	LAS VEGAS NV 89109			25-0145-RQR1
13934411021	PARK JI-YOON	505 HARVARD AVE	SANTA CLARA CA 95051-6015			25-0145-RQR1
13934411022	XU JUN	CARTERETTE NATHAN ANDREW	900 S LAS VEGAS BLVD UNIT 806	LAS VEGAS NV 89101		25-0145-RQR1
13934411023	IQBAL MOHAMED A	900 LAS VEGAS BLVD S # 807	LAS VEGAS NV 89101			25-0145-RQR1
13934411024	MORENO DANIEL PAUL	3401 STIRRUP AVE	PAHRUMP NV 89048			25-0145-RQR1
13934411025	ANDREWS GREGORY	727 WILCOX AVE # 401	LOS ANGELES CA 90038			25-0145-RQR1
13934411026	LAS VEGAS BOULEVARD SOUTH TRUST	PO BOX 36208	LAS VEGAS NV 89133-6208			25-0145-RQR1
13934411027	SMALL HOUSE L L C	38045 S GOLF COURSE DR	TUCSON AZ 85739			25-0145-RQR1
13934411028	PERKINS RONALD	TRIPOLI-PERKINS TARA DUREE	900 S LAS VEGAS BLVD # 812	LAS VEGAS NV 89101		25-0145-RQR1
13934411029	KAUTH MICHAEL	900 LAS VEGAS BLVD S # 813	LAS VEGAS NV 89101			25-0145-RQR1
13934411030	RICHARDSON SCOTT DAEMON	4179 SPARROW ROCK ST	LAS VEGAS NV 89129			25-0145-RQR1
13934411031	M J M V INVESTMENTS L L C NEV SERIES	1137 BUEHLER DR	LAS VEGAS NV 89102			25-0145-RQR1
13934411032	RAMACHANDRAN PARTHIBAN	27315 N 64TH LN	PHOENIX AZ 85083			25-0145-RQR1
13934411033	JACKSON VICTOR	175 S LAKE AVE # 405	PASADENA CA 91101			25-0145-RQR1
13934411034	LOWE BRENT	3729 VINTON AVE # 101	LOS ANGELES CA 90034-5970			25-0145-RQR1
13934411035	SONG JIHO	8190 DOGWOOD RD	GERMANTOWN TN 38139			25-0145-RQR1
13934411036	GEBHART DAVID S	2430 VICTORY PARK LN # 2104	DALLAS TX 75219-7606			25-0145-RQR1
13934411037	BURDA DOUGLAS BENJAMIN	163 ELDER VIEW DR	LAS VEGAS NV 89138			25-0145-RQR1
13934411038	SHERIDAN CHARLES	900 S LAS VEGAS BLVD UNIT 906	LAS VEGAS NV 89101			25-0145-RQR1
13934411039	ELLING HENRY & CANDACE	9188 WIGHEIL ST	SUFFOLK VA 22433			25-0145-RQR1
13934411040	EMPIRE S K 2 L L C	900 S LAS VEGAS BLVD # 803	LAS VEGAS NV 89101-6850			25-0145-RQR1
13934411041	MCMAHON JAMES CHRISTPHER	3012 PANORAMA RIDGE	HENDERSON NV 89052			25-0145-RQR1
13934411042	MUTZHAUS GLORIA CONSTANCE	900 S LAS VEGAS BLVD UNIT 910	LAS VEGAS NV 89101			25-0145-RQR1
13934411043	COZZENS CHRIS R	9700 HAIRLOOM CT	LAS VEGAS NV 89134			25-0145-RQR1
13934411044	900AY L L C	200 HOOVER AVE UNIT 2111	LAS VEGAS NV 89101			25-0145-RQR1
13934411045	RUSSELL GARRICK MICHAEL	900 S LAS VEGAS BLVD # 913	LAS VEGAS NV 89101			25-0145-RQR1
13934411046	TSE ERIC GEE & JOANNA LEE HUSBAND & WIFE GRTR TR	TSE ERIC GEE CHO & JOANNA LEE TRS	450 LANSDALE AVE	SAN FRANCISCO CA 94127		25-0145-RQR1
13934411047	BRODEY LAWRENCE B & CAROL M	647 INWOOD LN	SOUTH ORANGE NJ 07079-1107			25-0145-RQR1
13934411048	CHONKO FAMILY L L C SERIES 2	8255 S LAS VEGAS BLVD UNIT 1606	LAS VEGAS NV 89123			25-0145-RQR1
13934411049	JALILI FRANK & ARALEE S	900 S LAS VEGAS BLVD # 1001	LAS VEGAS NV 89101			25-0145-RQR1
13934411050	PRITCHARD JASON C & KIMBERLY L	900 S LAS VEGAS BLVD # 1002	LAS VEGAS NV 89101-6850			25-0145-RQR1
13934411051	CLARK DOUGLAS ADRON	ORMSBY NANCY KAY	112 NORTH GRANT ST	BEULAVILLE NC 28518		25-0145-RQR1

PARCEL	OWNER	ADDRESS1	ADDRESS2	ADDRESS3	ADDRESS4	CASE
13934411052	ADAIR GREGORY GENE	900 S LAS VEGAS BLVD # 1004	LAS VEGAS NV 89101			25-0145-RQR1
13934411053	HOLMES CHONITA L REVOCABLE TRUST	HOLMES CHONITA L TRS	1379 PARK WESTERN DR # 302	SAN PEDRO CA 90732-2300		25-0145-RQR1
13934411054	BAHRAMI JAMSHIED NIKKHAH TRUST	BAHRAMI JAMSHIED NIKKHAH TRS	900 LAS VEGAS BLVD S UNIT 1006	LAS VEGAS NV 89101		25-0145-RQR1
13934411055	PENTZ THOMAS WESLEY	16 W 22ND ST 2ND FLOOR	NEW YORK NY 10010			25-0145-RQR1
13934411056	SUNRISE REALTY L L C	4484 S PECOS RD # 120	LAS VEGAS NV 89121			25-0145-RQR1
13934411057	DREJA LORA	900 S LAS VEGAS BLVD UNIT 1009	LAS VEGAS NV 89101			25-0145-RQR1
13934411058	SHEN HONG	KOCH ANDREA	900 S LAS VEGAS BLVD # 1010	LAS VEGAS NV 89101-6860		25-0145-RQR1
13934411059	PALMER BRITNEY	900 S LAS VEGAS BLVD UNIT 1011	LAS VEGAS NV 89101			25-0145-RQR1
13934411060	J M ENTERPRISES NEVADA L L C	9850 S MARYLAND PKWY # A5-306	LAS VEGAS NV 89183			25-0145-RQR1
13934411061	SULLIVAN DAVID	900 S LAS VEGAS BLVD # 1013	LAS VEGAS NV 89101			25-0145-RQR1
13934411062	FREEDMAN ZACHARY	20525 BROOKIE LN	SANTA CLARITA CA 91350			25-0145-RQR1
13934411063	KOKORO ATARI G M B H REVOCABLE LIVING TRUST	ANDERSON ERIC TRS	900 S LAS VEGAS BLVD UNIT 1015	LAS VEGAS NV 89101		25-0145-RQR1
13934411064	BROCKER DOUGLAS L	900 S LAS VEGAS BLVD # 1016	LAS VEGAS NV 89101			25-0145-RQR1
13934411065	BENCUS JEFFREY A	900 S LAS VEGAS BLVD # 1101	LAS VEGAS NV 89101			25-0145-RQR1
13934411066	VITALE GILLES	2877 PARADISE RD # 1004	LAS VEGAS NV 89109			25-0145-RQR1
13934411067	BOOK LINDA S REVOCABLE TRUST	BOOK LINDA S TRS	3944 PARK VIEW DR	SALT LAKE CITY UT 84124		25-0145-RQR1
13934411068	STEINMAN STUART & FRANCISCA	371 N ADAMS ST	SIERRA CA 91024-1138			25-0145-RQR1
13934411069	HOFFMAN PATRICK	900 S LAS VEGAS BLVD UNIT 1105	LAS VEGAS NV 89101-6862			25-0145-RQR1
13934411070	Z-VEGAS HOLDINGS L L C	1500 BROADWAY 24TH FL	NEW YORK NY 10036			25-0145-RQR1
13934411071	FREDEKING TRUST	FREDEKING ROBIN TOBY TRS	2953 ORCHID LN	TURLOCK CA 95382		25-0145-RQR1
13934411072	C & H PROPERTIES L L C	4151 INDUSTRIAL CENTER DR STE 802	NORTH LAS VEGAS NV 89030			25-0145-RQR1
13934411073	DEHART BARBARA J	900 S LAS VEGAS BLVD UNIT 1109	LAS VEGAS NV 89101			25-0145-RQR1
13934411074	SEVERINO DAVID	900 S LAS VEGAS BLVD # 1110	LAS VEGAS NV 89101			25-0145-RQR1
13934411075	KJORVESTAD BLAIR PHILLIP	900 S LAS VEGAS BLVD # 1111	LAS VEGAS NV 89101			25-0145-RQR1
13934411076	WORTHY ENTERPRISES INC	900 S LAS VEGAS BLVD UNIT 1112	LAS VEGAS NV 89101			25-0145-RQR1
13934411077	CARREDO SALVADOR M	631 MONTECITO DR	PAHRUMP NV 89048			25-0145-RQR1
13934411078	GRAHAM MARK FRANCIS	636 W OVAL DR	BURLINGTON ON L7T 1B9	CANADA		25-0145-RQR1
13934411079	4CHANGE! TRUST	BUSH NEROLEE AILEEN TRS	1000 N GREEN VALLEY PKWY STE 440-546	HENDERSON NV 89074		25-0145-RQR1
13934411080	SEARS ROBERT	GREER DAVID	13829 ADAMS CIR	BRIGHTON CO 80602		25-0145-RQR1
13934411083	RYON VINCENT MILLER	900 S LAS VEGAS BLVD UNIT 1203	LAS VEGAS NV 89101			25-0145-RQR1
13934411084	BLOOM KELVIN MARK	900 LAS VEGAS BLVD S # 1204	LAS VEGAS NV 89101			25-0145-RQR1
13934411085	SIN CITY RENTALS L L C	4750 N JENSEN ST	LAS VEGAS NV 89129			25-0145-RQR1
13934411086	SANTANA VINCENT	KIESER CURT J	900 S LAS VEGAS BLVD # 1206	LAS VEGAS NV 89101		25-0145-RQR1
13934411087	ANDERSON JARED SCOTT	1017 E OAKY BLVD	LAS VEGAS NV 89104			25-0145-RQR1
13934411088	ROSSOTTI ANN M	11685 S BETHEL AVE	SELMA CA 93662			25-0145-RQR1
13934411089	MANNING ERNEST LEE JR	900 S LAS VEGAS BLVD # 1209	LAS VEGAS NV 89101			25-0145-RQR1
13934411090	BETHEL ASSOCIATES L L C	848 N RAINBOW BLVD # 653	LAS VEGAS NV 89107-1103			25-0145-RQR1
13934411091	DOUGLAS DOUGLAS	900 S LAS VEGAS BLVD # 1211	LAS VEGAS NV 89101			25-0145-RQR1
13934411092	ZEITLER ANDREW	900 S LAS VEGAS BLVD # 1212	LAS VEGAS NV 89101			25-0145-RQR1
13934411093	SUNRISE REALTY L L C	4484 S PECOS RD # 120	LAS VEGAS NV 89121			25-0145-RQR1
13934411094	VENTAROSA EQUITY GROUP	900 LAS VEGAS BLVD S # 1214	LAS VEGAS NV 89101			25-0145-RQR1
13934411095	TOOSON JAMAL	900 S LAS VEGAS BLVD UNIT 1215	LAS VEGAS NV 89101			25-0145-RQR1
13934411096	DAVIS TALMADGE	900 LAS VEGAS BLVD S	LAS VEGAS NV 89101			25-0145-RQR1
13934411097	SANTANGELO ANDREA	900 S LAS VEGAS BLVD # 1401	LAS VEGAS NV 89101-6864			25-0145-RQR1
13934411098	MAYHEW ROBERT J	3111 S VALLEY VIEW BLVD STE H101	LAS VEGAS NV 89102			25-0145-RQR1
13934411099	CHANNING REAL ESTATE L L C	131 W 35TH ST 6TH FLR	NEW YORK NY 10001-2111			25-0145-RQR1
13934411100	VITALE GILLES	2877 PARADISE RD # 1004	LAS VEGAS NV 89109			25-0145-RQR1
13934411101	SARRAF NILOUFAR	900 S LAS VEGAS BLVD UT 1405	LAS VEGAS NV 89101			25-0145-RQR1
13934411102	LIOSIS STAN	900 S LAS VEGAS BLVD # 1406	LAS VEGAS NV 89101-6865			25-0145-RQR1
13934411103	SINGH FAMILY TRUST	SINGH BEDI & BHARATHI TRS	2216 MANHATTAN AVE	MANHATTAN BEACH CA 90266		25-0145-RQR1
13934411104	GONZALES DIEGO	900 LAS VEGAS BLVD UNIT 1408	LAS VEGAS NV 89101			25-0145-RQR1
13934411105	TSE ERIC GEE & JOANNA LEE HUSBAND & WIFE GR TR	TSE ERIC GEE & JOANNA L TRS	450 LANSDALE AVE	SAN FRANCISCO CA 94127		25-0145-RQR1
13934411106	BLOMBERG LARS	6808 VIA LOCANDA AVE	LAS VEGAS NV 89131			25-0145-RQR1
13934411107	CHAN DONALD WING LIVING TRUST	CHAN DONALD WING TRS	900 S LAS VEGAS BLVD # 1411	LAS VEGAS NV 89101		25-0145-RQR1

PARCEL	OWNER	ADDRESS1	ADDRESS2	ADDRESS3	ADDRESS4	CASE
13934411108	COLLETTA KASSANDRA G & AARON R	900 LAS VEGAS BLVD S # 1412	LAS VEGAS NV 89052			25-0145-RQR1
13934411109	BLEUCIEL L L C	PO BOX 1108	LAS VEGAS NV 89125			25-0145-RQR1
13934411110	GOINS ROBERT ANTHONY JR & MANDI LYNNE	900 S LAS VEGAS BLVD UT # 1414	LAS VEGAS NV 89101			25-0145-RQR1
13934411111	1415 L L C	217 ROSEMARY LN	LAS VEGAS NV 89107			25-0145-RQR1
13934411112	VITALE CHRISTIAN	2877 PARADISE RD # 1004	LAS VEGAS NV 89109			25-0145-RQR1
13934411113	CHERRY FAMILY TRUST	CHERRY SAMUEL JAMES & MICHELLE DAHAN TRS	2808 ASHWORTH CIR	LAS VEGAS NV 89107		25-0145-RQR1
13934411114	L V CAPITAL FUND L L C	267 CRESCENT BAY DR	LAGUNA BEACH CA 92651			25-0145-RQR1
13934411115	COWLEY TEAGUE	853 E EMERSON AVE	SALT LAKE CITY UT 84098			25-0145-RQR1
13934411116	COWLEY TEAGUE	6841 WOODS ROSE DR	PARK CITY UT 84098			25-0145-RQR1
13934411117	WEIDNER HOLDINGS L L C	9711 ORIENT EXPRESS CT	LAS VEGAS NV 89145			25-0145-RQR1
13934411118	SCOFFLAW HOLDINGS L L C	511 E TALLGRASS DR	APPLETON WI 54913			25-0145-RQR1
13934411119	MOON JOON	9115 SE IMAGE LN	VANCOUVER WA 98664			25-0145-RQR1
13934411120	MOON JOON	9115 SE IMAGE LN	VANCOUVER WA 98664			25-0145-RQR1
13934411121	VIKTORMEEDA L L C	900 S LAS VEGAS BLVD # 130	LAS VEGAS NV 89101			25-0145-RQR1
13934411122	VIKTORMEEDA L L C	900 S LAS VEGAS BLVD # 130	LAS VEGAS NV 89101			25-0145-RQR1
13934411124	ALIAKBAR-AMID SASHA	17453 BLYTHE ST	NORTHRIDGE CA 91325			25-0145-RQR1
13934411125	CAMMARATA PAOLO	10120 S EASTERN AVE # 200	HENDERSON NV 89052			25-0145-RQR1
13934412001	THAYER CRISTEN C	200 HOOVER AVE UNIT 801	LAS VEGAS NV 89101			25-0145-RQR1
13934412002	HARRISON HALF TRUST	RYAN MICHAEL J TRS	200 HOOVER AVE UNIT 802	LAS VEGAS NV 89101		25-0145-RQR1
13934412003	METZGER JAMES P	105 PAPPAN DR	IMPERIAL PA 15126-1176			25-0145-RQR1
13934412004	FERENCZY EDWARD DANIEL	200 HOOVER AVE # 804	LAS VEGAS NV 89101			25-0145-RQR1
13934412005	FONTANA VINCENT CHRISTIAN	200 HOOVER AVE UNIT 805	LAS VEGAS NV 89101			25-0145-RQR1
13934412006	LEE CHI C	200 HOOVER AVE # 806	LAS VEGAS NV 89101-6873			25-0145-RQR1
13934412007	GUIRIBA EDEL UGANIZA	200 HOOVER AVE # 807	LAS VEGAS NV 89101			25-0145-RQR1
13934412008	RAMSEY RONALD & MARILYN	1262 PLUM TREE RD	CARLSBAD CA 92011-2505			25-0145-RQR1
13934412009	PENSCO TRUST COMPANY L L C	8404 MYERLEE CT	LAS VEGAS NV 89131			25-0145-RQR1
13934412010	NOONAN RYAN & HADASSAH	10744 OLD EAGLE RIVER RD	EAGLE RIVER AK 99577			25-0145-RQR1
13934412011	NEWPORT 18 L P	52 HILLMOUNT AVE	TORONTO ON M6B 1X4	CANADA		25-0145-RQR1
13934412012	JOSEPH VICTOR CHARLES & VICTOR RICARDO	10855 CHURCH ST APT 1009	RANCHO CUCAMONGA CA 91730			25-0145-RQR1
13934412013	PEREIRA STEPHEN J	1311 S 7TH ST	LAS VEGAS NV 89104			25-0145-RQR1
13934412014	SAATCHI SAEDEH	200 HOOVER AVE # 901	LAS VEGAS NV 89101			25-0145-RQR1
13934412015	EMERSON BLAKE	9401 CANYON MESA DR	LAS VEGAS NV 89144			25-0145-RQR1
13934412016	SUNSHINE REAL ESTATE RENTALS L L C	3130 BARONA RD	PALM SPRINGS CA 92264			25-0145-RQR1
13934412017	TROMANS BRIAN R	66 MAPLEWOOD AVE	ALBANY NY 12203			25-0145-RQR1
13934412018	DAVIS SHANON M & MARGARET E LIVING TRUST	DAVIS SHANON M & MARGARET E TRS	200 HOOVER AVE UNIT 905	LAS VEGAS NV 89101-6875		25-0145-RQR1
13934412019	STEINMAN STUART & FRANCISCA	371 ADAMS ST	SIERRA MADRE CA 91024			25-0145-RQR1
13934412020	WONG ELENIS E	WONG HOY Y & SAUSIM L	200 HOOVER AVE # 907	LAS VEGAS NV 89101		25-0145-RQR1
13934412021	TYSON TRUST	WRENSCH TYSON TRS	200 HOOVER AVE # 908	LAS VEGAS NV 89101-6875		25-0145-RQR1
13934412022	CAMACHO CHRISTINA & ALEX	1247 CORTE MENDI	CHULA VISTA CA 91913			25-0145-RQR1
13934412023	RODRIGUEZ PEDRO SAMUEL	30465 BRISTOL GATE LN	MENIFEE CA 92584			25-0145-RQR1
13934412024	SCHNITZER DAVID	200 HOOVER AVE # 911	LAS VEGAS NV 89101			25-0145-RQR1
13934412025	DASA HOLDING L P	35 SANIBEL CRESCENT	THORNHILL ON L4J 8G9	CANADA		25-0145-RQR1
13934412026	FITZGIBBONS MEGHAN ELIZABETH	SADIGHI BABAK	200 HOOVER AVE UNIT 913	LAS VEGAS NV 89101		25-0145-RQR1
13934412027	TISCHLER RYAN	13704 W WHITEWOOD DR	SUN CITY WEST AZ 85375			25-0145-RQR1
13934412028	LEE DAVID	200 HOOVER AVE # 1002	LAS VEGAS NV 89101			25-0145-RQR1
13934412029	SCHNEIDER THOMAS	200 HOOVER AVE # 1003	LAS VEGAS NV 89101			25-0145-RQR1
13934412030	NAZAL REVOCABLE LIVING TRUST	NAZAL RODOLFO R & SUSAN QUINO TRS	8667 MAJESTIC VISION WAY	LAS VEGAS NV 89178-7223		25-0145-RQR1
13934412031	MUCCI NATHAN	200 HOOVER AVE # 1005	LAS VEGAS NV 89101-6876			25-0145-RQR1
13934412032	MOORE BRIAN	39 SIRIUS RIDGE WAY	LAS VEGAS NV 89183			25-0145-RQR1
13934412033	FUCHS DAVID	200 HOOVER AVE UNIT 1007	LAS VEGAS NV 89101			25-0145-RQR1
13934412034	NAGY GINA MICHELLE	1025 17TH ST UNIT 1	SAN FRANCISCO CA 94107			25-0145-RQR1
13934412035	VACCARO DEBORAH SUE	200 HOOVER AVE UNIT 1009	LAS VEGAS NV 89101			25-0145-RQR1
13934412036	NEWPORT 1501 L P	7111 BATHURST ST # 200	THORNHILL ON L4J 2J6	CANADA		25-0145-RQR1
13934412037	PARTOUCHE MARC REVOCABLE LIVING TRUST	PARTOUCHE MARC TRS	200 HOOVER AVE # 1011	LAS VEGAS NV 89101		25-0145-RQR1

PARCEL	OWNER	ADDRESS1	ADDRESS2	ADDRESS3	ADDRESS4	CASE
13934412038	DESOUZA VENANT & VALERIE	200 HOOVER AVE # 1012	LAS VEGAS NV 89101			25-0145-RQR1
13934412039	EDWARDS FAMILY TRUST	EDWARDS BRIAN P & NOURIA TRS	25615 DEL NORTE	LAGUNA NIGUEL CA 92677		25-0145-RQR1
13934412040	BLUE CORN L L C	900 S LAS VEGAS BLVD # 1015	LAS VEGAS NV 89101			25-0145-RQR1
13934412041	NAEINI KRISTEN	500 BROADWAY ST # 510	VANCOUVER WA 98660			25-0145-RQR1
13934412042	BURDA DOUGLAS BENJAMIN & ANAT	7465 W LAKE MEAD BLVD STE 100	LAS VEGAS NV 89128			25-0145-RQR1
13934412043	PARRAY SAJID HAFEEZ	200 HOOVER AVE # 1104	LAS VEGAS NV 89101			25-0145-RQR1
13934412044	SILLETERO TRUST	ROBINSON M CLEMENCIA TRS	16510 N 92ND ST UNIT 1011	SCOTTSDALE AZ 85260		25-0145-RQR1
13934412045	GAITHER EDWARD D REV TRUST ETAL	GAITHER EDWARD DEAN TRS	200 HOOVER AVE UNIT 1106	LAS VEGAS NV 89101		25-0145-RQR1
13934412046	NAYLOR CLARENCE	5300 E WAVERLY DR N5206	PALM SPRINGS CA 92264			25-0145-RQR1
13934412047	LEVY'S INVESTMENT PROPERTIES L P	69 MILLCREEK CRESCENT	THORNHILL ON L4J 6N2	CANADA		25-0145-RQR1
13934412048	EDWARDS FAMILY TRUST	EDWARDS BRIAN P & NOURIA TRS	25615 DEL NORTE	LAGUNA NIGUEL CA 92677		25-0145-RQR1
13934412049	PLAN B HOLDING TRUST	CORRELL WILLIAM D TRS	200 HOVER AVE UNIT 1110	LAS VEGAS NV 89101		25-0145-RQR1
13934412050	BIDARI FAMILY TRUST	BIDARI CHANGIZ Z & M TINA TRS	200 HOOVER AVE	LAS VEGAS NV 89101		25-0145-RQR1
13934412051	PAYDAR SIAMAK	301 WEST G ST # 132	SAN DIEGO CA 92101-6054			25-0145-RQR1
13934412052	TEDESCHI MICHAEL J	200 HOOVER AVE # 1113	LAS VEGAS NV 89101-6877			25-0145-RQR1
13934412053	GOLBEN NATHANIEL M	200 HOOVER AVE UNIT 1201	LAS VEGAS NV 89101			25-0145-RQR1
13934412054	GUZINSKI ERIK	200 HOOVER AVE # 1202	LAS VEGAS NV 89101-6878			25-0145-RQR1
13934412055	VELEZ LAURA QINONES	BERTELOOT JULIE	200 HOOVER AVE # 1203	LAS VEGAS NV 89101-6878		25-0145-RQR1
13934412056	SPACE WORKS L L C	PO BOX 12	DENVER CO 80201			25-0145-RQR1
13934412057	AOKI MICKI T & RICHARD S	MUKAI ALISON L	804 HOOMAE MAE ST	PEARL CITY HI 96782-2148		25-0145-RQR1
13934412058	LENTZ ROBERT	4500 WILLIAMS DR STE 212-352	GEORGETOWN TX 78633			25-0145-RQR1
13934412059	AHARON BROTHERS HOLDINGS L P	9890 S MARYLAND PKWY SYE 200A	LAS VEGAS NV 89183			25-0145-RQR1
13934412060	MAGUIRE 2024 TRUST	MAGUIRE MICHIAL GEORGE & JUDY ANN TRS	PO BOX 2371	MCCALL ID 83638		25-0145-RQR1
13934412061	GRAHAM 2020 LIVING TRUST	GRAHAM SHIMEKA AKENY TRS	200 HOOVER # 1209	LAS VEGAS NV 89101-6878		25-0145-RQR1
13934412062	WAHLQUIST PHILIP	5404 BUTTE CIR	ROCKLIN CA 95765			25-0145-RQR1
13934412063	BROTMAN CLAUDIA	200 HOOVER AVE # 1211	LAS VEGAS NV 89101			25-0145-RQR1
13934412064	DASA HOLDINGS L P	35 SANIBEL CRESCENT	THORNHILL ON L4J 8G9	CANADA		25-0145-RQR1
13934412065	TAN SIMON Y & JENNY WEI	6364 CAMBRIDGE CREEK CT	LAS VEGAS NV 89149			25-0145-RQR1
13934412066	JULIAN SCOTT	1704 CHAPMAN DR	LAS VEGAS NV 89104			25-0145-RQR1
13934412067	MELTZER BRIAN	CHOI CASSY	13816 RIDGETOP RD	HERMOSA SD 57744-6004		25-0145-RQR1
13934412068	KALINA ILONA	200 HOOVER AVE UNIT 1403	LAS VEGAS NV 89101			25-0145-RQR1
13934412069	DEACHA SERGIO LIVING TRUST	DEACHA SERGIO TRS	1638 HYACINTH LN	SAN JOSE CA 95124-6505		25-0145-RQR1
13934412070	SHELANSKI STEPHAN	250 COOK ST	DENVER CO 80206			25-0145-RQR1
13934412071	WILLIAMS SAILOR & KAMI D	200 HOOVER AVE # 1406	LAS VEGAS NV 89101			25-0145-RQR1
13934412072	DAVIS SHANON M & MARGARET E LIVING TRUST	DAVIS SHANON M & MARGARET E TRS	200 HOOVER AVE UNIT 905	LAS VEGAS NV 89101		25-0145-RQR1
13934412073	CHIEN STEVEN	HU CARINA CHIH CHIH	23 VIA GRANADA	ROLLING HILLS ESTATES CA 90274		25-0145-RQR1
13934412074	JACOBSEN-HYLAND REV LIV TR	JACOBSEN MARK LEE TRS	200 HOOVER AVE # 1409	LAS VEGAS NV 89101-6879		25-0145-RQR1
13934412075	TAPIA DANIEL RILEY	3784 SALEM LN	CLOVIS CA 93619			25-0145-RQR1
13934412076	MATTU RAMANDEEP SINGH	200 HOOVER AVE UNIT 1411	LAS VEGAS NV 89101			25-0145-RQR1
13934412077	PIANA KENNETH R	1 MOUNT DARWIN CT	SAN RAFAEL CA 94903			25-0145-RQR1
13934412078	MADDEN BROOK E	200 HOOVER AVE # 1413	LAS VEGAS NV 89101			25-0145-RQR1
13934412079	NEWPORT 1501 L P	7117 BATHURST ST # 200	THORNHILL ON L4J 2J6	CANADA		25-0145-RQR1
13934412080	MIHAI EDWARD DANIEL	200 HOOVER AVE UNIT 1502	LAS VEGAS NV 89101			25-0145-RQR1
13934412081	STILWAGNER MICHAEL & LISA	200 HOOVER AVE # 1503	LAS VEGAS NV 89101			25-0145-RQR1
13934412082	SPACE WORKS L L C	PO BOX 12	DENVER CO 80201			25-0145-RQR1
13934412083	DASILVA FREDERIC DOMINIGUE	200 HOOVER AVE UNIT 1505	LAS VEGAS NV 89101			25-0145-RQR1
13934412084	SHEN JOHN CHEN & ANITA M	200 HOOVER AVE # 1506	LAS VEGAS NV 89101-6880			25-0145-RQR1
13934412085	WHITE GEOFFREY MITCHELL VARNUM	200 HOOVER AVE # 1507	LAS VEGAS NV 89101-6881			25-0145-RQR1
13934412086	FERNANDEZ CARLOS DAVID	200 HOOVER ST # 1508	LAS VEGAS NV 89101			25-0145-RQR1
13934412087	OASIS LIVING L L C	30251 GOLDEN LANTERN STE E356	LAGUNA NIGUEL CA 92677			25-0145-RQR1
13934412088	PELLIZZER MARK	200 HOOVER AVE UT 1510	LAS VEGAS NV 89101			25-0145-RQR1
13934412089	KUAN-CHENG C & HANG L C FAM TR	KUAN-CHENG CHEN TRS	28371 VISTA DEL VALLE	HEMET CA 92544-8361		25-0145-RQR1
13934412090	YOSHIOKA BILL HIROSHI	15531 SANDUSKY LN	WESTMINSTER CA 92683			25-0145-RQR1
13934412091	RENZO HEIDI	200 HOOVER AVE # 1513	LAS VEGAS NV 89101-6881			25-0145-RQR1

PARCEL	OWNER	ADDRESS1	ADDRESS2	ADDRESS3	ADDRESS4	CASE
13934412092	CRANE NICHOLAS	200 HOOVER AVE # 1601	LAS VEGAS NV 89101-6881			25-0145-RQR1
13934412093	GOLDBERG ALICE M & MELVIN J	PO BOX 33298	LAS VEGAS NV 89133-3298			25-0145-RQR1
13934412094	MARCH ROBERT ETHAN LIVING TRUST	MARCH ROBERT ETHAN TRS	35 CORALWOOD DR	LAS VEGAS NV 89135		25-0145-RQR1
13934412095	TSE ERIC GEE & JOANNA HUSBAND & WIFE GRANTOR TRUST	TSE ERIC GEE & JOANNA L TRS	450 LANSDALE AVE	SAN FRANCISCO CA 94127		25-0145-RQR1
13934412096	STEWART VONNE LIVING TRUST	STEWART VONNE L TRS	200 HOOVER AVE # 1605	LAS VEGAS NV 89101		25-0145-RQR1
13934412097	HSU MICHAEL NORRIS	3125 15TH AVE W	VANCOUVER BC V6K 3A7	CANADA		25-0145-RQR1
13934412098	JEREMY ENTERPRISES L P	600 STEEPROCK DRIVE	TORONTO ON M3S 2X1	CANADA		25-0145-RQR1
13934412099	VERA CRAIG JOSEPH	200 HOOVER AVE UNIT 1608	LAS VEGAS NV 89101			25-0145-RQR1
13934412100	FABER TORBEN	200 HOOVER AVE # 1609	LAS VEGAS NV 89101			25-0145-RQR1
13934412101	FINK MICHAEL ROBERT	200 HOOVER AVE UNIT 1610	LAS VEGAS NV 89101-6882			25-0145-RQR1
13934412102	RICHARDSON SCOTT DAEMON	900 LAS VEGAS BLVD S # 814	LAS VEGAS NV 89101			25-0145-RQR1
13934412103	IP KAM	PO BOX 192	STEPHENVILLE TX 76401-0003			25-0145-RQR1
13934412104	EDMONDS ROBERT S	200 HOOVER AVE # 1613	LAS VEGAS NV 89101			25-0145-RQR1
13934412105	PEABODY RUFUS	1424 PARKWOOD PL NW	WASHINGTON DC 20010			25-0145-RQR1
13934412106	DAY LEILA	257 PERALTA AVE	SAN FRANCISCO CA 94110			25-0145-RQR1
13934412107	BRUNET THOMAS M	2700 LAS VEGAS BLVD S # 3801	LAS VEGAS NV 89109-1173			25-0145-RQR1
13934412108	STEV HOLDINGS L L C	PO BOX 28549	LAS VEGAS NV 89126			25-0145-RQR1
13934412109	HAPPY PITBULL TRUST ETAL	TARIO BRIAN TRS	2328 CASERTA CT	HENDERSON NV 89074		25-0145-RQR1
13934412110	BARONE DAMON F TRUST	BARONE DAMON F TRS	200 HOOVER AVE # 1706	LAS VEGAS NV 89101		25-0145-RQR1
13934412111	CANDIA L L C	7363 GLORIOUS SUN DR	LAS VEGAS NV 89178			25-0145-RQR1
13934412112	SANCHEZ JEFF	ROBERT ST JOHN	200 HOOVER AVE UNIT 1708	LAS VEGAS NV 89101		25-0145-RQR1
13934412113	KAMP EVAN VANDER	200 HOOVER AVE UNIT 1709	LAS VEGAS NV 89101			25-0145-RQR1
13934412114	PETERMAN MICHAEL B	230 MAIN BLVD # B	BOYNTON BEACH FL 33435			25-0145-RQR1
13934412115	WILLARD DAVID D TRUST 1985 ETAL	WILLARD DAVID D TRS	200 HOOVER AVE UNIT 1711	LAS VEGAS NV 89101		25-0145-RQR1
13934412116	SHALAPENOK NIKITA	200 HOOVER AVE # 1712	LAS VEGAS NV 89101			25-0145-RQR1
13934412117	KUDLER DONALD C	DARCYL ONDINE S	3202 W CHARLESTON BLVD	LAS VEGAS NV 89102		25-0145-RQR1
13934412118	VANVOOREN EDWARD	200 HOOVER # 1801	LAS VEGAS NV 89101			25-0145-RQR1
13934412119	SATTERWHITE DANA L & KRISTEN A	7916 W 116TH TER	OVERLAND PARK KS 66210			25-0145-RQR1
13934412120	SMITH BARRY ALEXANDER	114 SCOTT RD	WHITE BIRD ID 83554			25-0145-RQR1
13934412121	DAVIS SHANON M & MARGARET E LIVING TRUST	DAVIS SHANON M & MARGARET E TRS	200 HOOVER AVE # 905	LAS VEGAS NV 89101		25-0145-RQR1
13934412122	NAITO RALPH KALEO TRUST	NAITO RALPH KALEO TRS	200 HOOVER AVE UNIT 1805	LAS VEGAS NV 89101		25-0145-RQR1
13934412123	EMMONS BRUCE F & LORETTA I REV TR	EMMONS LORETTA I TRS	765 WHITE OAK DR	SANTA ROSA CA 95409-6155		25-0145-RQR1
13934412124	BOYD KAREN SIRAN & BESS S	200 HOOVER AVE # 1811	LAS VEGAS NV 89101-6885			25-0145-RQR1
13934412125	CHONG HYO C	200 HOOVER AVE # 1808	LAS VEGAS NV 89101			25-0145-RQR1
13934412126	LESTER SUMMERSON REVOCABLE LIVING TRUST ETAL	SUMMERSON RAYMOND H III TRS	200 HOOVER AVE UNIT 1809	LAS VEGAS NV 89101-6885		25-0145-RQR1
13934412127	DASA HOLDINGS L P	35 SANIBEL CRESCENT	THORNHILL ON L4J 8G9	CANADA		25-0145-RQR1
13934412128	JOSEPH STEVEN LOUIS	BOYD KAREN SIRAN	200 HOOVER AVE # 1811	LAS VEGAS NV 89101-6885		25-0145-RQR1
13934412129	JOSEPH STEVEN	BOYD KAREN S	200 HOOVER AVE UNIT 1811	LAS VEGAS NV 89101		25-0145-RQR1
13934412130	SCHWEBEL ANDREW LIVING TRUST	SCHWEBEL ANDREW TRS	200 HOOVER AVE UNIT 1813	LAS VEGAS NV 89101		25-0145-RQR1
13934412131	EHRESMAN RONALD K & TERI L	200 HOOVER AVE UNIT 1901	LAS VEGAS NV 89101			25-0145-RQR1
13934412132	J-H R L T L L C	200 HOOVER AVE # 1409	LAS VEGAS NV 89101-6879			25-0145-RQR1
13934412133	PELICHOFF SCOTT E & LYNN B	3173 E CARRIGAN CANYON DR	SALT LAKE CITY UT 84109			25-0145-RQR1
13934412134	DUCHET DIMA N	8396 YAMHILL ST	LAS VEGAS NV 89123			25-0145-RQR1
13934412135	DISKIN RON MEIER	200 HOOVER AVE UNIT 1905	LAS VEGAS NV 89101			25-0145-RQR1
13934412136	JANIKOWSKI JACEK TRUST	JANIKOWSKI JACEK TRS	200 HOOVER AVE # 1906	LAS VEGAS NV 89101-6886		25-0145-RQR1
13934412137	CLOQUET CELINE Y	PO BOX 4504	SEATTLE WA 98194			25-0145-RQR1
13934412138	HOOVER 1908 L L C	3841 W CHARLESTON BLVD STE 100	LAS VEGAS NV 89102			25-0145-RQR1
13934412139	MIZRAHI DAVID 2010 LIVING TRUST	MIZRAHI DAVID TRS	6245 WHISPERING BROOK CT	LAS VEGAS NV 89149-3215		25-0145-RQR1
13934412140	SATICOY BAY L L C SER 200 HOOVER	PO BOX 36208	LAS VEGAS NV 89133			25-0145-RQR1
13934412141	MACRAE NELSON FAMILY TRUST ETAL	NELSON CHRISTY TRS	200 HOOVER AVE # 1911	LAS VEGAS NV 89101		25-0145-RQR1
13934412142	SAPUNAR SIERRA	200 HOOVER AVE # 1912	LAS VEGAS NV 89101-6887			25-0145-RQR1
13934412143	YEH XIAN-LI & DOROTHY LIVING TR	YEH XIAN-LI & DOROTHY TRS	1020 REGAL CANYON DR	WALNUT CA 91789-5022		25-0145-RQR1
13934412144	AGUILAR FRANCISCO V	200 HOOVER AVE # 2001	LAS VEGAS NV 89101			25-0145-RQR1
13934412145	MARLAND OLIVER	200 HOOVER AVE # 2002	LAS VEGAS NV 89101			25-0145-RQR1

PARCEL	OWNER	ADDRESS1	ADDRESS2	ADDRESS3	ADDRESS4	CASE
13934412146	L V OPPORTUNITIES FUND L L C	267 CRESCENT BAY DR	LAGUNA BEACH CA 92651			25-0145-RQR1
13934412147	SPACE WORKS L L C	PO BOX 12	DENVER CO 80201			25-0145-RQR1
13934412148	CLAYTON MARK TRUST	CLAYTON MARK A TRS	200 HOOVER AVE # 2005	LAS VEGAS NV 89101		25-0145-RQR1
13934412149	MAHR RICK	15021 VENTURA BLVD # 861	SHERMAN OAKS CA 91403			25-0145-RQR1
13934412150	AHARON BROTHERS HOLDINGS L P	61 PARKVIEW CREST	TORONTO ON M4B 1R1	CANADA		25-0145-RQR1
13934412151	ARNET P J L D TRUST	ARNET PETER J & LORI D TRS	200 HOOVER AVE # 2104	LAS VEGAS NV 89101		25-0145-RQR1
13934412152	WILGUS DAVID & ROBBYN	200 HOOVER AVE # 2009	LAS VEGAS NV 89101			25-0145-RQR1
13934412153	FARRELL FAMILY TRUST	BREAULT KIMBERLY G TRS	8960 W POST RD # 3018	LAS VEGAS NV 89148		25-0145-RQR1
13934412154	FELLNER ROBERT D	200 HOOVER AVE # 2011	LAS VEGAS NV 89101-6888			25-0145-RQR1
13934412155	LENTZ JILL	4500 WILLIAMS DR STE 212-352	GEORGETOWN TX 78633			25-0145-RQR1
13934412156	LUSTICK JEFFREY	200 HOOVER AVE UNIT 2013	LAS VEGAS NV 89101			25-0145-RQR1
13934412157	BARBU L L C	3750 S LAS VEGAS BLVD # 4706	LAS VEGAS NV 89158			25-0145-RQR1
13934412158	MCDONALD SPENCER ANDREW	BAKAR JENNIFER	200 HOOVER AVE # 2102	LAS VEGAS NV 89101		25-0145-RQR1
13934412159	WILLIAMS FAMILY TRUST	WILLIAMS STEPHEN H & PAMELA K TRS	200 HOOVER AVE # 2103	LAS VEGAS NV 89101		25-0145-RQR1
13934412160	P J L D ARNET TRUST	ARNET PETER J & LORI D TRS	200 HOOVER AVE # 2104	LAS VEGAS NV 89101		25-0145-RQR1
13934412161	TANG KEVIN C FAMILY TRUST	TANG KEVIN C TRS	4747 EXECUTIVE DR STE 210	SAN DIEGO CA 92101		25-0145-RQR1
13934412162	BEAUMONT GEOFFREY C REVOCABLE TRUST	BEAUMONT GEOFFREY C TRS	200 HOOVER AVE APT 2106	LAS VEGAS NV 89101		25-0145-RQR1
13934412163	OTHMER KONSTANTIN	200 HOOVER AVE UT 2107	LAS VEGAS NV 89101			25-0145-RQR1
13934412164	IVANOV MICHAEL	200 HOOVER AVE # 2108	LAS VEGAS NV 89101			25-0145-RQR1
13934412165	SUNSHINE REAL ESTATE RENTALS	3130 BARONA RD	PALM SPRINGS CA 92264-9675			25-0145-RQR1
13934412166	RUDY KELLY	200 HOOVER AVE # 2110	LAS VEGAS NV 89101			25-0145-RQR1
13934412167	YAZDANPANAH ARASH IRREVOCABLE SPENDTHRIFT TRUST	YAZDANPANAH ARASH TRS	200 HOOVER AVE # 2111	LAS VEGAS NV 89101-6886		25-0145-RQR1
13934412168	MACKENZIE KEITH GORDON	3-11 BELLEROSE DR # 301	SAINT ALBERT AB T8N 5C9	CANADA		25-0145-RQR1
13934412169	BROWN PARTNERS L L C	200 HOOVER AVE # 110	LAS VEGAS NV 89101-6872			25-0145-RQR1
13934412170	BROWN PARTNERS L L C	200 HOOVER AVE # 110	LAS VEGAS NV 89101-6872			25-0145-RQR1
13934412171	ANDANDOLINDO L L C	3202 W CHARLESTON BLVD	LAS VEGAS NV 89102			25-0145-RQR1

## Application Information

25-0147-RQR1 - REQUIRED REVIEW - PUBLIC HEARING - APPLICANT: LAMAR CENTRAL OUTDOOR, LLC - OWNER: FCPT RESTAURANT PROPERTIES, LLC - For possible action on a Land Use Entitlement project request for a Required Review of an approved Special Use Permit (U-0185-89) FOR A 40-FOOT TALL, 14-FOOT BY 48-FOOT OFF-PREMISE SIGN at 1361 South Decatur Boulevard (APN 162-06-211-001), C-1 (Limited Commercial) Zone, Ward 1 (Knudsen). Staff recommends APPROVAL.

## Application Location

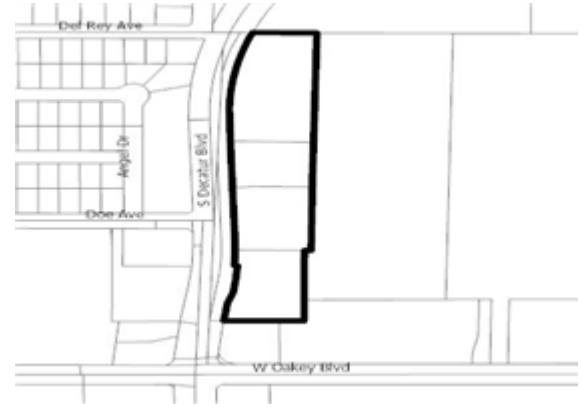

The proposed project may not pertain to the entire highlighted project site.

## Public Hearing Information

**Meeting:** City Council  
**Date:** 05/07/2025  
**Location:** City Council Chambers  
495 South Main St, 2<sup>nd</sup> Fl.  
Las Vegas, Nevada  
**Time:** 9:30 a.m.

Any and all interested persons may appear and be heard at said meeting, or may, prior thereto, file written objections thereto or approvals thereof with the City Clerk, 2nd Floor, City Hall, 495 South Main Street, Las Vegas, Nevada, 89101. For more information, go to [www.lasvegasnevada.gov/meetings](http://www.lasvegasnevada.gov/meetings) or call (702) 229-6311 (TTY 7-1-1). Note that postcards and comments received after an agenda posts will not be reflected online until after the meeting; however, the comments are made available to the members of the governing body for their consideration prior to the meeting.

## Application Information

25-0147-RQR1 - REQUIRED REVIEW - PUBLIC HEARING - APPLICANT: LAMAR CENTRAL OUTDOOR, LLC - OWNER: FCPT RESTAURANT PROPERTIES, LLC - For possible action on a Land Use Entitlement project request for a Required Review of an approved Special Use Permit (U-0185-89) FOR A 40-FOOT TALL, 14-FOOT BY 48-FOOT OFF-PREMISE SIGN at 1361 South Decatur Boulevard (APN 162-06-211-001), C-1 (Limited Commercial) Zone, Ward 1 (Knudsen). Staff recommends APPROVAL.

## Application Location



The proposed project may not pertain to the entire highlighted project site.

## Public Hearing Information

**Meeting:** City Council  
**Date:** 05/07/2025  
**Location:** City Council Chambers  
495 South Main St, 2<sup>nd</sup> Fl.  
Las Vegas, Nevada  
**Time:** 9:30 a.m.

Any and all interested persons may appear and be heard at said meeting, or may, prior thereto, file written objections thereto or approvals thereof with the City Clerk, 2nd Floor, City Hall, 495 South Main Street, Las Vegas, Nevada, 89101. For more information, go to [www.lasvegasnevada.gov/meetings](http://www.lasvegasnevada.gov/meetings) or call (702) 229-6311 (TTY 7-1-1). Note that postcards and comments received after an agenda posts will not be reflected online until after the meeting; however, the comments are made available to the members of the governing body for their consideration prior to the meeting.

City of Las Vegas, Office of The City Clerk  
495 South Main Street, 2<sup>nd</sup> Floor  
Las Vegas, Nevada 89101

**Return Service Requested**  
**Official Notice of Public Hearing**

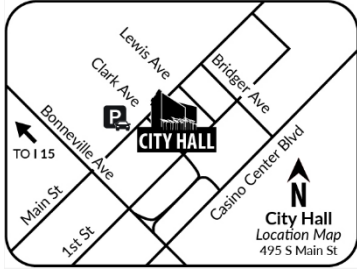

Scan or go to:

[www.lasvegasnevada.gov/meetings](http://www.lasvegasnevada.gov/meetings)

For additional information, scan the QR Code, select the meeting date shown below and then find the referenced project. To file your protest or support on this request, check one box below and return this card in an envelope with postage to the Office Of The City Clerk at the above address or fax this side of this card to (702) 382-4803. If you would like to contact your Council Representative, please call (702) 229-6405.

I SUPPORT  
this Request

I OPPOSE  
this Request

Please use available blank space on card for your comments.

**25-0147-RQR1**

City Council Meeting of **05/07/2025**

25-0147-RQR1  
1620611001  
SOUTHWESTERN HOLDINGS L L C  
23945 CALABASAS RD # 101  
CALABASAS CA 91302-1500

PRSRT  
FIRST CLASS MAIL  
U.S. Postage  
**PAID**  
Las Vegas, NV  
Permit No. 1630

City of Las Vegas, Office of The City Clerk  
495 South Main Street, 2<sup>nd</sup> Floor  
Las Vegas, Nevada 89101

**Return Service Requested**  
**Official Notice of Public Hearing**

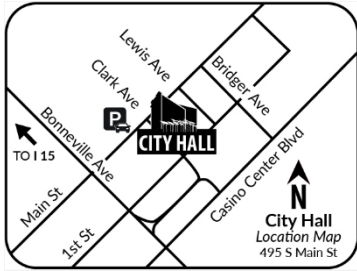

Scan or go to:

[www.lasvegasnevada.gov/meetings](http://www.lasvegasnevada.gov/meetings)

For additional information, scan the QR Code, select the meeting date shown below and then find the referenced project. To file your protest or support on this request, check one box below and return this card in an envelope with postage to the Office Of The City Clerk at the above address or fax this side of this card to (702) 382-4803. If you would like to contact your Council Representative, please call (702) 229-6405.

I SUPPORT  
this Request

I OPPOSE  
this Request

Please use available blank space on card for your comments.

**25-0147-RQR1**

City Council Meeting of **05/07/2025**

25-0147-RQR1  
1620611002  
BANK BUILDING INC  
101 N TRYON ST  
NC1-001-03-81  
CHARLOTTE NC 28255

PRSRT  
FIRST CLASS MAIL  
U.S. Postage  
**PAID**  
Las Vegas, NV  
Permit No. 1630

Label Total 537						
PARCEL	OWNER	ADDRESS1	ADDRESS2	ADDRESS3	ADDRESS4	CASE
1620611001	SOUTHWESTERN HOLDINGS L L C	23945 CALABASAS RD # 101	CALABASAS CA 91302-1500			25-0147-RQR1
1620611002	BANK BUILDING INC	101 N TRYON ST	NC1-001-03-81	CHARLOTTE NC 28255		25-0147-RQR1
1620611003	99 CENTS AT DECATUR L L C	15 W 6TH ST # 2400	TULSA OK 74119			25-0147-RQR1
1620611004	QUAM LESTER FAMILY 1997 IRR TR	QUAM LESTER TRS	1280 S DECATUR BLVD	LAS VEGAS NV 89102-8502		25-0147-RQR1
16206112010	COLE MT LAS VEGAS NV L L C	1000 LOWES BLVD	MOORESVILLE NC 28117			25-0147-RQR1
16206112011	WESTLAND FAIR L P	2654 W HORIZON RIDGE PKWY STE B5-145	HENDERSON NV 89052			25-0147-RQR1
16206112012	COLE MT LAS VEGAS NV L L C	1000 LOWES BLVD	MOORESVILLE NC 28117			25-0147-RQR1
16206112013	WESTLAND FAIR L P	2654 W HORIZON RIDGE PKWY STE B5-145	HENDERSON NV 89052			25-0147-RQR1
16206112014	COLE MT LAS VEGAS NV L L C	1000 LOWES BLVD	MOORESVILLE NC 28117			25-0147-RQR1
16206112015	WESTLAND FAIR L P	2654 W HORIZON RIDGE PKWY STE B5-145	HENDERSON NV 89052			25-0147-RQR1
16206201001	SANDPIPERVEGAS1 L L C	PO BOX 8608	CALABASAS CA 91372			25-0147-RQR1
16206201002	SANDPIPERVEGAS1 L L C	21731 VENTURA BLVD STE 205	WOODLAND HILLS CA 91364			25-0147-RQR1
16206201003	REBEL LAND & DEVELOPMENT L L C	2424 RIDGE RD	ROCKWALL TX 75087			25-0147-RQR1
16206201005	LAS VEGAS VALLEY WATER DISTRICT	1001 S VALLEY VIEW BLVD # MS 95	LAS VEGAS NV 89107-4447			25-0147-RQR1
16206201006	P M A K OAKLEY L L C	800 W MADISON ST STE 400	CHICAGO IL 60607			25-0147-RQR1
16206201007	SANDPIPERVEGAS1 L L C	21731 VENTURA BLVD STE 205	WOODLAND HILLS CA 91364			25-0147-RQR1
16206202001	LY INVESTMENTS L L C	5307 PATRICK HENRY	BELLAINE TX 77401-4816			25-0147-RQR1
16206211001	F C P T RESTAURANT PROPERTIES L	1000 DARDEN CENTER DR	ORLANDO FL 32837			25-0147-RQR1
16206211002	SANCHEZ SALVADOR S TRUST 2008	DICARLO DANIEL J TRS	450 N GRAND BLVD 7TH FLR	GLENDALE CA 91203		25-0147-RQR1
16206211003	O'REILLY AUTO ENTERPRISES L L C	PO BOX 9167	SPRINGFIELD MO 65801			25-0147-RQR1
16206211004	1617 DECATUR L L C	50 S JONES BLVD # 100	LAS VEGAS NV 89107-2672			25-0147-RQR1
16206212001	KWOK ROBERT K	LIU YAN H	5316 FLOATING FLOWER AVE	LAS VEGAS NV 89139-0132		25-0147-RQR1
16206212002	FELIX ARTURO A JR	1504 MARCUS DR	LAS VEGAS NV 89102-1524			25-0147-RQR1
16206212003	BRENT BRUCE M	1508 MARCUS DR	LAS VEGAS NV 89102-1524			25-0147-RQR1
16206212004	ABU-DAYYEH CRISTINA P & TAYSIR J	1512 MARCUS DR	LAS VEGAS NV 89102-1524			25-0147-RQR1
16206212005	FELIX ARTURO & EVODIA	1516 MARCUS DR	LAS VEGAS NV 89102-1524			25-0147-RQR1
16206212006	ALBILLAR ADIRIAN B & JAMEY F	MITCHELL CHERYLE ANN	1600 MARCUS DR	LAS VEGAS NV 89102		25-0147-RQR1
16206212007	THAM TRUST	THAM ANHHA TRS	1698 VALLEY GLEN CT	LAS VEGAS NV 89119		25-0147-RQR1
16206212008	ROSALES MARCO ANTONIO VASQUEZ	3708 ROUND LAKE DR	LAS VEGAS NV 89115			25-0147-RQR1
16206212009	MORAN DIANA E	MARTINEZ OMAR M	1612 MARCUS DR	LAS VEGAS NV 89102		25-0147-RQR1
16206212010	GAMAR MARILY	1616 MARCUS DR	LAS VEGAS NV 89102-1525			25-0147-RQR1
16206213001	SHAPIRO AHARON YITZCHOK & SUSAN	4742 63RD ST	SAN DIEGO CA 92115			25-0147-RQR1
16206213002	HAYNES CAVETT	5292 S MARYLAND PKWY # 21	LAS VEGAS NV 89119-1973			25-0147-RQR1
16206213003	HUSE COLIN D & JENNIFER L	1512 METROPOLITAN ST	LAS VEGAS NV 89102-1530			25-0147-RQR1
16206213004	BLACKMON BRADLEY	1508 METROPOLITAN ST	LAS VEGAS NV 89102			25-0147-RQR1
16206213005	LOPEZ ALEXIS J	6505 HILL VIEW AVE	LAS VEGAS NV 89107			25-0147-RQR1
16206215032	SANTAFE HOME L L C	10087 CANYON HILLS AVE	LAS VEGAS NV 89148			25-0147-RQR1
16206215033	CRUZ REY EFRAIN MENES	LOPEZ DEYSI SANDRA HERNANDEZ	1616 METROPOLITAN ST	LAS VEGAS NV 89102		25-0147-RQR1
16206215034	GASCON MICHAEL JOSH	1612 METROPOLITAN ST	LAS VEGAS NV 89102-1531			25-0147-RQR1
16206301001	LAZAROU REAL ESTATE L L C	1701 S DECATUR BLVD	LAS VEGAS NV 89102			25-0147-RQR1
16206301002	KAYS DOUGLAS B	SASUJA L L C	PO BOX 29071	LAS VEGAS NV 89126-3071		25-0147-RQR1
16206301003	DECATUR ONE L L C	PO BOX 10578	NEWPORT BEACH CA 92658			25-0147-RQR1
16206301004	BOUKATHER GEORGE A & REBECCA NUANEZ CO-TRS	PO BOX 10578	NEWPORT BEACH CA 92658			25-0147-RQR1
16206301005	USA POSTAL SERVICE	8055 E TUFTS AVE # 400	DENVER CO 80237			25-0147-RQR1
16206311001	DIAZ ANGEL & JOSEFINA	1700 CAMERON ST	LAS VEGAS NV 89102			25-0147-RQR1
16206311002	ZHOU ZIN	TOLOU MEHDI	1704 CAMERON ST	LAS VEGAS NV 89102		25-0147-RQR1
16206311003	LAW TAK WAH	1708 CAMERON ST	LAS VEGAS NV 89102			25-0147-RQR1
16206311004	SITT STEVE H & KATHY K	3025 GOLF LINKS DR	LAS VEGAS NV 89102			25-0147-RQR1
16206311005	BUTCH MICHAEL THOMAS	1716 CAMERON ST	LAS VEGAS NV 89102-3546			25-0147-RQR1
16206311006	BARSUMYAN IZABELLA	1720 CAMERON ST	LAS VEGAS NV 89102-3546			25-0147-RQR1
16206311007	GENG YAN	6145 SPRING MOUNTAIN RD UNIT 101	LAS VEGAS NV 89146			25-0147-RQR1
16301502018	SOUTHERN PACIFIC DIST COUNCIL	614 S 5TH AVE	LA PUENTE CA 91746-3029			25-0147-RQR1
16301512012	ZHU HELEN	5124 LYTTON AVE	LAS VEGAS NV 89146			25-0147-RQR1
16301512013	ROSE FAMILY LIVING TRUST	PHAM VIET-HOA TRS	5120 LYTTON AVE	LAS VEGAS NV 89146		25-0147-RQR1
16301512014	PEDRAZA LETICIA VELAZQUEZ	5116 LYTTON AVE	LAS VEGAS NV 89146-1445			25-0147-RQR1
16301512015	CRUZ IRELSY HERRERA	5112 LYTTON AVE	LAS VEGAS NV 89146			25-0147-RQR1
16301512016	SANCHEZ ALBERTO E	5108 LYTTON AVE	LAS VEGAS NV 89146-1445			25-0147-RQR1

PARCEL	OWNER	ADDRESS1	ADDRESS2	ADDRESS3	ADDRESS4	CASE
16301512017	ST LOUIS NEVADA L L C	3820 W GARY AVE	LAS VEGAS NV 89139			25-0147-RQR1
16301512018	LOPEZ AGUSTINA	5100 LYTTON AVE	LAS VEGAS NV 89146-1445			25-0147-RQR1
16301512019	MARTINEZ FRANCISCO LOPEZ	5105 LYTTON AVE	LAS VEGAS NV 89146			25-0147-RQR1
16301512020	SORIANO CRUZ	5101 LYTTON AVE	LAS VEGAS NV 89146-1444			25-0147-RQR1
16301512021	DENG LI	4134 FAIRCOVE CT	POMONA CA 91766			25-0147-RQR1
16301512022	RODEM L L C	2849 CHANNEL BAY DR	LAS VEGAS NV 89128			25-0147-RQR1
16301512023	GARCIA-GUTIERREZ DALGIS	1212 MONTCLAIR ST	LAS VEGAS NV 89146-1420			25-0147-RQR1
16301512024	MIR ROBERT JUSTICE & LARISSA	1216 MONTCLAIR ST	LAS VEGAS NV 89146			25-0147-RQR1
16301512025	CARRUBA PHILLIP	1300 MONTCLAIR ST	LAS VEGAS NV 89146			25-0147-RQR1
16301512026	FRANCO-MENDEZ AMILCAR J	DEFRANCO ROSA MUNGUIA	1304 MONTCLAIR ST	LAS VEGAS NV 89146		25-0147-RQR1
16301512027	LACOSTE ARTHUR J	4132 S RAINBOW BLVD # 338	LAS VEGAS NV 89103			25-0147-RQR1
16301512028	S M GUNATHILAKE FAMILY TRUST	GUNATHILAKE MALLIKA & SUSANTHA TRS	1312 MONTCLAIR ST	LAS VEGAS NV 89146-1435		25-0147-RQR1
16301512029	ORTIZ DANIEL	1316 MONTCLAIR ST	LAS VEGAS NV 89146			25-0147-RQR1
16301512030	CHIANG MIMI S	18406 AGUIRO ST	ROWLAND HEIGHTS CA 91748			25-0147-RQR1
16301512031	SIN CITY RENTALS L L C	4750 N JENSEN ST	LAS VEGAS NV 89129			25-0147-RQR1
16301512032	TAMAYO-MARTINEZ ALEXIS	ROMERO-MARRERO MARIA C	5112 DEL RAY AVE	LAS VEGAS NV 89146		25-0147-RQR1
16301512033	CASTELLANOS JUAN J LIAS	MEDINA MARIA E GARCIA	5116 DEL REY AVE	LAS VEGAS NV 89146		25-0147-RQR1
16301512034	YOSHIMI TOMOHIRO	401 E LIVE OAK ST # 28	SAN GABRIEL CA 91776			25-0147-RQR1
16301512035	BUCKEYE FAMILY TRUST	6219 ISLAND PALM AVE	LAS VEGAS NV 89118			25-0147-RQR1
16301512036	VUONG TONNY	1617 S 6TH ST	ALHAMBRA CA 91803			25-0147-RQR1
16301512037	CHOW CHUN & WANDA FAMILY TRUST	CHOW CHUN KUEN TRS	3210 DELTA AVE	ROSEMead CA 91770-2633		25-0147-RQR1
16301512038	ALIANO 1990 TRUST	ALIANO JOSEPH A TRS	PO BOX 28488	LAS VEGAS NV 89126-2488		25-0147-RQR1
16301512039	BLAZZARD KENT H & TONI	5204 DEL REY AVE	LAS VEGAS NV 89146-1414			25-0147-RQR1
16301512040	RESENDIZ JOSE	GONZALEZ KARLA	5208 DEL REY AVE	LAS VEGAS NV 89146-1414		25-0147-RQR1
16301512051	CHOI KAM YIN	4970 175TH	FRESH MEADOWS NY 11365-1624			25-0147-RQR1
16301512052	LAZARAKIS THEODORES D	8985 W CHEROKEE AVE	LAS VEGAS NV 89147-6539			25-0147-RQR1
16301512053	SCHAUER BELINDA M LIVING TRUST	SCHAUER BELINDA M TRS	4455 N CAMPBELL RD	LAS VEGAS NV 89129		25-0147-RQR1
16301512054	CHENSU SHU MEI	1750 152ND AVE NE # C314	BELLEVUE WA 98007			25-0147-RQR1
16301512055	GARCIA MISAEL	5129 LONGRIDGE AVE	LAS VEGAS NV 89146-1415			25-0147-RQR1
16301512056	M M R TRUST	REYES MARIA M TRS	5125 LONGRIDGE AVE	LAS VEGAS NV 89146-1415		25-0147-RQR1
16301512057	HILL MICHEAL MITSUYO REVOCABLE L	HILL MICHEAL MITSUYO TRS	5121 LONGRIDGE AVE	LAS VEGAS NV 89146		25-0147-RQR1
16301512058	GERMAN MARY ANNE	5117 LONGRIDGE AVE	LAS VEGAS NV 89146-1415			25-0147-RQR1
16301512059	CURTIS CURT RICK & SANDRA	5113 LONGRIDGE AVE	LAS VEGAS NV 89146-1415			25-0147-RQR1
16301512060	MACRAE HETHER M	WASHINGTON GLENN	1309 SQUIRES ST	LAS VEGAS NV 89146		25-0147-RQR1
16301512061	VANNOZZI TRUST	VANNOZZI THOMAS TRS	1305 SQUIRES ST	LAS VEGAS NV 89146-1437		25-0147-RQR1
16301512062	ORTEGA JOSAPHINE L	1301 SQUIRES ST	LAS VEGAS NV 89146-1437			25-0147-RQR1
16301512063	PATTERSON WILLIAM L	1217 SQUIRES ST	LAS VEGAS NV 89146-1427			25-0147-RQR1
16301512064	DANG DIANA DAN	1213 SQUIRES ST	LAS VEGAS NV 89146-1427			25-0147-RQR1
16301512065	VERGA JEANETTE L	1209 SQUIRES ST	LAS VEGAS NV 89146-1427			25-0147-RQR1
16301512066	ACTS 16:31 REVOCABLE LIVING TRUS	504 CAMPBELL DR	LAS VEGAS NV 89107			25-0147-RQR1
16301512067	ALVAREZ MARTIN	5900 MARKA DR	LAS VEGAS NV 89108			25-0147-RQR1
16301512068	DIAZ-VILLACIS LUIS FERNANDO	5117 LYTTON AVE	LAS VEGAS NV 89146			25-0147-RQR1
16301512069	CHAVEZ MARIA M TRUST	CHAVEZ MARIA M TRS	5121 LYTTON AVE	LAS VEGAS NV 89146-1452		25-0147-RQR1
16301512070	LYTTON OAKLEY L L C	5300 W SAHARA AVE STE 105	LAS VEGAS NV 89146			25-0147-RQR1
16301512071	TODORA TRUST	TODORA JOSEPH V & PAULA C TRS	5129 LYTTON AVE	LAS VEGAS NV 89146-1452		25-0147-RQR1
16301512072	GUAN HAIHUI	TANG YUFENG	1024 BUBB RD	CUPERTINO CA 95014-4939		25-0147-RQR1
16301512082	ARNOT DANIELLE	5200 HOLMBY AVE	LAS VEGAS NV 89146-1418			25-0147-RQR1
16301512083	FULLERTON DONALD & SUNDAY	5132 HOLMBY AVE	LAS VEGAS NV 89146			25-0147-RQR1
16301512084	HOLMBY TRUST	ALAMAR PROPERTIES L L C TRS	5128 HOLMBY AVE	LAS VEGAS NV 89146		25-0147-RQR1
16301512085	C E J A LIVING TRUST	JIMENEZ CESAR TRS	3065 S LINDELL RD	LAS VEGAS NV 89146		25-0147-RQR1
16301512086	MOORE JOHN WILLIAM & JUDITH P	5120 HOLMBY AVE	LAS VEGAS NV 89146-1440			25-0147-RQR1
16301512087	SILVA VINCENTE M & MARTINA R	5116 HOLMBY AVE	LAS VEGAS NV 89146-1440			25-0147-RQR1
16301512088	CEDAR BAND HOUSING FINANCE AGENC	10900 NE 4TH ST # 2300	BELLEVUE WA 98004			25-0147-RQR1
16301512089	GONZALEZ JULIA	5121 HOLMBY AVE	LAS VEGAS NV 89146			25-0147-RQR1
16301512090	HAN XUE LAN	5125 HOLMBY AVE	LAS VEGAS NV 89146-1439			25-0147-RQR1
16301512091	CARRILLO HORACIO	5129 HOLMBY AVE	LAS VEGAS NV 89146-1439			25-0147-RQR1
16301512092	DIAZ ADELA & GABRIEL	5133 HOLMBY AVE	LAS VEGAS NV 89146			25-0147-RQR1
16301512093	CORTES MANUEL	5201 HOLMBY AVE	LAS VEGAS NV 89146-1419			25-0147-RQR1

PARCEL	OWNER	ADDRESS1	ADDRESS2	ADDRESS3	ADDRESS4	CASE
16301512094	ACCU INVESTMENTS L L C	1505 CHELSEA RD	SAN MARINO CA 91108			25-0147-RQR1
16301512113	MEDINILLA PEDRO A GONZALEZ	5204 LONGRIDGE AVE	LAS VEGAS NV 89146			25-0147-RQR1
16301512114	821 GLACIER PEAK LANE L L C	821 CORONADO CENTER BLVD # 200	HENDERSON NV 89052			25-0147-RQR1
16301512115	VARGAS MARIA	5132 LONGRIDGE AVE	LAS VEGAS NV 89146			25-0147-RQR1
16301512116	HERNANDEZ EVARISTO & MARIA	5128 LONGRIDGE AVE	LAS VEGAS NV 89146			25-0147-RQR1
16301512117	MINOR VICKI ANN	5124 LONGRIDGE AVE	LAS VEGAS NV 89146			25-0147-RQR1
16301512118	WAGNER DAVID L & PATRICIA L	34300 NE 14TH AVE	LA CENTER WA 98629			25-0147-RQR1
16301512119	YELINEK LEONARD J	5116 LONGRIDGE AVE	LAS VEGAS NV 89146-1416			25-0147-RQR1
16301512120	JOHNSON SUSAN K	MUNTEAN MATTHEW	5112 LONGRIDGE	LAS VEGAS NV 89146		25-0147-RQR1
16301602003	1600 DECATUR L L C	PO BOX 371478	LAS VEGAS NV 89137			25-0147-RQR1
16301602004	D16 L L C	3065 N RANCHO DR # 132	LAS VEGAS NV 89130			25-0147-RQR1
16301602005	DECATUR OAKEY PLAZA L L C	2816 LAKECREST DR	LAS VEGAS NV 89128			25-0147-RQR1
16301602006	SCOUT VENTURES NEVADA L L C	7621 LARDEO ST	LAS VEGAS NV 89117			25-0147-RQR1
16301602008	5000 W OAKEY L L C	5000 W OAKEY BLVD # A3-1	LAS VEGAS NV 89146-0391			25-0147-RQR1
16301602009	D 16 L L C	3065 N RANCHO RD # 130	LAS VEGAS NV 89130			25-0147-RQR1
16301612001	P G HOLDINGS L L C	3150 LOMA VISTA AVE	LAS VEGAS NV 89120			25-0147-RQR1
16301612002	PIROSKI VIDOSAVA	PRVULOV NEBOJSA	5105 DEL REY AVE	LAS VEGAS NV 89146-1407		25-0147-RQR1
16301612003	RODRIGUEZ ESTHER & ADRIANA G	5109 DEL REY AVE	LAS VEGAS NV 89146-1407			25-0147-RQR1
16301612004	PERALTA VICENTE ADAME	5113 DEL REY AVE	LAS VEGAS NV 89146-1407			25-0147-RQR1
16301612005	LAWSON LEAH ANN	5117 DEL REY AVE	LAS VEGAS NV 89146-1407			25-0147-RQR1
16301612006	GOLD MOUNTAIN REAL ESTATE L L C	1300 EVANS AVE UNIT 884724	SAN FRANCISCO CA 94188-5539			25-0147-RQR1
16301612007	LIN MIMI WEI	PO BOX 2083	ARCADIA CA 91077-2083			25-0147-RQR1
16301612008	CUCHILLO RAYMUNDO CORONA	DECORONA TORIBIA PEREZ	5129 DEL REY AVE	LAS VEGAS NV 89146		25-0147-RQR1
16301612009	MUNETON ELVIA G	PINEDA CIRILO MUNETON	5133 DEL REY AVE	LAS VEGAS NV 89146-1407		25-0147-RQR1
16301612010	BERNAL IVONNE & NESTOR D	5137 DEL REY AVE	LAS VEGAS NV 89146			25-0147-RQR1
16301612011	CARDONA ROBERTO RIVERA	5201 DEL REY AVE	LAS VEGAS NV 89146-1417			25-0147-RQR1
16301612012	ZEH KRIS LEE	5205 DEL REY AVE	LAS VEGAS NV 89146-1417			25-0147-RQR1
16301612013	MARTINEZ ANA MARIA TRUST	MARTINEZ ANA MARIA & MAXIMO TRS	5209 DEL REY AVE	LAS VEGAS NV 89146		25-0147-RQR1
16301612014	MUNOZ MARIA ANTONIETA	5213 DEL REY AVE	LAS VEGAS NV 89146-1417			25-0147-RQR1
16301612015	CAOSJJ FAMILY TRUST	5422 SAN BELLASERA CT	LAS VEGAS NV 89141			25-0147-RQR1
16301612026	FULL MOON IRREVOCABLE TRUST	8280 CAMPANA DR	LAS VEGAS NV 89147			25-0147-RQR1
16301612027	BETANCOURT RICARH CONCEPCION	MARTINEZ YUSMILA QUINTANA	5212 MOUNTAIN VIEW DR	LAS VEGAS NV 89146-1421		25-0147-RQR1
16301612028	S R P SUB L L C	8665 E HARTFORD DR # 200	SCOTTSDALE AZ 85255			25-0147-RQR1
16301612029	HAZEL TRUST	KUZINICH JOANNE TRS	5204 MOUNTAIN VIEW DR	LAS VEGAS NV 89146		25-0147-RQR1
16301612030	FLEMING CLAUDIA	5200 MOUNTAIN VIEW DR	LAS VEGAS NV 89146-1421			25-0147-RQR1
16301612031	GUZMAN CHRISTIAN	DELEON STEPHANIE	5136 MOUNTAIN VIEW DR	LAS VEGAS NV 89146		25-0147-RQR1
16301612032	EMENDOZA L L C SERIES 5132 MOUNT	4813 W GILMORE AVE	LAS VEGAS NV 89130			25-0147-RQR1
16301612033	YANG STEVEN & AMY FAMILY TRUST	YANG STEVEN YEE BUN & AMY PING TRS	2243 BENTLEY RIDGE DR	SAN JOSE CA 95138		25-0147-RQR1
16301612034	LAZARO JUAN & ADULFA	5124 MOUNTAIN VIEW DR	LAS VEGAS NV 89146-1424			25-0147-RQR1
16301612035	GAINES CORNELIUS A & ROSIE F	5120 MOUNTAIN VIEW DR	LAS VEGAS NV 89146-1424			25-0147-RQR1
16301612036	STANFILL R A & T L 2006 REV TR	STANFILL RICHARD A & TACY CO-TRS	6371 SANDPIPER WAY	LAS VEGAS NV 89103-2110		25-0147-RQR1
16301612037	AGUILAR TERESA O	5112 MOUNTAIN VIEW DR	LAS VEGAS NV 89146			25-0147-RQR1
16301612038	URIBE JOSE	5108 MOUNTAIN VIEW DR	LAS VEGAS NV 89146-1424			25-0147-RQR1
16301612039	A V CENTRAL L L C ANGEL SERIES	1240 PACIFIC TERRACE DR	LAS VEGAS NV 89128			25-0147-RQR1
16301612042	LEGACY ENTERPRISES GROUP L L C	1000 N GREEN VALLEY PKY # 440-508	HENDERSON NV 89074			25-0147-RQR1
16301612043	CHEN JIAN QING	5117 MOUNTAIN VIEW DR	LAS VEGAS NV 89146			25-0147-RQR1
16301612044	SMITH ROSA MARIA AVILES & DANNY	5121 MOUNTAIN VIEW DR	LAS VEGAS NV 89146			25-0147-RQR1
16301612045	DOYLE MONAH	RUX EVELYN M	400 HOLCOMB CIR	LAS VEGAS NV 89107		25-0147-RQR1
16301612046	HERNANDEZ WILBERT	5129 MOUNTAIN VIEW DR	LAS VEGAS NV 89146			25-0147-RQR1
16301612047	RAMARPROPERTIES L L C	2223 EDGEWOOD AVE	LAS VEGAS NV 89102			25-0147-RQR1
16301612048	MARSH AMELIA A SEPARATE PROPERTY	MARSH AMELIA A TRS	5328 LOCHMOR AVE	LAS VEGAS NV 89130		25-0147-RQR1
16301612049	COSCOLLUELA ENRIQUE III & ERNEST	OANIA OLIVER DEJESUS & ELMA AGASEN	4017 PINOCHE PEAK WAY	RANCHO CORDOVA CA 95742		25-0147-RQR1
16301612050	TRUEMAN LIVING TRUST	5205 MOUNTAIN VIEW DR	LAS VEGAS NV 89146-1422			25-0147-RQR1
16301612051	ZHEN YAN HUAN TRUST	ZHEN YAN HUAN TRS	607 HIDDEN VALLEY DR	HENDERSON NV 89002-8307		25-0147-RQR1
16301612052	DALTON JOSHUA F	5213 MOUNTAIN VIEW DR	LAS VEGAS NV 89146			25-0147-RQR1
16301612053	LUIS-TORRES JUAN DE LA CRUZ	5217 MOUNTAIN VIEW DR	LAS VEGAS NV 89146-1422			25-0147-RQR1
16301614005	HERNANDEZ MARIA DEL CARMEN & CAR	JESUS JOSE SR	5112 DEL MONTE AVE	LAS VEGAS NV 89146-1404		25-0147-RQR1
16301614006	VOLS SERGEY	DUKACH REGINA	20933 BLYTH ST	CANOVA PARK CA 91304		25-0147-RQR1

PARCEL	OWNER	ADDRESS1	ADDRESS2	ADDRESS3	ADDRESS4	CASE
16301614007	TORRES ARMANDO	5120 DEL MONTE AVE	LAS VEGAS NV 89146			25-0147-RQR1
16301614008	YOCUM GARY LEE	5124 DEL MONTE AVE	LAS VEGAS NV 89146			25-0147-RQR1
16301614009	GOLDBERG JANIE SUE TRS	3401 EL CONLON AVE APT 1	LAS VEGAS NV 89102			25-0147-RQR1
16301614010	ENROSE L L C	5422 SAN BELLASERA CT	LAS VEGAS NV 89141			25-0147-RQR1
16301614011	LESTER JOHN C JR	5136 DEL MONTE AVE	LAS VEGAS NV 89146-1404			25-0147-RQR1
16301614012	TILLERY DENISE M	ADCOCK CHRISTOPHER T	5200 DEL MONTE AVE	LAS VEGAS NV 89146-1412		25-0147-RQR1
16301614013	MUNOZ JONATHAN	5204 DEL MONTE AVE	LAS VEGAS NV 89146-1412			25-0147-RQR1
16301614014	NASSER ANDREW A	2054 W 235TH ST	TORRANCE CA 90501			25-0147-RQR1
16301614015	GONZALEZ CASSANDRA	CASTRO REINA	5212 DEL MONTE AVE	LAS VEGAS NV 89146-1412		25-0147-RQR1
16301614016	LOGAN-WARD-BANKS LABONNA S	5216 DEL MONTE AVE	LAS VEGAS NV 89146-1412			25-0147-RQR1
16301614027	MONTIEL JUAN	5217 DEL MONTE AVE	LAS VEGAS NV 89146-1413			25-0147-RQR1
16301614028	SAUCEDO ANA MARIA & GERMAN	5213 DEL MONTE AVE	LAS VEGAS NV 89146-1413			25-0147-RQR1
16301614029	HIDALGO JORGE & MARIA R	5209 DEL MONTE AVE	LAS VEGAS NV 89146-1413			25-0147-RQR1
16301614030	CABRERA SERGIO J SOTOLONGO	HERNANDEZ AMARILIS L	5205 DEL MONTE AVE	LAS VEGAS NV 89146		25-0147-RQR1
16301614031	SALES DENNIS C	5201 DEL MONTE AVE	LAS VEGAS NV 89146			25-0147-RQR1
16301614032	FORNOS-GARCIA DARWING DAVID	5137 DEL MONTE AVE	LAS VEGAS NV 89146			25-0147-RQR1
16301614033	GERMANIER RENE J & H LIV TR 1993	GERMANIER RENE J & HELEN H T TRS	5133 DEL MONTE AVE	LAS VEGAS NV 89146-1403		25-0147-RQR1
16301614034	CAMPBELL ROAD L L C	PO BOX 14663	ALBUQUERQUE NM 87191			25-0147-RQR1
16301614035	ECHEVERRIA ANA D	5125 DEL MONTE AVE	LAS VEGAS NV 89146-1403			25-0147-RQR1
16301614036	CORDELL BEATRICE A REV LIV TR	5121 DEL MONTE AVE	LAS VEGAS NV 89146-1403			25-0147-RQR1
16301614037	RAMSEY LINDA ETAL	WINTON MARK & DONNA	5117 DEL MONTE AVE	LAS VEGAS NV 89146-1403		25-0147-RQR1
16301614038	SARIBA INTERNATIONAL LTD	17555 VENTURA BLVD # 202	ENCINO CA 91316			25-0147-RQR1
16301614039	MEJIA LUZ PATRICIA	5112 DOE AVE	LAS VEGAS NV 89146			25-0147-RQR1
16301614040	LADINO AMADO JUAREZ	HERRERRA-JUAREZ SALUSTIA	5116 DOE AVE	LAS VEGAS NV 89146-3346		25-0147-RQR1
16301614041	KNOBEL PAM	500 ANTELOPE WAY	LAS VEGAS NV 89145			25-0147-RQR1
16301614042	RODRIGUEZ MANUEL	CATOZZI TERESA	5124 DOE AVE	LAS VEGAS NV 89146-3346		25-0147-RQR1
16301614043	RIZZUTI KYLE ROBERT	5128 DOE AVE	LAS VEGAS NV 89146-3346			25-0147-RQR1
16301614044	RIVERA-GONZALEZ CRISTINA M	5132 DOE AVE	LAS VEGAS NV 89146			25-0147-RQR1
16301614045	BETANCOURT ERNESTINA	NUNES NANCY	5136 DOE AVE	LAS VEGAS NV 89146-3346		25-0147-RQR1
16301614046	LIN MIMI WEI	PO BOX 2083	ARCADIA CA 91077-2083			25-0147-RQR1
16301614047	BETTER ASSETS INC	8215 S EASTERN AVE # 265	LAS VEGAS NV 89123			25-0147-RQR1
16301614048	NILSSON MARC DAVID	5208 DOE AVE	LAS VEGAS NV 89146-0302			25-0147-RQR1
16301614049	KANG JING	54 PERENNIAL BORDER CT	LAS VEGAS NV 89148			25-0147-RQR1
16301614050	CHEN CHIU-CHI & SHU-JENG TRUST	231 STOCK BRIDGE AVE	ALHAMBRA CA 91801			25-0147-RQR1
16301614056	DECATUR INVESTMENT GROUP L L C	2781 TIOGA PINES CIR	LAS VEGAS NV 89117-2959			25-0147-RQR1
16301615001	BARRERA LUCIA ETAL	GARCIA ANDRES JOSE	5201 DOE AVE	LAS VEGAS NV 89146-0303		25-0147-RQR1
16301615002	BARRERA ENRIQUE	5205 DOE AVE	LAS VEGAS NV 89146-0303			25-0147-RQR1
16301615003	WILK ANDREA	9227 WILLIAM HILL AVE	LAS VEGAS NV 89146			25-0147-RQR1
16301615004	GARCIA ANDREW P	5213 DOE AVE	LAS VEGAS NV 89146-0303			25-0147-RQR1
16301615005	TORRES VIRGINIA	5217 DOE AVE	LAS VEGAS NV 89146			25-0147-RQR1
16301615016	LINDELL FAMILY TRUST	LINDELL JAC TRS	104 MALLARD ST	LAS VEGAS NV 89107		25-0147-RQR1
16301615017	WINNA RENTAL L L C - SERIES 6	3015 S TORREY PINES DR	LAS VEGAS NV 89146			25-0147-RQR1
16301615018	WONG SIU HING	6790 W OAKY BLVD	LAS VEGAS NV 89146-2914			25-0147-RQR1
16301615019	DURHAM JENNIFER	GUZMAN JOSE	5204 WESTLEIGH AVE	LAS VEGAS NV 89146		25-0147-RQR1
16301615020	ESCOBAR VICTOR ALEXANDER ESCOBAR	MOLINA MARIA VITALINA AYALA	5200 WESTLEIGH AVE	LAS VEGAS NV 89146		25-0147-RQR1
16301615021	LEE JENNY LAI YING	2206 UNIVERSITY AVE	HONOLULU HI 96822			25-0147-RQR1
16301615022	PATINO ISABEL	313 FOXVALE AVE	NORTH LAS VEGAS NV 89032			25-0147-RQR1
16301615023	COCCO NICHOLAS BENJAMIN	5209 WESTLEIGH AVE	LAS VEGAS NV 89146			25-0147-RQR1
16301615024	RODRIGUEZ PAUL SR & J D FAM TR	RODRIGUEZ PAUL SR & JUDITH D TRS	5213 WESTLEIGH AVE	LAS VEGAS NV 89146		25-0147-RQR1
16301615025	PAULA JUAN C	DEPAULA SUSANA DOMINGUEZ	5217 WESTLEIGH AVE	LAS VEGAS NV 89146		25-0147-RQR1
16301616006	ZEITER FAMILY TRUST	ZEITER GILDA M TRS	5216 W OAKY BLVD	LAS VEGAS NV 89146-3314		25-0147-RQR1
16301616007	HELLER ELIZABETH H TRUST	HELLER ELIZABETH H TRS	5212 W OAKY BLVD	LAS VEGAS NV 89146-3314		25-0147-RQR1
16301616008	JERRAM SARAH NICOLE	4401 TURNER BLVD	PAHRUMP NV 89061			25-0147-RQR1
16301616009	MORENO MARIANA	5204 W OAKY BLVD	LAS VEGAS NV 89146			25-0147-RQR1
16301616010	MENDOZA JORGE SERRANO	6392 CANYON DAWN AVE	LAS VEGAS NV 89107			25-0147-RQR1
16301703001	D L S E P V L L C	7301 PEAK DR STE 200	LAS VEGAS NV 89128-9308			25-0147-RQR1
16301704001	EXTRA SPACE PROPERTIES 127 L L C	PO BOX 800729	DALLAS TX 75380			25-0147-RQR1
16301704002	E L P VENTURES L L C	3738 PILGRIM ST	LAS VEGAS NV 89121			25-0147-RQR1

PARCEL	OWNER	ADDRESS1	ADDRESS2	ADDRESS3	ADDRESS4	CASE
16301704003	3 PLAY L L C	6360 S BUFFALO DR	LAS VEGAS NV 89113			25-0147-RQR1
16301704004	U-HAUL REAL ESTATE COMPANY	PO BOX 29046	PHOENIX AZ 85038-9046			25-0147-RQR1
16301704005	U-HAUL REAL ESTATE COMPANY	PO BOX 29046	PHOENIX AZ 85038-9046			25-0147-RQR1
16301708001	VERDE INVESTMENTS INC	1720 W RIO SALADO PKWY	TEMPE AZ 85281			25-0147-RQR1
16301708002	VERDE INVESTMENTS INC	1720 W RIO SALADO PKWY	TEMPE AZ 85281			25-0147-RQR1
16206217001	RICE ANNE MEREDITH & RONALD	1473 PINNER CT	LAS VEGAS NV 89102-1579			25-0147-RQR1
16206217002	KOZIOL GENE P & LINDA S	1473 PINNER CT # 101	LAS VEGAS NV 89102-1579			25-0147-RQR1
16206217003	WILLIAMS ANTHONY CHARLES & LARRY	1465 PINNER CT # 101	LAS VEGAS NV 89102			25-0147-RQR1
16206217004	KANE PAUL W	1465 PINNER CT # 102	LAS VEGAS NV 89102-1655			25-0147-RQR1
16206217005	MCCULLOUGH PAUL & HARYANI	1457 PINNER CT # 102	LAS VEGAS NV 89102			25-0147-RQR1
16206217006	SHUMWAY DUSTIN	1457 PINNER CT # 101	LAS VEGAS NV 89102			25-0147-RQR1
16206217007	ZACHODNI JASMINE NOELANI	1453 PINNER CT UNIT 101	LAS VEGAS NV 89102			25-0147-RQR1
16206217008	DOLLARHIDE ROPER	PO BOX 27332	LAS VEGAS NV 89126			25-0147-RQR1
16206217009	LANE DAVID L SR & CAROL J	1452 PINNER CT # 101	LAS VEGAS NV 89102-1686			25-0147-RQR1
16206217010	TROISI JOHN J	1452 PINNER CT # 102	LAS VEGAS NV 89102-1686			25-0147-RQR1
16206217011	KANG DAE YEON	1456 PINNER CT # 102	LAS VEGAS NV 89102-1687			25-0147-RQR1
16206217012	TONG ALEX MING DEEN	1456 PINNER CT # 101	LAS VEGAS NV 89102			25-0147-RQR1
16206217013	HUO RAN	1464 PINNER CT	LAS VEGAS NV 89102			25-0147-RQR1
16206217014	S L PROPERTIES L L C	12029 TELEGRAPH RD	SANTA FE SPRINGS CA 92886			25-0147-RQR1
16206217015	NURSE HARLENE M REVOCABLE TRUST	NURSE HARLENE M TRS	1472 PINNER CT # 102	LAS VEGAS NV 89102-1416		25-0147-RQR1
16206217016	B L LIVING TRUST	LEDERMAN BATSHEVA TRS	1473 BLISWORTH CT # 102	LAS VEGAS NV 89102-1408		25-0147-RQR1
16206217017	FRANCO LOUIS & CARRIE	1473 BLISWORTH CT # 101	LAS VEGAS NV 89102-1408			25-0147-RQR1
16206217018	BURKE CATHERINE E TRS	PO BOX 820	LOS OLIVOS CA 93441			25-0147-RQR1
16206217019	GOLZ GREGORY T & JANICE M	3228 25TH ST	ROCK ISLAND IL 61201			25-0147-RQR1
16206217020	LICHTMAN EDAN J	1457 BLISWORTH CT UNIT 102	LAS VEGAS NV 89102			25-0147-RQR1
16206217021	PEREZ JAIME ENRIQUE	1453 BLISWORTH CT # 101	LAS VEGAS NV 89102			25-0147-RQR1
16206217022	YU KYUNG J	1453 BLISWORTH CT # 102	LAS VEGAS NV 89102			25-0147-RQR1
16206217023	ALLENDER KRISTINA D	1452 BLISWORTH CT	LAS VEGAS NV 89102-1566			25-0147-RQR1
16206217024	HOEL EDMUND GEORGE	BIGELOW DEANNA R	1456 BLISWORTH CT # 101	LAS VEGAS NV 89102		25-0147-RQR1
16206217025	RUIZ JAIRO R	1456 BLISWORTH CT # 102	LAS VEGAS NV 89102			25-0147-RQR1
16206217026	MILEY DEBORA JEAN	1464 BLISWORTH CT	LAS VEGAS NV 89102			25-0147-RQR1
16206217027	MOULTON DEBRA K	1472 BLISWORTH CT # 101	LAS VEGAS NV 89102-1404			25-0147-RQR1
16206217028	TRAIVAI SOMSAKE	615 LAZY LN	LAS VEGAS NV 89107			25-0147-RQR1
16206217029	1376 INVESTMENT HOLDINGS L L C	1379 CUMULUS CT	HENDERSON NV 89014			25-0147-RQR1
16206217030	LEE JAY BEE	1473 TEDDINGTON CT UNIT 101	LAS VEGAS NV 89102			25-0147-RQR1
16206217031	CHOI LIVING TRUST	CHOI MYUNG SUK TRS	1465 TEDDINGTON CT	LAS VEGAS NV 89102		25-0147-RQR1
16206217032	KIEFER CAROLYN	1457 TEDDINGTON CT # 102	LAS VEGAS NV 89102			25-0147-RQR1
16206217033	LOUCHREN FAMILY TRUST ETAL	LOUCHREN WILLIAM T & PAULINE J TRS	1457 TEDDINGTON CT UNIT 101	LAS VEGAS NV 89102		25-0147-RQR1
16206217034	BOURN BRADLEY M	1453 TEDDINGTON CT	LAS VEGAS NV 89102-1563			25-0147-RQR1
16206217035	BURGESS GREGORY	136 VILLAGE LN	DAYTON BEACH FL 32119			25-0147-RQR1
16206217036	RASMUSSEN GUADALUPE	1452 TEDDINGTON CT # 101	LAS VEGAS NV 89102			25-0147-RQR1
16206217037	MARFIL HOMERO LIVING TRUST	MARFIL HOMERO CARENIA TRS	1456 TEDDINGTON CT	LAS VEGAS NV 89102		25-0147-RQR1
16206217038	NGUYEN MINH KIM	LUONG QUYNH CHAU	1464 TEDDINGTON CT # 102	LAS VEGAS NV 89102		25-0147-RQR1
16206217039	WRIGHT WAYNE A & DORIS L FAM TR	WRIGHT WAYNE A & DORIS L TRS	1464 TEDDINGTON CT # 101	LAS VEGAS NV 89102		25-0147-RQR1
16206217040	SANPEDRO ARMANDO	1472 TEDDINGTON CT UT 101	LAS VEGAS NV 89102			25-0147-RQR1
16206217041	HWANG JUNG JA	1472 TEDDINGTON CT # 102	LAS VEGAS NV 89102-1574			25-0147-RQR1
16206217042	TESSEMA ETSEGENET & MESFIN	1472 CRESLOW CT UNIT 102	LAS VEGAS NV 89102-1400			25-0147-RQR1
16206217043	ESCALANTE LILIA	1364 S 38TH ST	SAN DIEGO CA 92113			25-0147-RQR1
16206217044	SRIWATNAVORACHAI AMORASRI	TRAIVAI RENO & FLORIDA	1464 CRESLOW CT # 102	LAS VEGAS NV 89102-1691		25-0147-RQR1
16206217045	TROTTER MARKESIA	1464 CRESLOW CT # 101	LAS VEGAS NV 89102-1691			25-0147-RQR1
16206217046	DZIALOWSKI JERALD	1261 S ARVILLE ST	LAS VEGAS NV 89102-1600			25-0147-RQR1
16206217047	ZHAO SIFENG	4 SPRINBROOK RD E	MONTVILLE NJ 07045			25-0147-RQR1
16206217048	RUDY MICHAEL SCOTT REVOCABLE LIVING TRUST	RUDY MICHAEL SCOTT TRS	1452 CRESLOW CT	LAS VEGAS NV 89102		25-0147-RQR1
16206217049	CHEN JASON	SCHROEDER DEANNA	14241 NE WOODINVILLE-DUVALL RD	# 112	WOODINVILLE WA 98072-8564	25-0147-RQR1
16206217050	LALOR REVOCABLE LIVING TRUST	LALOR DAVID & DENISE TRS	1933 LANAI DR	COSTA MESA CA 92626		25-0147-RQR1
16206217051	MONFIERO REVOCABLE TRUST	1457 BRAMFIELD CT	LAS VEGAS NV 89102-1569			25-0147-RQR1
16206217052	TANG LI-CHENG	1465 BRAMFIELD CT # 102	LAS VEGAS NV 89102			25-0147-RQR1
16206217053	RUDICH MOSHE	921 E 31ST ST	BROOKLYN NY 11210			25-0147-RQR1

PARCEL	OWNER	ADDRESS1	ADDRESS2	ADDRESS3	ADDRESS4	CASE
16206217054	BATISO EYERUSALEM	ALEMU TEODROS	1473 BRAMFIELD CT # 101	LAS VEGAS NV 89102		25-0147-RQR1
16206217055	HANNERS LEONARD MARK & NIKKI LAVONNE	1473 BRAMFIELD CT UNIT 102	LAS VEGAS NV 89102			25-0147-RQR1
16206217056	VAZQUEZ LIVING TRUST	VAZQUEZ CONSUELO & FRANCISCO B TRS	1472 BRAMFIELD CT UNIT 102	LAS VEGAS NV 89102		25-0147-RQR1
16206217057	LIM SHARON	5000 RED ROCK ST APT 115	LAS VEGAS NV 89118			25-0147-RQR1
16206217058	MANIAUL JANET	MAMANGUN RIKKI	1464 BRAMFIELD CT # 102	LAS VEGAS NV 89102		25-0147-RQR1
16206217059	PORNTITAYA RACHAREJ	1464 BRAMFIELD CT # 101	LAS VEGAS NV 89102-1411			25-0147-RQR1
16206217060	PITTERMAN FAMILY TRUST-90	PITTERMAN ARTHUR B & SHARI J TRS	509 CRAIGIN PARK DR	LAS VEGAS NV 89107		25-0147-RQR1
16206217061	COPPLE JACK T & ELIZABETH N	1456 BRAMFIELD CT # 101	LAS VEGAS NV 89102			25-0147-RQR1
16206217062	WANG DONGSHUANG	QIAO FENG	1452 BRAMFIELD CT	LAS VEGAS NV 89102		25-0147-RQR1
16206217063	MILLER DANA R	1453 CUBLINGTON CT # 102	LAS VEGAS NV 89102			25-0147-RQR1
16206217064	PRINCER BELLE TRUST	PRINCER BELLE B TRS	1453 CUBLINGTON CT # 101	LAS VEGAS NV 89102-1672		25-0147-RQR1
16206217065	CHAMBERLAIN NATALIE	PO BOX 58396	FAIRBANKS AK 99711			25-0147-RQR1
16206217066	MACASKILL MARY	1465 CUBLINGTON CT # 102	LAS VEGAS NV 89102-1676			25-0147-RQR1
16206217067	BABA LIVING TRUST	IVANOVA MADLENA GEORGIEVA TRS	1465 CUBLINGTON CT UNIT 101	LAS VEGAS NV 89102		25-0147-RQR1
16206217068	DOROTIK BRIAN	1473 CUBLINGTON CT # 101	LAS VEGAS NV 89102			25-0147-RQR1
16206217069	LAI DAVID SAU FAT	CHIU DONNA TUEN YEE	1473 CUBLINGTON CT	LAS VEGAS NV 89102-1677		25-0147-RQR1
16206310001	TAN MEIYING	4700 OBANNON DR # A	LAS VEGAS NV 89102			25-0147-RQR1
16206310002	S F R INVESTMENTS POOL I L L C	7625 DEAN MARTIN DR STE 105	LAS VEGAS NV 89139			25-0147-RQR1
16206310003	MA TIMOTHY	HUANG SHIRLEY HUI	6037 KAUFFMAN AVE	TEMPLE CITY CA 91780-1742		25-0147-RQR1
16206310004	MARTIN JOSEPH	4700 OBANNON DR # D	LAS VEGAS NV 89102			25-0147-RQR1
16206310005	PEDERSEN LEWIS M	4702 OBANNON DR # A	LAS VEGAS NV 89102-3572			25-0147-RQR1
16206310006	J A M PROPERTIES INTL L L C	17555 VENTURA BLVD # 202	ENCINO CA 91316-3890			25-0147-RQR1
16206310007	EGRI ANNA	VOICU ANDREI A	4702 O'BANNON DR UNIT C	LAS VEGAS NV 89102		25-0147-RQR1
16206310008	SLATER CHARLOTTE E & LEEROY	19740 E SUNSET VISTA RD	WALNUT CA 91789-5326			25-0147-RQR1
16206310009	BOX HALEY	4704 O'BANNON DR # A	LAS VEGAS NV 89102			25-0147-RQR1
16206310010	BARNEY ROBERT T	4704 OBANNON DR UNIT B	LAS VEGAS NV 89102			25-0147-RQR1
16206310011	OGNEOVSKI JORGO	9762 VIA ROMO	BURBANK CA 91504			25-0147-RQR1
16206310012	NAW NANG SENG KHAM ETAL	GROUX MAURICE R & LYNDA	4704 OBANNON DR UNIT D	LAS VEGAS NV 89102		25-0147-RQR1
16206310013	MIRAB TRUST	KATANI MINA TRS	4617 S ESTRELLA PRIVADO	ONTARIO CA 91761		25-0147-RQR1
16206310014	HINES KAREN E LIVING TRUST	HINES KAREN E TRS	4706 OBANNON DR # B	LAS VEGAS NV 89102-3578		25-0147-RQR1
16206310015	FILAMOR NORGEL GAPASIN	4706 OBANNON DR UNIT C	LAS VEGAS NV 89102			25-0147-RQR1
16206310016	WITTEN FAMILY TRUST	WITTEN WILLIAM T & BONNIE J TRS	10 KEVIN CT	CHICO CA 95928		25-0147-RQR1
16206310017	WANG QING	4708 OBANNON DR UNIT A	LAS VEGAS NV 89102			25-0147-RQR1
16206310018	TRIGOLD PROPERTIES L L C	13251 VENTURA BLVD # 2	STUDIO CITY CA 91604			25-0147-RQR1
16206310019	BLAIR WILLIAM JOSEPH	6810 SIERRA TRL	LAS VEGAS NV 89146			25-0147-RQR1
16206310020	BORN-IN-NEVADA L L C	MALLILAY IRINA	1700 W CERRITOS AVE UNIT # 341	ANAHEIM CA 92804		25-0147-RQR1
16206310021	PARAYNO SONNY TRUST	95 GREENSBORO WAY	ANTIOCH CA 94509			25-0147-RQR1
16206310022	PARAYNO SONNY TRUST	95 GREENSBORO WAY	ANTIOCH CA 94509-6042			25-0147-RQR1
16206310023	PARAYNO SONNY TRUST	95 GREENSBORO WAY	ANTIOCH CA 94509-6042			25-0147-RQR1
16206310024	PARAYNO SONNY TRUST	95 GREENSBORO WAY	ANTIOCH CA 94509-6042			25-0147-RQR1
16206310030	FUNG FAMILY TRUST	3970 WAINSCOT CT	LAS VEGAS NV 89147			25-0147-RQR1
16206310025	PARAYNO SONNY TRUST	95 GREENSBORO WAY	ANTIOCH CA 94509-6042			25-0147-RQR1
16206310026	PARAYNO SONNY TRUST	95 GREENSBORO WAY	ANTIOCH CA 94509-6042			25-0147-RQR1
16206310027	PARAYNO SONNY TRUST	95 GREENSBORO WAY	ANTIOCH CA 94509-6042			25-0147-RQR1
16206310028	PARAYNO SONNY TRUST	95 GREENSBORO WAY	ANTIOCH CA 94509-6042			25-0147-RQR1
16206310029	TAN MEIYING	4700 OBANNON DR APT A	LAS VEGAS NV 89102			25-0147-RQR1
16206310031	BARTHOLOMEW FAMILY TRUST	BARTHOLOMEW ANTHONY & J L CO-TRS	3132 IVORY COAST DR	LAS VEGAS NV 89117		25-0147-RQR1
16206310032	HELEN LAM TRUST	LAM HELEN TRS	6 ADMIRAL DR # 289	EMERYVILLE CA 94608		25-0147-RQR1
16206310033	VRBENSKY JOSEPH	4716 O'BANNON DR # A	LAS VEGAS NV 89102			25-0147-RQR1
16206310034	TSARUKYAN FAMILY REVOCABLE TRUST	TSARUKYAN HAKOP JACK & AIDA TRS	6547 MARY ELLEN AVE	VAN NUYS CA 91401		25-0147-RQR1
16206310035	TU CHUONG CAM	6143 PINWOOD	LAS VEGAS NV 89103-2229			25-0147-RQR1
16206310036	LOI FAMILY TRUST	LOI TOM & PAULA L TRS	5631 CALIFORNIA ST	SAN FRANCISCO CA 94121		25-0147-RQR1
16206310040	GARDNER PATRICIA LUCILLE	3838 EDMOND ST	LAS VEGAS NV 89103-2413			25-0147-RQR1
16206310037	AMOROSO FAMILY TRUST	AMOROSO SYLVIA TRS	4718 OBANNON DR # A	LAS VEGAS NV 89102-3581		25-0147-RQR1
16206310038	DONG YAN REVOCABLE TRUST	SHAO GUANGDONG TRS	1501 COPPERFIELD PKWY APT 222	COLLEGE STATION TX 77845		25-0147-RQR1
16206310039	DOOLEY BRANDON	MILLER BLAISE	4718 OBANNON DR UNIT C	LAS VEGAS NV 89102		25-0147-RQR1
16206310041	YARMAK STEVEN	4509 DEL MONTE AVE	LAS VEGAS NV 89102-1520			25-0147-RQR1
16206310042	GUZMAN ECTNA DIANE MENDOZA	4720 OBANNON DR UNIT B	LAS VEGAS NV 89102			25-0147-RQR1

PARCEL	OWNER	ADDRESS1	ADDRESS2	ADDRESS3	ADDRESS4	CASE
16206310043	A C & E F INVESTMENT L L C	279 RENOAK WAY	ALHAMBRA CA 91007			25-0147-RQR1
16206310044	MCNAMEE JUNE M	4720 OBANNON DR # D	LAS VEGAS NV 89102-3504			25-0147-RQR1
16206310045	AGUILAR RAUL	4722 OBANNON DR UNIT A	LAS VEGAS NV 89102			25-0147-RQR1
16206310046	KENDRICK TERESA J & MARIOS M	3349 SALMON CREEK DR	LAS VEGAS NV 89129			25-0147-RQR1
16206310047	RUDIK IGOR & TATYANA	4722 OBANNON DR # C	LAS VEGAS NV 89102-3575			25-0147-RQR1
16206310048	MIRAB TRUST	RAHBAR SOHRAB TRS	4617 S ESTRELLA PRIVADO	ONTARIO CA 91761		25-0147-RQR1
16206310052	PARAYNO SONNY TRUST	95 GREENSBORO WAY	ANTIOCH CA 94509-6042			25-0147-RQR1
16206310049	R R O H PROPERTIES L L C	6726 239TH ST	OAKLAND GARDENS NY 11364			25-0147-RQR1
16206310050	RADFORD DEBORAH MARIE	247 N CIMARRON RD	LAS VEGAS NV 89145			25-0147-RQR1
16206310051	HUBERT REVOCABLE TRUST	HUBERT OSCAR B & SHIRLEY A TRS	PO BOX 5165	DIAMOND BAR CA 91765-7165		25-0147-RQR1
16206310053	LUO XINMIN	23 ROSECLAIRE ST	BOSTON MA 02125-1717			25-0147-RQR1
16206310054	G R Q INVESTMENTS TRUST	BURTON ELIINOR & RICHARD TRS	4132 BON HOMME RD	CALABASAS CA 91302		25-0147-RQR1
16206310055	CORDERO MARTHA ISABEL	4736 OBANNON DR UNIT C	LAS VEGAS NV 89102			25-0147-RQR1
16206310056	WEI HONG	4736 O'BANNON DR # D	LAS VEGAS NV 89102-3577			25-0147-RQR1
16206310057	MANCILLA SAMUEL	4734 O'BANNON DR # B	LAS VEGAS NV 89102			25-0147-RQR1
16206310058	MATHIESEN ANNIE	4734 OBANNON DR # B	LAS VEGAS NV 89102-3584			25-0147-RQR1
16206310059	JIMENEZ LUIS BORGES	RIVERO MARIA DELCARMEN	4409 THOMPSON CIR	LAS VEGAS NV 89107		25-0147-RQR1
16206310060	MAIORAN FRANCES C	4734 OBANNON DR # D	LAS VEGAS NV 89102-3584			25-0147-RQR1
16206310064	BENNETT DOUGLAS	634 N E 17TH WAY	FORT LAUDERDALE FL 33304			25-0147-RQR1
16206310061	CLAYTON DEBORAH	4732 OBANNON DR UNIT A	LAS VEGAS NV 89102			25-0147-RQR1
16206310062	ZENUNI KOSTANDINA	5996 WHITLING TREE CT	LAS VEGAS NV 89148			25-0147-RQR1
16206310063	DEV SOL CORPORATION	1036 W GARDENA BLVD # 3	GORDENA CA 90247-4975			25-0147-RQR1
16206310065	S F R INVESTMENTS POOL I L L C	7625 DEAN MARTIN DR STE 105	LAS VEGAS NV 89139			25-0147-RQR1
16206310066	HOFILENA LEAH	2655 TOPAZ BLUE ST	LAS VEGAS NV 89117			25-0147-RQR1
16206310067	PECORA JUSTIN & KAORI	5-6-2 KOYUCHONAKA # 433	HIGASHINADA	KU KOBE 658-0032	JAPAN	25-0147-RQR1
16206310068	CABATU JOHN	7875 HAMILTON POOL DR	LAS VEGAS NV 89113			25-0147-RQR1
16206310069	TOM LARRY V TRUST	TOM JUANITA Y M TRUST	5555 KANAU ST	HONOLULU HI 96821-2014		25-0147-RQR1
16206310070	WILLIAMS CLAYTON P	23809 LAMOUR CT	TORRANCE CA 90501			25-0147-RQR1
16206310071	WILSON WILLIAM A	4728 OBANNON DR APT C	LAS VEGAS NV 89102-3582			25-0147-RQR1
16206310072	GINI VICTORIA ELIZABETH	4577 BARNES CT	LAS VEGAS NV 89147			25-0147-RQR1
16206310078	I PROJECTS L L C	2053 GLENVIEW DR	LAS VEGAS NV 89134			25-0147-RQR1
16206310073	WAGERS HOUSE TRUST	WAGERS FRANK E TRS	4744 O BANNON DR # A	LAS VEGAS NV 89102-3540		25-0147-RQR1
16206310074	LANE SYLVIA TRUST	LANE SYLVIA TRS	1124 W 64TH ST	LOS ANGELES CA 90044		25-0147-RQR1
16206310075	ISLAM ABDUL	4224 ALVADA ST	LYNWOOD CA 90262			25-0147-RQR1
16206310076	LEE WEI HAO & CHRISTINA GEE	75 BENMORE DR	HAYWARD CA 94542			25-0147-RQR1
16206310077	BAS BUEN A	MONES JAYA B	4742 OBANNON DR UT A	LAS VEGAS NV 89102		25-0147-RQR1
16206310079	PARAYNO SONNY TRUST	95 GREENSBORO WAY	ANTIOCH CA 94509-6042			25-0147-RQR1
16206310080	ZHANG XIAOMIN	BAI XUE	3129 ARVILLE ST	LAS VEGAS NV 89102		25-0147-RQR1
16206310081	I PROJECTS L L C	2053 GLENVIEW DR	LAS VEGAS NV 89134			25-0147-RQR1
16206310082	I PROJECTS L L C	2053 GLENVIEW DR	LAS VEGAS NV 89134			25-0147-RQR1
16206310083	I PROJECTS L L C	2053 GLENVIEW DR	LAS VEGAS NV 89134			25-0147-RQR1
16206310084	I PROJECTS L L C	2053 GLENVIEW DR	LAS VEGAS NV 89134			25-0147-RQR1
16206310085	TU HA SAY	LANG HUNG UYEN	6143 PINWOOD AVE	LAS VEGAS NV 89103-2229		25-0147-RQR1
16206310086	NGUYEN VI AI TUONG	1315 W WASHINGTON ST	HARPERS FERRY WV 25425			25-0147-RQR1
16206310089	CHAMBERS DEANDREA N & SHADONNA J	810 EDGEWOOD ST # 301	INGLEWOOD CA 90302			25-0147-RQR1
16206310087	CHO KUN CHA	4738 OBANNON DR # C	LAS VEGAS NV 89102			25-0147-RQR1
16206310088	DISCOUNT DISTRIBUTORS	4616 W SAHARA AVE # 317	LAS VEGAS NV 89102-3654			25-0147-RQR1
16206310090	BERNADITA SALVADOR 2022 TRUST	SALVADOR BERNADITA TRS	1579 DARRAH AVE	SIMI VALLEY CA 93063		25-0147-RQR1
16206310091	BROWN FAMILY REVOCABLE TRUST	BROWN STEPHEN A & SANDRA T TRS	2429 ALLRED ST	LAKEWOOD CA 90712		25-0147-RQR1
16206310092	LIN YI-HUA	YEN CHAI-WEI	5113 MIEMBRO	LAGUNA WOODS CA 92637		25-0147-RQR1
16206310093	EMMETT PEGGY ANN & PATRUCUA	4750 OBANNON DR # A	LAS VEGAS NV 89102-3589			25-0147-RQR1
16206310094	JACKSON BARBARA	DAVIS RACHAEL	4750 OBANNON DR # B	LAS VEGAS NV 89102		25-0147-RQR1
16206310095	JONES BRANDON XAVIER	4750 OBANNON DR UNIT C	LAS VEGAS NV 89102			25-0147-RQR1
16206310096	CORONA ARMANDO	4750 O'BANNON DR # D	LAS VEGAS NV 89102-3589			25-0147-RQR1
16206310097	MUNOZ-HERRERA MARCIAL LUIS	6141 CROMWELL AVE	LAS VEGAS NV 89107			25-0147-RQR1
16206310099	CHAVEZ AMY F	BERTELSON CHAD PATRICK	4748 OBANNON DR # C	LAS VEGAS NV 89102		25-0147-RQR1
16206310100	FISHER KAREN K REVOCABLE LIVING TRUST	FISHER KAREN K TRS	4748 OBANNON DR # D	LAS VEGAS NV 89102		25-0147-RQR1
16206310101	G I S TRUST	PO BOX 48708	LOS ANGELES CA 90048			25-0147-RQR1

PARCEL	OWNER	ADDRESS1	ADDRESS2	ADDRESS3	ADDRESS4	CASE
16206310102	LEMUS CARYOLYN G	COMMINEY EDWARD S	4746 OBANNON DR UNIT B	LAS VEGAS NV 89102		25-0147-RQR1
16206310103	VITE LACY	4746 OBANNON DR UNIT C	LAS VEGAS NV 89102			25-0147-RQR1
16206310104	J M C C M C REVOCABLE LIVING TRUST	2673 LAGUNA SHORES LN	LAS VEGAS NV 89121			25-0147-RQR1
16206310098	WRIGHT ANDREA	4748 OBANNON DR UNIT B	LAS VEGAS NV 89102			25-0147-RQR1
16301710001	CSOKA AGNES I	1800 EDMOND ST UNIT 164	LAS VEGAS NV 89146			25-0147-RQR1
16301710002	GUO DAN TONG LIVING TRUST	164 WALKINSHAW AVE	LAS VEGAS NV 89148			25-0147-RQR1
16301710003	GARCIA LEONARDO LIVING TRUST	GARCIA LEONARDO TRS	1800 EDMOND ST	BLDG A UNIT 163	LAS VEGAS NV 89146	25-0147-RQR1
16301710004	EDWARDS VINCENT BERNARD	1800 EDMOND ST UNIT 263	LAS VEGAS NV 89146			25-0147-RQR1
16301710005	ALWAYS FORTUNE CORP	44 CROOKED PUTTER DR	LAS VEGAS NV 89148			25-0147-RQR1
16301710006	LIN FRANK	21 EL DORADO ST # C	ARCADIA CA 91006			25-0147-RQR1
16301710007	MCCORMAC DANIEL J	1800 EDMOND ST # 161	LAS VEGAS NV 89146-0329			25-0147-RQR1
16301710008	AKRAMI SEVDA	1800 EDMOND ST UNIT 261	LAS VEGAS NV 89146			25-0147-RQR1
16301710009	HOOKALA CHASE KEKOA	1800 EDMOND ST # 160	LAS VEGAS NV 89146			25-0147-RQR1
16301710010	MUDGE ERIC D	1800 EDMOND ST # 260	LAS VEGAS NV 89146			25-0147-RQR1
16301710011	DRAFI MAGDOLNA	9620 SIMPLE LIFE AVE	LAS VEGAS NV 89148			25-0147-RQR1
16301710012	ROSSI KYLA N	1800 EDMOND ST UNIT 255	LAS VEGAS NV 89146			25-0147-RQR1
16301710013	BOYD FREDDIE ALTON JR III	PO BOX 29102	LAS VEGAS NV 89126-3102			25-0147-RQR1
16301710014	ERICA LIVING TRUST	WANG HU TRS	7318 SUMMER GROVE AVE	LAS VEGAS NV 89117		25-0147-RQR1
16301710015	BLANCHARD PIERRE	1800 EDMOND ST # 157	LAS VEGAS NV 89146			25-0147-RQR1
16301710016	SMITH DORA DEAN REVOCABLE LIVING TRUST	SMITH DORA DEAN TRS	1800 EDMOND ST APT 257	LAS VEGAS NV 89146		25-0147-RQR1
16301710017	HO JAY H	1800 EDMOND ST # 158	LAS VEGAS NV 89146			25-0147-RQR1
16301710018	BALSAMO MARLO A	1800 EDMOND ST UNIT 258	LAS VEGAS NV 89146			25-0147-RQR1
16301710019	GUZMAN TRUST	GUZMAN HAROLD A TRS	10473 BURENSBURG AVE	LAS VEGAS NV 89135		25-0147-RQR1
16301710020	STROE RAMONA M	STROE MIRCEA & DORICA	2541 W ORANGE AVE	ANAHEIM CA 92804-3324		25-0147-RQR1
16301710021	MARTIN REMY M	1800 S EDMOND ST # 102	LAS VEGAS NV 89146-0326			25-0147-RQR1
16301710022	MAGORY PATRICK	1800 EDMOND ST APT 254	LAS VEGAS NV 89146			25-0147-RQR1
16301710023	CABO CHRISTOPHER	1800 EDMOND ST UNIT 153	LAS VEGAS NV 89146			25-0147-RQR1
16301710024	NAKAMURA ANDREW	1800 EDMOND ST APT C253	LAS VEGAS NV 89146			25-0147-RQR1
16301710025	PILIP JANUSZ REVOCABLE LIVING TRUST	PILIP JANUSZ TRS	1800 EDMOND ST # 152	LAS VEGAS NV 89146		25-0147-RQR1
16301710026	MAZELIN NGUYEN FAMILY TRUST ETAL	MAZELIN GREGORY THOMAS TRS	7404 OAK GROVE AVE	LAS VEGAS NV 89117		25-0147-RQR1
16301710027	DALEY STEPHEN P	2540 S MARYLAND PKWY # 139	LAS VEGAS NV 89109			25-0147-RQR1
16301710028	NG SEE PING BOB & SUSAN LEE	1482 S MAIN ST	WILLITS CA 95490			25-0147-RQR1
16301710029	WARE EDWARD C JR	1800 EDMOND ST # 150	LAS VEGAS NV 89146-0329			25-0147-RQR1
16301710030	COTTON DREW S	1800 EDMOND ST APT 250	LAS VEGAS NV 89146			25-0147-RQR1
16301710031	WU TONY	XU JIANG	87 RICHARD BROWN DR	UNCASVILLE CT 06382		25-0147-RQR1
16301710032	VALENZUELA CARLOS L	1800 EDMOND ST APT 245	LAS VEGAS NV 89146			25-0147-RQR1
16301710033	MACH YEN T	CHU HAO K	8651 ST ANDREWS AVE	WESTMINSTER CA 92683		25-0147-RQR1
16301710034	SHAWTY-E FAMILY TRUST	PO BOX 5304	GARDENA CA 90249			25-0147-RQR1
16301710035	LIU ECHO	CHAI GRACE	2418 NEW AVE	ROSEMead CA 91770		25-0147-RQR1
16301710036	WU TONY	XU JIANG	87 RICHARD BROWN DR	UNCASVILLE CT 06382		25-0147-RQR1
16301710037	GUTIERREZ CELESTE	1800 EDMOND ST APT 148	LAS VEGAS NV 89146			25-0147-RQR1
16301710038	CARLOS JOSE I & MARIA A	5324 PADUA WAY	LAS VEGAS NV 89107-0404			25-0147-RQR1
16301710039	VANDYKE DANIEL L	6347 VERNON WOODS DR NE	SANDY SPRINGS GA 30328			25-0147-RQR1
16301710040	WU YIQING	7055 MOSS HILL AVE	LAS VEGAS NV 89113			25-0147-RQR1
16301710041	MADJAR VESNA	1800 EDMOND ST UNIT 144	LAS VEGAS NV 89146			25-0147-RQR1
16301710042	WU GUIMEI	HAO QI	4952 W MOBERLY AVE	LAS VEGAS NV 89139		25-0147-RQR1
16301710043	BURNLEY KIMBERLY & CANDACE	2411 BROCKTON WAY	HENDERSON NV 89074			25-0147-RQR1
16301710044	SERIES V A B L L C EDMOND L L C	8067 DARK HOLLOW PL	LAS VEGAS NV 89117			25-0147-RQR1
16301710045	LI SHUANGYANG	1800 EDMOND ST APT 142	LAS VEGAS NV 89146			25-0147-RQR1
16301710046	MA MAGGIE WEN HSIEN	541 CHARMINGDALE RD	DIAMOND BAR CA 91765			25-0147-RQR1
16301710047	LASTRA NORMA L	1800 EDMOND ST # 141-E	LAS VEGAS NV 89146-0328			25-0147-RQR1
16301710048	PASTORI YASNA	1800 EDMOND ST # 241	LAS VEGAS NV 89146			25-0147-RQR1
16301710049	MEDINA SANDRA A	1800 EDMOND ST # 140	LAS VEGAS NV 89146-0328			25-0147-RQR1
16301710050	NGUYEN THULHA T	3012 SW 110TH ST	SEATTLE WA 98146			25-0147-RQR1
16301710051	CHING CURTIS	98-1234 ILIEE PL	AIEA HI 96701-3463			25-0147-RQR1
16301710052	SELASSIE EMANUEL	BEKELE KELEMWA A	1800 EDMOND ST # 235	LAS VEGAS NV 89146-0332		25-0147-RQR1
16301710053	CHAN LAI SHEUNG	9163 W FLAMINGO RD # 100	LAS VEGAS NV 89147			25-0147-RQR1
16301710054	KING GREGGY OLIVER M	1800 EDMOND ST UNIT 236	LAS VEGAS NV 89146			25-0147-RQR1

PARCEL	OWNER	ADDRESS1	ADDRESS2	ADDRESS3	ADDRESS4	CASE
16301710055	LIGERALDE GERALD L & JUANITA	1117 N 16TH ST	SHEBOYGAN WI 53081			25-0147-RQR1
16301710056	DAUGHERTY WILLIE	1800 EDMOND ST # 237	LAS VEGAS NV 89146-0332			25-0147-RQR1
16301710057	ALONSO HECTOR	3014 W MARTINS GRANT CIR	RICHMOND VA 23236			25-0147-RQR1
16301710058	NOIROT-NEVADA SERIES III L L C	4040 S EASTERN AVE STE 100	LAS VEGAS NV 89119			25-0147-RQR1
16301710059	VANVALKENBURG JAMES REVOCABLE LIVING TRUST	VANVALKENBURG JAMES TRS	PO BOX 28636	LAS VEGAS NV 89126		25-0147-RQR1
16301710060	JU FAMILY TRUST	JU RICHARD YUAN & BARBARA TRS	6415 S FORT APACHE RD # 185-78	LAS VEGAS NV 89148		25-0147-RQR1
16301710061	MANUEL JONATHAN	6636 CLYBOURN AVE UNIT 51	LOS ANGELES CA 91606			25-0147-RQR1
16301710062	STROE DORICA & MIRCEA G	2541 W ORANGE AVE	ANAHEIM CA 92804-3324			25-0147-RQR1
16301710063	OWENS RICHERD C & NANCY J	9116 DOVE RIVER RD	LAS VEGAS NV 89134			25-0147-RQR1
16301710064	WALKER KEVAN ROSS	1800 EDMOND ST # 231	LAS VEGAS NV 89146-0331			25-0147-RQR1
16301710065	ARUTYUNYAN VARDAN	1800 S EDMOND ST # 132	LAS VEGAS NV 89146			25-0147-RQR1
16301710066	PILOTO ARIASNY BRAVO	1800 EDMOND ST APT 232	LAS VEGAS NV 89146			25-0147-RQR1
16301710067	GUO HUGO ZUOPING	WANG HOLLY XIAOLING	4170 VIA DANTE	MONTCLAIR CA 91763		25-0147-RQR1
16301710068	TRANI JESUS ARENAS	1800 EDMOND ST APT 233	LAS VEGAS NV 89146			25-0147-RQR1
16301710069	MIHAYLOVICH SLOBODAN & DRAGINIA	1800 EDMOND ST # 134	LAS VEGAS NV 89146-0328			25-0147-RQR1
16301710070	TRAN THOMAS & KATHY	5629 ASPEN ST	CYPRESS CA 90630-3803			25-0147-RQR1
16301710071	SALONE VALERIE L	1800 EDMOND ST # 101	LAS VEGAS NV 89146			25-0147-RQR1
16301710072	GONZALEZ JUAN A & LAURA J	5516 MADIGAN CT	LAS VEGAS NV 89118-6030			25-0147-RQR1
16301710073	LIU SHANCHENG	LI GUIYUE	808 SALEM DR	LAS VEGAS NV 89107		25-0147-RQR1
16301710074	LU LOUIE HUNG KWEI	18600 COLIMA RD # H109	ROWLAND HEIGHTS CA 91748-5802			25-0147-RQR1
16301710075	CHIU RICHARD C H & KATHERINE S L	1880 CARLISLE DR	SAN MARINO CA 91108			25-0147-RQR1
16301710076	HUGHES MICHAEL ANTHONY	1800 EDMOND ST UNIT 203	LAS VEGAS NV 89146-0330			25-0147-RQR1
16301710077	KANSAN CITY NEVADA L L C	3820 W GARY AVE	LAS VEGAS NV 89139			25-0147-RQR1
16301710078	MOUSSAVI SHAHIN DOKHT ALLAHYARI REVOCABLE TRUST	MOUSSAVI PARVIZ OR SHAHIN D TRS	1040 WHITE TAIL CIR	WITCHIA KS 67206-4140		25-0147-RQR1
16301710079	1800 EDMOND ST TRUST	PROPERTY PRIVACY SERVICES TRS	4730 S FORT APACHE RD STE 300	LAS VEGAS NV 89147		25-0147-RQR1
16301710080	POTTER KATHLEEN A	1800 EDMOND ST # 209	LAS VEGAS NV 89146			25-0147-RQR1
16301710081	HERNANDEZ ESEQUIEL FRANCO	1238 W CHESTNUT AVE	SANTA ANA CA 92703			25-0147-RQR1
16301710082	GRANDE HALLAT THE GARDENS L L C	9921 CAMEL MOUNTAIN RD STE 606	SAN DIEGO CA 92129			25-0147-RQR1
16301710083	LITERATUS ERLINDA	938 N REDDING WAY UNIT D	UPLAND CA 91786			25-0147-RQR1
16301710084	SPENCE PROPERTIES L L C	10216 BRISTOL PEAK AVE	LAS VEGAS NV 89166			25-0147-RQR1
16301710085	DUNNS FAMILY REVOCABLE LIVING TRUST	DUNN EDDIE FUSYING & KATHY CHINCHU TRS	318 HARPERS FERRY AVE	LAS VEGAS NV 89148		25-0147-RQR1
16301710086	ZHANG CHAOYANG	9321 VILLA RIDGE DR	LAS VEGAS NV 89134			25-0147-RQR1
16301710087	TU YING	1800 EDMOND ST UNIT 105	LAS VEGAS NV 89146			25-0147-RQR1
16301710088	ZU QINXIN & GAO XIULIN REV TR	ZU QINXIN TRS	6762 MOUNT LENEVE DR	SAN JOSE CA 95120		25-0147-RQR1
16301710089	O'CONNELL SUSAN J TRUST	O'CONNELL SUSAN J TRS	PO BOX 37	DONNELLY ID 83615-0037		25-0147-RQR1
16301710090	GARAN JUNE TRUST	GARAN JUNE TRS	1800 EDMOND ST # 210	LAS VEGAS NV 89146		25-0147-RQR1
16301710091	THAM HOA ANH	9243 SAILING WATER AVE	LAS VEGAS NV 89147-6854			25-0147-RQR1
16301710092	WYATT DANNY & VUTHEAR	1800 EDMOND ST # 211	LAS VEGAS NV 89146			25-0147-RQR1
16301710093	DRAFI MAGDOLNA	1800 EDMOND ST UNIT 155	LAS VEGAS NV 89146			25-0147-RQR1
16301710094	MANALAC NICOLAS P & SOFIA C	MANALAC DANIEL C	1800 EDMOND ST # 212	LAS VEGAS NV 89146-0330		25-0147-RQR1
16301710095	STREIGHTIFF P JENNIE J	1623 N WOODHAVEN	FRANKTOWN CO 80116-9516			25-0147-RQR1
16301710096	ALEKSIC DRAGANA	205 JANICE ESTELLE DR	LAS VEGAS NV 89107			25-0147-RQR1
16301710097	ESQUIVEL-PONCE BENITO	DEESQUIVEL ANA MARIA COBIAN	1800 EDMOND ST UNIT 114	LAS VEGAS NV 89146		25-0147-RQR1
16301710098	CHU HAO K	MACH YEN T	8651 ST ANDREW AVE	WESTMINSTER CA 92683-7267		25-0147-RQR1
16301710099	FLORES OLIVIA	1800 EDMOND ST # 119	LAS VEGAS NV 89146-0327			25-0147-RQR1
16301710100	PUENTESPINA LILIAN & ERNESTO	1800 EDMOND ST # 219	LAS VEGAS NV 89146-0331			25-0147-RQR1
16301710101	TAKUSHI WILFRED	1324 RAINBOW MEADOWS DR	LAS VEGAS NV 89128			25-0147-RQR1
16301710102	DU NANCY WEN	1800 EDMOND ST # 218	LAS VEGAS NV 89146			25-0147-RQR1
16301710103	PARK KYUNG SUK	1800 EDMOND ST UNIT 117	LAS VEGAS NV 89146-0327			25-0147-RQR1
16301710104	V I K 2020 TRUST	KRUSTEV VESSELIN IVANOV TRS	1800 EDMOND ST # 217	LAS VEGAS NV 89146-0331		25-0147-RQR1
16301710105	RADIN FAMILY TRUST	RADIN ALBERT I & CATHERINE JEAN TRS	19881 GLOUCESTER LN	HUNTINGTON BEACH CA 92646-4043		25-0147-RQR1
16301710106	EVANS LISA	1800 EDMOND ST # 216	LAS VEGAS NV 89146			25-0147-RQR1
16301710107	HOLLYVALE RENTAL HOLDINGS L L C	2015 MANHATTAN BEACH BLVD STE 100	REDONDO BEACH CA 90278			25-0147-RQR1
16301710108	RIVERA JOSEPH	1800 EDMOND ST UNIT 215	LAS VEGAS NV 89146			25-0147-RQR1
16301710109	AMERICA FIRST FEDERAL CREDIT UNION	PO BOX 9199	OGDEN UT 84409			25-0147-RQR1
16301710110	GONZALEZ MARK	9124 CRAVEN AVE	LAS VEGAS NV 89149			25-0147-RQR1
16301710111	COLLINS PAMELA	1800 EDMOND ST # 123	LAS VEGAS NV 89146-0327			25-0147-RQR1
16301710112	R O I ASSETS L L C	8670 SPRING MOUNTAIN RD STE 102	LAS VEGAS NV 89117			25-0147-RQR1

PARCEL	OWNER	ADDRESS1	ADDRESS2	ADDRESS3	ADDRESS4	CASE
16301710113	LIENDO RAMON URBAEZ	1236 ARC DOME AVE	LAS VEGAS NV 89031			25-0147-RQR1
16301710114	KOHMS RITA M	2524 S DREXEL	MESA AZ 85209			25-0147-RQR1
16301710115	CHIPETA EDGAR F	74 EAST 5TH AVE	COLLEGEVILLE PA 19426			25-0147-RQR1
16301710116	SARO NAHOM	1800 EDMOND ST # 221	LAS VEGAS NV 89146			25-0147-RQR1
16301710117	SULLIVAN COLLEEN M	MAFILAS GEORGE ANTHONY	13039 37TH AVE NE	SEATTLE WA 98125		25-0147-RQR1
16301710118	PEREZ JACQUES L	1800 EDMOND ST # L220	LAS VEGAS NV 89146-0325			25-0147-RQR1
16301710119	SUGATHADASA MANELGEDON	1800 EDMOND ST # 129	LAS VEGAS NV 89146-0327			25-0147-RQR1
16301710120	GUNAWAN MATTHEW & TERESIA	1800 EDMOND ST UNIT 229	LAS VEGAS NV 89146			25-0147-RQR1
16301710121	GARTON ASPEN	1800 EDMOND ST UNIT 128	LAS VEGAS NV 89146			25-0147-RQR1
16301710122	STEWART CHRISTOPHER J	CHAO CHIA-HUA	1800 EDMOND ST # 228	LAS VEGAS NV 89146-0331		25-0147-RQR1
16301710123	KNASS TRUST 2007	FISHER DONA TRS	PO BOX 11929	COSTA MESA CA 92627		25-0147-RQR1
16301710124	STAR TEN L L C	8707 BLACK CORDONE RD	LAS VEGAS NV 89139			25-0147-RQR1
16301710125	LEMUS MARIA A	1800 EDMOND ST # 126	LAS VEGAS NV 89146-0327			25-0147-RQR1
16301710126	MUNTEAN BASILE & CARMEN E	5816 E PASEO DE SOTO	ANAHEIM CA 92807-3935			25-0147-RQR1
16301710127	GONZALEZ A & A FAMILY TRUST 2019	GONZALEZ MIGUEL ANGEL & CHRISTINE YVETTE TRS	561 E J ST	ONTARIO CA 91764		25-0147-RQR1
16301710128	IWAOKA STEVEN	1357 MANU ALOHA ST	KAILUA HI 96734-4315			25-0147-RQR1