

VICINITY MAP NOT TO SCALE

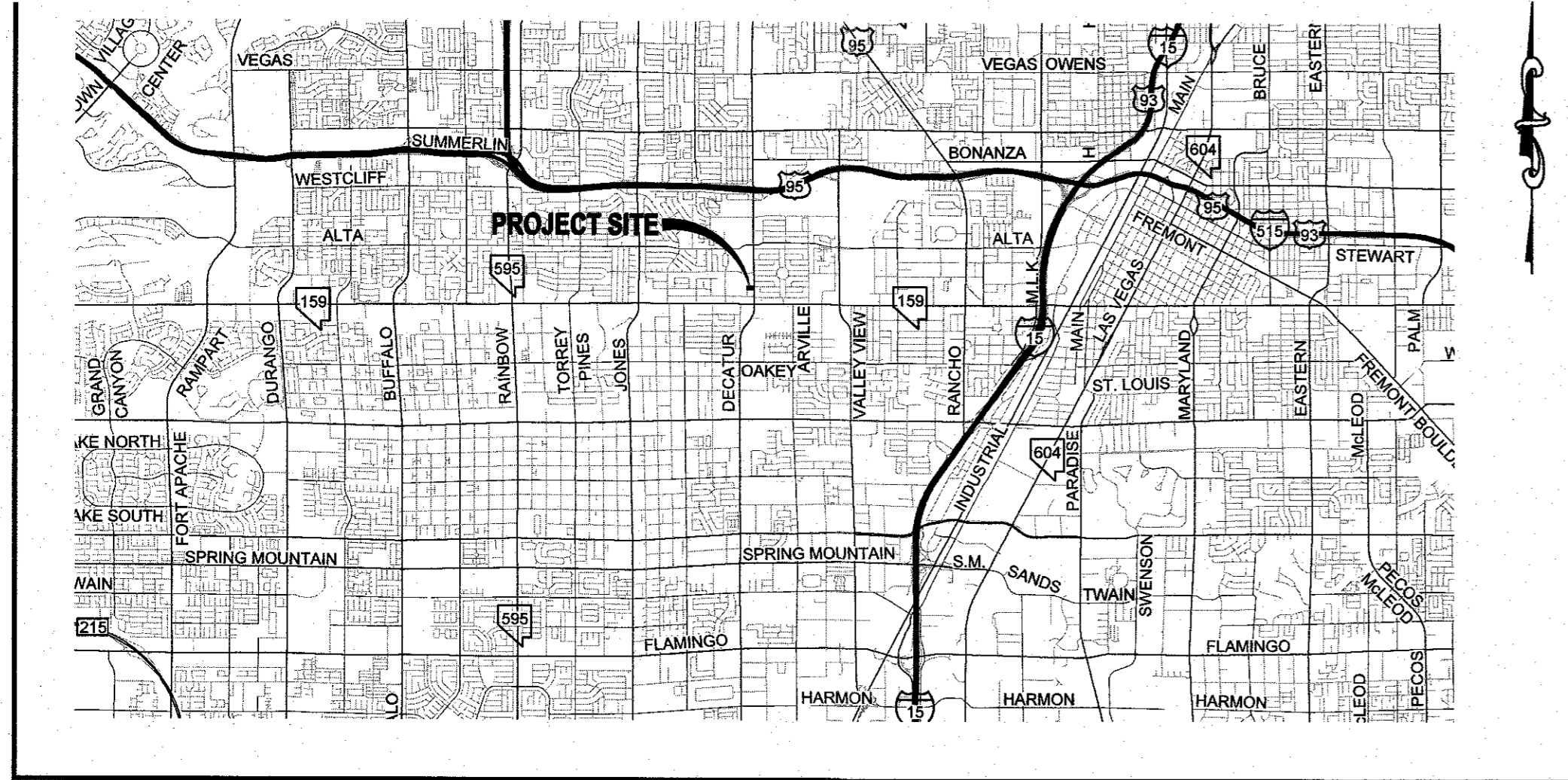

SITE MAP NOT TO SCALE

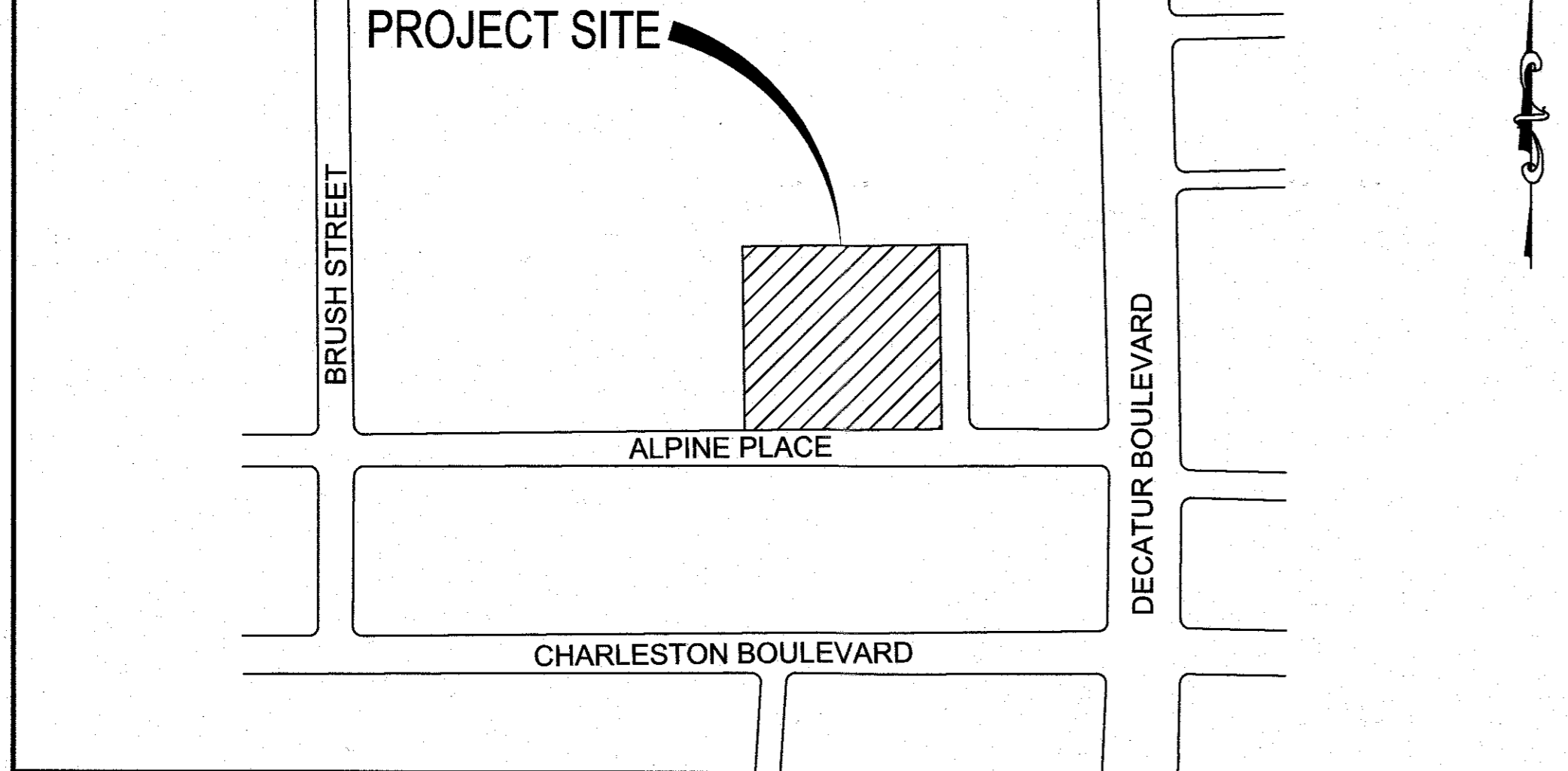

LEGEND

	EXISTING	PROPOSED
PROJECT BOUNDARY	---	---
RIGHT-OF-WAY	---	---
CENTERLINE	---	---
PROPERTY LINE	---	---
EDGE OF PAVEMENT	---	---
SIDEWALK	---	---
CURB AND GUTTER	---	---
FENCE	---	---
CONTOUR (1' INTERVAL)	---	---
CONTOUR (5' INTERVAL)	---	---
DIRECTION OF FLOW	---	---
CUT LINE-ASPHALT	---	---
SCARP (SLOPE VARIES)	---	---
DESIGN ELEVATION	(10.00)	10.00
FUTURE ELEVATION		[10.00]
NUMBER OF RETAINING COURSES	---	---
RETAINING WALL	---	---
CMU WALL	---	---
SOLID GROUTED WALL - NO RETAINING	---	---
OUT-OFF WALL	---	---
POWER POLE	---	---
SIDEWALK RAMP	---	---
CURB DROP INLET	---	---
STORM DRAIN W/MANHOLE	---	---
CUT-FILL LINE	---	---
SIGHT VISIBILITY ZONE	---	---
GAS MAIN	---	---
CAP & 2' BLOW OFF VALVE	---	---
WATERLINE FITTINGS	---	---
GATE VALVE	---	---
FIRE HYDRANT	---	---
SEWER LINE W/MANHOLE	---	---
SEWER LATERAL	---	---
WATER LINE	---	---
WATER LATERAL W/ METER	---	---
PRESSURE REDUCING VALVE	---	---
BACKWATER VALVE	---	---
200A SERVICE PEDESTAL	---	---
STREET LIGHT CONDUIT	---	---
F.A.S.T. CONDUIT	---	---
TRAFFIC SIGN	---	---
STOP SIGN W/ STREET NAME SIGN	---	---
LED LUMINAIRE W/ POLE (RESIDENTIAL)	---	---
LED LUMINAIRE W/ POLE (ARTERIAL)	---	---
LED LUMINAIRE W/ POLE (INTERSECTION)	---	---

FAST Call before you Dig
Underground 1-702-432-5300

Avoid overhead power line contact. It's costly.
Call before you Overhead 1-702-227-2929

Avoid cutting underground utility lines. It's costly.
CALL 811 OR 1-800-842-2444

ABBREVIATIONS

AC ASPHALTIC CONCRETE	LWVD LAS VEGAS VALLEY WATER DISTRICT
ACP ASBESTOS CEMENT PIPE	MAX MAXIMUM
AVE AVENUE	MH MANHOLE
BC BACK OF CURB	MIN MINIMUM
BCR BACK OF CURB RADIUS	NO NUMBER
BFE BASE FLOOD ELEVATION	NTS NOT TO SCALE
BFP BACK FLOW PREVENTOR	OC ON CENTER
BLM BUREAU OF LAND MANAGEMENT	PB PULL BOX
BM BENCH MARK	PC POINT OF CURVE
BO BOUNDARY	PCC POINT OF COMPOUND CURVE
BRPM BLUE RAISED PAVEMENT MARKER	PE POLYETHYLENE
BVC BEGIN VERTICAL CURVE	PI POINT OF INTERSECTION
BW BOTTOM OF WALL	PL PROPERTY LINE
CATV CABLE TELEVISION	PLT PLATE
CC CLARK COUNTY	POC POINT OF CONNECTION
CCSAUS CLARK COUNTY AREA UNIFORM STANDARD DRAWING	PP POWER POLE
CCFD CLARK COUNTY FIRE DEPARTMENT	P&P PLAN AND PROFILE
CCWRD CLARK COUNTY WATER RECLAMATION DISTRICT	PRC POINT OF REVERSE CURVE
CL CENTERLINE	PROJ PROJECT
CLSM CONTROLLED LOW STRENGTH MATERIAL	PRV PRESSURE REDUCING VALVE
CLV CITY OF LAS VEGAS	PT POINT OF TANGENCY
CMP CORRUGATED METAL PIPE	PVC POLYVINYL CHLORIDE
CNLV CITY OF NORTH LAS VEGAS	R RADIUS
CO CLEAN OUT, SEWER	RCB REINFORCED CONCRETE BOX
COH CITY OF HENDERSON	RCP REINFORCED CONCRETE PIPE
CY CUBIC YARD	RAW RIGHT-OF-WAY
DCSNCS DESIGN AND CONSTRUCTION STANDARDS FOR WASTE WATER COLLECTION SYSTEMS	RT RIGHT
DG DECOMPOSED GRANITE	SD STORM DRAIN
DI DROP INLET	SHT SHEET
DIP DUCTILE IRON PIPE	STLT STREETLIGHT
DR DRIVE	SNWA SOUTHERN NEVADA WATER AUTHORITY
EASE EASEMENT	SS SANITARY SEWER
EC END OF CURVE	ST STREET
EG EXISTING GRADE	STA STATION
ELEC ELECTRICAL	STD STANDARD
EP EDGE OF PAVEMENT	SVZ SIGHT VISIBILITY ZONE
EVC END VERTICAL CURVE	SW SIDEWALK
EX EXISTING	SY SQUARE YARD
FF FINISH FLOOR ELEVATION	TC TOP OF CURB
FG FINISH GRADE	TCD TRAFFIC CONTROL DEVICE
FH FIRE HYDRANT	TELE TELEPHONE
FL FLOW LINE	TF TOP OF FOOTING
FT FEET	T.O.P. TOP OF PIPE
GR GRADING	TR TOP OF RETAINING
GB GRADE BREAK	TW TOP OF WALL
OFF GARAGE FINISH FLOOR	TYP TYPICAL
HP HIGH POINT	UDMS UNIFORM DESIGN AND CONSTRUCTION STANDARDS
HPS HIGH PRESSURE GAS	UT UTILITY
INV INVERT	VC VERTICAL CURVE
LF LANE FEET	VCP VITRIFIED CLAY PIPE
LN LANE	VG VALLEY GUTTER
LS LANDSCAPE	W WATER
LT LEFT	ZC ZERO LIP CURB

ALPINE & APPIAN SINGLE FAMILY ATTACHED IMPROVEMENT PLANS

CITY OF LAS VEGAS, NEVADA
APN: 138-36-811-000
2.33 AC (GROSS)

NO.	DESCRIPTION	BY	SHFTS.	APPR.	DATE

D R HORTON

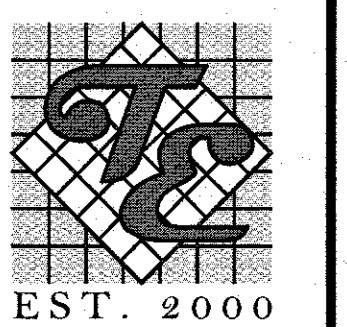

TANEY ENGINEERING & LAND SURVEYING
CIVIL ENGINEERING & LAND SURVEYING
6030 S. JONES BLVD
LAS VEGAS, NV 89118
(702) 362-8844
INFO@TANEYCORP.COM

APPROVAL SIGNATURES
APPROVED FOR CONSTRUCTION

SOUTHWEST GAS CORPORATION SWG UID DATE

CENTRAL TELEPHONE COMPANY dba CENTURYLINK DATE
THE AFFIXED CENTURYLINK APPROVAL DOES NOT ASSUME OR GUARANTEE LIABILITY FOR KNOWN OR UNKNOWN CONFLICTS WITH EXISTING OR PROPOSED IMPROVEMENTS. RESOLUTION OF ANY CONFLICT WILL BE ACCOMPLISHED PURSUANT TO LOCAL ORDINANCES, NEVADA REVISED STATUTES AND/OR PUBLIC UTILITY COMMISSION RULES AND REGULATIONS

NV ENERGY DATE
NV ENERGY ACKNOWLEDGES THAT WE HAVE RECEIVED YOUR PLANS WILL PROVIDE SERVICE TO ALL ELECTRICAL NEEDS ASSOCIATED WITH THIS PROJECT. NV ENERGY RESERVES THE RIGHT TO ADDRESS ANY EXISTING OR FUTURE CONFLICTS ONCE THE FINAL DESIGN IS COMPLETED. THE NEW SERVICE AND THE RESOLUTION OF ANY CONFLICTS WILL BE ACCOMPLISHED PURSUANT TO THE NEVADA PUBLIC UTILITY COMMISSION'S RULES AND REGULATIONS.

LAS VEGAS VALLEY WATER DISTRICT PLANNING AND ENGINEERING SERVICES
PROJECT# 122XXX, FIRST APPROVED DATE
LWVD APPROVED FIRE FLOW: XXXX GPM AT 20 PSI RESIDUAL
MAXIMUM AVAILABLE FIRE SPRINKLER FLOW XXXX GPM
SHEETS: XXXXXX

DEVELOPER
MICHAEL MARKVAN
D R HORTON
1081 WHITNEY RANCH DRIVE #141
LAS VEGAS, NV 89014
(702) 636-9808
M.MARKVAN@DRHORTON.COM

ENGINEER
ROBERT CUNNINGHAM
TANEY ENGINEERING
6030 SOUTH JONES BLVD
LAS VEGAS, NV 89118
(702) 362-8844 PHONE (702) 362-5233 FAX
INFO@TANEYCORP.COM

OWNER
AMBLESIDE PROPERTIES
4471 DEAN MARTIN DR. #606
LAS VEGAS, NV 89103
(604) 955-9051

SUBDIVISION INFORMATION
ACRES: 2.33 AC
AREA DISTURBED: 2.33 AC
LOTS: 31
LOT SIZE: 1,678 SF MIN.
ZONING: R-TH
FMP: XX
TMP: 23-0112-TMP1

SETBACKS:
FRONT: 10 FT
GARAGE: 20 FT
REAR: 5 FT
SIDE: 0 FT
CORNER: 10 FT

BASIS OF BEARING
N89°33'00"W BEING THE CENTERLINE OF CHARLESTON BOULEVARD AS SHOWN ON RECORD OF SURVEY MAP FILE 13 PAGE 60 CLARK COUNTY RECORDS, CLARK COUNTY, NEVADA

BENCHMARK
MONUMENT ID: 7LV0131SWS
REISET & PLATE IN TOP OF CURB AT NE CORNER OF DECATUR & CHARLESTON
ELEVATION (METERS): 670.37
ELEVATION (FEET): 2,198.37

LEGAL DESCRIPTION
THAT PORTION OF THE SOUTHEAST QUARTER OF THE SOUTHEAST QUARTER OF SECTION, TOWNSHIP 20 SOUTH, RANGE 60 E, M.D. 8 & M. IN THE COUNTY OF CLARK, STATE OF NEVADA, AS SHOWN ON RECORD OF SURVEY MAP, FILE 13, PAGE OF CLARK COUNTY NEVADA RECORDS

UTILITY DISCLAIMER
EXISTING UTILITY LOCATIONS SHOWN HEREIN ARE APPROXIMATE ONLY. IT SHALL BE THE CONTRACTORS RESPONSIBILITY TO DETERMINE THE EXACT VERTICAL AND HORIZONTAL LOCATION OF ALL EXISTING UNDERGROUND UTILITIES PRIOR TO COMMENCING CONSTRUCTION. NO REPRESENTATION IS MADE THAT ALL EXISTING UTILITIES ARE SHOWN HEREON. THE ENGINEER ASSUMES NO RESPONSIBILITY FOR UTILITIES NOT SHOWN OR UTILITIES NOT SHOWN IN THEIR EXISTING LOCATIONS.

COX COMMUNICATIONS LAS VEGAS, INC.

CITY OF LAS VEGAS FIRE & RESCUE

CITY OF LAS VEGAS ENGINEERING

CITY OF LAS VEGAS DEPARTMENT OF PLANNING

CITY

DATE: 11/17/2024
SCALE: NTS
JOB NO: DRH-24-107
DESIGNED BY: RC CHECKED BY: JT
SHEET NAME: C1
SHEET NUMBER: 01 OF 09
CITY 0000000

ALPINE & APPIAN SINGLE FAMILY ATTACHED COVER SHEET

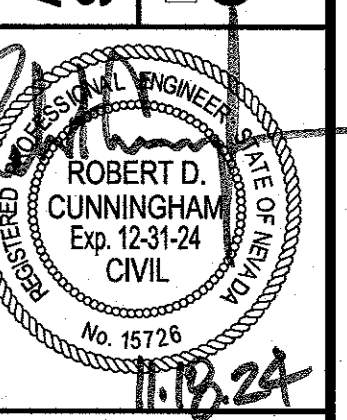

LAST PLOT: Jeff Thomson
FILE NAME: S:\ACTIVED R\HORTON\DRH-24-107 - APPIAN & ALPINE\ENGINEERING\IPSS SHEET\DWG\DRH107_SHT_CD.DWG

CLV GENERAL NOTES

- 1. ALL CONSTRUCTION AND MATERIALS SHALL BE IN ACCORDANCE WITH THE 'UNIFORM STANDARD SPECIFICATIONS FOR PUBLIC WORKS CONSTRUCTION OFF-SITE IMPROVEMENTS, CLARK COUNTY AREA, NEVADA', LATEST EDITION...

CLV TRAFFIC NOTES

- 1. ALL CONSTRUCTION SIGNING, BARRICADEING, AND TRAFFIC DELINEATION SHALL CONFORM TO THE 'MANUAL OF UNIFORM TRAFFIC CONTROL DEVICES', LATEST EDITION.

CLV FIRE DEPARTMENT NOTES

- 1. ALL WORK SHALL BE DONE IN STRICT ACCORDANCE WITH THE LAS VEGAS FIRE AND RESCUE ADOPTED FIRE CODE ORDINANCE # 6821 FOR HYDRANT SPECIFICATIONS AND HYDRANT INSTALLATION SPECIFICATIONS.

CLV SEWER NOTES

- 1. ALL CONSTRUCTION AND MATERIALS SHALL BE IN ACCORDANCE WITH THE LATEST EDITION OF DESIGN & CONSTRUCTION STANDARDS FOR WASTEWATER COLLECTION SYSTEMS AND THE UNIFORM STANDARD SPECIFICATIONS FOR PUBLIC WORKS CONSTRUCTION OFF-SITE IMPROVEMENTS, CLARK COUNTY AREA, NEVADA, AS AMENDED.

QUANTITIES

Table with columns: PAVING AND GRADING, STORM DRAIN, WATER, SEWER, TRAFFIC, PUBLIC, PRIVATE, XX SY.

RTC FAST NOTES

- 1. CONTRACTOR IS TO MAINTAIN AND KEEP OPERATIONAL ALL EXISTING ITS INFRASTRUCTURE WITHIN THE CONSTRUCTION LIMITS.

RTC TRANSIT NOTES

- 1. THE CONTRACTOR SHALL NOT BE ALLOWED TO CLOSE MORE THAN ONE CONSECUTIVE BUS STOP ON THE SAME SIDE OF THE STREET.

CLV GRADING NOTES

- 1. IN THE EVENT THAT ANY UNFORESEEN CONDITIONS NOT COVERED BY THESE NOTES ARE ENCOUNTERED DURING GRADING OPERATIONS, THE OWNER/ENGINEER SHALL BE IMMEDIATELY NOTIFIED FOR DIRECTION.

CLV STREETLIGHT NOTES

- 1. ALL STREET LIGHTING INSTALLATIONS SHALL BE IN ACCORDANCE WITH THE STREET LIGHTING PLANS, THE 'UNIFORM STANDARD SPECIFICATIONS FOR PUBLIC WORKS CONSTRUCTION OFF-SITE IMPROVEMENTS, CLARK COUNTY AREA, NEVADA', LATEST REVISION (USS), AND THE 'UNIFORM STANDARD SPECIFICATIONS FOR PUBLIC WORKS CONSTRUCTION OFF-SITE IMPROVEMENTS, CLARK COUNTY AREA, NEVADA'(USS), LATEST REVISION.

CLV STORMWATER RUNOFF MANAGEMENT NOTES

- 1. THE OWNER, SITE DEVELOPER, CONTRACTOR, AND/OR THEIR AUTHORIZED AGENTS SHALL EACH DAY REMOVE ALL SEDIMENT, MUD, CONSTRUCTION DEBRIS, AND OTHER POTENTIAL POLLUTANTS THAT MAY BE DISCHARGED TO, OR ACCUMULATED IN, THE PUBLIC RIGHTS OF WAY OF THE CITY OF LAS VEGAS AS A RESULT OF CONSTRUCTION ACTIVITIES ASSOCIATED WITH THIS SITE DEVELOPMENT CONSTRUCTION PROJECT.

CLV SEWER NOTES

- 1. ALL CONSTRUCTION AND MATERIALS SHALL BE IN ACCORDANCE WITH THE LATEST EDITION OF DESIGN & CONSTRUCTION STANDARDS FOR WASTEWATER COLLECTION SYSTEMS AND THE UNIFORM STANDARD SPECIFICATIONS FOR PUBLIC WORKS CONSTRUCTION OFF-SITE IMPROVEMENTS, CLARK COUNTY AREA, NEVADA, AS AMENDED.

SOUTHERN NEVADA SOUTHWEST GAS CORP. GENERAL NOTES

- 1. IN THE EVENT OF NATURAL GAS EMERGENCIES CALL 911 AND 1-877-860-8020.

SEWER MANHOLE SCHEDULE

Table with columns: MANHOLE SIZE, DEPTH, SCHEDULE.

STORM DRAIN MANHOLE SCHEDULE

Table with columns: MANHOLE SIZE, DEPTH, SCHEDULE.

Call before you Overhead 1-702-227-2929. Call before you Dig 1-800-842-2444.

BASE OF BEARING

N89° 33' 00" W BEING THE CENTERLINE OF CHARLESTON BOULEVARD AS SHOWN ON RECORD OF SURVEY MAP FILE 13 PAGE 80 CLARK COUNTY RECORDS, CLARK COUNTY, NEVADA.

BENCHMARK

MONUMENT ID: 7L010315WS. REINVT & PLATE IN TOP OF CURB AT NE CORNER OF DECATUR & CHARLESTON. ELEVATION (METERS): 870.37. ELEVATION (FEET): 2,199.37.

UTILITY DISCLAIMER

EXISTING UTILITY LOCATIONS SHOWN HEREIN ARE APPROXIMATE ONLY. IT SHALL BE THE CONTRACTOR'S RESPONSIBILITY TO DETERMINE THE EXACT VERTICAL AND HORIZONTAL LOCATION OF ALL EXISTING UNDERGROUND UTILITIES PRIOR TO COMMENCING CONSTRUCTION.

DEVIATIONS FROM STANDARDS

- 1. XX

LEGAL DESCRIPTION

THAT PORTION OF THE SOUTHEAST QUARTER OF THE SOUTHEAST QUARTER OF SECTION, TOWNSHIP 20 SOUTH, RANGE 80 E, M.D.B. & M, IN THE COUNTY OF CLARK, STATE OF NEVADA, AS SHOWN ON RECORD OF SURVEY MAP, FILE 13, PAGE OF CLARK COUNTY NEVADA RECORDS.

EARTHWORK

TOTAL FOR OVERALL DEVELOPMENT: 2,205 CY CUT / 1,403 CY FILL / 802 CY NET (-) CUTS. NOTE: THIS OPINION OF THE CUT AND FILL QUANTITIES IS PROVIDED AS REQUIRED BY THE GOVERNING ENTITY.

Table with columns: NO., DESCRIPTION, REVISIONS, BY, SHTS., APPR., DATE.

LAS VEGAS VALLEY WATER DISTRICT NOTES. LVVWD PROJECT #XXXXXX. REVISED 05/09/2024.

DR HORTON. TANEY ENGINEERING CIVIL ENGINEERING & LAND SURVEYING. 6030 S. JONES BLVD LAS VEGAS, NV 89118. INFO@TANEYCORP.COM

Call before you Overhead 1-702-227-2929. Call before you Dig 1-800-842-2444.

ALPINE & APIAN SINGLE FAMILY ATTACHED NOTES SHEET

APPROVED FOR CONSTRUCTION. LAS VEGAS VALLEY WATER DISTRICT PLANNING AND ENGINEERING SERVICES. PROJECT# 122XXX. FIRST APPROVED DATE. LVVWD APPROVED FIRE FLOW: XXXX. GPM AT 20 PSI RESIDUAL. MAXIMUM AVAILABLE FIRE SPRINKLER FLOW XXXX. GPM.

LEGAL DESCRIPTION

THAT PORTION OF THE SOUTHEAST QUARTER OF THE SOUTHEAST QUARTER OF SECTION, TOWNSHIP 20 SOUTH, RANGE 80 E, M.D.B. & M, IN THE COUNTY OF CLARK, STATE OF NEVADA, AS SHOWN ON RECORD OF SURVEY MAP, FILE 13, PAGE OF CLARK COUNTY NEVADA RECORDS.

EARTHWORK

TOTAL FOR OVERALL DEVELOPMENT: 2,205 CY CUT / 1,403 CY FILL / 802 CY NET (-) CUTS. NOTE: THIS OPINION OF THE CUT AND FILL QUANTITIES IS PROVIDED AS REQUIRED BY THE GOVERNING ENTITY.

DEVIATIONS FROM STANDARDS

- 1. XX

LEGAL DESCRIPTION

THAT PORTION OF THE SOUTHEAST QUARTER OF THE SOUTHEAST QUARTER OF SECTION, TOWNSHIP 20 SOUTH, RANGE 80 E, M.D.B. & M, IN THE COUNTY OF CLARK, STATE OF NEVADA, AS SHOWN ON RECORD OF SURVEY MAP, FILE 13, PAGE OF CLARK COUNTY NEVADA RECORDS.

EARTHWORK

TOTAL FOR OVERALL DEVELOPMENT: 2,205 CY CUT / 1,403 CY FILL / 802 CY NET (-) CUTS. NOTE: THIS OPINION OF THE CUT AND FILL QUANTITIES IS PROVIDED AS REQUIRED BY THE GOVERNING ENTITY.

DATE: 11/17/2024. SCALE: NTS. JOB NO: DRH-24-107. DESIGNED BY: RC | CHECKED BY: JT. SHEET NAME: C2. SHEET NUMBER: 02 OF 09. CITY: 000000.

LAST PLOT: Jeff Thomson. FILE NAME: S:\ACTIVED\DRHORTON\24-107-APP\AN & AP\ENGINE\3 IPS\3 SHEET\DRHORTON_SHT_C.DWG

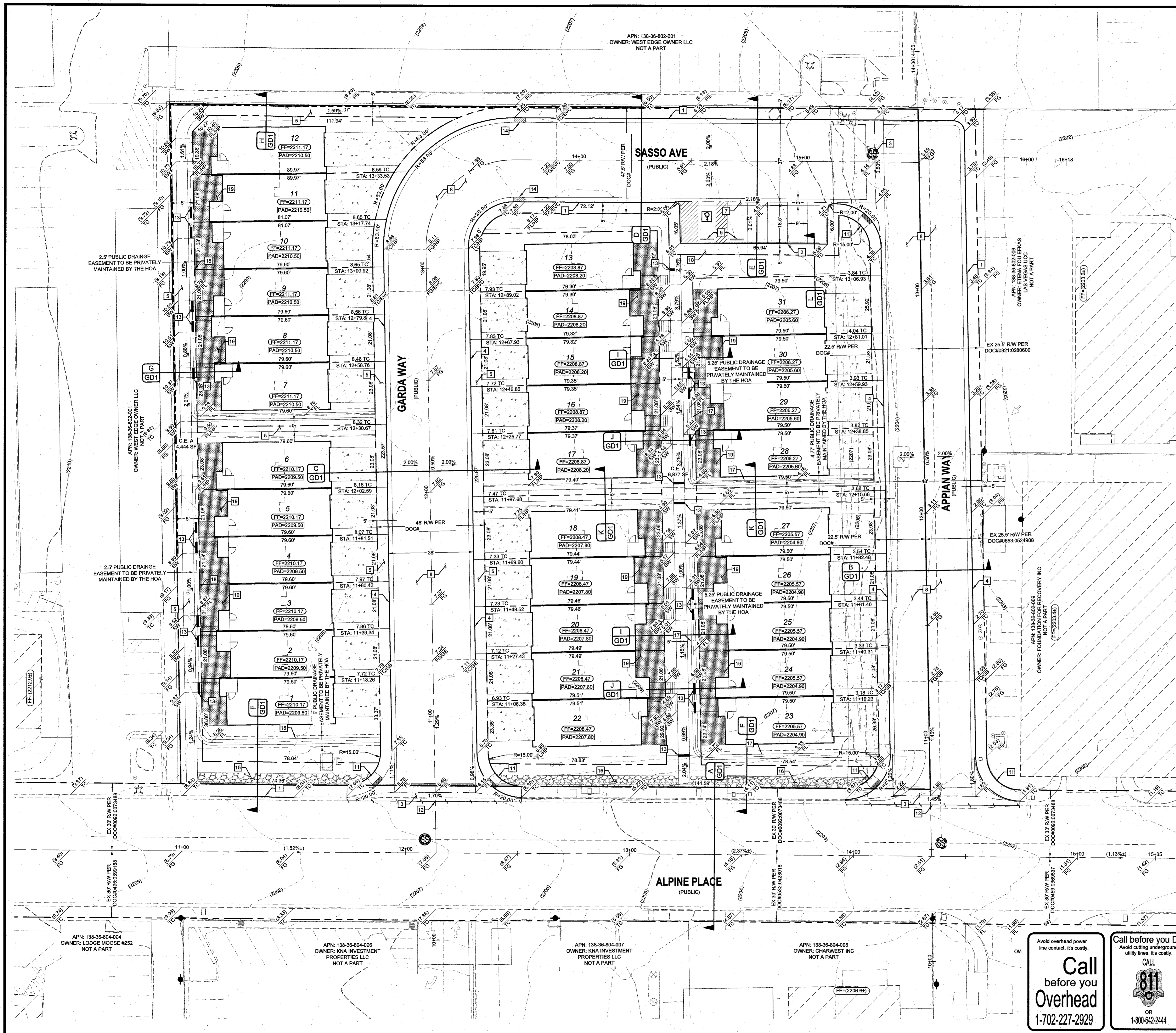

- GRADING CONSTRUCTION NOTES**
- 24" L-TYPE CURB & GUTTER (CCAUSSD #216)
 - 6" "A" TYPE CURB (CCAUSSD #219)
 - 8" CROSS GUTTER (CCAUSSD #228)
 - 24" R-TYPE CURB & GUTTER (CCAUSSD #217.3.S1)
 - 4" THICK CONC. SIDEWALK, WIDTH AS LABELED IN PLAN VIEW (CCAUSSD #234)
 - 6" ZERO LIP CURB (DETAIL QGD1)
 - 3" CONCRETE VALLEY GUTTER (DETAIL P/GD1)
 - CONSTRUCT AC PAVEMENT OVER AGG BASE - SEE GRADING DETAILS & SECTIONS FOR THICKNESS
 - CONTRACT 6" PRECAST CONCRETE BUMPER BLOCK (DETAIL Q/GD1)
 - ADA PARKING RAMP (DETAIL S/GD1)
 - CONCRETE SIDEWALK RAMP (CCAUSSD #235 - CASE 1 (A=8' / B=8'))
 - SAWCUT & MATCH INTO EXISTING AC PAVEMENT GRADE (CCAUSSD #600.3, #500.4 & #500.5)
 - INSTALL 4" PVC PIPE, MINIMUM SLOPE = 0.5% UNDER SIDEWALK (DETAIL R/GD1)
 - L-CURB TO R-CURB TRANSITION (DETAIL T/GD1)
 - INSTALL RIPRAP 50#-3" THICKNESS=4"
 - INSTALL RIPRAP 40#-3" THICKNESS=12"
 - 2" CONCRETE VALLEY GUTTER (DETAIL M/GD1)
 - 2.5" CONCRETE VALLEY GUTTER (DETAIL N/GD1)
 - PAVERS FOR FRONT PORCH AREA (SEE ARCHITECTURAL PLANS FOR DETAILS)

GEOTECHNICAL
 GEOTECK RESIDENTIAL LLC
 6835 S. ESCONCIDO ST., STE B
 LAS VEGAS, NV 89118
 (702) 897-1424
 REPORT NO: 18138-LVR
 DATE: 05/23/2024

EARTHWORK
 TOTAL FOR OVERALL DEVELOPMENT: 2,205 CY CUT / 1,403 CY FILL / 802 CY NET -CUT-
 NOTE: THIS OPINION OF THE CUT AND FILL QUANTITIES IS PROVIDED AS REQUIRED BY THE GOVERNING ENTITY. THIS INFORMATION SHOULD NOT BE USED FOR BIDDING PURPOSES. ALL CONTRACTORS ARE RESPONSIBLE FOR THEIR OWN REQUIREMENTS. THESE TOTALS ARE RAW AND DO NOT ACCOUNT FOR SHRINKAGE AND SUBSIDENCE.

FLOOD ZONE
 THIS PROJECT IS LOCATED IN FLOOD ZONE "X", AN AREA DETERMINED TO BE OUTSIDE OF THE 0.2% ANNUAL CHANCE FLOOD PLAIN PER FIRM PANEL 32003C000C, REVISED 11/16/11.

UTILITY DISCLAIMER
 EXISTING UTILITY LOCATIONS SHOWN HEREIN ARE APPROXIMATE ONLY. IT SHALL BE THE CONTRACTOR'S RESPONSIBILITY TO DETERMINE THE EXACT VERTICAL AND HORIZONTAL LOCATION OF ALL EXISTING UNDERGROUND UTILITIES PRIOR TO COMMENCING CONSTRUCTION. NO REPRESENTATION IS MADE THAT ALL EXISTING UTILITIES ARE SHOWN HEREON. THE ENGINEER ASSUMES NO RESPONSIBILITY FOR UTILITIES NOT SHOWN OR UTILITIES NOT SHOWN IN THEIR EXISTING LOCATIONS.

GRADING NOTES
 ADD 2200 FEET TO ALL GRADE TAGS TO GET ACTUAL ELEVATION.
 THE ELEVATION DIFFERENCE BETWEEN THE PAD AND FINISH FLOOR IS DETERMINED FROM THE MINIMUM THICKNESS REQUIRED PER THE GEOTECHNICAL REPORT. FINISH FLOORS MAY INCREASE DEPENDING ON THE TYPE OF SOIL AND FOUNDATION PLAN USED. NOTE THAT THE STRUCTURAL PLANS & GEOTECHNICAL REPORT SHALL SUPERSEDE THE CIVIL IMPROVEMENT PLANS.
 ALL PRIVATE STREETS AND DRAINAGE EASEMENTS ARE TO BE PRIVATELY OWNED AND MAINTAINED BY THE HOMEOWNERS ASSOCIATION (H.O.A.).
 ALL WORK TO BE PERFORMED OUTSIDE OF THE PROJECT BOUNDARY AND ON PRIVATE PROPERTY SHALL NOT BE PERFORMED UNTIL WRITTEN PERMISSION AND EASEMENTS HAVE BEEN OBTAINED FROM THE OFFSITE OWNER AND GIVEN TO THE GOVERNING ENTITY.

BENCHMARK
 MONUMENT ID: 7LVD1315WS
 REINET & PLATE IN TOP OF CURB AT NE CORNER OF DECATUR & CHARLESTON
 ELEVATION (METERS): 670.37
 ELEVATION (FEET): 2,199.37

GRADING CERTIFICATION
 I CERTIFY THIS GRADING PLAN COMPLIES WITH THE APPROVED DRAINAGE STUDY, HTE# XX-XXXXX, ON FILE WITH CITY OF LAS VEGAS FOR THIS PROJECT.
 ROBERT D. CUNNINGHAM, PE
 DATE

Call before you Dig
 Avoid cutting underground utility lines. It's costly.

Call before you Overhead
 Avoid overhead power line contact. It's costly.

CALL 811 OR 1-800-642-2444

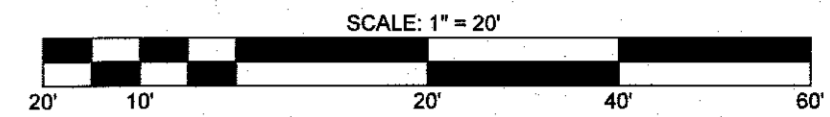

NO.	DESCRIPTION	BY	DATE

DR HORTON

TANEY ENGINEERING & LAND SURVEYING
 CIVIL ENGINEERING & LAND SURVEYING
 6030 S. JONES BLVD
 LAS VEGAS, NV 89118
 (702) 362-8844
 INFO@TANEYCORP.COM

ALPINE & APPIAN SINGLE FAMILY ATTACHED GRADING PLAN 1

ROBERT D. CUNNINGHAM
 Exp. 12-31-24
 CIVIL
 No. 15728

DATE:	11/17/2024
SCALE:	1"=20'
JOB NO.:	DRH-24-107
DESIGNED BY:	RC
CHECKED BY:	JT
SHEET NAME:	G1
SHEET NUMBER:	03 OF 09
CITY:	0000000

LAST PLOT: Jeff Thomson
 FILE NAME: S:\ACTIVED\H HORTON\DRH-24-107 - APPIAN & ALPINE\ENGR\IPSS SHEET DWS\DRH107_SHT_G.DWG

GENERAL SECTION NOTES:

1. ALL AGG. BASES SHALL BE COMPACTED PER GEOTECH REPORT. PRELIMINARY PAVEMENT SECTIONS SHALL BE VERIFIED WITH THE FINAL PAVEMENT SECTION RECOMMENDATION REPORT PRIOR TO CONSTRUCTION.
2. ALL SLOPES GREATER THAN 3:1 WILL HAVE A 2FT AT 2% BENCH AT THE TOP OF SLOPE.
3. SLOPES GREATER THAN 6:1 UP TO 3:1 WILL HAVE A 1FT BENCH AT 2% AT THE TOP OF SLOPE.
4. ALL PERIMETER WALLS SHALL BE DECORATIVE.
5. MAINTAIN 6 INCHES OR LESS SEPARATION BETWEEN WALLS. GAP TO BE FILLED & CAPPED WITH CEMENTITIOUS MATERIAL THAT WILL NOT INCREASE LOAD ON THE WALLS AND APPROVED BY THE DEPARTMENT AS TO BOTH STRUCTURAL AND LAND USE CONSIDERATIONS PER 18.06.040.
6. WALL SECTIONS SHOWN ON THIS SHEET ARE FOR REFERENCE ONLY. SEE GEOTECH REPORT AND STRUCTURAL DRAWINGS FOR DESIGN AND WATERPROOFING REQUIREMENTS.
7. FOR FOOTING DEPTH BELOW LOWEST ADJACENT GRADE, SEE GEOTECH REPORT RECOMMENDATIONS AND STRUCTURAL DRAWINGS.
8. DISTANCE FROM OUTSIDE EDGE OF FOOTING TO THE FACE OF ADJACENT DESCENDING SLOPE SHOULD MEET THE MINIMUM DISTANCES OUTLINED IN THE GEOTECH REPORT.
9. AGGREGATE BASE TO BE COMPACTED PER THE SOILS REPORT.
10. A.C. PAVEMENT TO BE A MAXIMUM 1/4" ABOVE LIP ON LOCAL RESIDENTIAL STREETS AND 1/2" ABOVE LIP ON COLLECTOR/ARTERIAL STREETS TO ADJACENT CONCRETE AFTER COMPACTION.

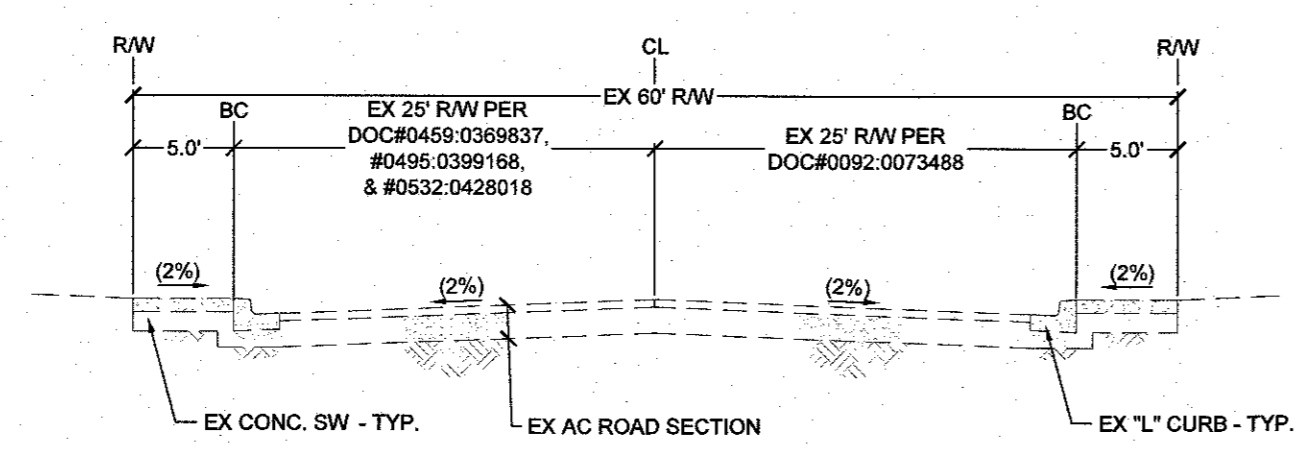

A ALPINE PLACE (PUBLIC)
60' PUBLIC RW WITH "L" CURB
NTS

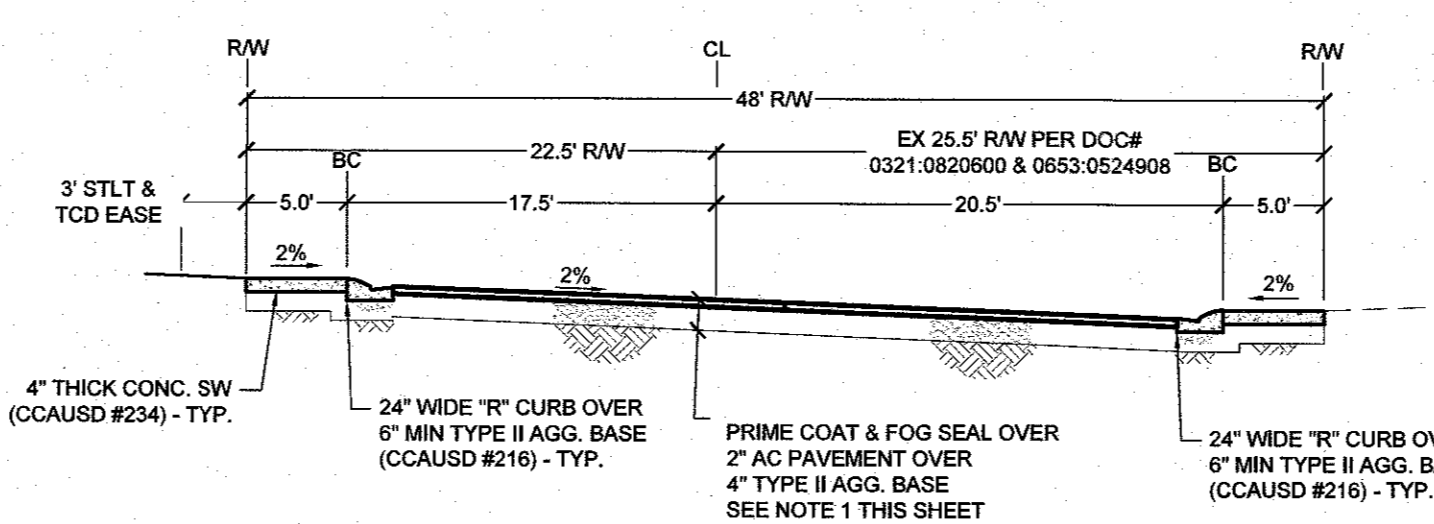

B APPIAN WAY (PUBLIC)
48' PUBLIC RW WITH "R" & "L" CURB
NTS

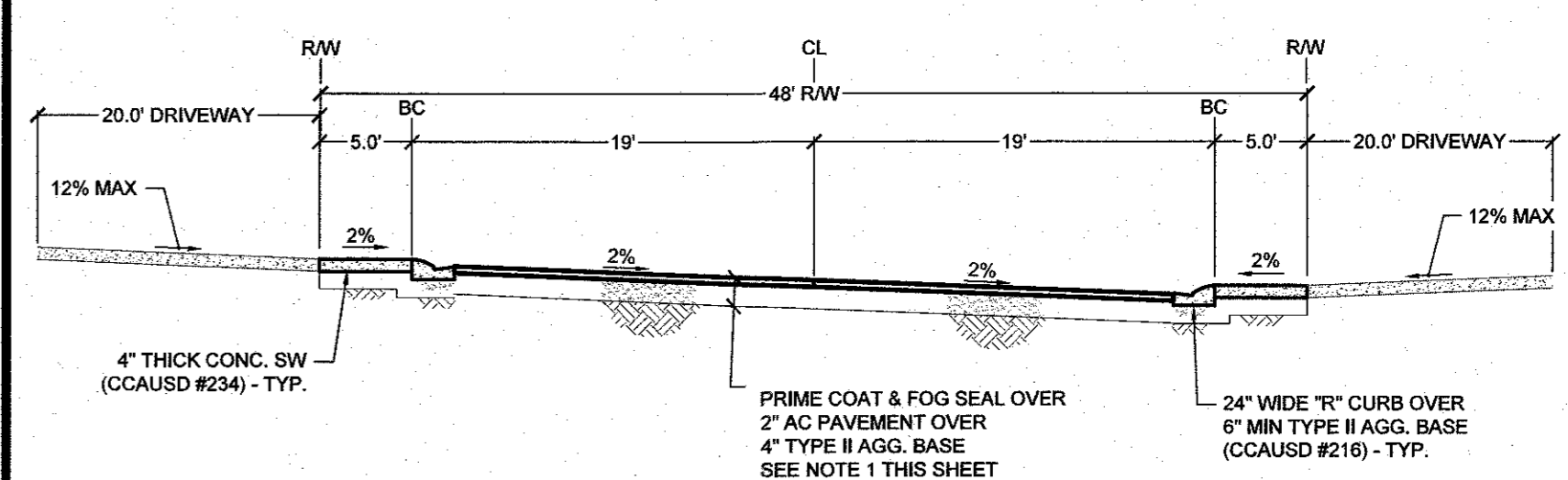

C GARDA WAY (PUBLIC)
48' PUBLIC RESIDENTIAL STREET WITH "R" CURB
NTS

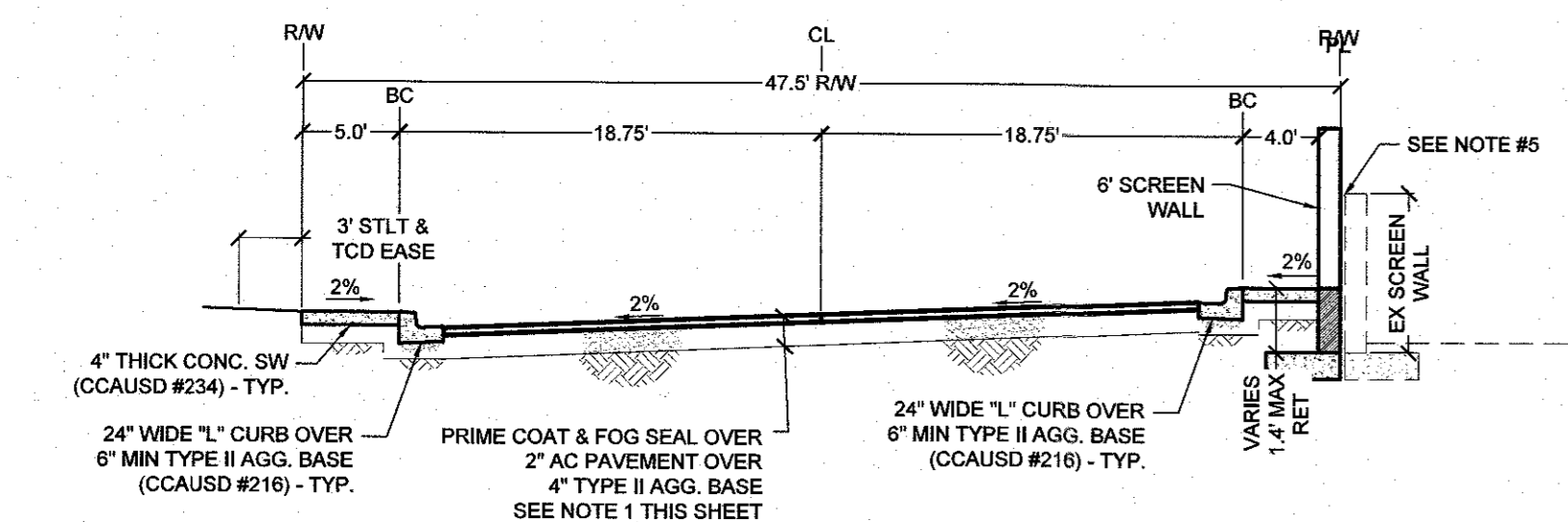

D SASSO AVENUE (PUBLIC)
47.5' PUBLIC RESIDENTIAL STREET WITH "L" CURB
NTS

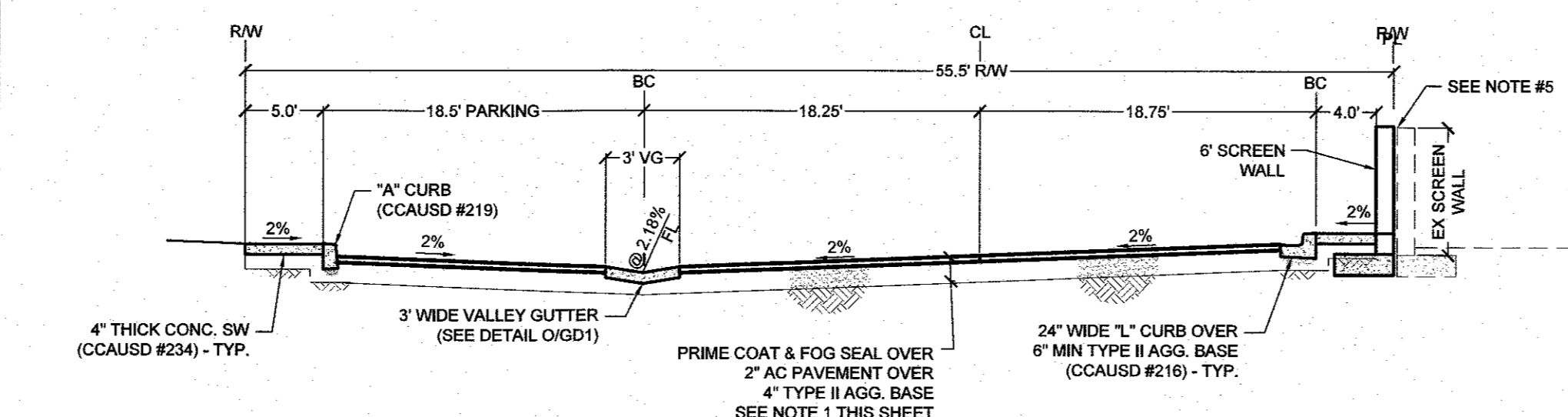

E SASSO AVENUE (PUBLIC)
55.5' PUBLIC RESIDENTIAL STREET WITH "L" CURB
NTS

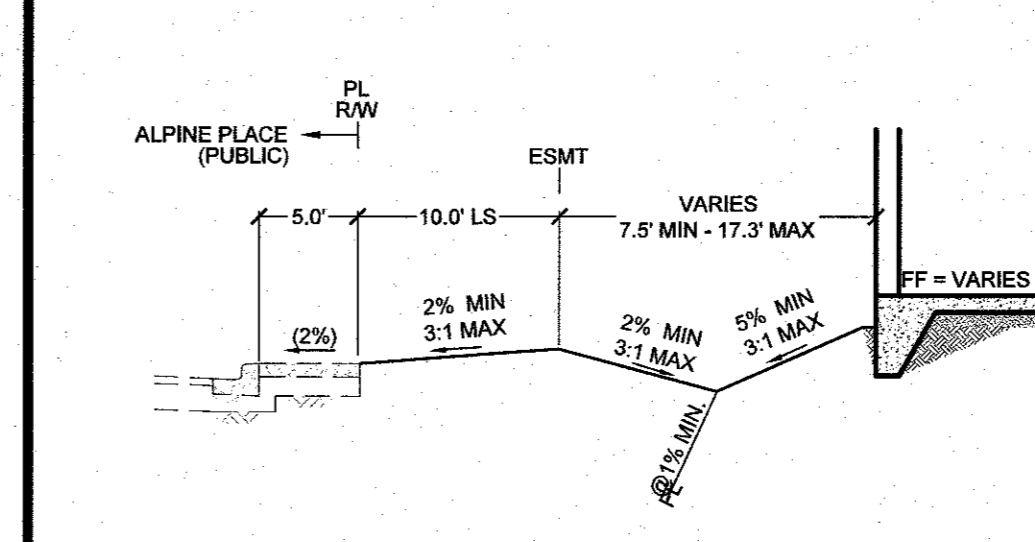

F COMMON AREAS
ADJACENT TO PUBLIC RW
NTS

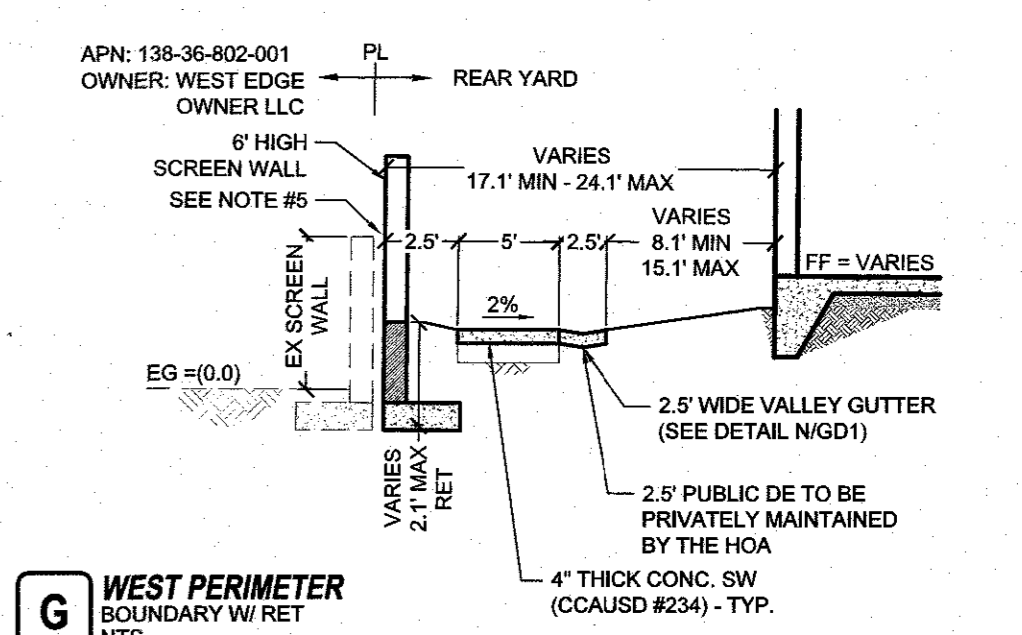

G WEST PERIMETER
BOUNDARY W/ RET
NTS

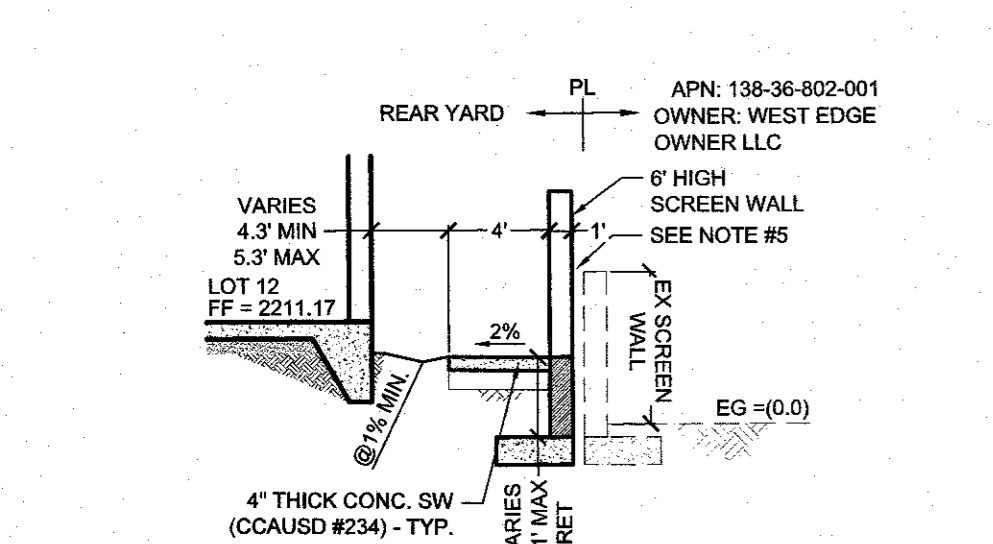

H NORTH PERIMETER
BOUNDARY W/ RET
NTS

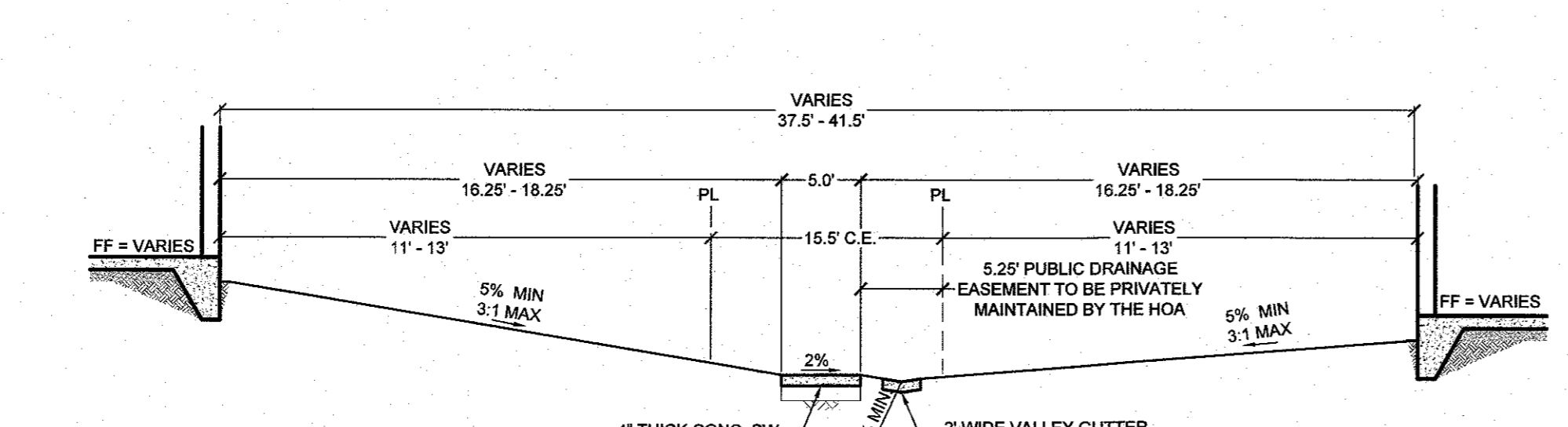

I WALKING PATH BETWEEN BUILDINGS
WITH FLOWLINE (NO STEPS)
NTS

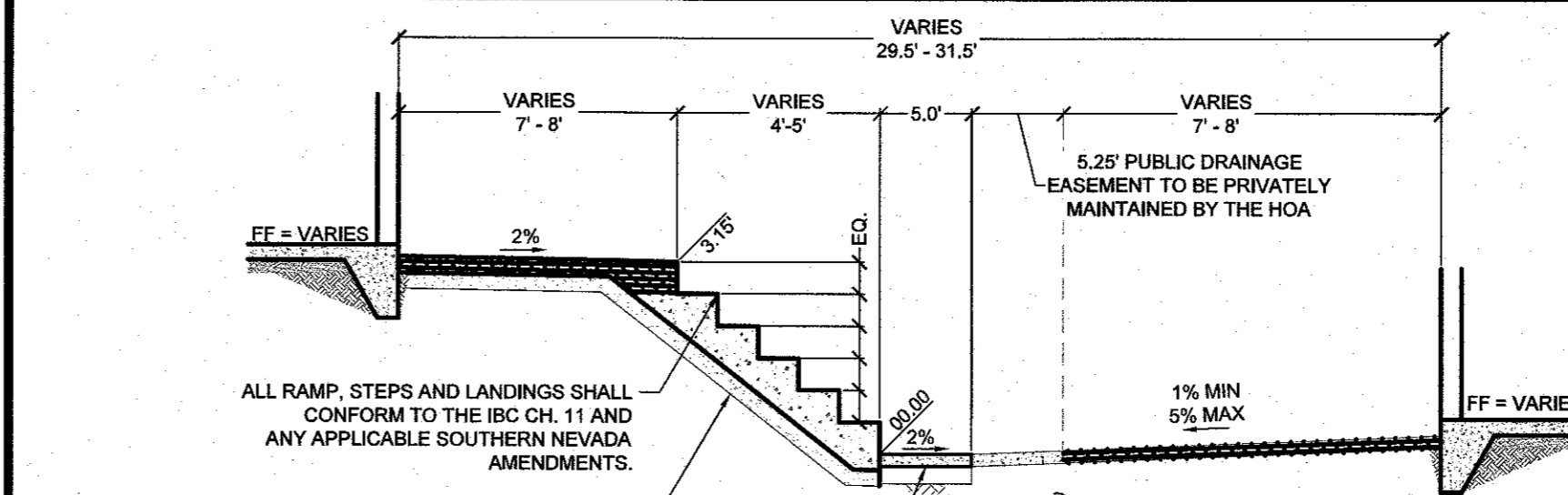

J WALKING PATH BETWEEN BUILDINGS
STEPS NEEDED
NTS

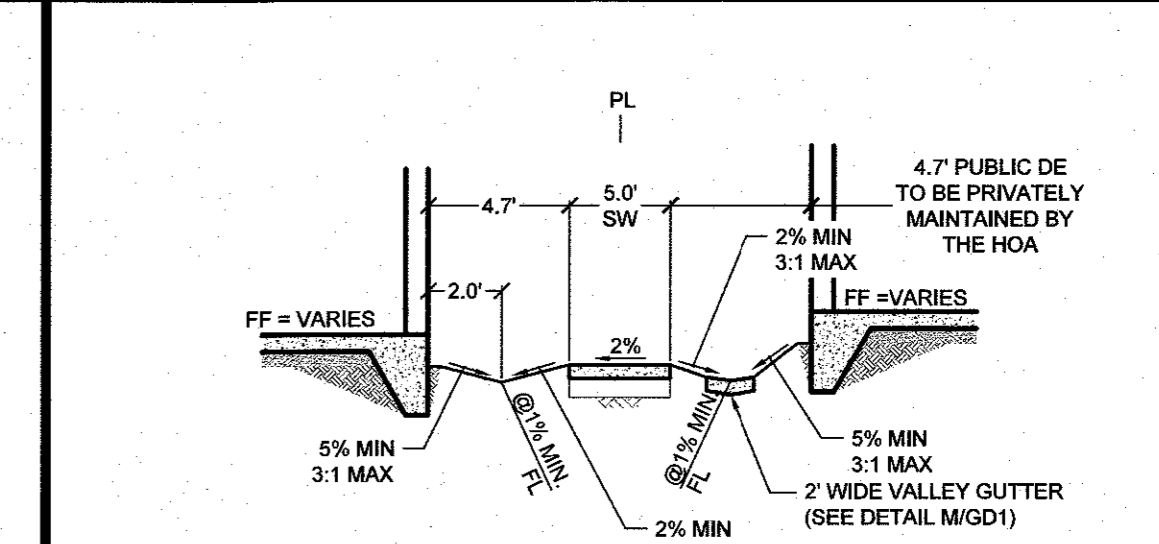

K WALKING PATH BETWEEN BUILDINGS
SOUTH TO NORTH
NTS

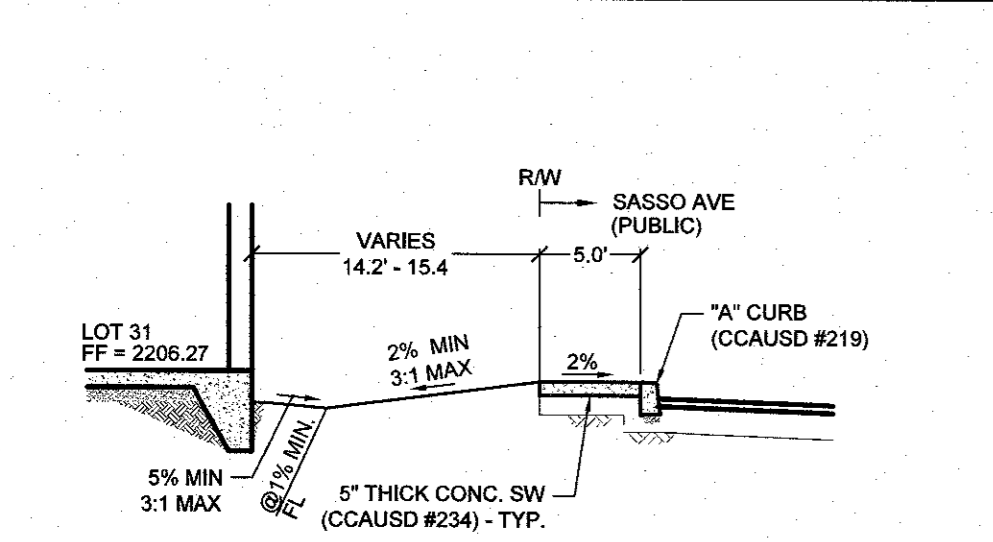

L ADJACENT TO LOT 31
NTS

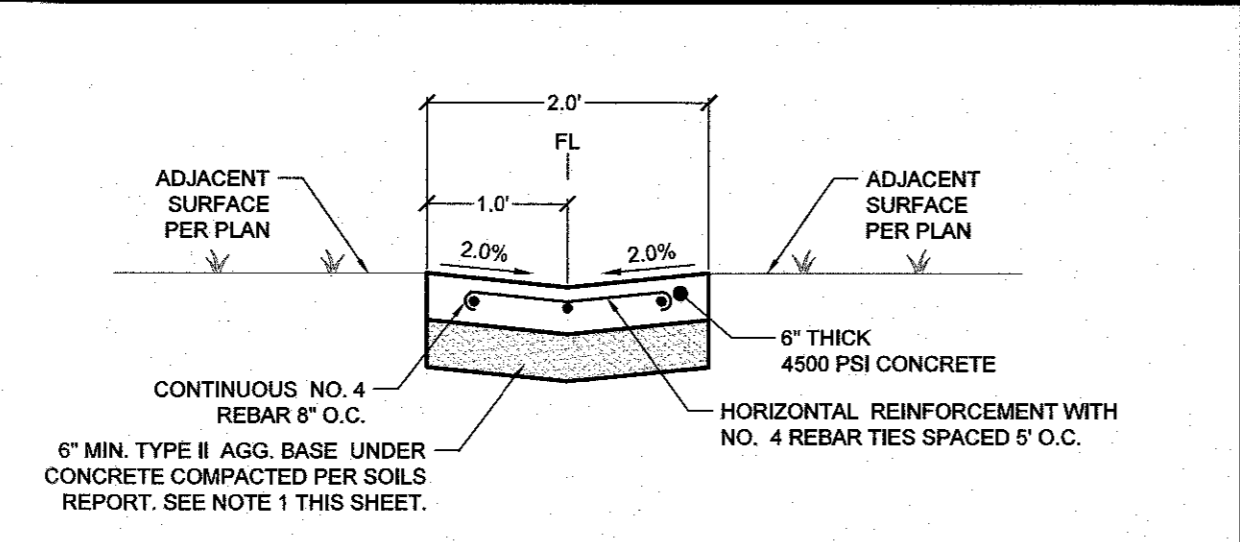

M 2FT VALLEY GUTTER
NTS

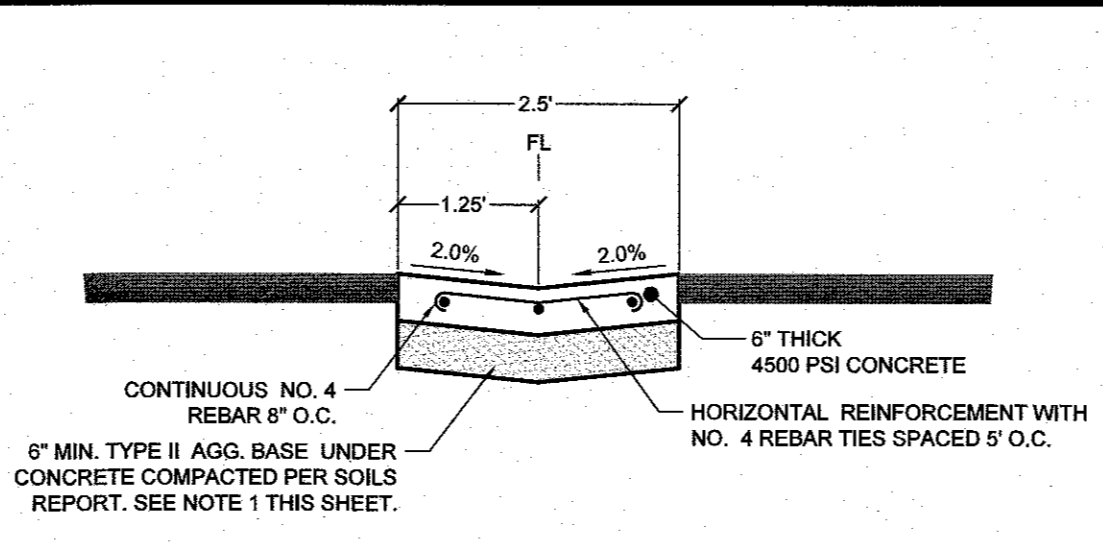

N 2.5FT VALLEY GUTTER
NTS

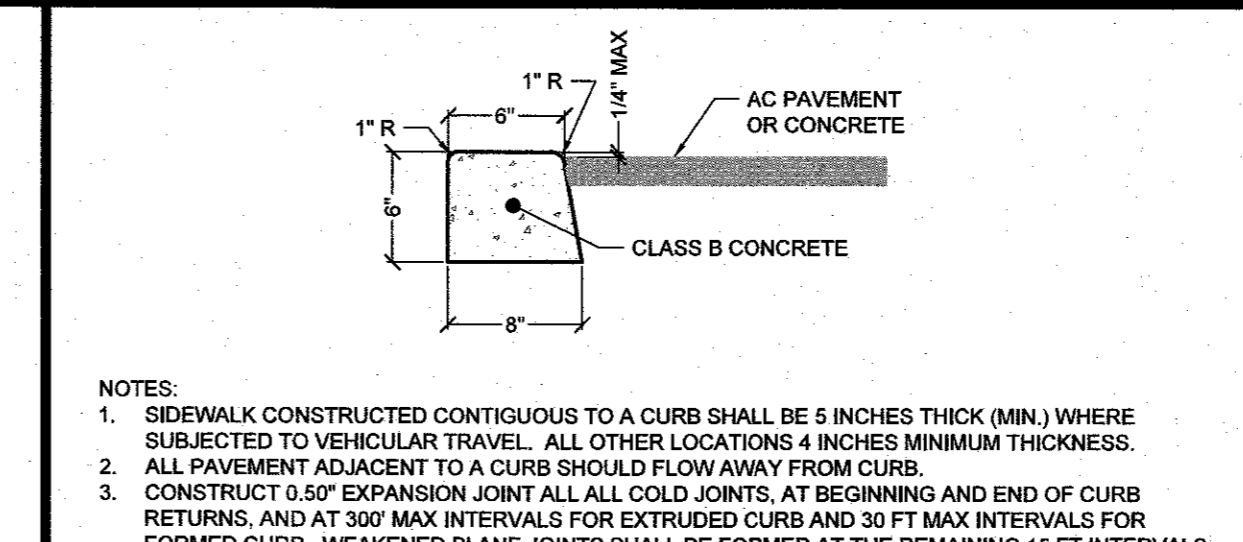

O 6\"/>

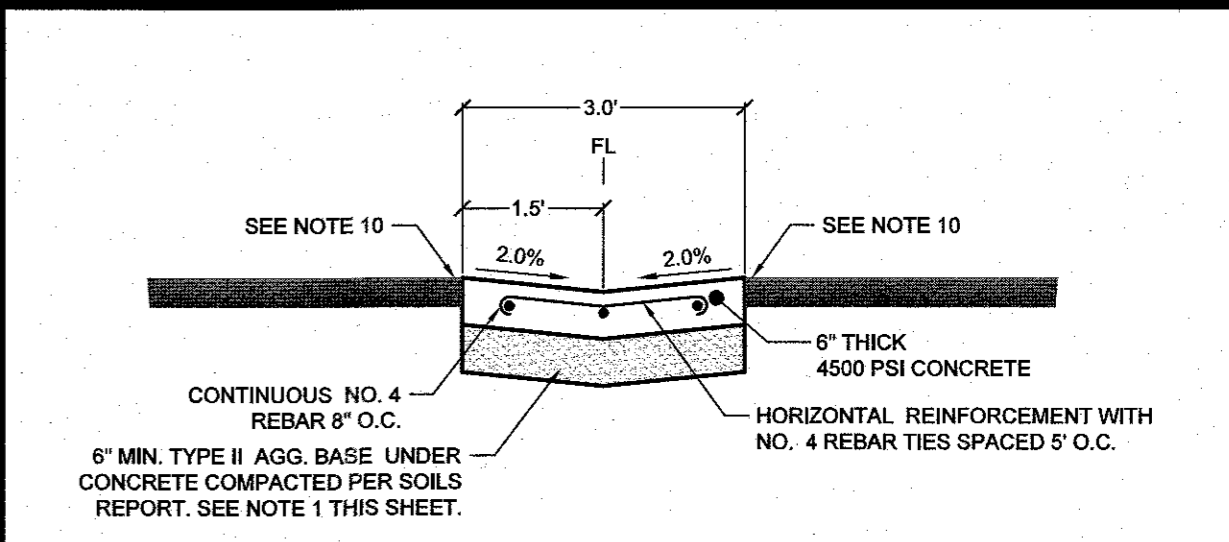

P 3FT VALLEY GUTTER
NTS

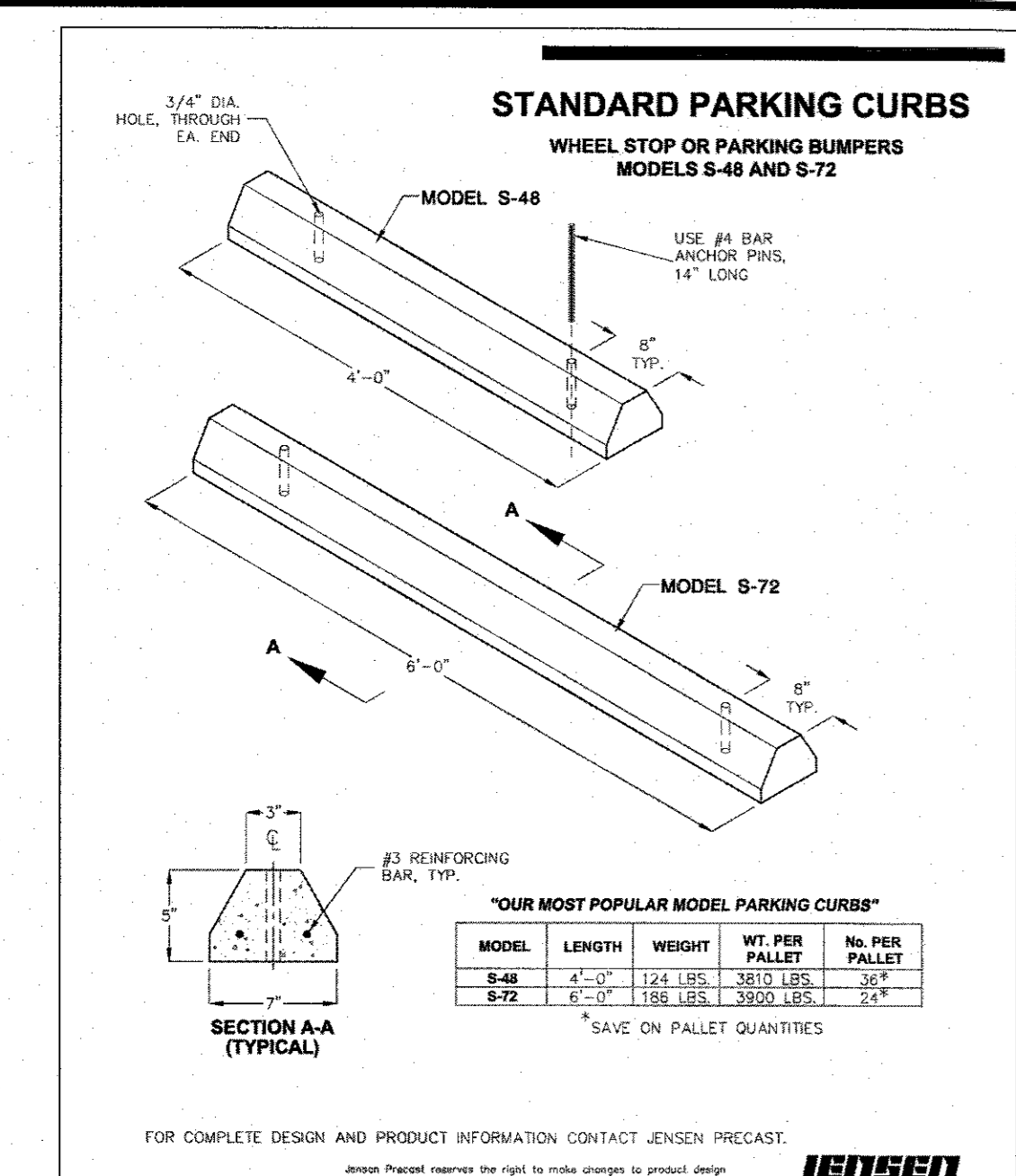

Q PRECAST CONCRETE BUMPER BLOCK
NTS

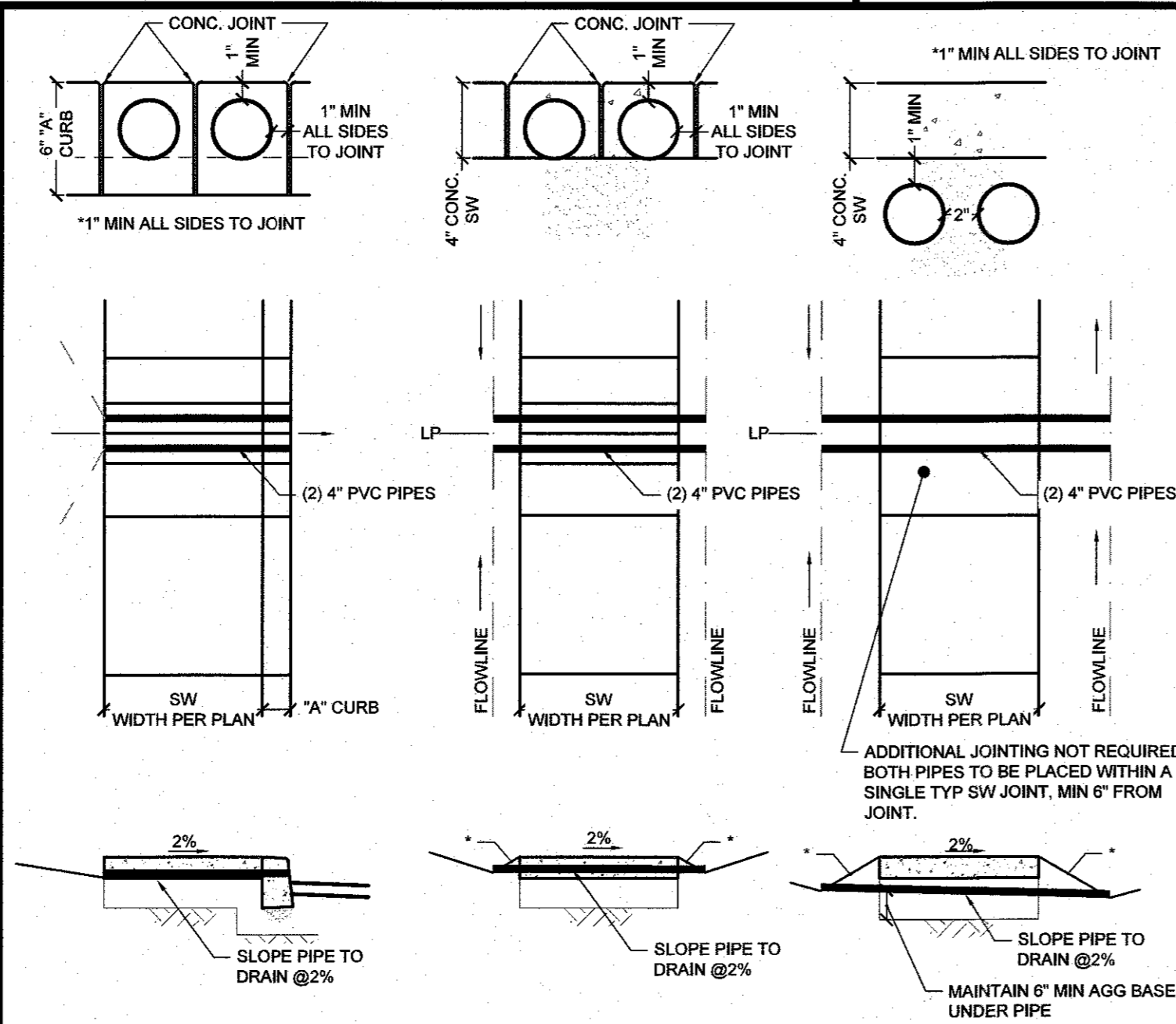

R SIDEWALK PIPE PENETRATION
OPTIONS
NTS

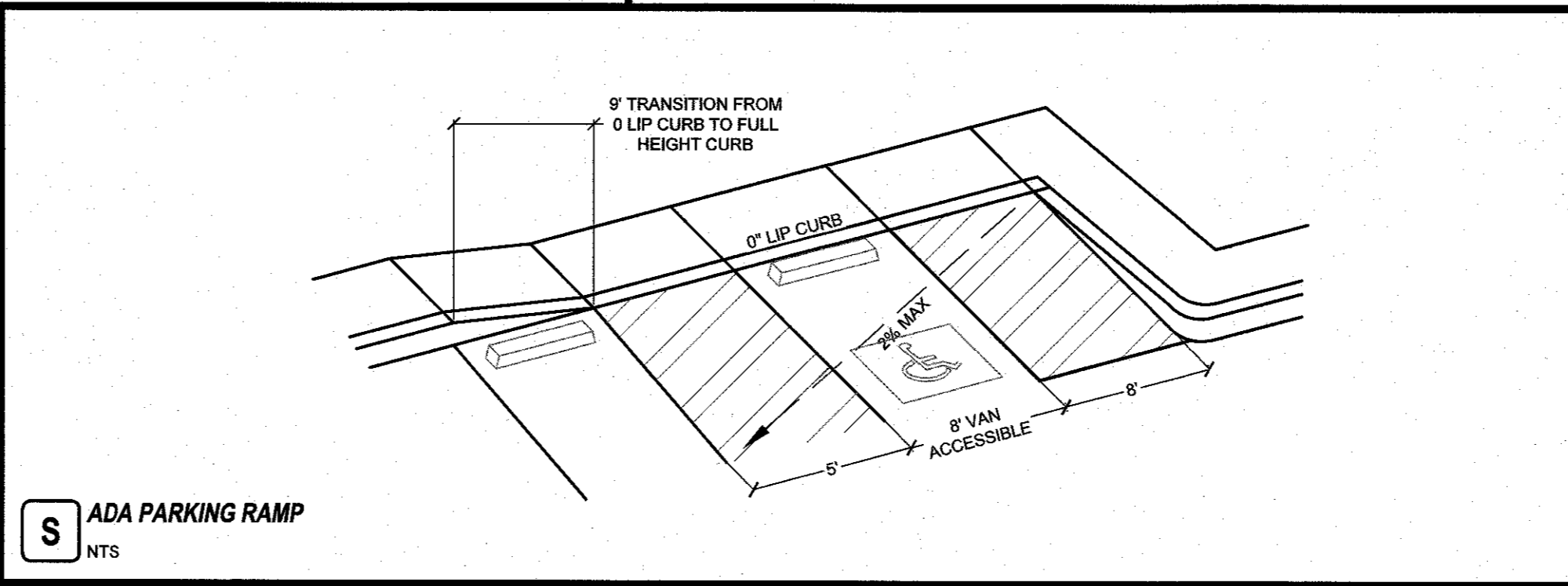

S ADA PARKING RAMP
NTS

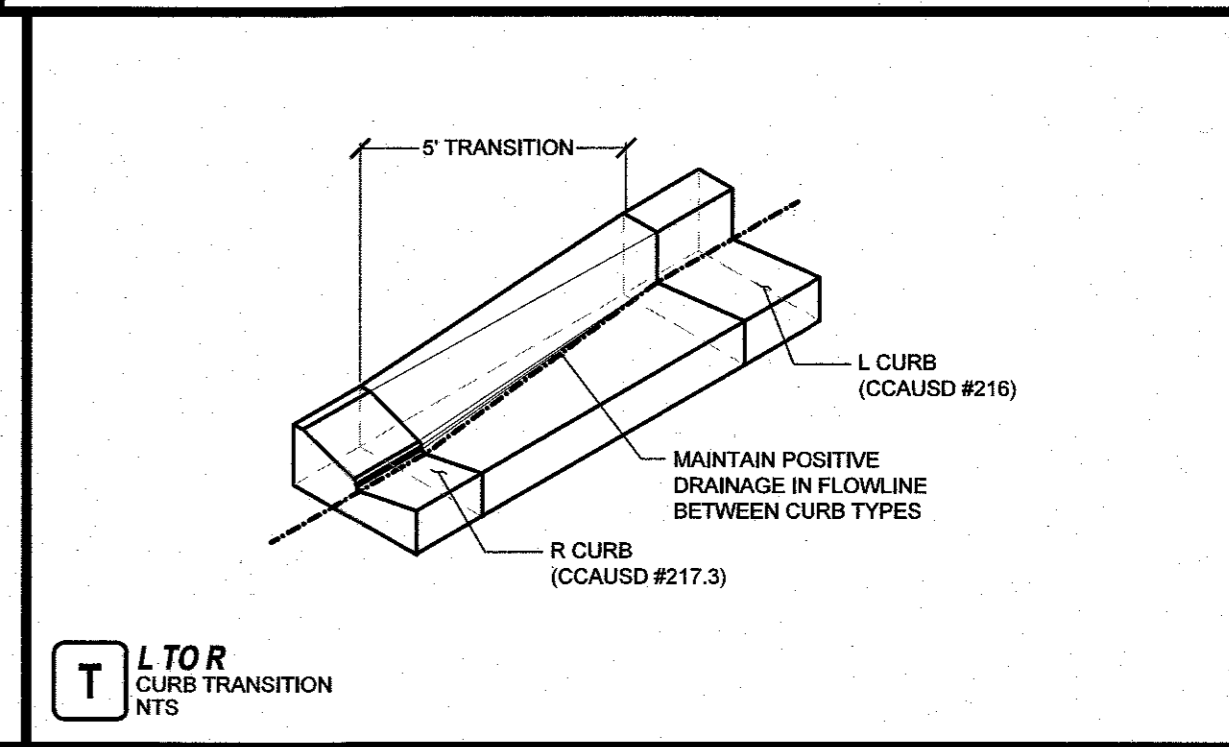

T L TO R CURB TRANSITION
NTS

NO.	DESCRIPTION	BY	DATE

REVISIONS

D R HORTON

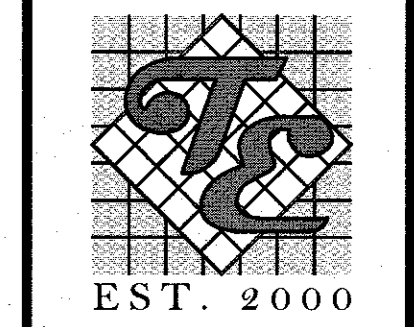

TANEY ENGINEERING & LAND SURVEYING
CIVIL ENGINEERING & LAND SURVEYING
6030 S. JONES BLVD
LAS VEGAS, NV 89118
(702) 362-8844
INFO@TANEYCORP.COM

ALPINE & APPIAN
SINGLE FAMILY ATTACHED
GRADING DETAILS & SECTIONS 1

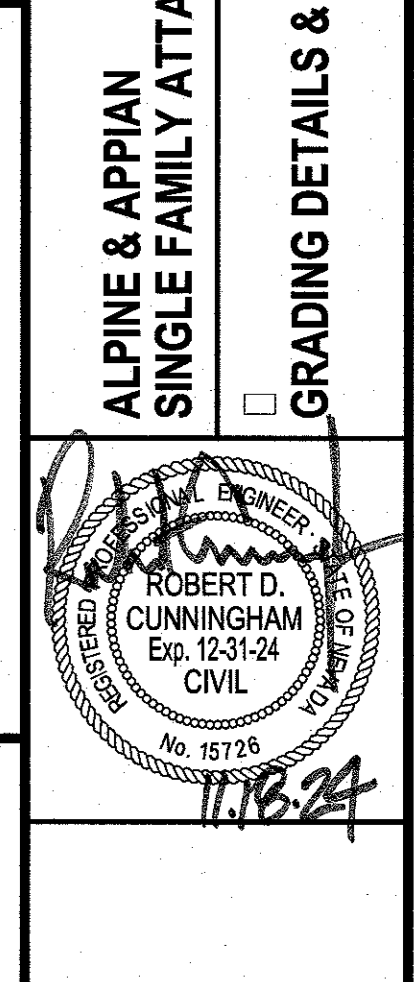

DATE:	11/17/2024
SCALE:	NTS
JOB NO:	DRH-24-107
DESIGNED BY:	RC
CHECKED BY:	JT
SHEET NAME:	GD1
SHEET NUMBER:	04 OF 09
CITY:	000000

Avoid overhead power line contact. It's costly.

Call before you Dig
Avoid cutting underground utility lines. It's costly.

Call before you Dig
1-702-227-2929

CALL 811 OR 1-800-642-2444

LAST PLOT: Jeff Thomson
FILE NAME: S:\ACTIVED R\HORTONDRH-24-107-APPIAN & ALPINEENG'S IPSIS SHEET DWGSDRHW107_SHT_GD.DWG

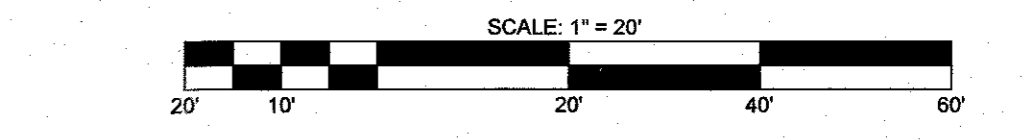
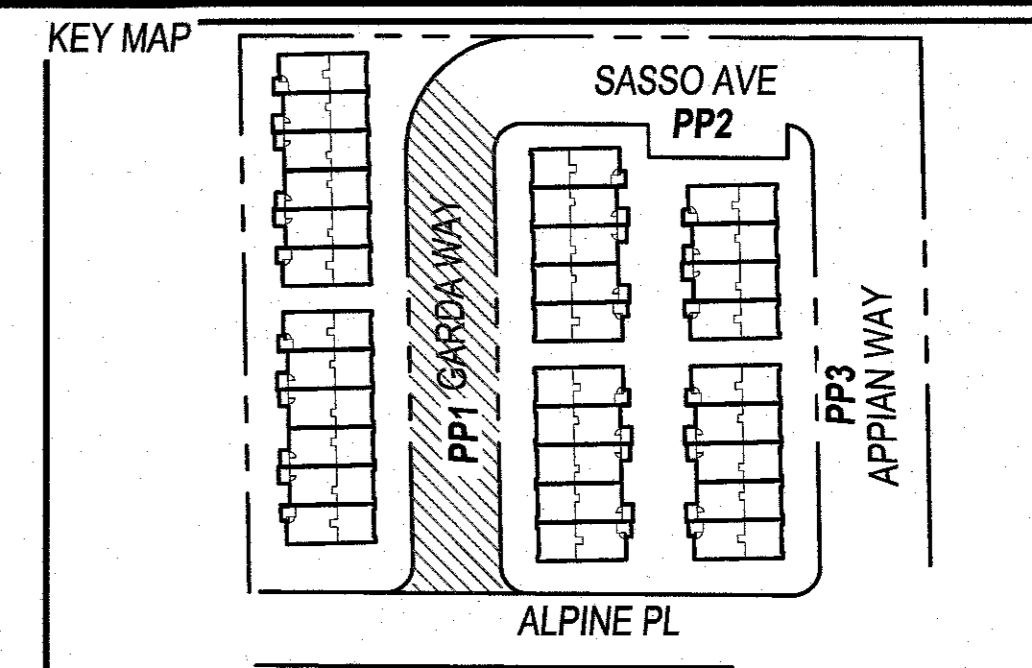

- GRADING CONSTRUCTION NOTES**
- 24" L-TYPE CURB & GUTTER (CCAUSD #216)
 - 6" A-TYPE CURB (CCAUSD #219)
 - 8" CROSS GUTTER (CCAUSD #228)
 - 24" R-TYPE CURB & GUTTER (CCAUSD #217.3.S1)
 - 4" THICK CONC. SIDEWALK, WIDTH AS LABELED IN PLAN VIEW (CCAUSD #234)
 - 6" ZERO LIP CURB (DETAIL O/G/D)
 - 3" CONCRETE VALLEY GUTTER (DETAIL P/G/D1)
 - CONSTRUCT AC PAVEMENT OVER AGG BASE - SEE GRADING DETAILS & SECTIONS FOR THICKNESS
 - CONSTRUCT 6" PRECAST CONCRETE BUMPER BLOCK (DETAIL O/G/D1)
 - ADA PARKING RAMP (DETAIL S/G/D1)
 - CONCRETE SIDEWALK RAMP (CCAUSD #235 - CASE 1 (A=B / B=B))
 - SAWCUT & MATCH INTO EXISTING AC PAVEMENT GRADE (CCAUSD#500.3, #500.4 & #500.5)
 - INSTALL 4" PVC PIPE, MINIMUM SLOPE = 0.5% UNDER SIDEWALK (DETAIL R/G/D1)
 - L-CURB TO R-CURB TRANSITION (DETAIL T/G/D1)
 - INSTALL RIPRAP 60#-3" THICKNESS=6"
 - INSTALL RIPRAP 60#-9" THICKNESS=12"
 - 2" CONCRETE VALLEY GUTTER (DETAIL M/G/D1)
 - 2.5" CONCRETE VALLEY GUTTER (DETAIL N/G/D1)
 - PAVERS FOR FRONT PORCH AREA (SEE ARCHITECTURAL PLANS FOR DETAILS)

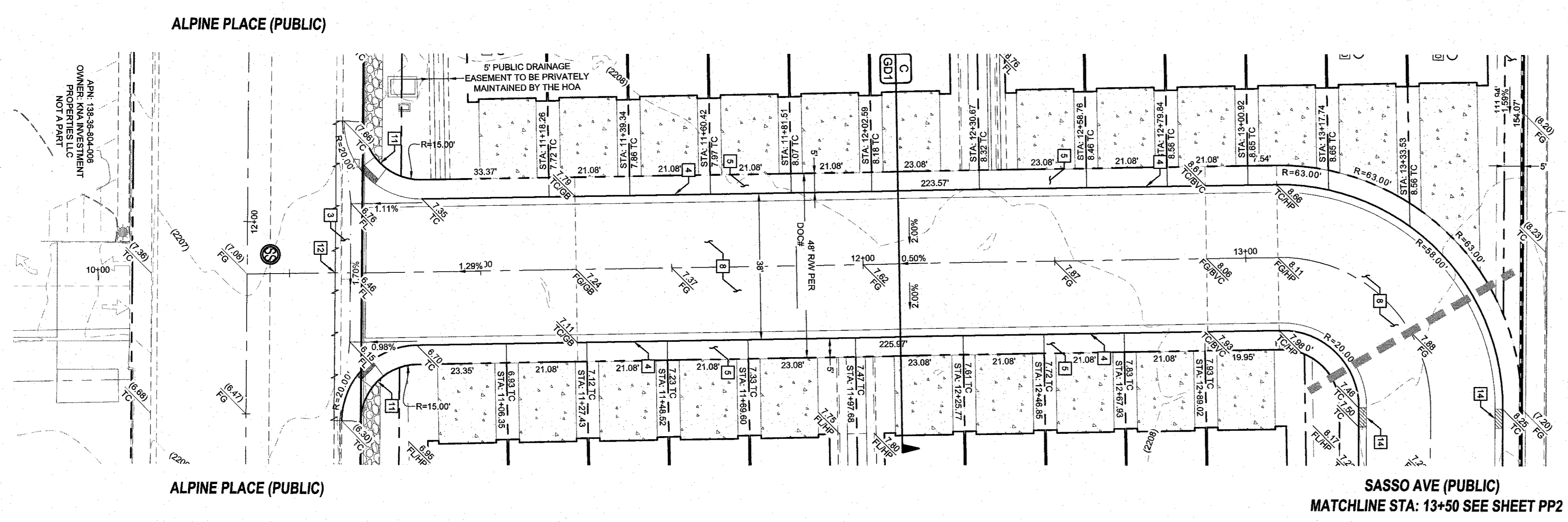

GARDA WAY (PUBLIC) - PLAN
STA: 10+00.00 TO 13+50.00

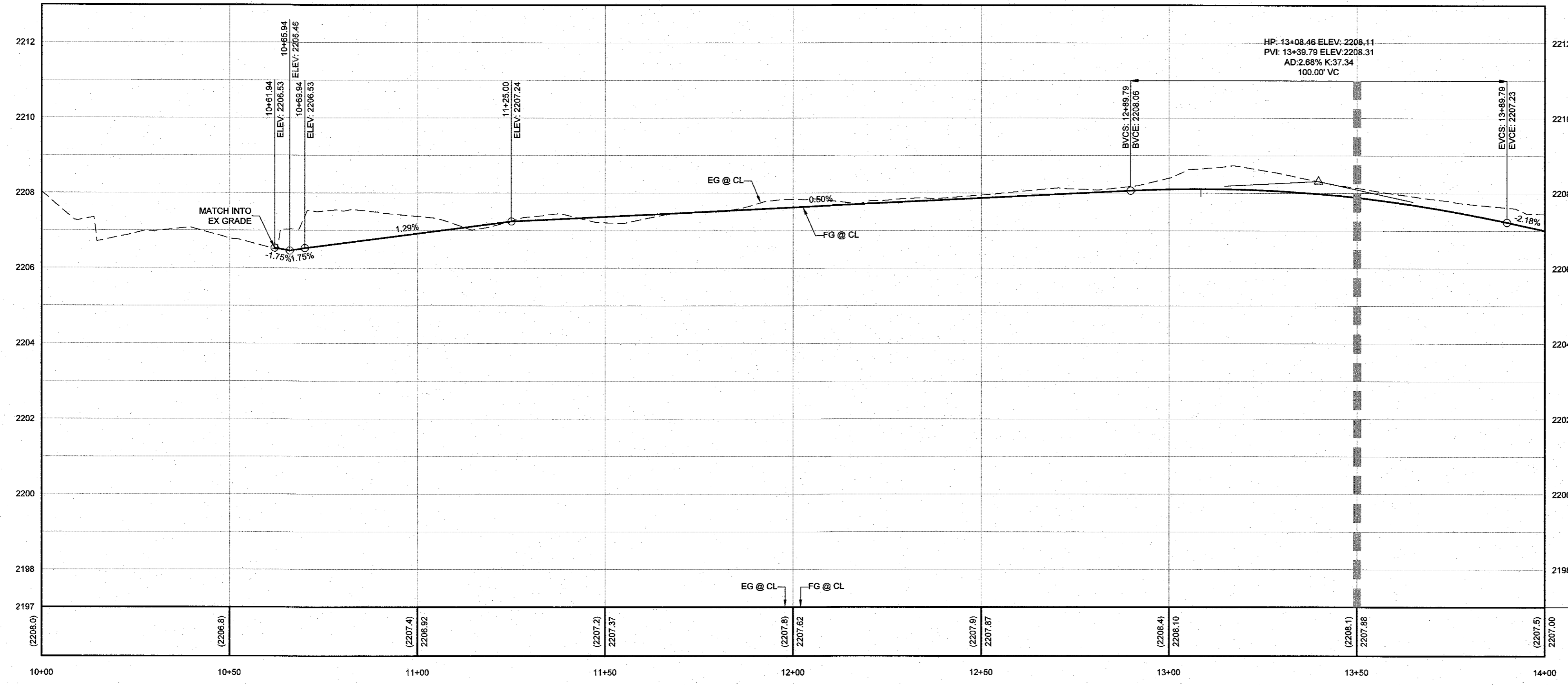

GARDA WAY (PUBLIC) - PROFILE
STA: 10+00.00 TO 13+50.00
SCALE: 1"=20' HORIZONTAL; 1"=2' VERTICAL

GEOTECHNICAL
GEOTECK RESIDENTIAL LLC
8835 S. ESCONCIBO ST., STE B
LAS VEGAS, NV 89119
(702) 897-1424
REPORT NO: 18138-LVR
DATE: 05/23/2024

LIVVWD NOTES:

- LIVVWD CANNOT GUARANTEE A WATERTIGHT SHUTDOWN WHERE CONNECTIONS OR REPAIRS TO EXISTING FACILITIES ARE REQUIRED. THE CONTRACTOR SHALL ENSURE ALL LABOR AND EQUIPMENT IS AVAILABLE TO REMOVE REMAINING WATER. COORDINATION WITH INSPECTION DIVISION MUST TAKE PLACE PRIOR TO ANY TRIAL SHUTDOWN.
- CONTRACTOR TO INSTALL TEMPORARY SERVICE TO ENSURE PROPER SHUTDOWN IN THE EVEN NO OTHER APPURTENANCES ARE AVAILABLE.
- DEPTH OF COVER DURING CONSTRUCTION
MAINTAIN MINIMUM TWENTY-FOUR (24) INCH COVER PER UDACS SECTION 2.08.04. GRADING MUST BE COMPLETED PRIOR TO WATERLINE INSTALLATION.
- WATER MAIN JOINT DEFLECTION PER UDACS 2.07.01 AND 2.07.03.
- PROTECT IN PLACE AND ADJUST LIVVWD EXISTING FACILITIES TO FINISHED GRADE PER UDACS. ALL LIVVWD FACILITIES SHALL BE ACCESSIBLE AT ALL TIMES.
- INSTALL PIPELINE MARKER BALLS, PER UDACS PLATE #15.

UTILITY DISCLAIMER
EXISTING UTILITY LOCATIONS SHOWN HEREIN ARE APPROXIMATE ONLY. IT SHALL BE THE CONTRACTOR'S RESPONSIBILITY TO DETERMINE THE EXACT VERTICAL AND HORIZONTAL LOCATION OF ALL EXISTING UNDERGROUND UTILITIES PRIOR TO COMMENCING CONSTRUCTION. NO REPRESENTATION IS MADE THAT ALL EXISTING UTILITIES ARE SHOWN HEREON. THE ENGINEER ASSUMES NO RESPONSIBILITY FOR UTILITIES NOT SHOWN OR UTILITIES NOT SHOWN IN THEIR EXISTING LOCATIONS.

LINE AND CURVE DATA
FOR LINE AND CURVE DATA TABLES, SEE THE GRADING PLAN SHEETS FOR THIS PROJECT.

PROFILE NOTES
ADD 2200 FEET TO ALL GRADE TAGS TO GET ACTUAL ELEVATION.
ALL PRIVATE STREETS AND DRAINAGE EASEMENTS ARE TO BE PRIVATELY OWNED AND MAINTAINED BY THE HOMEOWNERS ASSOCIATION (H.O.A.).
ALL WORK TO BE PERFORMED OUTSIDE OF THE PROJECT BOUNDARY AND ON PRIVATE PROPERTY SHALL NOT BE PERFORMED UNTIL WRITTEN PERMISSION AND EASEMENTS HAVE BEEN OBTAINED FROM THE OFFSITE OWNER AND GIVEN TO GOVERNING ENTITY.

BENCHMARK
MONUMENT ID: 7LV01315WS
REISET & PLATE IN TOP OF CURB AT NE CORNER OF DECATUR & CHARLESTON
ELEVATION (METERS): 871.37
ELEVATION (FEET): 2,199.37

APPROVED FOR CONSTRUCTION
LAS VEGAS VALLEY WATER DISTRICT PLANNING AND ENGINEERING SERVICES
PROJECT# 1220XX - FIRST APPROVED DATE
LIVVWD APPROVED FIRE FLOW: XXXX GPM AT 20 PSI RESIDUAL
MAXIMUM AVAILABLE FIRE SPRINKLER FLOW XXXX GPM

Call before you Dig
Avoid cutting underground utility lines. It's costly.

CALL
811
OR
1-800-642-2444

Avoid overhead power line contact. It's costly.

Call before you Overhead
1-702-227-2929

NO.	DESCRIPTION	BY	SHTS.	APPR.	DATE

D R HORTON

EST. 2000
TANNEY ENGINEERING & LAND SURVEYING
CIVIL ENGINEERING & LAND SURVEYING
6030 S. JONES BLVD
LAS VEGAS, NV 89118
(702) 362-8844
INFO@TANNEYCORP.COM

ALPINE & APPIAN
SINGLE FAMILY ATTACHED
GARDA WAY (PUBLIC)
PLAN & PROFILE 1
STA: 10+00 TO 13+50

DATE:	11/17/2024
SCALE:	1"=20'
JOB NO.:	DRH-24-107
DESIGNED BY:	RC
CHECKED BY:	JT
SHEET NAME:	PP1
SHEET NUMBER:	05 OF 09
CITY:	000000

LAST PLOT: Jeff Thomson
FILE NAME: S:\ACTIVED R HORTON\DRH-24-107 - APPIAN & ALPINE\ENG 03 IPS3 SHEET DWG\DRH107_SHT_PP.DWG

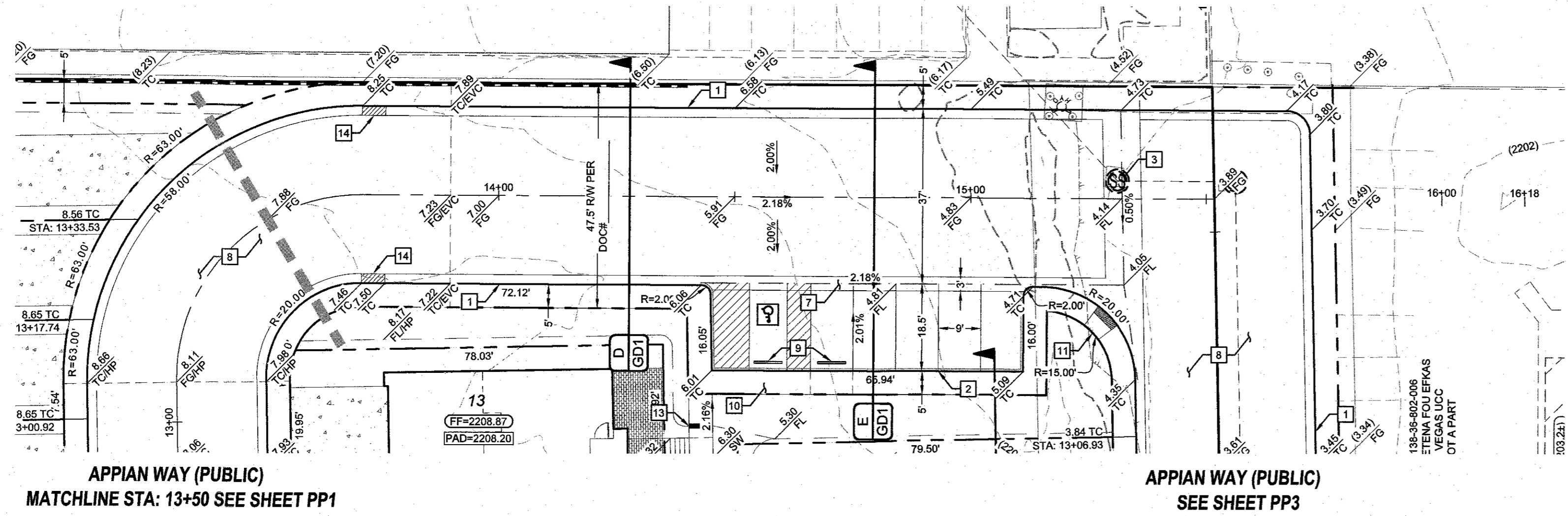

SASSO AVE (PUBLIC) - PLAN
STA: 13+50.00 TO 16+17.56

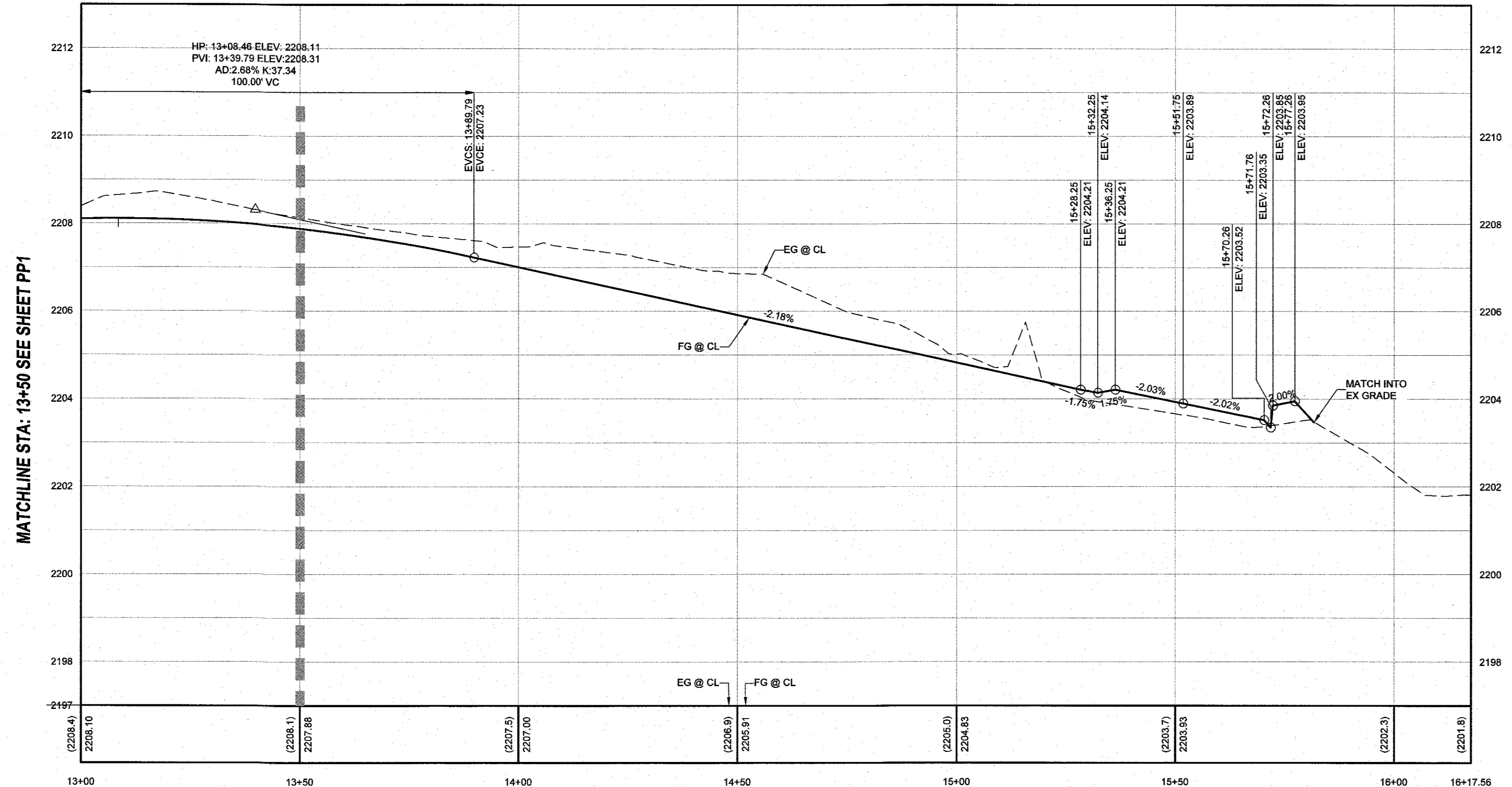

SASSO AVE (PUBLIC) - PROFILE
STA: 13+50.00 TO 16+17.56
SCALE: 1"=20' HORIZONTAL; 1"=2' VERTICAL

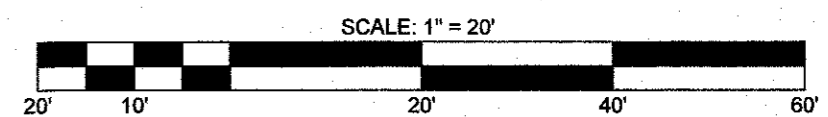
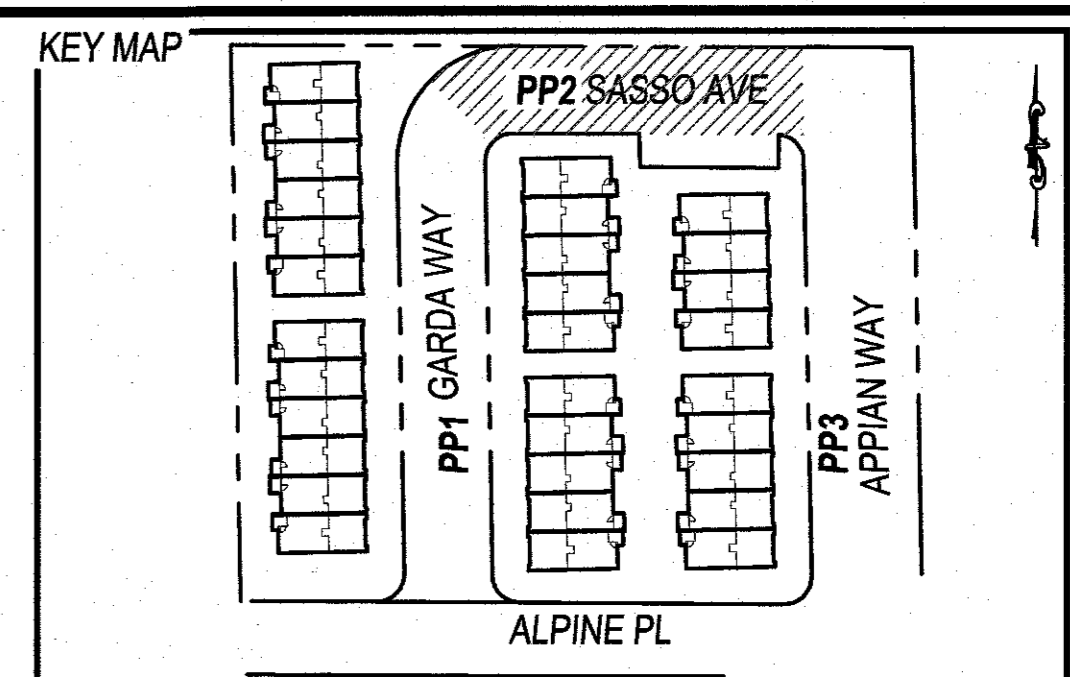

- GRADING CONSTRUCTION NOTES**
- 24" L-TYPE CURB & GUTTER (CCAUSD #216)
 - 6" A-TYPE CURB (CCAUSD #219)
 - 8" GROSS GUTTER (CCAUSD #228)
 - 24" R-TYPE CURB & GUTTER (CCAUSD #217.3.S1)
 - 4" THICK CONC. SIDEWALK WIDTH AS LABELED IN PLAN VIEW (CCAUSD #234)
 - 6" ZERO LIP CURB (DETAIL CGD1)
 - 3" CONCRETE VALLEY GUTTER (DETAIL PGD1)
 - CONSTRUCT AC PAVEMENT OVER AGG BASE - SEE GRADING DETAILS & SECTIONS FOR THICKNESS
 - CONTRACT 5' PRECAST CONCRETE BUMPER BLOCK (DETAIL OIGD1)
 - ADA PARKING RAMP (DETAIL S/GD1)
 - CONCRETE SIDEWALK RAMP (CCAUSD #235 - CASE 1 (A=6' / B=8'))
 - SAW-CUT & MATCH INTO EXISTING AC PAVEMENT GRADE (CCAUSD#500.3, #500.4 & #500.5)
 - INSTALL 4" PVC PIPE, MINIMUM SLOPE = 0.5% UNDER SIDEWALK (DETAIL RVGD1)
 - L-CURB TO R-CURB TRANSITION (DETAIL T/GD1)
 - INSTALL RIPRAP D50=3" THICKNESS=6"
 - INSTALL RIPRAP D50=6" THICKNESS=12"
 - 2" CONCRETE VALLEY GUTTER (DETAIL M/GD1)
 - 2" CONCRETE VALLEY GUTTER (DETAIL N/GD1)
 - PAVERS FOR FRONT PORCH AREA (SEE ARCHITECTURAL PLANS FOR DETAILS)

GEOTECHNICAL
 GEOTECK RESIDENTIAL LLC
 6835 S. ESCONCIDO ST., STE B
 LAS VEGAS, NV 89119
 (702) 897-1424
 REPORT NO: 18138-LVR
 DATE: 05/23/2024

- LVWVD NOTES:**
- LVWVD CANNOT GUARANTEE A WATERTIGHT SHUTDOWN WHERE CONNECTIONS OR REPAIRS TO EXISTING FACILITIES ARE REQUIRED. THE CONTRACTOR SHALL ENSURE ALL LABOR AND EQUIPMENT IS AVAILABLE TO REMOVE REMAINING WATER. COORDINATION WITH INSPECTION DIVISION MUST TAKE PLACE PRIOR TO ANY TRIAL SHUTDOWN.
 - CONTRACTOR TO INSTALL TEMPORARY SERVICE TO ENSURE PROPER SHUTDOWN IN THE EVENT NO OTHER APPURTENANCES ARE AVAILABLE.
 - DEPTH OF COVER DURING CONSTRUCTION MAINTAIN MINIMUM TWENTY-FOUR (24) INCH COVER PER UDACS SECTION 2.08.04. GRADING MUST BE COMPLETED PRIOR TO WATERLINE INSTALLATION.
 - WATER MAIN JOINT DEFLECTION PER UDACS 2.07.01 AND 2.07.03.
 - PROTECT IN PLACE AND ADJUST LVWVD EXISTING FACILITIES TO FINISHED GRADE PER UDACS. ALL LVWVD FACILITIES SHALL BE ACCESSIBLE AT ALL TIMES.
 - INSTALL PIPELINE MARKER BALLS, PER UDACS PLATE #15.

UTILITY DISCLAIMER
 EXISTING UTILITY LOCATIONS SHOWN HEREIN ARE APPROXIMATE ONLY. IT SHALL BE THE CONTRACTOR'S RESPONSIBILITY TO DETERMINE THE EXACT VERTICAL AND HORIZONTAL LOCATION OF ALL EXISTING UNDERGROUND UTILITIES PRIOR TO COMMENCING CONSTRUCTION. NO REPRESENTATION IS MADE THAT ALL EXISTING UTILITIES ARE SHOWN HEREON. THE ENGINEER ASSUMES NO RESPONSIBILITY FOR UTILITIES NOT SHOWN OR UTILITIES NOT SHOWN IN THEIR EXISTING LOCATIONS.

LINE AND CURVE DATA
 FOR LINE AND CURVE DATA TABLES, SEE THE GRADING PLAN SHEETS FOR THIS PROJECT.

PROFILE NOTES

ADD 2200 FEET TO ALL GRADE TAGS TO GET ACTUAL ELEVATION.

ALL PRIVATE STREETS AND DRAINAGE EASEMENTS ARE TO BE PRIVATELY OWNED AND MAINTAINED BY THE HOMEOWNERS ASSOCIATION (H.O.A.).

ALL WORK TO BE PERFORMED OUTSIDE OF THE PROJECT BOUNDARY AND ON PRIVATE PROPERTY SHALL NOT BE PERFORMED UNTIL WRITTEN PERMISSION AND EASEMENTS HAVE BEEN OBTAINED FROM THE OFFSITE OWNER AND GIVEN TO GOVERNING ENTITY.

BENCHMARK
 MONUMENT ID: 7LV0131SWS
 REVIET & PLATE IN TOP OF CURB AT NE CORNER OF DECATUR & CHARLESTON
 ELEVATION (METERS): 670.37
 ELEVATION (FEET) 2,199.37

APPROVED FOR CONSTRUCTION

LAS VEGAS VALLEY WATER DISTRICT PLANNING AND ENGINEERING SERVICES
 PROJECT# 1220XX, FIRST APPROVED DATE
 LVWVD APPROVED FIRE FLOW: XXXX GPM AT 20 PSI RESIDUAL
 MAXIMUM AVAILABLE FIRE SPRINKLER FLOW XXXX GPM

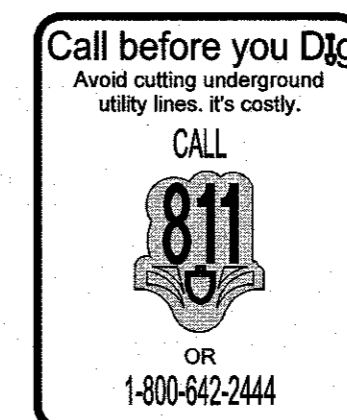

Avoid overhead power line contact. It's costly.

Call before you Overhead
 1-702-227-2929

NO.	DESCRIPTION	BY	SHTS	APPR.	DATE

D R HORTON

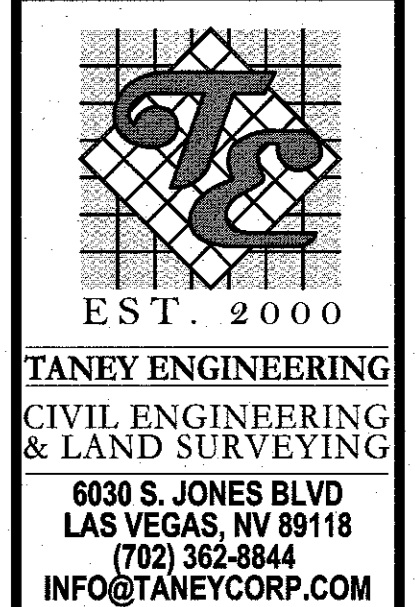

ALPINE & APPIAN SINGLE FAMILY ATTACHED SASSO AVE (PUBLIC) PLAN & PROFILE 2 STA: 13+50 TO 16+18

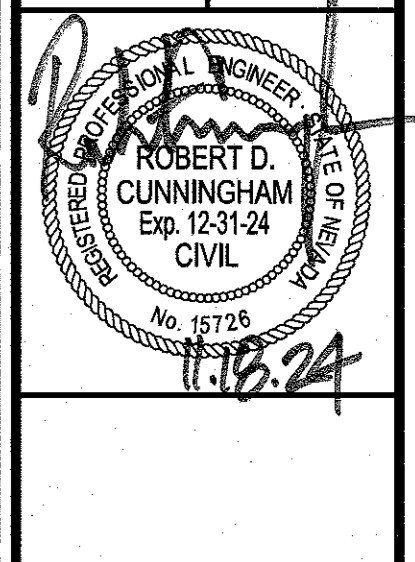

DATE:	11/17/2024
SCALE:	1"=20'
JOB NO.:	DRH-24-107
DESIGNED BY:	RC
CHECKED BY:	JT
SHEET NAME:	PP2
SHEET NUMBER:	06 OF 09
CITY:	0000000

LAST PLOT: Jeff Thomson
 FILE NAME: S:\ACTIVED\DRH\DRH-24-107 - APPIAN & ALPINE\ENG\PP2 SHEET DRH\DRH107_SHT_PP.DWG

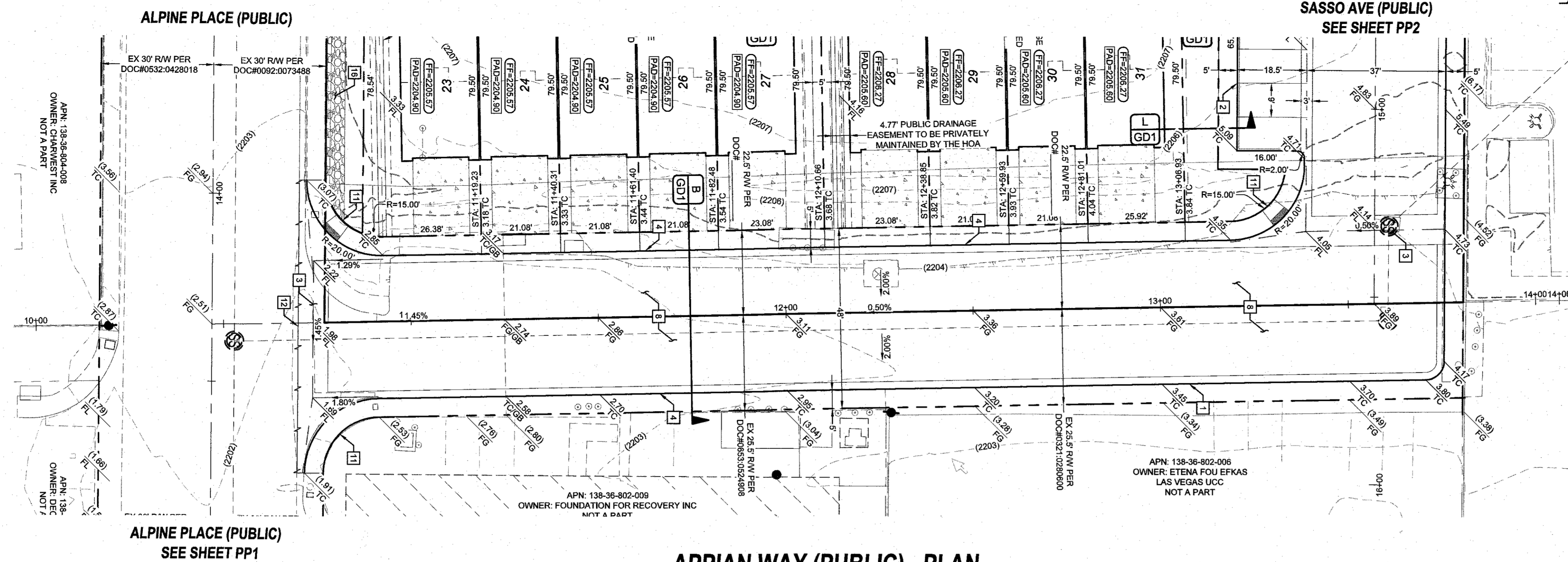

APPLAN WAY (PUBLIC) - PLAN
 STA: 10+00.00 TO 14+06.37

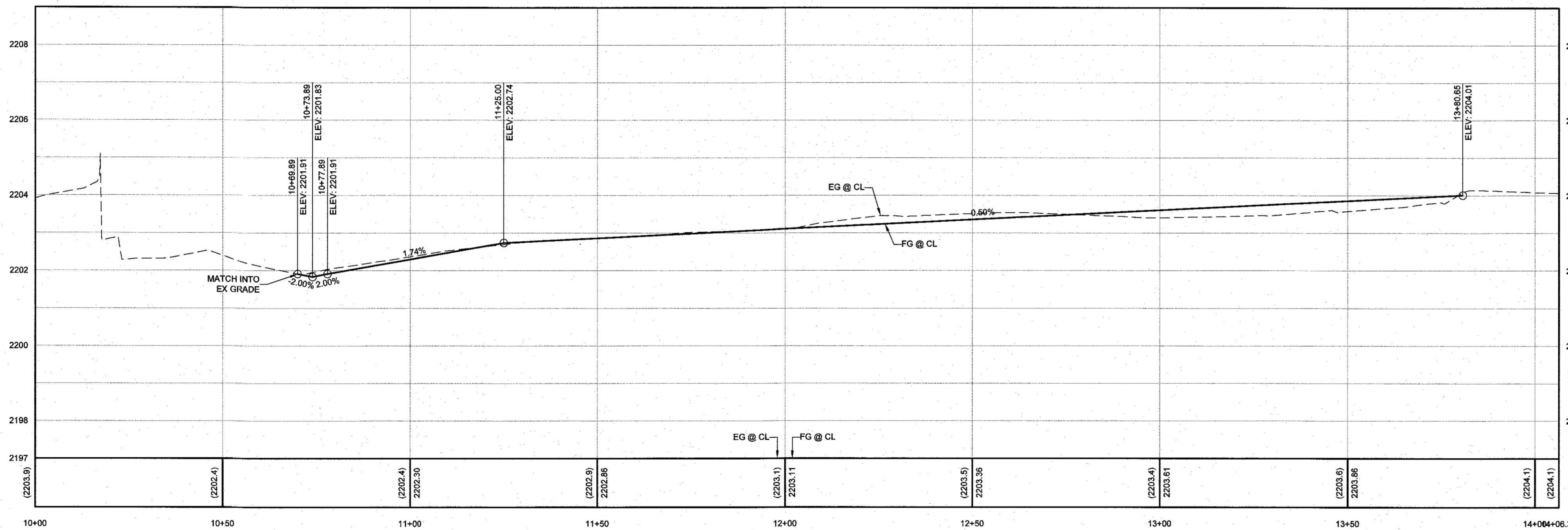

APPLAN WAY (PUBLIC) - PROFILE
 STA: 10+00.00 TO 14+06.37
 SCALE: 1"=20' HORIZONTAL; 1"=2' VERTICAL

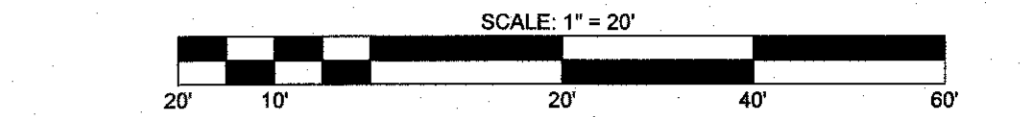
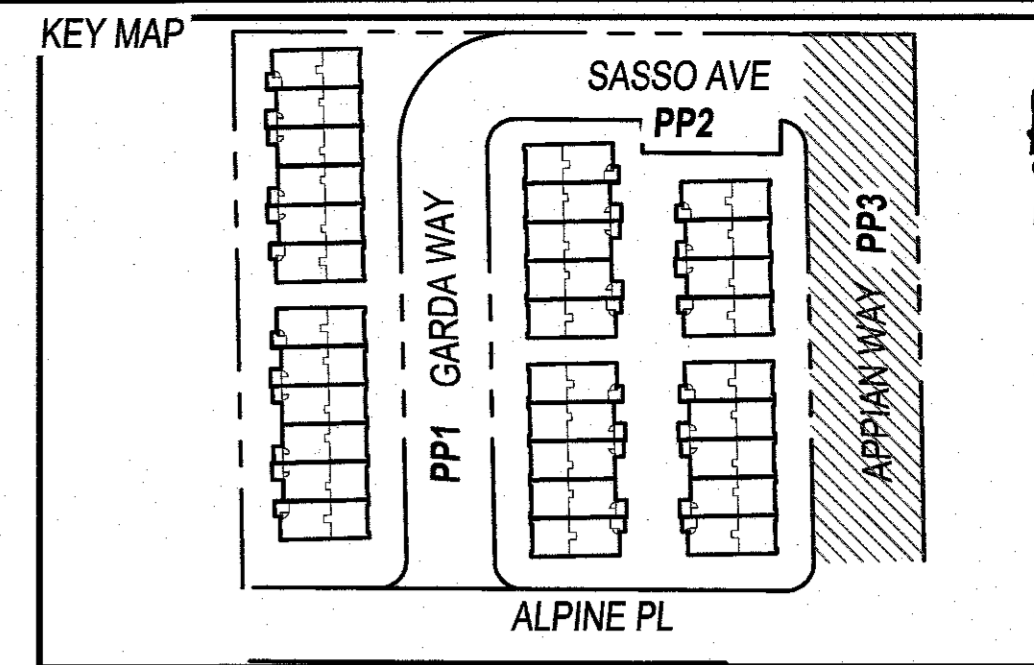

- GRADING CONSTRUCTION NOTES**
- 24" L-TYPE CURB & GUTTER (CCAUSD #216)
 - 6" A-TYPE CURB (CCAUSD #219)
 - 8" CROSS GUTTER (CCAUSD #228)
 - 24" R-TYPE CURB & GUTTER (CCAUSD #217.3.S1)
 - 4" THICK CONC. SIDEWALK, WIDTH AS LABELED IN PLAN VIEW (CCAUSD #234)
 - 6" ZERO LIP CURB (DETAIL QGD1)
 - 3" CONCRETE VALLEY GUTTER (DETAIL P/GD1)
 - CONSTRUCT AC PAVEMENT OVER AGG BASE - SEE GRADING DETAILS & SECTIONS FOR THICKNESS
 - CONSTRUCT 6" PRECAST CONCRETE BUMPER BLOCK (DETAIL Q/GD1)
 - ADA PARKING RAMP (DETAIL S/GD1)
 - CONCRETE SIDEWALK RAMP (CCAUSD #235 - CASE 1 (A+B) / B+B)
 - SAW-CUT & MATCH INTO EXISTING AC PAVEMENT GRADE (CCAUSD#500.3, #500.4 & #500.5)
 - INSTALL 4" PVC PIPE, MINIMUM SLOPE = 0.5% UNDER SIDEWALK (DETAIL R/GD1)
 - L-CURB TO R-CURB TRANSITION (DETAIL T/GD1)
 - INSTALL RIPRAP D50=5" THICKNESS=4"
 - INSTALL RIPRAP D50=5" THICKNESS=12"
 - 2" CONCRETE VALLEY GUTTER (DETAIL M/GD1)
 - 2.5" CONCRETE VALLEY GUTTER (DETAIL M/GD1)
 - PAVERS FOR FRONT PORCH AREA (SEE ARCHITECTURAL PLANS FOR DETAILS)

GEOTECHNICAL
 GEOTECH RESIDENTIAL LLC
 6835 S. ESCONCADO ST., STE B
 LAS VEGAS, NV 89119
 (702) 897-1424
 REPORT NO: 18138-LVR
 DATE: 05/23/2024

- LWVWD NOTES:**
- LWVWD CANNOT GUARANTEE A WATERTIGHT SHUTDOWN WHERE CONNECTIONS OR REPAIRS TO EXISTING FACILITIES ARE REQUIRED. THE CONTRACTOR SHALL ENSURE ALL LABOR AND EQUIPMENT IS AVAILABLE TO REMOVE REMAINING WATER COORDINATION WITH INSPECTION DIVISION MUST TAKE PLACE PRIOR TO ANY TRIAL SHUTDOWN.
 - CONTRACTOR TO INSTALL TEMPORARY SERVICE TO ENSURE PROPER SHUTDOWN IN THE EVENT NO OTHER APPURTENANCES ARE AVAILABLE.
 - DEPTH OF COVER DURING CONSTRUCTION
 MAINTAIN MINIMUM TWENTY-FOUR (24) INCH COVER PER UDACS SECTION 2.08.04. GRADING MUST BE COMPLETED PRIOR TO WATERLINE INSTALLATION.
 - WATER MAIN JOINT DEFLECTION PER UDACS 2.07.01 AND 2.07.03.
 - PROTECT IN PLACE AND ADJUST LWVWD EXISTING FACILITIES TO FINISHED GRADE PER UDACS. ALL LWVWD FACILITIES SHALL BE ACCESSIBLE AT ALL TIMES.
 - INSTALL PIPELINE MARKER BALLS, PER UDACS PLATE #15.

UTILITY DISCLAIMER
 EXISTING UTILITY LOCATIONS SHOWN HEREIN ARE APPROXIMATE ONLY. IT SHALL BE THE CONTRACTOR'S RESPONSIBILITY TO DETERMINE THE EXACT VERTICAL AND HORIZONTAL LOCATION OF ALL EXISTING UNDERGROUND UTILITIES PRIOR TO COMMENCING CONSTRUCTION. NO REPRESENTATION IS MADE THAT ALL EXISTING UTILITIES ARE SHOWN HEREON. THE ENGINEER ASSUMES NO RESPONSIBILITY FOR UTILITIES NOT SHOWN OR UTILITIES NOT SHOWN IN THEIR EXISTING LOCATIONS.

LINE AND CURVE DATA
 FOR LINE AND CURVE DATA TABLES, SEE THE GRADING PLAN SHEETS FOR THIS PROJECT.

PROFILE NOTES

- ADD 2200 FEET TO ALL GRADE TAGS TO GET ACTUAL ELEVATION.
- ALL PRIVATE STREETS AND DRAINAGE EASEMENTS ARE TO BE PRIVATELY OWNED AND MAINTAINED BY THE HOMEOWNERS ASSOCIATION (H.O.A.).
- ALL WORK TO BE PERFORMED OUTSIDE OF THE PROJECT BOUNDARY AND ON PRIVATE PROPERTY SHALL NOT BE PERFORMED UNTIL WRITTEN PERMISSION AND EASEMENTS HAVE BEEN OBTAINED FROM THE OFFSITE OWNER AND GIVEN TO GOVERNING ENTITY.

BENCHMARK
 MONUMENT ID: 7LV01315W6
 REINET & PLATE IN TOP OF CURB AT NE CORNER OF DECATUR & CHARLESTON
 ELEVATION (METERS): 670.37
 ELEVATION (FEET) 2,199.37

APPROVED FOR CONSTRUCTION
 LAS VEGAS VALLEY WATER DISTRICT PLANNING AND ENGINEERING SERVICES
 PROJECT# 122XXX, FIRST APPROVED DATE
 LWVWD APPROVED FIRE FLOW: XXXX GPM AT 20 PSI RESIDUAL
 MAXIMUM AVAILABLE FIRE SPRINKLER FLOW XXXX GPM

Call before you Dig
 Avoid cutting underground utility lines. It's costly.
 CALL

 OR
 1-800-642-2444

Avoid overhead power line contact. It's costly.
 Call before you Overhead
 1-702-227-2929

NO.	DESCRIPTION	BY	APPR.	DATE

D R HORTON

TANEY ENGINEERING & LAND SURVEYING
 CIVIL ENGINEERING & LAND SURVEYING
 6030 S. JONES BLVD
 LAS VEGAS, NV 89118
 (702) 362-8844
 INFO@TANEYCORP.COM

ALPINE & APPLAN SINGLE FAMILY ATTACHED APPLAN WAY (PUBLIC) PLAN & PROFILE 1 STA: 10+00 TO 14+06

DATE: 11/17/2024
 SCALE: 1"=20'
 JOB NO: DRH-24-107
 DESIGNED BY: RC CHECKED BY: JT
 SHEET NAME: PP3
 SHEET NUMBER: 07 OF 09
 CITY: 0000000