

Plotted By: Achihami, Abuhson, Sheet Set: King Layout: DEV-2 October 15, 2024 02:59:45pm K:\LAV-Civil\291400040 - Racel & Maverick\Reports\DRAINAGE\02\_ADD\Figures\CAD\_PRO\_Map\_ADD.dwg  
 This document, together with the concepts and designs presented herein, is intended only for the specific purpose and client for which it was prepared. Reuse of and improper reliance on this document without written authorization and adaptation by Kimley-Horn and Associates, Inc. shall be without liability to Kimley-Horn and Associates, Inc.

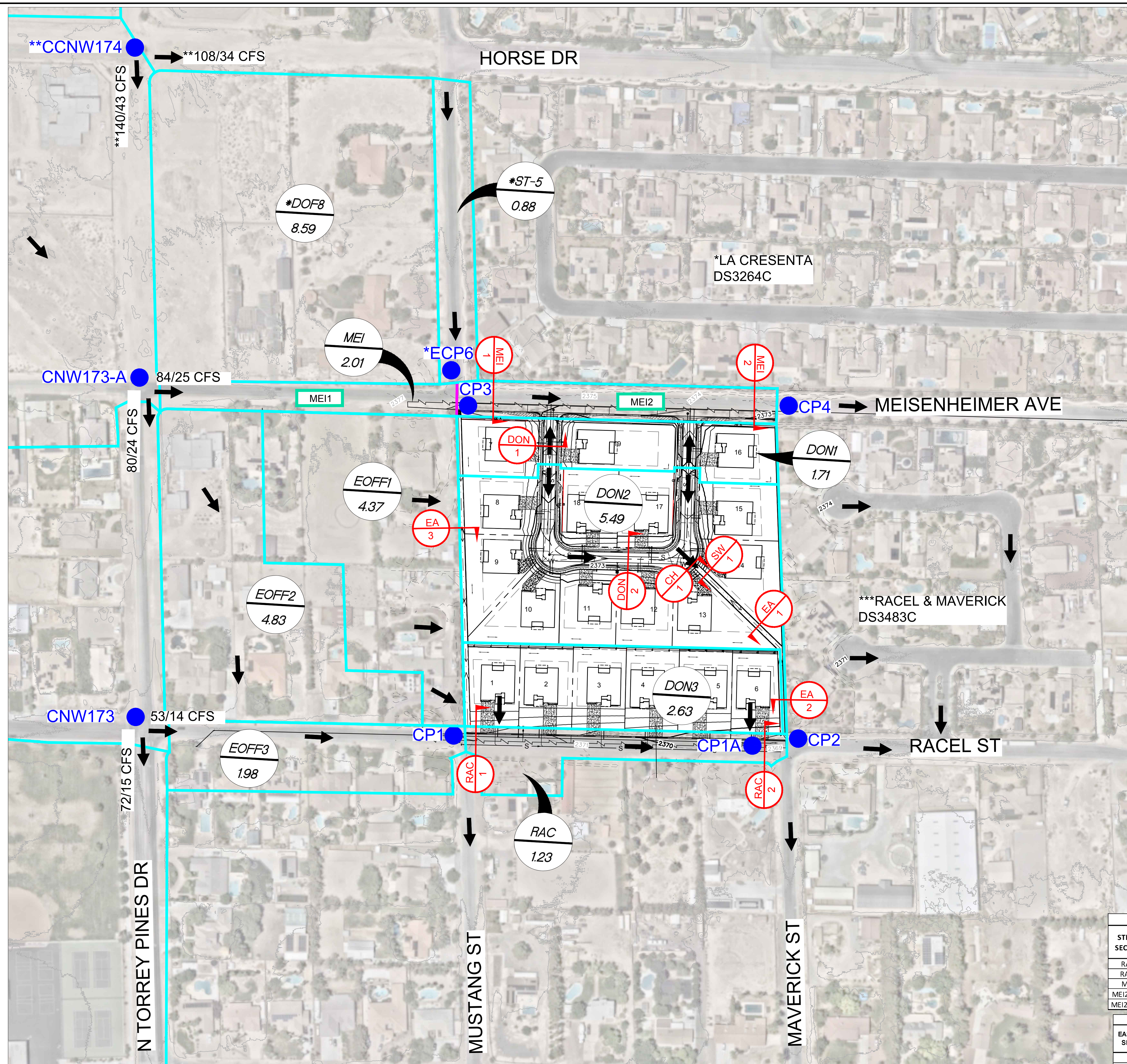

**LEGEND**

**GRAPHIC SCALE IN FEET**  
 0 50 100 200  
 SCALE: 1" = 100'

**XX** BASIN ID  
**XX** PRORATED BASIN BOUNDARY ID  
 BASIN BOUNDARY  
 PRORATED BASIN BOUNDARY  
 FLOW ARROW  
 100/10CFS FLOW ARROW WITH FLOW RATES  
 CPX CONCENTRATION POINT  
 SECTION ID

**PROPOSED FLOW SUMMARY TABLE**

BASIN ID/ COMB. PT.	BASIN AREA (ac)	100-YR FLOW (cfs)	10-YR FLOW (cfs)
**NW174	N/A	226	76
**CCNW174	N/A	248	70
**DNW184	N/A	108	31
**DCCNW174	N/A	140	39
**NW173-A	26.01	39	14
CNW173-A	N/A	164	48
DIVMEI	N/A	84	25
DCNW173-A	N/A	80	24
**NW173-B	64.79	57	14
CNW173	N/A	133	35
DTNW173	N/A	8	8
**DTCNW173	N/A	125	27
**DNW183	N/A	53	11
**DCNW173	N/A	72	15
**NW172	N/A	105	33
**CNW172	N/A	168	40
**DTDNW183	N/A	53	11
EOFF1	4.37	7	2
EOFF2	4.83	7	2
EOFF3	1.98	4	2
CP1	N/A	63	14
DON3	2.63	4	1
RAC	1.23	3	2
CP1A	N/A	68	16
DON2	5.49	9	3
CP2	N/A	74	18
*DOF8	8.59	12	4
*ST-5	0.88	2	1
*ECP6	N/A	14	4
MEI	2.01	6	3
DMEI2	N/A	3	1
DMEI1	N/A	3	2
CP3	N/A	92	28
DON1	1.71	3	1
CP4	N/A	95	28

\*Referenced from La Cresenta Study (DS3264)  
 \*\*Referenced/Revised from Neighborhood Study

**DEVELOPED PRORATED FLOW SUMMARY TABLE**

BASIN ID	EXISTING BASINS				
	100-YR FLOW (cfs)	10-YR FLOW (cfs)	AREA (acres)	Q100 (CFS/ACRE)	Q10 (CFS/ACRE)
MEI	6	3	2.01	2.99	1.49

BASIN ID	PRORATED DEVELOPED BASINS				
	100-YR FLOW (cfs)	10-YR FLOW (cfs)	AREA (acres)	Q100 (CFS/ACRE)	Q10 (CFS/ACRE)
MEI-1	2.5	1.5	0.88	2.99	1.49
MEI-2	3.5	1.5	1.13	2.99	1.49
TOTAL	6.0	3.0	2.01	NA	NA

**ONSITE HYDRAULIC SECTIONS**

SECTION	TRIBUTARY BASINS	CHANNEL SLOPE (%)	Q <sub>100</sub> (cfs)	FLOW DEPTH (ft)	VELOCITY (ft/s)	D*V (ft <sup>2</sup> /s)
DON1 (Min)	DON1	1.38	3.0	0.29	2.23	0.65
DON1 (Max)	DON1	1.69	3.0	0.28	2.42	0.68
DON2 (Min)	DON2	0.40	9.0	0.46	1.53	0.70
DON2 (Max)	DON2	1.30	9.0	0.38	2.70	1.03

**STREET HYDRAULIC SECTIONS**

STREET SECTION	TRIBUTARY BASINS	SLOPE (%)	Q <sub>100</sub> (cfs)	FLOW DEPTH (ft)	VELOCITY (ft/s)	D*V (ft <sup>2</sup> /s)	Q <sub>10</sub> (cfs)	FLOW DEPTH (ft)	VELOCITY (ft/s)	D*V (ft <sup>2</sup> /s)	DRY LAINE
RAC1	CP1	0.47	66.0	0.77	2.60	2.00	18.0	0.55	1.75	0.96	-
RAC2	CP1A	0.53	68.0	0.77	2.78	2.14	16.0	0.52	1.77	0.92	-
MEI1	CP3	0.40	92.0	0.91	3.03	2.76	28.0	0.64	1.97	1.26	-
MEI2 (Min)	CP4	0.42	95.0	0.91	3.11	2.83	28.0	0.63	2.00	1.26	-
MEI2 (Max)	CP4	0.69	95.0	0.84	3.62	3.04	28.0	0.59	2.39	1.41	-

**EASEMENT SECTIONS**

EASEMENT SECTION	TRIBUTARY BASINS	CHANNEL SLOPE (%)	Q <sub>100</sub> (cfs)	FLOW DEPTH (ft)	VELOCITY (ft/s)	D*V (ft <sup>2</sup> /s)	TYPE	BOTTOM WIDTH (ft)	SIDE SLOPES
CH1	DON2	1.00	9.0	0.24	3.93	0.94	RECT	11	N/A N/A
SW1	1/3DON2	0.62	3.0	0.39	3.86	1.51	RECT	2	N/A N/A
EA1	DON2	0.62	9.0	0.29	3.52	1.02	RECT	10	N/A N/A
EA2	DON2	0.62	9.0	0.30	3.61	1.08	RECT	9.33	N/A N/A
EA3	EOFF1	0.66	7.0	0.25	1.93	0.48	RECT	10	N/A N/A

NOTES:  
 \*REFERENCED FROM LA CRESSENTA STUDY (DS3264C)  
 \*\*REFERENCED FROM NORTHWEST NEIGHBORHOOD STUDY  
 \*\*\*REFERENCED FROM RACEL & MAVERICK STUDY (DS3483C)

**Kimley-Horn**  
 © 2024 KIMLEY-HORN AND ASSOCIATES, INC.  
 6671 LAS VEGAS BOULEVARD S., SUITE 320  
 LAS VEGAS, NV 89119  
 WWW.KIMLEY-HORN.COM  
 PHONE: 702-862-3600

**ONSITE PROPOSED CONDITIONS BASIN MAP**

**RACEL & MAVERICK**  
 PREPARED FOR  
**RICHMOND AMERICAN**

CITY OF LAS VEGAS NEVADA

PRO-2

DATE: 07/23/24  
 CHECKED BY: AA  
 DRAWN BY: UE  
 DESIGNED BY: AA  
 SCALE: AS SHOWN  
 DATE: 08/28/2024  
 PROJECT: 291400040