

**GENERAL SECTION NOTES:**

1. ALL AGG. BASES SHALL BE COMPACTED PER GEOTECH REPORT NO. 18095-LVR
2. PRELIMINARY PAVEMENT SECTIONS SHALL BE VERIFIED WITH THE FINAL PAVEMENT SECTION RECOMMENDATION REPORT PRIOR TO CONSTRUCTION. IF FINAL PAVEMENT SECTIONS ARE DIFFERENT, A REVISION TO THE IMPROVEMENT PLANS WILL BE REQUIRED.
3. ALL SLOPES GREATER THAN 3:1 WILL HAVE A 2FT AT 2% BENCH AT THE TOP OF SLOPE.
4. SLOPES GREATER THAN 6:1 UP TO 3:1 WILL HAVE A 1FT BENCH AT 2% AT THE TOP OF SLOPE.
5. ALL PERIMETER WALLS SHALL BE DECORATIVE.
6. MAINTAIN 4 INCHES OR LESS SEPARATION BETWEEN WALLS PER TITLE 30.64.0203. GAP TO BE FILLED & CAPPED WITH METAL FLASHING
7. WALL SECTIONS SHOWN ON THIS SHEET ARE FOR REFERENCE ONLY. SEE GEOTECH REPORT AND STRUCTURAL DRAWINGS FOR DESIGN AND WATERPROOFING REQUIREMENTS.
8. FOR FOOTING DEPTH BELOW LOWEST ADJACENT GRADE, SEE GEOTECH REPORT RECOMMENDATIONS AND STRUCTURAL DRAWINGS.
9. DISTANCE FROM OUTSIDE EDGE OF FOOTING TO THE FACE OF ADJACENT DESCENDING SLOPE SHOULD MEET THE MINIMUM DISTANCES OUTLINED IN THE GEOTECH REPORT.
10. AGGREGATE BASE TO BE COMPACTED PER THE SOILS REPORT.
11. A.C. PAVEMENT TO BE A MAXIMUM 1/4" ABOVE LIP ON LOCAL RESIDENTIAL STREETS AND 1/2" ABOVE LIP ON COLLECTOR/ARTERIAL STREETS TO ADJACENT CONCRETE AFTER COMPACTION.

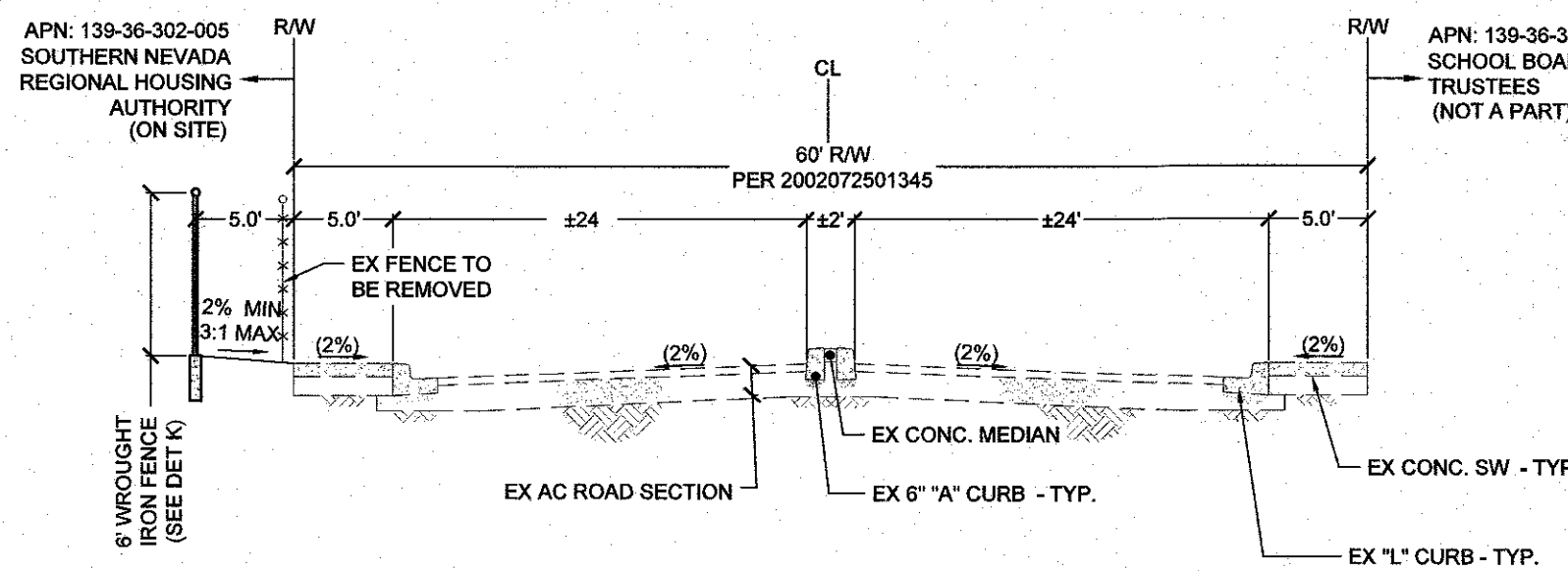

**A EXISTING N 28TH STREET**  
NTS

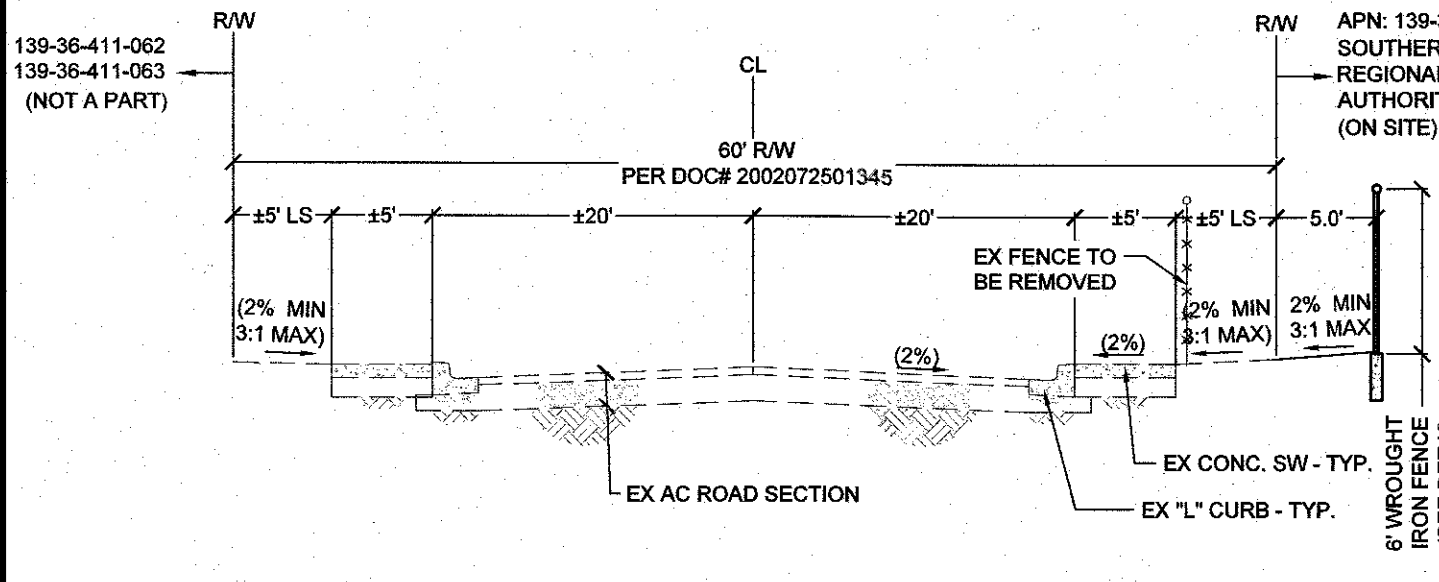

**B SUNRISE AVENUE EAST SIDE**  
NTS

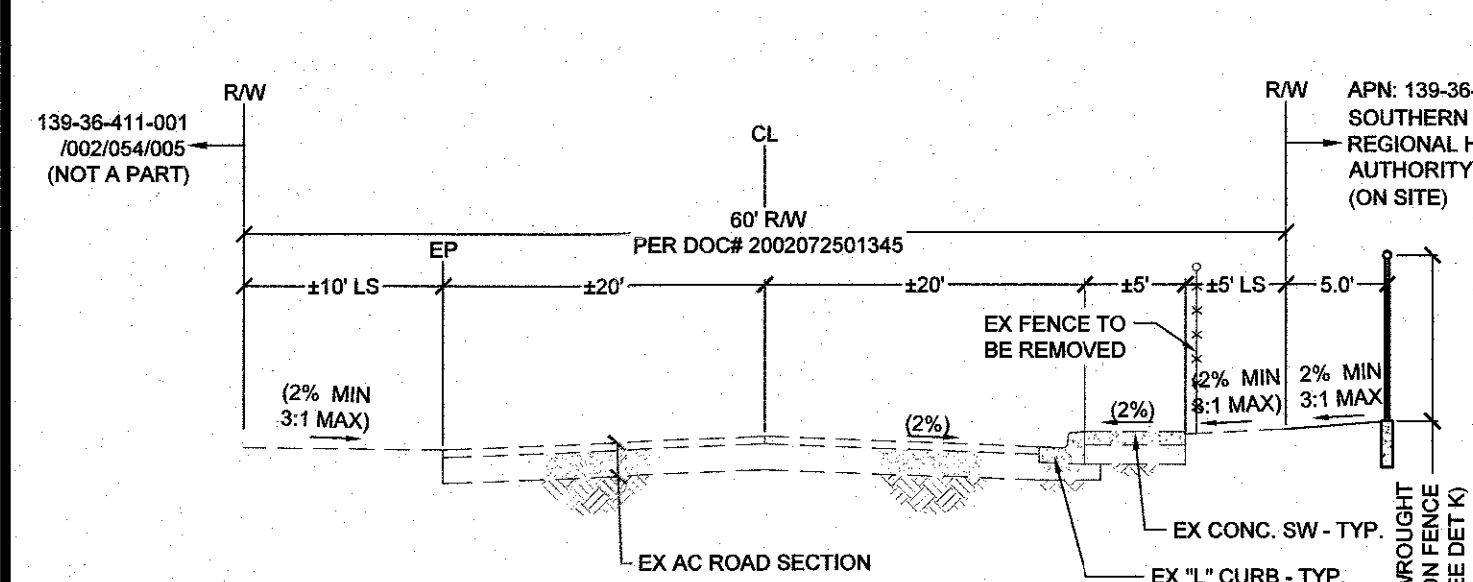

**C SUNRISE AVENUE WEST SIDE**  
NTS

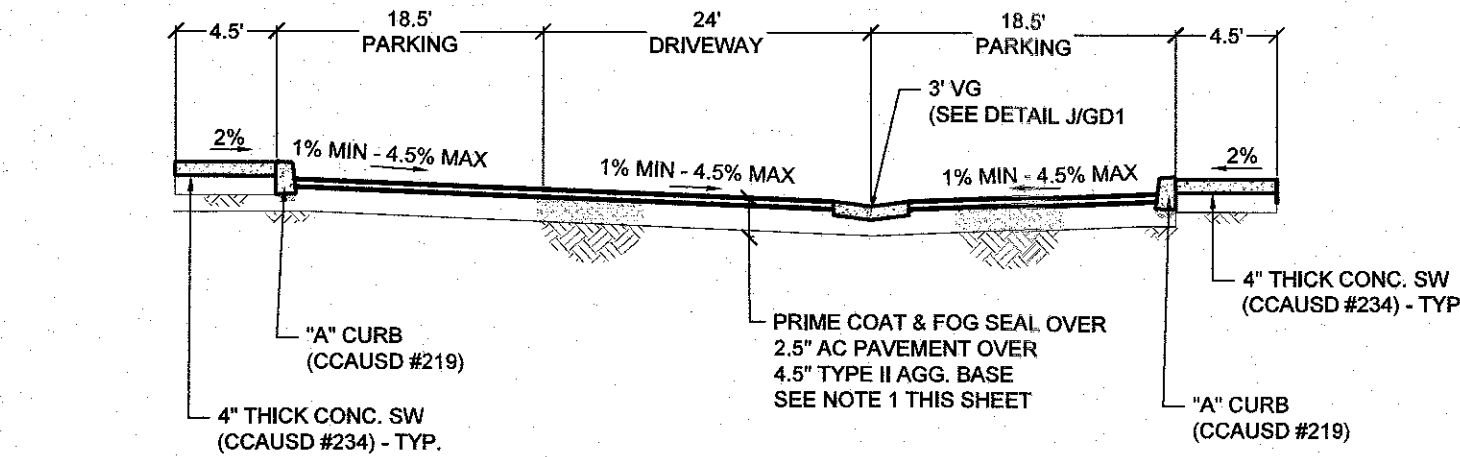

**D SOUTH AND EAST PARKING**  
SOUTH AND EAST PORTION  
NTS

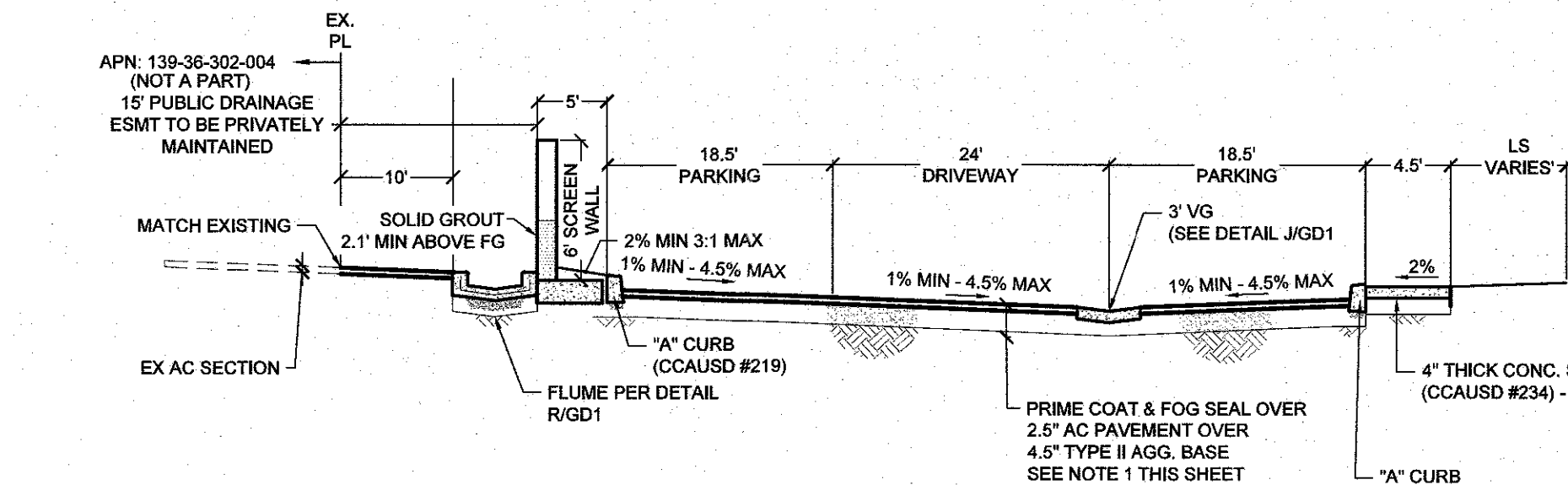

**E WEST PARKING**  
NTS

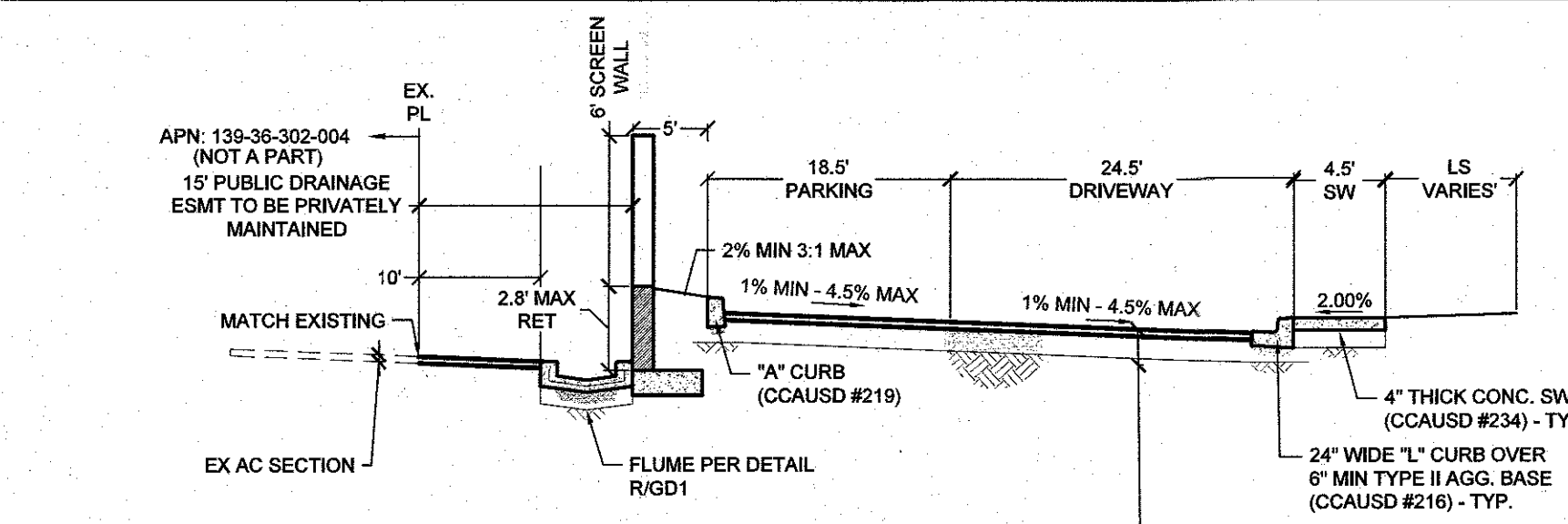

**F WEST ENTRANCE**  
NTS

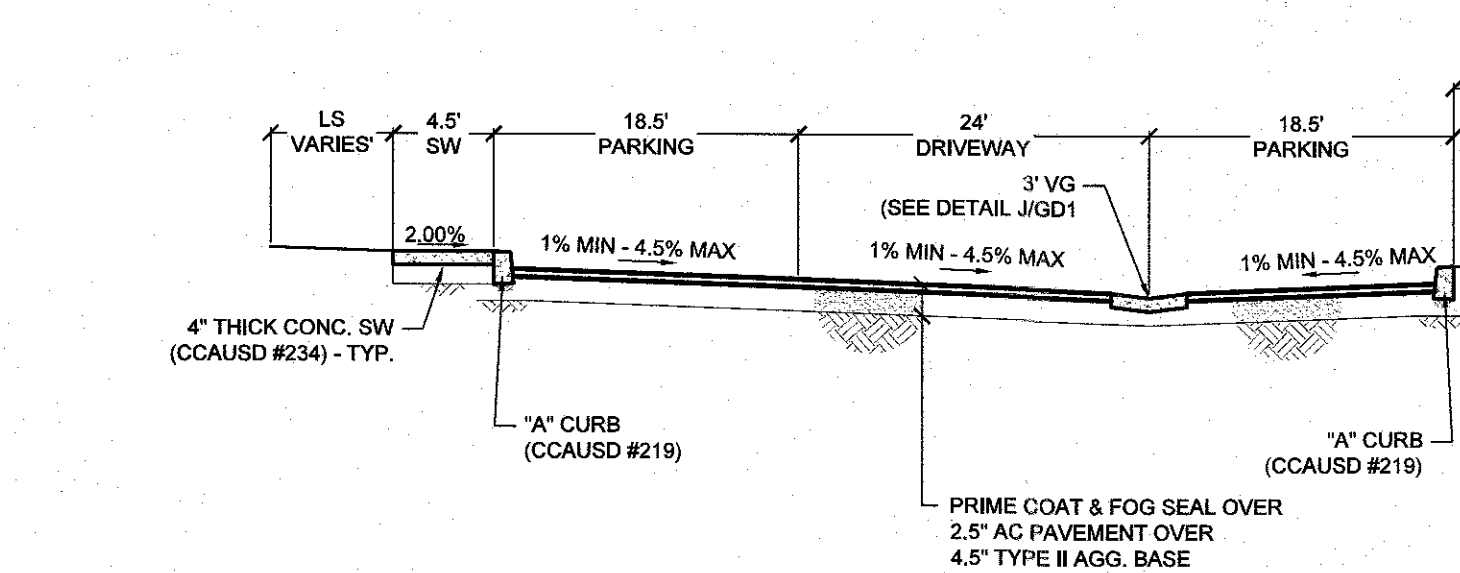

**G NORTH-EAST PARKING**  
NTS

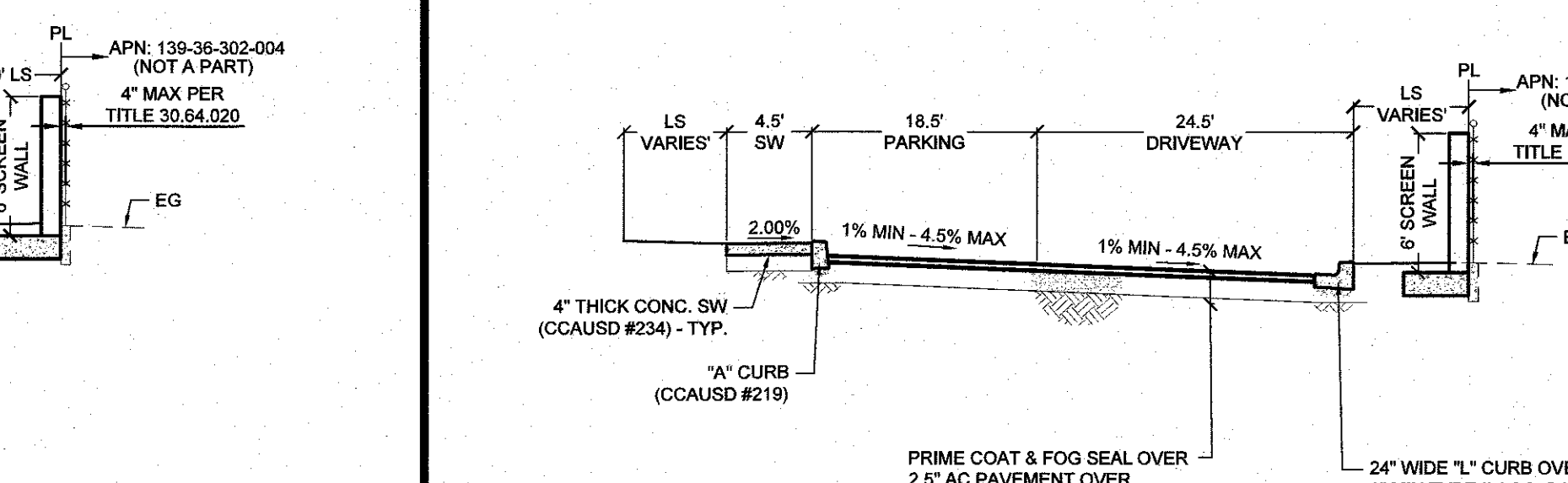

**H NORTH PARKING**  
NTS

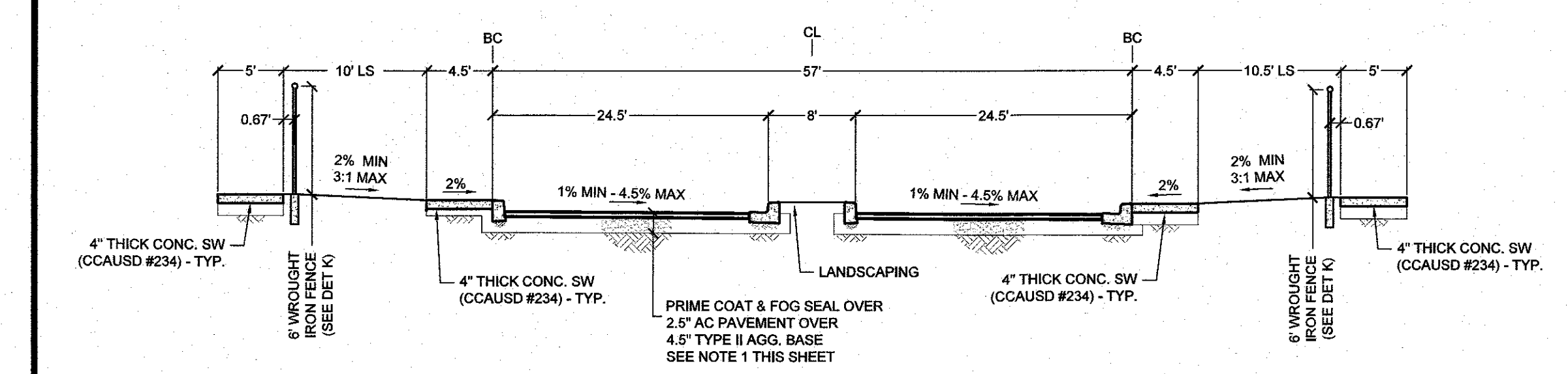

**I MAIN ENTRANCE SOUTH**  
NTS

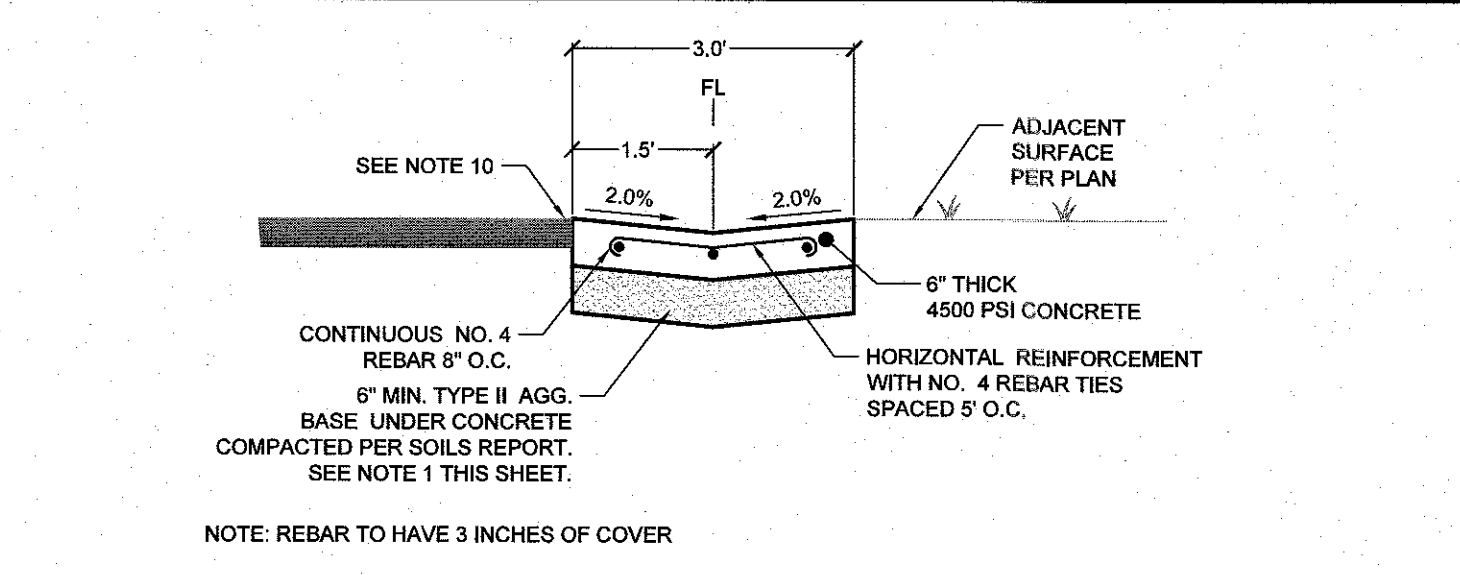

**J 3' VALLEY GUTTER SOUTH**  
NTS

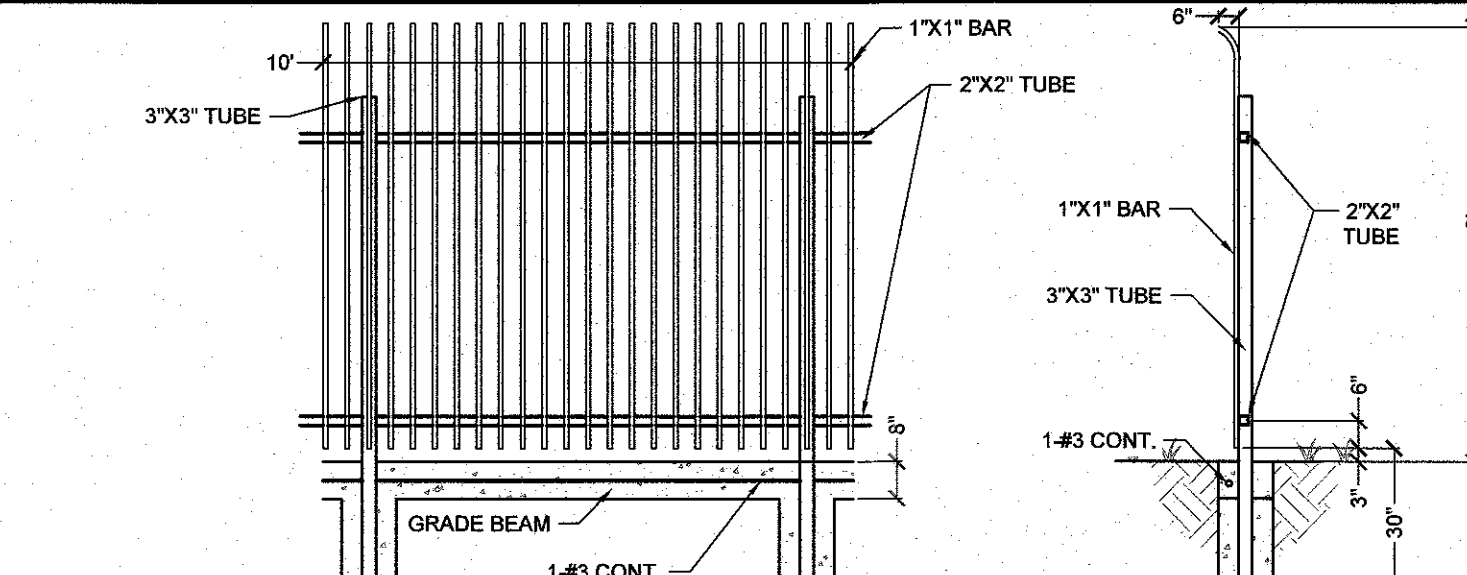

**K 10' WROUGHT IRON FENCE**  
DETAIL  
NTS

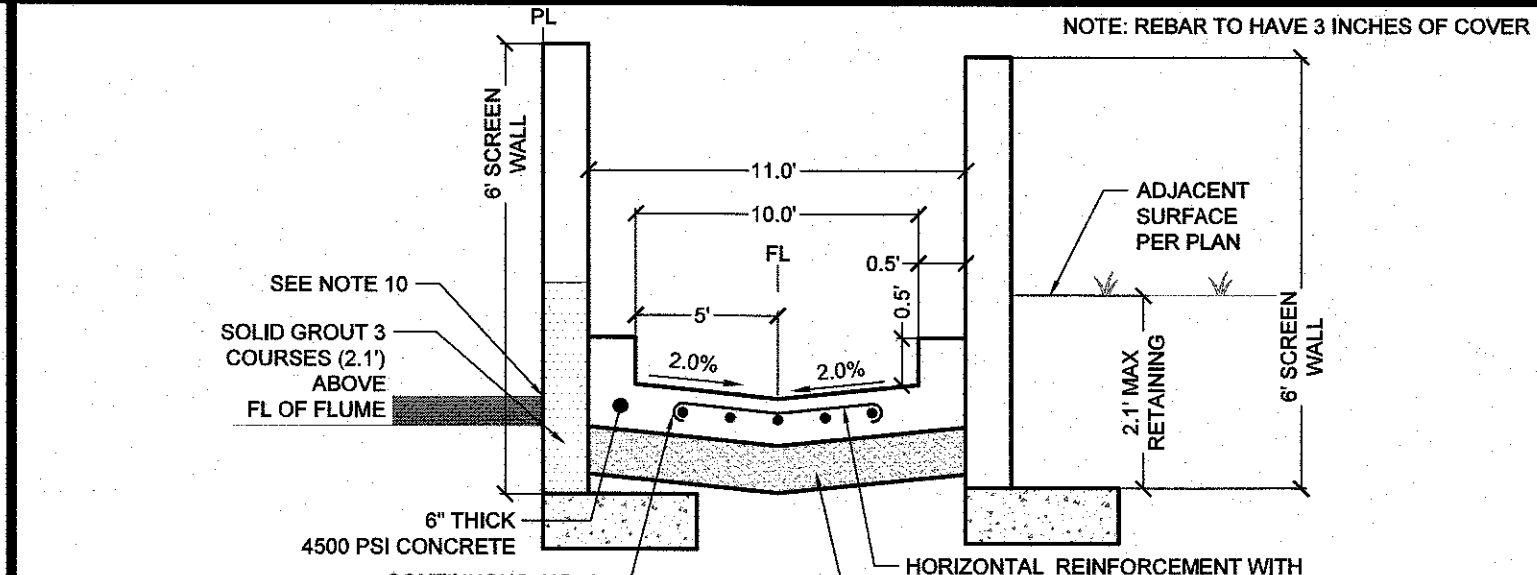

**L 11FT CONCRETE FLUME W/ FLOWLINE**  
NTS

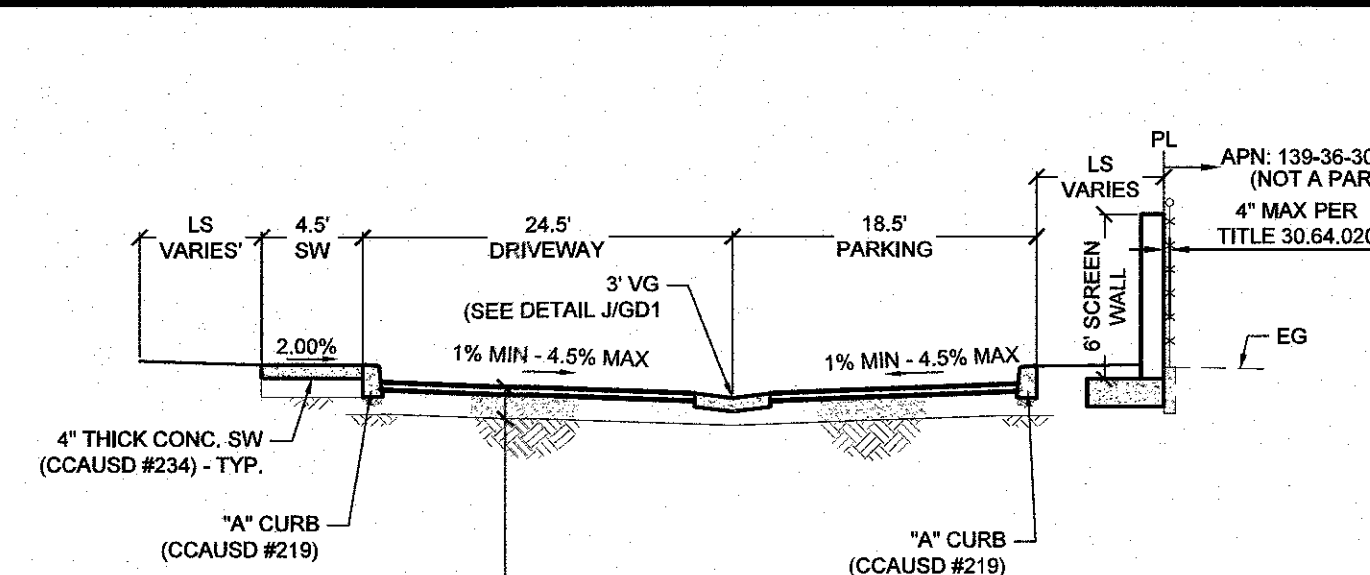

**M NORTH-WEST PARKING**  
NTS

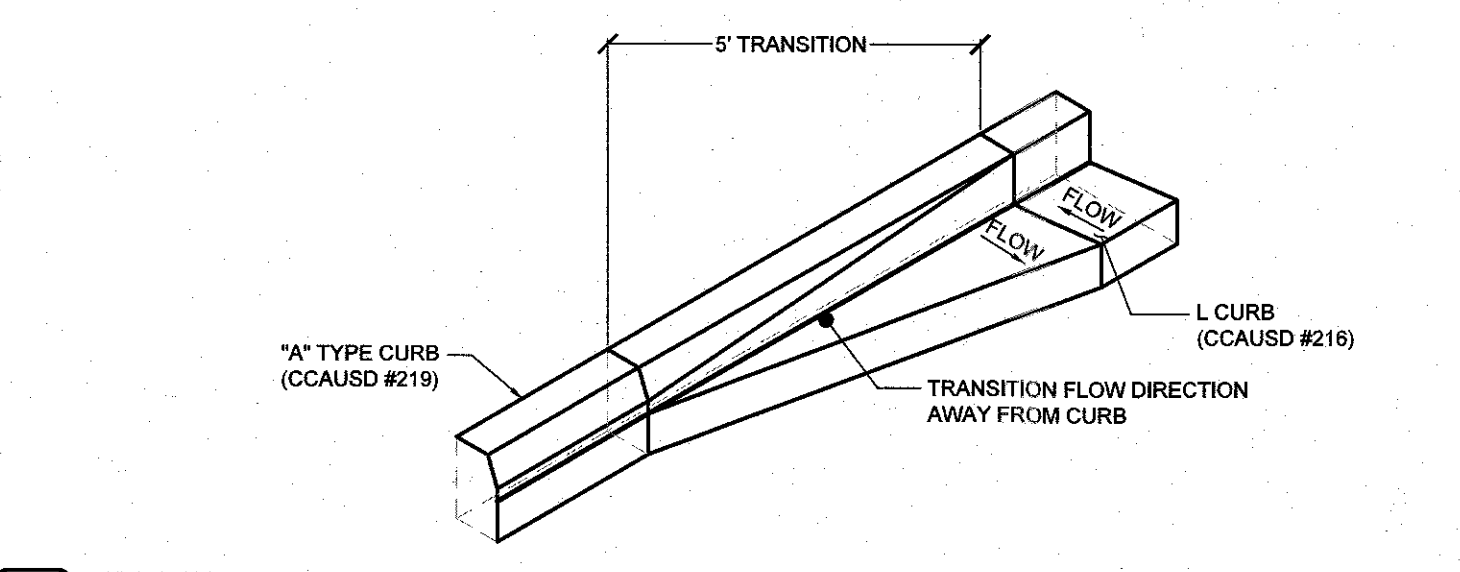

**N L TYPE TO A TYPE CURB TRANSITION**  
NTS

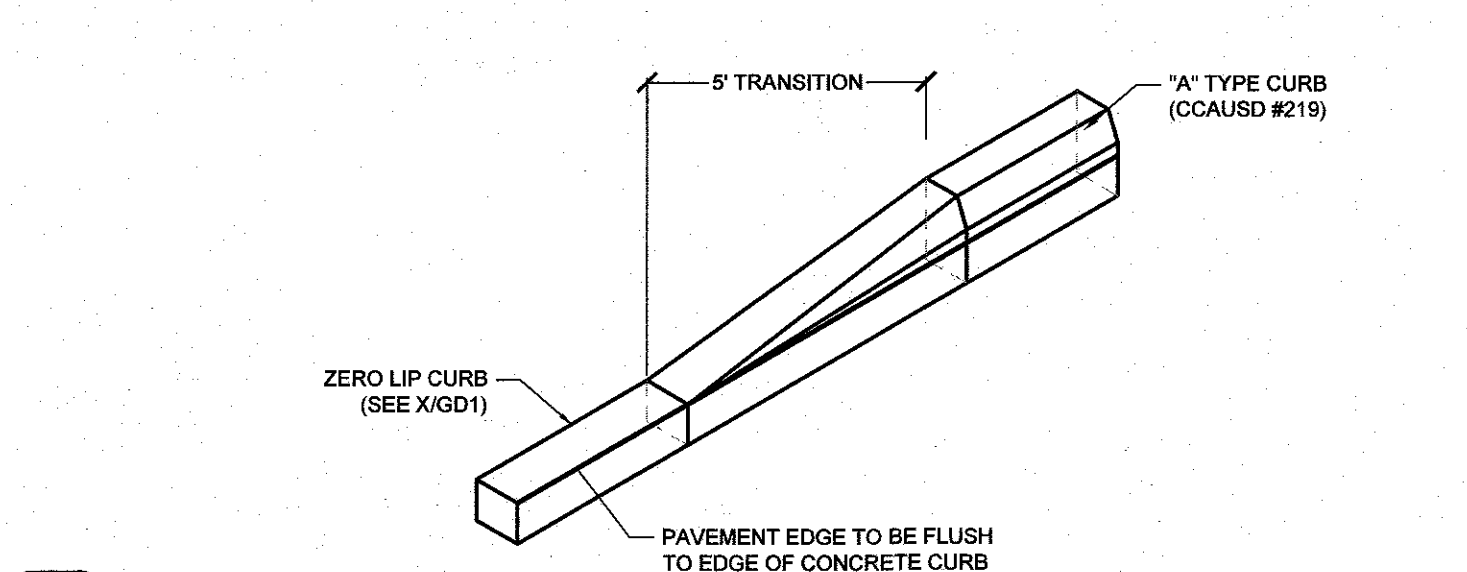

**O A TO ZERO LIP CURB TRANSITION**  
NTS

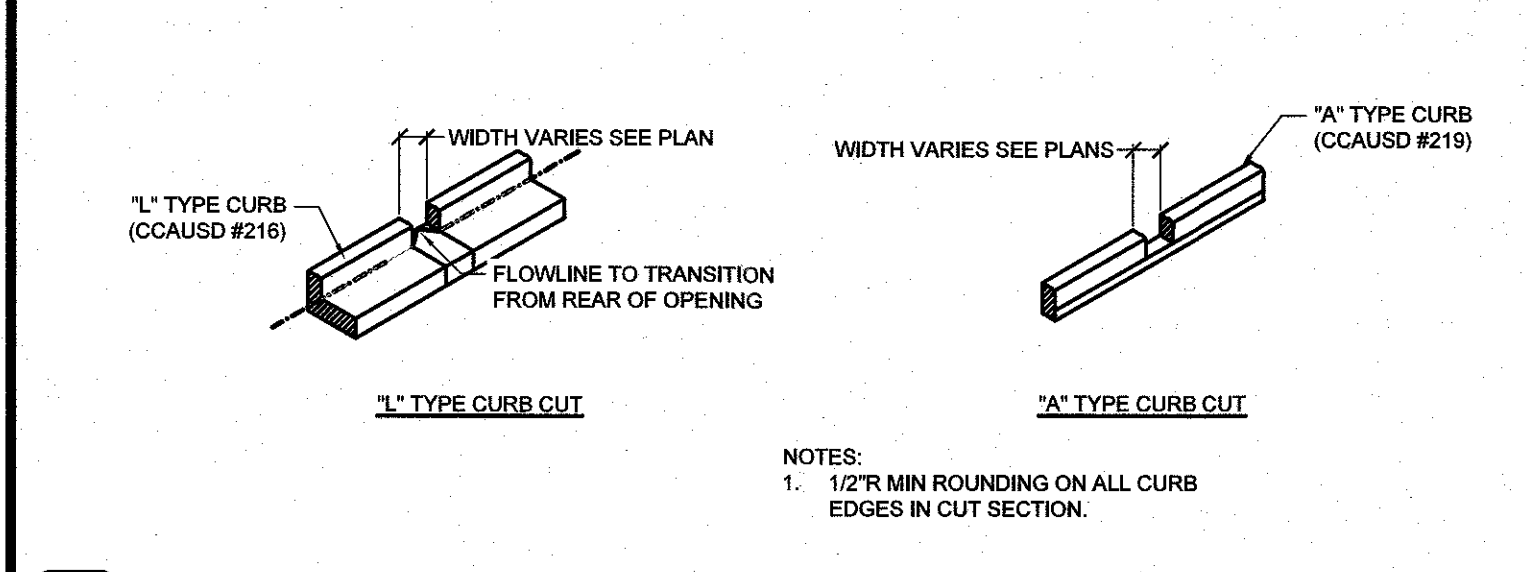

**P CURB CUT**  
CURB TYPE PER PLAN  
NTS

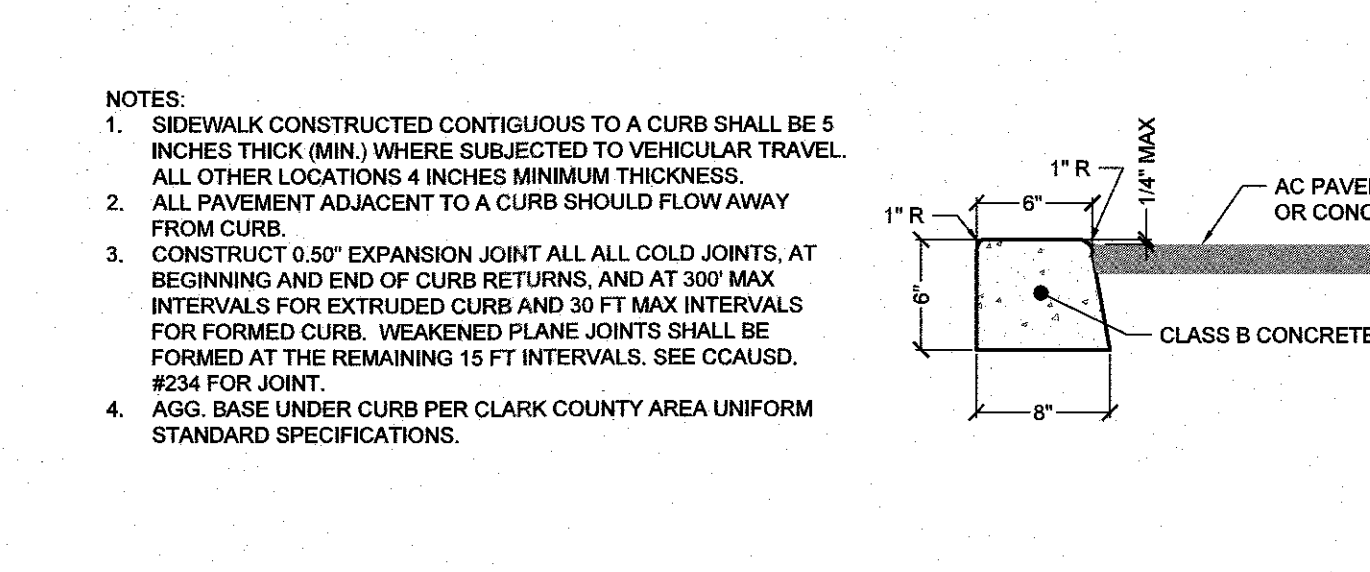

**Q 6\"/>**

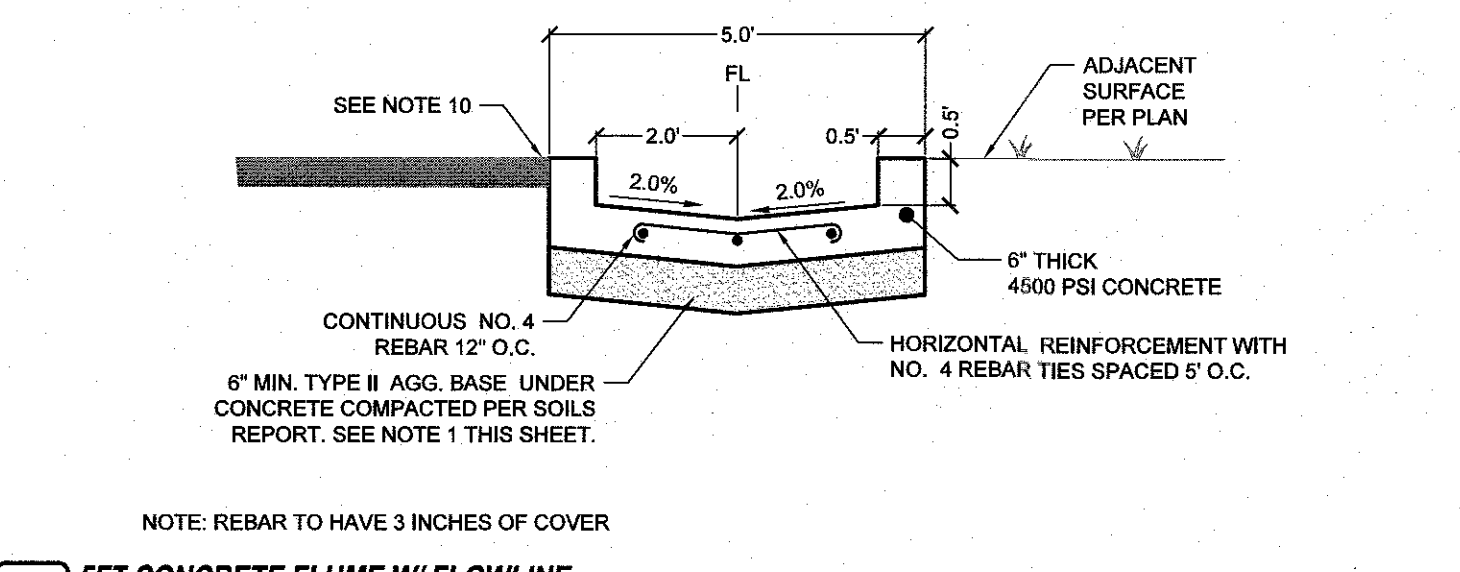

**R 5FT CONCRETE FLUME W/ FLOWLINE**  
NTS

LAST PLOT: P:\DWG\BANKS\5\ACT\MICHAELS\DEVELOPMENT\MCH-24-001 - SUNRISE & 28TH\ENG3\PS3 SHEET DWG\MCH001\_SHT\_CD.DWG

NO.	DESCRIPTION	BY	SHTS.	APPR.	DATE

MICHAELS DEVELOPMENT

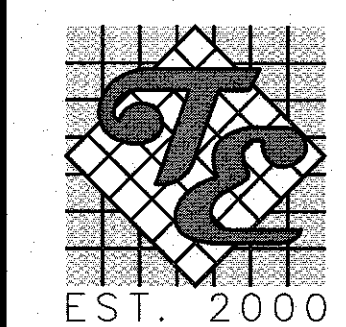

**TANEY ENGINEERING & LAND SURVEYING**  
6030 S. JONES BLVD  
LAS VEGAS, NV 89118  
(702) 362-8844  
INFO@TANEYCORP.COM

SUNRISE & 28TH  
MULTIFAMILY RESIDENTIAL PROJECT  
GRADING DETAILS 1

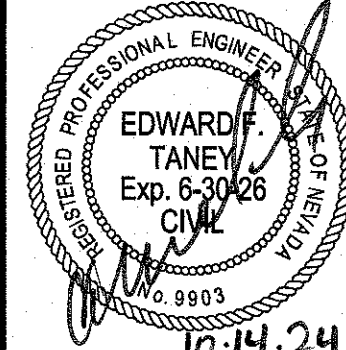

DATE:	10/14/2024
SCALE:	NTS
JOB NO.:	MCH-24-001
DESIGNED BY:	JN   CHECKED BY: BM
SHEET NAME:	<b>GD1</b>
SHEET NUMBER:	<b>06 OF 18</b>
CLV DWG#:	000-000
CLV:	000-00000

Avoid overhead power line contact. It's costly.  
**Call before you Overhead**  
1-702-227-2929

Call before you Dig  
Avoid cutting underground utility lines. It's costly.  
**CALL 811**  
OR 1-800-642-2444

