

Prorated Sub Basin Summary					
ONSITE DEVELOPED FLOW REFERENCED FROM TDS FOR POLICE PARK (DS5673)					
Basin ID	Area (acres)	Q <sub>10</sub> (cfs)	Q <sub>100</sub> (cfs)	10 -yr Unit Flow (cfs/acre)	100 -yr Unit Flow (cfs/acre)
DON1	8.03	6	18	0.75	2.20
Subbasin ID	Area (acres)	Q <sub>10</sub> (cfs)		Q <sub>100</sub> (cfs)	
DON1A	2.94	2		6	
DON1B	2.98	2		7	
DON1C	2.11	2		5	

CONCENTRATION POINT NOTES -

DCP1 = DON1A + DON1C  
 DCP2 = DON1B

REFERENCED STUDY NOTES

\*REFERENCED FROM UPDATE TO THE TDS FOR POLICE PARK (DS5673)

Developed Condition Concentration Points				
Data Point	Description	Q <sub>10</sub> (cfs)	Q <sub>100</sub> (cfs)	
REF1	Referenced flow from CLV POLICE PARK (DS 5673)	22	42	
REF2	Referenced flow from CLV POLICE PARK (DS 5673)	34	66	
DCP1	DON1A + DON1C	4	11	
DCP2	DON1B	2	7	
DCP3	Developed Condition of existing condition concentration point ECP3	0	0	
DCP4	Flow from DCP1	4	11	

Developed Condition						
Cross Section	Description	Q (cfs)	Slope (%)	Depth (ft)	Velocity (ft/s)	DxV
SECTION A - 100 YR	DCP1	11.00	0.40	0.41	2.30	0.94
SECTION B - 100 YR	DON1A	6.00	2.00	0.29	2.94	0.85
SECTION C - 100 YR	DON1B	7.00	3.73	0.28	3.89	1.09
SECTION D - 100 YR	DON1B	7.00	3.01	0.23	6.68	1.54
SECTION E - 100 YR	DON1A + 1/2 DON1C	8.50	4.75	0.29	4.45	1.29
SECTION F - 100 YR	DCP1	11.00	4.75	0.20	5.41	1.08

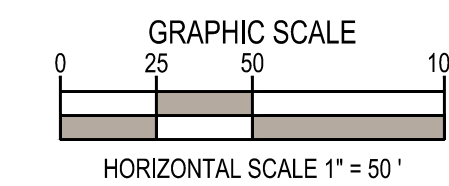

LEGEND

- BASIN D1
- 1 ACRE
- Q(10) = 10 CFS
- Q(100) = 100 CFS
- Hydraulic Section
- Flow Direction
- Basin Boundary
- Soil Boundary

FIGURE 9  
 DRAINAGE BASINS  
 DEVELOPED CONDITIONS

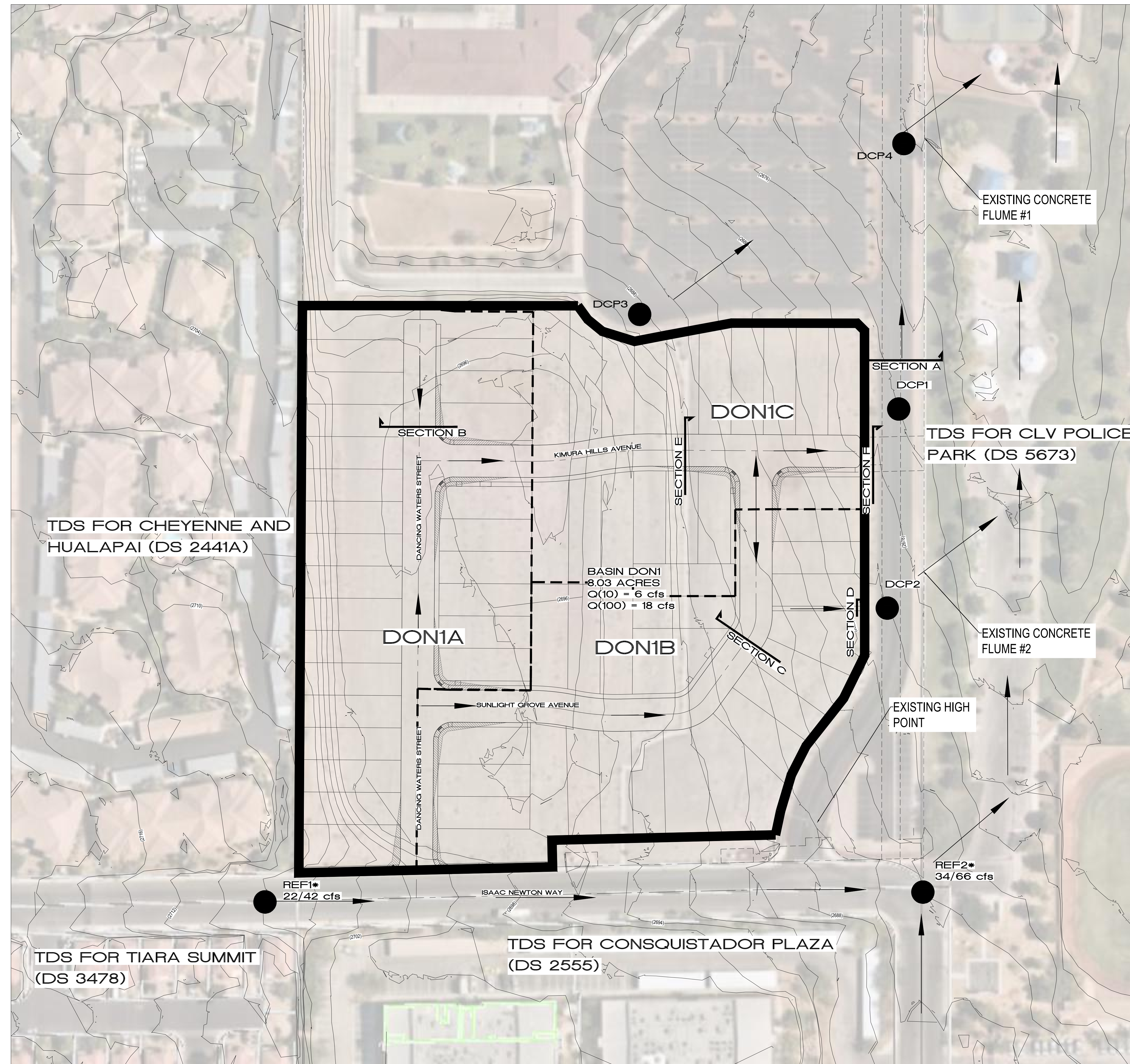

TDS FOR CHEYENNE AND HUALAPAI (DS 2441A)

TDS FOR TIARA SUMMIT (DS 3478)

TDS FOR CONSQUISTADOR PLAZA (DS 2555)

BASIN DON1  
 8.03 ACRES  
 Q(10) = 6 cfs  
 Q(100) = 18 cfs

REF2\*  
 34/66 cfs

REF1\*  
 22/42 cfs

EXISTING CONCRETE FLUME #1

TDS FOR CLV POLICE PARK (DS 5673)

EXISTING CONCRETE FLUME #2

EXISTING HIGH POINT