

CONCENTRATION POINT NOTES -

ECP1 = EXON1 (FLOWS TO THE EXISTING FLUME)

ECP2 = EXON2B

ECP3 = EXON2A

ECP4 = ECP2 + ECP3 (OVERTOPS IN METRO PARK THROUGH THE ADJACENT DRIVEWAY)

REFERENCED STUDY NOTES -

*REFERENCED FROM UPDATE TO THE TDS FOR POLICE PARK (DS5673)

Existing Basin Condition			
Drainage Basin	Area (acres)	Q ₁₀ (cfs)	Q ₁₀₀ (cfs)
EXON1	3.64	4	9
EXON2	4.39	5	11

Existing Condition Concentration Points			
Data Point	Description	Q ₁₀ (cfs)	Q ₁₀₀ (cfs)
REF1	Referenced flow from CLV POLICE PARK (DS 5673)	22	42
REF2	Referenced flow from CLV POLICE PARK (DS 5673)	34	66
ECP1	EXON1	4	9
ECP2	EXON2B	2.25	4.95
ECP3	EXON2A	2.75	6.05
ECP4	EXON2	5	11

Existing Condition						
Cross Section	Description	Q (cfs)	Slope (%)	Depth (ft)	Velocity (ft/s)	DxV
SECTION A - 10 YR	ECP2	5	0.4	0.31	1.89	0.59
SECTION A - 100 YR	ECP2	11	0.4	0.43	2.31	0.99

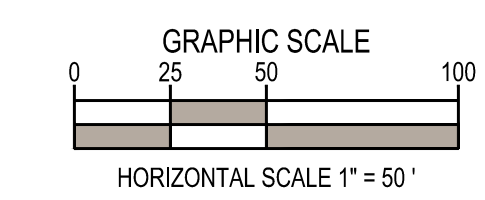

LEGEND

- BASIN D1
- 1 ACRE
- Q(10) = 10 CFS
- Q(100) = 100 CFS
- HYDRAULIC SECTION
- FLOW DIRECTION
- BASIN BOUNDARY

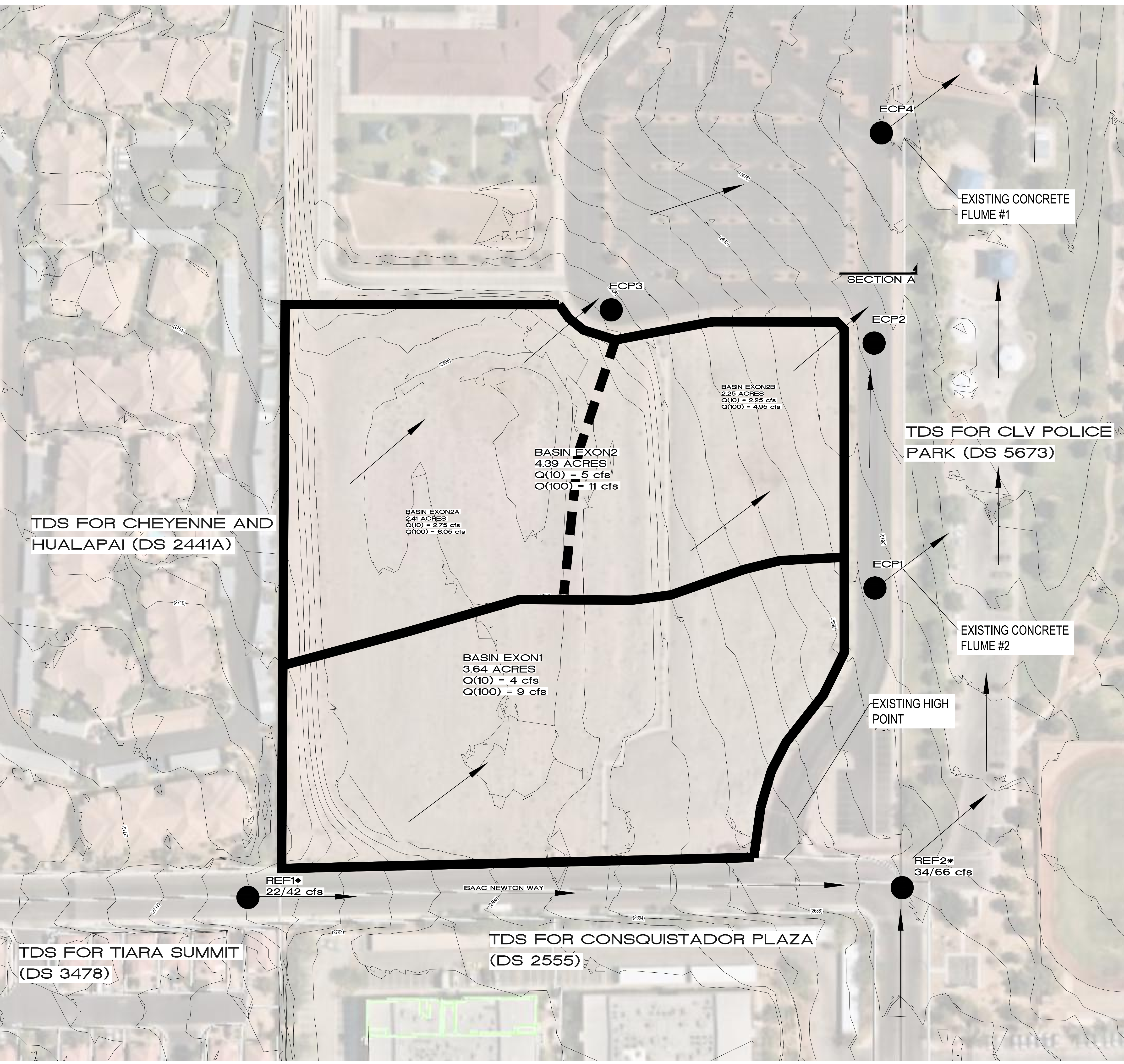

FIGURE 8
 DRAINAGE BASINS
 EXISTING CONDITIONS