

DS# 2/28

DS INDEX 5747

APN 13507301004

PROJECT Shiloh Christian School

SUMITTAL 3rd



CITY OF LAS VEGAS		DATE:	
INTER-OFFICE MEMORANDUM		December 18, 1997	
TO: Barry Thompson, P.E. Land Development Services Department of Public Works		FROM: Dennis W. Stransky, P.E. Flood Control Project Manager Department of Public Works	
SUBJECT: Drainage Study for: Shiloh Christian School		COPIES TO: Alpha Engineering West Charleston Baptist Church John McNellis, P.E. CCRFCFCD Willdan Associates	
FILE NO. \\KHAN\flood\Depot\DSMEMOS\DS2128C.doc			
FEMA Flood Zone	YES	No	X
Proposed Storm Drain	YES	X	No

HISTORY	DATE RECEIVED	DATE REVIEWED	COMMENTS	REVIEW FEES
1 st Submittal	9/22/97	10/08/97	Not Accepted	\$250.00
2 nd submittal	10/17/97	10/27/97	Not Accepted	\$250.00
3 rd submittal	12/04/97	12/17/97	See Comments Below	\$250.00
TOTAL FEES				\$500.00

REMARKS:

3rd Submittal Addendum

The Drainage Study for the subject project has been reviewed and:

	is acceptable in concept subject to conformance to all City standards and the following conditions.
X	must be resubmitted or supplemented including the following:
	must have Clark County Regional Flood Control District concurrence

NOTE: The site is adjacent to or crosses an existing or proposed Clark County Regional Flood Control District (CCRFCFCD) master planned facility. Therefore, CCRFCFCD concurrence is required prior to final acceptance of the drainage study.

- This study will not be accepted until the Master Plan for the Lone Mountain Development is accepted, the LLC is formed, and the cost of proposed Gilmore channel is completely bonded as will be set forth by the Master Plan for the Lone Mountain Development area.
- A typical cross section for Atwood Avenue and future top of curb elevations on the south side must be shown on the grading plan. The extension of Atwood Avenue must also be addressed in the study and grading plans must be provided.

Note: the following comments are retained from the previous memo:

- This project benefits from the Gilmore Channel System. Developments in this area will be required to make a contribution of \$7,800 per acre towards the construction of the Gilmore Channel prior to recordation of the Final Map. The contribution for this project will be 30 acres x \$7,800 = \$234,000.*
- The temporary drainage facility through the ball field area must be granted as a temporary public drainage easement to be privately maintained. The documents for this easement must be prepared and will be held by the right-of-way Section for a period of three years. If the permanent facilities controlling the drainage through the site have not been completed in that time period, the documents granting the easement will be recorded.*

5. *A copy of a notarized letter from the adjacent property owners granting permission for the off-site grading shown on the grading plans will be required for all off-site grading, filling, and rip-rap placement prior to receiving a grading permit.*

END OF REMARKS

gam

T/R/S: 20 S/ 60 E/ 7

AREA L07

Facsimile Transmission
**DEPARTMENT OF
 Public Works**



To: EDWARD TANEY
 Of: ALPHA ENGINEERING
 Fax Number 702/877-0300 • Phone Number 702/877-1300
 From: FLOOD CONTROL

	FAX	PHONE
Administration _____	382-0848	229-6276
<input type="checkbox"/> City Engineer Division _____	382-3232	229-6272
<input type="checkbox"/> Architectural Services _____	382-3232	229-6535
<input type="checkbox"/> Construction Services _____	254-4541	229-6337
<input type="checkbox"/> Engineering Design _____	382-3232	229-6272
<input type="checkbox"/> Land Development _____	383-9767	229-6371
<input type="checkbox"/> Special Improvement Districts _____	366-0032	229-2136
<input type="checkbox"/> Pavement Management _____	366-0032	229-2453
<input type="checkbox"/> Survey _____	386-5737	229-6217
<input type="checkbox"/> Traffic/Electrical Field Operations _____	382-0366	229-6331
<input checked="" type="checkbox"/> Engineering Planning _____	382-8551	229-6541
<input type="checkbox"/> Right of Way _____	382-8551	229-6483
<input type="checkbox"/> Streets and Sanitation _____	256-7817	229-6227
<input type="checkbox"/> Traffic Engineering _____	366-0032	229-6327
<input type="checkbox"/> LVACTS _____	229-6613	229-6611
<input type="checkbox"/> Environmental _____	641-9738	229-6200
<input type="checkbox"/> Water Pollution Control Facility _____	641-9738	229-6200
<input type="checkbox"/> Industrial Waste Pretreatment _____	641-9738	229-6200

(Area Code: 702)

Date: 12/19/97 Time 12:20 PM
 Page 1 of 3

Message: _____

City of Las Vegas - 400 E. Stewart Avenue, Las Vegas, NV 89101

TRANSMISSION REPORT

THIS DOCUMENT (REDUCED SAMPLE ABOVE)
 WAS SENT

**** COUNT ****
3

*** SEND ***

NO	REMOTE STATION I. D.	START TIME	DURATION	#PAGES	COMMENT
1	702 877 0300	12-19-97 13:01	2'20"	3	

TOTAL 0:02'20" 3

XEROX TELECOPIER 7021

Facsimile Transmission

DEPARTMENT of Public Works



To: EDWARD TANEY
Of: ALPHA ENGINEERING

Fax Number 702/877-0300 • Phone Number 702/877-1300

From: FLOOD CONTROL

	<u>FAX</u>	<u>PHONE</u>
Administration _____	382-0848	229-6276
<input type="checkbox"/> City Engineer Division _____	382-3232	229-6272
<input type="checkbox"/> Architectural Services _____	382-3232	229-6535
<input type="checkbox"/> Construction Services _____	254-4541	229-6337
<input type="checkbox"/> Engineering Design _____	382-3232	229-6272
<input type="checkbox"/> Land Development _____	383-9767	229-6371
<input type="checkbox"/> Special Improvement Districts _____	366-0032	229-2136
<input type="checkbox"/> Pavement Management _____	366-0032	229-2453
<input type="checkbox"/> Survey _____	386-5737	229-6217
<input type="checkbox"/> Traffic/Electrical Field Operations _____	382-0366	229-6331
<input checked="" type="checkbox"/> Engineering Planning _____	382-8551	229-6541
<input type="checkbox"/> Right of Way _____	382-8551	229-6483
<input type="checkbox"/> Streets and Sanitation _____	256-7817	229-6227
<input type="checkbox"/> Traffic Engineering _____	366-0032	229-6327
<input type="checkbox"/> LVACTS _____	229-6613	229-6611
<input type="checkbox"/> Environmental _____	641-9738	229-6200
<input type="checkbox"/> Water Pollution Control Facility _____	641-9738	229-6200
<input type="checkbox"/> Industrial Waste Pretreatment _____	641-9738	229-6200

(Area Code: 702)

Date: 12/19/97 Time 12:20 PM

Page 1 of 3

Message: _____

ALPHA ENGINEERING

Tel: (702) 877-1300
50 South Jones, Suite 202
Las Vegas, NV 89107
Fax: (702) 877-0300

Tel: (801) 628-6500
148 East Tabernacle
St. George, UT 84770
Fax: (801) 628-6553

LETTER OF TRANSMITTAL

DATE:	December 4, 1997
JOB NAME:	Shiloh Christian School
JOB NUMBER:	7161-01
TO:	City of Las Vegas Planning & Community Development
ATTENTION:	Dennis Stransky
ITEMS:	Addenda #2 Technical Drainage Study; 2 Sets of Grading Plans
COMMENTS:	For your review & comment, please.
FROM:	James Aquino

RECEIVED BY: Frederic Junior

tp

SHOW COMMENTS
to RLF.

Drainage Study
Can't be approved
prior to acceptance
of the LMPD
Master Plan.

***α* ALPHA ENGINEERING COMPANY**

2128
L07
#250

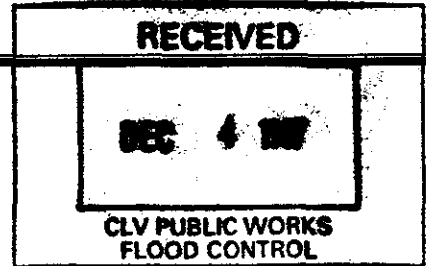

ADDENDA #2 TECHNICAL DRAINAGE STUDY FOR SHILOH CHRISTIAN SCHOOL CITY OF LAS VEGAS, NEVADA

**PREPARED FOR:
WEST CHARLESTON BAPTIST CHURCH
6701 WEST CHARLESTON BOULEVARD
LAS VEGAS, NEVADA 89102**

December 4, 1997

**PREPARED BY:
ALPHA ENGINEERING COMPANY
50 S. JONES BOULEVARD, SUITE 202
LAS VEGAS, NEVADA 89107**

**TELEPHONE (702) 877-1300
FAX (702) 877-0300**

MUNICIPAL

COMMERCIAL

RESIDENTIAL

**ADDENDA #2
TECHNICAL DRAINAGE STUDY
FOR
SHILOH CHRISTIAN SCHOOL**

Job No. 7161-01
December 4, 1997

Prepared for:

WEST CHARLESTON BAPTIST CHURCH
6701 West Charleston Boulevard
Las Vegas, Nevada 89102

Prepared by:

Alpha Engineering Company
50 South Jones, Suite 202
Las Vegas, Nevada 89107

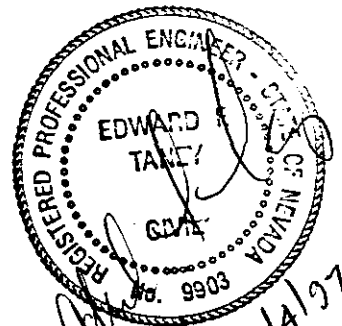

December 4, 1997
Job No. 7161-01

Mr. Dennis Stransky, P.E.
Planning & Community Land Development
400 East Stewart
Las Vegas, Nevada 89101

**SUBJECT: ADDENDA #2 TO THE TECHNICAL DRAINAGE STUDY FOR SHILOH
CHRISTIAN SCHOOL**

Dear Mr. Stransky:

Alpha Engineering Co. is pleased to submit one copy of the Addendum and two sets of the Grading Plan to the above referenced drainage study for your approval. The project site is located within a portion of North Half (N ½) of the Southwest Quarter (SW ¼) of Section 7, Township 20 South, Range 60 East, in the City of Las Vegas, Clark County, Nevada.

The Addendum is in response to the review memorandum from the City of Las Vegas dated October 30, 1997.

Comment 1: Developments within this area will increase the runoff into the Lone Mountain Detention Basin and must excavate 200 cubic yard per acre from the basin to accommodate this additional storage volume requirement. The owner may choose to contract to excavate the material from the basin or choose to make a contribution of \$2,700 per acre to have the material removed by the City in the future. Diamond Construction is currently excavating material from the basin and could provide a letter certifying that they will remove 6,000 cy (30 acres x 200 cy), from the basin. If a certification letter is not provided, a contribution of \$2,700 per acre must be made prior to the recordation of the Final Map. **NOTE: A proposal was included in the Addendum but it was not signed by Diamond Construction. The agreement must be finalized to be accepted.**

Response 1: The proposal provided by Diamond Construction Company was obtained and signed by Shiloh Middle School on October 23, 1997. Refer to the Appendix for the signed proposal.

Comment 2: This project benefits from the Gilmore Channel System. Developments in this area will be required to make a contribution of \$7,800 per acre towards the construction of the Gilmore Channel prior to recordation of the Final Map. The contribution for this project will be 30 acres x \$7,800 = \$234,000.

Response 2: Noted. The developer/owner is aware of the contribution to the Gilmore Channel and

shall be bonded per VTN's Master Plan for the Lone Mountain area.

Comment 3: The temporary drainage facility through the ball field area must be granted as a temporary public drainage easement to be privately maintained. The documents for this easement must be prepared and will be held by the Right-Of-Way Section for a period of three years. If the permanent facilities controlling the drainage through the site have not been completed in that time period, the documents granting the easement will be recorded.

Response 3: Per the conversation and request by Carol, Right-of Way Section for the City of Las Vegas, a documents for the temporary public drainage easement has been prepared and faxed to the City for review on November 4, 1997. The original documents have been forwarded to the City. The exhibits provide a legal description and a figure of the temporary public drainage easement. A Professional Land Surveyor (PLS) stamp has been provided on the document.

Comment 4: A copy of a notarized letter from the adjacent property owners granting permission for the off-site grading shown on the grading plans will be required for all off-site grading, filling, and rip-rap placement prior to receiving a grading permit.

Response 4: Per the phone conversation with FOCUS, dated November 19, 1997, a verbal agreement has been obtained. FOCUS has agreed to provide Alpha Engineering a notarized permission letter prior to receiving a grading permit. Alpha Engineering is requesting a conditional approval at this time.

Comment 5: The calculations provided for Section 1 use a flow rate of 8 cfs. Figure 6 shows a flow of 487 cfs at Section 1. A calculation is provided for 2 typical parking lot/driveway sections using 8 cfs and 14 cfs. There is no indication of the location of these calculations and the source of the flows. The calculation for Gowan Road uses a flow rate of 225 cfs. But Figure 6 at CP2 which is at Gowan Road shows 61 cfs. The calculations and figure 6 must be revised to coincide. The onsite and offsite flows must be combined at the concentration points on Figure 6.

Response 5: Hydraulic Section 1 labeled on Figure 6 has been divided into two hydraulic sections for the drainage channel and developed onsite parking lot/driveway section (DEV3). In the original submittal, the hydraulic calculation of 487 cfs is provided in the Appendix and included in this report. Since the DARF and CN values have been revised in the Addendum, Hydraulic Section 1 for the Developed Onsite Condition utilizes 8 cfs generated by DEV3 to determine a flow depth (0.55 ft) on the interior parking lot/driveway.

Per the phone conversation with Dennis Stransky, City of Las Vegas, dated November 3, 1997, CP2 on Figure 6 have been revised with the combined flows from the offsite and onsite for the interim and future conditions. For the interim condition, CP2 generates a flow of 1608 cfs (61 cfs + 1060 cfs + 487 cfs = 1608 cfs) for the 100-year event. In the future condition, CP2 generates a flow of 286 cfs (61 cfs + 225 cfs = 286 cfs) for the 100-year storm. Refer to the Figure 6 for the revised CP2 flow rates.

Comment 6: The grades shown at the northwest corner of the site indicate that the majority of the 487 cfs in the temporary channel will flow east in Gowan Road. An offset (1/4) crown road section must be provided in Gowan in this area. This will allow a portion of the flows to flow east in Gowan Road and the balance of the flow to weir across the centerline and flow northeast into the basin. This design must be coordinated with the Land Development section.

Response 6: Gowan Road has been re-designed with an offset (1/4) crown and shown on the revised Grading Plan. Per City's request, the design for Gowan Road shall be coordinated with Land Development. See revised Grading Plan for the re-design of Gowan Road.

Comment 7: The grading elevations shown on the temporary channel through the ball fields is not correct. The existing elevation contours and the proposed grades shows grade differences as much as 9 feet. The extent of the grading must be shown and the proposed grading must be tie into the existing contours.

Response 7: The intent of the ball fields is to be rough graded to match the elevations of the temporary drainage channel. Grade differences should be approximately 2-ft or lower. The excavated soil from the temporary drainage easement shall be stock piled onto the ball fields, until the future drainage facility (channel) upstream is constructed to Gowan Road.

Comment 8: The Developed On-site Drainage Map must show the off-site flows impacting the site in the interim and future conditions. The off-site flows must be combined with the onsite flows at the concentration points.

Response 8: The Developed Onsite Drainage Map, Figure 6, has been revised. See Response 5 and Appendix for further information.

Additional Response:

The memorandum from Zoning, dated November 20, 1997, requires a dedication of a 60-ft Right-Of-Way (ROW) along the south boundary of the development. Upon this request, the proposed

southerly channel onsite has been removed. The Shiloh Drive (60-ft ROW) is assumed to convey the 51 cfs generated by the 100-year storm.

Flowmaster software has been utilized to obtain a depth of flow for Shiloh Drive. The calculated flow depth is approximately 0.56-ft. The DV Product is 3.1 which is less than 8.0 and meets the requirement set forth by the Clark County Regional Flood Control District (CCRFCDD) Manual. Note that the southerly property line is offset 30-ft eliminating the channel onsite. Refer to the Appendix for the hydraulic calculation for Shiloh Drive. See Grading Plan for further revision. The velocity within the street is less than 5 fps, which means that the erosion is minimal. A sidewalk underdrain shall be constructed at the low point near the southeast corner of the property to convey nuisance flow. In the event of the 100-year storm, the stormwater shall weir over the curb and into its natural path downstream. Rip-rap pad ($D_{50} = 6$ -inches) shall be place at the outlet of the sidewalk underdrain. The rip-rap pad shall minimize erosion that may occur at the outlet.

If you have any questions or comments, please feel free to contact me at 877-1300.

Sincerely,
Alpha Engineering Co.



James M. Aquino, E.I.
Civil Designer

APPENDIX

Diamond Construction Co., Inc.

4100 EAST CHEYENNE AVENUE
LAS VEGAS, NEVADA 89115
(702) 644-1018 Office (702) 644-6541 Fax

Oct 13, 1997

97-101

PROPOSAL

Proposal To:
Shilo Middle School
C/O Clay @ Alpha Engineering
Las Vegas, Nevada

Project Location:
Ln Mountain Detention Basin
Basin Excavation
Alexander / Hualapai

We propose to furnish all supervision, labor, equipment and materials to construct the items listed below for the total price listed below.

Total Job Cost \$5,700.00

Five Thousand Seven Hundred Dollars and Zero Cents

Items

Item Description	Quantity	Units	Unit Price	Extended Price
1 Basin Excavation	6,000	CY	\$0.95	\$5,700.00

Notes & Inclusions

All Quantities are approximate only. Field measurements will be used for billing purposes.
 One Mobilization per operation. Any additional mobilizations will be \$3,000.00 each occurrence.
 Any Increase or Decrease to be at unit Prices. Any Supplier Increases to be passed on at time of installation
 This proposal to become a part of any and all contract documents.
 This Proposal may be withdrawn after ten (10) Days.
 Any invoice with an unpaid balance after 30 days from date of invoice, will accrue a service charge of 1% per month.

Exclusions

Cleanup of Others Construction Water & Fees
 Traffic Control Engineering, Testing, permits, and Fees.
 Catcher or Rock Excavation and removal will be done on a Hourly Rental Basis

Accepted By:

Shilo Middle School

Date:

10/23/97

Submitted By:

Jeff Craig - Estimator

Date:

10/14/97

Exhibit "A" - Description

BEING THE NORTH 300 FEET OF THE SOUTH 400 FEET OF THE NORTHEAST ONE-QUARTER (NE ¼) OF THE NORTHWEST ONE-QUARTER (NW ¼) OF THE SOUTHWEST ONE-QUARTER (SW ¼) OF SECTION 7, TOWNSHIP 20 SOUTH, RANGE 60 EAST, M.D.M., CITY OF LAS VEGAS AND CLARK COUNTY, NEVADA.

SAID EASEMENT CONTAINS 4.60 ACRES, MORE OR LESS.

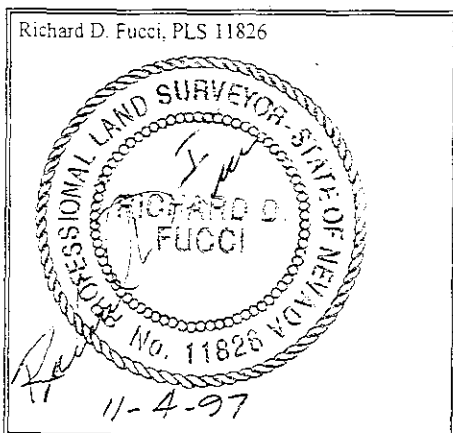

Project: SHILOH CHRISTIAN SCHOOL
Work Order: 715101
Date: November 4, 1997
Assessor's Parcel No.:
Location: GOWAN ROAD / SHILOH DRIVE
Purpose: TEMPORARY DRAINAGE EASEMENT

EXHIBIT "A"

NW CORNER
NE 1/4, NW 1/4, SW 1/4

GOWAN ROAD



300'

400'

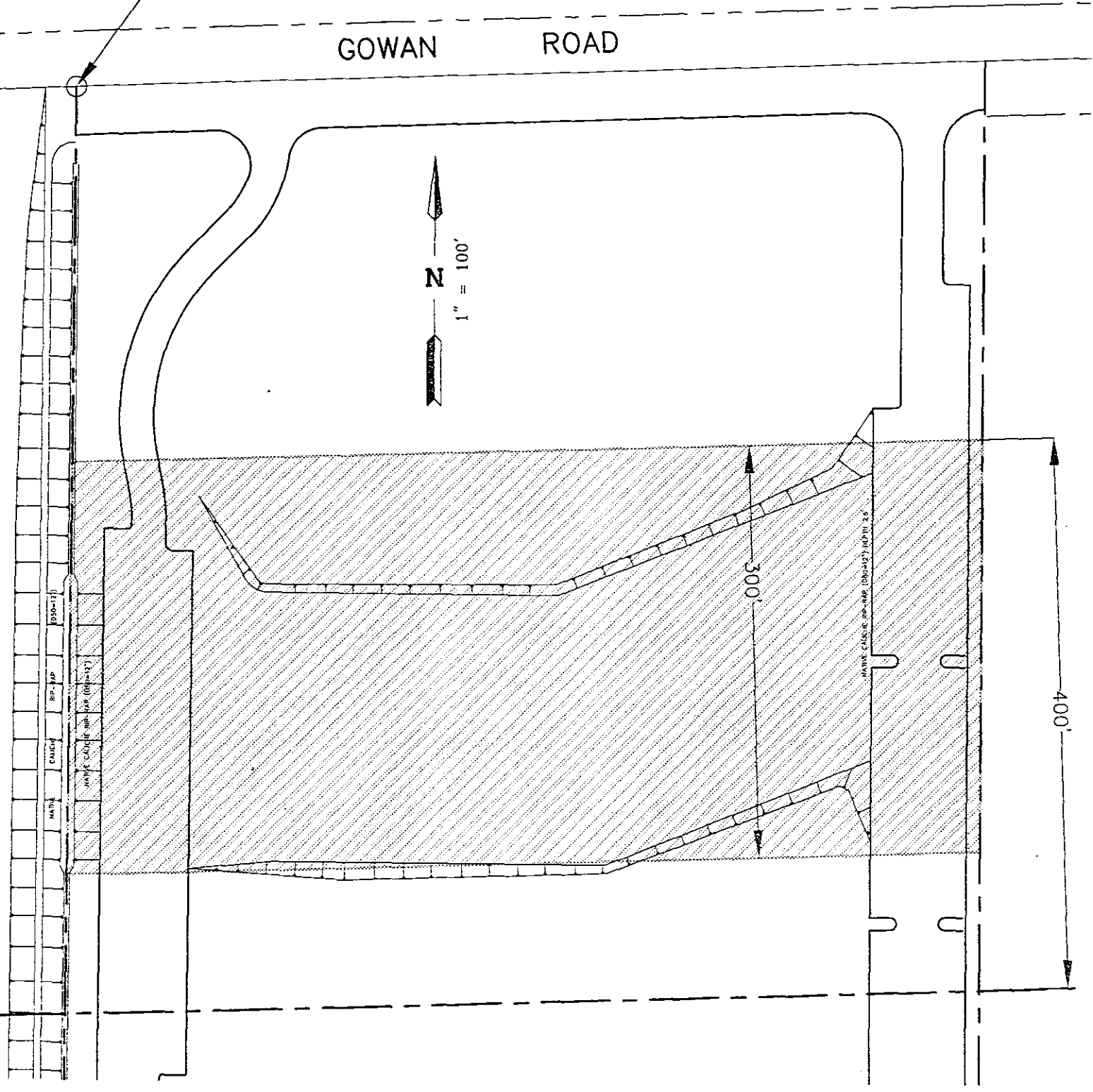

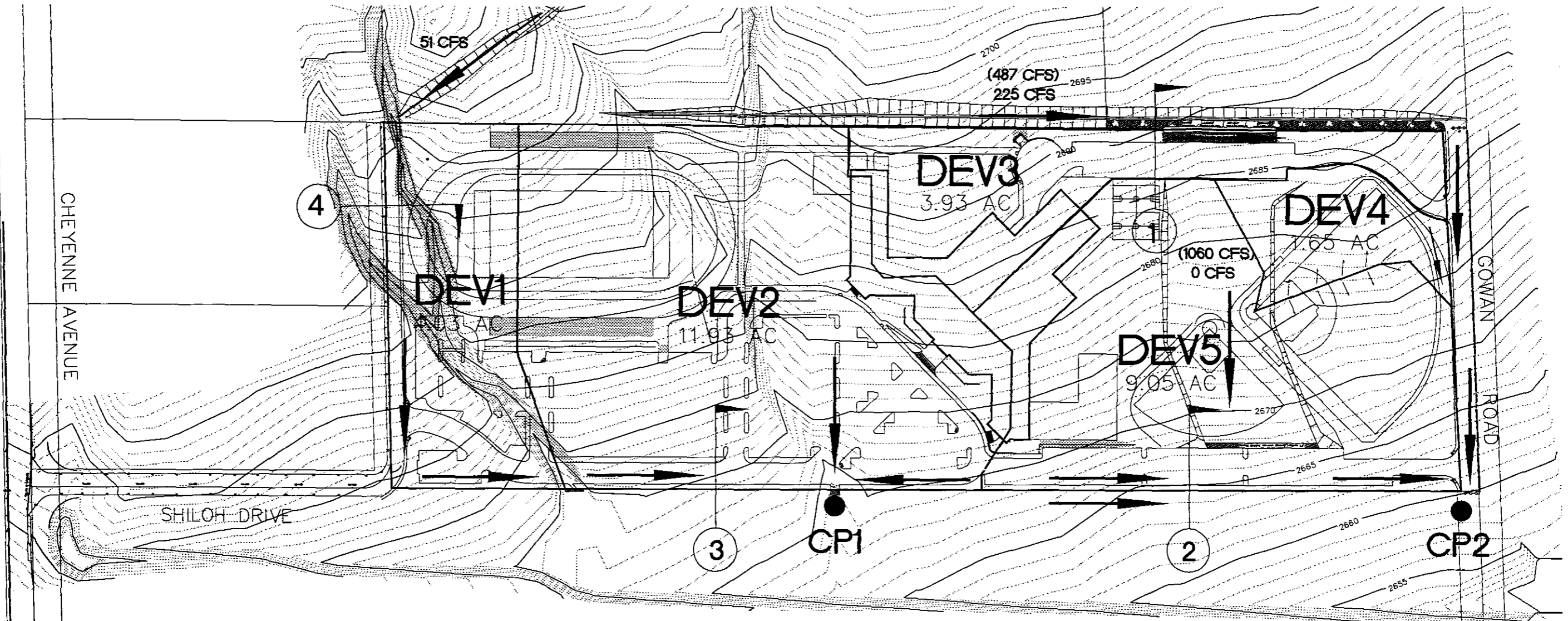

BASIN ID#	10-YEAR CFS	100-YEAR CFS
DEV1	3	9
DEV2	12	29
DEV3	3	8
DEV4	0	2
DEV5	4	14
CP1	15	38
CP2 (INTERIM)	600	1608
CP2 (FUTURE)	94	286

DRAINAGE LEGEND

- BASIN BOUNDARY
- FLOW PATH
- CONCENTRATION POINT(s) (CP1)
- DEV1 BASIN NAME(s)
- 23.07 AC ACREAGE
- (487 CFS) INTERIM CONDITION - 100 YEAR
- 225 CFS FUTURE/ULTIMATE CONDITION - 100 YEAR

HYDRAULIC SECTIONS

① CROSS SECTION AND LOCATION
SEE CALCULATIONS

FIGURE 6
(REVISED)
DEVELOPED ONSITE DRAINAGE MAP

HYDRAULIC ANALYSIS

HYDRAULIC SECTION NO. 1 - DRAINAGE CHNL

Worksheet for Irregular Channel

Project Description

Project File	c:\james\hydrology\shiloh\typ_sect.fm2
Worksheet	WEST CHANNEL - LOW FLOW
Flow Element	Irregular Channel
Method	Manning's Formula
Solve For	Discharge

Input Data

Channel Slope 0.007000 ft/ft

Water Surface Elevation 3.50 ft

Elevation range: 0.00 ft to 5.84 ft.

Station (ft)	Elevation (ft)	Start Station	End Station	Roughness
0.00	5.84	0.00	37.55	0.022
17.55	0.00			
22.55	0.00			
37.55	5.00			

Results

Wtd. Mannings Coefficient :	0.022	
Discharge	486.78	cfs
Flow Area	54.28	ft ²
Wetted Perimeter	27.15	ft
Top Width	26.02	ft
Height	3.50	ft
Critical Depth	3.65	ft
Critical Slope	0.005774	ft/ft
Velocity	8.97	ft/s
Velocity Head	1.25	ft
Specific Energy	4.75	ft
Froude Number	1.09	

Flow is supercritical.

Notes:

D50 = 12" - RIP RAP LINING ON THE EAST SIDE OF THE CHANNEL.

TYP DRAINAGE CHANNEL SECTION

Cross Section for Irregular Channel

Project Description	
Project File	c:\james\hydrology\shiloh\typ_sect.fm2
Worksheet	WEST CHANNEL - LOW FLOW
Flow Element	Irregular Channel
Method	Manning's Formula
Solve For	Discharge

Section Data	
Wtd. Mannings Coefficient	0.022
Channel Slope	0.007000 ft/ft
Water Surface Elevation	3.50 ft
Discharge	486.78 cfs

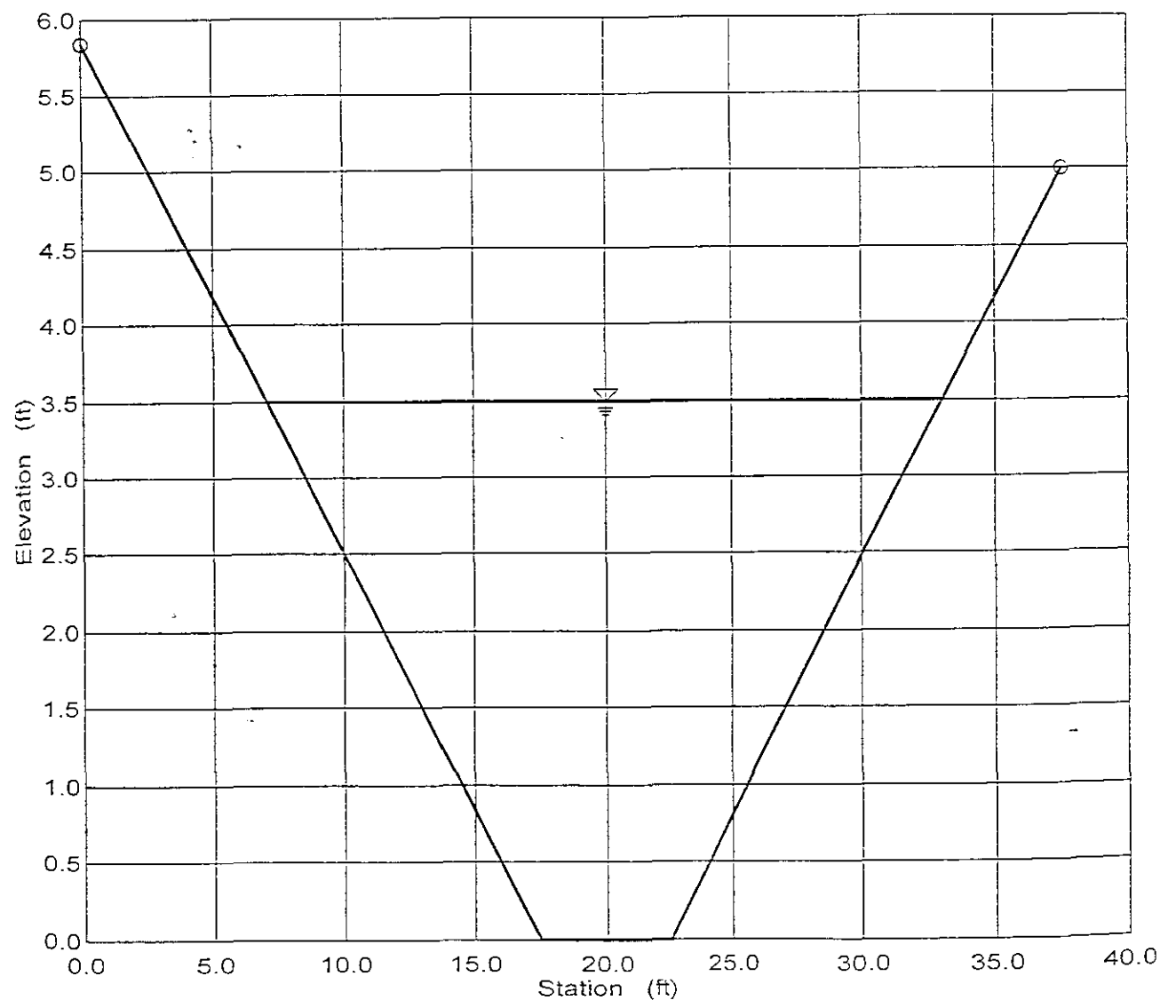

03/15/97
01:43:14 PM

SHILOH DRIVE - Q100 = 51 CFS
Worksheet for Irregular Channel

Project Description	
Project File	c:\james\hydrology\shiloh\typ_sect.fm2
Worksheet	TYP 60' R/W -NORMAL CROWN- "L" CURB
Flow Element	Irregular Channel
Method	Manning's Formula
Solve For	Water Elevation

Input Data

Channel Slope 0.030000 ft/ft

Elevation range: 0.00 ft to 2.00 ft.

Station (ft)	Elevation (ft)	Start Station	End Station	Roughness
0.00	2.00	0.00	7.01	0.013
0.01	0.60	7.01	52.99	0.016
5.00	0.50	52.99	60.00	0.013
5.50	0.50			
5.51	0.00			
7.00	0.13			
7.01	0.17			
30.00	0.63			
52.99	0.17			
53.00	0.13			
54.49	0.00			
54.50	0.50			
55.00	0.50			
59.99	0.60			
60.00	2.00			
Discharge	51.00	cfs		

Results

Wtd. Mannings Coefficient	0.015	
Water Surface Elevation	0.56	ft
Flow Area	9.32	ft ²
Wetted Perimeter	50.02	ft
Top Width	48.96	ft
Height	0.56	ft
Critical Depth	0.69	ft
Critical Slope	0.005327	ft/ft
Velocity	5.47	ft/s
Velocity Head	0.46	ft
Specific Energy	1.02	ft
Froude Number	2.21	
Flow is supercritical.		
Flow is divided.		

Notes: DV PRODUCT = 3.1 < 8.0 O.K.
 DEPTH OF FLOW IS 0.56' < 2.0'

TYP 60' R/W - SHILOH DRIVE
Cross Section for Irregular Channel

Project Description	
Project File	c:\james\hydrology\shiloh\typ_sect.fm2
Worksheet	TYP 60' R/W -NORMAL CROWN- "L" CURB
Flow Element	Irregular Channel
Method	Manning's Formula
Solve For	Water Elevation

Section Data	
Wtd. Mannings Coefficient	0.015
Channel Slope	0.030000 ft/ft
Water Surface Elevation	0.56 ft
Discharge	51.00 cfs

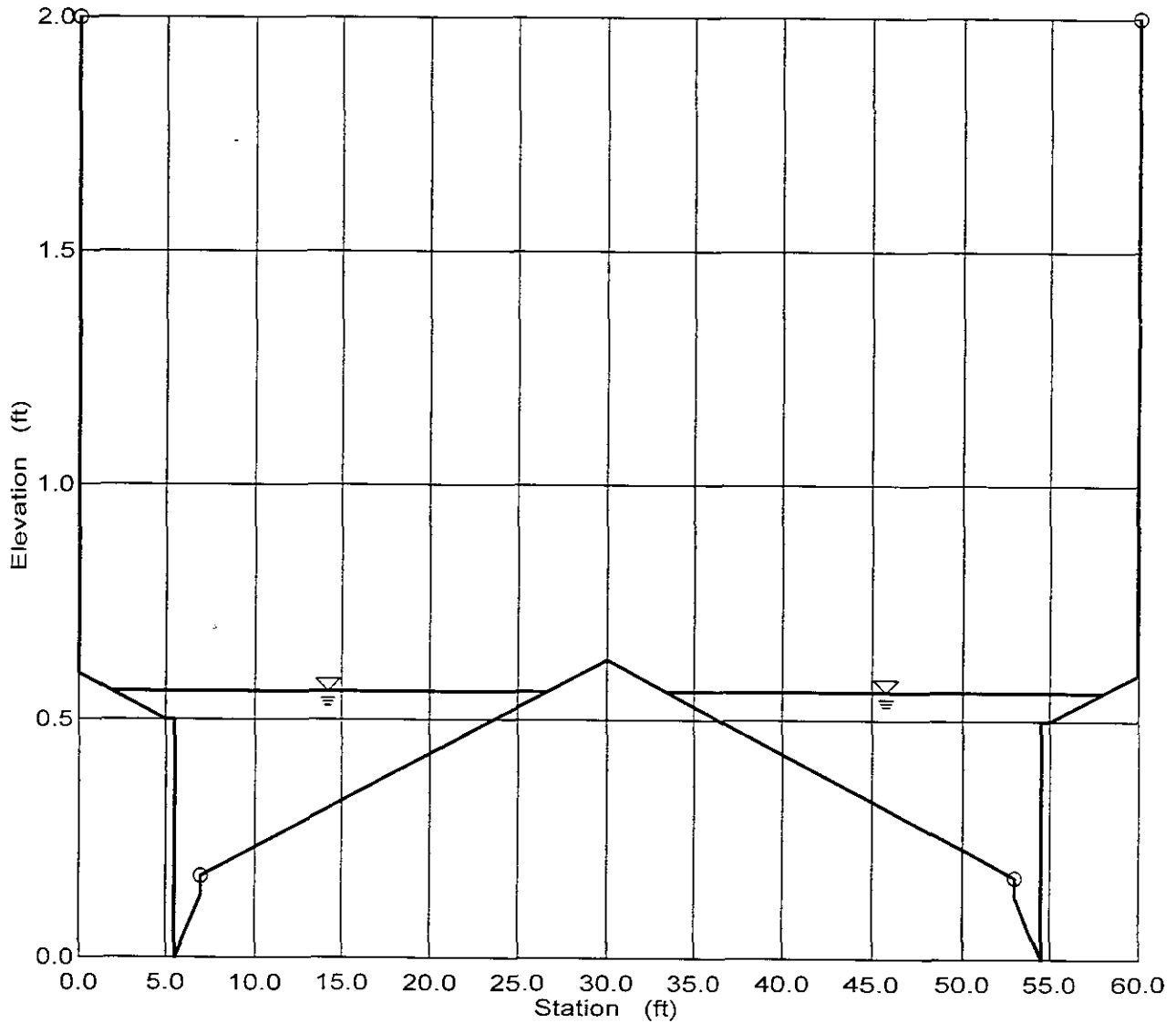

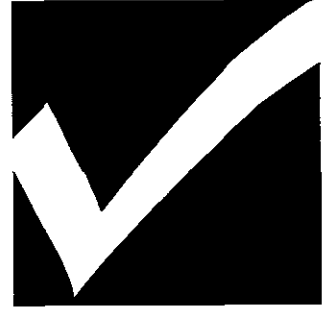

DS# 2128

DS INDEX 5356

APN 13807301004

PROJECT Zion Christian School

SUMITTAL 4th

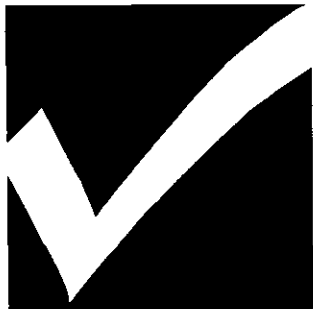

CITY OF LAS VEGAS		DATE:	
INTER-OFFICE MEMORANDUM		February 10, 1998	
TO: Barry Thompson, P.E. Land Development Services Department of Public Works		FROM: Dennis W. Stransky, P.E. Flood Control Project Manager Department of Public Works	
SUBJECT: Drainage Study for: Shiloh Christian School		COPIES TO: Alpha Engineering West Charleston Baptist Church John McNellis, P.E. CCRFCD	
FILE NO. \\KHAN\food\Depot\DSMEMOS\DS2128D.doc			
FEMA Flood Zone	YES	No	X
Proposed Storm Drain	YES	X	No

HISTORY	DATE RECEIVED	DATE REVIEWED	COMMENTS	REVIEW FEES
1 st Submittal	9/22/97	10/08/97	Not Accepted	\$250.00
2 nd submittal	10/17/97	10/27/97	Not Accepted	\$250.00
3 rd submittal	12/04/97	12/17/97	Not Accepted	\$250.00
4 th submittal	01/29/98	02/10/98	See Comments Below	\$250.00
TOTAL FEES				\$1000.00

REMARKS:

4th Submittal Addendum

The Drainage Study for the subject project has been reviewed and:

	is acceptable in concept subject to conformance to all City standards and the following conditions.
	must be resubmitted or supplemented including the following:
X	must have Clark County Regional Flood Control District concurrence

NOTE: The site is adjacent to or crosses an existing or proposed Clark County Regional Flood Control District (CCRFCD) master planned facility. Therefore, CCRFCD concurrence is required prior to final acceptance of the drainage study.

1. This study cannot be formally accepted until the Master Plan for the Lone Mountain Development is accepted, the LLC is formed, and the cost of proposed Gilmore channel is completely bonded as will be set forth by the Master Plan for the Lone Mountain Development area. However, the engineer may submit the study to CCRFCD for concurrence prior to the completion of said conditions.
2. The temporary drainage facility through the ball field area must be granted as a temporary public drainage easement to be privately maintained. The documents for this easement must be prepared and will be held by the right-of-way Section for a period of three years. If the permanent facilities controlling the drainage through the site have not been completed in that time period, the documents granting the easement will be recorded.
3. This project benefits from the Gilmore Channel System. Developments in this area will be required to make a contribution towards the construction of the Gilmore Channel prior to recordation of the Final Map. The contribution for this project will be determined by the cost estimates from the Lone Mountain Development Master Plan.

END OF REMARKS

gam

T/R/S: 20 S/ 60 E/ 7

AREA L07

*** TRANSMISSION REPORT ***

FEB-11-98 07:28 ID:3828551

CLV PW ENG PLANNING

JOB NUMBER 081
 INFORMATION CODE OK
 TELEPHONE NUMBER 8770300
 NAME(ID NUMBER) 702 877 0300
 START TIME FEB-11-98 07:27
 PAGES TRANSMITTED 002 TRANSMISSION MODE EMMR
 RESOLUTION STD REDIALING TIMES 00
 SECURITY OFF MAILBOX OFF
 MACHINE ENGAGED 01'07

THIS TRANSMISSION IS COMPLETED.

LAST SUCCESSFUL PAGE 002

Facsimile Transmission
 DEPARTMENT OF
Public Works



To: EDWARD TANEY
 Of: ALPHA ENGINEERING
 Fax Number 702/677-0300 • Phone Number 702/677-1300
 From: FLOOD CONTROL

	FAX	PHONE
Administration	382-0848	229-6276
<input type="checkbox"/> City Engineer Division	382-3232	229-6272
<input type="checkbox"/> Architectural Services	382-3232	229-6535
<input type="checkbox"/> Construction Services	254-4541	229-6337
<input type="checkbox"/> Engineering Design	382-3232	229-6272
<input type="checkbox"/> Land Development	383-9767	229-6371
<input type="checkbox"/> Special Improvement Districts	366-0032	229-2136
<input type="checkbox"/> Pavement Management	366-0032	229-2453
<input type="checkbox"/> Survey	386-5737	229-6217
<input type="checkbox"/> Traffic/Electrical Field Operations	382-0366	229-6331
<input checked="" type="checkbox"/> Engineering Planning	382-8551	229-6541
<input type="checkbox"/> Right of Way	382-8551	229-6483
<input type="checkbox"/> Streets and Sanitation	256-7817	229-6227
<input type="checkbox"/> Traffic Engineering	366-0032	229-6327
<input type="checkbox"/> LVACTS	229-6613	229-6611
<input type="checkbox"/> Environmental	641-9738	229-6200
<input type="checkbox"/> Water Pollution Control Facility	641-9738	229-6200
<input type="checkbox"/> Industrial Waste Pretreatment	641-9738	229-6200

(Area Code: 702)

Date: 2/11/98 Time 7:15 AM
 Page 1 of 2

Message: _____

Facsimile Transmission

DEPARTMENT of Public Works



To: EDWARD TANEY
Of: ALPHA ENGINEERING

Fax Number 702/877-0300 • Phone Number 702/877-1300

From: FLOOD CONTROL

	<u>FAX</u>	<u>PHONE</u>
Administration _____	382-0848	229-6276
<input type="checkbox"/> City Engineer Division _____	382-3232	229-6272
<input type="checkbox"/> Architectural Services _____	382-3232	229-6535
<input type="checkbox"/> Construction Services _____	254-4541	229-6337
<input type="checkbox"/> Engineering Design _____	382-3232	229-6272
<input type="checkbox"/> Land Development _____	383-9767	229-6371
<input type="checkbox"/> Special Improvement Districts _____	366-0032	229-2136
<input type="checkbox"/> Pavement Management _____	366-0032	229-2453
<input type="checkbox"/> Survey _____	386-5737	229-6217
<input type="checkbox"/> Traffic/Electrical Field Operations _____	382-0366	229-6331
<input checked="" type="checkbox"/> Engineering Planning _____	382-8551	229-6541
<input type="checkbox"/> Right of Way _____	382-8551	229-6483
<input type="checkbox"/> Streets and Sanitation _____	256-7817	229-6227
<input type="checkbox"/> Traffic Engineering _____	366-0032	229-6327
<input type="checkbox"/> LVACTS _____	229-6613	229-6611
<input type="checkbox"/> Environmental _____	641-9738	229-6200
<input type="checkbox"/> Water Pollution Control Facility _____	641-9738	229-6200
<input type="checkbox"/> Industrial Waste Pretreatment _____	641-9738	229-6200

(Area Code: 702)

Date: 2/11/98 Time 7:15 AM
Page 1 of 2

Message: _____

ALPHA ENGINEERING

Tel: (702) 877-1300
50 South Jones, Suite 202
Las Vegas, NV 89107
Fax: (702) 877-0300

Tel: (801) 628-6500
148 East Tabernacle
St. George, UT 84770
Fax: (801) 628-6553

LETTER OF TRANSMITTAL

DATE:	January 29, 1998
JOB NAME:	Shiloh Christian School
JOB NUMBER:	7161-01
TO:	City of Las Vegas
ATTENTION:	Dennis Stransky
ITEMS:	1 Addenda #3a Technical Drainage Study for Shiloh Christian School w/ 2 sets of Grading Plans
COMMENTS:	For your review/comment/approval.
FROM:	James Aquino

RECEIVED BY:

Fredra Juniors 1-29-98

tp

2128
LOT
N/C

CLARK COUNTY
REGIONAL FLOOD CONTROL DISTRICT

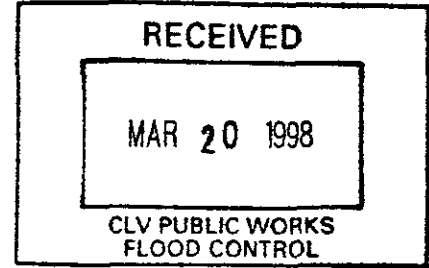

Gale Wm. Fraser, II, P.E.
General Manager / Chief Engineer

BOARD OF DIRECTORS

Lance M. Malone
Chairman
Clark County

Crescent Hardy
Vice-Chairman
City of Mesquite

Larry Brown
City of Las Vegas

Jan Laverty Jones
City of Las Vegas

Bryan A. Nix
City of Boulder City

John K. Rhodes
City of North Las Vegas

David Wood
City of Henderson

Bruce L. Woodbury
Clark County

March 5, 1998

Mr. Randy Fultz, P.E.
City of Las Vegas
Department of Public Works
400 East Stewart
Las Vegas, NV 89101

DISTRICT CONCURRENCE: SHILOH CHRISTIAN SCHOOL

Dear Mr. Fultz:

The District has reviewed the Technical Drainage Study dated September 27, 1997; Addendum No. 1 dated October 17, 1997; and Addendum No. 2 dated December 4, 1997; and Addendum No. 3 dated January 28, 1998, for the above captioned project as submitted by Alpha Engineering. In addition the District is in receipt of the Conditional Letter of Acceptance from the City of Las Vegas Department of Public Works dated February 10, 1998.

The District concurs with the acceptance of this Technical Drainage Study by the City of Las Vegas Department of Public Works.

The District's review of this project was limited to issues of Regional Flood Control Significance as defined in the Uniform Regulations for the Control of Drainage. Please be aware that as additional information becomes available and/or restudies of Flood Insurance Studies are performed, the information submitted by Alpha Engineering may be superseded. Compliance with the regulatory elements and design standards specified in the Uniform Regulations for the Control of Drainage does not imply a guarantee that properties will be free from flooding or flood damage. No liability is assumed by the District, its officials, or employees for the information, data or conclusions presented by the consulting engineer. We therefore make no warranties, either expressed or implied, in conducting this review.

GALE WM. FRASER II, P.E.
General Manager/Chief Engineer

BY: 
Kevin L. Eubanks, P.E.
Assistant General Manager

cc: Alpha Engineering

KLE:JHH:mak

File: 20-60-07.alp

Facsimile Transmission

DEPARTMENT of Public Works



To: JAMES AQUINO
Of: ALPHA ENGINEERING
Fax Number 702/877-0300 • Phone Number 702/877-1300
From: FLOOD CONTROL

	FAX	PHONE
Administration _____	382-0848	229-6276
<input type="checkbox"/> City Engineer Division _____	382-3232	229-6272
<input type="checkbox"/> Architectural Services _____	382-3232	229-6535
<input type="checkbox"/> Construction Services _____	254-4541	229-6337
<input type="checkbox"/> Development Coordination _____	474-7599	229-6578
<input type="checkbox"/> Engineering Design _____	382-3232	229-6272
<input type="checkbox"/> Land Development _____	383-9767	229-6371
<input type="checkbox"/> Special Improvement Districts _____	366-0032	229-2136
<input type="checkbox"/> Pavement Management _____	366-0032	229-2453
<input type="checkbox"/> Survey _____	386-5737	229-6217
<input type="checkbox"/> Traffic/Electrical Field Operations _____	382-0366	229-6331
<input checked="" type="checkbox"/> Engineering Planning _____	382-8551	229-6541
<input type="checkbox"/> Flood Control _____	385-2835	229-6541
<input type="checkbox"/> Right of Way _____	382-8551	229-6483
<input type="checkbox"/> Transportation Planning _____	474-7083	229-2452
<input type="checkbox"/> Streets and Sanitation _____	256-7817	229-6227
<input type="checkbox"/> Traffic Engineering _____	366-0032	229-6327
<input type="checkbox"/> LVACTS _____	229-6613	229-6611
<input type="checkbox"/> Environmental _____	641-9738	229-6200
<input type="checkbox"/> Water Pollution Control Facility _____	641-9738	229-6200
<input type="checkbox"/> Industrial Waste Pretreatment _____	641-9738	229-6200

Date: 3 / 24 / 98 Time 8:30 AM (Area Code: 702)
Page 1 of 3

Message: _____

Facsimile Transmission

DEPARTMENT of Public Works



To: ED TANEY

Of: ALPHA ENGINEERING

Fax Number 702/877-0300 • Phone Number 702/877-1300

From: FLOOD CONTROL

	<u>FAX</u>	<u>PHONE</u>
Administration _____	382-0848	229-6276
<input type="checkbox"/> City Engineer Division _____	382-3232	229-6272
<input type="checkbox"/> Architectural Services _____	382-3232	229-6535
<input type="checkbox"/> Construction Services _____	254-4541	229-6337
<input type="checkbox"/> Development Coordination _____	474-7599	229-6578
<input type="checkbox"/> Engineering Design _____	382-3232	229-6272
<input type="checkbox"/> Land Development _____	383-9767	229-6371
<input type="checkbox"/> Special Improvement Districts _____	366-0032	229-2136
<input type="checkbox"/> Pavement Management _____	366-0032	229-2453
<input type="checkbox"/> Survey _____	386-5737	229-6217
<input type="checkbox"/> Traffic/Electrical Field Operations _____	382-0366	229-6331
<input checked="" type="checkbox"/> Engineering Planning _____	382-8551	229-6541
<input type="checkbox"/> Flood Control _____	385-2835	229-6541
<input type="checkbox"/> Right of Way _____	382-8551	229-6483
<input type="checkbox"/> Transportation Planning _____	474-7083	229-2452
<input type="checkbox"/> Streets and Sanitation _____	256-7817	229-6227
<input type="checkbox"/> Traffic Engineering _____	366-0032	229-6327
<input type="checkbox"/> LVACTS _____	229-6613	229-6611
<input type="checkbox"/> Environmental _____	641-9738	229-6200
<input type="checkbox"/> Water Pollution Control Facility _____	641-9738	229-6200
<input type="checkbox"/> Industrial Waste Pretreatment _____	641-9738	229-6200

Date: 3 / 24 / 98 Time 7:45 AM (Area Code: 702)

Page 1 of 2

Message: _____

*** TRANSMISSION REPORT ***

MAR-24-98 08:31 ID:3028551

CLV PW ENG PLANNING

JOB NUMBER 453
 INFORMATION CODE OK
 TELEPHONE NUMBER 8770300
 NAME (ID NUMBER) 702 877 0300
 START TIME MAR-24-98 08:29
 PAGES TRANSMITTED 003 TRANSMISSION MODE EMMR
 RESOLUTION STD REDIALING TIMES 00
 SECURITY OFF MAILBOX OFF
 MACHINE ENGAGED 01'40

THIS TRANSMISSION IS COMPLETED.
 LAST SUCCESSFUL PAGE 003

Facsimile Transmission
 DEPARTMENT of
Public Works



To: JAMES AQUINO
 Of: ALPHA ENGINEERING
 Fax Number 702/877-0300 • Phone Number 702/877-1300
 From: FLOOD CONTROL

	FAX	PHONE
Administration	382-0848	229-6276
<input type="checkbox"/> City Engineer Division	382-3232	229-6272
<input type="checkbox"/> Architectural Services	382-3232	229-6535
<input type="checkbox"/> Construction Services	254-4541	229-6337
<input type="checkbox"/> Development Coordination	474-7599	229-6578
<input type="checkbox"/> Engineering Design	382-3232	229-6272
<input type="checkbox"/> Land Development	383-9767	229-6371
<input type="checkbox"/> Special Improvement Districts	366-0032	229-2136
<input type="checkbox"/> Pavement Management	366-0032	229-2453
<input type="checkbox"/> Survey	386-5737	229-6217
<input type="checkbox"/> Traffic/Electrical Field Operations	382-0366	229-6331
<input checked="" type="checkbox"/> Engineering Planning	382-8551	229-6541
<input type="checkbox"/> Flood Control	385-2835	229-6541
<input type="checkbox"/> Right of Way	382-8551	229-6483
<input type="checkbox"/> Transportation Planning	474-7083	229-2452
<input type="checkbox"/> Streets and Sanitation	256-7817	229-6227
<input type="checkbox"/> Traffic Engineering	366-0032	229-6327
<input type="checkbox"/> LVACTS	229-6613	229-6611
<input type="checkbox"/> Environmental	641-9738	229-6200
<input type="checkbox"/> Water Pollution Control Facility	641-9738	229-6200
<input type="checkbox"/> Industrial Waste Pretreatment	641-9738	229-6200

Date: 3/24/98 Time 8:30AM (Area Code: 702)
 Page 1 of 3

Message: _____

*** TRANSMISSION REPORT ***

MAR-24-98 08:06 ID:3828551

CLV PW ENG PLANNING

JOB NUMBER 449
 INFORMATION CODE OK
 TELEPHONE NUMBER 8770300
 NAME (ID NUMBER) 702 877 0300
 START TIME MAR-24-98 08:05
 PAGES TRANSMITTED 002 TRANSMISSION MODE EMMR
 RESOLUTION STD REDIALING TIMES 01
 SECURITY OFF MAILBOX OFF
 MACHINE ENGAGED 01'00

THIS TRANSMISSION IS COMPLETED.
 LAST SUCCESSFUL PAGE 002

Facsimile Transmission

DEPARTMENT OF
Public Works



To: ED TANEY
 Of: ALPHA ENGINEERING
 Fax Number 702/877-0300 • Phone Number 702/877-1300
 From: FLOOD CONTROL

	FAX	PHONE
Administration _____	382-0848	229-6276
<input type="checkbox"/> City Engineer Division _____	382-3232	229-6272
<input type="checkbox"/> Architectural Services _____	382-3232	229-6535
<input type="checkbox"/> Construction Services _____	254-4541	229-6337
<input type="checkbox"/> Development Coordination _____	474-7599	229-6578
<input type="checkbox"/> Engineering Design _____	382-3232	229-6272
<input type="checkbox"/> Land Development _____	383-9767	229-6371
<input type="checkbox"/> Special Improvement Districts _____	366-0032	229-2136
<input type="checkbox"/> Pavement Management _____	366-0032	229-2453
<input type="checkbox"/> Survey _____	386-5737	229-6217
<input type="checkbox"/> Traffic/Electrical Field Operations _____	382-0366	229-6331
<input checked="" type="checkbox"/> Engineering Planning _____	382-8551	229-6541
<input type="checkbox"/> Flood Control _____	385-2835	229-6541
<input type="checkbox"/> Right of Way _____	382-8551	229-6483
<input type="checkbox"/> Transportation Planning _____	474-7083	229-2452
<input type="checkbox"/> Streets and Sanitation _____	256-7817	229-6227
<input type="checkbox"/> Traffic Engineering _____	366-0032	229-6327
<input type="checkbox"/> LVACTS _____	229-6613	229-6611
<input type="checkbox"/> Environmental _____	641-9738	229-6200
<input type="checkbox"/> Water Pollution Control Facility _____	641-9738	229-6200
<input type="checkbox"/> Industrial Waste Pretreatment _____	641-9738	229-6200

(Area Code: 702)

Date: 3/24/98 Time 7:45 AM
 Page 1 of 2

Message: _____

***α* ALPHA ENGINEERING COMPANY**

2128
L07
#250

RECEIVED

JAN 29 1998

CLV PUBLIC WORKS
FLOOD CONTROL

ADDENDA #3 TECHNICAL DRAINAGE STUDY FOR SHILOH CHRISTIAN SCHOOL CITY OF LAS VEGAS, NEVADA

PREPARED FOR:
WEST CHARLESTON BAPTIST CHURCH
6701 WEST CHARLESTON BOULEVARD
LAS VEGAS, NEVADA 89102

January 28, 1998

PREPARED BY:
ALPHA ENGINEERING COMPANY
50 S. JONES BOULEVARD, SUITE 202
LAS VEGAS, NEVADA 89107

TELEPHONE (702) 877-1300
FAX (702) 877-0300

MUNICIPAL

COMMERCIAL

RESIDENTIAL

**ADDENDA #3
TECHNICAL DRAINAGE STUDY
FOR
SHILOH CHRISTIAN SCHOOL**

Job No. 7161-01
January 28, 1998

Prepared for:

WEST CHARLESTON BAPTIST CHURCH
6701 West Charleston Boulevard
Las Vegas, Nevada 89102

Prepared by:

Alpha Engineering Company
50 South Jones, Suite 202
Las Vegas, Nevada 89107

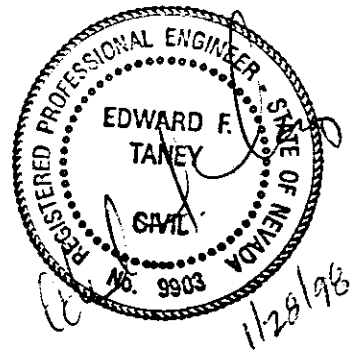

January 28, 1998
Job No. 7161-01

Mr. Dennis Stransky, P.E.
Planning & Community Land Development
400 East Stewart
Las Vegas, Nevada 89101

**SUBJECT: ADDENDA #3 TO THE TECHNICAL DRAINAGE STUDY FOR SHILOH
CHRISTIAN SCHOOL**

Dear Mr. Stransky:

Alpha Engineering Company is pleased to submit one copy of the Addenda and two sets of the Grading Plan to the above referenced drainage study for your approval. The project site is located within a portion of North Half (N ½) of the Southwest Quarter (SW ¼) of Section 7, Township 20 South, Range 60 East, in the City of Las Vegas, Clark County, Nevada.

The Addendum is in response to the review memorandum from the City of Las Vegas dated December 18, 1997.

Comment 1: This study will not be accepted until the Master Plan for the Lone Mountain Development is accepted, the LLC is formed, and the cost of proposed Gilmore channel is completely bonded as will be set forth by the Master Plan for the Lone Mountain Development area.

Response 1: Noted.

Comment 2: A typical cross section for Atwood Avenue and future top of curb elevations on the south side must be shown on the grading plan. The extension of Atwood Avenue must be also be addressed in the study and grading plans must be provided.

Response 2: A typical cross section for Atwood Avenue is provided on the Plan and Profile Sheet. Note that future top of curb elevations are provided along the south side of Atwood Avenue per City's request. In review of the Plan and Profile Sheet for Atwood Avenue, the street extends to Hualapai Way. Refer to the Temp Access Road – Atwood Avenue Plan and Profile Sheet (Sheet 9/13, 10/13 and 11/13) for further information.

Comment 3: This project benefits from the Gilmore Channel System. Developments in this area will be required to make a contribution of \$7,800 per acre towards the construction of the Gilmore Channel prior to recordation of the Final Map. The contribution for this project will be 30 acres x \$7,800 = \$234,000.

Response 3: Noted.

Comment 4: The temporary drainage facility through the ball field area must be granted as a temporary public drainage easement to be privately maintained. The documents for this easement must be prepared and will be held by the Right-Of-Way Section for a period of three years. If the permanent facilities controlling the drainage through the site have not been completed in that time period, the documents granting the easement will be recorded.

Response 4: Noted.

Comment 5: A copy of a notarized letter from the adjacent property owners granting permission for the off-site grading shown on the grading plans will be required for all off-site grading, filling, and rip-rap placement prior to receiving a grading permit.

Response 5: A copy of the notarized letter from FOCUS Inc has been obtained and provided for your information. Refer to the Appendix for the copy of the permission letter.

Noted: The site is adjacent to or crosses an existing or proposed Clark County Regional Flood Control District (CCRFCD) master planned facility. Therefore, CCRFCD concurrence is required prior to final acceptance of the drainage study.

Alpha Engineering shall submit the study and addenda to CCRFCD for concurrence upon final approval.

If you have any questions or comments, please feel free to contact me at 877-1300.

Sincerely,
Alpha Engineering Company

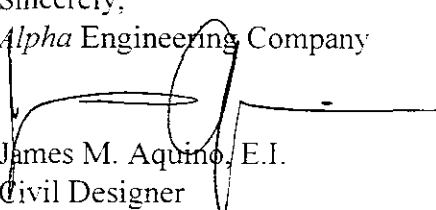
James M. Aquino, E.I.
Civil Designer

APPENDIX

F·O·C·U·S

Focus Commercial Group, Inc.

3320 N. Buffalo Dr., Suite 204

Las Vegas, Nevada 89129

(702) 242-4949 • Fax (702) 242-0414

January 6, 1998

West Charleston Baptist Church
6701 W. Charleston
L.V., NV 89102

Dear Sirs:

We understand that West Charleston Baptist Church ("Church") wishes to enter upon our real property, described as approximately 21 acres generally located at the north east corner of Hualapai and Cheyenne, Assessors Parcel Numbers 138-07-301-002, 008, 009 and 138-07-401-002 (the "Property"), for the purpose of the grading and construction of a temporary earthen berm and other related improvements as described in the Technical Drainage Study for Shiloh Christian School and any addenda thereto, as approved by the city of Las Vegas. We, as owners of the Property ("Owner"), have agreed to allow such entry and the performance of such work only after the complete satisfaction of the following conditions:

(a) All improvements to be constructed by Church on the Property shall be in conformance with plans and specifications approved by Owner;

(b) Church shall obtain all necessary licenses and permits for its activities, including, without limitation, a grading permit, and shall comply with all laws, regulation and ordinances applicable to their activities;

(c) Prior to entering on the Property, Church shall maintain throughout the term of this Agreement, commercial liability insurance (the "Insurance") covering the activities of Church and its agents, contractors and subcontractors on the Property, with a combined single limit of at least Two Million Dollars (\$2,000,000.00) primary coverage for bodily and personal injury and property damage, which insurance shall provide coverage for the indemnity obligations of Church set forth below;

(d) Church shall utilize only licensed and insured contractors to perform any work on the Property; and

(e) In the event the Church fails to restore the Property to its original condition as described below, the Church shall apply to Owner the sum, which shall be the cost incurred by Owner to restore the Real Property to the condition that existed prior to Church's entry on the Property.

If the Church fails to comply with any of such conditions, Owner may immediately terminate Church's right to access to the Property. The Insurance shall name Owner as an additional insured and shall contain a contractual liability endorsement covering Church's

insurable indemnity obligations hereunder. Prior to entry on the Property, Church shall deliver to Owner a certificate of insurance evidencing that Church has obtained the Insurance, which certificates shall provide that the insurer will give Owner at least (30) days' prior written notice of any material change, cancellation or non-renewal of such insurance policy. Such insurance shall be primary, and any insurance maintained by Owner for its protection shall be secondary or excess and not contributing to the Insurance. Church covenants and agrees to indemnify and hold the Property and Owner, its members, managers, agents and attorneys, free, clear and harmless and to defend Owner (with attorneys acceptable to Owner) from any and all losses, costs, damages, suits, liabilities, actions, proceedings, claims, demands, assessments, judgments, liens, costs and expenses, including attorney's fees and costs, arising from Church's entry and activities on the Property.

Church agrees and acknowledges that any and all improvements done to the Property shall be performed at Church's sole costs and expense and shall, at Owner's option, become the Property of Owner, and Church hereby waives any and all claims for payments or reimbursement therefore. Church shall perform and complete the improvements to the Property in a lien-free manner. Owner shall record a notice of non-responsibility against the Property, placing Church's contractors and laborers on notice that neither Owner nor the Property shall be responsible for the costs of such improvements.

The term shall be temporary and shall be allowed to remain on the Property until the Owner is prepared to commence construction. At that time the Owner shall provide written notice to the church of it's intent to begin development. The church shall then have 60 days to restore the Property to it's original condition or pay the cost of such restoration as described above.

Please execute this letter on the line provided below acknowledging your agreement to the above-listed conditions. Once the conditions have been satisfied, your work may commence on the Property.

Sincerely,

1-6-98 Kimberly Little

[Signature]
John A. Ritter
General Manager of Chieftain 5 and Gowan 20, LLC's

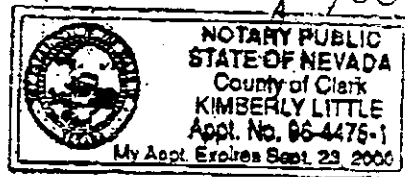

Agreed and Acknowledged:

By: *[Signature]*

Date: 1/27/98