

LEGEND

- PROPOSED SUBBASIN BOUNDARY
- PRORATED BASIN BOUNDARY
- ON1 PROPOSED DRAINAGE BASIN
- PR1 PRORATED BASIN
- FLOW DIRECTION

INTERIMULTIMATE CONDITIONS HEC-1 MODEL SUMMARY			
SUBBASIN OR CP	BASIN AREA (AC)	100 YR (cfs)	10 YR (cfs)
DOF1	17.09	40	18
DON1A	46.74	66	21
CP1	-	107	38
DOF2	3.43	<1	<1
DON1B	31.51	45	13
CP2	-	45	13

PRORATED BASIN STORM FLOW SUMMARY			
SUBBASIN OR CP	BASIN AREA (AC)	% OF DON1A	100 YR (cfs)
PR1	0.90	1.9	1
PR2	2.43	5.2	3
PR3	7.79	16.7	11
PR4	6.77	14.5	10
PR5	6.59	14.1	9
PR6	4.10	8.8	6
PR7	NOT USED		
PR8	5.59	11.9	8
PR9	5.87	12.6	8
PR10	2.14	4.6	3
PR11	4.55	9.7	6

PRORATED BASINS FOR DON1B STORM FLOW SUMMARY			
SUBBASIN OR CP	BASIN AREA (AC)	% OF DON1B	100 YR (cfs)
PR12	6.78	21.5	10
PR13	1.48	4.7	2
PR14	4.96	15.7	7
PR15	2.23	7.1	3
PR16	2.36	7.5	3
PR17	2.52	8.0	4
PR18	2.46	7.8	4
PR19	4.92	15.6	7
PR20	3.82	12.1	5

INTERIM CONDITION ONSITE DROP INLET SUMMARY				
DROP INLET	BASINS / CONC. PT.	Q100 (CFS)	Q100 (INTERCEPT) (CFS)	Q100 (BYPASS) (CFS)
D#1	1/2 OF BASINS (DOF1 AND PR1)	20.5	15.5	5
D#2	1/2 OF BASINS (DOF1 AND PR1)	20.5	15.5	5
D#3	1/2 OF (BYPASS D#1 + PR3 + PR4)	13	9	4
D#4	1/2 OF (BYPASS D#1 + PR3 + PR4)	13	9	4
D#5	BYPASS FROM (D#3 + D#4) + 40% OF BASIN PR5	12	8	4
D#6	60% OF PR5 + BYPASS FROM D#5	9	9	0
SUMP @ FUTURE D#7	PR9 + PR6	14	14	0
D#9	BYPASS FROM (D#10 + D#13)	10	10	0
D#10	BYPASS (D#2 + D#14) + PR2	12.5	4.5	8
D#13	BYPASS D#15	4.5	2.5	2
D#14	1/2 OF (PR8 + PR10 + PR11)	8.5	4	4.5
D#15	1/2 OF (PR8 + PR10 + PR11)	8.5	4	4.5

OFFSITE STREET BASINS SUMMARY		
SUBBASIN	AREA (ac)	Q ₁₀₀ (cfs)
ECR1	7.80	22
EFA1	2.70	8
EFA2	2.40	7
ELOG2	12.10	35

REFERENCED "TECHNICAL DRAINAGE STUDY FOR SUNSTONE PHASE 1 INFRASTRUCTURE (DS5135)" AND "TECHNICAL DRAINAGE STUDY FOR SUNSTONE PHASE 2 N. SKYE CANYON PARK DRIVE (DS5635)"

100-YEAR OFFSITE HYDRAULIC SECTIONS						
Location	Basins	Slope (%)	Q ₁₀₀ (cfs)	D ₁₀₀ (ft)	V ₁₀₀ (ft/sec)	D'V ₁₀₀
Section NC3a	-	1.40	3	0.34	2.61	0.9
Section NC3b	-	1.40	6	0.41	3.04	1.2
Section NC4b*	-	1.00	5	0.34	2.19	0.7
Section LC6*	-	3.83	13	0.37	4.57	1.7
Section LC7a*	-	3.83	5.5	0.35	4.4	1.5
Section LC7b*	-	3.75	7.5	0.46	4.68	2.2
Section SC1**	-	0.50	4	0.53	1.83	1.0
Section SC2**	-	0.50	3	0.39	1.71	0.7
Section SC3**	-	0.50	8	0.52	2.15	1.1

* HYDRAULIC SECTIONS LC6, LC7a, AND LC7b ARE REFERENCED "TECHNICAL DRAINAGE STUDY FOR SUNSTONE PHASE 1 INFRASTRUCTURE" (DS5135)

** HYDRAULIC SECTIONS SC1, SC2, AND SC3 REFERENCED FROM "TECHNICAL DRAINAGE STUDY FOR SUNSTONE PHASE 2 N. SKYE CANYON PARK DRIVE (DS5635)"

INTERIM CONDITION 100-YEAR HYDRAULIC SECTIONS SUMMARY						
Location	Basins	Slope (%)	Q ₁₀₀ (cfs)	D ₁₀₀ (ft)	V ₁₀₀ (ft/sec)	D'V ₁₀₀
Section 1	DOF1 + PR1	2.00	41	0.65	5.48	3.6
Section 2	DOF1 + PR1	0.53	41	0.63	3.21	2.0
Section 3	BYPASS FROM D#1 + PR3	0.71	16	0.43	2.55	1.1
Section 5	BYPASS FROM D#1 + PR3 + PR4	1.70	26	0.43	3.99	1.7
Section 6	BYPASS FROM (D#3 + D#4)	2.46	8	0.28	3.85	1.1
Section 7	PR5	2.56	9	0.29	4.00	1.2
Section 11	BYPASS FROM (D#2 + D#14 + D#15) + PR2	0.50	16	0.45	2.26	1.0
Section 12	BYPASS FROM D#2 + PR2	3.50	8	0.27	4.25	1.1
Section 13	BYPASS FROM D#2 + PR2	2.25	8	0.28	3.72	1.0
Section 14	PR10	1.52	3	0.23	2.48	0.6
Section 15	PR10 + PR11	3.50	9	0.27	4.67	1.3
Section 16A	PR3	3.69	11	0.29	4.71	1.4
Section 18	PR12 + PR13	1.69	12	0.34	3.54	1.2
Section 19	PR12 + PR13 + PR14 + PR15 + PR16 + PR17	1.77	29	0.44	4.19	1.7
Section 26	PR14 + PR15 + PR16 + PR17	0.89	17	0.42	2.82	1.2

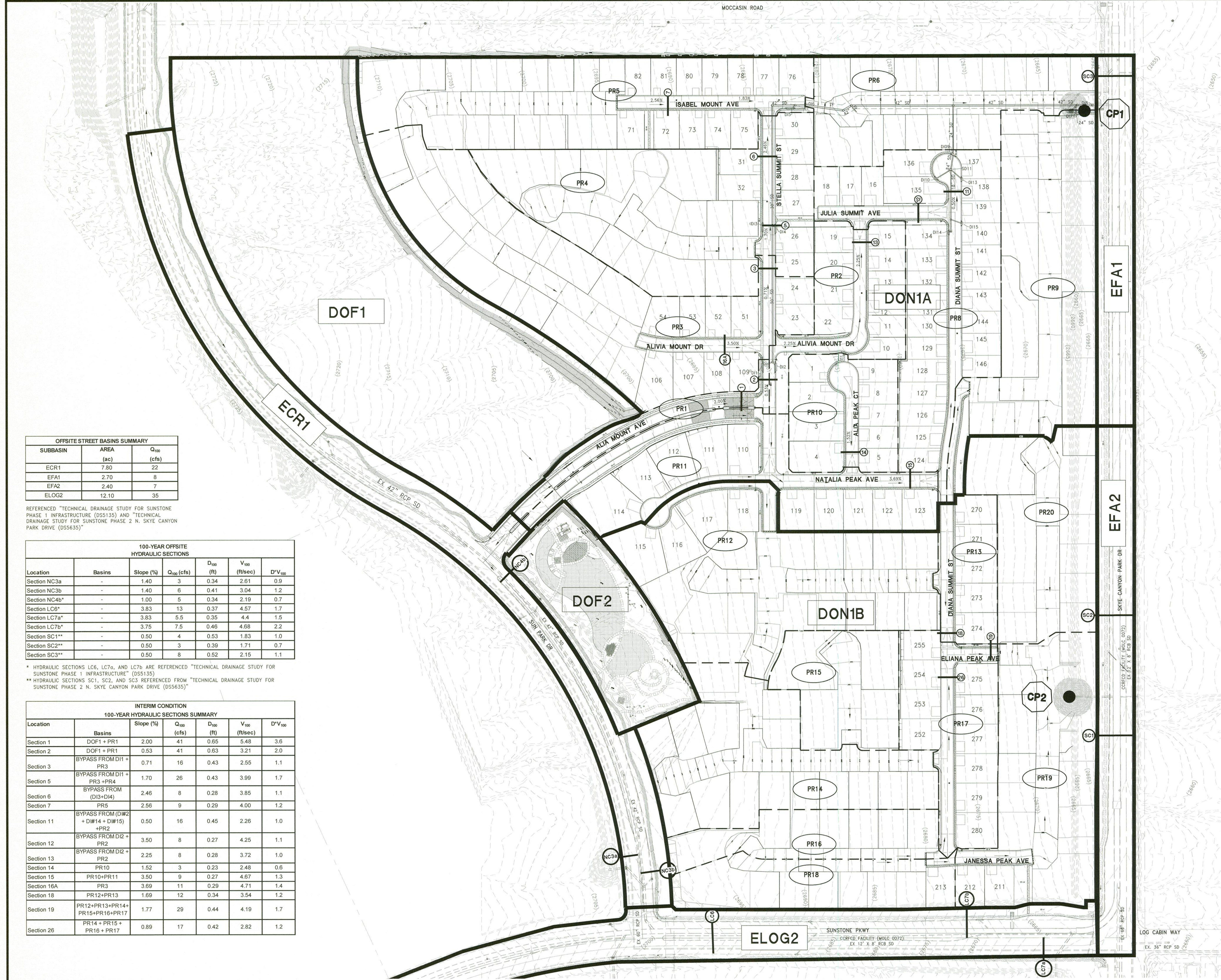

ALIA AT SUNSTONE
LENNAR

FIGURE 7
INTERIM CONDITIONS MAP

RCI ENGINEERING
500 SOUTH RANCHO DRIVE, SUITE 17, LAS VEGAS, NV 89106
MAIN: 702.453.0800 FAX: 702.453.0801

C:\3040_LENNAR\SUNSTONE\B\DRAIN\FIGURES\ORIGINAL\FIGURE7-INT.dwg savitaker 6/22/23 11:19am