

Proposed Condition 10-Year Street Flow Summary						
Section ID	Q ₁₀ (cfs)	Slope (%)	Depth (ft)	Velocity (fps)	DxV	Dry Lane (ft)
LC1 (Q = ELOG1(a))	5	4.06	0.28	3.83	1.1	20.5
LC2 (Q = Combined Bypass from LC1 Facilities + ELOG1(b))	4	4.06	0.27	3.67	1.0	21.0
LC3 (Q = Combined Bypass from LC2 Facilities + ELOG1(c) + ELOG2(a))	6	1.75	0.33	2.85	0.9	18.0
LC4 (Q = Combined Bypass from LC3 Facilities + ELOG2(b))	3	4.10	0.25	3.53	0.9	22.0
LC5 (Q = Combined Bypass from LC4 Facilities + ELOG2(c))	4	2.95	0.28	3.22	0.9	20.5
LC6 (Q = Combined Bypass from LC5 Facilities + ELOG2(d))	5	3.83	0.29	3.74	1.1	20.0
LC7a (Q = Bypass from LC6 Facilities + ELOG2(e))	2	3.83	0.27	3.59	1.0	21.0
LC7b (Q = Bypass from LC6 Facilities + ELOG2(f))	3	3.75	0.30	3.84	1.2	19.5
SC1* (Q = EFA4(a))	3	0.46	0.40	1.64	0.7	14.5
SC2* (Q = Bypass from SC1 + Combined Bypass from OH3 + EFA4(b) + EFA3(a))	14.5	0.46	0.61	2.37	1.4	21.5
SC3* (Q = EFA3(b))	1	0.22	0.33	3.89	1.3	35.5
SC4* (Q = EFA3(c))	1	0.65	0.28	1.52	0.4	38.0

Proposed Condition 100-Year Street Flow Summary						
Section ID	Q ₁₀₀ (cfs)	Slope (%)	Depth (ft)	Velocity (fps)	DxV	Dry Lane (ft)
LC1 (Q = ELOG1(a))	10	4.06	0.34	4.41	1.5	
LC2 (Q = Combined Bypass from LC1 Facilities + ELOG1(b))	7	4.06	0.31	4.09	1.3	
LC3 (Q = Combined Bypass from LC2 Facilities + ELOG1(c) + ELOG2(a))	12	1.75	0.40	3.32	1.3	
LC4 (Q = Combined Bypass from LC3 Facilities + ELOG2(b))	9	4.10	0.33	4.34	1.4	
LC5 (Q = Combined Bypass from LC4 Facilities + ELOG2(c))	11	2.95	0.36	3.97	1.4	
LC6 (Q = Combined Bypass from LC5 Facilities + ELOG2(d))	13	3.83	0.37	4.57	1.7	
LC7a (Q = Bypass from LC6 Facilities + ELOG2(e))	5.5	3.83	0.35	4.40	1.5	
LC7b (Q = Bypass from LC6 Facilities + ELOG2(f))	7.5	3.75	0.38	4.68	1.8	
ER1 (Q = EP2 + EOH1(d))	26	1.5	0.51	3.72	1.9	
ER2 (Q = EOH1(e))	2	0.6	0.29	1.48	0.4	
SP1* (Q = ESKY1(a))	4	1.5	0.37	2.85	1.1	
SP2* (Q = Bypass from Facility SP1 + EMLA1 + ESKY1(b))	12	2.9	0.45	4.73	2.1	
SP3* (Q = Bypass from Facility SP1a + ESKY1(c))	4	2.9	0.34	3.68	1.3	
SP4* (Q = Bypass from Facility SP3a + EMLA1 + ESKY1(d))	14	2.9	0.47	4.90	2.3	
SC1* (Q = EFA4(a))	5	0.46	0.45	1.85	0.8	
SC2* (Q = Bypass from SC1 + Combined Bypass from OH3 + EFA4(b) + EFA3(a))	14.5	0.46	0.61	2.37	1.4	
SC3* (Q = EFA3(b))	3	0.22	0.44	1.24	0.5	
SC4* (Q = EFA3(c))	2	0.65	0.34	1.73	0.6	
OH1 (Q = EP2 + EPG + EOH1(a))	70	2.63	0.61	6.19	3.8	
OH2 (Q = Combined Bypass from OH1 Facilities + EOH1(b))	39	4.37	0.49	6.18	3.0	
OH3 (Q = Combined Bypass from OH2 Facilities + EOH1(c))	36	3.76	0.49	5.73	2.8	
OH4 (Q = EP2 + EPG + EOH1(a+d))	68	0.95	0.7	4.50	3.2	
NC2a* (Q = ECR1(b))	3	2.06	0.27	2.64	0.7	
NC2b* (Q = ECR1(c))	4	2.06	0.29	2.79	0.8	
NC4a* (Q = ECR1(d))	2	1	0.27	1.83	0.5	
NC4b* (Q = ECR1(e))	5	1	0.34	2.19	0.7	

Recommended Flood Control Facility Summary						
Facility ID	Facility Description	Total Approaching Flow (cfs) Q ₁₀₀ /Q ₁₀	Facility Flow (cfs) Q ₁₀₀ /Q ₁₀	Surface/Bypass Flow (cfs) Q ₁₀₀ /Q ₁₀	Notes	
LC1	5' Type CM2 DI & 18" RCP	5/2.5	3/2	2/1		
LC2	12' 5" Type CM2 DI & 18" RCP	3.5/2	3/2	0/0		
LC3	5' Type CM2 DI & 18" RCP	6/3	3/2	3/1		
LC4	5' Type CM2 DI	4.5/1.5	2/2	2/0		
LC5	5' Type CM2 DI	5.5/2	3/1	2/1		
LC6	5' Type CM2 DI & 18" RCP	6.5/2.5	3/2	4/1		
LC7a	10' Type CM2 DI	5.5/2	5/2	1/0		
LC7b	15' Type CM2 DI & 18" RCP	7.5/3	6/3	1/0		Sump Inlet
LC8	5' Type CM2 DI & 18" RCP	2/0	2/0	0/0		
SC1	5' Type CM2 DI & 18" RCP	3/2	3/2	2/1		Sump Inlet
SC2	7.5' Type CM2 DI & 18" RCP	14.5/NA	14.5/NA	0/0		
SC3	5' Type CM2 DI & 18" RCP	3/1	2/1	1/0		
SC4	7.5' Type CM2 DI & 18" RCP	2/1	2/1	0/0		
OH1	15' Type CM2 DI & 18" RCP	35	18	17		
OH2	12' 5" Type CM2 DI & 18" RCP	19.5	6	13		Sump Inlet
OH3	20' Type CM2 DI & 18" RCP	18	14	4		Sump Inlet
OH4	5' Type CM2 DI & 18" RCP	2.5	2.5	0		Sump Inlet
NC1a	5' Type CM2 DI & 18" RCP	2.5	2.5	0		
NC1b	5' Type CM2 DI & 18" RCP	3	3	0		Sump Inlet
NC2a	7.5' Type CM2 DI	4	3	1		Sump Inlet
NC2b	5' Type CM2 DI & 18" RCP	4	3	1		Sump Inlet
NC3a	7.5' Type CM2 DI	3	3	0		Sump Inlet
NC3b	5' Type CM2 DI & 18" RCP	6	2	4		Sump Inlet
NC4a	5' Type CM2 DI & 18" RCP	5	3	2		Sump Inlet
NC4b	5' Type CM2 DI & 18" RCP	2	2	0		Sump Inlet
SP1a	5' Type CM2 DI & 18" RCP	4	2	2		Sump Inlet
SP1b	5' Type CM2 DI & 18" RCP	4	2	2		Sump Inlet
SP2a	7.5' Type CM2 DI	12	12	0		Sump Inlet
SP2b	5' Type CM2 DI & 18" RCP	6	6	0		Sump Inlet
SP3a	5' Type CM2 DI	4	2	2		Sump Inlet
SP3b	5' Type CM2 DI & 18" RCP	4	2	2		Sump Inlet
SP4a	5' Type CM2 DI & 18" RCP	14	5	9		Sump Inlet
SP4b	5' Type CM2 DI & 18" RCP	4	2	2		Sump Inlet

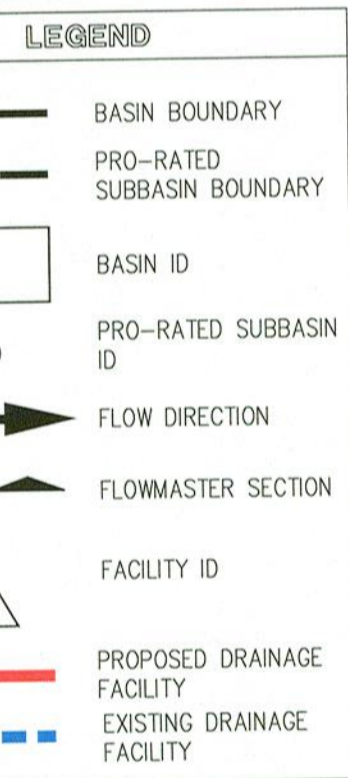

Prorated Flow Summary						
Basin ID	Q ₁₀₀ (cfs)	Q ₁₀ (cfs)	Area (acres)	100-yr Unit Flow (cfs/acre)	10-yr Unit Flow (cfs/acre)	
ESKY1	23	13	8.2	2.8	1.6	
ELOG1	15	8	4.3	3.5	1.9	
ELOG2	35	19	12.1	2.9	1.6	
EOHR1	29	16	10.1	2.9	1.6	
EFA3	7	4	2.5	2.8	1.6	
EFA4	8	5	2.8	2.9	1.6	
ECR1	22	12	7.8	2.8	1.5	
EMR2	26	8	19.2	1.4	0.4	
TOTAL	23	13	8.2	3.5	1.9	

Subbasin ID	Q ₁₀₀ (cfs)	Q ₁₀ (cfs)	Area (acres)	100-yr Unit Flow (cfs/acre)	10-yr Unit Flow (cfs/acre)	
ESKY1(a)	4	2	1.4	2.8	1.6	
ESKY1(b)	2	1	0.8	2.8	1.6	
ESKY1(c)	2	1	0.7	2.8	1.6	
ESKY1(d)	3	2	1.1	2.8	1.6	
ESKY1(e)	4	3	1.6	2.8	1.6	
ESKY1(f)	2	1	0.7	2.8	1.6	
ESKY1(g)	2	1	0.7	2.8	1.6	
ESKY1(h)	4	2	1.3	2.8	1.6	
TOTAL	23	13	8.2	3.5	1.9	

Facility ID	Facility Description	Total Approaching Flow (cfs) Q ₁₀₀ /Q ₁₀	Facility Flow (cfs) Q ₁₀₀ /Q ₁₀	Surface/Bypass Flow (cfs) Q ₁₀₀ /Q ₁₀	Notes
OH1	15' Type CM2 DI & 18" RCP	35	18	17	
OH2	12' 5" Type CM2 DI & 18" RCP	19.5	6	13	
OH3	20' Type CM2 DI & 18" RCP	18	14	4	
OH4	5' Type CM2 DI & 18" RCP	2.5	2.5	0	
NC1a	5' Type CM2 DI & 18" RCP	2.5	2.5	0	
NC1b	5' Type CM2 DI & 18" RCP	3	3	0	
NC2a	7.5' Type CM2 DI	4	3	1	
NC2b	5' Type CM2 DI & 18" RCP	4	3	1	
NC3a	7.5' Type CM2 DI	3	3	0	
NC3b	5' Type CM2 DI & 18" RCP	6	2	4	
NC4a	5' Type CM2 DI & 18" RCP	5	3	2	
NC4b	5' Type CM2 DI & 18" RCP	2	2	0	
SP1a	5' Type CM2 DI & 18" RCP	4	2	2	
SP1b	5' Type CM2 DI & 18" RCP	4	2	2	
SP2a	7.5' Type CM2 DI	12	12	0	
SP2b	5' Type CM2 DI & 18" RCP	6	6	0	
SP3a	5' Type CM2 DI	4	2	2	
SP3b	5' Type CM2 DI & 18" RCP	4	2	2	
SP4a	5' Type CM2 DI & 18" RCP	14	5	9	
SP4b	5' Type CM2 DI & 18" RCP	4	2	2	

\\slater\projects\100_sunstone\100_sunstone.dwg, 8/7/2019, 10:08 AM, Collin, Algoton

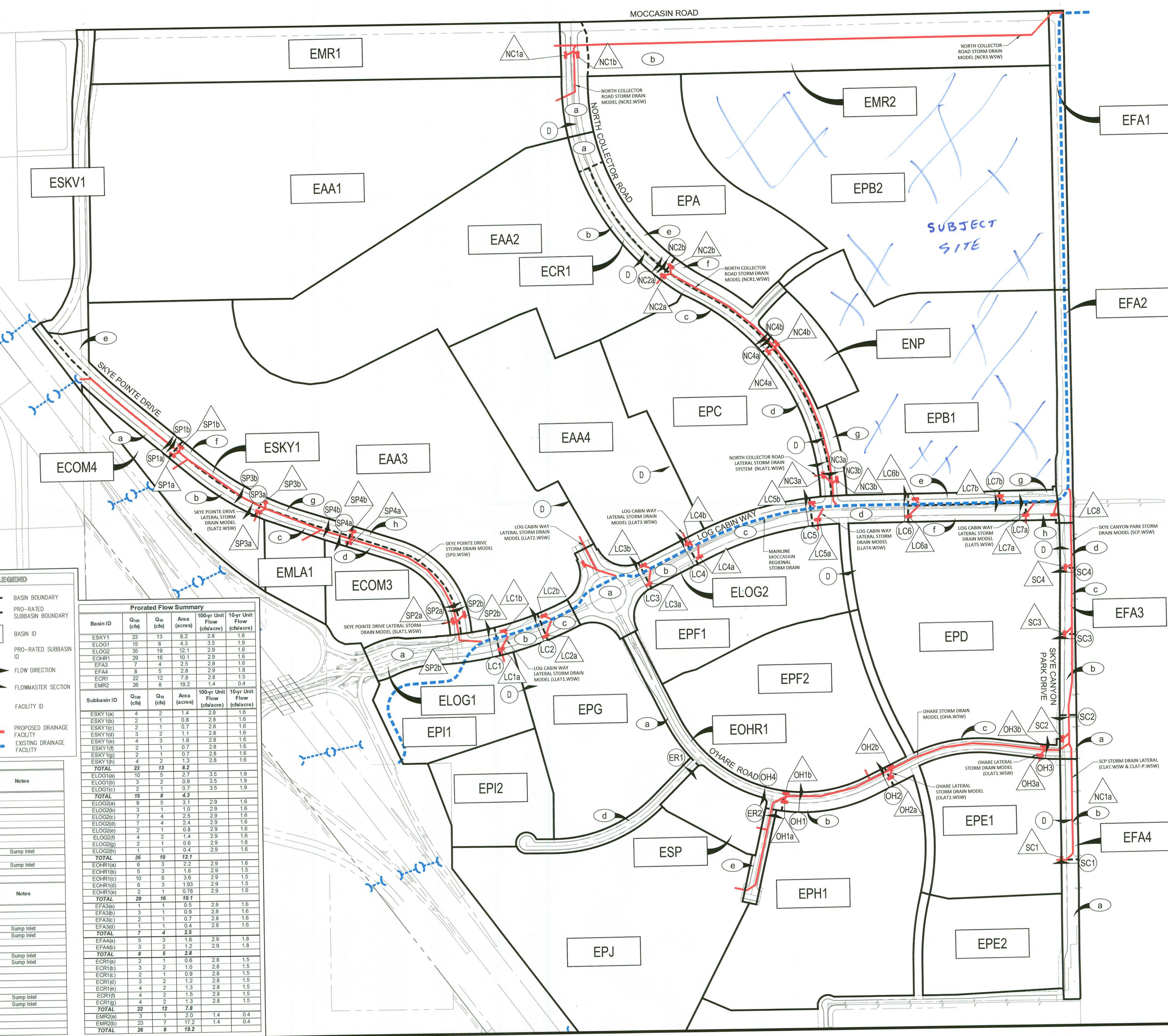

DATE	BY	APP.	DATE	DESCRIPTION	NO.

EASTLAND COMPANY, LLC
SUNSTONE PHASE 1
CROSS SECTION AND FACILITIES MAP

DATE: AUG 2019
DRAFTER: CAA
DESIGNER: CAA
CHECKED: LKL
PROJECT NO.
EST1905-000

EXHIBIT E
SHEET 1 OF 1